

Application for Permanent Water Right Transfer



Oregon Water Resources Department
725 Summer Street NE, Suite A
Salem, Oregon 97301-1266
(503) 986-0900
www.oregon.gov/OWRD

Part 1 of 5 – Minimum Requirements Checklist

This transfer application will be returned if Parts 1 through 5 and all required attachments are not completed and included.
For questions, please call (503) 986-0900, and ask for Transfer Section.

Received

JUN 10 2024

OWRD

Check all items included with this application. (N/A = Not Applicable)

- Part 1 – Completed Minimum Requirements Checklist.
- Part 2 – Completed Transfer Application Map Checklist.
- Part 3 – Application Fee, payable by check to the Oregon Water Resources Department, and completed Fee Worksheet, page 3. Try the new online fee calculator at:
http://apps.wrd.state.or.us/apps/misc/wrd_fee_calculator.
- Part 4 – Completed Applicant Information and Signature.
- Part 5 – Information about Water Rights to be Transferred: **How many water rights are to be transferred? 3 List them here: 45701, 32589, 23923**
Please include a separate Part 5 for each water right. (See instructions on page 6)
NOTE: A separate transfer application is required for each water right unless the criteria in OAR 690-380-3220 are met.

Attachments:

- Completed Transfer Application Map.
- Completed Evidence of Use Affidavit and supporting documentation.
- N/A Affidavit(s) of Consent from Landowner(s) (if the applicant does not own the land the water right is on.)
- N/A Supplemental Form D – For water rights served by or issued in the name of an irrigation district. Complete when the transfer applicant is not the irrigation district.
- N/A Oregon Water Resources Department’s Land Use Information Form with approval and signature from each local land use authority in which water is to be diverted, conveyed, and/or used. Not required if water is to be diverted, conveyed, and/or used only on federal lands or if **all** of the following apply: a) a change in place of use only, b) no structural changes, c) the use of water is for irrigation only, and d) the use is located within an irrigation district or an exclusive farm use zone.
- N/A Water Well Report/Well Log for changes in point(s) of appropriation (well(s)) or additional point(s) of appropriation.
- N/A Geologist Report for a change from a surface water point of diversion to a ground water point of appropriation (well), if the proposed well is more than 500’ from the surface water source and more than 1000’ upstream or downstream from the point of diversion. See OAR 690-380-2130 for requirements and applicability.

(For Staff Use Only)

WE ARE RETURNING YOUR APPLICATION FOR THE FOLLOWING REASON(S):

<input type="checkbox"/> Application fee not enclosed/insufficient	<input type="checkbox"/> Map not included or incomplete
<input type="checkbox"/> Land Use Form not enclosed or incomplete	<input type="checkbox"/> Evidence of Use Form not enclosed or incomplete
<input type="checkbox"/> Additional signature(s) required	<input type="checkbox"/> Part _____ is incomplete

Other/Explanation _____

Staff: _____ 503- _____ Date: ____/____/____

Part 2 of 5 – Transfer Application Map

Your transfer application will be returned if any of the map requirements listed below are not met.

Please be sure that the transfer application map you submit includes all the required items and matches the existing water right map. Check all boxes that apply.

- N/A Certified Water Right Examiner (CWRE) Stamp and Original Signature. For a list of CWREs, see http://apps.wrd.state.or.us/apps/wr/cwre_license_view/. CWRE stamp and signature are not required for substitutions.
- N/A If **more than three** water rights are involved, separate maps are needed for each water right.
 - Permanent quality printed with dark ink on good quality paper.
 - The size of the map can be 8½ x 11 inches, 8½ x 14 inches, 11 x 17 inches, or up to 30 x 30 inches. For 30 x 30 inch maps, one extra copy is required.
 - A north arrow, a legend, and scale.
 - The scale of the map must be: 1 inch = 400 feet, 1 inch = 1,320 feet, the scale of the Final Proof/Claim of Beneficial Use Map (the map used when the permit was certificated), the scale of the county assessor map if the scale is not smaller than 1 inch = 1,320 feet, or a scale that has been pre-approved by the Department.
 - Township, Range, Section, ¼ ¼, DLC, Government Lot, and other recognized public land survey lines.
 - Tax lot boundaries (property lines) are required. Tax lot numbers are recommended.
 - Major physical features including rivers and creeks showing direction of flow, lakes and reservoirs, roads, and railroads.
 - Major water delivery system features from the point(s) of diversion/appropriation such as main pipelines, canals, and ditches.
 - Existing place of use that includes separate hachuring for each water right, priority date, and use including number of acres in each quarter-quarter section, government lot, or in each quarter-quarter section as projected within government lots, donation land claims, or other recognized public land survey subdivisions. If less than the entirety of the water right is being changed, a separate hachuring is needed for lands left unchanged.
- N/A Proposed place of use that includes separate hachuring for each water right, priority date, and use including number of acres in each quarter-quarter section, government lot, or in each quarter-quarter section as projected within government lots, donation land claims, or other recognized public land survey subdivisions.
- Existing point(s) of diversion or well(s) with distance and bearing or coordinates from a recognized survey corner. This information can be found in your water right certificate or permit.
- N/A If you are proposing a change in point(s) of diversion or well(s), show the proposed location and label it clearly with distance and bearing or coordinates. If GPS coordinates are used, latitude-longitude coordinates may be expressed as either degrees-minutes-seconds with at least one digit after the decimal (example – 42°32'15.5") or degrees-decimal with five or more digits after the decimal (example – 42.53764°).

14471 -

Received

JUN 10 2024

Part 3 of 5 – Fee Worksheet

FEE WORKSHEET for PERMANENT TRANSFER (except Substitution)

1	Base Fee (includes one type of change to one water right for up to 1 cfs)	1	\$1,360
	Types of change proposed: <input checked="" type="checkbox"/> Place of Use <input type="checkbox"/> Character of Use <input type="checkbox"/> Point of Diversion/Appropriation Number of above boxes checked = <u>1 (2a)</u> Subtract 1 from the number in line 2a = <u>0 (2b)</u> <i>If only one change, this will be 0</i>		
2	Multiply line 2b by \$1090 and enter »	2	0
	Number of water rights included in transfer <u>3 (3a)</u> Subtract 1 from the number in 3a above: <u>2 (3b)</u> <i>If only one water right this will be 0</i>		
3	Multiply line 3b by \$610 and enter »	3	\$1,220
	Do you propose to add or change a well, or change from a surface water POD to a well? <input checked="" type="checkbox"/> No: enter 0 <input type="checkbox"/> Yes: enter \$480 for the 1 st well to be added or changed _____ (4a) Do you propose to add or change additional wells? <input checked="" type="checkbox"/> No: enter 0 <input type="checkbox"/> Yes: multiply the number of additional wells by \$410 _____ (4b)		
4	Add line 4a to line 4b and enter »	4	0
	Do you propose to change the place of use or character of use? <input type="checkbox"/> No: enter 0 on line 5 <input checked="" type="checkbox"/> Yes: enter the cfs for the portions of the rights to be transferred (see below*): <u>1.23 (5a)</u> Subtract 1.0 from the number in 5a above: <u>0.23 (5b)</u> If 5b is 0 or less, enter 0 on line 5 » If 5b is greater than 0, round up to the nearest whole number: <u>1 (5c)</u> and multiply 5c by \$410, then enter on line 5 »		
5		5	\$410
6	Add entries on lines 1 through 5 above » » » » » » » » » » » » » » » » Subtotal:	6	
	Is this transfer: <input type="checkbox"/> necessary to complete a project funded by the Oregon Watershed Enhancement Board (OWEB) under ORS 541.932? <input type="checkbox"/> endorsed in writing by ODFW as a change that will result in a net benefit to fish and wildlife habitat? If one or more boxes is checked, multiply line 6 by 0.5 and enter on line 7 »		
7	If no box is applicable, enter 0 on line 7 »	7	NA
8	Subtract line 7 from line 6 » Transfer Fee:	8	\$2,990

Received
JUN 10 2024
OWRD

*Example for Line 5a calculation to transfer 45.0 acres of Primary Certificate 12345 (total 1.25 cfs for 100 acres) and 45.0 acres of Supplemental Certificate 87654 (1/80 cfs per acre) on the same land:

- For irrigation calculate cfs for each water right involved as follows:
 - Divide total authorized cfs by total acres in the water right (*for C12345, 1.25 cfs ÷ 100 ac*); then multiply by the number of acres to be transferred to get the transfer cfs (*x 45 ac = 0.56 cfs*).
 - If the water right certificate does not list total cfs, but identifies the allowable use as 1/40 or 1/80 of a cfs per acre; multiply number of acres proposed for change by either 0.025 (1/40) or 0.0125 (1/80). (*For C87654, 45.0 ac x 0.0125 cfs/ac = 0.56 cfs*)
- Add cfs for the portions of water rights on all the land included in the transfer; however **do not count cfs for supplemental rights on acreage for which you have already calculated the cfs fee for the primary right on the same land**. The fee should be assessed only once for each "on the ground" acre included in the transfer. (*In this example, blank 5a would be only 0.56 cfs, since both rights serve the same 45.0 acres. Blank 5b would be 0 and Line 5 would then also become 0*).

FEE WORKSHEET for SUBSTITUTION

1	Base Fee (includes change to one well)	1	\$990.00
	Number of wells included in substitution _____ (2a) Subtract 1 from the number in 2a above: _____ (2b) <i>If only one well this will be 0</i>		
2	Multiply line 2b by \$480 and enter »	2	NA
3	Add entries on lines 1 through 2 above » » » » » » Fee for Substitution:	3	NA

14471 -

Part 4 of 5 – Applicant Information and Signature

Applicant Information

APPLICANT/BUSINESS NAME Robert Manzi & Joseph Manzi		PHONE NO.	ADDITIONAL CONTACT NO.
ADDRESS 13370 Elkins RD		FAX NO.	
CITY Monmouth	STATE OR	ZIP 97361	E-MAIL
BY PROVIDING AN E-MAIL ADDRESS, CONSENT IS GIVEN TO RECEIVE ALL CORRESPONDENCE FROM THE DEPARTMENT ELECTRONICALLY. COPIES OF THE FINAL ORDER DOCUMENTS WILL ALSO BE MAILED.			

Agent Information – The agent is authorized to represent the applicant in all matters relating to this application.

AGENT/BUSINESS NAME McKee, Zach		PHONE NO. 503-944-3116	ADDITIONAL CONTACT NO.
ADDRESS 11640 ELKINS RD		FAX NO.	
CITY Monmouth	STATE OR	ZIP 97101	E-MAIL
BY PROVIDING AN E-MAIL ADDRESS, CONSENT IS GIVEN TO RECEIVE ALL CORRESPONDENCE FROM THE DEPARTMENT ELECTRONICALLY. COPIES OF THE FINAL ORDER DOCUMENTS WILL ALSO BE MAILED.			

Explain in your own words what you propose to accomplish with this transfer application, and why:
Move senior water rights to location of center pivot. We would like 5 years to complete the changes and prove up on the transfer.

If you need additional space, continue on a separate piece of paper and attach to the application as "Attachment 1".

Check One Box

- By signing this application, I understand that, upon receipt of the draft preliminary determination and prior to Department approval of the transfer, I will be required to provide landownership information and evidence that I am authorized to pursue the transfer as identified in OAR 690-380-4010(5); **OR**
- I affirm the applicant is a municipality as defined in ORS 540.510(3)(b) and that the right is in the name of the municipality or a predecessor; **OR**
- I affirm the applicant is an entity with the authority to condemn property and is acquiring by condemnation the property to which the water right proposed for transfer is appurtenant and have supporting documentation.

Received
JUN 10 2024
OWRD

By my signature below, I confirm that I understand:

- Prior to Department approval of the transfer application, I may be required to submit payment to the Department for publication of a notice in a newspaper with general circulation in the area where the water right is located, once per week for two consecutive weeks. If more than one qualifying newspaper is available, I suggest publishing the notice in the following newspaper: Polk County Itemizer-Observer.
- Amendments to the application may only be made in response to the Department's Draft Preliminary Determination (DPD). The applicant will have a period of at least 30 days to amend the application to address any issues identified by the Department in the DPD, or to withdraw the application. Note that amendments may be subject to additional fees, pursuant to ORS 536.050.
- Failure to complete an approved change in place of use and/or change in character of use, will result in loss of the water right (OAR 690-380-6010).
- Refunds may only be granted upon request and, as set forth in ORS 536.050(4)(a), if the Director determines that a refund of all or part of a fee is appropriate in the interests of fairness to the public or necessary to correct an error of the Department.

I (we) affirm that the information contained in this application is true and accurate.

Applicant signature

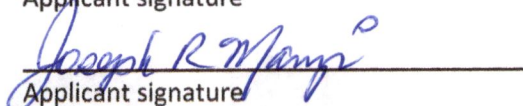

Applicant signature

Robert Manzi
Print Name (and Title if applicable)

6/06/24
Date

Joseph Manzi
Print Name (and Title if applicable)

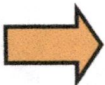
06/06/24
Date



Is the applicant the sole owner of the land on which the water right, or portion thereof, proposed for transfer is located? Yes No*

**If NO, include signatures of all deeded landowners (and mailing and/or e-mail addresses if different than the applicant's) or attach affidavits of consent (and mailing and/or e-mail addresses) from all landowners or individuals/entities to which the water right(s) were conveyed.*

Check the following boxes that apply:

- The applicant is responsible for completion of change(s). Notices and correspondence should continue to be sent to the applicant.
- The receiving landowner will be responsible for completing the proposed change(s) after the final order is issued. Copies of notices and correspondence should be sent to this landowner.
- Both the receiving landowner and applicant will be responsible for completion of change(s). Copies of notices and correspondence should be sent to this landowner and the applicant.

At this time, are the lands in this transfer application in the process of being sold? Yes No

If YES, and you know who the new landowner will be, please complete the receiving landowner information table below. If you do not know who the new landowner will be, then a request for assignment will have to be filed for at a later date.

If a property sells, the certificated water right(s) located on the land belong to the new owner, unless a sale agreement or other document states otherwise. For more information see:

https://www.oregon.gov/owrd/WRDFormsPDF/Transfer_Property_Transactions.pdf

RECEIVING LANDOWNER NAME NA			PHONE NO.	ADDITIONAL CONTACT NO.
ADDRESS			FAX NO.	Received
CITY	STATE	ZIP	E-MAIL	JUN 10 2024
Describe any special ownership circumstances:				OWRD
The confirming Certificate shall be issued in the name of: <input type="checkbox"/> Applicant <input type="checkbox"/> Receiving Landowner				

Check here if any of the water rights proposed for transfer are or will be located within or served by an irrigation or other water district. (Tip: Complete and attach Supplemental Form D.)

IRRIGATION DISTRICT NAME NA	ADDRESS		
CITY	STATE	ZIP	

Check here if water for any of the rights supplied under a water service agreement or other contract for stored water with a federal agency or other entity.

ENTITY NAME NA	ADDRESS		
CITY	STATE	ZIP	

 To meet State Land Use Consistency Requirements, you must list all county, city, municipal corporation, or tribal governments within whose jurisdiction water will be diverted, conveyed or used.

ENTITY NAME Polk County	ADDRESS 850 Main St		
CITY Dallas	STATE OR	ZIP 97338	

14471 -

Part 5 of 5 – Water Right Information

Please use a separate Part 5 for each water right being changed. See instructions on page 6, to copy and paste additional Part 5s, or to add additional rows to tables within the form.

CERTIFICATE # 45701

Description of Water Delivery System

System capacity: 0.47 cubic feet per second (cfs) **OR**
 _____ gallons per minute (gpm)

Describe the current water delivery system or the system that was in place at some time within the last five years. Include information on the pumps, canals, pipelines, and sprinklers used to divert, convey, and apply the water at the authorized place of use. 6in Underground Mainline to Pivot & B3 gun.

Table 1. Location of Authorized and Proposed Point(s) of Diversion (POD) or Appropriation (POA)

(Note: If the POD/POA name is not specified on the certificate, assign it a name or number here.)

POD/POA Name or Number	Is this POD/POA Authorized on the Certificate or is it Proposed?	If POA, OWRD Well Log ID# (or Well ID Tag # L-___)	Twp		Rng		Sec	¼ ¼		Tax Lot, DLC or Gov't Lot	Measured Distances (from a recognized survey corner)
POD 1	<input checked="" type="checkbox"/> Authorized <input type="checkbox"/> Proposed	NA	9	S	5	W	16	SE	SW		240' N & 1550' E FROM SW CORNER, DLC 57
	<input type="checkbox"/> Authorized <input type="checkbox"/> Proposed										
	<input type="checkbox"/> Authorized <input type="checkbox"/> Proposed										
	<input type="checkbox"/> Authorized <input type="checkbox"/> Proposed										

Check all type(s) of change(s) proposed below (change "CODES" are provided in parentheses):

- | | |
|--|---|
| <input checked="" type="checkbox"/> Place of Use (POU) | <input type="checkbox"/> Supplemental Use to Primary Use (S to P) |
| <input type="checkbox"/> Character of Use (USE) | <input type="checkbox"/> Point of Appropriation/Well (POA) |
| <input type="checkbox"/> Point of Diversion (POD) | <input type="checkbox"/> Additional Point of Appropriation (APOA) |
| <input type="checkbox"/> Additional Point of Diversion (APOD) | <input type="checkbox"/> Substitution (SUB) |
| <input type="checkbox"/> Surface Water POD to Ground Water POA (SW/GW) | <input type="checkbox"/> Government Action POD (GOV) |

Received
JUN 10 2024
OWRD

Will all of the proposed changes affect the entire water right?

- Yes Complete only the Proposed ("to" or "on" lands) section of Table 2 on the next page. Use the "CODES" listed above to describe the proposed changes.
- No Complete all of Table 2 to describe the portion of the water right to be changed.

14471 -

Please use and attach additional pages of Table 2 as needed.
See page 6 for instructions.

Do you have questions about how to fill-out the tables?
Contact the Department at 503-986-0900 and ask for Transfer Staff.

Table 2. Description of Changes to Water Right Certificate # 45701

List the change proposed for the acreage in each ¼ ¼. If more than one change is proposed, specify the acreage associated with each change.
If there is more than one POD/POA involved in the proposed changes, specify the acreage associated with each POD/POA.

AUTHORIZED (the "from" or "off" lands) The listing that appears on the certificate BEFORE PROPOSED CHANGES List only that part or portion of the water right that will be changed.													Proposed Changes (see "CODES" from previous page)	PROPOSED (the "to" or "on" lands) The listing as it would appear AFTER PROPOSED CHANGES are made.															
Twp	Rng	Sec	¼	¼	Tax Lot	Gvt Lot or DLC	Acres	Type of USE listed on Certificate	POD(s) or POA(s) (name or number from Table 1)	Priority Date	Twp	Rng		Sec	¼	¼	Tax Lot	Gvt Lot or DLC	Acres	New Type of USE	POD(s)/POA(s) to be used (from Table 1)	Priority Date							
EXAMPLE																													
2	S	9	E	15	NE	NW	100		15.0	Irrigation	POD #1	POD #2	1901	POU/POD	2	S	9	E	1	NW	NW	500	1	10.0		POD #5	1901		
															2	S	9	E	2	SW	NW	500		5.0		POD #6	1901		
9	S	5	W	16	NE	NW		57	10.5	IR	POD 1		1970	POU	9	S	5	W	16	NW	NE			17.8	IR	POD 1	1970		
9	S	5	W	16	NE	SW		57	12.1	IR	POD 1		1970	POU	9	S	5	W	16	SW	NE			5.7	IR	POD 1	1970		
9	S	5	W	16	NW	SW		57	2.1	IR	POD 1		1970	POU	9	S	5	W	16	SE	NW			0.2	IR	POD 1	1970		
9	S	5	W	16	SE	SW		57	2.8	IR	POD 1		1970	POU	9	S	5	W	16	SW	NW			0.2	IR	POD 1	1970		
															9	S	5	W	16	NE	NW			3.6	IR	POD 1	1970		
							TOTAL ACRES:	27.5														TOTAL ACRES:	27.5						

Additional remarks: Would like to request five years to complete changes.

Received
JUN 10 2024
OWRD

14471

Part 5 of 5 – Water Right Information

Please use a separate Part 5 for each water right being changed. See instructions on page 6, to copy and paste additional Part 5s, or to add additional rows to tables within the form.

CERTIFICATE # 32589

Received

JUN 10 2024

Description of Water Delivery System

System capacity: **0.62** cubic feet per second (cfs) **OR**
 _____ gallons per minute (gpm)

OWRD

Describe the current water delivery system or the system that was in place at some time within the last five years. Include information on the pumps, canals, pipelines, and sprinklers used to divert, convey, and apply the water at the authorized place of use. *bin underground Mainline TO PIVOT & big gun.*

Table 1. Location of Authorized and Proposed Point(s) of Diversion (POD) or Appropriation (POA)

(Note: If the POD/POA name is not specified on the certificate, assign it a name or number here.)

POD/POA Name or Number	Is this POD/POA Authorized on the Certificate or is it Proposed?	If POA, OWRD Well Log ID# (or Well ID Tag # L-___)	Twp	Rng	Sec	¼	¼	Tax Lot, DLC or Gov't Lot	Measured Distances (from a recognized survey corner)	
POD 1	<input checked="" type="checkbox"/> Authorized <input type="checkbox"/> Proposed		9	S	5	W	16	SE SW	57	240' N & 1550' E FROM SW CORNER, DLC 57
	<input type="checkbox"/> Authorized <input type="checkbox"/> Proposed									
	<input type="checkbox"/> Authorized <input type="checkbox"/> Proposed									
	<input type="checkbox"/> Authorized <input type="checkbox"/> Proposed									

Check all type(s) of change(s) proposed below (change "CODES" are provided in parentheses):

- | | |
|--|---|
| <input checked="" type="checkbox"/> Place of Use (POU) | <input type="checkbox"/> Supplemental Use to Primary Use (S to P) |
| <input type="checkbox"/> Character of Use (USE) | <input type="checkbox"/> Point of Appropriation/Well (POA) |
| <input type="checkbox"/> Point of Diversion (POD) | <input type="checkbox"/> Additional Point of Appropriation (APOA) |
| <input type="checkbox"/> Additional Point of Diversion (APOD) | <input type="checkbox"/> Substitution (SUB) |
| <input type="checkbox"/> Surface Water POD to Ground Water POA (SW/GW) | <input type="checkbox"/> Government Action POD (GOV) |

Will all of the proposed changes affect the entire water right?

- Yes Complete only the Proposed ("to" or "on" lands) section of Table 2 on the next page. Use the "CODES" listed above to describe the proposed changes.
- No Complete all of Table 2 to describe the portion of the water right to be changed.

Please use and attach additional pages of Table 2 as needed.
See page 6 for instructions.

Do you have questions about how to fill-out the tables?
Contact the Department at 503-986-0900 and ask for Transfer Staff.

Table 2. Description of Changes to Water Right Certificate # 32589

List the change proposed for the acreage in each ¼ ¼. If more than one change is proposed, specify the acreage associated with each change.
If there is more than one POD/POA involved in the proposed changes, specify the acreage associated with each POD/POA.

Additional remarks: _____.

AUTHORIZED (the "from" or "off" lands) The listing that appears on the certificate BEFORE PROPOSED CHANGES List only that part or portion of the water right that will be changed.											Proposed Changes (see "CODES" from previous page)	PROPOSED (the "to" or "on" lands) The listing as it would appear AFTER PROPOSED CHANGES are made.														
Twp	Rng	Sec	¼	¼	Tax Lot	Gvt Lot or DLC	Acres	Type of USE listed on Certificate	POD(s) or POA(s) (name or number from Table 1)	Priority Date		Twp	Rng	Sec	¼	¼	Tax Lot	Gvt Lot or DLC	Acres	New Type of USE	POD(s)/POA(s) to be used (from Table 1)	Priority Date				
EXAMPLE																										
2	S	9	E	15	NE	NW	100		15.0	Irrigation	POD #1 POD #2	1901	POU/POD	2	S	9	E	1	NW	NW	500	1	10.0		POD #5	1901
														2	S	9	E	2	SW	NW	500		5.0		POD #6	1901
9	S	5	W	16	NE	NW			0.5	IR	POD 1	1962	POU	9	S	5	W	16	NW	NE			0.1	IR	POD 1	1962
9	S	5	W	16	SW	NW			0.6	IR	POD 1	1962		9	S	5	W	16	NE	NW			9.3	IR	POD 1	1962
9	S	5	W	16	SE	NW			3.1	IR	POD 1	1962		9	S	5	W	16	SE	NW			6.3	IR	POD 1	1962
9	S	5	W	16	NW	SE			4.6	IR	POD 1	1962		9	S	5	W	16	SW	NE			9.7	IR	POD 1	1962
9	S	5	W	16	NE	SW			16.6	IR	POD 1	1962														
TOTAL ACRES:							25.4						TOTAL ACRES:							25.4						

Received

14471 -

JUN 10 2024

OWRD

Part 5 of 5 – Water Right Information

Please use a separate Part 5 for each water right being changed. See instructions on page 6, to copy and paste additional Part 5s, or to add additional rows to tables within the form.

CERTIFICATE # 23923

Received

JUN 10 2024

Description of Water Delivery System

System capacity: **0.99** cubic feet per second (cfs) **OR**
 _____ gallons per minute (gpm)

OWRD

Describe the current water delivery system or the system that was in place at some time within the last five years. Include information on the pumps, canals, pipelines, and sprinklers used to divert, convey, and apply the water at the authorized place of use. _____

Table 1. Location of Authorized and Proposed Point(s) of Diversion (POD) or Appropriation (POA)

(Note: If the POD/POA name is not specified on the certificate, assign it a name or number here.)

POD/POA Name or Number	Is this POD/POA Authorized on the Certificate or is it Proposed?	If POA, OWRD Well Log ID# (or Well ID Tag # L-____)	Twp		Rng		Sec	¼ ¼		Tax Lot, DLC or Gov't Lot	Measured Distances (from a recognized survey corner)
POD 1	<input checked="" type="checkbox"/> Authorized <input type="checkbox"/> Proposed		9	S	5	W	16	NW	SE	57	
	<input type="checkbox"/> Authorized <input type="checkbox"/> Proposed										
	<input type="checkbox"/> Authorized <input type="checkbox"/> Proposed										
	<input type="checkbox"/> Authorized <input type="checkbox"/> Proposed										

Check all type(s) of change(s) proposed below (change "CODES" are provided in parentheses):

- | | |
|---|---|
| <input checked="" type="checkbox"/> Place of Use (POU)
<input type="checkbox"/> Character of Use (USE)
<input type="checkbox"/> Point of Diversion (POD)
<input type="checkbox"/> Additional Point of Diversion (APOD)
<input type="checkbox"/> Surface Water POD to Ground Water POA (SW/GW) | <input type="checkbox"/> Supplemental Use to Primary Use (S to P)
<input type="checkbox"/> Point of Appropriation/Well (POA)
<input type="checkbox"/> Additional Point of Appropriation (APOA)
<input type="checkbox"/> Substitution (SUB)
<input type="checkbox"/> Government Action POD (GOV) |
|---|---|

Will all of the proposed changes affect the entire water right?

- Yes Complete only the Proposed ("to" or "on" lands) section of Table 2 on the next page. Use the "CODES" listed above to describe the proposed changes.
- No Complete all of Table 2 to describe the portion of the water right to be changed.

14471 -

Please use and attach additional pages of Table 2 as needed.
See page 6 for instructions.

Do you have questions about how to fill-out the tables?
Contact the Department at 503-986-0900 and ask for Transfer Staff.

Table 2. Description of Changes to Water Right Certificate # 23923

List the change proposed for the acreage in each ¼ ¼. If more than one change is proposed, specify the acreage associated with each change.
If there is more than one POD/POA involved in the proposed changes, specify the acreage associated with each POD/POA.

Additional remarks: _____.

AUTHORIZED (the "from" or "off" lands) The listing that appears on the certificate BEFORE PROPOSED CHANGES List only that part or portion of the water right that will be changed.											Proposed Changes (see "CODES" from previous page)	PROPOSED (the "to" or "on" lands) The listing as it would appear AFTER PROPOSED CHANGES are made.																	
Twp	Rng	Sec	¼	¼	Tax Lot	Gvt Lot or DLC	Acres	Type of USE listed on Certificate	POD(s) or POA(s) (name or number from Table 1)	Priority Date		Twp	Rng	Sec	¼	¼	Tax Lot	Gvt Lot or DLC	Acres	New Type of USE	POD(s)/POA(s) to be used (from Table 1)	Priority Date							
EXAMPLE																													
2	S	9	E	15	NE	NW	100		15.0	Irrigation	POD #1 POD #2	1901	POU/POD	2	S	9	E	1	NW	NW	500	1	10.0		POD #5	1901			
																									POD #6	1901			
9	S	5	W	16	NW	NE			15.7	IR	POD 1	1953	POU	9	S	5	W	16	SW	NW			0.1	IR	POD 1	1953			
9	S	5	W	16	SW	NE			11.4	IR	POD 1	1953	POU	9	S	5	W	16	SE	NW			2.7	IR	POD 1	1953			
9	S	5	W	16	NE	NW			9.2	IR	POD 1	1953	POU	9	S	5	W	16	NW	SE			8.9	IR	POD 1	1953			
9	S	5	W	16	SE	NW			8.2	IR	POD 1	1953	POU	9	S	5	W	16	NE	SW			28.7	IR	POD 1	1953			
TOTAL ACRES:							44.5							TOTAL ACRES:							44.5								

14471 -

Received

JUN 10 2024

For Place of Use or Character of Use Changes

Are there other water right certificates, water use permits or ground water registrations associated with the “from” or the “to” lands? Yes No

If YES, list the certificate, water use permit, or ground water registration numbers: _____.



Pursuant to ORS 540.510, any “layered” water use such as an irrigation right that is supplemental to a primary right proposed for transfer must be included in the transfer or be cancelled. Any change to a ground water registration must be filed separately in a ground water registration modification application.

For Substitution (ground water supplemental irrigation will be substituted for surface water primary irrigation)

Ground water supplemental Permit or Certificate # NA;
Surface water primary Certificate # _____.

Received

JUN 10 2024

For a change from Supplemental Irrigation Use to Primary Irrigation Use

Identify the primary certificate to be cancelled. Certificate # NA

OWRD

For a change in point(s) of appropriation (well(s)) or additional point(s) of appropriation:

Well log(s) are attached for each authorized and proposed well(s) that are clearly labeled and associated with the corresponding well(s) in Table 1 above and on the accompanying application map.

Tip: You may search for well logs on the Department’s web page at:
http://apps.wrd.state.or.us/apps/gw/well_log/Default.aspx

AND/OR

Describe the construction of the authorized and proposed well(s) in Table 3 for any wells that do not have a well log. For *proposed wells not yet constructed or built*, provide “a best estimate” for each requested information element in the table. The Department recommends you consult a licensed well driller, geologist, or certified water right examiner to assist with assembling the information necessary to complete Table 3.

Table 3. Construction of Point(s) of Appropriation

Any well(s) in this listing must be clearly tied to corresponding well(s) described in Table 1 and shown on the accompanying application map. Failure to provide the information will delay the processing of your transfer application until it is received. The information is necessary for the department to assess whether the proposed well(s) will access the same source aquifer as the authorized point(s) of appropriation (POA). The Department is prohibited by law from approving POA changes that do not access the same source aquifer.

Proposed or Authorized POA Name or Number	Is well already built? (Yes or No)	If an existing well: OWRD Well ID Tag No. L-____	Total well depth	Casing Diameter	Casing Intervals (feet)	Seal depth(s) (intervals)	Perforated or screened intervals (in feet)	Static water level of completed well (in feet)	Source aquifer (sand, gravel, basalt, etc.)	Well-specific rate (cfs or gpm). If less than full rate of water right
NA										

14471 -

Land Use Information Form



Oregon Water Resources Department
725 Summer Street NE, Suite A
Salem, Oregon 97301-1266
(503) 986-0900
www.oregon.gov/OWRD

Received
JUN 10 2024
OWRD

NOTE TO APPLICANTS

In order for your application to be processed by the Oregon Water Resources Department (OWRD), this Land Use Information Form must be completed by a local government planning official in the jurisdiction(s) where your water right will be diverted, conveyed, used, and developed. The planning official may choose to complete the form while you wait or return the "Receipt Acknowledging Request for Land Use Information" to you. Applications received by OWRD without the Land Use Information Form, or the signed receipt, will be returned to you. **IMPORTANT:** Please note that while OWRD can accept a signed receipt as part of intake for an application for a new permit to use or store water, a completed Land Use Information Form is required for OWRD's acceptance of all other applications. Please be aware that your application cannot be approved without land use approval.

This form is **NOT** required if:

- 1) Water is to be diverted, conveyed, and used on federal lands only; **OR**
- 2) The application is for a water right transfer, allocation of conserved water, exchange, permit amendment, or ground water registration modification, and **all** of the following apply:
 - a. The existing and proposed water use is located entirely within lands zoned for exclusive farm-use or within an irrigation district;
 - b. The application involves a change in place of use only;
 - c. The change does not involve the placement or modification of structures, including but not limited to water diversion, impoundment, distribution facilities, water wells and well houses; **and**
 - d. The application involves irrigation water uses only.

NOTE TO LOCAL GOVERNMENTS

The person presenting the attached Land Use Information Form is applying for a new water right or modifying an existing water right. The Oregon Water Resources Department (OWRD) requires applicants to obtain land use information to ensure the water right does not result in land uses that are incompatible with your comprehensive plan. Please complete the form and return it to the applicant for inclusion in their application. **NOTE:** For new water right applications only, if you are unable to complete this form while the applicant waits, you may complete the "Receipt Acknowledging Request for Land Use Information" and return it to the applicant.

You will receive notice via OWRD's weekly Public Notice once the applicant formally submits their request to OWRD. The notice will give more information about OWRD's water right process and provide additional comment opportunities. If you previously only completed the receipt for an application for a new permit to use or store water, you will have 30 days from the Public Notice date to complete the Land Use Information Form and return it to OWRD. Your attention to this request for information is greatly appreciated. If you have questions concerning this form, please contact OWRD's Customer Service Group at 503-986-0900 or WRD_DL_customerservice@water.oregon.gov.

Land Use Information Form



Oregon Water Resources Department
 725 Summer Street NE, Suite A
 Salem, Oregon 97301-1266
 (503) 986-0900
 www.oregon.gov/OWRD

NAME Robert Manzi & Joseph Manzi				PHONE	
MAILING ADDRESS 13370 Elkins RD					
CITY Monmouth		STATE OR	ZIP 97361	EMAIL	

A. Land and Location

Please include the following information for all tax lots where water will be diverted (taken from its source), conveyed (transported), and/or used or developed. Applicants for municipal use, or irrigation uses within irrigation districts, may substitute existing and proposed service-area boundaries for the tax-lot information requested below.

Township	Range	Section	¼ ¼	Tax Lot #	Plan Designation (e.g., Rural Residential/RR-5)	Water to be:			Proposed Land Use:
9 S	5 W	16		200		<input checked="" type="checkbox"/> Diverted	<input checked="" type="checkbox"/> Conveyed	<input checked="" type="checkbox"/> Used	
						<input type="checkbox"/> Diverted	<input type="checkbox"/> Conveyed	<input type="checkbox"/> Used	
						<input type="checkbox"/> Diverted	<input type="checkbox"/> Conveyed	<input type="checkbox"/> Used	
						<input type="checkbox"/> Diverted	<input type="checkbox"/> Conveyed	<input type="checkbox"/> Used	

List all counties and cities where water is proposed to be diverted, conveyed, and/or used or developed:

Polk County

NOTE: A separate Land Use Information Form must be completed and submitted for each county and city, as applicable.

B. Description of Proposed Use

Type of application to be filed with the Oregon Water Resources Department:

- Permit to Use or Store Water
 Water Right Transfer
 Permit Amendment or Ground Water Registration Modification
 Limited Water Use License
 Exchange of Water
 Allocation of Conserved Water

Source of water: Reservoir/Pond Ground Water Surface Water (name) Luckiamute River

Estimated quantity of water needed: 1.23 cubic feet per second gallons per minute acre-feet

Intended use of water: Irrigation Commercial Industrial Domestic for _____ household(s)
 Municipal Quasi-Municipal Instream Other _____

Briefly describe:

Move senior water rights to sit under center pivot

Received
 JUN 10 2024
 OWRD

Note to applicant: For new water right applications only, if the Land Use Information Form cannot be completed while you wait, please have a local government representative sign the receipt on the bottom of page 4 and include it with the application filed with the Oregon Water Resources Department.

See Page 4 →

For Local Government Use Only

The following section must be completed by a planning official from each county and city listed unless the project will be located entirely within the city limits. In that case, only the city planning agency must complete this form. This deals only with the local land use plan. Do not include approval for activities such as building or grading permits.

Please check the appropriate box below and provide the requested information

- Land uses to be served by the proposed water use(s), including proposed construction, are allowed outright or are not regulated by your comprehensive plan. Cite applicable ordinance section(s): PC20 136.030CA * Farm Use
- Land uses to be served by the proposed water use(s), including proposed construction, involve discretionary land-use approvals as listed in the table below. (Please attach documentation of applicable land-use approvals which have already been obtained. Record of Action/land-use decision and accompanying findings are sufficient.) **If approvals have been obtained but all appeal periods have not ended, check "Being Pursued."**

Type of Land-Use Approval Needed (e.g., plan amendments, rezones, conditional-use permits, etc.)	Cite Most Significant, Applicable Plan Policies & Ordinance Section References	Land-Use Approval:
		<input type="checkbox"/> Obtained <input type="checkbox"/> Being Pursued <input type="checkbox"/> Denied <input type="checkbox"/> Not Being Pursued
		<input type="checkbox"/> Obtained <input type="checkbox"/> Being Pursued <input type="checkbox"/> Denied <input type="checkbox"/> Not Being Pursued
		<input type="checkbox"/> Obtained <input type="checkbox"/> Being Pursued <input type="checkbox"/> Denied <input type="checkbox"/> Not Being Pursued
		<input type="checkbox"/> Obtained <input type="checkbox"/> Being Pursued <input type="checkbox"/> Denied <input type="checkbox"/> Not Being Pursued

Local governments are invited to express special land use concerns or make recommendations to the Oregon Water Resources Department regarding this proposed use of water in the box below or on a separate sheet.

** See Attached.*

Received
JUN 10 2024
OWRD

Name: Michael Burns Title: Associate Planner

Signature: Michael C. Burns Date: 6/6/2024

Governmental Entity: Polk County Phone: (503) 623-9237

Receipt Acknowledging Request for Land Use Information

Note to Local Government Representative:
 Please complete this form and return it to the applicant. **For new water right applications only**, if you are unable to complete this form while the applicant waits, you may complete this receipt and return it to the applicant. If you sign the receipt, you will have 30 days from the date of OWRD's Public Notice of the application to submit the completed Land Use Information Form to Oregon Water Resources Department. Please note while OWRD can accept a signed receipt as part of intake for an application for a new permit to use or store water, a completed Land Use Information Form is required for all other applications.

Applicant Name: _____

Staff Name: _____ Title: _____

Staff Signature: _____ Date: _____

Governmental Entity: _____ Phone: _____

*This serves as notice that a portion of the subject property is located within the Special Flood Hazard Area (SFHA). Any non-structural floodplain development, such as excavating, drilling, removal or fill material, etc., within the SFHA would require a land use application and approval prior to conducting the non-structural floodplain development activities. The applicable review and decision criteria for non-structural floodplain development can be found in chapter 178 of the Polk County Zoning Ordinance (PCZO).

*The subject property also contains wetlands identified on the National Wetland Inventory (NWI) map. According to the Polk County Significant Resource Area (SRA) map, some of these wetlands are associated with inventoried significant fish bearing streams. These wetlands are subject to the standards listed in PCZO Chapter 182. Any development within the inventoried wetland areas may also require permits from the Oregon Department of State Lands (DSL) and Oregon Department of Fish and Wildlife (ODFW).

Received
JUN 10 2024
OWRD

Polk County, Oregon

SEC.16 T.9S. R.5W. W.M.

Scale 1"=400'

Cancelled No. 201

Received JUN 10 2024 OWRD

Legend

- TaxlotLines
- TaxCodeLines
- TaxlotLines(NotMasked)
- Historic
- PublicRoadCL
- WaterLines
- PLSSLines
- MapIndexLines

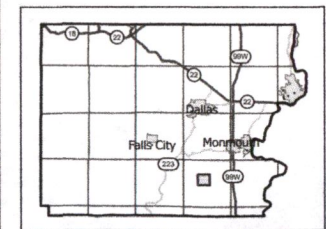
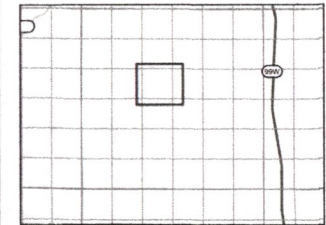

MAP FOR ASSESSMENT PURPOSES ONLY

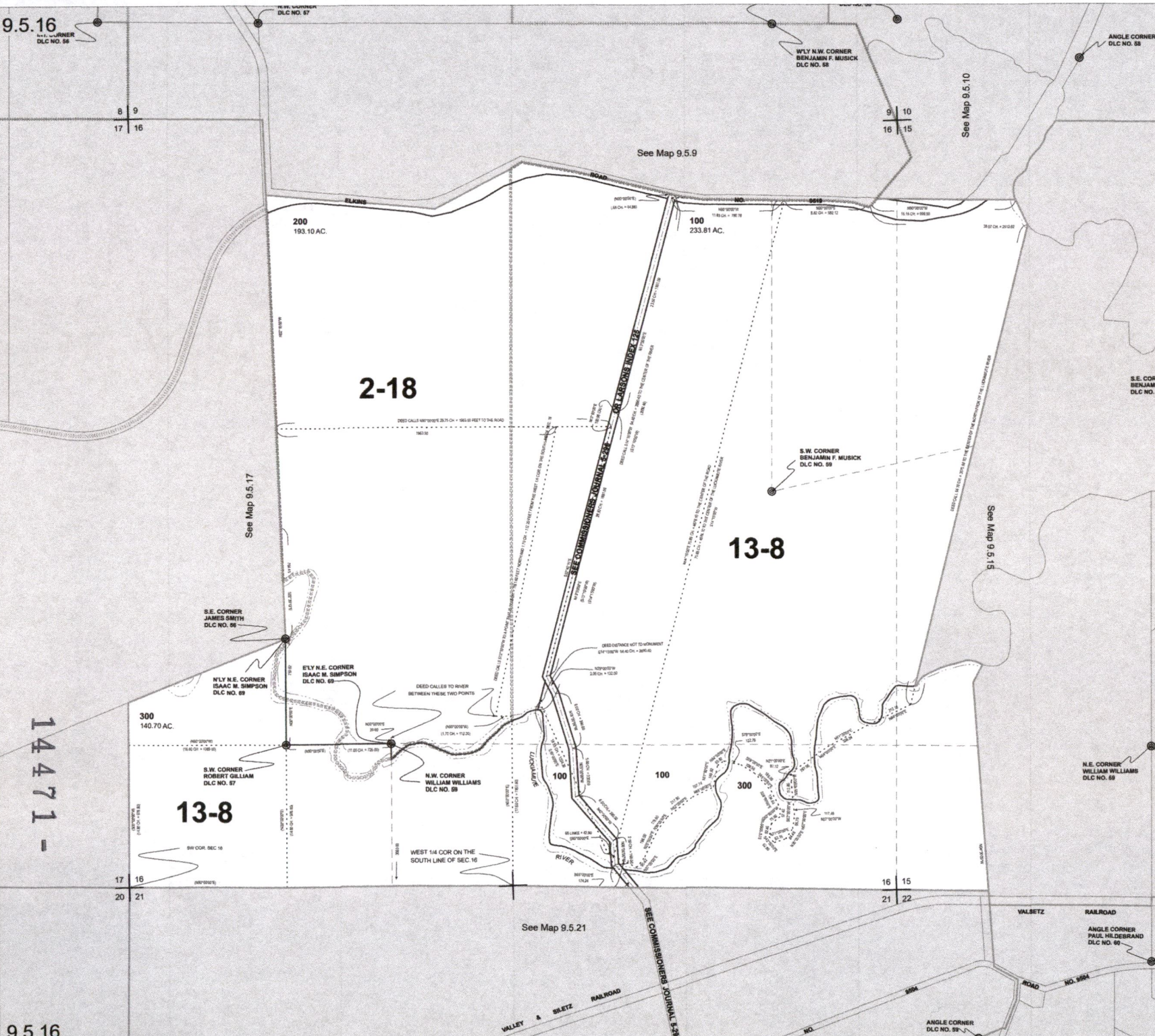

9.5.16

9.5.16

14471-

Application for Water Right Transfer

Evidence of Use Affidavit

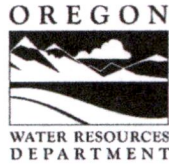

Oregon Water Resources Department
 725 Summer Street NE, Suite A
 Salem, Oregon 97301-1266
 (503) 986-0900
 www.wrd.state.or.us

Please print legibly or type. Be as specific as possible. Attach additional pages if you need more spacing. Supporting documentation must be attached.

State of Oregon)
) ss

County of POLK

I, Zach McKee, in my capacity as Farmer

mailing address 11640 Elkins Rd, Monmouth, OR 97361

telephone number (503) 949-3116, being first duly sworn depose and say:

Received
 JUN 10 2024
 OWRD

1. My knowledge of the exercise or status of the water right is based on (check one):

- Personal observation Professional expertise

2. I attest that:

Water was used during the previous five years on the **entire** place of use for Certificate # 45701, 35589, 23923; **OR**

My knowledge is specific to the use of water at the following locations within the last five years:

Certificate #	Township	Range	Mer	Sec	¼ ¼	Gov't Lot or DLC	Acres (if applicable)

OR

- Confirming Certificate # _____ has been issued within the past five years; **OR**
- Part or all of the water right was leased instream at some time within the last five years. The instream lease number is: _____ (Note: If the entire right proposed for transfer was not leased, additional evidence of use is needed for the portion not leased instream.); **OR**
- The water right is not subject to forfeiture and documentation that a presumption of forfeiture for non-use would be rebutted under ORS 540.610(2) is attached.
- Water has been used at the actual current point of diversion or appropriation for more than 10 years for Certificate # _____ (For Historic POD/POA Transfers)

(continues on reverse side)

3. The water right was used for: (e.g., crops, pasture, etc.): Crops

4. I understand that if I do not attach one or more of the documents shown in the table below to support the above statements, my application will be considered incomplete.

[Signature]
Signature of Affiant

6-6-24
Date

Signed and sworn to (or affirmed) before me this 6th day of June, 2024.

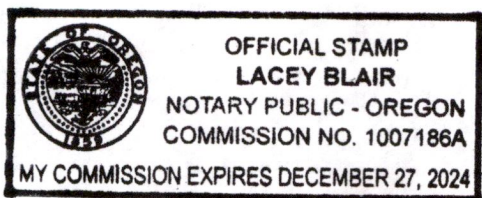

[Signature]
Notary Public for Oregon

My Commission Expires: December 27th, 2024

Supporting Documents	Examples
<input checked="" type="checkbox"/> Copy of a water right certificate that has been issued within the last five years. (not a remaining right certificate)	Copy of confirming water right certificate that shows issue date
<input checked="" type="checkbox"/> Copies of receipts from sales of irrigated crops or for expenditures related to use of water	<ul style="list-style-type: none">● Power usage records for pumps associated with irrigation use● Fertilizer or seed bills related to irrigated crops● Farmers Co-op sales receipt
<input type="checkbox"/> Records such as FSA crop reports, irrigation district records, NRCS farm management plan, or records of other water suppliers	<ul style="list-style-type: none">● District assessment records for water delivered● Crop reports submitted under a federal loan agreement● Beneficial use reports from district● IRS Farm Usage Deduction Report● Agricultural Stabilization Plan● CREP Report
<input checked="" type="checkbox"/> Aerial photos containing sufficient detail to establish location and date of photograph	Multiple photos can be submitted to resolve different areas of a water right. If the photograph does not print with a "date stamp" or without the source being identified, the date of the photograph and source should be added. Sources for aerial photos: OSU – www.oregonexplorer.info/imagery OWRD – www.wrd.state.or.us Google Earth – earth.google.com TerraServer – www.terra-server.com
<input type="checkbox"/> Approved Lease establishing beneficial use within the last 5 years	Copy of instream lease or lease number

Received
JUN 10 2024
OWRD

14471 -

McKee Family Farms

McKee Family Farms\S-Manzi

Received

JUN 10 2024

McKee Family Farms

2018

OWRD

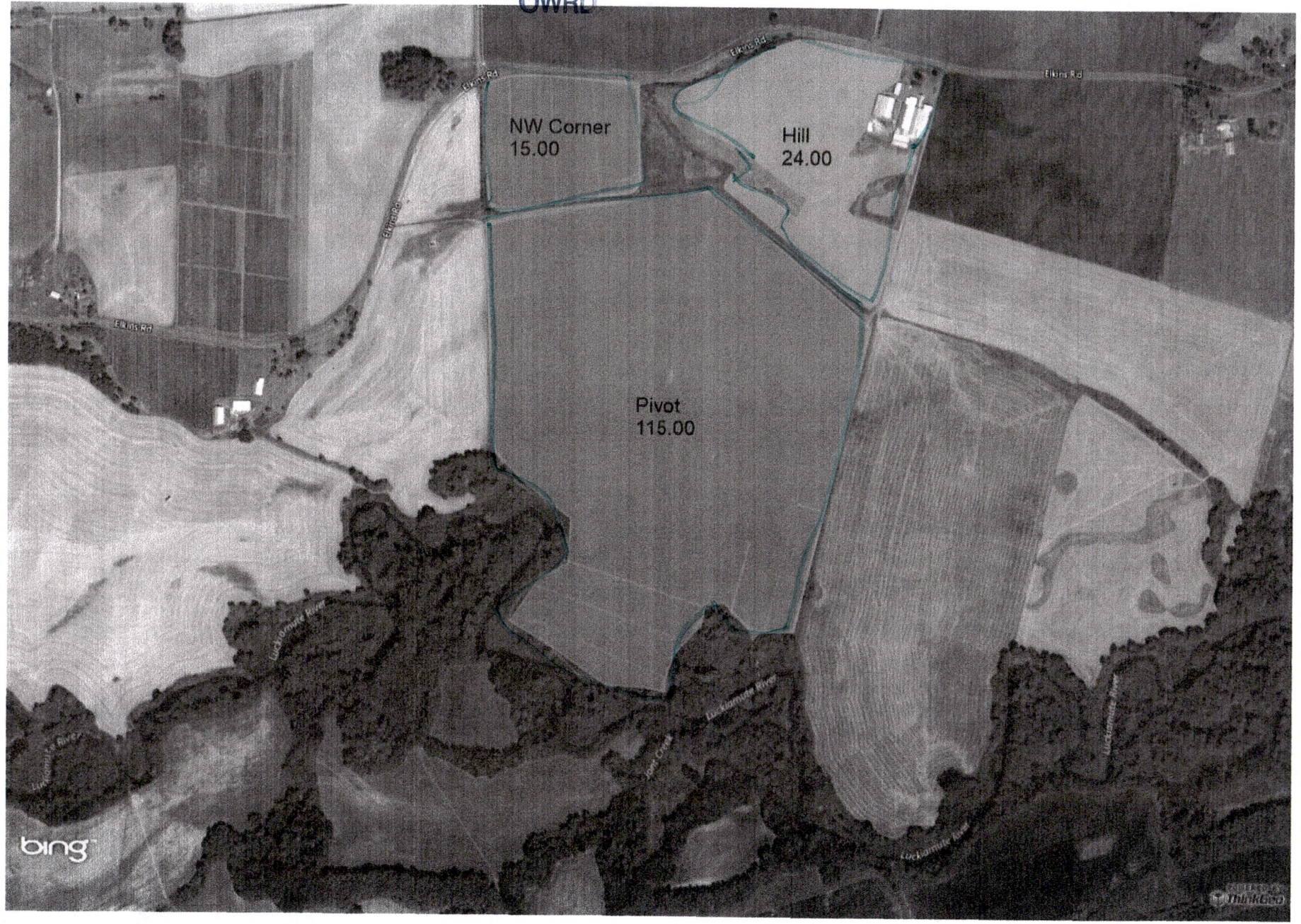

14471 -



CONSUMERS POWER INC.

Office Hours: Monday - Thursday 7:00 a.m. to 5:30 p.m.
Contact us: 541-929-3124 or 1-800-872-9036 Hours: 24/7

www.cpi.coop

Member Name: **ROBERT C MANZI
SHERRI L MANZI**

Account #: [REDACTED]

Statement Date: **10/09/2023**

TOTAL AMOUNT DUE
\$548.20
DUE DATE 11/01/23

Member Monthly Message

Update your contact information before a major outage. In the event of an outage, CPI needs your phone number and email on file. This allows us to better communicate and respond to power outages. If you are unsure if CPI has the correct information on file, or to update your information, give us a call today at 800-872-9036.

Previous Account Activity	
Previous Balance	\$1,071.44
Payments Received - Thank You	-\$1,071.44
Balance Before Current Charges	\$0.00
Account Balance	\$548.20

Rate Description: **IRRIGATION**

Service Address: **IRRIGATION**

Meter #	Type	Days	Services		Readings		Metered Usage	Meter Multiplier	Rate
			From	To	Previous	Present			
1200141	KWH	30	09/01/2023	10/01/2023	50751	52827	2076	1	034
1200141	KW	30	09/01/2023	10/01/2023	0	59.78	59.780	1	034
1200141	KVAR	30	09/01/2023	10/01/2023	0	26.55	11.605	1	034

Current Activity

Basic Service Charge		\$35.00
kWh Revenue	2,076 kWh @ .0760	\$157.78
kW Revenue	49.780 kW @ 7.0000	\$348.46
Load Factor - 5%		
Power Factor - 91.390%		
Reactive Power Charge		\$6.96
Total Current Activity		\$548.20

Usage History

Temp

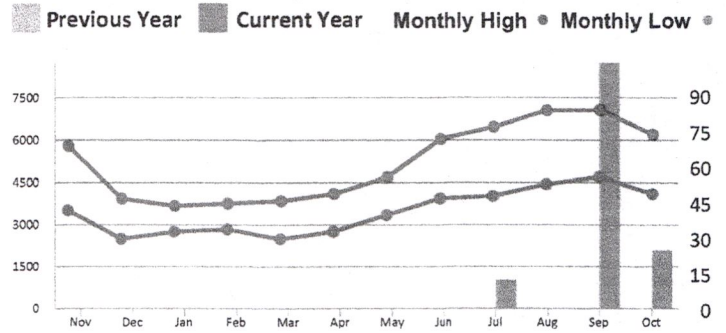

COMPARISONS	Days	kWh	Avg Temp	Avg kWh
Current Month	30	2076	62	69
Previous Month	31	8768	71	283
Same Last Year	0	0	65	0

Avg Cost Per Day: \$18.04

Any BALANCE FORWARD is subject to DISCONNECTION of services.

Received

JUN 10 2024

OWRD

14471 -

STATE OF OREGON

COUNTY OF POLK

CERTIFICATE OF WATER RIGHT

This Is to Certify, That SILVERIO & IDA MANZI

of 13370 Elkins Rd, Monmouth, State of Oregon 97361, has made proof to the satisfaction of the Water Resources Director, of a right to the use of the waters of Luckiamute River

a tributary of Willamette River for the purpose of irrigation of 37.3 acres

under Permit No. 35804 and that said right to the use of said waters has been perfected in accordance with the laws of Oregon; that the priority of the right hereby confirmed dates from December 10, 1970 that the amount of water to which such right is entitled and hereby confirmed, for the purposes aforesaid, is limited to an amount actually beneficially used for said purposes, and shall not exceed 0.47 cubic foot per second

or its equivalent in case of rotation, measured at the point of diversion from the stream. The point of diversion is located in the SE 1/4 SW 1/4, as projected within Gilliam DLC 57, Section 16, T. 9 S., R. 5 W., W. M., 240 feet North and 1550 feet East from the SW Corner, Gilliam DLC 57

The amount of water used for irrigation, together with the amount secured under any other right existing for the same lands, shall be limited to one-eightieth of one cubic foot per second per acre, or its equivalent for each acre irrigated and shall be further limited to a diversion of not to exceed 2 1/2 acre feet per acre for each acre irrigated during the irrigation season of each year,

and shall conform to such reasonable rotation system as may be ordered by the proper state officer.

A description of the place of use under the right hereby confirmed, and to which such right is appurtenant, is as follows:

- 14.0 acres NE 1/4 NW 1/4
- 6.1 acres NW 1/4 NW 1/4
- 0.1 acre SW 1/4 NW 1/4
- 0.1 acre SE 1/4 NW 1/4
- 12.1 acres NE 1/4 SW 1/4
- 2.1 acres NW 1/4 SW 1/4
- 2.8 acres SE 1/4 SW 1/4

All as projected within Gilliam DLC 57 Section 16 T. 9 S., R. 5 W., W. M.

Received JUN 10 2024 OWRD

The right to the use of the water for the purposes aforesaid is restricted to the lands or place of use herein described, and is subject to the existing minimum flow policies established by the Water Policy Review Board.

WITNESS the signature of the Water Resources Director, affixed

this date. May 19, 1978

James E. Sisson Water Resources Director

Recorded in State Record of Water Right Certificates, Volume 38, page 45701

STATE OF OREGON
COUNTY OF POLK
CERTIFICATE OF WATER RIGHT

This Is to Certify, That IVAN H. LOUGHARY

of Route 2, Box 28 $\frac{1}{2}$, Mozmouth, State of Oregon, has made proof to the satisfaction of the STATE ENGINEER of Oregon, of a right to the use of the waters of Big Luckiamute River

a tributary of Willamette River for the purpose of irrigation of 49.5 acres

under Permit No. 28464 of the State Engineer, and that said right to the use of said waters has been perfected in accordance with the laws of Oregon; that the priority of the right hereby confirmed dates from October 26, 1962

that the amount of water to which such right is entitled and hereby confirmed, for the purposes aforesaid, is limited to an amount actually beneficially used for said purposes, and shall not exceed 0.62 cubic foot per second

or its equivalent in case of rotation, measured at the point of diversion from the stream. The point of diversion is located in the SE $\frac{1}{4}$ SW $\frac{1}{4}$ as projected within Gilliam DIC 57, Section 16, T. 9 S., R. 5 W., W. M.

The amount of water used for irrigation, together with the amount secured under any other right existing for the same lands, shall be limited to one-eightieth of one cubic foot per second per acre, or its equivalent for each acre irrigated and shall be further limited to a diversion of not to exceed 2 $\frac{1}{2}$ acre feet per acre for each acre irrigated during the irrigation season of each year,

and shall conform to such reasonable rotation system as may be ordered by the proper state officer.

A description of the place of use under the right hereby confirmed, and to which such right is appurtenant, is as follows:

1.1 acres NE $\frac{1}{4}$ NW $\frac{1}{4}$
6.4 acres SW $\frac{1}{4}$ NW $\frac{1}{4}$
20.8 acres SE $\frac{1}{4}$ NW $\frac{1}{4}$
16.6 acres NE $\frac{1}{4}$ SW $\frac{1}{4}$
4.6 acres NW $\frac{1}{4}$ SE $\frac{1}{4}$
all as projected within Gilliam DIC 57
Section 16
T. 9 S., R. 5 W., W. M.

Received

JUN 10 2024

OWRD

The right to the use of the water for the purposes aforesaid is restricted to the lands or place of use herein described.

WITNESS the signature of the State Engineer, affixed

this date. November 17, 1965

CHRIS L. WHEELER

State Engineer

Recorded in State Record of Water Right Certificates, Volume 24, page 32589

14471

STATE OF OREGON
COUNTY OF POLK
CERTIFICATE OF WATER RIGHT

This Is to Certify, That IVAN H. LOUGHARY

of c/o Keith B. Tow, Mouth, State of Oregon, has made proof to the satisfaction of the State ENGINEER of Oregon, of a right to the use of the waters of Macklamute River a tributary of Willamette River for the purpose of irrigation under Permit No. 22749 of the State Engineer, and that said right to the use of said waters has been perfected in accordance with the laws of Oregon; that the priority of the right hereby confirmed dates from November 2, 1953,

that the amount of water to which such right is entitled and hereby confirmed, for the purposes aforesaid, is limited to an amount actually beneficially used for said purposes, and shall not exceed 0.99 cubic foot per second,

or its equivalent in case of rotation, measured at the point of diversion from the stream. The point of diversion is located in the NW $\frac{1}{4}$ SE $\frac{1}{4}$ as projected within R. Gilliam DIC #57, Section 16, Township 9 South, Range 5 West, W.M.

The amount of water used for irrigation, together with the amount secured under any other right existing for the same lands, shall be limited to one-eightieth of one cubic foot per second per acre, or its equivalent for each acre irrigated and shall be further limited to a diversion of not to exceed 2 $\frac{1}{2}$ acre feet per acre for each acre irrigated during the irrigation season of each year,

and shall conform to such reasonable rotation system as may be ordered by the proper state officer.

A description of the place of use under the right hereby confirmed, and to which such right is appurtenant, is as follows:

19.2 acres in the NW $\frac{1}{4}$ NE $\frac{1}{4}$
19.0 acres in the SW $\frac{1}{4}$ NE $\frac{1}{4}$
9.2 acres in the NE $\frac{1}{4}$ NW $\frac{1}{4}$
2.0 acres in the SW $\frac{1}{4}$ NW $\frac{1}{4}$
19.0 acres in the SE $\frac{1}{4}$ NW $\frac{1}{4}$
7.8 acres in the NE $\frac{1}{4}$ SW $\frac{1}{4}$
0.8 acres in the NW $\frac{1}{4}$ SW $\frac{1}{4}$
2.0 acres in the NW $\frac{1}{4}$ SE $\frac{1}{4}$

All as projected within R. Gilliam DIC #57
Section 16
Township 9 South, Range 5 West, W.M.

Received
JUN 10 2024
OWRD

The right to the use of the water for the purposes aforesaid is restricted to the lands or place of use herein described.

WITNESS the signature of the State Engineer, affixed

this 25th day of April, 1958.

LEWIS A. STANLEY

State Engineer

Recorded in State Record of Water Right Certificates, Volume 17, page 23923

14471 -