

State of Oregon  
 Water Resources Department  
 725 Summer Street NE, Suite A  
 Salem, Oregon 97301-1266  
 (503) 986-0900

## Surface Water Allocation of Conserved Water

Request for Finalization

For  
 CW 134

### Applicant Information

APPLICANT/BUSINESS NAME Peter Salant		PHONE NO. 541-899-8295	ADDITIONAL CONTACT NO.	
ADDRESS 5288 Little Applegate Road			FAX NO.	
CITY Jacksonville	STATE OR	ZIP 97530	E-MAIL pksalant@aol.com	

*(If submitting with an Application, complete only the Applicant name.)*

The above applicant requests that the allocation of conserved water be finalized. The construction of the conservation measure(s) has been completed that resulted in conserved water.

List the portions of the conserved water allocated to the applicant as listed in the Order Approving Allocation of Conserved Water or an Order issued pursuant to OAR 690-018-0062(2).

Applicant's Portion of Conserved Water	
Maximum Rate (CFS)	Maximum Duty (Volume)/AF
0.07	0.37

- All or part of the Applicant's portion of the conserved water is to be:
- Leased *(If water is to be temporarily leased instream, a separate Instream Lease Application must be submitted.);* \_\_\_\_\_ CFS; \_\_\_\_\_ AF
- Dedicated instream (permanent); \_\_\_\_\_ CFS; \_\_\_\_\_ AF
- Temporarily reserved instream for future out-of-stream use; \_\_\_\_\_ CFS; \_\_\_\_\_ AF
- Used out-of-stream as described below.

N/A Out-of-Stream Use. Describe the Applicant's portion of the conserved water to be used for an out-of-stream use at the location below.

Applicant's Conserved Water					Applicant's Conserved Water Remaining	
Certificate	Priority	Type of Use	Rate (CFS)	Volume (AF)	CFS	Volume
86646	9/1/857,	Irrigation	0.07	0.37		-
	plus one					
	minute	<b>Totals</b>	0.07	0.37		

Describe the point of diversion that will be used to deliver water to the new place of use:

Twp	Rng	Mer	Sec	Q-Q	Measured Distances
39 S	2 W	WM	29	NWNE	Gin Lin Ditch

1430 FEET NORTH & 1905 FEET WEST from E1/4 Section 29

Name and address of the person using the water: Peter Salant, 5288 Little Applegate Road  
Jacksonville, OR 97530

Description of the type of beneficial use of the water: Irrigation

Description of the place of use:

Applicant's Conserved Water Out-of-Stream Use Location										
Twp		Rng		Sec	¼	¼	Tax Lot	Gvt Lot or DLC	Acres	Priority Date
2	S	9	E	15	NE	NW	200	Example	153.0	1/1/1865
39	S	2	W	19	SW	SE	900		1.5	9/1/1857
39	S	2	W	29	NE	NW	300		1.1	9/1/1857
39	S	2	W	29	NW	NW	300		0.5	9/1/1857
39	S	2	W	19	SE	SE	900		2.5	9/1/1857
Totals									5.6	

N/A A map depicting the lands identified above that meets the standards in OAR 690-310-0050 (required if out-of-stream use table completed).

The above applicant requests that the allocation of conserved water be finalized. The applicant further requests that the Director issue:

1. A superseding certificate as provided for in the order approving the allocation of conserved water;
2. A certificate for an instream water right for the state's portion of the conserved water; and
3. An order allowing:
  - a. The use of any portion of the conserved water allocated to the applicant, at the location and for the type of use identified in the tables above; and
  - b. The use and management as an instream water right of any conserved water being leased, dedicated, or temporarily reserved instream.

Dated: JULY 3, 2024

Peter N. SACANT  
(Printed Applicant Name)

\_\_\_\_\_  
(Printed Applicant Name)

Peter Salant TRUSTEE  
(Applicant's signature)

\_\_\_\_\_  
(Applicant's signature)

# Request for Finalization Map - CW-134 SALANT

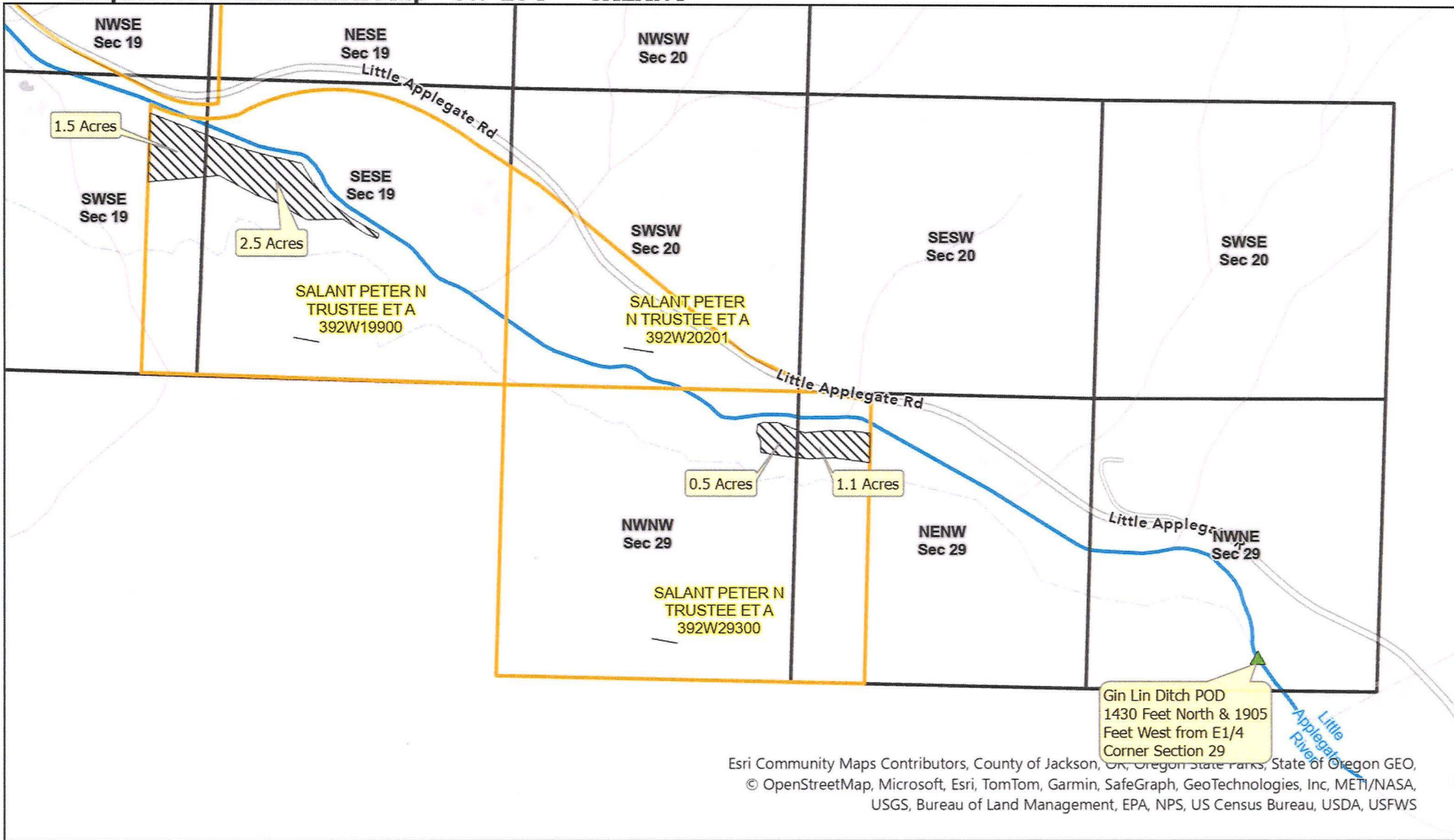

Esri Community Maps Contributors, County of Jackson, OR, Oregon State Parks, State of Oregon GEO, © OpenStreetMap, Microsoft, Esri, TomTom, Garmin, SafeGraph, GeoTechnologies, Inc, METI/NASA, USGS, Bureau of Land Management, EPA, NPS, US Census Bureau, USDA, USFWS

### Legend

- Taxlots
- Gin Lin Ditch POD
- Gin Lin Ditch
- Place of Use - Conserved Water  
5.6 Acres Cert 86646



Scale: 1:7,500

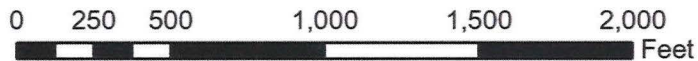

Peter Salant  
5288 Little Applegate Road  
Jacksonville, OR 97530  
  
Jackson County, Oregon



Paul DeMaggio, P.E.  
Jackson Soil & Water Conservation District  
Paul.demaggio@jswcd.org

This map is not intended to provide legal dimensions or locations of property ownership lines

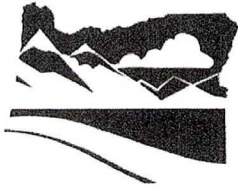

State of Oregon  
**Water Resources Department**  
 725 Summer Street NE, Suite A  
 Salem, Oregon 97301-1266  
 (503) 986-0900

## Surface Water Allocation of Conserved Water Request for Finalization For CW 134

**Applicant Information**

APPLICANT/BUSINESS NAME Erin Volheim		PHONE NO. 541-899-6935	ADDITIONAL CONTACT NO. 541-973-5092
ADDRESS 4873 Little Applegate Road			FAX NO.
CITY Jacksonville	STATE OR	ZIP 97530	E-MAIL erinwildingcenter@gmail.com

*(If submitting with an Application, complete only the Applicant name)* amacivor@gmail.com

The above applicant requests that the allocation of conserved water be finalized. The construction of the conservation measure(s) has been completed that resulted in conserved water.

List the portions of the conserved water allocated to the applicant as listed in the Order Approving Allocation of Conserved Water or an Order issued pursuant to OAR 690-018-0062(2).

Applicant's Portion of Conserved Water	
Maximum Rate (CFS)	Maximum Duty (Volume)/AF
0.009	0.048

- All or part of the Applicant's portion of the conserved water is to be:
- Leased (*If water is to be temporarily leased instream, a separate Instream Lease Application must be submitted.*); \_\_\_\_\_ CFS; \_\_\_\_\_ AF
  - Dedicated instream (permanent); \_\_\_\_\_ CFS; \_\_\_\_\_ AF
  - Temporarily reserved instream for future out-of-stream use; 0.009 CFS; 0.048 AF
  - Used out-of-stream as described below.
- N/A Out-of-Stream Use. Describe the Applicant's portion of the conserved water to be used for an out-of-stream use at the location below.

Applicant's Conserved Water					Applicant's Conserved Water Remaining	
Certificate	Priority	Type of Use	Rate (CFS)	Volume (AF)	CFS	Volume
<b>Totals</b>						



Describe the point of diversion that will be used to deliver water to the new place of use:

Twp	Rng	Mer	Sec	Q-Q	Measured Distances
		WM			

Name and address of the person using the water: \_\_\_\_\_

Description of the type of beneficial use of the water: \_\_\_\_\_

Description of the place of use:

Applicant's Conserved Water Out-of-Stream Use Location										
Twp		Rng		Sec	¼	¼	Tax Lot	Gvt Lot or DLC	Acres	Priority Date
'2	S	9	E	15	NE	NW	200	Example	153.0	1/1/1865
<b>Totals</b>										

N/A A map depicting the lands identified above that meets the standards in OAR 690-310-0050 (required if out-of-stream use table completed).

The above applicant requests that the allocation of conserved water be finalized. The applicant further requests that the Director issue:

1. A superseding certificate as provided for in the order approving the allocation of conserved water;
2. A certificate for an instream water right for the state's portion of the conserved water; and
3. An order allowing:
  - a. The use of any portion of the conserved water allocated to the applicant, at the location and for the type of use identified in the tables above; and
  - b. The use and management as an instream water right of any conserved water being leased, dedicated, or temporarily reserved instream.

Dated: 7/2/2024

Erin Volheim  
(Printed Applicant Name)

  
(Applicant's signature)

\_\_\_\_\_  
(Printed Applicant Name)

\_\_\_\_\_  
(Applicant's signature)



State of Oregon  
**Water Resources Department**  
 725 Summer Street NE, Suite A  
 Salem, Oregon 97301-1266  
 (503) 986-0900

## Surface Water Allocation of Conserved Water

**Request for Finalization**  
 For  
 CW 134

**Applicant Information**

APPLICANT/BUSINESS NAME <b>David Willard</b>		PHONE NO. <b>541-899-8404</b>	ADDITIONAL CONTACT NO.
ADDRESS <b>4055 Little Applegate Road</b>			FAX NO.
CITY <b>Jacksonville</b>	STATE <b>OR</b>	ZIP <b>97530</b>	E-MAIL <b>jencksa@yahoo.com</b>

*(If submitting with an Application, complete only the Applicant name)*

The above applicant requests that the allocation of conserved water be finalized. The construction of the conservation measure(s) has been completed that resulted in conserved water.

List the portions of the conserved water allocated to the applicant as listed in the Order Approving Allocation of Conserved Water or an Order issued pursuant to OAR 690-018-0062(2).

<b>Applicant's Portion of Conserved Water</b>	
Maximum Rate (CFS)	Maximum Duty (Volume)/AF
<b>0.017</b>	<b>0.09</b>

- All or part of the Applicant's portion of the conserved water is to be:
- Leased *(If water is to be temporarily leased instream, a separate Instream Lease Application must be submitted.);* \_\_\_\_\_ CFS; \_\_\_\_\_ AF
  - Dedicated instream (permanent); \_\_\_\_\_ CFS; \_\_\_\_\_ AF
  - Temporarily reserved instream for future out-of-stream use; \_\_\_\_\_ CFS; \_\_\_\_\_ AF
  - Used out-of-stream as described below.

N/A Out-of-Stream Use. Describe the Applicant's portion of the conserved water to be used for an out-of-stream use at the location below.

<b>Applicant's Conserved Water</b>					<b>Applicant's Conserved Water Remaining</b>	
Certificate	Priority	Type of Use	Rate (CFS)	Volume (AF)	CFS	Volume
86646	9/1/1857	Irrigation	0.017	0.09		
	plus one					
	minute	<b>Totals</b>	<b>0.017</b>	<b>0.09</b>		

Describe the point of diversion that will be used to deliver water to the new place of use:

Twp	Rng	Mer	Sec	Q-Q	Measured Distances
39 S	2 W	WM	29	NENW	Upper Phillips Ditch Lat: 42.1540 Long: -122.9636

Name and address of the person using the water: David Willard 4055 Little Applegate Road  
Jacksonville, OR 97530

Description of the type of beneficial use of the water: Irrigation

Description of the place of use:

Applicant's Conserved Water Out-of-Stream Use Location										
Twp	Rng		Sec	¼	¼	Tax Lot	Gvt Lot or DLC	Acres	Priority Date	
2	S	9	E	15	NE	NW	200	Example	153.0	1/1/1865
39	S	2	W	19	SE	NW	210		1.375	9/1/1857 plus one minute
<b>Totals</b>								1.375		

N/A A map depicting the lands identified above that meets the standards in OAR 690-310-0050 (required if out-of-stream use table completed).

The above applicant requests that the allocation of conserved water be finalized. The applicant further requests that the Director issue:

1. A superseding certificate as provided for in the order approving the allocation of conserved water;
2. A certificate for an instream water right for the state's portion of the conserved water; and
3. An order allowing:
  - a. The use of any portion of the conserved water allocated to the applicant, at the location and for the type of use identified in the tables above; and
  - b. The use and management as an instream water right of any conserved water being leased, dedicated, or temporarily reserved instream.

Dated: 7/12/2024

David willard  
(Printed Applicant Name)

\_\_\_\_\_  
(Printed Applicant Name)

DocuSigned by:  
David Willard  
DBAB37E3FA36408...  
(Applicant's signature)

\_\_\_\_\_  
(Applicant's signature)



# Request for Finalization Map - CW-134 WILLARD

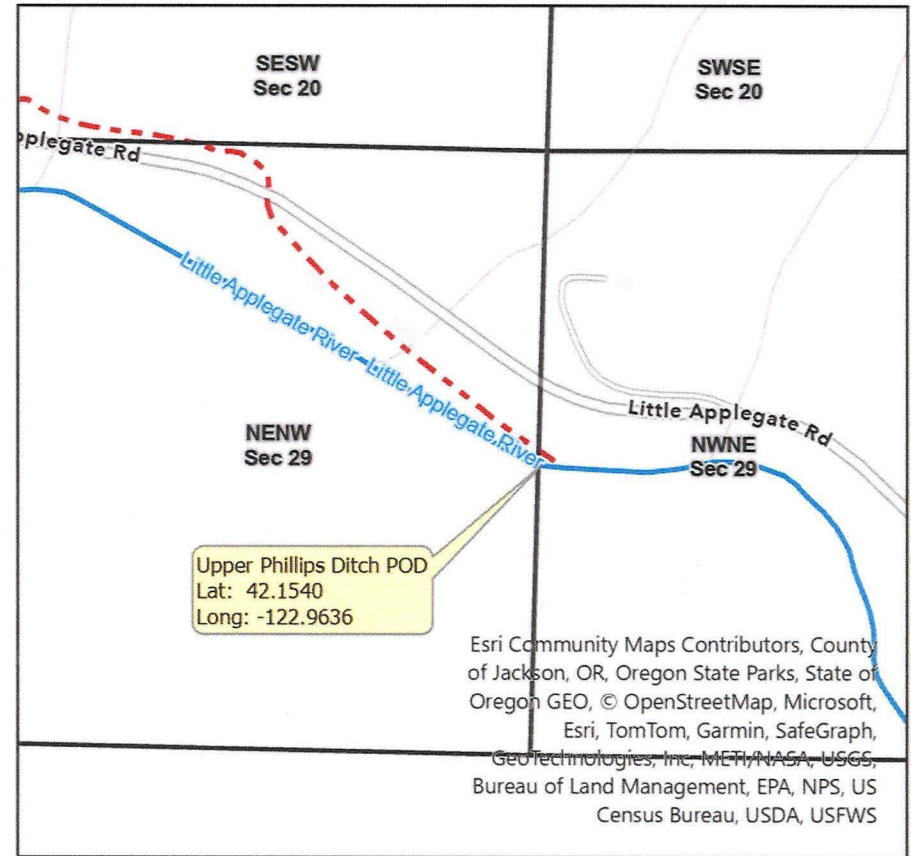
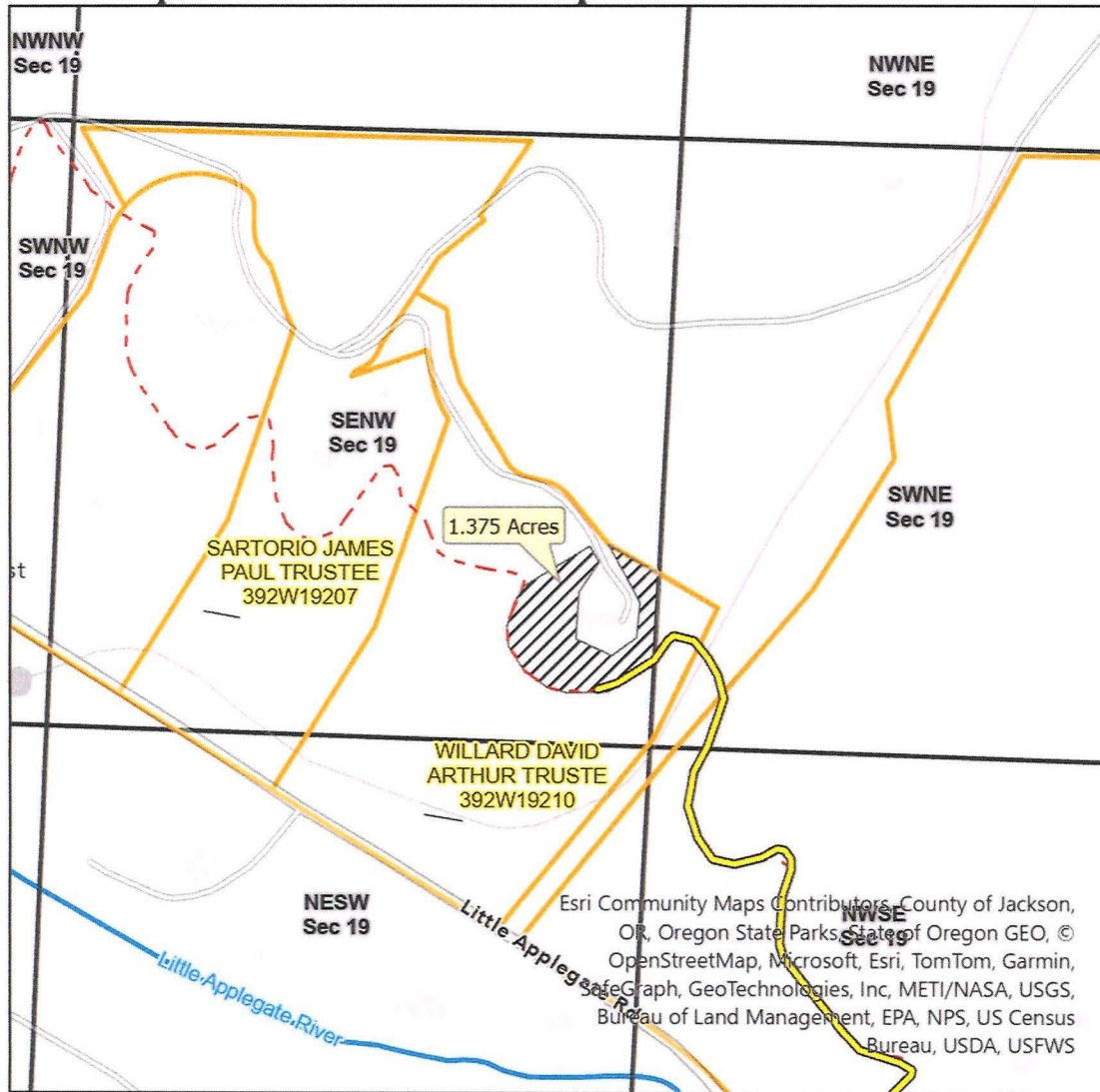

Esri Community Maps Contributors, County of Jackson, OR, Oregon State Parks, State of Oregon GEO, © OpenStreetMap, Microsoft, Esri, TomTom, Garmin, SafeGraph, GeoTechnologies, Inc, METI/NASA, USGS, Bureau of Land Management, EPA, NPS, US Census Bureau, USDA, USFWS

Esri Community Maps Contributors, County of Jackson, OR, Oregon State Parks, State of Oregon GEO, © OpenStreetMap, Microsoft, Esri, TomTom, Garmin, SafeGraph, GeoTechnologies, Inc, METI/NASA, USGS, Bureau of Land Management, EPA, NPS, US Census Bureau, USDA, USFWS

**Legend**

- Taxlots
- Upper Phillips Ditch
- Upper Phillips Ditch Pipeline
- Place of Use - Conserved Water  
1.375 Acres Cert 86646

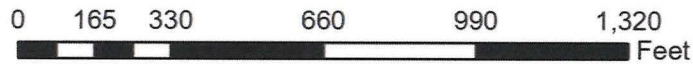

Scale: 1:5,000

David Willard  
4055 Little Applegate Road  
Jacksonville, OR 97530

Jackson County, Oregon



Paul DeMaggio, P.E.  
Jackson Soil & Water Conservation District  
Paul.demaggio@jswcd.org

This map is not intended to provide legal dimensions or locations of property ownership lines



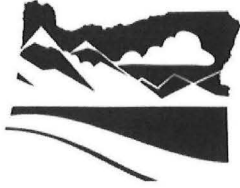

State of Oregon  
**Water Resources Department**  
 725 Summer Street NE, Suite A  
 Salem, Oregon 97301-1266  
 (503) 986-0900

## Surface Water Allocation of Conserved Water Request for Finalization For CW 134

### Applicant Information

APPLICANT/BUSINESS NAME <b>James Sartorio &amp; Marion Hadden</b>		PHONE NO. <b>541-899-9513</b>	ADDITIONAL CONTACT NO.
ADDRESS <b>4035 Little Applegate Road</b>			FAX NO.
CITY <b>Jacksonville</b>	STATE <b>OR</b>	ZIP <b>97530</b>	E-MAIL <b>mhts155@gmail.com</b>

*(If submitting with an Application, complete only the Applicant name)*

The above applicant requests that the allocation of conserved water be finalized. The construction of the conservation measure(s) has been completed that resulted in conserved water.

List the portions of the conserved water allocated to the applicant as listed in the Order Approving Allocation of Conserved Water or an Order issued pursuant to OAR 690-018-0062(2).

Applicant's Portion of Conserved Water	
Maximum Rate (CFS)	Maximum Duty (Volume)/AF
<b>0.01</b>	<b>0.053</b>

- All or part of the Applicant's portion of the conserved water is to be:
- Leased (If water is to be temporarily leased instream, a separate Instream Lease Application must be submitted.); \_\_\_\_\_ CFS; \_\_\_\_\_ AF
- Dedicated instream (permanent); \_\_\_\_\_ CFS; \_\_\_\_\_ AF
- Temporarily reserved instream for future out-of-stream use; 0.01 CFS; 0.053 AF
- Used out-of-stream as described below.
- N/A **Out-of-Stream Use.** Describe the Applicant's portion of the conserved water to be used for an out-of-stream use at the location below.

Applicant's Conserved Water					Applicant's Conserved Water Remaining	
Certificate	Priority	Type of Use	Rate (CFS)	Volume (AF)	CFS	Volume
<b>Totals</b>						

Describe the point of diversion that will be used to deliver water to the new place of use:

Twp	Rng	Mer	Sec	Q-Q	Measured Distances
		WM			

Name and address of the person using the water: \_\_\_\_\_

Description of the type of beneficial use of the water: \_\_\_\_\_

Description of the place of use:

Applicant's Conserved Water Out-of-Stream Use Location										
Twp		Rng		Sec	¼	¼	Tax Lot	Gvt Lot or DLC	Acres	Priority Date
2	S	9	E	15	NE	NW	200	Example	153.0	1/1/1865
<b>Totals</b>										

N/A A map depicting the lands identified above that meets the standards in OAR 690-310-0050 (required if out-of-stream use table completed).

The above applicant requests that the allocation of conserved water be finalized. The applicant further requests that the Director issue:

1. A superseding certificate as provided for in the order approving the allocation of conserved water;
2. A certificate for an instream water right for the state's portion of the conserved water; and
3. An order allowing:
  - a. The use of any portion of the conserved water allocated to the applicant, at the location and for the type of use identified in the tables above; and
  - b. The use and management as an instream water right of any conserved water being leased, dedicated, or temporarily reserved instream.

Dated: 7/2/2024

James Sartorio

(Printed Applicant Name)

Marion Hadden

(Printed Applicant Name)

James P. Sartorio

(Applicant's signature)

Marion R. Hadden

(Applicant's signature)



State of Oregon  
**Water Resources Department**  
 725 Summer Street NE, Suite A  
 Salem, Oregon 97301-1266  
 (503) 986-0900

## Surface Water Allocation of Conserved Water Request for Finalization For CW 134

**Applicant Information**

APPLICANT/BUSINESS NAME <b>Samuel Baldoni</b>		PHONE NO. <b>310-800-8424</b>	ADDITIONAL CONTACT NO.	
ADDRESS <b>4025 Little Applegate Road</b>			FAX NO.	
CITY <b>Jacksonville</b>	STATE <b>OR</b>	ZIP <b>97530</b>	E-MAIL <b>sbaldoni@me.com</b>	

*(If submitting with an Application, complete only the Applicant name)*

The above applicant requests that the allocation of conserved water be finalized. The construction of the conservation measure(s) has been completed that resulted in conserved water.

List the portions of the conserved water allocated to the applicant as listed in the Order Approving Allocation of Conserved Water or an Order issued pursuant to OAR 690-018-0062(2).

<b>Applicant's Portion of Conserved Water</b>	
Maximum Rate (CFS)	Maximum Duty (Volume)/AF
<b>0.013</b>	<b>0.07</b>

- All or part of the Applicant's portion of the conserved water is to be:
- Leased *(If water is to be temporarily leased instream, a separate Instream Lease Application must be submitted.);* \_\_\_\_\_ CFS; \_\_\_\_\_ AF
  - Dedicated instream (permanent); \_\_\_\_\_ CFS; \_\_\_\_\_ AF
  - Temporarily reserved instream for future out-of-stream use; \_\_\_\_\_ CFS; \_\_\_\_\_ AF
  - Used out-of-stream as described below.

N/A Out-of-Stream Use. Describe the Applicant's portion of the conserved water to be used for an out-of-stream use at the location below.

<b>Applicant's Conserved Water</b>					<b>Applicant's Conserved Water Remaining</b>	
Certificate	Priority	Type of Use	Rate (CFS)	Volume (AF)	CFS	Volume
86646	9/1/1857	Irrigation	0.013	0.07		
	<b>plus one</b>					
	<b>minute</b>	<b>Totals</b>	<b>0.013</b>	<b>0.07</b>		

Describe the point of diversion that will be used to deliver water to the new place of use:

Twp	Rng	Mer	Sec	Q-Q	Measured Distances
39 S	2 W	WM	29	NENW	Upper Phillips Ditch Lat: 42.1540 Long: -122.9636

Name and address of the person using the water: Samuel Baldoni 4025 Little Applegate Road  
— Jacksonville, OR 97530

Description of the type of beneficial use of the water: Irrigation

Description of the place of use:

Applicant's Conserved Water Out-of-Stream Use Location										
Twp		Rng		Sec	¼	¼	Tax Lot	Gvt Lot or DLC	Acres	Priority Date
2	S	9	E	15	NE	NW	200	Example	153.0	1/1/1865
39	S	2	W	19	SE	NW	209		1.05	9/1/1857 plus one minute
<b>Totals</b>									1.05	

N/A A map depicting the lands identified above that meets the standards in OAR 690-310-0050 (required if out-of-stream use table completed).

The above applicant requests that the allocation of conserved water be finalized. The applicant further requests that the Director issue:

1. A superseding certificate as provided for in the order approving the allocation of conserved water;
2. A certificate for an instream water right for the state's portion of the conserved water; and
3. An order allowing:
  - a. The use of any portion of the conserved water allocated to the applicant, at the location and for the type of use identified in the tables above; and
  - b. The use and management as an instream water right of any conserved water being leased, dedicated, or temporarily reserved instream.

Dated: 7/11/2024

Samuel Baldoni

(Printed Applicant Name)

(Printed Applicant Name)

DocuSigned by:

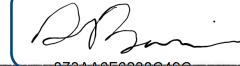

(Applicant's signature)

(Applicant's signature)



# Request for Finalization Map - CW-134 BALDONI

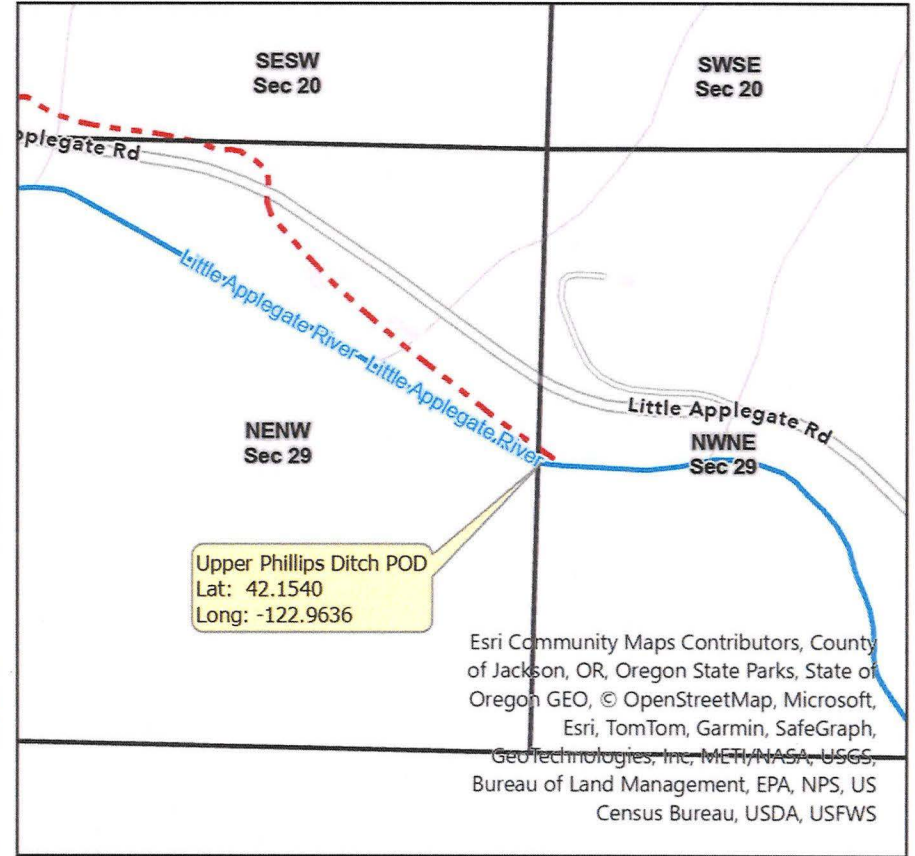
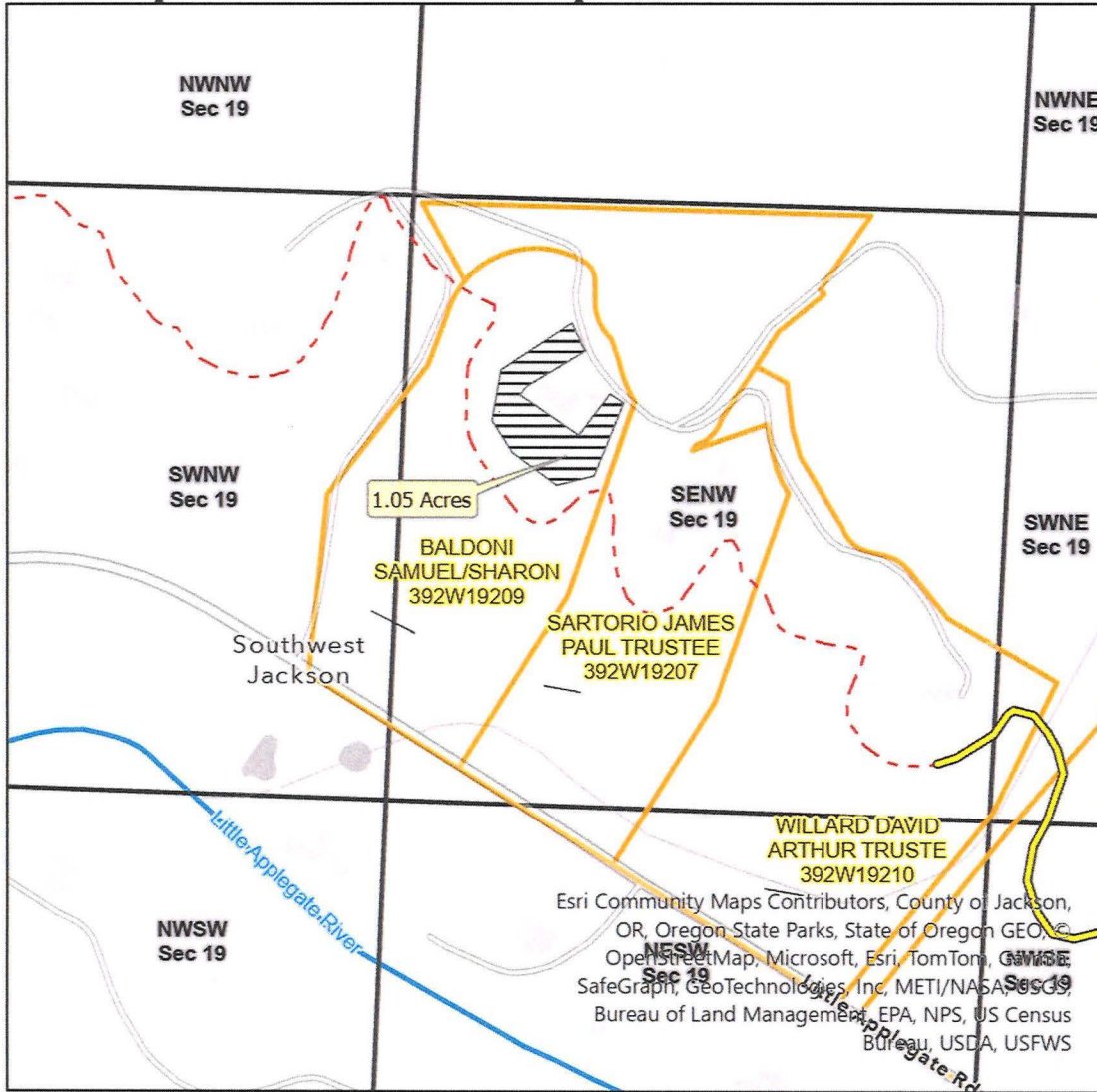

Esri Community Maps Contributors, County of Jackson, OR, Oregon State Parks, State of Oregon GEO, © OpenStreetMap, Microsoft, Esri, TomTom, Garmin, SafeGraph, GeoTechnologies, Inc, METI/NASA, USGS, Bureau of Land Management, EPA, NPS, US Census Bureau, USDA, USFWS

Esri Community Maps Contributors, County of Jackson, OR, Oregon State Parks, State of Oregon GEO, © OpenStreetMap, Microsoft, Esri, TomTom, Garmin, SafeGraph, GeoTechnologies, Inc, METI/NASA, USGS, Bureau of Land Management, EPA, NPS, US Census Bureau, USDA, USFWS

**Legend**

- Taxlots
- Upper Phillips Ditch
- Upper Phillips Ditch Pipeline
- Place of Use - Conserved Water 1.05 Acres Cert 86646

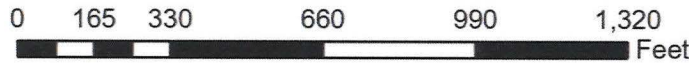

Scale: 1:5,000

Samuel Baldoni  
4025 Little Applegate Road  
Jacksonville, OR 97530

Jackson County, Oregon



Paul DeMaggio, P.E.  
Jackson Soil & Water Conservation District  
Paul.demaggio@jswcd.org

This map is not intended to provide legal dimensions or locations of property ownership lines