

Request for Assignment



Oregon Water Resources Department
 725 Summer Street NE, Suite A
 Salem, Oregon 97301-1266
 (503) 986-0900
www.oregon.gov/owrd

If the Department determines that the application is incomplete, fees have not been paid, or the required documents are not acceptable, the application and all fees submitted will be returned to the applicant.

If for multiple rights, a separate form and fee for each right will be required.

I, Robert Booth
 (Name of Current Holder of Record)
752 Fernwood Dr. Medford OR 97504 541-499-6907
 (Mailing Address) (City) (State) (Zip) (Phone #)

- hereby assign all my interest in and to the entire application/permit/transfer order/limited license/groundwater statement; (example, sold all the land authorized under the right)
- hereby assign all my interest in and to a portion of application/permit/transfer order/limited license/groundwater statement; (You must include a map showing the portion of the application/permit/transfer order/limited license/groundwater statement to be assigned. Example, sold a portion of the land authorized under the right)
- hereby assign a portion of my interest in and to the entire application/permit/transfer order/limited license/groundwater statement; (example, adding an additional person)

Application # _____; Permit # _____; Transfer Order # T12225;
 Limited License # _____; Groundwater Statement # _____;

as filed in the office of the Water Resources Director, to:

Jonathan Bowles
 (Name of New Owner)
806 S. Pacific Hwy (Ste A) Talent OR 97540 858-345-0224
 (Mailing Address) (City) (State) (Zip) (Phone #)

Note: If there are other owners of the property described in the application, permit, transfer order, limited license, or groundwater statement, you must provide a list of all other owners' names and mailing addresses and attach it to this form. Write the initials (first letters) of your first and last names at the spot indicated below.

I hereby certify that I have notified all other owners of the property described in this application, permit, transfer order, limited license, or groundwater statement of this Request of Assignment.

Witness my hand this 23 day of July, 2024.
 (Day) (Month) (Year)

Signature of Current Holder of Record Robert Booth

RECEIVED
 AUG 14 2024
 OWRD

Failure to provide any of the required information will result in the return of your application.

This certifies assignment and record change at Oregon Water Resources Department effective 8:00 a.m. on date of receipt at Salem, Oregon.

Fee receipt # 143495
 For Director by Mary Bjork, Program Analyst in Water Rights Division. MJB

The completed "Request for Assignment" form must be submitted to the Department along with the recording fee of \$120.

Received
 AUG 08 2024
 OWRD

Part Assign by Proof - Approve
 MJB 8-16-2024

ADDITIONAL POINT OF DIVERSION

CERTIFICATES:

16394 – PRIORITY DATE 1906
16396 – PRIORITY DATE 1872, 1897, AND 1900

FOR:

ROBERT BOOTH
6585 LITTLE APPLGATE ROAD
JACKSONVILLE, OREGON 97530

RECEIVED

DEC 28 2015

WATER RESOURCES DEPT
SALEM, OREGON

SITUATED IN:

SECTION 28, TOWNSHIP 39 SOUTH RANGE 2 WEST, W.M.
JACKSON COUNTY, OREGON

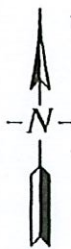
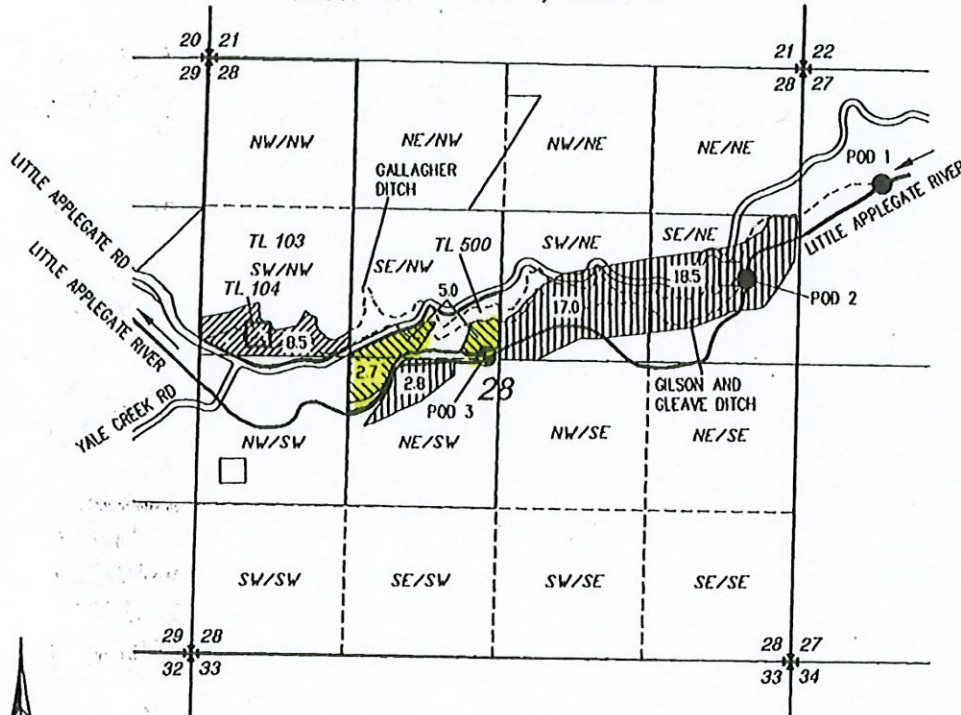

0 660 1320
SCALE: 1"=1,320'

LEGEND

- **POD 1**
CERTIFICATE 16394 DOES NOT DESCRIBE THE LOCATION OF THE POINT OF DIVERSION. THE LOCATION SHOWN IS BASED ON REVIEW OF AERIAL PHOTOS. APPROXIMATELY 1,040' SOUTH & 710' EAST FROM NE CORNER SECTION 28 (NO CHANGES)
- **POD 2**
CERTIFICATE 16396 DOES NOT DESCRIBE THE LOCATION OF THE POINT OF DIVERSION. THE LOCATION SHOWN IS BASED ON REVIEW OF AERIAL PHOTOS. APPROXIMATELY 1,890' SOUTH & 520' WEST* FROM NE CORNER SECTION 28 (NO CHANGES)
- **POD 3 – ADDITIONAL POINT OF DIVERSION**
FOR CERT. 16394 AND 16396
2,580' SOUTH & 2,880' WEST
FROM NE CORNER SECTION 28

*AUTHORIZED PLACE OF USE – CERT. 16394
ADDITIONAL POD

*AUTHORIZED PLACE OF USE – CERT. 16396
ADDITIONAL POD

*AUTHORIZED PLACE OF USE – CERT. 16396
NO CHANGES

DITCH/CANAL

*AUTHORIZED PLACE OF USE SHOWN IS BASED ON DECREE MAP.



RENEWS: 12/31/2016

This map is not intended to provide legal dimensions or locations of property ownership lines.

December 23, 2015 – EHM

Properly boundaries based on Jackson County GIS data downloaded January 1, 2014.

T 12225

Received
AUG 08 2024

OWRD