

# Groundwater Transfer Review Summary Form

Transfer/PA # T- 14477

GW Reviewer Phillip I. Marcy Date Review Completed: 10/21/2024

## Summary of Same Source Review:

☐ The proposed change in point of appropriation is not within the same aquifer as per OAR 690-380-2110(2).

## Summary of Injury Review:

☐ The proposed transfer will result in another, existing water right not receiving previously available water to which it is legally entitled or result in significant interference with a surface water source as per 690-380-0100(3).

## Summary of GW-SW Transfer Similarity Review:

☐ The proposed SW-GW transfer doesn't meet the definition of "similarly" as per OAR 690-380-2130.

*This is only a summary. Documentation is attached and should be read thoroughly to understand the basis for determinations.*



Oregon Water Resources Department  
725 Summer Street NE, Suite A  
Salem, Oregon 97301-1271  
(503) 986-0900  
www.wrd.state.or.us

## Ground Water Review Form:

- ☒ **Water Right Transfer**  
☐ **Permit Amendment**  
☐ **GR Modification**  
☐ **Other**

Application: T-14477

Applicant Name: William and Kathleen Mitchell

Proposed Changes: ☐ POA ☒ APOA ☐ SW→GW ☐ RA  
☐ USE ☐ POU ☐ OTHER

Reviewer(s): Phillip I. Marcy

Date of Review: 10/21/2024

Date Reviewed by GW Mgr. and Returned to WRSD: \_\_\_\_\_

The information provided in the application is insufficient to evaluate whether the proposed transfer may be approved because:

- ☐ The water well reports provided with the application do not correspond to the water rights affected by the transfer.
- ☐ The application does not include water well reports or a description of the well construction details sufficient to establish the ground water body developed or proposed to be developed.
- ☐ Other \_\_\_\_\_

- 
1. Basic description of the changes proposed in this transfer: The applicant proposes to add another well to Certificate 65838 due to loss of production at the authorized POA well (BAKE 949) over time.
  2. Will the proposed POA develop the same aquifer (source) as the existing authorized POA?  
☒ Yes ☐ No Comments: Authorized and proposed wells produce from alluvium.
  3. a) Is there more than one source developed under the right (e.g., basalt and alluvium)?  
☐ Yes ☒ No \_\_\_\_\_  
b) If yes, estimate the portion of the right supplied by each of the sources and describe any limitations that will need to be placed on the proposed change (rate, duty, etc.): NA
  4. a) Will this proposed change, at its maximum allowed rate of use, likely result in an increase in interference with **another ground water right**?  
☐ Yes ☒ No Comments: Considering the distance between the authorized well and the location of the proposed well, the authorized maximum rate and duty, and the nature of the target unconfined alluvial aquifer, no measurable increase in interference to nearby groundwater rights is anticipated as a result of the proposed changes to Certificate 65838.  
b) If yes, would this proposed change, at its maximum allowed rate of use, likely result in another groundwater right not receiving the water to which it is legally entitled?

☐ Yes ☐ No If yes, explain: NA

5. a) Will this proposed change, at its maximum allowed rate of use, likely result in an increase in interference with **another surface water source**?

☐ Yes ☒ No Comments: The proposed APOA well is not significantly closer to any surface water source.

b) If yes, at its maximum allowed rate of use, what is the expected change in degree of interference with any **surface water sources** resulting from the proposed change?

Stream: NA

☐ Minimal ☐ Significant

Stream: NA

☐ Minimal ☐ Significant

Provide context for minimal/significant impact: NA

6. For SW-GW transfers, will the proposed change in point of diversion affect the surface water source similarly (as per OAR 690-380-2130) to the authorized point of diversion specified in the water use subject to transfer?

☐ Yes ☐ No Comments: NA

7. What conditions or other changes in the application are necessary to address any potential issues identified above: The proposed well construction includes a total depth of 238' but does not specify details about casing and seal depth. In order to maintain production from the same source aquifer, the APOA well must be constructed to produce only from the alluvial aquifer. Nearby wells intersect basalt and granite at depth as displayed in the cross section diagram below.

APOA Construction Condition: If volcanic rock or granite is encountered during drilling, these lithologies must be sealed off from the borehole to limit groundwater production from the overlying sedimentary sequence.

8. Any additional comments:

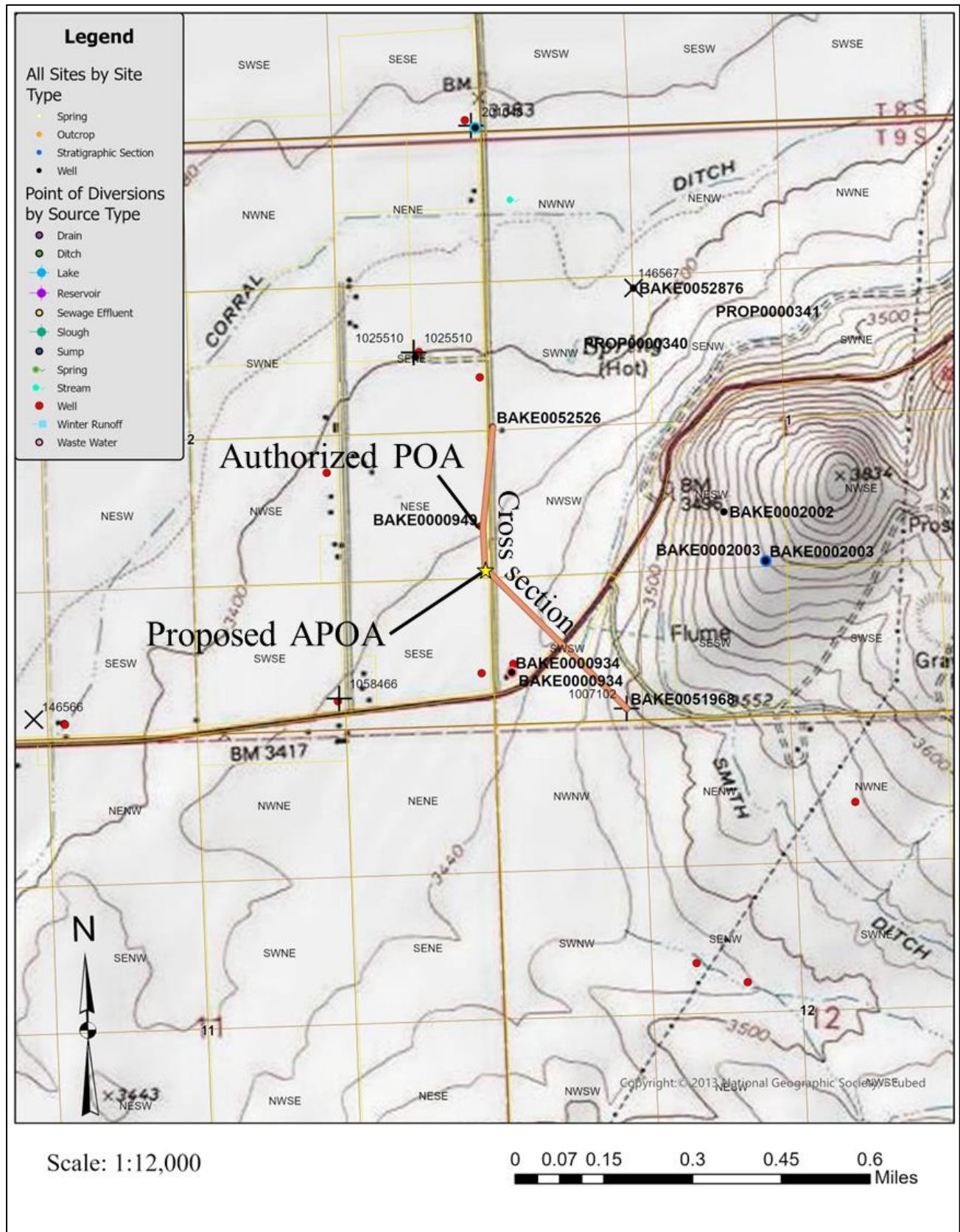

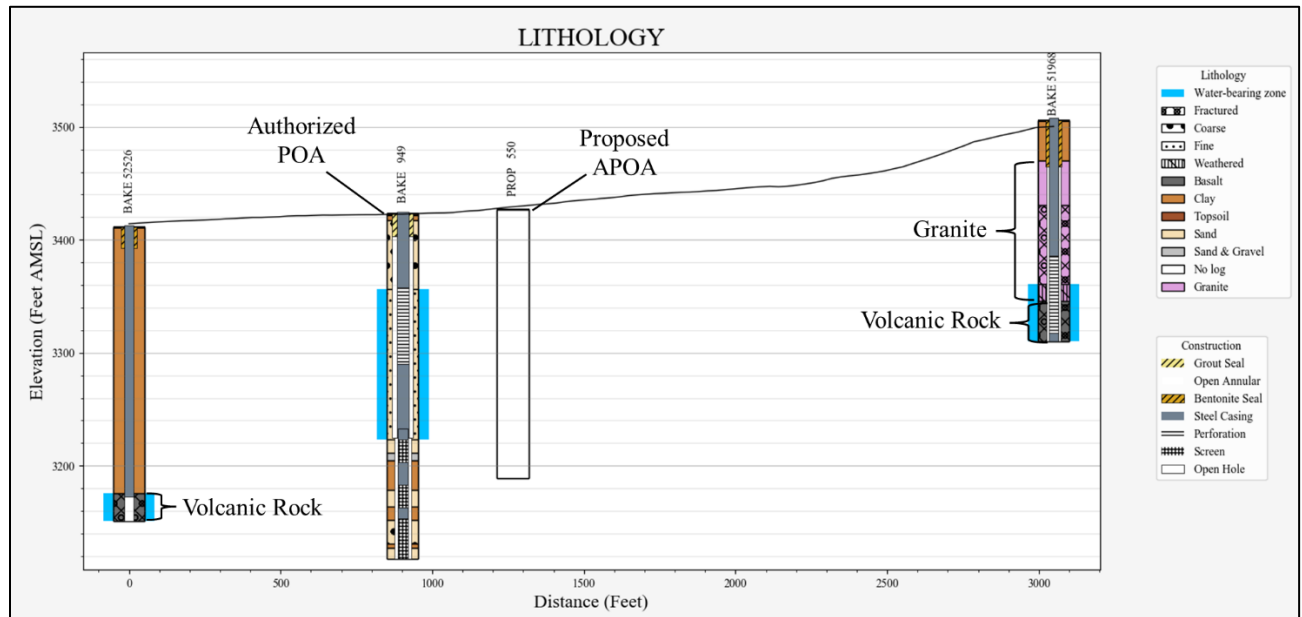

**Cross section of selected wells near the proposed APOA suggests the possibility of encountering bedrock at the proposed drilling location and depth, as nearby wells of similar depth have.**