

## Permit Amendment

Name Tiffany RangleAddress 13933 E East Evans Cr Rd  
reggie river or 91537Change in APDADate Filed 9/9/2021Initial notice date 9/21/2021

DPD issued date \_\_\_\_\_

PD issued date \_\_\_\_\_

PD notice date \_\_\_\_\_

Date of FO 5/25/2022 Vol 125 Page 164-160

C-Date \_\_\_\_\_

COBU due date \_\_\_\_\_

COBU Received date \_\_\_\_\_

Certificate issued \_\_\_\_\_

Assignments: \_\_\_\_\_

\_\_\_\_\_

\_\_\_\_\_

\_\_\_\_\_

Irrigation District \_\_\_\_\_

\_\_\_\_\_

Agent \_\_\_\_\_

\_\_\_\_\_

CWRE \_\_\_\_\_

CC's list Jackson County

\_\_\_\_\_

\_\_\_\_\_

\_\_\_\_\_

\_\_\_\_\_

## DESCRIPTION OF WATER RIGHT(S)

Name of Stream well, reservoirTrib. of Mays Creek Basin

Use \_\_\_\_\_ County \_\_\_\_\_

Quantity of water (CFS) \_\_\_\_\_ No. of Acres \_\_\_\_\_

Name of ditch \_\_\_\_\_

App# G18247 Per # G18004 Cert # \_\_\_\_\_ PR Date \_\_\_\_\_

App# \_\_\_\_\_ Per # \_\_\_\_\_ Cert # \_\_\_\_\_ PR Date \_\_\_\_\_

App# \_\_\_\_\_ Per # \_\_\_\_\_ Cert # \_\_\_\_\_ PR Date \_\_\_\_\_

App# \_\_\_\_\_ Per # \_\_\_\_\_ Cert # \_\_\_\_\_ PR Date \_\_\_\_\_

App# \_\_\_\_\_ Per # \_\_\_\_\_ Cert # \_\_\_\_\_ PR Date \_\_\_\_\_

## FEES PAID

Date	Amount	Receipt #
9-9-2021	\$1,840. <sup>00</sup>	136377

## FEES REFUNDED

Date	Amount	Receipt #
------	--------	-----------

☐ - Oversized map - Location \_\_\_\_\_





# Oregon

Kate Brown, Governor

## Water Resources Department

725 Summer St NE, Suite A

Salem, OR 97301

(503) 986-0900

Fax (503) 986-0904

May 25, 2022

TIFFANY RANGOLE  
13933 E EVANS CREEK RD  
ROGUE RIVER, OR 97537

REFERENCE: Permit Amendment Application T-13820

Enclosed is a copy of the order approving your Permit Amendment application.

Also enclosed is a superseding permit that incorporates the amendments approved by the final order contained herein. Please read this document and abide by the requirements.

If you have any questions related to the approval of this transfer, you may contact your caseworker, Scott Grew, by telephone at (503) 986-0890 or by e-mail at [Scott.A.Grew@oregon.gov](mailto:Scott.A.Grew@oregon.gov).

Sincerely,

Julie C. Baustian  
Water Rights Services Support  
Transfers and Conservation Section

cc: Shavon L. Haynes, Watermaster Dist. # 13 (via email)  
Jackson County Planning Department

Enclosure



BEFORE THE WATER RESOURCES DEPARTMENT  
OF THE  
STATE OF OREGON

In the Matter of Permit Amendment	)	FINAL ORDER APPROVING AN
T-13820, Jackson County	)	ADDITIONAL POINT OF
	)	APPROPRIATION

**Authority**

Oregon Revised Statute (ORS) 537.211 establishes the process in which a water right permit holder may submit a request to change the point of appropriation and/or place of use authorized under an existing water right permit.

**Applicant**

TIFFANY RANGOLE  
AND PAMELA J. OTT  
13933 E EVANS CREEK RD  
ROGUE RIVER, OR 97537

**Findings of Fact**

1. On September 9, 2021, TIFFANY RANGOLE, filed an application for an additional point of appropriation under Permit G-18004. The Department assigned the application number T-13820.
2. Notice of the application for the permit amendment was published in the Department's weekly notice on September 21, 2021, pursuant to ORS 540.520(5). No comments were filed in response to the notices.
3. On January 24, 2022, the Department contacted the applicant asking for consent for the permit amendment from PAMELA OTT the co-permittee.
4. On January 31, 2022, the Department received a copy of the application signature page with the signature of PAMELA J. OTT.
5. Permit Amendment Application T-13820 proposes an additional point of appropriation approximately 500 feet from the existing point of appropriation to:

Twp	Rng	Mer	Sec	Q-Q	Measured Distances
35 S	3 W	WM	5	NE NE	JACK 64943 - 520 FEET SOUTH AND 1,300 FEET WEST FROM THE NE CORNER OF SECTION 5

This is a final order in other than contested case. This order is subject to judicial review under ORS 183.484. Any petition for judicial review must be filed within the 60 day time period specified by ORS 183.484(2). Pursuant to ORS 536.075 and OAR 137-004-0080 and OAR 690-01-0005 you may either petition for judicial review or petition the Director for reconsideration of this order. A petition for reconsideration may be granted or denied by the Director, and if no action is taken within 60 days following the date the petition was filed, the petition shall be deemed denied.



### *Permit Amendment Review Criteria*

6. The change would not result in injury to other water rights.
7. The change does not enlarge the permit.
8. The change does not alter any other terms of the permit.

### **Conclusions of Law**

The additional point of appropriation proposed by Permit Amendment Application T-13820 is consistent with the requirements of ORS 537.211.

### **Now, therefore, it is ORDERED:**

1. The additional point of appropriation proposed by Permit Amendment Application T-13820 is approved.
2. Permit G-18757, in the name of TIFFANY RANGOLE AND PAMELA OTT, is issued to replace Permit G-18004, and incorporates the amendments approved by this order. Permit G-18004, in the name of TIFFANY RANGOLE AND PAMELA OTT, is no longer of any force or effect.
3. The combined quantity of water diverted at the additional point of appropriation (JACK 64943), together with that diverted at the authorized point of appropriation (JACK 4441), shall not exceed the quantity of water lawfully available at the original point of appropriation (JACK 4441).
4. Water use measurement conditions:
  - a. Before water use may begin under this order, the water user shall install a totalizing flow meter, or, with prior approval of the Director, another suitable measuring device, at each point of appropriation.
  - b. The water user shall maintain the meters or measuring devices in good working order.
  - c. The water user shall allow the Watermaster access to the meters or measuring devices; provided however, where the meters or measuring devices are located within a private structure, the Watermaster shall request access upon reasonable notice.
5. Water shall be acquired from the same aquifer as the original point of appropriation.



6. All other terms and conditions of Permit G-18757 remain the same.

Dated in Salem, Oregon on

**MAY 25 2022**

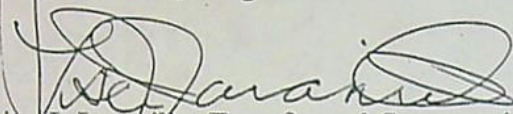

Lisa J. Jaramillo, Transfer and Conservation Section Manager, for  
THOMAS M BYLER, DIRECTOR  
Oregon Water Resources Department

*Mailing Date:*

**MAY 26 2022**



## Oregon Water Resources Department

## Measurement Condition Information for the Applicant

(To be sent with the Draft Preliminary Determination or Final Order)

Transfer #: T- 13820

(TFM)

In order to avoid enlargement of the right or injury to other rights, a Totalizing Flow Meter will be required to be installed prior to diversion of water, as a condition of this transfer:

at each point of diversion/appropriation (new and existing) OR



at each new point of diversion/appropriation.

For additional information, or to obtain approval of a different type of measurement device, the applicant should contact the area Watermaster:

Watermaster name: Shawn Haynes

District: 13

Address: 10 S. Oakdale, Room 309A

City/State/Zip: Medford, OR 97501

Phone: 541-774-6880

Email: shawn.l.haynes@water.oregon.gov

**Note:** If a device other than the one specified in the Preliminary Determination or Final Order is approved by the Watermaster, fill out and mail the form below to the Salem office.

\*\*\*\*\*

## Approval of an Alternate Measurement Device

T-

(to be filled out after consultation with the applicant, or after a site visit)

On behalf of the Director, I authorize use of the following suitable alternate measurement device:

\_\_\_\_\_  
\_\_\_\_\_\_\_\_\_\_  
Watermaster signature\_\_\_\_\_  
District\_\_\_\_\_  
Date

If this form is used for approval of an alternative measurement device, it must be mailed to:

Oregon Water Resources Department  
725 Summer Street NE, Suite A  
Salem, OR 97301-1266

38



## STATE OF OREGON

## COUNTY OF JACKSON

## PERMIT TO APPROPRIATE THE PUBLIC WATERS

THIS PERMIT IS HEREBY ISSUED TO

TIFFANY RANGOLE  
PAMELA OTT  
13933 E EVANS CREEK RD  
ROGUE RIVER OR 97537

This superseding permit is issued to describe an amendment for an additional point of appropriation proposed under Permit Amendment Application T-13820 and approved by Special Order Vol. 125, Page 164, entered May 25, 2022. This permit supersedes Permit G-18004.

The specific limits and conditions of the use are listed below.

APPLICATION FILE NUMBER: G-18367

SOURCE OF WATER: WELL 1 (JACK 4441) AND WELL 2 (JACK 64943) IN MAYS CREEK BASIN

RATE AND PURPOSE OR USE:

0.16 CUBIC FOOT PER SECOND FOR NURSERY USE (IRRIGATION AND  
AGRICULTURE USES) ON 10.0 ACRES

1.0 ACRE-FOOT STORED IN LAKE MONTANA FOR NURSERY USE (IRRIGATION AND  
AGRICULTURE USES)

PERIOD OF USE: JANUARY 1 THROUGH DECEMBER 31

DATE OF PRIORITY: AUGUST 15, 2016

WELL LOCATION:

POD Name	Twp	Rng	Mer	Sec	Q-Q	Measured Distances
JACK 64943	35 S	3 W	WM	5	NE NE	520 FEET SOUTH AND 1,300 FEET WEST FROM THE NE CORNER OF SECTION 5
JACK 4441	35 S	3 W	WM	5	NW NE	90 FEET SOUTH AND 1565 FEET WEST FROM THE NE CORNER OF SECTION 5

DAM LOCATION:

POD Name	Twp	Rng	Mer	Sec	Q-Q	Measured Distances
LAKE MONTANA	35 S	3 W	WM	5	NE NE	45 FEET SOUTH AND 840 FEET WEST FROM THE NE CORNER OF SECTION 5



The amount of water used for nursery use under this right, together with the amount secured under any other right existing for the same lands, is limited to 0.15 cubic foot per second per acre and 5.0 acre feet per acre per year. For irrigation of containerized nursery plants, the amount of water diverted under this right, together with the amount secured under any other right existing for the same lands, is limited to ONE-FORTIETH of one cubic foot per second and 5.0 acre feet per acre per year. For irrigation of in-ground nursery plants, the amount of water diverted under this right, together with the amount secured under any other right existing for the same lands, is limited to ONE-EIGHTIETH of one cubic foot per second and 2.5 acre feet per acre per year. The use of water for nursery use may be made at any time, during the period of allowed use specified above, that the use is beneficial. For irrigation of any other crop, the amount of water diverted under this right, together with the amount secured under any other right existing for the same lands, is limited to ONE-EIGHTIETH of one cubic foot per second and 2.5 acre feet per acre during the irrigation season of each year.

**THE PLACE OF USE IS LOCATED AS FOLLOWS:**

NURSERY USE					
Twp	Rng	Mer	Sec	Q-Q	Acres
35 S	3 W	WM	5	NE NE	4.9
35 S	3 W	WM	5	NW NE	5.1
Total					10.0

STORAGE				
Twp	Rng	Mer	Sec	Q-Q
35 S	3 W	WM	5	NE NE

**Permit Amendment T-13820 Conditions**

1. The combined quantity of water diverted at the additional point of appropriation (JACK 64943), together with that diverted at the authorized point of appropriation (JACK 4441), shall not exceed the quantity of water lawfully available at the original point of appropriation (JACK 4441).
2. Water use measurement conditions:
  - a. Before water use may begin under this order, the water user shall install a totalizing flow meter, or, with prior approval of the Director, another suitable measuring device, at each point of appropriation.
  - b. The water user shall maintain the meters or measuring devices in good working order.
  - c. The water user shall allow the Watermaster access to the meters or measuring devices; provided however, where the meters or measuring devices are located within a private structure, the Watermaster shall request access upon reasonable notice.

**Measurement Devices, and Recording/Reporting of Annual Water Use Conditions:**

- A. Before water use may begin under this permit, the permittee shall install a totalizing flow meter at each point of appropriation. The permittee shall maintain the device in good working order.
- B. The permittee shall allow the watermaster access to the device; provided however, where any device is located within a private structure, the watermaster shall request access upon reasonable notice.
- C. The permittee shall keep a complete record of the volume of water used each month, and shall submit an annual report which includes the recorded water-use measurements to the Department annually, or more frequently as may be required by the Director. Further, the Director may



require the permittee to report general water-use information, including the place and nature of use of water under the permit.

- D. The Director may provide an opportunity for the permittee to submit alternative measuring and reporting procedures for review and approval.

#### **Static Water Level Conditions:**

To monitor the effect of water use from the well(s) authorized under this permit, the Department requires the water user to obtain, from a qualified individual (see below), and report annual static water level measurements. The static water level shall be measured in the month of March. Reports shall be submitted to the Department within 30 days of measurement.

Measurements must be made according to the following schedule:

##### **Before Use of Water Takes Place**

###### **Initial and Annual Measurements**

The Department requires the permittee to report an initial water level measurement in the month specified above once well construction is complete and annually thereafter until use of water begins; and

##### **After Use of Water has Begun**

###### **Seven Consecutive Annual Measurements**

Following the first year of water use, the user shall report seven consecutive annual static water level measurements. The first of these seven annual measurements will establish the reference level against which future annual measurements will be compared. Based on an analysis of the data collected, the Director may require the user to obtain and report additional annual static water level measurements beyond the seven year minimum reporting period. The additional measurements may be required in a different month. If the measurement requirement is stopped, the Director may restart it at any time.

All measurements shall be made by a certified water rights examiner, registered professional geologist, registered professional engineer, licensed well constructor or pump installer licensed by the Construction Contractors Board and be submitted to the Department on forms provided by the Department. The Department requires the individual performing the measurement to:

- A. Identify each well with its associated measurement; and
- B. Measure and report water levels to the nearest tenth of a foot as depth-to-water below ground surface; and
- C. Specify the method used to obtain each well measurement; and
- D. Certify the accuracy of all measurements and calculations reported to the Department.

The water user shall discontinue use of, or reduce the rate or volume of withdrawal from, the well(s) if any of the following events occur:

- A. Annual water level measurements reveal an average water level decline of three or more feet per year for five consecutive years; or
- B. Annual water level measurements reveal a water level decline of 15 or more feet in fewer than five consecutive years; or
- C. Annual water level measurements reveal a water level decline of 25 or more feet; or



- D. Hydraulic interference leads to a decline of 25 or more feet in any neighboring well with senior priority.

The period of non-use or restricted use shall continue until the water level rises above the decline level which triggered the action or until the Department determines, based on the permittee's and/or the Department's data and analysis, that no action is necessary because the aquifer in question can sustain the observed declines without adversely impacting the resource or senior water rights. The water user shall in no instance allow excessive decline, as defined in Commission rules, to occur within the aquifer as a result of use under this permit. If more than one well is involved, the water user may submit an alternative measurement and reporting plan for review and approval by the Department.

#### **Scenic Water Way Condition:**

Use of water under authority of this permit may be regulated if analysis of data available after the permit is issued discloses that the appropriation will measurably reduce the surface water flows necessary to maintain the free-flowing character of a scenic waterway in quantities necessary for recreation, fish and wildlife in effect as of the priority date of the right or as those quantities may be subsequently reduced.

#### **Well Identification Tag Condition:**

Prior to using water from any well listed on this permit, the permittee shall ensure that the well has been assigned an OWRD Well Identification Number (Well ID tag), which shall be permanently attached to the well. The Well ID shall be used as a reference in any correspondence regarding the well, including any reports of water use, water level, or pump test data.

### **STANDARD CONDITIONS**

Failure to comply with any of the provisions of this permit may result in action including, but not limited to, restrictions on the use, civil penalties, or cancellation of the permit.

If the number, location, source, or construction of any well deviates from that proposed in the permit application or required by permit conditions, this permit may be subject to cancellation, unless the Department authorizes the change in writing.

If substantial interference with surface water or a senior water right occurs due to withdrawal of water from any well listed on this permit, then use of water from the well(s) shall be discontinued or reduced and/or the schedule of withdrawal shall be regulated until or unless the Department approves or implements an alternative administrative action to mitigate the interference. The Department encourages junior and senior appropriators to jointly develop plans to mitigate interferences.

The well(s) shall be constructed and maintained in accordance with the General Standards for the Construction and Maintenance of Water Supply Wells in Oregon. The works shall be equipped with a usable access port adequate to determine water-level elevation in the well at all times.

If the riparian area is disturbed in the process of developing a point of appropriation, the permittee shall be responsible for restoration and enhancement of such riparian area in accordance with ODFW's Fish and Wildlife Habitat Mitigation Policy OAR 635-415. For purposes of mitigation, the ODFW Fish and Wildlife Habitat Mitigation Goals and Standards, OAR 635-415, shall be followed.



The use may be restricted if the quality of downstream waters decreases to the point that those waters no longer meet state or federal water quality standards due to reduced flows.

Where two or more water users agree among themselves as to the manner of rotation in the use of water and such agreement is placed in writing and filed by such water users with the watermaster, and such rotation system does not infringe upon such prior rights of any water user not a party to such rotation plan, the watermaster shall distribute the water according to such agreement.

Prior to receiving a certificate of water right, the permit holder shall submit to the Water Resources Department the results of a pump test meeting the Department's standards for each point of appropriation (well), unless an exemption has been obtained in writing under OAR 690-217. The Director may require water-level or pump-test data every ten years thereafter.

This permit is for the beneficial use of water without waste. The water user is advised that new regulations may require the use of best practical technologies or conservation practices to achieve this end.

By law, the land use associated with this water use must be in compliance with statewide land-use goals and any local acknowledged land-use plan.

Construction of the well shall begin within five years of the date of original permit issuance April 17, 2018. The deadline to begin construction may not be extended. This permit is subject to cancellation proceedings if the construction deadline to begin is missed.

Complete application of the water shall be made within five years of the date of permit issuance. If beneficial use of permitted water has not been made before this date, the permittee may submit an application for extension of time, which may be approved based upon the merit of the application.

Within one year after making beneficial use of water, the permittee shall submit a claim of beneficial use, which includes a map and report, prepared by a Certified Water Rights Examiner.

Issued

**MAY 25 2022**

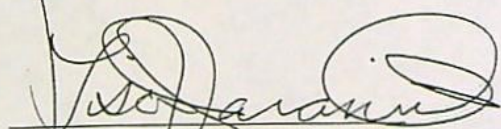

Lisa J. Jaramillo, Transfer and Conservation Section Manager, for  
THOMAS M BYLER, DIRECTOR  
Oregon Water Resources Department



# WATER RIGHT TRANSFER COVER SHEET

Transfer: T- 13820

Transfer Specialist: *Scott*

Transfer Type: Permit Amendment Transfer

<b>Applicant:</b> TIFFANY RANGOLE 13933 E EVANS CREEK RD ROGUE RIVER, OR 97537 Email: _____ Phone: _____		<b>Agent:</b> <input type="checkbox"/> N/A UNAVAILABLE Email: _____ Phone: _____	
<b>Irrigation District:</b> <input type="checkbox"/> N/A Email: _____		<b>CWRE:</b> <input type="checkbox"/> N/A Email: _____	
<b>Affected Local Gov'ts:</b> <input type="checkbox"/> N/A Jackson County Planning & Development county Courthouse Email: _____		<b>Affected Tribal Gov't:</b> <input type="checkbox"/> N/A UNAVAILABLE Email: _____	
<b>Current Landowner if other than Applicant:</b> <input type="checkbox"/> N/A Email: _____		<b>Receiving Landowner:</b> <input type="checkbox"/> N/A Email: _____	

## Water Rights Affected

File Marked	App. File # or Decree Name	Permit	Certificate	RR/CR Needed	RR/CR Nos.
<input type="checkbox"/>	G18367	G-18004		<input type="checkbox"/> Yes <input type="checkbox"/> No	
<input type="checkbox"/>				<input type="checkbox"/> Yes <input type="checkbox"/> No	
<input type="checkbox"/>				<input type="checkbox"/> Yes <input type="checkbox"/> No	

## Key Dates & Initial Actions:

Rec'd: September 9, 2021	Proposed Action(s): POINT OF APPROPRIATION	
Fees Pd: 1840.00	WM District: 13	ODFW District:
Initial Public Notice: September 21, 2021	WM Review sent:	ODFW Review sent:
Acknowledgement Letter Sent <input checked="" type="checkbox"/>		GW Review sent: <input type="checkbox"/> N/A
County sent cc: of Ack Letter <input type="checkbox"/>	BOR notified (date): <input type="checkbox"/> N/A	
Newspaper quote requested:	Request for news \$ sent:	News \$ received:
Request to publish sent:	Affidavit of publication received:	Last day of publication:

Document	Drafted	Peer Review	Changes Made	Coordinator	Changes Made	Signature Bin	Signature Date
DPD	Date: _____ Initials: _____	Date: _____ Initials: _____	Date: _____ Initials: _____	Date: _____ Initials: _____	Date: _____ Initials: _____	CW Sent: _____	N/A
PD	Date: _____ Initials: _____	Date: _____ Initials: _____	Date: _____ Initials: _____	Date: _____ Initials: _____	Date: _____ Initials: _____	Date: _____	Date: _____
FO	Date: 3/28/22 Initials: Scott	Date: 4/1/22 Initials: Scott	Date: _____ Initials: _____	Date: 4/19/22 Initials: PKS	Date: 4/22/22 Initials: Scott	Date: 4/22/22	Date: 5/25/2022

*again 5/4/22*

Special Issues: \_\_\_\_\_

Special Order Volume: Vol. 125 Pages 1104-104



## GREW Scott A \* WRD

---

**From:** GREW Scott A \* WRD  
**Sent:** Thursday, March 3, 2022 6:14 PM  
**To:** truecarefarms@gmail.com  
**Cc:** GREW Scott A \* WRD  
**Subject:** RE: Permit Amendment Application T-13820  
**Attachments:** Land Use Form incomplete.pdf

Tiffany,

I wanted to confirm that the Department received the signature page you sent. Thank you.

I have received both the Watermaster Review and Groundwater Review and am proceeding with your application.

Upon closer inspection, the Land Use form is incomplete. Page 3 has to be filled out and signed by a representative of Jackson County attesting to the land use. See the attached scan and please have Jackson County fill it out and you can return it to me. You can e-mail this. I'm sorry I didn't notice this earlier.

Please return the form by March 31, 2022 in order for your application to be complete.

Thank you so much,

*Scott*

Scott Grew  
Transfer Specialist  
Oregon Water Resources Department  
503-986-0890

---

**From:** GREW Scott A \* WRD <Scott.A.GREW@water.oregon.gov>  
**Sent:** Monday, January 24, 2022 2:42 PM  
**To:** truecarefarms@gmail.com  
**Cc:** GREW Scott A \* WRD <Scott.A.GREW@water.oregon.gov>  
**Subject:** Permit Amendment Application T-13820

Good afternoon Tiffany Rangle,

I am the caseworker that will be processing your Permit Amendment Application T-13820.

The application is missing the signature from the other Permitholder of record.

Attached is a copy of the signature page for the application. Please print it out and add the other Permit holder and have them sign this and return the hardcopy to the Department.

Oregon Water Resources Department



**GREW Scott A \* WRD**

---

**From:** GREW Scott A \* WRD  
**Sent:** Monday, January 24, 2022 2:42 PM  
**To:** truecarefarms@gmail.com  
**Cc:** GREW Scott A \* WRD  
**Subject:** Permit Amendment Application T-13820  
**Attachments:** T-13820 signature page.pdf

Good afternoon Tiffany Rangole,

I am the caseworker that will be processing your Permit Amendment Application T-13820.

The application is missing the signature from the other Permitholder of record.

Attached is a copy of the signature page for the application. Please print it out and add the other Permit holder and have them sign this and return the hardcopy to the Department.

Oregon Water Resources Department  
Attn: Transfers T-13820  
725 Summer Street NE, Suite A  
Salem, OR 97301

Thank you,

Scott Grew  
Transfer Specialist  
Oregon Water Resources Department  
503-986-0890



# Watermaster Review Form: Water Right Transfer



Oregon Water Resources Department  
725 Summer St NE, Suite A  
Salem, Oregon 97301-1266  
(503) 986-0900  
[www.oregon.gov/OWRD](http://www.oregon.gov/OWRD)

Transfer Application: T-13820

Review Due Date:

Applicant Name: Tiffany Rangole

Proposed Changes: ☐ POU ☐ POD ☒ POA ☐ USE ☐ OTHER

Reviewer(s): S. Haynes

Date of Review: 02/15/2022

1. Do you have evidence that the right has not been used in the last 5 years and that the presumption of forfeiture would not likely be rebuttable? ☐ Yes ☒ No If "Yes", attach evidence (e.g. dated aerial photo showing pavement or building on the land for >5 yrs.)
2. Is there a history of regulation on the source that serves this (or these) right(s) that has involved the transferred right(s) and downstream water rights? ☐ Yes ☒ No Generally characterize the frequency of any regulation or explain why regulation has not occurred:
3. Have headgate notices been issued for the source that serves the transferred right(s)?  
☐ Yes ☐ No ☐ Records not available.
4. In your estimation, after the proposed change, would distribution of water for the right(s) result in regulation of other water rights that would not have occurred if use under the original right(s) was/were maximized? ☐ Yes ☒ No If "Yes", explain:
5. In your estimation, if the proposed change is approved, are there upstream water rights that would be affected? ☐ Yes ☒ No If "Yes", describe how the rights would be affected and list the rights most affected:



6. Check here ☐ if it appears that downstream water rights benefit from return flows resulting from the current use of the transferred right(s)? If you check the box, generally characterize the locations where the return flows likely occur and list the water rights that benefit most:

☒ N/A

7. For POD changes and instream transfers, check here if there are channel losses between the old and new PODs or within the proposed instream reach? If you check the box, describe and, if possible, estimate the losses:

☒ N/A

8. For instream transfers that propose protection of a reach beyond the mouth of the source stream:

☒ N/A Would the quantity be measureable into the receiving stream consistent with OAR 690-077-0015(8)? ☐ Yes ☐ No

9. For POU changes: ☒ N/A Is it likely the original place of use would continue to receive water from the same source? ☐ Yes ☐ No If "Yes", explain:

10. For POU or USE changes: ☒ N/A In your best judgment, would use of the existing right at "full face value," result in the diversion of more water than can be used beneficially and without waste?

☐ Yes ☐ No If "Yes", explain:

11. For POU changes that involve micro-irrigation: ☒ N/A

- a. Has the applicant made changes (absent a transfer) to convert to micro-irrigation within the current place of use boundary of the water right proposed for transfer, and previously demonstrated to the Department through monitoring and site inspections by the Watermaster that the proposed transfer will not result in injury or enlargement?

☐ Yes ☐ No If "Yes", explain:



- b. Has a temporary transfer of this nature been previously filed and approved on the same lands (or portions thereof) as those lands involved in this transfer?

☐ Yes ☐ No If "Yes", answer the following:

- i. Were there any problems with more acres being irrigated (or wetted) than were authorized under the temporary transfer? ☐ Yes ☐ No If "Yes", explain:

- ii. Did the designated areas that were to remain dry (or not wetted) under the temporary transfer actually remain dry? ☐ Yes ☐ No If "No", explain:

- iii. Did the applicant comply with and meet all of the conditions of the temporary transfer? ☐ Yes ☐ No If "No", explain:

- iv. Do you have any other observations regarding the temporary transfer? ☐ Yes ☐ No If "Yes", describe:

- v. Did the applicant demonstrate to the Department through monitoring and site inspections by the Watermaster that neither injury nor enlargement occurred as a result of the temporary transfer? ☐ Yes ☐ No If "No", explain:

- c. To the best of your knowledge, if this transfer is approved, does it appear that:

- i. "Injury" will occur to other water rights that share the same source? ☐ Yes ☐ No If "Yes", explain:

- ii. "Enlargement" of the water right being transferred will occur? ☐ Yes ☐ No If "Yes", explain:



12. Are there other issues not identified through the above questions that should be considered in determining whether the change "can be effected without injury to other rights"?

☒ Yes ☐ No If "Yes", explain:

Well JACK 64943 appears to be within a 1/4 mile of Evans Creek. This proposed POA may have PSI.

13. What alternatives may be available for addressing any issues identified above:

The proposed POA may need to be relocated. Water use reporting that include annual static water level measurements.

14. Do conditions need to be included in the transfer order to avoid enlargement of the right or injury to other rights? ☐ No ☒ Yes, as checked and provided below:

☐ For POU changes that involve micro-irrigation, provide the monitoring and reporting conditions necessary to prevent injury/enlargement:

☐ A Headgate should be required prior to diverting water.

☒ Measurement Devices for POD or POA: (if this condition is selected, also fill in the top sections of Page 4)

*a. Before water use may begin under this order, the water user shall install a totalizing flow meter\*, or, with prior approval of the Director, another suitable measuring device, ☒ at each point of diversion/appropriation (new and existing) OR at each new point of diversion/appropriation ☐ with the exception that water rights issued to the Bureau of Reclamation or an irrigation district (or similar entity) are not subject to this condition.*

*b. The water user shall maintain the meters or measuring devices in good working order.*

*c. The water user shall allow the Watermaster access to the meters or measuring devices; provided however, where the meters or measuring devices are located within a private structure, the Watermaster shall request access upon reasonable notice.*

☐ Reservoir water use measurement: (if this condition is selected, also fill in the top sections of Page 4)

*a. Before water use may begin under this order, the water user shall install staff gages\*, or, with prior approval of the Director, other suitable measuring devices, that measure the entire range and stage between empty and full in each reservoir. Staff gages shall be United States Geological Survey style.*

*b. Before water use may begin under this order, if the reservoir is located in channel, weirs or other suitable measuring devices must be installed upstream and downstream of the reservoir, and, an adjustable outlet valve must be installed. The water user shall maintain such devices in good working order. A written waiver may be obtained, if in the judgment of the Director, the installation of weirs or other suitable measuring devices, or the adjustable outlet valve, will provide no public benefit.*

\* The following alternative device(s) should be substituted for the bold, underlined device in the above selected condition:

☐ Weir  
☐ Parshall Flume  
☐ Other: \_\_\_\_\_

☐ Submerged Orifice  
☐ Flow Restrictor



**Oregon Water Resources Department**  
**Measurement Condition Information for the Applicant**  
*(To be sent with the Draft Preliminary Determination or Final Order)*

Transfer #: T-

☐ In order to avoid enlargement of the right or injury to other rights, a \_\_\_\_\_ will  
 be required to be installed **prior to diversion of water**, as a condition of this transfer:

☐ at each point of diversion/appropriation (new and existing) **OR**

☐ at each new point of diversion/appropriation.

For additional information, or to obtain approval of a different type of measurement device, the applicant should contact the area Watermaster:

Watermaster name:

District:

Address:

City/State/Zip:

Phone:

Email:

**Note:** If a device other than the one specified in the Preliminary Determination or Final Order is approved by the Watermaster, fill out and mail the form below to the Salem office.

\*\*\*\*\*

**Approval of an Alternate Measurement Device T-**  
*(to be filled out after consultation with the applicant, or after a site visit)*

On behalf of the Director, I authorize use of the following suitable **alternate measurement device**:

\_\_\_\_\_  
 \_\_\_\_\_

\_\_\_\_\_  
 Watermaster signature

\_\_\_\_\_  
 District

\_\_\_\_\_  
 Date

If this form is used for approval of an alternative measurement device, it must be mailed to:

Oregon Water Resources Department  
 725 Summer Street NE, Suite A  
 Salem, OR 97301-1266



## Groundwater Transfer Review Summary Form

Transfer/PA # T- 13820

GW Reviewer Joe Kemper Date Review Completed: 11/19/2021

### Summary of Same Source Review:

- ☐ The proposed change in point of appropriation is not within the same aquifer as per OAR 690-380-2110(2).

### Summary of Injury Review:

- ☐ The proposed transfer will result in another, existing water right not receiving previously available water to which it is legally entitled or result in significant interference with a surface water source as per 690-380-0100(3).

### Summary of GW-SW Transfer Similarity Review:

- ☐ The proposed SW-GW transfer doesn't meet the definition of "similarly" as per OAR 690-380-2130.

*This is only a summary. Documentation is attached and should be read thoroughly to understand the basis for determinations.*





Oregon Water Resources Department  
725 Summer Street NE, Suite A  
Salem, Oregon 97301-1271  
(503) 986-0900  
www.wrd.state.or.us

## Ground Water Review Form:

☐ Water Right Transfer

☒ Permit Amendment

☐ GR Modification

☐ Other

Application: T-13820

Applicant Name: Tiffany Rangole

Proposed Changes: ☐ POA

☒ APOA

☐ SW→GW

☐ RA

☐ USE

☐ POU

☐ OTHER

Reviewer(s): Joe Kemper

Date of Review: 11/19/2021

Date Reviewed by GW Mgr. and Returned to WRSD: JT 12/27/21

The information provided in the application is insufficient to evaluate whether the proposed transfer may be approved because:

- ☐ The water well reports provided with the application do not correspond to the water rights affected by the transfer.
- ☐ The application does not include water well reports or a description of the well construction details sufficient to establish the ground water body developed or proposed to be developed.
- ☐ Other \_\_\_\_\_

- 
1. Basic description of the changes proposed in this transfer: The permit amendment proposes to add JACK 64943 as an additional point of appropriation (APOA) to the current valid POA, JACK 4441 under permit G-18004. There is no proposed change to the POU or character of use.
  2. Will the proposed POA develop the same aquifer (source) as the existing authorized POA?  
☒ Yes ☐ No Comments: JACK 4441 and JACK 64943 both access a fractured-rock aquifer hosted in secondary porosity of schistose metamorphic rock (JTrm) of the Applegate Group (Wiley et al., 2006). JACK 4441 is 65 deep and produces water from a relatively shallow fracture zone within JTrm. JACK 64943 is 320 feet and the well report identifies a deeper WBZ. Fractured rock aquifers typically consist of a single overall groundwater flow system primarily controlled by surface topography, fracture density, and fracture interconnection. While individual wells may encounter heterogeneous higher-permeability fracture zones, JACK 4441 and JACK 64943 are considered within the same overall aquifer.
  3. a) Is there more than one source developed under the right (e.g., basalt and alluvium)?  
☐ Yes ☒ No JACK 4441 and JACK 64943 are constructed such that they are only open to the fractured rock aquifer.  
b) If yes, estimate the portion of the right supplied by each of the sources and describe any limitations that will need to be placed on the proposed change (rate, duty, etc.): NA



4. a) Will this proposed change, at its maximum allowed rate of use, likely result in an increase in interference with **another ground water right**?

☒ Yes ☐ No Comments: There is relatively high groundwater development adjacent to the applicant's wells including exempt-use wells on adjacent tax lots and three permitted POAs within 1/3 mile. The APOA will likely increase interference with wells to the south and east, while decrease or keep constant any interference with wells to the west and north. Best available information indicates that JACK 30499 (POA under Certificate 83628) is the closest well to the APOA that will likely see increased interference from the proposed change. JACK 30499 is 875 feet from JACK 64943 and 1065 feet from JACK 4441.

b) If yes, would this proposed change, at its maximum allowed rate of use, likely result in another groundwater right not receiving the water to which it is legally entitled?

☐ Yes ☒ No If yes, explain: This distance drawdown modeling indicates that full appropriation of permit G-18004 from JACK 4441 would likely cause 10-15 feet of seasonal drawdown at JACK 30499. Pumping from JACK 64943 may increase that drawdown 2-5 feet. JACK 30499 may also experience some interference from JACK 4423 under Certificate 84098 to the SE. However, considering the total depth of JACK 30499 (175 feet) and late season WL records in that well (50-60 feet BLS), there is not a preponderance of evidence that adding the proposed APOA would preclude JACK 30499 from accessing water to which it is legally entitled to.

5. a) Will this proposed change, at its maximum allowed rate of use, likely result in an increase in interference with **another surface water source**?

☒ Yes ☐ No Comments: Groundwater elevations in the target aquifer are higher than or coincident with adjacent streams (Evans Creek and May Creek), indicating that groundwater is flowing towards and discharging to surface water. JACK 4441 was found to be hydraulically connected to Evans Creek and May Creek in the initial technical review for application G-18367. JACK 64943 is 200 feet closer to Evans Creek than JACK 4441, which will likely increase stream depletion. JACK 64943 is further from May Creek than JACK 4441, which will likely decrease stream depletion.

b) If yes, at its maximum allowed rate of use, what is the expected change in degree of interference with any **surface water sources** resulting from the proposed change?

Stream: Evans Creek

☒ Minimal ☐ Significant

Provide context for minimal/significant impact: The change in interference with Evans Creek from the proposed changes is estimated using the Hunt (1999) model using aquifer parameters representative of bulk aquifer properties. The estimated increase in stream depletion is less than 5% at any point during regular use.

6. For SW-GW transfers, will the proposed change in point of diversion affect the surface water source similarly (as per OAR 690-380-2130) to the authorized point of diversion specified in the water use subject to transfer?

☐ Yes ☒ No Comments: NA

7. What conditions or other changes in the application are necessary to address any potential issues identified above: NA

8. Any additional comments: NA



**References**

Hunt, B. 1999. Unsteady Stream Depletion from Ground Water Pumping. *Journal of Hydrologic Engineering*, Vol 8(1), pp 12-19

OWRD Groundwater Information System Database – Accessed 11/18/2021.

Theis, C.V., 1935. The relation between the lowering of the piezometric surface and the rate and duration of discharge of a well using groundwater storage, *Am. Geophys. Union Trans.*, vol. 16, pp. 519-524.

Wiley, T.J., 2006, Preliminary geologic map of the Wimer and McConville Peak 7.5' quadrangles, Jackson and Josephine Counties, Oregon: Oregon Department of Geology and Mineral Industries, Open-File Report O-06-05, scale 1:24,000



## Transfer Map

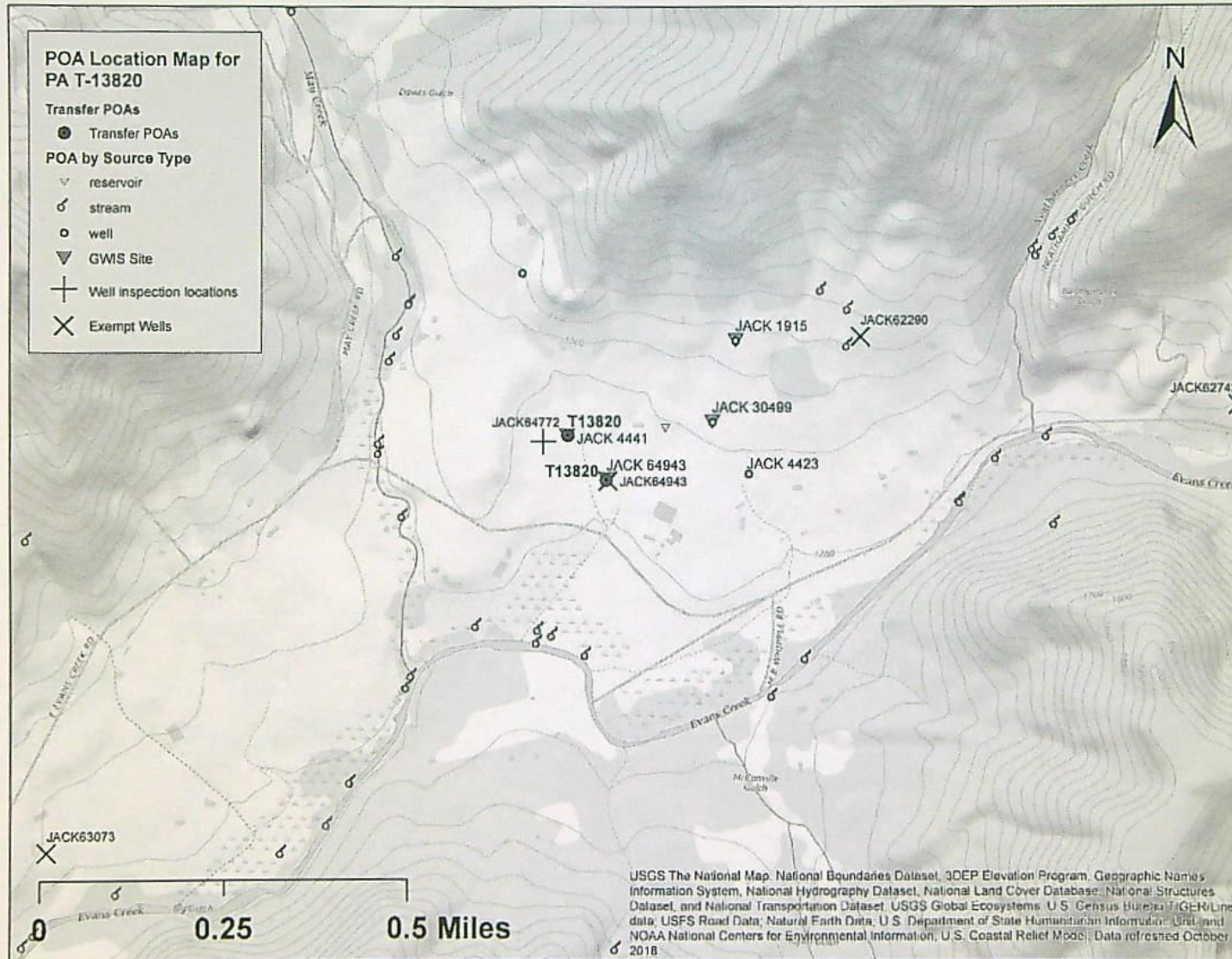



## Theis Distance Drawdown Modeling

$Q = 0.08$  cfs or  $\sim 35$  gpm, which is used to represent a sustainable pumping rate from JACK 64943 to appropriate the full permitted volume (50 AF) over 315 days. Model parameters are used to represent bulk aquifer properties and are taken from published expected values for fractured metamorphic rock and from a single-well pumping test conducted at JACK 4423.

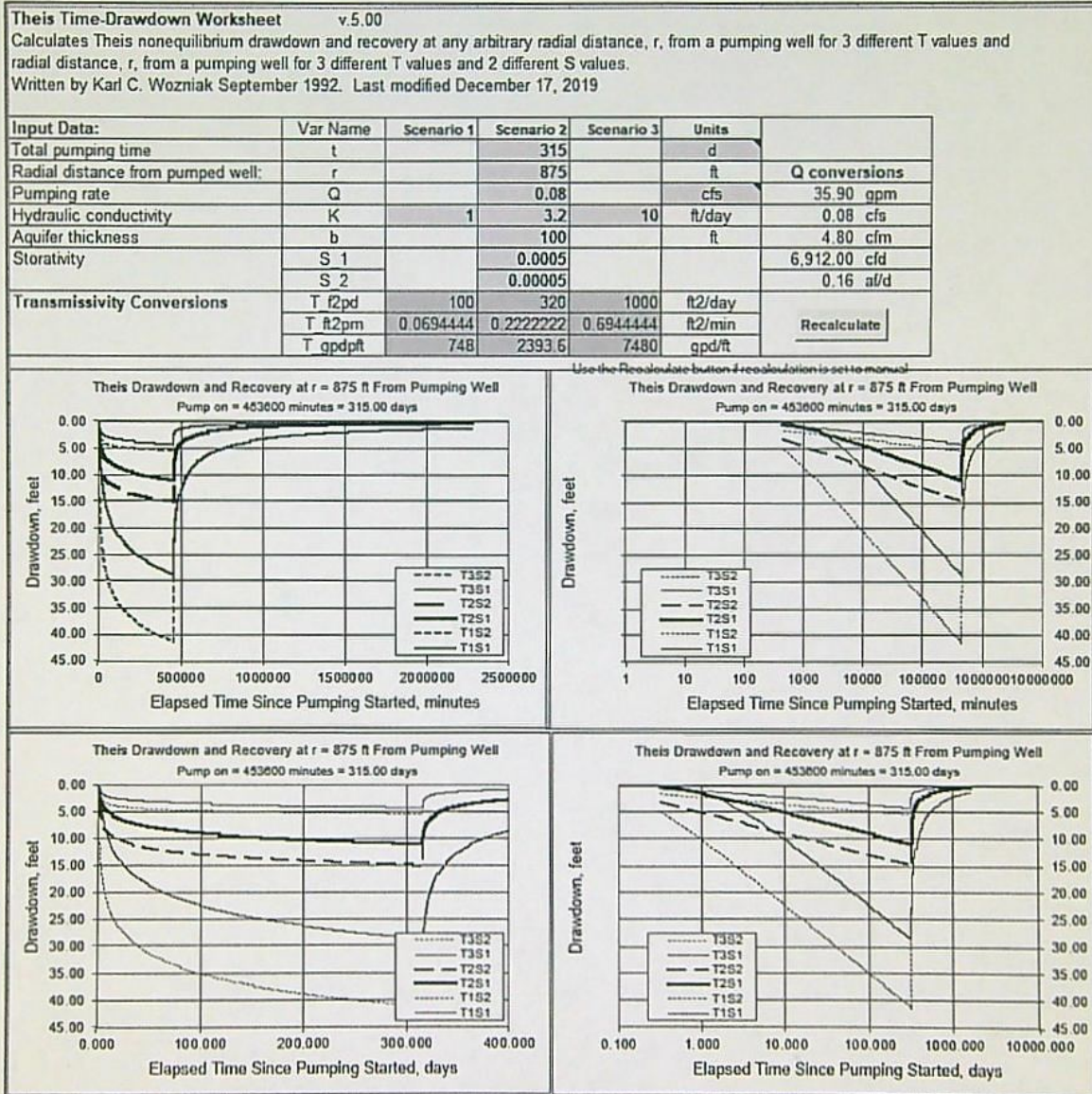



## Stream Depletion Modeling (Hunt, 1999)

Application type:	PA
Application number:	T13820
Well number:	1 v 2
Stream Number:	1
Pumping rate (cfs):	0.16
Pumping duration (days):	244.0
Pumping start month number (3=March)	3.0

Parameter	Symbol	Scenario 1	Scenario 2	Scenario 3	Units
Distance from well to stream	a	1280	1480	1480	ft
Aquifer transmissivity	T	320	320	320	ft <sup>2</sup> /day
Aquifer storativity	S	0.0001	0.0001	0.0001	-
Aquitard vertical hydraulic conductivity	Kva	0.05	0.05	0.05	ft/day
Not used		1	1	1	
Aquitard thickness below stream	babs	20	20	20	ft
Not used		1	1	1	
Stream width	ws	50	50	50	ft

Stream depletion for Scenario 2:

Days	10	330	360	30	60	90	120	150	180	210	240	270	300
Depletion (%)	49	10	8	66	75	79	82	83	85	86	87	23	14
Depletion (cfs)	0.08	0.02	0.01	0.11	0.12	0.13	0.13	0.13	0.14	0.14	0.14	0.04	0.02

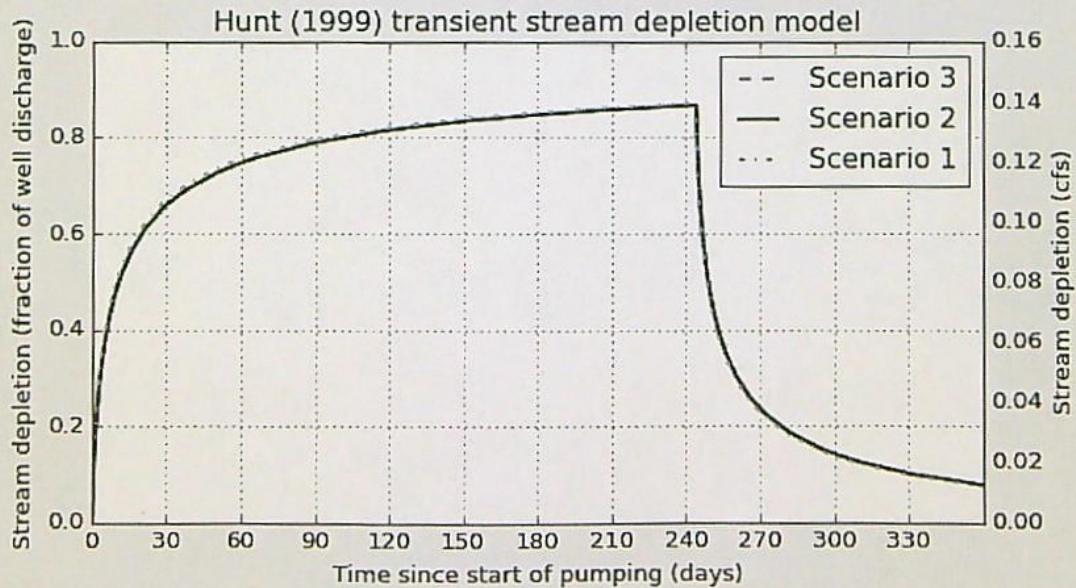





**Oregon**  
Kate Brown, Governor

**Water Resources Department**

725 Summer St NE, Suite A  
Salem, OR 97301  
(503) 986-0900  
Fax (503) 986-0904

September 21, 2021

TIFFANY RANGOLE  
13933 E EVANS CREEK RD  
ROGUE RIVER, OR 97537

Reference: Application T-13820

On September 9, 2021, OWRD received your water right Permit Amendment Application. The application was accompanied by \$1840.00. Our receipt number 136377 is enclosed.

By copy of this letter, we are asking the Watermaster for a report regarding the potential for injury to existing water rights which may be caused by the requested change. A review form will also be sent to our groundwater staff to determine whether the proposed well accesses the same source of water as the original well.

This application may require publication of a notice for two consecutive weeks in a newspaper with general circulation in the area where the water right is located. If it is determined that newspaper notice will be required, the Department will prepare the notice and notify you of the cost. You will be responsible for submitting payment to the Department prior to publication of the notice.

Except as provided under ORS 540.510(3) for municipalities, you may not use water from the new point of appropriation until a final order approving the application has been issued by the Department.

Refer to the following page for a chart showing the steps and expected timelines for the processing of your application.

If you have any questions, please contact the Transfer Section at (503) 986-0815.

Cc: Watermaster Dist. #13, Shavon L. Haynes (via email)  
Jackson County Planning Department

Enclosure



## Permit Amendment Process

ORS 537.211

Changes: POD/POA, Place of Use

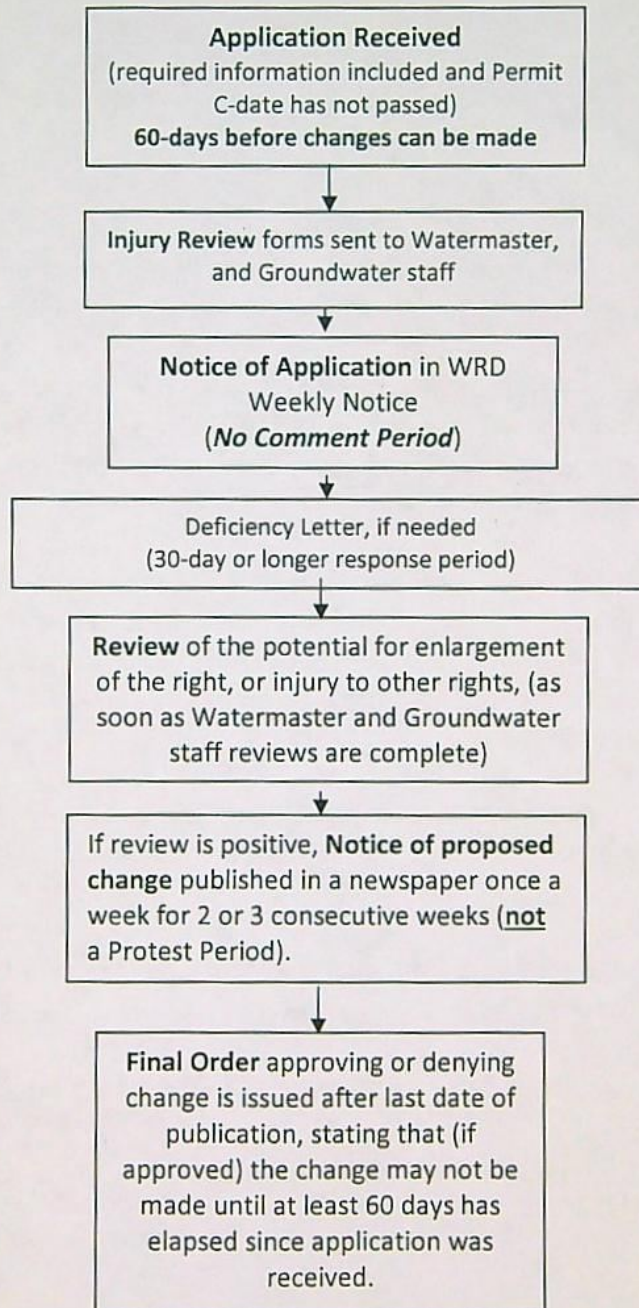



**STATE OF OREGON  
WATER RESOURCES DEPARTMENT**

725 Summer St. N.E. Ste. A

SALEM, OR 97301-4172

(503) 986-0900 / (503) 986-0904 (fax)

RECEIPT # **136377**

INVOICE # \_\_\_\_\_

RECEIVED FROM:

Anthony J. Ott

BY:

Truecare, Inc.

APPLICATION

PERMIT

TRANSFER

1-13820

CASH:

☐

CHECK: #

☒

671

OTHER: (IDENTIFY)

☐

TOTAL REC'D

\$ 1,840.00

**1083 TREASURY 4170 WRD MISC CASH ACCT**

0407 COPIES

\$

OTHER: (IDENTIFY)

\$

0243 I/S Lease

0244 Muni Water Mgmt. Plan

0245 Cons. Water

**4270 WRD OPERATING ACCT**

MISCELLANEOUS

46110

0407 COPY & TAPE FEES

\$

0410 RESEARCH FEES

\$

0408 MISC REVENUE: (IDENTIFY)

\$

TC162 DEPOSIT LIAB. (IDENTIFY)

\$

0240 EXTENSION OF TIME

\$

**WATER RIGHTS:**

EXAM FEE

RECORD FEE

0201 SURFACE WATER

\$

0202

\$

0203 GROUND WATER

\$

0204

\$

0205 TRANSFER

\$ 1,840.00

**WELL CONSTRUCTION**

EXAM FEE

LICENSE FEE

0218 WELL DRILL CONSTRUCTOR

\$

0219

\$

LANDOWNER'S PERMIT

0220

\$

OTHER (IDENTIFY)

**0536 TREASURY 0437 WELL CONST. START FEE**

0211 WELL CONST START FEE

\$

CARD#

0210 MONITORING WELLS

\$

CARD#

OTHER (IDENTIFY)

**0607 TREASURY 0467 HYDRO ACTIVITY**

LIC NUMBER

0233 POWER LICENSE FEE (FW/WRD)

\$

0231 HYDRO LICENSE FEE (FW/WRD)

\$

HYDRO APPLICATION

\$

**TREASURY OTHER / RDX**

FUND \_\_\_\_\_ TITLE \_\_\_\_\_

OBJ. CODE \_\_\_\_\_ VENDOR # \_\_\_\_\_

DESCRIPTION \_\_\_\_\_

\$

RECEIPT:

**136377**

DATED:

9-9-2021

BY:

Mindy Carlson



## Part 1 of 5 – Minimum Requirements Checklist



**Oregon Water Resources Department**  
725 Summer Street NE, Suite A  
Salem, Oregon 97301-1266  
(503) 986-0900  
[www.oregon.gov/OWRD](http://www.oregon.gov/OWRD)

For questions, please call (503) 986-0900, and ask for Transfer Section.

RECEIVED

SEP 09 2021

OWRD

☒ Part 1 – Completed Minimum Requirements Checklist.

☒ Part 2 – Completed Application Map Checklist.

☒ Part 3 – Application Fee, payable by check to the Oregon Water Resources Department, and completed Fee Worksheet, page 3. Try the new online fee calculator at:  
[http://apps.wrd.state.or.us/apps/misc/wrd\\_fee\\_calculator](http://apps.wrd.state.or.us/apps/misc/wrd_fee_calculator).

☒ Part 4 – Completed Applicant Information and Signature.

☒ Part 5 – Information about Permits to be Amended: **Number of permits to be amended:** 1  
**List the Permits here:** G-18004  
Please include a separate Part 5 for each permit. (See instructions on page 6)

☒ Completed Permit Amendment Application Map (Does not have to be prepared by a Certified Water Right Examiner).

☐ ☒ N/A Request for Assignment Form and statutory fee. The request for assignment form has to be completed if the applicant is **not** the permit holder of record and needs to be assigned to the permit; **or** the landowner of the proposed place of use is **not** the permit holder of record and needs to be assigned to the permit (the Request for Assignment Form is available online at <https://www.oregon.gov/OWRD/Forms/Pages/default.aspx>). Assignment is not needed if the applicant is the permit holder of record.

☐ ☒ N/A Affidavit(s) of Consent are required from all permit holder(s) of record if the permit is not assigned to the applicant **or** other permit holders of record that are not listed as applicants.

☒ ☐ N/A Oregon Water Resources Department's Land Use Information Form with approval and signature (or signed land use form receipt stub) from each local land use authority in which water is to be diverted, conveyed, and/or used. Not required if water is to be diverted, conveyed, and/or used only on federal lands or if **all** of the following apply: a) a change in place of use only, b) no structural changes, c) the use of water is for irrigation only, and d) the use is located within an irrigation district or an exclusive farm use zone.

☒ ☐ N/A Water Well Report/Well Log for changes in point(s) of appropriation (well(s)) or additional point(s) of appropriation.

☐ ☒ N/A Geologist Report for a change from a surface water point of diversion to a ground water point of appropriation (well), if the proposed well is more than 500 feet from the surface water source and more than 1000 feet upstream or downstream from the point of diversion. (ORS 540.531(2) or (3)).

**WE ARE RETURNING YOUR APPLICATION FOR THE FOLLOWING REASON(S):**

Application fee not enclosed/insufficient \_\_\_\_\_ Map not included or incomplete \_\_\_\_\_

Land Use Form not enclosed or incomplete

Additional signature(s) required

Part is incomplete

Other/Explanation

Staff: 503- Date: / /



## Part 2 of 5 – Permit Amendment Map Checklist

Your permit amendment application will be returned if any of the map requirements listed below are not met.

Please be sure that the map you submit includes all the items listed below and meets the requirements of OAR 690-380-3100, however, the map does not have to be prepared by a Certified Water Right Examiner. Check all boxes that apply.

RECEIVED

SEP 09 2021

- ☐ ☒ N/A If **more than three** permits are involved, separate maps for each permit.
- ☒ Permanent quality printed with dark ink on good quality paper.
- ☒ The size of the map can be 8½ x 11 inches, 8½ x 14 inches, 11 x 17 inches, or up to 30 x 30 inches. For 30 x 30 inch maps, one extra copy is required.
- ☒ A north arrow, a legend, and scale.
- ☒ The scale of the map must be: 1 inch = 400 feet, 1 inch = 1,320 feet, the scale of the county assessor map if the scale is not smaller than 1 inch = 1,320 feet, or a scale that has been pre-approved by the Department.
- ☒ Township, Range, Section, ¼ ¼, DLC, Government Lot, and other recognized public land survey lines.
- ☒ Tax lot boundaries (property lines) are required. Tax lot numbers are recommended.
- ☒ Major physical features including rivers and creeks showing direction of flow, lakes and reservoirs, roads, and railroads.
- ☒ Major water delivery system features from the point(s) of diversion/appropriation such as main pipelines, canals, and ditches.
- ☒ Existing place of use that includes separate hachuring for each water use permit, priority date, and use including number of acres in each quarter-quarter section, government lot, or in each quarter-quarter section as projected within government lots, donation land claims, or other recognized public land survey subdivisions. If less than the entirety of the permit is being changed, a separate hachuring is needed for the portion of the permit left unchanged.
- ☐ ☒ N/A If you are proposing a change in place of use, show the proposed place of use with hachuring that includes separate hachuring for each permit, priority date, and use including number of acres in each quarter-quarter section, government lot, or in each quarter-quarter section as projected within government lots, donation land claims, or other recognized public land survey subdivisions.
- ☒ Existing point(s) of diversion or well(s) with distance and bearing or coordinates from a recognized survey corner. This information can be found in your water use permit.
- ☐ ☒ N/A If you are proposing a change in point(s) of diversion or well(s), show the proposed location and label it clearly with distance and bearing or coordinates. If GPS coordinates are used, latitude-longitude coordinates may be expressed as either degrees-minutes-seconds with at least one digit after the decimal (example – 42°32'15.5") or degrees-decimal with five or more digits after the decimal (example – 42.53764°).

OWRD



## RECEIVED

SEP 09 2021

OWRD

1. For irrigation calculate cfs for each permit involved as follows:
  - a. Divide total authorized cfs by total acres in the permit (*for S-12345, 1.25 cfs ÷ 100 ac*); then multiply by the number of acres to be changed to get the application cfs (*x 45 ac = 0.56 cfs*).
  - b. If the water right permit does not list total cfs, but identifies the allowable use as 1/40 or 1/80 of a cfs per acre; multiply number of acres proposed for change by either 0.025 (1/40) or 0.0125 (1/80). (*For S-87654, 45.0 ac x 0.0125 cfs/ac = 0.56 cfs*)
2. Add cfs for the portions of permits on all the land included in the application; however **do not count cfs for supplemental permits on acreage for which you have already calculated the cfs fee for the primary permit on the same land**. The fee should be assessed only once for each "on the ground" acre included in the application. (*In this example, blank 5a would be only 0.56 cfs, since both permits serve the same 45.0 acres. Blank 5b would be 0 and Line 5 would then also become 0*).



RECEIVED

JAN 31 2022

OWRD

RECEIVED

## Part 4 of 5 – Applicant Information and Signature

## Applicant Information

SEP 09 2021

APPLICANT/BUSINESS NAME Tiffany Rangole		PHONE NO. 650-391-6030	ADDITIONAL CONTACT NO. 541-582-0521
ADDRESS 13933 E EAST EVANS CREEK RD.		FAX NO.	
CITY ROGUE RIVER	STATE OR	ZIP 97537	E-MAIL truecarefarms@gmail.com
BY PROVIDING AN E-MAIL ADDRESS, CONSENT IS GIVEN TO RECEIVE ALL CORRESPONDENCE FROM THE DEPARTMENT ELECTRONICALLY. COPIES OF THE FINAL ORDER DOCUMENTS WILL ALSO BE MAILED.			

## Agent Information – The agent is authorized to represent the applicant in all matters relating to this application.

AGENT/BUSINESS NAME		PHONE NO.	ADDITIONAL CONTACT NO.
ADDRESS		FAX NO.	
CITY	STATE	ZIP	E-MAIL
BY PROVIDING AN E-MAIL ADDRESS, CONSENT IS GIVEN TO RECEIVE ALL CORRESPONDENCE FROM THE DEPARTMENT ELECTRONICALLY. COPIES OF THE FINAL ORDER DOCUMENTS WILL ALSO BE MAILED.			

Explain in your own words what you propose to accomplish with this permit amendment; and why:  
 Add new (additional) well to supply more water for irrigation use. New well will also supply water for domestic use.  
 Current well isn't supplying enough water to meet our irrigation demand and is currently being shared for domestic use.  
 If you need additional space, continue on a separate piece of paper and attach to the application as "Attachment 1".

☐ Check this box if this project is fully or partially funded by the American Recovery and Reinvestment Act. (Federal stimulus dollars)

Is the applicant the permit holder of record? ☒ Yes ☐ No

If NO, include either:

- ☐ A completed assignment form (with required statutory assignment fee), assigning all or a portion of the permit to the applicant(s), OR
- ☐ An affidavit of consent from the permit holder(s) of record that gives permission for the applicant to amend the permit.

Has the Completion ("C") Date of the permit(s) in this application expired? ☐ Yes ☒ No

If YES, this application will not be accepted by the Department.

If NO, what are the completion dates of the permit(s)? April 17, 2023

- If the permit completion date expires while the Permit Amendment Application is pending, the Department will not approve the Permit Amendment Application until an Extension of Time Application is approved for the permit.
- You may consider using the Reimbursement Authority process to expedite the processing of this Permit Amendment Application if the completion date of the permit expires within 6 months of the date of filing this application.

By my signature below, I confirm that I understand:

- Prior to Department approval of the permit amendment, I may be required to submit payment to the Department for publication of a notice in a newspaper with general circulation in the area where the permit is located, once per week for two consecutive weeks. If more than one qualifying newspaper is available, I suggest publishing the notice in the following newspaper: \_\_\_\_\_

I (we) affirm that the information contained in this application is true and accurate.

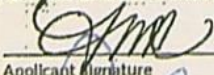
  
 Applicant Signature

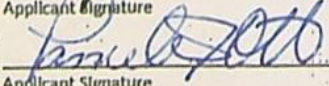
  
 Applicant Signature

Tiffany Rangole  
 Print Name (and Title if applicable)

Pamela J. Ott  
 Print Name (and Title if applicable)

9/1/2021  
 Date

9/1/2021  
 Date

13820

SUPERSEDING



Check one of the following:

- ☐ The applicant is responsible for completion of change(s). Notices and correspondence should continue to be sent to the applicant.
- ☒ The permit holder(s) of record will be responsible for completing the proposed change(s) after the final order is issued. Copies of notices and correspondence should be sent to the permit holder(s) of record.

Check the appropriate box, if applicable:

- ☐ Check here if any of the permits proposed for amendment are or will be located within or served by an irrigation or other water district.

IRRIGATION DISTRICT NAME	ADDRESS	
CITY	STATE	ZIP

- ☐ Check here if water for any of the permits supplied under a water service agreement or other contract for stored water with a federal agency or other entity.

ENTITY NAME	ADDRESS	
CITY	STATE	ZIP



To meet State Land Use Consistency Requirements, you must list all local governments (each county, city, municipal corporation, or tribal government) within whose jurisdiction water will be diverted, conveyed or used.

ENTITY NAME Jackson County	ADDRESS 10 South Oakdale Ave.	
CITY Medford	STATE OR	ZIP 97501

ENTITY NAME	ADDRESS	
CITY	STATE	ZIP

ENTITY NAME	ADDRESS	
CITY	STATE	ZIP

RECEIVED

SEP 09 2021

OWRD



# Part 5 of 5 – Water Use Permit Information

Please use a separate Part 5 for each permit being changed. See instructions on page 6, to copy and paste additional Part 5s, or to add additional rows to tables within the form.

PERMIT # G-18004

RECEIVED

SEP 09 2021

OWRD

**Table 1. Location of Authorized and Proposed Point(s) of Diversion (POD) or Appropriation (POA)**  
(Note: If the POD/POA name is not specified in the permit, assign it a name or number here.)

POD/POA Name or Number	Is this POD/POA Authorized by the permit or is it Proposed?	If POA, OWRD Well Log ID# (or Well ID Tag # L- )	Twp	Rng	Sec	¼ ¼	Tax Lot, DLC or Gov't Lot	Measured Distances (from a recognized survey corner)
APOA	<input type="checkbox"/> Authorized <input checked="" type="checkbox"/> Proposed	#L 143451 JACK 64943	35 S	3 W	5	NE NE	107	520 FEET SOUTH AND 1,300 FEET WEST FROM NE CORNER, SECTION 5
POA	<input checked="" type="checkbox"/> Authorized <input type="checkbox"/> Proposed	JACK 4441	35 S	3 W	5	NW NE	107	90 FEET SOUTH AND 1,565 FEET WEST FROM NE CORNER, SECTION 5
POD	<input checked="" type="checkbox"/> Authorized <input type="checkbox"/> Proposed	LAKE MONTANA	35 S	3 W	5	NE NE	107	45 FEET SOUTH AND 840 FEET WEST FROM NE CORNER, SECTION 5
	<input type="checkbox"/> Authorized <input type="checkbox"/> Proposed							

Check all type(s) of change(s) proposed below (change "CODES" are provided in parentheses):

- |   |  |
|---|--|
| <input type="checkbox"/> Place of Use (POU)                   | <input type="checkbox"/> Point of Appropriation/Well (POA)                   |
| <input type="checkbox"/> Point of Diversion (POD)             | <input checked="" type="checkbox"/> Additional Point of Appropriation (APOA) |
| <input type="checkbox"/> Additional Point of Diversion (APOD) | <input type="checkbox"/> Surface water POD to Ground Water POA (SW/GW)       |

Will all of the proposed changes affect the entire water use permit?

- ☒ Yes Complete only the proposed ("to" lands) section of Table 2 on the next page. Use the "CODES" listed above to describe the proposed changes.
- ☐ No Complete all of Table 2 to describe the portion of the permit to be changed.

For a change in place of use: N/A

Does the permit holder of record own or control the land TO which the place of use is being moved?

☐ Yes ☐ No

If NO, the landowner of the land TO which the place of use is being moved must be assigned to the permit as a permit holder of record by submitting a completed Request for Assignment form and the required statutory fee for an assignment.

Is the proposed place of use contiguous to the authorized place of use? ☐ Yes ☐ No

The permitted place of use can be moved only to lands that are contiguous to the authorized place of use unless the change to non-contiguous lands is in furtherance of mitigation or conservation efforts undertaken for the purposes of benefiting a species listed as sensitive, threatened, or endangered under ORS 496.171 to 496.192 or the federal Endangered Species Act of 1973 (16 U.S.C. 1531 to 1544), as determined by the listing agency. Contiguous land being either adjacent land or land separated from the land to which a permit is authorized by roads, utility corridors, irrigation ditches or publicly owned rights of way.



Please use and attach additional pages of Table 2 as needed.  
See page 6 for instructions.

Do you have questions about how to fill-out the tables?  
Contact the Department at 503-986-0900 and ask for Transfer

**Table 2. Description of Changes to Water Use Permit # G-18004**

List the change proposed for the acreage in each ¼ ¼. If more than one change is proposed, specify the acreage associated with each change.  
If there is more than one POD/POA involved in the proposed changes, specify the acreage associated with each POD/POA.

AUTHORIZED (the "from" or "off" lands) The listing that appears on the certificate BEFORE PROPOSED CHANGES List only that part or portion of the water right that will be changed.										Proposed Changes (see "CODES" from previous page)	PROPOSED (the "to" or "on" lands) The listing as it would appear AFTER PROPOSED CHANGES are made.									
Twp	Rng	Sec	¼ ¼	Tax Lot	Gvt Lot or DLC	Acre (if applicable)	POD(s) or POA(s) (name or number from Table 1)	Priority Date	Twp		Rng	Sec	¼ ¼	Tax Lot	Gvt Lot or DLC	Acre (if applicable)	POD(s) or POA(s) to be used (from Table 1)	Priority Date		
EXAMPLE																				
2	S	9	E 15 NE NW	100		15.0	POD #1 POD #2		POU/POD	2	S	9	E 15 NW NW	100	1	10.0	POD #5			
"	"	"	" " " "	"	"	EXAMPLE	"		"	2	S	9	E 15 SW NW	200		5.0	POD #6			
									APOA	35 S	3 W	5 NE NE	107		4.9	POA #2				
										35 S	3 W	5 NW NE	107		5.1	POA #2				
TOTAL ACRES										TOTAL ACRES						10.0				

RECEIVED  
SEP 09 2021  
OWRD

Additional remarks: proposing to add a well, but rate and acreage will remain the same

13820



Are there other water rights certificates, water use permits or ground water registrations associated with the "from" or "to" lands? ☐ Yes ☐ No

If YES, list the other certificate, permit, or ground water registration numbers: \_\_\_\_\_



If the permit(s) are for irrigation or supplemental irrigation use, other water rights existing on the same land for irrigation that are subject to transfer must either change concurrently or be cancelled. Any change to a water right certificate or ground water registration must be filed separately in a water right transfer application or ground water registration modification application, respectively.

**For a change in point(s) of appropriation (well(s)) or additional point(s) of appropriation:**

- ☒ Well log(s) are attached for each authorized and proposed well(s) that are clearly labeled and associated with the corresponding well(s) in Table 1 above and on the accompanying application map. (Tip: You may search for well logs on the Department's web page at: [http://apps.wrd.state.or.us/apps/gw/well\\_log/Default.aspx](http://apps.wrd.state.or.us/apps/gw/well_log/Default.aspx))

**AND/OR**

- ☒ Describe the construction of the authorized and proposed well(s) in Table 3 for any wells that do not have a well log. For *proposed wells not yet constructed or built*, provide "a best estimate" for each requested information element in the table. The Department recommends you consult a licensed well driller, geologist, or certified water right examiner to assist with assembling the information necessary to complete Table 3.

**Table 3. Construction of Point(s) of Appropriation**

Any well(s) in this listing must be clearly tied to corresponding well(s) described in Table 1 and shown on the accompanying application map. Failure to provide the information will delay the processing of your transfer application until it is received. The information is necessary for the department to assess whether the proposed well(s) will access the same source aquifer as the authorized point(s) of appropriation (POA). The Department is prohibited by law from approving POA changes that do not access the same source aquifer.

Proposed or Authorized POA Name or Number	Is well already built? (Yes or No)	If an existing well, OWRD Well ID Tag No. L-____	Total well depth	Casing Diameter	Casing Intervals (feet)	Seal depth(s) (intervals)	Perforated or screened intervals (in feet)	Static water level of completed well (in feet)	Source aquifer (sand, gravel, basalt, etc.)	Well-specific rate (cfs or gpm). If less than full rate of water right
PROPOSED	YES	143451	320'	6				45	SCHIST	

RECEIVED

SEP 09 2021



# Groundwater Application for Randall and Gina Rice 35S-3W-05-Tax Lot 107

Place of Use:

NW/NE: 5.1 Acres of Nursery

NE/NE: 4.9 Acres of Nursery

NE/NE: 1 Acre Feet of Multi-Purpose Storage

**RECEIVED**

AUG 15 2016

WATER RESOURCES DEPT  
SALEM, OREGON

Reference Corner

**RECEIVED**

SEP 09 2021

**OWRD**

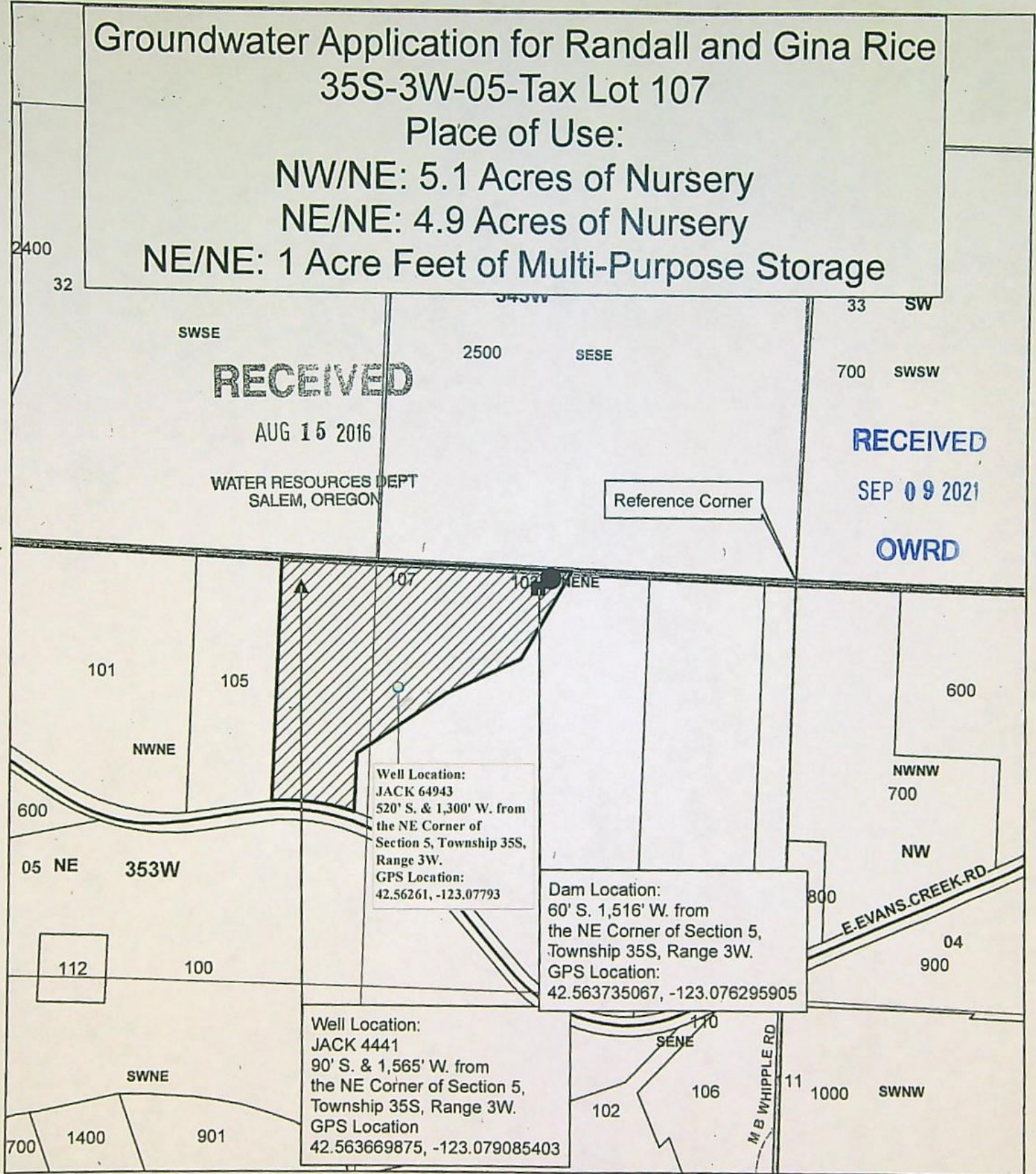

## Legend

- Lake Montana
- Dam Location
- ▲ Well Location
- ▨ Place of Use
- Taxlot 107
- Taxlots
- ▤ Townships
- ▥ Sections
- ▧ Quarter Sections
- ▩ Quarter Quarter Sections
- Additional Well Location

1 inch = 400 feet

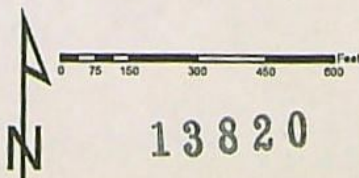

JACKSON COUNTY  
WATERMASTER

Prepared by Travis Kelly

This map is based on a digital database compiled by Jackson County from a variety of sources. Jackson County cannot accept responsibility for errors, omissions, or positional accuracy. There are no warranties, expressed or implied.

Date: 01/15/2016; 35-3W-5-tax lot 107 Groundwater for Rice.mxd; kelly

2-18867



# Land Use Information Form



Oregon Water Resources Department  
725 Summer Street NE, Suite A  
Salem, Oregon 97301-1266  
(503) 986-0900  
[www.oregon.gov/OWRD](http://www.oregon.gov/OWRD)

RECEIVED

SEP 09 2021

OWRD

## NOTE TO APPLICANTS

In order for your application to be processed by the Water Resources Department (WRD), this Land Use Information Form must be completed by a local government planning official in the jurisdiction(s) where your water right will be used and developed. The planning official may choose to complete the form while you wait, or return the receipt stub to you. Applications received by WRD without the Land Use Form or the receipt stub will be returned to you. Please be aware that your application will not be approved without land use approval.

### This form is NOT required if:

- 1) Water is to be diverted, conveyed, and/or used only on federal lands; **OR**
- 2) The application is for a water right transfer, allocation of conserved water, exchange, permit amendment, or ground water registration modification, and all of the following apply:
  - a) The existing and proposed water use is located entirely within lands zoned for exclusive farm-use or within an irrigation district;
  - b) The application involves a change in place of use only;
  - c) The change does not involve the placement or modification of structures, including but not limited to water diversion, impoundment, distribution facilities, water wells and well houses; and
  - d) The application involves irrigation water uses only.

## NOTE TO LOCAL GOVERNMENTS

The person presenting the attached Land Use Information Form is applying for or modifying a water right. The Water Resources Department (WRD) requires its applicants to obtain land-use information to be sure the water rights do not result in land uses that are incompatible with your comprehensive plan. Please complete the form or detach the receipt stub and return it to the applicant for inclusion in their water right application. You will receive notice once the applicant formally submits his or her request to the WRD. The notice will give more information about WRD's water rights process and provide additional comment opportunities. You will have 30 days from the date of the notice to complete the land-use form and return it to the WRD. If no land-use information is received from you within that 30-day period, the WRD may presume the land use associated with the proposed water right is compatible with your comprehensive plan. Your attention to this request for information is greatly appreciated by the Water Resources Department. If you have any questions concerning this form, please contact the WRD's Customer Service Group at 503-986-0801.

13820



# Land Use Information Form

RECEIVED

SEP 09 2021

OWRD



Oregon Water Resources Department  
725 Summer Street NE, Suite A  
Salem, Oregon 97301-1266  
(503) 986-0900  
www.oregon.gov/OWRD

Applicant(s): TIFFANY RANGOLE

Mailing Address: 13933 E EVANS CREEK RD

City: ROGUE RIVER State: OR Zip Code: 97537 Daytime Phone: 650-391-6030

## A. Land and Location

Please include the following information for all tax lots where water will be diverted (taken from its source), conveyed (transported), and/or used or developed. Applicants for municipal use, or irrigation uses within irrigation districts may substitute existing and proposed service-area boundaries for the tax-lot information requested below.

Township	Range	Section	¼ ¼	Tax Lot #	Plan Designation (e.g., Rural Residential/RR-5)	Water to be:			Proposed Land Use:
35S	3W	5	NE NE	107	EFU	<input checked="" type="checkbox"/> Diverted	<input type="checkbox"/> Conveyed	<input type="checkbox"/> Used	Irrigation & Nursery
35S	3W	5	NE NE	107	EFU	<input type="checkbox"/> Diverted	<input type="checkbox"/> Conveyed	<input checked="" type="checkbox"/> Used	Irrigation & Nursery
35S	3W	5	NW NE	107	EFU	<input type="checkbox"/> Diverted	<input type="checkbox"/> Conveyed	<input checked="" type="checkbox"/> Used	Irrigation & Nursery
						<input type="checkbox"/> Diverted	<input type="checkbox"/> Conveyed	<input type="checkbox"/> Used	

List all counties and cities where water is proposed to be diverted, conveyed, and/or used or developed:

Jackson County

## B. Description of Proposed Use

Type of application to be filed with the Water Resources Department:

- ☐ Permit to Use or Store Water   
 ☐ Water Right Transfer   
 ☒ Permit Amendment or Ground Water Registration Modification  
☐ Limited Water Use License   
 ☐ Allocation of Conserved Water   
 ☐ Exchange of Water

Source of water: ☐ Reservoir/Pond    ☒ Ground Water    ☐ Surface Water (name) \_\_\_\_\_

Estimated quantity of water needed: 70 GPM    ☐ cubic feet per second    ☒ gallons per minute    ☐ acre-feet

Intended use of water: ☒ Irrigation    ☐ Commercial    ☐ Industrial    ☒ Domestic for 1 household(s)  
☐ Municipal    ☐ Quasi-Municipal    ☐ Instream    ☒ Other Nursery

Briefly describe:

WATER FOR YEAR-ROUND NURSERY, FARM USE-CROP FIELDS: HAY PRODUCTION, CANNABIS AND POTENTIAL VINEYARD

**Note to applicant:** If the Land Use Information Form cannot be completed while you wait, please have a local government representative sign the receipt at the bottom of the next page and include it with the application filed with the Water Resources Department.

See bottom of Page 3. →



# Land Use Information Form

RECEIVED

SEP 09 2021

OWRD



Oregon Water Resources Department  
725 Summer Street NE, Suite A  
Salem, Oregon 97301-1266  
(503) 986-0900  
www.oregon.gov/OWRD

Applicant(s): TIFFANY RANGOLE

Mailing Address: 13933 E EVANS CREEK RD

City: ROGUE RIVER State: OR Zip Code: 97537 Daytime Phone: 650-391-6030

## A. Land and Location

Please include the following information for all tax lots where water will be diverted (taken from its source), conveyed (transported), and/or used or developed. Applicants for municipal use, or irrigation uses within irrigation districts may substitute existing and proposed service-area boundaries for the tax-lot information requested below.

Township	Range	Section	¼ ¼	Tax Lot #	Plan Designation (e.g., Rural Residential/RR-5)	Water to be:			Proposed Land Use:
35S	3W	5	NE NE	107	EFU	<input checked="" type="checkbox"/> Diverted	<input type="checkbox"/> Conveyed	<input type="checkbox"/> Used	Irrigation & Nursery
35S	3W	5	NE NE	107	EFU	<input type="checkbox"/> Diverted	<input type="checkbox"/> Conveyed	<input checked="" type="checkbox"/> Used	Irrigation & Nursery
35S	3W	5	NW NE	107	EFU	<input type="checkbox"/> Diverted	<input type="checkbox"/> Conveyed	<input checked="" type="checkbox"/> Used	Irrigation & Nursery
						<input type="checkbox"/> Diverted	<input type="checkbox"/> Conveyed	<input type="checkbox"/> Used	

List all counties and cities where water is proposed to be diverted, conveyed, and/or used or developed:

Jackson County

## B. Description of Proposed Use

Type of application to be filed with the Water Resources Department:

- ☐ Permit to Use or Store Water    ☐ Water Right Transfer    ☒ Permit Amendment or Ground Water Registration Modification  
☐ Limited Water Use License    ☐ Allocation of Conserved Water    ☐ Exchange of Water

Source of water: ☐ Reservoir/Pond    ☒ Ground Water    ☐ Surface Water (name) \_\_\_\_\_

Estimated quantity of water needed: 70 GPM    ☐ cubic feet per second    ☒ gallons per minute    ☐ acre-feet

Intended use of water: ☒ Irrigation    ☐ Commercial    ☐ Industrial    ☒ Domestic for 1 household(s)  
☐ Municipal    ☐ Quasi-Municipal    ☐ Instream    ☒ Other Nursery

Briefly describe:

WATER FOR YEAR-ROUND NURSERY, FARM USE-CROP FIELDS: HAY PRODUCTION, CANNABIS AND POTENTIAL VINEYARD

Received by OWRD

**SUPERSEDING**

MAR 28 2022

Salem, OR



RECEIVED

SEP 09 2021

## For Local Government Use Only

OWRD

The following section must be completed by a planning official from each county and city listed unless the project will be located entirely within the city limits. In that case, only the city planning agency must complete this form. This deals only with the local land-use plan. Do not include approval for activities such as building or grading permits.

## Please check the appropriate box below and provide the requested information

- ☐ Land uses to be served by the proposed water uses (including proposed construction) are allowed outright or are not regulated by your comprehensive plan. Cite applicable ordinance section(s):
- ☒ Land uses to be served by the proposed water uses (including proposed construction) involve ~~discretionary~~ land-use approvals as listed in the table below. (Please attach documentation of applicable land-use approvals which have already been obtained. Record of Action/land-use decision and accompanying findings are sufficient.) If approvals have been obtained but all appeal periods have not ended, check "Being pursued."

Type of Land-Use Approval Needed (e.g., plan amendments, rezones, conditional-use permits, etc.)	Cite Most Significant, Applicable Plan Policies & Ordinance Section References	Land-Use Approval:	
439.17.02562.20m 439.19.01145.2m	UDO 4.2-1; 13.3	<input checked="" type="checkbox"/> Obtained <input type="checkbox"/> Denied	<input type="checkbox"/> Being Pursued <input type="checkbox"/> Not Being Pursued
		<input type="checkbox"/> Obtained <input type="checkbox"/> Denied	<input type="checkbox"/> Being Pursued <input type="checkbox"/> Not Being Pursued
		<input type="checkbox"/> Obtained <input type="checkbox"/> Denied	<input type="checkbox"/> Being Pursued <input type="checkbox"/> Not Being Pursued
		<input type="checkbox"/> Obtained <input type="checkbox"/> Denied	<input type="checkbox"/> Being Pursued <input type="checkbox"/> Not Being Pursued
		<input type="checkbox"/> Obtained <input type="checkbox"/> Denied	<input type="checkbox"/> Being Pursued <input type="checkbox"/> Not Being Pursued

Local governments are invited to express special land-use concerns or make recommendations to the Water Resources Department regarding this proposed use of water below, or on a separate sheet.

See attached

Name: Francisco M. Hernandez Title: Planner III  
 Signature: Francisco M. Hernandez Phone: 541-774-6903 Date: 03.28.2022  
 Government Entity: \_\_\_\_\_

SUPERSEDING

Received by OWRD

MAR 28 2022

Salem, OR



## For Local Government Use Only

OWRD

The following section must be completed by a planning official from each county and city listed unless the project will be located entirely within the city limits. In that case, only the city planning agency must complete this form. This deals only with the local land-use plan. Do not include approval for activities such as building or grading permits.

**Please check the appropriate box below and provide the requested information**

- ☐ Land uses to be served by the proposed water uses (including proposed construction) are allowed outright or are not regulated by your comprehensive plan. Cite applicable ordinance section(s):
- ☐ Land uses to be served by the proposed water uses (including proposed construction) involve discretionary land-use approvals as listed in the table below. (Please attach documentation of applicable land-use approvals which have already been obtained. Record of Action/land-use decision and accompanying findings are sufficient.) **If approvals have been obtained but all appeal periods have not ended, check "Being pursued."**

Type of Land-Use Approval Needed (e.g., plan amendments, rezones, conditional-use permits, etc.)	Cite Most Significant, Applicable Plan Policies & Ordinance Section References	Land-Use Approval:	
		<input type="checkbox"/> Obtained <input type="checkbox"/> Denied	<input type="checkbox"/> Being Pursued <input type="checkbox"/> Not Being Pursued
		<input type="checkbox"/> Obtained <input type="checkbox"/> Denied	<input type="checkbox"/> Being Pursued <input type="checkbox"/> Not Being Pursued
		<input type="checkbox"/> Obtained <input type="checkbox"/> Denied	<input type="checkbox"/> Being Pursued <input type="checkbox"/> Not Being Pursued
		<input type="checkbox"/> Obtained <input type="checkbox"/> Denied	<input type="checkbox"/> Being Pursued <input type="checkbox"/> Not Being Pursued
		<input type="checkbox"/> Obtained <input type="checkbox"/> Denied	<input type="checkbox"/> Being Pursued <input type="checkbox"/> Not Being Pursued

Local governments are invited to express special land-use concerns or make recommendations to the Water Resources Department regarding this proposed use of water below, or on a separate sheet.

**SUPERSEDED**

Name: \_\_\_\_\_ Title: \_\_\_\_\_

Signature: \_\_\_\_\_ Phone: \_\_\_\_\_ Date: \_\_\_\_\_

Government Entity: \_\_\_\_\_

**Note to local government representative:** Please complete this form or sign the receipt below and return it to the applicant. If you sign the receipt, you will have 30 days from the Water Resources Department's notice date to return the completed Land Use Information Form or WRD may presume the land use associated with the proposed use of water is compatible with local comprehensive plans.

**Receipt for Request for Land Use Information**



Applicant name: TIFFANY RANGOLE

City or County: Jackson County Staff contact: \_\_\_\_\_

Signature: \_\_\_\_\_ Phone: \_\_\_\_\_ Date: \_\_\_\_\_





# JACKSON COUNTY ZONING INFORMATION SHEET

DEVELOPMENT SERVICES  
Planning Division  
10 South Oakdale Ave., Room 100  
Medford, OR 97501-2902  
Phone: 541-774-6907

ZONING: Exclusive Farm Use  
ADDRESS: 13933 EAST EVANS CR RD  
PRIMARY PARCEL #: 35-3W-05-107  
ASSOCIATED LOTS:

RECORD #: 439-22-00650-ZON  
PRINT DATE: 03/28/2022  
LAST UPDATED: 03/28/2022

## Owners

RANGOLE TIFFANY M ET AL  
241 CASTILLON WAY  
SAN JOSE, CA 95119-1506

## Record Detail Description

LUC Water Rights-Additional Well

## Primary Contact

RANGOLE TIFFANY M ET AL  
241 CASTILLON WAY  
SAN JOSE, CA 95119-1506

## Contact Type

Applicant

## GENERAL ZIS INFORMATION:

<u>STAFF</u>	<u>DATE</u>	<u>COMMENTS</u>
--------------	-------------	-----------------

WILLIASM	03/25/2022	03/25/2022: LUCS for water rights submitted for year round nursery, farm use-crop fields, hay production cannabis an potential vineyard. Appl requests LUCS be emailed. SW
----------	------------	--

03/28/2022: For the purposes of the Oregon Water Resources LUCS, nursery use is as defined in OAR 690-300-010, not as stated in the Jackson County Land Development Ordinance.

Farm crop (cannabis) production as a type 1 permitted use has been reviewed and approved under land use permits 439-17-02562-ZON (marijuana) and 439-19-01145-ZON (hemp).

This LUCS is not a land use authorization allowing you to conduct your hemp and/or marijuana (cannabis) use on your property.

This LUCS is a communication mechanism between state agencies such as the Oregon Water Resources Department (OWRD) Oregon Liquor and Cannabis Commission (OLCC), the Oregon Department of Agriculture (ODA) and the Oregon Water Resources Department (OWRD) and Jackson County stating that your cannabis use is not prohibited, is prohibited or may be permitted via a Conditional Use Permit. FH

## OVERLAY DETAILS:

Applicable Overlay

Comments

Received by OWRD

## STRUCTURE / SIZE DETAILS:

Item

Units

Proposed Size

Approved Size

Comments

MAR 28 2022

Salem, OR

THIS DOCUMENT IS FOR INFORMATION PURPOSES ONLY!  
THIS IS NOT A LAND USE PERMIT







RECEIVED

WATER SUPPLY WELL REPORT - Map with location identified must be attached and shall include an approximate scale and north arrow

JACK 64943

SEP 09 2021

8/9/2021

OWRD

Map of Hole

STATE OF OREGON  
WELL LOCATION MAP

This map is supplemental to the WATER SUPPLY WELL REPORT

Oregon Water Resources Department

725 Summer St NE, Salem OR 97301  
(503)996-0900



LOCATION OF WELL

Latitude: 42.56261000 Datum: WGS84

Longitude: -123.07793000

Township/Range/Section/Quarter-Quarter Section:

WM35.00S3.00W5NENE

Address of Well:

13933 E EVANS CRK RD., ROGUE RIVER, OR 97537

Well Label: 143451

Printed: August 9, 2021

DISCLAIMER: This map is intended to represent the approximate location the well. It is not intended to be construed as survey accurate in any manner.

Provided by well constructor





# Permit Amendment Application Checklist

Checked by Corcy

Date 9/15/21

App # 6-18367

Permit # 6-18004

## Permit Amendments are authorized for changes in POD/POA, APOD/APOA, or POU.

(If OK, check box to left; if not, fill in the blank)

- ☒ 1. Is the name of the Permit Amendment applicant the same as the Water Right Permit holder(s) of record?

If not, one of the following must be included with the application:

- \_\_\_ a) An affidavit of consent from all Permit holder(s) or the other Permit holders that have not signed the Permit Amendment application form, consenting to the proposed Permit Amendment application; OR,  
\_\_\_ b) A completed Request for Assignment form (and statutory fee) to move all (or portion) of the permit into the Permit Amendment applicant's name.

If not, what is missing? \_\_\_\_\_

- ☐ 2. Page 1 of application: Are all attachments that have been checked actually included?

If not, what is missing? Land Use not signed by County

- ☒ 3. Are fees included and correct? Fee Paid: \$1,840.00

If not, the correct fee would be: \_\_\_\_\_, so the amount missing is: \_\_\_\_\_

- ☒ 4. Part 4 of application: Have all the applicants listed at the top of the page signed at the bottom?

If not, whose signature is missing? Pamela Ott

- ☒ 5. Are the Permit completion date(s) current?

If the Permit completion date has expired, we **CANNOT** accept the application.

- ☒ 6. If all #1-#5 boxes on this checklist are checked (with no remaining deficiencies identified), accept the application. Put this check sheet in the transfer folder.

If #1, #2, #3, #4 or #5 on this checklist is deficient, the application **CANNOT** be accepted.

It should be returned and the deficiencies listed in the "staff" section at the bottom of Application Page 1, unless the applicant or agent can resolve the deficiencies within 2-3 days.



RECEIVED

Part 4 of 5 – Applicant Information and Signature

Applicant Information

SEP 09 2021

APPLICANT/BUSINESS NAME Tiffany Rangole		PHONE NO. 650-391-6030	ADDITIONAL CONTACT NO. 541-582-0521
ADDRESS 13933 E EAST EVANS CREEK RD		FAX NO.	
CITY ROGUE RIVER	STATE OR	ZIP 97537	E-MAIL truecarefarms@gmail.com
BY PROVIDING AN E-MAIL ADDRESS, CONSENT IS GIVEN TO RECEIVE ALL CORRESPONDENCE FROM THE DEPARTMENT ELECTRONICALLY. COPIES OF THE FINAL ORDER DOCUMENTS WILL ALSO BE MAILED.			

Agent Information – The agent is authorized to represent the applicant in all matters relating to this application.

AGENT/BUSINESS NAME		PHONE NO.	ADDITIONAL CONTACT NO.
ADDRESS		FAX NO.	
CITY	STATE	ZIP	E-MAIL
BY PROVIDING AN E-MAIL ADDRESS, CONSENT IS GIVEN TO RECEIVE ALL CORRESPONDENCE FROM THE DEPARTMENT ELECTRONICALLY. COPIES OF THE FINAL ORDER DOCUMENTS WILL ALSO BE MAILED.			

Explain in your own words what you propose to accomplish with this permit amendment; and why:  
Add new (additional) well to supply more water for irrigation use. New well will also supply water for domestic use. Current well isn't supplying enough water to meet our irrigation demand and is currently being shared for domestic use. If you need additional space, continue on a separate piece of paper and attach to the application as "Attachment 1".

☐ Check this box if this project is fully or partially funded by the American Recovery and Reinvestment Act. (Federal stimulus dollars)

Is the applicant the permit holder of record? ☒ Yes ☐ No

If NO, include either:

- ☐ A completed assignment form (with required statutory assignment fee), assigning all or a portion of the permit to the applicant(s), OR
- ☐ An affidavit of consent from the permit holder(s) of record that gives permission for the applicant to amend the permit.

Has the Completion ("C") Date of the permit(s) in this application expired? ☐ Yes ☒ No

If YES, this application will not be accepted by the Department.

If NO, what are the completion dates of the permit(s)? April 17, 2023

- If the permit completion date expires while the Permit Amendment Application is pending, the Department will not approve the Permit Amendment Application until an Extension of Time Application is approved for the permit.
- You may consider using the Reimbursement Authority process to expedite the processing of this Permit Amendment Application if the completion date of the permit expires within 6 months of the date of filing this application.

By my signature below, I confirm that I understand:

- Prior to Department approval of the permit amendment, I may be required to submit payment to the Department for publication of a notice in a newspaper with general circulation in the area where the permit is located, once per week for two consecutive weeks. If more than one qualifying newspaper is available, I suggest publishing the notice in the following newspaper: \_\_\_\_\_

I (we) affirm that the information contained in this application is true and accurate.

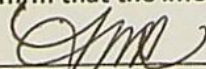
  
Applicant Signature

Tiffany Rangole  
Print Name (and Title if applicable)

9/1/2021  
Date

Applicant Signature

Print Name (and Title if applicable)

Date

SUPERSEDED

13820



RECEIVED

JAN 31 2022

RECEIVED

## Part 4 of 5 – Applicant Information and Signature

OWRD

## Applicant Information

SEP 09 2021

APPLICANT/BUSINESS NAME Tiffany Rangole		PHONE NO. 650-391-6030	ADDITIONAL CONTACT NO. 541-582-0521
ADDRESS 13933 E EAST EVANS CREEK RD.		FAX NO.	
CITY ROGUE RIVER	STATE OR	ZIP 97537	E-MAIL truecarefarms@gmail.com
BY PROVIDING AN E-MAIL ADDRESS, CONSENT IS GIVEN TO RECEIVE ALL CORRESPONDENCE FROM THE DEPARTMENT ELECTRONICALLY. COPIES OF THE FINAL ORDER DOCUMENTS WILL ALSO BE MAILED.			

Agent Information – The agent is authorized to represent the applicant in all matters relating to this application.

AGENT/BUSINESS NAME		PHONE NO.	ADDITIONAL CONTACT NO.
ADDRESS		FAX NO.	
CITY	STATE	ZIP	E-MAIL
BY PROVIDING AN E-MAIL ADDRESS, CONSENT IS GIVEN TO RECEIVE ALL CORRESPONDENCE FROM THE DEPARTMENT ELECTRONICALLY. COPIES OF THE FINAL ORDER DOCUMENTS WILL ALSO BE MAILED.			

Explain in your own words what you propose to accomplish with this permit amendment; and why:  
 Add new (additional) well to supply more water for irrigation use. New well will also supply water for domestic use.  
 Current well isn't supplying enough water to meet our irrigation demand and is currently being shared for domestic use.  
 If you need additional space, continue on a separate piece of paper and attach to the application as "Attachment 1".

☐ Check this box if this project is fully or partially funded by the American Recovery and Reinvestment Act. (Federal stimulus dollars)

Is the applicant the permit holder of record? ☒ Yes ☐ No

If NO, include either:

- ☐ A completed assignment form (with required statutory assignment fee), assigning all or a portion of the permit to the applicant(s); OR
- ☐ An affidavit of consent from the permit holder(s) of record that gives permission for the applicant to amend the permit.

Has the Completion ("C") Date of the permit(s) in this application expired? ☐ Yes ☒ No

If YES, this application will not be accepted by the Department.

If NO, what are the completion dates of the permit(s)? April 17, 2023

- If the permit completion date expires while the Permit Amendment Application is pending, the Department will not approve the Permit Amendment Application until an Extension of Time Application is approved for the permit.
- You may consider using the Reimbursement Authority process to expedite the processing of this Permit Amendment Application if the completion date of the permit expires within 6 months of the date of filing this application.

By my signature below, I confirm that I understand:

- Prior to Department approval of the permit amendment, I may be required to submit payment to the Department for publication of a notice in a newspaper with general circulation in the area where the permit is located, once per week for two consecutive weeks. If more than one qualifying newspaper is available, I suggest publishing the notice in the following newspaper: \_\_\_\_\_

I (we) affirm that the information contained in this application is true and accurate.

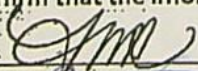
  
 Applicant Signature

Tiffany Rangole  
 Print Name (and Title if applicable)

9/1/2021

Date

  
 Applicant Signature

Pamela J. OTT  
 Print Name (and Title if applicable)

1/25/2022  
 Date

13820