

**Application for Water Right
Temporary or Drought Temporary Transfer
Part 1 of 5 – Minimum Requirements Checklist**



Oregon Water Resources Department
725 Summer Street NE, Suite A
Salem, Oregon 97301-1266
(503) 986-0900
www.oregon.gov/OWRD

This temporary transfer application will be returned if Parts 1 through 5 and all required attachments are not completed and included.
For questions, please call (503) 986-0900, and ask for Transfer Section.

FOR ALL TEMPORARY TRANSFER APPLICATIONS

Received
MAR 21 2025
OWRD

Check all items included with this application. (N/A = Not Applicable)

- Part 1 – Completed Minimum Requirements Checklist.
 - Part 2 – Completed Temporary Transfer Application Map Checklist.
 - Part 3 – Application Fee, payable by check to the Oregon Water Resources Department, and completed Fee Worksheet, page 3. Try the online fee calculator at: http://apps.wrd.state.or.us/apps/misc/wrd_fee_calculator.
 - Part 4 – Completed Applicant Information and Signature.
 - Part 5 – Information about Transferred Water Rights: **How many water rights are to be transferred? 1 List them here: 97540**
- Please include a separate Part 5 for each water right. (See instructions on page 6)
- N/A For standard Temporary Transfer (one to five years) **Begin Year: 2025 End Year: 2026.**
 - N/A Temporary Drought Transfer (Only in counties where the Governor has declared drought)

Attachments:

- Completed Temporary Transfer Application Map.
- Completed Evidence of Use Affidavit and supporting documentation.
- Current recorded deed for the land **from** which the authorized place of use is temporarily being moved.
- N/A Affidavit(s) of Consent from Landowner(s) (if the applicant does not own the land upon which the water right is located.)
- N/A Supplemental Form D – For water rights served by or issued in the name of a district. Complete when the temporary transfer applicant is not the district.
- N/A Oregon Water Resources Department’s Land Use Information Form with approval and signature from each local land use authority in which water is to be diverted, conveyed, and/or used. Not required if water is to be diverted, conveyed, and/or used only on federal lands or if **all** of the following apply: a) a change in place of use only, b) no structural changes, c) the use of water is for irrigation only, and d) the use is located within an irrigation district or an exclusive farm use zone.
- N/A Water Well Report/Well Log for changes in point(s) of appropriation (well(s)) or additional point(s) of appropriation (if necessary to convey water to the proposed place of use).

(For Staff Use Only)
WE ARE RETURNING YOUR APPLICATION FOR THE FOLLOWING REASON(S):

<input type="checkbox"/> Application fee not enclosed/insufficient	<input type="checkbox"/> Map not included or incomplete
<input type="checkbox"/> Land Use Form not enclosed or incomplete	<input type="checkbox"/> Part _____ is incomplete
<input type="checkbox"/> Additional signature(s) required	

Other/Explanation _____

Staff: _____ Phone: _____ Date: ____/____/____

Part 2 of 5 – Temporary Transfer Application Map Checklist

Your temporary transfer application will be returned if any of the map requirements listed below are not met.

Please be sure that the temporary transfer application map you submit includes all the required items and matches the existing water right map. Check all boxes that apply.

- N/A If **more than three** water rights are involved, separate maps are needed for each water right.
- Permanent quality printed with dark ink on good quality paper.
- The size of the map can be 8½ x 11 inches, 8½ x 14 inches, 11 x 17 inches, or up to 30 x 30 inches. For 30 x 30 inch maps, one extra copy is required.
- A north arrow, a legend, and scale.
- The scale of the map must be: 1 inch = 400 feet, 1 inch = 1,320 feet; the scale of the Final Proof/Claim of Beneficial Use Map (the map used when the permit was certificated); the scale of the county assessor map if the scale is not smaller than 1 inch = 1,320 feet; or a scale that has been pre-approved by the Department.
- Township, Range, Section, ¼ ¼, DLC, Government Lot, and other recognized public land survey lines.
- Tax lot boundaries (property lines) are required. Tax lot numbers are recommended.
- Major physical features including rivers and creeks showing direction of flow, lakes and reservoirs, roads, and railroads.
- Major water delivery system features from the point(s) of diversion/appropriation such as main pipelines, canals, and ditches.
- Existing place of use that includes separate hachuring for each water right, priority date, and use including number of acres in each quarter-quarter section, government lot, or in each quarter-quarter section as projected within government lots, donation land claims, or other recognized public land survey subdivisions. If less than the entirety of the water right is being changed, a separate hachuring is needed for lands left unchanged.
- N/A Proposed temporary place of use that includes separate hachuring for each water right, priority date, and use including number of acres in each quarter-quarter section, government lot, or in each quarter-quarter section as projected within government lots, donation land claims, or other recognized public land survey subdivisions.
- Existing point(s) of diversion or well(s) with distance and bearing or coordinates from a recognized survey corner. This information can be found in your water right certificate or permit.
- N/A If you are proposing a change in point(s) of diversion or well(s) to convey water to the new temporary place of use, show the proposed location and label it clearly with distance and bearing or coordinates. If GPS coordinates are used, latitude-longitude coordinates may be expressed as either degrees-minutes-seconds with at least one digit after the decimal (example – 42°32'15.5") or degrees-decimal with five or more digits after the decimal (example – 42.53764°).

14630 - Received
MAR 21 2025

Part 3 of 5 – Fee Worksheet

FEE WORKSHEET for TEMPORARY (not drought) TRANSFERS			
1	Base Fee (includes temporary change to one water right for up to 1 cfs)	1	\$950.00
2	Number of water rights included in transfer: <u>1</u> (2a) Subtract 1 from the number in 3a above: <u>0</u> (2b) <i>If only one water right this will be 0</i> Multiply line 2b by \$310.00 and enter » » » » » » » » » » » » » » » »	2	
3	Do you propose to change the place of use for a non-irrigation use? <input checked="" type="checkbox"/> No: enter 0 on line 3 » » » » » » » » » » » » » » » » <input type="checkbox"/> Yes: enter the cfs for the portions of the rights to be transferred: _____ (3a) Subtract 1.0 from the number in 3a above: _____ (3b) If 3b is 0, enter 0 on line 3 » » » » » » » » » » » » » » » » If 3b is greater than 0, round up to the nearest whole number: _____ (3c) and multiply 4c by \$210.00, then enter on line 3	3	0
4	Do you propose to change the place of use for an irrigation use? <input type="checkbox"/> No: enter 0 on line 4 » » » » » » » » » » » » » » » » <input checked="" type="checkbox"/> Yes: enter the number of acres in the footprint of the place of use for the portions of the rights to be transferred: <u>123.9</u> (4a) Multiply the number of acres in 4a above by \$2.70 and enter on line 4 » »	4	334.53
5	Add entries on lines 1 through 4 above » » » » » » » » » » » » Subtotal:	5	1,284.53
6	Is this transfer: <input type="checkbox"/> necessary to complete a project funded by the Oregon Watershed Enhancement Board (OWEB) under ORS 541.932? <input type="checkbox"/> endorsed in writing by ODFW as a change that will result in a net benefit to fish and wildlife habitat? If one or more boxes is checked, multiply line 5 by 0.5 and enter on line 6 » If no box is applicable, enter 0 on line 7 » » » » » » » » » » » » » » » »	6	
7	Subtract line 6 from line 5 » » » » » » » » » » » » » » » » Transfer Fee:	7	\$1,284.53

FEE WORKSHEET for TEMPORARY DROUGHT TRANSFERS			
1	Base Fee (includes drought application and recording fee for up to 1 cfs)	1	\$200.00
2	Enter the cfs for the portions of the rights to be transferred (see example below*): _____ (2a) Subtract 1.0 from the number in 2a above: _____ (2b) If 2b is 0, enter 0 on line 2 » » » » » » » » » » » » » » » » If 2b is greater than 0, round up to the nearest whole number: _____ (2c) and multiply 2c by \$50, then enter on line 2 » » » » » » » » » » » »	2	
3	Add entries on lines 1 through 2 above » » » » » » » » » » » » Transfer Fee:	3	

*Example for Line 2a calculation to transfer 45.0 acres of Primary Certificate 12345 (total 1.25 cfs for 100 acres) and 45.0 acres of Supplemental Certificate 87654 (1/80 cfs per acre) on the same land:

1. Divide total authorized cfs by total acres in the water right (for C12345, $1.25 \text{ cfs} \div 100 \text{ ac}$); then multiply by the number of acres to be transferred to get the transfer cfs ($\times 45 \text{ ac} = 0.56 \text{ cfs}$).
2. If the water right certificate does not list total cfs, but identifies the allowable use as 1/40 or 1/80 of a cfs per acre; multiply number of acres proposed for change by either 0.025 (1/40) or 0.0125 (1/80). (For C87654, $45.0 \text{ ac} \times 0.0125 \text{ cfs/ac} = 0.56 \text{ cfs}$)
3. Add cfs for the portions of water rights on all the land included in the transfer; however **do not count cfs for supplemental rights on acreage for which you have already calculated the cfs fee for the primary right on the same land**. The fee should be assessed only once for each "on the ground" acre included in the transfer. (In this example, blank 2a would be only 0.56 cfs, since both rights serve the same 45.0 acres. Blank 2b would be 0 and Line 2 would then also become 0).

14630 -

Received
MAR 21 2025
OWRD

Part 4 of 5 – Applicant Information and Signature

Applicant Information

APPLICANT/BUSINESS NAME Eagle Ranch C/O Arthur Prior			PHONE NO. 541-561-4769	ADDITIONAL CONTACT NO.
ADDRESS 1333 Columbia Park Trail				FAX NO.
CITY Richland	STATE WA	ZIP 99350	E-MAIL arthur@eoni.com	
BY PROVIDING AN E-MAIL ADDRESS, CONSENT IS GIVEN TO RECEIVE ALL CORRESPONDENCE FROM THE DEPARTMENT ELECTRONICALLY. COPIES OF THE FINAL ORDER DOCUMENTS WILL ALSO BE MAILED.				

Agent Information – The agent is authorized to represent the applicant in all matters relating to this application.

AGENT/BUSINESS NAME William Porfily			PHONE NO. 541-561-7259	ADDITIONAL CONTACT NO.
ADDRESS P.O. Box 643				FAX NO.
CITY Stanfield	STATE OR	ZIP 97875	E-MAIL wporfily@gmail.com	
BY PROVIDING AN E-MAIL ADDRESS, CONSENT IS GIVEN TO RECEIVE ALL CORRESPONDENCE FROM THE DEPARTMENT ELECTRONICALLY. COPIES OF THE FINAL ORDER DOCUMENTS WILL ALSO BE MAILED.				

Explain in your own words what you propose to accomplish with this transfer application and why:
We plan to move the water rights off a crop that is growing fallow this year to a crop that will need the water.

If you need additional space, continue on a separate piece of paper and attach to the application as "Attachment 1".

I (we) affirm that the information contained in this application is true and accurate.

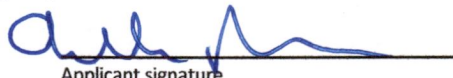
	Arthur Prior - owner	3-14-2025
Applicant signature	Print Name (and Title if applicable)	Date
_____	_____	_____
Applicant signature	Print Name (and Title if applicable)	Date

Is the applicant the sole owner of the land on which the water right, or portion thereof, proposed for transfer is located? Yes No

If NO, include signatures of all landowners (and mailing and/or e-mail addresses if different than the applicant's) or attach affidavits of consent from all landowners or individuals/entities (and mailing and/or e-mail addresses) to which the water right(s) has been conveyed.

Received
MAR 21 2025
OWRD

Check here if any of the water rights proposed for transfer are or will be located within or served by an irrigation or other water district. (NOTE: If this box is checked, you must complete and attach Supplemental Form D.)

DISTRICT NAME Westland Irrigation District	ADDRESS 77096 OR-207	
CITY Echo	STATE OR	ZIP 97826

Check here if water for any of the rights supplied under a water service agreement or other contract for stored water with a federal agency or other entity.

ENTITY NAME	ADDRESS	
CITY	STATE	ZIP

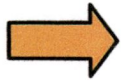

To meet State Land Use Consistency Requirements, you must list all local governments (each county, city, municipal corporation, or tribal government) within whose jurisdiction water will be diverted, conveyed and/or used.

ENTITY NAME Umatilla County	ADDRESS 216 E 4 th ST	
CITY Pendleton	STATE OR	ZIP 97801

ENTITY NAME	ADDRESS	
CITY	STATE	ZIP

Received
MAR 21 2025

INSTRUCTIONS for editing the Application Form

To add lines to tables within the forms or to copy and paste additional Part 5 pages, please **save the application form to your computer**. Unlock the document by using one of the following instructions for your Microsoft Word software version:

Microsoft Word 2003

Unlock the document by one of the following:

- Using the **Tools** menu => click **Unprotect Document**;
- OR**

- Using the **Forms** toolbar => click on the **Protect/Unprotect** icon.

To relock the document to enable the checkboxes to work, you will need to:

- Using the **Tools** menu => click **Protect Document**;
- OR**

- Using the **Forms** toolbar => click on the **Protect/Unprotect** icon.

Microsoft Word 2007

- Unlock the document by clicking the **Review** tab, then click **Protect Document**, then click **Stop Protect**
- To relock the document, click **Editing Restrictions**, then click **Allow Only This Type of Editing**, select **Filling In Forms** from the drop-down menu, then check **Yes, Start Enforcing Protection**.

Microsoft Word 2010

- Unlock the document by clicking the **Review** tab; toggle the **Restrict Editing icon** at the upper right, then click **Stop Protect** at the bottom right. Then uncheck the "**Allow only this type of editing** in the document: **Filling in forms**" in the "Editing restrictions" section on the right-hand list of options.
- To relock the document, check the **Editing Restrictions/Allow Only This Type of Editing/Filling In Forms** box from the drop-down menu, then check **Yes, Start Enforcing Protection**. You do not need to assign a password for the editing restrictions.

Other Alternatives:

- Photocopy pages or tables in Part 5, ~~mark through~~ any non-applicable information, insert/attach photocopied pages to document in the appropriate location, and manually amend page numbers as necessary (e.g. Page ~~5~~ 6 of ~~9~~ 10).
- You may refer to additional attachments that you may include, such as separately produced tables or spreadsheets to convey large numbers of rows of place of use listings, owner/property parcels, etc. You may contact the Department at 503-986-0900 and ask for Transfer Staff if you have questions

Once the application has been unlocked, you may:

- add rows to tables using the Table tools, and
- select and copy the pages of Part 5 and paste as many additional sets of Part 5 pages as needed at the end of the application.

After editing, re-lock the document to enable checkboxes to work.

1 4 6 3 0 -

Part 5 of 5 – Water Right Information

Please use a separate Part 5 for each water right being changed. See instructions on page 6, to copy and paste additional Part 5s, or to add rows to tables within the form.

Water Right Certificate # 97540

Description of Water Delivery System

System capacity: 3.34 cubic feet per second (cfs) **OR**
 _____ gallons per minute (gpm)

Describe the current water delivery system or the system that was in place at some time within the last five years. Include information on the pumps, canals, pipelines, and sprinklers used to divert, convey, and apply the water at the authorized place of use. [Please See Attached Delivery Map](#)

Table 1. Location of Authorized and Proposed Point(s) of Diversion (POD) or Appropriation (POA)
 (Note: If the POD/POA name is not specified on the certificate, assign it a name or number here.)

POD/POA Name or Number	Is this POD/POA Authorized on the Certificate or is it Proposed?	If POA, OWRD Well Log ID# (or Well ID Tag # L-_____)	Twp		Rng		Sec	¼ ¼		Tax Lot, DLCor Gov't Lot	Measured Distances (from a recognized survey corner)
UMAT 468	<input checked="" type="checkbox"/> Authorized <input type="checkbox"/> Proposed	WELL 4	2	N	28	E	1	SE	NW	200	2640 FT S & 630 FT WEST FROM THE N ¼ COR OF SEC 1
UMAT 1285	<input checked="" type="checkbox"/> Authorized <input type="checkbox"/> Proposed	WELL 8	2	N	28	E	2	NE	SE	500	2800 FT S & 500 FT WEST FROM THE NE COR OF SEC 2

Check all type(s) of temporary change(s) proposed below (change "CODES" are provided in parentheses):

- Place of Use (POU) Appropriation/Well (POA)
- Point of Diversion (POD) Additional Point of Appropriation (APOA)
- Additional Point of Diversion (APOD)

Check all type(s) of temporary change(s) due to drought proposed below (change "CODES" are provided in parentheses): N/A

- Place of Use (POU) Point of Appropriation/Well (POA)
- Character of Use (USE) Additional Point of Appropriation (APOA)
- Point of Diversion (POD) Additional Point of Diversion (APOD)

Will all of the proposed changes affect the entire water right?

- Yes Complete only the Proposed ("to" lands) section of Table 2 on the next page. Use the "CODES" listed above to describe the proposed changes.
- No Complete all of Table 2 to describe the portion of the water right to be changed.

14630 - = **Received**

MAR 21 2025

OWRD

Please use and attach additional pages of Table 2 as needed.
See page 6 for instructions.

Do you have questions about how to fill-out the tables?
Contact the Department at 503-986-0900 and ask for Transfer Staff.

Table 2. Description of Temporary Changes to Water Right Certificate # 97540

List only the part of the right that will be changed. For the acreage in each ¼ ¼, list the change proposed. If more than one change, specify the acreage associated with each change. If more than one POD/POA, specify the acreage associated with each POD/POA.

AUTHORIZED (the "from" or "off" lands) The listing that appears on the Certificate BEFORE PROPOSED CHANGES List only that part or portion of the water right that will be changed.											Proposed Changes (see "CODES" from previous page)	PROPOSED (the "to" or "on" lands) The listing as it would appear AFTER PROPOSED CHANGES are made.														
Twp	Rng	Sec	¼	¼	Tax Lot	Gvt Lot or DL C	Acres	Type of USE listed on Cert	POD(s) or POA(s) (name or number from Table 1)	Priority Date		Twp	Rng	Sec	¼	¼	Tax Lot	Gvt Lot or DL C	Acres	New Type of USE	POD(s)/ POA(s) to be used (from Table 1)	Priority Date				
2	N	28	E	3	NE	NE	700		32.0	IRR	WELL 4 & 8	10/15/1975	POU	3	N	28	E	21	NE	NE			30.6	SUPP IRR	WELL 4 & 8	10/15/1975
2	N	28	E	3	NW	NE	700		31.6	IRR	WELL 4 & 8	10/15/1975	POU	3	N	28	E	21	NW	NE			30.3	SUPP IRR	WELL 4 & 8	10/15/1975
2	N	28	E	3	SW	NE	700		31.0	IRR	WELL 4 & 8	10/15/1975	POU	3	N	28	E	21	SW	NE			31.9	SUPP IRR	WELL 4 & 8	10/15/1975
2	N	28	E	3	SE	NE	700		29.3	IRR	WELL 4 & 8	10/15/1975	POU	3	N	28	E	21	SE	NE			31.1	SUPP IRR	WELL 4 & 8	10/15/1975
TOTAL ACRES							123.9												TOTAL ACRES	123.9						

Additional remarks: _____

Received
MAR 21 2025

OWRD
TACS

For Place of Use Changes

Are there other water right certificates, water use permits or ground water registrations associated with the "from" or the "to" lands? Yes No

If YES, list the certificate, water use permit, or ground water registration numbers: _____

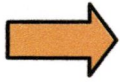

Pursuant to ORS 540.525, any "layered" water use such as an irrigation right that is supplemental to a primary right proposed for temporary transfer can be included in the transfer or remain unused on the authorized place of use. If the primary water right does not revert soon enough to allow use of the supplemental right within five years, the supplemental right shall become subject to cancellation for nonuse under ORS 540.610.

If a change in point(s) of appropriation (well(s)) or additional point(s) of appropriation is necessary to convey the water to the new temporary place of use you must provide: N/A

- Well log(s) for each authorized and proposed well(s) that are clearly labeled and associated with the corresponding well(s) in Table 1 above and on the accompanying application map. (Tip: You may search for well logs on the Department's web page at: http://apps.wrd.state.or.us/apps/gw/well_log/Default.aspx)

AND/OR

- Describe the construction of the authorized and proposed well(s) in Table 3 below for any well that does not have a well log. For a *proposed well(s) not yet constructed or built*, provide "a best estimate" for each requested information element in the table. The Department recommends you consult a licensed well driller, geologist, or certified water right examiner to assist with assembling the information necessary to complete Table 3.

Table 3. Construction of Point(s) of Appropriation N/A

Any well(s) in this listing must be clearly tied to corresponding well(s) described in Table 1 and shown on the accompanying application map. Failure to provide the information will delay the processing of your transfer application until it is received. The information is necessary for the Department to assess whether the proposed well(s) will access the same source aquifer as the authorized point(s) of appropriation (POA). The Department is prohibited by law from approving POA changes that do not access the same source aquifer.

Proposed or Authorized POA Name or Number	Is well already built? (Yes or No)	If an existing well, OWRD Well ID Tag No. L-___	Total well depth	Casing Diameter	Casing Intervals (feet)	Seal depth(s) (intervals)	Perforated or screened intervals (in feet)	Static water level of completed well (in feet)	Source aquifer (sand, gravel, basalt, etc.)	Well-specific rate (cfs or gpm). If less than full rate of water right

Received
MAR 21 2025
OWRD

Application for Water Right Transfer

Evidence of Use Affidavit



Oregon Water Resources Department
 725 Summer Street NE, Suite A
 Salem, Oregon 97301-1266
 (503) 986-0900
 www.wrd.state.or.us

Please print legibly or type. Be as specific as possible. Attach additional pages if you need more spacing. Supporting documentation must be attached.

State of Oregon)
) ss
 County of UMATILLA)

I, EAGLE RANCH C/O ART PRIOR, in my capacity as OWNER,
 mailing address 1333 COLUMBIA PARK TRAIL, RICHLAND, WA 99350
 telephone number (541)561-4769, being first duly sworn depose and say:

1. My knowledge of the exercise or status of the water right is based on (check one):

- Personal observation Professional expertise

2. I attest that:

- Water was used during the previous five years on the **entire** place of use for Certificate # _____; **OR**
- My knowledge is specific to the use of water at the following locations within the last five years:

Certificate #	Township		Range		Mer	Sec	¼ ¼		Tax Lot	Acres (if applicable)
97540	2	N	28	E	W.M	3	NE	NE	700	32.0
97540	2	N	28	E	W.M	3	NW	NE	700	31.6
97540	2	N	28	E	W.M	3	SW	NE	700	31.0
97540	2	N	28	E	W.M	3	SE	NE	700	29.3

OR

- Confirming Certificate # _____ has been issued within the past five years; **OR**
- Part or all of the water right was leased instream at some time within the last five years. The instream lease number is: _____ (Note: If the entire right proposed for transfer was not leased, additional evidence of use is needed for the portion not leased instream.); **OR**
- The water right is not subject to forfeiture and documentation that a presumption of forfeiture for non-use would be rebutted under ORS 540.610(2) is attached.
- Water has been used at the actual current point of diversion or appropriation for more than 10 years for Certificate # _____ (For Historic POD/POA Transfers)

(continues on reverse side)

Received
 MAR 21 2025
 OWRD

3. The water right was used for: (e.g., crops, pasture, etc.): CROPS

4. I understand that if I do not attach one or more of the documents shown in the table below to support the above statements, my application will be considered incomplete.

[Signature]
Signature of Affiant

3-14-2025
Date

Signed and sworn to (or affirmed) before me this 14 day of MARCH 2025.

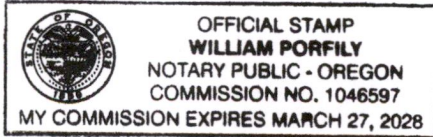

William Porfily
Notary Public for Oregon

My Commission Expires: March 27, 2028

Supporting Documents	Examples
<input type="checkbox"/> Copy of a water right certificate that has been issued within the last five years. (not a remaining right certificate)	Copy of confirming water right certificate that shows issue date
<input type="checkbox"/> Copies of receipts from sales of irrigated crops or for expenditures related to use of water	<ul style="list-style-type: none">● Power usage records for pumps associated with irrigation use● Fertilizer or seed bills related to irrigated crops● Farmers Co-op sales receipt
<input type="checkbox"/> Records such as FSA crop reports, irrigation district records, NRCS farm management plan, or records of other water suppliers	<ul style="list-style-type: none">● District assessment records for water delivered● Crop reports submitted under a federal loan agreement● Beneficial use reports from district● IRS Farm Usage Deduction Report● Agricultural Stabilization Plan● CREP Report
<input checked="" type="checkbox"/> Aerial photos containing sufficient detail to establish location and date of photograph GOOGLE EARTH AERIAL PHOTO 4/2021	Multiple photos can be submitted to resolve different areas of a water right. If the photograph does not print with a "date stamp" or without the source being identified, the date of the photograph and source should be added. Sources for aerial photos: OSU – www.oregonexplorer.info/imagery OWRD – www.wrd.state.or.us Google Earth – earth.google.com TerraServer – www.terraserver.com

Received
MAR 21 2025
OWRD

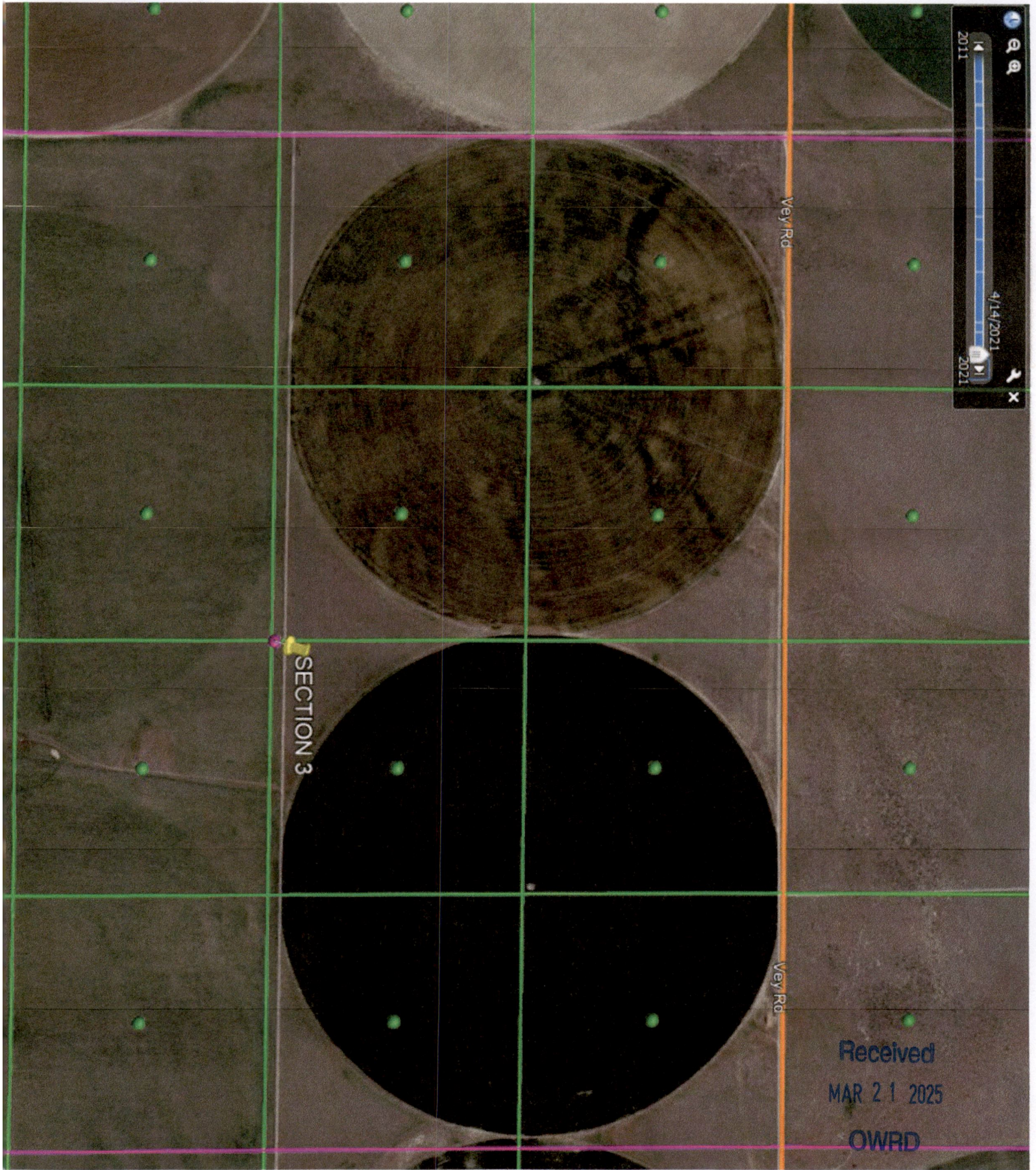

14630 -

Supplemental Form U

For Water Right Transfers Involving Irrigation Within Portions of Morrow & Umatilla Counties



Oregon Water Resources Department
725 Summer Street NE, Suite A
Salem, Oregon 97301-1266
503-986-0900
www.oregon.gov/OWRD

T2N, R26-R28	T3N, R26-R30
T4N, R26-R30	T5N, R27-R30

For transfers involving a change in place of use and/or character of use submitted under OAR Chapter 690, Division 380 or 385
--

1. APPLICANT INFORMATION

NAME Eagle Ranch C/ O Arthur Prior		PHONE (HOME) 541-561-4769	
PHONE (WORK)	CELL 541-561-4769	FAX	
ADDRESS 1333 Columbia Park Trail			
CITY Richland	STATE WA	ZIP 99350	E-MAIL** arthur@eoni.com

** By providing an e-mail address, the applicant and/or the district/water supplier consents to receive all correspondence from the Department electronically. Copies of final order documents will also be mailed.

2. PLEASE READ – EXPLAINS WHY THIS FORM IS NEEDED

Within certain portions of the Umatilla Drainage Basin (i.e., Umatilla Basin), irrigation water rights have been issued that provide for the special use of Columbia River water under certain conditions. These are collectively referred to as “**Mid-C Water Rights**,” managed by the **Mid-Columbia Water Commission**. These rights are in the names of Columbia Improvement District and East Improvement District.

Water may only be used under a Mid-C water right where “Planned Irrigation” activity under the Mid-C right has been described on maps filed with the Watermaster by February 14 for the upcoming irrigation season. “Planned Irrigation” activity is coordinated with the water user and is determined on an annual basis and is authorized for a single irrigation season at a time.

The purpose of this form is to make transfer applicants aware of potential effects to transfers when the authorized “off” or “from” lands or proposed “on” or “to” lands become temporarily layered with “Planned Irrigation” under a Mid-C managed water right for an irrigation season.

Received
MAR 21 2025

OWRD

For more information, please read the permit conditions on any of the Mid-C water rights listed in Item #3, below.

3. DETERMINE LAYERING WITH Mid-C WATER RIGHTS – may require a plat card search @

https://apps.wrd.state.or.us/apps/wr/wrinfo/wr_platcard.aspx

West Side – all POU's mostly identical*
Application S-88161 / Permit S-55061
Application S-88162 / Permit S-54633
Application S-88288 / Permit S-55190*exception
Application S-88289 / Permit S-55192

East Side – all POU's mostly identical
Application S-88206 / Permit S-55114
Application S-88290 / Permit S-55262
Application S-88286 / Permit S-55263
Application S-88287 / Permit S-55167

YES NO Are any portions of the authorized OFF or proposed ON lands in the transfer application layered with one of the above identified Mid-C Water Rights?

IF NO, you are done. Sign under Item #5 to complete the form.

IF YES, provide the following additional information, and complete Item #4.

Mid-C Water Right Numbers (listed above) layered with lands in the transfer application:

Permit's S-55061, S-55192, and S-54633

Water Right(s) Numbers included in the transfer application which are layered with Mid-C Water Rights:

Certificate 97540

4. RECOGNIZE POTENTIAL EFFECTS OF "PLANNED IRRIGATION" ON LAYERED LANDS IN TRANSFERS

YES In order to prevent enlargement, I understand the authorized place of use (the "from" or "off" lands) described in the transfer application, if layered with "Planned Irrigation" activity under the Mid-C water rights, may not be transferred off (unlayered) during the irrigation season (only) as described on the annual February 14 maps filed with the watermaster.

YES In order to prevent enlargement, I understand that the proposed place of use (the "to" or "on" lands) described in the transfer application, if layered with "Planned Irrigation" activity under the Mid-C water rights, may not be transferred off (unlayered) during the irrigation season (only) as described on the annual February 14 maps filed with the watermaster.

Received
MAR 21 2025
OWRD

COMMENTS OR ADDITIONAL INFORMATION:

The water right permits listed above have not been made available to the area involved in the temporary transfer as of this date.

5. APPLICANT'S SIGNATURE

I certify I have read the contents of this form, and that to the best of my knowledge the information provided in this **Supplemental Form U** is true and accurate.

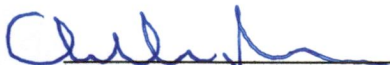
Applicant Signature

Arthur Prior
Name (print)

3-14-2025
Date

SMITH Joan M * WRD

From: wporfily@gmail.com
Sent: Wednesday, March 26, 2025 11:24 AM
To: SMITH Joan M * WRD
Subject: RE: Eagle Ranch New Temp Transfer Application
Attachments: DEED.pdf

Yes, sorry about that. Here you go,

Thank you

William Porfily
PO Box 643
Stanfield, OR 97875
Cel (541)561-7259
E-Mail: wporfily@gmail.com

From: SMITH Joan M * WRD <Joan.M.SMITH@water.oregon.gov>
Sent: Tuesday, March 25, 2025 4:51 PM
To: wporfily@gmail.com
Subject: Eagle Ranch New Temp Transfer Application

Good Afternoon Bill, I got this new application to look at and I am not locating the deed. Would you please send me the deeds? Electronically will suffice, then I can get this one assigned a number.
Thank you
Joan

JOAN M. SMITH | TRANSFER SPECIALIST
TRANSFER & CONSERVATION SECTION
725 Summer Street NE, Suite A Salem, OR 97301 | Phone 503-986-0892

NOTE: OWRD offices are now open to the public. Given that many staff will continue teleworking remotely or have job duties that take them into the field on a regular basis, however, availability of staff in the office is not guaranteed 8 a.m. - 5 p.m. every day (M-F). OWRD's Salem office is closed for customer service drop-ins from Noon – 1pm. **Customers and visitors are encouraged to schedule an appointment in advance if they wish to meet in person with specific staff members.** Alternative methods for meeting, such as by phone or virtually via Teams, are also available.

R177 1580

QUIT CLAIM DEED

145148

CHESTER J. PRIOR, and ROSALIE PRIOR, husband and wife individually, and CHESTER J. PRIOR, TRUSTEE FOR THE MICHAEL WILLIAM PRIOR TRUST, the ARTHUR RAY PRIOR TRUST, and the DAVID CHESTER PRIOR TRUST, in consideration for the transfer to a family partnership do hereby release, and quit claim to EAGLE RANCH, GRANTEE, all right, title and interest in and to these real properties situated in the County of Umatilla, State of Oregon, as more particularly described on Exhibit "A" attached hereto which by this reference is made a part hereof.

THIS DEED will not allow use of the property described in this instrument in violation of applicable land use laws and regulations. Before signing or accepting this instrument, the person acquiring fee planning department to verify approved uses. *Consideration \$1*

UNTIL a change is requested, all tax statements shall be sent to the following address: Eagle Ranch, Star Route, Echo, Oregon 97826.

DATED THIS 29 day of Mar, 1989.

[Signature]
CHESTER J. PRIOR

[Signature]
ROSALIE PRIOR

[Signature]
CHESTER J. PRIOR, TRUSTEE
MICHAEL WILLIAM PRIOR TRUST

[Signature]
CHESTER J. PRIOR, TRUSTEE
ARTHUR RAY PRIOR TRUST

[Signature]
CHESTER J. PRIOR, TRUSTEE
DAVID CHESTER PRIOR TRUST

R177 ~~1581~~ 1581

STATE OF OREGON

County of UMATILLA

} ss.

On this 29th day of March, 1989, before me a Notary Public in and for the said State, Personally appeared, CHESTER J. PRIOR and ROSALIE PRIOR, husband and wife individually, known to me to be the persons whose names are subscribed to the within instrument, and acknowledged to me that they executed the same.

William Edward Robinson
NOTARY PUBLIC IN and for the State of OREGON, Residing at Echo, Oregon.
My Commission Expires: 12-31-91

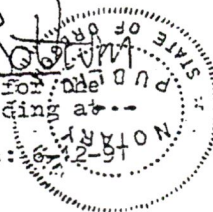

EXHIBIT "A"

TO QUIT CLAIM DEED between Chester J. Prior
and Rosalie Prior grantors in favor of Eagle
Ranch a Partnership as Grantee.

TOWNSHIP 2 NORTH, RANGE 23, E. W. M.

- Section 1: West Half.
- Section 2: North Half,
Southeast Quarter.
- Section 3: North Half.

TOWNSHIP 3 NORTH, RANGE 23, E. W. M.

- Section 9: All
- Section 10: West half.
- Section 14: South Half of Northwest Quarter,
West Half of Southwest quarter,
Northeast Quarter of Southwest Quarter.

ALSO, beginning at a point on North line of Southeast Quarter of Southwest Quarter of said Section 14, at a point 158.5 feet East of Northwest corner of said Southeast Quarter of Southwest Quarter of said Section 14; thence in a Southwesterly direction a distance of 346 feet to a point on West line of Southeast Quarter of Southwest Quarter of said Section 14, a distance of 303 feet South of Northwest corner of Southeast Quarter of Southwest Quarter of said Section 14; thence North along said West line a distance of 303 feet to Northwest corner of said Southeast Quarter of Southwest Quarter of said Section 14; thence East a distance of 158.5 feet to the point of beginning.

- Section 15: East Half of Northeast Quarter,
Southeast Quarter,
West half.
- Section 16: All
- Section 17: East Half of Northeast Quarter or Northeast Quarter,
West Half of Northwest Quarter of Northeast Quarter.

South Half of Northeast Quarter.

Southeast Quarter of Northwest Quarter.
Southwest Quarter of the Northeast Quarter of the Northeast
Quarter.
South Half.

Northeast Quarter of Northwest Quarter of Northeast
Quarter, excepting therefrom that tract conveyed to
State of Oregon, by and through its State Highway
Commission, by Deed recorded in Book 130, Page 568.
Deed Records:

Southeast Quarter of the Northwest Quarter of the
Northeast Quarter.

Section 18: Southeast Quarter of Southeast Quarter.

Section 19: East Half of Northeast Quarter.

Section 21: All

Section 22: Northwest Quarter.

Section 25: All

Section 26: South Half.

Section 29: North Half.

Section 30: All that portion of Northeast Quarter lying Easterly
of State Highway No. 207:

EXCEPTING THEREFROM, commencing at Southwest corner
of said Section 30: thence North 50° 36' 55" East a
distance of 5295.62 feet to a point on East right of
way line of Oregon State Highway No. 207, said point
being the true point of beginning for this description:
thence along said East right of way line along a 1 curve
to the left, the chord bears North 23° 00' East 298.76
feet a distance of 298.88 feet: thence leaving said East
right of way line East a distance of 259.93 feet: thence
South 275 feet: thence West a distance of 376.56 feet to
the true point of beginning:

Section 35: All

Section 36: All

Section 18: A tract of land located in Northwest Quarter of said Section 18, described as beginning at West Quarter corner of said Section 18; thence North 88° 07' 58" East along East West centerline of said Section a distance of 1851.41 feet to the true point of beginning of this description, which is Southwest corner of Andrews Tract; thence North 1° 08' 45" West along West line of said Andrews Tract a distance of 289.06 feet to intersection with the arc of a radial sprinkler line who's radius is 1339.75 feet; thence along said arc of said radial sprinkler line which curves to the right a distance of 534.79 feet, the long chord of which bears South 58° 53' 59" East a distance of 531.25 feet, to a point of intersection with East-West centerline of said Section 18; thence South 88° 07' 58" West along said East-West centerline a distance of 449.37 feet to the point of beginning;

ALSO that portion of West Half of Northwest Quarter of said Section 18, lying and being Southerly of Southerly line of the Hinkle Ditch;

Section 18: Southwest Quarter.

EXCEPTING a tract of land located in Southwest Quarter of said Section 18, described as beginning at South Quarter corner of said Section; thence South 87° 21' 44" West along South line of said Section a distance of 658.81 feet to intersection with the arc of a radial sprinkler line who's radius is 1290 feet; thence along said arc of said radial sprinkler line which curves to the right a distance of 1235.06 feet, the long chord of which bears North 34° 33' 40" East a distance of 1188.43 feet, to intersection with North-South centerline of said Section; thence South 1° 00' 38" East along said North-South centerline a distance of 1066.76 feet to the point of beginning.

All bearings shown herein are from Oregon State Highway Grid bearings, North Zone.

ALSO EXCEPTING a tract of land described as beginning at South 1/16 corner center to center of said Section 18; thence South 01° 00' 38" East a distance of 80 feet; thence South 87° 44' 53" West a distance of 474.71 feet; thence North 00° 03' 40" East 528.93 feet; thence North 15° 40' 10" West a distance of 580.90 feet; thence North 32° 19' 35" West a distance of 300 feet; thence North 88° 47' 45" East a distance of 779 feet; thence South 00° 29' 35" East a distance of 1257.61 feet to the point of beginning;

Section 19: that portion of said Section 19, lying North of Oregon State Highway No. 320.

EXCEPTING a track or land located in North half of said Section 19 described as beginning at North Quarter corner of said Section; thence North 87° 21' 44" East along North line of said Section a distance of 1909.13 feet to intersection with the arc of a radial sprinkler line whc's radius is 1290 feet; thence along said arc or said radial sprinkler line which curves to the right a distance of 4254.94 feet to a point intersection with North line of said Section. said point bears South 87° 21' 44" West along North line of said Section a distance of 2567.94 feet; thence North 87° 31' 44" East along North line of said Section a distance of 658.81 feet to the point of beginning;

ALL bearings shown herein are from Oregon State Highway grid bearings, North Zone.

ALSO EXCEPTING a tract of land described as commencing at Northeast corner of said Section 19. thence South 1° 22' 23" East along East line of said Section 19. a distance of 622.01 feet to centerline of Oregon State Highway No. 320; thence along said centerline the following courses and distances: South 57° 31' 25" West 993.04 feet; thence along the arc of a 2864.93 foot radius curve to the right, the chord of which bears South 63° 39' 02" West 611.55 feet a distance of 612.72 feet; thence South 69° 46' 40" West a distance of 166 feet to the true point of beginning; thence continuing south 69° 47' 40" West a distance of 943.51 feet; thence leaving said centerline and at a right angles North 20° 13' 20" West 341.85 feet; thence South 68° 54' 52" West 448 feet; thence North 21° 05' 08" West 154 feet; thence North 68° 54' 52" East 409.14 feet to an intersection with the crop line of a 1320.14 foot radius irrigated agriculture circle; thence along said crop line and along the arc of a 1320.14 foot radius curve to the left the chord of which bears South 86° 06' 16" East 1076.86 feet a distance of 1111.39 feet; thence South 20° 13' 20" East a distance of 54.41 feet to the true point of beginning;

ALSO EXCEPTING a tract of land described as beginning at Northeast corner of said Section 19; thence South 01° 22' 23" East along East line of said Section 19 a distance of 622.01 feet to centerline of Oregon State Highway No. 320; thence South 57° 31' 25" West along centerline of said Highway No. 320 a distance of 993.04 feet; thence continuing along said highway centerline along the arc of a 2864.93 foot radius curve to the right, the chord of which bears South 63° 39' 02" West 611.55 feet a distance of 612.72 feet; thence continuing along centerline of said highway South 69° 46' 40" West a distance of 166 feet; thence at a right angle North 20° 13' 21" West a distance of 54.41 feet to an intersection with crop line of 1320.14 foot radius agriculture irrigated

R 177 PAGE 1586

circle; thence along said crop line and along the arc of a 1320.14 foot radius curve to the left, the chord of which bears North 31 21' 38" East 1640.62 feet a distance of 1770.32 feet to intersection with North line of said Section 19; thence along said North line North 87 21' 44" East a distance of 692.34 feet to the point of beginning for this description.

ALSO EXCEPTING a tract described as commencing at the Northeast corner of said Section 19; thence South 1 22' 23" East along East line of said Section 19 a distance of 622.01 feet to centerline of Oregon State Highway No. 320; thence along said centerline the following courses and distances: South 57 31' 25" West 993.04 feet; thence along the chord of which bears South 63 39' 02" West 611.55 feet a distance of 612.72 feet; thence South 69 46' 40" West a distance of 165 feet; thence continuing South 69 46' 40" West a distance of 942.51 feet to the true point of beginning of this description; thence South 69 46' 40" West along said centerline a distance of 446.30 feet; thence leaving said centerline and at a right angle North 20 13' 20" West a distance of 125 feet; thence North 69 46' 40" East and parallel with said centerline a distance of 446.30 feet; thence South 20 13' 20" East to said centerline a distance of 125 feet to the true point of beginning:

SUBJECT to a 50 foot highway right of way along Southernly boundary.

SUBJECT to any and all water rights of way and roads:

All being East of the Willamette Meridian, Umatilla County, Oregon.

FILED
J. DEAN FOUQUETTE, SR.
UMATILLA COUNTY CLERK

1989 MAR 29 P 2:23

R177 PAGE 1587

STATE OF OREGON, } ss
COUNTY OF UMATILLA, }

I, J. Dean Fouquette, Sr., County Clerk,
certify that this instrument was received and
recorded

ON MAR 29 1989

at 2:23 o'clock P.M. in the record
of DEEDS of said County in

Book Page
R177 1580

J. DEAN FOUQUETTE, SR.
County Clerk

By Betty Brown Deputy
Fees \$ 45.00 No. 145148

Chester J. Prior
Star Rte
Echo, Or. 97826



725 Summer Street NE, Suite A
Salem, Oregon 97301-1271

PILOT PROJECT SB 267
(Use of this form is voluntary)

**District Temporary Transfer
Place of Use Change**

**VOLUNTARY FORM FOR USE WHEN FILING REQUIRED MAPS
WITH THE LOCAL WATERMASTER PRIOR TO TEMPORARY TRANSFER OF WATER RIGHT
UNDER THE PILOT PROJECT**

The Department requests maps for spring irrigation be provided to the watermaster before the start of the irrigation season.

Irrigation Season 2025
Year

District: Westland Irrigation District

Contact Person: William Porfily Phone: 541-561-7259

Mailing Address: WID P O Box 944 Hermiston, OR 97838

E-mail Address: curtis@westlandirrigation.com Notice #: _____

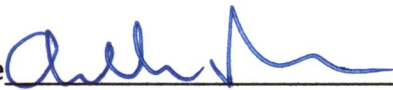
Land Owner Signature  Date 3-14-2025

I. The district proposes to change the place of use for the following water rights:

WATER RIGHTS	
Permit or Certificate Number(s)	
Primary (IR)	Supplemental (IS)
76050	95532, 75127 & 80652
76715	79439
53732	
76722	
T-9591 (76050)	95542

Received
MAR 21 2025
OWRD

II. The point(s) of diversion/appropriation for the water rights proposed for transfer are as follows:

POINT(S) OF DIVERSION / APPROPRIATION			
IR/IS	Permit or Certificate Number(s)	POD#	LOCATION – MEASURED DISTANCES
	76050,95532, 76715, 76722, 53732, 79439 & T-9591	WID	N76°45'56"E, 2913.19 ft. from W ¼ Cor. of Sec. 21, T3N, R29 EWM
	75127	Prior Well #4	2640'S & 630'W from the N ¼ Corner, Sec. 1, T2N, R28E, WM
	75127	Prior Well #7	2500'S & 2580'E from the NW Corner, Sec. 2, T2N, R28E, WM
	75127	Prior Well #8	2800'S & 500'W from the NE Corner, Sec. 2, T2N, R28E, WM

80652 & 95542	WELL 2	750 FT S AND 2620 FT W FROM THE NE COR OF SEC 36
80652 & 95542	WELL 3	1780 FT N AND 2600 FT W FROM THE SE COR OF SEC 36
80652 & 95542	WELL 5	770 FT S AND 2640 FT E FROM THE NW COR OF SEC 35
80652 & 95542	WELL 6	1940 FT N AND 2540 FT E FROM THE SW COR OF SEC 35

If a POD/POA is not identified by a number on the water right (i.e.: POD #1, or Well #1), assign it a number in the Section II (the above table), and use that number to identify the authorized POD/POA from which water is diverted to serve the lands described in Tables 1 and 2 on the reverse side of this form (Page 2).

- III. The district proposes to change the place of use from the authorized location listed in Table 1 to the location listed in Table 2.
- IV. An accurate map showing the authorized place of use and the proposed place of use is attached.

Received
MAR 21 2025
OWRD

TABLE 1. – AUTHORIZED PLACE OF USE-FROM LANDS

WATER RIGHT		PRIORITY DATE	USE (IR/IS)	LEGAL DESCRIPTION						ACRES	WATER USER
Cert/Decree	Permit			POD #	TWP	RNG	SEC	Q-Q	TAX LOT		
76050		4/22/1955	IR	WID	2N	28E	1	NENW	200	32.2	EAGLE RANCH
76050		4/22/1955	IR	WID	2N	28E	1	NWNW	200	31.6	EAGLE RANCH
76050		4/22/1955	IR	WID	2N	28E	1	SWNW	200	29.6	EAGLE RANCH
76050		4/22/1955	IR	WID	2N	28E	1	NESW	200	36.5	EAGLE RANCH
76050		4/22/1955	IR	WID	2N	28E	1	NWSW	200	31.0	EAGLE RANCH
76050		4/22/1955	IR	WID	2N	28E	1	SWSW	200	28.8	EAGLE RANCH
76050		4/22/1955	IR	WID	2N	28E	1	SESW	200	31.2	EAGLE RANCH
76050		4/22/1955	IR	WID	2N	28E	2	NENE	300	8.2	EAGLE RANCH
76050		4/22/1955	IR	WID	2N	28E	2	NWNE	300	36.7	EAGLE RANCH
76050		4/22/1955	IR	WID	2N	28E	2	SWNE	300	38.2	EAGLE RANCH
76050		4/22/1955	IR	WID	2N	28E	2	SENE	300	29.2	EAGLE RANCH
76050		4/22/1955	IR	WID	2N	28E	2	NENW	300	33.3	EAGLE RANCH
76050		4/22/1955	IR	WID	2N	28E	2	NWNW	300	32.2	EAGLE RANCH
76050		4/22/1955	IR	WID	2N	28E	2	SWNW	300	27.8	EAGLE RANCH
76050		4/22/1955	IR	WID	2N	28E	2	SENW	300	30.0	EAGLE RANCH
76050		4/22/1955	IR	WID	2N	28E	2	NESE	500	19.1	EAGLE RANCH
76050		4/22/1955	IR	WID	2N	28E	2	NWSE	500	30.0	EAGLE RANCH
76050		4/22/1955	IR	WID	2N	28E	2	SWSE	600	35.2	EAGLE RANCH
76050		4/22/1955	IR	WID	2N	28E	2	SESE	600	22.8	EAGLE RANCH
76050		4/22/1955	IR	WID	3N	28E	25	SESW	7402	8.9	EAGLE RANCH
76050		4/22/1955	IR	WID	3N	28E	25	SWSE	7402	8.1	EAGLE RANCH
76050		4/22/1955	IR	WID	3N	28E	26	SWSE	7400	8.6	EAGLE RANCH
76050		4/22/1955	IR	WID	3N	28E	35	NWNE	7400	9.5	EAGLE RANCH
76050		4/22/1955	IR	WID	3N	28E	35	SENW	7400	5.4	EAGLE RANCH
76050		4/22/1955	IR	WID	3N	28E	35	SWNE	7400	5.3	EAGLE RANCH
76050		4/22/1955	IR	WID	3N	28E	35	NESW	7400	6.8	EAGLE RANCH
76050		4/22/1955	IR	WID	3N	28E	35	NESE	7400	29.0	EAGLE RANCH
76050		4/22/1955	IR	WID	3N	28E	35	NWSE	7400	37.6	EAGLE RANCH
76050		4/22/1955	IR	WID	3N	28E	35	SWSE	7400	33.8	EAGLE RANCH
76050		4/22/1955	IR	WID	3N	28E	35	SESE	7400	30.2	EAGLE RANCH

76050		4/22/1955	IR	WID	3N	28E	36	NWNE	7402	8.5	EAGLE RANCH
76050		4/22/1955	IR	WID	3N	28E	36	MENW	7402	8.2	EAGLE RANCH
Total										763.5	

Received
MAR 21 2025
OWRD

TABLE 2. – PROPOSED PLACE OF USE-TO LANDS

WATER RIGHT		PRIORITY DATE	USE (IR/IS)	POD #	LEGAL DESCRIPTION					ACRES	WATER USER
Cert/Decree	Permit				TWP	RNG	SEC	QQ	TAX LOT		
76050		4/22/1955	SUPP IR	WID	2N	28E	3	NENW	700	31.4	EAGLE RANCH
76050		4/22/1955	SUPP IR	WID	2N	28E	3	NWNW	700	31.4	EAGLE RANCH
76050		4/22/1955	SUPP IR	WID	2N	28E	3	SWNW	700	31.3	EAGLE RANCH
76050		4/22/1955	SUPP IR	WID	2N	28E	3	SENW	700	31.4	EAGLE RANCH
76050		4/22/1955	SUPP IR	WID	3N	28E	15	NENW	4501	7.0	EAGLE RANCH
76050		4/22/1955	SUPP IR	WID	3N	28E	15	SWNW	4501	9.0	EAGLE RANCH
76050		4/22/1955	SUPP IR	WID	3N	28E	15	SENW	4501	30.2	EAGLE RANCH
76050		4/22/1955	SUPP IR	WID	3N	28E	15	SWSW	4501	23.2	EAGLE RANCH
76050		4/22/1955	SUPP IR	WID	3N	28E	16	SWNW	3101	13.9	EAGLE RANCH
76050		4/22/1955	SUPP IR	WID	3N	28E	16	SENW	3101	9.2	EAGLE RANCH
76050		4/22/1955	SUPP IR	WID	3N	28E	16	SWSW	3101	23.3	EAGLE RANCH
76050		4/22/1955	SUPP IR	WID	3N	28E	16	SWSE	4600	14.0	EAGLE RANCH
76050		4/22/1955	SUPP IR	WID	3N	28E	16	SESE	4600	9.2	EAGLE RANCH
76050		4/22/1955	SUPP IR	WID	3N	28E	20	NENE	6700	15.9	EAGLE RANCH
76050		4/22/1955	SUPP IR	WID	3N	28E	20	NESE	6700	31.9	EAGLE RANCH
76050		4/22/1955	SUPP IR	WID	3N	28E	20	NWSE	6700	31.3	EAGLE RANCH
76050		4/22/1955	SUPP IR	WID	3N	28E	20	SWSE	6700	32.7	EAGLE RANCH
76050		4/22/1955	SUPP IR	WID	3N	28E	25	SWNE	7402	5.3	EAGLE RANCH
76050		4/22/1955	SUPP IR	WID	3N	28E	25	SENW	7402	4.9	EAGLE RANCH
76050		4/22/1955	SUPP IR	WID	3N	28E	25	NESW	7402	6.1	EAGLE RANCH
76050		4/22/1955	SUPP IR	WID	3N	28E	25	NWSE	7402	6.7	EAGLE RANCH
76050		4/22/1955	SUPP IR	WID	3N	28E	26	NESW	7406	31.1	EAGLE RANCH
76050		4/22/1955	SUPP IR	WID	3N	28E	26	NWSW	7406	31.2	EAGLE RANCH
76050		4/22/1955	SUPP IR	WID	3N	28E	26	SWSW	7406	24.4	EAGLE RANCH
76050		4/22/1955	SUPP IR	WID	3N	28E	26	SESW	7406	31.2	EAGLE RANCH
76050		4/22/1955	SUPP IR	WID	3N	28E	29	NENE	8100	30.5	EAGLE RANCH
76050		4/22/1955	SUPP IR	WID	3N	28E	29	NWNE	8100	29.7	EAGLE RANCH
76050		4/22/1955	SUPP IR	WID	3N	28E	29	SWNE	8100	32.2	EAGLE RANCH
76050		4/22/1955	SUPP IR	WID	3N	28E	29	SENE	8100	30.0	EAGLE RANCH
76050		4/22/1955	SUPP IR	WID	3N	28E	29	NENW	8100	28.7	EAGLE RANCH
76050		4/22/1955	SUPP IR	WID	3N	28E	29	NWNW	8100	33.1	EAGLE RANCH
76050		4/22/1955	SUPP IR	WID	3N	28E	29	SWNW	8100	33.1	EAGLE RANCH

76050		4/22/1955	SUPP IR	WID	3N	28E	29	SENW	8100	28.5	EAGLE RANCH
76050		4/22/1955	SUPP IR	WID	3N	28E	30	NENE	8100	0.2	EAGLE RANCH
76050		4/22/1955	SUPP IR	WID	3N	28E	30	SENE	8100	0.3	EAGLE RANCH
Total										763.5	

Received
MAR 21 2025

OWRD

14630 -

CERTIFICATE 95532 MAP 2 OF 6

TABLE 1. – AUTHORIZED PLACE OF USE-FROM LANDS

WATER RIGHT		PRIORITY DATE	USE (IR/IS)	LEGAL DESCRIPTION						ACRES	WATER USER
Cert/Decree	Permit			POD #	TWP	RNG	SEC	Q-Q	TAX LOT		
SUPPLEMENTAL											
95532		4/03/1981	SUPP IR	WID	2N	28E	1	NENW	200	32.2	EAGLE RANCH
95532		4/03/1981	SUPP IR	WID	2N	28E	1	NWNW	200	31.6	EAGLE RANCH
95532		4/03/1981	SUPP IR	WID	2N	28E	1	SWNW	200	29.6	EAGLE RANCH
95532		4/03/1981	SUPP IR	WID	2N	28E	1	NESW	200	31.6	EAGLE RANCH
95532		4/03/1981	SUPP IR	WID	2N	28E	1	NWSW	200	31.0	EAGLE RANCH
95532		4/03/1981	SUPP IR	WID	2N	28E	1	SWSW	200	28.8	EAGLE RANCH
95532		4/03/1981	SUPP IR	WID	2N	28E	1	SESW	200	31.2	EAGLE RANCH
95532		4/03/1981	SUPP IR	WID	2N	28E	2	NENE	300	8.2	EAGLE RANCH
95532		4/03/1981	SUPP IR	WID	2N	28E	2	NWNE	300	36.7	EAGLE RANCH
95532		4/03/1981	SUPP IR	WID	2N	28E	2	SWNE	300	38.2	EAGLE RANCH
95532		4/03/1981	SUPP IR	WID	2N	28E	2	SENE	300	29.2	EAGLE RANCH
95532		4/03/1981	SUPP IR	WID	2N	28E	2	NENW	300	33.3	EAGLE RANCH
95532		4/03/1981	SUPP IR	WID	2N	28E	2	NWNW	300	32.2	EAGLE RANCH
95532		4/03/1981	SUPP IR	WID	2N	28E	2	SWNW	300	27.8	EAGLE RANCH
95532		4/03/1981	SUPP IR	WID	2N	28E	2	SENW	300	30.0	EAGLE RANCH
95532		4/03/1981	SUPP IR	WID	2N	28E	2	NESE	500	19.1	EAGLE RANCH
95532		4/03/1981	SUPP IR	WID	2N	28E	2	NWSE	500	30.0	EAGLE RANCH
95532		4/03/1981	SUPP IR	WID	2N	28E	2	SWSE	600	35.2	EAGLE RANCH
95532		4/03/1981	SUPP IR	WID	2N	28E	2	SESE	600	22.8	EAGLE RANCH
95532		4/03/1981	SUPP IR	WID	3N	28E	26	SWSE	7400	9.5	EAGLE RANCH
95532		4/03/1981	SUPP IR	WID	3N	28E	35	NWNE	7400	9.5	EAGLE RANCH
95532		4/03/1981	SUPP IR	WID	3N	28E	35	SENW	7400	5.4	EAGLE RANCH
95532		4/03/1981	SUPP IR	WID	3N	28E	35	SWNE	7400	5.3	EAGLE RANCH
95532		4/03/1981	SUPP IR	WID	3N	28E	35	NESW	7400	6.8	EAGLE RANCH
95532		4/03/1981	SUPP IR	WID	3N	28E	35	NESE	7400	29.0	EAGLE RANCH
95532		4/03/1981	SUPP IR	WID	3N	28E	35	NWSE	7400	37.6	EAGLE RANCH
95532		4/03/1981	SUPP IR	WID	3N	28E	35	SWSE	7400	33.8	EAGLE RANCH
95532		4/03/1981	SUPP IR	WID	3N	28E	35	SESE	7400	30.2	EAGLE RANCH

Received
MAR 21 2025
OWRD

14630 -

95532		4/03/1981	SUPP IR	WID	3N	28E	36	NWNE	7402	8.5	EAGLE RANCH	
95532		4/03/1981	SUPP IR	WID	3N	28E	36	NENW	7402	8.2	EAGLE RANCH	
Total										743.5		
			PRIMARY									
95532		4/03/1981	IR	WID	2N	28E	1	SENW	200	40.0	EAGLE RANCH	
95532		4/03/1981	IR	WID	2N	28E	1	NESW	200	2.3	EAGLE RANCH	
95532		4/03/1981	IR	WID	3N	28E	36	SWNE	7402	5.3	EAGLE RANCH	
95532		4/03/1981	IR	WID	3N	28E	36	SENW	7402	5.3	EAGLE RANCH	
95532		4/03/1981	IR	WID	3N	28E	36	NESW	7402	5.4	EAGLE RANCH	
95532		4/03/1981	IR	WID	3N	28E	36	SESW	7402	9.1	EAGLE RANCH	
95532		4/03/1981	IR	WID	3N	28E	36	NWSE	7402	5.2	EAGLE RANCH	
Total										72.6		
GRAND TOTAL										816.1		

TABLE 2. – PROPOSED PLACE OF USE-TO LANDS

WATER RIGHT		PRIORITY DATE	USE (IR/IS)	POD #	LEGAL DESCRIPTION					ACRES	WATER USER
Cert/Decree	Permit				TWP	RNG	SEC	QQ	TAX LOT		
76050		4/22/1955	SUPP IR	WID	2N	28E	3	NENW	700	31.4	EAGLE RANCH
76050		4/22/1955	SUPP IR	WID	2N	28E	3	NWNW	700	31.4	EAGLE RANCH
76050		4/22/1955	SUPP IR	WID	2N	28E	3	SWNW	700	31.3	EAGLE RANCH
76050		4/22/1955	SUPP IR	WID	2N	28E	3	SENW	700	31.4	EAGLE RANCH
95532		4/03/1981	SUPP IR	WID	3N	28E	9	NENE	2900	31.0	EAGLE RANCH
95532		4/03/1981	SUPP IR	WID	3N	28E	9	SENE	2900	17.4	EAGLE RANCH
95532		4/03/1981	SUPP IR	WID	3N	28E	9	NENW	2900	30.7	EAGLE RANCH
95532		4/03/1981	SUPP IR	WID	3N	28E	9	NNW	2900	33.8	EAGLE RANCH
95532		4/03/1981	SUPP IR	WID	3N	28E	9	SWNE	2900	35.9	EAGLE RANCH
95532		4/03/1981	SUPP IR	WID	3N	28E	9	SENW	3000	31.1	EAGLE RANCH
95532		4/03/1981	SUPP IR	WID	3N	28E	10	NENW	2900	28.3	EAGLE RANCH
95532		4/03/1981	SUPP IR	WID	3N	28E	10	NWNW	2900	33.9	EAGLE RANCH
95532		4/03/1981	SUPP IR	WID	3N	28E	10	SWNW	2900	34.4	EAGLE RANCH
95532		4/03/1981	SUPP IR	WID	3N	28E	10	SENW	2900	28.8	EAGLE RANCH
95532		4/03/1981	SUPP IR	WID	3N	28E	15	NENW	4501	7.0	EAGLE RANCH
95532		4/03/1981	SUPP IR	WID	3N	28E	15	SWNW	4501	9.0	EAGLE RANCH

14630 -

Received
MAR 21 2025

OWBD

95532		4/03/1981	SUPP IR	WID	3N	28E	15	SENW	4501	30.2	EAGLE RANCH
95532		4/03/1981	SUPP IR	WID	3N	28E	15	SWSW	4501	23.2	EAGLE RANCH
95532		4/03/1981	SUPP IR	WID	3N	28E	16	SWNW	3101	13.9	EAGLE RANCH
95532		4/03/1981	SUPP IR	WID	3N	28E	16	SENW	3101	9.2	EAGLE RANCH
95532		4/03/1981	SUPP IR	WID	3N	28E	16	SWSW	3101	23.3	EAGLE RANCH
95532		4/03/1981	SUPP IR	WID	3N	28E	16	SWSE	4600	14.0	EAGLE RANCH
95532		4/03/1981	SUPP IR	WID	3N	28E	16	SESE	4600	9.2	EAGLE RANCH
95532		4/03/1981	SUPP IR	WID	3N	28E	29	NENE	8100	30.5	EAGLE RANCH
95532		4/03/1981	SUPP IR	WID	3N	28E	29	NWNE	8100	29.7	EAGLE RANCH
95532		4/03/1981	SUPP IR	WID	3N	28E	29	SWNE	8100	32.2	EAGLE RANCH
95532		4/03/1981	SUPP IR	WID	3N	28E	29	SENE	8100	30.0	EAGLE RANCH
95532		4/03/1981	SUPP IR	WID	3N	28E	29	NENW	8100	28.7	EAGLE RANCH
95532		4/03/1981	SUPP IR	WID	3N	28E	29	NWNW	8100	33.1	EAGLE RANCH
95532		4/03/1981	SUPP IR	WID	3N	28E	29	SWNW	8100	33.1	EAGLE RANCH
95532		4/03/1981	SUPP IR	WID	3N	28E	29	SENW	8100	28.5	EAGLE RANCH
95532		4/03/1981	SUPP IR	WID	3N	28E	30	NENE	8100	0.2	EAGLE RANCH
95532		4/03/1981	SUPP IR	WID	3N	28E	30	SENE	8100	0.3	EAGLE RANCH
Total										816.1	

Received
MAR 21 2025

OWRD

Received
 MAR 21 2025
 OWRD

TABLE 1. – AUTHORIZED PLACE OF USE-FROM LANDS

WATER RIGHT		PRIORITY DATE	USE (IR/IS)	LEGAL DESCRIPTION						ACRES	WATER USER
Cert/Decree	Permit			POD #	TWP	RNG	SEC	Q-Q	TAX LOT		
				PRIMARY							
75127		9/05/1974	PRIM IR	WELL 4,7,8	2N	28E	1	NESW	200	0.6	EAGLE RANCH
				SUPPLEMENTAL							
75127		9/05/1974	SUPP IR	WELL 4,7,8	2N	28E	1	NENW	200	32.2	EAGLE RANCH
75127		9/05/1974	SUPP IR	WELL 4,7,8	2N	28E	1	NWNW	200	31.6	EAGLE RANCH
75127		9/05/1974	SUPP IR	WELL 4,7,8	2N	28E	1	SWNW	200	29.6	EAGLE RANCH
75127		9/05/1974	SUPP IR	WELL 4,7,8	2N	28E	1	SESW	200	39.7	EAGLE RANCH
75127		9/05/1974	SUPP IR	WELL 4,7,8	2N	28E	1	NESW	200	39.4	EAGLE RANCH
75127		9/05/1974	SUPP IR	WELL 4,7,8	2N	28E	1	NWSW	200	31.0	EAGLE RANCH
75127		9/05/1974	SUPP IR	WELL 4,7,8	2N	28E	1	SWSW	200	28.8	EAGLE RANCH
75127		9/05/1974	SUPP IR	WELL 4,7,8	2N	28E	1	SESW	200	31.2	EAGLE RANCH
75127		9/05/1974	SUPP IR	WELL 4,7,8	2N	28E	2	NENE	300	8.2	EAGLE RANCH
75127		9/05/1974	SUPP IR	WELL 4,7,8	2N	28E	2	NWNE	300	36.7	EAGLE RANCH
75127		9/05/1974	SUPP IR	WELL 4,7,8	2N	28E	2	SWNE	300	38.2	EAGLE RANCH
75127		9/05/1974	SUPP IR	WELL 4,7,8	2N	28E	2	SENE	300	29.2	EAGLE RANCH
75127		9/05/1974	SUPP IR	WELL 4,7,8	2N	28E	2	NENW	300	33.3	EAGLE RANCH
75127		9/05/1974	SUPP IR	WELL 4,7,8	2N	28E	2	NWNW	300	32.2	EAGLE RANCH
75127		9/05/1974	SUPP IR	WELL 4,7,8	2N	28E	2	SWNW	300	27.8	EAGLE RANCH
75127		9/05/1974	SUPP IR	WELL 4,7,8	2N	28E	2	SESW	300	30.0	EAGLE RANCH
75127		9/05/1974	SUPP IR	WELL 4,7,8	2N	28E	2	NESE	500	19.1	EAGLE RANCH
75127		9/05/1974	SUPP IR	WELL 4,7,8	2N	28E	2	NWSE	500	30.0	EAGLE RANCH
75127		9/05/1974	SUPP IR	WELL 4,7,8	2N	28E	2	SWSE	600	35.2	EAGLE RANCH
75127		9/05/1974	SUPP IR	WELL 4,7,8	2N	28E	2	SESE	600	22.8	EAGLE RANCH

Total										606.6
GRAND TOTAL										606.8

Received
MAR 21 2025

TABLE 2. – PROPOSED PLACE OF USE-TO LANDS

OWRD

WATER RIGHT		PRIORITY DATE	USE (IR/IS)	POD #	LEGAL DESCRIPTION					ACRES	WATER USER
Cert/Decree	Permit				TWP	RNG	SEC	QQ	TAX LOT		
75127		9/05/1974	SUPP IR	WELL 4,7,8	3N	28E	9	NENE	2900	31.0	EAGLE RANCH
75127		9/05/1974	SUPP IR	WELL 4,7,8	3N	28E	9	NWNE	2900	34.1	EAGLE RANCH
75127		9/05/1974	SUPP IR	WELL 4,7,8	3N	28E	9	SWNE	3000	35.2	EAGLE RANCH
75127		9/05/1974	SUPP IR	WELL 4,7,8	3N	28E	9	SENE	2900	29.5	EAGLE RANCH
75127		9/05/1974	SUPP IR	WELL 4,7,8	3N	28E	9	NENW	2900	30.7	EAGLE RANCH
75127		9/05/1974	SUPP IR	WELL 4,7,8	3N	28E	9	NWNW	2900	33.8	EAGLE RANCH
75127		9/05/1974	SUPP IR	WELL 4,7,8	3N	28E	9	SWNW	2900	35.9	EAGLE RANCH
75127		9/05/1974	SUPP IR	WELL 4,7,8	3N	28E	9	SENW	3000	31.1	EAGLE RANCH
75127		9/05/1974	SUPP IR	WELL 4,7,8	3N	28E	10	NENW	2900	28.3	EAGLE RANCH
75127		9/05/1974	SUPP IR	WELL 4,7,8	3N	28E	10	NWNW	2900	33.9	EAGLE RANCH
75127		9/05/1974	SUPP IR	WELL 4,7,8	3N	28E	10	SWNW	2900	34.4	EAGLE RANCH
75127		9/05/1974	SUPP IR	WELL 4,7,8	3N	28E	10	SENW	2900	28.8	EAGLE RANCH
75127		9/05/1974	SUPP IR	WELL 4,7,8	3N	28E	17	NESW	1200	10.1	EAGLE RANCH
75127		9/05/1974	SUPP IR	WELL 4,7,8	3N	28E	17	SESW	1200	5.8	EAGLE RANCH
75127		9/05/1974	SUPP IR	WELL 4,7,8	3N	28E	17	NESE	1300	.6	EAGLE RANCH
75127		9/05/1974	SUPP IR	WELL 4,7,8	3N	28E	17	NWSE	1300	19.1	EAGLE RANCH
75127		9/05/1974	SUPP IR	WELL 4,7,8	3N	28E	17	SWSE	1300	35.9	EAGLE RANCH
75127		9/05/1974	SUPP IR	WELL 4,7,8	3N	28E	17	SESE	1300	24.7	EAGLE RANCH
75127		9/05/1974	SUPP IR	WELL 4,7,8	3N	28E	21	NESW	6900	31.2	EAGLE RANCH
75127		9/05/1974	SUPP IR	WELL 4,7,8	3N	28E	21	NWSW	6800	30.7	EAGLE RANCH
75127		9/05/1974	SUPP IR	WELL 4,7,8	3N	28E	21	SWSW	6900	31.0	EAGLE RANCH
75127		9/05/1974	SUPP IR	WELL 4,7,8	3N	28E	21	SESW	6800	31.0	EAGLE RANCH
Total										606.8	

Received
MAR 21 2025

OWRD

CERTIFICATE 79715 MAP 4 OF 6

TABLE 1. – AUTHORIZED PLACE OF USE-FROM LANDS

WATER RIGHT		PRIORITY DATE	USE (IR/IS)	LEGAL DESCRIPTION						ACRES	WATER USER
Cert/Decree	Permit			POD #	TWP	RNG	SEC	Q-Q	TAX LOT		
76715		3/14/1903	IR	WID	3N	28E	14	SW NW	4400	25.3	EAGLE RANCH
76715		3/14/1903	IR	WID	3N	28E	14	SE NW	4400	33.5	EAGLE RANCH
76715		3/14/1903	IR	WID	3N	28E	14	NE SW	4400	14.3	EAGLE RANCH
76715		3/14/1903	IR	WID	3N	28E	14	SW SW	4400	11.0	EAGLE RANCH
76715		3/14/1903	IR	WID	3N	28E	15	SE NE	4400	2.4	EAGLE RANCH
76715		3/14/1903	IR	WID	3N	28E	15	NW SE	4400	6.5	EAGLE RANCH
76715		3/14/1903	IR	WID	3N	28E	15	SE SE	4400	2.5	EAGLE RANCH
Total										95.5	

TABLE 2. – PROPOSED PLACE OF USE-TO LANDS

WATER RIGHT		PRIORITY DATE	USE (IR/IS)	POD #	LEGAL DESCRIPTION				TAX LOT	ACRES	WATER USER
Cert/Decree	Permit				TWP	RNG	SEC	QQ			
76715		3/14/1903	SUPP IR	WID	3N	28E	29	NENW	8100	28.7	EAGLE RANCH
76715		3/14/1903	SUPP IR	WID	3N	28E	29	NWNW	8100	33.1	EAGLE RANCH
76715		3/14/1903	SUPP IR	WID	3N	28E	29	SWNW	8100	33.1	EAGLE RANCH
76715		3/14/1903	SUPP IR	WID	3N	28E	29	SENW	8100	0.1	EAGLE RANCH
76715		3/14/1903	SUPP IR	WID	3N	28E	30	NENE	8100	0.2	EAGLE RANCH
76715		3/14/1903	SUPP IR	WID	3N	28E	30	SENE	8100	0.3	EAGLE RANCH
Total									95.5		

CERTIFICATE 53732 MAP 5 OF 6

TABLE 1. – AUTHORIZED PLACE OF USE-FROM LANDS

WATER RIGHT		PRIORITY DATE	USE (IR/IS)	LEGAL DESCRIPTION						ACRES	WATER USER
Cert/Decree	Permit			POD #	TWP	RNG	SEC	Q-Q	TAX LOT		
53732		2/07/1974	IR	WID	3N	28E	14	NE SW	4400	12.3	EAGLE RANCH
53732		2/07/1974	IR	WID	3N	28E	15	SW SE	4400	22.0	EAGLE RANCH
53732		2/07/1974	IR	WID	3N	28E	15	SE SE	4400	14.7	EAGLE RANCH
Total										49.0	

TABLE 2. – PROPOSED PLACE OF USE-TO LANDS

WATER RIGHT		PRIORITY DATE	USE (IR/IS)	POD #	LEGAL DESCRIPTION				TAX LOT	ACRES	WATER USER
Cert/Decree	Permit				TWP	RNG	SEC	QQ			
53732		2/07/1974	SUPP IR	WID	3N	28E	20	NENE	6700	31.8	EAGLE RANCH
53732		2/07/1974	SUPP IR	WID	3N	28E	20	NWNE	6700	17.2	EAGLE RANCH
Total									49.0		

CERTIFICATE 79439 MAP 5 OF 6

CERTIFICATE 79439 MAP 5 OF 6

Received
MAR 21 2025
OWRD

TABLE 1. – AUTHORIZED PLACE OF USE-FROM LANDS

WATER RIGHT		PRIORITY DATE	USE (IR/IS)	LEGAL DESCRIPTION						ACRES	WATER USER
Cert/Decree	Permit			POD #	TWP	RNG	SEC	Q-Q	TAX LOT		
79439		3/14/1903	SUPP IR	WID	3N	28E	8	SW SE	700	23.0	EAGLE RANCH
79439		3/14/1903	SUPP IR	WID	3N	28E	14	SWNW	4400	25.3	EAGLE RANCH
79439		3/14/1903	SUPP IR	WID	3N	28E	14	SENW	4400	33.5	EAGLE RANCH
79439		3/14/1903	SUPP IR	WID	3N	28E	15	NWSW	4400	14.3	EAGLE RANCH
79439		3/14/1903	SUPP IR	WID	3N	28E	15	SWSW	4400	11.0	EAGLE RANCH
79439		3/14/1903	SUPP IR	WID	3N	28E	15	SENE	4400	2.4	EAGLE RANCH
79439		3/14/1903	SUPP IR	WID	3N	28E	15	NESE	4400	6.5	EAGLE RANCH
79439		3/14/1903	SUPP IR	WID	3N	28E	15	SESE	4400	2.5	EAGLE RANCH
Total										118.5	

TABLE 2. – PROPOSED PLACE OF USE-TO LANDS

WATER RIGHT		PRIORITY DATE	USE (IR/IS)	POD #	LEGAL DESCRIPTION					ACRES	WATER USER
Cert/Decree	Permit				TWP	RNG	SEC	QQ	TAX LOT		
79439		3/14/1903	SUPP IR	WID	3N	28E	25	SWNE	7402	5.3	EAGLE RANCH
79439		3/14/1903	SUPP IR	WID	3N	28E	25	SENW	7402	4.9	EAGLE RANCH
79439		3/14/1903	SUPP IR	WID	3N	28E	25	NESW	7402	6.1	EAGLE RANCH
79439		3/14/1903	SUPP IR	WID	3N	28E	25	NWSE	7402	6.7	EAGLE RANCH
79439		3/14/1903	SUPP IR	WID	3N	28E	29	NENW	8100	28.7	EAGLE RANCH
79439		3/14/1903	SUPP IR	WID	3N	28E	29	NWNW	8100	33.1	EAGLE RANCH
79439		3/14/1903	SUPP IR	WID	3N	28E	29	SWNW	8100	33.1	EAGLE RANCH
79439		3/14/1903	SUPP IR	WID	3N	28E	29	SENW	8100	0.1	EAGLE RANCH
79439		3/14/1903	SUPP IR	WID	3N	28E	30	NENE	8100	0.2	EAGLE RANCH
79439		3/14/1903	SUPP IR	WID	3N	28E	30	SENE	8100	0.3	EAGLE RANCH
Total										118.5	

TABLE 1. – AUTHORIZED PLACE OF USE-FROM LANDS

WATER RIGHT		PRIORITY DATE	USE (IR/IS)	LEGAL DESCRIPTION						ACRES	WATER USER
Cert/Decree	Permit			POD #	TWP	RNG	SEC	Q-Q	TAX LOT		
76722		2/23/1976	IR	WID	3N	28E	8	SW SE	700	23.0	EAGLE RANCH
Total										23.0	

Received
MAR 21 2025
OWRD

TABLE 2. – PROPOSED PLACE OF USE-TO LANDS

WATER RIGHT		PRIORITY DATE	USE (IR/IS)	POD #	LEGAL DESCRIPTION					ACRES	WATER USER
Cert/Decree	Permit				TWP	RNG	SEC	QQ	TAX LOT		
76722		2/23/1976	SUPP IR	WID	3N	28E	25	SWNE	7402	5.3	EAGLE RANCH
76722		2/23/1976	SUPP IR	WID	3N	28E	25	SESW	7402	4.9	EAGLE RANCH
76722		2/23/1976	SUPP IR	WID	3N	28E	25	NESW	7402	6.1	EAGLE RANCH
76722		2/23/1976	SUPP IR	WID	3N	28E	25	NWSE	7402	6.7	EAGLE RANCH
Total										23.0	

Received
 MAR 21 2025
 OWRD

CERTIFICATE 80652 MAP 6 OF 6

TABLE 1. – AUTHORIZED PLACE OF USE-FROM LANDS

WATER RIGHT		PRIORITY DATE	USE (IR/IS)	LEGAL DESCRIPTION						ACRES	WATER USER
Cert/Decree	Permit			POD #	TWP	RNG	SEC	Q-Q	TAX LOT		
80652		3/26/1974	SUPP IRR	WELL 2,3,5,6	3N	28E	8	SW SE	7402	8.9	EAGLE RANCH
80652		3/26/1974	SUPP IRR	WELL 2,3,5,6	3N	28E	25	SE SW	7402	8.1	EAGLE RANCH
80652		3/26/1974	SUPP IRR	WELL 2,3,5,6	3N	28E	25	SW SE	7400	9.5	EAGLE RANCH
80652		3/26/1974	SUPP IRR	WELL 2,3,5,6	3N	28E	35	NW NE	7400	5.4	EAGLE RANCH
80652		3/26/1974	SUPP IRR	WELL 2,3,5,6	3N	28E	35	SW NE	7400	5.3	EAGLE RANCH
80652		3/26/1974	SUPP IRR	WELL 2,3,5,6	3N	28E	35	SE NW	7400	6.8	EAGLE RANCH
80652		3/26/1974	SUPP IRR	WELL 2,3,5,6	3N	28E	35	NE SW	7400	29.0	EAGLE RANCH
80652		3/26/1974	SUPP IRR	WELL 2,3,5,6	3N	28E	35	NE SE	7400	37.6	EAGLE RANCH
80652		3/26/1974	SUPP IRR	WELL 2,3,5,6	3N	28E	35	NW SE	7400	33.8	EAGLE RANCH
80652		3/26/1974	SUPP IRR	WELL 2,3,5,6	3N	28E	35	SW SE	7400	30.2	EAGLE RANCH
80652		3/26/1974	SUPP IRR	WELL 2,3,5,6	3N	28E	35	SE SE	7402	8.5	EAGLE RANCH
80652		3/26/1974	SUPP IRR	WELL 2,3,5,6	3N	28E	36	NW NE	7402	8.2	EAGLE RANCH
Total										191.3	

TABLE 2. – PROPOSED PLACE OF USE-TO LANDS

WATER RIGHT		PRIORITY DATE	USE (IR/IS)	POD #	LEGAL DESCRIPTION				TAX LOT	ACRES	WATER USER
Cert/Decree	Permit				TWP	RNG	SEC	QQ			
80652		3/26/1974	SUPP IRR	WELL 2,3,5,6	3N	28E	15	NESW	4501	31.2	EAGLE RANCH
80652		3/26/1974	SUPP IRR	WELL 2,3,5,6	3N	28E	15	NWSW	4501	6.05	EAGLE RANCH

80652		3/26/1974	SUPP IRR	WELL 2,3,5,6	3N	28E	16	NESW	3101	29.6	EAGLE RANCH
80652		3/26/1974	SUPP IRR	WELL 2,3,5,6	3N	28E	16	NWSW	3101	32.2	EAGLE RANCH
80652		3/26/1974	SUPP IRR	WELL 2,3,5,6	3N	28E	16	SWSW	3101	34.75	EAGLE RANCH
80652		3/26/1974	SUPP IRR	WELL 2,3,5,6	3N	28E	16	SESW	3101	39.0	EAGLE RANCH
80652		3/26/1974	SUPP IRR	WELL 2,3,5,6	3N	28E	16	SESE	3101	43.5	EAGLE RANCH
Total										191.3	

CERTIFICATE 76050 (T-9591) MAP 6 OF 6

TABLE 1. – AUTHORIZED PLACE OF USE-FROM LANDS

WATER RIGHT		PRIORITY DATE	USE (IR/IS)	LEGAL DESCRIPTION						ACRES	WATER USER
Cert/Decree	Permit			POD #	TWP	RNG	SEC	Q-Q	TAX LOT		
T-9591		4/22/1955	IR	WID	3N	28E	21	SESE	6800	6.0	EAGLE RANCH
Total										6.0	

TABLE 2. – PROPOSED PLACE OF USE-TO LANDS

WATER RIGHT		PRIORITY DATE	USE (IR/IS)	POD #	LEGAL DESCRIPTION				TAX LOT	ACRES	WATER USER
Cert/Decree	Permit				TWP	RNG	SEC	QQ			
T-9591		4/22/1955	SUPP IR	WID	3N	28E	15	SESW	4501	6.0	EAGLE RANCH
Total										6.0	

CERTIFICATE 95542 MAP 6 OF 6

TABLE 1. – AUTHORIZED PLACE OF USE-FROM LANDS

WATER RIGHT		PRIORITY DATE	USE (IR/IS)	LEGAL DESCRIPTION						ACRES	WATER USER
Cert/Decree	Permit			POD #	TWP	RNG	SEC	Q-Q	TAX LOT		
95542		3/26/1974	IR	WELL 2,3,5,6	3N	28E	21	SESE	6800	6.0	EAGLE RANCH
Total										6.0	

TABLE 2. – PROPOSED PLACE OF USE-TO LANDS

WATER RIGHT		PRIORITY DATE	USE (IR/IS)	POD #	LEGAL DESCRIPTION				TAX LOT	ACRES	WATER USER
Cert/Decree	Permit				TWP	RNG	SEC	QQ			
95542		3/26/1974	SUPP IR	WELL 2,3,5,6	3N	28E	15	SESW	4501	6.0	EAGLE RANCH
Total										6.0	

Received
MAR 21 2025
OWRD

EAGLE RANCH 2025 PILOT PROJECT SB 267 TEMP TRANSFER
 T2N & T3N RANGE 28 E WM
 FROM MAP 1 OF 6

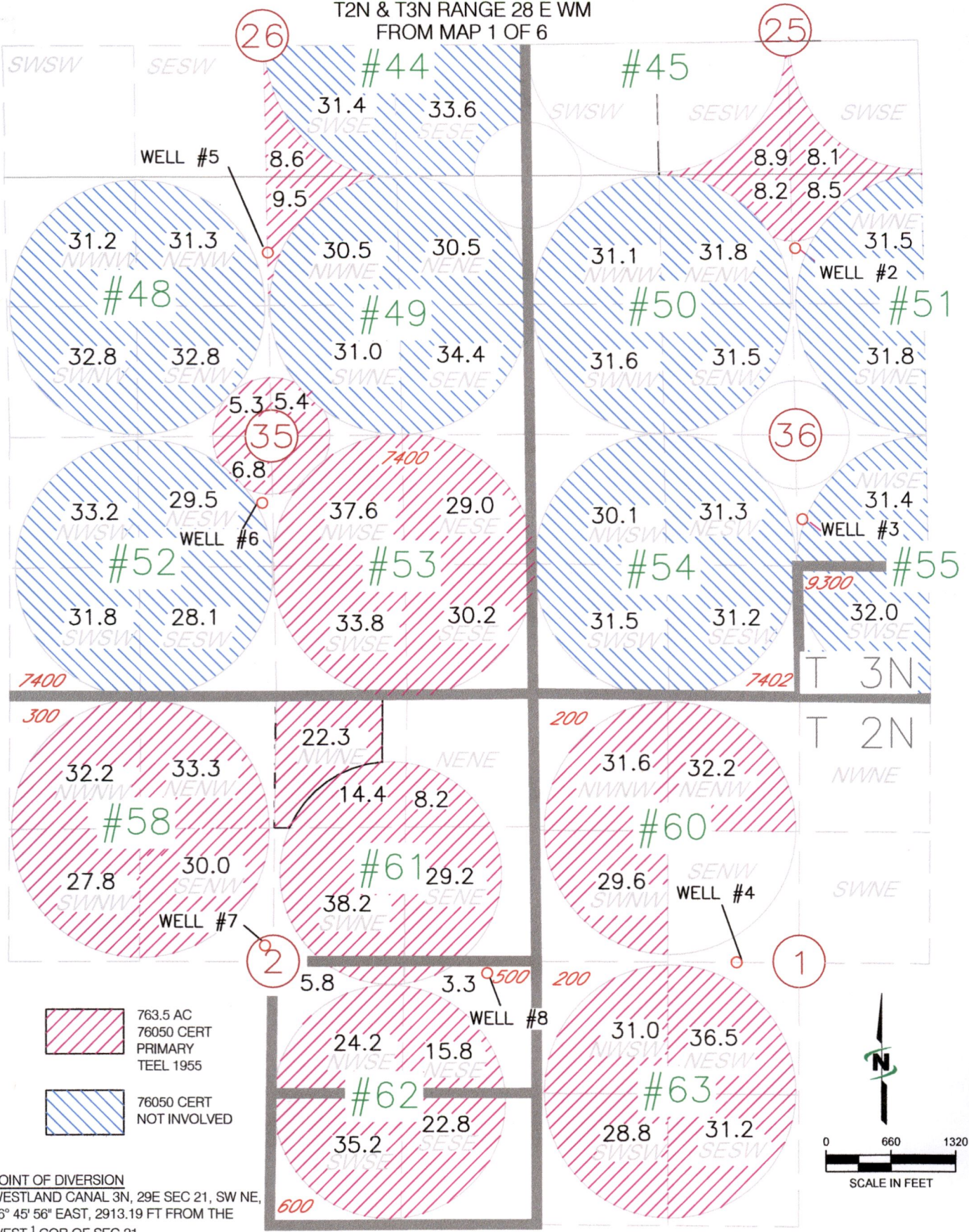

 763.5 AC
 76050 CERT
 PRIMARY
 TEEL 1955

 76050 CERT
 NOT INVOLVED

POINT OF DIVERSION
 WESTLAND CANAL 3N, 29E SEC 21, SW NE,
 76° 45' 56" EAST, 2913.19 FT FROM THE
 WEST ¼ COR OF SEC 21

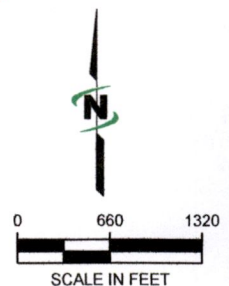

EAGLE RANCH 2025 PILOT PROJECT SB 267 TEMP TRANSFER
T2N RANGE 28 E WM
FROM MAP 3 OF 6

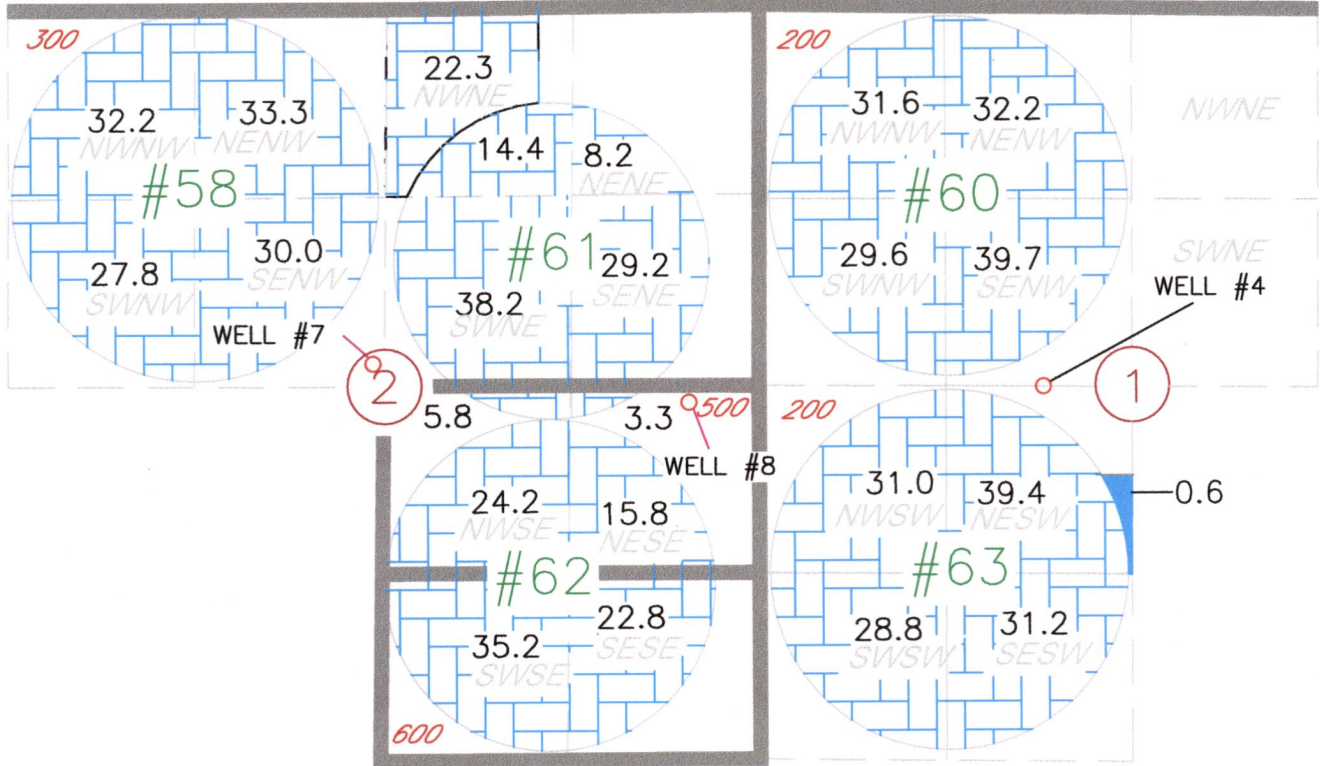

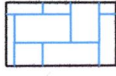
-  0.6 AC
75127 CERT
PRIMARY
PRIOR 1974
-  606.2 AC
75127 CERT
SUPPLEMENTAL
PRIOR 1974

POINTS OF APPROPRIATION
WELL 4
2N, 28E SEC 1, SE NW, 2640 FT S. & 630 FT W.
FROM THE N $\frac{1}{4}$ COR OF SEC 1

WELL 7
2N, 28E SEC 2, SE NW, 2500 FT S. & 2580 FT E.
FROM THE NW COR OF SEC 2

WELL 8
2N, 28E SEC 2, NE SE, 2800 FT S. & 500 FT W.
FROM THE NE COR OF SEC 2

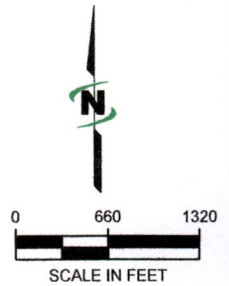

Received
MAR 21 2025

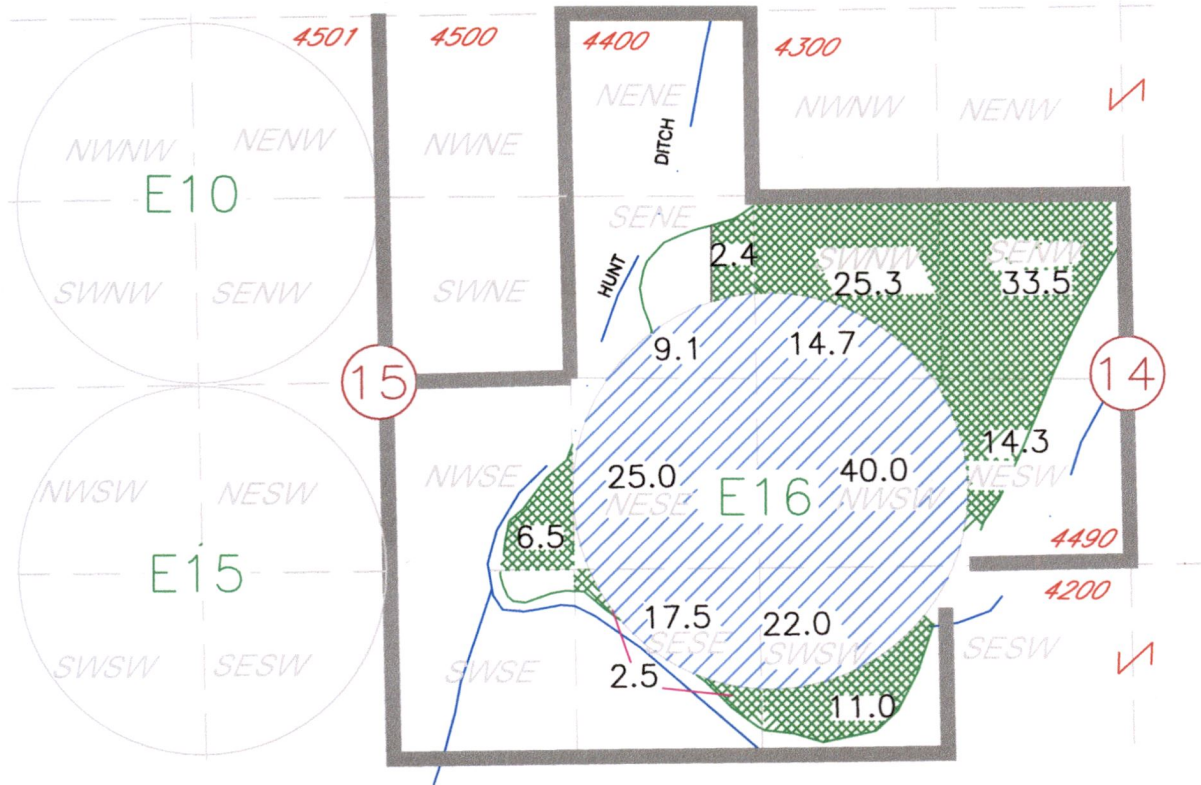

14630 - OWRD

EAGLE RANCH 2025 PILOT PROJECT SB 267 TEMP TRANSFER
T3N RANGE 28 E WM
FROM MAP 4 OF 6



-  128.3 AC
76715 CERT
NOT INVOLVED
-  95.5 AC
76715 CERT
PRIMARY
WESTLAND 1903

POINT OF DIVERSION
WESTLAND CANAL 3N, 29E SEC 21, SW NE,
76° 45' 56" EAST, 2913.19 FT FROM THE
WEST ¼ COR OF SEC 21

Received
MAR 21 2025

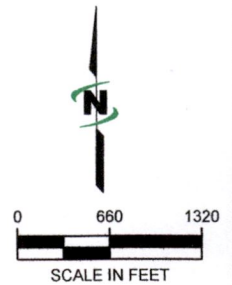

14630 - OWRD

EAGLE RANCH 2025 PILOT PROJECT SB 267 TEMP TRANSFER
T3N RANGE 28 E WM
FROM MAP 5 OF 6

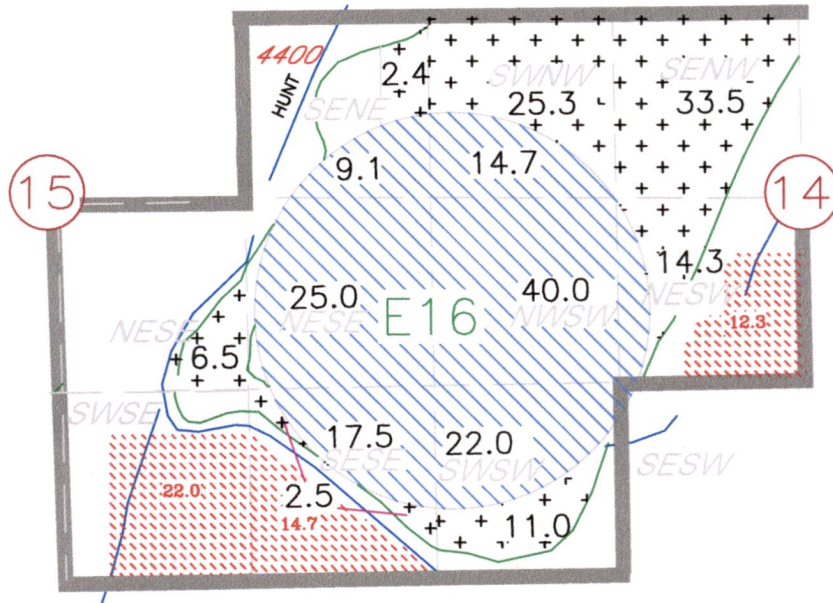
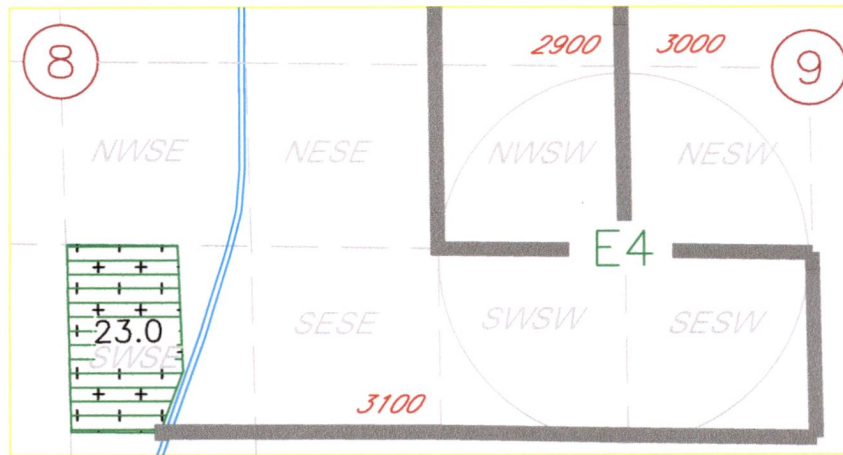

49.0 AC
53732 CERT
PRIMARY
JC WATSON CO 1974

118.5 AC
79439 CERT
SUPPLEMENTAL
MCKAY 1924

128.3 AC
79439 CERT
NOT INVOLVED

23.0 AC
76722 CERT
PRIMARY
WESTLAND 1976

POINT OF DIVERSION
WESTLAND CANAL 3N, 29E SEC 21, SW NE,
76° 45' 56" EAST, 2913.19 FT FROM THE
WEST 1/4 COR OF SEC 21

Received
MAR 21 2025
OWRD

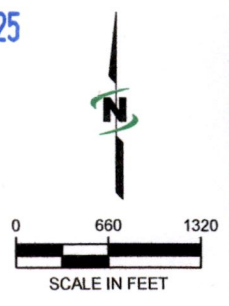

EAGLE RANCH 2025 PILOT PROJECT SB 267 TEMP TRANSFER
T3N RANGE 28 E WM
FROM MAP 6 OF 6

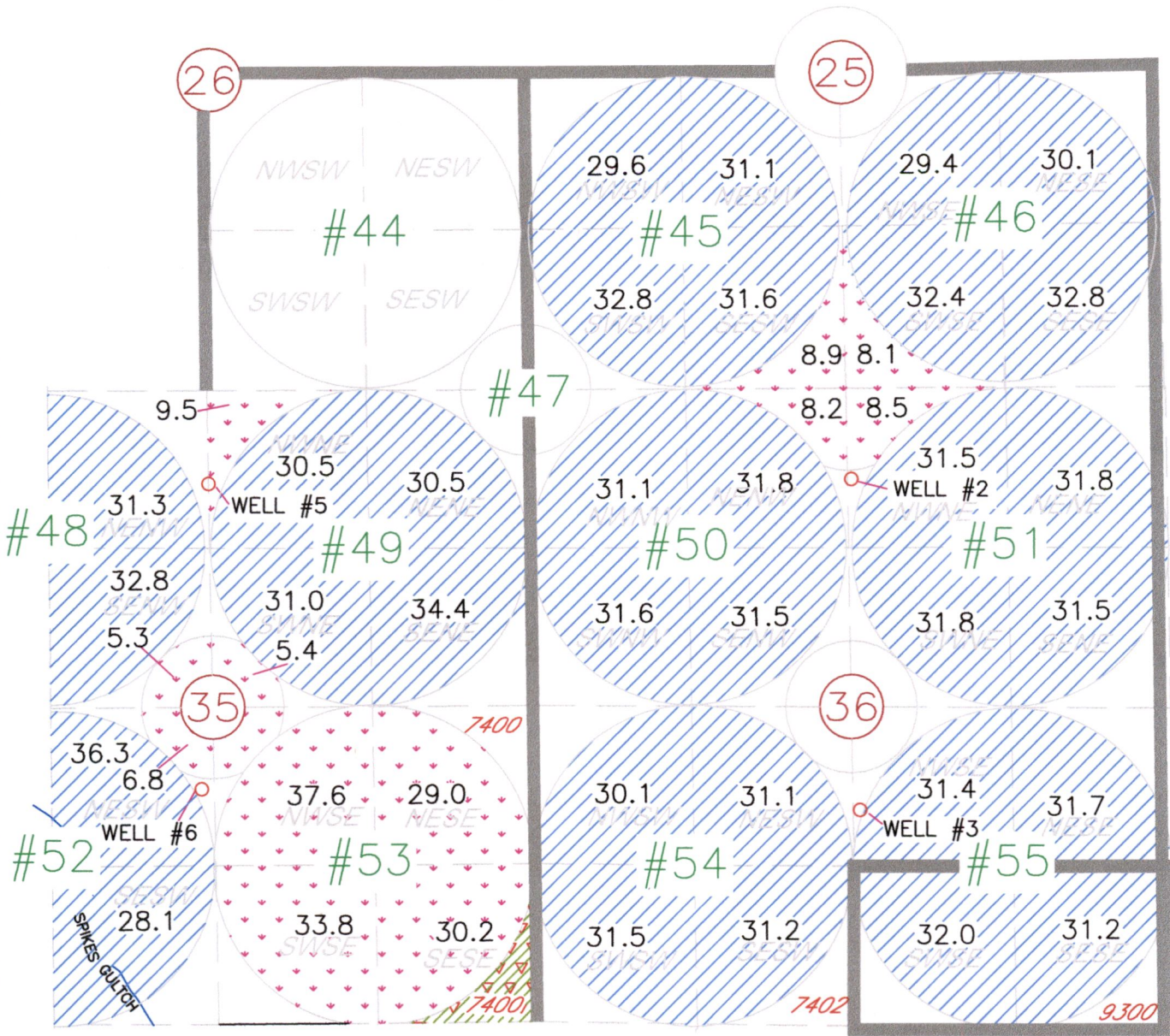

191.3 AC
80652 CERT
SUPPLEMENTAL
PRIOR 1974



6 AC
T-9591
76050 CERT
PRIMARY
TEEL 1974



6 AC
95542 CERT
PRIMARY
PRIOR 1974



1007.4 AC
80652 CERT
NOT INVOLVED

POINT OF APPROPRIATION

WELL 2
3N, 28E SEC 36, NW NE, 750 FT S AND 2620 FT W FROM THE NE COR OF SEC 36

WELL 3
3N, 28E SEC 36, NW SE, 1780 FT N AND 2600 FT W FROM THE SE COR OF SEC 36

WELL 5
3N, 28E SEC 35, NW NE, 770 FT S AND 2640 FT E FROM THE NW COR OF SEC 35

WELL 6
3N, 28E SEC 35, NE SW, 1940 FT N AND 2540 FT E FROM THE SW COR OF SEC 35

POINT OF DIVERSION

WESTLAND CANAL 3N, 29E SEC 21, SW NE,
76° 45' 56" EAST, 2913.19 FT FROM THE
WEST 1/4 COR OF SEC 21

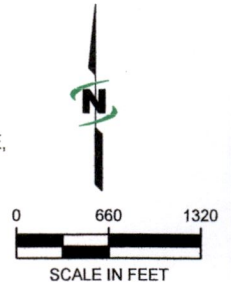

Received

MAR 21 2025

OWRD

DRAWING: \\MYCLODEX2ULTRA\Public\Work\Eagle Ranch\2025\Temp Transfer\District Transfer\2024 TEMP TRANSFER.dwg

14630 -

EAGLE RANCH 2025 PILOT PROJECT SB 267 TEMP TRANSFER
 T2N & T3N RANGE 28 E WM
 TO MAP 1 OF 6
 PART 1 OF 2 FOR CERT 76050

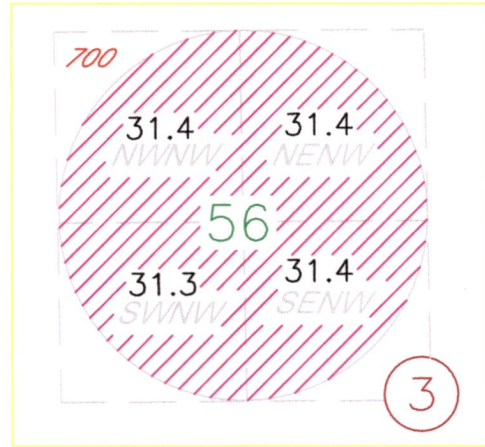
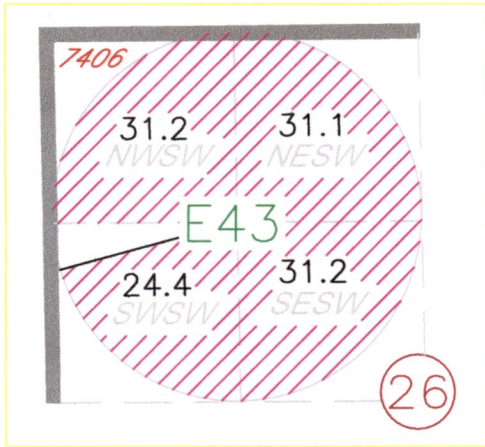
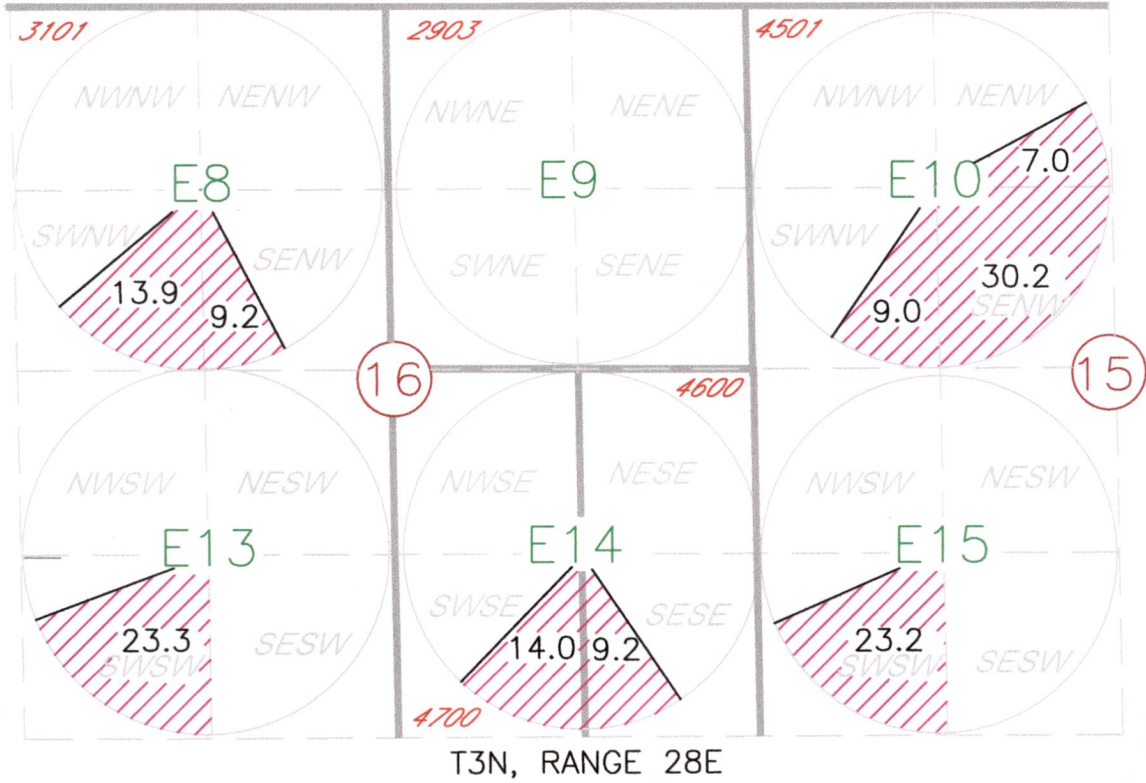

Received
 MAR 21 2025

OWRD

Received
 MAR 21 2025

OWRD

 763.5 AC
 76050 CERT
 SUPPLEMENTAL
 TEEL 1955

POINT OF DIVERSION
 WESTLAND CANAL 3N, 29E SEC 21, SW NE, 76° 45' 56"
 EAST, 2913.19 FT FROM THE WEST ¼ COR OF SEC 21

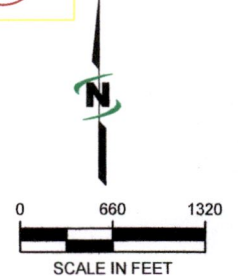

EAGLE RANCH 2025 PILOT PROJECT SB 267 TEMP TRANSFER
T3N RANGE 28 E WM
TO MAP 1 OF 6
PART 2 OF 2 FOR CERT 76050

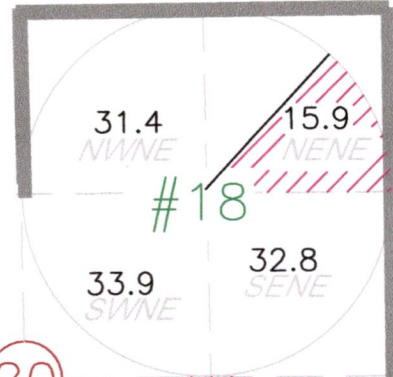
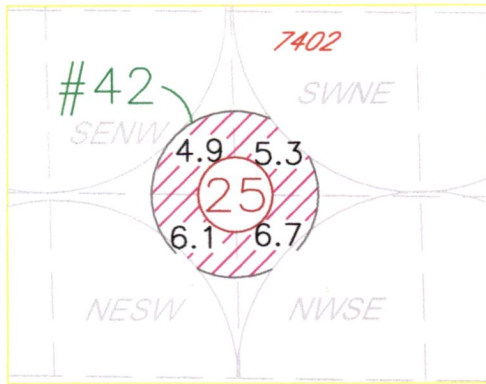

20



0.2 NENE
0.3 SENE

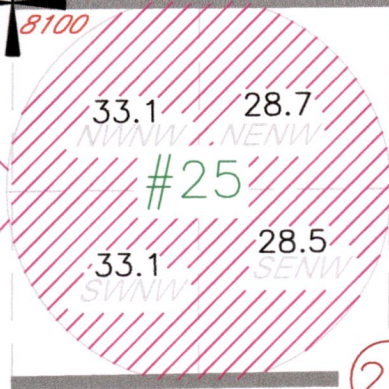

29

POINT OF DIVERSION
WESTLAND CANAL 3N, 29E SEC 21,
SW NE, 76° 45' 56" EAST, 2913.19 FT
FROM THE WEST 1/4 COR OF SEC 21



763.5 AC
76050 CERT
SUPPLEMENTAL
TEEL 1955

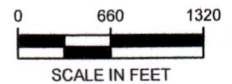

Received
MAR 21 2025
OWRD

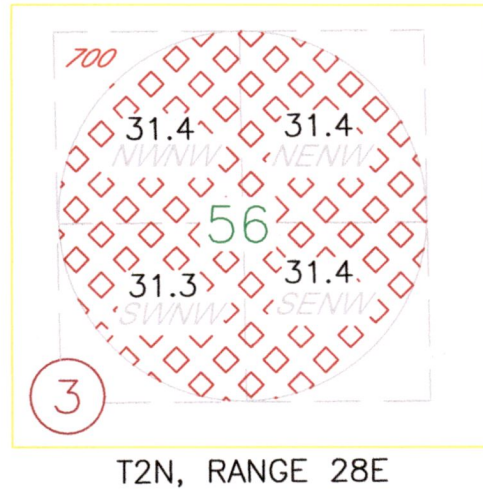
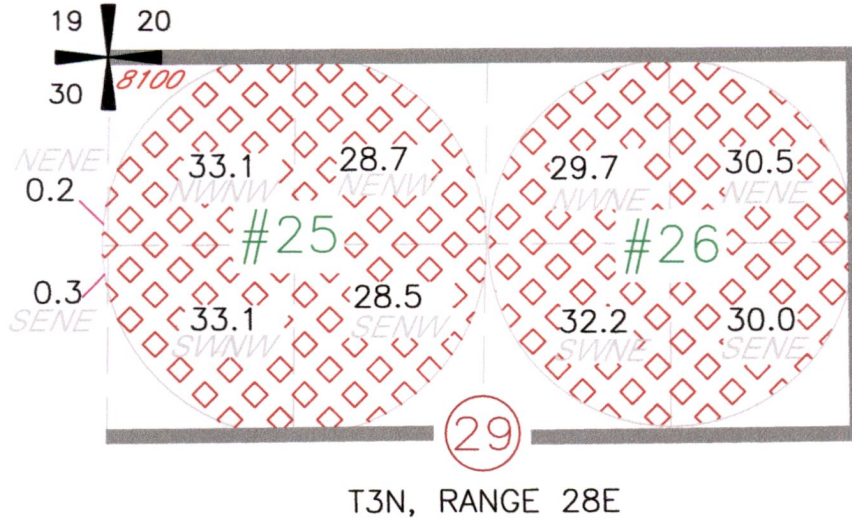

EAGLE RANCH 2025 PILOT PROJECT SB 267 TEMP TRANSFER
 T2N & T3N RANGE 28 E WM
 TO MAP 2 OF 6
 PART 1 OF 2 FOR CERT 95532



Received
 MAR 21 2025
 OWRD

  816.1 AC
 95532 CERT
 SUPPLEMENTAL SURFACE WR
 PRIOR 1981

POINT OF DIVERSION
 WESTLAND CANAL 3N, 29E SEC 21, SW NE,
 76° 45' 56" EAST, 2913.19 FT FROM THE
 WEST 1/4 COR OF SEC 21

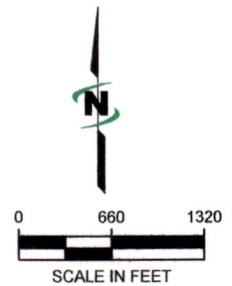

EAGLE RANCH 2025 PILOT PROJECT SB 267 TEMP TRANSFER
T3N RANGE 28 E WM
TO MAP 3 OF 6

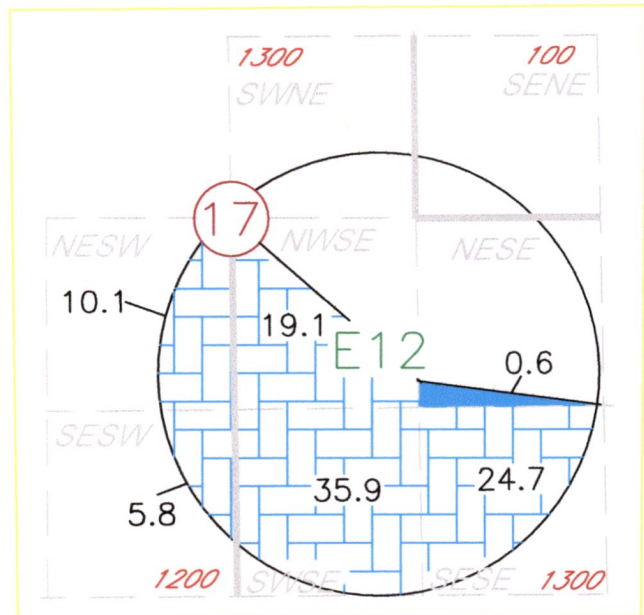
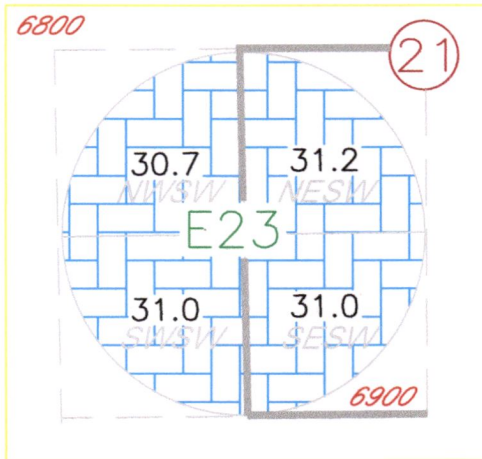
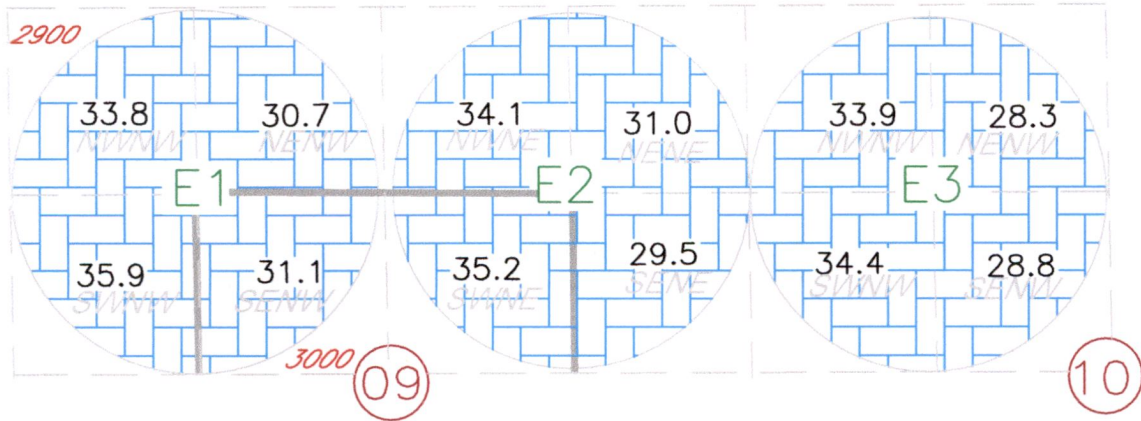

Received
MAR 21 2025
OWRD

POINTS OF APPROPRIATION

WELL 4

2N, 28E SEC 1, SE NW, 2640 FT S. & 630 FT
W. FROM THE N $\frac{1}{4}$ COR OF SEC 1

WELL 7

2N, 28E SEC 2, SE NW, 2500 FT S. & 2580 FT
E. FROM THE NW COR OF SEC 2

WELL 8

2N, 28E SEC 2, NE SE, 2800 FT S. & 500 FT
W. FROM THE NE COR OF SEC 2



606.8 AC
75127 CERT
SUPPLEMENTAL
PRIOR 1974

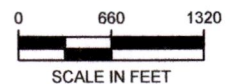

EAGLE RANCH 2025 PILOT PROJECT SB 267 TEMP TRANSFER
T3N RANGE 28 E WM
TO MAP 4 OF 6

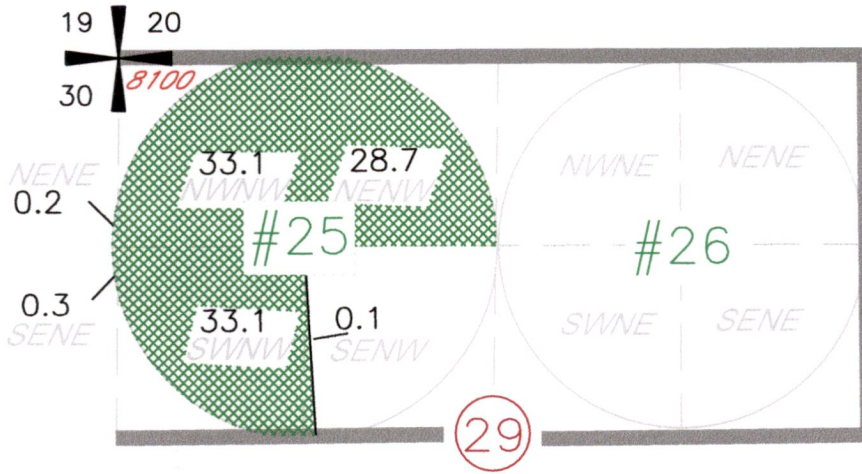

Received
MAR 21 2025
OWRD

 95.5 AC
76715 CERT
SUPPLEMENTAL
WESTLAND 1903

POINT OF DIVERSION
WESTLAND CANAL 3N, 29E SEC 21, SW NE,
76° 45' 56" EAST, 2913.19 FT FROM THE
WEST 1/4 COR OF SEC 21

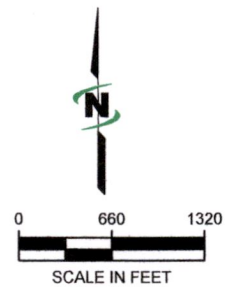

EAGLE RANCH 2025 PILOT PROJECT SB 267 TEMP TRANSFER
T2N & T3N RANGE 28 E WM
TO MAP 5 OF 6

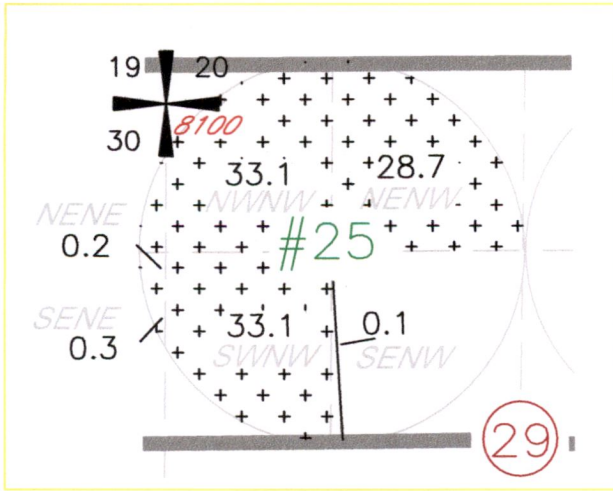

T3N 28E

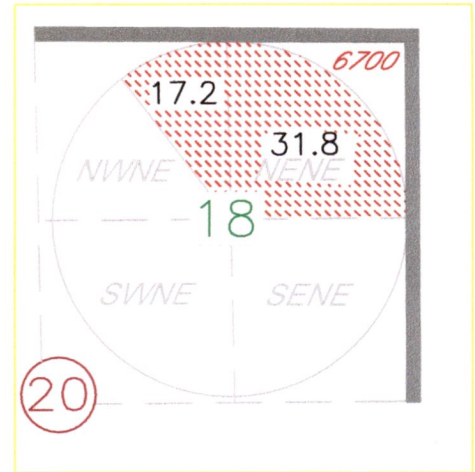

T2N 28E

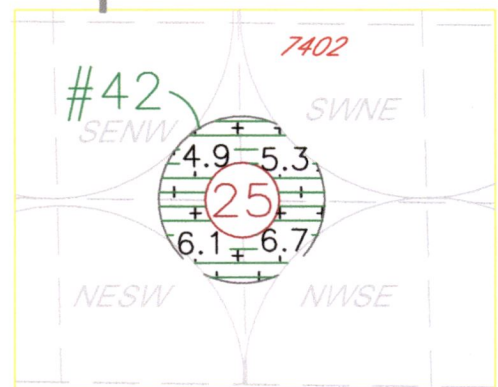

T3N 28E

Received
MAR 21 2025

OWRD

118.5 AC
79439 CERT
SUPPLEMENTAL
MCKAY 1924

POINT OF DIVERSION
WESTLAND CANAL 3N, 29E SEC 21, SW NE,
76° 45' 56" EAST, 2913.19 FT FROM THE
WEST ¼ COR OF SEC 21

23.0 AC
76722 CERT
SUPPLEMENTAL
WESTLAND 1976

49.0 AC
53732 CERT
SUPPLEMENTAL
JC WATSON CO 1974

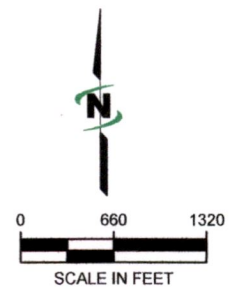

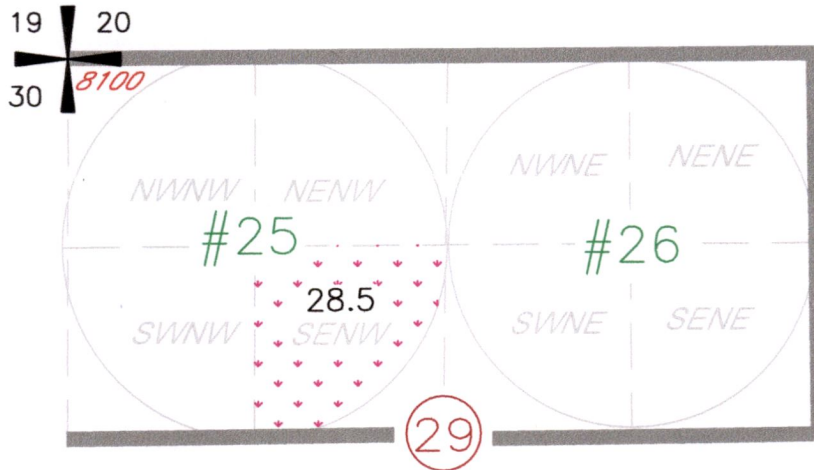
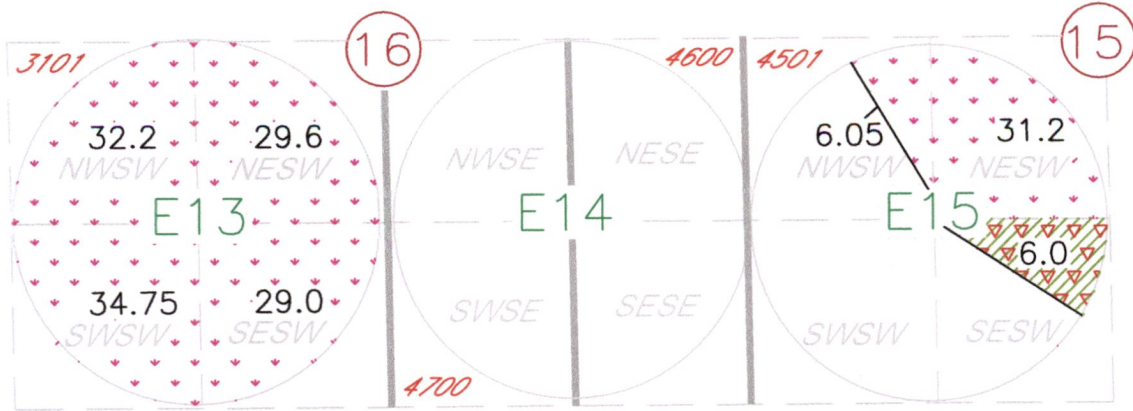

EAGLE RANCH 2025 PILOT PROJECT SB 267 TEMP TRANSFER
 T3N RANGE 28 E WM
 TO MAP 6 OF 6



Received
 MAR 21 2025

OWRD

- 

191.3 AC
 80652 CERT
 SUPPLEMENTAL
 PRIOR 1974
- 

6 AC
 T-9591
 76050 CERT
 SUPPLEMENTAL
 TEEL 1974
- 

6 AC
 95542 CERT
 SUPPLEMENTAL
 PRIOR 1974

POINT OF APPROPRIATION

- WELL 2
 3N, 28E SEC 36, NW NE, 750 FT S AND 2620 FT W FROM THE NE COR OF SEC 36
- WELL 3
 3N, 28E SEC 36, NW SE, 1780 FT N AND 2600 FT W FROM THE SE COR OF SEC 36
- WELL 5
 3N, 28E SEC 35, NW NE, 770 FT S AND 2640 FT E FROM THE NW COR OF SEC 35
- WELL 6
 3N, 28E SEC 35, NE SW, 1940 FT N AND 2540 FT E FROM THE SW COR OF SEC 35

POINT OF DIVERSION

WESTLAND CANAL 3N, 29E SEC 21, SW NE,
 76° 45' 56" EAST, 2913.19 FT FROM THE
 WEST ¼ COR OF SEC 21

