

Regular

Name James & Sue Gilmore

Address 30427 Stellmacher Drive
Albany OR 97321

Change in POU/POA

Date Filed 5/18/2023

Initial notice date _____

DPD issued date _____

PD issued date _____

PD notice date _____

Date of FO 12/26/2024 Vol 133 Page 616-617

C-Date _____

COBU due date _____

COBU Received date _____

Certificate issued _____

Assignments: _____

Irrigation District _____

Agent All Points Engineering & Surveying Inc

CWRE _____

CC's list Harney County

- Oversized map - Location _____

DESCRIPTION OF WATER RIGHT(S)

Name of Stream Aweu

Trib. of Malheur Lake Basin

Use Irrigation County _____

Quantity of water (CFS) _____ No. of Acres _____

Name of ditch _____

App# 612154 Per # 611230 Cert # 93211 PR Date 6/27/1990

App# _____ Per # _____ Cert # _____ PR Date _____

App# _____ Per # _____ Cert # _____ PR Date _____

App# _____ Per # _____ Cert # _____ PR Date _____

App# _____ Per # _____ Cert # _____ PR Date _____

FEES PAID		
Date	Amount	Receipt #
<u>5-18-2023</u>	<u>\$ 3,340.⁰⁰</u>	<u>140737</u>

FEES REFUNDED		
Date	Amount	Receipt #
<u>12/31/2024</u>	<u>\$881.⁵⁰</u>	<u>VP059330</u>

WATER RESOURCES DEPARTMENT
REQUEST FOR DISTRIBUTION OF FUNDS

TO: **Fiscal Services Section**

DATE: 12-20-24

FROM: Dante Luongo, Transfer Specialist
Phone: 971-304-5006

SUBJECT: **TRANSFER FILE - Request for Payment or Refund**

TRANSFER FILE #: T-14246

RECEIPT #: 140737

Please prepare payment in the amount of \$ 881.50 , made payable to:

Name: JAMES AND SUE GILMOUR
Organization
Address: 30427 STELLMACHER DR
City: ALBANY, OR 97320

46110
0205

These funds are being paid or refunded as a result of (check one):

- Request for file to be Rejected/Withdrawn/Misfiled
- Excess fees were collected for application/PON
- Payment of PON
- Protest filing fee
- Other:

I have reviewed this distribution request and have determined the request to be justified as to the purpose indicated above. Fiscal Services is hereby authorized to process the requested distribution.

Authorized Signature:

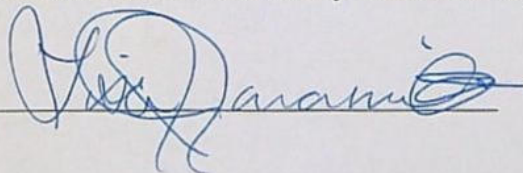

Date:

12-20-2024



Oregon

Tina Kotek, Governor

Water Resources Department

North Mall Office Building

725 Summer St NE, Suite A

Salem, OR 97301

Phone 503 986-0900

Fax 503 986-0904

December 26, 2024

James Gilmour
30427 SW Stellmacher Dr
Albany, OR 97320

ORDER ON WITHDRAWN APPLICATION

Reference: Transfer Application T-14246

The above referenced transfer application was withdrawn from the record of the Water Resources Department on December 26, 2024, by Special Order Volume 133, Page 616 (copy enclosed).

The transfer application is no further force or effect.

If you have any questions related to the withdrawal of this transfer, you may contact your caseworker, Dante Luongo, by telephone at (971) 304-5006 or by e-mail at Dante.j.luongo@water.oregon.gov.

Sincerely,

Elyse D. Richman
Water Right Services Support
Transfers and Conservation Section

cc: Donald (dally) S. Swindlehurst, Watermaster Dist. # 10 (via email)
Scott D. Montgomery, Agent
County of Harney Planning Department, Local Government

Enclosure

BEFORE THE WATER RESOURCES DEPARTMENT
OF THE
STATE OF OREGON

In the Matter of Transfer Application)	FINAL ORDER WITHDRAWING
T-14246, Harney County)	AN APPLICATION FOR A WATER RIGHT
)	TRANSFER

Authority

ORS 540.505 to 540.580 establishes the process in which a water right holder may submit a request to transfer the point of diversion, place of use, or character of use authorized under an existing water right.

Applicant

JAMES AND SUE GILMOUR
30427 STELLMACHER DR
ALBANY, OR 97320

Findings of Fact

1. Transfer Application T-14246, in the name of JAMES AND SUE GILMOUR, was filed on May 24, 2023, to change the point of appropriation and to change the place of use under Certificate 93211.
2. On August 29, 2024, the Department mailed a copy of the draft Preliminary Determination proposing to deny Transfer Application T-14246 to the applicants. The Department determined the proposed point of appropriation (POA) does not develop the same aquifer as the exiting POA. The draft Preliminary Determination cover letter set forth a deadline of September 28, 2024, for the applicants to respond.
3. On November 22, 2024, applicants Jim and Sue Gilmour, submitted a request via email that Transfer Application T-14246 be withdrawn.

This final order is subject to judicial review by the Court of Appeals under ORS 183.482. Any petition for judicial review must be filed within the 60-day time period specified by ORS 183.482(1). Pursuant to ORS 536.075 and OAR 137-003-0675, you may petition for judicial review or petition the Director for reconsideration of this order. A petition for reconsideration may be granted or denied by the Director, and if no action is taken within 60 days following the date the petition was filed, the petition shall be deemed denied.

Now, therefore, it is ORDERED:

Transfer Application T-14246, in the name of James and Sue Gilmour, is withdrawn and is of no further force or effect.

Dated in Salem, Oregon on **DEC 26 2024**

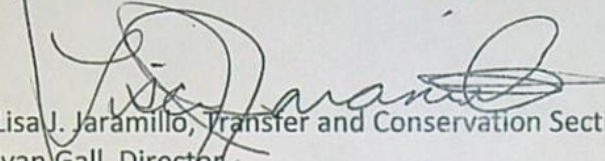
Lisa J. Jaramillo, Transfer and Conservation Section Manager, for
Ivan Gall, Director
Oregon Water Resources Department

Mailing date: DEC 27 2024

WATER RIGHT TRANSFER COVER SHEET

Transfer: T-14246

Transfer Specialist:

Transfer Type: Regular Transfer

Reimbursement Authority?

Dante L.

Applicant: JAMES GILMOUR 30427 SW STELLMACHER DR ALBANY, OR 97320	Agent: SCOTT D. MONTGOMERY PO BOX 767 TERREBONNE, OR 97760	Receiving Landowner:
Current Landowner if other than Applicant:	CWRE:	Irrigation District:
Affected Local Gov'ts: County Of Harneyplanning Department	Affected Tribal Gov't:	BOR Notified (date):

Water Rights Affected

File Marked	App. File # or Decree Name	Permit	Certificate	RR/CR Needed	RR/CR Nos.
<input type="checkbox"/>	G12154	G11230	93211	<input type="checkbox"/> Yes <input type="checkbox"/> No	
<input type="checkbox"/>				<input type="checkbox"/> Yes <input type="checkbox"/> No	
<input type="checkbox"/>				<input type="checkbox"/> Yes <input type="checkbox"/> No	

Key Dates & Initial Actions (Support Staff)

Rec'd: May 24, 2023	Proposed Action(s): POINT OF APPROPRIATION; PLACE OF USE	
Fees Pd: UNAVAILABLE	Acknowledgement Letter Sent <input type="checkbox"/>	Basin: 12 Malheur Lake
Initial Public Notice:	County sent cc: of Ack Letter <input type="checkbox"/>	County: HARNEY
WM District: 10 J R. Johnson	WM Review request sent:	WM Review date received:
ODFW District:	ODFW Review sent:	ODFW Review date received:
Groundwater	GW Review sent:	GW Review date received:

Caseworker Actions: Newspaper & PD Notice:

Newspaper notice needed: <input type="checkbox"/>	Name of Newspaper:
Newspaper notice sent to coordinator:	Newspaper notice quote requested (NRS1):
Request for news \$ sent:	News \$ received:
Affidavit of publication received:	Last day of publication:

Peer Review:

Document	Drafted	Peer Review	Coordinator	Changes Made	Signature Bin	Signature Date
DPD	Date: <u>6-8-24</u> Initials: <u>AZ</u>	Date: _____ Initials: _____	Date: <u>8-21-24</u> Initials: <u>CC</u>	Date: <u>8-25-24</u> Initials: <u>AZ</u>	CW Sent: _____ WM Sheet <input type="checkbox"/> ODFW Sheet: <input type="checkbox"/>	N/A
PD	Date: _____ Initials: _____	Date: _____ Initials: _____	Date: <u>8</u> Initials: _____	Date: _____ Initials: _____ Data Review Date: _____	Date: _____	Date: _____
FO	Date: <u>12-1-24</u> Initials: <u>AZ</u>	Date: <u>12-2-24</u> Initials: <u>SG</u>	Date: <u>12-19-24</u> Initials: <u>CC</u>	Date: <u>12-20-24</u> Initials: <u>AZ</u>	Date: <u>12-20-24</u> No. of docs for sig: <u>2</u>	Date: <u>12/26/24</u>

Special Issues: _____

Special Order Volume: Vol. 133 Pages 616-617

Groundwater Transfer Review Summary Form

Transfer/PA # T- 14246

GW Reviewer Darrick E. Boschmann Date Review Completed: 12/18/2023

Summary of Same Source Review:

The proposed change in point of appropriation is not within the same aquifer as per OAR 690-380-2110(2).

Summary of Injury Review:

The proposed transfer will result in another, existing water right not receiving previously available water to which it is legally entitled or result in significant interference with a surface water source as per 690-380-0100(3).

Summary of GW-SW Transfer Similarity Review:

The proposed SW-GW transfer doesn't meet the definition of "similarly" as per OAR 690-380-2130.

This is only a summary. Documentation is attached and should be read thoroughly to understand the basis for determinations.



Oregon Water Resources Department
 725 Summer Street NE, Suite A
 Salem, Oregon 97301-1271
 (503) 986-0900
 www.wrd.state.or.us

Ground Water Review Form:

- Water Right Transfer
- Permit Amendment
- GR Modification
- Other

Application: T-14246

Applicant Name: Gilmour

- Proposed Changes: POA APOA SW→GW RA
 USE POU OTHER

Reviewer(s): Darrick E. Boschmann

Date of Review: 12/18/2023

Date Reviewed by GW Mgr. and Returned to WRSD: _____

The information provided in the application is insufficient to evaluate whether the proposed transfer may be approved because:

- The water well reports provided with the application do not correspond to the water rights affected by the transfer.
- The application does not include water well reports or a description of the well construction details sufficient to establish the ground water body developed or proposed to be developed.
- Other _____

1. Basic description of the changes proposed in this transfer: _____

This application is related to certificate 93211 which authorizes groundwater pumping from 2 wells (POD 1 = HARN 1033; POD 2 = HARN 1047) for primary irrigation of 254.6 acres in the Malheur Lake Basin. The following changes are proposed:

1. Change POD 2 (HARN 1047) to HARN 52285*.
2. Transfer 126.6 acres of the POU.

*The application Table 1 lists the proposed well as HARN 52885, which is an alteration log for a well located many miles away down the Blitzen Valley. The application also includes a copy of alteration log HARN 52885. The application map lists HARN 52285, which corresponds to a well with a GWIS location consistent with that depicted on the application map. Note that the current GWIS location is auto-mapped in the center of the TRSQQ with a horizontal error of 1320 feet. It is assumed HARN 52285 is the intended well.

The proposed well HARN 52285 is a livestock well with no original drillers' well log. The well was drilled at some unknown time prior to 1977. Very little information is available about this well, and it is unknown if this well meets minimum well construction standards. No new use should be authorized for this well until it is verified that the well meets minimum well construction standards.

2. Will the proposed POA develop the same aquifer (source) as the existing authorized POA?
 Yes No Comments: _____

Groundwater occurs in multiple hydrostratigraphic units, and groundwater within these units is hydraulically connected, making a single groundwater system composed of multiple hydrostratigraphic units (Gingerich and others, 2022).

In general, groundwater in the Harney Basin flows from several upland recharge areas to a common discharge area near Malheur and Harney Lakes, with some apparent discharge to the Malheur Basin through one area along the eastern margin. While the rocks and sediments making up the aquifer system in the Harney Basin do constitute a single groundwater flow system, sub-watersheds within the basin contribute recharge to different parts of the system depending on groundwater flow-paths from recharge to discharge areas. In general, within these sub-watersheds water within the aquifer system is sourced from a common recharge area and can therefore be considered a single source.

The currently authorized well is located approximately 2.5 miles northwest of Crane, in an area where groundwater flow is generally to the west/southwest toward Malheur Lake. The proposed well is located nearly 14 miles south of the location of the authorized well, about 2 miles south of Princeton in an area where groundwater flow is to the southeast toward the Malheur River basin.

3. a) Is there more than one source developed under the right (e.g., basalt and alluvium)?
 Yes No _____
- b) If yes, estimate the portion of the right supplied by each of the sources and describe any limitations that will need to be placed on the proposed change (rate, duty, etc.): _____
4. a) Will this proposed change, at its maximum allowed rate of use, likely result in an increase in interference with **another ground water right**?
 Yes No Comments: The proposed well is located nearly 14 miles south of the currently authorized well. This will result in an incremental increase in interference with existing wells at the proposed location.
- b) If yes, would this proposed change, at its maximum allowed rate of use, likely result in another groundwater right not receiving the water to which it is legally entitled?
 Yes No If yes, explain: Any increase in interference with existing wells in will not meet the standard for substantial or undue interference given the thickness of the aquifer system in the Harney Basin.
5. a) Will this proposed change, at its maximum allowed rate of use, likely result in an increase in interference with **another surface water source**?
 Yes No Comments: There are no perennial surface water sources in the vicinity of the authorized or proposed wells.
- b) If yes, at its maximum allowed rate of use, what is the expected change in degree of interference with any **surface water sources** resulting from the proposed change?
 Stream: _____ Minimal Significant
 Stream: _____ Minimal Significant
 Provide context for minimal/significant impact: _____
6. For SW-GW transfers, will the proposed change in point of diversion affect the surface water source similarly (as per OAR 690-380-2130) to the authorized point of diversion specified in the water use subject to transfer?
 Yes No Comments: _____
7. What conditions or other changes in the application are necessary to address any potential issues identified above: none.
8. Any additional comments: _____

The proposed well HARN 52285 is a livestock well with no original drillers' well log. Very little information is available about this well, and it is unknown if this well meets minimum well construction standards. No new use should be authorized for this well until it is verified that the well meets minimum well construction standards.



Watermaster Review Form: Water Right Transfer



Oregon Water Resources Department
725 Summer Street NE, Suite A
Salem, Oregon 97301-1266
(503) 986-0900
www.oregon.gov/OWRD

Transfer Application: T- 14246

Review Due Date: _____

Applicant Name: James & Sue Gilmour

Proposed Changes: POU POD POA USE OTHER

Reviewer(s): Dally Swindlehurst

Date of Review: 05/30/23

1. Do you have evidence that the right has not been used in the last 5 years and that the presumption of forfeiture would not likely be rebuttable? Yes No If "Yes", attach evidence (e.g. dated aerial photo showing pavement or building on the land for >5 yrs.)
2. Is there a history of regulation on the source that serves this (or these) right(s) that has involved the transferred right(s) and downstream water rights? Yes No
Generally characterize the frequency of any regulation or explain why regulation has not occurred: _____
3. Have headgate notices been issued for the source that serves the transferred right(s)?
 Yes No Records not available.
4. In your estimation, after the proposed change, would distribution of water for the right(s) result in regulation of other water rights that would not have occurred if use under the original right(s) was/were maximized? Yes No If "Yes", explain: _____
5. In your estimation, if the proposed change is approved, are there upstream water rights that would be affected? Yes No If "Yes", describe how the rights would be affected and list the rights most affected: _____
6. Check here if it appears that downstream water rights benefit from return flows resulting from the current use of the transferred right(s)? If you check the box, generally characterize the locations where the return flows likely occur and list the water rights that benefit most: _____. N/A text here
7. For POD changes and instream transfers, check here if there are channel losses between the old and new PODs or within the proposed instream reach? If you check the box, describe and, if possible, estimate the losses: _____. N/A
8. For instream transfers that propose protection of a reach beyond the mouth of the source stream: N/A Would the quantity be measureable into the receiving stream consistent with OAR 690-077-0015(8)? Yes No

9. For POU changes: N/A Is it likely the original place of use would continue to receive water from the same source? Yes No If "Yes", explain: _____
10. For POU or USE changes: N/A In your best judgment, would use of the existing right at "full face value," result in the diversion of more water than can be used beneficially and without waste? Yes No If "Yes", explain: _____
11. For POU changes that involve micro-irrigation: N/A
- a. Has the applicant made changes (absent a transfer) to convert to micro-irrigation within the current place of use boundary of the water right proposed for transfer, and previously demonstrated to the Department through monitoring and site inspections by the Watermaster that the proposed transfer will not result in injury or enlargement? Yes No If "Yes", explain: _____
 - b. Has a temporary transfer of this nature been previously filed and approved on the same lands (or portions thereof) as those lands involved in this transfer? Yes No If "Yes", answer the following:
 - i. Were there any problems with more acres being irrigated (or wetted) than were authorized under the temporary transfer? Yes No
If "Yes", explain: _____
 - ii. Did the designated areas that were to remain dry (or not wetted) under the temporary transfer actually remain dry? Yes No
If "No", explain: _____
 - iii. Did the applicant comply with and meet all of the conditions of the temporary transfer? Yes No If "No", explain: _____
 - iv. Do you have any other observations regarding the temporary transfer? Yes No If "Yes", describe: _____
 - v. Did the applicant demonstrate to the Department through monitoring and site inspections by the Watermaster that neither injury nor enlargement occurred as a result of the temporary transfer? Yes No
If "No", explain: _____
 - c. To the best of your knowledge, if this transfer is approved, does it appear that:
 - i. "Injury" will occur to other water rights that share the same source?
 Yes No If "Yes", explain: _____
 - ii. "Enlargement" of the water right being transferred will occur?
 Yes No If "Yes", explain: _____
12. Are there other issues not identified through the above questions that should be considered in determining whether the change "can be effected without injury to other rights"? Yes No If "Yes", explain: _____

13. What alternatives may be available for addressing any issues identified above: _____

14. Do conditions need to be included in the transfer order to avoid enlargement of the right or injury to other rights? No Yes, as checked and provided below:

For POU changes that involve micro-irrigation, provide the monitoring and reporting conditions necessary to prevent injury/enlargement: _____

A Headgate should be required prior to diverting water.

Measurement Devices for POD or POA: (if this condition is selected, also fill in the top sections of Page 4)

a. Before water use may begin under this order, the water user shall install a **totalizing flow meter***, or, with prior approval of the Director, another suitable measuring device, at each point of diversion/appropriation (new and existing)

OR at each new point of diversion/appropriation

with the exception that water rights issued to the Bureau of Reclamation or an irrigation district (or similar entity) are not subject to this condition.

b. The water user shall maintain the meters or measuring devices in good working order.

c. The water user shall allow the Watermaster access to the meters or measuring devices; provided however, where the meters or measuring devices are located within a private structure, the Watermaster shall request access upon reasonable notice.

Reservoir water use measurement: (if this condition is selected, also fill in the top sections of Page 4)

a. Before water use may begin under this order, the water user shall install **staff gages***, or, with prior approval of the Director, other suitable measuring devices, that measure the entire range and stage between empty and full in each reservoir. Staff gages shall be United States Geological Survey style.

b. Before water use may begin under this order, if the reservoir is located in channel, weirs or other suitable measuring devices must be installed upstream and downstream of the reservoir, and, an adjustable outlet valve must be installed. The water user shall maintain such devices in good working order. A written waiver may be obtained, if in the judgment of the Director, the installation of weirs or other suitable measuring devices, or the adjustable outlet valve, will provide no public benefit.

* The following alternative device(s) should be substituted for the bold, underlined device in the above selected condition:

Weir

Submerged Orifice

Parshall Flume

Flow Restrictor

Other: _____

Oregon Water Resources Department

Measurement Condition Information for the Applicant

(To be sent with the Draft Preliminary Determination or Final Order)

Transfer #: T- 14246

- In order to avoid enlargement of the right or injury to other rights, a _____ will be required to be installed **prior to diversion of water**, as a condition of this transfer:
 - at each point of diversion/appropriation (new and existing) **OR**
 - at each new point of diversion/appropriation.

For additional information, or to obtain approval of a different type of measurement device, the applicant should contact the area Watermaster:

Watermaster name: Dally Swindlehurst

District: 10

Address: 450 N Buena Vista

City/State/Zip: Burns OR 97720

Phone: 541-573-2591

Email: donald.s.swindlehurst@water.oregon.gov

Note: If a device other than the one specified in the Preliminary Determination or Final Order is approved by the Watermaster, fill out and mail the form below to the Salem office.

Approval of an Alternate Measurement Device T- _____
(to be filled out after consultation with the applicant, or after a site visit)

On behalf of the Director, I authorize use of the following suitable alternate measurement device:

Watermaster signature

District

Date

If this form is used for approval of an alternative measurement device, it must be mailed to:

Oregon Water Resources Department
725 Summer Street NE, Suite A
Salem, OR 97301-1266



Oregon

Tina Kotek, Governor

Water Resources Department

North Mall Office Building
725 Summer St NE, Suite A
Salem, OR 97301
Phone 503 986-0900
Fax 503 986-0904

May 24, 2023

JAMES GILMOUR 30427 SW STELLMACHER DR ALBANY, OR 97320

Reference: Application T-14246

On May 24, 2023, the Department received your water right Permanent Transfer Application. The application was accompanied by \$3340.00. Receipt number 140737 is enclosed.

By copy of this letter, we are asking the Watermaster for a report regarding the potential for injury to existing water rights which may be caused by the requested change. A review form will also be sent to groundwater staff to determine whether the proposed well accesses the same source of water as the original well.

This application may require publication of a notice for two consecutive weeks in a newspaper with general circulation in the area where the water right is located. If it is determined that newspaper notice will be required, the Department will prepare the notice and notify you of the cost. You will be responsible for submitting payment to the Department prior to publication of the notice.

Except as provided under ORS 540.510(3) for municipalities, you may not use water for the new use, in the new place of use or from the new point of appropriation until a final order approving the transfer application has been issued by the Department. In order to avoid any possible forfeiture of the water right, you should continue to use the water as described by your existing water right.

If the land is sold before the application is approved, the buyer's consent to the application will be required unless a recorded deed or other legal document clearly established that the water right was not conveyed in the sale.

Refer to the following page for a chart showing the steps and expected timelines for the processing of your application.

If you have any questions, please contact the Transfer Section at (503) 986-0935.

Cc: Watermaster Dist. #10, J R. Johnson (*via email*)
Scott D. Montgomery, Agent
Harney County

Enclosure

**STATE OF OREGON
WATER RESOURCES DEPARTMENT**

725 Summer St. N.E. Ste. A
SALEM, OR 97301-4172
(503) 986-0900 / (503) 986-0904 (fax)

RECEIPT # **140737**

INVOICE # _____

RECEIVED FROM: Silmar Mint Farms LLC
BY: _____

APPLICATION	
PERMIT	
TRANSFER	T-14246

CASH: CHECK: # 2639 OTHER: (IDENTIFY)

TOTAL REC'D	\$3,340.00
-------------	------------

1083 TREASURY 4170 WRD MISC CASH ACCT

0407 COPIES	\$	
OTHER: (IDENTIFY)	\$	
0243 I/S Lease	0244 Muni Water Mgmt. Plan	0245 Cons. Water

4270 WRD OPERATING ACCT

MISCELLANEOUS <u>46110</u>		
0407 COPY & TAPE FEES	\$	
0410 RESEARCH FEES	\$	
0408 MISC REVENUE: (IDENTIFY)	\$	
TC162 DEPOSIT LIAB. (IDENTIFY)	\$	
0240 EXTENSION OF TIME	\$	
WATER RIGHTS:		
0201 SURFACE WATER	EXAM FEE \$	0202 RECORD FEE \$
0203 GROUND WATER	\$	0204 \$
0205 TRANSFER	\$3,340.00	
WELL CONSTRUCTION		
0218 WELL DRILL CONSTRUCTOR	EXAM FEE \$	0219 \$
LANDOWNER'S PERMIT		0220 \$
OTHER (IDENTIFY)		

0536 TREASURY 0437 WELL CONST. START FEE

0211 WELL CONST START FEE	\$	CARD#
0210 MONITORING WELLS	\$	CARD#
OTHER (IDENTIFY)		

0607 TREASURY 0467 HYDRO ACTIVITY LIC NUMBER

0233 POWER LICENSE FEE (FWWRD)		\$
0231 HYDRO LICENSE FEE (FWWRD)		\$
HYDRO APPLICATION		\$

TREASURY OTHER / RDX

FUND _____	TITLE _____
OBJ. CODE _____	VENDOR # _____
DESCRIPTION _____	\$ _____

RECEIPT: **140737** DATED: 5/18/2023 BY: Leslie Miller

Application for Permanent Water Right Transfer



Oregon Water Resources Department
 725 Summer Street NE, Suite A
 Salem, Oregon 97301-1266
 (503) 986-0900
 www.oregon.gov/OWRD

Part 1 of 5 – Minimum Requirements Checklist

This transfer application will be returned if Parts 1 through 5 and all required attachments are not completed and included.
 For questions, please call (503) 986-0900, and ask for Transfer Section.

RECEIVED

MAY 18 2023

OWRD
SALEM, OREGON

Check all items included with this application. (N/A = Not Applicable)

- Part 1 – Completed Minimum Requirements Checklist.
- Part 2 – Completed Transfer Application Map Checklist.
- Part 3 – Application Fee, payable by check to the Oregon Water Resources Department, and completed Fee Worksheet, page 3. Try the new online fee calculator at: http://apps.wrd.state.or.us/apps/misc/wrd_fee_calculator.
- Part 4 – Completed Applicant Information and Signature.
- Part 5 – Information about Water Rights to be Transferred: **How many water rights are to be transferred? 2 List them here: 93211**
 Please include a separate Part 5 for each water right. (See instructions on page 6)
NOTE: A separate transfer application is required for each water right unless the criteria in OAR 690-380-3220 are met.

Attachments:

- Completed Transfer Application Map.
- Completed Evidence of Use Affidavit and supporting documentation.
- N/A Affidavit(s) of Consent from Landowner(s) (if the applicant does not own the land the water right is on.)
- N/A Supplemental Form D – For water rights served by or issued in the name of an irrigation district. Complete when the transfer applicant is not the irrigation district.
- N/A Oregon Water Resources Department’s Land Use Information Form with approval and signature from each local land use authority in which water is to be diverted, conveyed, and/or used. Not required if water is to be diverted, conveyed, and/or used only on federal lands or if **all** of the following apply: a) a change in place of use only, b) no structural changes, c) the use of water is for irrigation only, and d) the use is located within an irrigation district or an exclusive farm use zone.
- N/A Water Well Report/Well Log for changes in point(s) of appropriation (well(s)) or additional point(s) of appropriation.
- N/A Geologist Report for a change from a surface water point of diversion to a ground water point of appropriation (well), if the proposed well is more than 500’ from the surface water source and more than 1000’ upstream or downstream from the point of diversion. See OAR 690-380-2130 for requirements and applicability.

(For Staff Use Only)

WE ARE RETURNING YOUR APPLICATION FOR THE FOLLOWING REASON(S):

<input type="checkbox"/> Application fee not enclosed/insufficient	<input type="checkbox"/> Map not included or incomplete
<input type="checkbox"/> Land Use Form not enclosed or incomplete	<input type="checkbox"/> Evidence of Use Form not enclosed or incomplete
<input type="checkbox"/> Additional signature(s) required	<input type="checkbox"/> Part ____ is incomplete

Other/Explanation _____

Staff: _____ 503- _____ Date: ____/____/____

Part 2 of 5 – Transfer Application Map

Your transfer application will be returned if any of the map requirements listed below are not met.

Please be sure that the transfer application map you submit includes all the required items and matches the existing water right map. Check all boxes that apply.

- N/A Certified Water Right Examiner (CWRE) Stamp and Original Signature. For a list of CWREs, see http://apps.wrd.state.or.us/apps/wr/cwre_license_view/. CWRE stamp and signature are not required for substitutions.
- N/A If **more than three** water rights are involved, separate maps are needed for each water right.
 - Permanent quality printed with dark ink on good quality paper.
 - The size of the map can be 8½ x 11 inches, 8¾ x 14 inches, 11 x 17 inches, or up to 30 x 30 inches. For 30 x 30 inch maps, one extra copy is required.
 - A north arrow, a legend, and scale.
 - The scale of the map must be: 1 inch = 400 feet, 1 inch = 1,320 feet, the scale of the Final Proof/Claim of Beneficial Use Map (the map used when the permit was certificated), the scale of the county assessor map if the scale is not smaller than 1 inch = 1,320 feet, or a scale that has been pre-approved by the Department.
 - Township, Range, Section, ¼ ¼, DLC, Government Lot, and other recognized public land survey lines.
 - Tax lot boundaries (property lines) are required. Tax lot numbers are recommended.
 - Major physical features including rivers and creeks showing direction of flow, lakes and reservoirs, roads, and railroads.
 - Major water delivery system features from the point(s) of diversion/appropriation such as main pipelines, canals, and ditches.
 - Existing place of use that includes separate hachuring for each water right, priority date, and use including number of acres in each quarter-quarter section, government lot, or in each quarter-quarter section as projected within government lots, donation land claims, or other recognized public land survey subdivisions. If less than the entirety of the water right is being changed, a separate hachuring is needed for lands left unchanged.
- N/A Proposed place of use that includes separate hachuring for each water right, priority date, and use including number of acres in each quarter-quarter section, government lot, or in each quarter-quarter section as projected within government lots, donation land claims, or other recognized public land survey subdivisions.
- Existing point(s) of diversion or well(s) with distance and bearing or coordinates from a recognized survey corner. This information can be found in your water right certificate or permit.
- N/A If you are proposing a change in point(s) of diversion or well(s), show the proposed location and label it clearly with distance and bearing or coordinates. If GPS coordinates are used, latitude-longitude coordinates may be expressed as either degrees-minutes-seconds with at least one digit after the decimal (example – 42°32'15.5") or degrees-decimal with five or more digits after the decimal (example – 42.53764°).

Part 4 of 5 – Applicant Information and Signature

Applicant Information

APPLICANT/BUSINESS NAME James & Sue Gilmour		PHONE NO. (541) 979-4120	ADDITIONAL CONTACT NO.
ADDRESS 30427 Stellmacher Drive			FAX NO.
CITY Albany	STATE OR	ZIP 97321	E-MAIL riverbottomfarms@gmail.com
BY PROVIDING AN E-MAIL ADDRESS, CONSENT IS GIVEN TO RECEIVE ALL CORRESPONDENCE FROM THE DEPARTMENT ELECTRONICALLY. COPIES OF THE FINAL ORDER DOCUMENTS WILL ALSO BE MAILED.			

Agent Information – The agent is authorized to represent the applicant in all matters relating to this application.

AGENT/BUSINESS NAME All Points Engineering & Surveying, Inc.		PHONE NO. (541) 548-5833	ADDITIONAL CONTACT NO. (541) 420-0401
ADDRESS P.O. Box 767			FAX NO.
CITY Terrebonne	STATE OR	ZIP 97760	E-MAIL scott@apeands.com
BY PROVIDING AN E-MAIL ADDRESS, CONSENT IS GIVEN TO RECEIVE ALL CORRESPONDENCE FROM THE DEPARTMENT ELECTRONICALLY. COPIES OF THE FINAL ORDER DOCUMENTS WILL ALSO BE MAILED.			

Explain in your own words what you propose to accomplish with this transfer application, and why: Propose to move the POA & POU approximately 12 miles south to land situated closer to the owners other farms for convenience & efficiency

additional space, continue on a separate piece of paper and attach to the application as "Attachment 1".

Check One Box

- By signing this application, I understand that, upon receipt of the draft preliminary determination and prior to Department approval of the transfer, I will be required to provide landownership information and evidence that I am authorized to pursue the transfer as identified in OAR 690-380-4010(5); OR
- I affirm the applicant is a municipality as defined in ORS 540.510(3)(b) and that the right is in the name of the municipality or a predecessor; OR
- I affirm the applicant is an entity with the authority to condemn property and is acquiring by condemnation the property to which the water right proposed for transfer is appurtenant and have supporting documentation.

RECEIVED

MAY 18 2023

OWRD
SALEM, OREGON

By my signature below, I confirm that I understand:

- Prior to Department approval of the transfer application, I may be required to submit payment to the Department for publication of a notice in a newspaper with general circulation in the area where the water right is located, once per week for two consecutive weeks. If more than one qualifying newspaper is available, I suggest publishing the notice in the following newspaper: Burns Times Herald.
- Amendments to the application may only be made in response to the Department's Draft Preliminary Determination (DPD). The applicant will have a period of at least 30 days to amend the application to address any issues identified by the Department in the DPD, or to withdraw the application. Note that amendments may be subject to additional fees, pursuant to ORS 536.050.
- Failure to complete an approved change in place of use and/or change in character of use, will result in loss of the water right (OAR 690-380-6010).
- Refunds may only be granted upon request and, as set forth in ORS 536.050(4)(a), if the Director determines that a refund of all or part of a fee is appropriate in the interests of fairness to the public or necessary to correct an error of the Department.

I (we) affirm that the information contained in this application is true and accurate.

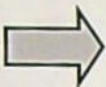

[Signature]
Applicant signature

James Gilmour, Ownerr
Print Name (and Title if applicable)

4/12/23
Date

Sue Gilmour
Applicant signature

Sue Gilmour, Owner
Print Name (and Title if applicable)

4/12/23
Date

Is the applicant the sole owner of the land on which the water right, or portion thereof, proposed for transfer is located? Yes No*

**If NO, include signatures of all deeded landowners (and mailing and/or e-mail addresses if different than the applicant's) or attach affidavits of consent (and mailing and/or e-mail addresses) from all landowners or individuals/entities to which the water right(s) were conveyed.*

Check the following boxes that apply:

- The applicant is responsible for completion of change(s). Notices and correspondence should continue to be sent to the applicant.
- The receiving landowner will be responsible for completing the proposed change(s) after the final order is issued. Copies of notices and correspondence should be sent to this landowner.
- Both the receiving landowner and applicant will be responsible for completion of change(s). Copies of notices and correspondence should be sent to this landowner and the applicant.

At this time, are the lands in this transfer application in the process of being sold? Yes No

If YES, and you know who the new landowner will be, please complete the receiving landowner information table below. If you do not know who the new landowner will be, then a request for assignment will have to be filed for at a later date.

If a property sells, the certificated water right(s) located on the land belong to the new owner, unless a sale agreement or other document states otherwise. For more information see: https://www.oregon.gov/owrd/WRDFormsPDF/Transfer_Property_Transactions.pdf

RECEIVING LANDOWNER NAME			PHONE NO.	ADDITIONAL CONTACT NO.
ADDRESS				FAX NO.
CITY	STATE	ZIP	E-MAIL	
Describe any special ownership circumstances:				
The confirming Certificate shall be issued in the name of: <input type="checkbox"/> Applicant <input type="checkbox"/> Receiving Landowner				

RECEIVED
MAY 18 2023
OWRD
SALEM, OREGON

Check here if any of the water rights proposed for transfer are or will be located within or served by an irrigation or other water district. (Tip: Complete and attach Supplemental Form D.)

IRRIGATION DISTRICT NAME	ADDRESS	
CITY	STATE	ZIP

Check here if water for any of the rights supplied under a water service agreement or other contract for stored water with a federal agency or other entity.

ENTITY NAME	ADDRESS	
CITY	STATE	ZIP



To meet State Land Use Consistency Requirements, you must list all county, city, municipal corporation, or tribal governments within whose jurisdiction water will be diverted, conveyed or used.

ENTITY NAME	ADDRESS	
Harney County	360 N Alvord	
CITY	STATE	ZIP
Burns	OR	97720

RECEIVED

MAY 18 2023

OWRD
SALEM, OREGON

Part 5 of 5 – Water Right Information

Please use a separate Part 5 for each water right being changed. See instructions on page 6, to copy and paste additional Part 5s, or to add additional rows to tables within the form.

CERTIFICATE # 93211

Description of Water Delivery System

System capacity: 1.58 cubic feet per second (cfs) OR
 _____ gallons per minute (gpm)

Describe the current water delivery system or the system that was in place at some time within the last five years. Include information on the pumps, canals, pipelines, and sprinklers used to divert, convey, and apply the water at the authorized place of use.

Table 1. Location of Authorized and Proposed Point(s) of Diversion (POD) or Appropriation (POA)
 (Note: If the POD/POA name is not specified on the certificate, assign it a name or number here.)

POD/POA Name or Number	Is this POD/POA Authorized on the Certificate or is it Proposed?	If POA, OWRD Well Log ID# (or Well ID Tag # L-___)	Twp		Rng		Sec		¼ ¼	Tax Lot, DLC or Gov't Lot	Measured Distances (from a recognized survey corner)
#2	<input checked="" type="checkbox"/> Authorized <input type="checkbox"/> Proposed	HARN 1047	24	S	33	E	36	NW	NE	6903	1260' S & 2635' W from NE cor, Sec 36
Well	<input type="checkbox"/> Authorized <input checked="" type="checkbox"/> Proposed	HARN 52885	27	S	34	E	6	SE	SW	700	1970' s & 3280' w FROM e ¼ COR, Sec 6

Check all type(s) of change(s) proposed below (change "CODES" are provided in parentheses):

- | | |
|--|---|
| <input checked="" type="checkbox"/> Place of Use (POU) | <input type="checkbox"/> Supplemental Use to Primary Use (S to P) |
| <input type="checkbox"/> Character of Use (USE) | <input checked="" type="checkbox"/> Point of Appropriation/Well (POA) |
| <input type="checkbox"/> Point of Diversion (POD) | <input type="checkbox"/> Additional Point of Appropriation (APOA) |
| <input type="checkbox"/> Additional Point of Diversion (APOD) | <input type="checkbox"/> Substitution (SUB) |
| <input type="checkbox"/> Surface Water POD to Ground Water POA (SW/GW) | <input type="checkbox"/> Government Action POD (GOV) |

Will all of the proposed changes affect the entire water right?

- Yes Complete only the Proposed ("to" or "on" lands) section of Table 2 on the next page. Use the "CODES" listed above to describe the proposed changes.
- No Complete all of Table 2 to describe the portion of the water right to be changed.

RECEIVED

MAY 18 2023

OWRD
SALEM, OREGON

Please use and attach additional pages of Table 2 as needed.
See page 6 for instructions.

Do you have questions about how to fill-out the tables?
Contact the Department at 503-986-0900 and ask for Transfer Staff.

Table 2. Description of Changes to Water Right Certificate # 93211

List the change proposed for the acreage in each ¼ ¼. If more than one change is proposed, specify the acreage associated with each change.
If there is more than one POD/POA involved in the proposed changes, specify the acreage associated with each POD/POA.

AUTHORIZED (the "from" or "off" lands) The listing that appears on the certificate BEFORE PROPOSED CHANGES List only that part or portion of the water right that will be changed.											Proposed Changes (see "CODES" from previous page)	PROPOSED (the "to" or "on" lands) The listing as it would appear AFTER PROPOSED CHANGES are made.														
Twp	Rng	Sec	¼	¼	Tax Lot	Gvt Lot or DLC	Acres	Type of USE listed on Certificate	POD(s) or POA(s) (name or number from Table 1)	Priority Date		Twp	Rng	Sec	¼	¼	Tax Lot	Gvt Lot or DLC	Acres	New Type of USE	POD(s)/ POA(s) to be used (from Table 1)	Priority Date				
24	S	33	E	36	NE	SE	6903		31.3	IR	#2	1990	POU/POA	27	S	34	E	6	NW	SE	700		1.2	IR	#2, Well	1990
				NW	SE				31.3											NE	SW			30.5		
					SW	SE			32.0											6	NW	SW			29.5	
					SE	SE			32.0												SW	SW			28.4	
																					SE	SW			37.0	
TOTAL ACRES:								126.6					TOTAL ACRES:								126.6					

Additional remarks: Entire POU supplied by POA 2 proposed to transfer "off" & change POA

RECEIVED

MAY 18 2023

OWRD
SALEM, OREGON

14246

For Place of Use or Character of Use Changes

Are there other water right certificates, water use permits or ground water registrations associated with the "from" or the "to" lands? Yes No

If YES, list the certificate, water use permit, or ground water registration numbers: G-16169.

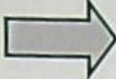
 Pursuant to ORS 540.510, any "layered" water use such as an irrigation right that is supplemental to a primary right proposed for transfer must be included in the transfer or be cancelled. Any change to a ground water registration must be filed separately in a ground water registration modification application.

For Substitution (ground water supplemental irrigation will be substituted for surface water primary irrigation)

Ground water supplemental Permit or Certificate # _____;
Surface water primary Certificate # _____.

RECEIVED
MAY 18 2023
OWRD
SALEM, OREGON

For a change from Supplemental Irrigation Use to Primary Irrigation Use

Identify the primary certificate to be cancelled. Certificate # _____

For a change in point(s) of appropriation (well(s)) or additional point(s) of appropriation:

Well log(s) are attached for each authorized and proposed well(s) that are clearly labeled and associated with the corresponding well(s) in Table 1 above and on the accompanying application map.

Tip: You may search for well logs on the Department's web page at:
http://apps.wrd.state.or.us/apps/gw/well_log/Default.aspx

AND/OR

Describe the construction of the authorized and proposed well(s) in Table 3 for any wells that do not have a well log. For *proposed wells not yet constructed or built*, provide "a best estimate" for each requested information element in the table. The Department recommends you consult a licensed well driller, geologist, or certified water right examiner to assist with assembling the information necessary to complete Table 3.

Table 3. Construction of Point(s) of Appropriation

Any well(s) in this listing must be clearly tied to corresponding well(s) described in Table 1 and shown on the accompanying application map. Failure to provide the information will delay the processing of your transfer application until it is received. The information is necessary for the department to assess whether the proposed well(s) will access the same source aquifer as the authorized point(s) of appropriation (POA). The Department is prohibited by law from approving POA changes that do not access the same source aquifer.

Proposed or Authorized POA Name or Number	Is well already built? (Yes or No)	If an existing well: OWRD Well ID Tag No. L-_____	Total well depth	Casing Diameter	Casing Intervals (feet)	Seal depth(s) (intervals)	Perforated or screened intervals (in feet)	Static water level of completed well (in feet)	Source aquifer (sand, gravel, basalt, etc.)	Well-specific rate (cfs or gpm). If less than full rate of water right
See well logs										

Application for Water Right Transfer

Evidence of Use Affidavit



Oregon Water Resources Department
 725 Summer Street NE, Suite A
 Salem, Oregon 97301-1266
 (503) 986-0900
 www.wrd.state.or.us

Please print legibly or type. Be as specific as possible. Attach additional pages if you need more spacing. Supporting documentation must be attached.

State of Oregon)
) ss
 County of HARNEY)

RECEIVED

MAY 18 2023

OWRD
 SALEM, OREGON

I, JAMES GILMOUR, in my capacity as LANDOWNER,
 mailing address 30427 STELLMACHER DR, ALBANY, OR 97321
 telephone number (541)589-4884, being first duly sworn depose and say:

1. My knowledge of the exercise or status of the water right is based on (check one):

- Personal observation Professional expertise

2. I attest that:

- Water was used during the previous five years on the **entire** place of use for Certificate # 93211; **OR**
- My knowledge is specific to the use of water at the following locations within the last five years:

Certificate #	Township	Range	Mer	Sec	¼ ¼	Gov't Lot or DLC	Acres (if applicable)

- OR**
- Confirming Certificate # ____ has been issued within the past five years; **OR**
- Part or all of the water right was leased instream at some time within the last five years. The instream lease number is: ____ (Note: If the entire right proposed for transfer was not leased, additional evidence of use is needed for the portion not leased instream.); **OR**
- The water right is not subject to forfeiture and documentation that a presumption of forfeiture for non-use would be rebutted under ORS 540.610(2) is attached.
- Water has been used at the actual current point of diversion or appropriation for more than 10 years for Certificate # ____ (For Historic POD/POA Transfers)

(continues on reverse side)

3. The water right was used for: (e.g., crops, pasture, etc.): CROPS

4. I understand that if I do not attach one or more of the documents shown in the table below to support the above statements, my application will be considered incomplete.

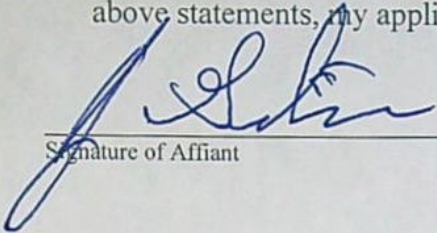
Signature of Affiant

4-21-2023
Date

Signed and sworn to (or affirmed) before me this 21 day of April, 2023.

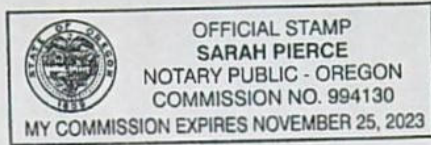

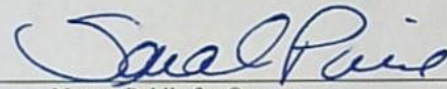
Notary Public for Oregon

My Commission Expires: 11-25-2023

Supporting Documents	Examples
<input type="checkbox"/> Copy of a water right certificate that has been issued within the last five years. (not a remaining right certificate)	Copy of confirming water right certificate that shows issue date
<input type="checkbox"/> Copies of receipts from sales of irrigated crops or for expenditures related to use of water	<ul style="list-style-type: none">• Power usage records for pumps associated with irrigation use• Fertilizer or seed bills related to irrigated crops• Farmers Co-op sales receipt
<input type="checkbox"/> Records such as FSA crop reports, irrigation district records, NRCS farm management plan, or records of other water suppliers	<ul style="list-style-type: none">• District assessment records for water delivered• Crop reports submitted under a federal loan agreement• Beneficial use reports from district• IRS Farm Usage Deduction Report• Agricultural Stabilization Plan• CREP Report
<input checked="" type="checkbox"/> Aerial photos containing sufficient detail to establish location and date of photograph	Multiple photos can be submitted to resolve different areas of a water right. If the photograph does not print with a "date stamp" or without the source being identified, the date of the photograph and source should be added. Sources for aerial photos: OSU – www.oregonexplorer.info/imagery OWRD – www.wrd.state.or.us Google Earth – earth.google.com TerraServer – www.terra-server.com
<input type="checkbox"/> Approved Lease establishing beneficial use within the last 5 years	Copy of instream lease or lease number

RECEIVED

MAY 18 2023

OWRD
SALEM, OREGON

FS

14246 -

JUN 21 1989

24S/33E/36ab

STATE OF OREGON WATER RESOURCES DEPT. WATER WELL REPORT SALEM, OREGON

(START CARD) # 1640

(1) OWNER: Name Gerald A. & Ona L. Lindsey Well Number: Address PO Box 868 City Hines, Or 97738 State Zip

(2) TYPE OF WORK: [X] New Well [] Deepen [] Recondition [] Abandon

(3) DRILL METHOD: [] Rotary Air [] Rotary Mud [X] Cable [] Other

(4) PROPOSED USE: [] Domestic [] Community [] Industrial [X] Irrigation [] Thermal [] Injection [] Other

(5) BORE HOLE CONSTRUCTION: Special Construction approval Yes No Depth of Completed Well 157 ft. Explosives used [] [X] Type Amount

Table with columns: HOLE Diameter, SEAL From, To, Material, Amount sacks or pounds. Row 1: 27", 0, 18, Cement, 0, 18, 16. Row 2: 22", 20, 157.

How was seal placed: Method [] A [] B [X] C [] D [] E Backfill placed from ft. to ft. Material Gravel placed from ft. to ft. Size of gravel

(6) CASING/LINER: Table with columns: Diameter, From, To, Gauge, Steel, Plastic, Welded, Threaded. Casing rows: 23" (+1, 20, 250), 14" (+1.5, 146, 250), 16" (14, 6, 157, 250). Liner row: 157' plug.

(7) PERFORATIONS/SCREENS: [X] Perforations Method saw cut [] Screens Type Material

Table with columns: From, To, Slot size, Number, Diameter, Tele/pipe size, Casing, Liner. Row 1: 32', 146', 1/8"x3"x60"per, 14'.

(8) WELL TESTS: Minimum testing time is 1 hour [X] Pump [] Bailer [] Air [] Artesian Yield gal/min Drawdown Drill stem at Time

Temperature of water 60 Depth Artesian Flow Found Was a water analysis done? No [] Yes [] By whom Did any strata contain water not suitable for intended use? No [] Too little [] Salty [] Muddy [] Odor [] Colored [] Other Depth of strata:

(9) LOCATION OF WELL by legal description: County Harney Latitude Longitude Township 24 S N or S, Range 33E E or W, WM. Section 36 NW 1/4 NE 1/4 Tax Lot 9600 Lot Block Subdivision Street Address of Well (or nearest address)

(10) STATIC WATER LEVEL: 31' ft. below land surface. Date 6/10/89 Artesian pressure lb. per square inch. Date

(11) WATER BEARING ZONES: Table with columns: From, To, Estimated Flow Rate, SWL. Row 1: 49', 137', 1000, 31.

(12) WELL LOG: Ground elevation 4123' MSL. Table with columns: Material, From, To, SWL. Rows: Top soil sandy loam (0-2), Clay/sand fine, brn (2-21), Sand/clay, brn (21-26), Clay grey (26-49), Sand, fine, brn w/b (49-60), Sand fine, brn (60-63), Sand fine, brn (63-70), Sand fine, blk (70-75), Clay grey/sandfine blk (75-83), Sand blk, grey fine (83-137), Clay, grey (137-147), Clay, blue (147-157).

RECEIVED MAY 18 2023 OWHD SALEM OREGON

Date started 5/16/89 Completed 6/6/89

(unbonded) Water Well Constructor Certification: I certify that the work I performed on the construction, alteration, or abandonment of this well is in compliance with Oregon well construction standards. Signed Date WWC Number

(bonded) Water Well Constructor Certification: I accept responsibility for the construction, alteration, or abandonment work performed on this well during the construction dates reported above. Signed Date WWC Number 426

14910

RECEIVED

MAY 18 2023

OWRD
SALEM, OREGON



Oregon Water Resources Department
725 Summer Street NE, Suite A
Salem, Oregon 97301-1266
(503) 986-0900
www.wrd.state.or.us

Land Use Information Form

Applicant(s): James & Sue Gilmour

Mailing Address: 30427 Stellmacher Dr

City: Albany

State: OR

Zip Code: 97321

Daytime Phone: 541-979-4120

A. Land and Location

Please include the following information for all tax lots where water will be diverted (taken from its source), conveyed (transported), and/or used or developed. Applicants for municipal use, or irrigation uses within irrigation districts may substitute existing and proposed service-area boundaries for the tax-lot information requested below.

Township	Range	Section	¼ ¼	Tax Lot #	Plan Designation (e.g., Rural Residential/RR-5)	Water to be:	Proposed Land Use:
<u>27S</u>	<u>34E</u>	<u>6</u>	<u>NW SE</u>	<u>700</u>	<u>EFU</u>	<input type="checkbox"/> Diverted <input type="checkbox"/> Conveyed <input checked="" type="checkbox"/> Used	<u>IR</u>
<u>27S</u>	<u>34E</u>	<u>6</u>	<u>NE SW</u>	<u>SW</u>	<u>EFU</u>	<input type="checkbox"/> Diverted <input checked="" type="checkbox"/> Conveyed <input checked="" type="checkbox"/> Used	<u>IR</u>
<u>27S</u>	<u>34E</u>	<u>6</u>	<u>NW SW</u>		<u>EFU</u>	<input type="checkbox"/> Diverted <input checked="" type="checkbox"/> Conveyed <input checked="" type="checkbox"/> Used	<u>IR</u>
<u>27S</u>	<u>34E</u>	<u>6</u>	<u>SW SW</u>		<u>EFU</u>	<input type="checkbox"/> Diverted <input type="checkbox"/> Conveyed <input checked="" type="checkbox"/> Used	<u>IR</u>
<u>27S</u>	<u>34E</u>	<u>6</u>	<u>SE SW</u>		<u>EFU</u>	<input checked="" type="checkbox"/> Diverted <input checked="" type="checkbox"/> Conveyed <input checked="" type="checkbox"/> Used	<u>IR</u>

List all counties and cities where water is proposed to be diverted, conveyed, and/or used or developed:

Harney

B. Description of Proposed Use

Type of application to be filed with the Water Resources Department:

- Permit to Use or Store Water
 Water Right Transfer
 Permit Amendment or Ground Water Registration Modification
 Limited Water Use License
 Allocation of Conserved Water
 Exchange of Water

Source of water: Reservoir/Pond Ground Water Surface Water (name) _____

Estimated quantity of water needed: 1.58 cubic feet per second gallons per minute acre-feet

Intended use of water: Irrigation Commercial Industrial Domestic for _____ household(s)
 Municipal Quasi-Municipal Instream Other _____

Briefly describe:

Propose to move the POA & POU approximately 12 miles south to land situated closer to the owners other for convenience & efficiency

Note to applicant: If the Land Use Information Form cannot be completed while you wait, please have a local government representative sign the receipt at the bottom of the next page and include it with the application filed with the Water Resources Department.

See bottom of Page 3. →

RECEIVED

MAY 18 2023

OWRD
SALEM, OREGON

For Local Government Use Only

The following section must be completed by a planning official from each county and city listed unless the project will be located entirely within the city limits. In that case, only the city planning agency must complete this form. This deals only with the local land-use plan. Do not include approval for activities such as building or grading permits.

Please check the appropriate box below and provide the requested information

- Land uses to be served by the proposed water uses (including proposed construction) are allowed outright or are not regulated by your comprehensive plan. Cite applicable ordinance section(s): HCZA 3.010 / EFDV-1
- Land uses to be served by the proposed water uses (including proposed construction) involve discretionary land-use approvals as listed in the table below. (Please attach documentation of applicable land-use approvals which have already been obtained. Record of Action/land-use decision and accompanying findings are sufficient.) If approvals have been obtained but all appeal periods have not ended, check "Being pursued."

Type of Land-Use Approval Needed (e.g., plan amendments, rezones, conditional-use permits, etc.)	Cite Most Significant, Applicable Plan Policies & Ordinance Section References	Land-Use Approval:	
		<input type="checkbox"/> Obtained <input type="checkbox"/> Denied	<input type="checkbox"/> Being Pursued <input type="checkbox"/> Not Being Pursued
		<input type="checkbox"/> Obtained <input type="checkbox"/> Denied	<input type="checkbox"/> Being Pursued <input type="checkbox"/> Not Being Pursued
		<input type="checkbox"/> Obtained <input type="checkbox"/> Denied	<input type="checkbox"/> Being Pursued <input type="checkbox"/> Not Being Pursued
		<input type="checkbox"/> Obtained <input type="checkbox"/> Denied	<input type="checkbox"/> Being Pursued <input type="checkbox"/> Not Being Pursued
		<input type="checkbox"/> Obtained <input type="checkbox"/> Denied	<input type="checkbox"/> Being Pursued <input type="checkbox"/> Not Being Pursued
		<input type="checkbox"/> Obtained <input type="checkbox"/> Denied	<input type="checkbox"/> Being Pursued <input type="checkbox"/> Not Being Pursued

Local governments are invited to express special land-use concerns or make recommendations to the Water Resources Department regarding this proposed use of water below, or on a separate sheet.

Name: Brandon McMullen Title: Planning Director
 Signature: [Signature] Phone: (541) 578-6655 Date: 4/17/2023
 Government Entity: Harney County

Note to local government representative: Please complete this form or sign the receipt below and return it to the applicant. If you sign the receipt, you will have 30 days from the Water Resources Department's notice date to return the completed Land Use Information Form or WRD may presume the land use associated with the proposed use of water is compatible with local comprehensive plans.



Receipt for Request for Land Use Information

Applicant name: _____
 City or County: _____ Staff contact: _____
 Signature: _____ Phone: _____ Date: _____

TRANSFER MAP TO ACCOMPANY APPLICATION TO
ADD A POINT OF APPROPRIATION AND CHANGE
PLACE OF USE FOR
JAMES & SUE GILMOUR

TOWNSHIP 24 SOUTH, RANGE 33 EAST, SECTION 36, W.M.
TAX LOT: 6903

"FROM"

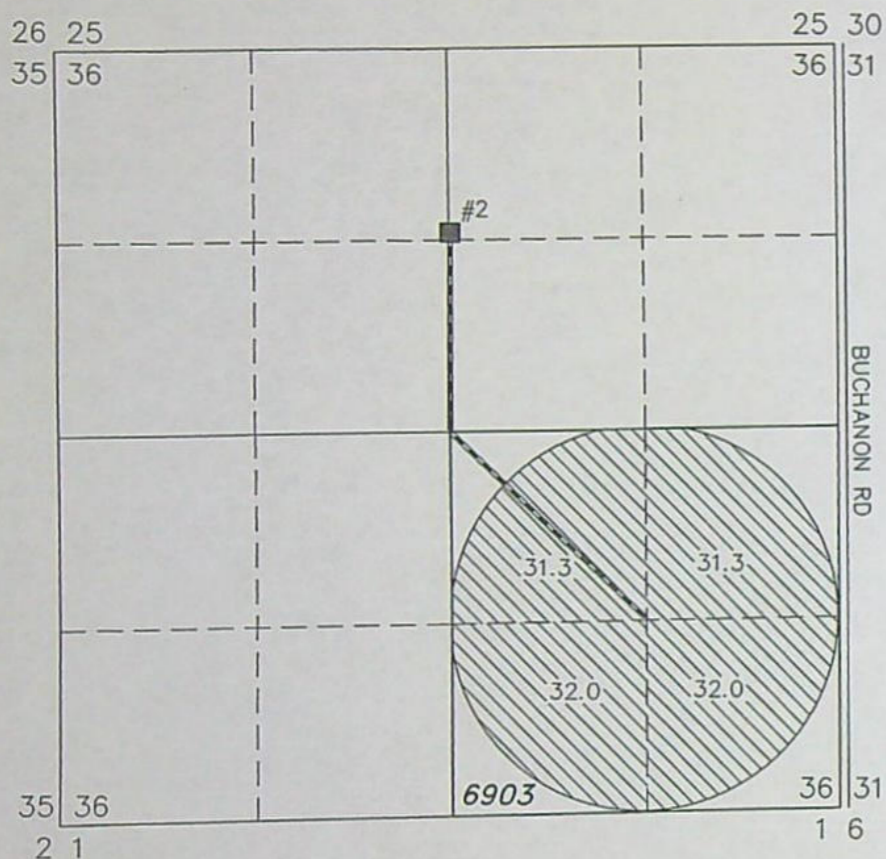

WELL 2 (HARN 1047)

LOCATED IN THE NW 1/4 NE 1/4 SECTION 36, T24S R33E, W.M. AND 1260 FEET SOUTH AND 2635 FEET WEST FROM THE NE CORNER OF SECTION 36.



126.6 ACRES IR FROM CERTIFICATE 93211, TRANSFERRED OFF, AS SHOWN.



SCALE 4" = 1 MILE

TOWNSHIP 27 SOUTH, RANGE 34 EAST, SECTION 6, W.M.
TAX LOT: 700

"TO"

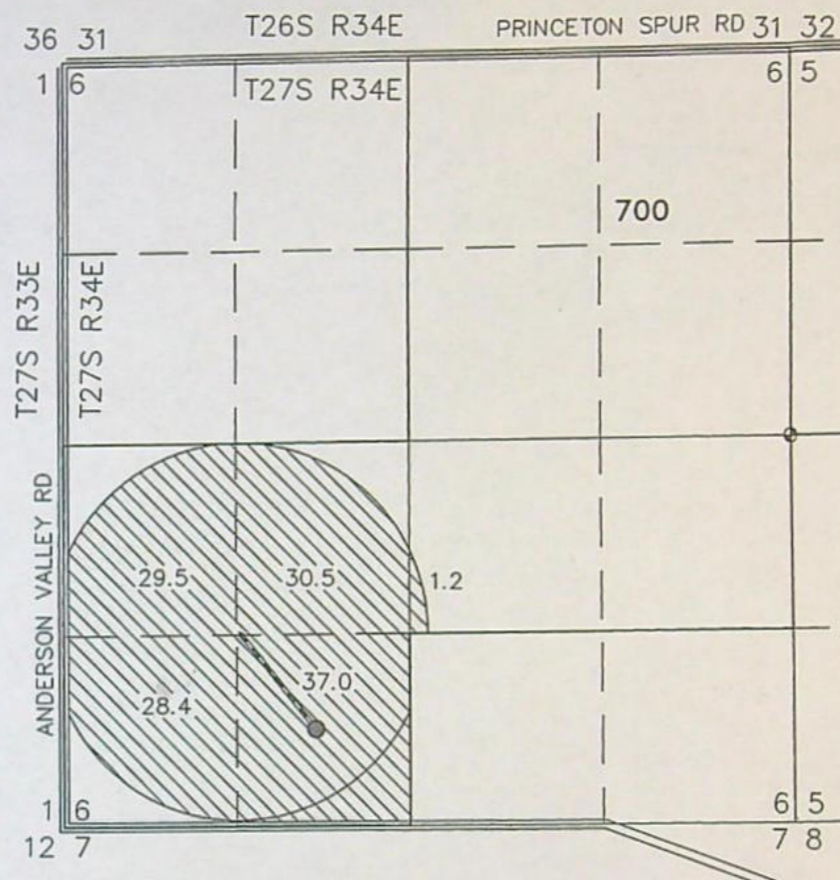

WELL (HARN 52285)

LOCATED IN THE SE 1/4 SW 1/4 SECTION 6, T27S R34E, W.M. AND 1970 FEET SOUTH AND 3280 FEET WEST FROM THE E 1/4 CORNER OF SECTION 6.



126.6 ACRES IR FROM CERTIFICATE 93211, TRANSFERRED ON, AS SHOWN.

THIS MAP IS FOR THE PURPOSE OF LOCATING A WATER RIGHT ONLY AND HAS NO INTENT TO PROVIDE LEGAL DIMENSIONS OR THE LOCATION OF PROPERTY LINES

RECEIVED

MAY 18 2023

OWRD
SALEM, OREGON
14246 -

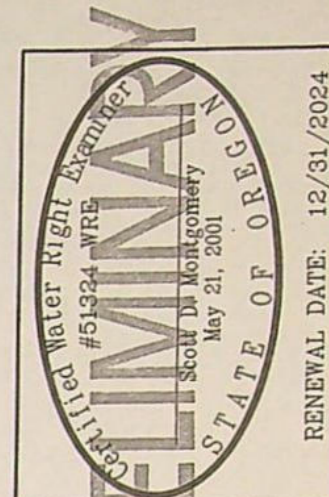

ALL POINTS ENGINEERING & SURVEYING, INC. PR

P.O. BOX 767
TERREBONNE, OREGON 97760
(541) 548-5833 PH
(541) 585-4602 FX
www.APEandS.com

PROJECT No. 23-053

PREPARED AT THE REQUEST OF:
JAMES & SUE GILMOUR
30427 STELLMACHER DRIVE
ALBANY, OR 97321

T24S R 33E, W.M.

2020 aerial imagery from NRCS Gateway website imported into ArcMap GIS software in statewide Lambert projection.

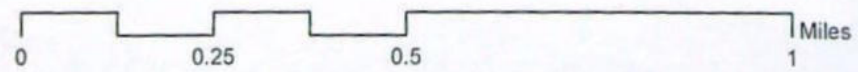
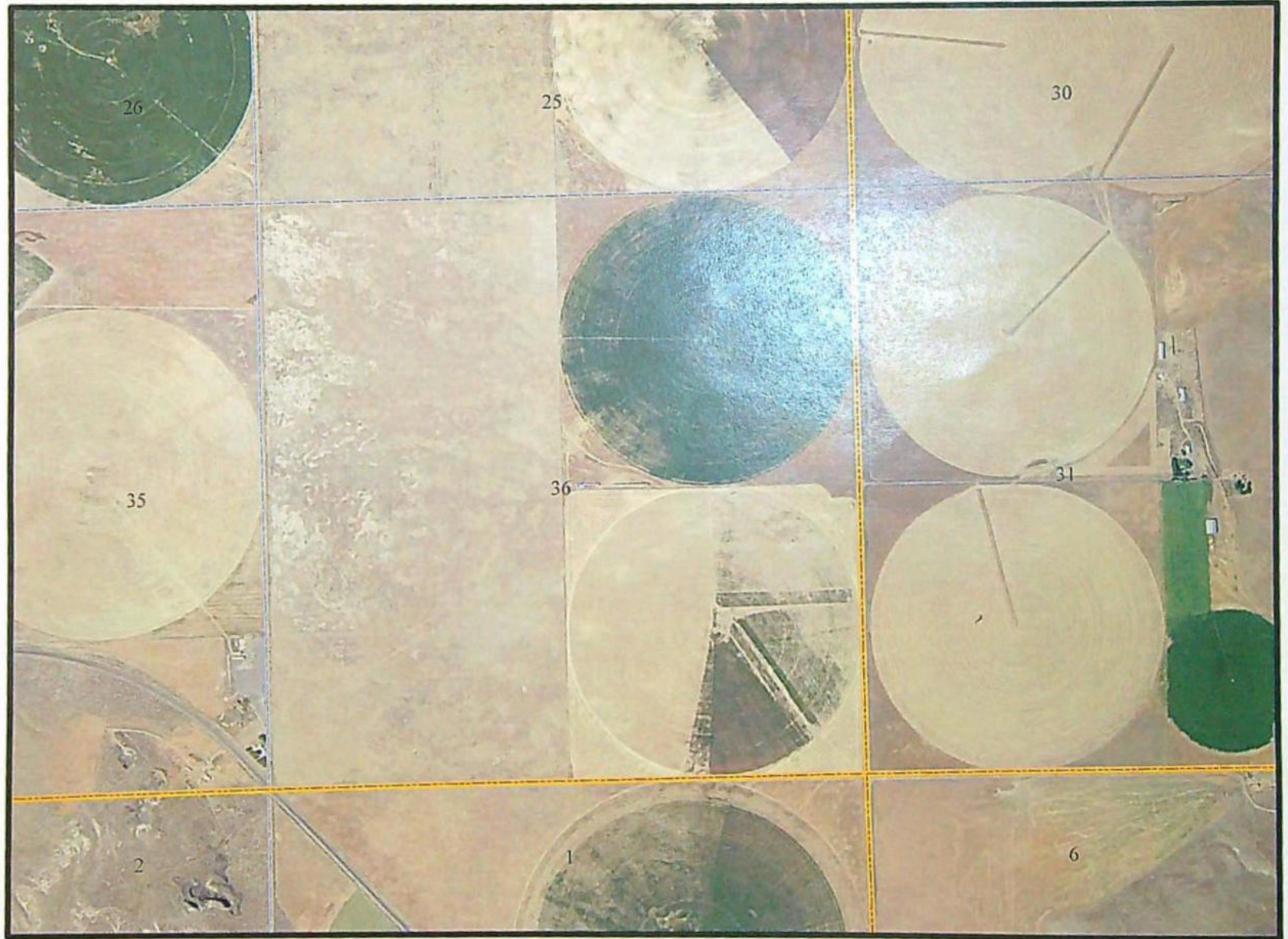

14246 -

RECEIVED
MAY 18 2023
OWRD
SALEM, OREGON

Permanent Transfer Application Intake Checklist

Transfer # T- 14246

Reviewer Kim French Date 5/22/23	Type of Change(s) Proposed: <input checked="" type="checkbox"/> POU <input type="checkbox"/> POD <input type="checkbox"/> APOD <input checked="" type="checkbox"/> POA <input type="checkbox"/> APOA <input type="checkbox"/> USE <input type="checkbox"/> Substitution <input type="checkbox"/> Gov't Action <input type="checkbox"/> Sup to Primary <input type="checkbox"/> SW to GW
Calculated Fee \$3340 Use fee calculator on back of this form	Fee Received \$3340
Certificate(s): 93211	Check <u>all</u> Certs in WRIS to confirm they are not cancelled
For multiple certificates, does application meet requirement of OAR 690-380-3220? If no, why? Use the flow chart for multiple Certs	<input type="checkbox"/> YES <input type="checkbox"/> NO <input checked="" type="checkbox"/> N/A
Notes:	

Application: OAR 690-380-3000; OAR 690-380-3220				
1.	<input checked="" type="checkbox"/> YES	<input type="checkbox"/> NO	Have <u>ALL</u> of the applicant's signed and dated the application? If no, whose signature is missing?	
2.	<input checked="" type="checkbox"/> YES	<input type="checkbox"/> NO	Part 5 of application: Does the information match the description of the explanation on Part 4 of the application?	
3.	<input checked="" type="checkbox"/> YES	<input type="checkbox"/> NO	<input type="checkbox"/> N/A	For multiple certificates: Each certificate proposed for transfer has their own separate completed Part 5, Tables 1 & 2? If no, which certificate(s) are missing separate Part 5, Tables 1 & 2?

Map Requirements: OAR 690-380-3100				
4.	<input checked="" type="checkbox"/> YES	<input type="checkbox"/> NO	Has the map been completed and signed by a CWRE?	
5.	<input type="checkbox"/> YES	<input type="checkbox"/> NO	<input checked="" type="checkbox"/> N/A	Map Waiver? The map waiver must be issued by the Department
Notes:				

Attachments: OAR 690-380-3000				
6.	<input checked="" type="checkbox"/> YES	<input type="checkbox"/> NO	Evidence of Use included, signed, & notarized w/supporting documentation?	
7.	<input checked="" type="checkbox"/> YES	<input type="checkbox"/> NO	<input type="checkbox"/> N/A	Land Use Form included and signed by the County?
8.	<input type="checkbox"/> YES	<input type="checkbox"/> NO	<input checked="" type="checkbox"/> N/A	Consent Form included, signed, and notarized?
9.	<input type="checkbox"/> YES	<input type="checkbox"/> NO	<input checked="" type="checkbox"/> N/A	District: Place of use is in <u>or</u> near an irrigation district?
	<input type="checkbox"/> YES	<input type="checkbox"/> NO		If Yes, is Form D included? Name of the District
10.	<input checked="" type="checkbox"/> YES	<input type="checkbox"/> NO	<input type="checkbox"/> N/A	For changes in POA/APOA – are the well logs included?
11.	<input type="checkbox"/> YES	<input type="checkbox"/> NO	<input checked="" type="checkbox"/> N/A	For change in POU within Umatilla County, Supplemental Form U included?

<input checked="" type="checkbox"/>	Application complete: no deficiencies identified, assign a T-number and put this checklist in T-folder.
<input type="checkbox"/>	Application DEFICIENT: DO NOT accept - return to applicant with letter explaining deficiencies identified.

