

T-2376

STATUS OF APPLICATION

Change in Place of Use
 Date filed May 11, 1970
 Date of hearing _____
 Place of hearing _____
 ✓ Date of order 1-19-71 Vol. 20, page 350
 Date for application of water 10-1-71
 Proof mailed FEB 25 1977
 Proof received _____
 Certificate issued APR 15 1977 Vol. 36, page 44316
~~89180~~

DESCRIPTION OF WATER RIGHT

Name of stream Well No. 1
 Trib. of - County of Malheur
 Use Irrigation
 Quantity of water - No. of acres 41 1/4
 Name of ditch -
 Date of priority February 14, 1950
 In name of Rankin Crow
 _____ Adjudication, Vol. _____, page _____
 App. No. U-305 Per. No. U-320 Cert. No. 23627
 Certificate cancelled _____
 Notation made on record by slw

FEEES PAID

Date	Amount	Receipt No.
<u>5/11/70</u>	<u>25.00</u>	<u>18626</u>
TOTAL . . .		
<u>2/25/77</u>	<u>\$ Cert. Fee</u>	<u>58570</u>

FEEES REFUNDED

Date	Amount	Check No.

REMARKS

T-8787 A POW/APOA

TO BE ENTERED WHERE CHECKED	INDEX CARDS:		Checked
	Entered		
<input checked="" type="checkbox"/>	Name	<u>slw</u>	_____
<input checked="" type="checkbox"/>	Stream	<u>slw</u>	_____
<input type="checkbox"/>	Pt. of Div.	<u>slw</u>	_____
<input checked="" type="checkbox"/>	Calendar	<u>slw</u>	_____
CHECKED TO RECORDS:			
<input checked="" type="checkbox"/>	Twp. & range.	<u>slw</u>	_____
<input type="checkbox"/>	Decree-vault	_____	_____
<input type="checkbox"/>	Decree-safe	_____	_____
<input checked="" type="checkbox"/>	Cert. of W/R	<u>slw</u>	_____
<input checked="" type="checkbox"/>	Per. folder	<u>slw</u>	_____
<input type="checkbox"/>	Chaindex	_____	_____
<input type="checkbox"/>	Cross Ref.	_____	_____
<input type="checkbox"/>	Power Claim	_____	_____
<input type="checkbox"/>	Abstracts	_____	_____

T-2376

STATE OF OREGON
COUNTY OF MALHEUR
CERTIFICATE OF WATER RIGHT

THIS CERTIFICATE ISSUED TO

RAYMOND S. AND JEAN BELNAP
4137 KOCHSMEIER RD
VALE OR 97918

confirms the right to use the waters of WELL #1 within the COW CREEK BASIN for IRRIGATION of 67.9 ACRES.

This right was perfected under Permit U-320. The date of priority is FEBRUARY 14, 1950. The amount of water to which this right is entitled is limited to an amount actually used beneficially, and shall not exceed 0.85 CUBIC FOOT PER SECOND, or its equivalent in case of rotation, measured at the well.

The well is located as follows:

Twp	Rng	Mer	Sec	Q-Q	Measured Distances
15 S	40 E	WM	2	SW SE	WELL #1 - 225 FEET NORTH AND 1560 FEET WEST FROM THE SE CORNER, SECTION 2

The amount of water used for irrigation, together with the amount secured under any other right existing for the same lands, shall be limited to a diversion of ONE-EIGHTIETH of one cubic foot per second per acre, or its equivalent for each acre irrigated, and shall be further limited to a diversion of not to exceed 3.0 acre-feet per acre for each acre irrigated during the irrigation season of each year.

The use shall conform to such reasonable rotation system as may be ordered by the proper state officer.

A description of the place of use is as follows:

IRRIGATION					
Twp	Rng	Mer	Sec	Q-Q	Acres
15 S	40 E	WM	2	SW SE	4.5
15 S	40 E	WM	11	SW NE	16.9
15 S	40 E	WM	11	SE NE	11.7
15 S	40 E	WM	11	NE SE	19.6
15 S	40 E	WM	11	NW SE	15.2

When required by the Department the water user shall install an in-line flow meter or other suitable device for measuring and recording the quantity of water used. The type and plans of the measuring device must be approved by the Department prior to beginning construction and shall be installed under the general supervision of the Department.

Water shall be acquired from the same aquifer as the original point of appropriation.

NOTICE OF RIGHT TO PETITION FOR RECONSIDERATION OR JUDICIAL REVIEW

This is an order in other than a contested case. This order is subject to judicial review under ORS 183.482. Any petition for judicial review must be filed within the 60-day time period specified by ORS 183.482. Pursuant to ORS 183.482, ORS 536.075 and OAR 137-003-0675, you may petition for judicial review and petition the Director for reconsideration of this order. A petition for reconsideration may be granted or denied by the Director, and if no action is taken within 60 days following the date the petition was filed, the petition shall be deemed denied.

The right to the use of the water for the purpose aforesaid is restricted to the lands or place of use herein described and is subject to the existing minimum flow policies established by the Water Policy Review Board.

This certificate is issued to confirm a change in PLACE OF USE approved by an order of the Water Resources Director entered February 17, 2005, at Special Order Volume 63, Page 311, approving Transfer Application T- 8787, and together with Certificate 81208, supersedes Certificate 44316, State Record of Water Right Certificates.

Issued APR 09 2014

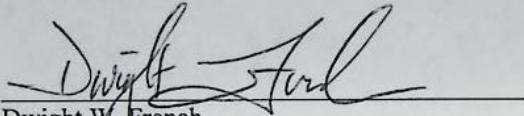

Dwight W. French
Administrator, Water Right Services, for
Phillip C. Ward, Director
Oregon Water Resources Department

T.15 S. R.40 E. W.M.

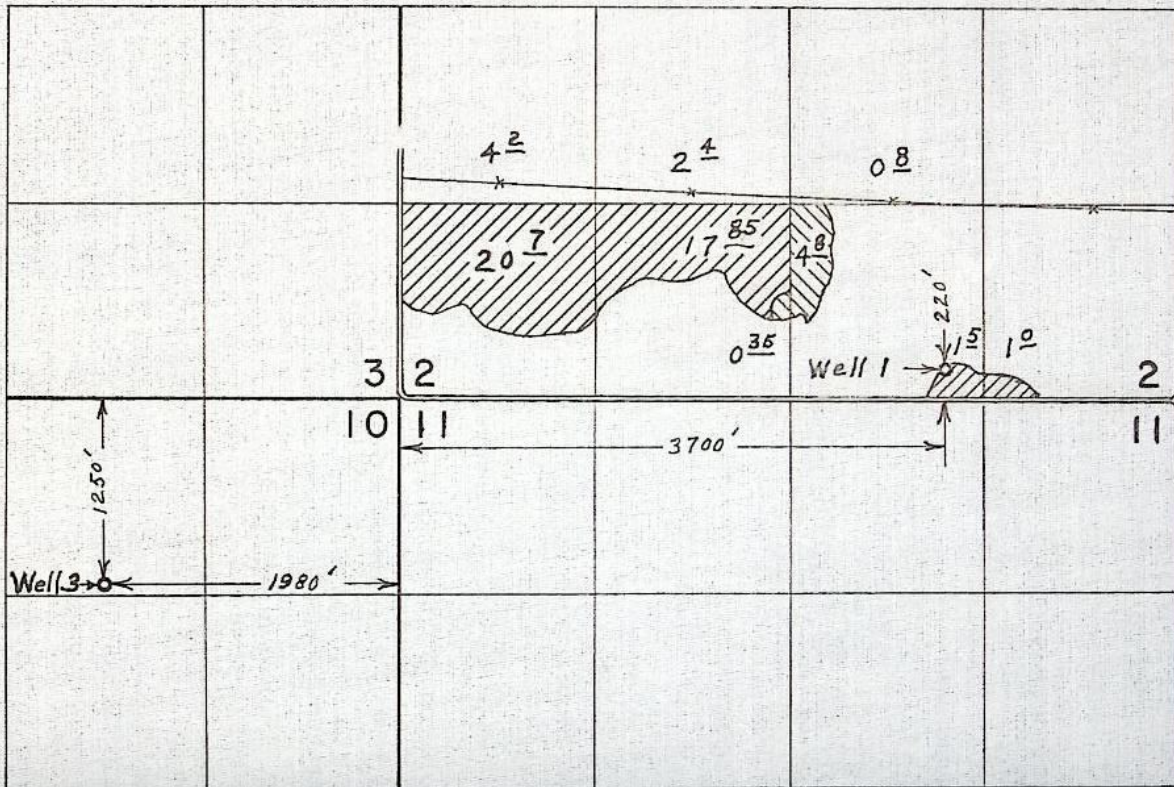

FINAL PROOF SURVEY
UNDER

Transfer No. 2376



Transfer No. 2378



Application No. Permit No.

IN NAME OF

BURTON HAVERFIELD

Surveyed *May 1, 1975*, by *L. E. Gould*

STATE OF OREGON

COUNTY OF MALHEUR

ORDER APPROVING A CHANGE IN PLACE OF USE,
POINT OF APPROPRIATION, ADDITIONAL POINT OF APPROPRIATION AND
PARTIAL CANCELLATION OF A WATER RIGHT

Pursuant to ORS 537.705, after notice was given and no objections were filed, and finding that no injury to existing water rights would result, this order approves, as conditioned or limited herein, TRANSFER 8787 submitted by

RAYMOND S. AND JEAN BELNAP
4137 KOCHEMIER ROAD
VALE, OREGON 97918.

The FIRST right to be modified, as evidenced by a PORTION of Certificate 23628, was perfected under Permit U-349 with a date of priority of SEPTEMBER 18, 1950. The right allows the use of WELL NO. 2, in the COW CREEK BASIN, for IRRIGATION OF 16.9 ACRES. The amount of water to which this right is entitled is limited to an amount actually beneficially used and shall not exceed 0.21 cubic foot per second, if available at the original well; SW $\frac{1}{4}$ SW $\frac{1}{4}$, SECTION 2, T 15 S, R 40 E, W.M., or its equivalent in case of rotation, measured at the well.

This is an order in other than a contested case. This order is subject to judicial review under ORS 183.484. Any petition for judicial review must be filed within the 60 day time period specified by ORS 183.484(2).

Pursuant to ORS 536.075 and OAR 137-004-080 and OAR 690-01-005 you may either petition for judicial review or petition the Director for reconsideration of this order.

The amount of water used for irrigation, together with the amount secured under any other right existing on the same lands, is limited to ONE-EIGHTIETH of one cubic foot per second per acre, or its equivalent for each acre irrigated and shall be further limited to a diversion of not to exceed 3.0 acre-feet per acre for each acre irrigated during the irrigation season of each year.

The use shall conform to any reasonable rotation system ordered by the proper state officer.

The authorized place of use is as follows:

POU ONLY

SW $\frac{1}{4}$ SW $\frac{1}{4}$ 0.2 ACRES
SE $\frac{1}{4}$ SW $\frac{1}{4}$ 16.6 ACRES
SW $\frac{1}{4}$ SE $\frac{1}{4}$ 0.1 ACRES

SECTION 2

TOWNSHIP 15 SOUTH, RANGE 40 EAST, W.M.

The right to use water for the above purpose is restricted to beneficial use on the lands or place of use described.

The SECOND right to be modified, as evidenced by a PORTION of Certificate 23632, was perfected under Permit U-391 with a date of priority of MAY 10, 1951. The right allows the use of WELLS NO. 6 & 7, in the COW CREEK BASIN, for IRRIGATION OF 71.4 ACRES. The amount of water to which this right is entitled is limited to an amount actually beneficially used and shall not exceed 0.90 cubic foot per second, if available at the original wells; NO. 6: NW $\frac{1}{4}$ SW $\frac{1}{4}$, SECTION 8, NO. 7: NE $\frac{1}{4}$ SE $\frac{1}{4}$, SECTION 7, T 15 S, R 41 E, W.M. , or its equivalent in case of rotation, measured at the well.

The amount of water used for irrigation, together with the amount secured under any other right existing on the same lands, is limited to ONE-EIGHTIETH of one cubic foot per second per acre, or its equivalent for each acre irrigated and shall be further limited to a diversion of not to exceed 3.0 acre-feet per acre for each acre irrigated during the irrigation season of each year.

The use shall conform to any reasonable rotation system ordered by the proper state officer.

The authorized place of use is as follows:

<u>POU ONLY</u>	<u>POU & POA CHANGE</u>
SW $\frac{1}{4}$ SE $\frac{1}{4}$ 1.1 ACRES	
SE $\frac{1}{4}$ SE $\frac{1}{4}$ 1.3 ACRES	
SECTION 6	
NE $\frac{1}{4}$ NE $\frac{1}{4}$	10.0 ACRES
NE $\frac{1}{4}$ NE $\frac{1}{4}$ 2.2 ACRES	
NW $\frac{1}{4}$ NE $\frac{1}{4}$ 4.8 ACRES	
SW $\frac{1}{4}$ NE $\frac{1}{4}$ 6.7 ACRES	
NE $\frac{1}{4}$ SE $\frac{1}{4}$ 0.3 ACRES	
NW $\frac{1}{4}$ SE $\frac{1}{4}$ 3.1 ACRES	
SECTION 7	
SE $\frac{1}{4}$ NE $\frac{1}{4}$ 0.3 ACRES	
NE $\frac{1}{4}$ NW $\frac{1}{4}$ 0.6 ACRES	
NW $\frac{1}{4}$ NW $\frac{1}{4}$	5.0 ACRES
SW $\frac{1}{4}$ NW $\frac{1}{4}$	2.0 ACRES
NE $\frac{1}{4}$ SW $\frac{1}{4}$ 3.2 ACRES	
NW $\frac{1}{4}$ SW $\frac{1}{4}$ 11.4 ACRES	
NE $\frac{1}{4}$ SE $\frac{1}{4}$ 8.8 ACRES	
NW $\frac{1}{4}$ SE $\frac{1}{4}$ 4.0 ACRES	
SECTION 8	
SW $\frac{1}{4}$ NW $\frac{1}{4}$ 2.1 ACRES	

NW¼ SW¼ 4.5 ACRES
SECTION 9
TOWNSHIP 15 SOUTH, RANGE 41 EAST, W.M.

The right to use water for the above purpose is restricted to beneficial use on the lands or place of use described.

The THIRD right to be modified, as evidenced by a PORTION of Certificate 44207, was perfected under Permit U-369 with a date of priority of FEBRUARY 5, 1951. The right allows the use of WELL NO. 4, in the COW CREEK BASIN, for IRRIGATION OF 5.5 ACRES. The amount of water to which this right is entitled is limited to an amount actually beneficially used and shall not exceed 0.07 cubic foot per second, if available at the original well; SE¼ SW¼, SECTION 11, T 15 S, R 40 E, W.M.; 730 FEET NORTH AND 1400 FEET EAST FROM THE SW CORNER, SECTION 11, or its equivalent in case of rotation, measured at the well.

The amount of water used for irrigation, together with the amount secured under any other right existing on the same lands, is limited to ONE-EIGHTIETH of one cubic foot per second per acre, or its equivalent for each acre irrigated and shall be further limited to a diversion of not to exceed 3.0 acre-feet per acre for each acre irrigated during the irrigation season of each year.

The use shall conform to any reasonable rotation system ordered by the proper state officer.

The authorized place of use is as follows:

POU AND POA CHANGE

NE¼ SW¼ 0.5 ACRES

SE¼ SW¼ 4.0 ACRES

NE¼ SE¼ 0.1 ACRES

SE¼ SE¼ 0.9 ACRES

SECTION 11
TOWNSHIP 15 SOUTH, RANGE 40 EAST, W.M.

The right to use water for the above purpose is restricted to beneficial use on the lands or place of use described.

The FOURTH right to be modified, as evidenced by a PORTION of Certificate 44208, was perfected under Permit U-490 with a date of priority of FEBRUARY 2 1953. The right allows the use of WELL NO. 9, in the COW CREEK BASIN, for IRRIGATION OF 7.2 ACRES. The amount of water to which this right is entitled is limited to an amount actually beneficially used and shall not exceed 0.09 cubic foot per second, if available at the original well; NW $\frac{1}{4}$ SE $\frac{1}{4}$, SECTION 10, T 15 S, R 40 E, W.M.; 1460 FEET NORTH AND 2600 FEET WEST FROM THE SE CORNER, SECTION 10, or its equivalent in case of rotation, measured at the well.

The amount of water used for irrigation, together with the amount secured under any other right existing on the same lands, is limited to ONE-EIGHTIETH of one cubic foot per second per acre, or its equivalent for each acre irrigated and shall be further limited to a diversion of not to exceed 3.0 acre-feet per acre for each acre irrigated during the irrigation season of each year.

The use shall conform to any reasonable rotation system ordered by the proper state officer.

The authorized place of use is as follows:

POU ONLY
NW $\frac{1}{4}$ SE $\frac{1}{4}$ 5.7 ACRES
SW $\frac{1}{4}$ SE $\frac{1}{4}$ 1.5 ACRES
SECTION 10
TOWNSHIP 15 SOUTH, RANGE 40 EAST, W.M.

The right to use water for the above purpose is restricted to beneficial use on the lands or place of use described.

The FIFTH right to be modified, as evidenced by a PORTION of Certificate 44316, was perfected under Permit U-320 with a date of priority of FEBRUARY 14, 1950. The right allows the use of WELL NO. 1, in the COW CREEK BASIN, for IRRIGATION OF 67.9 ACRES. The amount of water to which this right is entitled is limited to an amount actually beneficially used and shall not exceed 0.85 cubic foot per second, if available at the original well; SW¼ SE¼, SECTION 2, T 15 S, R 40 E, W.M., or its equivalent in case of rotation, measured at the well.

The amount of water used for irrigation, together with the amount secured under any other right existing on the same lands, is limited to ONE-EIGHTIETH of one cubic foot per second per acre, or its equivalent for each acre irrigated and shall be further limited to a diversion of not to exceed 3.0 acre-feet per acre for each acre irrigated during the irrigation season of each year.

The use shall conform to any reasonable rotation system ordered by the proper state officer.

The authorized place of use is as follows:

POU ONLY

SW¼ SW¼	20.70 ACRES
SE¼ SW¼	18.05 ACRES
SW¼ SE¼	8.50 ACRES
SE¼ SE¼	6.80 ACRES

SECTION 2

TOWNSHIP 15 SOUTH, RANGE 40 EAST, W.M.

POU ONLY

NE¼ NE¼	5.20 ACRES
NW¼ NE¼	5.00 ACRES
SW¼ NE¼	1.55 ACRES

SE¼ NE¼ 1.90 ACRES
NE¼ NW¼ 0.20 ACRES

SECTION 11

TOWNSHIP 15 SOUTH, RANGE 40 EAST, W.M.

The right to use water for the above purpose is restricted to beneficial use on the lands or place of use described.

The SIXTH right to be modified, as evidenced by a PORTION of Certificate 46078, was perfected under Permit U-350 with a date of priority of SEPTEMBER 18, 1950. The right allows the use of WELL NO. 3, in the COW CREEK BASIN, for IRRIGATION OF 82.1 ACRES. The amount of water to which this right is entitled is limited to an amount actually beneficially used and shall not exceed 1.03 cubic foot per second, if available at the original well; NW¼ NE¼, SECTION 10, T 15 S, R 40 E, W.M.; 1250 FEET SOUTH AND 1980 FEET WEST FROM THE NE CORNER, SECTION 10, or its equivalent in case of rotation, measured at the well.

The amount of water used for irrigation, together with the amount secured under any other right existing on the same lands, is limited to ONE-EIGHTIETH of one cubic foot per second per acre, or its equivalent for each acre irrigated and shall be further limited to a diversion of not to exceed 3.0 acre-feet per acre for each acre irrigated during the irrigation season of each year.

The use shall conform to any reasonable rotation system ordered by the proper state officer.

The authorized place of use is as follows:

	<u>POU ONLY</u>	<u>POU & POA CHANGE</u>
SE¼ SW¼	0.35 ACRES	
SW¼ SE¼		4.80 ACRES
	SECTION 2	
SW¼ NE¼		0.30 ACRES

SE $\frac{1}{4}$ NE $\frac{1}{4}$ 1.00 ACRES

SECTION 10

TOWNSHIP 15 SOUTH, RANGE 40 EAST, W.M.

	<u>POU ONLY</u>	<u>POA ONLY</u>	<u>POU & POA CHANGE</u>
NW $\frac{1}{4}$ NE $\frac{1}{4}$	2.60 ACRES		
SW $\frac{1}{4}$ NE $\frac{1}{4}$	0.35 ACRES		
NE $\frac{1}{4}$ NW $\frac{1}{4}$	7.40 ACRES	31.4 ACRES	
NW $\frac{1}{4}$ NW $\frac{1}{4}$		24.4 ACRES	7.6 ACRES
SE $\frac{1}{4}$ NW $\frac{1}{4}$			1.9 ACRES

SECTION 11

TOWNSHIP 15 SOUTH, RANGE 40 EAST, W.M.

The right to use water for the above purpose is restricted to beneficial use on the lands or place of use described.

The SEVENTH right to be modified, as evidenced by Certificate 80440, was perfected under Permit U-359 with a date of priority of SEPTEMBER 20, 1950. The right allows the use of WELL NO. 5, in the COW CREEK BASIN, for IRRIGATION 194.1 ACRES. The amount of water to which this right is entitled is limited to an amount actually beneficially used and shall not exceed 2.40 cubic feet per second, if available at the original well; NE $\frac{1}{4}$ SW $\frac{1}{4}$, SECTION 14, T 15 S, R 40 EAST, W.M., or its equivalent in case of rotation, measured at the well.

The amount of water used for irrigation, together with the amount secured under any other right existing on the same lands, is limited to ONE-EIGHTIETH of one cubic foot per second per acre, or its equivalent for each acre irrigated and shall be further limited to a diversion of not to exceed 3.0 acre-feet per acre for each acre irrigated during the irrigation season of each year.

The use shall conform to any reasonable rotation system ordered by the proper state officer.

The authorized place of use is as follows:

	<u>A POA ONLY</u>	<u>A POA and POU</u>
SE¼ NE¼	10.3 ACRES	
NE¼ NW¼	27.6 ACRES	
NW¼ NW¼		37.2 ACRES
SW¼ NW¼		39.1 ACRES
SE¼ NW¼	27.6 ACRES	
NE¼ SW¼		16.7 ACRES

SECTION 14

TOWNSHIP 15 SOUTH, RANGE 40 EAST, W.M.

	<u>A POA ONLY</u>	<u>A POA and POU</u>
NW¼ SW¼		29.9 ACRES
NW¼ SE¼		5.7 ACRES

SECTION 14

TOWNSHIP 15 SOUTH, RANGE 40 EAST, W.M.

The right to use water for the above purpose is restricted to beneficial use on the lands or place of use described.

The EIGHTH right to be modified, as evidenced by Certificate 80441, was perfected under Permit U-392 with a date of priority of MAY 10, 1951. The right allows the use of WELL NO. 5, in the COW CREEK BASIN BASIN, for IRRIGATION OF 130.4 ACRES. The amount of water to which this right is entitled is limited to an amount actually beneficially used and shall not exceed 1.63 cubic feet per second, if available at the original well; NE¼ SW¼, SECTION 14, T 15 SOUTH, RANGE 40 EAST, W.M., or its equivalent in case of rotation, measured at the well.

The amount of water used for irrigation, together with the amount secured under any other right existing on the same lands, is limited to ONE-EIGHTIETH of one cubic foot per second per acre, or its equivalent for each acre irrigated and shall be further limited to a diversion of not to exceed 3.0 acre-feet per acre for each acre irrigated during the irrigation season of each year.

The use shall conform to any reasonable rotation system ordered by the proper state officer.

The authorized place of use is as follows:

POU AND POA CHANGE

NE $\frac{1}{4}$ NE $\frac{1}{4}$	40.0 ACRES
NW $\frac{1}{4}$ NE $\frac{1}{4}$	30.6 ACRES
SW $\frac{1}{4}$ NE $\frac{1}{4}$	30.6 ACRES
SE $\frac{1}{4}$ NE $\frac{1}{4}$	29.2 ACRES

SECTION 14

TOWNSHIP 15 SOUTH, RANGE 40 EAST W.M.

The right to use water for the above purpose is restricted to beneficial use on the lands or place of use described.

The NINTH right to be modified, as evidenced by Certificate 80442, was perfected under Permit U-406 with a date of priority of AUGUST 21, 1951. The right allows the use of WELL NO. 8, in the COW CREEK BASIN, for IRRIGATION OF 40.9 ACRES. The amount of water to which this right is entitled is limited to an amount actually beneficially used and shall not exceed 0.51 cubic foot per second, if available at the original well; SW $\frac{1}{4}$ SE $\frac{1}{4}$, SECTION 14, T 15 SOUTH, R 40 EAST, W.M., or its equivalent in case of rotation, measured at the well.

The amount of water used for irrigation, together with the amount secured under any other right existing on the same lands, is limited to ONE-EIGHTIETH of one cubic foot per second per acre, or its equivalent for each acre irrigated and shall be further limited to a diversion of not to exceed 3.0 acre-feet per acre for each acre irrigated during the irrigation season of each year.

The use shall conform to any reasonable rotation system ordered

by the proper state officer.

The authorized place of use is as follows:

	<u>ADD POA ONLY</u>	<u>POU AND ADD POA</u>	<u>POU AND POA CHANGE</u>
SW¼ NE¼		3.0 ACRES	
SE¼ NE¼		0.5 ACRES	
SE¼ NW¼		0.8 ACRE	
NE¼ SW¼	15.5 ACRES		
NE¼ SE¼			6.4 ACRES
NW¼ SE¼	6.3 ACRES		8.4 ACRES

SECTION 14
TOWNSHIP 15 SOUTH, RANGE 40 EAST, W.M.

The right to use water for the above purpose is restricted to beneficial use on the lands or place of use described.

The applicant proposes to make the following changes:

Cert	T	R	S	¼¼	Acres	Proposed POA/ A_POA	POU Change Y/N	Proposed CFS
23628	15S	40E	2	SW SW	12.8		Y	
23628	15S	40E	2	SE SW	4.1		Y	
Cert	T	R	S	¼¼	Acres	Proposed POA/ A_POA	POU Change Y/N	Proposed CFS
23632	15S	41E	7	NE NE	2.9		Y	
23632	15S	41E	7	NW NE	2.6		Y	
23632	15S	41E	7	SW NE	1.0		Y	
23632	15S	41E	7	SE NE	1.0		Y	
23632	15S	41E	7	NW SE	0.4		Y	
23632	15S	41E	8	NE NE	12.1		Y	
23632	15S	41E	8	NW NE	8.7		Y	
23632	15S	41E	8	NE NW	5.6		Y	
23632	15S	41E	8	NW NW	7.8		Y	

Cert	T	R	S	¼	Acres	Proposed POA/ A_POA	POU Change Y/N	Proposed CFS
23632	15S	41E	8	SW NW	2.6		Y	
23632	15S	41E	8	SE NW	5.6		Y	
23632	15S	41E	8	NW SW	4.1		Y	
23632	15S	40E	11	SE NE	10.0	#1	Y	0.13
23632	15S	40E	11	NW NW	7.0	#2	Y	0.09
44207	15S	40E	2	SE SW	5.5	#2	Y	0.07
44208	15S	40E	10	NW SE	1.0		Y	
44208	15S	40E	10	SW SE	6.2		Y	
44316	15S	40E	2	SW SE	4.5		Y	
44316	15S	40E	11	SW NE	16.9		Y	
44316	15S	40E	11	SE NE	11.7		Y	
44316	15S	40E	11	NE SE	19.6		Y	
44316	15S	40E	11	NW SE	15.2		Y	
46078	15S	40E	2	SE SW	14.6	#2	Y	0.18
46078	15S	40E	10	NE NE	4.6		Y	
46078	15S	40E	10	NW NE	2.3		Y	
46078	15S	40E	11	NE NW	31.4	#2	N	0.39
46078	15S	40E	11	NW NW	24.4	#2	N	0.31
46078	15S	40E	11	SW NW	4.8		Y	
80440	15S	40E	2	SE SW	2.2	#2	Y	0.01
80440	15S	40E	14	NE NE	36.4	ADD #8	Y	
80440	15S	40E	14	NW NE	30.6	ADD #8	Y	
Cert	T	R	S	¼	Acres	Proposed POA/ A_POA	POU Change Y/N	Proposed CFS
80440	15S	40E	14	SW NE	30.6	ADD #8	Y	
80440	15S	40E	14	SE NE	28.8	ADD #8	Y	
80440	15S	40E	14	SE NE	10.3	ADD #8	N	
80440	15S	40E	14	NE NW	27.6	ADD #8	N	
80440	15S	40E	14	SE NW	27.6	ADD #8	N	

80441	15S	40E	14	SW NE	2.9	ADD #8	Y	
80441	15S	40E	14	NW NW	35.9	ADD #8	Y	
80441	15S	40E	14	SW NW	39.1	ADD #8	Y	
80441	15S	40E	14	SE NW	3.1	ADD #8	Y	
80441	15S	40E	14	NE SW	13.0	ADD #8	Y	
80441	15S	40E	14	NW SW	26.4	ADD #8	Y	
80441	15S	40E	14	NW SE	10.0	ADD #8	Y	
80442	15S	40E	10	SW NE	2.4	#9	Y	0.03
80442	15S	40E	10	NW SE	12.4	#9	Y	0.16
80442	15S	40E	14	NE SW	15.5	ADD #5	N	
80442	15S	40E	14	NE SW	4.3	ADD #5	Y	
80442	15S	40E	14	NW SE	6.3	ADD #5	N	

The proposed points of appropriation mentioned in the table above are located as follows:

POA NO. 1: SW $\frac{1}{4}$ SE $\frac{1}{4}$, T 15 S, R 40 E, W.M.; 225 FEET NORTH AND 1560 FEET WEST FROM THE SE CORNER, SECTION 2.

POA NO. 2: SW $\frac{1}{4}$ SW $\frac{1}{4}$, SECTION 2, T 15 S, R 40 E, W.M.; 880 FEET NORTH AND 55 FEET EAST FROM THE SW CORNER, SECTION 2.

POA NO. 5: NE $\frac{1}{4}$ SW $\frac{1}{4}$, SECTION 14, T 15 SOUTH, RANGE 40 EAST, W.M.; 325 FEET SOUTH & 1575 FEET EAST FROM W $\frac{1}{4}$ CORNER, SECTION 14.

POA NO. 8: SW $\frac{1}{4}$ SE $\frac{1}{4}$, SECTION 14, T 15 SOUTH, R 40 EAST, W.M.; 1420 FEET SOUTH AND 2370 FEET WEST FROM E $\frac{1}{4}$ CORNER SECTION 14.

POD NO. 9: NW $\frac{1}{4}$ SE $\frac{1}{4}$, SECTION 10, T 15 S, R 40 E, W.M.; 1460 FEET NORTH AND 2600 FEET WEST FROM THE SE CORNER, SECTION 10
 An affidavit was received from Raymond and Jean Belnap owners of certain land and the water right appurtenant to it. A portion of Certificates 80442 have been abandoned and are requested to be

anceled.

The water right is a PORTION of the right described by Certificate 80442, State Record of Water Right Certificates. The abandoned water right is for 1.63 CUBIC FEET PER SECOND from Well No. 8, in the COW CREEK BASIN. The date of priority is AUGUST 21, 1951. The abandoned right is for SUPPLEMENTAL IRRIGATION OF 130.4 ACRES.

The authorized place of use of the abandoned right is as follows:

NE¼ NE¼	40.0 ACRES
NW¼ NE¼	30.6 ACRES
SW¼ NE¼	30.6 ACRES
SE¼ NE¼	29.2 ACRES

SECTION 14

TOWNSHIP 15 SOUTH, RANGE 40 EAST W.M.

ORS 540.621 provides: "Whenever the owner of a perfected and developed water right certifies under oath to the Water Resources Commission that the water right has been abandoned by the owner and that the owner desires cancellation thereof, the Commission shall enter an order canceling the water right."

THESE CHANGES TO EXISTING WATER RIGHTS MAY BE MADE PROVIDED THE FOLLOWING CONDITIONS ARE MET BY THE WATER USER:

1. The proposed change shall be completed on or before October 1, 2006.
2. A claim of Beneficial Use prepared by a Certified Water Rights Examiner shall be submitted by the applicant to the Department by October 1, 2007.
3. The quantity of water diverted at the new points of appropriation (wells), together with the quantity diverted at the old points of appropriation, shall not exceed the

quantity of water lawfully available from the original points of appropriation.

4. When required by the Department the water user shall install an in-line flow meter or other suitable device for measuring and recording the quantity of water used. The type and plans of the measuring device must be approved by the Department prior to beginning construction and shall be installed under the general supervision of the Department.
5. Water shall be acquired from the same aquifer as the original point of appropriation.
6. The former places of use shall no longer be irrigated as part of this water right.

Except as modified herein, all other conditions and restrictions of Certificates 23628, 23632, 44207, 44208, 44316, 46078, 80440, 80441, and 80442 remain in effect.

New certificates will be issued to confirm the portions of the rights NOT involved in this transfer. When satisfactory proof of the completed changes are received, new certificates confirming these water rights will be issued.

WITNESS the signature of the Water Resources

Director, affixed FEBRUARY 17, 2005.

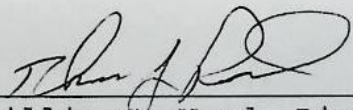

For Phillip C. Ward, Director

STATE OF OREGON
COUNTY OF MALHEUR
CERTIFICATE OF WATER RIGHT

THIS CERTIFICATE ISSUED TO

BURTON HAVERFIELD
CULVER OREGON 97734

confirms the right to use the waters of WELL NO. 1 in the COW CREEK BASIN for IRRIGATION OF 121.1 ACRES.

This right was perfected under Permit U-320. The date of priority is FEBRUARY 14, 1950. The amount of water to which this right is entitled is limited to an amount actually beneficially used and shall not exceed 1.51 CUBIC FEET PER SECOND or its equivalent in case of rotation, measured at the well.

The well is located as follows:

SW $\frac{1}{4}$ SE $\frac{1}{4}$, SECTION 2, T 15 S, R 40 E, W.M..

The amount of water used for irrigation, together with the amount secured under any other right existing for the same lands, is limited to a diversion of ONE-EIGHTIETH of one cubic foot per second, or its equivalent for each acre irrigated and shall be further limited to a diversion of not to exceed 3.0 acre-feet per acre for each acre irrigated during the irrigation season of each year.

The use shall conform to such reasonable rotation system as may be ordered by the proper state officer.

A description of the place of use to which this right is appurtenant is as follows:

SW $\frac{1}{4}$ SE $\frac{1}{4}$ 26.9 ACRES
SE $\frac{1}{4}$ SE $\frac{1}{4}$ 31.4 ACRES
SECTION 2

NE $\frac{1}{4}$ NE $\frac{1}{4}$ 31.4 ACRES
NW $\frac{1}{4}$ NE $\frac{1}{4}$ 31.4 ACRES
SECTION 11

TOWNSHIP 15 SOUTH, RANGE 40 EAST, W.M.

The well shall be maintained in accordance with the General Standards for the Construction and Maintenance of Water Wells in Oregon.

This certificate describes that portion of the water right confirmed by Certificate 44316, State Record of Water Right Certificates, NOT modified by the provisions of an order of the Water Resources Director entered FEB 17 2005, approving Transfer Application 8787 for a change in place of use and point of appropriation.

The issuance of this superseding certificate does not confirm the status of the water right in regard to the provisions of ORS 540.610 pertaining to forfeiture or abandonment.

The right to the use of the water for the above purpose is restricted to beneficial use on the lands or place of use described.

WITNESS the signature of the Water Resources

Director, affixed FEBRUARY 17, 2005.

for Phillip C. Ward, Director

Recorded in State Record of Water Right Certificates numbered 81208

STATE OF OREGON
COUNTY OF MALHEUR
CERTIFICATE OF WATER RIGHT

THIS CERTIFICATE ISSUED TO

RANKIN CROW
BROGAN, OREGON 97903

confirms the right to use the waters of WELL NO. 2 in the COW CREEK BASIN for IRRIGATION OF 23.6 ACRES.

This right was perfected under Permit U-349. The date of priority is SEPTEMBER 18, 1950. The amount of water to which this right is entitled is limited to an amount actually beneficially used and shall not exceed 0.30 CUBIC FOOT PER SECOND or its equivalent in case of rotation, measured at the well.

The well is located as follows:

SW $\frac{1}{4}$ SW $\frac{1}{4}$, SECTION 2, T 15 SOUTH, RANGE 40 EAST, W.M..

The amount of water used for irrigation, together with the amount secured under any other right existing for the same lands, is limited to a diversion of ONE-EIGHTIETH of one cubic foot per second, or its equivalent for each acre irrigated and shall be further limited to a diversion of not to exceed 3.0 acre-feet per acre for each acre irrigated during the irrigation season of each year.

The use shall conform to such reasonable rotation system as may be ordered by the proper state officer.

A description of the place of use to which this right is appurtenant is as follows:

SW $\frac{1}{4}$ SW $\frac{1}{4}$ 18.6 ACRES
SE $\frac{1}{4}$ SW $\frac{1}{4}$ 5.0 ACRES
SECTION 2
TOWNSHIP 15 SOUTH, RANGE 40 EAST, W.M

The well shall be maintained in accordance with the General Standards for the Construction and Maintenance of Water Wells in Oregon.

This certificate describes that portion of the water right confirmed by Certificate 23628, State Record of Water Right Certificates, NOT modified by the provisions of an order of the Water Resources Director entered FEB 17 2005, approving Transfer Application 8787 for a change in place of use and point of appropriation.

The issuance of this superseding certificate does not confirm the status of the water right in regard to the provisions of ORS 540.610 pertaining to forfeiture or abandonment.

The right to the use of the water for the above purpose is restricted to beneficial use on the lands or place of use described.

WITNESS the signature of the Water Resources

Director, affixed FEBRUARY 17, 2005.

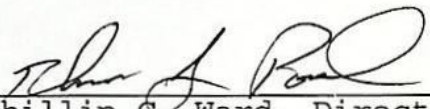

For Phillip C. Ward, Director

Recorded in State Record of Water Right Certificates numbered 81209

STATE OF OREGON
COUNTY OF MALHEUR
CERTIFICATE OF WATER RIGHT

THIS CERTIFICATE ISSUED TO

RANKIN CROW
BROGAN OR 97903

confirms the right to use the waters of two wells in the ANTELOPE SPRS CR, a tributary of the COW CR BASIN for IRRIGATION of 403.20 ACRES.

This right was perfected under Permit U-391. The date of priority is MAY 10, 1951. The amount of water to which this right is entitled is limited to an amount actually used beneficially, and shall not exceed 5.1 CUBIC FEET PER SECOND, being 2.55 cubic feet per second from each well, or its equivalent in case of rotation, measured at the well.

The well is located as follows:

Twp	Rng	Mer	Sec	Q-Q	Survey Coordinates
15 S	41 E	WM	7	NE SE	
15 S	41 E	WM	8	NW SW	

The amount of water used for irrigation, together with the amount secured under any other right existing for the same lands, is limited to a diversion of ONE-EIGHTIETH of one cubic foot per second, or its equivalent for each acre irrigated, and shall be further limited to a diversion of not to exceed 3 acre-feet per acre for each acre irrigated during the irrigation season of each year. The use shall conform to such reasonable rotation system as may be ordered by the proper state officer. The right to the use of the water for the above purpose is restricted to beneficial use on the lands or place of use described.

A description of the place of use to which this right is appurtenant is as follows:

Twp	Rng	Mer	Sec	Q-Q	Acres
15 S	41 E	WM	7	NE NE	25.0
15 S	41 E	WM	7	NW NE	0.2
15 S	41 E	WM	7	SW NE	2.9
15 S	41 E	WM	7	SE NE	39.0
15 S	41 E	WM	7	NE SE	31.4
15 S	41 E	WM	7	NW SE	2.7
15 S	41 E	WM	8	NW NE	13.5
15 S	41 E	WM	8	SW NE	40.0
15 S	41 E	WM	8	SE NE	39.7
15 S	41 E	WM	8	NE NW	32.0
15 S	41 E	WM	8	NW NW	15.0
15 S	41 E	WM	8	SW NW	35.2
15 S	41 E	WM	8	SE NW	34.4
15 S	41 E	WM	8	NE SW	28.8
15 S	41 E	WM	8	NW SW	11.0
15 S	41 E	WM	8	NE SE	23.4
15 S	41 E	WM	8	NW SE	26.6

Twp	Rng	Mer	Sec	Q-Q	Acres
15 S	41 E	WM	9	SW NW	2.3
15 S	41 E	WM	9	NW SW	0.1

This certificate describes that portion of the water right confirmed by Certificate 23632, State Record of Water Right Certificates, NOT modified by the provisions of an order of the Water Resources Director entered FEB 17 2005, approving Transfer Application 8787.

The issuance of this superseding certificate does not confirm the status of the water right in regard to the provisions of ORS 540.610 pertaining to forfeiture or abandonment.

WITNESS the signature of the Water Resources Director, affixed FEBRUARY 17, 2005.

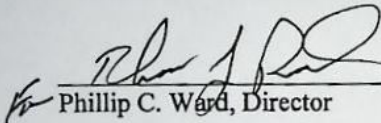
 Phillip C. Ward, Director

Recorded in State Record of Water Right Certificates numbered 81210.

STATE OF OREGON
 COUNTY OF MALHEUR
 CERTIFICATE OF WATER RIGHT

THIS CERTIFICATE ISSUED TO

COW VALLEY RANCHES
 BOX 251
 MILTON FREEWATER OR 97862

confirms the right to use the waters of WELL #4 in the LYMAN CR, a tributary of the COW CR BASIN for IRRIGATION of 126.50 ACRES.

This right was perfected under Permit U-369. The date of priority is FEBRUARY 5, 1951. The amount of water to which this right is entitled is limited to an amount actually used beneficially, and shall not exceed 1.63 CUBIC FEET PER SECOND or its equivalent in case of rotation, measured at the well.

The well is located as follows:

Twp	Rng	Mer	Sec	Q-Q	Survey Coordinates
15 S	40 E	WM	11	SE SW	730 FT N & 1400 FT E FM SW COR, S11

The amount of water used for irrigation, together with the amount secured under any other right existing for the same lands, is limited to a diversion of ONE-EIGHTIETH of one cubic foot per second, or its equivalent for each acre irrigated, and shall be further limited to a diversion of not to exceed 3 acre-feet per acre for each acre irrigated during the irrigation season of each year. The use shall conform to such reasonable rotation system as may be ordered by the proper state officer. The right to the use of the water for the above purpose is restricted to beneficial use on the lands or place of use described.

A description of the place of use to which this right is appurtenant is as follows:

Twp	Rng	Mer	Sec	Q-Q	Acres
15 S	40 E	WM	11	NE SW	4.3
15 S	40 E	WM	11	SE SW	35.2
15 S	40 E	WM	11	NE SE	4.7
15 S	40 E	WM	11	NW SE	4.8
15 S	40 E	WM	11	SW SE	39.2
15 S	40 E	WM	11	SE SE	38.3

This certificate describes that portion of the water right confirmed by Certificate 44207, State Record of Water Right Certificates, NOT modified by the provisions of an order of the Water Resources Director entered FEB 17 2005, approving Transfer Application 8787.

The issuance of this superseding certificate does not confirm the status of the water right in regard to the provisions of ORS 540.610 pertaining to forfeiture or abandonment.

WITNESS the signature of the Water Resources Director, affixed FEBRUARY 17, 2005.

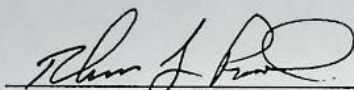
Phillip C. Ward, Director

STATE OF OREGON
 COUNTY OF MALHEUR
 CERTIFICATE OF WATER RIGHT

THIS CERTIFICATE ISSUED TO

RAYMOND & JEAN BELNAP
 4137 KOCHEMEIER ROAD
 VALE OR 97918

confirms the right to use the waters of WELL#4 in the LYMAN CR, a tributary of the COW CR BASIN for IRRIGATION of 40.80 ACRES.

This right was perfected under Permit U-490. The date of priority is FEBRUARY 2, 1953. The amount of water to which this right is entitled is limited to an amount actually used beneficially, and shall not exceed 0.51 CUBIC FOOT PER SECOND or its equivalent in case of rotation, measured at the well.

The well is located as follows:

Twp	Rng	Mer	Sec	Q-Q	Survey Coordinates
15 S	40 E	WM	10	NW SE	1460 feet North & 2600 Feet West from SE cor, S10

The amount of water used for irrigation, together with the amount secured under any other right existing for the same lands, is limited to a diversion of ONE-EIGHTIETH of one cubic foot per second, or its equivalent for each acre irrigated, and shall be further limited to a diversion of not to exceed 3 acre-feet per acre for each acre irrigated during the irrigation season of each year. The use shall conform to such reasonable rotation system as may be ordered by the proper state officer. The right to the use of the water for the above purpose is restricted to beneficial use on the lands or place of use described.

A description of the place of use to which this right is appurtenant is as follows:

Township	Range	Mer	Sec	Q-Q	Acres
15 S	40 E	WM	10	NW SE	22.3
15 S	40 E	WM	10	SW SE	18.5

This certificate describes that portion of the water right confirmed by Certificate 44208, State Record of Water Right Certificates, NOT modified by the provisions of an order of the Water Resources Director entered FEB 17 2005, approving Transfer Application 8787.

The issuance of this superseding certificate does not confirm the status of the water right in regard to the provisions of ORS 540.610 pertaining to forfeiture or abandonment.

WITNESS the signature of the Water Resources Director, affixed FEBRUARY 17, 2005.

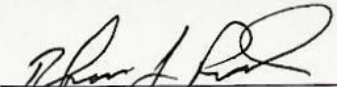
 Phillip C. Ward, Director

Recorded in State Record of Water Right Certificates numbered 81212

STATE OF OREGON
COUNTY OF MALHEUR
CERTIFICATE OF WATER RIGHT

THIS CERTIFICATE ISSUED TO

BURTON HAVERFIELD
CULVER, OREGON 97734

confirms the right to use the waters of WELL NO. 3 in the COW CREEK BASIN for IRRIGATION OF 81.6 ACRES.

This right was perfected under Permit U-350. The date of priority is SEPTEMBER 18, 1950. The amount of water to which this right is entitled is limited to an amount actually beneficially used and shall not exceed 1.02 CUBIC FEET PER SECOND or its equivalent in case of rotation, measured at the well.

The well is located as follows:

NW $\frac{1}{4}$ NE $\frac{1}{4}$, SECTION 10, T 15 S, R 40 E, W.M.; 1250 FEET SOUTH AND 1980 FEET WEST FROM THE NE CORNER, SECTION 10.

The amount of water used for irrigation, together with the amount secured under any other right existing for the same lands, is limited to a diversion of ONE-EIGHTIETH of one cubic foot per second, or its equivalent for each acre irrigated and shall be further limited to a diversion of not to exceed 3.0 acre-feet per acre for each acre irrigated during the irrigation season of each year.

The use shall conform to such reasonable rotation system as may be ordered by the proper state officer.

A description of the place of use to which this right is appurtenant is as follows:

NE $\frac{1}{4}$ NE $\frac{1}{4}$ 30.6 ACRES
NW $\frac{1}{4}$ NE $\frac{1}{4}$ 36.8 ACRES
SW $\frac{1}{4}$ NE $\frac{1}{4}$ 1.5 ACRES
SE $\frac{1}{4}$ NE $\frac{1}{4}$ 3.8 ACRES
SECTION 10

NW $\frac{1}{4}$ NW $\frac{1}{4}$ 7.0 ACRES
SW $\frac{1}{4}$ NW $\frac{1}{4}$ 1.9 ACRES
SECTION 11

TOWNSHIP 15 SOUTH, RANGE 40 EAST, W.M.

This certificate describes that portion of the water right confirmed by Certificate 46078, State Record of Water Right Certificates, NOT modified by the provisions of an order of the Water Resources Director entered FEB 17 2005, approving Transfer Application 8787 for a change in place of use and point of appropriation.

The issuance of this superseding certificate does not confirm the status of the water right in regard to the provisions of ORS 540.610 pertaining to forfeiture or abandonment.

The right to the use of the water for the above purpose is restricted to beneficial use on the lands or place of use described.

WITNESS the signature of the Water Resources Director, affixed FEBRUARY 17, 2005.

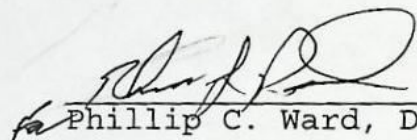

Phillip C. Ward, Director

FINAL PROOF SURVEY IN THE NAME OF RANKIN CROW

SURVEYED, SEPTEMBER 11 THRU 16, 1956

BY C.O. BARTELS

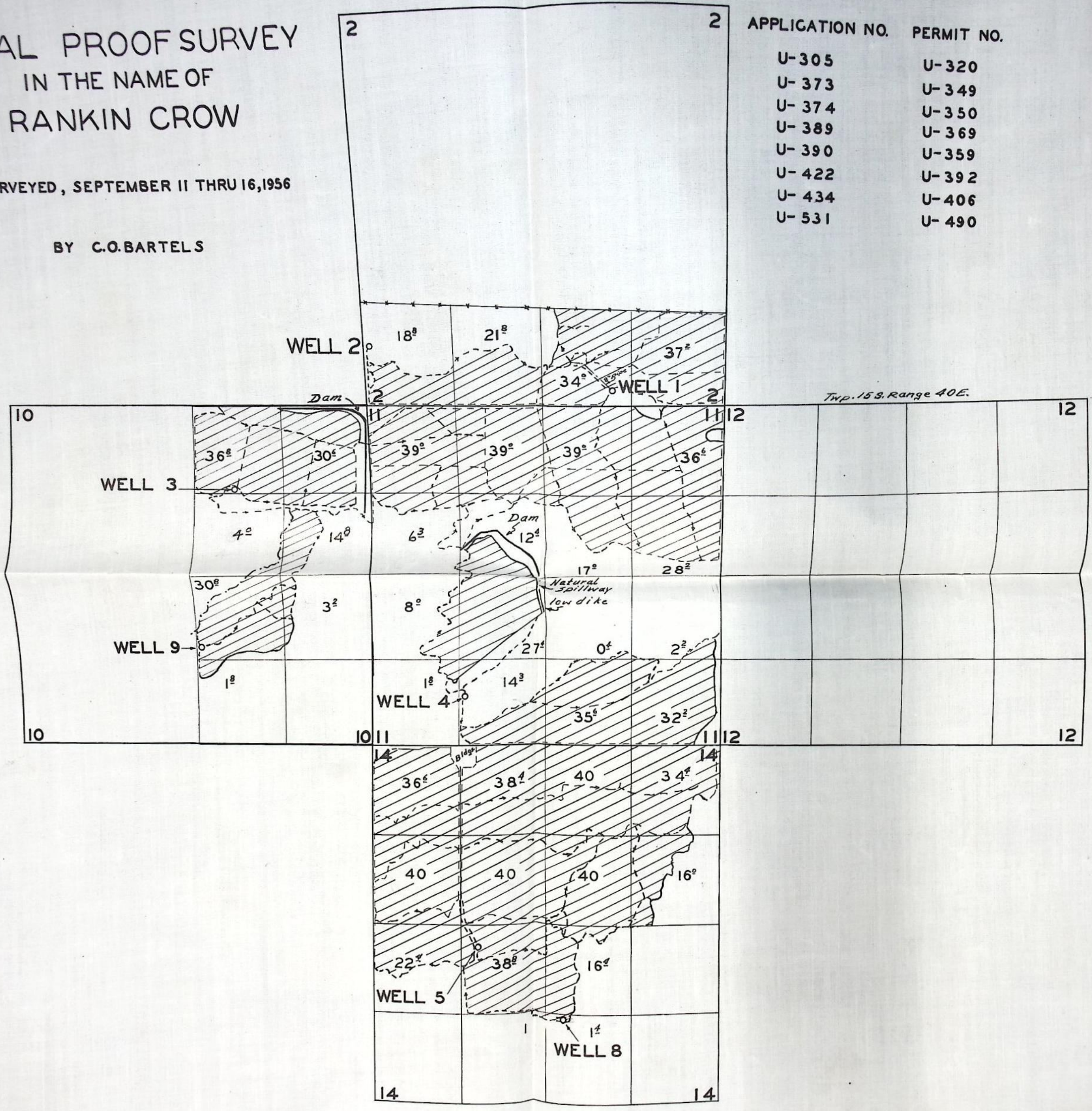
APPLICATION NO.	PERMIT NO.
U-305	U-320
U-373	U-349
U-374	U-350
U-389	U-369
U-390	U-359
U-422	U-392
U-434	U-406
U-531	U-490



LEGEND

Existing right (no change) - - - - - 39

Transfer right from - - - - -

Transfer right to - - - - -

RECEIVED
MAY 11 1970
STATE ENGINEER
SALEM OREGON

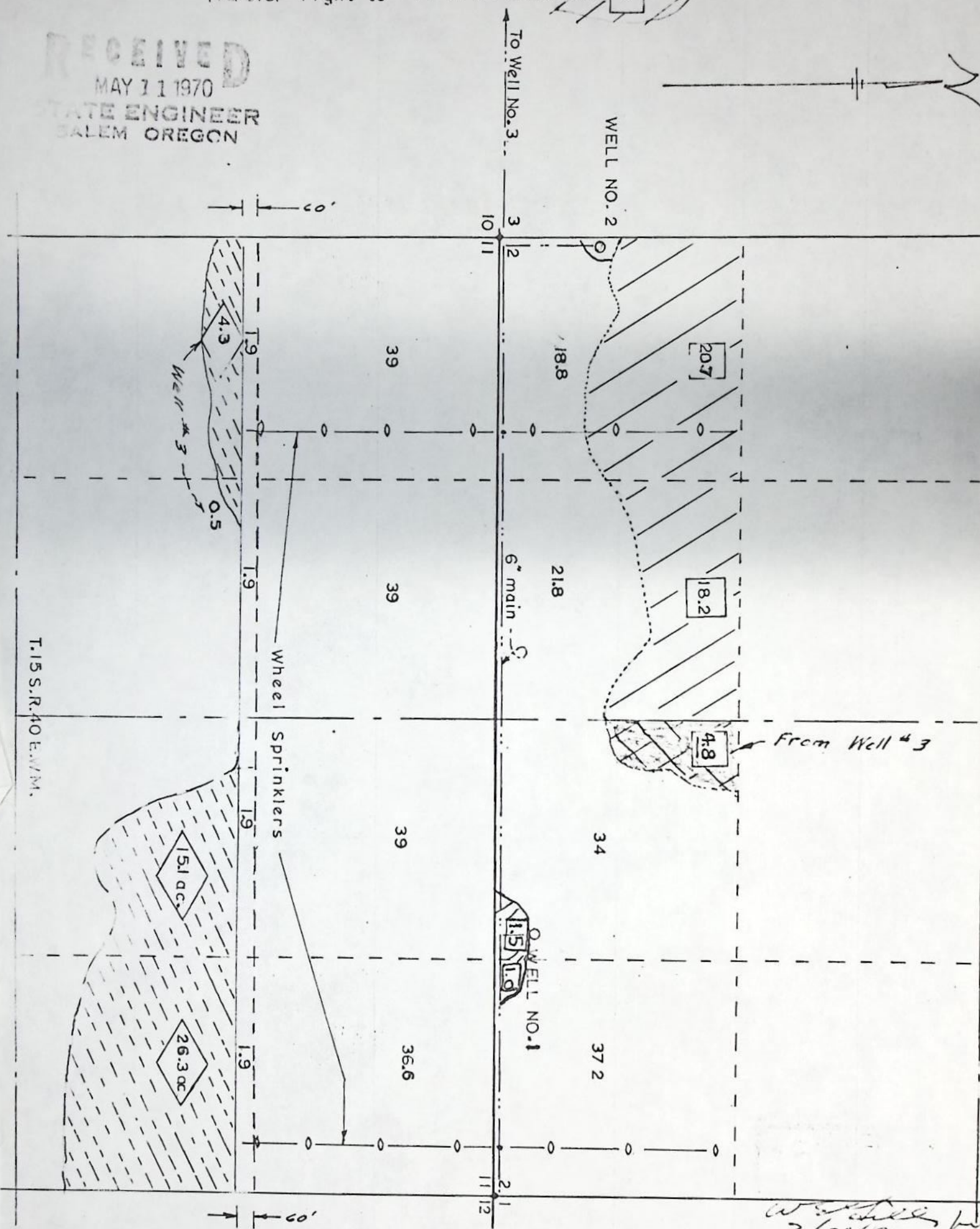

APPLICATION FOR CHANGE IN PLACE OF USE
Burton Haverfield - Ironsides, Oregon
Scale 1"=660'

T-2378

W. Haverfield
3/24/70
Rec 9/11/70

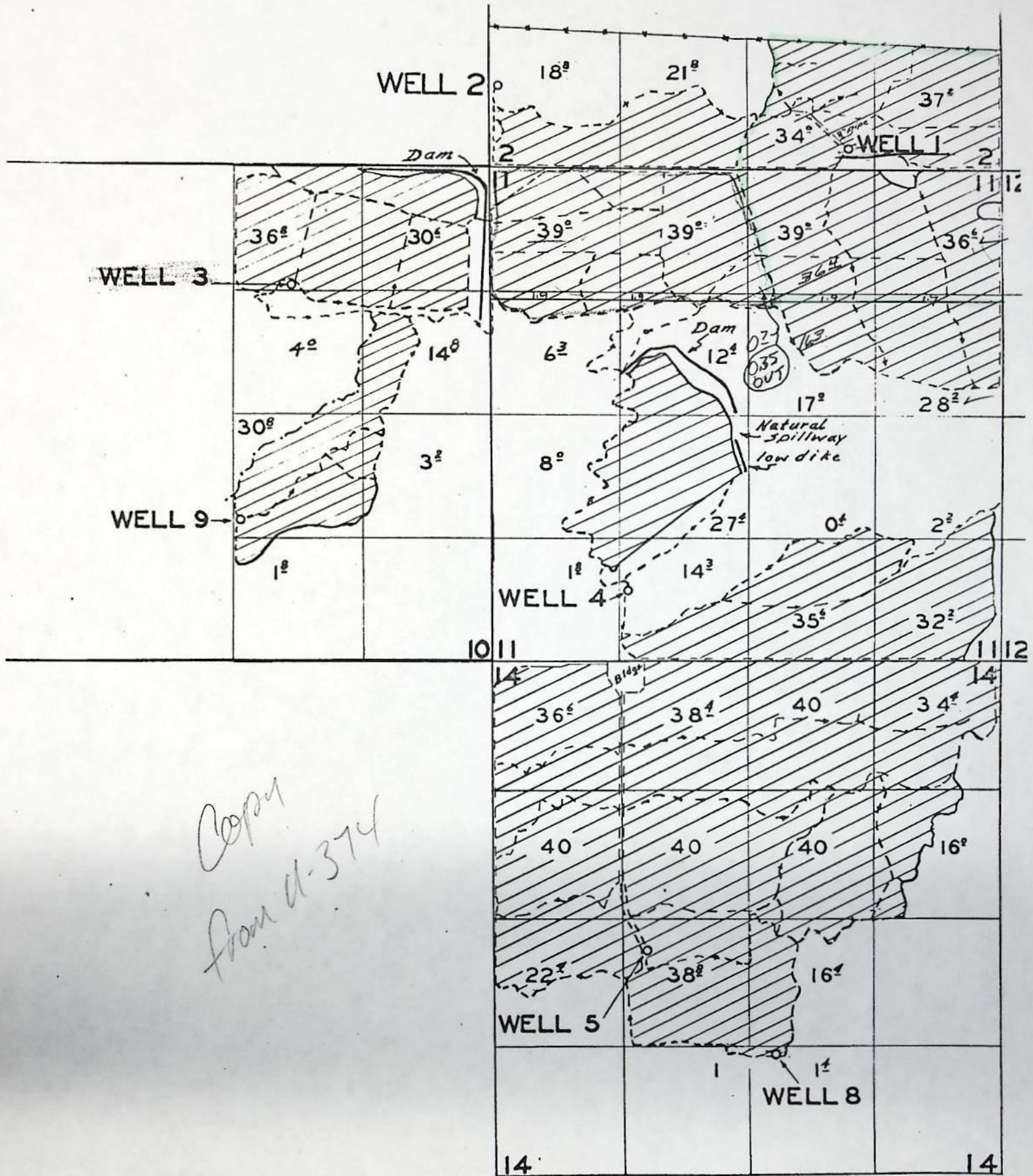

*Copy
from 4-374*

Permit No. U-320

Transfer No. T-2376

County Malheur

PROOF OF APPROPRIATION OF WATER

1. Name - Burton Haverfield 2. Address - Box 218, Emmett, ID 83617
 3. Source of Supply - one well #1
 Tributary of Cow Creek, Malheur River
 4. Amount of Water - 2.36 cubic feet per second 5. Priority date Feb. 14, 1950
 6. Use - irrigation
 7. Location of point of diversion - SW $\frac{1}{4}$ SE $\frac{1}{4}$, Section 2, T. 15 S., R. 40 E., W. M.

8. The description of land given below and as shown on the attached map corresponds to that found to be irrigated:

20.7 acres SW $\frac{1}{4}$ SW $\frac{1}{4}$
 18.05 acres SE $\frac{1}{4}$ SW $\frac{1}{4}$
 35.4 acres SW $\frac{1}{4}$ SE $\frac{1}{4}$
 38.2 acres SE $\frac{1}{4}$ SE $\frac{1}{4}$
 Section 2

36.6 acres NE $\frac{1}{4}$ NE $\frac{1}{4}$
 36.4 acres NW $\frac{1}{4}$ NE $\frac{1}{4}$
 1.55 acres SW $\frac{1}{4}$ NE $\frac{1}{4}$
 1.9 acres SE $\frac{1}{4}$ NE $\frac{1}{4}$
 0.2 acre NE $\frac{1}{4}$ NW $\frac{1}{4}$
 Section 11

T. 15 S., R. 40 E., W. M.

RECEIVED

MAR 19 1977

WATER RESOURCES DEPT
SALEM, OREGON

I have read the above and foregoing proof of appropriation of water defining the extent of use of water under the change of in place of use approved by the order of the State Engineer entered Jan. 19, 1971; I know the contents thereof, and that the facts therein stated are true.

IN WITNESS WHEREOF, I have hereunto set my hand this 16th day of MARCH, 1977.

Burton O. Haverfield
 Legal owner of the above described lands

BEFORE THE STATE ENGINEER OF OREGON

Malheur County

IN THE MATTER OF THE APPLICATION)
OF BURTON HAVERFIELD FOR THE AP-)
PROVAL OF A CHANGE IN PLACE OF)
USE OF WATER FROM WELL NO. 1)

ORDER APPROVING
TRANSFER NO. 2376

On May 11, 1970, Burton Haverfield filed an application in the office of the State Engineer for the approval of a change in place of use of water from Well No. 1, pursuant to the provisions of ORS 540.510 to 540.530.

Certificate of water right issued to Rankin Crow and recorded at page 23627, Volume 17, State Record of Water Right Certificates, confirms a right to the use of 2.36 cubic feet per second of the waters of Well No. 1 for the irrigation of, among other lands, 14.75 acres in SW $\frac{1}{4}$ NE $\frac{1}{4}$ and 26.3 acres in SE $\frac{1}{4}$ NE $\frac{1}{4}$, Section 11, Township 15 South, Range 40 East, W.M., with a date of priority of February 14, 1950.

The applicant herein, contract purchaser of the lands above described, proposes to transfer the water right therefrom, without loss of priority, to 20.7 acres in SW $\frac{1}{4}$ SW $\frac{1}{4}$, 17.85 acres in SE $\frac{1}{4}$ SW $\frac{1}{4}$, 1.5 acres in SW $\frac{1}{4}$ SE $\frac{1}{4}$ and 1.0 acre in SE $\frac{1}{4}$ SE $\frac{1}{4}$, Section 2, Township 15 South, Range 40 East, W.M.

Notice by publication as provided by ORS 540.520 was not given in connection with this application for the reason that said section provides notice is not required on an application for a change in place of use of water.

Mr. Frank W. Elfering, Watermaster of District No. 9, has filed a statement to the effect that the proposed change in place of use of water may be made without injury to existing rights.

Rankin Crow, contract seller of the land involved, has submitted written approval of the change in place of use.

No objections having been filed and it appearing that the proposed change in place of use of water may be made without injury to existing rights, the application should be approved.

NOW, THEREFORE, it hereby is ORDERED that the proposed change in place of use of water is approved and the water right hereinbefore described as appurtenant to 14.75 acres in SW $\frac{1}{4}$ NE $\frac{1}{4}$ and 26.3 acres in SE $\frac{1}{4}$ NE $\frac{1}{4}$, Section 11, Township 15 South, Range 40 East, W.M., with a date of priority of February 14, 1950, be severed therefrom and simultaneously and without loss of priority transferred to 20.7 acres in SW $\frac{1}{4}$ SW $\frac{1}{4}$, 17.85 acres in SE $\frac{1}{4}$ SW $\frac{1}{4}$, 1.5 acres in SW $\frac{1}{4}$ SE $\frac{1}{4}$ and 1.0 acres in SE $\frac{1}{4}$ SE $\frac{1}{4}$, Section 2, Township 15 South, Range 40 East, W.M.

It is FURTHER ORDERED that said water so transferred shall be applied to beneficial use on or before October 1, 1971.

It is FURTHER ORDERED that certificate of water right heretofore issued to Rankin Crow and recorded at page 23627, Volume 17, State Record of Water Right Certificates, is canceled and upon receipt of proof satisfactory to the State Engineer of application of water to beneficial use, a certificate of water right shall be issued to Burton Haverfield confirming the extent to which the water has been applied beneficially and covering the balance of the lands not involved in this proceeding.

Dated at Salem, Oregon, this 19th day of January, 1971.

/s/ CHRIS L. WHEELER
State Engineer

RECEIVED

MAR 1 1977

WATER RESOURCES DEPT
SALEM, OREGON

T.15 S. R.40 E. W.M.

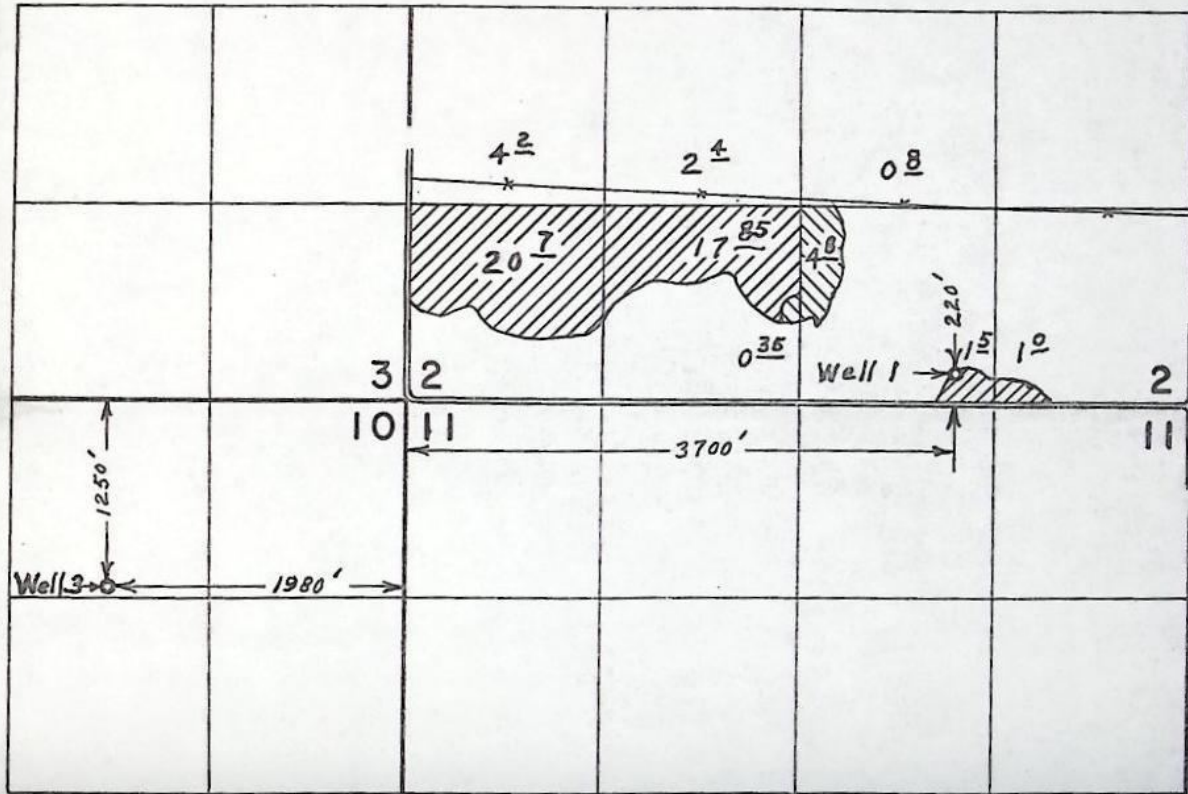

FINAL PROOF SURVEY UNDER

Transfer No. 2376



Transfer No. 2378



Application No. Permit No.

IN NAME OF

BURTON HAVERFIELD

Surveyed *May 1, 1975*, by *L. E. Gould*

LEGEND

Existing right (no change) - - - - - 39

Transfer right from - - - - -

Transfer right to - - - - -

RECEIVED MAY 11 1970
STATE ENGINEER
 SALEM OREGON

RECEIVED MAY 20 1970
STATE ENGINEER
 SALEM, OREGON

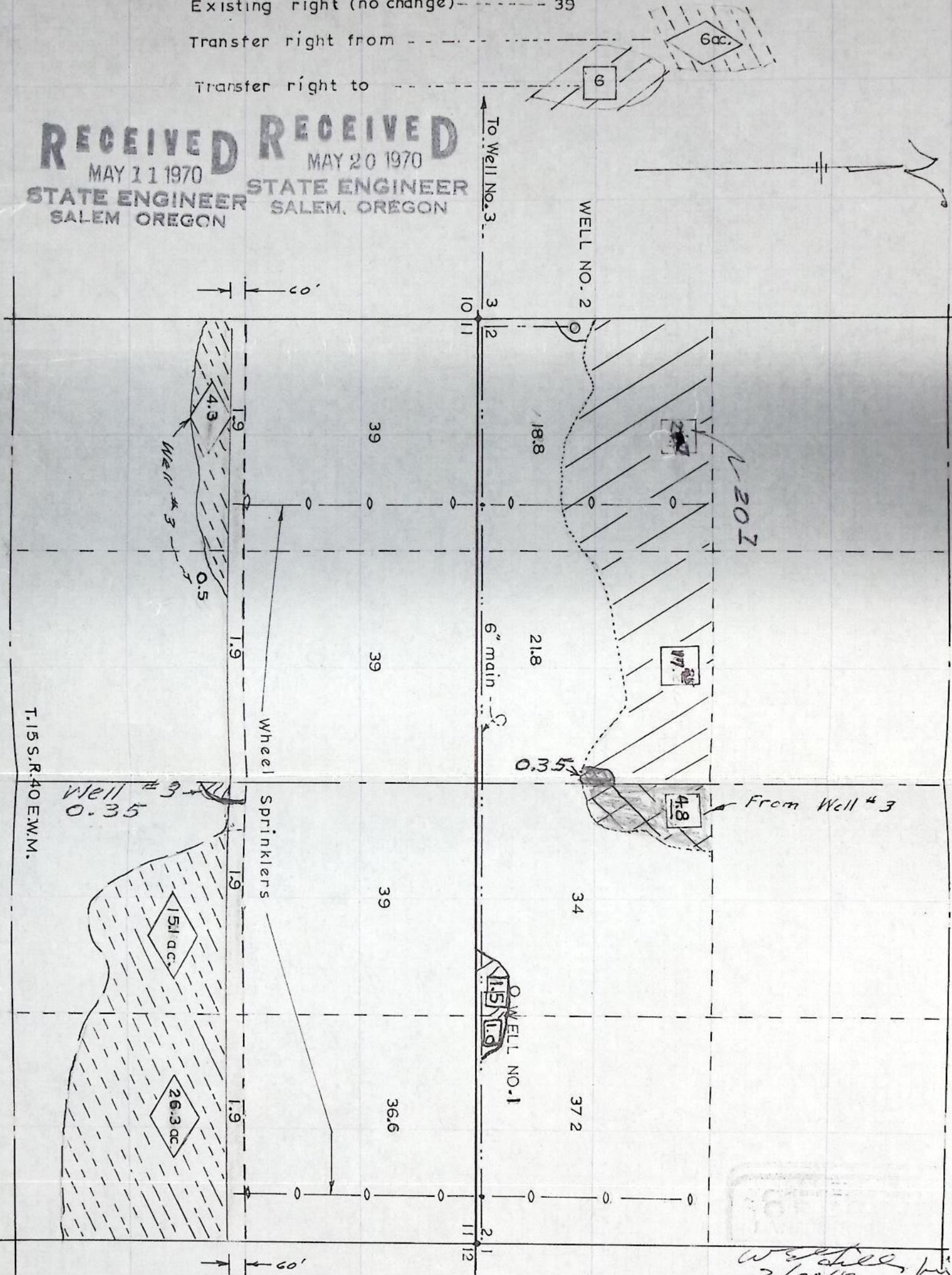

APPLICATION FOR CHANGE IN PLACE OF USE
 Burton Haverfield - Ironsides, Oregon
 Scale 1"=660'

W. J. Haverfield
 3/20/70
 344
 Rev 9/18/70
 Rev 5/18/70

2738 #2376

CHANGE IN PLACE OF USE

BBC-17N-159
 May 1, 1975
 L. E. G.

REPORT ON INSPECTION UNDER
 TRANSFER OF WATER RIGHT FOR

Transfer No. 2376 County Maheur

1. Name Burton Haverfield Address Box 218 Emmett, Idaho, 83617

2. Source of Supply Well #1, Trib. of Willow Creek

3. Amount of Water 2.36 cfs Priority Date 2/14/50

4. Use irrigation

5. Proposed Point of Diversion _____

6. Place of Use DATE FOR APPLICATION OF WATER: 10/1/71

Township	Range	Section	Forty Acre Tract	Use for Which Transfer Made	
15 S	40 E	2	SW $\frac{1}{4}$ SW $\frac{1}{4}$		20.7 acres ✓
15 S	40 E	2	SE $\frac{1}{4}$ SW $\frac{1}{4}$		17.85 acres ✓
15 S	40 E	2	SW $\frac{1}{4}$ SE $\frac{1}{4}$		1.5 acres ✓
15 S	40 E	2	SE $\frac{1}{4}$ SE $\frac{1}{4}$		1.0 acre ✓

No "C" record

Info: Mr. Ken Dinger (Ranch Foreman)

Well #1 10" Casing
Static W.L. approx. 80'

Well Pump: 40 H.P. U.S., 3ph., 1800 R.P.M.
Dir. Dr. Peerless Turbine, 8" Disch.

Booster Pump: 50 H.P. G.E., 3ph., 3545 R.P.M.
D. D. Goulds Cent. 5" x 5"

Pipe: 4000' 6" Alum. } (Main)
1320' 5" " }
2 miles 4" Alum. (Wheel Move)

Heads: 264 R.B. #30 - $\frac{11}{64}$

Note: Mr. Dinger said that all heads can be operated at one time with pumps on wells #1, #2 & #3 manifolded together.

Crop: Hay & Grain

Lift: Approx. 120' to top well 0' top well to ground

Tie: Shown on Photo BBC-17N-159

Note: Mr. Dinger said that he connects Wells #1, 2, & 3 together when irrigating.

May 1, 1975, L. E. Gould
Field Engineer

RECEIVED
MAY 11 1970
STATE ENGINEER
SALEM OREGON

RECEIVED
MAY 20 1970
STATE ENGINEER
SALEM, OREGON

236

Application for Transfer of Water Right

To the STATE ENGINEER OF OREGON:

I, Burton Haverfield
(Name of applicant)

of Emmett, County of Gem
(Postoffice)

State of Idaho, do hereby make application for change of place of use

(In point of diversion; place of use; use heretofore made of the water)

1. The source of present water right is Well no. 1
(Name of stream)

2. The use to which the water is applied is Irrigation
(Irrigation; Mining; Power; Manufacturing; etc.)

3. The name of the ditch, canal or pipe line is ~~200xftxNorthxandx1040xftxfromxS1/4~~

4. The point of diversion is located 200 ft. N and 1040 ft. E from the S1/4
(N. or S.) (E. or W.)

corner of Sec. 2, T. 15 S., R. 40 E. being within the SW1/4 SE1/4
(Section or subdivision)

of Section 2 Tp. 15 S R. 40 W. M., in the County of Malheur
(No. N. or S.) (No. E. or W.)

5. List the number of acres irrigated in each smallest legal subdivision (40-acre tract) involved in this transfer. If for any other use, indicate place of use.

Twp.	Range	Sec.	NE 1-4				NW 1-4				SW 1-4				SE 1-4			
			NE $\frac{1}{4}$	NW $\frac{1}{4}$	SW $\frac{1}{4}$	SE $\frac{1}{4}$	NE $\frac{1}{4}$	NW $\frac{1}{4}$	SW $\frac{1}{4}$	SE $\frac{1}{4}$	NE $\frac{1}{4}$	NW $\frac{1}{4}$	SW $\frac{1}{4}$	SE $\frac{1}{4}$	NE $\frac{1}{4}$	NW $\frac{1}{4}$	SW $\frac{1}{4}$	SE $\frac{1}{4}$
15S	40E	11			14.25	✓												
					35.1													
					26.3													

NOTE: If you own less than 40-acre tracts, attach a description of your land as it appears in your deed.

(Attach separate sheet if necessary)

6. Are you the legal owner of the above described lands? Purchaser under contract of
(If not owner, explain your interest)
sale dated December, 1968

7. Has water been used beneficially for the purposes indicated herein during the past 5 years? yes

8. What is the date of priority of your water right? certificate No. 23267, February 14, 1950

9. Was your water right acquired by State Engineer's Permit? Yes If so, give number
(Yes or No)

of permit U 320, certificate 23627

10. Do you hold a water right certificate? yes If so, give number of certificate 23627
(Yes or No)

11. Was your water right determined by State Engineer's order of Determination or Decree of Court?

No If so, give title of proceedings
(Yes or No)

12. Is the water right recorded in your name? Rankin Crow
(If not, give name)

13. I propose to transfer the water right to the following described lands: (Do not answer if your application is for change in point of diversion only.)

Twp.	Range	Sec.	NE 1-4				NW 1-4				SW 1-4				SE 1-4				
			NE $\frac{1}{4}$	NW $\frac{1}{4}$	SW $\frac{1}{4}$	SE $\frac{1}{4}$	NE $\frac{1}{4}$	NW $\frac{1}{4}$	SW $\frac{1}{4}$	SE $\frac{1}{4}$	NE $\frac{1}{4}$	NW $\frac{1}{4}$	SW $\frac{1}{4}$	SE $\frac{1}{4}$	NE $\frac{1}{4}$	NW $\frac{1}{4}$	SW $\frac{1}{4}$	SE $\frac{1}{4}$	
15 S	40E	2																1.5	1.0

(Attach separate sheet if necessary)

NOTE: Answer questions 14, 15, 16 and 17, if the application is for change in point of diversion.

14. The proposed point of diversion is located ft. and ft. from the
(N. or S.) (E. or W.)
 corner of being within the of Section Tp. R. W. M.,
(Smallest legal subdivision) (No. N. or S.) (No. E. or W.)
 in the county of The name of the ditch to be used is

15. Are you the owner of the land on which the proposed point of diversion is to be located?

16. If not the owner of the land on which the proposed point of diversion is to be located, give the name and address of owner and submit evidence of your right-of-way for your proposed ditch, canal, or pipe line.

.....

17. Are there any diversions between your present point of diversion and the proposed point of diversion?

NOTE: Answer questions 18 and 19 if application is for change in use or place of use.

18. Are the lands from which you propose to transfer your water right free of all encumbrances, including taxes, mortgages, liens, etc.?
(Answer Yes or No)

19. If not, give below a description of existing encumbrances:

NATURE OF ENCUMBRANCE	HELD BY	AMOUNT

20. Reasons for the proposed changes are See remarks, below.

.....

RECEIVED
 RECEIVED

AFFIDAVIT OF APPLICANT

STATE OF OREGON,

County of Malheur } ss.

I, Burton Haverfield, the applicant herein, being first duly sworn, depose and say that I have read the above and foregoing application for transfer of water right; that I know the contents thereof and that the statements therein made are true and correct to the best of my knowledge and belief.

In Witness Whereof, I have hereunto set my hand this 8th day of May, 1970

Burton Haverfield (Name of applicant)

Subscribed and sworn to before me this 8th day of May, 1970

[Notarial Seal]

Bill L. Hillis NOTARY PUBLIC FOR OREGON

My commission expires 11/6/71

Remarks Method of irrigation has been changed from contour and furrows to sprinkler application. To further improve efficiency and water application the applicant intends to install wheel type, self-propelled sprinklers. Area adjacent to well #1 has been leveled sufficiently to accomodate sprinklers. Use of self-propelled sprinklers requires approximately parallel boundaries. In order to adjust the field goundaries, it will be necessary to make the above change in place of use.

THIS APPLICATION MUST BE ACCOMPANIED BY A MAP SHOWING THE LOCATION OF THE POINT OF DIVERSION, PLACE OF USE AND WORKS UTILIZED UNDER THE PRESENT WATER RIGHT. THE MAP SHOULD ALSO SHOW THE NEW POINT OF DIVERSION OR PLACE OF USE, AS THE CASE MAY BE.