

2671 Gary Heisey  
Caw Valley Ranches, Inc.  
Ironside Ave.

T-2671

STATUS OF APPLICATION

Change in Place of Use  
Date filed July 3, 1972  
Date of hearing \_\_\_\_\_  
Place of hearing \_\_\_\_\_  
Date of order Aug 3, 1972 Vol. 22, page 138  
Date for application of water 12-1-73  
Proof mailed \_\_\_\_\_  
Proof received \_\_\_\_\_  
Certificate issued MAR 9 1977 Vol. \_\_\_\_\_, page 44207  
89178

DESCRIPTION OF WATER RIGHT

Name of stream Rankin Crow Well No 4  
Trib. of \_\_\_\_\_ County of Malheur  
Use Irrigation  
Quantity of water \_\_\_\_\_ No. of acres 44 1/2  
Name of ditch \_\_\_\_\_  
Date of priority Feb. 5, 1951  
In name of Rankin Crow  
\_\_\_\_\_ Adjudication, Vol. \_\_\_\_\_, page \_\_\_\_\_  
App. No. U-389 Per. No. U-369 Cert. No. 23630  
Certificate cancelled \_\_\_\_\_  
Notation made on record by \_\_\_\_\_

FEES PAID

Date	Amount	Receipt No.
<u>7/3/72</u>	<u>25.00</u>	<u>29501</u>
TOTAL . . .		
<u>2-8-77</u>	<u>\$2</u> Cert. Fee	<u>57993</u>

FEES REFUNDED

Date	Amount	Check No.
<u>8-28-72</u>	<u>\$2.75</u>	<u>4895</u>

REMARKS

T-8787 A POU/POA

	INDEX CARDS:		Entered	Checked
	TO BE ENTERED WHEN CHECKED			
<input checked="" type="checkbox"/>	Name		<u>st</u>	
<input checked="" type="checkbox"/>	Stream		<u>st</u>	
<input checked="" type="checkbox"/>	Pt. of Div.			
<input checked="" type="checkbox"/>	Calendar		<u>st</u>	
CHECKED TO RECORDS:				
<input checked="" type="checkbox"/>	Twp. & Rge.		<u>st</u>	
<input checked="" type="checkbox"/>	Decree-vault			
<input checked="" type="checkbox"/>	Decree-safe			
<input checked="" type="checkbox"/>	Cert. of W/R		<u>st</u>	
<input checked="" type="checkbox"/>	Per. Folder		<u>st</u>	
<input type="checkbox"/>	Chainindex			
<input type="checkbox"/>	Cross Ref.			
<input type="checkbox"/>	Power Claim			
<input type="checkbox"/>	Abstracts			



STATE OF OREGON  
COUNTY OF MALHEUR  
CERTIFICATE OF WATER RIGHT

THIS CERTIFICATE ISSUED TO

RAYMOND S. AND JEAN BELNAP  
4137 KOCHSMEIER RD  
VALE OR 97918

confirms the right to use the waters of WELL #2 within the COW CREEK BASIN for IRRIGATION of 5.5 ACRES.

This right was perfected under Permit U-369. The date of priority is FEBRUARY 5, 1951. The amount of water to which this right is entitled is limited to an amount actually used beneficially, and shall not exceed 0.07 CUBIC FOOT PER SECOND, or its equivalent in case of rotation, measured at the well .

The well is located as follows:

Twp	Rng	Mer	Sec	Q-Q	Measured Distances
15 S	40 E	WM	2	SW SW	WELL #2 - 880 FEET NORTH & 55 FEET EAST FROM SW CORNER, SECTION 2

The amount of water used for irrigation, together with the amount secured under any other right existing for the same lands, shall be limited to ONE-EIGHTIETH of one cubic foot per second, or its equivalent for each acre irrigated, and shall be further limited to a diversion of not to exceed 3.0 acre-feet per acre for each acre irrigated during the irrigation season of each year.

The use shall conform to such reasonable rotation system as may be ordered by the proper state officer.

A description of the place of use is as follows:

IRRIGATION					
Twp	Rng	Mer	Sec	Q-Q	Acres
15 S	40 E	WM	2	SE SW	5.5

The quantity of water diverted at the new point of appropriation (well) shall not exceed the quantity of water lawfully available from the original point of appropriation located as follows:

Twp	Rng	Mer	Sec	Q-Q	Measured Distances
15 S	40 E	WM	11	SE SW	WELL #4 - 730 FEET NORTH & 1400 FEET EAST FROM SW CORNER, SECTION 11

When required by the Department the water user shall install an in-line flow meter or other suitable device for measuring and recording the quantity of water used. The type and plans of the measuring device must be approved by the Department prior to beginning construction and shall be installed under the general supervision of the Department.

**NOTICE OF RIGHT TO PETITION FOR RECONSIDERATION OR JUDICIAL REVIEW**

This is an order in other than a contested case. This order is subject to judicial review under ORS 183.482. Any petition for judicial review must be filed within the 60-day time period specified by ORS 183.482. Pursuant to ORS 183.482, ORS 536.075 and OAR 137-003-0675, you may petition for judicial review and petition the Director for reconsideration of this order. A petition for reconsideration may be granted or denied by the Director, and if no action is taken within 60 days following the date the petition was filed, the petition shall be deemed denied.



Water shall be acquired from the same aquifer as the original point of appropriation.

The right to the use of the water for the purposes aforesaid is restricted to the lands or place of use herein described.

The right to the use of the water for the purpose aforesaid is restricted to the lands or place of use herein described and is subject to the existing minimum flow policies established by the Water Policy Review Board.

This certificate is issued to confirm a change in PLACE OF USE and POINTS OF APPROPRIATION approved by an order of the Water Resources Director entered February 17, 2005, at Special Order Volume 63, Page 311, approving Transfer Application T- 8787, and together with Certificate 81211, supersedes Certificate 44207, State Record of Water Right Certificates.

Issued APR 09 2014

A handwritten signature in cursive script, appearing to read "Dwight French", written over a horizontal line.

Dwight W. French  
Administrator, Water Right Services, for  
Phillip C. Ward, Director  
Oregon Water Resources Department

T.15 S. R.40 E. W.M.

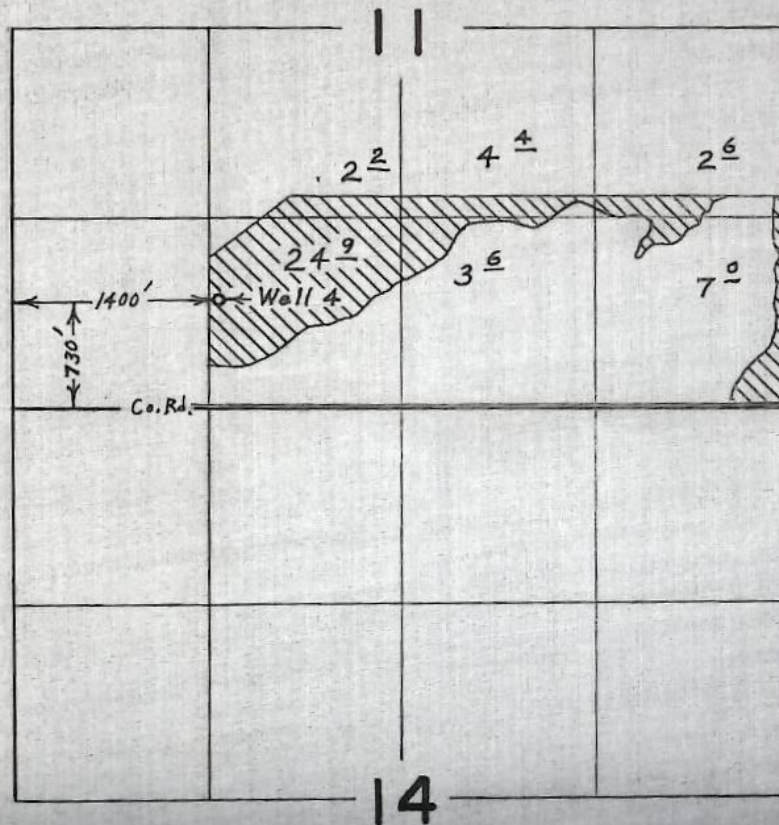

**FINAL PROOF SURVEY**  
UNDER

Application No. \_\_\_\_\_ Transfer No. 2671  
Permit No. \_\_\_\_\_  
IN NAME OF  
**COW VALLEY RANCHES**

Surveyed May 1, 1975, by L. E. Gould



T-2671

STATE OF OREGON

COUNTY OF MALHEUR

ORDER APPROVING A CHANGE IN PLACE OF USE,  
POINT OF APPROPRIATION, ADDITIONAL POINT OF APPROPRIATION AND  
PARTIAL CANCELLATION OF A WATER RIGHT

Pursuant to ORS 537.705, after notice was given and no objections were filed, and finding that no injury to existing water rights would result, this order approves, as conditioned or limited herein, TRANSFER 8787 submitted by

RAYMOND S. AND JEAN BELNAP  
4137 KOICHEMIER ROAD  
VALE, OREGON 97918.

The FIRST right to be modified, as evidenced by a PORTION of Certificate 23628, was perfected under Permit U-349 with a date of priority of SEPTEMBER 18, 1950. The right allows the use of WELL NO. 2, in the COW CREEK BASIN, for IRRIGATION OF 16.9 ACRES. The amount of water to which this right is entitled is limited to an amount actually beneficially used and shall not exceed 0.21 cubic foot per second, if available at the original well; SW $\frac{1}{4}$  SW $\frac{1}{4}$ , SECTION 2, T 15 S, R 40 E, W.M., or its equivalent in case of rotation, measured at the well.

---

This is an order in other than a contested case. This order is subject to judicial review under ORS 183.484. Any petition for judicial review must be filed within the 60 day time period specified by ORS 183.484(2).

Pursuant to ORS 536.075 and OAR 137-004-080 and OAR 690-01-005 you may either petition for judicial review or petition the Director for reconsideration of this order.

The amount of water used for irrigation, together with the amount secured under any other right existing on the same lands, is limited to ONE-EIGHTIETH of one cubic foot per second per acre, or its equivalent for each acre irrigated and shall be further limited to a diversion of not to exceed 3.0 acre-feet per acre for each acre irrigated during the irrigation season of each year.

The use shall conform to any reasonable rotation system ordered by the proper state officer.

The authorized place of use is as follows:

POU ONLY

SW $\frac{1}{4}$ SW $\frac{1}{4}$	0.2 ACRES
SE $\frac{1}{4}$ SW $\frac{1}{4}$	16.6 ACRES
SW $\frac{1}{4}$ SE $\frac{1}{4}$	0.1 ACRES

SECTION 2

TOWNSHIP 15 SOUTH, RANGE 40 EAST, W.M.

The right to use water for the above purpose is restricted to beneficial use on the lands or place of use described.

The SECOND right to be modified, as evidenced by a PORTION of Certificate 23632, was perfected under Permit U-391 with a date of priority of MAY 10, 1951. The right allows the use of WELLS NO. 6 & 7, in the COW CREEK BASIN, for IRRIGATION OF 71.4 ACRES. The amount of water to which this right is entitled is limited to an amount actually beneficially used and shall not exceed 0.90 cubic foot per second, if available at the original wells; NO. 6: NW $\frac{1}{4}$  SW $\frac{1}{4}$ , SECTION 8, NO. 7: NE $\frac{1}{4}$  SE $\frac{1}{4}$ , SECTION 7, T 15 S, R 41 E, W.M. , or its equivalent in case of rotation, measured at the well.



The amount of water used for irrigation, together with the amount secured under any other right existing on the same lands, is limited to ONE-EIGHTIETH of one cubic foot per second per acre, or its equivalent for each acre irrigated and shall be further limited to a diversion of not to exceed 3.0 acre-feet per acre for each acre irrigated during the irrigation season of each year.

The use shall conform to any reasonable rotation system ordered by the proper state officer.

The authorized place of use is as follows:

<u>POU ONLY</u>		<u>POU &amp; POA CHANGE</u>
SW $\frac{1}{4}$ SE $\frac{1}{4}$	1.1 ACRES	
SE $\frac{1}{4}$ SE $\frac{1}{4}$	1.3 ACRES	
SECTION 6		
NE $\frac{1}{4}$ NE $\frac{1}{4}$		10.0 ACRES
NE $\frac{1}{4}$ NE $\frac{1}{4}$	2.2 ACRES	
NW $\frac{1}{4}$ NE $\frac{1}{4}$	4.8 ACRES	
SW $\frac{1}{4}$ NE $\frac{1}{4}$	6.7 ACRES	
NE $\frac{1}{4}$ SE $\frac{1}{4}$	0.3 ACRES	
NW $\frac{1}{4}$ SE $\frac{1}{4}$	3.1 ACRES	
SECTION 7		
SE $\frac{1}{4}$ NE $\frac{1}{4}$	0.3 ACRES	
NE $\frac{1}{4}$ NW $\frac{1}{4}$	0.6 ACRES	
NW $\frac{1}{4}$ NW $\frac{1}{4}$		5.0 ACRES
SW $\frac{1}{4}$ NW $\frac{1}{4}$		2.0 ACRES
NE $\frac{1}{4}$ SW $\frac{1}{4}$	3.2 ACRES	
NW $\frac{1}{4}$ SW $\frac{1}{4}$	11.4 ACRES	
NE $\frac{1}{4}$ SE $\frac{1}{4}$	8.8 ACRES	
NW $\frac{1}{4}$ SE $\frac{1}{4}$	4.0 ACRES	
SECTION 8		
SW $\frac{1}{4}$ NW $\frac{1}{4}$	2.1 ACRES	

NW¼ SW¼ 4.5 ACRES  
SECTION 9  
TOWNSHIP 15 SOUTH, RANGE 41 EAST, W.M.

The right to use water for the above purpose is restricted to beneficial use on the lands or place of use described.

The THIRD right to be modified, as evidenced by a PORTION of Certificate 44207, was perfected under Permit U-369 with a date of priority of FEBRUARY 5, 1951. The right allows the use of WELL NO. 4, in the COW CREEK BASIN, for IRRIGATION OF 5.5 ACRES. The amount of water to which this right is entitled is limited to an amount actually beneficially used and shall not exceed 0.07 cubic foot per second, if available at the original well; SE¼ SW¼, SECTION 11, T 15 S, R 40 E, W.M.; 730 FEET NORTH AND 1400 FEET EAST FROM THE SW CORNER, SECTION 11, or its equivalent in case of rotation, measured at the well.

The amount of water used for irrigation, together with the amount secured under any other right existing on the same lands, is limited to ONE-EIGHTIETH of one cubic foot per second per acre, or its equivalent for each acre irrigated and shall be further limited to a diversion of not to exceed 3.0 acre-feet per acre for each acre irrigated during the irrigation season of each year.

The use shall conform to any reasonable rotation system ordered by the proper state officer.

The authorized place of use is as follows:

POU AND POA CHANGE

NE¼ SW¼ 0.5 ACRES  
SE¼ SW¼ 4.0 ACRES  
NE¼ SE¼ 0.1 ACRES  
SE¼ SE¼ 0.9 ACRES



SECTION 11  
TOWNSHIP 15 SOUTH, RANGE 40 EAST, W.M.

The right to use water for the above purpose is restricted to beneficial use on the lands or place of use described.

The FOURTH right to be modified, as evidenced by a PORTION of Certificate 44208, was perfected under Permit U-490 with a date of priority of FEBRUARY 2 1953. The right allows the use of WELL NO. 9, in the COW CREEK BASIN, for IRRIGATION OF 7.2 ACRES. The amount of water to which this right is entitled is limited to an amount actually beneficially used and shall not exceed 0.09 cubic foot per second, if available at the original well; NW¼ SE¼, SECTION 10, T 15 S, R 40 E, W.M.; 1460 FEET NORTH AND 2600 FEET WEST FROM THE SE CORNER, SECTION 10, or its equivalent in case of rotation, measured at the well.

The amount of water used for irrigation, together with the amount secured under any other right existing on the same lands, is limited to ONE-EIGHTIETH of one cubic foot per second per acre, or its equivalent for each acre irrigated and shall be further limited to a diversion of not to exceed 3.0 acre-feet per acre for each acre irrigated during the irrigation season of each year.

The use shall conform to any reasonable rotation system ordered by the proper state officer.

The authorized place of use is as follows:

POU ONLY  
NW¼ SE¼    5.7 ACRES  
SW¼ SE¼    1.5 ACRES  
SECTION 10  
TOWNSHIP 15 SOUTH, RANGE 40 EAST, W.M.

The right to use water for the above purpose is restricted to beneficial use on the lands or place of use described.



The FIFTH right to be modified, as evidenced by a PORTION of Certificate 44316, was perfected under Permit U-320 with a date of priority of FEBRUARY 14, 1950. The right allows the use of WELL NO. 1, in the COW CREEK BASIN, for IRRIGATION OF 67.9 ACRES. The amount of water to which this right is entitled is limited to an amount actually beneficially used and shall not exceed 0.85 cubic foot per second, if available at the original well; SW¼ SE¼, SECTION 2, T 15 S, R 40 E, W.M., or its equivalent in case of rotation, measured at the well.

The amount of water used for irrigation, together with the amount secured under any other right existing on the same lands, is limited to ONE-EIGHTIETH of one cubic foot per second per acre, or its equivalent for each acre irrigated and shall be further limited to a diversion of not to exceed 3.0 acre-feet per acre for each acre irrigated during the irrigation season of each year.

The use shall conform to any reasonable rotation system ordered by the proper state officer.

The authorized place of use is as follows:

POU ONLY

SW¼ SW¼ 20.70 ACRES

SE¼ SW¼ 18.05 ACRES

SW¼ SE¼ 8.50 ACRES

SE¼ SE¼ 6.80 ACRES

SECTION 2

TOWNSHIP 15 SOUTH, RANGE 40 EAST, W.M.

POU ONLY

NE¼ NE¼ 5.20 ACRES

NW¼ NE¼ 5.00 ACRES

SW¼ NE¼ 1.55 ACRES



SE¼ NE¼ 1.90 ACRES

NE¼ NW¼ 0.20 ACRES

SECTION 11

TOWNSHIP 15 SOUTH, RANGE 40 EAST, W.M.

The right to use water for the above purpose is restricted to beneficial use on the lands or place of use described.

The SIXTH right to be modified, as evidenced by a PORTION of Certificate 46078, was perfected under Permit U-350 with a date of priority of SEPTEMBER 18, 1950. The right allows the use of WELL NO. 3, in the COW CREEK BASIN, for IRRIGATION OF 82.1 ACRES. The amount of water to which this right is entitled is limited to an amount actually beneficially used and shall not exceed 1.03 cubic foot per second, if available at the original well; NW¼ NE¼, SECTION 10, T 15 S, R 40 E, W.M.; 1250 FEET SOUTH AND 1980 FEET WEST FROM THE NE CORNER, SECTION 10, or its equivalent in case of rotation, measured at the well.

The amount of water used for irrigation, together with the amount secured under any other right existing on the same lands, is limited to ONE-EIGHTIETH of one cubic foot per second per acre, or its equivalent for each acre irrigated and shall be further limited to a diversion of not to exceed 3.0 acre-feet per acre for each acre irrigated during the irrigation season of each year.

The use shall conform to any reasonable rotation system ordered by the proper state officer.

The authorized place of use is as follows:

	<u>POU ONLY</u>	<u>POU &amp; POA CHANGE</u>
SE¼ SW¼	0.35 ACRES	
SW¼ SE¼		4.80 ACRES
	SECTION 2	
SW¼ NE¼		0.30 ACRES



SE¼ NE¼ 1.00 ACRES

SECTION 10

TOWNSHIP 15 SOUTH, RANGE 40 EAST, W.M.

	<u>POU ONLY</u>	<u>POA ONLY</u>	<u>POU &amp; POA CHANGE</u>
NW¼ NE¼	2.60 ACRES		
SW¼ NE¼	0.35 ACRES		
NE¼ NW¼	7.40 ACRES	31.4 ACRES	
NW¼ NW¼		24.4 ACRES	7.6 ACRES
SE¼ NW¼			1.9 ACRES

SECTION 11

TOWNSHIP 15 SOUTH, RANGE 40 EAST, W.M.

The right to use water for the above purpose is restricted to beneficial use on the lands or place of use described.

The SEVENTH right to be modified, as evidenced by Certificate 80440, was perfected under Permit U-359 with a date of priority of SEPTEMBER 20, 1950. The right allows the use of WELL NO. 5, in the COW CREEK BASIN, for IRRIGATION 194.1 ACRES. The amount of water to which this right is entitled is limited to an amount actually beneficially used and shall not exceed 2.40 cubic feet per second, if available at the original well;

NE¼ SW¼, SECTION 14, T 15 S, R 40 EAST, W.M., or its equivalent in case of rotation, measured at the well.

The amount of water used for irrigation, together with the amount secured under any other right existing on the same lands, is limited to ONE-EIGHTIETH of one cubic foot per second per acre, or its equivalent for each acre irrigated and shall be further limited to a diversion of not to exceed 3.0 acre-feet per acre for each acre irrigated during the irrigation season of each year.

The use shall conform to any reasonable rotation system ordered by the proper state officer.

The authorized place of use is as follows:



	<u>A POA ONLY</u>	<u>A POA and POU</u>
SE¼ NE¼	10.3 ACRES	
NE¼ NW¼	27.6 ACRES	
NW¼ NW¼		37.2 ACRES
SW¼ NW¼		39.1 ACRES
SE¼ NW¼	27.6 ACRES	
NE¼ SW¼		16.7 ACRES

SECTION 14

TOWNSHIP 15 SOUTH, RANGE 40 EAST, W.M.

	<u>A POA ONLY</u>	<u>A POA and POU</u>
NW¼ SW¼		29.9 ACRES
NW¼ SE¼		5.7 ACRES

SECTION 14

TOWNSHIP 15 SOUTH, RANGE 40 EAST, W.M.

The right to use water for the above purpose is restricted to beneficial use on the lands or place of use described.

The EIGHTH right to be modified, as evidenced by Certificate 80441, was perfected under Permit U-392 with a date of priority of MAY 10, 1951. The right allows the use of WELL NO. 5, in the COW CREEK BASIN BASIN, for IRRIGATION OF 130.4 ACRES. The amount of water to which this right is entitled is limited to an amount actually beneficially used and shall not exceed 1.63 cubic feet per second, if available at the original well; NE¼ SW¼, SECTION 14, T 15 SOUTH, RANGE 40 EAST, W.M., or its equivalent in case of rotation, measured at the well.

The amount of water used for irrigation, together with the amount secured under any other right existing on the same lands, is limited to ONE-EIGHTIETH of one cubic foot per second per acre, or its equivalent for each acre irrigated and shall be further limited to a diversion of not to exceed 3.0 acre-feet per acre for each acre irrigated during the irrigation season of each year.



The use shall conform to any reasonable rotation system ordered by the proper state officer.

The authorized place of use is as follows:

POU AND POA CHANGE

NE $\frac{1}{4}$ NE $\frac{1}{4}$	40.0 ACRES
NW $\frac{1}{4}$ NE $\frac{1}{4}$	30.6 ACRES
SW $\frac{1}{4}$ NE $\frac{1}{4}$	30.6 ACRES
SE $\frac{1}{4}$ NE $\frac{1}{4}$	29.2 ACRES

SECTION 14

TOWNSHIP 15 SOUTH, RANGE 40 EAST W.M.

The right to use water for the above purpose is restricted to beneficial use on the lands or place of use described.

The NINTH right to be modified, as evidenced by Certificate 80442, was perfected under Permit U-406 with a date of priority of AUGUST 21, 1951. The right allows the use of WELL NO. 8, in the COW CREEK BASIN, for IRRIGATION OF 40.9 ACRES. The amount of water to which this right is entitled is limited to an amount actually beneficially used and shall not exceed 0.51 cubic foot per second, if available at the original well; SW $\frac{1}{4}$  SE $\frac{1}{4}$ , SECTION 14, T 15 SOUTH, R 40 EAST, W.M., or its equivalent in case of rotation, measured at the well.

The amount of water used for irrigation, together with the amount secured under any other right existing on the same lands, is limited to ONE-EIGHTIETH of one cubic foot per second per acre, or its equivalent for each acre irrigated and shall be further limited to a diversion of not to exceed 3.0 acre-feet per acre for each acre irrigated during the irrigation season of each year.

The use shall conform to any reasonable rotation system ordered



by the proper state officer.

The authorized place of use is as follows:

	<u>ADD POA ONLY</u>	<u>POU AND ADD POA</u>	<u>POU AND POA CHANGE</u>
SW¼ NE¼		3.0 ACRES	
SE¼ NE¼		0.5 ACRES	
SE¼ NW¼		0.8 ACRE	
NE¼ SW¼	15.5 ACRES		
NE¼ SE¼			6.4 ACRES
NW¼ SE¼	6.3 ACRES		8.4 ACRES

SECTION 14  
TOWNSHIP 15 SOUTH, RANGE 40 EAST, W.M.

The right to use water for the above purpose is restricted to beneficial use on the lands or place of use described.

The applicant proposes to make the following changes:

Cert	T	R	S	¼¼	Acres	Proposed POA/ A_POA	POU Change Y/N	Proposed CFS
23628	15S	40E	2	SW SW	12.8		Y	
23628	15S	40E	2	SE SW	4.1		Y	
Cert	T	R	S	¼¼	Acres	Proposed POA/ A_POA	POU Change Y/N	Proposed CFS
23632	15S	41E	7	NE NE	2.9		Y	
23632	15S	41E	7	NW NE	2.6		Y	
23632	15S	41E	7	SW NE	1.0		Y	
23632	15S	41E	7	SE NE	1.0		Y	
23632	15S	41E	7	NW SE	0.4		Y	
23632	15S	41E	8	NE NE	12.1		Y	
23632	15S	41E	8	NW NE	8.7		Y	
23632	15S	41E	8	NE NW	5.6		Y	
23632	15S	41E	8	NW NW	7.8		Y	



Cert	T	R	S	¼¼	Acres	Proposed POA/ A_POA	POU Change Y/N	Proposed CFS
23632	15S	41E	8	SW NW	2.6		Y	
23632	15S	41E	8	SE NW	5.6		Y	
23632	15S	41E	8	NW SW	4.1		Y	
23632	15S	40E	11	SE NE	10.0	#1	Y	0.13
23632	15S	40E	11	NW NW	7.0	#2	Y	0.09
44207	15S	40E	2	SE SW	5.5	#2	Y	0.07
44208	15S	40E	10	NW SE	1.0		Y	
44208	15S	40E	10	SW SE	6.2		Y	
44316	15S	40E	2	SW SE	4.5		Y	
44316	15S	40E	11	SW NE	16.9		Y	
44316	15S	40E	11	SE NE	11.7		Y	
44316	15S	40E	11	NE SE	19.6		Y	
44316	15S	40E	11	NW SE	15.2		Y	
46078	15S	40E	2	SE SW	14.6	#2	Y	0.18
46078	15S	40E	10	NE NE	4.6		Y	
46078	15S	40E	10	NW NE	2.3		Y	
46078	15S	40E	11	NE NW	31.4	#2	N	0.39
46078	15S	40E	11	NW NW	24.4	#2	N	0.31
46078	15S	40E	11	SW NW	4.8		Y	
80440	15S	40E	2	SE SW	2.2	#2	Y	0.01
80440	15S	40E	14	NE NE	36.4	ADD #8	Y	
80440	15S	40E	14	NW NE	30.6	ADD #8	Y	
Cert	T	R	S	¼¼	Acres	Proposed POA/ A_POA	POU Change Y/N	Proposed CFS
80440	15S	40E	14	SW NE	30.6	ADD #8	Y	
80440	15S	40E	14	SE NE	28.8	ADD #8	Y	
80440	15S	40E	14	SE NE	10.3	ADD #8	N	
80440	15S	40E	14	NE NW	27.6	ADD #8	N	
80440	15S	40E	14	SE NW	27.6	ADD #8	N	



80441	15S	40E	14	SW NE	2.9	ADD #8	Y	
80441	15S	40E	14	NW NW	35.9	ADD #8	Y	
80441	15S	40E	14	SW NW	39.1	ADD #8	Y	
80441	15S	40E	14	SE NW	3.1	ADD #8	Y	
80441	15S	40E	14	NE SW	13.0	ADD #8	Y	
80441	15S	40E	14	NW SW	26.4	ADD #8	Y	
80441	15S	40E	14	NW SE	10.0	ADD #8	Y	
80442	15S	40E	10	SW NE	2.4	#9	Y	0.03
80442	15S	40E	10	NW SE	12.4	#9	Y	0.16
80442	15S	40E	14	NE SW	15.5	ADD #5	N	
80442	15S	40E	14	NE SW	4.3	ADD #5	Y	
80442	15S	40E	14	NW SE	6.3	ADD #5	N	

The proposed points of appropriation mentioned in the table above are located as follows:

POA NO. 1: SW $\frac{1}{4}$  SE $\frac{1}{4}$ , T 15 S, R 40 E, W.M.; 225 FEET NORTH AND 1560 FEET WEST FROM THE SE CORNER, SECTION 2.

POA NO. 2: SW $\frac{1}{4}$  SW $\frac{1}{4}$ , SECTION 2, T 15 S, R 40 E, W.M.; 880 FEET NORTH AND 55 FEET EAST FROM THE SW CORNER, SECTION 2.

POA NO. 5: NE $\frac{1}{4}$  SW $\frac{1}{4}$ , SECTION 14, T 15 SOUTH, RANGE 40 EAST, W.M.; 325 FEET SOUTH & 1575 FEET EAST FROM W $\frac{1}{4}$  CORNER, SECTION 14.

POA NO. 8: SW $\frac{1}{4}$  SE $\frac{1}{4}$ , SECTION 14, T 15 SOUTH, R 40 EAST, W.M.; 1420 FEET SOUTH AND 2370 FEET WEST FROM E $\frac{1}{4}$  CORNER SECTION 14.

POD NO. 9: NW $\frac{1}{4}$  SE $\frac{1}{4}$ , SECTION 10, T 15 S, R 40 E, W.M.; 1460 FEET NORTH AND 2600 FEET WEST FROM THE SE CORNER, SECTION 10  
An affidavit was received from Raymond and Jean Belnap owners of certain land and the water right appurtenant to it. A portion of Certificates 80442 have been abandoned and are requested to be



canceled.

The water right is a PORTION of the right described by Certificate 80442, State Record of Water Right Certificates. The abandoned water right is for 1.63 CUBIC FEET PER SECOND from Well No. 8, in the COW CREEK BASIN. The date of priority is AUGUST 21, 1951. The abandoned right is for SUPPLEMENTAL IRRIGATION OF 130.4 ACRES.

The authorized place of use of the abandoned right is as follows:

NE $\frac{1}{4}$ NE $\frac{1}{4}$	40.0 ACRES
NW $\frac{1}{4}$ NE $\frac{1}{4}$	30.6 ACRES
SW $\frac{1}{4}$ NE $\frac{1}{4}$	30.6 ACRES
SE $\frac{1}{4}$ NE $\frac{1}{4}$	29.2 ACRES

SECTION 14

TOWNSHIP 15 SOUTH, RANGE 40 EAST W.M.

ORS 540.621 provides: "Whenever the owner of a perfected and developed water right certifies under oath to the Water Resources Commission that the water right has been abandoned by the owner and that the owner desires cancellation thereof, the Commission shall enter an order canceling the water right."

THESE CHANGES TO EXISTING WATER RIGHTS MAY BE MADE PROVIDED THE FOLLOWING CONDITIONS ARE MET BY THE WATER USER:

1. The proposed change shall be completed on or before October 1, 2006.
2. A claim of Beneficial Use prepared by a Certified Water Rights Examiner shall be submitted by the applicant to the Department by October 1, 2007.
3. The quantity of water diverted at the new points of appropriation (wells), together with the quantity diverted at the old points of appropriation, shall not exceed the



quantity of water lawfully available from the original points of appropriation.

4. When required by the Department the water user shall install an in-line flow meter or other suitable device for measuring and recording the quantity of water used. The type and plans of the measuring device must be approved by the Department prior to beginning construction and shall be installed under the general supervision of the Department.
5. Water shall be acquired from the same aquifer as the original point of appropriation.
6. The former places of use shall no longer be irrigated as part of this water right.

Except as modified herein, all other conditions and restrictions of Certificates 23628, 23632, 44207, 44208, 44316, 46078, 80440, 80441, and 80442 remain in effect.

New certificates will be issued to confirm the portions of the rights NOT involved in this transfer. When satisfactory proof of the completed changes are received, new certificates confirming these water rights will be issued.

WITNESS the signature of the Water Resources

Director, affixed FEBRUARY 17, 2005.

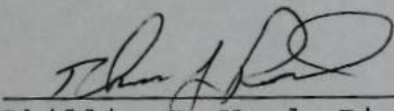
  
\_\_\_\_\_  
For Phillip C. Ward, Director



STATE OF OREGON  
COUNTY OF MALHEUR  
CERTIFICATE OF WATER RIGHT

THIS CERTIFICATE ISSUED TO

BURTON HAVERFIELD  
CULVER OREGON 97734

confirms the right to use the waters of WELL NO. 1 in the COW CREEK BASIN for IRRIGATION OF 121.1 ACRES.

This right was perfected under Permit U-320. The date of priority is FEBRUARY 14, 1950. The amount of water to which this right is entitled is limited to an amount actually beneficially used and shall not exceed 1.51 CUBIC FEET PER SECOND or its equivalent in case of rotation, measured at the well.

The well is located as follows:

SW $\frac{1}{4}$  SE $\frac{1}{4}$ , SECTION 2, T 15 S, R 40 E, W.M..

The amount of water used for irrigation, together with the amount secured under any other right existing for the same lands, is limited to a diversion of ONE-EIGHTIETH of one cubic foot per second, or its equivalent for each acre irrigated and shall be further limited to a diversion of not to exceed 3.0 acre-feet per acre for each acre irrigated during the irrigation season of each year.

The use shall conform to such reasonable rotation system as may be ordered by the proper state officer.

A description of the place of use to which this right is appurtenant is as follows:

SW $\frac{1}{4}$  SE $\frac{1}{4}$  26.9 ACRES  
SE $\frac{1}{4}$  SE $\frac{1}{4}$  31.4 ACRES  
SECTION 2

NE $\frac{1}{4}$  NE $\frac{1}{4}$  31.4 ACRES  
NW $\frac{1}{4}$  NE $\frac{1}{4}$  31.4 ACRES  
SECTION 11

TOWNSHIP 15 SOUTH, RANGE 40 EAST, W.M.



The well shall be maintained in accordance with the General Standards for the Construction and Maintenance of Water Wells in Oregon.

This certificate describes that portion of the water right confirmed by Certificate 44316, State Record of Water Right Certificates, NOT modified by the provisions of an order of the Water Resources Director entered FEB 17 2005, approving Transfer Application 8787 for a change in place of use and point of appropriation.

The issuance of this superseding certificate does not confirm the status of the water right in regard to the provisions of ORS 540.610 pertaining to forfeiture or abandonment.

The right to the use of the water for the above purpose is restricted to beneficial use on the lands or place of use described.

WITNESS the signature of the Water Resources  
Director, affixed FEBRUARY 17, 2005.

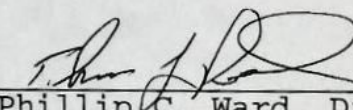
  
for Phillip C. Ward, Director

Recorded in State Record of Water Right Certificates numbered 81208



STATE OF OREGON  
COUNTY OF MALHEUR  
CERTIFICATE OF WATER RIGHT

THIS CERTIFICATE ISSUED TO

RANKIN CROW  
BROGAN, OREGON 97903

confirms the right to use the waters of WELL NO. 2 in the COW CREEK BASIN for IRRIGATION OF 23.6 ACRES.

This right was perfected under Permit U-349. The date of priority is SEPTEMBER 18, 1950. The amount of water to which this right is entitled is limited to an amount actually beneficially used and shall not exceed 0.30 CUBIC FOOT PER SECOND or its equivalent in case of rotation, measured at the well.

The well is located as follows:

SW $\frac{1}{4}$  SW $\frac{1}{4}$ , SECTION 2, T 15 SOUTH, RANGE 40 EAST, W.M..

The amount of water used for irrigation, together with the amount secured under any other right existing for the same lands, is limited to a diversion of ONE-EIGHTIETH of one cubic foot per second, or its equivalent for each acre irrigated and shall be further limited to a diversion of not to exceed 3.0 acre-feet per acre for each acre irrigated during the irrigation season of each year.

The use shall conform to such reasonable rotation system as may be ordered by the proper state officer.

A description of the place of use to which this right is appurtenant is as follows:

SW $\frac{1}{4}$  SW $\frac{1}{4}$  18.6 ACRES  
SE $\frac{1}{4}$  SW $\frac{1}{4}$  5.0 ACRES  
SECTION 2  
TOWNSHIP 15 SOUTH, RANGE 40 EAST, W.M



The well shall be maintained in accordance with the General Standards for the Construction and Maintenance of Water Wells in Oregon.

This certificate describes that portion of the water right confirmed by Certificate 23628, State Record of Water Right Certificates, NOT modified by the provisions of an order of the Water Resources Director entered FEB 17 2005, approving Transfer Application 8787 for a change in place of use and point of appropriation.

The issuance of this superseding certificate does not confirm the status of the water right in regard to the provisions of ORS 540.610 pertaining to forfeiture or abandonment.

The right to the use of the water for the above purpose is restricted to beneficial use on the lands or place of use described.

WITNESS the signature of the Water Resources

Director, affixed FEBRUARY 17, 2005.

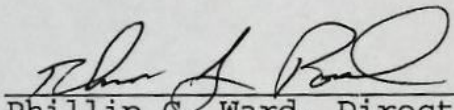
  
\_\_\_\_\_  
For Phillip C. Ward, Director

Recorded in State Record of Water Right Certificates numbered 81209



## STATE OF OREGON

## COUNTY OF MALHEUR

## CERTIFICATE OF WATER RIGHT

THIS CERTIFICATE ISSUED TO

RANKIN CROW  
BROGAN OR 97903

confirms the right to use the waters of two wells in the ANTELOPE SPRS CR, a tributary of the COW CR BASIN for IRRIGATION of 403.20 ACRES.

This right was perfected under Permit U-391. The date of priority is MAY 10, 1951. The amount of water to which this right is entitled is limited to an amount actually used beneficially, and shall not exceed 5.1 CUBIC FEET PER SECOND, being 2.55 cubic feet per second from each well, or its equivalent in case of rotation, measured at the well.

The well is located as follows:

Twp	Rng	Mer	Sec	Q-Q	Survey Coordinates
15 S	41 E	WM	7	NE SE	
15 S	41 E	WM	8	NW SW	

The amount of water used for irrigation, together with the amount secured under any other right existing for the same lands, is limited to a diversion of ONE-EIGHTIETH of one cubic foot per second, or its equivalent for each acre irrigated, and shall be further limited to a diversion of not to exceed 3 acre-feet per acre for each acre irrigated during the irrigation season of each year. The use shall conform to such reasonable rotation system as may be ordered by the proper state officer. The right to the use of the water for the above purpose is restricted to beneficial use on the lands or place of use described.

A description of the place of use to which this right is appurtenant is as follows:

Twp	Rng	Mer	Sec	Q-Q	Acres
15 S	41 E	WM	7	NE NE	25.0
15 S	41 E	WM	7	NW NE	0.2
15 S	41 E	WM	7	SW NE	2.9
15 S	41 E	WM	7	SE NE	39.0
15 S	41 E	WM	7	NE SE	31.4
15 S	41 E	WM	7	NW SE	2.7
15 S	41 E	WM	8	NW NE	13.5
15 S	41 E	WM	8	SW NE	40.0
15 S	41 E	WM	8	SE NE	39.7
15 S	41 E	WM	8	NE NW	32.0
15 S	41 E	WM	8	NW NW	15.0
15 S	41 E	WM	8	SW NW	35.2
15 S	41 E	WM	8	SE NW	34.4
15 S	41 E	WM	8	NE SW	28.8
15 S	41 E	WM	8	NW SW	11.0
15 S	41 E	WM	8	NE SE	23.4
15 S	41 E	WM	8	NW SE	26.6



Twp	Rng	Mer	Sec	Q-Q	Acres
15 S	41 E	WM	9	SW NW	2.3
15 S	41 E	WM	9	NW SW	0.1

This certificate describes that portion of the water right confirmed by Certificate 23632, State Record of Water Right Certificates, NOT modified by the provisions of an order of the Water Resources Director entered FEB 17 2005, approving Transfer Application 8787.

The issuance of this superseding certificate does not confirm the status of the water right in regard to the provisions of ORS 540.610 pertaining to forfeiture or abandonment.

WITNESS the signature of the Water Resources Director, affixed FEBRUARY 17, 2005.

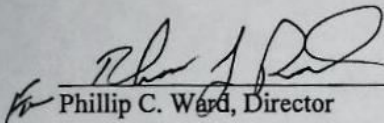
  
 Phillip C. Ward, Director

Recorded in State Record of Water Right Certificates numbered 81210.



STATE OF OREGON  
COUNTY OF MALHEUR  
CERTIFICATE OF WATER RIGHT

THIS CERTIFICATE ISSUED TO

COW VALLEY RANCHES  
BOX 251  
MILTON FREEWATER OR 97862

confirms the right to use the waters of WELL #4 in the LYMAN CR, a tributary of the COW CR BASIN for IRRIGATION of 126.50 ACRES.

This right was perfected under Permit U-369. The date of priority is FEBRUARY 5, 1951. The amount of water to which this right is entitled is limited to an amount actually used beneficially, and shall not exceed 1.63 CUBIC FEET PER SECOND or its equivalent in case of rotation, measured at the well.

The well is located as follows:

Twp	Rng	Mer	Sec	Q-Q	Survey Coordinates
15 S	40 E	WM	11	SE SW	730 FT N & 1400 FT E FM SW COR, S11

The amount of water used for irrigation, together with the amount secured under any other right existing for the same lands, is limited to a diversion of ONE-EIGHTIETH of one cubic foot per second, or its equivalent for each acre irrigated, and shall be further limited to a diversion of not to exceed 3 acre-feet per acre for each acre irrigated during the irrigation season of each year. The use shall conform to such reasonable rotation system as may be ordered by the proper state officer. The right to the use of the water for the above purpose is restricted to beneficial use on the lands or place of use described.

A description of the place of use to which this right is appurtenant is as follows:

Twp	Rng	Mer	Sec	Q-Q	Acres
15 S	40 E	WM	11	NE SW	4.3
15 S	40 E	WM	11	SE SW	35.2
15 S	40 E	WM	11	NE SE	4.7
15 S	40 E	WM	11	NW SE	4.8
15 S	40 E	WM	11	SW SE	39.2
15 S	40 E	WM	11	SE SE	38.3



This certificate describes that portion of the water right confirmed by Certificate 44207, State Record of Water Right Certificates, NOT modified by the provisions of an order of the Water Resources Director entered FEB 17 2005, approving Transfer Application 8787.

The issuance of this superseding certificate does not confirm the status of the water right in regard to the provisions of ORS 540.610 pertaining to forfeiture or abandonment.

WITNESS the signature of the Water Resources Director, affixed FEBRUARY 17, 2005.

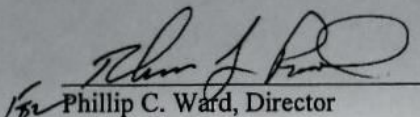
  
For Phillip C. Ward, Director

Recorded in State Record of Water Right Certificates numbered 81211.

STATE OF OREGON  
COUNTY OF MALHEUR  
CERTIFICATE OF WATER RIGHT

THIS CERTIFICATE ISSUED TO

RAYMOND & JEAN BELNAP  
4137 KOCHEMEIER ROAD  
VALE OR 97918

confirms the right to use the waters of WELL#4 in the LYMAN CR, a tributary of the COW CR BASIN for IRRIGATION of 40.80 ACRES.

This right was perfected under Permit U-490. The date of priority is FEBRUARY 2, 1953. The amount of water to which this right is entitled is limited to an amount actually used beneficially, and shall not exceed 0.51 CUBIC FOOT PER SECOND or its equivalent in case of rotation, measured at the well.

The well is located as follows:

Twp	Rng	Mer	Sec	Q-Q	Survey Coordinates
15 S	40 E	WM	10	NW SE	1460 feet North & 2600 Feet West from SE cor, S10

The amount of water used for irrigation, together with the amount secured under any other right existing for the same lands, is limited to a diversion of ONE-EIGHTIETH of one cubic foot per second, or its equivalent for each acre irrigated, and shall be further limited to a diversion of not to exceed 3 acre-feet per acre for each acre irrigated during the irrigation season of each year. The use shall conform to such reasonable rotation system as may be ordered by the proper state officer. The right to the use of the water for the above purpose is restricted to beneficial use on the lands or place of use described.

A description of the place of use to which this right is appurtenant is as follows:

Township	Range	Mer	Sec	Q-Q	Acres
15 S	40 E	WM	10	NW SE	22.3
15 S	40 E	WM	10	SW SE	18.5

This certificate describes that portion of the water right confirmed by Certificate 44208, State Record of Water Right Certificates, NOT modified by the provisions of an order of the Water Resources Director entered FEB 17 2005, approving Transfer Application 8787.

The issuance of this superseding certificate does not confirm the status of the water right in regard to the provisions of ORS 540.610 pertaining to forfeiture or abandonment.

WITNESS the signature of the Water Resources Director, affixed FEBRUARY 17, 2005

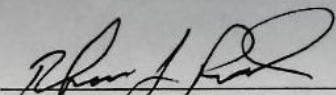
  
For Phillip C. Ward, Director

Recorded in State Record of Water Right Certificates numbered 81212



STATE OF OREGON  
COUNTY OF MALHEUR  
CERTIFICATE OF WATER RIGHT

THIS CERTIFICATE ISSUED TO

BURTON HAVERFIELD  
CULVER, OREGON 97734

confirms the right to use the waters of WELL NO. 3 in the COW CREEK BASIN for IRRIGATION OF 81.6 ACRES.

This right was perfected under Permit U-350. The date of priority is SEPTEMBER 18, 1950. The amount of water to which this right is entitled is limited to an amount actually beneficially used and shall not exceed 1.02 CUBIC FEET PER SECOND or its equivalent in case of rotation, measured at the well.

The well is located as follows:

NW $\frac{1}{4}$  NE $\frac{1}{4}$ , SECTION 10, T 15 S, R 40 E, W.M.; 1250 FEET SOUTH AND 1980 FEET WEST FROM THE NE CORNER, SECTION 10.

The amount of water used for irrigation, together with the amount secured under any other right existing for the same lands, is limited to a diversion of ONE-EIGHTIETH of one cubic foot per second, or its equivalent for each acre irrigated and shall be further limited to a diversion of not to exceed 3.0 acre-feet per acre for each acre irrigated during the irrigation season of each year.

The use shall conform to such reasonable rotation system as may be ordered by the proper state officer.

A description of the place of use to which this right is appurtenant is as follows:

NE $\frac{1}{4}$  NE $\frac{1}{4}$  30.6 ACRES  
NW $\frac{1}{4}$  NE $\frac{1}{4}$  36.8 ACRES  
SW $\frac{1}{4}$  NE $\frac{1}{4}$  1.5 ACRES  
SE $\frac{1}{4}$  NE $\frac{1}{4}$  3.8 ACRES  
SECTION 10

NW $\frac{1}{4}$  NW $\frac{1}{4}$  7.0 ACRES  
SW $\frac{1}{4}$  NW $\frac{1}{4}$  1.9 ACRES  
SECTION 11

TOWNSHIP 15 SOUTH, RANGE 40 EAST, W.M.

This certificate describes that portion of the water right confirmed by Certificate 46078, State Record of Water Right Certificates, NOT modified by the provisions of an order of the Water Resources Director entered FEB 17 2005, approving Transfer Application 8787 for a change in place of use and point of appropriation.

The issuance of this superseding certificate does not confirm the status of the water right in regard to the provisions of ORS 540.610 pertaining to forfeiture or abandonment.

The right to the use of the water for the above purpose is restricted to beneficial use on the lands or place of use described.

WITNESS the signature of the Water Resources

Director, affixed FEBRUARY 17, 2005.

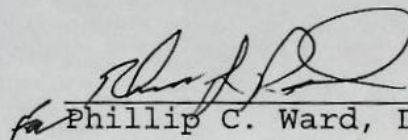
  
Phillip C. Ward, Director

Recorded in State Record of Water Right Certificates numbered 81213



BEFORE THE STATE ENGINEER OF OREGON

Malheur County

IN THE MATTER OF THE APPLICATION )  
OF COW VALLEY RANCHES, INC. )  
(GARY HEISEY) FOR THE APPROVAL )  
OF A CHANGE IN PLACE OF USE OF )  
WATER FROM RANKIN CROW WELL NO. 4 )  
-----

ORDER APPROVING  
TRANSFER NO. 2671

On July 3, 1972, Cow Valley Ranches, Inc., filed an application in the office of the State Engineer for the approval of a change in place of use of water from Rankin Crow Well No. 4, pursuant to the provisions of ORS 540.510 to 540.530.

Certificate of water right issued to Rankin Crow and recorded at page 23630, Volume 17, State Record of Water Right Certificates, confirms a right to the use of not to exceed 1.7 cubic feet per second of water from Well No. 4, for the irrigation of, among other lands, 0.1 acres in SW $\frac{1}{4}$  NW $\frac{1}{4}$ , 10.0 acres in SE $\frac{1}{4}$  NW $\frac{1}{4}$ , 24.8 acres in NE $\frac{1}{4}$  SW $\frac{1}{4}$ , 8.0 acres in NW $\frac{1}{4}$  SW $\frac{1}{4}$ , and 1.8 acres in SW $\frac{1}{4}$  SW $\frac{1}{4}$ , Section 11, Township 15 South, Range 40 East, W.M., with a date of priority of February 5, 1951.

The applicant herein, owner of the lands above described, proposes to transfer the water right therefrom, without loss of priority, to 2.2 acres in NE $\frac{1}{4}$  SW $\frac{1}{4}$ , 24.9 acres in SE $\frac{1}{4}$  SW $\frac{1}{4}$ , 2.6 acres in NE $\frac{1}{4}$  SE $\frac{1}{4}$ , 4.4 acres in NW $\frac{1}{4}$  SE $\frac{1}{4}$ , 3.6 acres in SW $\frac{1}{4}$  SE $\frac{1}{4}$ , and 7.0 acres in SE $\frac{1}{4}$  SE $\frac{1}{4}$ , Section 11, Township 15 South, Range 40 East, W.M.

Notice by publication as provided by ORS 540.520 was not given in connection with this application for the reason that said section provides notice is not required on an application for a change in place of use of water.

Mr. Frank Elfering, Watermaster of District No. 9, has filed a statement to the effect that the proposed change in place of use of



water may be made without injury to existing rights.

No objections having been filed and it appearing that the proposed change in place of use of water may be made without injury to existing rights, the application should be approved.

NOW, THEREFORE, it hereby is ORDERED that the proposed change in place of use of water is approved and the water right hereinbefore described as appurtenant to 0.1 acres in SW $\frac{1}{4}$  NW $\frac{1}{4}$ , 10.0 acres in SE $\frac{1}{4}$  NW $\frac{1}{4}$ , 24.8 acres in NE $\frac{1}{4}$  SW $\frac{1}{4}$ , 8.0 acres in NW $\frac{1}{4}$  SW $\frac{1}{4}$ , and 1.8 acres in SW $\frac{1}{4}$  SW $\frac{1}{4}$ , Section 11, Township 15 South, Range 40 East, W.M., with a date of priority of February 5, 1951, be severed therefrom and simultaneously and without loss of priority, transferred to 2.2 acres in NE $\frac{1}{4}$  SW $\frac{1}{4}$ , 24.9 acres in SE $\frac{1}{4}$  SW $\frac{1}{4}$ , 2.6 acres in NE $\frac{1}{4}$  SE $\frac{1}{4}$ , 4.4 acres in NW $\frac{1}{4}$  SE $\frac{1}{4}$ , 3.6 acres in SW $\frac{1}{4}$  SE $\frac{1}{4}$ , and 7.0 acres in SE $\frac{1}{4}$  SE $\frac{1}{4}$ , Section 11, Township 15 South, Range 40 East, W.M.

It is FURTHER ORDERED that said water so transferred shall be applied to beneficial use on or before October 1, 1973.

It is FURTHER ORDERED that certificate of water right heretofore issued to Rankin Crow and recorded at page 23630, Volume 17, State Record of Water Right Certificates, is canceled and upon receipt of proof satisfactory to the State Engineer of application of water to beneficial use, a certificate of water right shall be issued to Cow Valley Ranches, Inc., confirming the extent to which the water has been applied beneficially, and covering the balance of the right not involved in this proceeding.

Dated at Salem, Oregon, this 3rd day of August, 1972.

/s/ CHRIS L. WHEELER  
State Engineer



## STATE OF OREGON

COUNTY OF MALHEUR

## CERTIFICATE OF WATER RIGHT

This Is to Certify, That RANKIN CROW

of Brogan, State of Oregon, has made proof to the satisfaction of the STATE ENGINEER of Oregon, of a right to the use of the waters of Well #4 a tributary of Cow Creek for the purpose of irrigation under Permit No. U-369 of the State Engineer, and that said right to the use of said waters has been perfected in accordance with the laws of Oregon; that the priority of the right hereby confirmed dates from February 5, 1951

that the amount of water to which such right is entitled and hereby confirmed, for the purposes aforesaid, is limited to an amount actually beneficially used for said purposes, and shall not exceed 1.7 cubic foot per second

or its equivalent in case of rotation, measured at the point of diversion from the stream. The point of diversion is located in the SE $\frac{1}{4}$ SW $\frac{1}{4}$ , Section 11, Township 15 South, Range 40 East, W.M.

The amount of water used for irrigation, together with the amount secured under any other right existing for the same lands, shall be limited to one-eightieth of one cubic foot per second per acre, or its equivalent for each acre irrigated and shall be further limited to a diversion of not to exceed 3.0 acre feet per acre for each acre irrigated during the irrigation season of each year,

and shall conform to such reasonable rotation system as may be ordered by the proper state officer.

A description of the place of use under the right hereby confirmed, and to which such right is appurtenant, is as follows:

6.1 acres in the SW $\frac{1}{4}$ NW $\frac{1}{4}$   
 10.0 acres in the SE $\frac{1}{4}$ NW $\frac{1}{4}$   
 2.6 acres in the NE $\frac{1}{4}$ SW $\frac{1}{4}$  +  
 8.0 acres in the NW $\frac{1}{4}$ SW $\frac{1}{4}$   
 1.8 acres in the SW $\frac{1}{4}$ SW $\frac{1}{4}$   
 14.3 acres in the SE $\frac{1}{4}$ SW $\frac{1}{4}$  +  
 2.2 acres in the NE $\frac{1}{4}$ SE $\frac{1}{4}$  +  
 0.4 acres in the NW $\frac{1}{4}$ SE $\frac{1}{4}$  +  
 35.6 acres in the SW $\frac{1}{4}$ SE $\frac{1}{4}$  +  
 32.2 acres in the SE $\frac{1}{4}$ SE $\frac{1}{4}$  +

Section 11  
 Township 15 South, Range 40 East, W.M.

132.0

The right to the use of the water for the purposes aforesaid is restricted to the lands or place of use herein described.

WITNESS the signature of the State Engineer, affixed

this 3rd day of February, 1958

LEWIS A. STANLEY State Engineer