

Groundwater Transfer Review Summary Form

Transfer/PA # T- 14588

GW Reviewer James Hootsmans Date Review Completed: 3/26/2025

Summary of Same Source Review:

☐ The proposed change in point of appropriation is not within the same aquifer as per OAR 690-380-2110(2).

Summary of Water Level Decline Condition Review:

☐ Water levels at the original point(s) of appropriation have exceeded the allowed decline threshold defined by conditions in the originating water right.

Summary of Injury Review:

☐ The proposed transfer will result in another, existing water right not receiving previously available water to which it is legally entitled or result in significant interference with a surface water source as per 690-380-0100(3).

Summary of GW-SW Transfer Similarity Review:

☐ The proposed SW-GW transfer doesn't meet the definition of "similarly" as per OAR 690-380-2130.

This is only a summary. Documentation is attached and should be read thoroughly to understand the basis for determinations.



Oregon Water Resources Department
725 Summer Street NE, Suite A
Salem, Oregon 97301-1271
(503) 986-0900
www.wrd.state.or.us

Ground Water Review Form:

- ☐ Water Right Transfer
☐ Permit Amendment
☐ GR Modification
☐ Other

Application: T-14588

Applicant Name: Leighty LT

Proposed Changes: ☐ POA ☒ APOA ☐ SW→GW ☐ RA
☐ USE ☐ POU ☐ OTHER

Reviewer(s): James Hootsmans

Date of Review: 3/26/2025

Date Reviewed by GW Mgr. and Returned to WRSD: JTI 6/4/25

The information provided in the application is insufficient to evaluate whether the proposed transfer may be approved because:

- ☐ The water well reports provided with the application do not correspond to the water rights affected by the transfer.
- ☐ The application does not include water well reports or a description of the well construction details sufficient to establish the ground water body developed or proposed to be developed.
- ☐ Other _____

1. Basic description of the changes proposed in this transfer: This proposed transfer pertains to one certificate, 76296. Certificate 76296 is for primary irrigation of 75.1 acres from one POA (MARI 4764, JANZ Well) with a maximum rate of 0.65 cfs. The proposed changes on **Certificate 76296** are the addition of one new groundwater Point of Appropriation (POA) as indicated below:

- Authorized POA: MARI 4764 (JANZ Well)
- Proposed Additional POAs (APOA): MARI 4765 (Proposed Well 1)

2. Will the proposed POA develop the same aquifer (source) as the existing authorized POA?
☒ Yes ☐ No Comments: The authorized POA (MARI 4764) is cased to 386 feet below ground surface (bgs) into decomposed basalt. However, the well is only sealed to 18 feet bgs and the casing is perforated from 75 to 170. Therefore, the authorized POA is completed in the sand and gravel layers of the alluvial aquifer.

The proposed APOA (MARI 4765) is sealed to 35 bgs and cased to 212 feet bgs. There are two sets of perforations from 105 to 135 and 145 to 199 feet bgs. Therefore the APOA is also completed in the alluvial aquifer.

3. a) Is the existing authorized POA subject to a water level decline condition?
☐ Yes ☒ No Comments: Certificate 76296 does not have any water level decline conditions.

- b) If yes, for each POA identify the reference level, most recent spring-high water level, and whether an applicable permit decline condition has been exceeded: _____
4. a) Is there more than one source developed under the right (e.g., basalt and alluvium)?
☐ Yes ☒ No Comments: Both the authorized and proposed POA develop the quaternary alluvial aquifer.
- b) If yes, estimate the portion of the right supplied by each of the sources and describe any limitations that will need to be placed on the proposed change (rate, duty, etc.): _____
5. a) Will this proposed change, at its maximum allowed rate of use, likely result in an increase in interference with **another ground water right**?
☐ Yes ☒ No Comments: All POAs indicated on this application are similar distances to other groundwater POAs. The additional POA is already authorized POAs on Certificate 56264. Any slight increase of impact on wells closer to the APOA will be negated by the loss of impact from the existing POA, since the authorized POA is relatively closer to nearby groundwater rights than the APOA is.
- On Certificate 56264, the maximum rate that MARI 4765 can pump is 0.94 cfs. There is no decline conditions on Certificate 56264. To protect the resource, water level measurements should be included on the new certificate for all POAs to help eliminate the potential of stacked use in the given wells.
- b) If yes, would this proposed change, at its maximum allowed rate of use, likely result in another groundwater right not receiving the water to which it is legally entitled?
☐ Yes ☐ No If yes, explain: N/A
6. a) Will this proposed change, at its maximum allowed rate of use, likely result in an increase in interference with **another surface water source**?
☐ Yes ☒ No Comments: All POAs indicated on this application are similar distances to nearby surface water bodies. All the nearby surface water bodies are part of the Pudding R > Molalla R – AB Mill CR Water Availability Basin, therefore any acute changes in depletion of specific surface water bodies will not affect the overall water availability.
- b) If yes, at its maximum allowed rate of use, what is the expected change in degree of interference with any **surface water sources** resulting from the proposed change?
Stream: _____ ☐ Minimal ☐ Significant
Stream: _____ ☐ Minimal ☐ Significant
Provide context for minimal/significant impact: _____
7. For SW-GW transfers, will the proposed change in point of diversion affect the surface water source similarly (as per OAR 690-380-2130) to the authorized point of diversion specified in the water use subject to transfer?
☐ Yes ☐ No Comments: N/A
8. What conditions or other changes in the application are necessary to address any potential issues identified above: The additional POAs are authorized wells on other Certificates. To protect the resource, the new certificate should include water level measurement requirements as part of approving this transfer.
9. Any additional comments: N/A

T14588 Leighty LT

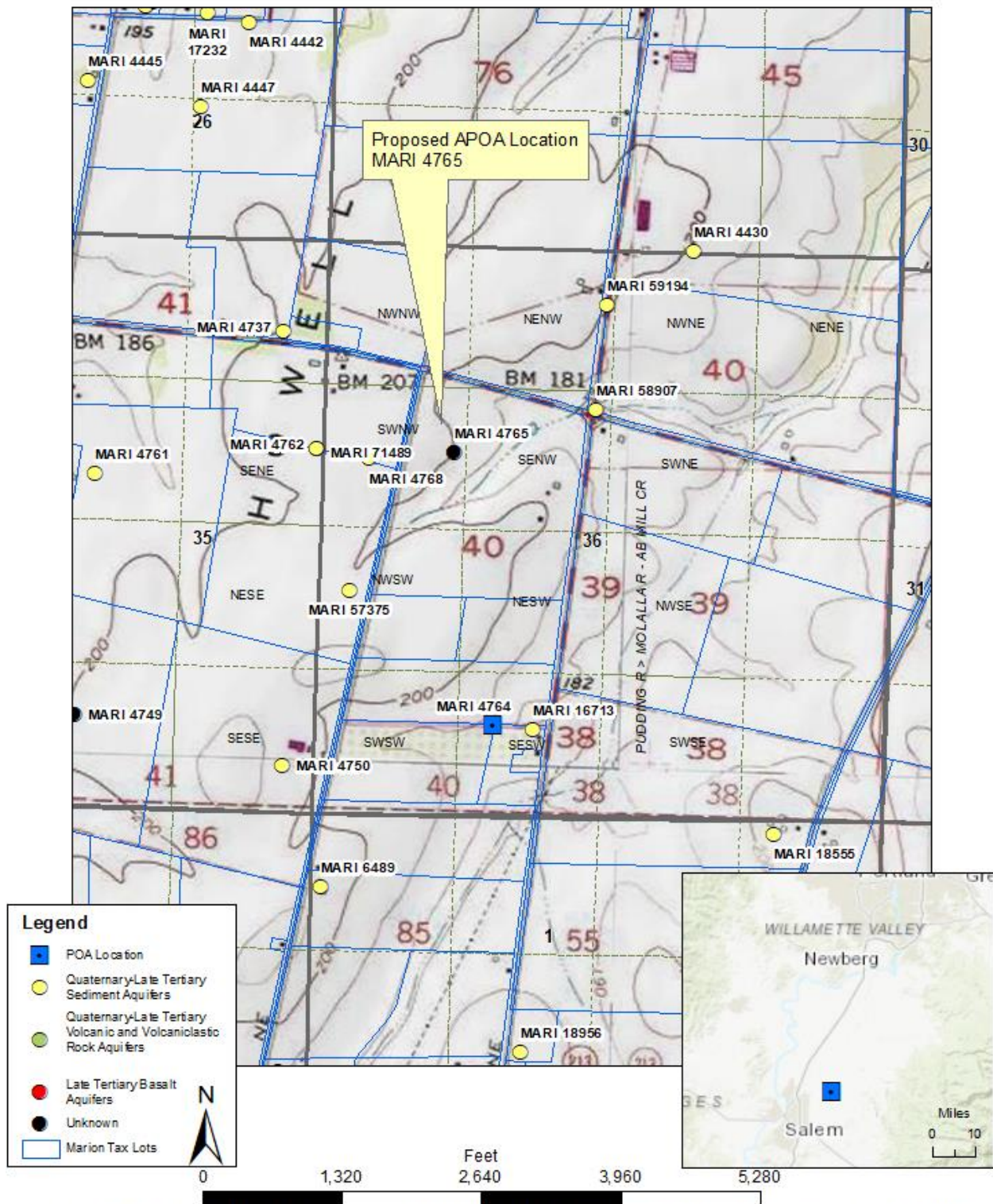

Service Layer Credits: Sources: Esri, HERE, Garmin, Intermap, increment P Corp., GEBCO, USGS, FAO, NPS, NRCAN, GeoBase, IGN, Kadaster NL, Ordnance Survey, Esri Japan, METI, Esri China (Hong Kong), (c) OpenStreetMap contributors, and the GIS User Community
 Copyright© 2013 National Geographic Society, i-cubed