

3414 Clarence E. Quirk
2116 Wash. Ninth St
The Dalles, Or

3414

STATUS OF APPLICATION

Change in place of use
Date filed 5-19-76
Date of hearing _____
Place of hearing _____
Date of order 6-4-76 Vol. 27, page 231
Date for application of water 10-1-77
Proof mailed _____
Proof received _____
Certificate issued OCT 26 1979 Vol. 42, page 48692
Survey 8/76

DESCRIPTION OF WATER RIGHT

Name of stream Fifteenmile Creek
Trib. of _____ County of Wasco
Use irrigation
Quantity of water _____ No. of acres 40
Name of ditch _____
Date of priority April 14, 1960
In name of Clarence E. Quirk
_____ Adjudication, Vol. _____, page _____
App. No. 33876 Per. No. 26700 Cert. No. 32363 Transfer Q-4
Certificate cancelled _____
Notation made on record by _____

FEEES PAID

Date	Amount	Receipt No.
<u>5-19-76</u>	<u>30.00</u>	<u>52636</u>
TOTAL . . .		
	Cert. Fee	

FEEES REFUNDED

Date	Amount	Check No.

REMARKS

See transfer Q4
See 54347 for F.P. maps

TO BE ENTERED WHERE CHECKED	INDEX CARDS:		
		Entered	Checked
	<input checked="" type="checkbox"/> Name	<u>WH</u>	___
	<input checked="" type="checkbox"/> Stream	<u>WH</u>	___
	<input checked="" type="checkbox"/> Pt. of Div.	___	___
	<input checked="" type="checkbox"/> Calendar	<u>WH</u>	___
	CHECKED TO RECORDS:		
	<input checked="" type="checkbox"/> Twp. & Rge.	<u>WH</u>	___
	<input type="checkbox"/> Decree-vault	___	___
	<input type="checkbox"/> Decree-safe	___	___
	<input checked="" type="checkbox"/> Cert. of W/R	<u>CC</u>	___
	<input checked="" type="checkbox"/> Per. Folder	<u>CC</u>	___
	<input type="checkbox"/> Chainindex	___	___
	<input type="checkbox"/> Cross Ref.	___	___
	<input type="checkbox"/> Power Claim	___	___
	<input type="checkbox"/> Abstracts	___	___

TRANSFERRED TO
TRANSFERRED FROM

Scale 1" = 1320'

RECEIVED

MAY 19 1976

WATER RESOURCES DEPT
SALEM, OREGON

Application Map Prepared By
Watermaster District No. 3
Thomas J. Paul

572-59

BEFORE THE WATER RESOURCES DIRECTOR OF OREGON

Wasco County

IN THE MATTER OF THE APPLICATION }
OF CLARENCE E. QUIRK FOR THE }
APPROVAL OF A CHANGE IN PLACE OF }
USE OF WATER FROM FIFTEENMILE }
CREEK }

ORDER APPROVING
TRANSFER NO. 3414

On May 19, 1976, Clarence E. Quirk filed an application in the office of the Water Resources Director for the approval of a change in place of use of water from Fifteenmile Creek, pursuant to the provisions of ORS 540.510 to 540.530.

Certificate of water right issued to Clarence E. Quirk and recorded at Page 32363, Volume 24, State Record of Water Right Certificates, confirmed a right to the use of not to exceed 0.54 cubic foot per second of water from Fifteenmile Creek for the irrigation of, among other lands, 3.9 acres in SE $\frac{1}{4}$ SW $\frac{1}{4}$ and 0.1 acre in SW $\frac{1}{4}$ SE $\frac{1}{4}$, Section 30, Township 2 North, Range 15 East, W.M., with a date of priority of April 14, 1960. These lands are irrigated from a point of diversion located 40 feet South and 2300 feet East from the Northwest corner of Section 31, being within the NE $\frac{1}{4}$ NW $\frac{1}{4}$, Section 31, Township 2 North, Range 15 East, W.M.

The applicant herein, owner of the lands above described, proposes to transfer the water right therefrom, without loss of priority, to 4.0 acres in NW $\frac{1}{4}$ SW $\frac{1}{4}$, Section 30, Township 2 North, Range 15 East, W.M.

Notice by publication as provided by ORS 540.520 was not given in connection with this application for the reason that said section provides notice is not required on an application for a change in place of use of water.

ALL COTTON

Mr. Thomas J. Paul, Watermaster of District No. 3, has filed a statement to the effect that the proposed change in place of use of water may be made without injury to existing rights.

No objection having been filed and it appearing that the proposed change in place of use may be made without injury to existing rights, the application should be approved.

NOW, THEREFORE, it hereby is ORDERED that the change in place of use of water is approved and the water right hereinbefore described as appurtenant to 3.9 acres in SE $\frac{1}{4}$ SW $\frac{1}{4}$ and 0.1 acre in SW $\frac{1}{4}$ SE $\frac{1}{4}$, Section 30, Township 2 North, Range 15 East, W.M., with a date of priority of April 14, 1960, be severed therefrom and simultaneously and without loss of priority transferred to 4.0 acres in NW $\frac{1}{4}$ SW $\frac{1}{4}$, Section 30, Township 2 North, Range 15 East, W.M.

It is FURTHER ORDERED that said water so transferred shall be applied to beneficial use on or before October 1, 1977.

On November 5, 1969, an order was entered by the State Engineer approving an application designated as Transfer Q-4 for a change in point of diversion for part of the right confirmed by the certificate recorded at Page 32363. Said order canceled the certificate recorded at Page 32363 and provided for a certificate to be issued upon completion of the change in point of diversion confirming that portion of the right involved in the change and the balance of the right. Satisfactory proof of completion of the change in point of diversion has been received.

It is FURTHER ORDERED that no certificate be issued as provided by the order entered November 5, 1969, and upon receipt of proof satisfactory to the Water Resources Director of completion of the change in place of use

ALL COTTON

authorized herein, a certificate of water right shall be issued to Clarence E. Quirk confirming that part of the right involved in the change in point of diversion, the extent to which the water has been applied beneficially as authorized herein, and the balance of the right not involved in the changes.

Dated at Salem, Oregon, this 4th day of June, 1976.

/s/ JAMES E. SEXSON
Director

Siberian Onion Skin

MILLERS FALLS

ALL COTTON

T.2N.R.14&15E.W.M.

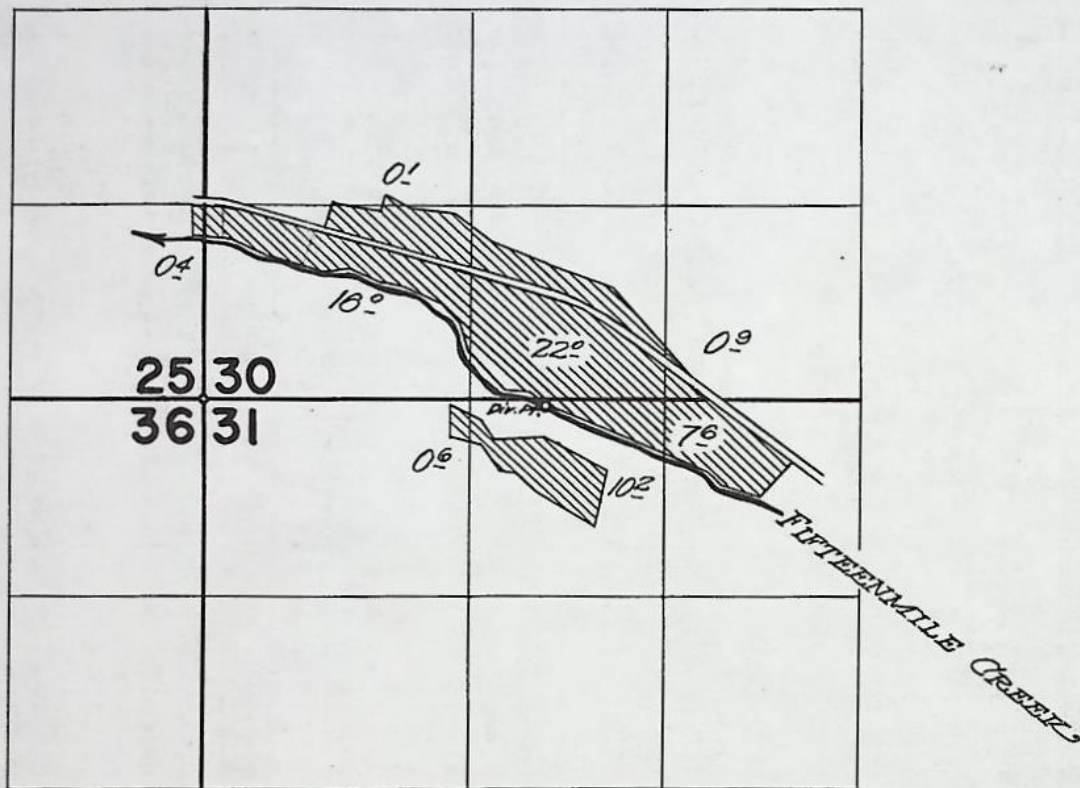

FINAL PROOF SURVEY
UNDER

Application No. 33876... Permit No. 26700...
IN NAME OF



CLARENCE E. QUIRK

Surveyed Oct. 30 1963, by C. Baker

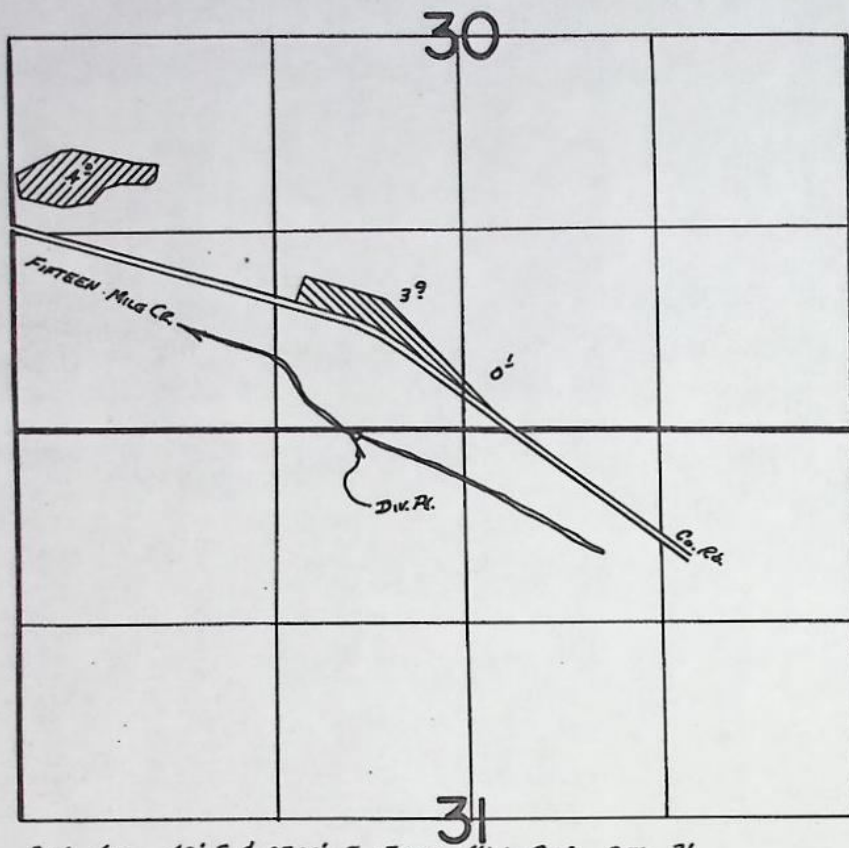
T.2N. R.15E. W.M.



DIV. LOC. 40' S & 1300' E FROM NW COR. SEC. 31

 TRANSFERRED TO
 TRANSFERRED FROM

Application Map For
CLARENCE E. QUIRK

Scale 1" = 1320'

RECEIVED

MAY 19 1976

WATER RESOURCES DEPT
SALEM, OREGON

Application Map Prepared By
Watermaster District No. 3
Thomas J. Paul

7-3414

T.2N. R.15E. W.M.

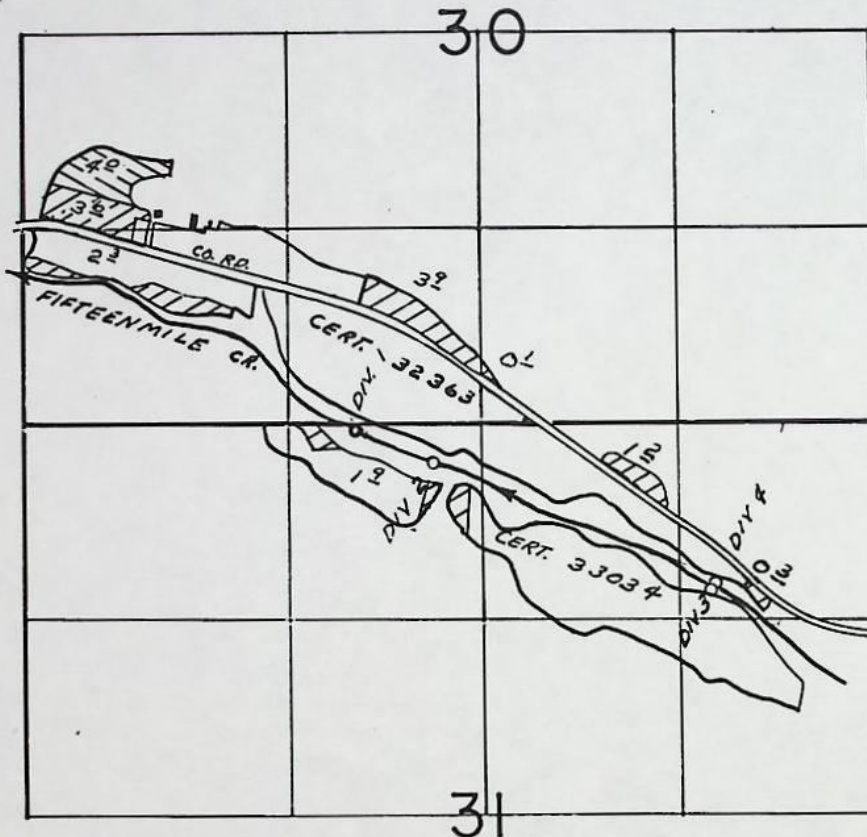

DIV. 1 - 2300'E & 40'S; DIV. 2 - 270'S & 2800'E; DIV. 3 - 1120'S & 4670'E; DIV. 4 - 1080'S & 4710'E, ALL FROM THE NW CORNER SECTION 31

FINAL PROOF SURVEY UNDER

TRANSFER NO. 3414 ☒
Application No. 54347..... Permit No. 40741..... ☒
IN NAME OF

.....CLARENCE E. QUICK.....

Surveyed SEP. 16... 1977, by L.H. NUNN.....

RECEIVED

MAY 19 1976

WATER RESOURCES DEPT
SALEM, OREGON

Application for Transfer of Water Right

To the STATE ENGINEER OF OREGON:

I, Clarence E. Quirk
(Name of applicant)

of 716 West Ninth Street, County of Wasco
(Postoffice) The Dalles

State of Oregon, do hereby make application for change in place of use

(In point of diversion; place of use; use heretofore made of the water)

1. The source of present water right is Fifteenmile Creek
(Name of stream)

2. The use to which the water is applied is irrigation
(Irrigation; Mining; Power; Manufacturing; etc.)

3. The name of the ditch, canal or pipe line is _____

4. The point of diversion is located 40 ft. S and 2300 ft. E from the NW
(N. or S.) (E. or W.)

corner of Section 31 being within the NE $\frac{1}{4}$ NW $\frac{1}{4}$
(Section or subdivision)

of Section 31 Tp. 2N R. 15E W. M., in the County of Wasco
(No. N. or S.) (No. E. or W.)

5. List the number of acres irrigated in each smallest legal subdivision (40-acre tract) involved in this transfer. If for any other use, indicate place of use.

Twp.	Range	Sec.	NE 1-4				NW 1-4				SW 1-4				SE 1-4			
			NE $\frac{1}{4}$	NW $\frac{1}{4}$	SW $\frac{1}{4}$	SE $\frac{1}{4}$	NE $\frac{1}{4}$	NW $\frac{1}{4}$	SW $\frac{1}{4}$	SE $\frac{1}{4}$	NE $\frac{1}{4}$	NW $\frac{1}{4}$	SW $\frac{1}{4}$	SE $\frac{1}{4}$	NE $\frac{1}{4}$	NW $\frac{1}{4}$	SW $\frac{1}{4}$	SE $\frac{1}{4}$
2N	15E	30												3.9			0.1	

NOTE: If you own less than 40-acre tracts, attach a description of your land as it appears in your deed.

(Attach separate sheet if necessary)

6. Are you the legal owner of the above described lands? yes
(If not owner, explain your interest)

7. Has water been used beneficially for the purposes indicated herein during the past 5 years? yes

8. What is the date of priority of your water right? April 14, 1960

9. Was your water right acquired by State Engineer's Permit? yes If so, give number
(Yes or No)
of permit 26700

10. Do you hold a water right certificate? yes If so, give number of certificate 32363
(Yes or No)

11. Was your water right determined by State Engineer's order of Determination or Decree of Court?

no If so, give title of proceedings
(Yes or No)

12. Is the water right recorded in your name? yes
(If not, give name)

13. I propose to transfer the water right to the following described lands: (Do not answer if your application is for change in point of diversion only.)

Twp.	Range	Sec.	NE 1-4				NW 1-4				SW 1-4				SE 1-4			
			NE $\frac{1}{4}$	NW $\frac{1}{4}$	SW $\frac{1}{4}$	SE $\frac{1}{4}$	NE $\frac{1}{4}$	NW $\frac{1}{4}$	SW $\frac{1}{4}$	SE $\frac{1}{4}$	NE $\frac{1}{4}$	NW $\frac{1}{4}$	SW $\frac{1}{4}$	SE $\frac{1}{4}$	NE $\frac{1}{4}$	NW $\frac{1}{4}$	SW $\frac{1}{4}$	SE $\frac{1}{4}$
2N	15E	30										4.0						

(Attach separate sheet if necessary)

NOTE: Answer questions 14, 15, 16 and 17, if the application is for change in point of diversion.

14. The proposed point of diversion is located ft. and ft. from the
(N. or S.) (E. or W.)
corner of being within the of Section Tp. R. W. M.,
(Smallest legal subdivision) (No. N. or S.) (No. E. or W.)
in the county of The name of the ditch to be used is

15. Are you the owner of the land on which the proposed point of diversion is to be located?

16. If not the owner of the land on which the proposed point of diversion is to be located, give the name and address of owner and submit evidence of your right-of-way for your proposed ditch, canal, or pipe line.

17. Are there any diversions between your present point of diversion and the proposed point of diversion?

NOTE: Answer questions 18 and 19 if application is for change in use or place of use.

18. Are the lands from which you propose to transfer your water right free of all encumbrances, including taxes, mortgages, liens, etc.? yes
(Answer Yes or No)

19. If not, give below a description of existing encumbrances:

NATURE OF ENCUMBRANCE	HELD BY	AMOUNT

20. Reasons for the proposed changes are We planted the new area to alfalfa to
protect the house from dust and fire.

BY THE ENGINEER

MAILED RECORDS DEPT

WATER DIVISION

RECEIVED

AFFIDAVIT OF APPLICANT

STATE OF OREGON,

County of Wasco

} ss.

I, Clarence E. Quirk, the applicant herein, being first duly sworn, depose and say that I have read the above and foregoing application for transfer of water right; that I know the contents thereof and that the statements therein made are true and correct to the best of my knowledge and belief.

In Witness Whereof, I have hereunto set my hand this 18 day of May, 1976

Clarence E. Quirk
(Name of applicant)

Subscribed and sworn to before me this 18 day of MAY, 1976

[Notarial Seal]

Thomas J. Hall
NOTARY PUBLIC FOR OREGON

My commission expires 3-18-80

Remarks _____

THIS APPLICATION MUST BE ACCOMPANIED BY A MAP SHOWING THE LOCATION OF THE POINT OF DIVERSION, PLACE OF USE AND WORKS UTILIZED UNDER THE PRESENT WATER RIGHT. THE MAP SHOULD ALSO SHOW THE NEW POINT OF DIVERSION OR PLACE OF USE, AS THE CASE MAY BE.

REPORT ON INSPECTION UNDER
TRANSFER OF WATER RIGHT FORTransfer No. 3414County Wasco

1. Name Clarence E. Quirk Address 716 West Ninth St., The Dalles, Oregon
2. Source of Supply Fifteenmile Creek, Trib. of Columbia
3. Amount of Water 0.54 c.f.s. Priority Date April 14, 1960
4. Use irrigation of 4⁰ ac
5. Proposed Point of Diversion _____

6. Place of Use DATE FOR APPLICATION OF WATER:
- 10/1/77

Township	Range	Section	Forty Acre Tract	Use for Which Transfer Made	
<u>2N</u>	<u>15E</u>	<u>30</u>	<u>NW$\frac{1}{4}$ SW$\frac{1}{4}$</u>		<u>4.0 acres</u>

Note: page 40's not
lotted.

Info: Vince Remington (Renter)

Source: Fifteen Mile Cr.

Div: pump from Cr.

Pump: Reliance 40 Hp @ 3500
Gould CDD 4x3

Pipe: buried main, 5280' - 3" o.d.

Heads: 132 RB30 $5/32 \times 3/32$

Lift: +20 to +50

Crop: Alfalfa

Tie: 1977-9 tied to SE cor Sec. 31 & center Sec. 30

Remarks: This land is part of a larger field. The actual transferred land will have to be determined by comparing F.P. map with app map & old rights.

9-16-77

Larry W. Funn
Field Engineer