

3433 Henry L. + Joe L. Morris  
8027 High Banks Road  
Central Point 97502

3433

STATUS OF APPLICATION

Change in point of diversion  
Date filed 2-13-76  
Date of hearing 12-14-76  
Place of hearing Medford  
Date of order 1-3-77 Vol. 28, page 230  
Date for application of water 10-1-78-10-1-79  
Proof mailed \_\_\_\_\_  
Proof received \_\_\_\_\_  
Certificate issued NOV 28 1977 Vol. 37, page 44951  
Sept 27, 1988 54 57703

DESCRIPTION OF WATER RIGHT

Name of stream agate slough  
Trib. of \_\_\_\_\_ County of Jackson  
Use irrigation  
Quantity of water \_\_\_\_\_ No. of acres 11<sup>0</sup>  
Name of ditch Main Ditch  
Date of priority February 6, 1931  
In name of Helen Mace  
\_\_\_\_\_ Adjudication, Vol. \_\_\_\_\_, page \_\_\_\_\_  
App. No. 13894 Per. No. 10001 Cert. No. 9093  
Certificate cancelled \_\_\_\_\_  
Notation made on record by \_\_\_\_\_

FEES PAID

Date	Amount	Receipt No.
7-13-76	35.00	54334
7-13-76	45.00 P.O.N.	54335
TOTAL . . .	2 <sup>00</sup>	FROM
11-10-76	Cert. Fee	54335
Paid Newspaper Medford Mail Tribune Part of Ch. #955 +31.90 11-10-76 FEES REFUNDED		

Date	Amount	Check No.
11-10-76	11.10	956

Surveyed 5/86 (Shields)

to survey 8/70

REMARKS

See Transfer 3434- involves same right

CARD FOR C DEC 26 1979

TO BE ENTERED WHERE CHECKED	INDEX CARDS:	Entered	Checked
	<u>WA</u> Name	<input checked="" type="checkbox"/>	<input type="checkbox"/>
	<u>WA</u> Stream	<input checked="" type="checkbox"/>	<input type="checkbox"/>
	<u>WA</u> Pl. & Div.	<input checked="" type="checkbox"/>	<input type="checkbox"/>
	<u>WA</u> Calendar	<input checked="" type="checkbox"/>	<input type="checkbox"/>
	CHECKED TO RECORD:		
	<input checked="" type="checkbox"/> Twp & rge.	<u>GLS</u>	<input type="checkbox"/>
	<input type="checkbox"/> Decree-vault	<input type="checkbox"/>	<input type="checkbox"/>
	<input type="checkbox"/> Decree-sae	<input type="checkbox"/>	<input type="checkbox"/>
	<input checked="" type="checkbox"/> Com. of W/R	<input checked="" type="checkbox"/>	<input type="checkbox"/>
	<input checked="" type="checkbox"/> Per. folder	<input checked="" type="checkbox"/>	<input type="checkbox"/>
	<input type="checkbox"/> Chainindex	<input type="checkbox"/>	<input type="checkbox"/>
	<input type="checkbox"/> Cross Ref.	<input type="checkbox"/>	<input type="checkbox"/>
	<input type="checkbox"/> Power Claim	<input type="checkbox"/>	<input type="checkbox"/>
	<input checked="" type="checkbox"/> Abstracts	<input checked="" type="checkbox"/>	<input type="checkbox"/>



T.36S. R.2W. W.M.

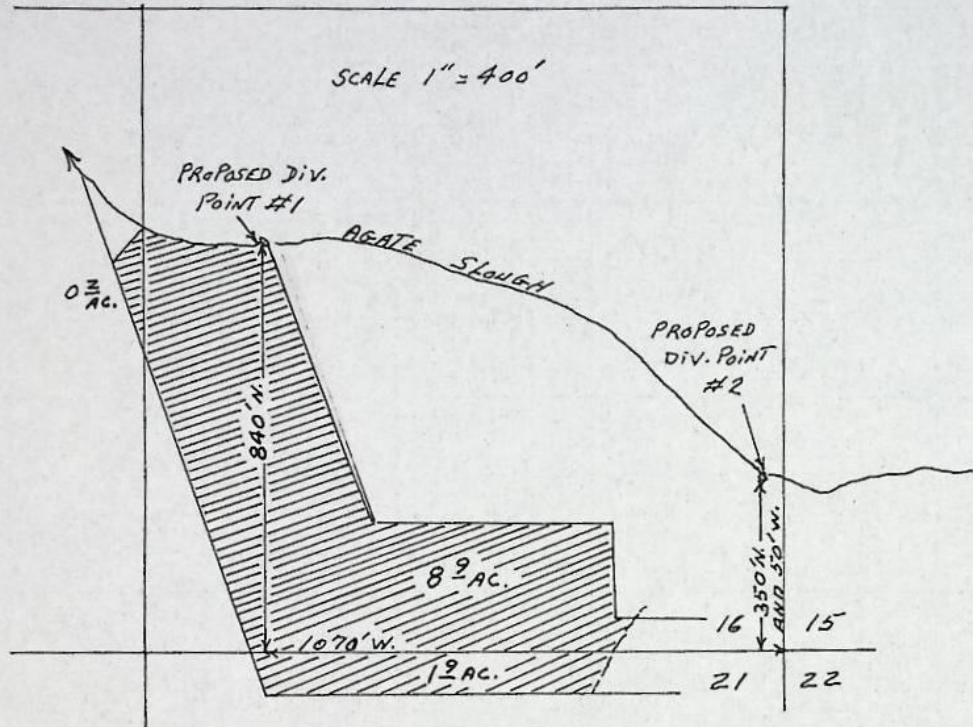

T.36S. R.2W. W.M.

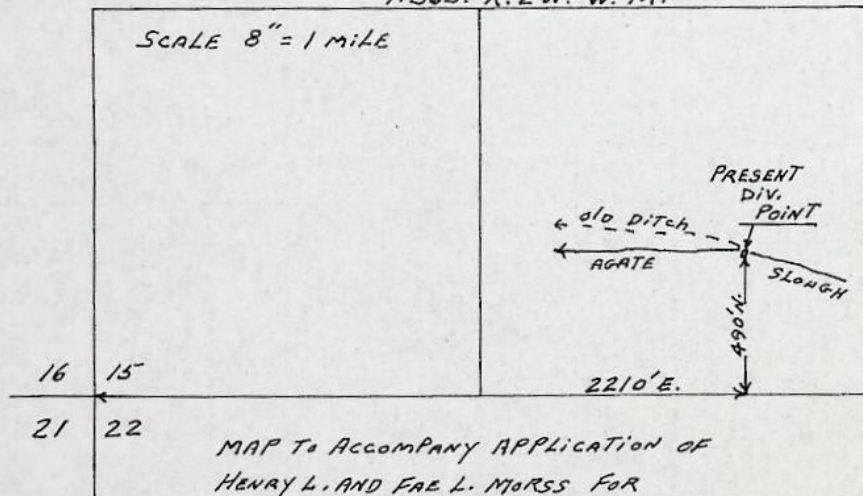

MAP TO ACCOMPANY APPLICATION OF  
HENRY L. AND FAE L. MORSS FOR  
CHANGE IN POINT OF DIVERSION

RECEIVED

JUL 10 1976

WATER RESOURCES DEPT  
SALEM, OREGON

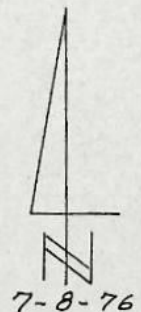

T-2433

T. 36 S., R. 2 W., W.M.

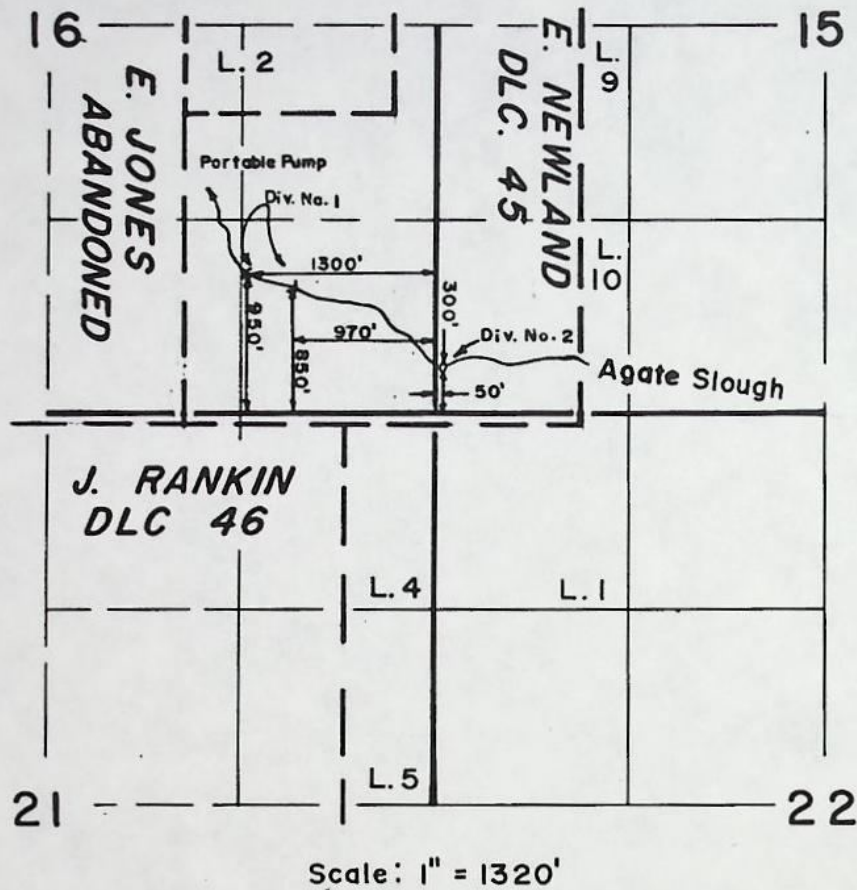

## FINAL PROOF SURVEY

UNDER

TRANSFERS NO. 3433 & 3434

Application No. .... Permit No. ....  
IN NAME OF

LYNDA E. SHIELDS & ED. KROLOP

Surveyed MAY 30, 1986, by B. S. JAMES



BEFORE THE WATER RESOURCES DIRECTOR OF OREGON

Jackson County

IN THE MATTER OF THE APPLICATION }  
OF HENRY L. AND FAE L. MORSS FOR }  
THE APPROVAL OF A CHANGE IN POINT }  
OF DIVERSION OF WATER FROM AGATE }  
SLOUGH }  
-----

ORDER APPROVING  
TRANSFER NO. 3433

On July 13, 1976, Henry L. and Fae L. Morss filed an application in the office of the Water Resources Director for the approval of a change in point of diversion of water from Agate Slough pursuant to the provisions of ORS 540.510 to 540.530.

Certificate of water right issued to Helen Mace and recorded at Page 9093, Volume 8, State Record of Water Right Certificates, confirms a right which includes the use of 0.138 cubic foot per second from Agate Slough, being 0.092 cubic foot per second with a date of priority of December 29, 1930, and 0.046 cubic foot per second with a date of priority of February 6, 1931, for the irrigation of 0.2 acre in SW $\frac{1}{4}$  SE $\frac{1}{4}$  and 8.9 acres in SE $\frac{1}{4}$  SE $\frac{1}{4}$  of Section 16; and 1.9 acres in NE $\frac{1}{4}$  NE $\frac{1}{4}$  of Section 21, Township 36 South, Range 2 West, W.M.

These lands are irrigated by means of the Main Ditch from a point of diversion located 490 feet North and 2210 feet East from the Southwest corner of Section 15, being within the SE $\frac{1}{4}$  SW $\frac{1}{4}$  of Section 15, Township 36 South, Range 2 West, W.M.

The applicant herein, owner of the lands above described, proposes to irrigate these lands from two points of diversion to be located (1) 840 feet North and 1070 feet West and (2) 350 feet North and 50 feet West from the Southeast corner of Section 16, both being within the SE $\frac{1}{4}$  SE $\frac{1}{4}$  of Section 16, Township 36 South, Range 2 West, W.M.



Notice of the application, pursuant to ORS 540.510 was published in the Medford Mail Tribune, a newspaper printed and having general circulation in Jackson County, Oregon, for a period of three weeks in the issues of October 20, 27 and November 3, 1976.

Mr. David C. Hendrix, Watermaster of District No. 13, has filed a statement to the effect that the proposed change in point of diversion may be made without injury to existing rights.

No objection having been filed and it appearing that the proposed change in point of diversion may be made without injury to existing rights, the application should be approved.

NOW, THEREFORE, it hereby is ORDERED that the requested change in point of diversion described herein, without loss of priority, is approved.

It is FURTHER ORDERED that the quantity of water diverted at the new point of diversion shall not exceed the quantity of water available at the old point of diversion, and shall not exceed 0.092 cubic foot per second with a priority date of December 29, 1930, and 0.046 cubic foot per second with a priority date of February 6, 1931.

It is FURTHER ORDERED that the following provisions shall be effective when in the judgement of the watermaster it becomes necessary to install head-gates and measuring devices:

That the diversion works shall include an in line flow meter, a weir, or other suitable device for measuring the water to which the applicant is entitled;

That the type and plans of the measuring device be approved by the watermaster before the beginning of construction work and that the weir or measuring device be installed under the general supervision of said watermaster.

It is FURTHER ORDERED that the construction work shall be completed and the change in point of diversion of water made on or before October 1, 1978.



It is FURTHER ORDERED that the certificate of water right heretofore issued to Helen Mace and recorded at Page 9093, Volume 8, State Record of Water Right Certificates, is canceled, and in lieu thereof a new certificate be issued covering the balance of the right not involved in this proceeding, and upon proof satisfactory to the Water Resources Director of completion of works and beneficial use of water to the extent intended under the provisions of this order, a confirming certificate of water right shall be issued to Henry L. and Fae L. Morss.

Dated at Salem, Oregon, this 3rd day of January, 1977.

/s/ JAMES E. SEXSON  
Director



# Application for Extension of Time for Transfer of Water Right

**RECEIVED**

MAR 7 1979

WATER RESOURCES DEPT.  
SALEM, OREGON

To the WATER RESOURCES DIRECTOR OF OREGON:

I, Lynda E. Shields (Name of applicant)  
 of 8027 High Banks Rd, Central Point (City)  
 State of Ore, 97502, 664-2377 (Zip Code) (Phone number)

do hereby make application for an extension of time within which to complete

a change in: ☒ (X) point of diversion☐ ( ) place of use☐ ( ) use heretofore made of water

under the terms of an order of the Water Resources Director entered on

January 3, 1977, approving transfer application No. 3433,in the name of Henry L. and Fae L. Morss \*

The following has been accomplished toward completion of the  
 change within the time allowed, which expired on October 1, 1978:

\_\_\_\_\_  
 \_\_\_\_\_  
 \_\_\_\_\_  
 \_\_\_\_\_  
 (If for irrigation, how many acres, total, are now irrigated)

\*If you are not the applicant named above, please explain your interest in

this matter. I am buying the place from  
Henry and Fae Morss

Extend to 10-1-79 to allow opportunity to  
 fully complete the other changes in POD

To fully complete the change, it will be necessary to accomplish the following: \_\_\_\_\_

*RECEIVED  
MAY 1979  
WATER RESOURCES DEPT.  
SALEM, OREGON*

I <sup>was unable</sup> ~~am unable~~ to complete the change under the terms of the order, within the time allowed, because I was ill ~~last~~ last  
after I bought the place from moss's  
I need more time to finish this

and request that the time for completion be extended to ~~Jan 1~~ Jan 1 1980

#### AFFIDAVIT OF APPLICANT

I, Lynda E Shields, being first duly sworn, depose and say that I have read the above and foregoing application for extension of time; that I know the contents thereof, and the facts stated therein are true.

IN WITNESS WHEREOF, I have hereunto set my hand this 5 day of March, 1979.

Subscribed and sworn to before me this 5th day of MARCH, 1979.

[Notarial Seal]

Lynda E Shields  
Tracy Chisholm  
Notary Public for Oregon  
My commission expires May 31 1979

MAIL COMPLETED APPLICATION AND FEE IN THE AMOUNT OF \$ 10.00

TO:

Water Resources Department  
MILL CREEK OFFICE PARK  
555 13th STREET N.E.  
SALEM, OREGON 97310

Receipt # 9520





*Water Resources Department*  
**MILL CREEK OFFICE PARK**

555 13th STREET N.E., SALEM, OREGON 97310

PHONE 378-3066

February 8, 1979

Henry L and Fae L Morss  
8027 High Banks Road  
Central Point, Oregon 97502

RE: File No. T- 3433

The time allowed for completion of the change in point of diversion of water from Agate Slough, proposed by your water right transfer application No. 3433, expired October 1, 1978.

If the authorized change(s) was/were accomplished on or before said date, please fill out and sign the statement of completion at the bottom of this letter and send it to us.

If you were unable to fully accomplish the change within the time allowed, but were diligently working on it and, therefore, you want to apply for an extension of the time limit, check the box at the very bottom of this letter to request the proper application form.

Sincerely,

*James W. Carver, Jr.*  
James W. Carver, Jr.  
Engineer

JWC:lcj

-----  
**STATEMENT OF COMPLETION**

I hereby certify that completion of works and use of water to the extent intended within the provisions of the order of the Water Resources Director approving water right transfer application No. 3433 was accomplished by \_\_\_\_\_, 19\_\_.

\_\_\_\_\_  
Date

\_\_\_\_\_  
Signature

-----  
☒ Please send form for application for extension of time limit.

*Sent 2/13/79 lcj*

**RECEIVED**  
FEB 13 1979  
WATER RESOURCES DEPT.  
SALEM, OREGON



RECEIVED

JUL 13 1976

WATER RESOURCES DEPT  
SALEM, OREGON

# Application for Transfer of Water Right

To the STATE ENGINEER OF OREGON:

I, Henry L. and Fae L. Morss  
(Name of applicant)

of 8027 High Banks Road, Central Point, County of Jackson  
(Postoffice)

State of Oregon 97502, do hereby make application for change in point of diversion.

(In point of diversion; place of use; use heretofore made of the water)

1. The source of present water right is Agate Slough.  
(Name of stream)

2. The use to which the water is applied is irrigation.  
(Irrigation; Mining; Power; Manufacturing; etc.)

3. The name of the ditch, canal or pipe line is Main Ditch.

4. The point of diversion is located 490 ft. N. and 2210 ft. E. from the SW  
(N. or S.) (E. or W.)

corner of Section 15 being within the SE 1/4 SW 1/4  
(Section or subdivision)

of Section 15 Tp. 36 S. R. 2 W. W. M., in the County of Jackson.  
(No. N. or S.) (No. E. or W.)

5. List the number of acres irrigated in each smallest legal subdivision (40-acre tract) involved in this transfer. If for any other use, indicate place of use.

Twp.	Range	Sec.	NE 1-4				NW 1-4				SW 1-4				SE 1-4			
			NE 1/4	NW 1/4	SW 1/4	SE 1/4	NE 1/4	NW 1/4	SW 1/4	SE 1/4	NE 1/4	NW 1/4	SW 1/4	SE 1/4	NE 1/4	NW 1/4	SW 1/4	SE 1/4
36 S.	2 W.	16															0.2	8.9
		21	1.9															

NOTE: If you own less than 40-acre tracts, attach a description of your land as it appears in your deed.

(Attach separate sheet if necessary)

112 Ac.

0.138

0.092 Dec 29, 1930

0.046 Feb 6, 1931

Part

6. Are you the legal owner of the above described lands? Yes.  
(If not owner, explain your interest)

7. Has water been used beneficially for the purposes indicated herein during the past 5 years? Yes.

8. What is the date of priority of your water right? Feb. 6, 1931.

9. Was your water right acquired by State Engineer's Permit? Yes. If so, give number  
(Yes or No)

of permit 10001.

13824



10. Do you hold a water right certificate? Yes. If so, give number of certificate 9093.  
(Yes or No)

11. Was your water right determined by State Engineer's order of Determination or Decree of Court?

No. If so, give title of proceedings none.  
(Yes or No)

12. Is the water right recorded in your name? No. Helen Mace.  
(If not, give name)

13. I propose to transfer the water right to the following described lands: (Do not answer if your application is for change in point of diversion only.)

Twp.	Range	Sec.	NE 1-4				NW 1-4				SW 1-4				SE 1-4			
			NE $\frac{1}{4}$	NW $\frac{1}{4}$	SW $\frac{1}{4}$	SE $\frac{1}{4}$	NE $\frac{1}{4}$	NW $\frac{1}{4}$	SW $\frac{1}{4}$	SE $\frac{1}{4}$	NE $\frac{1}{4}$	NW $\frac{1}{4}$	SW $\frac{1}{4}$	SE $\frac{1}{4}$	NE $\frac{1}{4}$	NW $\frac{1}{4}$	SW $\frac{1}{4}$	SE $\frac{1}{4}$

(Attach separate sheet if necessary)

NOTE: Answer questions 14, 15, 16 and 17, if the application is for change in point of diversion.

#1 Diversion ---

#2 Div<sup>14</sup>. The proposed point of diversion is located 840' N. 1070 W.  
350 ft. N. and 50 ft. W. from the SE  
(N. or S.) (E. or W.)  
corner of Sec. 16 both being within the SE $\frac{1}{4}$  SE $\frac{1}{4}$  of Section 16 Tp. 36 S. R. 2 W. M.,  
(Smallest legal subdivision) (No. N. or S.) (No. E. or W.)  
in the county of Jackson. The name of the ditch to be used is pump.

15. Are you the owner of the land on which the proposed point of diversion is to be located? Div. #1, Yes

16. If not the owner of the land on which the proposed point of diversion is to be located, give the name and address of owner and submit evidence of your right-of-way for your proposed ditch, canal, or pipe line.

Diversion #2 is located on property of Gordon and Annabelle Rose, of  
2227 E. Pico Street, Fresno, California 93726.

17. Are there any diversions between your present point of diversion and the proposed point of diversion? Yes.

NOTE: Answer questions 18 and 19 if application is for change in use or place of use.

18. Are the lands from which you propose to transfer your water right free of all encumbrances, including taxes, mortgages, liens, etc.? Yes.  
(Answer Yes or No)

19. If not, give below a description of existing encumbrances:

NATURE OF ENCUMBRANCE	HELD BY	AMOUNT

20. Reasons for the proposed changes are Ditch too costly to maintain.



AFFIDAVIT OF APPLICANT

STATE OF OREGON,

County of Jackson } ss.

I, Henry L. and Fae L. Morss, the applicant herein, being first duly sworn, depose and say that I have read the above and foregoing application for transfer of water right; that I know the contents thereof and that the statements therein made are true and correct to the best of my knowledge and belief.

In Witness Whereof, I have hereunto set my hand this 8 day of JULY, 1976  
\*Henry Morss  
\*Fae L. Morss  
(Name of applicant)

Subscribed and sworn to before me this 8 day of JULY, 1976

[Notarial Seal]

John F. Cummings  
NOTARY PUBLIC FOR OREGON  
My commission expires 21 JANUARY 1980

Remarks \_\_\_\_\_  
\_\_\_\_\_  
\_\_\_\_\_  
\_\_\_\_\_  
\_\_\_\_\_  
\_\_\_\_\_  
\_\_\_\_\_  
\_\_\_\_\_  
\_\_\_\_\_  
\_\_\_\_\_  
\_\_\_\_\_  
\_\_\_\_\_

THIS APPLICATION MUST BE ACCOMPANIED BY A MAP SHOWING THE LOCATION OF THE POINT OF DIVERSION, PLACE OF USE AND WORKS UTILIZED UNDER THE PRESENT WATER RIGHT. THE MAP SHOULD ALSO SHOW THE NEW POINT OF DIVERSION OR PLACE OF USE, AS THE CASE MAY BE.



NOTICE OF FILING APPLICATION  
FOR A CHANGE  
IN POINT OF DIVERSION  
FROM AGATE SLOUGH

Notice is given hereby that Henry L. and Fae L. Morss have filed an application for the approval of a change in point of diversion from Agate Slough.

Certificate of water right issued to Helen Mace and recorded at Page 9093, Volume 8, State Record of Water Right Certificates, confirms a right which includes the use of 0.138 cubic foot per second from Agate Slough, being 0.092 cubic foot per second with a date of priority of Dec. 29, 1930, and 0.046 c.f.s. with a date of priority of Feb. 6, 1931, for the irrigation of 0.2 acre in SW $\frac{1}{4}$  SE $\frac{1}{4}$  and 8.9 acres in SE $\frac{1}{4}$  SE $\frac{1}{4}$  of Sec. 16; and 1.9 acres in NE $\frac{1}{4}$  NE $\frac{1}{4}$  of Sec. 21, T. 36 S., R. 2 W., W.M.

These lands are irrigated by means of the main ditch from a point of diversion located 490 ft. N. and 2210 ft. E. from the SW corner of Sec. 15, being within the SE $\frac{1}{4}$  SW $\frac{1}{4}$  of Sec. 15, T. 36 S., R. 2 W., W.M.

The applicant herein, owner of the lands above described, proposes to irrigate these lands from two points of diversion to be located (1) 840 ft. N. and 1070 ft. W. and (2) 350 ft. N. and 50 ft. W. from the SE corner of Sec. 16, both being within the SE $\frac{1}{4}$  SE $\frac{1}{4}$  of Sec. 16, T. 36 S., R. 2 W., W.M.

All persons interested are notified hereby that a hearing will be held at the county courthouse at Medford, Oregon, on Dec. 14, 1976, at 9:30 a.m. All objections to the proposed change, if any there are, will be heard at said time and place. Any and all objections shall be prepared in writing, one copy to be served on Henry L. and Fae L. Morss, 8027 High Banks Rd., Central Point, Or. 97502, and one copy filed with the Water Resources Department, Salem, Or., 97310, together with a \$10 filing fee, at least 10 days prior to the date set for hearing. IF NO OBJECTION IS FILED, THE APPLICATION MAY BE APPROVED BY THE WATER RESOURCES DIRECTOR WITHOUT A HEARING. Administrative rules pertaining to the filing of a protest will be furnished by the Water Resources Department upon request.

Dated at Salem, Oregon, this 8th day of October, 1976.

JAMES E. SEXSON  
Director

## Affidavit of Publication

State of Oregon,  
County of Jackson

ss.

1. Sharon J. Morris, being first duly

sworn, depose and say that I am the.....  
(OWNER, EDITOR, PUBLISHER, MANAGER.)

### Principal Clerk

ADVERTISING MANAGER, PRINCIPAL CLERK, PRINTER OR PRINTER'S FOREMAN

of Medford Mail Tribune, a newspaper of general circulation, as defined by ORS 193,010 and 193,020; printed and published at Medford in the aforesaid county and state;

that the Notice of filing application for a  
change in point of diversion from Agate Slough  
copy of which is hereto annexed, was published in the entire issue of said newspaper for 3 successive and consecutive weeks in the

following issues Oct. 20, 27, Nov. 3, 1976  
(HERE SET FORTH DATES OF ISSUES IN WHICH THE SAME WAS PUBLISHED)

Sharon J. Morris

Subscribed and sworn to before me this 3rd day of Nov., 1976

James J. Osborn  
NOTARY PUBLIC FOR OREGON

My Commission expires 21st day of May, 1977



Record

76-07510

9:28

6<sup>00</sup>

EASEMENT

GORDON ROSE and ANABELLE ROSE, husband and wife, hereinafter called Grantors, convey to HENRY L. MORSS and FAE L. MORSS, husband and wife, an easement for location, operation and maintenance of an irrigation pipeline to run across the following described real property situated in Jackson County, Oregon:

Commencing at the southeast corner of Donation Land Claim No. 45 in Township 36 South, Range 2 West of the Willamette Meridian in Jackson County, Oregon, thence North 89°41'50" West, along the south boundary of said Claim, 965.43 feet to a 5/8" iron pin, thence North 0°06'50" West 157.75 feet to a 5/8" iron pin for the true point of beginning; thence West 321.25 feet to a 5/8" iron pin; thence North 196.87 feet to a 5/8" iron pin; thence West 501.89 feet to a 5/8" iron pin; thence North 19°10' West 585.42 feet to a 5/8" iron pin; thence South 82°18'10" East 209.95 feet to a 5/8" iron pin; thence South 69°08'10" East 575.26 feet to a 5/8" iron pin; thence South 27°29'30" East 118.72 feet; thence South 56°18'40" East 223.89 feet to a 5/8" iron pin; thence South 76°28'30" East 28.90 feet; thence South 0°06'50" East 280.58 feet to the true point of beginning.

ALSO

Commencing at a 5/8" iron pin on the northerly boundary of Highbanks Road which bears North 89°41'50" West 800.22 feet and North 0°18'10" East 30.00 feet from the southeast corner of Donation Land Claim No. 45, Township 36 South, Range 2 West of the Willamette Meridian, Jackson County, Oregon, thence North 89°41'50" West along said road boundary 100.43 feet to a 5/8" iron pin for the true point of beginning; thence continue along said boundary North 89°41'50" West 65.00 feet to a 5/8" iron pin; thence leave said boundary and run North 0°06'50" West 408.33 feet; thence South 76°28'30" East 66.88 feet to a 5/8" iron pin; thence South 0°06'50" East 393.03 feet to the true point of beginning, and containing 0.60 acres, more or less.

Said easement to be appurtenant to the following described property:

Commencing at the southeast corner of Donation Land Claim No. 45, Township 36 South, Range 2 West of the Willamette Meridian, Jackson County, Oregon; thence North 89°41'50" West along the south boundary of Donation Land Claim No. 45, said Township and Range, 965.43 feet to a 5/8" iron pin for the true point of beginning; thence North 0°06'50" West 157.75 feet to a 5/8" iron pin; thence West 321.25 feet to a 5/8" iron pin; thence North 196.87 feet to a 5/8" iron pin; thence West 501.89 feet to a 5/8" iron pin; thence North 19°10' West 585.42 feet to a 5/8" iron pin; thence North 84°11'40" West 274.14 feet to a 5/8" iron pin; thence North 40°41'30" West 173.74 feet; thence South 19°10' East 1123.89 feet to the northeast.

MORSS  
PROP.

1-EASEMENT

RECEIVED

JUL 13 1976

WATER RESOURCES DEPT  
SALEM, OREGON

T-2433



corner of Donation Land Claim No. 46, said Township and Range; thence South 89°41'50" East along the south boundary of Donation Land Claim No. 45, said Township and Range, 1032.69 feet to the true point of beginning. ALSO, the right of ingress and egress over and across a strip of land 20 feet in width lying easterly of and tangent to the easterly boundary of the above described land, which said 20 foot right of way shall extend from the true point of beginning northerly 157.75 feet and no further.

The above described land, access strip excepted, contains 11.8 acres, more or less, and both are subject to the existing exceptions and reservations.

The true and actual consideration of this transfer is other value given.

The foregoing recital of consideration is true as we verily believe.

DATED this 6 day of May, 1976.

Gordon Rose  
Gordon Rose

Anabelle Rose  
Anabelle Rose

STATE OF OREGON     )  
County of Jackson    ) ss.  
May 6th, 1976        )

Personally appeared GORDON ROSE and ANABELLE ROSE, husband and wife, and both acknowledged the foregoing instrument to be their voluntary act and deed. Before me:



Charles B. Bell  
Notary Public for Oregon  
My commission expires Feb. 27, 1980

Jackson County, Oregon  
Recorded  
OFFICIAL RECORDS  
9.28 MAY 12 1976 A.M.  
HARRY CHIPMAN  
CLERK and RECORDER  
By Betty Deputy  
J Thompson

RECEIVED

JUL 18 1976

WATER RESOURCES DEPT  
SALEM, OREGON

T-3433