



June 25, 2025

Lisa Jaramillo
Oregon Water Resources
Department 725 Summer
Street NE, Suite A Salem, OR
97301

RE: Transfer Application for Certificates 84092 and 90750, in the name of City of Hubbard

Dear Lisa:

The City of Hubbard is the holder of portions of Certificates 84092 and 90750 that authorize the appropriation of groundwater for municipal use.

On behalf of the City of Hubbard, GSI Water Solutions, Inc. is filing the enclosed transfer application to add two additional points of appropriation, Well 4 and Well 1A, to Certificate 84092, and add an additional point of appropriation, Well 1A, to Certificate 90750.

The required transfer application fee of \$2,860 is also enclosed.

Please contact me if you have any questions or concerns. My email address is mclarke@gsiws.com.

Sincerely,

A handwritten signature in black ink that reads "Mikaela Clarke". The signature is written in a cursive, flowing style.

Mikaela Clarke
Water Resources Analyst

Enclosures: Water Right Transfer Application and attachments
Check for processing fee in the amount of \$2,860

Received
JUN 27 2025
OWRD

Application for Permanent Water Right Transfer

Part 1 of 5 – Minimum Requirements Checklist



Oregon Water Resources Department
725 Summer Street NE, Suite A
Salem, Oregon 97301-1266
(503) 986-0900
www.oregon.gov/OWRD

This transfer application will be returned if Parts 1 through 5 and all required attachments are not completed and included.

For questions, please call (503) 986-0900, and ask for Transfer Section.

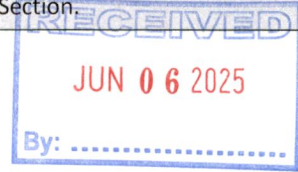

Check all items included with this application. (N/A = Not Applicable)

- ☒ Part 1 – Completed Minimum Requirements Checklist.
- ☒ Part 2 – Completed Transfer Application Map Checklist.
- ☒ Part 3 – Application Fee, payable by check to the Oregon Water Resources Department, and completed Fee Worksheet, page 3. Try the new online fee calculator at:
http://apps.wrd.state.or.us/apps/misc/wrd_fee_calculator.
- ☒ Part 4 – Completed Applicant Information and Signature.
- ☒ Part 5 – Information about Water Rights to be Transferred: **How many water rights are to be transferred? 2 List them here: Certificate 84092 & Certificate 90750 (See Attachment A)**

Please include a separate Part 5 for each water right. (See instructions on page 6)

NOTE: A separate transfer application is required for each water right unless the criteria in OAR 690-380-3220 are met.

Attachments:

- ☒ Completed Transfer Application Map. [See Attachment B](#)
- ☒ Completed Evidence of Use Affidavit and supporting documentation. [See Attachment C](#)
- ☐ ☒ N/A Affidavit(s) of Consent from Landowner(s) (if the applicant does not own the land the water right is on.)
- ☐ ☒ N/A Supplemental Form D – For water rights served by or issued in the name of an irrigation district. Complete when the transfer applicant is not the irrigation district.
- ☒ ☐ N/A Oregon Water Resources Department's Land Use Information Form with approval and signature from each local land use authority in which water is to be diverted, conveyed, and/or used. Not required if water is to be diverted, conveyed, and/or used only on federal lands or if all of the following apply: a) a change in place of use only, b) no structural changes, c) the use of water is for irrigation only, and d) the use is located within an irrigation district or an exclusive farm use zone. [See Attachment D](#)
- ☒ ☐ N/A Water Well Report/Well Log for changes in point(s) of appropriation (well(s)) or additional point(s) of appropriation. [See Attachment E](#)
- ☐ ☒ N/A Geologist Report for a change from a surface water point of diversion to a ground water point of appropriation (well), if the proposed well is more than 500' from the surface water source and more than 1000' upstream or downstream from the point of diversion. See OAR 690-380-2130 for requirements and applicability.

(For Staff Use Only)

WE ARE RETURNING YOUR APPLICATION FOR THE FOLLOWING REASON(S):

- | | |
|--|--|
| <input type="checkbox"/> Application fee not enclosed/insufficient | <input type="checkbox"/> Map not included or incomplete |
| <input type="checkbox"/> Land Use Form not enclosed or incomplete | <input type="checkbox"/> Evidence of Use Form not enclosed or incomplete |
| <input type="checkbox"/> Additional signature(s) required | <input type="checkbox"/> Part _____ is incomplete |

Other/Explanation _____

Staff: _____ 503- _____ Date: ____/____/____

Received
JUN 27 2025
OWRD

Part 2 of 5 – Transfer Application Map

Your transfer application will be returned if any of the map requirements listed below are not met.

Please be sure that the transfer application map you submit includes all the required items and matches the existing water right map. Check all boxes that apply.

- ☒ ☐ N/A Certified Water Right Examiner (CWRE) Stamp and Original Signature. For a list of CWREs, see http://apps.wrd.state.or.us/apps/wr/cwre_license_view/. CWRE stamp and signature are not required for substitutions.
- ☐ ☒ N/A If **more than three** water rights are involved, separate maps are needed for each water right.
- ☒ Permanent quality printed with dark ink on good quality paper.
- ☒ The size of the map can be 8½ x 11 inches, 8½ x 14 inches, 11 x 17 inches, or up to 30 x 30 inches. For 30 x 30 inch maps, one extra copy is required.
- ☒ A north arrow, a legend, and scale.
- ☒ The scale of the map must be: 1 inch = 400 feet, 1 inch = 1,320 feet, the scale of the Final Proof/Claim of Beneficial Use Map (the map used when the permit was certificated), the scale of the county assessor map if the scale is not smaller than 1 inch = 1,320 feet, or a scale that has been pre-approved by the Department.
- ☒ Township, Range, Section, ¼ ¼, DLC, Government Lot, and other recognized public land survey lines.
- ☒ Tax lot boundaries (property lines) are required. Tax lot numbers are recommended.
- ☒ Major physical features including rivers and creeks showing direction of flow, lakes and reservoirs, roads, and railroads.
- ☒ Major water delivery system features from the point(s) of diversion/appropriation such as main pipelines, canals, and ditches.
- ☒ Existing place of use that includes separate hachuring for each water right, priority date, and use including number of acres in each quarter-quarter section, government lot, or in each quarter-quarter section as projected within government lots, donation land claims, or other recognized public land survey subdivisions. If less than the entirety of the water right is being changed, a separate hachuring is needed for lands left unchanged.
- ☐ ☒ N/A Proposed place of use that includes separate hachuring for each water right, priority date, and use including number of acres in each quarter-quarter section, government lot, or in each quarter-quarter section as projected within government lots, donation land claims, or other recognized public land survey subdivisions.
- ☒ Existing point(s) of diversion or well(s) with distance and bearing or coordinates from a recognized survey corner. This information can be found in your water right certificate or permit.
- ☒ ☐ N/A If you are proposing a change in point(s) of diversion or well(s), show the proposed location and label it clearly with distance and bearing or coordinates. If GPS coordinates are used, latitude-longitude coordinates may be expressed as either degrees-minutes-seconds with at least one digit after the decimal (example – 42°32'15.5") or degrees-decimal with five or more digits after the decimal (example – 42.53764°).

Part 3 of 5 – Fee Worksheet

FEE WORKSHEET for PERMANENT TRANSFER (except Substitution)

FEE WORKSHEET for PERMANENT TRANSFER (except Substitution)			
1	Base Fee (includes one type of change to one water right for up to 1 cfs)	1	\$1,360
	Types of change proposed: <input type="checkbox"/> Place of Use <input type="checkbox"/> Character of Use <input checked="" type="checkbox"/> Point of Diversion/Appropriation Number of above boxes checked = <u> </u> (2a) Subtract 1 from the number in line 2a = <u>0 (2b)</u> <i>If only one change, this will be 0</i>		
2	Multiply line 2b by \$1090 and enter »	2	0
	Number of water rights included in transfer <u>2 (3a)</u> Subtract 1 from the number in 3a above: <u>1 (3b)</u> <i>If only one water right this will be 0</i>		
3	Multiply line 3b by \$610 and enter »	3	610
	Do you propose to add or change a well, or change from a surface water POD to a well? <input type="checkbox"/> No: enter 0 <input checked="" type="checkbox"/> Yes: enter \$480 for the 1 st well to be added or changed <u>480 (4a)</u> Do you propose to add or change additional wells? <input type="checkbox"/> No: enter 0 <input checked="" type="checkbox"/> Yes: multiply the number of additional wells by \$410 <u>410 (4b)</u>		
4	Add line 4a to line 4b and enter »	4	890
	Do you propose to change the place of use or character of use? <input checked="" type="checkbox"/> No: enter 0 on line 5 <input type="checkbox"/> Yes: enter the cfs for the portions of the rights to be transferred (see below*): <u> </u> (5a) Subtract 1.0 from the number in 5a above: <u> </u> (5b) If 5b is 0 or less, enter 0 on line 5 » If 5b is greater than 0, round up to the nearest whole number: <u> </u> (5c) and multiply		
5	5c by \$410, then enter on line 5 »	5	0
6	Add entries on lines 1 through 5 above » » » » » » » » » » Subtotal:	6	2,860
	Is this transfer: <input type="checkbox"/> necessary to complete a project funded by the Oregon Watershed Enhancement Board (OWEB) under ORS 541.932? <input type="checkbox"/> endorsed in writing by ODFW as a change that will result in a net benefit to fish and wildlife habitat? If one or more boxes is checked, multiply line 6 by 0.5 and enter on line 7 »		
7	If no box is applicable, enter 0 on line 7 »	7	0
8	Subtract line 7 from line 6 » Transfer Fee:	8	\$2,860

*Example for Line 5a calculation to transfer 45.0 acres of Primary Certificate 12345 (total 1.25 cfs for 100 acres) and 45.0 acres of Supplemental Certificate 87654 (1/80 cfs per acre) on the same land:

1. For irrigation calculate cfs for each water right involved as follows:
 - a. Divide total authorized cfs by total acres in the water right (*for C12345, 1.25 cfs ÷ 100 ac*); then multiply by the number of acres to be transferred to get the transfer cfs (*x 45 ac = 0.56 cfs*).
 - b. If the water right certificate does not list total cfs, but identifies the allowable use as 1/40 or 1/80 of a cfs per acre; multiply number of acres proposed for change by either 0.025 (1/40) or 0.0125 (1/80). (*For C87654, 45.0 ac x 0.0125 cfs/ac = 0.56 cfs*)
2. Add cfs for the portions of water rights on all the land included in the transfer; however **do not count cfs for supplemental rights on acreage for which you have already calculated the cfs fee for the primary right on the same land**. The fee should be assessed only once for each "on the ground" acre included in the transfer. (*In this example, blank 5a would be only 0.56 cfs, since both rights serve the same 45.0 acres. Blank 5b would be 0 and Line 5 would then also become 0*).

FEE WORKSHEET for SUBSTITUTION

FEE WORKSHEET for SUBSTITUTION			
1	Base Fee (includes change to one well)	1	\$990.00
	Number of wells included in substitution _____ (2a) Subtract 1 from the number in 2a above: _____ (2b) <i>If only one well this will be 0</i>		
2	Multiply line 2b by \$480 and enter » » » » » » » » » » » » » » »	2	
3	Add entries on lines 1 through 2 above » » » » » » Fee for Substitution:	3	

Received

JUN 27 2025 TACS

OWRD

Part 4 of 5 – Applicant Information and Signature

Applicant Information

APPLICANT/BUSINESS NAME City of Hubbard; Attn: Melinda Olinger			PHONE NO. 503-982-9429	ADDITIONAL CONTACT NO.
ADDRESS P.O. Box 380				FAX NO.
CITY Hubbard	STATE OR	ZIP 97032	E-MAIL molinger@cityofhubbard.org	
BY PROVIDING AN E-MAIL ADDRESS, CONSENT IS GIVEN TO RECEIVE ALL CORRESPONDENCE FROM THE DEPARTMENT ELECTRONICALLY. COPIES OF THE FINAL ORDER DOCUMENTS WILL ALSO BE MAILED.				

Agent Information – The agent is authorized to represent the applicant in all matters relating to this application.

AGENT/BUSINESS NAME GSI Water Solutions, Inc.; Attn: Mikaela Clarke			PHONE NO. 971-200-8501	ADDITIONAL CONTACT NO.
ADDRESS 650 NE Holladay Street, Suite 900				FAX NO.
CITY Portland	STATE OR	ZIP 97232	E-MAIL mclarke@gsiws.com	
BY PROVIDING AN E-MAIL ADDRESS, CONSENT IS GIVEN TO RECEIVE ALL CORRESPONDENCE FROM THE DEPARTMENT ELECTRONICALLY. COPIES OF THE FINAL ORDER DOCUMENTS WILL ALSO BE MAILED.				

Explain in your own words what you propose to accomplish with this transfer application, and why:
The City of Hubbard is proposing to add two additional points of appropriation, Well 4 and Well 1A, to water right Certificate 84092, and an additional point of appropriation, Well 1A, to water right Certificate 90750.

If you need additional space, continue on a separate piece of paper and attach to the application as "Attachment 1".

Check One Box

- ☐ By signing this application, I understand that, upon receipt of the draft preliminary determination and prior to Department approval of the transfer, I will be required to provide landownership information and evidence that I am authorized to pursue the transfer as identified in OAR 690-380-4010(5); **OR**
- ☒ I affirm the applicant is a municipality as defined in ORS 540.510(3)(b) and that the right is in the name of the municipality or a predecessor; **OR**
- ☐ I affirm the applicant is an entity with the authority to condemn property and is acquiring by condemnation the property to which the water right proposed for transfer is appurtenant and have supporting documentation.

Received
JUN 27 2025
OWRD

OWRD

By my signature below, I confirm that I understand:

- Prior to Department approval of the transfer application, I may be required to submit payment to the Department for publication of a notice in a newspaper with general circulation in the area where the water right is located, once per week for two consecutive weeks. If more than one qualifying newspaper is available, I suggest publishing the notice in the following newspaper: Woodburn Independent.
- Amendments to the application may only be made in response to the Department's Draft Preliminary Determination (DPD). The applicant will have a period of at least 30 days to amend the application to address any issues identified by the Department in the DPD, or to withdraw the application. Note that amendments may be subject to additional fees, pursuant to ORS 536.050.
- Failure to complete an approved change in place of use and/or change in character of use, will result in loss of the water right (OAR 690-380-6010).
- Refunds may only be granted upon request and, as set forth in ORS 536.050(4)(a), if the Director determines that a refund of all or part of a fee is appropriate in the interests of fairness to the public or necessary to correct an error of the Department.

I (we) affirm that the information contained in this application is true and accurate.

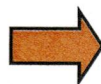

Applicant signature

Melinda Olinger, Public Works Superintendent

Print Name (and Title if applicable)

05/26/2025

Date

Is the applicant the sole owner of the land on which the water right, or portion thereof, proposed for transfer is located? ☐ Yes ☐ No* **N/A – This water right is held by a municipality for municipal use.**

**If NO, include signatures of all deeded landowners (and mailing and/or e-mail addresses if different than the applicant's) or attach affidavits of consent (and mailing and/or e-mail addresses) from all landowners or individuals/entities to which the water right(s) were conveyed.*

Check the following boxes that apply:

- ☒ The applicant is responsible for completion of change(s). Notices and correspondence should continue to be sent to the applicant.
- ☐ The receiving landowner will be responsible for completing the proposed change(s) after the final order is issued. Copies of notices and correspondence should be sent to this landowner.
- ☐ Both the receiving landowner and applicant will be responsible for completion of change(s). Copies of notices and correspondence should be sent to this landowner and the applicant.

At this time, are the lands in this transfer application in the process of being sold? ☒ Yes ☐ No **The City is in the process of purchasing the land where the proposed well (Well 1A) is located.**

If YES, and you know who the new landowner will be, please complete the receiving landowner information table below. If you do not know who the new landowner will be, then a request for assignment will have to be filed for at a later date.

If a property sells, the certificated water right(s) located on the land belong to the new owner, unless a sale agreement or other document states otherwise. For more information see:

https://www.oregon.gov/owrd/WRDFormsPDF/Transfer_Property_Transactions.pdf

RECEIVING LANDOWNER NAME City of Hubbard		PHONE NO.	ADDITIONAL CONTACT NO.
ADDRESS P.O. Box 380			FAX NO.
CITY Hubbard	STATE OR	ZIP 97032	E-MAIL
Describe any special ownership circumstances:			
The confirming Certificate shall be issued in the name of: <input checked="" type="checkbox"/> Applicant <input type="checkbox"/> Receiving Landowner			

☐ Check here if any of the water rights proposed for transfer are or will be located within or served by an irrigation or other water district. (Tip: Complete and attach Supplemental Form D.)

IRRIGATION DISTRICT NAME	ADDRESS	
CITY	STATE	ZIP

☐ Check here if water for any of the rights supplied under a water service agreement or other contract for stored water with a federal agency or other entity.

ENTITY NAME	ADDRESS	
CITY	STATE	ZIP

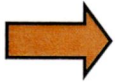

To meet State Land Use Consistency Requirements, you must list all county, city, municipal corporation, or tribal governments within whose jurisdiction water will be diverted, conveyed or used.

ENTITY NAME City of Hubbard Planning/Land Use Department*	ADDRESS 3720 Second Street P.O. Box 380	
CITY Hubbard	STATE OR	ZIP 97032

***The City of Hubbard Planning/Land Use Department is contracted to the Mid-Willamette Valley Council of Governments (MWVCOG) for land use planning reviews.**

ENTITY NAME	ADDRESS	
CITY	STATE	ZIP

Received
JUN 27 2025
OWRD

Part 5 of 5 – Water Right Information

Please use a separate Part 5 for each water right being changed. See instructions on page 6, to copy and paste additional Part 5s, or to add additional rows to tables within the form.

CERTIFICATE # 84092

Received

JUN 27 2025

OWRD

Description of Water Delivery System

System capacity: 1.56 cubic feet per second (cfs) OR
_____ gallons per minute (gpm)

Describe the current water delivery system or the system that was in place at some time within the last five years. Include information on the pumps, canals, pipelines, and sprinklers used to divert, convey, and apply the water at the authorized place of use. The City's water distribution system relies on 4 annually or seasonally active wells and conveys water to its customers via a piped system. Wells 1, 2, and 3 are equipped with a line-shaft turbine pump and motor. Well 4 is equipped with a submersible pump.

Table 1. Location of Authorized and Proposed Point(s) of Diversion (POD) or Appropriation (POA)

(Note: If the POD/POA name is not specified on the certificate, assign it a name or number here.)

POD/POA Name or Number	Is this POD/POA Authorized on the Certificate or is it Proposed?	If POA, OWRD Well Log ID# (or Well ID Tag # L-___)	Twp		Rng		Sec	¼ ¼		Tax Lot, DLC or Gov't Lot	Measured Distances (from a recognized survey corner)
Well 1	<input checked="" type="checkbox"/> Authorized <input type="checkbox"/> Proposed	MARI 56602	4	S	1	W	33	NE	SE	DLC 70	415 feet North and 3,885 feet West from SE corner of DLC 70 ¹
Well 2	<input checked="" type="checkbox"/> Authorized <input type="checkbox"/> Proposed	MARI 923	4	S	1	W	33	SE	NE	DLC 70	1,725 feet North and 3,560 feet West from SE corner of DLC 70 ¹
Well 3	<input checked="" type="checkbox"/> Authorized <input type="checkbox"/> Proposed	MARI 955	4	S	1	W	34	SW	NW	DLC 70	1,240 feet North and 2,620 feet West from SE corner of DLC 70 ¹
Well 4	<input type="checkbox"/> Authorized <input checked="" type="checkbox"/> Proposed	MARI 55251	4	S	1	W	33	NW	SE	DLC 55	1,690 feet North and 1,460 feet West from SE corner of Section 33
Well 1A	<input type="checkbox"/> Authorized <input checked="" type="checkbox"/> Proposed	Well 1A	4	S	1	W	33	NE	SE	DLC 70, TL 3102	2,380 feet North and 700 feet West from SE corner of Section 33

¹The measured distances provided in Table 1 more accurately describe the actual locations of the authorized wells.

Check all type(s) of change(s) proposed below (change "CODES" are provided in parentheses):

- | | |
|---|--|
| <input type="checkbox"/> Place of Use (POU) | <input type="checkbox"/> Supplemental Use to Primary Use (S to P) |
| <input type="checkbox"/> Character of Use (USE) | <input type="checkbox"/> Point of Appropriation/Well (POA) |
| <input type="checkbox"/> Point of Diversion (POD) | <input checked="" type="checkbox"/> Additional Point of Appropriation (APOA) |

- | | |
|---|--|
| <input type="checkbox"/> Additional Point of Diversion (APOD) | <input type="checkbox"/> Substitution (SUB) |
| <input type="checkbox"/> Surface Water POD to Ground Water
POA (SW/GW) | <input type="checkbox"/> Government Action POD (GOV) |

Will all of the proposed changes affect the entire water right?

- ☒ Yes Complete only the Proposed ("to" or "on" lands) section of Table 2 on the next page. Use the "CODES" listed above to describe the proposed changes.
- ☐ No Complete all of Table 2 to describe the portion of the water right to be changed.

Received
JUN 27 2025
OWRD

Please use and attach additional pages of Table 2 as needed.
See page 6 for instructions.

Do you have questions about how to fill-out the tables?
Contact the Department at 503-986-0900 and ask for Transfer Staff.

Table 2. Description of Changes to Water Right Certificate # 84092

List the change proposed for the acreage in each ¼ ¼. If more than one change is proposed, specify the acreage associated with each change.
If there is more than one POD/POA involved in the proposed changes, specify the acreage associated with each POD/POA.

AUTHORIZED (the "from" or "off" lands) The listing that appears on the certificate BEFORE PROPOSED CHANGES List only that part or portion of the water right that will be changed.													Proposed Changes (see "CODES" from previous page)	PROPOSED (the "to" or "on" lands) The listing as it would appear AFTER PROPOSED CHANGES are made.													
Twp	Rng	Sec	¼ ¼	Tax Lot	Gvt Lot or DLC	Acre	Type of USE listed on Certificate	POD(s) or POA(s) (name or number from Table 1)	Priority Date	Twp	Rng	Sec		¼ ¼	Tax Lot	Gvt Lot or DLC	Acre	New Type of USE	POD(s)/ POA(s) to be used (from Table 1)	Priority Date							
EXAMPLE																											
2	S	9	E	15	NE	NW	100		15.0	Irrigation	POD #1 POD #2	1901	POU/POD	2	S	9	E	1	NW	NW	500	1	10.0		POD #5	1901	
														2	S	9	E	2	SW	NW	500		5.0		POD #6	1901	
													APOA	See Certificate 84092 (Attachment A) and Map (Attachment B) for Place of Use								Municipal	Wells 1, 2, 3, 4, and 1A	12/13/1989			
TOTAL ACRES:															TOTAL ACRES:								N/A				

Additional remarks: The Applicant is proposing to add two additional points of appropriation, Well 4 and Well 1A, to water right Certificate 84092.

Received
JUN 27 2025
OWRD

14686 -

For Place of Use or Character of Use Changes

Are there other water right certificates, water use permits or ground water registrations associated with the "from" or the "to" lands? ☐ Yes ☐ No **N/A**

If YES, list the certificate, water use permit, or ground water registration numbers: **Certificate 84092 authorizes the use of water for municipal use so "layering" does not apply.**

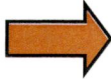
 Pursuant to ORS 540.510, any "layered" water use such as an irrigation right that is supplemental to a primary right proposed for transfer must be included in the transfer or be cancelled. Any change to a ground water registration must be filed separately in a ground water registration modification application.

For Substitution (ground water supplemental irrigation will be substituted for surface water primary irrigation) **N/A**

Ground water supplemental Permit or Certificate # _____;
Surface water primary Certificate # _____.

Received
JUN 27 2025

For a change from Supplemental Irrigation Use to Primary Irrigation Use **N/A**

Identify the primary certificate to be cancelled. Certificate # _____

OWRD

For a change in point(s) of appropriation (well(s)) or additional point(s) of appropriation:

- ☒ Well log(s) are attached for each authorized and proposed well(s) that are clearly labeled and associated with the corresponding well(s) in Table 1 above and on the accompanying application map. **See Attachment E AND/OR**
- ☒ Describe the construction of the authorized and proposed well(s) in Table 3 for any wells that do not have a well log. For *proposed wells not yet constructed or built*, provide "a best estimate" for each requested information element in the table. The Department recommends you consult a licensed well driller, geologist, or certified water right examiner to assist with assembling the information necessary to complete Table 3.

Table 3. Construction of Point(s) of Appropriation

Any well(s) in this listing must be clearly tied to corresponding well(s) described in Table 1 and shown on the accompanying application map. Failure to provide the information will delay the processing of your transfer application until it is received. The information is necessary for the department to assess whether the proposed well(s) will access the same source aquifer as the authorized point(s) of appropriation (POA). The Department is prohibited by law from approving POA changes that do not access the same source aquifer.

Proposed or Authorized POA Name or Number	Is well already built? (Yes or No)	If an existing well: OWRD Well ID Tag No. L-____	Total well depth	Casing Diameter	Casing Intervals (feet)	Seal depth(s) (intervals)	Perforated or screened intervals (in feet)	Static water level of completed well (in feet)	Source aquifer (sand, gravel, basalt, etc.)	Well -specific rate (cfs or gpm). If less than full rate of water right
Well 1A	No	N/A	280 (est.)	16 (casing) 12 (screen assembly) (est.)	0-280 (est.)	0-150 (est.)	183-200 215-235 250-280 (est.)	80 (est.)	Sand & Gravel (Quaternary-Late Tertiary Sediment)	N/A

Part 5 of 5 – Water Right Information

Please use a separate Part 5 for each water right being changed. See instructions on page 6, to copy and paste additional Part 5s, or to add additional rows to tables within the form.

Received

CERTIFICATE # 90750

JUN 27 2025

OWRD

Description of Water Delivery System

System capacity: 0.668 cubic feet per second (cfs) OR

_____ gallons per minute (gpm)

Describe the current water delivery system or the system that was in place at some time within the last five years. Include information on the pumps, canals, pipelines, and sprinklers used to divert, convey, and apply the water at the authorized place of use. Well 4 conveys water to the City's customers via a piped system. Well 4 is equipped with a submersible pump.

Table 1. Location of Authorized and Proposed Point(s) of Diversion (POD) or Appropriation (POA)

(Note: If the POD/POA name is not specified on the certificate, assign it a name or number here.)

POD/POA Name or Number	Is this POD/POA Authorized on the Certificate or is it Proposed?	If POA, OWRD Well Log ID# (or Well ID Tag # L-____)	Twp		Rng		Sec	¼ ¼		Tax Lot, DLC or Gov't Lot	Measured Distances (from a recognized survey corner)
Well 4	<input type="checkbox"/> Authorized <input checked="" type="checkbox"/> Proposed	MARI 55251	4	S	1	W	33	NW	SE	DLC 55	1,690 feet North and 1,460 feet West from SE corner of Section 33 ¹
Well 1A	<input type="checkbox"/> Authorized <input checked="" type="checkbox"/> Proposed	Well 1A	4	S	1	W	33	NE	SE	DLC 70, TL 3102	2,380 feet North and 700 feet West from SE corner of Section 33

¹The measured distance provided in Table 1 more accurately describes the actual location of the authorized Well 4.

Check all type(s) of change(s) proposed below (change "CODES" are provided in parentheses):

- | | |
|--|--|
| <input type="checkbox"/> Place of Use (POU) | <input type="checkbox"/> Supplemental Use to Primary Use (S to P) |
| <input type="checkbox"/> Character of Use (USE) | <input type="checkbox"/> Point of Appropriation/Well (POA) |
| <input type="checkbox"/> Point of Diversion (POD) | <input checked="" type="checkbox"/> Additional Point of Appropriation (APOA) |
| <input type="checkbox"/> Additional Point of Diversion (APOD) | <input type="checkbox"/> Substitution (SUB) |
| <input type="checkbox"/> Surface Water POD to Ground Water POA (SW/GW) | <input type="checkbox"/> Government Action POD (GOV) |

Will all of the proposed changes affect the entire water right?

- ☒ Yes Complete only the Proposed ("to" or "on" lands) section of Table 2 on the next page. Use the "CODES" listed above to describe the proposed changes.
- ☐ No Complete all of Table 2 to describe the portion of the water right to be changed.

Please use and attach additional pages of Table 2 as needed.
See page 6 for instructions.

Do you have questions about how to fill-out the tables?
Contact the Department at 503-986-0900 and ask for Transfer Staff.

Table 2. Description of Changes to Water Right Certificate # 90750

List the change proposed for the acreage in each ¼ ¼. If more than one change is proposed, specify the acreage associated with each change.
If there is more than one POD/POA involved in the proposed changes, specify the acreage associated with each POD/POA.

AUTHORIZED (the “from” or “off” lands) The listing that appears on the certificate BEFORE PROPOSED CHANGES List only that part or portion of the water right that will be changed.											Proposed Changes (see “CODES” from previous page)	PROPOSED (the “to” or “on” lands) The listing as it would appear AFTER PROPOSED CHANGES are made.														
Twp	Rng	Sec	¼ ¼	Tax Lot	Gvt Lot or DLC	Acre	Type of USE listed on Certificate	POD(s) or POA(s) (name or number from Table 1)	Priority Date	Twp		Rng	Sec	¼ ¼	Tax Lot	Gvt Lot or DLC	Acre	New Type of USE	POD(s)/ POA(s) to be used (from Table 1)	Priority Date						
EXAMPLE																										
2	S	9	E	15	NE	NW	100		15.0	Irrigation	POD #1 POD #2	1901	POU/POD	2	S	9	E	1	NW	NW	500	1	10.0		POD #5	1901
														2	S	9	E	2	SW	NW	500		5.0		POD #6	1901
													APOA	“Within the Service Boundaries of the City”								Municipal	Well 4, Well 1A	3/29/1999		
TOTAL ACRES:														TOTAL ACRES:					N/A							

Additional remarks: The Applicant is proposing to add an additional point of appropriation, Well 1A, to water right Certificate 90750.

Received
JUN 27 2025
OWRD

14686 -

For Place of Use or Character of Use Changes

Are there other water right certificates, water use permits or ground water registrations associated with the "from" or the "to" lands? ☐ Yes ☐ No **N/A**

If YES, list the certificate, water use permit, or ground water registration numbers: **Certificate 90750 authorizes the use of water for municipal use so "layering" does not apply.**

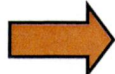
 Pursuant to ORS 540.510, any "layered" water use such as an irrigation right that is supplemental to a primary right proposed for transfer must be included in the transfer or be cancelled. Any change to a ground water registration must be filed separately in a ground water registration modification application.

For Substitution (ground water supplemental irrigation will be substituted for surface water primary irrigation) **N/A**

Ground water supplemental Permit or Certificate # _____;

Surface water primary Certificate # _____.

For a change from Supplemental Irrigation Use to Primary Irrigation Use **N/A**

Identify the primary certificate to be cancelled. Certificate # _____

For a change in point(s) of appropriation (well(s)) or additional point(s) of appropriation:

☒ Well log(s) are attached for each authorized and proposed well(s) that are clearly labeled and associated with the corresponding well(s) in Table 1 above and on the accompanying application map. **See Attachment E**

AND/OR

☒ Describe the construction of the authorized and proposed well(s) in Table 3 for any wells that do not have a well log. For *proposed wells not yet constructed or built*, provide "a best estimate" for each requested information element in the table. The Department recommends you consult a licensed well driller, geologist, or certified water right examiner to assist with assembling the information necessary to complete Table 3.

Table 3. Construction of Point(s) of Appropriation

Any well(s) in this listing must be clearly tied to corresponding well(s) described in Table 1 and shown on the accompanying application map. Failure to provide the information will delay the processing of your transfer application until it is received. The information is necessary for the department to assess whether the proposed well(s) will access the same source aquifer as the authorized point(s) of appropriation (POA). The Department is prohibited by law from approving POA changes that do not access the same source aquifer.

Proposed or Authorized POA Name or Number	Is well already built? (Yes or No)	If an existing well: OWRD Well ID Tag No. L-____	Total well depth	Casing Diameter	Casing Intervals (feet)	Seal depth(s) (intervals)	Perforated or screened intervals (in feet)	Static water level of completed well (in feet)	Source aquifer (sand, gravel, basalt, etc.)	Well -specific rate (cfs or gpm). If less than full rate of water right
Well 1A	No	N/A	280 (est.)	16 (casing) 12 (screen assembly) (est.)	0-280 (est.)	0-150 (est.)	183-200 215-235 250-280 (est.)	80 (est.)	Sand & Gravel (Quaternary-Late Tertiary Sediment)	N/A

Received
JUN 27 2025

OWRD

Received
JUN 27 2025
OWRD

Attachment A

Certificates 84092 and 90750

Application for a Permanent Water Right Transfer
City of Hubbard

STATE OF OREGON

COUNTY OF MARION

CERTIFICATE OF WATER RIGHT

THIS CERTIFICATE ISSUED TO

CITY OF HUBBARD
PO BOX 380
HUBBARD OR 97032-0380

confirms the right to use the waters of THREE WELLS in the Mill Creek Basin for MUNICIPAL USES.

This right was perfected under Permit G-10965. The date of priority is DECEMBER 13, 1989. The amount of water to which this right is entitled is limited to an amount actually used beneficially, and shall not exceed 1.56 CUBIC FEET PER SECOND or its equivalent in case of rotation, measured at the well.

The wells are located as follows:

Well	Twp	Rng	Mer	Sec	Q-Q	GLot	DLC	Survey Coordinates
1	4 S	1 W	WM	33	NE SE		70	240 FEET NORTH & 3940 FEET WEST FROM SE CORNER, DLC 70
2	4 S	1 W	WM	33	SE NE		70	1575 FEET NORTH & 3748 FEET WEST FROM SE CORNER, DLC 70
3	4 S	1 W	WM	34	SW NW		70	1125 FEET NORTH & 2675 FEET WEST FROM SE CORNER, DLC 70

A description of the place of use to which this right is appurtenant is as follows:

MUNICIPAL USES						
Twp	Rng	Mer	Sec	Q-Q	GLot	DLC
4 S	1 W	WM	27	NW SW	6	
4 S	1 W	WM	27	NW SW		70
4 S	1 W	WM	27	SW SW		70
4 S	1 W	WM	28	NE SE		70
4 S	1 W	WM	28	NE SE	1	
4 S	1 W	WM	28	SE SE		70
4 S	1 W	WM	33	NE NE		70
4 S	1 W	WM	33	NW NE		70
4 S	1 W	WM	33	NW NE	1	
4 S	1 W	WM	33	SW NE		70

Received

JUN 27 2025

OWRD

NOTICE OF RIGHT TO PETITION FOR RECONSIDERATION OR JUDICIAL REVIEW

This is an order in other than a contested case. This order is subject to judicial review under ORS 183.484. Any petition for judicial review must be filed within the 60 day time period specified by ORS 183.484(2). Pursuant to ORS 536.075 and OAR 137-004-0080, you may either petition for judicial review or petition the Director for reconsideration of this order. A petition for reconsideration may be granted or denied by the Director, and if no action is taken within 60 days following the date the petition was filed, the petition shall be deemed denied. In addition, under ORS 537.260 any person with an application, permit or water right certificate subsequent in priority may jointly or severally contest the issuance of the certificate at any time before it has issued, and after the time has expired for the completion of the appropriation under the permit, or within three months after issuance of the certificate.

MUNICIPAL USES						
Twp	Rng	Mer	Sec	Q-Q	GLot	DLC
4 S	1 W	WM	33	SW NE	3	
4 S	1 W	WM	33	SE NE		70
4 S	1 W	WM	33	SE NW	3	
4 S	1 W	WM	33	NE SW	4	
4 S	1 W	WM	33	NE SE		70
4 S	1 W	WM	33	NE SE		55
4 S	1 W	WM	33	NW SE		70
4 S	1 W	WM	33	NW SE		55
4 S	1 W	WM	33	NW SE	4	
4 S	1 W	WM	33	SW SE		55
4 S	1 W	WM	33	SE SE		55
4 S	1 W	WM	34	NE NW		70
4 S	1 W	WM	34	NW NW		70
4 S	1 W	WM	34	SW NW		70
4 S	1 W	WM	34	NW SW		70
4 S	1 W	WM	34	NW SW		55
4 S	1 W	WM	34	SW SW		55
5 S	1 W	WM	4	NW NE		38

The wells shall be maintained in accordance with the General Standards for the Construction and Maintenance of Water Wells in Oregon.

The works shall be equipped with a usable access port, and may also include an air line and pressure gauge adequate to determine water level elevation in the wells at all times.

When required by the department, the water user shall install and maintain a weir, meter, or other suitable measuring device and shall keep a complete record of the amount of ground water withdrawn.

The Director may require water level or pump test results every ten years.

Failure to comply with any of the provisions of this right may result in action including, but not limited to restrictions on the use, civil penalties, or cancellation of the right.

This right is for the beneficial use of water without waste. The water user is advised that new regulations may require the use of best practical technologies or conservation practices to achieve this end.

By law, the land use associated with this water use must be in compliance with statewide land-use goals and any local acknowledged land-use plan.

Water may be applied to lands which are not specifically described above, provided the holder of this right complies with ORS 540.510(3).

Received
JUN 27 2025
OWRD

The use of water shall be limited when it interferes with any prior surface or ground water rights.

Issued JUN 20 2008

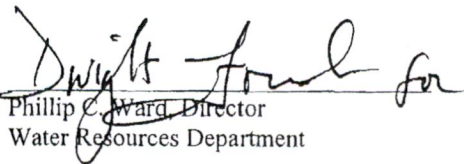
Phillip C. Ward, Director
Water Resources Department

Received
JUN 27 2025
OWRD

STATE OF OREGON
COUNTY OF MARION
CERTIFICATE OF WATER RIGHT

THIS CERTIFICATE ISSUED TO

CITY OF HUBBARD
VICKIE NOGLE
PO BOX 380
HUBBARD, OREGON 97032

Received
JUN 27 2025
OWRD

confirms the right to use the waters of A WELL IN MILL CREEK BASIN for MUNICIPAL USE.

This right was perfected under Permit G-13857. The date of priority is MARCH 29, 1999. The amount of water to which this right is entitled is limited to an amount actually used beneficially, and shall not exceed 0.668 CUBIC FOOT PER SECOND, measured at the well.

The period of use is year round.

The well is located as follows:

Twp	Rng	Mer	Sec	Q-Q	DLC	Measured Distances
4 S	1 W	WM	33	NW SE	55	1540 FEET NORTH AND 1720 FEET WEST FROM SE CORNER, SECTION 33

The place of use is located as follows:

WITHIN THE SERVICE BOUNDARIES OF THE CITY

Measurement, recording and reporting conditions:

- A. The water user shall maintain a meter or other suitable measuring device approved by the Director in good working order, shall keep a complete record of the amount of water used each month, and shall submit a report which includes the recorded water use measurements to the Department annually or more frequently as may be required by the Director. Further, the Director may require the water user to report general water-use information, including the place and nature of use of water under the right.
- B. The water user shall allow the watermaster access to the meter or measuring device; provided however, where the meter or measuring device is located within a private structure, the watermaster shall request access upon reasonable notice.

NOTICE OF RIGHT TO PETITION FOR RECONSIDERATION OR JUDICIAL REVIEW

This is an order in other than a contested case. This order is subject to judicial review under ORS 183.484 and ORS 536.075. Any petition for judicial review must be filed within the 60-day time period specified by ORS 183.484(2). Pursuant to ORS 183.484, ORS 536.075 and OAR 137-004-0080, you may petition for judicial review and petition the Director for reconsideration of this order. A petition for reconsideration may be granted or denied by the Director, and if no action is taken within 60 days following the date the petition was filed, the petition shall be deemed denied. In addition, under ORS 537.260 any person with an application, permit or water right certificate subsequent in priority may jointly or severally contest the issuance of the certificate within three months after issuance of the certificate.

The water user shall monitor and report the impact of water use under this right in accordance with the approved water level monitoring plan on file with the Department. If a well listed on this right (or replacement well) displays a total static water-level decline of 25 or more feet over any period of years, as compared to the reference level, then the water user shall discontinue use of, or reduce the rate or volume of withdrawal from, the well(s). Such action shall be taken until the water level recovers to above the 25-foot decline level or until the Department determines, based on the water user's and/or the Department's data and analysis, that no action is necessary because the aquifer in question can sustain the observed declines without adversely impacting the resource or senior water rights. The water user shall in no instance allow excessive decline, as defined in Commission rules, to occur within the aquifer as a result of use under this right.

If substantial interference with a senior water right occurs due to withdrawal of water from any well listed on this right, then use of water from the well(s) shall be discontinued or reduced and/or the schedule of withdrawal shall be regulated until or unless the Department approves or implements an alternative administrative action to mitigate the interference. The Department encourages junior and senior appropriators to jointly develop plans to mitigate interferences.

The well shall be continuously cased and continuously sealed to a minimum depth of 210 feet below land surface.

The well shall be maintained in accordance with the General Standards for the Construction and Maintenance of Water Wells in Oregon. The works shall be equipped with a usable access port, and may also include an air line and pressure gauge adequate to determine the water level elevation in the well at all times.

The Director may require water level or pump test results every ten years.

Failure to comply with any of the provisions of this right may result in action including, but not limited to, restrictions on the use, civil penalties, or cancellation of the right.

This right is for the beneficial use of water without waste. The water user is advised that new regulations may require the use of best practical technologies or conservation practices to achieve this end.

By law, the land use associated with this water use must be in compliance with statewide land-use goals and any local acknowledged land-use plan.

The use of water shall be limited when it interferes with any prior surface or ground water rights.

The right to the use of the water for the above purpose is restricted to beneficial use on the lands or place of use described; however, water may be applied to lands which are not specifically described above, provided the holder of this right complies with ORS 540.510(3).

Issued _____

SEP 18 2015



Dwight French
Water Right Services Division Administrator, for
Thomas M. Byler, Director
Oregon Water Resources Department

Received

JUN 27 2025

OWRD

Received
JUN 27 2025
OWRD

Attachment B

Application Maps

Application for a Permanent Water Right Transfer
City of Hubbard

Received

JUN 27 2025

OWRD

Attachment C

Evidence of Use Affidavit

Application for a Permanent Water Right Transfer

City of Hubbard

Application for Water Right Transfer Evidence of Use Affidavit



Oregon Water Resources Department
725 Summer Street NE, Suite A
Salem, Oregon 97301-1266
(503) 986-0900
www.wrd.state.or.us

Please print legibly or type. Be as specific as possible. Attach additional pages if you need more spacing.
Supporting documentation must be attached.

State of Oregon)
County of MARION) ss

I, MELINDA OLINGER, in my capacity as PUBLIC WORKS SUPERINTENDENT

mailing address P.O. BOX 380, HUBBARD, OR 97032

telephone number (503)982-9429, being first duly sworn depose and say:

1. My knowledge of the exercise or status of the water right is based on (check one):

☐ Personal observation ☒ Professional expertise

2. I attest that:

☒ Water was used during the previous five years on the **entire** place of use for
Certificate # 84092 AND 90750; OR

☐ My knowledge is specific to the use of water at the following locations within the last five years:

Certificate #	Township	Range	Mer	Sec	¼ ¼	Gov't Lot or DLC	Acres (if applicable)

OR

- ☐ Confirming Certificate # _____ has been issued within the past five years; OR
- ☐ Part or all of the water right was leased instream at some time within the last five years. The instream lease number is: _____ (Note: If the entire right proposed for transfer was not leased, additional evidence of use is needed for the portion not leased instream.); OR
- ☒ The water right is not subject to forfeiture and documentation that a presumption of forfeiture for non-use would be rebutted under ORS 540.610(2) is attached.
- ☐ Water has been used at the actual current point of diversion or appropriation for more than 10 years for Certificate # _____ (For Historic POD/POA Transfers)

3. The water right was used for: (e.g., crops, pasture, etc.): MUNICIPAL

4. I understand that if I do not attach one or more of the documents shown in the table below to support the above statements, my application will be considered incomplete.

(continues on reverse side)

Received
JUN 27 2025
OWRD

Signature of Affiant

Date

Signed and sworn to (or affirmed) before me this 17 day of June, 2025.

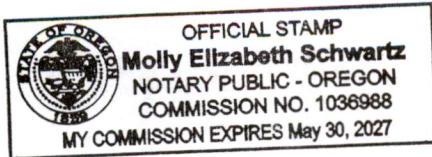

Notary Public for Oregon

My Commission Expires: 05/30/2027

Supporting Documents	Examples
<input type="checkbox"/> Copy of a water right certificate that has been issued within the last five years. (not a remaining right certificate)	Copy of confirming water right certificate that shows issue date
<input type="checkbox"/> Copies of receipts from sales of irrigated crops or for expenditures related to use of water	<ul style="list-style-type: none">• Power usage records for pumps associated with irrigation use• Fertilizer or seed bills related to irrigated crops• Farmers Co-op sales receipt
<input type="checkbox"/> Records such as FSA crop reports, irrigation district records, NRCS farm management plan, or records of other water suppliers	<ul style="list-style-type: none">• District assessment records for water delivered• Crop reports submitted under a federal loan agreement• Beneficial use reports from district• IRS Farm Usage Deduction Report• Agricultural Stabilization Plan• CREP Report
<input type="checkbox"/> Aerial photos containing sufficient detail to establish location and date of photograph	<p>Multiple photos can be submitted to resolve different areas of a water right. If the photograph does not print with a "date stamp" or without the source being identified, the date of the photograph and source should be added.</p> <p>Sources for aerial photos: OSU – www.oregonexplorer.info/imagery OWRD – www.wrd.state.or.us Google Earth – earth.google.com TerraServer – www.terraserver.com</p>
<input type="checkbox"/> Approved Lease establishing beneficial use within the last 5 years	Copy of instream lease or lease number
<input checked="" type="checkbox"/> The water right is not subject to forfeiture and documentation that a presumption of forfeiture for non-use would be rebutted under ORS 540.610(2) is attached.	Certificates 84092 and 90750 (Attachment A) are water rights held by a city for municipal purposes.

Received

JUN 27 2025

OWRD

Received
JUN 27 2025
OWRD

Attachment D

Land Use Information Form

Application for a Permanent Water Right Transfer
City of Hubbard

14686 -

Land Use Information Form

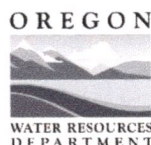

Oregon Water Resources Department
725 Summer Street NE, Suite A
Salem, Oregon 97301-1266
(503) 986-0900
www.oregon.gov/OWRD

Received

JUN 27 2025

OWRD

NOTE TO APPLICANTS

In order for your application to be processed by the Oregon Water Resources Department (OWRD), this Land Use Information Form must be completed by a local government planning official in the jurisdiction(s) where your water right will be diverted, conveyed, used, and developed. The planning official may choose to complete the form while you wait or return the "Receipt Acknowledging Request for Land Use Information" to you. Applications received by OWRD without the Land Use Information Form, or the signed receipt, will be returned to you. **IMPORTANT:** Please note that while OWRD can accept a signed receipt as part of intake for an application for a new permit to use or store water, a completed Land Use Information Form is required for OWRD's acceptance of all other applications. Please be aware that your application cannot be approved without land use approval.

This form is **NOT** required if:

- 1) Water is to be diverted, conveyed, and used on federal lands only; **OR**
- 2) The application is for a water right transfer, allocation of conserved water, exchange, permit amendment, or ground water registration modification, and **all** of the following apply:
 - a. The existing and proposed water use is located entirely within lands zoned for exclusive farm-use or within an irrigation district;
 - b. The application involves a change in place of use only;
 - c. The change does not involve the placement or modification of structures, including but not limited to water diversion, impoundment, distribution facilities, water wells and well houses; **and**
 - d. The application involves irrigation water uses only.

NOTE TO LOCAL GOVERNMENTS

The person presenting the attached Land Use Information Form is applying for a new water right or modifying an existing water right. The Oregon Water Resources Department (OWRD) requires applicants to obtain land use information to ensure the water right does not result in land uses that are incompatible with your comprehensive plan. Please complete the form and return it to the applicant for inclusion in their application. **NOTE:** For new water right applications only, if you are unable to complete this form while the applicant waits, you may complete the "Receipt Acknowledging Request for Land Use Information" and return it to the applicant.

You will receive notice via OWRD's weekly Public Notice once the applicant formally submits their request to OWRD. The notice will give more information about OWRD's water right process and provide additional comment opportunities. If you previously only completed the receipt for an application for a new permit to use or store water, you will have 30 days from the Public Notice date to complete the Land Use Information Form and return it to OWRD. Your attention to this request for information is greatly appreciated. If you have questions concerning this form, please contact OWRD's Customer Service Group at 503-986-0900 or WRD_DL_customerservice@water.oregon.gov.

This page intentionally left blank.

Received
JUN 27 2025
OWRD

Land Use Information Form



Oregon Water Resources Department
725 Summer Street NE, Suite A
Salem, Oregon 97301-1266
(503) 986-0900
www.oregon.gov/OWRD

NAME City of Hubbard; Attn: Melinda Olinger			PHONE 503-982-9429	
MAILING ADDRESS P.O. Box 380				
CITY Hubbard	STATE OR	ZIP 97032	EMAIL molinger@cityofhubbard.org	

A. Land and Location

Please include the following information for all tax lots where water will be diverted (taken from its source), conveyed (transported), and/or used or developed. Applicants for municipal use, or irrigation uses within irrigation districts, may substitute existing and proposed service-area boundaries for the tax-lot information requested below.

Township	Range	Section	¼ ¼	Tax Lot #	Plan Designation (e.g., Rural Residential/RR-5)	Water to be:			Proposed Land Use:
4S	1W	33	NW SE	3001	PU	<input checked="" type="checkbox"/> Diverted	<input checked="" type="checkbox"/> Conveyed	<input checked="" type="checkbox"/> Used	Municipal
4S	1W	33	NE SE	3100	RC	<input checked="" type="checkbox"/> Diverted	<input checked="" type="checkbox"/> Conveyed	<input checked="" type="checkbox"/> Used	Municipal

List all counties and cities where water is proposed to be diverted, conveyed, and/or used or developed:

City of Hubbard, through Mid-Willamette Valley Council of Governments (MWVCOG)

NOTE: A separate Land Use Information Form must be completed and submitted for each county and city, as applicable.

B. Description of Proposed Use

Type of application to be filed with the Oregon Water Resources Department:

- ☐ Permit to Use or Store Water
 ☒ Water Right Transfer
 ☐ Permit Amendment or Ground Water Registration Modification
☐ Limited Water Use License
 ☐ Exchange of Water
 ☐ Allocation of Conserved Water

Source of water: ☐ Reservoir/Pond ☒ Ground Water ☐ Surface Water (name) _____

Estimated quantity of water needed: **2.228** ☒ cubic feet per second ☐ gallons per minute ☐ acre-feet

Intended use of water: ☐ Irrigation ☐ Commercial ☐ Industrial ☐ Domestic for _____ household(s)
☒ Municipal ☐ Quasi-Municipal ☐ Instream ☐ Other _____

Briefly describe:

The Applicant is proposing to add two additional wells to water right Certificate 84092, and one additional well to Certificate 90750. The locations of the wells are listed on this form and shown on the attached maps. Well 4 (on tax lot 3001) is already authorized on the City's water right Certificate 90750.

Note to applicant: For new water right applications only, if the Land Use Information Form cannot be completed while you wait, please have a local government representative sign the receipt on the bottom of page 4 and include it with the application filed with the Oregon Water Resources Department.

See Page 4 ➔

Received
JUN 27 2025

OWRD
Last Revised: 10/2023

For Local Government Use Only

The following section must be completed by a planning official from each county and city listed unless the project will be located entirely within the city limits. In that case, only the city planning agency must complete this form. This deals only with the local land use plan. Do not include approval for activities such as building or grading permits.

Please check the appropriate box below and provide the requested information

- ☒ Land uses to be served by the proposed water use(s), including proposed construction, are allowed outright or are not regulated by your comprehensive plan. Cite applicable ordinance section(s): PU zone outright permitted
- ☒ Land uses to be served by the proposed water use(s), including proposed construction, involve discretionary land-use approvals as listed in the table below. (Please attach documentation of applicable land-use approvals which have already been obtained. Record of Action/land-use decision and accompanying findings are sufficient.) **If approvals have been obtained but all appeal periods have not ended, check "Being Pursued."**

Type of Land-Use Approval Needed (e.g., plan amendments, rezones, conditional-use permits, etc.)	Cite Most Significant, Applicable Plan Policies & Ordinance Section References	Land-Use Approval:	
<u>conditional use permit</u>	<u>Approved</u>	<input checked="" type="checkbox"/> Obtained <input type="checkbox"/> Denied	<input type="checkbox"/> Being Pursued <input type="checkbox"/> Not Being Pursued
		<input type="checkbox"/> Obtained <input type="checkbox"/> Denied	<input type="checkbox"/> Being Pursued <input type="checkbox"/> Not Being Pursued
		<input type="checkbox"/> Obtained <input type="checkbox"/> Denied	<input type="checkbox"/> Being Pursued <input type="checkbox"/> Not Being Pursued
		<input type="checkbox"/> Obtained <input type="checkbox"/> Denied	<input type="checkbox"/> Being Pursued <input type="checkbox"/> Not Being Pursued

Local governments are invited to express special land use concerns or make recommendations to the Oregon Water Resources Department regarding this proposed use of water in the box below or on a separate sheet.

--

Name: Holly Byram Title: Contract City Planner, MWVCOG
Signature: [Signature] Date: 06/17/25
Governmental Entity: for city of Hubbard Phone: (503) 540-1617

Receipt Acknowledging Request for Land Use Information

Note to Local Government Representative:

Please complete this form and return it to the applicant. **For new water right applications only**, if you are unable to complete this form while the applicant waits, you may complete this receipt and return it to the applicant. If you sign the receipt, you will have 30 days from the date of OWRD's Public Notice of the application to submit the completed Land Use Information Form to Oregon Water Resources Department. Please note while OWRD can accept a signed receipt as part of intake for an application for a new permit to use or store water, a completed Land Use Information Form is required for all other applications.

Applicant Name: _____

Staff Name: _____ Title: _____

Staff Signature: _____ Date: _____

Governmental Entity: _____ Phone: _____

Received

JUN 27 2025

OWRD

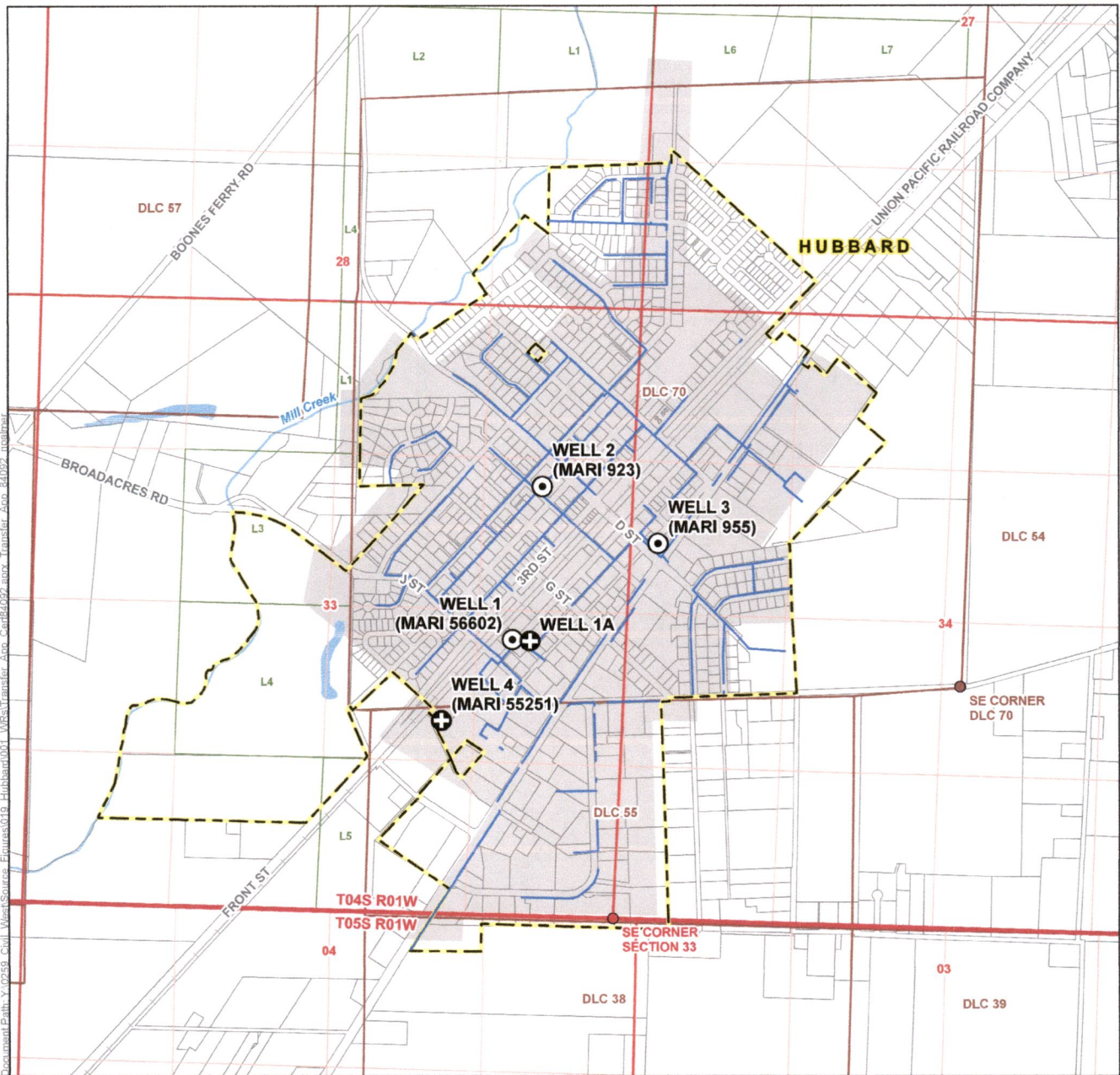

LEGEND

- ⊙ Authorized Point of Appropriation
- ⊕ Proposed Additional Point of Appropriation
- Pipeline
- Authorized Place of Use (POU)
- Tax Lot
- ▭ Donation Land Survey (DLC)
- Government Lot (GL)
- City Boundary
- Railroad
- Watercourse
- Waterbody

CERTIFIED WATER RIGHTS EXAMINER STAMP

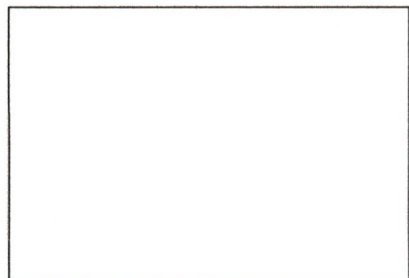

Transfer Application for Certificate 84092

City of Hubbard

Authorized Place of Use/Authorized and Proposed Points of Appropriation

Received

JUN 27 2025

OWRD

LOCATION DESCRIPTION

Authorized Points of Appropriation

Well 1 (MARI 56602): 415 feet North and 3,885 feet West from SE corner of DLC 70, Section 33, Township 4 South, Range 1 West (W.M.) - Tax lot 4800
 Well 2 (MARI 923): 1,725 feet North and 3,560 feet West from SE corner of DLC 70, Section 33, Township 4 South, Range 1 West (W.M.) - Tax lot 5900
 Well 3 (MARI 955): 1,240 feet North and 2,620 feet West from SE corner of DLC 70, Section 34, Township 4 South, Range 1 West (W.M.) - Tax lot 1800

Proposed Additional Points of Appropriation

Well 4 (MARI 55251): 1,690 feet North and 1,460 feet West from SE corner of Section 33, Township 4 South, Range 1 West (W.M.) - Tax lot 3001
 Well 1A: 2,380 feet North and 700 feet West from SE corner of Section 33, Township 4 South, Range 1 West (W.M.) - Tax lot 3100

DISCLAIMER

This map was prepared for the purpose of identifying the location of a water right only and it is not intended to provide legal dimensions or location of property ownership lines.

Date: May 2, 2025

Data Sources: BLM, ESRI, OWRD, USGS

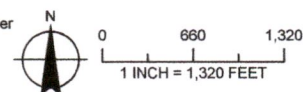

14686 -

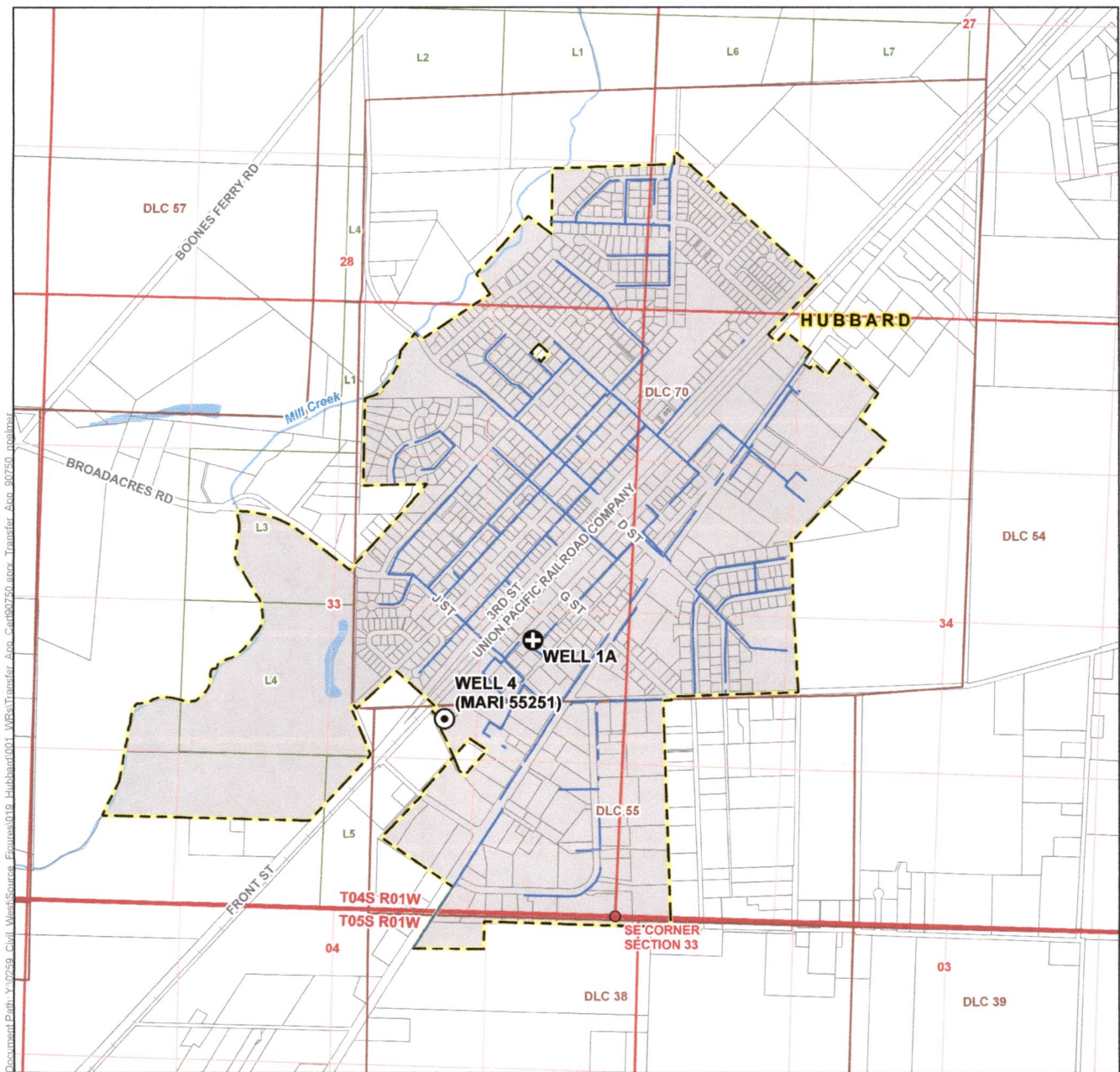

LEGEND

- Authorized Point of Appropriation
- Proposed Additional Point of Appropriation
- Pipeline
- Authorized Place of Use (POU) (City Service Boundaries)
- Tax Lot

- Donation Land Survey (DLC)
- Government Lot (GL)
- City Boundary
- Railroad
- Watercourse
- Waterbody

Transfer Application for Certificate 90750 City of Hubbard

Authorized Place of Use/Authorized and
Proposed Points of Appropriation

Received
JUN 27 2025
OWRD

CERTIFIED WATER RIGHTS EXAMINER STAMP

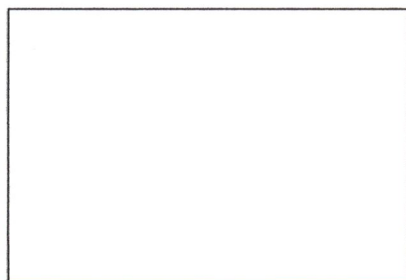

LOCATION DESCRIPTION

Authorized Points of Appropriation

Well 4 (MARI 55251):
1,690 feet North and 1,460 feet West from SE corner of Section 33,
Township 4 South, Range 1 West (W.M.) - Tax lot 3001

Proposed Additional Points of Appropriation

Well 1A:
2,380 feet North and 700 feet West from SE corner of Section 33,
Township 4 South, Range 1 West (W.M.) - Tax lot 3100

DISCLAIMER
This map was prepared for the purpose of
identifying the location of a water right only and
it is not intended to provide legal dimensions
or location of property ownership lines.

Date: May 1, 2025
Data Sources: BLM, ESRI, OWRD, USGS

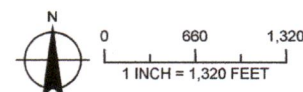

14686 -

Received

JUN 27 2025

OWRD

Attachment E

Well Logs

Well 1: MARI 56602

Well 2: MARI 923

Well 3: MARI 955

Well 4: MARI 55251

Application for a Permanent Water Right Transfer
City of Hubbard

Name Zent Drilling, Inc. (Person, firm or corporation) (Type or print)
Address 7310 St. Johns Blvd. Vancouver, Wash. 98665

Well I

City of Hubbard Well # 1

#12

Formations	From	To
top soil	0	2
silty clay lt. brown	2	35
silty sand fine lt. brown	35	65
silt blue gray	65	71
silty sand lt. brown	71	96
silty clay gray	96	103
silty sand fine blue gray	103	109
sand gravel water (1/2-)	109	116 1/2
silt gray	116 1/2	119 1/2
sand gravel water gray	119 1/2	124
silt gray	123	131 1/2
clay gravel	131 1/2	134
sand gravel water (3/4-)	134	136
silt gray green	136	151
gravelly silt gray	151	164
clay gray green	164	176
rocky clay gray green	176	184
silty sand gray	184	188
sand medium gray	188	199
sand gravel fine gray	199	199 1/2
sandy silt fine gray	199 1/2	215
sand medium gray	215	218
sand gravel (layered w/clay sand)	218	222 1/2
sand gravel (1 1/2- med sand)	222 1/2	227 1/2
sand gravel clay sand gray green	227 1/2	239
sandy silt gray green	239	249
sand fine gray	249	252 1/2
sand medium gray	252 1/2	256 1/2
sand fine gray	256 1/2	269
silty clay gray green	269	271

#7

Diameter	slot size	set from	to
10" pipe size	#20	188	199
"	#80	216	222 1/2
"	#100	222 1/2	235
"	#10	251 1/2	253
"	#16	253	256 1/2

Air Column 180 ft
 Static level 9/1/76 57 ft

Received
 JUN 27 2025
 OWRD

14686 -

NOTICE TO WATER WELL CONTRACTOR
The original and first copy
of this report are to be
filed with the

RECEIVED
NOV 13 1967

WATER WELL REPORT

STATE ENGINEER, SALEM, OREGON 97310
within 30 days from the date
of well completion.

STATE ENGINEER
SALEM, OREGON

STATE OF OREGON

(Please type or print)

(Do not write above this line)

State Well No.

State Permit No.

Received
JUN 9 1967
MARK 7-2025
OWRD

4/16-33 K

(1) OWNER:

Name City Of Hubbard, Oregon

Address

(2) TYPE OF WORK (check):

New Well ☒ Deepening ☐ Reconditioning ☐ Abandon ☐

If abandonment, describe material and procedure in Item 12.

(3) TYPE OF WELL:

Rotary ☐ Driven ☐
Cable ☒ Jetted ☐
Dug ☐ Bored ☐

(4) PROPOSED USE (check):

Domestic ☐ Industrial ☐ Municipal ☒
Irrigation ☐ Test Well ☐ Other ☐

CASING INSTALLED:

Threaded ☐ Welded ☒

16" Diam. from 0 ft. to 51 ft. Gage .312

12" Diam. from 0 ft. to 140'6" ft. Gage .375

" Diam. from ft. to ft. Gage

PERFORATIONS:

Perforated? ☐ Yes ☒ No.

Type of perforator used

Size of perforations	in.	by	in.
perforations from		ft. to	ft.
perforations from		ft. to	ft.
perforations from		ft. to	ft.
perforations from		ft. to	ft.
perforations from		ft. to	ft.

(7) SCREENS:

Well screen installed? ☒ Yes ☐ No

Manufacturer's Name Johnson

Type Johnson Stainless Steel No. pipe size

Diam. 10 Slot size 18 Set from 139 ft. to 149 ft.

Diam. Slot size Set from ft. to ft.

(8) WATER LEVEL: Completed well.

Static level 40 ft. below land surface Date 11-6-67

ian pressure lbs. per square inch Date

(9) WELL TESTS:

Drawdown is amount water level is
lowered below static level

Was a pump test made? ☒ Yes ☐ No If yes, by whom? Driller

Yield: 800 gal./min. with 76 ft. drawdown after 7 hrs.

" " " "

" " " "

Ball test gal./min. with ft. drawdown after hrs.

Artesian flow g.p.m. Date

Temperature of water Was a chemical analysis made? ☐ Yes ☒ No

(10). CONSTRUCTION:

Well seal—Material used Bentonite

Depth of seal 50 ft.

Diameter of well bore to bottom of seal 16 in.

Were any loose strata cemented off? ☐ Yes ☒ No Depth

Was a drive shoe used? ☒ Yes ☐ No

Did any strata contain unusable water? ☒ Yes ☐ No

Type of water? bad oder depth of strata 115 to 131

Method of sealing strata off heavy bentonite slurry

Was well gravel packed? ☐ Yes ☒ No Size of gravel:

Gravel placed from ft. to ft.

(11) LOCATION OF WELL:

County Marion Driller's well number

NW ¼ SE ¼ Section 33 T. 4S R. 1W W.M.

Bearing and distance from section or subdivision corner

(12) WELL LOG:

Diameter of well below casing

Depth drilled 263 ft. Depth of completed well 260 ft.

Formation: Describe color, texture, grain size and structure of materials; and show thickness and nature of each stratum and aquifer penetrated, with at least one entry for each change of formation. Report each change in position of Static Water Level as drilling proceeds. Note drilling rates.

MATERIAL	From	To	SWL
brown sandy clay	0	9	
fine brown sandy silt	9	15	
grey-brown sandy silt	15	40	
grey-brown fine sand & water	40	45	19
grey-brown clay silt	45	83	
grey sandy clay	83	101	
cemented medium fine sand & gravel	101	103	
Med. fine sand & water with bad oder	103	115	32
2 in coarse sand, 2in. rocky clay, sand & gravel	115	131	32
grey-brown rocky clay	131	138½	
med. grey-green sand & water	138½	149½	41
gravel, sandy clay binder	149½	152	
fine grey sandy silt	152	158	
fine grey sandy clay	158	173	
4 to 6 in. layers of fine grey sand & fine grey sandy sandy silt	173	179	
Work started	8-29-67	19	Completed 11-24-67
Date well drilling machine moved off of well	11-3-67	6	19 67

Drilling Machine Operator's Certification:

This well was constructed under my direct supervision. Materials used and information reported above are true to my best knowledge and belief.

[Signed] Marlin Jent Date 11-7-67
(Drilling Machine Operator)

Drilling Machine Operator's License No. 213

Water Well Contractor's Certification:

This well was drilled under my jurisdiction and this report is true to the best of my knowledge and belief.

NAME George Zent & Sons
(Person, firm or corporation) (Type or print)

Address 4305 N.E. 44th St. Vancouver, Wash.

[Signed] George Zent
(Water Well Contractor)

Contractor's License No. 228 Date 11-7-67

(USE ADDITIONAL SHEETS IF NECESSARY)

14686 -

4/1w-33 K
Marion

CITY OF HUBBARD WELL
11-14-67

Screen, Johnson 10 in pipe size

dia.	10	slot size	18	set from	139 ft.	to	149 ft.
"	10	"	10	"	180 "	"	182 "
"	10	"	15	"	182 "	"	190 "
"	10	"	12	"	250 "	"	253 "
"	10	"	25	"	253 "	"	260 "

FORMATIONS CONTINUED

fine to med. grey sand & water	from	to	SWL
	179	194	35
grey-green shale	194	205	
rocky clay	205	210	
gravel with sandy clay binder	210	215	
Med sand 3/4 gravel with some 4 to 5 in seams of sandy clay binder	215	229	50
gravel with grey sandy clay binder	229	249	
fine grey sand & water	249	250	50
med. to coarse grey sand & water mixed with some 2 in. minus gravel	250	260	50
sandy clay, 4 in. grey-brown sandstone at 260	260	263	

RECEIVED
NOV 13 1967
STATE ENGINEER
SALEM, OREGON

Received
JUN 27 2025
OWRD

NOTICE TO WATER WELL CONTRACTOR
The original and first copy of this report
are to be filed with the

WATER RESOURCES DEPARTMENT
SALEM, OREGON 97310
within 30 days from the date
of well completion.

WATER WELL REPORT

STATE OF OREGON

JAN 24 1983

State Well No.

45/110-34

(Please type or print)

(Do not write above this line)

WATER RESOURCES DEPT.
SALEM, OREGON

Permit No.

(1) OWNER:

Name City of Hubbard

Address Hubbard, Oregon 97032

(2) TYPE OF WORK (check):

New Well ☒ Deepening ☐ Reconditioning ☐ Abandon ☐

If abandonment, describe material and procedure in Item 12.

(3) TYPE OF WELL:

Rotary ☐ Driven ☐
Cable ☒ Jetted ☐
Dug ☐ Bored ☐

(4) PROPOSED USE (check):

Domestic ☐ Industrial ☐ Municipal ☒
Irrigation ☐ Test Well ☐ Other ☐

CASING INSTALLED:

12 1/2" Diam. from +3 ft. to 206 ft. Gage 3/8
" Diam. from _____ ft. to _____ ft. Gage _____
" Diam. from _____ ft. to _____ ft. Gage _____

PERFORATIONS:

Perforated? ☐ Yes ☒ No.

Type of perforator used _____

Size of perforations	in.	by	in.
_____ perforations from _____	ft.	to _____	ft.
_____ perforations from _____	ft.	to _____	ft.
_____ perforations from _____	ft.	to _____	ft.

(7) SCREENS:

Well screen installed? ☒ Yes ☐ No

Manufacturer's Name Johnson

Type Telescoping Model No. _____

Diam. 12 Slot size 150 Set from 205 ft. to 230 ft.

Diam. _____ Slot size _____ Set from _____ ft. to _____ ft.

(8) WELL TESTS:

Drawdown is amount water level is
lowered below static level

Was a pump test made? ☒ Yes ☐ No If yes, by whom? driller

Yield: 330 gal./min. with 140 ft. drawdown after 12 hrs.

" " " "

Bailer test gal./min. with _____ ft. drawdown after _____ hrs.

Artesian flow g.p.m. _____

Temperature of water _____ Depth artesian flow encountered _____ ft.

(9) CONSTRUCTION:

Well seal—Material used Cement

Well sealed from land surface to 50 ft.

Diameter of well bore to bottom of seal 16 in.

Diameter of well bore below seal 12 in.

Number of sacks of cement used in well seal 47 sacks

How was cement grout placed? Grout pumped

Was a drive shoe used? ☒ Yes ☐ No Plugs _____ Size: location _____ ft.

Did any strata contain unusable water? ☐ Yes ☒ No

Type of water? _____ depth of strata _____

Method of sealing strata off _____

Was well gravel packed? ☐ Yes ☒ No Size of gravel: _____

Gravel placed from _____ ft. to _____ ft.

(10) LOCATION OF WELL:

County Marian Driller's well number _____

1/4 1/4 Section 34 T. 1W R. 4S W.M.

Bearing and distance from section or subdivision corner _____

(11) WATER LEVEL: Completed well.

Depth at which water was first found 78 ft.

Static level 40 ft. below land surface. Date 1/18/83

Artesian pressure _____ lbs. per square inch. Date _____

(12) WELL LOG:

Diameter of well below casing 12

Depth drilled 250 ft. Depth of completed well 250 ft.

Formation: Describe color, texture, grain size and structure of materials;
and show thickness and nature of each stratum and aquifer penetrated,
with at least one entry for each change of formation. Report each change in
position of Static Water Level and indicate principal water-bearing strata.

MATERIAL	From	To	SWL
Surface	0	3	
Brown clay	3	23	
Brown sandy clay	23	44	
Blue clay	44	78	
Black sand	78	98	
Blue clay	98	112	
Blue sandy clay	112	120	
Sand & gravel	120	135	
Blue clay	135	145	
Sandy blue clay	145	159	
Blue clay	159	181	
Sandy blue clay	181	188	
Sand & small gravel	188	190	
Blue clay	190	200	
Sandy blue clay	200	204	
Sand & gravel	204	230	
Blue clay	230	250	

Work started Nov 16 19 82 Completed Jan 18 19 83

Date well drilling machine moved off of well Jan 18 19 83

Drilling Machine Operator's Certification:

This well was constructed under my direct supervision.
Materials used and information reported above are true to my
best knowledge and belief.

[Signed] John T. Miller Date Jan 20, 19 83

(Drilling Machine Operator)

Drilling Machine Operator's License No. 26

Water Well Contractor's Certification:

This well was drilled under my jurisdiction and this report is
true to the best of my knowledge and belief.

Name John T. Miller

(Person, firm or corporation)

(Type or print)

Address 1780 Tomlin Woodburn, Oregon 97071

[Signed] John T. Miller

(Water Well Contractor)

Contractor's License No. 277 Date Jan 20, 19 83

(USE ADDITIONAL SHEETS IF NECESSARY)

SP*45856-119

14686 -

RECEIVED

MARI 55251

OCT 06 2000

STATE OF OREGON
WATER SUPPLY WELL REPORT
(as required by ORS 537.765) WATER RESOURCES DEPT.
Instructions for completing this report are on the back of this form.

WELL I.D. # L. 45374
START CARD # 128562

WATER RESOURCES DEPT.
SALEM, OREGON

NOV 21 2000

RECEIVED

(1) OWNER: Well Number _____
Name CITY OF HUBBARD
Address 3720 2ND STREET
City HUBBARD State OR Zip 97032

(2) TYPE OF WORK
☒ New Well ☐ Deepening ☐ Alteration (repair/recondition) ☐ Abandonment

(3) DRILL METHOD:
☐ Rotary Air ☐ Rotary Mud ☒ Cable ☐ Auger
☐ Other _____

(4) PROPOSED USE:
☐ Domestic ☒ Community ☐ Industrial ☐ Irrigation
☐ Thermal ☐ Injection ☐ Livestock ☐ Other _____

(5) BORE HOLE CONSTRUCTION:
Special Construction approval ☐ Yes ☒ No Depth of Completed Well 304 ft.
Explosives used ☐ Yes ☒ No Type _____ Amount _____

HOLE SEAL
Diameter From To Material From To Sacks or pounds
16 0 320 CEMENT 0 210 231 SACKS

How was seal placed: Method ☐ A ☐ B ☒ C ☐ D ☐ E
☐ Other _____

Backfill placed from 304 ft. to 320 ft. Material CLAY SLOUGH
Gravel placed from 210 ft. to 304 ft. Size of gravel 8/12 & 6/9

(6) CASING/LINER:
Diameter From To Gauge Steel Plastic Welded Threaded
Casing: 12 +3 208 250 ☒ ☐ ☒ ☐
10 208 228 250 ☒ ☐ ☒ ☐
10 271 289 250 ☒ ☐ ☒ ☐
10 297 304 250 ☒ ☐ ☒ ☐
Liner: _____
Final location of shoe(s) 301 (16") CUT OFF

(7) PERFORATIONS/SCREENS:
☐ Perforations Method CONTINUOUS V-WIRE
☒ Screens Type _____ Material SS
From To Slot size Number Diameter Tele/pipe size Casing Liner
228 225 .070 _____ 10" p/s ☐ ☐
255 271 .045 _____ 10" p/s ☐ ☐
289 297 .070 _____ 10" p/s ☐ ☐

(8) WELL TESTS: Minimum testing time is 1 hour

☒ Pump ☐ Bailor ☐ Air ☐ Flowing
Yield gallons Drawdown Drill stem at Time
100 19 _____ 1 hr
450 124 _____ 5 hr
350 96 _____ 12 hr

Temperature of water 54 Depth Artesian Flow Found _____

Was a water analysis done? ☐ Yes By whom NO

Did any strata contain water not suitable for intended use? ☐ Too little

☐ Salty ☐ Muddy ☐ Odor ☐ Colored ☐ Other _____

Depth of strata: _____

(9) LOCATION OF WELL by legal description:
County MARION Latitude _____ Longitude _____
Township 4S N or S Range 1W E. W. W.M.
Section 33 NE 1/4 SE 1/4
Tax Lot 3001 Lot _____ Block _____ Subdivision _____
Street Address of Well (or nearest address) _____

2701 PACIFIC HWY 99E. HUBBARD, OR

(10) STATIC WATER LEVEL:
_____ ft. below land surface. Date 9-14-00
Artesian pressure _____ lb. per square inch. Date _____

(11) WATER BEARING ZONES:
Depth at which water was first found 112'

From	To	Estimated Flow Rate	SWL
<u>112</u>	<u>142</u>	<u>N/A</u>	<u>N/A</u>
<u>229</u>	<u>294</u>	<u>450+</u>	<u>63</u>

(12) WELL LOG:
Ground Elevation _____

Material	From	To	SWL
<u>FILL DIRT & GRAVEL</u>	<u>0</u>	<u>4</u>	
<u>SILTY BRN SOIL</u>	<u>4</u>	<u>22</u>	
<u>SANDY SILT BRN</u>	<u>22</u>	<u>47</u>	
<u>SILTY CLAY GREY SANDY</u>	<u>47</u>	<u>78</u>	
<u>CLAY GREY STICKY</u>	<u>78</u>	<u>84</u>	
<u>CLAY GREY SANDY</u>	<u>84</u>	<u>112</u>	
<u>CLAY & GRAVEL</u>	<u>112</u>	<u>121</u>	
<u>CMTD GRVL GREY</u>	<u>121</u>	<u>142</u>	
<u>CLAY GREY STICKY</u>	<u>142</u>	<u>168</u>	
<u>CLAY GREY & BRN</u>	<u>168</u>	<u>177</u>	
<u>CLAY BLUE GRN STICKY</u>	<u>177</u>	<u>194</u>	
<u>CLAY GREY W/GRAVEL</u>	<u>194</u>	<u>210</u>	
<u>CLAY GREY SILTY</u>	<u>210</u>	<u>217</u>	
<u>CLAY GRN STICKY</u>	<u>217</u>	<u>229</u>	
<u>CEMENTED GRAVEL</u>	<u>229</u>	<u>254</u>	
<u>CLAY GREY</u>	<u>254</u>	<u>259</u>	
<u>CLAY GREY W/STRKS OF SAND</u>	<u>259</u>		
<u>& PUMICE</u>		<u>268</u>	
<u>CLAY GREY BLUE STICKY</u>	<u>268</u>	<u>277</u>	
<u>CONT.</u>			

Date started 7-24-00 Completed 9-20-00

(unbonded) Water Well Constructor Certification:
I certify that the work I performed on the construction, alteration, or abandonment of this well is in compliance with Oregon water supply well construction standards. Materials used and information reported above are true to the best of my knowledge and belief.

WWC Number _____
Signed _____ Date _____

(bonded) Water Well Constructor Certification:

I accept responsibility for the construction, alteration, or abandonment work performed on this well during the construction dates reported above. All work performed during this time is in compliance with Oregon water supply well construction standards. This report is true to the best of my knowledge and belief.

WWC Number 688
Signed Steven M. Sholei Date 9-28-00

ORIGINAL WATER RESOURCES DEPARTMENT FIRST COPY CONSTRUCTOR SECOND COPY CUSTOMER

Received

JUN 27 2025

OWRD

14686 -

OCT 06 2000

WELL I.D. # L _____
START CARD # 128562

(9) LOCATION OF WELL by legal description:
County MARION Latitude _____ Longitude _____
Township 4S N or S Range 1W E or W. WM.
Section 33 NE 1/4 SE 1/4
Tax Lot 3001 Lot _____ Block _____ Subdivision _____
Street Address of Well (or nearest address) _____
2701 PACIFIC HWY 99E

(10) **STATIC WATER LEVEL:**
 _____ ft. below land surface. Date _____
 Artesian pressure _____ lb. per square inch. Date _____

(11) **WATER BEARING ZONES:** _____

Depth at which water was first found _____

From	To	Estimated Flow Rate	SWI,

(12) WELL LOG:

Ground Elevation _____

[illegible]

Work started 7-24-00 Completed 9-20-00
(b) (5) DPP
I certify that the work I performed on the construction, alteration, or abandonment of this well is in compliance with Oregon water supply well construction standards. The materials used and information reported above are true to the best of my knowledge and belief.

WWC Number _____
Date _____

Accepted responsibility for the construction, alteration, or abandonment work performed on this well during the construction dates reported above. All work performed during this time is in compliance with Oregon water supply well construction standards. This report is true to the best of my knowledge and belief.

 WWC Number 688
 Date 9-28-00

WWC Number 688
Date 9-28-00

INSTRUCTOR SECOND COPY - CUSTOMER

Temperature of water _____ Depth Artesian Flow Pound _____

Was a water analysis done? ☐ Yes By whom _____

Did any strata contain water not suitable for intended use? ☐ Too little

☐ Salty ☐ Muddy ☐ Odor ☐ Colored ☐ Other _____

Depth of strata: _____

ORIGINAL WATER RESOURCES DEPARTMENT FIRST COPY CONSTRUCTOR SECOND COPY CUSTOMER

Received

JUN 27 2025

OWRD

14686 -