

3379 International Paper Co.
P.O. Box 579
Longview, Wash. 98601

3379

STATUS OF APPLICATION

Change in point of diversion and use
Date filed 3-25-76
Date of hearing 4-12-77
Place of hearing Dallas, Oregon
✓ Date of order 4-29-77 Vol. 29, page 8
EXT 10-1-87
Date for application of water 10-1-80
EXT TO 10-1-92, 10-1-97
Proof mailed _____
Proof received _____
Certificate issued AUG 03 1995 Vol. _____, page 68530

DESCRIPTION OF WATER RIGHT

Name of stream Rock Creek
Trib. of _____ County of _____
Use _____
Quantity of water _____ No. of acres _____
Name of ditch _____
Date of priority _____
In name of _____
_____ Adjudication, Vol. _____, page _____
App. No. 20041 Per. No. 15608 Cert. No. 15613
Certificate cancelled _____
Notation made on record by _____

FEES PAID

Date	Amount	Receipt No.
3-25-76	35.00	52123
3-25-76	PAN. 45.00	52124
2/17/77	15.00	52234
TOTAL . . .		
2/17/77	No Cert. Fee	
The Polk Co. Steniger-Obenauer 4/1.25		Ch. # 1216

FEES REFUNDED

Date	Amount	Check No.
3-24-77	3.75	1217

Fees Exam 20.00
Office 15.00
A P.O.D. 15.00
50.00

REMARKS

See also Appl Nos. 52769 & 52770
(Cert #15555 - File #R-20040 - Canceled)
CARD FOR C NOV 4 1980

MAP IN FILE # 120

TO BE ENTERED WHERE CHECKED	INDEX CARDS:		Entered	Checked
	✓	Name	✓	_____
	✓	Stream	✓	_____
	✓	Pt. of Div.	_____	_____
	✓	Calendar	✓	_____
	CHECKED TO RECORDS:			
	✓	Twp. & Rge.	bcg	_____
	_____	Decree-vault	_____	_____
	_____	Decree-safe	_____	_____
	✓	Cert. of W/R	✓	_____
_____	✓	Per. Folder	✓	_____
_____	_____	Chainindex	_____	_____
_____	_____	Cross Ref.	_____	_____
_____	_____	Power Claim	_____	_____
_____	_____	Abstracts	✓	_____

Notice to Mailer of Correction in Address

200418T-3379

Addressee's Account Number (All numbers, dates, and letters)

- ☒ No account number on mail
☐ Account number illegible

Addressee's Name

Grand Ronde Community Water Assc

Site address? →

Old Address (Include apartment or suite number)
City, State, and ZIP Code

26690 Hwy. 18
Grand Ronde, OR 97347

New Address (Include apartment or suite number)
City, State, and ZIP Code

PO Box 253
Grand Ronde, OR 97347

This card is furnished: ☒ For address correction, as requested (your mailpiece was forwarded).
☐ In place of Form 3579 (see reason for nondelivery below).

The address portion of your mailpiece was not readily detachable. Reason for nondelivery:

- ☐ Moved, left no address
☐ No such street
☐ No such number
☐ Refused
☐ Attempted, not known
☐ Unclaimed

PS Form 3547, June 1995

|||||

Oregon Water Resources Dept.
725 Summer St NE Suite A
Salem, OR 97301

Postage Due 50¢

First-Class Mail
Postage & Fees Paid
USPS
Permit No. G-10

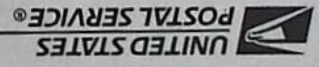

CLAIM OF BENEFICIAL USE AND SITE REPORT

Transfer 3379

Grand Ronde Community Water Association
26690 Salmon River Highway
Willamina, Oregon 97396

P.O. Box 253
Grand Ronde, Oregon 97347

Telephone: (503) 879-5624

RECEIVED

JUN 12 1995

**WATER RESOURCES DEPT.
SALEM, OREGON**

Sources of Information: Karl Ekstrom, Grand Ronde manager
Chuck Hosley, Grand Ronde meter reader
Carol Heckadon, Grand Ronde billing
Mark Lyons, Buell-Red Prairie meter reader

SOURCE: Spring tributary to Rock Creek, tributary to South Yamhill River. The spring is located in the Coast Range southwest of the community of Grand Ronde.

**DIVERSION
POINT:** The diversion point consists of three 6" diameter underground infiltration galleries. The north and middle galleries were depositing into the system. The gate valve was closed on the south one and it is passing all water via a 6" overflow pipe to a stream channel tributary to Rock Creek.

Water is piped downhill through a 6" pipeline to a steel spring box, 8' x 12' x 8' deep with a 6" diameter overflow which drains to the stream channel. The spring box connects to a 6" diameter transmission line which delivers water to the Association's main reservoir off Fire Hall Road. The transmission line consists of both 6" and 4" sized piping, depending on the steepness of the grade, and is 6± miles long and falls 1200± in elevation between the spring box and the main reservoir.

Along this steep downgrade there are three pressure reducing tanks which overflow to various existing roadside ditches and unnamed channels, all of which empty into Rock Creek.

**DISTRIBUTION
SYSTEM:**

The distribution system contains the following approximate quantities of buried pipeline:

16,500	LF of 8" dia	(3.13 mi.)
61,200	LF of 6" dia	(11.59 mi)
136,400	LF of 4" dia	(25.83 mi.)
19,000	LF of 2" & 3" dia	(3.6 mi)

RECEIVED**JUN 12 1995**

The Association has three existing tank reservoirs:

WATER RESOURCES DEPT.
SALEM, OREGON

	<i>Elevation</i>	
	<i>ground</i>	<i>water surface</i>
50,000 gal Fire Hall Road	470	541.5
150,000 gal Rowell Creek Road	496	519
103,000 gal Corbett Acres	778	801

The Corbett Acres Reservoir is filled by means of a booster pump station with two horizontal diffuser pumps, 85 gpm at 358', Peerless Model TH-32, 3 stage, intake and discharge 4" diameter. The motor is a Baldor 20hp, 3500rpm, 254T frame, Serial No 30755-S

The westerly end of the system, along Hebo Road, is pressurized by a pump station with a Franklin 2hp motor and a 2hp Jacuzzi Model 2 5650-5, 220 volt single phase, designed for 150' total dynamic head at 40gpm or 100' total dynamic head at 58gpm. The pump is a submersible well pump housed in an 8" ductile iron pipe lying horizontally.

USE:

The transfer changed the type of use to quasi-municipal. The Association is using this water for the uses allowed under the quasi-municipal classification, including domestic, industrial, irrigation of lawns and gardens, commercial, fire protection, stockwater and agricultural use.

The Association currently has 603 active services. There are membership holders who have a service at the road side but who have never put any water to beneficial use. These non-using members' properties were not included in the field proof survey and are not included in the area of beneficial use unless they fall in a quarter-quarter already established as a place of beneficial use by virtue of the location of actual water users.

A portion of Grand Ronde's permit boundary for this Transfer overlaps part of the Buell-Red Prairie system. Over the years, and as recently as September of 1993, Grand Ronde has sold water to Buell-Red Prairie in

sufficient quantity to supply those services lying within the boundary overlap. These include an additional 155 hook-ups for beneficial use.

LIFT:

As explained above, the source is elevated above the community it serves and flows by gravity to most of the services. The northeast area, known as Corbett Acres, is served by the Corbett Acres reservoir. Water is pumped by a lift station to this reservoir. The northwest area, along Hebo Road, is also assisted by a lift station to keep pressures levels up, especially during summertime periods of heavy demand.

CALCULATIONS: The method used to determine the quantity of water diverted and put to beneficial use by the Association was to obtain copies of the monthly totalized figures of water sales as reported and recorded by their meter reading activities (included).

The summertime readings indicate peak demand periods. For at least the last four years, Grand Ronde has routinely exceeded the 0.30 cfs allowed by this water right permit during the months of July, August and September.

SURVEY TIE:

The spring source was tied to the property pins which mark the corners of the Association's land ownership. The property was surveyed on February 23, 1995 by Edward L. Query, PLS 1653, of Barker Surveying of Salem, Oregon. Mr. Query located the monuments at the Southeast corner and the East Quarter corner of Section 32 and set the property corners at the specified deed locations from these existing monuments. Mr. Query also provided the Association with a map of some of the physical features at the spring site. These two maps were used to measure the location of the springs in the field on April 12, 1995.

RECEIVED

JUN 12 1995

**WATER RESOURCES DEPT.
SALEM, OREGON**

The locations of the places of use were collected in the field. Prints of 1" = 400' aerial photographs were obtained from the Polk and Yamhill County Assessor's offices. The Polk County photos were taken June 18, 1993; the Yamhill County photos are dated September of 1992. On February 22 and 24, 1995, the Grand Ronde meter reader drove their entire system with my surveyor and the places of use were located on the aerial photos. The meter reader for the Buell-Red Prairie system met with my surveyor and, with his meter list, identified on the aerial photos those places of service which lie within the Grand Ronde boundary.

The locations of the place of use were transferred from the aerial photos to USGS Quad maps. The quarter-quarter sections were identified, tabulated and transferred to the accompanying proof survey map.

REMARKS:

Grand Ronde currently holds two other valid permits for an additional 0.88 cfs of water from these springs. They are Application No. 52769, Permit No. 41436 and Application No. 52770, Permit No. 41437. Therefore, the fact that they are exceeding the amount permitted by this Transfer is not a violation of their permits.

The final proof survey and inspection of the use as found to be completed under the terms and condition of Transfer No. 3379 was completed by me on the above listed dates, and the facts as contained in this report and accompanying final proof map are correct to the best of my knowledge.

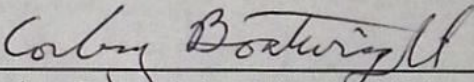
Corbey Boatwright, CWRE No 208

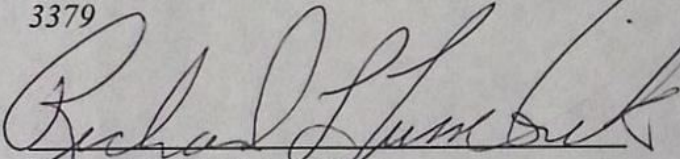

I, Richard L. Zimbrick, Chairman of the Board of the Grand Ronde Community Water Association, agree to the findings of the CWRE and do submit this site report and map as our Claim of Beneficial Use of the water as provided under the terms and conditions of Transfer No. 3379

Richard L. Zimbrick, Chairman
Grand Ronde Community Water Association

RECEIVED

JUN 12 1995

WATER RESOURCES DEPT.
SALEM, OREGON

AREA OF BENEFICIAL USE

S ½ NE ¼
NE ¼ NE ¼
N ½ SE ¼
SW ¼ SE ¼
Section 33

W ½ NW ¼
SE ¼ NW ¼
NE ¼ SW ¼
SE ¼
Section 34

All
Section 35

W ½ NE ¼
NW ¼
N ½ SW ¼
SE ¼ SW ¼
NE ¼ SE ¼
W ½ SE ¼
Section 36

Township 5 South, Range 7 West, W.M.

S ½ SW ¼
SW ¼ SE ¼
Section 29

SE ¼ SE ¼
Section 30

NW ¼ NE ¼
S ½ NE ¼
NE ¼ NW ¼
NE ¼ SE ¼
Section 32

S ½ NW ¼
N ½ SW ¼
NW ¼ SE ¼
S ½ SE ¼
Section 33

SW ¼ SW ¼
Section 34

S ½ NE ¼
E ½ NW ¼
E ½ SW ¼
SE ¼
Section 36

Township 5 South, Range 8 West, W.M.

RECEIVED

JUN 12 1995

**WATER RESOURCES DEPT.
SALEM, OREGON**

W $\frac{1}{2}$ SW $\frac{1}{4}$ rev 7-24, 1995

Section 5

NE $\frac{1}{4}$ NE $\frac{1}{4}$

W $\frac{1}{2}$ E $\frac{1}{2}$

E $\frac{1}{2}$ W $\frac{1}{2}$

Section 15

NW $\frac{1}{4}$

NE $\frac{1}{4}$ SW $\frac{1}{4}$

S $\frac{1}{2}$ SW $\frac{1}{4}$

SE $\frac{1}{4}$ SE $\frac{1}{4}$

Section 16

SE $\frac{1}{4}$ NE $\frac{1}{4}$

E $\frac{1}{2}$ SE $\frac{1}{4}$

Section 17

W $\frac{1}{2}$ SW $\frac{1}{4}$

SE $\frac{1}{4}$ SW $\frac{1}{4}$

Section 18

W $\frac{1}{2}$ NE $\frac{1}{4}$

SE $\frac{1}{4}$ NE $\frac{1}{4}$

N $\frac{1}{2}$ NW $\frac{1}{4}$

N $\frac{1}{2}$ SE $\frac{1}{4}$

Section 19

S $\frac{1}{2}$ N $\frac{1}{2}$

SW $\frac{1}{4}$

Section 20

W $\frac{1}{2}$ NW $\frac{1}{4}$

SE $\frac{1}{4}$ NW $\frac{1}{4}$

E $\frac{1}{2}$ SW $\frac{1}{4}$

SW $\frac{1}{4}$ SE $\frac{1}{4}$

Section 21

W $\frac{1}{2}$ NE $\frac{1}{4}$

SE $\frac{1}{4}$ NE $\frac{1}{4}$

E $\frac{1}{2}$ NW $\frac{1}{4}$

SE $\frac{1}{4}$

Section 22

E $\frac{1}{2}$

E $\frac{1}{2}$ NW $\frac{1}{4}$

SW $\frac{1}{4}$ NW $\frac{1}{4}$

NE $\frac{1}{4}$ SW $\frac{1}{4}$

SW $\frac{1}{4}$ SW $\frac{1}{4}$

Section 27

NE $\frac{1}{4}$

S $\frac{1}{2}$ NW $\frac{1}{4}$

E $\frac{1}{2}$ SW $\frac{1}{4}$

E $\frac{1}{2}$ SE $\frac{1}{4}$

Section 28

NW $\frac{1}{4}$ NE $\frac{1}{4}$

S $\frac{1}{2}$ NE $\frac{1}{4}$

NW $\frac{1}{4}$

N $\frac{1}{2}$ SE $\frac{1}{4}$

Section 29

SE $\frac{1}{4}$ NE $\frac{1}{4}$

N $\frac{1}{2}$ SW $\frac{1}{4}$

NE $\frac{1}{4}$ SE $\frac{1}{4}$

W $\frac{1}{2}$ SE $\frac{1}{4}$

Section 32

NW $\frac{1}{4}$

Section 33

N $\frac{1}{2}$

Section 34

Township 6 South, Range 6 West, W.M.

RECEIVED

JUL 25 1995

WATER RESOURCES DEPT.
SALEM, OREGON

N $\frac{1}{2}$ SW $\frac{1}{4}$
SW $\frac{1}{4}$ SW $\frac{1}{4}$
Section 5

NE $\frac{1}{4}$ NE $\frac{1}{4}$
W $\frac{1}{2}$ E $\frac{1}{2}$
E $\frac{1}{2}$ W $\frac{1}{2}$
Section 15

NW $\frac{1}{4}$
NE $\frac{1}{4}$ SW $\frac{1}{4}$
S $\frac{1}{2}$ SW $\frac{1}{4}$
SE $\frac{1}{4}$ SE $\frac{1}{4}$
Section 16

SE $\frac{1}{4}$ NE $\frac{1}{4}$
E $\frac{1}{2}$ SE $\frac{1}{4}$
Section 17

W $\frac{1}{2}$ SW $\frac{1}{4}$
SE $\frac{1}{4}$ SW $\frac{1}{4}$
Section 18

W $\frac{1}{2}$ NE $\frac{1}{4}$
SE $\frac{1}{4}$ NE $\frac{1}{4}$
N $\frac{1}{2}$ NW $\frac{1}{4}$
N $\frac{1}{2}$ SE $\frac{1}{4}$
Section 19

S $\frac{1}{2}$ N $\frac{1}{2}$
SW $\frac{1}{4}$
Section 20

W $\frac{1}{2}$ NW $\frac{1}{4}$
SE $\frac{1}{4}$ NW $\frac{1}{4}$
E $\frac{1}{2}$ SW $\frac{1}{4}$
SW $\frac{1}{4}$ SE $\frac{1}{4}$
Section 21

W $\frac{1}{2}$ NE $\frac{1}{4}$
SE $\frac{1}{4}$ NE $\frac{1}{4}$
E $\frac{1}{2}$ NW $\frac{1}{4}$
SE $\frac{1}{4}$

Section 22

E $\frac{1}{2}$
E $\frac{1}{2}$ NW $\frac{1}{4}$
SW $\frac{1}{4}$ NW $\frac{1}{4}$
NE $\frac{1}{4}$ SW $\frac{1}{4}$
SW $\frac{1}{4}$ SW $\frac{1}{4}$

Section 27

NE $\frac{1}{4}$
S $\frac{1}{2}$ NW $\frac{1}{4}$
E $\frac{1}{2}$ SW $\frac{1}{4}$
E $\frac{1}{2}$ SE $\frac{1}{4}$

Section 28

NW $\frac{1}{4}$ NE $\frac{1}{4}$
S $\frac{1}{2}$ NE $\frac{1}{4}$
NW $\frac{1}{4}$
N $\frac{1}{2}$ SE $\frac{1}{4}$

Section 29

SE $\frac{1}{4}$ NE $\frac{1}{4}$
N $\frac{1}{2}$ SW $\frac{1}{4}$
NE $\frac{1}{4}$ SE $\frac{1}{4}$
W $\frac{1}{2}$ SE $\frac{1}{4}$

Section 32

NW $\frac{1}{4}$
Section 33

N $\frac{1}{2}$
Section 34

Township 6 South, Range 6 West, W.M.

RECEIVED

JUN 12 1995

**WATER RESOURCES DEPT.
SALEM, OREGON**

N $\frac{1}{2}$ NW $\frac{1}{4}$
SE $\frac{1}{4}$ NW $\frac{1}{4}$
Section 2

W $\frac{1}{2}$ E $\frac{1}{2}$
E $\frac{1}{2}$ NW $\frac{1}{4}$
NE $\frac{1}{4}$ SW $\frac{1}{4}$
Section 4

N $\frac{1}{2}$ NW $\frac{1}{4}$
SE $\frac{1}{4}$ NW $\frac{1}{4}$
SW $\frac{1}{4}$
Section 5

NE $\frac{1}{4}$
S $\frac{1}{2}$ NW $\frac{1}{4}$
S $\frac{1}{2}$
Section 6

SW $\frac{1}{4}$ NE $\frac{1}{4}$
S $\frac{1}{2}$ NW $\frac{1}{4}$
SW $\frac{1}{4}$
S $\frac{1}{2}$ SE $\frac{1}{4}$
Section 7

SW $\frac{1}{4}$ NE $\frac{1}{4}$
N $\frac{1}{2}$ NW $\frac{1}{4}$
SE $\frac{1}{4}$ NW $\frac{1}{4}$
NE $\frac{1}{4}$ SW $\frac{1}{4}$
S $\frac{1}{2}$ SW $\frac{1}{4}$
SE $\frac{1}{4}$
Section 8

W $\frac{1}{2}$ NE $\frac{1}{4}$
S $\frac{1}{2}$ NW $\frac{1}{4}$
S $\frac{1}{2}$
Section 9

SW $\frac{1}{4}$ SW $\frac{1}{4}$
Section 10

N $\frac{1}{2}$ NE $\frac{1}{4}$
SW $\frac{1}{4}$ NE $\frac{1}{4}$
SE $\frac{1}{4}$ NW $\frac{1}{4}$
E $\frac{1}{2}$ SW $\frac{1}{4}$
Section 12

W $\frac{1}{2}$ NE $\frac{1}{4}$
SE $\frac{1}{4}$ NE $\frac{1}{4}$
NW $\frac{1}{4}$
N $\frac{1}{2}$ SW $\frac{1}{4}$
SE $\frac{1}{4}$ SW $\frac{1}{4}$
NE $\frac{1}{4}$ SE $\frac{1}{4}$
W $\frac{1}{2}$ SE $\frac{1}{4}$
Section 13

S $\frac{1}{2}$ N $\frac{1}{2}$
N $\frac{1}{2}$ NW $\frac{1}{4}$
N $\frac{1}{2}$ S $\frac{1}{2}$
SW $\frac{1}{4}$ SW $\frac{1}{4}$
Section 14

S $\frac{1}{2}$ N $\frac{1}{2}$
NW $\frac{1}{4}$ NW $\frac{1}{4}$
S $\frac{1}{2}$
Section 15

N $\frac{1}{2}$ N $\frac{1}{2}$
SE $\frac{1}{4}$ NE $\frac{1}{4}$
SW $\frac{1}{4}$ NW $\frac{1}{4}$
S $\frac{1}{2}$ SE $\frac{1}{4}$
Section 16

NE $\frac{1}{4}$
NW $\frac{1}{4}$ NW $\frac{1}{4}$
N $\frac{1}{2}$ SE $\frac{1}{4}$
SW $\frac{1}{4}$ SE $\frac{1}{4}$
Section 17

RECEIVED

JUN 12 1995

WATER RESOURCES DEPT.
SALEM, OREGON

W $\frac{1}{2}$ NW $\frac{1}{4}$
Section 18

NE $\frac{1}{4}$ NE $\frac{1}{4}$
S $\frac{1}{2}$ NE $\frac{1}{4}$
SE $\frac{1}{4}$
Section 21

NW $\frac{1}{4}$ NE $\frac{1}{4}$
W $\frac{1}{2}$ NW $\frac{1}{4}$
Section 22

S $\frac{1}{2}$ SE $\frac{1}{4}$
Section 26

Township 6 South, Range 7 West, W.M.

All
Section 1

NW $\frac{1}{4}$ NE $\frac{1}{4}$
S $\frac{1}{2}$ N $\frac{1}{2}$
NE $\frac{1}{4}$ SW $\frac{1}{4}$
N $\frac{1}{2}$ SE $\frac{1}{4}$
Section 2

S $\frac{1}{2}$ NE $\frac{1}{4}$
N $\frac{1}{2}$ NW $\frac{1}{4}$
SE $\frac{1}{4}$ NW $\frac{1}{4}$
Section 3

NE $\frac{1}{4}$ NE $\frac{1}{4}$
Section 4

S $\frac{1}{4}$
NW $\frac{1}{4}$ SW $\frac{1}{4}$
NE $\frac{1}{4}$ SE $\frac{1}{4}$
Section 10

S $\frac{1}{4}$
Section 11

E $\frac{1}{2}$
E $\frac{1}{2}$ W $\frac{1}{2}$
NW $\frac{1}{4}$ NW $\frac{1}{4}$
SW $\frac{1}{4}$ SW $\frac{1}{4}$
Section 12

N $\frac{1}{2}$
N $\frac{1}{2}$ S $\frac{1}{2}$
SW $\frac{1}{4}$ SW $\frac{1}{4}$
Section 13

NW $\frac{1}{4}$ NE $\frac{1}{4}$
S $\frac{1}{2}$ NE $\frac{1}{4}$
NW $\frac{1}{4}$ NW $\frac{1}{4}$
N $\frac{1}{2}$ SE $\frac{1}{4}$
SE $\frac{1}{4}$ SE $\frac{1}{4}$
Section 14

N $\frac{1}{2}$ NE $\frac{1}{4}$
Section 15

Township 6 South, Range 8 west, W.M.

RECEIVED

JUN 12 1995

**WATER RESOURCES DEPT.
SALEM, OREGON**

Application for Transfer of Water Right

To the STATE ENGINEER OF OREGON:

I, International Paper Company (A New York Corporation) Northwest Regional Office
(Name of applicant)

of P. O. Box 579, Longview, Washington, County of Cowlitz
(Postoffice) 98632

State of Washington, do hereby make application for change to a supplemental source
of supply for Grand Ronde Community Water Association from Rock Creek for quasi municipal
(In point of diversion; place of use; use heretofore made of the water) filing.

1. The source of present water right is Rock Creek
(Name of stream)
2. The use to which the water is applied is Mill pond sorting and logging activities
(Irrigation; Mining; Power; Manufacturing; etc.)
3. The name of the ditch, canal or pipe line is Mill pond International Paper at Grand Ronde.
4. The point of diversion is located N 43° 14' W 1044.0 feet to N. W. Corner
(N. or S.) (E. or W.)

corner of Section 13, T6S, R8W, Willamette Meridian being within the NW 1/4 of NW 1/4
(Section or subdivision)
of Section 13 Tp. 6S R. 8W W. M., in the County of Polk
(No. N. or S.) (No. E. or W.)

5. List the number of acres irrigated in each smallest legal subdivision (40-acre tract) involved in this transfer. If for any other use, indicate place of use.

Twp.	Range	Sec.	NE 1-4				NW 1-4				SW 1-4				SE 1-4			
			NE 1/4	NW 1/4	SW 1/4	SE 1/4	NE 1/4	NW 1/4	SW 1/4	SE 1/4	NE 1/4	NW 1/4	SW 1/4	SE 1/4	NE 1/4	NW 1/4	SW 1/4	SE 1/4
6S	8W	13							X									

NOTE: If you own less than 40-acre tracts, attach a description of your land as it appears in your deed.

(Attach separate sheet if necessary)

1.9 cfs
0.30 cfs - see Boatwright letter
of Jan 26, 1976

6. Are you the legal owner of the above described lands? Yes
(If not owner, explain your interest)

7. Has water been used beneficially for the purposes indicated herein during the past 5 years? Yes

8. What is the date of priority of your water right? September 22, 1943

9. Was your water right acquired by State Engineer's Permit? Yes If so, give number
(Yes or No)

of permit 15608

10. Do you hold a water right certificate? Yes If so, give number of certificate 15613
(Yes or No)

11. Was your water right determined by State Engineer's order of Determination or Decree of Court?

No If so, give title of proceedings
(Yes or No)

12. Is the water right recorded in your name? No, Polk Operating Co.
(If not, give name)

13. I propose to transfer the water right to the following described lands: (Do not answer if your application is for change in point of diversion only.)

Twp.	Range	Sec.	NE 1-4				NW 1-4				SW 1-4				SE 1-4			
			NE $\frac{1}{4}$	NW $\frac{1}{4}$	SW $\frac{1}{4}$	SE $\frac{1}{4}$	NE $\frac{1}{4}$	NW $\frac{1}{4}$	SW $\frac{1}{4}$	SE $\frac{1}{4}$	NE $\frac{1}{4}$	NW $\frac{1}{4}$	SW $\frac{1}{4}$	SE $\frac{1}{4}$	NE $\frac{1}{4}$	NW $\frac{1}{4}$	SW $\frac{1}{4}$	SE $\frac{1}{4}$

(Attach separate sheet if necessary)

NOTE: Answer questions 14, 15, 16 and 17, if the application is for change in point of diversion.

Supplemental source of supply to point of diversion shown below

14. The proposed point of diversion is located 591 ft. N and 32 ft. W from the SW corner of Section 34 being within the SE $\frac{1}{4}$ of SE $\frac{1}{4}$ of Section 33 Tp. 6S R. 8W W. M.,
(Smallest legal subdivision) (N. or S.) (E. or W.) (No. N. or S.) (No. E. or W.)
in the county of Polk The name of the ditch to be used is

15. Are you the owner of the land on which the proposed point of diversion is to be located? Yes

16. If not the owner of the land on which the proposed point of diversion is to be located, give the name and address of owner and submit evidence of your right-of-way for your proposed ditch, canal, or pipe line.

Land is owned by International Paper Co. which has granted an easement to the Grand Ronde Community Water Association for water development purposes.

17. Are there any diversions between your present point of diversion and the proposed point of diversion? Yes

NOTE: Answer questions 18 and 19 if application is for change in use or place of use.

18. Are the lands from which you propose to transfer your water right free of all encumbrances, including taxes, mortgages, liens, etc.? No
(Answer Yes or No)

19. If not, give below a description of existing encumbrances:

NATURE OF ENCUMBRANCE	HELD BY	AMOUNT

20. Reasons for the proposed changes are International Paper no longer intends to sort logs and haul from pond site by RR; as old growth is about logged out and 2nd growth is being taken out by log truck. Area needs area wide water system for both domestic, commercial and industrial needs. International Paper feels that this will assist the area and their present and future industrial and other water needs.

Grand Ronde Community Water Association

EXHIBIT "A"

Township	Range	Section	Acres
5S	8W	25, 29, 30, 32, 33, 34, 35 & 36	5,120
5S	7W	27, 28, 30, 31, 32, 33, 34, 35 & 36	5,760
5S	6W	W 1/2 Section 30, All of Section 31	960
6S	8W	All of Section 1, 2, 3, The northerly 3/4 of Sections 4 & 5, The N. E. of the N. E., the S.E. of the N.E. and the N. E. of the S. E. of Section 6 and all of Section 10, 11, 12, 13, 14, & 15.	6,840
6S	7W	1, 2, 3, 4, 5, 6, 7, 8, 9, 10, 11, 12, 13, 14, 15, 16, 17, 18, 21, 22, 23, 24, 26, 27, & 28	16,000
6S	6W	W 1/4 of Section 5 & 8, All of Sections 6, 7, 15, 16, 17, 18, 19, 20, 21, 22, 27, 28, 29, 32, 33, & 34	10,560

AFFIDAVIT OF APPLICANT

STATE OF ~~OREGON~~ WASHINGTON

County of

Cowlitz

} ss.

I, F. L. Patrick, the applicant herein, being first duly sworn, depose and say that I have read the above and foregoing application for transfer of water right; that I know the contents thereof and that the statements therein made are true and correct to the best of my knowledge and belief.

In Witness Whereof, I have hereunto set my hand this 21st day of January, 1977.

FL Patrick

(Name of applicant)

Subscribed and sworn to before me this 21st day of January, 1977.

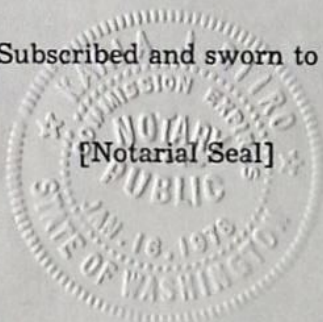

[Notarial Seal]

Karla J. Dineen
Notary Public in and for ~~the State of Washington~~
the State of Washington, residing at Longview
My commission expires 1-16-78

Remarks

THIS APPLICATION MUST BE ACCOMPANIED BY A MAP SHOWING THE LOCATION OF THE POINT OF DIVERSION, PLACE OF USE AND WORKS UTILIZED UNDER THE PRESENT WATER RIGHT. THE MAP SHOULD ALSO SHOW THE NEW POINT OF DIVERSION OR PLACE OF USE, AS THE CASE MAY BE.



T-3379

Grand Ronde Community Water Association 26690 Salmon River Highway Willamina, Oregon 97396			
PROOF SURVEY T-3379			
Scale 1" = 3000'	Date: May 16, 1995	Revised: May 24, 1995	
Design	Job No.		
Drawn JMB	Sheet		
Checked CFB	1 of 1		
Boatwright Engineering Inc. 2613 12th St. SE, SALEM, OREGON 97302 (503) 363-9225 FAX (503) 363-1051			



STATE OF OREGON

COUNTY OF POLK

CERTIFICATE OF WATER RIGHT

THIS CERTIFICATE ISSUED TO

GRAND RONDE COMMUNITY WATER ASSOCIATION
26690 SALMON RIVER HIGHWAY
WILLAMINA, OREGON 97396

confirms the right to use the waters of ROCK CREEK, a tributary of SOUTH YAMHILL RIVER, for QUASI-MUNICIPAL.

This right was perfected under Permit 15608. The date of priority is SEPTEMBER 22, 1943. The amount of water to which this right is entitled is limited to an amount actually beneficially used and shall not exceed 0.30 CUBIC FOOT PER SECOND, or its equivalent in case of rotation, measured at the point of diversion from the source.

The point of diversion is located as follows:

SE 1/4 SE 1/4, SECTION 32, T 6 S, R 8 W, W.M.; 530 FEET NORTH AND 165 FEET WEST OF THE SE CORNER OF SECTION 32.

The use shall conform to such reasonable rotation system as may be ordered by the proper state officer.

A description of the place of use to which this right is appurtenant is as follows:

WITHIN THE SERVICE AREA OF THE GRAND RONDE COMMUNITY WATER ASSOCIATION

<u>TOWNSHIP</u>	<u>RANGE</u>	<u>SECTIONS</u>
5 S	8 W	25, 29, 30, 32, 33, 34, 35, & 36
5 S	7 W	27, 28, 30, 31, 32, 33, 34, 35, & 36
5 S	6 W	31; W 1/2 OF SECTION 30
6 S	8 W	1, 2, 3, 10, 11, 12, 13, 14, & 15; NORTHERLY 3/4 OF SECTION 4; NORTHERLY 3/4 OF SECTION 5; NE 1/4 NE 1/4 OF SECTION 6; SE 1/4 NE 1/4 OF SECTION 6; NE 1/4 SE 1/4 OF SECTION 6
6 S	7 W	1, 2, 3, 4, 5, 6, 7, 8, 9, 10, 11, 12, 13, 14, 15, 16, 17, 18, 21, 22, 23, 24, 26, 27, & 28
6 S	6 W	6, 7, 15, 16, 17, 18, 19, 20, 21, 22, 27, 28, 29, 32, 33, 34; W 1/4 OF SECTION 5; W 1/4 OF SECTION 8

This certificate is issued to confirm a change in POINT OF DIVERSION approved by an order of the Water Resources Director entered APRIL 29, 1977, and supersedes Certificate 15613, State Record of Water Right Certificates.

The issuance of this superseding certificate does not confirm the status of the water right in regard to the provisions of ORS 540.610 pertaining to forfeiture or abandonment.

SEE NEXT PAGE

When required by the Department, the water user shall install an in-line flow meter or other suitable device for measuring and recording the quantity of water used. The type and plans of the measuring device must be approved by the Department prior to beginning construction and shall be installed under the general supervision of the Department.

The quantity of water diverted at the new point of diversion, shall not exceed the quantity of water available at the old point of diversion, and shall not exceed 0.30 CUBIC FOOT PER SECOND.

The right to the use of the water for the above purpose is restricted to beneficial use on the lands or place of use described.

WITNESS the signature of the Water Resources Director, affixed AUGUST 3, 1995.

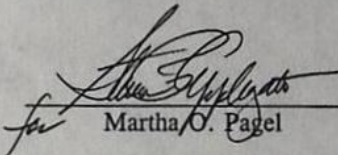
Martha O. Pagel

NOTICE OF WATER RIGHT TRANSFER
APPLICATION NO. 3379
FOR CHANGE IN USE AND
POINT OF DIVERSION

Notice is given hereby that International Paper Company has filed an application in the office of the Water Resources Director for the approval of a change in use and point of diversion from Rock Creek.

Certificate of water right recorded at Page 15613, Vol. 13, State Record of Water Right Certificates, in the name of The Long-Bell Company, describes an existing right of record for the use of water from Rock Creek for supplying a log pond in NW $\frac{1}{4}$ NW $\frac{1}{4}$ of Sec. 13, T. 6 S., R. 8 W., W.M., with a date of priority of Sept. 22, 1943.

Water for the said right is diverted from a point located S. 43 degrees 14 minutes E., 1044.0 ft. from the NW Corner of Sec. 13, being within the NW $\frac{1}{4}$ NW $\frac{1}{4}$ of Sec. 13, T. 6 S., R. 8 W., W.M.

The applicant herein, owner of the lands above described and the said water right appurtenant thereto, proposes to change, without loss of priority, the point of diversion and the use heretofore made of the water under said right in favor of quasi-municipal use within the service area of the Grand Ronde Community Water Association within T. 5 S., R. 6, 7 and 8 W., and T. 6 S., R. 6, 7 and 8 W., W.M., and to divert 0.30 c.f.s. at a point located 591 ft. N. and 32 ft. W. from the SW corner of Sec. 33, T. 6 S., R. 8 W., W.M., for said use.

All persons interested are notified hereby that a hearing will be held at the county courthouse at Dallas, Oregon, on April 12, 1977, at 9:30 a.m. All objections to the proposed change, if any there are, will be heard at said time and place. Any and all objections shall be prepared in writing, one copy to be served on International Paper Co., P.O. Box 579, Longview, Wash. 98632, and one copy filed with the Water Resource Department, Salem, Oregon 97310, together with a \$10 filing fee, at least 10 days prior to the date set for hearing. IF NO OBJECTION IS FILED, THE APPLICATION MAY BE APPROVED BY THE WATER RESOURCES DIRECTOR WITHOUT A HEARING. Administrative rules pertaining to the filing of a protest will be furnished by the Water Resources Department upon request.

Dated at Salem, Oregon, this 8th day of February, 1977.

JAMES E. SEXSON
Director

(Feb. 23, March 2, 9, 1977)

Affidavit Of Publication

STATE OF OREGON, } ss.
County of Polk

I, Joseph W. Blaha, being

first duly sworn, depose and say I am the PUBLISHER
of the Polk County Itemizer-Observer, a newspaper of general circulation
as defined by ORS 193.010 and 193.020, printed and published at Dallas in
the aforesaid county and state; that the Notice of Water Right
Transfer #3379

....., a printed copy of which is hereto annexed,
was published in the entire issue of said newspaper for
successive and consecutive weeks in the following issues:

Feb. 23, March 2, 9, 1977

Joseph W. Blaha
Subscribed and sworn to before me this 9 day of
March, 1977.

Jakuto A. Shier
Notary Public for Oregon.
(My Commission Expires 9/5/78)

RECEIVED
MAR 10 1977
WATER RESOURCES DEPT
SALEM, OREGON



INTERNATIONAL PAPER COMPANY

LONG-BELL DIVISION

BOX 579, LONGVIEW, WASHINGTON 98632, PHONE (206) 423-2110

March 23, 1976

Mr. Martin G. Boatwright
M. G. Boatwright & Associates
2613 Twelfth Street S. E.
Salem, OR 97302

Dear Mr. Boatwright:

Water Right Transfer
Permit No. R 783
dated September 22, 1943

Enclosed is executed Affidavit abandoning above water right interest of International Paper Company and attached Application for Transfer of Water Right to the Grand Ronde Community Water Association for water development purposes.

Very truly yours,

R. A. Green, Manager
Property and Taxes

RAG/kd
encs.

RECEIVED

OCT 28 1976

WATER RESOURCES DEPT.
SALEM, OREGON

STATE OF WASHINGTON)
) ss.
County of Cowlitz)

being first duly sworn, depose and say that International Paper Company
_____ is the owner of a water right and the land to
which it is appurtenant, which is for the storage of 59.0 acre feet of water
from Rock Creek in a reservoir constructed under permit No. R 783 for a log
pond, under a priority date of September 22, 1943, as evidenced by certificate
recorded at Page 15555, Volume 13, State Record of Water Right Certificates;
that International Paper Company has abandoned any and all interest
in and to said right and request same be canceled.

IN WITNESS WHEREOF, I have hereunto set my hand this 17th day
of February, 1976.

By

Subscribed and sworn to before me this 17th day of February, 1976.

Notary Public in and for the State of
Washington, residing at Longview.
My Commission Expires January 16, 1978

RECEIVED

OCT 28 1976

WATER RESOURCES DEPT.
SALEM, OREGON

3379

M. G. BOATWRIGHT & ASSOCIATES

2613 Twelfth Street S. E.
SALEM, OREGON 97302
January 26, 1976

Area Code (503) 363-9225

Water Resources Department
1158 Chemeketa St. N. E.
Salem, Oregon 97310

Attention: Mr. Trevor Jones

RE: WATER RIGHT TRANSFER, INTERNATIONAL PAPER TO GRAND RONDE COMMUNITY WATER ASSOCIATION.

Dear Mr. Jones:

Earlier I wrote you a letter, dated May 15, 1975, concerning the amount of consumptive water that could be justified through the utilization of the water right, certification number 15613, a non consumptive right by International Paper Company for log pond and steam boiler use. At that time I felt that 50 gpm was a reasonable consumptive demand for the operation; which I have found to be far to low after a complete investigation of the log pond construction and operational program at the site.

Aerial photographs taken during peak operational activities indicate that additional ponds were utilized as settling ponds and polishing ponds. A discussion of the operational procedure with Mr. Dick Doran of International Paper indicates that the bark and other floating debris was removed daily by surface flows to the adjoining settling ponds allowing for ready collection and disposal. A much larger pond surface area existed with these ponds than in the log pond only, greatly increasing the evaporation losses. The logs were dumped into the pond and sorted with hauling by railroad to mills elsewhere, resulting in a far larger amount of activity for splashage losses as the sheer number of logs handled through the log pond far exceeded that which would have been the case with a mill adjoining.

In conclusion, it is my opinion that the larger surface area for evaporation and the greater log dumptage and removal activities with the nature of construction of the pond would result in consumptive water demands in the nature of 120 to 150 gpm. This amount will be requested in the water right transfer we have discussed with you in the past.

RECEIVED

JAN 27 1976

WATER RESOURCES DEPT.
SALEM, OREGON

January 26, 1976

If you have any questions on this matter, please contact me at your earliest convenience.

Yours truly,

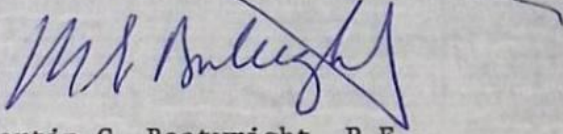
A handwritten signature in blue ink, appearing to read "M. G. Boatwright", with a long horizontal flourish extending to the right.

Martin G. Boatwright, P.E.

MGB/lb

cc: Grand Ronde Community Water Association
Mr. Marvin Weiser

June 12, 1995



Boatwright Engineering Inc.

2613 12th ST SE, SALEM, OREGON 97302
civil engineers • land surveyors

(503) 363-9225 (FAX) 363-1051

Don Knauer
Oregon Dept. of Water Resources
158 12th Street N.E.
Salem, Oregon

RECEIVED

JUN 13 1995

WATER RESOURCES DEPT.
SALEM, OREGON

Re: Grand Ronde Community Water Association
T-3379

Dear Don,

The Proof Survey report and map for the above described project was submitted to your office this afternoon. I would like to request a rush processing of the certificate for this permit due to the following circumstances:

- Grand Ronde would like to transfer a portion of this area to some areas outside of their permitted boundary, primarily up Willamina Creek Road, north of the town of Willamina. They would like to have the transfer approved this fall or early winter and need the certificate in order to make the application.
- As is common in much of Polk and southwest Yamhill Counties, there is limited and poor quality ground water available. A number of the residences on this four mile stretch of Willamina Creek Road have contaminated and/or low producing wells resulting in the population purchasing or hauling water. This includes reports of bucketing water from Willamina Creek for washing clothes and flushing toilets. This is a health and safety issue that Grand Ronde is willing to help remedy.
- Unfortunately, the proposed area to be served did not get included within the water rights boundary of any nearby entity. The City of Willamina, which has the sole municipally classified rights in the area, has only raw surface water available, as their treatment plant is closer into town. The City's responsibility is first to its citizen taxpayers. If water could be provided to Willamina Creek Road as a secondary benefit to a project for their own use, then the City might be willing to consider service. There is no point for the area to try and form into an independent association or district because it cannot acquire year around surface water rights in the Willamina Creek basin and, as stated above, the ground water is unacceptable.
- Grand Ronde currently has an approved loan from the USDA Rural Economic and Community Development. Financing from the federal government no longer pays directly to the contractors as the work progresses. The owner has to obtain

page 2
Don Knauer
T-3379

interim financing from a local bank and pay the contractors out of it. The fed pays off the interim financing when all construction is complete. The interest on the interim financing begins to accrue on the entire amount approved from the time the first monies are withdrawn. Grand Ronde has several different projects planned under this loan. Contracts for the construction of two reservoirs have already been awarded and construction is set to begin soon. Also included in the loan program are funds for the construction of the Willamina Creek Road waterline extension. Grand Ronde would like to be able to build this waterline extension this fall in order to minimize the time frame of their \$300,000 private loan and its accruing interest.

- I and several representatives from Grand Ronde met with Reed Marbet, Steve Brown and Michael Mattick last year. After discussing a few scenarios and possibilities, it was recommended that we proof this permit and then transfer the needed area of use.

Thank you for your immediate attention to this matter. If I can be of any assistance to you, please do not hesitate to give me a call.

Sincerely,

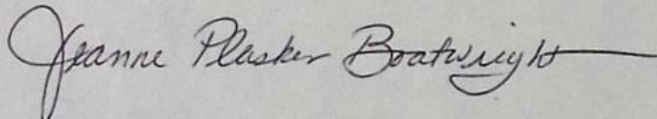

Jeannne Plasker Boatwright

CC: Karl Ekstrom, manager, Grand Ronde Community Water Association
Larry Nunn

RECEIVED

JUN 13 1995

WATER RESOURCES DEPT.
SALEM, OREGON

STATE OF OREGON
COUNTY OF POLK
CERTIFICATE OF WATER RIGHT

This Is to Certify, That **THE LONG-BELL LUMBER COMPANY**

of **Grande Ronde**, State of **Oregon**, has made proof
to the satisfaction of the STATE ENGINEER of Oregon, of a right to the use of the waters of
Rock Creek
a tributary of **South Yamhill River** for the purpose of
supplying log pond described in Application No. R-20040, Permit No. R-783,
under Permit No. **15608** of the State Engineer, and that said right to the use of said waters
has been perfected in accordance with the laws of Oregon; that the priority of the right hereby
confirmed dates from **September 22, 1943**

that the amount of water to which such right is entitled and hereby confirmed, for the purposes
aforesaid, is limited to an amount actually beneficially used for said purposes, and shall not exceed
1.9 cubic feet per second

or its equivalent in case of rotation, measured at the point of diversion from the stream.
The point of diversion is located in the **NW $\frac{1}{4}$ NW $\frac{1}{4}$, Section 13, Township 6 South, Range 8 West,**
W. M.

The amount of water used for irrigation, together with the amount secured under any other
right existing for the same lands, shall be limited to **- - - -** of one cubic foot per second
per acre,

and shall
conform to such reasonable rotation system as may be ordered by the proper state officer.

A description of the place of use under the right hereby confirmed, and to which such right is
appurtenant, is as follows:

**SW $\frac{1}{4}$ NW $\frac{1}{4}$,
Section 13,
T. 6 S., R. 8 W., W. M.**

The right to the use of the water for the purposes aforesaid is restricted to the lands or place of
use herein described.

WITNESS the signature of the State Engineer, affixed

this **1st** day of **March**, 194**9**.

CHAS. E. STRICKLIN

State Engineer

Recorded in State Record of Water Right Certificates, Volume **13**, page **15613**

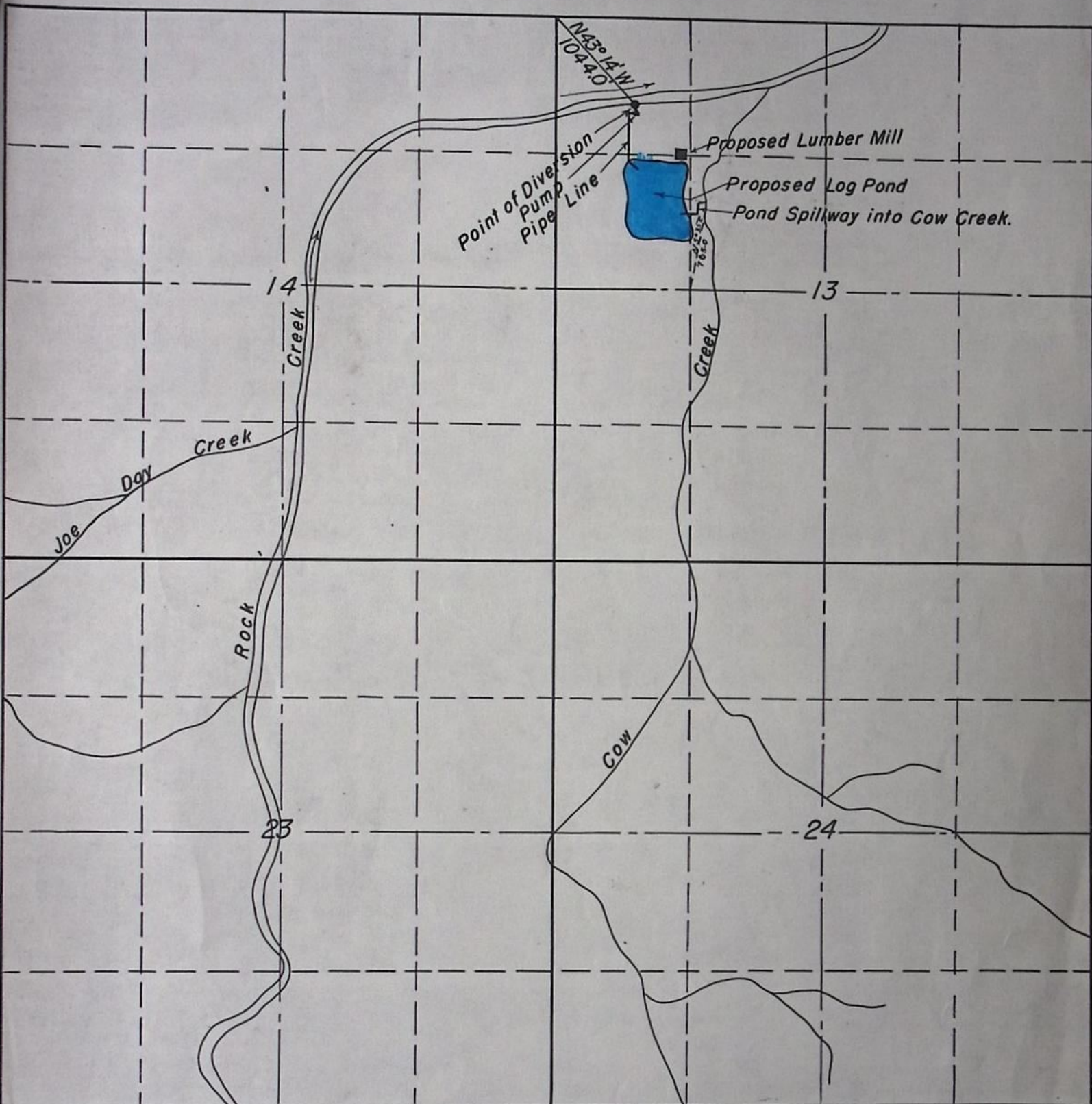

The Polk Operating Company
 Map Showing
 Location of Point of Diversion of Water
 For Proposed Log Pond
 Situated in Section 13 T.6 S., R.8 W. W.M.
 Polk County Oregon
 Scale 4" = 1 Mile
 Sept. 7, 1943

20041 OK
 2-90I

Application No. 20041
 Permit No. 15608

APPLICATION FOR EXTENSION OF TIME
FOR TRANSFER OF WATER RIGHT

Transfer 3379
RECEIVED

JAN -7 1988

To the WATER RESOURCES DIRECTOR OF OREGON:

I, Grand Ronde Domestic Water Association
(Name of Applicant)

WATER RESOURCES DEPT.
SALEM, OREGON

of P.O. Box 183, Grand Ronde,
(Mailing Address) (City)

State of Oregon, 97347, 879-5624,
(Zip Code) (Phone Number)

do hereby make application for an extension of time within which to complete a change in:

(x) point of diversion () place of use (x) use heretofore made

of water under the terms of an order of the Water Resources Director entered
on April 29, 19 77, approving Transfer 3379, in the name
of International Paper Co.,
for Grand Ronde Domestic Water Association as described in permits
41436 & 41437

(give location of your property, as shown on the order approving the transfer)

THE FOLLOWING HAS BEEN accomplished toward completion of the change within the time
allowed, which expired on October 1, 19 87 :

Reference permits 41436 & 42437 - Additional users have been added and
improvements made to serve some 90 new service hookups, including inline
storage of 105,000 gallons.

(if for irrigation, how many acres, total, are now irrigated)

TO FULLY COMPLETE the change, it will be necessary to accomplish the
following: The transfer's interest is to cover the commercial-industrial
users on the system. Additional hookups are anticipated throughout
the system for quasi-municipal purposes.

I AM UNABLE TO COMPLETE the change under the terms of the order, within the time allowed,
because commercial and industrial uses cannot be predicted for location
or amount of service within this type of water system. The time limit
for completion of the permits 41436 & 41437 is also 10/1/92 and request that the
time for completion be extended to October 1, 19 92 .

(signature of applicant)

Boatwright Engineering, Inc.
Project Engineer

MAIL COMPLETED APPLICATION AND FEE IN THE AMOUNT OF \$100 TO:

Water Resources Department
3850 Portland Road NE
Salem, OR 97310

Form 690-4B-0 11-82
3379B

1-7-88
\$100.00
54279

OK to
10-1-92
BCE

APPLICATION FOR EXTENSION OF TIME
FOR TRANSFER OF WATER RIGHT

To the WATER RESOURCES DIRECTOR OF OREGON:

I, Grand Ronde Community Water Association
(Name of Applicant)
of P.O. Box 253, Grand Ronde,
(Mailing Address) (City)
State of Oregon, 97347, 879-5624,
(Zip Code) (Phone Number)

do hereby make application for an extension of time within which to complete a change in:

☒ point of diversion ☐ place of use ☒ use heretofore made
of water under the terms of an order of the Water Resources Director entered
on April 29, 19 77, approving Transfer 3379, in the name
of International Paper Co.,
for Grand Ronde Community Water Association as described in
Permits 41436 & 41437

(give location of your property, as shown on the order approving the transfer)

THE FOLLOWING HAS BEEN accomplished toward completion of the change within the time
allowed, which expired on October 1, 19 92 :

Reference Permits 41436 & 41437 - Additional services have been added and
improvements made to serve 57 new hookups since 1987. Installed a booster
pump to serve 10 households, extensive repair, maintenance & const. @ spring.

(if for irrigation, how many acres, total, are now irrigated)

TO FULLY COMPLETE the change, it will be necessary to accomplish the
following: The transfer's interest is to cover the commercial-industrial
users on the system. Additional hookups are anticipated throughout
the system for quasi-municipal purposes.

I AM UNABLE TO COMPLETE the change under the terms of the order, within the time allowed,
because Commercial and industrial uses cannot be predicted for location or
amount of service within this type of water system. Time extensions to
1997 have also been filed for Permits 41436 & 41437. and request that the
time for completion be extended to October 1, 19 97.

(signature of applicant)

for Boatwright Engineering, Inc. - Engineers for Assoc.

MAIL COMPLETED APPLICATION AND FEE IN THE AMOUNT OF \$100 TO:

RECEIVED

NOV 16 1992

WATER RESOURCES DEPT.
SALEM, OREGONWater Resources Department
3850 Portland Road NE
Salem, OR 9731011/16/92
100.00
94146

RECEIVED

Transfer 3379

APPLICATION FOR EXTENSION OF TIME
FOR TRANSFER OF WATER RIGHT

MAY 3 1984
WATER RESOURCES DEPT

SALEM, OREGON SOURCES DIRECTOR OF OREGON:

I, Grande Ronde Domestic Water Assoc
(Name of Applicant)
of Boatwright Engineering, 2613 12th St Salem
(Mailing Address) (City)
State of Ore, 97302, 3639225
(Zip Code) (Phone Number)

do hereby make application for an extension of time within which to complete a change in:

☒ point of diversion ☐ place of use ☒ use heretofore made
of water under the terms of an order of the Water Resources Director entered
on Apr 29, 1977, approving Transfer 3379, in the name
of International Paper Co
for _____

(give location of your property, as shown on the order approving the transfer)

THE FOLLOWING HAS BEEN accomplished toward completion of the change within the time
allowed, which expired on October 1, 1983: The use of water is through
the same systems as described in Permits 41436 & 41437 and it
is basically completed. The intent of the transfer was to insure
against a curtailment of use for commercial-industrial use under
(if for irrigation, how many acres, total, are now irrigated) Permit 41437

TO FULLY COMPLETE the change, it will be necessary to accomplish the
following: We anticipate additional hook ups to the system
for quasi-municipal purposes which will require the
0.30 cfs provided by the transfer but cannot specify
when & where these may be within the system.

I AM UNABLE TO COMPLETE the change under the terms of the order, within the time allowed,
because The time limits for completion under permits
41436 & 41437 is Oct 1 1987 & we request the same
date for this transfer. and request that the
time for completion be extended to October 1, 1987.

M S Boatwright (Project Engineer)
(signature of applicant)

MAIL COMPLETED APPLICATION AND FEE IN THE AMOUNT OF \$100 TO:

WATER RESOURCES DEPARTMENT
Mill Creek Office Park
555 13th Street, NE
Salem, Oregon 97310

Ext to 10/1/87

SRB

56/6

5-3-84
\$100 ⁰⁰²
42324

Application for Extension of Time for Transfer of Water Right

To the WATER RESOURCES DIRECTOR OF OREGON:

I, Grand Ronde Domestic Water Association
(Name of applicant)
of P.O. Box 183, Grand Ronde
(Mailing address) (City)
State of Oregon, 97347, 877-5624
(Zip Code) (Phone number)

do hereby make application for an extension of time within which to complete
a change in: ☒ point of diversion
☐ place of use
☒ use heretofore made of water

under the terms of an order of the Water Resources Director entered on
April 29, 1977, 19 , approving transfer application No. T-3379
in the name of International Paper *.

The following has been accomplished toward completion of the
change within the time allowed, which expired on Oct. 1, 1980:
this transfer has been used to cover commercial & industrial
uses on the system (Now serving some 750 ± acres)
Industrial & commercial use is estimated to be 20 gpm
on a continuous basis at this time (30 to 40 users)
(If for irrigation, how many acres, total, are now irrigated)

*If you are not the applicant named above, please explain your interest in
this matter. Engineer for Grand Ronde Domestic Water
Association which has purchased the water
right from International Paper

Ext to 10-1-83 Receipt # 21524 handed to Boatwright
SRA 11-17-80

To fully complete the change, it will be necessary to accomplish the following: Meet the water needs of the commercial & industrial users (all but domestic needs) of a system that has increased from 240 to 350 services in the last 4 years

I am unable to complete the change under the terms of the order, within the time allowed, because Industrial & Commercial demands are controlled by Sewer Service, now under study!

and request that the time for completion be extended to Oct 1, 1983.

AFFIDAVIT OF APPLICANT

I, MARTIN BEATWRIGHT, being first duly sworn, depose and say that I have read the above and foregoing application for extension of time; that I know the contents thereof, and the facts stated therein are true.

IN WITNESS WHEREOF, I have hereunto set my hand this 17 day of November

1980

M. A. Beatwright

Subscribed and sworn to before me this _____ day of _____, 19_____

[Notarial Seal]

Notary Public for Oregon

My commission expires _____

MAIL COMPLETED APPLICATION AND FEE IN THE AMOUNT OF \$ 10.00

TO:

Water Resources Department
MILL CREEK OFFICE PARK
555 13th STREET N.E.
SALEM, OREGON 97310

gallons

Jan
Feb
Mar
Apr
May
June
July
Aug
Sept
Oct
Nov
Dec

1991

573,500
473,010
432,760
444,140
438,600
503,030
742,230
981,130
863,360
673,620
456,600
403,260

6,985,400

1992

419,320
425,870
491,730
473,120
581,200
954,200
964,720
921,120
672,550
519,500
513,540
465,110

7,401,980

1993

617,490
493,100
414,200
501,900
465,170
517,750
626,700
748,780
794,420
671,472
545,900
506,830

6,903,712

J.R.

Jan
Feb
Mar
Apr
May
June
July
Aug
Sept
Oct
Nov
Dec

1991

6,369,460
5,001,150
4,088,750
4,470,610
3,833,690
4,337,690
5,703,190
7,913,060
6,571,835
5,692,360
4,659,540
3,533,870

57,544,205

1992

4,266,590
3,967,160
4,313,940
4,278,980
4,456,710
7,620,740
5,353,800
6,560,500
6,494,560
3,984,130
4,216,210
3,807,390

59,320,710

1993

5,156,830
4,516,300
3,614,930
4,390,170
4,074,990
4,313,020
5,354,400
5,549,780
5,974,090 *
4,792,335
4,377,310
3,976,815

55,086,970

* add 895,000 gal
and
to Buell Red
Prairie

55,981,970 gal
Total

62,885,682 gal

RECEIVED

JUN 13 1995

PREPARED BY	INITIALS	DATE	REFERENCE
CHECKED BY			
APPROVED BY			

85-103

water service fee LITHO IN U.S.A.

(1)

(2)

(3)

1993

WATER RESOURCES DEPT.
SALEM, OREGON

1994

LINE
No.

Jan	617,490 gal	2,114.30	563,110 gal	2,684.65
Feb	493,100 "	2,032.45	529,300 "	2,633.95
Mar	414,200 "	1,919.15	481,000 "	2,544.00
Apr	501,900 "	2,038.55	561,390 "	2,664.59
May	465,170 "	2,002.05	541,000 gal	2,642.25
June	517,750 "	2,091.00	638,880 gal	2,798.32
July	626,700 "	2,725.05	928,468 "	3,232.70
Aug	748,280 "	2,893.17	1,473,300 "	3,474.95
Sept	794,420 "	2,996.63	901,360 "	3,217.04
Oct	621,472 "	2,847.20	715,106 "	2,937.66
Nov	545,900 "	2,658.85	534,100	2,666.15
Dec	506,830 "	2,600.25	603,000 gal	2,769.50
13	6,903,712 gal	\$28,923.65	8,068,996 gal	\$34,266.26

1993

1994

Jan	5,156,830 gal	\$8,726.55	4,181,710 gal	11,822.61
Feb	4,516,300 "	8,276.00	3,890,120 gal	11,385.18
Mar	3,614,930 "	7,550.70	3,636,900 gal	11,005.35
Apr	4,390,170 "	8,123.80	4,143,600 gal	11,765.40
May	4,074,990 "	7,925.10	3,849,930 gal	11,236.80
June	4,313,020 "	8,360.20	4,109,070 gal	12,175.60
July	5,354,400 "	13,571.60	6,160,780 gal	14,813.17
Aug	5,549,780 "	13,874.67	6,376,100 gal	15,127.55
Sept	5,970,090 "	14,498.38	4,977,760 "	13,008.18
Oct	4,722,335 "	12,748.49	3,960,020 "	11,531.23
Nov	4,377,310 "	12,125.51	3,497,850 "	10,789.78
Dec	3,976,815 "	11,515.87	4,106,300 gal	11,731.45

32	55,086,970 gal	\$127,296.87	53,183,870 gal	146,487.30
----	----------------	--------------	----------------	------------

34	+ 895,000 "	+ 6,085.00		
----	-------------	------------	--	--

36	55,981,970 gal	\$133,381.87		
----	----------------	--------------	--	--

* water rock
(P.P.P.)

RECEIVED

PREPARED BY	INITIALS	DATE	REFERENCE
CHECKED BY			
APPROVED BY			

82-103

Water service fee LITHO IN U.S.A.

JUN 13 1995

1993

WATER RESOURCES DEPT.
SALEM, OREGON

1994

LINE No.		(1)	(2)	(3)
1	Jan 617,490 gal	2,114.30	563,110 gal	2,684.65
2	Feb 493,100 "	2,032.45	529,300 "	2,633.95
3	Mar 414,200 "	1,919.15	481,000 "	2,544.00
4	Apr 501,900 "	2,032.55	561,390 "	2,664.59
5	May 465,170 "	2,002.05	541,000 gal	2,642.25
6	June 517,750 "	2,091.00	638,880 gal	2,798.32
7	July 626,700 "	2,725.05	928,468 "	3,232.70
8	Aug 748,280 "	2,893.17	1,473,300 "	3,474.95
9	Sept 794,420 "	2,996.63	901,360 "	2,217.04
10	Oct 621,472 "	2,847.20	715,106 "	2,937.66
11	Nov 545,900 "	2,658.85	534,100 "	2,666.15
12	Dec 526,830 "	2,600.25	603,000 gal	2,769.50
13	6,903,712 gal	\$28,923.65	8,048,996 gal	\$34,266.26

1993

1994

14				
15				
16				
17				
18				
19	Jan 5,156,830 gal	\$8,726.55	4,181,740 gal	\$11,822.61
20	Feb 4,516,300 "	8,276.00	3,880,170 gal	11,385.18
21	Mar 3,614,930 "	7,550.70	2,636,900 gal	11,005.35
22	Apr 4,390,170 "	8,123.80	4,143,600 gal	11,765.40
23	May 4,074,990 "	7,925.10	3,819,930 gal	11,236.80
24	June 4,313,020 "	8,360.20	4,109,070 gal	12,175.60
25	July 5,354,400 "	13,521.60	6,160,280 gal	14,813.17
26	Aug 5,549,780 "	13,874.67	6,376,100 gal	15,122.56
27	Sept * 5,970,090 "	14,498.38	4,977,760 "	13,008.18
28	Oct 4,792,335 "	12,748.49	3,960,020 "	11,531.23
29	Nov 4,322,310 "	12,125.51	3,491,850 "	10,789.78
30	Dec 3,976,815 "	11,515.87	4,106,300 gal	11,731.45
31				
32	55,086,970 gal	\$127,296.87	53,183,870 gal	146,487.30
33				
34	+ 895,000 "	+ 6,085.00		
35				
36	55,981,970 gal	\$133,381.87		
37				
38				
39				
40	* water sold			



BEFORE THE WATER RESOURCES DIRECTOR OF OREGON

Polk County

IN THE MATTER OF THE APPLICATION
OF INTERNATIONAL PAPER COMPANY
FOR APPROVAL OF A CHANGE IN POINT
OF DIVERSION AND USE OF WATER FROM
ROCK CREEK

ORDER APPROVING
TRANSFER NO. 3379

On March 25, 1976, International Paper Company filed an application in the office of the Water Resources Director for the approval of a change in use and point of diversion from Rock Creek under an existing water right of record, pursuant to the provisions of ORS 540.510 to 540.530.

Certificate of water right recorded at Page 15613, Volume 13, State Record of Water Right Certificates, in the name of The Long-Bell Company, describes an existing right of record for the use of water from Rock Creek for supplying a log pond in NW $\frac{1}{4}$ NW $\frac{1}{4}$ of Section 13, Township 6 South, Range 8 West, W.M., with a date of priority of September 22, 1943.

Water for the said right is diverted from a point located South 43 Degrees 14 Minutes East, 1044.0 feet from the Northwest corner of Section 13, being within the NW $\frac{1}{4}$ NW $\frac{1}{4}$ of Section 13, Township 6 South, Range 8 West, W.M.

The applicant herein, owner of the lands above described, and the said water right appurtenant thereto, proposes to change, without loss of priority, the point of diversion and the use heretofore made of the water under said right in favor of quasi-municipal use within the service area of the Grand Ronde Community Water Association, listed as follows:

Township	Range	Section
5S	8W	25, 29, 30, 32, 33, 34, 35 & 36
5S	7W	27, 28, 30, 31, 32, 33, 34, 35 & 36
5S	6W	W $\frac{1}{2}$ Section 30, All of Section 31

Township	Range	Section
6S	8W	All of Section 1, 3, 2, the Northerly 3/4 of Sections 4 & 5, the NE of the NE, the SE of the NE and the NE of the SE of Section 6 and all of Section 10, 11, 12, 13, 14 & 15.
6S	7W	1, 2, 3, 4, 5, 6, 7, 8, 9, 10, 11, 12, 13, 14, 15, 16, 17, 18, 21, 22, 23, 24, 26, 27 & 28
6S	6W	W $\frac{1}{2}$ of Section 5 & 8, all of Sections 6, 7, 15, 16, 17, 18, 19, 20, 21, 22, 27, 28, 29, 32, 33, and 34.

and to divert 0.30 cubic foot per second at a point located 591 feet North and 32 feet West from the Southwest corner of Section 33, Township 6 South, Range 8 West, W.M., for said use.

Data submitted in support of the subject application establishes that 0.30 cubic foot per second was the extent of use made under the subject right for the past many years.

Notice of the application, pursuant to ORS 540.510 was published in the Itemizer-Observer, a newspaper printed and having general circulation in Polk County, Oregon, for a period of three weeks in the issues of February 23 and March 2 and 9, 1977.

Mr. Benjamin E. Monroe, Watermaster, has filed a statement to the effect that the proposed changes in point of diversion and use heretofore made may be made without injury to existing rights.

No objection having been filed and it appearing that the proposed changes in point of diversion and use heretofore made may be made without injury to existing rights, the application should be approved.

NOW, THEREFORE, it hereby is ORDERED that the requested changes in point of diversion and use heretofore made described herein, without loss of priority, is approved.

It is FURTHER ORDERED that the quantity of water diverted at the new point of diversion shall not exceed the quantity of water available at the old point of diversion under the subject right, and shall not exceed 0.30 cubic foot per second.

It is FURTHER ORDERED that the following provisions shall be effective when in the judgement of the watermaster it becomes necessary to install head-gates and measuring devices:

That the diversion works shall include an in line flow meter, a weir, or other suitable device for measuring the water to which the applicant is entitled;

That the type and plans of the measuring device be approved by the watermaster before the beginning of construction work and that the weir or measuring device be installed under the general supervision of said watermaster.

It is FURTHER ORDERED that the construction work shall be completed and the change in point of diversion of water made and said water so transferred shall be applied to beneficial use on or before October 1, 1980.

It is FURTHER ORDERED that the certificate of water right heretofore issued to Long-Bell Lumber Company and recorded at Page 15613, Volume 13, State Record of Water Right Certificates, is canceled, and upon proof satisfactory to the Water Resources Director of completion of works and beneficial use of water to the extent intended under the provisions of this order, a confirming certificate of water right shall be issued to the applicant herein.

Dated at Salem, Oregon, this 29th day of April, 1977.

/s/ JAMES E. SEXSON
Director



STATE OF OREGON

INTEROFFICE MEMO

TO: Mr. Jim Carver

DATE: 4-25-77

FROM: Ben Monroe

SUBJECT: T-3379 International Paper Co.

After examining the application T-3379, I find no reason why it should not be allowed; with the understanding that they would be limited to the amount available at the original point of diversion.

I also feel that provision No. 2 should be written into the order.

Ben Monroe

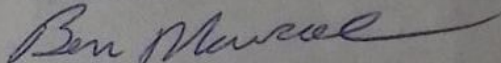

Watermaster Dist. 18