

RA

Permit Amendment

T-14146

Name City of Florence
Attn: Mike Miller
 Address 250 Hwy 101
Florence, OR 97439
mike.miller@ci.florence.or.us

DESCRIPTION OF WATER RIGHT(S)

Name of Stream A Well
 Trib. of Munsell Creek Basin

Use Municipal Uses County Lane
 Quantity of water (CFS) _____ No. of Acres _____
 Name of ditch _____

App#	Per #	Cert #	PR Date
<u>G-15295</u>	<u>G-112885</u>	<u>---</u>	<u>2/5/2001</u>
App#	Per #	Cert #	PR Date
App#	Per #	Cert #	PR Date
App#	Per #	Cert #	PR Date
App#	Per #	Cert #	PR Date

Change in APOA
 Date Filed 1-13-2023
 Initial notice date 1-24-2023
 DPD issued date _____
 PD issued date _____
 PD notice date _____
 Date of FO 1/28/2025 Vol 133 Page 786-788

C-Date _____
 COBU due date _____
 COBU Received date _____
 Certificate issued _____

Assignments: _____

Irrigation District _____

Agent GSI Water Solutions, Inc. - zpikeurlacher@gsiws.com

CWRE _____

CC's list City of Florence

☐ - Oversized map - Location _____

FEES PAID

Date	Amount	Receipt #
<u>1-13-2023</u>	<u>\$1,840.00</u>	<u>139921</u>
<u>10-30-2023</u>	<u>\$125.00</u>	<u>141821</u>
<u>9-16-2024</u>	<u>\$70.06</u>	<u>143832</u>

FEES REFUNDED

Date	Amount	Receipt #

STATE OF OREGON
WATER RESOURCES DEPARTMENT

725 Summer St. N.E. Ste. A
SALEM, OR 97301-4172

(503) 986-0900 / (503) 986-0904 (fax)

RECEIPT # 143832

INVOICE #

RECEIVED FROM: City of Florence
BY:

APPLICATION
PERMIT
TRANSFER T-14146

CASH: ☐ CHECK: # 22240 OTHER: (IDENTIFY) ☐

TOTAL REC'D \$70.06

1083 TREASURY 4170 WRD MISC CASH ACCT

0407 COPIES 46118 \$
0207 OTHER: (IDENTIFY) Newspaper Notice \$70.06
0243 I/S Lease 0244 Muni Water Mgmt. Plan 0245 Cons. Water

4270 WRD OPERATING ACCT

MISCELLANEOUS

0407 COPY & TAPE FEES \$
0410 RESEARCH FEES \$
0408 MISC REVENUE: (IDENTIFY) \$
TC162 DEPOSIT LIAB. (IDENTIFY) \$
0240 EXTENSION OF TIME \$

WATER RIGHTS:

0201 SURFACE WATER EXAM FEE 0202 RECORD FEE \$
0203 GROUND WATER EXAM FEE 0204 RECORD FEE \$

WELL CONSTRUCTION

0218 WELL DRILL CONSTRUCTOR EXAM FEE 0219 LICENSE FEE \$
LANDOWNER'S PERMIT 0220 LICENSE FEE \$

OTHER (IDENTIFY)

0536 TREASURY 0437 WELL CONST. START FEE

0211 WELL CONST START FEE \$ CARD#
0210 MONITORING WELLS \$ CARD#

OTHER (IDENTIFY)

0607 TREASURY 0467 HYDRO ACTIVITY LIC NUMBER

0233 POWER LICENSE FEE (FW/WRD) \$
0231 HYDRO LICENSE FEE (FW/WRD) \$
HYDRO APPLICATION \$

TREASURY OTHER / RDX

FUND TITLE

OBJ. CODE VENDOR #

DESCRIPTION \$

RECEIPT: 143832

DATED: 9-16-24

BY:

Distribution - White Copy - Customer, Yellow Copy - Fiscal, Blue Copy - File, Buff Copy - Fiscal

CITY OF FLORENCE

VENDOR: 000927 OREGON WATER RESOURCES DEPT

DATE	INVOICE #	DESCRIPTION
9/11/2024	T-14146	14146 well 14 permit notice

STATE OF OREGON
WATER RESOURCES DEPARTMENT

725 Summer St. N.E. Ste. A
SALEM, OR 97301-4172

(503) 986-0900 / (503) 986-0904 (fax)

RECEIPT # 143832

INVOICE #

RECEIVED FROM: City of Florence
BY:

APPLICATION
PERMIT
TRANSFER T-14146

CASH: ☐ CHECK: # 22240 OTHER: (IDENTIFY) ☐

TOTAL REC'D \$70.06

1083 TREASURY 4170 WRD MISC CASH ACCT

0407 COPIES 46118 \$
0207 OTHER: (IDENTIFY) Newspaper Notice \$70.06
0243 I/S Lease 0244 Muni Water Mgmt. Plan 0245 Cons. Water

4270 WRD OPERATING ACCT

MISCELLANEOUS

0407 COPY & TAPE FEES \$
0410 RESEARCH FEES \$
0408 MISC REVENUE: (IDENTIFY) \$
TC162 DEPOSIT LIAB. (IDENTIFY) \$
0240 EXTENSION OF TIME \$

WATER RIGHTS:

0201 SURFACE WATER EXAM FEE 0202 RECORD FEE \$
0203 GROUND WATER EXAM FEE 0204 RECORD FEE \$

WELL CONSTRUCTION

0218 WELL DRILL CONSTRUCTOR EXAM FEE 0219 LICENSE FEE \$
LANDOWNER'S PERMIT 0220 LICENSE FEE \$

OTHER (IDENTIFY)

0536 TREASURY 0437 WELL CONST. START FEE

0211 WELL CONST START FEE \$ CARD#
0210 MONITORING WELLS \$ CARD#

OTHER (IDENTIFY)

0607 TREASURY 0467 HYDRO ACTIVITY LIC NUMBER

0233 POWER LICENSE FEE (FW/WRD) \$
0231 HYDRO LICENSE FEE (FW/WRD) \$
HYDRO APPLICATION \$

TREASURY OTHER / RDX

FUND TITLE

OBJ. CODE VENDOR #

DESCRIPTION \$

RECEIPT: 143832

DATED: 9-16-24

BY:

Distribution - White Copy - Customer, Yellow Copy - Fiscal, Blue Copy - File, Buff Copy - Fiscal

Received
SEP 16 2024

OWRD

CHECK TOTAL

70.06

**AFFIDAVIT
OF
PUBLICATION**

Received
FEB 10 2025
OWRD

COUNTY OF LANE
STATE OF OREGON SS.

I, Amanda Boulware, being first duly sworn, depose and say that I am a Clerk of The Siuslaw News, a newspaper of general circulation, as defined by sections ORS 193.010 and 193.020, printed and published in the aforesaid county and state; that the

Oregon Water Resources Dept
Legal Notice T-14146
SLN24-3030

Was published 2 (two) successive and consecutive week(s) in the following issues:

September 25th, 2024
October 2nd, 2024

Amanda Boulware

Subscribed and sworn before me
this

3rd day of February 2025

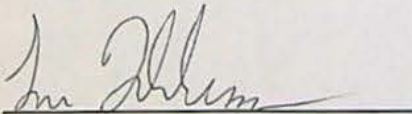

999
PUBLIC NOTICES
SLN24-3030
Notice of Permit
Amendment T-14146.
T-14146 filed by City
of Florence, Attn Mike

999
PUBLIC NOTICES
Miller, 250 Hwy 101
Florence, OR 97439,
proposes an additional
point of appropriation
change under Permit
G-16885. The permit
allows the use of 0.6
cubic feet per second
from Wells 8, 9, 10, 11,
12, and 13 in Sec. 23,
T18S, R12W, W.M. for
Municipal Use within
the City of Florence
Service Area. The appli-
cant proposes to add
an additional point of
appropriation in Sect.
23, T18S, R12W, W.M.
The Water Resources
Department has con-
cluded that the pro-
posed permit amend-
ment appears to be
consistent with the
requirements of ORS
537.211. The last date
of newspaper publica-
tion is 10/02/2024.

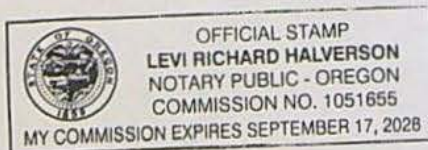



Oregon

Tina Kotek, Governor

Water Resources Department

North Mall Office Building

725 Summer St NE, Suite A

Salem, OR 97301

Phone 503 986-0900

Fax 503 986-0904

January 28, 2025

City Of Florence
Attn Mike Miller
250 HWY 101
Florence, OR 97439

REFERENCE: Permit Amendment Application T-14146

Enclosed is a copy of the order approving your Permit Amendment application.

Also enclosed is a superseding permit that incorporates the amendments approved by the final order contained herein. Please read this document and abide by the requirements.

If you have any questions related to the approval of this permit amendment, you may contact your caseworker, Arla Davis, by telephone at (503) 979-3129 or by e-mail at Arla.L.Davis@water.oregon.gov.

Sincerely,

David V. Jones Jr
Water Rights Services Support
Transfers and Conservation Section

cc: Lanaya F. Blakely, Watermaster Dist. # 2 (via email)
Zach Pike-Urlacher, Agent

Enclosure

3. On September 29, 2020, the Department approved a Water Management and Conservation Plan (WMCP), recorded at Special Order Volume 117, Pages 607-608. The approved plan contains the following Development Limitation: The limitation of the diversion of water under Permit G-16885 established in the Final Order approving the City's previous WMCP issued on April 9, 2010, is now modified. Subject to other limitations or conditions of the permit, therefore, the City of Florence is now authorized to divert only up to 2.4 CFS (out of the total permitted 3.0 CFS) of water under Permit G-16885.
4. On August 11, 2023, pursuant to ORS 537.260 and OAR 690-320-0040(5), the Department approved the partial perfection of 2.4 CFS under Permit G-16885, recorded at Special Order Volume 128, Pages 831-832. Confirming Certificate 97298 was issued as a result of the approval of the partial perfection of Permit G-16885.
5. Notice of the application for the permit amendment was published in the Department's weekly notice on January 24, 2023, and in the Siuslaw News newspaper on September 25 and October 2, 2024, pursuant to ORS 540.520(5).
6. On October 16, 2024, the Department contacted the agent for the applicant via phone regarding a deficiency in the application map, specifically Well 13 is described and mapped in the SW NE of T18S, R12W, Section 23.
7. Permit Amendment Application T-14146 proposes an additional point of appropriation with the following approximate distances from the existing points of appropriation to:

Twp	Rng	Mer	Sec	Q-Q	Measured Distances	Distance from Authorized Points of Appropriation
18 S	12 W	WM	23	SW NE	WELL 14 - 2480 FEET SOUTH AND 1500 FEET WEST FROM THE NE CORNER OF SECTION 23	Well 8- 520 FEET NORTH Well 9- 560 FEET SOUTH Well 10- 1150 FEET SOUTH Well 11- 1640 FEET SOUTH Well 12- 2100 FEET SOUTH Well 13- 1190 FEET SOUTHWEST

Permit Amendment Review Criteria

8. The change would not result in injury to other water rights.
9. The change does not enlarge the permit.
10. The change does not alter any other terms of the permit.

Conclusions of Law

The additional point of appropriation proposed by Permit Amendment Application T-14146 is consistent with the requirements of ORS 537.211.

Now, therefore, it is ORDERED:

1. The additional point of appropriation proposed by Permit Amendment Application T-14146 is approved.
2. Approval of this permit amendment application does not constitute nor grant legal access onto or through another person's property for purposes of accessing the new point of appropriation.
3. Permit G-18896, in the name of CITY OF FLORENCE, is issued to replace Permit G-16885, and incorporates the amendment approved by this order and the Water Management and Conservation Plan. Permit G-16885, in the name of CITY OF FLORENCE, is no longer of any force or effect.
4. The combined quantity of water diverted at the new additional point of appropriation (Well 14), together with that diverted at the original points of appropriation (Wells 8, 9, 10, 11, 12, and 13), shall not exceed the quantity of water lawfully available at the original points of appropriation (Wells 8, 9, 10, 11, 12, and 13).
5. Water use measurement conditions:
 - a. Before water use may begin under this order, the water user shall install a totalizing flow meter, or, with prior approval of the Director, another suitable measuring device, at each point of appropriation (new and existing).
 - b. The water user shall maintain the meters or measuring devices in good working order.
 - c. The water user shall allow the Watermaster access to the meters or measuring devices; provided however, where the meters or measuring devices are located within a private structure, the Watermaster shall request access upon reasonable notice.
6. Water shall be acquired from the same aquifer as the original points of appropriation (Wells 8, 9, 10, 11, 12, and 13).
7. All other terms and conditions of Permit G-18896 remain the same.

Dated in Salem, Oregon on JAN 28 2025

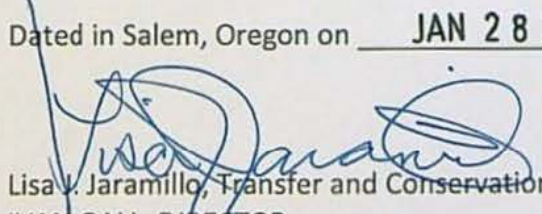
Lisa V. Jaramillo, Transfer and Conservation Section Manager, for
IVAN GALL, DIRECTOR
Oregon Water Resources Department

Mailing Date: JAN 29 2025

STATE OF OREGON

COUNTY OF LANE

PERMIT TO APPROPRIATE THE PUBLIC WATERS

THIS PERMIT IS HEREBY ISSUED TO

CITY OF FLORENCE
250 HWY 101
FLORENCE OR 97439

This superseding permit is issued to describe an amendment for an additional point of appropriation proposed under Permit Amendment Application T-14146 and approved by Special Order Vol. 133, Page 786, entered JAN 28 2025, and to describe a previous Permit Amendment T-11282 approved by Special Order Vol. 85, Page 957, entered January 19, 2012, and a Water Management and Conservation Plan approved September 29, 2020. This permit supersedes Permit G-16885.

The specific limits and conditions of the use are listed below.

APPLICATION FILE NUMBER: G-15295

SOURCE OF WATER: WELLS 8, 9, 10, 11, 12, 13, AND 14, IN MUNSEL CREEK BASIN

PURPOSE OR USE: MUNICIPAL USE

MAXIMUM RATE: 0.6 CUBIC FEET PER SECOND

PERIOD OF USE: YEAR ROUND

DATE OF PRIORITY: FEBRUARY 5, 2001

AUTHORIZED POINTS OF APPROPRIATION:

Twp	Rng	Mer	Sec	Q-Q	Measured Distances
18 S	12 W	WM	23	NW NE	WELL 11 - 905 FEET SOUTH AND 1435 FEET WEST FROM THE NE CORNER OF SECTION 23
18 S	12 W	WM	23	NW NE	WELL 12 - 300 FEET SOUTH AND 1425 FEET WEST FROM THE NE CORNER OF SECTION 23
18 S	12 W	WM	23	SW NE	WELL 13 - 1490 FEET SOUTH AND 2080 FEET WEST FROM THE NE CORNER OF SECTION 23
18 S	12 W	WM	23	SW NE	WELL 14 - 2480 FEET SOUTH AND 1500 FEET WEST FROM THE NE CORNER OF SECTION 23
18 S	12 W	WM	23	SW NE	WELL 9 - 1920 FEET SOUTH AND 1450 FEET WEST FROM THE NE CORNER OF SECTION 23
18 S	12 W	WM	23	SW NE	WELL 10 - 1515 FEET SOUTH AND 1505 FEET WEST FROM THE NE CORNER OF SECTION 23
18 S	12 W	WM	23	NW SE	WELL 8 - 2930 FEET SOUTH AND 1455 FEET WEST FROM THE NE CORNER OF SECTION 23

AUTHORIZED PLACE OF USE:

MUNICIPAL USE
WITHIN THE SERVICE AREA BOUNDARY OF THE CITY OF FLORENCE

Permit Amendment T-14146 Conditions:

The combined quantity of water diverted at the new additional point of appropriation (Well 14), together with that diverted at the original points of appropriation (Wells 8, 9, 10, 11, 12, and 13), shall not exceed the quantity of water lawfully available at the original points of appropriation (Wells 8, 9, 10, 11, 12, and 13).

Water use measurement conditions:

- a. Before water use may begin under this order, the water user shall install a totalizing flow meter, or, with prior approval of the Director, another suitable measuring device, at each point of appropriation (new and existing).
- b. The water user shall maintain the meters or measuring devices in good working order.
- c. The water user shall allow the Watermaster access to the meters or measuring devices; provided however, where the meters or measuring devices are located within a private structure, the Watermaster shall request access upon reasonable notice.

Water shall be acquired from the same aquifer as the original points of appropriation (Wells 8, 9, 10, 11, 12, and 13).

Permit Amendment T-11282 Conditions:

The combined quantity of water diverted at the new point of appropriation (Well 13), together with that diverted at the old points of appropriation (Wells 8, 9, 10, 11, and 12), shall not exceed the quantity of water lawfully available at the original points of appropriation (Wells 8, 9, 10, 11, and 12).

Prior to the water use from the proposed point of appropriation, the permittee shall install a meter or other suitable measuring device as approved by the Director. The permittee shall maintain the meter or other measuring device in good working order, and shall keep a complete record of the amount of water used each month and shall submit a report which includes the recorded water use measurements to the Department annually or more frequently as may be required by the Director. Further, the Director may require the permittee to report general water use information, including the place and nature of use of water under the permit.

The permittee shall allow the watermaster access to the meter or measuring device; provided, however, where the meter or measuring device is located within a private structure, the watermaster shall request access upon reasonable notice.

Water shall be acquired from the same aquifer as the original points of appropriation (Wells 8, 9, 10, 11, and 12).

WMCP Conditions:**Duration of Plan Approval:**

The City of Florence Water Management and Conservation Plan is approved and shall remain in effect until September 10, 2030, unless this approval is rescinded pursuant to OAR 690-086-0920.

Development Limitation:

The limitation of the diversion of water under Permit G-16885 established in the Final Order approving the City's previous WMCP issued on April 9, 2010, is now modified. Subject to other limitations or conditions of the permit, therefore, the City of Florence is now authorized to divert only up to 2.4cfs (out of the total permitted 3.0 cfs) of water under Permit G-16885.

Plan Update Schedule:

The City of Florence shall submit an updated plan meeting the requirements of OAR Chapter 690, Division 086 (effective November 1, 2002) within 10 years and no later than March 10, 2030.

Progress Report Schedule:

The City of Florence shall submit a progress report containing the information required under OAR 690-086-0120(4) by September 10, 2025.

Other Requirements for Plan Submittal:

The deadline established herein for the submittal of an updated Water Management and Conservation Plan (consistent with OAR Chapter 690, Division 086) shall not relieve the City of Florence from any existing or future requirement(s) for submittal of a Water Management and Conservation Plan at an earlier date as established through other final orders of the Department.

Original Permit Conditions:**Measurement, recording and reporting conditions:**

- A. Before water use may begin under this permit, the permittee shall install a meter or other suitable measuring device as approved by the Director. The permittee shall maintain the meter or measuring device in good working order, shall keep a complete record of the amount of water used each month and shall submit a report which includes the recorded water use measurements to the Department annually or more frequently as may be required by the Director. Further, the Director may require the permittee to report general water use information, including the place and nature of use of water under the permit.
- B. The permittee shall allow the watermaster access to the meter or measuring device; provided however, where the meter or measuring device is located within a private structure, the watermaster shall request access upon reasonable notice.

Within THREE years of permit issuance, the permittee shall submit a Water Management and Conservation Plan consistent with OAR Chapter 690, Division 86. The Director may approve an extension of this timeline to complete the required Water Management and Conservation Plan.

The City of Florence shall submit an updated Water Management and Conservation Plan no later than April 9, 2020, and shall submit a progress report containing the information required under OAR 690-086-0120(4) by April 9, 2015.

Mitigation Condition #1: During the period October 16 through October 31 of each year after this permit is first exercised, the City will deliver to the wetlands adjacent to Munsel Creek the equivalent of 26% of the average pumping rate under this permit for the previous June, July, August, and September.

Mitigation Condition #2: Any time this permit is being exercised, all clarified backwash water from the City's water treatment plant will be diverted to wetlands adjacent to Munsel Creek.

Nothing in this permit shall be construed to allow any person to trespass on the lands of another person.

STANDARD CONDITIONS

If substantial interference with a senior water right occurs due to withdrawal of water from any well listed on this permit, then use of water from the well(s) shall be discontinued or reduced and/or the schedule of withdrawal shall be regulated until or unless the Department approves or implements an alternative administrative action to mitigate the interference. The Department encourages junior and senior appropriators to jointly develop plans to mitigate interferences.

The wells shall be constructed in accordance with the General Standards for the Construction and Maintenance of Water Wells in Oregon. The works shall be equipped with a usable access port, and may also include an air line and pressure gauge adequate to determine water level elevation in the well at all times.

The use shall conform to such reasonable rotation system as may be ordered by the proper state officer.

Prior to receiving a certificate of water right, the permit holder shall submit the results of a pump test meeting the department's standards, to the Water Resources Department. The Director may require water level or pump test results every ten years thereafter.

Failure to comply with any of the provisions of this permit may result in action including, but not limited to, restrictions on the use, civil penalties, or cancellation of the permit.

This permit is for the beneficial use of water without waste. The water user is advised that new regulations may require the use of best practical technologies or conservation practices to achieve this end.

By law, the land use associated with this water use must be in compliance with statewide land-use goals and any local acknowledged land-use plan.

The use of water shall be limited when it interferes with any prior surface or ground water rights.

The Director finds that the proposed use of water described by this permit, as conditioned, will not impair or be detrimental to the public interest.

Complete application of the water to the use shall be made on or before October 1, 2025. If the water is not completely applied before this date, and the permittee wishes to continue development under the permit, the permittee must submit an application for extension of time, which may be approved based upon the merit of the application.

Within one year after complete application of water to the proposed use, the permittee shall submit a claim of beneficial use, which includes a map and report, prepared by a Certified Water Right Examiner (CWRE).

Issued JAN 28 2025

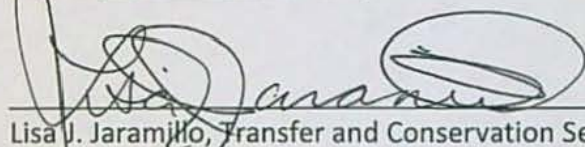

Lisa J. Jaramillo, Transfer and Conservation Section Manager, for
IVAN GALL, DIRECTOR
Oregon Water Resources Department

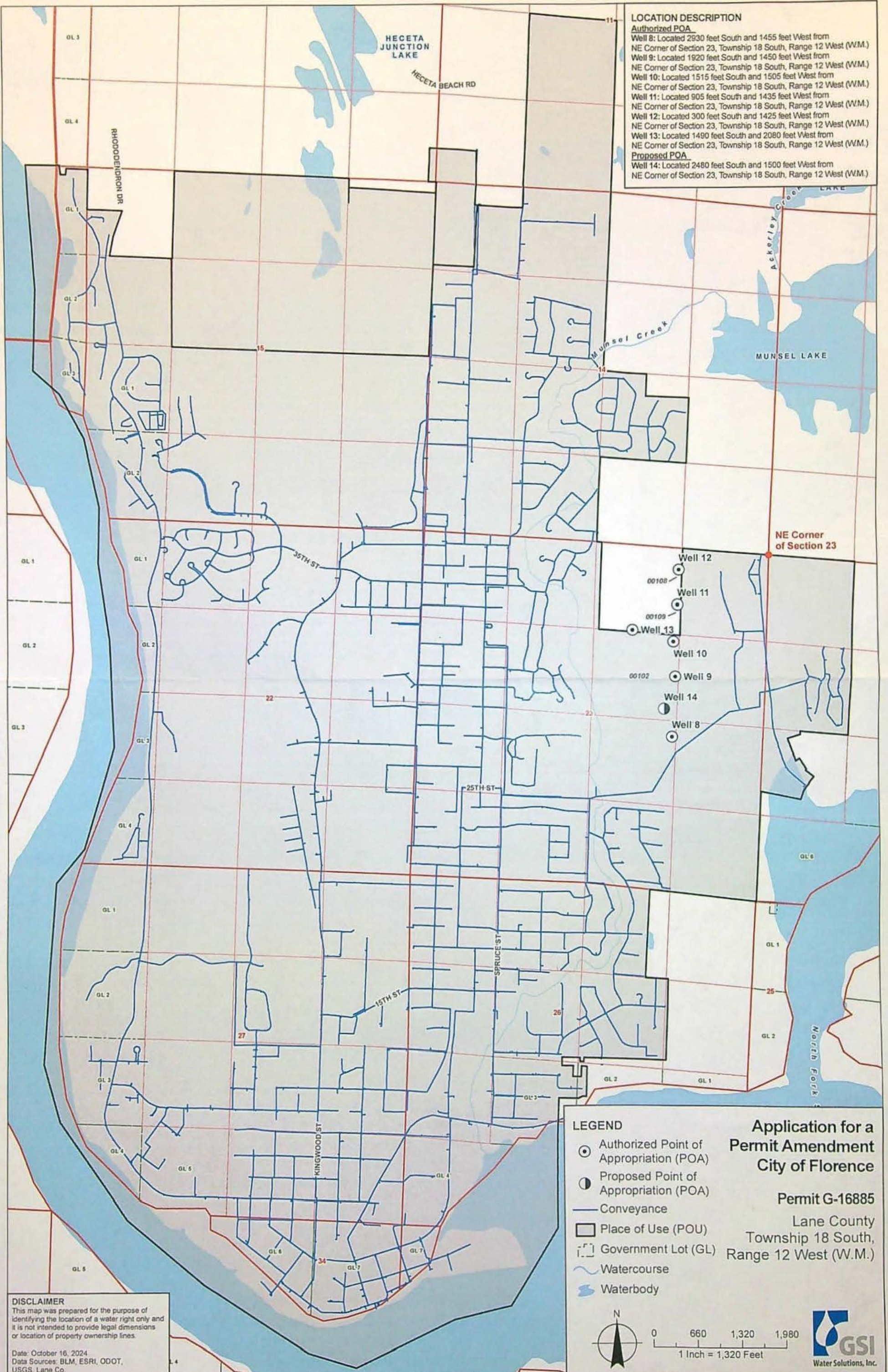

LOCATION DESCRIPTION
Authorized POA
Well 8: Located 2930 feet South and 1455 feet West from NE Corner of Section 23, Township 18 South, Range 12 West (W.M.)
Well 9: Located 1920 feet South and 1450 feet West from NE Corner of Section 23, Township 18 South, Range 12 West (W.M.)
Well 10: Located 1515 feet South and 1505 feet West from NE Corner of Section 23, Township 18 South, Range 12 West (W.M.)
Well 11: Located 905 feet South and 1435 feet West from NE Corner of Section 23, Township 18 South, Range 12 West (W.M.)
Well 12: Located 300 feet South and 1425 feet West from NE Corner of Section 23, Township 18 South, Range 12 West (W.M.)
Well 13: Located 1490 feet South and 2080 feet West from NE Corner of Section 23, Township 18 South, Range 12 West (W.M.)
Proposed POA
Well 14: Located 2480 feet South and 1500 feet West from NE Corner of Section 23, Township 18 South, Range 12 West (W.M.)

- LEGEND**
- Authorized Point of Appropriation (POA)
 - Proposed Point of Appropriation (POA)
 - Conveyance
 - Place of Use (POU)
 - Government Lot (GL)
 - Watercourse
 - Waterbody

Application for a Permit Amendment
City of Florence

Permit G-16885

Lane County
Township 18 South,
Range 12 West (W.M.)

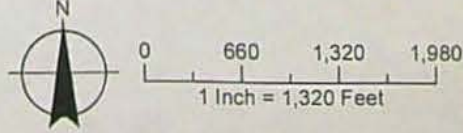

DISCLAIMER
This map was prepared for the purpose of identifying the location of a water right only and it is not intended to provide legal dimensions or location of property ownership lines.

Date: October 16, 2024
Data Sources: BLM, ESRI, ODOT, USGS, Lane Co.

Permit Amendment Checklist

Transfer: T- 14146

Transfer Specialist: Stacy

Transfer Type: Permit Amendment

Applicant Name/Address/email: CITY OF FLORENCE ATTN MIKE MILLER 250 HWY 101 FLORENCE, OR 97439	Agent Name/Address/email: ZACH PIKE-URLACHER 1600 SW WESTERN AVENUE, SUITE 240 CORVALLIS, OR 97333	Rec Landowner Name/Address:
CWRE Name/Number:	Irr. District Name/Address:	Affected Gov'ts Name/Address:
Commentor(s): Name/Address:	Current Landowner Name/Address (if different than applicant):	

Permit(s) Affected

Records Marked	Records Copied	App File No. or Decree Name	Permit No.	Superseding Permit No.
<input type="checkbox"/>	<input type="checkbox"/>	G-15295	G-16885	G-18896

Key Dates & Initial Actions

Rec'd: January 13, 2023	Proposed Action(s): ADDITIONAL POINT OF APPROPRIATION	
Fees Pd: 1840.00	WM District: 2	ODFW District:
Initial Notice: UNAVAILABLE	WM Review sent: Done: <u>2-9-2023</u>	ODFW Review sent: Done:
Acknowledgement Letter Sent: <input checked="" type="checkbox"/> Date: January 19, 2023		GW Review sent: Done: <u>12-6-2023</u>

Processing Dates & Actions

Deficiency Contact(s): _____

Draft Mailed: _____

If yes, date rec'd okay from agent/applicant: _____

☐ ODFW contact sheet sent; need? Yes ☐ or No ☒

☐ WM measurement sheet sent; need?

Yes ☐ or No ☒

Newspaper: Siuslaw News

☐ not required

Date quote requested: _____

Request for news \$ sent: _____

News \$ received: _____

Request to publish sent to newspaper: _____

Affidavit of publication received: _____

Dates of publication: _____

Final Order

<p>Draft Order & Superseding Permit Review (Optional)</p> <p>Reviewer: <u>ALD</u></p> <p>Date: _____</p> <p>Coordinator: _____</p> <p>Date: _____</p> <p>Signature Bin Date: _____</p>	<p>Final Order & Superseding Permit Review (Salem)</p> <p>Reviewer: _____</p> <p>Date: _____</p> <p>Coordinator: _____</p> <p>Date: _____</p> <p>Signature Bin Date: _____</p>
<p>Comments/Special Issues: _____</p>	

Special Order Volume: Vol: _____, Pages _____ Final Order Signature Date: _____

Notice of FO e-mailed to processors: _____

Application**PR CW**

- ☐ ☐ The type of change is clearly indicated.
- ☐ ☐ The application is appropriately signed.
- ☐ ☐ Appropriate fees were paid. N/A ☐ If overpayment, Refund Request submitted _____
- ☐ ☐ Land use form matches affected tax lots and is signed by proper official. (from ALL affected Govt's) _____
- ☐ ☐ N/A Ditch company, district, and/or BOR, sent a copy of the application and map, if appropriate.
- ☐ ☐ All required attachments received.
- ☐ ☐ Check application file and WRIS for assignment(s) and/or extension(s). _____

Application Map**PR CW**

- ☐ ☐ The map size and scale are accurate and appropriate per OAR 690-380-3100(1)(b)(c)&(d).
- ☐ ☐ All authorized and proposed POD's/POA's and POU are properly described on the map.
- ☐ ☐ The POD/POA location description(s) on the map match the PA application and permit descriptions.
- ☐ ☐ Map acres (to, from and rr, if applicable) match Table 2 on the PA application and as applicable, on the permit
- ☐ ☐ Have permit map(s).

Determining the "From" and "To" Lands (make working copy of application and permit(s))**PR CW**

- ☐ ☐ Only the authorized POD's/POA's and/or POU's to be transferred are listed (Tables 1 & 2).
- ☐ ☐ PA application and permit tabulations (acreage) match. (Mark on appl. and permit copies and note corrections needed)
- ☐ ☐ ALL Mark on permit the acreage and amount of water being transferred.

Permit Ownership

- ☐ ☐ The applicant(s) is/are the holder(s) of the permit.
- ☐ ☐ All holders of the permit have signed the application or
- ☐ ☐ N/A If necessary, there is a notarized, signed statement of consent from permit holders other than applicant.
- ☐ ☐ N/A If necessary, the permit has been assigned to permit amendment applicant.

Evaluation Materials

- | | | | |
|---|-------------------------------------|--|--|
| <input type="checkbox"/> Application complete | <input type="checkbox"/> Permit | <input type="checkbox"/> Land Use form | <input type="checkbox"/> N/A Plat card |
| <input type="checkbox"/> Amendment Map | <input type="checkbox"/> Permit Map | <input type="checkbox"/> Fees paid | <input type="checkbox"/> N/A Well logs |

Reviews/comments/conditions received? ☐ ☐ Watermaster ☐ ☐ N/A ODFW ☐ ☐ N/A GWN/A Headgate ☐ When in the judgment ☐ Prior to diverting ☐ Existing and maintainN/A Measuring Devices ☐ When in the judgment ☐ Prior to diverting ☐ Existing and maintain

Type of device, if applicable: _____ totalizing flow meter: at new at existing and new

Injury: ☐ Yes ☐ NoEnlargement: ☐ Yes ☐ No

Conditions to avoid enlargement/injury –

ODFW conditions: _____

GW Conditions: _____



Oregon

Tina Kotek, Governor

Water Resources Department

North Mall Office Building

725 Summer St NE, Suite A

Salem, OR 97301

Phone 503 986-0900

Fax 503 986-0904

August 30, 2024

VIA E-MAIL

Applicant

CITY OF FLORENCE

ATTN MIKE MILLER

250 HWY 101

FLORENCE, OR 97439

SUBJECT: Permit Amendment Application T-14146

Your Permit Amendment application requires publication of a notice for two consecutive weeks in a newspaper with general circulation in the area where the permit is located. The Department will publish the notice in the Siuslaw News newspaper upon receiving your payment for the notice.

At this time you need to:

1. Submit a check for **\$70.06** (to cover cost* of publication of the notice), made out to the Oregon Water Resources Department.
2. Write **"for T-14146 NOTICE"** on the front of your check, and
3. Submit it with the tracking stub at the bottom of this letter.

***PLEASE NOTE:** As outlined in OAR 690-380-4020(3), publication costs include both the direct cost of the notice and indirect processing costs (not to exceed 20% of the direct costs) for processing.

Mail the check to 725 Summer St. NE, Suite A, Salem, OR 97301-1266, **no later than September 30, 2024.**

Upon receipt of your check, processing will continue on the permit amendment application. If we do not receive payment for newspaper notice by September 30, 2024, a Final Order may be issued denying the application as incomplete.

✂-----
Attached is a check for **\$70.06** Newspaper Notice for Permit Amendment T-1414614146

- made out to Oregon Water Resources Department (or OWRD)
- **"for T-14146 NOTICE"** written on front of check

Mail to: Oregon Water Resources Department
725 Summer St. NE, Suite A
Salem, OR 97301-1266

Caseworker: Dante Luongo

Please don't hesitate to contact me at 971 304-5006 or
Dante.J.Luongo@water.oregon.gov

Sincerely,

Dante Luongo
Permit Amendment Specialist
Transfer and Conservation Section

cc: Permit Amendment application file T-14146
Lanaya F. Blakely, District 2 Watermaster *(via e-mail)*
Zach Pike-urlacher, Agent for the applicant *(via e-mail)*

Groundwater Transfer Review Summary Form

Transfer/PA # T- 14146

GW Reviewer Phillip I. Marcy Date Review Completed: 12/06/2023

Summary of Same Source Review:

☐ The proposed change in point of appropriation is not within the same aquifer as per OAR 690-380-2110(2).

Summary of Injury Review:

☐ The proposed transfer will result in another, existing water right not receiving previously available water to which it is legally entitled or result in significant interference with a surface water source as per 690-380-0100(3).

Summary of GW-SW Transfer Similarity Review:

☐ The proposed SW-GW transfer doesn't meet the definition of "similarly" as per OAR 690-380-2130.

This is only a summary. Documentation is attached and should be read thoroughly to understand the basis for determinations.



Oregon Water Resources Department
725 Summer Street NE, Suite A
Salem, Oregon 97301-1271
(503) 986-0900
www.wrd.state.or.us

Ground Water Review Form:

- ☐ Water Right Transfer
☒ Permit Amendment
☐ GR Modification
☐ Other

Application: T-14146

Applicant Name: City of Florence

Proposed Changes: ☐ POA ☒ APOA ☐ SW→GW ☐ RA
☐ USE ☐ POU ☐ OTHER

Reviewer(s): Phillip I. Marcy

Date of Review: 12/06/2023

Date Reviewed by GW Mgr. and Returned to WRSD: 12/21/2023

The information provided in the application is insufficient to evaluate whether the proposed transfer may be approved because:

- ☐ The water well reports provided with the application do not correspond to the water rights affected by the transfer.
- ☐ The application does not include water well reports or a description of the well construction details sufficient to establish the ground water body developed or proposed to be developed.
- ☐ Other _____

-
1. Basic description of the changes proposed in this transfer: The applicant is proposing to add one APOA well (Well 14) to the authorized use under Permit G-16885.
 2. Will the proposed POA develop the same aquifer (source) as the existing authorized POA?
☒ Yes ☐ No Comments: All wells produce from the dunal sand aquifer.
 3. a) Is there more than one source developed under the right (e.g., basalt and alluvium)?
☐ Yes ☒ No _____
b) If yes, estimate the portion of the right supplied by each of the sources and describe any limitations that will need to be placed on the proposed change (rate, duty, etc.): _____
 4. a) Will this proposed change, at its maximum allowed rate of use, likely result in an increase in interference with **another ground water right**?
☐ Yes ☒ No Comments: The additional drawdown induced by the proposed APOA well is not anticipated to increase impacts to wells other than the City of Florence's other nearby wells.
b) If yes, would this proposed change, at its maximum allowed rate of use, likely result in another groundwater right not receiving the water to which it is legally entitled?
☐ Yes ☐ No If yes, explain: NA

5. a) Will this proposed change, at its maximum allowed rate of use, likely result in an increase in interference with **another surface water source**?
☐ Yes ☒ No Comments: The proposed APOA location is not notably closer to any surface water source than any authorized well under Permit G-16885.
- b) If yes, at its maximum allowed rate of use, what is the expected change in degree of interference with any **surface water sources** resulting from the proposed change?
Stream: NA ☐ Minimal ☐ Significant
Stream: NA ☐ Minimal ☐ Significant
Provide context for minimal/significant impact: NA
6. For SW-GW transfers, will the proposed change in point of diversion affect the surface water source similarly (as per OAR 690-380-2130) to the authorized point of diversion specified in the water use subject to transfer?
☐ Yes ☐ No Comments: NA
7. What conditions or other changes in the application are necessary to address any potential issues identified above: None
8. Any additional comments: _____

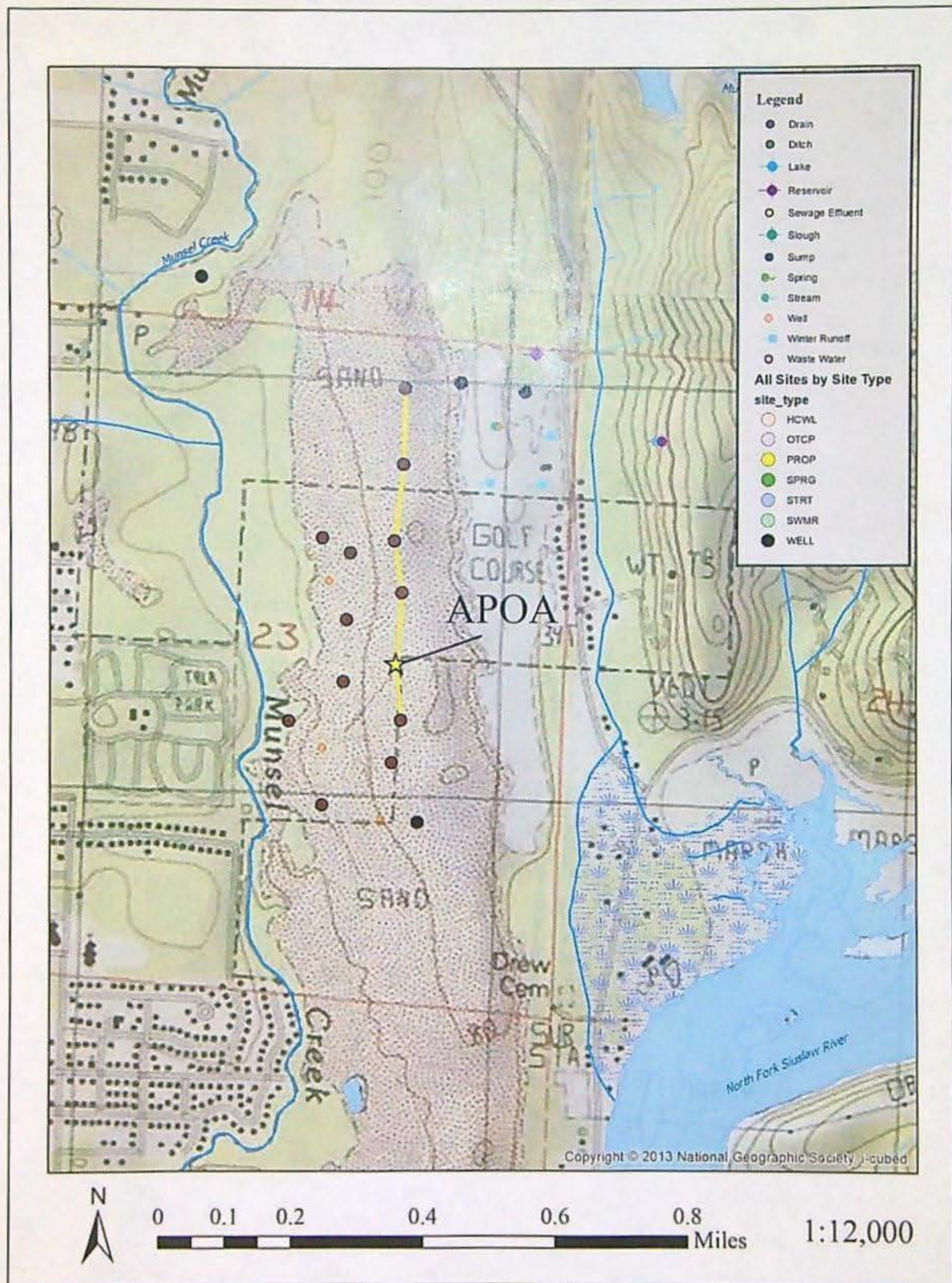

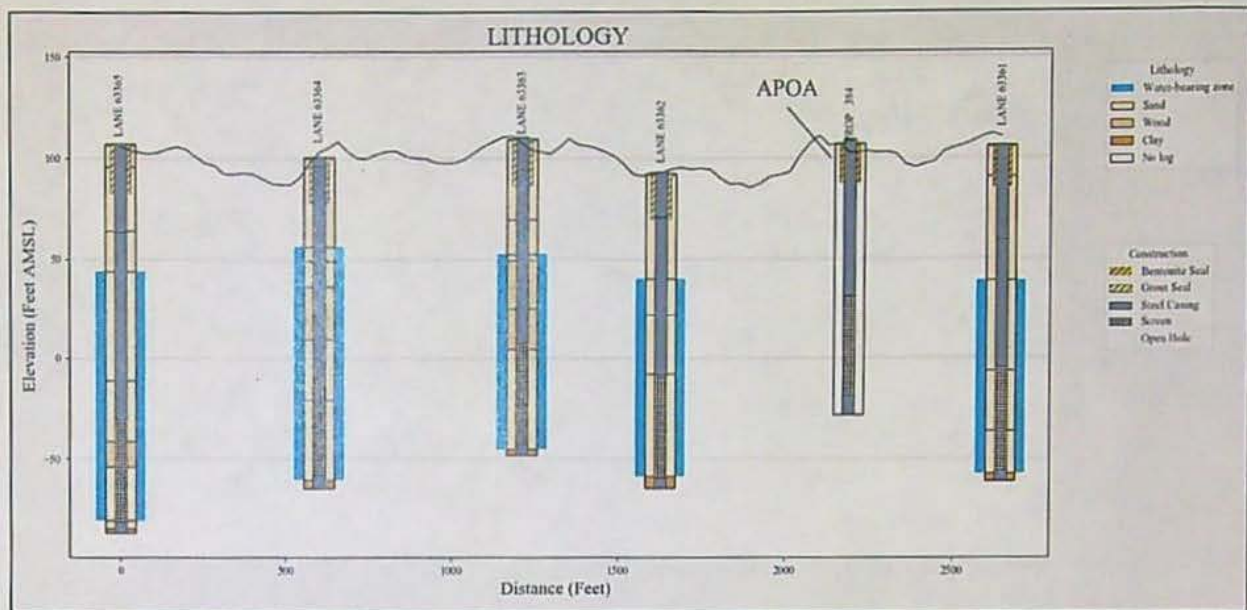

All authorized wells nearby produce from unconfined sands and wood debris above a lower permeability clay horizon. The proposed APOA well targets the same elevation range.

Watermaster Review Form: Water Right Transfer



Oregon Water Resources Department
725 Summer St NE, Suite A
Salem, Oregon 97301-1266
(503) 986-0900
www.oregon.gov/OWRD

Transfer Application: T-14146

Review Due Date:

Applicant Name: City of Florence

Proposed Changes: ☐ POU ☐ POD ☒ POA ☐ USE ☐ OTHER

Reviewer(s): L. Blakely

Date of Review: 02/09/2023

1. Do you have evidence that the right has not been used in the last 5 years and that the presumption of forfeiture would not likely be rebuttable? ☐ Yes ☒ No If "Yes", attach evidence (e.g. dated aerial photo showing pavement or building on the land for >5 yrs.)
2. Is there a history of regulation on the source that serves this (or these) right(s) that has involved the transferred right(s) and downstream water rights? ☐ Yes ☒ No Generally characterize the frequency of any regulation or explain why regulation has not occurred:
3. Have headgate notices been issued for the source that serves the transferred right(s)?
☐ Yes ☐ No ☒ Records not available.
4. In your estimation, after the proposed change, would distribution of water for the right(s) result in regulation of other water rights that would not have occurred if use under the original right(s) was/were maximized? ☐ Yes ☒ No If "Yes", explain:
5. In your estimation, if the proposed change is approved, are there upstream water rights that would be affected? ☐ Yes ☒ No If "Yes", describe how the rights would be affected and list the rights most affected:

6. Check here ☐ if it appears that downstream water rights benefit from return flows resulting from the current use of the transferred right(s)? If you check the box, generally characterize the locations where the return flows likely occur and list the water rights that benefit most:

☒ N/A

7. For POD changes and instream transfers, check here if there are channel losses between the old and new PODs or within the proposed instream reach? If you check the box, describe and, if possible, estimate the losses:

☒ N/A

8. For instream transfers that propose protection of a reach beyond the mouth of the source stream:

☒ N/A Would the quantity be measureable into the receiving stream consistent with OAR 690-077-0015(8)? ☐ Yes ☐ No

9. For POU changes: ☒ N/A Is it likely the original place of use would continue to receive water from the same source? ☐ Yes ☐ No If "Yes", explain:

10. For POU or USE changes: ☒ N/A In your best judgment, would use of the existing right at "full face value," result in the diversion of more water than can be used beneficially and without waste?

☐ Yes ☐ No If "Yes", explain:

11. For POU changes that involve micro-irrigation: ☒ N/A

- a. Has the applicant made changes (absent a transfer) to convert to micro-irrigation within the current place of use boundary of the water right proposed for transfer, and previously demonstrated to the Department through monitoring and site inspections by the Watermaster that the proposed transfer will not result in injury or enlargement?

☐ Yes ☐ No If "Yes", explain:

- b. Has a temporary transfer of this nature been previously filed and approved on the same lands (or portions thereof) as those lands involved in this transfer?

☐ Yes ☒ No If "Yes", answer the following:

- i. Were there any problems with more acres being irrigated (or wetted) than were authorized under the temporary transfer? ☐ Yes ☐ No If "Yes", explain:
- ii. Did the designated areas that were to remain dry (or not wetted) under the temporary transfer actually remain dry? ☐ Yes ☐ No If "No", explain:
- iii. Did the applicant comply with and meet all of the conditions of the temporary transfer? ☐ Yes ☐ No If "No", explain:
- iv. Do you have any other observations regarding the temporary transfer? ☐ Yes ☐ No If "Yes", describe:
- v. Did the applicant demonstrate to the Department through monitoring and site inspections by the Watermaster that neither injury nor enlargement occurred as a result of the temporary transfer? ☐ Yes ☐ No If "No", explain:

- c. To the best of your knowledge, if this transfer is approved, does it appear that:

- i. "Injury" will occur to other water rights that share the same source? ☐ Yes ☐ No If "Yes", explain:
- ii. "Enlargement" of the water right being transferred will occur? ☐ Yes ☐ No If "Yes", explain:

12. Are there other issues not identified through the above questions that should be considered in determining whether the change "can be effected without injury to other rights"?

☐ Yes ☒ No If "Yes", explain:

13. What alternatives may be available for addressing any issues identified above:

14. Do conditions need to be included in the transfer order to avoid enlargement of the right or injury to other rights? ☐ No ☒ Yes, as checked and provided below:

☐ For POU changes that involve micro-irrigation, provide the monitoring and reporting conditions necessary to prevent injury/enlargement:

☐ A Headgate should be required prior to diverting water.

☒ Measurement Devices for POD or POA: (if this condition is selected, also fill in the top sections of Page 4)

*a. Before water use may begin under this order, the water user shall install a **totalizing flow meter***, or, with prior approval of the Director, another suitable measuring device, ☒ at each point of diversion/appropriation (new and existing) OR at each new point of diversion/appropriation ☐ with the exception that water rights issued to the Bureau of Reclamation or an irrigation district (or similar entity) are not subject to this condition.*

b. The water user shall maintain the meters or measuring devices in good working order.

c. The water user shall allow the Watermaster access to the meters or measuring devices; provided however, where the meters or measuring devices are located within a private structure, the Watermaster shall request access upon reasonable notice.

☐ Reservoir water use measurement: (if this condition is selected, also fill in the top sections of Page 4)

*a. Before water use may begin under this order, the water user shall install **staff gages***, or, with prior approval of the Director, other suitable measuring devices, that measure the entire range and stage between empty and full in each reservoir. Staff gages shall be United States Geological Survey style.*

b. Before water use may begin under this order, if the reservoir is located in channel, weirs or other suitable measuring devices must be installed upstream and downstream of the reservoir, and, an adjustable outlet valve must be installed. The water user shall maintain such devices in good working order. A written waiver may be obtained, if in the judgment of the Director, the installation of weirs or other suitable measuring devices, or the adjustable outlet valve, will provide no public benefit.

* The following alternative device(s) should be substituted for the bold, underlined device in the above selected condition:

<input type="checkbox"/> Weir	<input type="checkbox"/> Submerged Orifice
<input type="checkbox"/> Parshall Flume	<input type="checkbox"/> Flow Restrictor
<input type="checkbox"/> Other: _____	

Oregon Water Resources Department

Measurement Condition Information for the Applicant

(To be sent with the Draft Preliminary Determination or Final Order)

Transfer #: T- 14146



In order to avoid enlargement of the right or injury to other rights, a totalizing flowmeter will be required to be installed prior to diversion of water, as a condition of this transfer:



at each point of diversion/appropriation (new and existing) **OR**



at each new point of diversion/appropriation.

For additional information, or to obtain approval of a different type of measurement device, the applicant should contact the area Watermaster:

Watermaster name: Lanaya Blakely

District: 2

Address: 125 E 8th Ave

City/State/Zip: Eugene, OR 97401

Phone: 541-913-1154

Email: lanaya.f.blakely@water.oregon.gov

Note: If a device other than the one specified in the Preliminary Determination or Final Order is approved by the Watermaster, fill out and mail the form below to the Salem office.

Approval of an Alternate Measurement Device

T-

(to be filled out after consultation with the applicant, or after a site visit)

On behalf of the Director, I authorize use of the following suitable alternate measurement device:

Watermaster signature

District

Date

If this form is used for approval of an alternative measurement device, it must be mailed to:

Oregon Water Resources Department
725 Summer Street NE, Suite A
Salem, OR 97301-1266

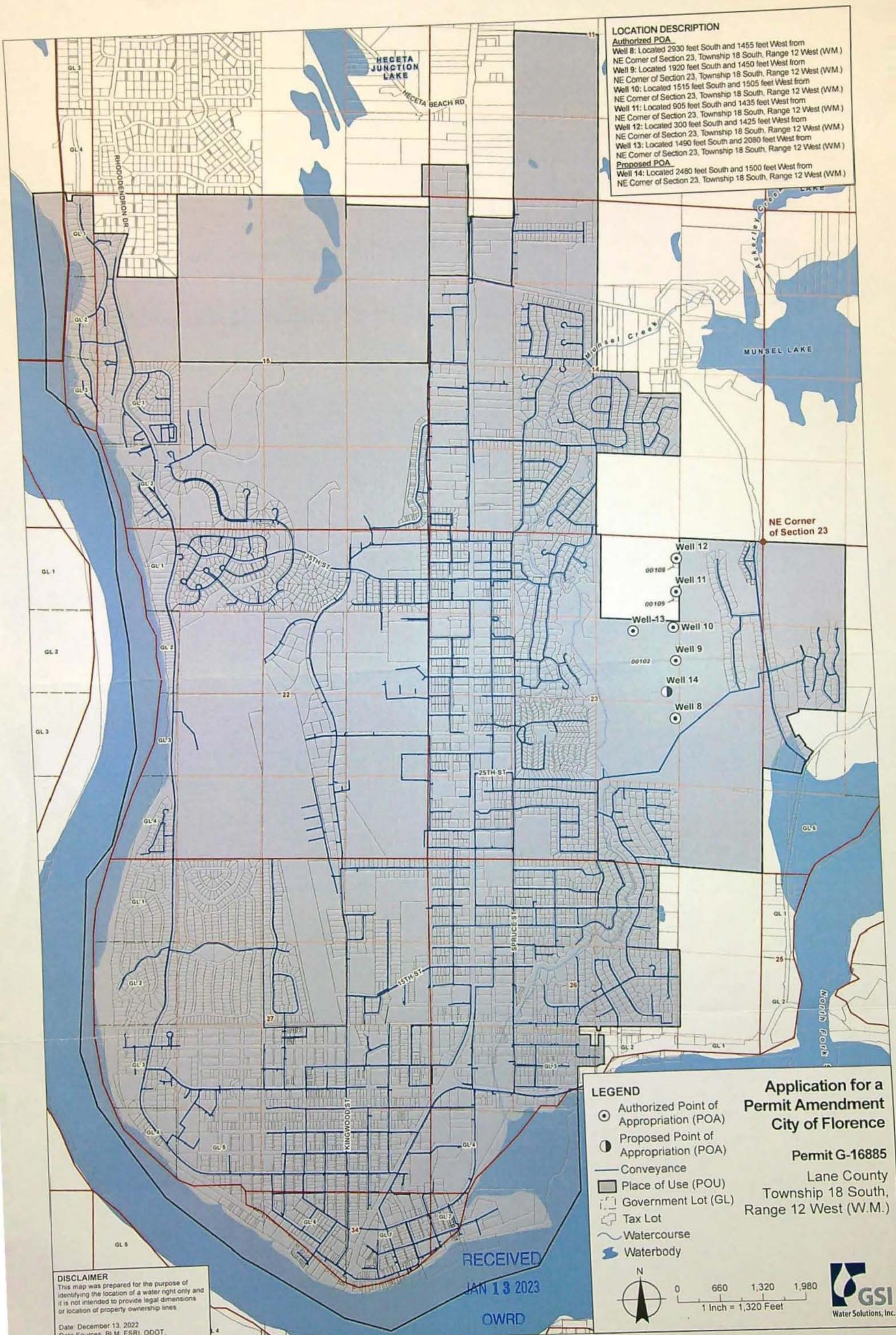

LOCATION DESCRIPTION
Authorized POA
Well 8: Located 2930 feet South and 1455 feet West from NE Corner of Section 23, Township 18 South, Range 12 West (WM.)
Well 9: Located 1920 feet South and 1450 feet West from NE Corner of Section 23, Township 18 South, Range 12 West (WM.)
Well 10: Located 1515 feet South and 1505 feet West from NE Corner of Section 23, Township 18 South, Range 12 West (WM.)
Well 11: Located 905 feet South and 1435 feet West from NE Corner of Section 23, Township 18 South, Range 12 West (WM.)
Well 12: Located 300 feet South and 1425 feet West from NE Corner of Section 23, Township 18 South, Range 12 West (WM.)
Well 13: Located 1490 feet South and 2080 feet West from NE Corner of Section 23, Township 18 South, Range 12 West (WM.)
Proposed POA
Well 14: Located 2480 feet South and 1500 feet West from NE Corner of Section 23, Township 18 South, Range 12 West (WM.)

- LEGEND**
- Authorized Point of Appropriation (POA)
 - Proposed Point of Appropriation (POA)
 - Conveyance
 - Place of Use (POU)
 - Government Lot (GL)
 - Tax Lot
 - Watercourse
 - Waterbody

Application for a Permit Amendment
City of Florence

Permit G-16885
Lane County
Township 18 South,
Range 12 West (W.M.)

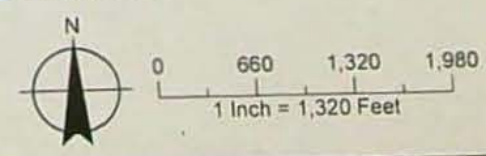

DISCLAIMER
This map was prepared for the purpose of identifying the location of a water right only and it is not intended to provide legal dimensions or location of property ownership lines.

Date: December 13, 2022
Data Sources: BLM, ESRI, ODOT, USGS, Lane Co

Document Path: Y:\0180_City_Florence\Source_Figures\008_Well14_POA\Permit_Amend_App_taloid.mxd: abarry

VENDOR: 5081 OREGON WATER RESOURCES DEPT

108640

DATE

INVOICE #

DESCRIPTION

12/20/2022 12-20-22

permit

12/21/2022

AMOUNT

1,840.00

RECEIVED

JAN 13 2023

OWRD

Total Amount:

\$1,840.00

STATE OF OREGON
WATER RESOURCES DEPARTMENT

725 Summer St. N.E. Ste. A

SALEM, OR 97301-4172

(503) 986-0900 / (503) 986-0904 (fax)

RECEIPT # 139921

INVOICE #

RECEIVED FROM:

BY:

CASH:

CHECK: #

OTHER: (IDENTIFY)

APPLICATION

PERMIT

TRANSFER

TOTAL REC'D

\$1,840.00

1083 TREASURY 4170 WRD MISC CASH ACCT

0407 COPIES

\$

OTHER: (IDENTIFY)

\$

0243 I/S Lease

0244 Muni Water Mgmt. Plan

0245 Cons. Water

4270 WRD OPERATING ACCT

MISCELLANEOUS

0407 COPY & TAPE FEES

\$

0410 RESEARCH FEES

\$

0408 MISC REVENUE: (IDENTIFY)

\$

TC162 DEPOSIT LIAB. (IDENTIFY)

\$

0240 EXTENSION OF TIME

\$

WATER RIGHTS:

EXAM FEE

RECORD FEE

0201 SURFACE WATER

\$

0202

\$

0203 GROUND WATER

\$

0204

\$

0205 TRANSFER

\$1,840.00

WELL CONSTRUCTION

EXAM FEE

LICENSE FEE

0218 WELL DRILL CONSTRUCTOR

\$

0219

\$

LANDOWNER'S PERMIT

0220

\$

OTHER (IDENTIFY)

0536 TREASURY 0437 WELL CONST. START FEE

0211 WELL CONST START FEE

\$

CARD#

0210 MONITORING WELLS

\$

CARD#

OTHER (IDENTIFY)

0607 TREASURY 0467 HYDRO ACTIVITY LIC NUMBER

0233 POWER LICENSE FEE (FW/WRD)

\$

0231 HYDRO LICENSE FEE (FW/WRD)

\$

HYDRO APPLICATION

\$

TREASURY OTHER / RDX

FUND TITLE

OBJ. CODE VENDOR #

DESCRIPTION

\$

RECEIPT

139921

DATED: 1-13-2023

BY: [Signature]

Application for Permit Amendment

Part 1 of 5 – Minimum Requirements Checklist



Oregon Water Resources Department
725 Summer Street NE, Suite A
Salem, Oregon 97301-1266
(503) 986-0900
www.oregon.gov/OWRD

This permit amendment application will be returned if Parts 1 through 5 and all required attachments are not completed and included.

For questions, please call (503) 986-0900, and ask for Transfer Section.

RECEIVED

JAN 13 2023

OWRD

Check all items included with this application. (N/A = Not Applicable)

- ☒ Part 1 – Completed Minimum Requirements Checklist.
- ☒ Part 2 – Completed Application Map Checklist.
- ☒ Part 3 – Application Fee, payable by check to the Oregon Water Resources Department, and completed Fee Worksheet, page 3. **Check in amount of \$1,840 enclosed.**
- ☒ Part 4 – Completed Applicant Information and Signature.
- ☒ Part 5 – Information about Permits to be Amended: **Number of permits to be amended: 1**
List the Permits here: G-16885 (Attachment A)
Please include a separate Part 5 for each permit. (See instructions on page 6)
- ☒ Completed Permit Amendment Application Map (Does not have to be prepared by a Certified Water Right Examiner). **(Attachment B)**
- ☐ ☒ N/A Request for Assignment Form and statutory fee. The request for assignment form has to be completed if the applicant is **not** the permit holder of record and needs to be assigned to the permit; **or** the landowner of the proposed place of use is **not** the permit holder of record and needs to be assigned to the permit (the Request for Assignment Form is available online at <https://www.oregon.gov/OWRD/Forms/Pages/default.aspx>). Assignment is not needed if the applicant is the permit holder of record.
- ☐ ☒ N/A Affidavit(s) of Consent are required from all permit holder(s) of record if the permit is not assigned to the applicant **or** other permit holders of record that are not listed as applicants.
- ☒ ☐ N/A Oregon Water Resources Department's Land Use Information Form with approval and signature (or signed land use form receipt stub) from each local land use authority in which water is to be diverted, conveyed, and/or used. Not required if water is to be diverted, conveyed, and/or used only on federal lands or if **all** of the following apply: a) a change in place of use only, b) no structural changes, c) the use of water is for irrigation only, and d) the use is located within an irrigation district or an exclusive farm use zone. **(Attachment C)**
- ☒ ☐ N/A Water Well Report/Well Log for changes in point(s) of appropriation (well(s)) or additional point(s) of appropriation. **(Attachment D)**
- ☐ ☒ N/A Geologist Report for a change from a surface water point of diversion to a ground water point of appropriation (well), if the proposed well is more than 500 feet from the surface water source and more than 1000 feet upstream or downstream from the point of diversion. (ORS 540.531(2) or (3)).

(For Staff Use Only)

WE ARE RETURNING YOUR APPLICATION FOR THE FOLLOWING REASON(S):

___ Application fee not enclosed/insufficient ___ Map not included or incomplete

___ Land Use Form not enclosed or incomplete

___ Additional signature(s) required ___ Part ___ is incomplete

Other/Explanation _____

Staff: _____ 503- _____ Date: ____/____/____

Your permit amendment application will be returned if any of the map requirements listed below are not met.

Please be sure that the map you submit includes all the items listed below and meets the requirements of OAR 690-380-3100, however, the map does not have to be prepared by a Certified Water Right Examiner. Check all boxes that apply.

RECEIVED

JAN 18 2023

OWRD

- ☐ ☒ N/A If **more than three** permits are involved, separate maps for each permit.
- ☒ Permanent quality printed with dark ink on good quality paper.
- ☒ The size of the map can be 8½ x 11 inches, 8½ x 14 inches, 11 x 17 inches, or up to 30 x 30 inches. For 30 x 30 inch maps, one extra copy is required.
- ☒ A north arrow, a legend, and scale.
- ☒ The scale of the map must be: 1 inch = 400 feet, 1 inch = 1,320 feet, the scale of the county assessor map if the scale is not smaller than 1 inch = 1,320 feet, or a scale that has been pre-approved by the Department.
- ☒ Township, Range, Section, ¼ ¼, DLC, Government Lot, and other recognized public land survey lines.
- ☒ Tax lot boundaries (property lines) are required. Tax lot numbers are recommended.
- ☒ Major physical features including rivers and creeks showing direction of flow, lakes and reservoirs, roads, and railroads.
- ☒ Major water delivery system features from the point(s) of diversion/appropriation such as main pipelines, canals, and ditches.
- ☒ Existing place of use that includes separate hachuring for each water use permit, priority date, and use including number of acres in each quarter-quarter section, government lot, or in each quarter-quarter section as projected within government lots, donation land claims, or other recognized public land survey subdivisions. If less than the entirety of the permit is being changed, a separate hachuring is needed for the portion of the permit left unchanged.
- ☐ ☒ N/A If you are proposing a change in place of use, show the proposed place of use with hachuring that includes separate hachuring for each permit, priority date, and use including number of acres in each quarter-quarter section, government lot, or in each quarter-quarter section as projected within government lots, donation land claims, or other recognized public land survey subdivisions.
- ☒ Existing point(s) of diversion or well(s) with distance and bearing or coordinates from a recognized survey corner. This information can be found in your water use permit.
- ☒ ☐ N/A If you are proposing a change in point(s) of diversion or well(s), show the proposed location and label it clearly with distance and bearing or coordinates. If GPS coordinates are used, latitude-longitude coordinates may be expressed as either degrees-minutes-seconds with at least one digit after the decimal (example – 42°32'15.5") or degrees-decimal with five or more digits after the decimal (example – 42.53764°).

Part 3 of 5 – Fee Worksheet

RECEIVED
JAN 13 2023
OWRD

*Example for Line 5a calculation to transfer 45.0 acres of Primary Permit S-12345 (total 1.25 cfs for 100 acres) and 45.0 acres of Supplemental Permit S-87654 (1/80 cfs per acre) on the same land:

1. For irrigation calculate cfs for each permit involved as follows:
 - a. Divide total authorized cfs by total acres in the permit (for S-12345, $1.25 \text{ cfs} \div 100 \text{ ac}$); then multiply by the number of acres to be changed to get the application cfs ($\times 45 \text{ ac} = 0.56 \text{ cfs}$).
 - b. If the water right permit does not list total cfs, but identifies the allowable use as 1/40 or 1/80 of a cfs per acre; multiply number of acres proposed for change by either 0.025 (1/40) or 0.0125 (1/80). (For S-87654, $45.0 \text{ ac} \times 0.0125 \text{ cfs/ac} = 0.56 \text{ cfs}$)
2. Add cfs for the portions of permits on all the land included in the application; however **do not count cfs for supplemental permits on acreage for which you have already calculated the cfs fee for the primary permit on the same land.** The fee should be assessed only once for each "on the ground" acre included in the application. (In this example, blank 5a would be only 0.56 cfs, since both permits serve the same 45.0 acres. Blank 5b would be 0 and Line 5 would then also become 0).

Part 4 of 5 – Applicant Information and Signature

Applicant Information

APPLICANT/BUSINESS NAME City of Florence ATTN: Mike Miller			PHONE NO. 541-997-4106	ADDITIONAL CONTACT NO. 541-997-3437
ADDRESS 250 HWY 101			FAX NO.	
CITY Florence	STATE OR	ZIP 97439	E-MAIL mike.miller@ci.florence.or.us	
BY PROVIDING AN E-MAIL ADDRESS, CONSENT IS GIVEN TO RECEIVE ALL CORRESPONDENCE FROM THE DEPARTMENT ELECTRONICALLY. COPIES OF THE FINAL ORDER DOCUMENTS WILL ALSO BE MAILED.				

Agent Information – The agent is authorized to represent the applicant in all matters relating to this application.

AGENT/BUSINESS NAME GSI Water Solutions, Inc. ATTN: Zach Pike-Urlacher			PHONE NO. 541-753-0933	ADDITIONAL CONTACT NO.
ADDRESS 1600 Western Boulevard, Suite 240			FAX NO.	
CITY Corvallis	STATE OR	ZIP 97333	E-MAIL zpikurlacher@gsiws.com	
BY PROVIDING AN E-MAIL ADDRESS, CONSENT IS GIVEN TO RECEIVE ALL CORRESPONDENCE FROM THE DEPARTMENT ELECTRONICALLY. COPIES OF THE FINAL ORDER DOCUMENTS WILL ALSO BE MAILED.				

Explain in your own words what you propose to accomplish with this permit amendment; and why:
The City of Florence (Applicant) is proposing to add a new well (Well 14) to Permit G-16885. There is a partial perfection COBU pending for 2.4 cfs of the 3.0 cfs under the permit.

If you need additional space, continue on a separate piece of paper and attach to the application as "Attachment 1".

☐ Check this box if this project is fully or partially funded by the American Recovery and Reinvestment Act. (Federal stimulus dollars)

Is the applicant the permit holder of record? ☒ Yes ☐ No

If NO, include either:

- ☐ A completed assignment form (with required statutory assignment fee), assigning all or a portion of the permit to the applicant(s), OR
- ☐ An affidavit of consent from the permit holder(s) of record that gives permission for the applicant to amend the permit.

Has the Completion ("C") Date of the permit(s) in this application expired? ☐ Yes ☒ No

If YES, this application will not be accepted by the Department.

If NO, what are the completion dates of the permit(s)? 10/1/2025

- If the permit completion date expires while the Permit Amendment Application is pending, the Department will not approve the Permit Amendment Application until an Extension of Time Application is approved for the permit.
- You may consider using the Reimbursement Authority process to expedite the processing of this Permit Amendment Application if the completion date of the permit expires within 6 months of the date of filing this application.

By my signature below, I confirm that I understand:

- Prior to Department approval of the permit amendment, I may be required to submit payment to the Department for publication of a notice in a newspaper with general circulation in the area where the permit is located, once per week for two consecutive weeks. If more than one qualifying newspaper is available, I suggest publishing the notice in the following newspaper: Siuslaw News

I (we) affirm that the information contained in this application is true and accurate.

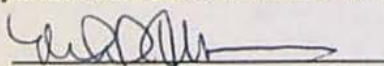
Applicant Signature

Mike Miller, Public Works Director
Print Name (and Title if applicable)

12/14/2022
Date

RECEIVED

JAN 13 2023

OWRD

Check one of the following:

- ☒ The applicant is responsible for completion of change(s). Notices and correspondence should continue to be sent to the applicant.
- ☐ The permit holder(s) of record will be responsible for completing the proposed change(s) after the final order is issued. Copies of notices and correspondence should be sent to the permit holder(s) of record.

Check the appropriate box, if applicable:

- ☐ Check here if any of the permits proposed for amendment are or will be located within or served by an irrigation or other water district.

IRRIGATION DISTRICT NAME N/A	ADDRESS	
CITY	STATE	ZIP

- ☐ Check here if water for any of the permits supplied under a water service agreement or other contract for stored water with a federal agency or other entity.

ENTITY NAME N/A	ADDRESS	
CITY	STATE	ZIP



To meet State Land Use Consistency Requirements, you must list all local governments (each county, city, municipal corporation, or tribal government) within whose jurisdiction water will be diverted, conveyed or used.

ENTITY NAME City of Florence	ADDRESS 250 Hwy 101	
CITY Florence	STATE OR	ZIP 97439

ENTITY NAME	ADDRESS	
CITY	STATE	ZIP

RECEIVED
JAN 13 2023
OWRD

Please use a separate Part 5 for each permit being changed. See instructions on page 6, to copy and paste additional Part 5s, or to add additional rows to tables within the form.

RECEIVED

JAN 13 2023

OWRD

PERMIT # G-16885**Table 1. Location of Authorized and Proposed Point(s) of Diversion (POD) or Appropriation (POA)**

(Note: If the POD/POA name is not specified in the permit, assign it a name or number here.)

POD/POA Name or Number	Is this POD/POA Authorized by the permit or is it Proposed?	If POA, OWRD Well Log ID# (or Well ID Tag # L-___)	Twp	Rng	Sec	¼ ¼	Tax Lot, DLC or Gov't Lot	Measured Distances (from a recognized survey corner)
Well 8	<input checked="" type="checkbox"/> Authorized <input type="checkbox"/> Proposed	LANE 63361	18 S	12 W	23	NW SE	102	2930 FEET SOUTH AND 1455 FEET WEST FROM NE CORNER, SECTION 23
Well 9	<input checked="" type="checkbox"/> Authorized <input type="checkbox"/> Proposed	LANE 63362	18 S	12 W	23	SW NE	102	1920 FEET SOUTH AND 1450 FEET WEST FROM NE CORNER, SECTION 23
Well 10	<input checked="" type="checkbox"/> Authorized <input type="checkbox"/> Proposed	LANE 63363	18 S	12 W	23	SW NE	102	1515 FEET SOUTH AND 1505 FEET WEST FROM NE CORNER, SECTION 23
Well 11	<input checked="" type="checkbox"/> Authorized <input type="checkbox"/> Proposed	LANE 63364	18 S	12 W	23	NW NE	109	905 FEET SOUTH AND 1435 FEET WEST FROM NE CORNER, SECTION 23
Well 12	<input checked="" type="checkbox"/> Authorized <input type="checkbox"/> Proposed	LANE 63365	18 S	12 W	23	NW NE	108	300 FEET SOUTH AND 1425 FEET WEST FROM NE CORNER, SECTION 23
Well 13	<input checked="" type="checkbox"/> Authorized <input type="checkbox"/> Proposed	LANE 71033	18 S	12 W	23	NW NE	102	1490 FEET SOUTH AND 2080 FEET WEST FROM NE CORNER, SECTION 23
Well 14	<input type="checkbox"/> Authorized <input checked="" type="checkbox"/> Proposed	-	18 S	12 W	23	SW NE	102	2480 FEET SOUTH AND 1500 FEET WEST FROM NE CORNER, SECTION 23

Check all type(s) of change(s) proposed below (change "CODES" are provided in parentheses):

- | | |
|---|--|
| <input type="checkbox"/> Place of Use (POU) | <input type="checkbox"/> Point of Appropriation/Well (POA) |
| <input type="checkbox"/> Point of Diversion (POD) | <input checked="" type="checkbox"/> Additional Point of Appropriation (APOA) |
| <input type="checkbox"/> Additional Point of Diversion (APOD) | <input type="checkbox"/> Surface water POD to Ground Water POA (SW/GW) |

Will all of the proposed changes affect the entire water use permit?

- ☒ Yes Complete only the proposed ("to" lands) section of Table 2 on the next page. Use the "CODES" listed above to describe the proposed changes.
- ☐ No Complete all of Table 2 to describe the portion of the permit to be changed.

Please use and attach additional pages of Table 2 as needed.
See page 6 for instructions.

Do you have questions about how to fill-out the tables?
Contact the Department at 503-986-0900 and ask for Transfer

Table 2. Description of Changes to Water Use Permit # G-16885

List the change proposed for the acreage in each ¼ ¼. If more than one change is proposed, specify the acreage associated with each change.
If there is more than one POD/POA involved in the proposed changes, specify the acreage associated with each POD/POA.

AUTHORIZED (the "from" or "off" lands) The listing that appears on the certificate BEFORE PROPOSED CHANGES List only that part or portion of the water right that will be changed.										Proposed Changes (see "CODES" from previous page)	PROPOSED (the "to" or "on" lands) The listing as it would appear AFTER PROPOSED CHANGES are made.													
Twp	Rng	Sec	¼ ¼	Tax Lot	Gvt Lot or DLC	Acres (if applicable)	POD(s) or POA(s) (name or number from Table 1)	Priority Date	Twp		Rng	Sec	¼ ¼	Tax Lot	Gvt Lot or DLC	Acres (if applicable)	POD(s) or POA(s) to be used (from Table 1)	Priority Date						
EXAMPLE																								
2	S	9	E	15	NE	NW	100		15.0	POD #1 POD #2		POU/POD	2	S	9	E	15	NW	NW	100	1	10.0	POD #5	
"	"	"	"	"	"	"	"	"	EXAMPLE	"		"	2	S	9	E	15	SW	NW	200		5.0	POD #6	
													City of Florence Service Area – See Attachment B										Wells 8, 9, 10, 11, 12, 13, 14	2/5/2001
TOTAL ACRES													TOTAL ACRES						N/A					

Additional remarks: There is a partial perfection COBU pending for 2.4 cfs of the 3.0 cfs authorized under Permit G-16885.

RECEIVED
JAN 13 2023
OWRD

For a change in place of use:

Does the permit holder of record own or control the land TO which the place of use is being moved?

☐ Yes ☐ No -N/A

If NO, the landowner of the land TO which the place of use is being moved **must be assigned to the permit as a permit holder of record** by submitting a completed Request for Assignment form and the required statutory fee for an assignment.

Is the proposed place of use contiguous to the authorized place of use? ☐ Yes ☐ No -N/A

The permitted place of use can be moved only to lands that are contiguous to the authorized place of use **unless** the change to non-contiguous lands is in furtherance of mitigation or conservation efforts undertaken for the purposes of benefiting a species listed as sensitive, threatened, or endangered under ORS 496.171 to 496.192 or the federal Endangered Species Act of 1973 (16 U.S.C. 1531 to 1544), as determined by the listing agency. Contiguous land being either adjacent land or land separated from the land to which a permit is authorized by roads, utility corridors, irrigation ditches or publicly owned rights of way.

RECEIVED

JAN 13 2023

OWRD

Are there other water rights certificates, water use permits or ground water registrations associated with the "from" or "to" lands? ☐ Yes ☐ No N/A - Permit G-16885 is for municipal use so "layering" does not apply.

If YES, list the other certificate, permit, or ground water registration numbers: _____

 If the permit(s) are for irrigation or supplemental irrigation use, other water rights existing on the same land for irrigation that are subject to transfer must either change concurrently or be cancelled. Any change to a water right certificate or ground water registration must be filed separately in a water right transfer application or ground water registration modification application, respectively.

For a change in point(s) of appropriation (well(s)) or additional point(s) of appropriation:

- ☒ Well log(s) are attached for each authorized and proposed well(s) that are clearly labeled and associated with the corresponding well(s) in Table 1 above and on the accompanying application map. See Attachment D.

AND/OR

- ☒ Describe the construction of the authorized and proposed well(s) in Table 3 for any wells that do not have a well log. For *proposed wells not yet constructed or built*, provide "a best estimate" for each requested information element in the table. The Department recommends you consult a licensed well driller, geologist, or certified water right examiner to assist with assembling the information necessary to complete Table 3.

Table 3. Construction of Point(s) of Appropriation

Any well(s) in this listing must be clearly tied to corresponding well(s) described in Table 1 and shown on the accompanying application map. Failure to provide the information will delay the processing of your transfer application until it is received. The information is necessary for the department to assess whether the proposed well(s) will access the same source aquifer as the authorized point(s) of appropriation (POA). The Department is prohibited by law from approving POA changes that do not access the same source aquifer.

Proposed or Authorized POA Name or Number	Is well already built? (Yes or No)	If an existing well, OWRD Well ID Tag No. L- _____	Total well depth	Casing Diameter	Casing Intervals (feet)	Seal depth(s) (intervals)	Perforated or screened intervals (in feet)	Static water level of completed well (in feet)	Source aquifer (sand, gravel, basalt, etc.)	Well - specific rate (cfs or gpm). If less than full rate of water right
Well 14	No	-	135ft (est.)	12in (est.)	+2.5-75 125-130 (est.)	0-19ft (est.)	75-125 (est.)	9ft (est.)	Sand	-

Well 14 construction details were estimated based on construction of Well 13.

RECEIVED

JAN 13 2023

OWRD

STATE OF OREGON

COUNTY OF LANE

PERMIT TO APPROPRIATE THE PUBLIC WATERS

THIS PERMIT IS HEREBY ISSUED TO

CITY OF FLORENCE
250 HWY 101
FLORENCE OR 97439

541-997-4106

This superseding permit is issued to describe an amendment for an additional point of appropriation proposed under Permit Amendment Application T-11282 and approved by Special Order Vol. 85 Page 956, entered JAN 19, 2012, and to describe an extension of time for complete application of water approved June 23, 2009 and an Water Management and Conservation Plan approved April, 9, 2010. This permit supersedes Permit G-15056.

The specific limits and conditions of the use are listed below.

APPLICATION FILE NUMBER: G-15295

SOURCE OF WATER: WELLS 8, 9, 10, 11, 12, AND 13, IN MUNSEL CREEK BASIN

PURPOSE OR USE: MUNICIPAL USE

MAXIMUM RATE: 3.0 CUBIC FEET PER SECOND

RECEIVED

PERIOD OF USE: YEAR ROUND

JAN 13 2023

DATE OF PRIORITY: FEBRUARY 5, 2001

OWRD

AUTHORIZED POINTS OF APPROPRIATION:

Twp	Rng	Mer	Sec	Q-Q	Measured Distances
18 S	12 W	WM	23	NW SE	WELL 8 - 2930 FEET SOUTH AND 1455 FEET WEST FROM THE NE CORNER OF SECTION 23
18 S	12 W	WM	23	SW NE	WELL 9 - 1920 FEET SOUTH AND 1450 FEET WEST FROM THE NE CORNER OF SECTION 23
18 S	12 W	WM	23	SW NE	WELL 10 - 1515 FEET SOUTH AND 1505 FEET WEST FROM THE NE CORNER OF SECTION 23
18 S	12 W	WM	23	NW NE	WELL 11 - 905 FEET SOUTH AND 1435 FEET WEST FROM THE NE CORNER OF SECTION 23
18 S	12 W	WM	23	NW NE	WELL 12 - 300 FEET SOUTH AND 1425 FEET WEST FROM THE NE CORNER OF SECTION 23
18 S	12 W	WM	23	NW NE	WELL 13 - 1490 FEET SOUTH AND 2080 FEET WEST FROM THE NE CORNER OF SECTION 23

AUTHORIZED PLACE OF USE:

MUNICIPAL USE
WITHIN THE SERVICE AREA BOUNDARY OF THE CITY OF FLORENCE

The combined quantity of water diverted at the new point of appropriation (Well 13), together with that diverted at the old points of appropriation (Wells 8, 9, 10, 11, and 12), shall not exceed the quantity of water lawfully available at the original points of appropriation (Wells 8, 9, 10, 11, and 12).

Water shall be acquired from the same aquifer as the original points of appropriation (Wells 8, 9, 10, 11, and 12).

Measurement, recording and reporting conditions:

- A. Before water use may begin under this permit, the permittee shall install a meter or other suitable measuring device as approved by the Director. The permittee shall maintain the meter or measuring device in good working order, shall keep a complete record of the amount of water used each month and shall submit a report which includes the recorded water use measurements to the Department annually or more frequently as may be required by the Director. Further, the Director may require the permittee to report general water use information, including the place and nature of use of water under the permit.
- B. The permittee shall allow the watermaster access to the meter or measuring device; provided however, where the meter or measuring device is located within a private structure, the watermaster shall request access upon reasonable notice.

Within THREE years of permit issuance, the permittee shall submit a Water Management and Conservation Plan consistent with OAR Chapter 690, Division 86. The Director may approve an extension of this timeline to complete the required Water Management and Conservation Plan.

The City of Florence shall submit an updated Water Management and Conservation Plan no later than **April 9, 2020**, and shall submit a progress report containing the information required under OAR 690-086-0120(4) by **April 9, 2015**.

Mitigation Condition #1: During the period October 16 through October 31 of each year after this permit is first exercised, the City will deliver to the wetlands adjacent to Munsel Creek the equivalent of 26% of the average pumping rate under this permit for the previous June, July, August, and September.

Mitigation Condition #2: Any time this permit is being exercised, all clarified backwash water from the City's water treatment plant will be diverted to wetlands adjacent to Munsel Creek.

Nothing in this permit shall be construed to allow any person to trespass on the lands of another person.

RECEIVED

JAN 13 2023

OWRD

STANDARD CONDITIONS

If substantial interference with a senior water right occurs due to withdrawal of water from any well listed on this permit, then use of water from the well(s) shall be discontinued or reduced and/or the schedule of withdrawal shall be regulated until or unless the Department approves or implements an alternative administrative action to mitigate the interference. The Department encourages junior and senior appropriators to jointly develop plans to mitigate interferences.

The wells shall be constructed in accordance with the General Standards for the Construction and Maintenance of Water Wells in Oregon. The works shall be equipped with a usable access port, and may also include an air line and pressure gauge adequate to determine water level elevation in the well at all times.

The use shall conform to such reasonable rotation system as may be ordered by the proper state officer.

Prior to receiving a certificate of water right, the permit holder shall submit the results of a pump test meeting the department's standards, to the Water Resources Department. The Director may require water level or pump test results every ten years thereafter.

Failure to comply with any of the provisions of this permit may result in action including, but not limited to, restrictions on the use, civil penalties, or cancellation of the permit.

This permit is for the beneficial use of water without waste. The water user is advised that new regulations may require the use of best practical technologies or conservation practices to achieve this end.

By law, the land use associated with this water use must be in compliance with statewide land-use goals and any local acknowledged land-use plan.

The use of water shall be limited when it interferes with any prior surface or ground water rights.

The Director finds that the proposed use of water described by this permit, as conditioned, will not impair or be detrimental to the public interest.

Complete application of the water to the use shall be made on or before October 1, 2025. If the water is not completely applied before this date, and the permittee wishes to continue development under the permit, the permittee must submit an application for extension of time, which may be approved based upon the merit of the application.

Within one year after complete application of water to the proposed use, the permittee shall submit a claim of beneficial use, which includes a map and report, prepared by a Certified Water Right Examiner (CWRE).

Issued January 19, 2012

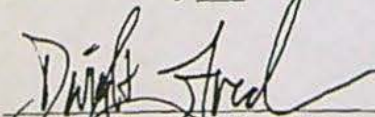

Dwight French, Water Right Services Administrator, for
PHILLIP C. WARD, DIRECTOR

Application G-15295/T-11282.pks

Water Resources Department

RECEIVED

JAN 13 2023

OWRD

PERMIT G-16885

Land Use Information Form



Oregon Water Resources Department
725 Summer Street NE, Suite A
Salem, Oregon 97301-1266
(503) 986-0900
www.oregon.gov/OWRD

NOTE TO APPLICANTS

In order for your application to be processed by the Water Resources Department (WRD), this Land Use Information Form must be completed by a local government planning official in the jurisdiction(s) where your water right will be used and developed. The planning official may choose to complete the form while you wait, or return the receipt stub to you. Applications received by WRD without the Land Use Form or the receipt stub will be returned to you. Please be aware that your application will not be approved without land use approval.

This form is NOT required if:

- 1) Water is to be diverted, conveyed, and/or used only on federal lands; OR
- 2) The application is for a water right transfer, allocation of conserved water, exchange, permit amendment, or ground water registration modification, and all of the following apply:
 - a) The existing and proposed water use is located entirely within lands zoned for exclusive farm-use or within an irrigation district;
 - b) The application involves a change in place of use only;
 - c) The change does not involve the placement or modification of structures, including but not limited to water diversion, impoundment, distribution facilities, water wells and well houses; and
 - d) The application involves irrigation water uses only.

NOTE TO LOCAL GOVERNMENTS

The person presenting the attached Land Use Information Form is applying for or modifying a water right. The Water Resources Department (WRD) requires its applicants to obtain land-use information to be sure the water rights do not result in land uses that are incompatible with your comprehensive plan. Please complete the form or detach the receipt stub and return it to the applicant for inclusion in their water right application. You will receive notice once the applicant formally submits his or her request to the WRD. The notice will give more information about WRD's water rights process and provide additional comment opportunities. You will have 30 days from the date of the notice to complete the land-use form and return it to the WRD. If no land-use information is received from you within that 30-day period, the WRD may presume the land use associated with the proposed water right is compatible with your comprehensive plan. Your attention to this request for information is greatly appreciated by the Water Resources Department. If you have any questions concerning this form, please contact the WRD's Customer Service Group at 503-986-0801.

RECEIVED

JAN 13 2023

OWRD

Land Use Information Form

OREGON



WATER RESOURCES
DEPARTMENT

Oregon Water Resources Department
725 Summer Street NE, Suite A
Salem, Oregon 97301-1266
(503) 986-0900
www.oregon.gov/OWRD

Applicant(s): City of Florence ATTN: Mike Miller

Mailing Address: 250 HWY 101

City: Florence

State: OR

Zip Code: 97439

Daytime Phone: 541-571-3847

A. Land and Location

Please include the following information for all tax lots where water will be diverted (taken from its source), conveyed (transported), and/or used or developed. Applicants for municipal use, or irrigation uses within irrigation districts may substitute existing and proposed service-area boundaries for the tax-lot information requested below.

Township	Range	Section	¼ ¼	Tax Lot #	Plan Designation (e.g., Rural Residential/RR-5)	Water to be:	Proposed Land Use:
18S	12W	23	SWNE	102	Parks & Open Space	<input checked="" type="checkbox"/> Diverted <input checked="" type="checkbox"/> Conveyed <input checked="" type="checkbox"/> Used	Municipal

List all counties and cities where water is proposed to be diverted, conveyed, and/or used or developed:

City of Florence

B. Description of Proposed Use

Type of application to be filed with the Water Resources Department:

- ☐ Permit to Use or Store Water ☐ Water Right Transfer ☒ Permit Amendment or Ground Water Registration Modification
☐ Limited Water Use License ☐ Allocation of Conserved Water ☐ Exchange of Water

Source of water: ☐ Reservoir/Pond ☒ Ground Water ☐ Surface Water (name) _____

Estimated quantity of water needed: 3.0 ☒ cubic feet per second ☐ gallons per minute ☐ acre-feet

Intended use of water: ☐ Irrigation ☐ Commercial ☐ Industrial ☐ Domestic for _____ household(s)
☒ Municipal ☐ Quasi-Municipal ☐ Instream ☐ Other _____

Briefly describe:

The City of Florence is proposing to add a new well, Well 14, to groundwater permit G-16885. The well will be used for municipal use.

Note to applicant: If the Land Use Information Form cannot be completed while you wait, please have a local government representative sign the receipt at the bottom of the next page and include it with the application filed with the Water Resources Department.

See bottom of Page 3. →

RECEIVED

JAN 13 2023

OWRD

For Local Government Use Only

The following section must be completed by a planning official from each county and city listed unless the project will be located entirely within the city limits. In that case, only the city planning agency must complete this form. This deals only with the local land-use plan. Do not include approval for activities such as building or grading permits.

Please check the appropriate box below and provide the requested information

- ☒ Land uses to be served by the proposed water uses (including proposed construction) are allowed outright or are not regulated by your comprehensive plan. Cite applicable ordinance section(s): FCC 10-22-2
- ☐ Land uses to be served by the proposed water uses (including proposed construction) involve discretionary land-use approvals as listed in the table below. (Please attach documentation of applicable land-use approvals which have already been obtained. Record of Action/land-use decision and accompanying findings are sufficient.) If approvals have been obtained but all appeal periods have not ended, check "Being pursued."

Type of Land-Use Approval Needed (e.g., plan amendments, rezones, conditional-use permits, etc.)	Cite Most Significant, Applicable Plan Policies & Ordinance Section References	Land-Use Approval:	
		<input type="checkbox"/> Obtained <input type="checkbox"/> Denied	<input type="checkbox"/> Being Pursued <input type="checkbox"/> Not Being Pursued
		<input type="checkbox"/> Obtained <input type="checkbox"/> Denied	<input type="checkbox"/> Being Pursued <input type="checkbox"/> Not Being Pursued
		<input type="checkbox"/> Obtained <input type="checkbox"/> Denied	<input type="checkbox"/> Being Pursued <input type="checkbox"/> Not Being Pursued
		<input type="checkbox"/> Obtained <input type="checkbox"/> Denied	<input type="checkbox"/> Being Pursued <input type="checkbox"/> Not Being Pursued
		<input type="checkbox"/> Obtained <input type="checkbox"/> Denied	<input type="checkbox"/> Being Pursued <input type="checkbox"/> Not Being Pursued

Local governments are invited to express special land-use concerns or make recommendations to the Water Resources Department regarding this proposed use of water below, or on a separate sheet.

RECEIVED

JAN 13 2023

OWRD

Name: Clare Kurth Title: Assistant Planner

Signature: Clare Kurth Phone: 541-997-8237 Date: Jan 10 2023

Government Entity: City of Florence

Note to local government representative: Please complete this form or sign the receipt below and return it to the applicant. If you sign the receipt, you will have 30 days from the Water Resources Department's notice date to return the completed Land Use Information Form or WRD may presume the land use associated with the proposed use of water is compatible with local comprehensive plans.

Receipt for Request for Land Use Information

Applicant name: City of Florence ATTN: Mike Miller

City or County: City of Florence Staff contact: Clare Kurth

Signature: Clare Kurth Phone: 541-997-8237 Date: Jan 10 2023

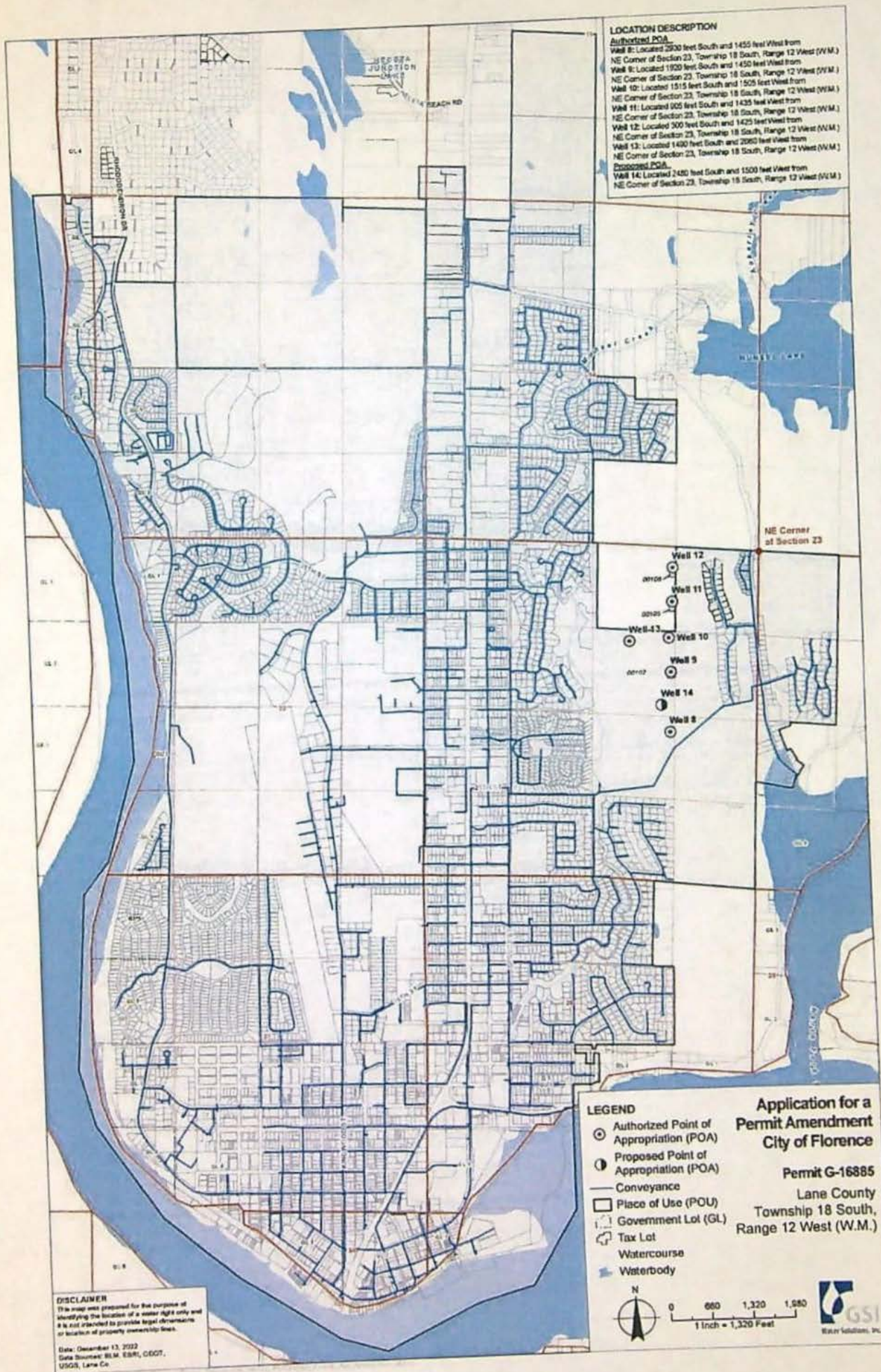

STATE OF OREGON
WATER SUPPLY WELL REPORT
(as required by ORS 537.765)

WELL I.D. # 169478
START CARD # 153272

Instructions for completing this report are on the last page of this form.

(1) LAND OWNER: City of Florence Well Number 10
Name City of Florence
Address P.O. Box 340
City Florence State OR Zip 97439

(2) TYPE OF WORK
☒ New Well ☐ Deepening ☐ Alteration (repair/recondition) ☐ Abandonment

(3) DRILL METHOD:
☐ Rotary Air ☒ Rotary Mud ☐ Cable ☐ Auger
☐ Other

(4) PROPOSED USE:
☐ Domestic ☒ Community ☐ Industrial ☐ Irrigation
☐ Thermal ☐ Injection ☐ Livestock ☐ Other

(5) BORE HOLE CONSTRUCTION:
Special Construction approval ☐ Yes ☒ No Depth of Completed Well 157.95 ft.
Explosives used ☐ Yes ☒ No Type _____ Amount _____

HOLE SEAL
Diameter From To Material From To Sacks or pounds
16" 0 23 Cement 0 23 32
12" 23 158 W/4% Bentonite
How was seal placed: Method ☐ A ☐ B ☒ C ☐ D ☐ E
☐ Other _____
Backfill placed from _____ ft. to _____ ft. Material _____
Gravel placed from _____ ft. to _____ ft. Size of gravel _____

(6) CASING/LINER:
Diameter From To Gauge Steel Plastic Welded Threaded
Casing: 12" 0 154.45 375 ☒ ☐ ☒ ☐
12" 15.25 104.45 375 ☒ ☐ ☒ ☐
12" 152.95 157.95 375 ☒ ☐ ☒ ☐
Liner: _____
Drive Shoe used ☐ Inside ☐ Outside ☐ None
Final location of shoe(s) _____

(7) PERFORATIONS/SCREENS:
☐ Perforations Method _____
☒ Screens Type "V" Wire Material 304SS
From To Slot size Number Diameter size Casing Liner
101.45 152.95 208 12" 15 ☒ ☐
152.95 157.95 208 12" 15 ☐ ☐
157.95 157.95 208 12" 15 ☐ ☐

(8) WELL TESTS: Minimum testing time is 1 hour
Well output may fluctuate
☒ Pump ☐ Bailer ☐ Air ☐ Flowing
Yield gal/min Drawdown Drill stem at Time
145 31.64 _____ 1 hr.
248 50.27 _____ 85.5m

Temperature of water 51° Depth Artesian Flow Found _____
Was a water analysis done? ☐ Yes By whom _____
Did any strata contain water not suitable for intended use? ☐ Too little
☐ Salty ☐ Muddy ☐ Odor ☐ Colored ☐ Other _____
Depth of strata: _____

(9) LOCATION OF WELL by legal description:
County Lane Latitude _____ Longitude _____
Township 18S N or S Range 12 W E or W M.
Section 23 SE 1/4 NE 1/4
Tax Lot City Lot _____ Block _____ Subdivision _____
Street Address of Well (or nearest address) 28th & Willow
Florence City Well Field

(10) STATIC WATER LEVEL:
57' ft. below land surface. Date 10-7-03
Artesian pressure _____ lb. per square inch Date _____

(11) WATER BEARING ZONES:
Depth at which water was first found 57'
From To Estimated Flow Rate SWL
57' 155 250 gpm 57

(12) WELL LOG:
Ground Elevation _____
Material From To SWL
Sand-brown 0 40 _____
Sand-Dk brown 40 60 57
Wood-Tree 60 84 _____
Wood-Sand 84 105 _____
Wood Particles-Sand 105 155 _____
Clay blue Gray 155 157.9 _____
Cement Plug 154.45 to 157.95
Stainless Plate w/ 1" hole @ 151.95
RECEIVED
MAR 30 2004
WATER RESOURCES DEPT
Date started 7-14-03 Completed 3/16/04

(unbonded) Water Well Constructor Certification:
I certify that the work I performed on the construction, alteration, or abandonment of this well is in compliance with Oregon water supply well construction standards. Materials used and information reported above are true to the best of my knowledge and belief.
WWC Number _____
Signed _____ Date _____

(bonded) Water Well Constructor Certification:
I accept responsibility for the construction, alteration, or abandonment work performed on this well during the construction dates reported above. All work performed during this time is in compliance with Oregon water supply well construction standards. This report is true to the best of my knowledge and belief.
Signed Paul Christensen WWC Number 636
Date 3-26-04

STATE OF OREGON
WATER SUPPLY WELL REPORT
(as required by ORS 537.765)

WELL I.D. # L69479
START CARD # 153274

Instructions for completing this report are on the last page of this form.

(1) LAND OWNER Well Number 11
Name City of Florence
Address P.O. Box 340
City Florence State OR Zip 97439

(2) TYPE OF WORK
☒ New Well ☐ Deepening ☐ Alteration (repair/recondition) ☐ Abandonment

(3) DRILL METHOD:
☐ Rotary Air ☒ Rotary Mud ☐ Cable ☐ Auger
☐ Other

(4) PROPOSED USE:
☐ Domestic ☒ Community ☐ Industrial ☐ Irrigation
☐ Thermal ☐ Injection ☐ Livestock ☐ Other

(5) BORE HOLE CONSTRUCTION:
Special Construction approval ☐ Yes ☒ No Depth of Completed Well 165 ft.
Explosives used ☐ Yes ☒ No Type _____ Amount _____

HOLE		SEAL	
Diameter	From To	Material	From To
16"	0 22	Cement	0 22
12"	22 165	48 Portland	

How was seal placed: Method ☐ A ☐ B ☒ C ☐ D ☐ E
☐ Other

Backfill placed from _____ ft. to _____ ft. Material _____
Gravel placed from _____ ft. to _____ ft. Size of gravel _____

(6) CASING/LINER:

Diameter	From	To	Gauge	Steel	Plastic	Welded	Threaded
Casing: 12"	0	4	375	<input checked="" type="checkbox"/>	<input type="checkbox"/>	<input checked="" type="checkbox"/>	<input type="checkbox"/>
12"	4	113	375	<input checked="" type="checkbox"/>	<input type="checkbox"/>	<input checked="" type="checkbox"/>	<input type="checkbox"/>
12"	113.8	165	375	<input checked="" type="checkbox"/>	<input type="checkbox"/>	<input checked="" type="checkbox"/>	<input type="checkbox"/>

Liner: _____
Drive Shoe used ☐ Inside ☐ Outside ☐ None
Final location of shoe(s) _____

(7) PERFORATIONS/SCREENS:

☐ Perforations Method _____
☒ Screens Type "V" Wire Material 304 SS

From	To	Slot size	Number	Diameter	Tele/pipe size	Casing	Liner
107.3	158.8	.008		12"	PS	<input checked="" type="checkbox"/>	<input type="checkbox"/>

Well output may fluctuate

(8) WELL TESTS: Minimum testing time is 1 hour

Yield gal/min	Drawdown	Drill stem at	Flowing Time
144	47.25		1 hr.
204	71.8		5.5

Temperature of water 50° Depth Artesian Flow Found _____

Was a water analysis done? ☐ Yes By whom _____

Did any strata contain water not suitable for intended use? ☐ Too little

☐ Salty ☐ Muddy ☐ Odor ☐ Colored ☐ Other _____

Depth of strata: _____

(9) LOCATION OF WELL by legal description:

County Lane Latitude _____ Longitude _____
Township 18S N or S Range 12W E or W M.
Section 23 SE 1/4 NE 1/4
Tax Lot City Lot _____ Block _____ Subdivision _____
Street Address of Well (or nearest address) Florence City Well Fk. 28th + Willow

(10) STATIC WATER LEVEL:

44 ft. below land surface. Date 11-18-03
Artesian pressure _____ lb. per square inch Date _____

(11) WATER BEARING ZONES:

Depth at which water was first found _____

From	To	Estimated Flow Rate	SWL
44	161	210	44

(12) WELL LOG:

Material	From	To	SWL
Sand-Tan w/roots	0	51	
Sand-Tan	51	64	44
Wood-bts of IT	64	91	
Sand-Wood	91	121	
Sand-dark w/wood	121	161	
Clay-blue black	161	165	

Cement Plug 162.5 to 165
Stainless Plate w/1" hole @ 165'

RECEIVED
MAR 30 2004
WATER RESOURCES DEPARTMENT
SALEM, OREGON
JAN 13 2003
OWRD

Date started 7-25-03 Completed 3-16-04

(unbonded) Water Well Constructor Certification:

I certify that the work I performed on the construction, alteration, or abandonment of this well is in compliance with Oregon water supply well construction standards. Materials used and information reported above are true to the best of my knowledge and belief.

WWC Number _____
Signed _____ Date _____

(bonded) Water Well Constructor Certification:

I accept responsibility for the construction, alteration, or abandonment work performed on this well during the construction dates reported above. All work performed during this time is in compliance with Oregon water supply well construction standards. This report is true to the best of my knowledge and belief.

WWC Number 636
Signed Paul Christensen Date 3-26-04

Christensen Well Drilling Co.

STATE OF OREGON
WATER SUPPLY WELL REPORT
(as required by ORS 537.765)

Instructions for completing this report are on the last page of this form.

WELL I.D. # L69480
START CARD # 153275

(1) LAND OWNER _____ Well Number 12
 Name City of Florence
 Address P.O. Box 340
 City Florence State OR Zip 97439

(2) TYPE OF WORK
☒ New Well ☐ Deepening ☐ Alteration (repair/recondition) ☐ Abandonment

(3) DRILL METHOD: ☐ Rotary Air ☒ Rotary Mud ☐ Cable ☐ Auger
☐ Other

(4) PROPOSED USE:

☐ Domestic ☒ Community ☐ Industrial ☐ Irrigation

☐ Thermal ☐ Injection ☐ Livestock ☐ Other _____

(5) BORE HOLE CONSTRUCTION:
Special Construction approval ☐ Yes ☒ No Depth of Completed Well 194 ft
Explosives used ☐ Yes ☒ No Type _____ Amount _____

HOLE			SEAL			Sacks or pounds
Diameter	From	To	Material	From	To	
16"	0	24	Cement 4% Bentonite	0	24	24
12"	24	194				

How was seal placed: Method ☐ A ☐ B ☒ C ☐ D ☐ E

☐ Other

Backfill placed from _____ ft. to _____ ft. Material _____
Gravel placed from _____ ft. to _____ ft. Size of gravel _____

(6) CASING/LINER:								
	Diameter	From	To	Gauge	Steel	Plastic	Welded	Threaded
Casing:	12"	41	43	375	<input checked="" type="checkbox"/>	<input type="checkbox"/>	<input checked="" type="checkbox"/>	<input type="checkbox"/>
	12"	43	47	375	<input checked="" type="checkbox"/> 85	<input type="checkbox"/>	<input checked="" type="checkbox"/>	<input type="checkbox"/>
	12"	48	49	375	<input checked="" type="checkbox"/> 56	<input type="checkbox"/>	<input checked="" type="checkbox"/>	<input type="checkbox"/>
					<input type="checkbox"/>	<input type="checkbox"/>	<input type="checkbox"/>	<input type="checkbox"/>
Liner:					<input type="checkbox"/>	<input type="checkbox"/>	<input type="checkbox"/>	<input type="checkbox"/>
					<input type="checkbox"/>	<input type="checkbox"/>	<input type="checkbox"/>	<input type="checkbox"/>

Drive Shoe used ☐ Inside ☐ Outside ☐ None
Final location of shoe(s) _____

(7) PERFORATIONS/SCREENS:

<input type="checkbox"/> Perforations	Method	
<input checked="" type="checkbox"/> Screens	Type	"V" WIRE
	Material	304 SS

From	To	Slot size	Number	Diameter	Tele/pipe size	Casing	Liner
137.2	188.8	.008		12"	P5	<input checked="" type="checkbox"/>	<input type="checkbox"/>
						<input type="checkbox"/>	<input type="checkbox"/>
						<input type="checkbox"/>	<input type="checkbox"/>
						<input type="checkbox"/>	<input type="checkbox"/>

(8) WELL TESTS: Minimum testing time is 1 hour

<input checked="" type="checkbox"/> Pump	<input type="checkbox"/> Bailor	<input type="checkbox"/> Air	<input type="checkbox"/> Flowing <input type="checkbox"/> Artesian
Yield gal/min	Drawdown	Drill stem at	Time
184	41.35		1 hr.
344	71.5		7 hr

Temperature of water 50° Depth Artesian Flow Found _____

Was a water analysis done? ☐ Yes By whom _____

Did any strata contain water not suitable for intended use? ☐ Too little

☐ Salty ☐ Muddy ☐ Odor ☐ Colored ☐ Other _____

Depth of strata: _____

(9) LOCATION OF WELL by legal description:
County Lanc Latitude _____ Longitude _____
Township 18S N or S Range 12W E or W WM.
Section 23 SE 1/4 NE 1/4
Tax Lot City Lot _____ Block _____ Subdivision _____
Street Address of Well (or nearest address) 38th + Willow
Florence City Well Field

(10) STATIC WATER LEVEL:
63 ft. below land surface. Date 10-29-03
 Artesian pressure _____ lb. per square inch Date _____

(11) WATER BEARING ZONES:
Depth at which water was first found 63

From	To	Estimated Flow Rate	SWL
63	188	340 gpm	

(12) WELL LOG:
Ground Elevation _____

Material	From	To	SWL
Sand-Tan	0	11	
Sand-w/wood	11	43	
Sand-Tan	43	118	
Sand-w/wood	118	148	
Sand, Drk-w/Heavy wood	148	161	
Sand-Drk blue	161	192	
Clay-Blue	192	194	

RECEIVED

JAN 13 2023

OWRD

Center Pile - 192' to 194'
Stainless Steel plate w/ 1" hole @ 194'
MAR 30 2004
WATER RESOURCES DEPT
SALEM, OREGON

Date started 7-25-03 Completed 3-16-04

(unbonded) Water Well Constructor Certification:

I certify that the work I performed on the construction, alteration, or abandonment of this well is in compliance with Oregon water supply well construction standards. Materials used and information reported above are true to the best of my knowledge and belief.

Signed _____ WWC Number _____
Date _____

(bonded) Water Well Constructor Certification:

I accept responsibility for the construction, alteration, or abandonment work performed on this well during the construction dates reported above. All work performed during this time is in compliance with Oregon water supply well construction standards. This report is true to the best of my knowledge and belief.

Signed: Todd Christensen WWC Number 636
Chimer Date 3-26-04

LANE 71033

Lane 71033

STATE OF OREGON
WATER SUPPLY WELL REPORT
(as required by ORS 537.765)

WELL I.D. # 1. 102232

START CARD # 207005

Instructions for completing this report are on the last page of this form.

(1) LAND OWNER Well Number 13
Name City of Florence
Address 250 Hwy 101
City Florence State OR Zip 97439

(2) TYPE OF WORK ☒ New Well
☐ Deepening ☐ Alteration (repair/recondition) ☐ Abandonment ☐ Conversion

(3) DRILL METHOD
☐ Rotary Air ☒ Rotary Mud ☐ Cable ☐ Auger ☐ Cable Mud
☐ Other _____

(4) PROPOSED USE
☐ Domestic ☒ Community ☐ Industrial ☐ Irrigation
☐ Thermal ☐ Injection ☐ Livestock ☐ Other _____

(5) BORE HOLE CONSTRUCTION Special Construction: ☐ Yes ☒ No
Depth of Completed Well 130 ft
Explosives used: ☐ Yes ☒ No Type _____ Amount _____

BORE HOLE			SEAL			Sacks or Pounds
Diameter	From	To	Material	From	To	
18"	0	19	cement	0	19	16 sacks
14"	19	130	with 4% bentonite			

How was seal placed: Method ☐ A ☐ B ☒ C ☐ D ☐ E
☐ Other _____

Backfill placed from 130 ft. to 135 ft. Material native sand
Gravel placed from _____ ft. to _____ ft. Size of gravel _____

(6) CASING/LINER

Diameter	From	To	Gauge	Steel	Plastic	Welded	Threaded
Casing: 12	+2.5	75	.375	<input checked="" type="checkbox"/>	<input type="checkbox"/>	<input checked="" type="checkbox"/>	<input type="checkbox"/>
12	125	130	.375	<input type="checkbox"/>	<input type="checkbox"/>	<input type="checkbox"/>	<input type="checkbox"/>
Liner:				<input type="checkbox"/>	<input type="checkbox"/>	<input type="checkbox"/>	<input type="checkbox"/>

Drive Shoe used ☐ Inside ☐ Outside ☒ None
Final location of shoe(s) _____

(7) PERFORATIONS/SCREENS
☐ Perforations Method _____
☒ Screens Type "V" wire Material SS

From	To	Slot Size	Number	Diameter	Tele/pipe size	Casing	Liner
75	125	.008		12"	pipesize	<input checked="" type="checkbox"/>	<input type="checkbox"/>
						<input type="checkbox"/>	<input type="checkbox"/>
						<input type="checkbox"/>	<input type="checkbox"/>

(8) WELL TESTS: Minimum testing time is 1 hour
☒ Pump ☐ Bailer ☐ Air ☐ Flowing Artesian

Yield gal/min	Drawdown	Drill stem at	Time
415	55.85		6 hours
well output	may fluctuate		

Temperature of water 50 Depth Artesian Flow Found _____
Was a water analysis done? ☐ Yes By whom _____
Did any strata contain water not suitable for intended use? ☐ Too little
☐ Salty ☐ Muddy ☐ Odor ☐ Colored ☐ Other _____
Depth of strata: _____

(9) LOCATION OF WELL (legal description)

County Lane
Tax Lot City of Florence - city lot Lot city lot
Township 18 S Range 12 W WM
Section 23 NW 1/4 NE 1/4
Lat _____ " or _____ (degrees or decimal)
Long _____ " or _____ (degrees or decimal)

Street Address of Well (or nearest address) 28th & Willow - Florence City
Well Field _____

(10) STATIC WATER LEVEL

9 ft. below land surface. Date 03-31-11
_____ ft. below land surface. Date _____
Artesian pressure _____ lb. per square inch Date _____

(11) WATER BEARING ZONES

From	To	Estimated Flow Rate	SWL
25	125	400 gpm	9

(12) WELL LOG

Material	From	To	SWL
sand, yellow	0	17	9
sand, brownish yellow w/wood	17	40	9
sand, blue gray w/wood	40	43	9
sand, blue gray	43	88	9
sand, grayish tan w/wood	88	107	9
sand, gray	107	120	9
sand, blue gray	120	125	9
clay, gray, sandy w/shells	125	135	9

RECEIVED

JAN 13 2023

OWRD

RECEIVED

MAY 8 2011

Date Started 03-15-11 Completed 03-31-11 WATER RESOURCES DEPT

(unbonded) Water Well Constructor Certification

I certify that the work I performed on the construction, deepening, alteration, or abandonment of this well is in compliance with Oregon water supply well construction standards. Materials used and information reported above are true to the best of my knowledge and belief.

WWC Number 1886 Date _____

Signed _____

(bonded) Water Well Constructor Certification

I accept responsibility for the construction, deepening, alteration, or abandonment work performed on this well during the construction dates reported above. All work performed during this time is in compliance with Oregon water supply well construction standards. This report is true to the best of my knowledge and belief.

WWC Number 636 Date _____Signed Paul Christensen Christensen Well Drilling Co

STATE OF OREGON
WATER RESOURCES DEPARTMENT

725 Summer St. N.E. Ste. A

SALEM, OR 97301-4172

(503) 986-0900 / (503) 986-0904 (fax)

RECEIPT # **141981**

INVOICE # _____

RECEIVED FROM: 651 Water Solutions
BY: Inc

APPLICATION _____
PERMIT _____
TRANSFER T-14146

CASH: ☐ CHECK: # 26427 OTHER: (IDENTIFY) _____

TOTAL REC'D \$1,632.10

1083 TREASURY 4170 WRD MISC CASH ACCT

0407 COPIES 47124 R 11471-25 \$ _____
0412 OTHER: (IDENTIFY) Transfer Reimbursement Authority \$ 1,632.10

0243 I/S Lease _____ 0244 Muni Water Mgmt. Plan _____ 0245 Cons. Water _____

4270 WRD OPERATING ACCT

MISCELLANEOUS

0407 COPY & TAPE FEES \$ _____
0410 RESEARCH FEES \$ _____
0408 MISC REVENUE: (IDENTIFY) _____ \$ _____
TC162 DEPOSIT LIAB. (IDENTIFY) _____ \$ _____
0240 EXTENSION OF TIME \$ _____

WATER RIGHTS:

0201 SURFACE WATER EXAM FEE \$ _____ 0202 RECORD FEE \$ _____
0203 GROUND WATER \$ _____ 0204 \$ _____

WELL CONSTRUCTION

0218 WELL DRILL CONSTRUCTOR EXAM FEE \$ _____ 0219 LICENSE FEE \$ _____
LANDOWNER'S PERMIT 0220 \$ _____

OTHER (IDENTIFY) _____

0536 TREASURY 0437 WELL CONST. START FEE

0211 WELL CONST START FEE \$ _____ CARD# _____
0210 MONITORING WELLS \$ _____ CARD# _____

OTHER (IDENTIFY) _____

0607 TREASURY 0467 HYDRO ACTIVITY LIC NUMBER

0233 POWER LICENSE FEE (FW/WRD) \$ _____
0231 HYDRO LICENSE FEE (FW/WRD) \$ _____
HYDRO APPLICATION \$ _____

TREASURY OTHER / RDX

FUND _____ TITLE _____

OBJ. CODE _____ VENDOR # _____

DESCRIPTION _____ \$ _____

RECEIPT: **141981**

DATED: 11-27-2023 BY: [Signature]

Distribution - White Copy - Customer, Yellow Copy - Fiscal, Blue Copy - File, Buff Copy - Fiscal

GSI WATER SOLUTIONS INC

Check Date: 11/21/2023

026427

Invoice Number	Date	Voucher	Amount	Discounts	Previous Pay	Net Amount
RA Agreement T-14146	11/20/2023	0022996	1,632.10			1,632.10
Oregon Water Resources Department						
Beneficial Checking 3		00275	1,632.10			1,632.10
		TOTAL				

RECEIVED
NOV 27 2023
OWRD

**REIMBURSEMENT AUTHORITY
APPLICANT'S AGREEMENT**
Contract Number: R11-471-25

RECEIVED

NOV 27 2023

OWRD

This Agreement is between the **Oregon Water Resources Department**, hereafter OWRD, and **City of Florence**, hereafter Applicant, hereafter known together as the parties.

OWRD Information

Contact: **Kelly Starnes**
Title: Transfer Advisor
Address: 725 Summer Street, NE, Suite A
Salem, OR 97301-1266

Phone: 503 979-3511
Fax: 503 986-0901
Email: patrick.k.starnes@water.oregon.gov

Applicant's Information

Name: City of Florence
Contact: Mike Miller
Address: 250 HWY 101
Florence, OR 97439

Phone: (541) 997-4106
Fax:
Email: mike.miller@ci.florence.or.us

Applicant's Representative

Name: GSI Water Solutions, Inc
Contact: Adam Sussman
Address: 1600 SW Western Blvd.
Corvallis, OR 97333

Phone: (541) 257-9001
Fax:
Email: asussman@gsiws.com

Purpose The purpose of this Agreement is to expedite the processing of the **Transfer Application**. (Application Number: T-14146)

1. **Authority.** The OWRD has been authorized pursuant to ORS 536.055 to enter into a voluntary agreement with any applicant, permittee or regulated entity (collectively Applicant) for expediting or enhancing a regulatory process. In making this agreement, OWRD shall require the applicant to pay the full cost of expedited process.
2. **Restrictions.** Applicant and OWRD agree that this Agreement shall not be construed to restrict in any way the decisions and actions by OWRD. OWRD shall be free to exercise independent judgment consistent with existing laws and regulations.
3. **Effective Date and Duration.** Unless otherwise terminated by non-deposit of funds by the Applicant, this Agreement shall become effective on the date on which both parties have signed the Agreement and the full deposit of the estimated cost of the proposed service.
4. **Consideration.**
 - a. Applicant shall pay OWRD in advance for actual costs incurred by OWRD. The estimated maximum reimbursement payable to OWRD under this Agreement is **\$1,632.10**. Applicant agrees to pay the full amount of **\$1,632.10** to OWRD prior to commencement of any work stated in this Agreement. This payment will be placed in an account administered by OWRD and drawn upon as costs are actually incurred. If the actual cost of performing the work is less than payments received, OWRD will refund the unspent balance. If the actual cost of processing exceeds the estimate, the Applicant can either elect to terminate this Agreement or amend the Agreement to reflect the increase in cost.
 - b. The costs stated in this Agreement do not include the statutory application processing and filing fees.
5. **Confidentiality.** Applicant agrees that any information provided to or acquired by OWRD under this Agreement will be subject to the Oregon Public Records Law and shall be considered public records.
6. **Indemnity.** Applicant shall defend, save, hold harmless, and indemnify the State of Oregon, OWRD, and their officers, employees, and agents from and against all claims, suits, actions, losses, damages, liabilities, costs, and expenses of any nature resulting from or arising out of, or relating to the activities of Applicant or its representatives, officers, employees, contractors, or agents under this Agreement or with respect to the expedited service. The Applicant acknowledges that the Oregon Water Resources Department cannot and does not guarantee a favorable review under the subject regulatory process.

7. **Termination.** Applicant may request to terminate this agreement only in writing at anytime during the process. The Applicant agrees to pay for the work done by OWRD up until the time of the written termination request. OWRD, upon receiving such written termination request from the Applicant, will refund any unspent balance.
8. **Funds Authorized and Available.** By its execution of this Agreement, Applicants certify that sufficient funds are authorized and available to cover the expenditures contemplated by this Agreement.
9. **Duration of Estimate.** The Estimate of Time to completion is **approximately** 120 days once this Agreement has been fully executed and payment of the estimated cost deposited. If the Applicant's Agreement is not received by the Department within thirty (30) days of mailing the Agreement, the Applicant may need to re-apply for a new estimate. NOTE: Any time estimate is approximate; No guarantee of Final Order issuance of a date is certain. Duration estimates do not include any statutory waiting periods.
10. **Completion Date.** OWRD, by the execution of this Agreement does not guarantee the completion date indicated in this Agreement. Completion date is only an estimate and may be affected by the Department's workload, issues arising from the processing of the requested services and Applicant's timely response to requests for additional information.
11. **Captions.** The captions or headings in this Agreement are for the convenience only and in no way define, limit, or describe the scope, or intent, of any provision of this Agreement.
12. **Amendment and Merger.** The terms of this Agreement shall not be waived, altered, modified, supplemented, or amended in any manner whatsoever, except by written instrument signed by both parties. Such waiver, consent, modification or change, if made, shall be effective only in the specific instance and for the specific purpose given. There are no understandings, agreements or representations, oral or written, not specified herein regarding this Agreement.
13. **Signatures.** All parties, by the authorized representative's signature below, hereby acknowledge that they have read this Agreement, understand it and agree to be bound by its terms and conditions.

For Applicant: Michael Miller Mike Miller, Public Works Director

Name/Title:

11/7/2023

Date

For OWRD:

Dwight French

Dwight French – Administrator

NOV 29 2023

Date

Mail signed Agreement to:

Elyse Richman
Oregon Water Resources Department
725 Summer Street NE, Suite A
Salem, OR 97301-1266

STATE OF OREGON
WATER RESOURCES DEPARTMENT

RECEIPT # 141821

725 Summer St. N.E. Ste. A
SALEM, OR 97301-4172
(503) 986-0900 / (503) 986-0904 (fax)

INVOICE #

RECEIVED FROM: GSI, Water Solutions, Inc.
BY:

APPLICATION
PERMIT
TRANSFER T-14146

CASH: CHECK: # OTHER: (IDENTIFY)

☒ 26369

TOTAL REC'D \$ 125.00

1083 TREASURY 4170 WRD MISC CASH ACCT

0407 COPIES 47124 R11471-25 \$
0412 OTHER: (IDENTIFY) Transfer R.A. \$125.00

0243 I/S Lease 0244 Muni Water Mgmt. Plan 0245 Cons. Water

4270 WRD OPERATING ACCT

MISCELLANEOUS

0407 COPY & TAPE FEES \$
0410 RESEARCH FEES \$
0408 MISC REVENUE: (IDENTIFY) \$
TC162 DEPOSIT LIAB. (IDENTIFY) \$
0240 EXTENSION OF TIME \$

WATER RIGHTS:

0201 SURFACE WATER EXAM FEE 0202 RECORD FEE \$
0203 GROUND WATER EXAM FEE 0204 RECORD FEE \$
0205 TRANSFER EXAM FEE

WELL CONSTRUCTION

0218 WELL DRILL CONSTRUCTOR EXAM FEE 0219 LICENSE FEE \$
LANDOWNER'S PERMIT 0220 LICENSE FEE \$

OTHER (IDENTIFY)

0536 TREASURY 0437 WELL CONST. START FEE

0211 WELL CONST START FEE \$ CARD#
0210 MONITORING WELLS \$ CARD#

OTHER (IDENTIFY)

0607 TREASURY 0467 HYDRO ACTIVITY LIC NUMBER

0233 POWER LICENSE FEE (FW/WRD) \$
0231 HYDRO LICENSE FEE (FW/WRD) \$
HYDRO APPLICATION \$

TREASURY OTHER / RDX

FUND TITLE

OBJ. CODE VENDOR #

DESCRIPTION \$

RECEIPT: 141821

DATED: 10/30/2023 BY: Lee D. Miller

Distribution - White Copy - Customer, Yellow Copy - Fiscal, Blue Copy - File, Buff Copy - Fiscal

GSI WATER SOLUTIONS INC

Check Date: 10/24/2023

Invoice Number	Date	Voucher	Amount	Discounts	Previous Pay	Net Amount
T-14146 RA Estimate	10/24/2023	0022839	125.00			125.00
Oregon Water Resources Department		TOTAL	125.00			125.00
Beneficial Checking	1	00275				

STATE OF OREGON
WATER RESOURCES DEPARTMENT

RECEIPT # 141821

725 Summer St. N.E. Ste. A
SALEM, OR 97301-4172
(503) 986-0900 / (503) 986-0904 (fax)

INVOICE #

RECEIVED FROM: GSI, Water Solutions, Inc.
BY:

APPLICATION
PERMIT
TRANSFER T-14146

CASH: CHECK: # OTHER: (IDENTIFY)

☒ 26369

TOTAL REC'D \$ 125.00

1083 TREASURY 4170 WRD MISC CASH ACCT

0407 COPIES 47124 R11471-25 \$
0412 OTHER: (IDENTIFY) Transfer R.A. \$125.00

0243 I/S Lease 0244 Muni Water Mgmt. Plan 0245 Cons. Water

4270 WRD OPERATING ACCT

MISCELLANEOUS

0407 COPY & TAPE FEES \$
0410 RESEARCH FEES \$
0408 MISC REVENUE: (IDENTIFY) \$
TC162 DEPOSIT LIAB. (IDENTIFY) \$
0240 EXTENSION OF TIME \$

WATER RIGHTS:

0201 SURFACE WATER EXAM FEE 0202 RECORD FEE \$
0203 GROUND WATER EXAM FEE 0204 RECORD FEE \$
0205 TRANSFER EXAM FEE

WELL CONSTRUCTION

0218 WELL DRILL CONSTRUCTOR EXAM FEE 0219 LICENSE FEE \$
LANDOWNER'S PERMIT 0220 LICENSE FEE \$

OTHER (IDENTIFY)

0536 TREASURY 0437 WELL CONST. START FEE

0211 WELL CONST START FEE \$ CARD#
0210 MONITORING WELLS \$ CARD#

OTHER (IDENTIFY)

0607 TREASURY 0467 HYDRO ACTIVITY LIC NUMBER

0233 POWER LICENSE FEE (FW/WRD) \$
0231 HYDRO LICENSE FEE (FW/WRD) \$
HYDRO APPLICATION \$

TREASURY OTHER / RDX

FUND TITLE

OBJ. CODE VENDOR #

DESCRIPTION \$

RECEIPT: 141821

DATED: 10/30/2023 BY: Lee D. Miller

Distribution - White Copy - Customer, Yellow Copy - Fiscal, Blue Copy - File, Buff Copy - Fiscal

026369

RECEIVED

OCT 30 2023

OWRD
SALEM, OREGON



OREGON WATER RESOURCES DEPARTMENT
TRANSFER REIMBURSEMENT AUTHORITY
ESTIMATE APPLICATION



ORS 536.055 authorizes the Oregon Water Resources Department to expedite or enhance regulatory processes voluntarily requested under the agreement.

Please contact Transfer Staff before submitting this request, as the application fee of \$125.00 per request is non-refundable.

Checks submitted for this application must be separate from Transfer fees.

The purpose of this application is to obtain estimates of the cost and time required to process a Transfer Application Request. There is a non-refundable application fee of \$125.00 per request.

REQUEST	TYPE	FILE NUMBER
<input checked="" type="checkbox"/>	Transfer Application	Transfer Number T-14146

	Applicant Information	Applicant's Representative/Contact
Name:	City of Florence ATTN: Mike Miller	GSI Water Solutions, Inc. ATTN: Adam Sussman
Address:	250 HWY 101	1600 SW Western Boulevard
	Florance, OR 97439	Corvallis, OR 97333
Phone:	541-997-4106	541.257.9001
Fax:		
E-Mail Address:	mike.miller@ci.florence.or.us	asussman@gsiws.com

By signing this application, I understand:

- That upon receipt of my non-refundable application fee of **\$125.00**, OWRD will, within fourteen (14) days, notify me in writing of the estimate of costs and time frame for the expedited service.
- That this fee covers the reimbursement authority staff to evaluate and provide the estimate for processing of the request.
- That upon receiving the estimate, I may agree or decline to enter into a formal contract to pay the estimated cost in advance to initiate the expedited service.
- That an incomplete or inaccurate application may delay the process and increase the cost to process my request.
- That expedited processing does not guarantee a favorable review of my request.

I certify that I am the (check one):

___ Applicant ☒ Applicant's Representative ___ Other (Please specify) ___

Name: Adam Sussman

Signature: _____

Send completed Application and payment to:

Oregon Water Resources Department
Transfer Reimbursement Authority Program
725 Summer St. NE, Suite A
Salem, OR 97301-1271

RECEIVED

OCT 30 2023

OWRD
SALEM OREGON

OWRD USE ONLY: Reimbursement Authority Number: R/11 471 -25



Oregon

Tina Kotek, Governor

Water Resources Department

North Mall Office Building
725 Summer St NE, Suite A
Salem, OR 97301
Phone 503 986-0900
Fax 503 986-0904

January 19, 2023

CITY OF FLORENCE
ATTN MIKE MILLER
250 HWY 101
FLORENCE, OR 97439

Reference: Application T-14146

On January 13, 2023, OWRD received your water right Permit Amendment Application. The application was accompanied by \$1840.00. Our receipt number 139921 is enclosed.

By copy of this letter, we are asking the Watermaster for a report regarding the potential for injury to existing water rights which may be caused by the requested change. A review form will also be sent to our groundwater staff to determine whether the proposed well accesses the same source of water as the original well.

This application may require publication of a notice for two consecutive weeks in a newspaper with general circulation in the area where the water right is located. If it is determined that newspaper notice will be required, the Department will prepare the notice and notify you of the cost. You will be responsible for submitting payment to the Department prior to publication of the notice.

Except as provided under ORS 540.510(3) for municipalities, you may not use water from the new point of appropriation until a final order approving the application has been issued by the Department.

Refer to the following page for a chart showing the steps and expected timelines for the processing of your application.

If you have any questions, please contact the Transfer Section at (503) 979-9931.

Cc: Watermaster Dist. #2, Lanaya F. Blakely (via email)
Zach Pike-urlacher, Agent

Enclosure

Permit Amendment Process

ORS 537.211

Changes: POD/POA, Place of Use

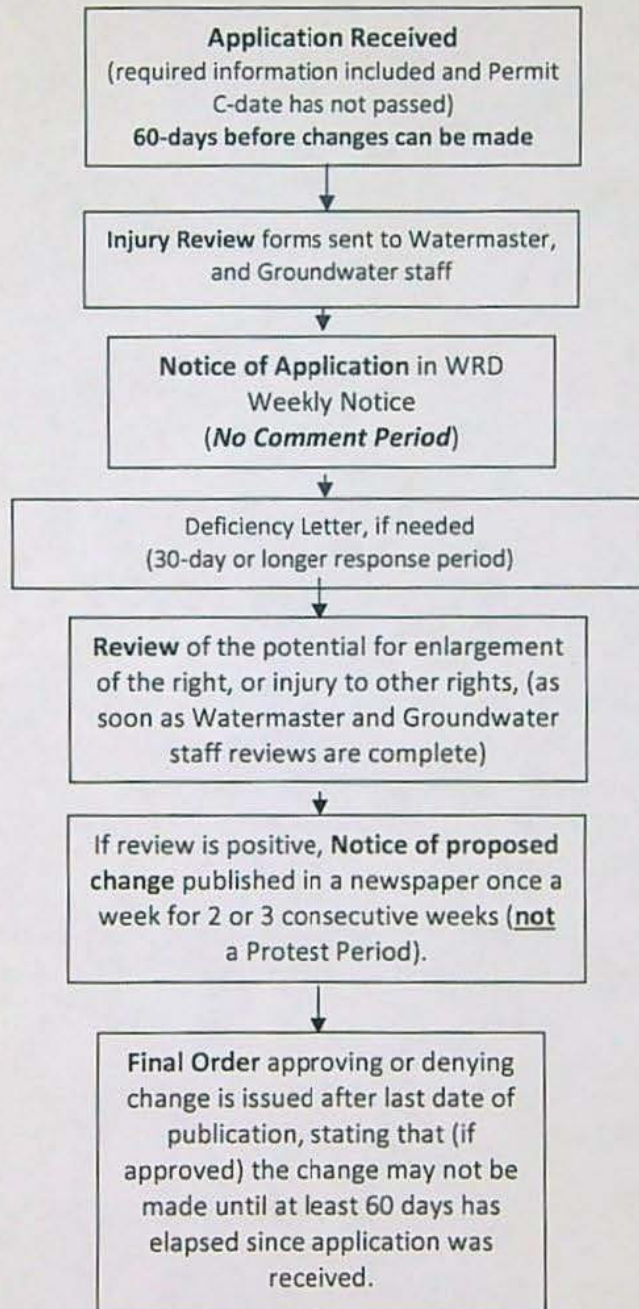



RECEIVED

JAN 13 2023

OWRD

January 11, 2022

Kelly Starnes
Oregon Water Resources Department
725 Summer Street NE, Suite A
Salem, OR 97301

Dear Kelly:

GSI Water Solutions, Inc. (GSI) is submitting the enclosed permit amendment application on behalf of the City of Florence (City). The City is proposing to add an additional point of appropriation (Well 14) to Permit G-16885.

The permit amendment application and a check in the amount of \$1,840 for the application fee are enclosed. If you have any questions regarding this application, you can reach me at 541-753-0933.

Sincerely,

A handwritten signature in blue ink that reads "Zach Pike-Urlacher". The signature is written in a cursive, flowing style.

Zach Pike-Urlacher
Water Resources Consultant

CC: Mike Miller, City of Florence

Enclosures: Permit Amendment Application
Check in amount of \$1,840

Permit Amendment Application Checklist

Checked by Aela

Date 1/17/23

App # G-15295

Permit # G-16885

Permit Amendments are authorized for changes in POD/POA, APOD/APOA, or POU.

(If OK, check box to left; if not, fill in the blank)

- ☒ 1. Is the name of the Permit Amendment applicant the same as the Water Right Permit holder(s) of record?

If not, one of the following must be included with the application:

- ___ a) An affidavit of consent from all Permit holder(s) or the other Permit holders that have not signed the Permit Amendment application form, consenting to the proposed Permit Amendment application; OR,
- ___ b) A completed Request for Assignment form (and statutory fee) to move all (or portion) of the permit into the Permit Amendment applicant's name.

If not, what is missing? _____

- ☒ 2. Page 1 of application: Are all attachments that have been checked actually included?

If not, what is missing? _____

- ☒ 3. Are fees included and correct? Fee Paid: 1840

If not, the correct fee would be: _____, so the amount missing is: _____

- ☒ 4. Part 4 of application: Have all the applicants listed at the top of the page signed at the bottom?

If not, whose signature is missing? _____

- ☒ 5. Are the Permit completion date(s) current? 2025

If the Permit completion date has expired, we **CANNOT** accept the application.

- ☒ 6. If all #1-#5 boxes on this checklist are checked (with no remaining deficiencies identified), accept the application. Put this check sheet in the transfer folder.

If #1, #2, #3, #4 or #5 on this checklist is deficient, the application **CANNOT** be accepted.

It should be returned and the deficiencies listed in the "staff" section at the bottom of Application Page 1, unless the applicant or agent can resolve the deficiencies within 2-3 days.