

## Permit Amendment

RA

Name City of Echo  
Attn: David Slaght, Administrator  
Address PO Box 9  
Echo, OR 97826  
dave@echo-oregon.com

## DESCRIPTION OF WATER RIGHT(S)

Name of Stream A WellTrib. of Umatilla River ; Unnamed StreamUse Municipal UsesCounty Umatilla

Quantity of water (CFS)

No. of Acres

Name of ditch

App# G-8865Per # A-18545

Cert #

PR Date 6/21/1978

App#

Per #

Cert #

PR Date

App#

Per #

Cert #

PR Date

App#

Per #

Cert #

PR Date

App#

Per #

Cert #

PR Date

Change in APDA  
Date Filed 6-30-2023  
Initial notice date 7-11-2023  
DPD issued date  
PD issued date  
PD notice date  
Date of FO 8/12/2024 Vol 131 Page 879-881

C-Date  
COBU due date  
COBU Received date  
Certificate issued

Assignments:

Irrigation District

Agent Ted Ressler ; Summit Water Resources - tressler@summitwr.com

CWRE

CC's list City of Stanfield ; City of Echo☐ - Oversized map - Location

## FEES PAID

Date	Amount	Receipt #
<u>6/30/23</u>	<u>\$1,840.00</u>	<u>141053</u>
<u>6/30/23</u>	<u>\$125.02</u>	<u>141054</u>
<u>8/9/23</u>	<u>\$1,839.65</u>	<u>141346</u>

## FEES REFUNDED

Date	Amount	Receipt #
------	--------	-----------





# Oregon

Tina Kotek, Governor

## Water Resources Department

North Mall Office Building

725 Summer St NE, Suite A

Salem, OR 97301

Phone 503 986-0900

Fax 503 986-0904

August 12, 2024

City of Echo  
Attn: David Slaughter  
PO Box 669  
Echo, OR 97826

REFERENCE: Permit Amendment Application T-14270

Enclosed is a copy of the order approving your Permit Amendment application.

Also enclosed is a superseding permit that incorporates the amendments approved by the final order contained herein. Please read this document and abide by the requirements.

If you have any questions related to the approval of this permit amendment, you may contact your caseworker, Dante Luongo, by telephone at (971) 304-5006 or by e-mail at [Dante.j.luongo@water.oregon.gov](mailto:Dante.j.luongo@water.oregon.gov).

Sincerely,

Elyse D. Richman  
Water Rights Services Support  
Transfers and Conservation Section

cc: Gregory M. Silbernagel, Watermaster Dist. # 5 (via email)  
Ted Ressler, Agent  
City of Stanfield, Local Government  
Enclosure



BEFORE THE WATER RESOURCES DEPARTMENT  
OF THE  
STATE OF OREGON

In the Matter of Permit Amendment	)	FINAL ORDER
T-14270, Umatilla County	)	APPROVING AN ADDITIONAL POINT OF
	)	APPROPRIATION

**Authority**

Oregon Revised Statute (ORS) 537.211 establishes the process in which a water right permit holder may submit a request to change the point of appropriation and/or place of use authorized under an existing water right permit.

**Applicant**

CITY OF ECHO  
ATTN: DAVID SLAGHT, CITY ADMINISTRATOR  
PO BOX 669  
ECHO, OR 97826

**Findings of Fact**

1. On May 12, 1982, the Department approved an extension of time under Permit G-8546 for complete application of water to October 1, 1985.
2. On March 21, 1986, the Department approved an extension of time under Permit G-8546 for complete application of water to October 1, 1990.
3. On March 31, 1991, the Department approved an extension of time under Permit G-8546 for complete application of water to October 1, 1995.
4. On November 9, 1995, the Department approved an extension of time under Permit G-8546 for complete application of water to October 1, 2000.
5. On August 3, 2006, the Department approved an extension of time under Permit G-8546 for complete application of water to October 1, 2028.
6. On October 6, 2021, the Department issued a Final Order for T-13270, recorded at Special Order Volume 121, Pages 749-751, for additional points of appropriation under Permit G-8546. The Department subsequently issued Permit G-18545 describing the changes.

This is a final order in other than contested case. This order is subject to judicial review under ORS 183.484. Any petition for judicial review must be filed within the 60 day time period specified by ORS 183.484(2). Pursuant to ORS 536.075 and OAR 137-004-0080 you may either petition for judicial review or petition the Director for reconsideration of this order. A petition for reconsideration may be granted or denied by the Director, and if no action is taken within 60 days following the date the petition was filed, the petition shall be deemed denied.



7. On June 30, 2023, CITY OF ECHO, ATTN: DAVID SLAGHT, CITY ADMINISTRATOR filed an application for an additional point of appropriation under Permit G-18545. The Department assigned the application number T-14270.
8. Notice of the application for the permit amendment was published in the Department's weekly notice on July 7, 2023, and in the East Oregonian newspaper on June 22 and June 29, 2024, pursuant to ORS 540.520(5).
9. Permit Amendment Application T-14270 proposes an additional point of appropriation with approximate distances from the existing points of appropriation as follows:

Twp	Rng	Mer	Sec	Q-Q	Measured Distances	Approximate distance from the authorized points of appropriation
3 N	29 E	WM	5	SE SE	STANFIELD WELL 5 - 877 FEET NORTH AND 233 FEET WEST FROM THE SE CORNER OF SECTION 5	WELL 2 - 9,000 FEET Northwest WELL 4 - 9,050 FEET Northwest WELL 6A - 4,350 FEET Northwest WELL 6B - 3,500 FEET Northwest

***Permit Amendment Review Criteria***

10. The change, as conditioned, would not result in injury to other water rights.
11. The change, as conditioned, does not enlarge the permit.
12. The change does not alter any other terms of the permit.

**Conclusions of Law**

The additional point of appropriation proposed by Permit Amendment Application T-14270 is consistent with the requirements of ORS 537.211.

**Now, therefore, it is ORDERED:**

1. The additional point of appropriation proposed by Permit Amendment Application T-14270 is approved.
2. Approval of this permit amendment application does not constitute nor grant legal access onto or through another person's property for purposes of accessing the new point of appropriation.
3. Permit G-18897, in the name of CITY OF ECHO, is issued to replace Permit G-18545, and incorporates the amendments approved by this order. Permit G-18545, in the name of CITY OF ECHO, is no longer of any force or effect.



4. The combined quantity of water diverted at the new additional point of appropriation (Stanfield Well 5), together with that diverted at the original points of appropriation (Well 2, Well 4, Well 6A, and Well 6B), shall not exceed the quantity of water lawfully available at the original points of appropriation (Well 2, Well 4, Well 6A, and Well 6B).
5. Water use measurement conditions:
  - a. Before water use may begin under this order, the water user shall install a totalizing flow meter, or, with prior approval of the Director, another suitable measuring device, at each point of appropriation (new and existing).
  - b. The water user shall maintain the meters or measuring devices in good working order.
  - c. The water user shall allow the Watermaster access to the meters or measuring devices; provided however, where the meters or measuring devices are located within a private structure, the Watermaster shall request access upon reasonable notice.
6. Water shall be acquired from the same aquifer as the original points of appropriation.
7. All other terms and conditions of Permit G-18897 remain the same.

Dated in Salem, Oregon on **AUG 12 2024**

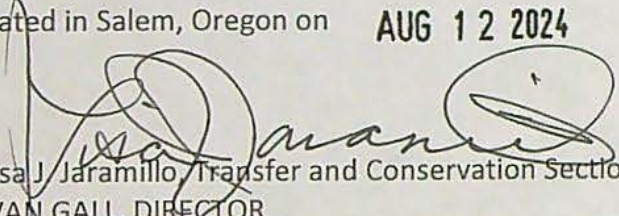
  
Lisa J. Jaramillo, Transfer and Conservation Section Manager, for  
IVAN GALL, DIRECTOR  
Oregon Water Resources Department

Mailing Date: **AUG 13 2024**



STATE OF OREGON

COUNTY OF UMATILLA

PERMIT TO APPROPRIATE THE PUBLIC WATERS

THIS PERMIT IS HEREBY ISSUED TO

CITY OF ECHO

PO BOX 669

ECHO, OREGON 97826

This superseding permit is issued to describe an amendment for an additional point of appropriation proposed under Permit Amendment Application T-14270 and approved by Special Order Vol. 131, Page 879, entered AUG 12 2024, 2024, and to describe additional points of diversion proposed under Permit Amendment Application T-13270 and approved by Special Order Vol. 121, Page 749, entered October 6, 2021, Extensions of Time for complete application of water approved May 12, 1982, March 21, 1986, March 31, 1991, November 9, 1995, and August 3, 2006, and a Water Management and Conservation order approved April 26, 2024. This permit supersedes Permit G-18545.

This is to certify that I have examined the foregoing application and do hereby grant the same, SUBJECT TO EXISTING RIGHTS INCLUDING THE EXISTING MINIMUM FLOW POLICIES ESTABLISHED BY THE WATER POLICY REVIEW BOARD and the following limitations and conditions:

The right herein granted is limited to the amount of water which can be applied to beneficial use and shall not exceed 4.9 cubic feet per second (cfs) measured at the point of diversion from the well or source of appropriation, or its equivalent in case of rotation with other water users, being no more than a maximum cumulative quantity of 4.9 cfs at any one time from Wells #2, #4, 6A, 6B, and Stanfield Well 5 and further limited not to exceed 2.9 cfs from Well #2, and not to exceed 2.0 cfs from Well #4.

The use to which water is to be applied is Municipal.

**Authorized Points of Appropriation:**

TwP	Rng	Mer	Sec	Q-Q	Measured Distances
3 N	29 E	WM	5	SE SE	STANFIELD WELL 5 - 877 FEET NORTH AND 233 FEET WEST FROM THE SE CORNER OF SECTION 5
3 N	29 E	WM	9	SE NW	WELL 6A - 2530 FEET SOUTH AND 2510 FEET EAST FROM THE NW CORNER OF SECTION 9
3 N	29 E	WM	9	SW NW	WELL 6B - 2155 FEET SOUTH AND 765 FEET EAST FROM THE NW CORNER OF SECTION 9



Twp	Rng	Mer	Sec	Q-Q	Measured Distances
3 N	29 E	WM	16	NE NE	WELL 2 - SOUTH 17 DEGREES 41 MINUTES 08 SECONDS WEST 1146.1 FEET FROM THE NE CORNER OF SECTION 16
3 N	29 E	WM	16	SE NE	WELL 4 - SOUTH 22 DEGREES 02 MINUTES 29 SECONDS WEST 1959.6 FEET FROM THE NE CORNER OF SECTION 16

**Authorized Place of Use:**

MUNICIPAL USES				
Twp	Rng	Mer	Sec	Q-Q
3 N	29 E	WM	5	S 1/2 SE
3 N	29 E	WM	8	E 1/2
3 N	29 E	WM	9	NW NE
3 N	29 E	WM	9	S 1/2 NE
3 N	29 E	WM	9	NW
3 N	29 E	WM	10	S 1/2
3 N	29 E	WM	10	W 1/2 SW
3 N	29 E	WM	10	SE SW
3 N	29 E	WM	15	NW 1/4
3 N	29 E	WM	16	N 1/2 SW
3 N	29 E	WM	16	N 1/2
3 N	29 E	WM	16	NE SW
3 N	29 E	WM	16	N 1/2 SE
3 N	29 E	WM	17	SE SE
3 N	29 E	WM	17	NE NE

The well shall be constructed in accordance with the General Standards for the Construction and Maintenance of Water Wells in Oregon.

The permittee shall install and maintain a weir, meter, or other suitable measuring device, and shall keep a complete record of the amount of ground water withdrawn.

The works constructed shall include an airline and pressure gauge or an access port for measuring line, adequate to determine water level elevation in the well at all times.

**Permit Amendment T-14270 Conditions:**

The combined quantity of water diverted at the new point of appropriation (Stanfield Well 5), together with that diverted at the old points of appropriation (Well #2, Well #4, Well 6A and Well 6B), shall not exceed the quantity of water lawfully available at the original points of appropriation (Well #2, Well #4, Well 6A and Well 6B).

Water use measurement conditions:

- a. Before water use may begin under this order, the water user shall install a totalizing flow meter, or, with prior approval of the Director, another suitable measuring device, at each point of appropriation (new and existing).
- b. The water user shall maintain the meters or measuring devices in good working order.



- c. The water user shall allow the Watermaster access to the meters or measuring devices; provided however, where the meters or measuring devices are located within a private structure, the Watermaster shall request access upon reasonable notice.

Water shall be acquired from the same aquifer as the original points of appropriation.

**Permit Amendment T-13270 Conditions**

The combined quantity of water diverted at the new points of appropriation (Well 6A and Well 6B), together with that diverted at the old points of appropriation (Well #2, Well #4), shall not exceed the quantity of water lawfully available at the original points of appropriation (Well #2, Well #4).

Water use measurement conditions:

- a. Before water use may begin under this order, the water user shall install a totalizing flow meter, or, with prior approval of the Director, another suitable measuring device at each point of appropriation (new and existing).
- b. The water user shall maintain the meters or measuring devices in good working order.
- c. The water user shall allow the Watermaster access to the meters or measuring devices; provided however, where the meters or measuring devices are located within a private structure, the Watermaster shall request access upon reasonable notice.

Water shall be acquired from the same aquifer as the original points of appropriation (Well #2, Well #4, Well 6A and Well 6B).

**Extension of Time Conditions**

The water user shall develop a plan to monitor and report the impact of water user under this permit on water levels within the aquifer that provides water to the permitted wells. The plan shall be submitted to the Department within one year of the date the Extension Order is issued and shall be subject to the approval of the Department. At a minimum, the plan shall include a program to periodically measure static water levels within the permitted wells or/and adequate substitute such as water levels in nearby wells.

**Water Management and Conservation Plan**

The City of Echo shall submit an updated plan meeting the requirements of OAR Chapter 690, Division 086 (effective date December 23, 2018) within **10 years** and no later than October 26, 2033.

The City of Echo shall submit a progress report containing the information required under OAR 690-086-0120(4) by April 26, 2029.



Original Permit Conditions

The priority date of this permit is June 21, 1978.

The original Permit was issued May 30, 1979. Actual construction work shall begin on or before May 30, 1980.

By Extension of Time Final order dated August 3, 2006, the deadline for completing construction and for complete application of water to use was extended to October 1, 2028.

Dated in Salem, Oregon on **AUG 12 2024**

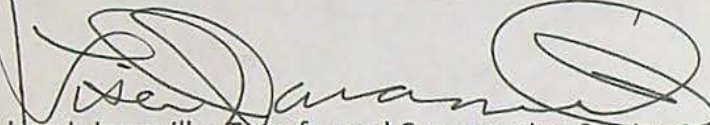
A handwritten signature in black ink, appearing to read "Lisa J. Jaramillo", is written over the printed name and title.

Lisa J. Jaramillo, Transfer and Conservation Section Manager, for  
IVAN GALL, DIRECTOR

Oregon Water Resources Department



# PERMIT AMENDMENT COVER SHEET

Transfer: T-14270

Permit Amendment Specialist: Stacy

Transfer Type: Permit Amendment Transfer

Reimbursement Authority? ☒

<b>Applicant:</b> CITY OF ECHO DAVID SLAGHT PO BOX 9 ECHO, OR 97826	<b>Agent:</b> Ted Ressler; Summit WR 4784 SE 17 <sup>th</sup> Ave Suite 111 Portland, OR 97202	<b>CWRE:</b>
<b>Irrigation District:</b>	<b>Affected Local Gov'ts:</b> City Of Stanfield	<b>Affected Tribal Gov't:</b>
<b>BOR Notified (date):</b>		

## Permit(s) Affected

File Marked	App. File # or Decree Name	Permit Number	Superseding Permit Number
<input type="checkbox"/>	G-8865	G-18545	G-18897
<input type="checkbox"/>			
<input type="checkbox"/>			

## Key Dates & Initial Actions (Support Staff)

Rec'd: June 30, 2023	Proposed Action(s): ADDITIONAL POINT OF APPROPRIATION	
Fees Pd: 1840.00	Acknowledgement Letter Sent <input type="checkbox"/>	Basin: 7 Umatilla
Initial Public Notice:	County sent cc: of Ack Letter <input type="checkbox"/>	County: UMATILLA
WM District: 5 Gregory M. Silbernagel	WM Review request sent:	WM Review date received:
ODFW District:	ODFW Review sent:	ODFW Review date received:
Groundwater	GW Review sent:	GW Review date received:

## Caseworker Actions: Newspaper Notice and other:

Newspaper notice needed: <input checked="" type="checkbox"/>	Name of Newspaper:		
Newspaper notice sent to coordinator:	Newspaper notice quote requested (NRS1):		
Request for news \$ sent:	News \$ received:		
Affidavit of publication received:	Last day of publication:		
Extension of Time? <input checked="" type="checkbox"/>	Assignment? <input type="checkbox"/>	Previous Permit Amendments? <input checked="" type="checkbox"/>	WMCP? <input checked="" type="checkbox"/>

## Peer Review:

Document	Drafted	Peer Review	Coordinator	Changes Made	Signature Bin	Signature Date
FO	Date: <u>4-27-24</u> Initials: <u>DL</u>	Date: <u>4-29-24</u> Initials: <u>SG</u>	Date: <u>5-1-24</u> Initials: <u>PRS</u>	Date: _____ Initials: _____ Data Review Date: <u>5-10-24</u>	Date: <u>7-25-24</u> WM Sheet <input type="checkbox"/> ODFW Sheet: <input type="checkbox"/> No. of docs for sig: <u>2</u>	Date: <u>8/13/24</u> <u>8/12/24</u>

Special Issues: \_\_\_\_\_

Special Order Volume: Vol. 131 Pages 879-881



This Permit is Hereby Issued to:  
 City of Echo  
 PO Box 669  
 Echo, Oregon 97826

This superseding permit is issued to describe an amendment for additional points of appropriation proposed under Permit Amendment Application T-13270 and approved by Special Order Vol. 121, Page 749, entered October 10, 2021, and to describe five extensions of time for complete application of water approved August 3, 2006, and a Water Management and Conservation order approved August 28, 2012. This permit supersedes Permit G-8546.

This is to certify that I have examined the foregoing application and do hereby grant the same, SUBJECT TO EXISTING RIGHTS INCLUDING THE EXISTING MINIMUM FLOW POLICIES ESTABLISHED BY THE WATER POLICY REVIEW BOARD and the following limitations and conditions:

The right herein granted is limited to the amount of water which can be applied to beneficial use and shall not exceed 4.9 cubic feet per second (cfs) measured at the point of diversion from the well or source of appropriation, or its equivalent in case of rotation with other water users, from Wells #2 and #4 being 2.9 cfs from Well #2 and 2.0 cfs from Well #4.

The use to which water is to be applied is Municipal.

#### Authorized Points of Appropriation:

Twp	Rng	Mer	Sec	Q-Q	Measured Distances
3 N	29 E	WM	16	NE NE	WELL 2 - SOUTH 17 DEGREES 41 MINUTES 08 SECONDS WEST 1146.1 FEET FROM THE NE CORNER OF SECTION 16
3 N	29 E	WM	16	SE NE	WELL 4 - SOUTH 22 DEGREES 02 MINUTES 29 SECONDS WEST 1959.6 FEET FROM THE NE CORNER OF SECTION 16
3 N	29 E	WM	9	SE NW	WELL 6A - 2530 FEET SOUTH AND 765 FEET EAST FROM THE NW CORNER OF SECTION 9
3 N	29 E	WM	9	SW NW	WELL 6B - 2155 FEET SOUTH AND 765 FEET EAST FROM THE NW CORNER OF SECTION 9

#### Authorized Place of Use:

Twp	Rng	Mer	Sec	Q-Q
3 N	29 E	WM	5	S 1/2 SE
3 N	29 E	WM	8	E 1/2
3 N	29 E	WM	9	NW NE
3 N	29 E	WM	9	S 1/2 NE
3 N	29 E	WM	9	NW
3 N	29 E	WM	10	S 1/2
3 N	29 E	WM	10	W 1/2 SW
3 N	29 E	WM	10	SE SW
3 N	29 E	WM	15	NW 1/4
3 N	29 E	WM	16	N 1/2 SW

For Reference:  
 Copies of prior  
 permits &  
 WMCP FO's.



Twp	Rng	Mer	Sec	Q-Q
3 N	29 E	WM	16	N 1/2
3 N	29 E	WM	16	NE SW
3 N	29 E	WM	16	N 1/2 SE
3 N	29 E	WM	17	SE SE
3 N	29 E	WM	17	NE NE

If for irrigation, this appropriation shall be limited to ..... of one cubic foot per second or its equivalent for each acre irrigated and shall further be limited to a diversion of not to exceed ..... acre feet per acre for each acre irrigated during the irrigation season of each year;

and shall be subject to such reasonable rotation system as may be ordered by the proper state officer.

The well shall be constructed in accordance with the General Standards for the Construction and Maintenance of Water Wells in Oregon.

The permittee shall install and maintain a weir, meter, or other suitable measuring device, and shall keep a complete record of the amount of ground water withdrawn.

The works constructed shall include an airline and pressure gauge or an access port for measuring line, adequate to determine water level elevation in the well at all times.

#### *Extension of Time Conditions*

The water user shall develop a plan to monitor and report the impact of water user under this permit on water levels within the aquifer that provides water to the permitted wells. The plan shall be submitted to the Department within one year of the date the Extension Order is issued and shall be subject to the approval of the Department. At a minimum, the plan shall include a program to periodically measure static water levels within the permitted wells or/and adequate substitute such as water levels in nearby wells.

#### *Water Management and Conservation Plan*

The City of Echo shall submit a progress report containing the information required under OAR 690-086-0120(4) by August 28, 2017.

#### *Transfer T-13270 Conditions:*

The combined quantity of water diverted at the new points of appropriation (Well 6A and Well 6B), together with that diverted at the old points of appropriation (Well #2 and Well #4), shall not exceed the quantity of water lawfully available at the original points of appropriation (Well #2 and Well #4).

#### *Water use measurement conditions:*

a. Before water use may begin under this order, the water user shall install a totalizing flow meter, or, with prior approval of the Director, another suitable measuring device at each point of appropriation (new and existing).

b. The water user shall maintain the meters or measuring devices in good working order.

c. The water user shall allow the Watermaster access to the meters or measuring devices; provided however, where the meters or measuring devices are located within a private structure, the Watermaster shall request access upon reasonable notice.



*Water shall be acquired from the same aquifer as the original points of appropriation (Well #2 and Well #4).*

*The priority date of this permit is ....June 21, 1978.....*

*Actual construction work shall begin on or  
before .....May 30, 1980..... and shall thereafter be prosecuted with reasonable diligence and be completed  
on or before October 1, 2028....Complete application of the water to the proposed use shall be made on or before  
October 1, 2028...WITNESS my hand this 10 day of October, 20 21*

*Lisa Jaramillo, Water Right Transfer and Conservation Manager, for  
Thomas M. Byler, DIRECTOR*



WMCP #1

BEFORE THE WATER RESOURCES DEPARTMENT  
OF THE  
STATE OF OREGON

In the Matter of the Proposed Water )  
Management and Conservation Plan for the )  
City of Echo, Umatilla County ) FINAL ORDER APPROVING A  
WATER MANAGEMENT AND  
CONSERVATION PLAN

**Authority**

OAR Chapter 690, Division 086, establishes the process and criteria for approving water management and conservation plans required under the conditions of permits, permit extensions and other orders of the Department.

**Findings of Fact**

1. The City of Echo (City) submitted a Water Management and Conservation Plan (plan) to the Water Resources Department (Department) on May 1, 2012.
2. The Department published notice of receipt of the plan on May 8, 2012, as required under OAR Chapter 690, Division 086. No comments were received.
3. The Department provided written comments on the plan to the City on June 13, 2012, and in response, the City submitted revisions to the plan on August 23 and 28, 2012.
4. The Department reviewed the revised plan and finds that it is consistent with the relevant requirements under OAR Chapter 690, Division 086.

**Conclusion of Law**

The Water Management and Conservation Plan submitted by the City of Echo is consistent with the criteria in OAR Chapter 690, Division 086.

**Now, therefore, it is ORDERED:**

1. The City of Echo Water Management and Conservation Plan is approved and shall remain in effect until August 28, 2022, unless this approval is rescinded pursuant to OAR 690-086-0920.
2. The City of Echo shall submit an updated plan meeting the requirements of OAR Chapter 690, Division 086 within 10 years and no later than February 28, 2022.

This is a final order in other than a contested case. This order is subject to judicial review under ORS 183.484. Any petition for judicial review must be filed within the 60-day time period specified by ORS 183.484(2). Pursuant to ORS 536.075 and OAR 137-004-0080, you may petition for judicial review or petition the Director for reconsideration of this order. A petition for reconsideration may be granted or denied by the Director, and if no action is taken within 60 days following the date the petition was filed, the petition shall be deemed denied.



3. The City of Echo shall submit a progress report containing the information required under OAR 690-086-0120(4) by August 28, 2017.
4. The deadline established herein for the submittal of an updated Water Management and Conservation Plan (consistent with OAR Chapter 690, Division 086) shall not relieve the City of Echo from any existing or future requirement(s) for submittal of a Water Management and Conservation Plan at an earlier date as established through other final orders of the Department.

Dated at Salem, Oregon this 28 day of August, 2012.

  
Dwight French, Water Right Services Administrator for  
PHILLIP C. WARD, DIRECTOR

Mailing date: AUG 31 2012



Application No. G-8865

Permit No. G 8546

\* Superseded by  
Permit G-18545

## Permit to Appropriate the Public Waters of the State of Oregon

This is to certify that I have examined the foregoing application and do hereby grant the same, **SUBJECT TO EXISTING RIGHTS INCLUDING THE EXISTING MINIMUM FLOW POLICIES ESTABLISHED BY THE WATER POLICY REVIEW BOARD** and the following limitations and conditions:

The right herein granted is limited to the amount of water which can be applied to beneficial use and shall not exceed 4.9 cubic feet per second measured at the point of diversion from the well or source of appropriation, or its equivalent in case of rotation with other water users, from Wells #2 and #4; being 2.9 c.f.s. from Well #2 and 2.0 c.f.s. from Well #4.

The use to which this water is to be applied is municipal.

If for irrigation, this appropriation shall be limited to of one cubic foot per second or its equivalent for each acre irrigated and shall be further limited to a diversion of not to exceed acre feet per acre for each acre irrigated during the irrigation season of each year;

and shall be subject to such reasonable rotation system as may be ordered by the proper state officer.

The well shall be constructed in accordance with the General Standards for the Construction and Maintenance of Water Wells in Oregon.

The works constructed shall include an air line and pressure gauge or an access port for measuring line, adequate to determine water level elevation in the well at all times.

The permittee shall install and maintain a weir, meter, or other suitable measuring device, and shall keep a complete record of the amount of ground water withdrawn.

The priority date of this permit is June 21, 1978

Actual construction work shall begin on or before May 30, 1980 and shall

thereafter be prosecuted with reasonable diligence and be completed on or before October 1, 1980

Extended to Oct. 1985 Extended to October 1, 1990, 10-1-95, 10-1-2000

Complete application of the water to the proposed use shall be made on or before October 1, 1981

Extended to Oct. 1985 Extended to October 1, 1990, 10-1-95, 10-1-2000

WITNESS my hand this 30th day of May, 1979

  
Water Resources Director

12/8 A



Remarks:



Signature of Applicant

Stanley G. Wallulis, Echo City Engineer

This is to certify that I have examined the foregoing application, together with the accompanying maps and data, and return the same for.....

In order to retain its priority, this application must be returned to the Water Resources Director with corrections on or before....., 19.....

WITNESS my hand this..... day of....., 19.....

Water Resources Director

By.....

This instrument was first received in the office of the Water Resources Director at Salem, Oregon, on the

21st day of June, 1978, at 4:20 o'clock

P.M.

Application No.

G-8865

Permit No.

G-8546



6. The amount of water which the applicant intends to apply to beneficial use is ~~2.0~~ <sup>2.9</sup> 4.9 cubic feet per second or <sup>2205</sup> ~~900~~ gallons per minute. being 2.9 cfs from well #2 and 2.0 cfs from well #4.

7. The use to which the water is to be applied is Municipal; ie: Domestic, industrial, recreational, irrigation, fire protection, etc.

8. If the flow to be utilized is artesian, the works to be used for the control and conservation of the supply when not in use must be described.

N.A.

9. If the location of the well, or other development work is less than one-fourth mile from a natural stream channel, give the distance to the channel and the difference in elevation between the stream bed and the ground surface at the source of development.

N.A.

10.

#### DESCRIPTION OF WORKS

Include length and dimensions of supply ditch or pipeline, size and type of pump and motor, type of irrigation system to adequately describe the proposed distribution system.

To be submitted prior to new construction and reconstruction of the present water system.

11. Construction work will begin on or before June 20, 1978

12. Construction work will be completed on or before June 20, 1981

13. The water will be completely applied to the proposed use on or before June 20, 1984

14. If the ground water supply is supplemental to an existing supply, identify the supply and existing water right. Certificate 19613 and 34386

Application No.

G-8865

Permit No.

G 8546

0 9200



Application No. G-8865Permit No. G 8546

## STATE OF OREGON WATER RESOURCES DEPARTMENT

## Application for a Permit to Appropriate Ground Water

RECEIVED  
JUN 21 1978  
WATER RESOURCES DEPT.  
SALEM, OREGON

I, City of Echo, Oregon

(Name of Applicant)

of P.O. Box 669 ----- Echo (ZIP 97826)

(Mailing Address)

(City)

State of Oregon

(Zip Code)

Phone No. 376-8341

do hereby

make application for a permit to appropriate the following described ground waters of the State of Oregon:

1. The development will consist of ~~a single deep well~~ <sup>2</sup> wells (City Wells No. 4 & No. 2) <sup>#2 8, 10, & 12</sup>  
 having a diameter of <sup>#4</sup> 10 inches and an estimated depth of <sup>878</sup> 600 feet.  
 (Give number of wells, tile lines, infiltration galleries, etc.)

2. The well or other source is to be located ----- ft. ----- and ----- ft. -----  
 (N. or S.) (E. or W.)  
 from the NE corner of SECTION 16  
 (Public Land Survey Corner)  
#2 - S 17° 41' 08" W 1146.1 feet within NE 1/4 NE 1/4  
 (If there is more than one well, each must be described)  
#4 - S 22° 02' 29" W 1959.6' being within the S.E. 1/4 of the N.E. 1/4 of  
 Sec. 16 Tp. 3 North R. 29 East W. M., in the county of Umatilla

3. Location of area to be irrigated, or place of use if use other than irrigation.

Township	Range	Section	List 1/4 1/4 of Section	List use and/or number of acres to be irrigated
<u>3 N</u>	<u>29 E</u>	<u>5</u>	<u>S 1/2 SE 1/4</u>	<u>MUNICIPAL</u>
		<u>8</u>	<u>E 1/2</u>	"
		<u>9</u>	<u>NW 1/4 NE 1/4</u> <u>S 1/2 NE 1/4</u> <u>NW 1/4</u>	"
		<u>10</u>	<u>S 1/2</u> <u>W 1/2 SW 1/4</u> <u>SE 1/4 SW 1/4</u>	"
		<u>15</u>	<u>NW 1/4</u> <u>N 1/2 SW 1/4</u>	"
		<u>16</u>	<u>N 1/2</u> <u>NE 1/4 SW 1/4</u> <u>N 1/2 SE 1/4</u>	"
		<u>17</u>	<u>SE 1/4 SE 1/4</u> <u>NE 1/4 NE 1/4</u>	"

4. It is estimated that <sup>#2</sup> 45 feet of the well will require <sup>1"</sup> 1" thick 10" dia. casing.

5. Depth to water table is estimated <sup>both</sup> 315 Well drilled by <sup>#2 Ben Dreyer (kind) (6-20-64)</sup> Troy Griffin (Completed 8-2-74)  
 (Feet)



INVOICE NUMBER

DATE

AMOUNT

INVOICE NUMBER

DATE

AMOUNT

T-14270 Notice  
Water Resources - advertising Phase 1 WSI  
5/28/2024

\$151.20

Received

MAY 31 2024

OWRD

Total:

\$151.20

Ameforms JL1098HBGJ 2248958

STATE OF OREGON  
WATER RESOURCES DEPARTMENT725 Summer St. N.E. Ste. A  
SALEM, OR 97301-4172  
(503) 986-0900 / (503) 986-0904 (fax)

RECEIPT # 143021

INVOICE #

RECEIVED FROM: City of Echo  
BY:CASH: ☐ CHECK: # ☒ 12164 OTHER: (IDENTIFY) ☐APPLICATION  
PERMIT  
TRANSFER T-14270

TOTAL REC'D \$151.20

## 1083 TREASURY 4170 WRD MISC CASH ACCT

0407 COPIES 46118 \$  
0207 OTHER: (IDENTIFY) Newspaper Notice \$151.20

0243 I/S Lease 0244 Muni Water Mgmt. Plan 0245 Cons. Water

## 4270 WRD OPERATING ACCT

## MISCELLANEOUS

0407 COPY & TAPE FEES \$  
0410 RESEARCH FEES \$  
0408 MISC REVENUE: (IDENTIFY) \$  
TC162 DEPOSIT LIAB. (IDENTIFY) \$  
0240 EXTENSION OF TIME \$

## WATER RIGHTS:

0201 SURFACE WATER \$ 0202 \$  
0203 GROUND WATER \$ 0204 \$  
0205 TRANSFER \$  
WELL CONSTRUCTION EXAM FEE LICENSE FEE  
0218 WELL DRILL CONSTRUCTOR \$ 0219 \$  
LANDOWNER'S PERMIT 0220 \$

OTHER (IDENTIFY)

## 0536 TREASURY 0437 WELL CONST. START FEE

0211 WELL CONST START FEE \$ CARD#  
0210 MONITORING WELLS \$ CARD#  
OTHER (IDENTIFY)

## 0607 TREASURY 0467 HYDRO ACTIVITY LIC NUMBER

0233 POWER LICENSE FEE (FW/WRD) \$  
0231 HYDRO LICENSE FEE (FW/WRD) \$  
HYDRO APPLICATION \$

## TREASURY OTHER / RDX

FUND TITLE  
OBJ. CODE VENDOR #  
DESCRIPTION \$

RECEIPT: 143021

DATED: 5-31-24 BY: (signature)

Distribution - White Copy - Customer, Yellow Copy - Fiscal, Blue Copy - File, Buff Copy - Fiscal

STATE OF OREGON  
WATER RESOURCES DEPARTMENT725 Summer St. N.E. Ste. A  
SALEM, OR 97301-4172  
(503) 986-0900 / (503) 986-0904 (fax)

RECEIPT # 143021

INVOICE #

RECEIVED FROM: City of Echo  
BY:CASH: ☐ CHECK: # ☒ 12164 OTHER: (IDENTIFY) ☐APPLICATION  
PERMIT  
TRANSFER T-14270

TOTAL REC'D \$151.20

## 1083 TREASURY 4170 WRD MISC CASH ACCT

0407 COPIES 46118 \$  
0207 OTHER: (IDENTIFY) Newspaper Notice \$151.20

0243 I/S Lease 0244 Muni Water Mgmt. Plan 0245 Cons. Water

## 4270 WRD OPERATING ACCT

## MISCELLANEOUS

0407 COPY & TAPE FEES \$  
0410 RESEARCH FEES \$  
0408 MISC REVENUE: (IDENTIFY) \$  
TC162 DEPOSIT LIAB. (IDENTIFY) \$  
0240 EXTENSION OF TIME \$

## WATER RIGHTS:

0201 SURFACE WATER \$ 0202 \$  
0203 GROUND WATER \$ 0204 \$  
0205 TRANSFER \$  
WELL CONSTRUCTION EXAM FEE LICENSE FEE  
0218 WELL DRILL CONSTRUCTOR \$ 0219 \$  
LANDOWNER'S PERMIT 0220 \$

OTHER (IDENTIFY)

## 0536 TREASURY 0437 WELL CONST. START FEE

0211 WELL CONST START FEE \$ CARD#  
0210 MONITORING WELLS \$ CARD#  
OTHER (IDENTIFY)

## 0607 TREASURY 0467 HYDRO ACTIVITY LIC NUMBER

0233 POWER LICENSE FEE (FW/WRD) \$  
0231 HYDRO LICENSE FEE (FW/WRD) \$  
HYDRO APPLICATION \$

## TREASURY OTHER / RDX

FUND TITLE  
OBJ. CODE VENDOR #  
DESCRIPTION \$

RECEIPT: 143021

DATED: 5-31-24 BY: (signature)

Distribution - White Copy - Customer, Yellow Copy - Fiscal, Blue Copy - File, Buff Copy - Fiscal



IN THE CIRCUIT COURT OF  
THE STATE OF OREGON  
FOR UNION/BAKER/UMATILLA/MORROW COUNTY

T-14270

}AFFIDAVIT OF PUBLICATION

STATE OF OREGON

County of Union/Baker/Umatilla/Morrow} ss

I, Dayle Stinson being duly sworn, depose and say that I am the principal clerk of the publisher of the La Grande Observer, lagrandeobserver.com, Baker City Herald, bakercityherald.com, East Oregonian, eastoregonian.com, Northeast Oregon Weekender, Hermiston Herald, hermistonherald.com, a newspaper of general circulation, as defined by ORS 193.010 and 193.020; that the

EO-13260 NOTICE OF PERMIT AMENDMENT T 14270 T-14270 FILED BY CITY OF ECHO PO BOX 669 ECHO OR 97826 PROPOSES AN ADDITIONAL POINT OF APPROPRIATION UNDER PERMIT G-18545 THE PERMIT ALLOWS THE USE OF 4 9

a printed copy of which is hereto annexed; was published in the entire issue of said newspaper for 2 successive and consecutive issues in the following issues:

6/22/24, 6/29/24

Subscribed and sworn to before me on this 29th day of June, A.D. 2024

*Dayle Stinson*  
*Kathryn Bedford Brown*  
Notary Public of Oregon

Add: 437029

PO:

Tagline: EO-13260 T-14270





**EO-13260  
NOTICE OF PERMIT  
AMENDMENT T 14270**

T-14270 filed by City of Echo, PO Box 669, Echo, OR 97826, proposes an additional point of appropriation under Permit G-18545. The permit allows the use of 4.9 cubic feet per second from four wells in Sects. 9 and 16, T3N, R29E, WM for municipal use in Sects. 5, 8, 9, 10, 15, 16, and 17, T3N, R29E, WM. The applicant proposes an additional point of appropriation in Sec. 5, T3N, R29E, WM. The Water Resources Department has concluded that the proposed permit amendment appears to be consistent with the requirements of ORS 537.211. The last date of newspaper publication is 06/29/2024.  
Publish June 22, 29, 2024





EO Media Group  
PO Box 6020  
Bend, OR 97708

BILLING PERIOD		ADVERTISER/CLINIC NAME	
06/01/2024 to 06/30/2024		OREGON WATER RESOURCES	
SALES REP		ADVERTISER/CLINIC ACCOUNT #	BILLED ACCOUNT #
EasternOregon Classifieds			
SALES REP PHONE		INVOICE NUMBER	TERMS OF PAYMENT
		0624EO32255	Due Upon Receipt
PAGE	BILLING DATE	*UNAPPLIED AMOUNT	TOTAL AMOUNT DUE
1	7/1/2024	\$0.00	\$126.00

0101100 100634000201

100634000201\*11\*\*\*\*\*AUTO\*\*ALL FOR AADC 970



OREGON WATER RESOURCES DEPARTMENT  
725 SUMMER ST NE STE A  
SALEM, OR 97301-1266

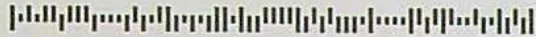

EO MEDIA GROUP  
PO BOX 6020  
BEND, OR 97708-6020



PLEASE DETACH AND RETURN UPPER PORTION WITH YOUR REMITTANCE

AD ID#	DESCRIPTION - OTHER COMMENTS/CHARGES	START & STOP DATE	SAU SIZE BILLED UNITS	TIMES RUN	AMOUNT
	BALANCE FORWARD				\$294.00
PMT CK	Payment Check # 127064186	6/21/24			\$(294.00)
437029	EO-13260 T-14270 East Oregonian, Northeast Oregon Weekender, eastoregonian.com	6/22/24, 6/29/24		6.00x	\$126.00

Received  
JUL 03 2024  
OWRD

#### STATEMENT OF ACCOUNT

#### AGING OF PAST DUE AMOUNTS

CURRENT AMOUNT	30 DAYS	60 DAYS	90 DAYS	UNAPPLIED AMOUNT	TOTAL AMOUNT DUE
\$126.00	\$0.00	\$0.00	\$0.00		\$126.00

REMIT TO: EO Media Group  
PO Box 6020, Bend, OR 97708

To make a payment, please  
call (541) 383-0333. For  
other questions contact  
your sales rep.

\*TERMS: NET 30, ALL PAST DUE AMOUNTS ARE SUBJECT TO  
A SERVICE CHARGE OF 1.5% PER MONTH, WHICH IS AN  
ANNUAL PERCENTAGE RATE OF 18%

INVOICE NUMBER	ADVERTISER INFORMATION		
	BILLING PERIOD	BILLED ACCOUNT NUMBER	ADVERTISER NAME
0624EO32255	06/01/2024 to 06/30/2024		OREGON WATER RESOURCES DEPARTI

ROGUE VALLEY  
TIMES

CHINOOK  
OBSERVER

the Astorian

Capital Press

The Bulletin

EAST OREGONIAN

Blue Mountains  
EAGLE

SEASIDE  
JOURNAL

Coast River  
JOURNAL

Signal

Herald

REDMOND  
SPOKESMAN

THE OTHER OREGON  
A VOICE FOR RURAL OREGON

Baker City Herald

WILLAMETTE COUNTY  
CHIEFTAIN



## Groundwater Transfer Review Summary Form

Transfer/PA # T- 14270

GW Reviewer J. Hootsmans/A. Wentworth Date Review Completed: 2/2/2024

### Summary of Same Source Review:

☐ The proposed change in point of appropriation is not within the same aquifer as per OAR 690-380-2110(2).

### Summary of Injury Review:

☐ The proposed transfer will result in another, existing water right not receiving previously available water to which it is legally entitled or result in significant interference with a surface water source as per 690-380-0100(3).

### Summary of GW-SW Transfer Similarity Review:

☐ The proposed SW-GW transfer doesn't meet the definition of "similarly" as per OAR 690-380-2130.

*This is only a summary. Documentation is attached and should be read thoroughly to understand the basis for determinations.*





Oregon Water Resources Department  
725 Summer Street NE, Suite A  
Salem, Oregon 97301-1271  
(503) 986-0900  
www.wrd.state.or.us

## Ground Water Review Form:

- ☐ Water Right Transfer  
☒ Permit Amendment  
☐ GR Modification  
☐ Other

Application: T-14270

Applicant Name: City of Echo, ATTN: David Slaght

Proposed Changes: ☐ POA ☒ APOA ☐ SW→GW ☐ RA  
☐ USE ☐ POU ☐ OTHER

Reviewer(s): J. Hootsmans/A. Wentworth

Date of Review: 2/2/2024

Date Reviewed by GW Mgr. and Returned to WRSD: JTI 2/2/24

The information provided in the application is insufficient to evaluate whether the proposed transfer may be approved because:

- ☐ The water well reports provided with the application do not correspond to the water rights affected by the transfer.
- ☐ The application does not include water well reports or a description of the well construction details sufficient to establish the ground water body developed or proposed to be developed.
- ☐ Other \_\_\_\_\_

- 
1. Basic description of the changes proposed in this transfer: The applicant proposes to add an additional point of appropriation (APOA) to Permit G-18545. The proposed APOA is existing well UMAT 57155, Stanfield Well 5. UMAT 57155 is located within the same Stage Gulch Critical Groundwater subarea as the authorized POAs on Permit G-18545 (Subarea A).
  2. Will the proposed POA develop the same aquifer (source) as the existing authorized POA?  
☒ Yes ☐ No Comments: Both the existing authorized POA on Permit G-18545 (Well 4: UMAT 1311/5842 and Well 2: UMAT 1314/1313) and the proposed APOA (Well 5: UMAT 57155) are physically located within Stage Gulch Critical Groundwater Subarea A. Two other authorized POA (Well 6A and Well 6B) on Permit G-18545 are also located within Stage Gulch Critical Groundwater Subarea A, but have not been drilled. Water level trends indicate that the authorized POA UMAT 1314/1313 and proposed POA UMAT 57155 produce from the same aquifer. The water level elevation in the other authorized POA, UMAT 1311/5842, is more than 200 feet higher than UMAT 57155 and UMAT 1314, despite being deepened to a similar depth as UMAT 57177 in 1992. Regardless, past practice has been to treat all basalt wells within Subarea A as same source (see GW review for Application T-13270).
  3. a) Is there more than one source developed under the right (e.g., basalt and alluvium)?  
☐ Yes ☒ No All Authorized and Proposed POAs develop water from the Columbia River Basalt Group.



- b) If yes, estimate the portion of the right supplied by each of the sources and describe any limitations that will need to be placed on the proposed change (rate, duty, etc.): \_\_\_\_\_
4. a) Will this proposed change, at its maximum allowed rate of use, likely result in an increase in interference with **another ground water right**?  
☐ Yes ☒ No Comments: All POAs will be located similar distances from existing groundwater users, so interference is not expected to increase.
- b) If yes, would this proposed change, at its maximum allowed rate of use, likely result in another groundwater right not receiving the water to which it is legally entitled?  
☐ Yes ☒ No If yes, explain: \_\_\_\_\_
5. a) Will this proposed change, at its maximum allowed rate of use, likely result in an increase in interference with **another surface water source**?  
☐ Yes ☒ No Comments: The proposed APOA is cased and sealed well below the level of nearby surface water bodies and is at similar distances from surface water bodies as the authorized POA.
- b) If yes, at its maximum allowed rate of use, what is the expected change in degree of interference with any **surface water sources** resulting from the proposed change?  
Stream: \_\_\_\_\_ ☐ Minimal ☐ Significant  
Stream: \_\_\_\_\_ ☐ Minimal ☐ Significant  
Provide context for minimal/significant impact: \_\_\_\_\_
6. For SW-GW transfers, will the proposed change in point of diversion affect the surface water source similarly (as per OAR 690-380-2130) to the authorized point of diversion specified in the water use subject to transfer?  
☐ Yes ☐ No Comments: NA
7. What conditions or other changes in the application are necessary to address any potential issues identified above: The proposed water right will have to comply with the Stage Gulch CGWA rules (OAR 690-507-0750), including the duties of a water user (OAR 690-507-0780) and flow meter specifications (OAR 690-507-0785).
8. Any additional comments: NA

**References:**

Application file: T-13270, T-14270, Permit G-18585

McConnell, Vicki S., 2003, Preliminary Geologic Map of Service Buttes, Echo, Nolin, Barnhart, and Pendleton 7.5' Quadrangles (west to east), Umatilla County, Oregon; Oregon Department of Geology and Mineral Industries Open-File Report O-06-20.

OWRD Water Level and Well Log Databases.



1:20,000 scale

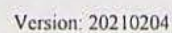



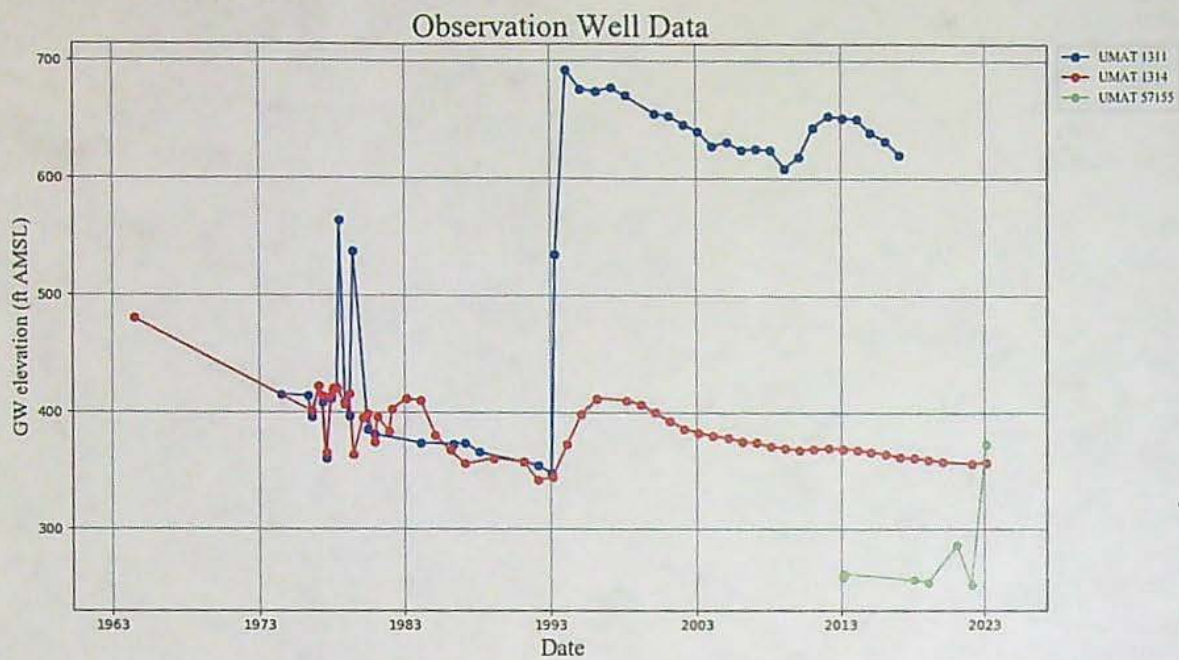



## Watermaster Review Form: Water Right Transfer



Oregon Water Resources Department  
725 Summer St NE, Suite A  
Salem, Oregon 97301-1266  
(503) 986-0900  
[www.oregon.gov/OWRD](http://www.oregon.gov/OWRD)

Transfer Application: T-14270

Review Due Date:

Applicant Name: City of Echo

Proposed Changes: ☐ POU ☐ POD ☒ POA ☐ USE ☐ OTHER

Reviewer(s): Greg Silbernagel

Date of Review: 07/27/2023

1. Do you have evidence that the right has not been used in the last 5 years and that the presumption of forfeiture would not likely be rebuttable? ☐ Yes ☒ No If "Yes", attach evidence (e.g. dated aerial photo showing pavement or building on the land for >5 yrs.)
2. Is there a history of regulation on the source that serves this (or these) right(s) that has involved the transferred right(s) and downstream water rights? ☒ Yes ☐ No Generally characterize the frequency of any regulation or explain why regulation has not occurred:  
This area is within the Stage Gulch critical groundwater area - subarea A.
3. Have headgate notices been issued for the source that serves the transferred right(s)?  
☐ Yes ☒ No ☐ Records not available.
4. In your estimation, after the proposed change, would distribution of water for the right(s) result in regulation of other water rights that would not have occurred if use under the original right(s) was/were maximized? ☐ Yes ☒ No If "Yes", explain:  
Defer to groundwater section.
5. In your estimation, if the proposed change is approved, are there upstream water rights that would be affected? ☐ Yes ☒ No If "Yes", describe how the rights would be affected and list the rights most affected:  
Defer to groundwater section.



6. Check here ☐ if it appears that downstream water rights benefit from return flows resulting from the current use of the transferred right(s)? If you check the box, generally characterize the locations where the return flows likely occur and list the water rights that benefit most:

☒ N/A

7. For POD changes and instream transfers, check here if there are channel losses between the old and new PODs or within the proposed instream reach? If you check the box, describe and, if possible, estimate the losses:

☒ N/A

8. For instream transfers that propose protection of a reach beyond the mouth of the source stream:  
☐ N/A Would the quantity be measureable into the receiving stream consistent with OAR 690-077-0015(8)? ☐ Yes ☐ No

9. For POU changes: ☒ N/A Is it likely the original place of use would continue to receive water from the same source? ☐ Yes ☐ No If "Yes", explain:

10. For POU or USE changes: ☒ N/A In your best judgment, would use of the existing right at "full face value," result in the diversion of more water than can be used beneficially and without waste?  
☐ Yes ☐ No If "Yes", explain:

11. For POU changes that involve micro-irrigation: ☒ N/A
- a. Has the applicant made changes (absent a transfer) to convert to micro-irrigation within the current place of use boundary of the water right proposed for transfer, and previously demonstrated to the Department through monitoring and site inspections by the Watermaster that the proposed transfer will not result in injury or enlargement?
- ☐ Yes ☐ No If "Yes", explain:



- b. Has a temporary transfer of this nature been previously filed and approved on the same lands (or portions thereof) as those lands involved in this transfer?

☐ Yes ☐ No If "Yes", answer the following:

- i. Were there any problems with more acres being irrigated (or wetted) than were authorized under the temporary transfer? ☐ Yes ☐ No If "Yes", explain:

- ii. Did the designated areas that were to remain dry (or not wetted) under the temporary transfer actually remain dry? ☐ Yes ☐ No If "No", explain:

- iii. Did the applicant comply with and meet all of the conditions of the temporary transfer? ☐ Yes ☐ No If "No", explain:

- iv. Do you have any other observations regarding the temporary transfer? ☐ Yes ☐ No If "Yes", describe:

- v. Did the applicant demonstrate to the Department through monitoring and site inspections by the Watermaster that neither injury nor enlargement occurred as a result of the temporary transfer? ☐ Yes ☐ No If "No", explain:

- c. To the best of your knowledge, if this transfer is approved, does it appear that:

- i. "Injury" will occur to other water rights that share the same source? ☐ Yes ☐ No If "Yes", explain:

- ii. "Enlargement" of the water right being transferred will occur? ☐ Yes ☐ No If "Yes", explain:



12. Are there other issues not identified through the above questions that should be considered in determining whether the change "can be effected without injury to other rights"?

☒ Yes ☐ No If "Yes", explain:

Defer to groundwater section.

13. What alternatives may be available for addressing any issues identified above:

14. Do conditions need to be included in the transfer order to avoid enlargement of the right or injury to other rights? ☐ No ☒ Yes, as checked and provided below:

☐ For POU changes that involve micro-irrigation, provide the monitoring and reporting conditions necessary to prevent injury/enlargement:

☐ A Headgate should be required prior to diverting water.

☒ Measurement Devices for POD or POA: (if this condition is selected, also fill in the top sections of Page 4)

*a. Before water use may begin under this order, the water user shall install a **totalizing flow meter\***, or, with prior approval of the Director, another suitable measuring device, ☒ at each point of diversion/appropriation (new and existing) OR at each new point of diversion/appropriation ☐ with the exception that water rights issued to the Bureau of Reclamation or an irrigation district (or similar entity) are not subject to this condition.*

*b. The water user shall maintain the meters or measuring devices in good working order.*

*c. The water user shall allow the Watermaster access to the meters or measuring devices; provided however, where the meters or measuring devices are located within a private structure, the Watermaster shall request access upon reasonable notice.*

☐ Reservoir water use measurement: (if this condition is selected, also fill in the top sections of Page 4)

*a. Before water use may begin under this order, the water user shall install **staff gages\***, or, with prior approval of the Director, other suitable measuring devices, that measure the entire range and stage between empty and full in each reservoir. Staff gages shall be United States Geological Survey style.*

*b. Before water use may begin under this order, if the reservoir is located in channel, weirs or other suitable measuring devices must be installed upstream and downstream of the reservoir, and, an adjustable outlet valve must be installed. The water user shall maintain such devices in good working order. A written waiver may be obtained, if in the judgment of the Director, the installation of weirs or other suitable measuring devices, or the adjustable outlet valve, will provide no public benefit.*

\* The following alternative device(s) should be substituted for the bold, underlined device in the above selected condition:

☐ Weir  
☐ Parshall Flume  
☐ Other: \_\_\_\_\_

☐ Submerged Orifice  
☐ Flow Restrictor



## Oregon Water Resources Department

## Measurement Condition Information for the Applicant

*(To be sent with the Draft Preliminary Determination or Final Order)*

Transfer #: T- 14270



In order to avoid enlargement of the right or injury to other rights, a **totalizing flowmeter** will be required to be installed **prior to diversion of water**, as a condition of this transfer:



*at each point of diversion/appropriation (new and existing) OR*



*at each new point of diversion/appropriation.*

For additional information, or to obtain approval of a different type of measurement device, the applicant should contact the area Watermaster:

Watermaster name: Greg Silbernagel

District: 5

Address: 116 SE Dorion Avenue

City/State/Zip: Pendleton, Oregon 97801

Phone: 541-969-1677

Email: Greg.M.Silbernagel@water.oregon.gov

**Note:** *If a device other than the one specified in the Preliminary Determination or Final Order is approved by the Watermaster, fill out and mail the form below to the Salem office.*

\*\*\*\*\*

## Approval of an Alternate Measurement Device

T-

*(to be filled out after consultation with the applicant, or after a site visit)*

On behalf of the Director, I authorize use of the following suitable **alternate measurement device**:

\_\_\_\_\_

\_\_\_\_\_

\_\_\_\_\_  
Watermaster signature

\_\_\_\_\_  
District

\_\_\_\_\_  
Date

If this form is used for approval of an alternative measurement device, it must be mailed to:

Oregon Water Resources Department  
725 Summer Street NE, Suite A  
Salem, OR 97301-1266



Check Date: 7/17/2023

78494

Invoice Number	Date	Voucher	Amount	Discounts	Previous Pay	Net Amount
RA Fee, T-14270	7/17/2023	0229273	1,839.65			1,839.65
Oregon Water Resources Department						
COMERICA GENERAL	2	262158	1,839.65			1,839.65
		TOTAL				

STATE OF OREGON  
WATER RESOURCES DEPARTMENT  
725 Summer St. N.E. Ste. A  
SALEM, OR 97301-4172  
(503) 986-0900 / (503) 986-0904 (fax)

RECEIPT # **141346** INVOICE # \_\_\_\_\_

RECEIVED FROM: Geo-Logic Associates APPLICATION \_\_\_\_\_  
BY: \_\_\_\_\_ PERMIT \_\_\_\_\_  
CASH: ☐ CHECK: # 78494 OTHER: (IDENTIFY) \_\_\_\_\_ TRANSFER T-14270  
TOTAL REC'D \$ 1,839.65

**1083 TREASURY 4170 WRD MISC CASH ACCT**

0407 COPIES 47124 R 11432-25 \$ \_\_\_\_\_  
0412 OTHER: (IDENTIFY) Transfer Reimburse- \$ 1,839.65  
ment Authority  
0243 I/S Lease \_\_\_\_\_ 0244 Muni Water Mgmt. Plan \_\_\_\_\_ 0245 Cons. Water \_\_\_\_\_

**4270 WRD OPERATING ACCT**

MISCELLANEOUS

0407 COPY & TAPE FEES \$ \_\_\_\_\_  
0410 RESEARCH FEES \$ \_\_\_\_\_  
0408 MISC REVENUE: (IDENTIFY) \_\_\_\_\_ \$ \_\_\_\_\_  
TC162 DEPOSIT LIAB. (IDENTIFY) \_\_\_\_\_ \$ \_\_\_\_\_  
0240 EXTENSION OF TIME \$ \_\_\_\_\_

WATER RIGHTS:

0201 SURFACE WATER EXAM FEE 0202 \$ \_\_\_\_\_ RECORD FEE \$ \_\_\_\_\_  
0203 GROUND WATER EXAM FEE 0204 \$ \_\_\_\_\_ \$ \_\_\_\_\_  
0205 TRANSFER EXAM FEE \$ \_\_\_\_\_

WELL CONSTRUCTION

0218 WELL DRILL CONSTRUCTOR EXAM FEE 0219 \$ \_\_\_\_\_ LICENSE FEE \$ \_\_\_\_\_  
LANDOWNER'S PERMIT 0220 \$ \_\_\_\_\_

OTHER (IDENTIFY) \_\_\_\_\_

**0536 TREASURY 0437 WELL CONST. START FEE**

0211 WELL CONST START FEE \$ \_\_\_\_\_ CARD# \_\_\_\_\_  
0210 MONITORING WELLS \$ \_\_\_\_\_ CARD# \_\_\_\_\_  
OTHER (IDENTIFY) \_\_\_\_\_

**0607 TREASURY 0467 HYDRO ACTIVITY LIC NUMBER**

0233 POWER LICENSE FEE (FWWRD) \$ \_\_\_\_\_  
0231 HYDRO LICENSE FEE (FWWRD) \$ \_\_\_\_\_  
HYDRO APPLICATION \$ \_\_\_\_\_

**TREASURY OTHER / RDX**

FUND \_\_\_\_\_ TITLE \_\_\_\_\_  
OBJ. CODE \_\_\_\_\_ VENDOR # \_\_\_\_\_  
DESCRIPTION \_\_\_\_\_ \$ \_\_\_\_\_

RECEIVED

AUG 07 2023

OWRD

RECEIPT:

**141346**DATED: 8-7-23BY: Bruce

Distribution - White Copy - Customer, Yellow Copy - Fiscal, Blue Copy - File, Buff Copy - Fiscal



**REIMBURSEMENT AUTHORITY  
APPLICANT'S AGREEMENT**  
Contract Number: R11-452-25

**RECEIVED**  
**AUG 07 2023**  
**OWRD**

This Agreement is between the Oregon Water Resources Department, hereafter OWRD, and City of Echo, hereafter Applicant, hereafter known together as the parties.

OWRD Information	Applicant's Information	Applicant's Representative
Contact: Kelly Starnes Title: Transfer Advisor Address: 725 Summer Street, NE, Suite A Salem, OR 97301-1266  Phone: 503 979-3511 Fax: 503 986-0901 Email: <a href="mailto:patrick.k.starnes@water.oregon.gov">patrick.k.starnes@water.oregon.gov</a>	Name: City of Echo Contact: David Slaght Address: PO Box 9 Echo, OR 97826  Phone: (541) 376-6038 Fax: Email: <a href="mailto:dave@echo-oregon.com">dave@echo-oregon.com</a>	Name: Summit Water Resources, LLC Contact: Theodore Ressler, RG, CWRE Address: 4784 SE 17 <sup>th</sup> Avenue, Suite 111 Portland, OR 97202  Phone: (503) 967-7050 x204 Fax: Email: <a href="mailto:tressler@summitwr.com">tressler@summitwr.com</a>

**Purpose** The purpose of this Agreement is to expedite the processing of the Transfer Application. (Application Number: T-14270)

1. **Authority.** The OWRD has been authorized pursuant to ORS 536.055 to enter into a voluntary agreement with any applicant, permittee or regulated entity (collectively Applicant) for expediting or enhancing a regulatory process. In making this agreement, OWRD shall require the applicant to pay the full cost of expedited process.
2. **Restrictions.** Applicant and OWRD agree that this Agreement shall not be construed to restrict in any way the decisions and actions by OWRD. OWRD shall be free to exercise independent judgment consistent with existing laws and regulations.
3. **Effective Date and Duration.** Unless otherwise terminated by non-deposit of funds by the Applicant, this Agreement shall become effective on the date on which both parties have signed the Agreement and the full deposit of the estimated cost of the proposed service.
4. **Consideration.**
  - a. Applicant shall pay OWRD in advance for actual costs incurred by OWRD. The estimated maximum reimbursement payable to OWRD under this Agreement is \$1,839.65. Applicant agrees to pay the full amount of \$1,839.65 to OWRD prior to commencement of any work stated in this Agreement. This payment will be placed in an account administered by OWRD and drawn upon as costs are actually incurred. If the actual cost of performing the work is less than payments received, OWRD will refund the unspent balance. If the actual cost of processing exceeds the estimate, the Applicant can either elect to terminate this Agreement or amend the Agreement to reflect the increase in cost.
  - b. The costs stated in this Agreement do not include the statutory application processing and filing fees.
5. **Confidentiality.** Applicant agrees that any information provided to or acquired by OWRD under this Agreement will be subject to the Oregon Public Records Law and shall be considered public records.
6. **Indemnity.** Applicant shall defend, save, hold harmless, and indemnify the State of Oregon, OWRD, and their officers, employees, and agents from and against all claims, suits, actions, losses, damages, liabilities, costs, and expenses of any nature resulting from or arising out of, or relating to the activities of Applicant or its representatives, officers, employees, contractors, or agents under this Agreement or with respect to the expedited service. The Applicant acknowledges that the Oregon Water Resources Department cannot and does not guarantee a favorable review under the subject regulatory process.



- For Applicant:

Applicant's Representative

7/17/2023

Date \_\_\_\_\_

For OWRD:

Dwight French – Administrator

Date \_\_\_\_\_

Revised December 2, 2022.shp





# Oregon

Tina Kotek, Governor

## Water Resources Department

North Mall Office Building

725 Summer St NE, Suite A

Salem, OR 97301

Phone 503 986-0900

Fax 503 986-0904

July 5, 2023

CITY OF ECHO  
ATTN: DAVID SLAGHT  
PO BOX 9  
ECHO, OR 97826

Reference: Application T-14270

On June 30, 2023, OWRD received your water right Permit Amendment Application. The application was accompanied by \$1840.00. Our receipt number 141053 is enclosed.

By copy of this letter, we are asking the Watermaster for a report regarding the potential for injury to existing water rights which may be caused by the requested change. A review form will also be sent to our groundwater staff to determine whether the proposed well accesses the same source of water as the original well.

This application may require publication of a notice for two consecutive weeks in a newspaper with general circulation in the area where the water right is located. If it is determined that newspaper notice will be required, the Department will prepare the notice and notify you of the cost. You will be responsible for submitting payment to the Department prior to publication of the notice.

Except as provided under ORS 540.510(3) for municipalities, you may not use water from the new point of appropriation until a final order approving the application has been issued by the Department.

Refer to the following page for a chart showing the steps and expected timelines for the processing of your application.

If you have any questions, please contact the Transfer Section at (503) 986-0935.

Cc: Watermaster Dist. #5, Gregory M. Silbernagel (via email)  
Ted Ressler, Agent  
City of Stanfield

Enclosure



Check Date: 6/23/2023

78251

Invoice Number	Date	Voucher	Amount	Discounts	Previous Pay	Net Amount
RA Estimate Fee	6/20/2023	0228493	125.00			125.00
Oregon Water Resources Department			125.00			125.00
COMERICA GENERAL						
1						
		262158				
		TOTAL				

STATE OF OREGON  
WATER RESOURCES DEPARTMENT  
725 Summer St. N.E. Ste. A  
SALEM, OR 97301-4172  
(503) 986-0900 / (503) 986-0904 (fax)

RECEIPT # 141059

INVOICE # \_\_\_\_\_

RECEIVED FROM:

Geo-Logic Associates

BY:

APPLICATION

PERMIT

TRANSFER

T-14270

CASH:

CHECK: #

OTHER: (IDENTIFY)

☐

78251

☐

TOTAL REC'D

\$125.00

1083 TREASURY 4170 WRD MISC CASH ACCT

0407 COPIES

47124 R11-452-25

\$

0412 OTHER:

(IDENTIFY) Transfer Rumboldt

\$125.00

0243 I/S Lease

0244 Muni Water Mgmt. Plan

0245 Cons. Water

4270 WRD OPERATING ACCT

## MISCELLANEOUS

0407 COPY &amp; TAPE FEES

\$

0410 RESEARCH FEES

\$

0408 MISC REVENUE: (IDENTIFY)

\$

TC162 DEPOSIT LIAB. (IDENTIFY)

\$

0240 EXTENSION OF TIME

\$

## WATER RIGHTS:

## EXAM FEE

0201 SURFACE WATER

\$

0202

0203 GROUND WATER

\$

0204

0205 TRANSFER

\$

## WELL CONSTRUCTION

## EXAM FEE

0218 WELL DRILL CONSTRUCTOR

\$

0219

LANDOWNER'S PERMIT

0220

OTHER (IDENTIFY)

0536 TREASURY 0437 WELL CONST. START FEE

0211 WELL CONST START FEE

\$

CARD#

0210 MONITORING WELLS

\$

CARD#

OTHER (IDENTIFY)

0607 TREASURY 0467 HYDRO ACTIVITY

LIC NUMBER

0233 POWER LICENSE FEE (FW/WRD)

\$

0231 HYDRO LICENSE FEE (FW/WRD)

\$

HYDRO APPLICATION

\$

TREASURY OTHER / RDX

FUND TITLE

OBJ. CODE VENDOR #

DESCRIPTION

\$

RECEIPT:

141059

DATED:

6/30/23

BY:

C. D. Miller

Distribution - White Copy - Customer, Yellow Copy - Fiscal, Blue Copy - File, Buff Copy - Fiscal

RECEIVED  
JUN 30 2023

OWRD





OREGON WATER RESOURCES DEPARTMENT  
TRANSFER REIMBURSEMENT AUTHORITY  
ESTIMATE APPLICATION



ORS 536.055 authorizes the Oregon Water Resources Department to expedite or enhance regulatory processes voluntarily requested under the agreement.  
**Please contact Transfer Personnel before submitting this request; as the application fee is a non-refundable \$125.00 fee per request. Checks submitted for this application should be separate From Transfer fees.**  
The purpose of this application is to obtain estimates of the cost and time required to process a Transfer Application Request. **There is a non-refundable application fee of \$125.00 per request.**

REQUEST	TYPE	FILE NUMBER
<input checked="" type="checkbox"/>	Transfer Application	Transfer Number <u>T-14270</u>

	Applicant Information	Applicant's Representative/Contact
Name:	David Slaght	Theodore Ressler, RG, CWRE
Address:	City of Echo PO Box 9 Echo, OR 97826	Summit Water Resources, LLC 4784 SE 17 <sup>th</sup> Avenue, Suite 111 Portland, OR 97202
Phone:	541-376-6038	503-967-7050 x204
Fax:	-	-
E-Mail Address:	dave@echo-oregon.com	tressler@summitwr.com

I understand the following:

- That upon receipt of my non-refundable application fee of \$ 125.00, OWRD will, within fourteen (14) days, notify me in writing of the estimate of costs and time frame for the expedited service.
- That this fee covers the reimbursement authority staff to evaluate and provide the estimate for processing of the request.
- That OWRD will, within fourteen (14) days, notify me in writing of the estimates of costs and time frame for the expedited service.
- That upon receiving the estimate I may agree or decline to enter into a formal contract to pay the estimated cost in advance to initiate the expedited service.
- An incomplete or inaccurate application may delay the process and increase the cost to process my request.
- Expedited processing does not guarantee a favorable review of my request.
- Send completed Application and payment to:

Oregon Water Resources Department  
Transfer Reimbursement Authority Program  
725 Summer St. NE, Suite A  
Salem, OR 97301-1271

RECEIVED

JUN 30 2023

OWRD

I certify that I am the (check one):

☒ Applicant ☐ Applicant's Representative ☐ Other (Please specify) \_\_\_\_\_

Name: David Slaght - City of Echo

Signature: \_\_\_\_\_

OWRD USE ONLY: Reimbursement Authority Number: R11- 452-25



Check Date: 6/23/2023

78252

Invoice Number	Date	Voucher	Amount	Discounts	Previous Pay	Net Amount
Transfer Fee Permit	6/20/2023	0228494	1,840.00			1,840.00
Oregon Water Resources Department						
COMERICA GENERAL	2	262158	1,840.00			1,840.00
		TOTAL	1,840.00			

STATE OF OREGON  
**WATER RESOURCES DEPARTMENT**  
 725 Summer St. N.E. Ste. A  
 SALEM, OR 97301-4172  
 (503) 986-0900 / (503) 986-0904 (fax)

RECEIPT # **141053**

INVOICE # \_\_\_\_\_

RECEIVED FROM: GEO-LOGIC ASSOCIATES

BY: \_\_\_\_\_

APPLICATION \_\_\_\_\_

PERMIT \_\_\_\_\_

TRANSFER T-14270CASH: ☐ CHECK: # 78252 OTHER: (IDENTIFY) ☐TOTAL REC'D \$ 1,840.00**1083 TREASURY 4170 WRD MISC CASH ACCT**

0407 COPIES \$

OTHER: (IDENTIFY) \$

0243 I/S Lease \_\_\_\_\_ 0244 Muni Water Mgmt. Plan \_\_\_\_\_ 0245 Cons. Water \_\_\_\_\_

**4270 WRD OPERATING ACCT****MISCELLANEOUS**

0407 COPY &amp; TAPE FEES \$

0410 RESEARCH FEES \$

0408 MISC REVENUE: (IDENTIFY) \$

TC162 DEPOSIT LIAB. (IDENTIFY) \$

0240 EXTENSION OF TIME \$

**WATER RIGHTS:**

0201 SURFACE WATER \$

0203 GROUND WATER \$

0205 TRANSFER \$ 1,840.00**WELL CONSTRUCTION**

0218 WELL DRILL CONSTRUCTOR \$

LANDOWNER'S PERMIT

OTHER (IDENTIFY) \_\_\_\_\_

**EXAM FEE**

\$

0202

\$

0204

\$ 1,840.00**EXAM FEE**

\$

0219

0220

**RECORD FEE**

\$

\$

**LICENSE FEE**

\$

\$

**0536 TREASURY 0437 WELL CONST. START FEE**

0211 WELL CONST START FEE \$

0210 MONITORING WELLS \$

OTHER (IDENTIFY) \_\_\_\_\_

CARD# \_\_\_\_\_

CARD# \_\_\_\_\_

**0607 TREASURY 0467 HYDRO ACTIVITY LIC NUMBER**

0233 POWER LICENSE FEE (FW/WRD) \$

0231 HYDRO LICENSE FEE (FW/WRD) \$

HYDRO APPLICATION \$

**TREASURY OTHER / RDX**

FUND \_\_\_\_\_ TITLE \_\_\_\_\_

OBJ. CODE \_\_\_\_\_ VENDOR # \_\_\_\_\_

DESCRIPTION \_\_\_\_\_ \$

RECEIPT:

**141053**DATED: 6/30/23BY: Geo-Logic AssociatesRECEIVED  
JUN 30 2023

OWRD



# Application for Permit Amendment

## Part 1 of 5 – Minimum Requirements Checklist



Oregon Water Resources Department  
725 Summer Street NE, Suite A  
Salem, Oregon 97301-1266  
(503) 986-0900  
[www.oregon.gov/OWRD](http://www.oregon.gov/OWRD)

**This permit amendment application will be returned if Parts 1 through 5 and all required attachments are not completed and included.**

For questions, please call (503) 986-0900, and ask for Transfer Section.

RECEIVED

JUN 30 2023

OWRD

Check all items included with this application. (N/A = Not Applicable)

- ☒ Part 1 – Completed Minimum Requirements Checklist.
- ☒ Part 2 – Completed Application Map Checklist.
- ☒ Part 3 – Application Fee, payable by check to the Oregon Water Resources Department, and completed Fee Worksheet, page 3. Try the new online fee calculator at:  
[http://apps.wrd.state.or.us/apps/misc/wrd\\_fee\\_calculator](http://apps.wrd.state.or.us/apps/misc/wrd_fee_calculator).
- ☒ Part 4 – Completed Applicant Information and Signature.
- ☒ Part 5 – Information about Permits to be Amended: **Number of permits to be amended: 1**  
**List the Permits here: G-18545**  
Please include a separate Part 5 for each permit. (See instructions on page 6)
- ☒ Completed Permit Amendment Application Map (Does not have to be prepared by a Certified Water Right Examiner).
- ☐ ☒ N/A Request for Assignment Form and statutory fee. The request for assignment form has to be completed if the applicant is **not** the permit holder of record and needs to be assigned to the permit; or the landowner of the proposed place of use is not the permit holder of record and needs to be assigned to the permit (the Request for Assignment Form is available online at <https://www.oregon.gov/OWRD/Forms/Pages/default.aspx>). Assignment is not needed if the applicant is the permit holder of record.
- ☐ ☒ N/A Affidavit(s) of Consent are required from all permit holder(s) of record if the permit is not assigned to the applicant or other permit holders of record that are not listed as applicants.
- ☒ ☐ N/A Oregon Water Resources Department's Land Use Information Form with approval and signature (or signed land use form receipt stub) from each local land use authority in which water is to be diverted, conveyed, and/or used. Not required if water is to be diverted, conveyed, and/or used only on federal lands or if all of the following apply: a) a change in place of use only, b) no structural changes, c) the use of water is for irrigation only, and d) the use is located within an irrigation district or an exclusive farm use zone.
- ☒ ☐ N/A Water Well Report/Well Log for changes in point(s) of appropriation (well(s)) or additional point(s) of appropriation.
- ☐ ☒ N/A Geologist Report for a change from a surface water point of diversion to a ground water point of appropriation (well), if the proposed well is more than 500 feet from the surface water source and more than 1000 feet upstream or downstream from the point of diversion. (ORS 540.531(2) or (3)).

(For Staff Use Only)

**WE ARE RETURNING YOUR APPLICATION FOR THE FOLLOWING REASON(S):**

- ☐ Application fee not enclosed/insufficient
- ☐ Land Use Form not enclosed or incomplete
- ☐ Additional signature(s) required
- ☐ Map not included or incomplete
- ☐ Part \_\_\_\_\_ is incomplete

Other/Explanation \_\_\_\_\_

Staff: \_\_\_\_\_ 503- \_\_\_\_\_ Date: \_\_\_\_/\_\_\_\_/\_\_\_\_



## Part 2 of 5 – Permit Amendment Map Checklist

Your permit amendment application will be returned if any of the map requirements listed below are not met.

Please be sure that the map you submit includes all the items listed below and meets the requirements of OAR 690-380-3100, however, the map does not have to be prepared by a Certified Water Right Examiner. Check all boxes that apply.

RECEIVED

JUN 30 2023

OWRD

- ☐ ☒ N/A If more than three permits are involved, separate maps for each permit.
- ☒ Permanent quality printed with dark ink on good quality paper.
- ☒ The size of the map can be 8½ x 11 inches, 8½ x 14 inches, 11 x 17 inches, or up to 30 x 30 inches. For 30 x 30 inch maps, one extra copy is required.
- ☒ A north arrow, a legend, and scale.
- ☒ The scale of the map must be: 1 inch = 400 feet, 1 inch = 1,320 feet, the scale of the county assessor map if the scale is not smaller than 1 inch = 1,320 feet, or a scale that has been pre-approved by the Department.
- ☒ Township, Range, Section, ¼ ¼, DLC, Government Lot, and other recognized public land survey lines.
- ☒ Tax lot boundaries (property lines) are required. Tax lot numbers are recommended.
- ☒ Major physical features including rivers and creeks showing direction of flow, lakes and reservoirs, roads, and railroads.
- ☒ Major water delivery system features from the point(s) of diversion/appropriation such as main pipelines, canals, and ditches.
- ☒ Existing place of use that includes separate hachuring for each water use permit, priority date, and use including number of acres in each quarter-quarter section, government lot, or in each quarter-quarter section as projected within government lots, donation land claims, or other recognized public land survey subdivisions. If less than the entirety of the permit is being changed, a separate hachuring is needed for the portion of the permit left unchanged.
- ☐ ☒ N/A If you are proposing a change in place of use, show the proposed place of use with hachuring that includes separate hachuring for each permit, priority date, and use including number of acres in each quarter-quarter section, government lot, or in each quarter-quarter section as projected within government lots, donation land claims, or other recognized public land survey subdivisions.
- ☒ Existing point(s) of diversion or well(s) with distance and bearing or coordinates from a recognized survey corner. This information can be found in your water use permit.
- ☒ ☐ N/A If you are proposing a change in point(s) of diversion or well(s), show the proposed location and label it clearly with distance and bearing or coordinates. If GPS coordinates are used, latitude-longitude coordinates may be expressed as either degrees-minutes-seconds with at least one digit after the decimal (example – 42°32'15.5") or degrees-decimal with five or more digits after the decimal (example – 42.53764°).



### Part 3 of 5 – Fee Worksheet

FEE WORKSHEET for PERMIT AMENDMENT		
1	Base Fee (includes one type of change to one permit for up to 1 cfs)	\$1,360
2	Types of change proposed: <input type="checkbox"/> Place of Use <input checked="" type="checkbox"/> Point of Diversion/Appropriation Number of above boxes checked = <u>1</u> (2a) Subtract 1 from the number in line 2a = <u>0</u> (2b) <i>If only one change, this will be 0</i> Multiply line 2b by \$1090 and enter »	\$0
3	Number of permits included in Permit Amendment <u>1</u> (3a) Subtract 1 from the number in 3a: <u>0</u> (3b) <i>If only one permit this will be 0</i> Multiply line 3b by \$610 and enter »	\$0
4	Do you propose to add or change a well, or change from a surface water POD to a well? <input type="checkbox"/> No: enter 0 <input checked="" type="checkbox"/> Yes: enter \$480 for the 1 <sup>st</sup> well to be added or changed <u>\$480</u> (4a) Do you propose to add or change additional wells? <input checked="" type="checkbox"/> No: enter 0 <input type="checkbox"/> Yes: multiply the number of additional wells by \$410 _____ (4b) Add line 4a to line 4b and enter »	\$480
5	Do you propose to change the place of use? <input checked="" type="checkbox"/> No: enter 0 on line 5 <input type="checkbox"/> Yes: enter the cfs for the portions of the permits to be amended (see below*): _____ (5a) Subtract 1.0 from the number in 5a above: _____ (5b) If 5b is 0, enter 0 on line 5 » If 5b is greater than 0, round up to the nearest whole number: _____ (5c) and multiply 5c by \$350, then enter on line 5 »	\$0
6	Add entries on lines 1 through 5 above » » » » » » » » » » Subtotal:	\$1,840
7	Is this permit amendment: <input type="checkbox"/> necessary to complete a project funded by the Oregon Watershed Enhancement Board (OWEB) under ORS 541.932? <input type="checkbox"/> endorsed in writing by ODFW as a change that will result in a net benefit to fish and wildlife habitat? If one or more boxes is checked, multiply line 6 by 0.5 and enter on line 7 If no box is applicable, enter 0 on line 7 »	\$0
8	Subtract line 7 from line 6 » <b>Permit Amendment Fee:</b>	<b>\$1,840</b>

\*Example for Line 5a calculation to transfer 45.0 acres of Primary Permit S-12345 (total 1.25 cfs for 100 acres) and 45.0 acres of Supplemental Permit S-87654 (1/80 cfs per acre) on the same land:

1. For irrigation calculate cfs for each permit involved as follows:
  - a. Divide total authorized cfs by total acres in the permit (*for S-12345, 1.25 cfs ÷ 100 ac*); then multiply by the number of acres to be changed to get the application cfs (*x 45 ac = 0.56 cfs*).
  - b. If the water right permit does not list total cfs, but identifies the allowable use as 1/40 or 1/80 of a cfs per acre; multiply number of acres proposed for change by either 0.025 (1/40) or 0.0125 (1/80). (*For S-87654, 45.0 ac x 0.0125 cfs/ac = 0.56 cfs*)
2. Add cfs for the portions of permits on all the land included in the application; however **do not count cfs for supplemental permits on acreage for which you have already calculated the cfs fee for the primary permit on the same land**. The fee should be assessed only once for each "on the ground" acre included in the application. (*In this example, blank 5a would be only 0.56 cfs, since both permits serve the same 45.0 acres. Blank 5b would be 0 and Line 5 would then also become 0*).



# Part 4 of 5 – Applicant Information and Signature

## Applicant Information

APPLICANT/BUSINESS NAME City of Echo, ATTN: David Slaght, City Administrator			PHONE NO. 541-376-6038	ADDITIONAL CONTACT NO. -
ADDRESS PO Box 9			FAX NO. -	
CITY Echo	STATE OR	ZIP 97826	E-MAIL dave@echo-oregon.com	
BY PROVIDING AN E-MAIL ADDRESS, CONSENT IS GIVEN TO RECEIVE ALL CORRESPONDENCE FROM THE DEPARTMENT ELECTRONICALLY. COPIES OF THE FINAL ORDER DOCUMENTS WILL ALSO BE MAILED.				

**Agent Information** – The agent is authorized to represent the applicant in all matters relating to this application.

AGENT/BUSINESS NAME Theodore Ressler, RG, CWRE / Summit Water Resources			PHONE NO. 503-967-7050 x204	ADDITIONAL CONTACT NO. -
ADDRESS 4784 SE 17 <sup>th</sup> Avenue, Suite 111			FAX NO. -	
CITY Portland	STATE OR	ZIP 97202	E-MAIL tressler@summitwr.com	
BY PROVIDING AN E-MAIL ADDRESS, CONSENT IS GIVEN TO RECEIVE ALL CORRESPONDENCE FROM THE DEPARTMENT ELECTRONICALLY. COPIES OF THE FINAL ORDER DOCUMENTS WILL ALSO BE MAILED.				

Explain in your own words what you propose to accomplish with this permit amendment; and why:  
The City of Echo wishes to add a point of appropriation (Stanfield Well 5, UMAT-57155) to Permit G-18545 to more efficiently use the authorized capacity of Permit G-18545 to reliably provide municipal supply for the City of Echo. The proposed point of appropriation is located within the same subarea as the authorized points of appropriation on Permit G-18545 (Stage Gulch Critical Groundwater Area, Subarea A).

If you need additional space, continue on a separate piece of paper and attach to the application as "Attachment 1".

☐ Check this box if this project is fully or partially funded by the American Recovery and Reinvestment Act. (Federal stimulus dollars)

Is the applicant the permit holder of record? ☒ Yes ☐ No

If NO, include either:

- ☐ A completed assignment form (with required statutory assignment fee), assigning all or a portion of the permit to the applicant(s), OR
- ☐ An affidavit of consent from the permit holder(s) of record that gives permission for the applicant to amend the permit.

Has the Completion ("C") Date of the permit(s) in this application expired? ☐ Yes ☒ No

If YES, this application will not be accepted by the Department.

If NO, what are the completion dates of the permit(s)? 10/1/2028

- If the permit completion date expires while the Permit Amendment Application is pending, the Department will not approve the Permit Amendment Application until an Extension of Time Application is approved for the permit.
- You may consider using the Reimbursement Authority process to expedite the processing of this Permit Amendment Application if the completion date of the permit expires within 6 months of the date of filing this application.

By my signature below, I confirm that I understand:

- Prior to Department approval of the permit amendment, I may be required to submit payment to the Department for publication of a notice in a newspaper with general circulation in the area where the permit is located, once per week for two consecutive weeks. If more than one qualifying newspaper is available, I suggest publishing the notice in the following newspaper: The East Oregonian

I (we) affirm that the information contained in this application is true and accurate.

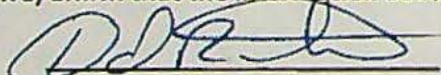
  
Applicant Signature

David Slaght, City Administrator

Print Name (and Title if applicable)

Date

5-17-23



**Check one of the following:**

- ☒ The applicant is responsible for completion of change(s). Notices and correspondence should continue to be sent to the applicant.
- ☐ The permit holder(s) of record will be responsible for completing the proposed change(s) after the final order is issued. Copies of notices and correspondence should be sent to the permit holder(s) of record.

**Check the appropriate box, if applicable:**

- ☐ Check here if any of the permits proposed for amendment are or will be located within or served by an irrigation or other water district.

IRRIGATION DISTRICT NAME	ADDRESS	
CITY	STATE	ZIP

- ☐ Check here if water for any of the permits supplied under a water service agreement or other contract for stored water with a federal agency or other entity.

ENTITY NAME	ADDRESS	
CITY	STATE	ZIP

 To meet State Land Use Consistency Requirements, you must list all local governments (each county, city, municipal corporation, or tribal government) within whose jurisdiction water will be diverted, conveyed or used.

ENTITY NAME <b>City of Stanfield</b>	ADDRESS <b>PO Box 369, 160 South Main St</b>	
CITY <b>Stanfield</b>	STATE <b>OR</b>	ZIP <b>97875</b>

ENTITY NAME <b>City of Echo</b>	ADDRESS <b>PO Box 9</b>	
CITY <b>Echo</b>	STATE <b>OR</b>	ZIP <b>97826</b>

ENTITY NAME	ADDRESS	
CITY	STATE	ZIP

**RECEIVED**

**JUN 30 2023**

**OWRD**



Please use a separate Part 5 for each permit being changed. See instructions on page 6, to copy and paste additional Part 5s, or to add additional rows to tables within the form.

PERMIT # G-18545

**Table 1. Location of Authorized and Proposed Point(s) of Diversion (POD) or Appropriation (POA)**

(Note: If the POD/POA name is not specified in the permit, assign it a name or number here.)

POD/POA Name or Number	Is this POD/POA Authorized by the permit or is it Proposed?	If POA, OWRD Well Log ID# (or Well ID Tag # L-___)	Twp	Rng	Sec	¼ ¼	Tax Lot, DLC or Gov't Lot	Measured Distances (from a recognized survey corner)
Stanfield Well 5	<input type="checkbox"/> Authorized <input checked="" type="checkbox"/> Proposed	UMAT-57155	3N	29E	5	SESE	1509	877 feet north and 233 feet west from the SW corner of Section 5, T3N, R29E (W.M.)
Well 2	<input checked="" type="checkbox"/> Authorized <input type="checkbox"/> Proposed	UMAT-1314, 1313	3N	29E	16	NENE	100	South 17 degrees 41 minutes 8 seconds west 1,146 feet from NE corner of Section 16, T3N, R29E (W.M.)
Well 4	<input checked="" type="checkbox"/> Authorized <input type="checkbox"/> Proposed	UMAT-1311, 5842	3N	29E	16	SENE	100	South 22 degrees 2 minutes 29 seconds west 1,959 feet from NE corner of Section 16, T3N, R29E (W.M.)
Well 6A	<input checked="" type="checkbox"/> Authorized <input type="checkbox"/> Proposed	NOT CONSTRUCTED	3N	29E	9	SENW	400	2,530 feet south and 2,510 feet east from the NW corner of Section 9, T3N, R29E (W.M.)
Well 6B	<input checked="" type="checkbox"/> Authorized <input type="checkbox"/> Proposed	NOT CONSTRUCTED	3N	29E	9	SWNW	400	2,155 feet south and 765 feet east from the NW corner of Section 9, T3N, R29E (W.M.)

Check all type(s) of change(s) proposed below (change "CODES" are provided in parentheses):

- |   |  |
|---|--|
| <input type="checkbox"/> Place of Use (POU)                   | <input type="checkbox"/> Point of Appropriation/Well (POA)                   |
| <input type="checkbox"/> Point of Diversion (POD)             | <input checked="" type="checkbox"/> Additional Point of Appropriation (APOA) |
| <input type="checkbox"/> Additional Point of Diversion (APOD) | <input type="checkbox"/> Surface water POD to Ground Water POA (SW/GW)       |

Will all of the proposed changes affect the entire water use permit?

- ☒ Yes Complete only the proposed ("to" lands) section of Table 2 on the next page. Use the "CODES" listed above to describe the proposed changes.
- ☐ No Complete all of Table 2 to describe the portion of the permit to be changed.

For a change in place of use:

Does the permit holder of record own or control the land TO which the place of use is being moved?

☐ Yes ☐ No NA

If NO, the landowner of the land TO which the place of use is being moved must be assigned to the permit as a permit holder of record by submitting a completed Request for Assignment form and the required statutory fee for an assignment.

Is the proposed place of use contiguous to the authorized place of use? ☐ Yes ☐ No NA



The permitted place of use can be moved only to lands that are contiguous to the authorized place of use **unless** the change to non-contiguous lands is in furtherance of mitigation or conservation efforts undertaken for the purposes of benefiting a species listed as sensitive, threatened, or endangered under ORS 496.171 to 496.192 or the federal Endangered Species Act of 1973 (16 U.S.C. 1531 to 1544), as determined by the listing agency. Contiguous land being either adjacent land or land separated from the land to which a permit is authorized by roads, utility corridors, irrigation ditches or publicly owned rights of way.

RECEIVED

JUN 30 2023

OWRD



**Repetition of Changes to Water Use Permit # G-18545**

For each proposed change, specify the acreage in each ¼ ¼. If more than one change is proposed, specify the acreage associated with each change. If more than one POD/POA is involved in the proposed changes, specify the acreage associated with each POD/POA.

AUTHORIZED (the "from" or "off" lands) that appears on the certificate BEFORE PROPOSED CHANGES : part or portion of the water right that will be changed.							Proposed Changes (see "CODES" from previous page)	PROPOSED (the "to" or "on" lands) The listing as it would appear AFTER PROPOSED CHANGES are made.									
Sec	¼ ¼	Tax Lot	Gvt Lot or DLC	Acres (if applicable)	POD(s) or POA(s) (name or number from Table 1)	Priority Date		Twp	Rng	Sec	¼ ¼	Tax Lot	Gvt Lot or DLC	Acres	POD(s) or POA(s) to be used (from Table 1)		
							APOA	3	N	29	E	5	S½ SE	-	-	-	Well 2, Well 4, Well 6a, Well 6b, Stanfield Well 5
							APOA	3	N	29	E	8	E ½	-	-	-	
							APOA	3	N	29	E	9	NW NE	-	-	-	
							APOA	3	N	29	E	9	S½ NE	-	-	-	
							APOA	3	N	29	E	9	NW ¼	-	-	-	
							APOA	3	N	29	E	10	S ½	-	-	-	
							APOA	3	N	29	E	10	W½ SW	-	-	-	
							APOA	3	N	29	E	10	SE SW	-	-	-	
							APOA	3	N	29	E	15	NW ¼	-	-	-	
							APOA	3	N	29	E	16	N½ SW	-	-	-	
							APOA	3	N	29	E	16	N½	-	-	-	
							APOA	3	N	29	E	16	NE SW	-	-	-	
							APOA	3	N	29	E	16	N½ SE	-	-	-	
							APOA	3	N	29	E	17	SE SE	-	-	-	
							APOA	3	N	29	E	17	NE NE	-	-	-	
TOTAL ACRES							TOTAL ACRES							NA			

Remarks: The applicant is requesting to add an additional point of appropriation. No changes to the place of use or designated beneficial use are requested.

RECEIVED

JUN 30 2023

OWRD



Are there other water rights certificates, water use permits or ground water registrations associated with the "from" or "to" lands? ☒ Yes ☐ No However, Permit G-18545 is a municipal water right and does not layer with other water rights.

If YES, list the other certificate, permit, or ground water registration numbers: Permit G-64 and Certificate 92295 (additional municipal use water rights held by the City of Echo)

If the permit(s) are for irrigation or supplemental irrigation use, other water rights existing on the same land for irrigation that are subject to transfer must either change concurrently or be cancelled. Any change to a water right certificate or ground water registration must be filed separately in a water right transfer application or ground water registration modification application, respectively.

**For a change in point(s) of appropriation (well(s)) or additional point(s) of appropriation:**

- ☒ Well log(s) are attached for each authorized and proposed well(s) that are clearly labeled and associated with the corresponding well(s) in Table 1 above and on the accompanying application map. (Tip: You may search for well logs on the Department's web page at: [http://apps.wrd.state.or.us/apps/gw/well\\_log/Default.aspx](http://apps.wrd.state.or.us/apps/gw/well_log/Default.aspx))

**AND/OR**

- ☐ Describe the construction of the authorized and proposed well(s) in Table 3 for any wells that do not have a well log. For *proposed wells not yet constructed or built*, provide "a best estimate" for each requested information element in the table. The Department recommends you consult a licensed well driller, geologist, or certified water right examiner to assist with assembling the information necessary to complete Table 3.

### Table 3. Construction of Point(s) of Appropriation

Any well(s) in this listing must be clearly tied to corresponding well(s) described in Table 1 and shown on the accompanying application map. Failure to provide the information will delay the processing of your transfer application until it is received. The information is necessary for the department to assess whether the proposed well(s) will access the same source aquifer as the authorized point(s) of appropriation (POA). The Department is prohibited by law from approving POA changes that do not access the same source aquifer.

RECEIVED

JUN 30 2023

OWRD



Proposed or Authorized POA Name or Number	Is well already built? (Yes or No)	If an existing well, OWRD Well ID Tag No. L-_____	Total well depth	Casing Diameter	Casing Intervals (feet)	Seal depth(s) (intervals)	Perforated or screened intervals (in feet)	Static water level of completed well (in feet)	Source aquifer (sand, gravel, basalt, etc.)	Well - specific rate (cfs or gpm). If less than full rate of water right
Well 6A	No	NA	1500'	16"	0-1275'	0-1275'	1275-1500'	'--	Basalt, Subarea A, Stage Gulch CGWA	2,198
Well 6B	No	NA	1500'	16"	0-1275'	0-1275'	1275-1500'	'--	Basalt, Subarea A, Stage Gulch CGWA	2,198

See Attachment 3 for Well Logs for constructed authorized and proposed points of appropriation

As previously noted, the proposed APOA (Stanfield Well 5, UMAT-57155) is within the same subarea as the authorized POAs on Permit G-18545 (Stage Gulch Critical Groundwater Area, Subarea A).

RECEIVED

JUN 30 2023

OWRD



UMAT 1313

WELL 2

## NOTICE TO WATER WELL CONTRACTOR

The original and first copy  
of this report are to be  
filed with the

STATE ENGINEER, SALEM, OREGON 97310  
within 30 days from the date  
of well completion.

RECEIVED  
NOV 27 1964

## WATER WELL REPORT

STATE OF OREGON  
(Please type or print)

UMAT  
1313

State Well No. 3N/29-16

State Permit No. 6-8546 #2

## (1) OWNER:

Name City of Echo

Address Echo, Oregon

## (2) LOCATION OF WELL:

County Umatilla Driller's well number

1/4 NE 1/4 Section 16 T. 3 R. 29 W.M.

Bearing and distance from section or subdivision corner

## (3) TYPE OF WORK (check):

Well ☐ Deepening ☒ Reconditioning ☐ Abandon ☐  
Abandonment, describe material and procedure in Item 12.

## (4) PROPOSED USE (check):

Domestic ☐ Industrial ☐ Municipal ☒  
Irrigation ☐ Test Well ☐ Other ☐

## (5) TYPE OF WELL:

Rotary ☐ Driven ☐  
Cable ☒ Jetted ☐  
Dug ☐ Bored ☐

## (6) CASING INSTALLED:

Threaded ☐ Welded ☐

" Diam. from ft. to ft. Gage

" Diam. from ft. to ft. Gage

" Diam. from ft. to ft. Gage

## (7) PERFORATIONS:

Perforated? ☐ Yes ☐ No

Type of perforator used

Size of perforations in. by in.

perforations from ft. to ft.

perforations from ft. to ft.

perforations from ft. to ft.

perforations from ft. to ft.

perforations from ft. to ft.

## (8) SCREENS:

Well screen installed? ☐ Yes ☐ No

Manufacturer's Name

Model No.

Slot size Set from ft. to ft.

Diam. Slot size Set from ft. to ft.

## (9) CONSTRUCTION:

Well seal—Material used in seal

Depth of seal ft. Was a packer used?

Diameter of well bore to bottom of seal in.

Were any loose strata cemented off? ☐ Yes ☐ No DepthWas a drive shoe used? ☐ Yes ☐ NoWas well gravel packed? ☐ Yes ☐ No Size of gravel:

Gravel placed from ft. to ft.

Did any strata contain unusable water? ☐ Yes ☐ No

Type of water? depth of strata

Method of sealing strata off

## (10) WATER LEVELS:

Static level 315 ft. below land surface Date 6-20-64

Artesian pressure lbs. per square inch Date

## (11) WELL TESTS:

Drawdown is amount water level is lowered below static level

Was a pump test made? ☒ Yes ☐ No If yes, by whom? Contractor

Yield: 300 gal./min. with 0 ft. drawdown after 5 hrs.

" " " "

" " " "

Ballor test gal./min. with ft. drawdown after hrs.

Artesian flow g.p.m. Date

Temperature of water Was a chemical analysis made? ☐ Yes ☒ No

## (12) WELL LOG: Diameter of well below casing 8

Depth drilled ft. Depth of completed well 820 ft.

Formation: Describe by color, character, size of material and structure, and show thickness of aquifers and the kind and nature of the material in each stratum penetrated, with at least one entry for each change of formation.

MATERIAL	FROM	TO
Rock gray hard	495	557
Rock black soft	557	592
Rock gray hard	592	671
Rock gray medium	671	686
Rock gray soft	686	700
Rock red medium	700	704
Rock gray soft	704	715
Rock gray hard	715	731
Rock gray medium	731	739
Rock gray hard	739	761
Rock gray soft	761	782
Rock gray hard	782	798
Rock black soft (water)	798	813
Rock gray hard	813	820

RECEIVED

JUN 30 2023

OWRD

Work started 5-26-64 19 Completed 6-20-64 19

Date well drilling machine moved off of well 6-21-64 19

## (13) PUMP:

Manufacturer's Name

Type: H.P.

## Water Well Contractor's Certification:

This well was drilled under my jurisdiction and this report is true to the best of my knowledge and belief.

NAME Ben Dreyer Drilling Contractor

(Person, firm or corporation)

(Type or print)

Address Rt. 1 Box 225 Hermiston, Ore.

Drilling Machine Operator's License No. 126

[Signed]

Ben Dreyer

(Water Well Contractor)

Contractor's License No. 12 Date 6-25-64, 19



STATE ENGINEER  
Salem, Oregon

**UMAT 1314**  
**Well Record**

STATE WELL NO. 3N/29-16A(1)  
COUNTY Umatilla Co.  
APPLICATION NO. U-175

OWNER: City of Echo

MAILING  
ADDRESS: \_\_\_\_\_

LOCATION OF WELL: Owner's No. 2

CITY AND  
STATE: \_\_\_\_\_

NE  $\frac{1}{4}$  NE  $\frac{1}{4}$  Sec. 16 T. 3 N. E.  
S. R. 29 W., W.M.

Bearing and distance from section or subdivision  
corner \_\_\_\_\_

Altitude at well \_\_\_\_\_

TYPE OF WELL: drilled Date Constructed 1945-47

Depth drilled 520 Depth cased \_\_\_\_\_

CASING RECORD:

12"  
10"  
8"

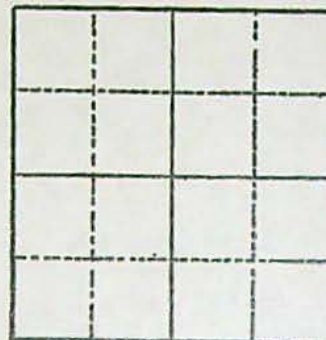

Section 16

FINISH: \_\_\_\_\_

AQUIFERS: \_\_\_\_\_

WATER LEVEL:

300' below land surface

PUMPING EQUIPMENT: Type \_\_\_\_\_ H.P. \_\_\_\_\_  
Capacity \_\_\_\_\_ G.P.M.

WELL TESTS:

Drawdown \_\_\_\_\_ ft. after \_\_\_\_\_ hours \_\_\_\_\_ G.P.M.

Drawdown \_\_\_\_\_ ft. after \_\_\_\_\_ hours \_\_\_\_\_ G.P.M.

USE OF WATER None-abandoned 1951 Temp. \_\_\_\_\_ °F. \_\_\_\_\_, 10.

SOURCE OF INFORMATION U-175

DRILLER or DIGGER \_\_\_\_\_

ADDITIONAL DATA:

Log ☒ Water Level Measurements \_\_\_\_\_ Chemical Analysis \_\_\_\_\_ Aquifer Test \_\_\_\_\_

REMARKS:

When in use, well furnished about 260 g.p.m.

RECEIVED

JUN 30 2023

OWRD



OWRD



# UMAT 1314

Wagner, N.S., 1949, Ground-water studies in Umatilla and Morrow Counties.  
Oregon Dept. of Geol. & Min. Ind. Bull. 41.

Echo City  
Well name  
Index number -- 77-4  
File number  
(Code: Tp., R., Sec., & Range.)

LOCATION:  
Umatilla County  
Umatilla  
Umatilla  
Tp. 28S Range 16E Section 16 of 36  
Final depth 520'

STATISTICS:  
Well type-Dug  
Drilled  
Driven  
Final depth 520'

City of Echo  
Owner's name  
Address

This record compiled by E.S.V. from  
date secured from the following sources:  
Driller

Date compiled October 1947

Material	Thickness (feet)	Depth (feet)	Remarks
Soil	4	4	Casing log and pump test
Gravel and hardpan	26	30	data entered on last log
Dirt	5	35	about.
Loose sand and gravel	2	37	
Red clay	7	44	
Loose gravel	2	46	
Hardpan	6	52	
Rock	4	56	
Red clay	6	62	
Soft red rock	10	72	70 - some water
Soft red rock	5	77	at 75 - last good water
Pea gravel	1 1/2	80 1/2	
Red clay	5	85 1/2	
Yellow rock with boulders	1 1/2	88	
Blue rock, broken and sand	12	100	Some water
Blue rock	5	105	
Hard rock, sand and blue clay			
between layers of boulders	10	125	
Solid rock	8	133	
Broken "cube" basalt	9	142	Very slow drilling
Blue gray basalt	10	152	
broken "cube" basalt 5" followed by very hard basalt	14	166	
Dark blue gray basalt, 8" zone of brown shale followed by	18	184	
Blue and gray basalt	30	214	
Shale and rock in 6" ave. layers	18	232	
Hard, solid clay	7	239	
Green shale	2	241	
Green shale, hard	16	257	Water at 257
Basalt	6	263	
Basalt - extremely hard	11	274	
Blue basalt - alternate soft and hard layers	4	278	
Brown rock	8	286	
Hard basalt	4	290	
Alternate hard rock and clay in 6" to 8" layers	6	296	
Cretaceous	4	300	Water dropped 20'
Blue rock and sand clay layers	28	328	
Hard basalt	62	390	
Extremely hard basalt	16	406	
Sand and crevices in basalt	4	410	Water dropped 50'
Very hard basalt	1	411	
Shale	1	412	
Blue rock with crevices	8	420	
Very hard gray basalt	5	425	

(continued)

Medium soft blue rock	12	437	
Black basalt	5	442	Water at 442
Boulder and crevice	1	443	Water and some sand. Drilled 5 hours with no penetration.
Black basalt (and water course)	17	460	Water dropped to 220' level
Hard boulders and soft spots	30	490	
Green clay sand & few inches thick between basalt layers	8	498	
Hard basalt	22	520	Bottom of hole
Casing logs			
12" hole to 167'			
10" hole to 109' to 330'			
6" hole 330' to 520'.			
Cased 167' with 10" casing.			
Pump test with 6" deep well pump at capacity output gave yield of 200 g.p.m.			
Drawdown with above equipment was 60' at 100 g.p.m. - No difference noted with greater flow.			
Temp. E.O. is 67°F.			

Gebert  
Well name  
Index number -- 119-4  
File number  
(Code: Tp., R., Sec., & Range.)

LOCATION:  
Morrow County  
Umatilla  
Umatilla  
Tp. 28S Range 16E Section 16 of 36  
Final depth 278'

STATISTICS:  
Well type-Dug  
Drilled  
Driven  
Final depth 278'

Gebert Holmes  
Owner's name  
Address

Date compiled October 1947

Material	Thickness (feet)	Depth (feet)	Remarks
Top soil	2 1/2	2 1/2	5 1/2" hole.
Shelly boulder formation	2 1/2	27	
Soft formation with little clay	8	35	
Blue basalt	34	69	Trace water at 50 feet.
Hard gray basalt	13	82	
Brown porous rock	7	89	
Hard blue rock	7	96	
Black to brown porous rock	14	110	
Moderately hard blue rock	26	136	
Very hard gray rock	19	155	
Hard blue porous basalt	5	160	
Hard solid blue basalt	6	166	
Brown porous rock	6	172	
Moderately hard black rock	8	180	
Gray rock	4	184	
Brown porous rock	10	194	

RECEIVED

JUN 30 2023

OWRD



believe. Stephen Schneider WWC Number 649  
Signed Stephen Schneider Date 6/18/93



RECEIVED

JUN 29 1993

WATER RESOURCES DEPT.  
SALEM, OREGON

City of Echo  
Start Card No. 46231  
by Schneider Drilling Co.  
May 18, 1993

<u>Depth</u>		<u>Description</u>
<u>From</u>	<u>To</u>	
600	607	Basalt, multi-color, soft, vesicular
607	612	Basalt, blackish gray, med
612	643	Basalt, gray, hard, fractured
643	655	Basalt, black, med-soft, fractured
655	660	Basalt, black, med, some fractures
660	690	Basalt, gray, hard
690	712	Basalt, grayish black, med, vesicular
712	725	Basalt, black, fractured
725	757	Basalt, black, fractured, med
757	770	Basalt, gray, fractured, hard
770	785	Basalt, black, vesicular, some frac, hard
785	805	Basalt, gray-green, vesicular, med-soft
805	834	Basalt, black, med
834	840	Basalt, blackish gray, hard
840	861	Basalt, gray, hard
861	865	Basalt, gray, vesicular, med-hard
865	880	Basalt, gray, hard
880	891	Basalt, black, ves, fractured, med-hard
891	898	Basalt, blackish gray, fractured
898	914	Basalt, red-grn w/quartz, soft, some caving
914	920	Basalt, blackish gray, fractured, med
920	935	Basalt, gray, very hard
935	939	Basalt, red-green, vesicular
939	948	Basalt, reddish gray, fractured, med-hard
948	979	Basalt, gray, hard
979	1030	Basalt, multi-clrd, ves, red-brn, med-soft, frac
1030	1039	Basalt, crumbly, multi-clrd, mostly red-brn & gray fractures
1039	1045	Basalt, gray, hard

RECEIVED

JUN 30 2023

OWRD

W32036.ECH



## NOTICE TO WATER WELL CONTRACTOR

The original and first copy  
of this report are to be  
filed with the

STATE ENGINEER, SALEM, OREGON 97310  
within 30 days from the date  
of well completion.

## WATER WELL REPORT

STATE OF OREGON

(Please type or print)

(Do not write above this line)

RECEIVED

AUG 7 1974

State Well No.

3N/29E-16

STATE ENGINEER  
SALEM, OREGON

State Permit No.

G-8546

Well #4

WELL 4

## (1) OWNER:

Name

City of Echo

Address

Echo, Oregon 97826

## (2) TYPE OF WORK (check):

New Well ☒ Deepening ☐ Reconditioning ☐ Abandon ☐

If abandonment, describe material and procedure in Item 12.

## (3) TYPE OF WELL:

Rotary ☒ Driven ☐  
Cable ☐ Jetted ☐  
Dug ☐ Bored ☐

## (4) PROPOSED USE (check):

Domestic ☐ Industrial ☐ Municipal ☒  
Irrigation ☐ Test Well ☐ Other ☐

## (5) CASING INSTALLED:

Threaded ☐ Welded ☐

10" Diam. from 0 ft. to 45 ft. Gage 250  
" Diam. from ft. to ft. Gage  
" Diam. from ft. to ft. Gage

## (6) PERFORATIONS:

Perforated? ☐ Yes ☒ No.

Type of perforator used

Size of perforations

in. by

in.

perforations from ft. to ft.  
perforations from ft. to ft.  
perforations from ft. to ft.

## (7) SCREENS:

Well screen installed? ☐ Yes ☒ No

Manufacturer's Name

Type

Model No.

Diam. Slot size Set from ft. to ft.

Diam. Slot size Set from ft. to ft.

## (8) WELL TESTS:

Drawdown is amount water level is  
lowered below static levelWas a pump test made? ☒ Yes ☐ No If yes, by whom?

Yield: 656 gal./min. with 18 ft. drawdown after 13 hrs.

Bailer test gal./min. with ft. drawdown after hrs.

Artesian flow g.p.m.

Temperature of water Depth artesian flow encountered ft.

## (9) CONSTRUCTION:

Well seal—Material used Cement

Well sealed from land surface to 45 ft.

Diameter of well bore to bottom of seal 14 in.

Diameter of well bore below seal 10 in.

Number of sacks of cement used in well seal 20 sacks

Number of sacks of bentonite used in well seal sacks

Brand name of bentonite

Number of pounds of bentonite per 100 gallons  
of water lbs./100 gals.Was a drive shoe used? ☒ Yes ☐ No Plugs Size: location ft.Did any strata contain unusable water? ☐ Yes ☒ No

Type of water? depth of strata

Method of sealing strata off

Was well gravel packed? ☐ Yes ☒ No Size of gravel: ft.

Gravel placed from ft. to ft.

## (10) LOCATION OF WELL:

County

Umatilla

Driller's well number

1/4

1/4 Section

16

T. 37N.

R. 29E.

W.M.

Bearing and distance from section or subdivision corner

Tay lot 3200

## (11) WATER LEVEL: Completed well.

Depth at which water was first found 353 ft.

Static level 315 ft. below land surface. Date 7-15-74

Artesian pressure lbs. per square inch. Date

## (12) WELL LOG:

Diameter of well below casing 10"

Depth drilled 600 ft. Depth of completed well 600 ft.

Formation: Describe color, texture, grain size and structure of materials;  
and show thickness and nature of each stratum and aquifer penetrated,  
with at least one entry for each change of formation. Report each change in  
position of Static Water Level and indicate principal water-bearing strata.

MATERIAL	From	To	SWL
Topsoil	0	5	
Claystone	5	20	
Rock, brown	20	37	
Basalt	37	146	
Rock, med. black	146	289	
Basalt	289	341	
Basalt, hard, gray	341	353	
Rock, porous, black	353	415	W.B.
Basalt, black	415	441	
Basalt, hard, gray	441	512	
Rock, black + blue claystone	512	532	
Rock, med. gray	532	548	
Rock, brown	548	554	
Basalt	554	585	
Rock, porous	585	600	W.B.

Work started 5-20 1974 Completed 8-1 1974

Date well drilling machine moved off of well 6-4 1974

## Drilling Machine Operator's Certification:

This well was constructed under my direct supervision.  
Materials used and information reported above are true to my  
best knowledge and belief.

[Signed] James T. Lental Date 8-5, 1974

(Drilling Machine Operator)

Drilling Machine Operator's License No. 665

## Water Well Contractor's Certification:

This well was drilled under my jurisdiction and this report is  
true to the best of my knowledge and belief.

Name TROY GRIFFIN (Type or print)

Address 900 HERMISTON AVE, HERMISTON, ORE

[Signed] Troy Griffin (Water Well Contractor)

Contractor's License No. 65 Date 8-2, 1974

(USE ADDITIONAL SHEETS IF NECESSARY)

RECEIVED 45050-119

JUN 30 2023







**UMAT 57155**

WATER SUPPLY WELL REPORT -  
continuation page

WELL I.D. # L 108240

START CARD # 208746

### (5) BORE HOLE CONSTRUCTION

[illegible]

FILTER PACK			
From	To	Material	Size

### (6) CASING/LINER

Casing Liner	Dia	+	From	To	Gauge	Stl	Plstc	Wld	Thrd
	16		1,057	1,075	.375				
	16		1,100	1,114	.375				
	30		35	64	.375				

### (7) PERFORATIONS/SCREENS

[illegible]

**(8) WELL TESTS:** Minimum testing time is 1 hour

Yield gal/min	Drawdown	Drill stem/Pump depth	Duration (hr)

## Water Quality Concerns

[illegible]

### (10) STATIC WATER LEVEL

### Water Bearing Zones

[illegible]

(11) WELL LOG

[illegible]

## Comments/Remarks

There is a steel plate ring welded between the 24" and 20" casings at the top of the 24" casing.  
Bore hole dimensions are nominal diameters.  
Cement seal listed from 0'-89" is around outside of 24" casing. Other seals are around the 20" casing and between the 24" and 20" casings.



# UMAT 57155

## CITY OF STANFIELD

Well No. 5 - Start Card #208746

by Schneider Water Services

FM	TO	DESCRIPTION
0	10	Soil, brown, silty
10	23	Silt, brown, some sandy, packed
23	31	Silt, pinkish brown to brown, cemented
31	32	Silt, brown & gravel, 3" minus
32	36	Gravel, 3" minus & silt, brown
36	45	Silt, brown & gravel, 1-1/2" minus w/some sand
45	48	Gravel, 2-1/2" minus, sandy, cemented
48	54	Silt, brown & gravel, 1" minus w/sand
54	58	Gravel, 3" minus, cemented, sandy
58	60	Gravel, 3" minus & clay, brown, soft
60	65	Gravel, 3" minus, sandy, cemented & some clay
65	75	Basalt, grey & brown, medium, broken & some clay
75	76	Clay, light yellow, sandy, soft
76	79	Basalt, grey & brown, medium, broken
79	97	Basalt, grey & brown, medium-hard, fractured
97	128	Basalt, grey w/ brown, medium, fractured
128	134	Basalt, grey, medium w/claystone, green, medium-soft
134	135	Basalt, grey & some brown, w/some claystone, green, medium-soft
135	144	Basalt, grey medium w/claystone, green, medium-soft & some cinders, red, medium
144	147	Basalt, grey, medium & some claystone, green, medium-soft & some cinders, red, medium
147	152	Basalt, grey, medium-soft, fractured w/claystone, brown-yellow, soft & cinders, red, medium
152	172	Cinders, red, medium-soft w/claystone, brown-yellow, soft & some basalt, grey
172	176	Basalt, grey, medium, fractured w/cinders, red & some claystone, brown-yellow, soft-medium, fractured
176	177	Cinders, red, medium w/claystone, brown-yellow, soft
177	184	Basalt, grey-black, medium, fractured w/some cinders, red
184	270	Basalt, black, hard, some fractures
270	290	Basalt, black, medium, some vesicular w/cinders, red, soft & claystone, blue-green, soft
290	300	Basalt, black & red, medium-hard, some fractures
300	316	Basalt, black & red, medium, fractured w/claystone, green, soft
316	357	Basalt, black, medium-hard, some fractures & vesicles
357	372	Basalt, black, hard, some fractures
372	413	Basalt, black, medium, some vesicles & fractures w/some claystone, green, medium
413	417	Basalt, black, medium, some fractures & vesicles
417	436	Basalt, black-grey, hard, some fractures
436	450	Basalt, black w/grey, medium, fractured w/vesicles & claystone, green, medium-soft
450	460	Basalt, black, hard, some fractures
460	496	Basalt, black-grey, medium, w/fractures & some vesicles
496	530	Basalt, black, medium, w/fractures, some vesicular w/some claystone, green, medium
530	626	Basalt, grey, hard, some fractures
626	651	Basalt, grey, medium, some fractures w/claystone, green-grey, medium & some pyrite
651	652	Basalt, grey, medium, some vesicles
652	671	Basalt, grey, hard some fractures

RECEIVED  
JUN 30 2023  
OWRD

RECEIVED BY OWRD

MAR 13 2013

SALEM, OR



# UMAT 57155

## CITY OF STANFIELD

Well No. 5 - Start Card #208746

by Schneider Water Services

<u>FM</u>	<u>TO</u>	<u>DESCRIPTION</u>
671	680	Basalt, grey, medium-hard, fractured, some vesicles & pyrite
680	685	Basalt, grey, hard, some fractures & some claystone & pyrite
685	690	Basalt, grey, hard w/some pyrite
690	700	Basalt, grey, medium-hard, fractured, some vesicles
700	718	Basalt, grey, hard, some fractures
718	723	Basalt, grey, medium, fractured, some vesicles w/claystone, green, medium & some pyrite
723	747	Basalt, grey & some brown, medium-hard, fractured, some vesicles w/some claystone, green, medium & some pyrite
747	753	Basalt, grey, medium-hard, fractured w/some claystone, blue, medium & some pyrite
753	781	Basalt, grey, hard, fractured
781	785	Basalt, grey, hard, fractured w/some claystone, blue, medium
785	800	Basalt, grey, medium, fractured w/some vesicles
800	825	Basalt, grey, hard, fractured
825	826	Basalt, grey & brown, medium-hard, fractured, vesicular w/some claystone, grey, medium
826	828	Basalt, grey, very hard, fractured w/claystone, grey, medium
828	830	Basalt, grey, hard, fractured w/claystone, green, medium
830	835	Basalt, grey, very hard, some fractures
835	862	Basalt, grey, hard, some fractures
862	877	Basalt, grey, medium-hard, fractured, some vesicles & pyrite
877	892	Basalt, grey, medium-hard, fractured, some vesicles w/some claystone, green, medium
892	902	Basalt, grey, medium, fractured, some vesicles & claystone, blue-green, medium & some pyrite
902	904	Basalt, brown, medium, fractured, vesicular
904	909	Basalt, grey, medium-hard, fractured & claystone, blue-green, medium
909	925	Basalt, grey, hard, fractured
925	945	Basalt, dark grey, medium-soft, fractured, some vesicles & occasional claystone, green, soft
945	954	Basalt, grey, hard, some fractures
954	980	Basalt, black, medium-soft, fractured, some vesicles & claystone, green
980	1040	Basalt, dark grey, medium, fractured & some claystone, blue, medium
1040	1055	Basalt, dark grey, soft-medium, fractured, broken, vesicular & some claystone, blue-green, medium
1055	1060	Basalt, dark grey, medium, fractured, some vesicles & occasional claystone, blue-green, hard
1060	1078	Basalt, dark grey, hard, some fractures
1078	1096	Basalt, dark grey & reddish brown, medium-soft, fractured, broken, some vesicles
1096	1111	Basalt, grey, medium-hard, some fractures
1111	1116	Basalt, grey, hard, occasional fracture

RECEIVED BY OWRD

MAR 13 2013

SALEM, OR

RECEIVED

JUN 30 2023

OWRD



# Land Use Information Form

RECEIVED  
JUN 30 2023



Oregon Water Resources Department  
725 Summer Street NE, Suite A  
Salem, Oregon 97301-1266  
(503) 986-0900  
www.oregon.gov/OWRD

Applicant(s): City of Echo

OWRD

Mailing Address: PO Box 9

City: Echo

State: OR

Zip Code: 97826

Daytime Phone: 541-376-6038

## A. Land and Location

Please include the following information for all tax lots where water will be diverted (taken from its source), conveyed (transported), and/or used or developed. Applicants for municipal use, or irrigation uses within irrigation districts may substitute existing and proposed service-area boundaries for the tax-lot information requested below.

Township	Range	Section	¼ ¼	Tax Lot #	Plan Designation (e.g., Rural Residential/RR-5)	Water to be:	Proposed Land Use:
<u>3N</u>	<u>29E</u>	<u>5</u>	<u>SESE</u>	<u>1509</u>	<u>D/TC = Downtown/Tourist Commercial</u>	<input checked="" type="checkbox"/> Diverted <input checked="" type="checkbox"/> Conveyed <input type="checkbox"/> Used	<u>Municipal</u>
<u>Within the service area of the City of Echo</u>						<input type="checkbox"/> Diverted <input checked="" type="checkbox"/> Conveyed <input checked="" type="checkbox"/> Used	<u>Municipal</u>

List all counties and cities where water is proposed to be diverted, conveyed, and/or used or developed:

City of Stanfield, City of Echo

## B. Description of Proposed Use

Type of application to be filed with the Water Resources Department:

- ☐ Permit to Use or Store Water   
 ☐ Water Right Transfer   
 ☒ Permit Amendment or Ground Water Registration Modification  
☐ Limited Water Use License   
 ☐ Allocation of Conserved Water   
 ☐ Exchange of Water

Source of water: ☐ Reservoir/Pond    ☒ Ground Water    ☐ Surface Water (name) \_\_\_\_\_

Estimated quantity of water needed: 0 ☒ cubic feet per second    ☐ gallons per minute    ☐ acre-feet

Intended use of water: ☐ Irrigation    ☐ Commercial    ☐ Industrial    ☐ Domestic for \_\_\_\_\_ household(s)  
☒ Municipal    ☐ Quasi-Municipal    ☐ Instream    ☐ Other \_\_\_\_\_

Briefly describe:

The City of Echo is submitting a permit amendment to add an existing well owned by the City of Stanfield (UMAT-57155) to the City of Echo's existing groundwater permit (G-18545). The subject well (UMAT-57155) is an existing, operational well that is being connected to the to the City of Echo's water system to more efficiently use the authorized capacity of permit G-18545. No additional use of water is associated with this permit amendment beyond the current authorized capacity of permit G-18545 (4.9 cubic feet per second).

**Note to applicant:** If the Land Use Information Form cannot be completed while you wait, please have a local government representative sign the receipt at the bottom of the next page and include it with the application filed with the Water Resources Department.

See bottom of Page 3. →



RECEIVED

JUN 30 2023

OWRD

## For Local Government Use Only

The following section must be completed by a planning official from each county and city listed unless the project will be located entirely within the city limits. In that case, only the city planning agency must complete this form. This deals only with the local land-use plan. Do not include approval for activities such as building or grading permits.

**Please check the appropriate box below and provide the requested information**

- ☒ Land uses to be served by the proposed water uses (including proposed construction) are allowed outright or are not regulated by your comprehensive plan. Cite applicable ordinance section(s):
- ☐ Land uses to be served by the proposed water uses (including proposed construction) involve discretionary land-use approvals as listed in the table below. (Please attach documentation of applicable land-use approvals which have already been obtained. Record of Action/land-use decision and accompanying findings are sufficient.) If approvals have been obtained but all appeal periods have not ended, check "Being pursued."

Type of Land-Use Approval Needed (e.g., plan amendments, rezones, conditional-use permits, etc.)	Cite Most Significant, Applicable Plan Policies & Ordinance Section References	Land-Use Approval:	
		<input type="checkbox"/> Obtained <input type="checkbox"/> Denied	<input type="checkbox"/> Being Pursued <input type="checkbox"/> Not Being Pursued
		<input type="checkbox"/> Obtained <input type="checkbox"/> Denied	<input type="checkbox"/> Being Pursued <input type="checkbox"/> Not Being Pursued
		<input type="checkbox"/> Obtained <input type="checkbox"/> Denied	<input type="checkbox"/> Being Pursued <input type="checkbox"/> Not Being Pursued
		<input type="checkbox"/> Obtained <input type="checkbox"/> Denied	<input type="checkbox"/> Being Pursued <input type="checkbox"/> Not Being Pursued
		<input type="checkbox"/> Obtained <input type="checkbox"/> Denied	<input type="checkbox"/> Being Pursued <input type="checkbox"/> Not Being Pursued

Local governments are invited to express special land-use concerns or make recommendations to the Water Resources Department regarding this proposed use of water below, or on a separate sheet.

It is our understanding that this permit is to allow Echo's water rights to pull water from our Stanfield's well, which is in operation, and will still be using Stanfield's water rights as well, thus allowing both Stanfield and Echo to get water from this well for their respective cities.

Name: Benjamin Burgener Title: City Manager

Signature:  Phone: 541-449-3831 Date: 5/15/2023

Government Entity: City of Stanfield

**Note to local government representative:** Please complete this form or sign the receipt below and return it to the applicant. If you sign the receipt, you will have 30 days from the Water Resources Department's notice date to return the completed Land Use Information Form or WRD may presume the land use associated with the proposed use of water is compatible with local comprehensive plans.

### Receipt for Request for Land Use Information

Applicant name: \_\_\_\_\_

City or County: \_\_\_\_\_ Staff contact: \_\_\_\_\_

Signature: \_\_\_\_\_ Phone: \_\_\_\_\_ Date: \_\_\_\_\_



# Land Use Information Form



Oregon Water Resources Department  
725 Summer Street NE, Suite A  
Salem, Oregon 97301-1266  
(503) 986-0900  
www.oregon.gov/OWRD

Applicant(s): City of Echo

Mailing Address: PO Box 9

City: Echo

State: OR

Zip Code: 97826

Daytime Phone: 541-376-6038

## A. Land and Location

Please include the following information for all tax lots where water will be diverted (taken from its source), conveyed (transported), and/or used or developed. Applicants for municipal use, or irrigation uses within irrigation districts may substitute existing and proposed service-area boundaries for the tax-lot information requested below.

Township	Range	Section	¼ ¼	Tax Lot #	Plan Designation (e.g., Rural Residential/RR-5)	Water to be:	Proposed Land Use:
<u>3N</u>	<u>29E</u>	<u>5</u>	<u>SESE</u>	<u>1509</u>	<u>D/TC = Downtown/Tourist Commercial</u>	<input checked="" type="checkbox"/> Diverted <input checked="" type="checkbox"/> Conveyed <input type="checkbox"/> Used	<u>Municipal</u>
<u>Within the service area of the City of Echo</u>						<input type="checkbox"/> Diverted <input checked="" type="checkbox"/> Conveyed <input checked="" type="checkbox"/> Used	<u>Municipal</u>

List all counties and cities where water is proposed to be diverted, conveyed, and/or used or developed:

City of Stanfield, City of Echo

## B. Description of Proposed Use

Type of application to be filed with the Water Resources Department:

- ☐ Permit to Use or Store Water   
 ☐ Water Right Transfer   
 ☒ Permit Amendment or Ground Water Registration Modification  
☐ Limited Water Use License   
 ☐ Allocation of Conserved Water   
 ☐ Exchange of Water

Source of water: ☐ Reservoir/Pond    ☒ Ground Water    ☐ Surface Water (name) \_\_\_\_\_

Estimated quantity of water needed: 0    ☒ cubic feet per second    ☐ gallons per minute    ☐ acre-feet

Intended use of water: ☐ Irrigation    ☐ Commercial    ☐ Industrial    ☐ Domestic for \_\_\_\_\_ household(s)  
☒ Municipal    ☐ Quasi-Municipal    ☐ Instream    ☐ Other \_\_\_\_\_

Briefly describe:

The City of Echo is submitting a permit amendment to add an existing well owned by the City of Stanfield (UMAT-57155) to the City of Echo's existing groundwater permit (G-18545). The subject well (UMAT-57155) is an existing, operational well that is being connected to the to the City of Echo's water system to more efficiently use the authorized capacity of permit G-18545. No additional use of water is associated with this permit amendment beyond the current authorized capacity of permit G-18545 (4.9 cubic feet per second).

**Note to applicant:** If the Land Use Information Form cannot be completed while you wait, please have a local government representative sign the receipt at the bottom of the next page and include it with the application filed with the Water Resources Department.

See bottom of Page 3. →

RECEIVED

JUN 30 2023

OWRD



RECEIVED

JUN 30 2023

OWRD

**For Local Government Use Only**

The following section must be completed by a planning official from each county and city listed unless the project will be located entirely within the city limits. In that case, only the city planning agency must complete this form. This deals only with the local land-use plan. Do not include approval for activities such as building or grading permits.

**Please check the appropriate box below and provide the requested information**

- ☒ Land uses to be served by the proposed water uses (including proposed construction) are allowed outright or are not regulated by your comprehensive plan. Cite applicable ordinance section(s): *Comp Plan title 4 Chapter 3*
- ☐ Land uses to be served by the proposed water uses (including proposed construction) involve discretionary land-use approvals as listed in the table below. (Please attach documentation of applicable land-use approvals which have already been obtained. Record of Action/land-use decision and accompanying findings are sufficient.) If approvals have been obtained but all appeal periods have not ended, check "Being pursued."

Type of Land-Use Approval Needed (e.g., plan amendments, rezones, conditional-use permits, etc.)	Cite Most Significant, Applicable Plan Policies & Ordinance Section References	Land-Use Approval:	
		<input type="checkbox"/> Obtained <input type="checkbox"/> Denied	<input type="checkbox"/> Being Pursued <input type="checkbox"/> Not Being Pursued
		<input type="checkbox"/> Obtained <input type="checkbox"/> Denied	<input type="checkbox"/> Being Pursued <input type="checkbox"/> Not Being Pursued
		<input type="checkbox"/> Obtained <input type="checkbox"/> Denied	<input type="checkbox"/> Being Pursued <input type="checkbox"/> Not Being Pursued
		<input type="checkbox"/> Obtained <input type="checkbox"/> Denied	<input type="checkbox"/> Being Pursued <input type="checkbox"/> Not Being Pursued
		<input type="checkbox"/> Obtained <input type="checkbox"/> Denied	<input type="checkbox"/> Being Pursued <input type="checkbox"/> Not Being Pursued

Local governments are invited to express special land-use concerns or make recommendations to the Water Resources Department regarding this proposed use of water below, or on a separate sheet.

Name: David Slaght Title: City Administrator/Recorder

Signature:  Phone: 541-376-6038 Date: 5-15-2023

Government Entity: City of Echo

**Note to local government representative:** Please complete this form or sign the receipt below and return it to the applicant. If you sign the receipt, you will have 30 days from the Water Resources Department's notice date to return the completed Land Use Information Form or WRD may presume the land use associated with the proposed use of water is compatible with local comprehensive plans.

**Receipt for Request for Land Use Information**

Applicant name: \_\_\_\_\_

City or County: \_\_\_\_\_ Staff contact: \_\_\_\_\_

Signature: \_\_\_\_\_ Phone: \_\_\_\_\_ Date: \_\_\_\_\_





June 26, 2023

P. Kelly Starnes  
Transfer Applications  
Oregon Water Resources Department  
725 Summer Street NE, Suite A  
Salem, Oregon 97301-1271

**Subject:** Application for a Permit Amendment for Permit G-18545 and Request for Reimbursement Authority Processing

Mr. Starnes:

On behalf of the permittee, please find enclosed an application for a permit amendment for Permit G-18545 (Application G-8865). The permit holder would like to use Reimbursement Authority processing for the permit amendment, and Reimbursement Authority Estimate Application is included with this submittal. Please also find enclosed a check in the amount of \$1,965 for payment of the Reimbursement Authority Estimate fee (\$125) and payment of the permit amendment fee (\$1,840).

If you have any questions regarding the enclosed transfer application, please call me at 503-967-7050 x204.

Respectfully submitted,

Theodore Ressler, RG, CWRE  
Summit Water Resources LLC.

Enclosures:

Application for a Permit Amendment for Permit G-18545  
Transfer Reimbursement Authority Estimate Application  
Check #78252 in the amount of \$1,840  
Check #78251 in the amount of \$125

RECEIVED

JUN 30 2023

OWRD

Cc: David Slaght – City of Echo



Application for a Permit Amendment  
Permit G-18545, Application G-8865

A Water Right held by the City of Echo  
Township 3 North, Range 29 East, (W.M.)

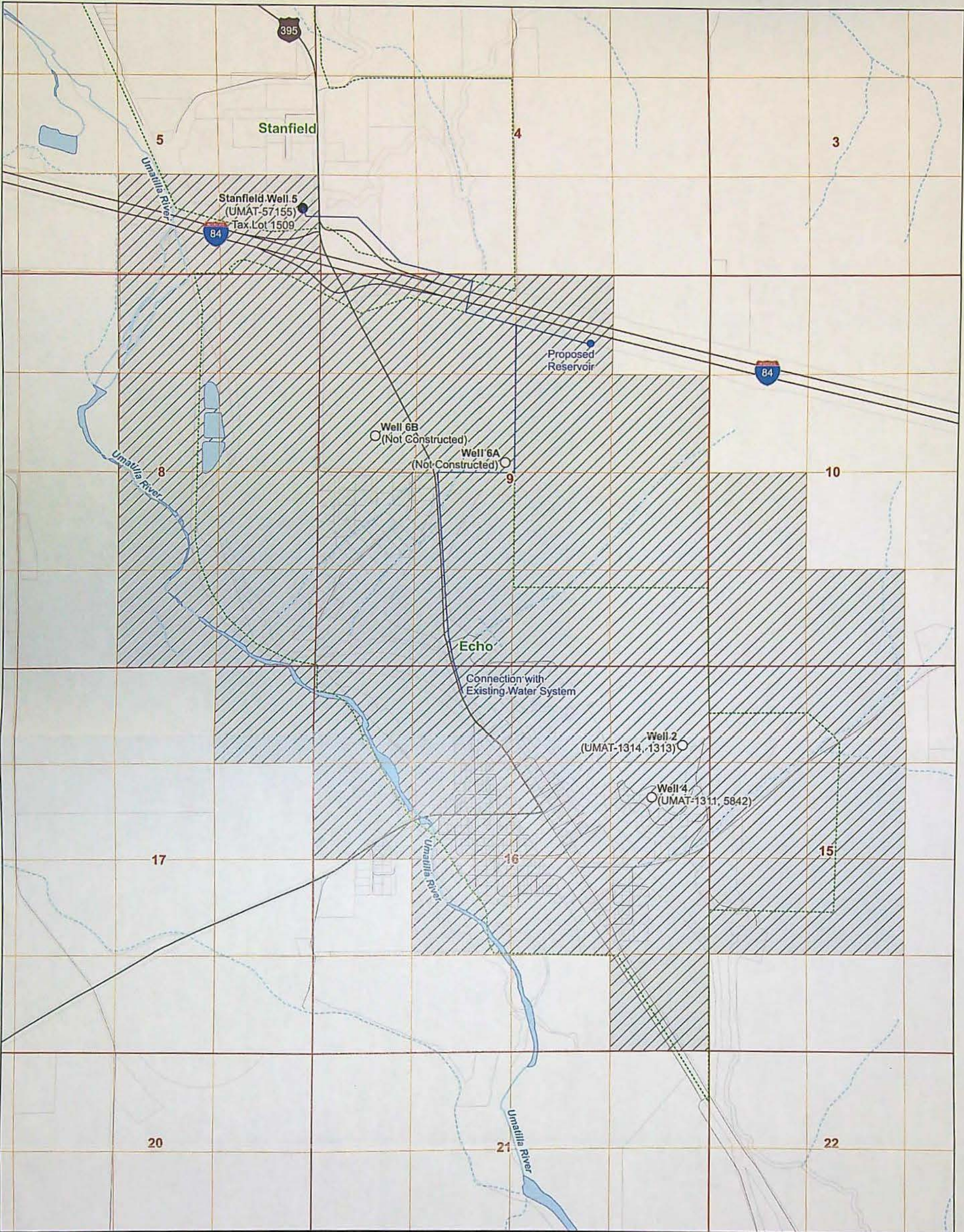

LEGEND

- Authorized Point of Appropriation (POA)
- Additional POA
- ▨ Authorized Place of Use (POU)
- ▭ Urban Growth Boundary
- ▭ Property Lines
- ▭ Sections
- ▭ Quarter Sections
- ~ Surface Water
- ~ Major Road
- ~ Mainline (Approximate)

POA Location Descriptions

Well 2 (UMAT-1314, 1313):  
Located south 17 degrees 41 minutes 8 seconds, west 1,146 feet from NE corner, Section 16, Township 3N, Range 29E (W.M.)  
Well 4 (UMAT-1311, 5842):  
Located south 22 degrees 2 minutes 29 seconds, west 1,959 feet from NE corner, Section 16, Township 3N, Range 29E (W.M.)  
Well 6A (Not Constructed):  
Located 2,530 feet south and 2,510 feet east from the NW corner of Section 9, Township 3N, Range 29E (W.M.)  
Well 6B (Not Constructed):  
Located 2,155 feet south and 765 feet east from the NW corner of Section 9, Township 3N, Range 29E (W.M.)  
Stanfield Well 5 (UMAT-57155):  
Located 877 feet north and 233 feet west from the SW corner of Section 5, Township 3N, Range 29E (W.M.)

Date: 5/17/2023  
Data Sources: OWRD, USGS, BLM, Umatilla County  
Disclaimer: This map was prepared for the purpose of identifying the location of a water right only and is not intended to provide legal dimensions or location of property ownership lines.

N

Scale  
0 660 1,320 ft  
1-inch = 1,320 feet

RECEIVED

JUN 30 2023

OWRD





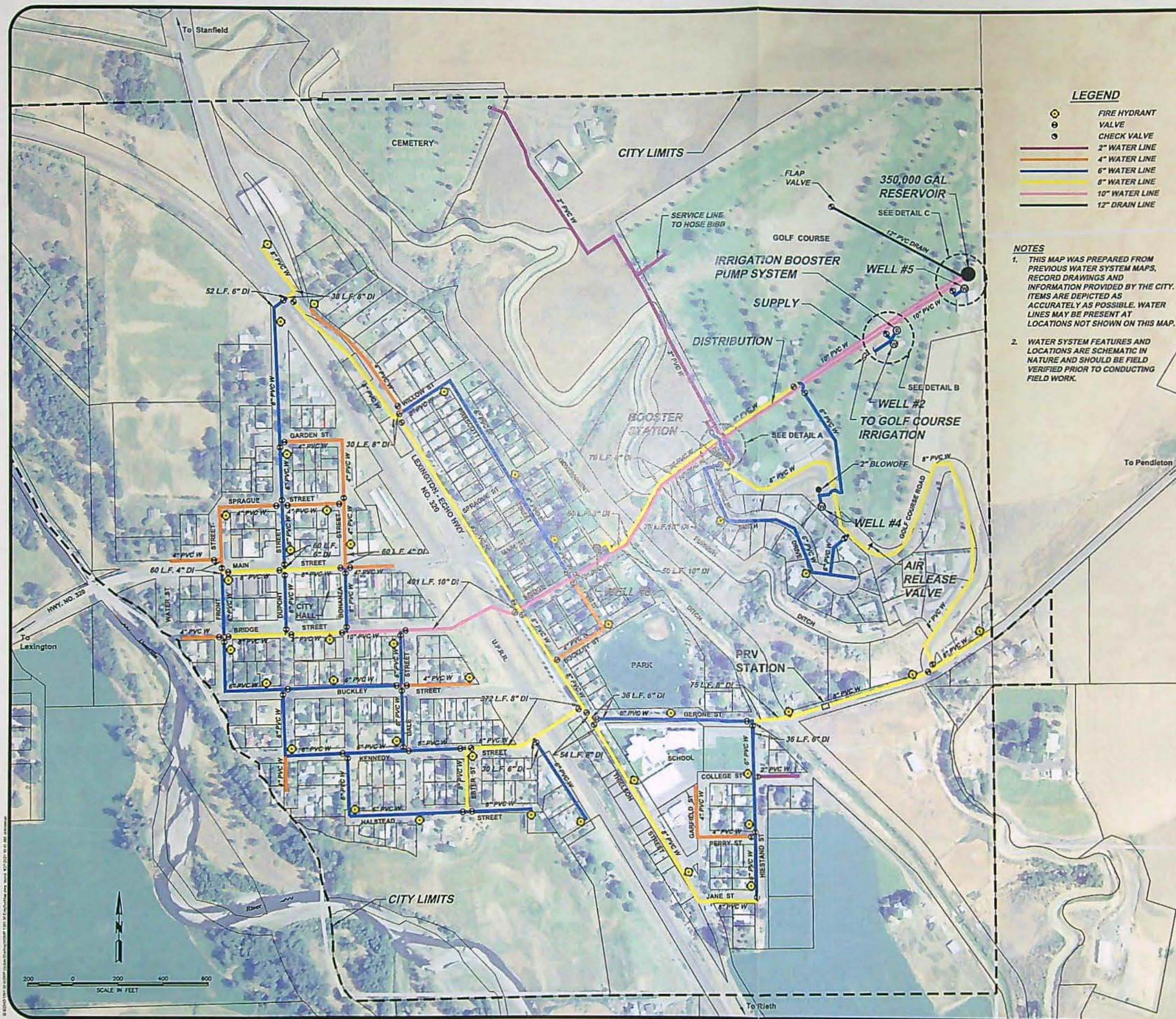

- LEGEND**
- FIRE HYDRANT
  - VALVE
  - CHECK VALVE
  - 2" WATER LINE
  - 4" WATER LINE
  - 6" WATER LINE
  - 8" WATER LINE
  - 10" WATER LINE
  - 12" DRAIN LINE

- NOTES**
1. THIS MAP WAS PREPARED FROM PREVIOUS WATER SYSTEM MAPS, RECORD DRAWINGS AND INFORMATION PROVIDED BY THE CITY. ITEMS ARE DEPICTED AS ACCURATELY AS POSSIBLE. WATER LINES MAY BE PRESENT AT LOCATIONS NOT SHOWN ON THIS MAP.
  2. WATER SYSTEM FEATURES AND LOCATIONS ARE SCHEMATIC IN NATURE AND SHOULD BE FIELD VERIFIED PRIOR TO CONDUCTING FIELD WORK.

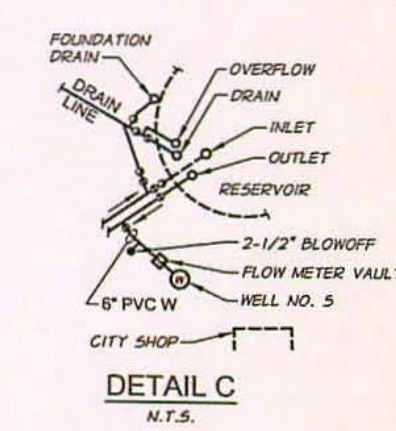
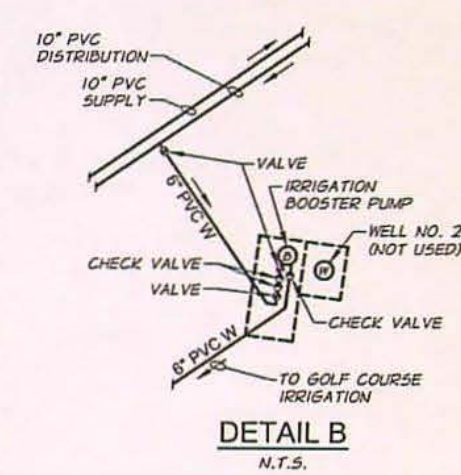
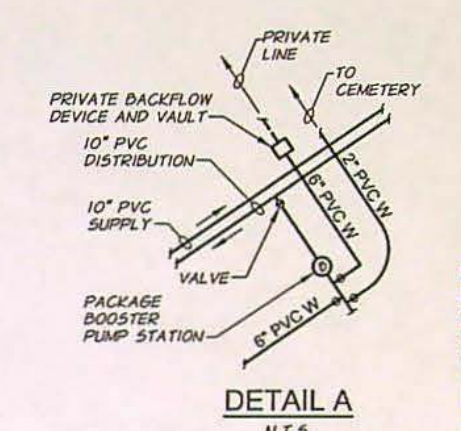

CITY OF  
ECHO, OREGON  
**EXISTING WATER SYSTEM MAP**  
SEPTEMBER 2021

**ap anderson  
perry  
& associates, inc.**  
engineering • surveying • natural resources  
1901 N. Fr Street - La Grande, OR 97850 Ph: (541) 963-6309 Fax: (541) 963-5456  
LA GRANDE, OR VALLA VALLA, WA REDMOND, OR HERRISTON, OR

RECEIVED  
JUN 30 2023  
OWRD



## Permit Amendment Application Intake Checklist

Permit Amendment # T- 14270

Reviewer <u>Stacy</u>	Type of Change(s) Proposed:	
Date <u>7-3-2023</u>	<input type="checkbox"/> POU <input type="checkbox"/> POD <input type="checkbox"/> APOD <input type="checkbox"/> POA <input checked="" type="checkbox"/> APOA <input type="checkbox"/> SW to GW	
Calculated Fee \$ <input checked="" type="checkbox"/> Use fee calculator on back of this form		Fee Received \$ <u>1840.00</u>
Permit: <u>G-18545</u>	Completion Date: <u>10-1-2028</u>	Check <u>ALL</u> Permits in WRIS to confirm completion date is not expired
Permit:	Completion Date:	
Permit:	Completion Date:	
Notes:		

Application:			
1.	<input checked="" type="checkbox"/> YES	<input type="checkbox"/> NO	Have <u>ALL</u> of the applicant's signed and dated the application? If no, whose signature is missing?
2.	<input checked="" type="checkbox"/> YES	<input type="checkbox"/> NO	Part 5 of application: Does the information match the description of the explanation on Part 4 of the application?
3.	<input type="checkbox"/> YES	<input type="checkbox"/> NO	<input checked="" type="checkbox"/> N/A
For multiple permits: Each permit proposed for transfer has their own separate completed Part 5, Tables 1 & 2? If no, which permit(s) are missing separate Part 5, Tables 1 & 2?			

Map Requirements:			
4.	<input checked="" type="checkbox"/> YES	<input type="checkbox"/> NO	Map included & to scale? (Separate map for each permit if more than 3 permits)
5.	<input type="checkbox"/> YES	<input type="checkbox"/> NO	<input checked="" type="checkbox"/> N/A
Map Waiver? The map waiver must be issued by the Department			
Notes:			

Attachments:			
6.	<input type="checkbox"/> YES	<input checked="" type="checkbox"/> NO	Has the Permit Completion Date expired? (If yes, we cannot accept)
7.	<input checked="" type="checkbox"/> YES	<input type="checkbox"/> NO	<input type="checkbox"/> N/A
Land Use Form included and signed by the County?			
8.	<input type="checkbox"/> YES	<input type="checkbox"/> NO	<input checked="" type="checkbox"/> N/A
Consent Form included, signed, & notarized (for applicants who are not a permit holder of record)?			
9.	<input checked="" type="checkbox"/> YES	<input type="checkbox"/> NO	<input type="checkbox"/> N/A
For changes in POA/APOA – are the well logs included?			
10.	<input type="checkbox"/> YES	<input type="checkbox"/> NO	<input checked="" type="checkbox"/> N/A
For change in POU within Umatilla County, Supplemental Form U included?			

<input checked="" type="checkbox"/>	Application complete: no deficiencies identified, assign a T-number and put this checklist in T-folder.
<input type="checkbox"/>	Application DEFICIENT: DO NOT accept - return to applicant with letter explaining deficiencies identified.



## Permit Amendment Application Intake Checklist

FEE WORKSHEET for PERMIT AMENDMENT			
1	Base Fee (includes one type of change to one permit for up to 1 cfs)	1	\$1,360
2	Types of change proposed: <input type="checkbox"/> Place of Use <input checked="" type="checkbox"/> Point of Diversion/Appropriation Number of above boxes checked = <u>1</u> (2a) Subtract 1 from the number in line 2a = <u>0</u> (2b) <i>If only one change, this will be 0</i> Multiply line 2b by \$1090 and enter » » » » » » » » » » » » » » » »	2	<u>0</u>
3	Number of permits included in Permit Amendment <u>1</u> (3a) Subtract 1 from the number in 3a above: <u>0</u> (3b) <i>If only one permit, this will be 0</i> Multiply line 3b by \$610 and enter » » » » » » » » » » » » » » » »	3	<u>0</u>
4	Do you propose to add or change a well, or change from a surface water POD to a well? <input type="checkbox"/> No: enter 0 <input checked="" type="checkbox"/> Yes: enter \$480 for the 1st well to be added or changed <u>480</u> (4a) Do you propose to add or change additional wells? <input checked="" type="checkbox"/> No: enter 0 <input type="checkbox"/> Yes: multiply the number of additional wells by \$410 _____ (4b)	4	<u>480</u>
5	Do you propose to change the place of use? <input checked="" type="checkbox"/> No: enter 0 on line 5 » <input type="checkbox"/> Yes: enter the cfs for the portions of the permits to be amended (see example below*): _____ (5a) Subtract 1.0 from the number in 5a above: _____ (5b) If 5b is 0 or less, enter 0 on line 5 » If 5b is greater than 0, round up to the nearest whole number: _____ (5c)	5	<u>0</u>
6	Add entries on lines 1 through 5 above » » » » » » » » » » Subtotal:	6	<u>480</u>
7	Is this Permit Amendment: <input type="checkbox"/> necessary to complete a project funded by the Oregon Watershed Enhancement Board (OWEB) under ORS 541.932? <input type="checkbox"/> endorsed in writing by ODFW as a change that will result in a net benefit to fish and wildlife habitat? If one or more boxes is checked, multiply line 6 by 0.5 and enter on line 7 »	7	<u>0</u>
8	Subtract line 7 from line 6 » » » » » » » » » » » » » » » » Permit Amendment Fee:	8	<u>1840</u>