

Regular

RA

Name Jensen Family, LLC
c/o Mark Tribbet
 Address 5289 Blue Grass Ln.
Silverton, OR 97381
mark@jbinstantlawn.net

Change in APOA
 Date Filed 12/18/2024
 Initial notice date 12/24/2024
 DPD issued date
 PD issued date 4/25/2025
 PD notice date 4/29/2025
 Date of FO 7/7/2025 Vol 135 Page 32-35

C-Date
 COBU due date
 COBU Received date
 Certificate issued

DESCRIPTION OF WATER RIGHT(S)

Name of Stream A well
 Trib. of Little Pudding River

Use Irrigation County Marion
 Quantity of water (CFS) No. of Acres

Name of ditch
 App# G-4838 Per # G-4559 Cert # 42225 PR Date 4-9-1969
 App# Per # Cert # PR Date
 App# Per # Cert # PR Date
 App# Per # Cert # PR Date

FEES PAID

Date	Amount	Receipt #
12-18-2024	\$2,660. ⁰⁰	144429
12-18-2024	125. ⁰⁰	144418
1-16-2025	\$3390. ⁹⁶	144552

FEES REFUNDED

Date	Amount	Receipt #

Assignments:

Irrigation District _____

Agent Doann Hamilton
phgdmh@gmail.com

CWRE
 CC's list Marion County Planning Department

☐ - Oversized map - Location _____



Oregon

Tina Kotek, Governor

Water Resources Department

North Mall Office Building

725 Summer St NE, Suite A

Salem, OR 97301

Phone 503 986-0900

Fax 503 986-0904

July 7, 2025

Mark Tribbett
5289 Bluegrass Lane
Silverton, OR 97381

REFERENCE: Transfer Application T-14580

Enclosed is a copy of the final order approving your water right transfer application.

The time allowed to complete the transfer is specified in the final order. YOU SHOULD GIVE PARTICULAR ATTENTION TO THE TIME LIMIT. The water right for any portion of the authorized change in character of use or change in place of use NOT carried out within the time allowed will be lost.

An extension of the time limit can be allowed only upon a showing that diligent effort has been made to complete the actual change(s) within the time allowed.

You are required to hire a Certified Water Rights Examiner (CWRE) to complete a Claim of Beneficial Use report and map which must be submitted to this Department within one year of the date you complete the change(s) or within one year of the completion date authorized in the transfer final order, whichever occurs first.

If you have any questions related to the approval of this transfer, you may contact your caseworker, Dante Luongo, by telephone at (971) 304-5006 or by e-mail at Dante.j.luongo@water.oregon.gov.

Sincerely,

David V. Jones Jr
Water Rights Services Support
Transfers and Conservation Section

cc: Gregory J. Wacker, Watermaster Dist. # 16 (via email)
Doann Hamilton, Agent
Marion County Planning Department, Local Government

Enclosure

**BEFORE THE WATER RESOURCES DEPARTMENT
OF THE
STATE OF OREGON**

In the Matter of Transfer Application)	FINAL ORDER
T-14580, Marion County)	APPROVING ADDITIONAL POINTS OF
)	APPROPRIATION

Authority

Oregon Revised Statutes (ORS) 537.705 and 540.505 to 540.580 establish the process in which a water right holder may submit a request to transfer the point of appropriation, place of use, or character of use authorized under an existing water right. Oregon Administrative Rules (OAR) Chapter 690, Division 380 implement the statutes and provides the Department's procedures and criteria for evaluating transfer applications.

Applicant

JENSEN FAMILY LLC
C/O MARK TRIBBETT
5289 BLUEGRASS LANE
SILVERTON, OR 97381

Findings of Fact

1. On December 18, 2024, Jensen Family LLC, c/o Mark Tribbett filed an application for additional points of appropriation under Certificate 42225. The Department assigned the application number T-14580.
2. Notice of the application for transfer was published on December 24, 2024, pursuant to OAR 690-380-4000. No comments were filed in response to the notice.
3. On March 11, 2025, the Department sent a copy of the draft Preliminary Determination to the applicant, proposing to approve Transfer Application T-14580. The draft Preliminary Determination cover letter provided a deadline of April 10, 2025, for the applicant to respond and submit the required information. The applicant requested that the Department proceed with issuance of a Preliminary Determination and provided the necessary information to demonstrate that the applicant is authorized to pursue the transfer.

This final order is subject to judicial review by the Court of Appeals under ORS 183.482. Any petition for judicial review must be filed within the 60-day time period specified by ORS 183.482(1). Pursuant to ORS 536.075 and OAR 137-003-0675, you may petition for judicial review or petition the Director for reconsideration of this order. A petition for reconsideration may be granted or denied by the Director, and if no action is taken within 60 days following the date the petition was filed, the petition shall be deemed denied.

4. On April 25, 2025, the Department issued a Preliminary Determination proposing to approve Transfer Application T-14580 and sent a copy to the applicant. Additionally, notice of the Preliminary Determination for the transfer application was published in the Department's weekly notice on April 29, 2025, and in the Woodburn Independent newspaper on May 7 and 14, 2025, pursuant to ORS 540.520 and OAR 690-380-4020. No protests were filed in response to the notice.

5. The right to be transferred is as follows:

Certificate: 42225 in the name of DONALD D. KUENZI (perfected under Permit G-4559)
Use: IRRIGATION OF 42.6 ACRES
Priority Date: APRIL 9, 1969
Rate: 0.53 CUBIC FOOT PER SECOND
Limit/Duty: The amount of water used for irrigation, together with the amount secured under any other right existing for the same lands, shall be limited to ONE-EIGHTIETH of one cubic foot per second per acre, or its equivalent for each acre irrigated and shall be further limited to a diversion of not to exceed 2.5 acre feet per acre for each acre irrigated during the irrigation season of each year.
Source: A WELL a tributary of LITTLE PUDDING RIVER

Authorized Point of Appropriation:

Twp	Rng	Mer	Sec	Q-Q	DLC	Measured Distances
7 S	2 W	WM	2	SW NE	58	CERTIFICATE 42225 WELL - 1110 FEET NORTH AND 1350 FEET EAST FROM THE NW CORNER OF DLC 57

Authorized Place of Use:

IRRIGATION						
Twp	Rng	Mer	Sec	Q-Q	DLC	Acres
7 S	2 W	WM	2	NE NE	58	1.2
7 S	2 W	WM	2	NW NE	58	17.5
7 S	2 W	WM	2	SW NE	58	22.1
7 S	2 W	WM	2	SE NE	58	1.8
TOTAL						42.6

6. Transfer Application T-14580 proposes additional points of appropriation located as follows:

Twp	Rng	Mer	Sec	Q-Q	DLC	Measured Distances	Approximate Distance from Authorized Point of Appropriation in Feet
6 S	2 W	WM	35	SW SE	41	GR-859 WELL - WEST 17 DEGREES NORTH AND 2640 FEET FROM THE SE CORNER OF SECTION 35	2750 FEET NW

Twp	Rng	Mer	Sec	Q-Q	DLC	Measured Distances	Approximate Distance from Authorized Point of Appropriation in Feet
6 S	2 W	WM	35	SE SE	41	WELL 2 - 100 FEET NORTH AND 865 FEET WEST FROM THE SE CORNER OF SECTION 35	1750 FEET NE
6 S	2 W	WM	35	SE SE	41	WELL 3 - 15 FEET NORTH AND 185 FEET WEST FROM THE SE CORNER OF SECTION 35	2170 FEET NE

Transfer Review Criteria [OAR 690-380-0100(14), OAR 690-380-4010(2), and OAR 690-380-2110(2)]

7. Water has been used within the last five years according to the terms and conditions of the right. There is no information in the record that would demonstrate that the right is subject to forfeiture under ORS 540.610.
8. A water delivery system sufficient to use the full amount of water allowed under the existing right was present within the five-year period prior to submittal of Transfer Application T-14580.
9. The water right is subject to transfer as defined in ORS 540.505(4) and OAR 690-380-0100(14).
10. The proposed points of appropriation develop groundwater from the same aquifer as the authorized point of appropriation, as required by OAR 690-380-2110(2).
11. The proposed change, as conditioned, would not result in enlargement of the right.
12. The proposed change, as conditioned, would not result in injury to other existing water rights.
13. All other application requirements are met.

Conclusions of Law

The additional points of appropriation proposed in Transfer Application T-14580 are consistent with the requirements of ORS 537.705 and 540.505 to 540.580 and OAR 690-380-5000.

Now, therefore, it is ORDERED:

1. The additional points of appropriation proposed in Transfer Application T-14580 are approved.
2. The right to the use of the water is restricted to beneficial use at the place of use described and is subject to all other conditions and limitations contained in Certificate 42225 and any related decree.

3. Approval of this transfer application does not constitute nor grant legal access onto or through another person's property for purposes of accessing the new points of appropriation.
4. Water right Certificate 42225 is cancelled.
5. The quantity of water diverted at the new additional points of appropriation (Well 2, Well, 3 and GR-859 Well), together with that diverted at the original point of appropriation (Certificate 42225 Well), shall not exceed the quantity of water lawfully available at the original point of appropriation (Certificate 42225 Well).
6. Water shall be acquired from the same aquifer (water source) as the original point of appropriation.
7. Water use measurement conditions:
 - a. Before water use may begin under this order, the water user shall install a totalizing flow meter, or, with prior approval of the Director, another suitable measuring device, at each point of appropriation (new and existing).
 - b. The water user shall maintain the meters or measuring devices in good working order.
 - c. The water user shall allow the Watermaster access to the meters or measuring devices; provided however, where the meters or measuring devices are located within a private structure, the Watermaster shall request access upon reasonable notice.
8. Full beneficial use of the water shall be made, consistent with the terms of this order, on or before **October 1, 2026**. A Claim of Beneficial Use prepared by a Certified Water Right Examiner shall be submitted by the applicant to the Department within one year after the deadline for completion of the change and full beneficial use of the water.
9. After satisfactory proof of beneficial use is received, a new certificate confirming the right transferred will be issued.

Dated in Salem, Oregon on **JUL 07 2025**

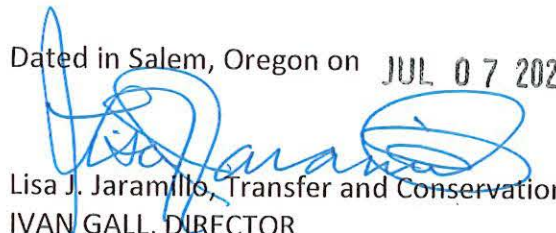
Lisa J. Jaramillo, Transfer and Conservation Section Manager, for
IVAN GALL, DIRECTOR
Oregon Water Resources Department

Mailing Date: **JUL 08 2025**

TRANSFER COVER SHEET

Transfer: T-14580

GR Application #: GR-

File Assigned- Transfer Specialist:

Transfer Type: Regular Transfer

Reimbursement Authority? ☒

Dante L.

Applicant: Mark Tribbett 5289 Bluegrass Lane Silverton, OR 97381	Receiving Landowner: 	CWRE Agent: Doann Hamilton 18487 S Valley Vista Rd Mulino, OR 97042
Interested Parties: BOR (date): _____ Tribal Gov't: _____ Gov'ts: Marion County Planning Department County: MARION	Irrigation District: Check area of interest on map <input type="checkbox"/>	Additional Contact Information:

Key Dates & Initial Actions (Support Staff)

Type of change(s) proposed- attach additional review checklists as necessary

ADDITIONAL POINT OF APPROPRIATION

If change is Historic or Substitution, application will go directly to Final Order. Add'l questions on last page for Historic and Gov't Action.

Fees Pd:	\$2660.00	WM Review request date sent - WM District: 16	12/23/2024
Received Date:	December 18, 2024	WM Review - date received:	
Acknowledgement Letter Sent	Date: 12/23/2024	GW Review - date sent:	12/23/2024
County sent cc: of Ack Letter	Date: 12/23/2024	GW Review - date received:	
Initial Public Notice Date:	12/24/2024	ODFW Review - date sent: ODFW District:	
Comments Received:	Yes <input type="checkbox"/> No: <input type="checkbox"/>	ODFW Review - date received:	

Water Rights Affected

File Marked	No.	App. File # or Decree Name	Permit	Certificate	RR/CR Needed	RR/CR Nos.
<input type="checkbox"/>	1	G-4838	G-4559	42225	<input type="checkbox"/> Yes <input type="checkbox"/> No	
<input type="checkbox"/>	2				<input type="checkbox"/> Yes <input type="checkbox"/> No	
<input type="checkbox"/>	3				<input type="checkbox"/> Yes <input type="checkbox"/> No	

I have confirmed that the information on this document is correct (or has been corrected): initials

Caseworker Actions:

Assigned in WRIS: <i>Dante</i>	DPD Workflow updated:	WRIS Notes:
PD and RR sent to Data Entry:	Certified mail date:	
Newspaper notice needed: Yes <input checked="" type="checkbox"/> No: <input type="checkbox"/>	Name of Newspaper: <i>Woodburn Independent</i>	
PD notice email coordinator:	PD notice Request Date:	Amount Due: \$
		Received date:
Last day of publication:	Affidavit received:	

DOCUMENT	Drafted		Peer Review		Policy Review		Changes		ODFW contact info: <input type="checkbox"/> included NA: <input type="checkbox"/>
	Date	initials	Date	initials	Date	initials	Date	initials	WM contact info: <input checked="" type="checkbox"/> included NA: <input type="checkbox"/>
DPD	2-18-25	<i>AL</i>	2-20-25	<i>JS</i>	2-24-25	<i>CC</i>	2-25-25	<i>AL</i>	Number of Docs for signature:
NOTICE									Date in Signature bin
PD	3-21-25	<i>AL</i>	3-26-25	<i>JS</i>	3-31-25	<i>SH</i>	4-1-25	<i>AL</i>	Signature date
FO	5-30-25	<i>AL</i>	5-30-25	<i>ER</i>	6-4-25	<i>TS</i>	6-27-25	<i>AL</i>	
RR									
Special Issues:									

PERMANENT TRANSFER APPLICATION CHECKLIST

☐ RA

Transfer #: T-1458014580

CW	PR	Coord	
<input type="checkbox"/>	<input type="checkbox"/>		Save all certificates in electronic "T" folder and highlight Priority Date, Rate, Use and Limit/Duty paragraph
<input type="checkbox"/>	<input type="checkbox"/>	<input type="checkbox"/>	<input type="checkbox"/> Supplemental checklist for transfers w/in a District (S:\groups\wr\TACS\WRISApps Templates\Transfer Checklists\SUPP_Within District Processing Checklist 9-5-2019) If this is a Living Certificate – check with Ann Reece See Supplemental Language document for language

Transfer Application Review and Deficiencies

CW	PR	Coord			
<input type="checkbox"/>	<input type="checkbox"/>	<input type="checkbox"/>	Are all applicants/agents listed in WRIS with email addresses, if available?	<input checked="" type="checkbox"/> Yes	<input type="checkbox"/> No
<input type="checkbox"/>	<input type="checkbox"/>	<input type="checkbox"/>	Have all permit/certificates been entered in WRIS under Transfer #?	<input checked="" type="checkbox"/> Yes	<input type="checkbox"/> No
<input type="checkbox"/>	<input type="checkbox"/>	<input type="checkbox"/>	Were timely Public Comments received? (if yes, enter commenter names/email on mailing list)	<input type="checkbox"/> Yes	<input checked="" type="checkbox"/> No
Add finding for any comments received (see Supplemental Language document)					

Groundwater Modification Application Review and Deficiencies

CW	PR	Coord			
			<input type="checkbox"/> N/A		
<input type="checkbox"/>	<input type="checkbox"/>	<input type="checkbox"/>	If for a Groundwater Modification, were there any assignments? All GR Mod applicants must be the holder of record.	<input type="checkbox"/> Yes	<input type="checkbox"/> No
<input type="checkbox"/>	<input type="checkbox"/>	<input type="checkbox"/>	Are there any past GR Modifications and/or letters documenting changes to the GR These must be accounted for in the GR Mod Order.	<input type="checkbox"/> Yes	<input type="checkbox"/> No

Review "From" and "To" Lands and/or POD/POA

CW	PR	Coord			
<input type="checkbox"/>	<input type="checkbox"/>	<input type="checkbox"/>	Are only the authorized POD(s)/POA(s)/POU listed on the "from" map?	<input checked="" type="checkbox"/> Yes	<input type="checkbox"/> No
<input type="checkbox"/>	<input type="checkbox"/>	<input type="checkbox"/>	Does the "from" map match the certificate map? If No, what is different?	<input checked="" type="checkbox"/> Yes	<input type="checkbox"/> No
<input type="checkbox"/>	<input type="checkbox"/>	<input type="checkbox"/>	Compare FROM POU in application (Table 2) with certificate. <i>Mark certificate with acres being xferred, any RR acres and any acres being cancelled.</i>		
<input type="checkbox"/>	<input type="checkbox"/>	<input type="checkbox"/>	Compare TO POU in Table 2 with the TO Lands on map (for accuracy)		
<input type="checkbox"/>	<input type="checkbox"/>	<input type="checkbox"/>	Are any of the "from" lands being cancelled/diminished?	<input type="checkbox"/> Yes	<input checked="" type="checkbox"/> No
<input type="checkbox"/>	<input type="checkbox"/>	<input type="checkbox"/>	If Yes, were cancellation/diminution affidavits submitted? (see findings and additional authority in Supplemental Language doc)	<input type="checkbox"/> Yes	<input type="checkbox"/> No
<input type="checkbox"/>	<input type="checkbox"/>	<input type="checkbox"/>	Are any instream water rights affected? If Yes, Cert # (If Yes, check criteria for injury-upstream POD move, moving closer to SW, or return flows affected)	<input type="checkbox"/> Yes	<input checked="" type="checkbox"/> No

Layered/Supplemental Rights

CW	PR	Coord			
			<input type="checkbox"/> N/A		
<input type="checkbox"/>	<input type="checkbox"/>	<input type="checkbox"/>	Are there any layered irrigation rights?	<input type="checkbox"/> Yes	<input checked="" type="checkbox"/> No
<input type="checkbox"/>	<input type="checkbox"/>	<input type="checkbox"/>	If Yes, were they included in application? If No, they must move with the primary, to a "like" primary, or they will be cancelled though the transfer process	<input type="checkbox"/> Yes	<input type="checkbox"/> No
<input type="checkbox"/>	<input type="checkbox"/>	<input type="checkbox"/>	Layered right(s) Cert:		

<input type="checkbox"/>	<input type="checkbox"/>	<input type="checkbox"/>	Are any supplemental rights being transferred? (verify that it is actually a supplemental right)	<input type="checkbox"/> Yes	<input checked="" type="checkbox"/> No
<input type="checkbox"/>	<input type="checkbox"/>	<input type="checkbox"/>	If Yes, are they being transferred to a "like" primary (i.e. similar reliability)?	<input type="checkbox"/> Yes	<input checked="" type="checkbox"/> No
<input type="checkbox"/>	<input type="checkbox"/>	<input type="checkbox"/>	Notes:		

Transfer Review Criteria					
CW	PR	Coord			
<input type="checkbox"/>	<input type="checkbox"/>	<input type="checkbox"/>	Validity of the right – Has the right been used in the last 5 years and is not subject to forfeiture?	<input checked="" type="checkbox"/> Yes	<input type="checkbox"/> No
<input type="checkbox"/>	<input type="checkbox"/>	<input type="checkbox"/>	<input checked="" type="checkbox"/> Evidence of use and supporting documentation <input type="checkbox"/> Confirming (not a remaining right) cert issued within the last 5 years <input type="checkbox"/> Rebuttal to forfeiture (ORS 540.610)		
<input type="checkbox"/>	<input type="checkbox"/>	<input type="checkbox"/>	Ready, Willing and Able – <input type="checkbox"/> Current delivery system sufficiently described in application. Does delivery system have capacity to fully divert and use the authorized rate/duty of the right?	<input checked="" type="checkbox"/> Yes	<input type="checkbox"/> No
<input type="checkbox"/>	<input type="checkbox"/>	<input type="checkbox"/>	Would the proposed transfer result in enlargement? If Yes, why? What conditions, if any, will avoid?	<input type="checkbox"/> Yes	<input checked="" type="checkbox"/> No
<input type="checkbox"/>	<input type="checkbox"/>	<input type="checkbox"/>	Would the proposed transfer result in injury? If Yes, why? What conditions, if any, will avoid?	<input type="checkbox"/> Yes	<input checked="" type="checkbox"/> No
<input type="checkbox"/>	<input type="checkbox"/>	<input type="checkbox"/>	If injury, has WM or GW provided a list of injured water right holders? <input checked="" type="checkbox"/> N/A	<input type="checkbox"/> Yes	<input type="checkbox"/> No
<input type="checkbox"/>	<input type="checkbox"/>	<input type="checkbox"/>	If POD/POA/APOD/APOA change, will it be from the same source? If No, deny per OAR 690-380-2110(2) <input type="checkbox"/> N/A	<input checked="" type="checkbox"/> Yes	<input type="checkbox"/> No
<input type="checkbox"/>	<input type="checkbox"/>	<input type="checkbox"/>	Notes:		

Draft Preliminary Determination and Cover Letter – 12 pt. Calibri font			
CW	PR	Coord	
<input checked="" type="checkbox"/>	<input type="checkbox"/>	<input type="checkbox"/>	Prepare ModPod workareas
<input checked="" type="checkbox"/>	<input type="checkbox"/>	<input type="checkbox"/>	Prepare DPD (save as T-XXXXX-dpd-approve/deny (where XXXXX is the transfer number)
<input checked="" type="checkbox"/>	<input type="checkbox"/>	<input type="checkbox"/>	Prepare DPD Cover letter (save as T-XXXXX-dpd-cov)
<input checked="" type="checkbox"/>	<input type="checkbox"/>	<input type="checkbox"/>	Prepare Public Notice <input type="checkbox"/> and/or <input type="checkbox"/> newspaper notice (if required) (save as T-XXXXX-pd-notice)
<input checked="" type="checkbox"/>	<input type="checkbox"/>	<input type="checkbox"/>	Prepare Remaining Right(s) (if applicable). Send with DPD, cover letter and notice for peer review.

Issue Draft Preliminary Determination	
CW	
<input checked="" type="checkbox"/>	Copy DPD and cover letter for paper file
<input checked="" type="checkbox"/>	Save DPD and cover letter as PDF
<input checked="" type="checkbox"/>	Mail/email to applicant/agent/WM
<input checked="" type="checkbox"/>	Add workflow item "Draft PD Issued"

Report of Ownership Information (ROI)				
CW	PR	Coord		
<input checked="" type="checkbox"/>	<input type="checkbox"/>	<input type="checkbox"/>	Does legal description in ROI/Deed match "from" lands?	<input checked="" type="checkbox"/> Yes <input type="checkbox"/> No
<input checked="" type="checkbox"/>	<input type="checkbox"/>	<input type="checkbox"/>	Have all owners on the ROI/Deed signed the application?	<input checked="" type="checkbox"/> Yes <input type="checkbox"/> No
<input checked="" type="checkbox"/>	<input type="checkbox"/>	<input type="checkbox"/>	Has a notarized statement of consent been submitted? (if applicable) <input type="checkbox"/> N/A	<input type="checkbox"/> Yes <input type="checkbox"/> No

Newspaper Notice (if required)				
CW	PR	Coord		
<input type="checkbox"/>	<input type="checkbox"/>	<input type="checkbox"/>	<input type="checkbox"/> N/A	
<input type="checkbox"/>	<input type="checkbox"/>	<input type="checkbox"/>	Prepare/send letter to applicant/agent regarding newspaper notice cost	<input checked="" type="checkbox"/> Yes <input type="checkbox"/> No
<input type="checkbox"/>	<input type="checkbox"/>	<input type="checkbox"/>	TACS Support delivered receipted funds to caseworker	<input checked="" type="checkbox"/> Yes <input type="checkbox"/> No

Preliminary Determination and Cover Letter Preparation

CW	PR	Coord		
			<i>See cheat sheet at (S:\groups\wr\TACS\6. Transfers\Procedures\DPD to PD Conversion 12-8-2016) for more detailed instructions</i>	
<input type="checkbox"/>	<input type="checkbox"/>	<input type="checkbox"/>	Was application amended after DPD was issued? - Make sure amended pages were scanned to WRIS (see support staff) and make sure you mark amended (replaced) pages with SUPERSEDED. Also make findings in PD.	<input type="checkbox"/> Yes <input checked="" type="checkbox"/> No
<input type="checkbox"/>	<input type="checkbox"/>	<input type="checkbox"/>	If Yes, what was amended?	
<input type="checkbox"/>	<input type="checkbox"/>	<input type="checkbox"/>	Did amendment change outcome from denial to approval? <i>If Yes, make findings in PD.</i>	<input type="checkbox"/> Yes <input checked="" type="checkbox"/> No
<input type="checkbox"/>	<input type="checkbox"/>	<input type="checkbox"/>	<input type="checkbox"/> If POD/POA changes or changes in "from" lands – re-review required from WM <input type="checkbox"/> If POA changes – re-review required from GW	
<i>Note: If POD was amended and changed from a downstream move to upstream within an ISWR reach – Consent to Injury may be required.</i>				
<input checked="" type="checkbox"/>			Save DPD as a new document (T-XXXXX-pd-approve/deny.doc) – 12 pt. Calibri font	
<input checked="" type="checkbox"/>			Remove "Draft" from document	
<input checked="" type="checkbox"/>			Unhide hidden findings (cntrl-A, select Font, uncheck "hidden" box) and add dates	
<input checked="" type="checkbox"/>			If application was amended, add finding including date of amendment	
<input checked="" type="checkbox"/>			Change language resulting from any amendments in response to the DPD, including language under Determination and Proposed Action	
<input checked="" type="checkbox"/>			Unhide appeal (protest) language at the end of the document	
<input checked="" type="checkbox"/>			Prepare PD Cover Letter (save as T-XXXXX-pd-cov)	
<input checked="" type="checkbox"/>			Check email address(s) for accuracy	
<input type="checkbox"/>			Notes:	
<input checked="" type="checkbox"/>			Send to caseworker/coordinator for Peer Review	

Data Center Review of PD

CW	PR	Coord	
<input checked="" type="checkbox"/>	<input type="checkbox"/>	<input type="checkbox"/>	Email PD and RR(s)(with new cert numbers) to Data* for review – Indicate if file is RA *email address is in key
<input checked="" type="checkbox"/>	<input type="checkbox"/>	<input type="checkbox"/>	Data Center will send notification that file is complete
<input checked="" type="checkbox"/>	<input type="checkbox"/>	<input type="checkbox"/>	Make any necessary changes to PD or prepare Revised DPD (if substantive changes)

Issue Preliminary Determination

CW	
<input checked="" type="checkbox"/>	Print PD and put in Manager's box for signature and issuance (support will print cover letter)
<input type="checkbox"/>	Add workflow notes

Protest

CW	PR	Coord	
<input type="checkbox"/>	<input type="checkbox"/>	<input type="checkbox"/>	Have protests been received? <input type="checkbox"/> Yes <input type="checkbox"/> No If YES, STOP! Coordinate with Protest section.

Final Order	
CW	See cheat sheet at (S:\groups\wr\TACS\6. Transfers\Procedures\PD to FO Conversion 12-8-2016) for more detailed instructions
Do not issue Final Order before this date: (protest period end date or 30 days after date of last newspaper publication)	
<input type="checkbox"/>	If application had a newspaper notice, verify that Affidavit of Publication was received. Date:
<input type="checkbox"/>	Save PD as a new document (T-XXXXX-ord-approve (or deny))
<input type="checkbox"/>	Remove "PRELIMINARY DETERMINATION" from document title and replace with "FINAL ORDER." Unhide hidden findings (cntrl-a, select Font, uncheck "hidden" box)
<input type="checkbox"/>	Replace "PROPOSING APPROVAL/DENIAL OF" with APPROVING/DENYING
<input type="checkbox"/>	Replace the "judicial review/reconsideration rights" box in the first page footer for the "Final Order" judicial review language; unhide and add Special Order Volume (support will add page #)
<input type="checkbox"/>	Update the hidden paragraph following the public notice and amendments findings (regarding issuance of PD)
<input type="checkbox"/>	Change "Determination and Proposed Action" to "Conclusions of Law" and update paragraph
<input type="checkbox"/>	Replace "If application T-XXXXX is approved . . ." with Now, therefore, it is ORDERED:"
<input type="checkbox"/>	Select list of conditions below "It is ORDERED" section and turn off Italics. Check numbering (start at "1").
<input type="checkbox"/>	Delete Protest language, Document preparation box, and Notice Regarding Servicemembers; Insert "Mailing Date: _____"
<input type="checkbox"/>	Final Check: All Conclusions of Law are supported by Findings and Transfer Review Criteria

Remaining Rights			
CW	PR	Coord	<input type="checkbox"/> N/A
<input type="checkbox"/>	<input type="checkbox"/>	<input type="checkbox"/>	Make sure all RR certs have new cert numbers and are entered on the right side of the footer of each RR
<input type="checkbox"/>	<input type="checkbox"/>	<input type="checkbox"/>	Update left side of footer to read: T-XXXXX.rr.YYYYYY.ini, where YYYYYY is original cert number and .ini stands for your initials. New certificate should be on the right.
<input type="checkbox"/>	<input type="checkbox"/>	<input type="checkbox"/>	Print RR on certificate paper and include with Final Order for signature

Issue Final Order	
CW	
<input type="checkbox"/>	Pull "Working Copy" folder from file
<input type="checkbox"/>	Print and put FO and RR in Manager's box for signature (manager will deliver to support for processing and issuance)
Notes:	

**STATE OF OREGON
WATER RESOURCES DEPARTMENT**

725 Summer St. N.E. Ste. A

SALEM, OR 97301-4172

(503) 986-0900 / (503) 986-0904 (fax)

RECEIPT # **145009**

INVOICE # _____

RECEIVED FROM: Jensen Family LLC
BY: _____

APPLICATION	
PERMIT	
TRANSFER	T-145810

CASH: ☐ CHECK: # 5087 OTHER: (IDENTIFY) ☐ _____

TOTAL REC'D \$ 76.13

1083 TREASURY 4170 WRD MISC CASH ACCT

0407 COPIES 46118 \$ _____
0207 OTHER: (IDENTIFY) Newspaper Notice \$ 76.13
0243 I/S Lease _____ 0244 Muni Water Mgmt. Plan _____ 0245 Cons. Water _____

4270 WRD OPERATING ACCT

MISCELLANEOUS

0407	COPY & TAPE FEES	\$ _____
0410	RESEARCH FEES	\$ _____
0408	MISC REVENUE: (IDENTIFY) _____	\$ _____
TC162	DEPOSIT LIAB. (IDENTIFY) _____	\$ _____
0240	EXTENSION OF TIME	\$ _____

WATER RIGHTS:

0201	SURFACE WATER	EXAM FEE \$ _____	0202	RECORD FEE \$ _____
0203	GROUND WATER	\$ _____	0204	\$ _____
0205	TRANSFER	\$ _____		

WELL CONSTRUCTION

0218	WELL DRILL CONSTRUCTOR	EXAM FEE \$ _____	0219	LICENSE FEE \$ _____
	LANDOWNER'S PERMIT		0220	\$ _____

OTHER (IDENTIFY) _____

0536 TREASURY 0437 WELL CONST. START FEE

0211	WELL CONST START FEE	\$ _____	CARD#	_____
0210	MONITORING WELLS	\$ _____	CARD#	_____
	OTHER (IDENTIFY) _____			

0607 TREASURY 0467 HYDRO ACTIVITY LIC NUMBER

0233	POWER LICENSE FEE (FW/WRD)	\$ _____
0231	HYDRO LICENSE FEE (FW/WRD)	\$ _____
	HYDRO APPLICATION	\$ _____

TREASURY OTHER / RDX

FUND _____ TITLE _____
OBJ. CODE _____ VENDOR # _____
DESCRIPTION _____ \$ _____

RECEIPT: **145009**

DATED: 4-11-25 BY: BZ



P.O. Box 45 West Linn, OR 97068
Phone: 503-684-0360 Fax: 503-620-3433
E-mail: legals@commnewspapers.com

AFFIDAVIT OF PUBLICATION

State of Oregon, County of Marion, ss I, Kristine Humphries, being first duly sworn, depose and say that I am the Principal Clerk of the Woodburn Independent, a newspaper of general circulation, published in Marion County, Oregon, as defined by ORS 193.010 and 193.020, that

Ad#: 356717

Owner: Oregon water Resources Dept

Description: Notice of Preliminary Determination for

Water Right Transfer T-14580

A copy of which is hereto annexed, was published in the entire issue of said newspaper for 2 week(s) in the following issue:
05/07/2025, 05/14/2025



Kristine Humphries (Principal Clerk)

Subscribed and sworn to before me this 05/14/2025.

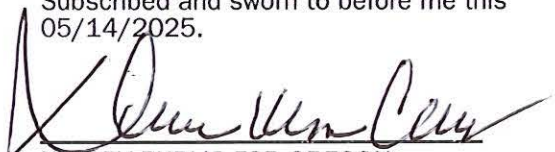

NOTARY PUBLIC FOR OREGON

Acct #: 150076

Attn: DAVID JONES JR

OREGON WATER RESOURCES DEPARTMENT
725 SUMMER ST. NE, SUITE A
SALEM, OR 97301

SEE EXHIBIT A

Received
MAY 27 2025
OWRD

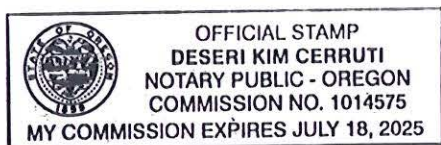

EXHIBIT A

Notice of Preliminary Determination for Water Right Transfer T-14580

T-14580 filed by Jensen Family LLC, c/o Mark Tribbett, 5289 Bluegrass Lane, Silverton, OR 97381, proposes additional points of appropriation under Certificate 42225. The right allows the use of 0.53 cubic foot per second from a well in Sec. 2, T7S, R2W, WM for irrigation in Sec. 2, T7S, R2W, WM. The applicant proposes additional points of appropriation in Sec. 35, T6S, R2W, WM. The Water Resources Department proposes to approve the transfer, based on the requirements of ORS Chapter 540 and OAR 690-380-5000.

Any person may file, jointly or severally, a protest or standing statement within 30 days after the last date of newspaper publication of this notice, May 14, 2025. Call (503) 986-0935 to obtain additional information. If no protests are filed, the Department will issue a final order consistent with the preliminary determination.
Published May 7 & 14, 2025

WI356717

Received
MAY 27 2025
OWRD



Oregon

Tina Kotek, Governor

Water Resources Department

North Mall Office Building

725 Summer St NE, Suite A

Salem, OR 97301

Phone 503 986-0900

Fax 503 986-0904

www.oregon.gov/owrd

April 25, 2025

VIA CERTIFIED MAIL AND E-MAIL

JENSEN FAMILY LLC
C/O MARK TRIBBETT
5289 BLUEGRASS LANE
SILVERTON, OR 97381

SUBJECT: Water Right Transfer Application T-14580

Please find enclosed the Preliminary Determination indicating that, based on the information available, the Department intends to approve application T-14580. This document is an intermediate step in the approval process; water may not be used legally as proposed in the transfer application until a Final Order has been issued by the Department. Please read this entire letter carefully to determine your responsibility for additional action.

A public notice is being published in the Department's weekly publication and in the Woodburn Independent newspaper, simultaneously with issuance of the Preliminary Determination. The notice initiates a period in which any person may file either a protest opposing the decision proposed by the Department in the Preliminary Determination or a standing statement supporting the Department's decision. The protest period will end 30 days after the last date of newspaper publication.

If no protest is filed, the Department will issue a Final Order consistent with the Preliminary Determination. You should receive a copy of the Final Order about 30 days after the close of the protest period.

If a protest is filed, the application may be referred to a contested case proceeding. A contested case provides an opportunity for the proponents and opponents of the decision proposed in the Preliminary Determination to present information and arguments supporting their position in a quasi-judicial proceeding.

Please don't hesitate to contact me at 971 304-5006 or Dante.J.Luongo@water.oregon.gov Richman., if I may be of assistance.

Sincerely,

Dante Luongo

Transfer Specialist

Transfer and Conservation Section

cc: Transfer Application file T-14580
Gregory J. Wacker, District 16 Watermaster (*via e-mail*)
Doann Hamilton, Agent for the applicant (*via e-mail*)

**BEFORE THE WATER RESOURCES DEPARTMENT
OF THE
STATE OF OREGON**

In the Matter of Transfer Application)	PRELIMINARY DETERMINATION
T-14580, Marion County)	PROPOSING APPROVAL OF ADDITIONAL
)	POINTS OF APPROPRIATION

Authority

Oregon Revised Statutes (ORS) 537.705 and 540.505 to 540.580 establish the process in which a water right holder may submit a request to transfer the point of appropriation, place of use, or character of use authorized under an existing water right. Oregon Administrative Rules (OAR) Chapter 690, Division 380 implement the statutes and provides the Department's procedures and criteria for evaluating transfer applications.

Applicant

JENSEN FAMILY LLC
C/O MARK TRIBBETT
5289 BLUEGRASS LANE
SILVERTON, OR 97381

Findings of Fact

1. On December 18, 2024, Jensen Family LLC, c/o Mark Tribbett filed an application for additional points of appropriation under Certificate 42225. The Department assigned the application number T-14580.
2. Notice of the application for transfer was published on December 24, 2024, pursuant to OAR 690-380-4000. No comments were filed in response to the notice.
3. On March 11, 2025, the Department sent a copy of the draft Preliminary Determination to the applicant, proposing to approve Transfer Application T-14580. The draft Preliminary Determination cover letter provided a deadline of April 10, 2025, for the applicant to respond and submit the required information. The applicant requested that the Department proceed with issuance of a Preliminary Determination and provided the necessary information to demonstrate that the applicant is authorized to pursue the transfer.

Pursuant to OAR 690-380-4030, any person may file a protest or standing statement within 30 days after the last date of publication of the newspaper notice or the Department's weekly notice as prescribed by OAR 690-380-4020, whichever is later, of this preliminary determination.

4. The right to be transferred is as follows:

Certificate: 42225 in the name of DONALD D. KUENZI (perfected under Permit G-4559)
Use: IRRIGATION OF 42.6 ACRES
Priority Date: APRIL 9, 1969
Rate: 0.53 CUBIC FOOT PER SECOND
Limit/Duty: The amount of water used for irrigation, together with the amount secured under any other right existing for the same lands, shall be limited to ONE-EIGHTIETH of one cubic foot per second per acre, or its equivalent for each acre irrigated and shall be further limited to a diversion of not to exceed 2.5 acre feet per acre for each acre irrigated during the irrigation season of each year.
Source: A WELL a tributary of LITTLE PUDDING RIVER

Authorized Point of Appropriation:

Twp	Rng	Mer	Sec	Q-Q	DLC	Measured Distances
7 S	2 W	WM	2	SW NE	58	CERTIFICATE 42225 WELL - 1110 FEET NORTH AND 1350 FEET EAST FROM THE NW CORNER OF DLC 57

Authorized Place of Use:

IRRIGATION						
Twp	Rng	Mer	Sec	Q-Q	DLC	Acres
7 S	2 W	WM	2	NE NE	58	1.2
7 S	2 W	WM	2	NW NE	58	17.5
7 S	2 W	WM	2	SW NE	58	22.1
7 S	2 W	WM	2	SE NE	58	1.8
TOTAL						42.6

5. Transfer Application T-14580 proposes additional points of appropriation located as follows:

Twp	Rng	Mer	Sec	Q-Q	DLC	Measured Distances	Approximate Distance from Authorized Point of Appropriation in Feet
6 S	2 W	WM	35	SW SE	41	GR-859 WELL - WEST 17 DEGREES NORTH AND 2640 FEET FROM THE SE CORNER OF SECTION 35	2750 FEET NW
6 S	2 W	WM	35	SE SE	41	WELL 2 - 100 FEET NORTH AND 865 FEET WEST FROM THE SE CORNER OF SECTION 35	1750 FEET NE
6 S	2 W	WM	35	SE SE	41	WELL 3 - 15 FEET NORTH AND 185 FEET WEST FROM THE SE CORNER OF SECTION 35	2170 FEET NE

Transfer Review Criteria [OAR 690-380-0100(14), OAR 690-380-4010(2), and OAR 690-380-2110(2)]

6. Water has been used within the last five years according to the terms and conditions of the right. There is no information in the record that would demonstrate that the right is subject to forfeiture under ORS 540.610.
7. A water delivery system sufficient to use the full amount of water allowed under the existing right was present within the five-year period prior to submittal of Transfer Application T-14580.
8. The water right is subject to transfer as defined in ORS 540.505(4) and OAR 690-380-0100(14).
9. The proposed points of appropriation develop groundwater from the same aquifer as the authorized point of appropriation, as required by OAR 690-380-2110(2).
10. The proposed change, as conditioned, would not result in enlargement of the right.
11. The proposed change, as conditioned, would not result in injury to other existing water rights.
12. All other application requirements are met.

Determination and Proposed Action

The additional points of appropriation proposed in Transfer Application T-14580 appear to be consistent with the requirements of ORS 537.705 and 540.505 to 540.580 and OAR 690-380-5000. If protests are not filed pursuant to OAR 690-380-4030, the application will be approved.

If Transfer Application T-14580 is approved, the final order will include the following:

1. *The additional points of appropriation proposed in Transfer Application T-14580 are approved.*
2. *The right to the use of the water is restricted to beneficial use at the place of use described and is subject to all other conditions and limitations contained in Certificate 42225 and any related decree.*
3. *Approval of this transfer application does not constitute nor grant legal access onto or through another person's property for purposes of accessing the new points of appropriation.*
4. *Water right Certificate 42225 is cancelled.*

5. *The quantity of water diverted at the new additional points of appropriation (Well 2, Well, 3 and GR-859 Well), together with that diverted at the original point of appropriation (Certificate 42225 Well), shall not exceed the quantity of water lawfully available at the original point of appropriation (Certificate 42225 Well).*
6. *Water shall be acquired from the same aquifer (water source) as the original point of appropriation.*
7. *Water use measurement conditions:*
 - a. *Before water use may begin under this order, the water user shall install a totalizing flow meter, or, with prior approval of the Director, another suitable measuring device, at each point of appropriation (new and existing).*
 - b. *The water user shall maintain the meters or measuring devices in good working order.*
 - c. *The water user shall allow the Watermaster access to the meters or measuring devices; provided however, where the meters or measuring devices are located within a private structure, the Watermaster shall request access upon reasonable notice.*
8. *Full beneficial use of the water shall be made, consistent with the terms of this order, on or before **October 1, 2026**. A Claim of Beneficial Use prepared by a Certified Water Right Examiner shall be submitted by the applicant to the Department within one year after the deadline for completion of the change and full beneficial use of the water.*
9. *After satisfactory proof of beneficial use is received, a new certificate confirming the right transferred will be issued.*

Dated in Salem, Oregon on **APR 25 2025**

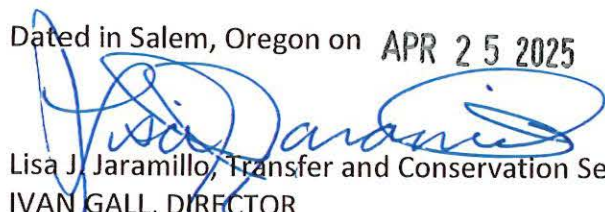
Lisa J. Jaramillo, Transfer and Conservation Section Manager, for
IVAN GALL, DIRECTOR
Oregon Water Resources Department

This Preliminary Determination was prepared by If you have questions about the information in this document, you may reach me at 971-304-5006 or dante.j.luongo@hotmail.com.

Protests

Under the provisions of ORS 540.520(6) & (7) and OAR 690-380-4030, within 30 days after the last date of publication of the newspaper notice or the Department's weekly notice as prescribed by OAR 690-380-4020, whichever is later, any person may file, jointly or severally, a protest expressing opposition of approval of the transfer application and disagreement with this Preliminary Determination or a standing statement in support of this Preliminary Determination. If this Preliminary Determination determines that a change in point of diversion or appropriation would result in injury, the applicant may file a notification of intent to pursue approval of the transfer under OAR 690-380-5030 to 690-380-5050. Protests and standing statements must be received by the Water Resources Department within 30 days after the last date of publication of the newspaper notice or the Department's weekly notice as prescribed by OAR 690-380-4020, whichever is later.

Protests must be in writing and received in hard copy form with the appropriate statutory protest filing fee; protests cannot be filed by electronic mail. [OAR 690-002-0025(3) and 690-380-0100(9)]. The protest must include the following:

- The person's name, address, and telephone number;
- All reasonably ascertainable issues and all reasonably available arguments supporting the person's position by the close of the protest period. Failure to raise a reasonably ascertainable issue in a protest or failure to provide sufficient specificity to afford the Department an opportunity to respond to the issue may preclude consideration of the issue during the hearing;
- If you are the applicant, a protest fee of \$480 required by ORS 536.050; and
- If you are not the applicant, a protest fee of \$950 required by ORS 536.050 and proof of service of the protest upon the applicant.

Requests for Standing

Under the provisions of OAR 690-380-4030(5), the Department shall provide to persons who have filed standing statements as defined under OAR 690-380-0100(11) notice of any differences between the Department's Preliminary Determination and the Final Order, notice of a hearing on the application under OAR 137-003-0535, and an opportunity to request limited party status or party status in the hearing.

Requests for standing must be received in the Water Resources Department no later than 30 days after the last date of publication of the newspaper notice or the Department's weekly notice as prescribed by OAR 690-380-4020, whichever is later. Requests for standing must be in writing, and must include the following:

- The requester's name, mailing address and telephone number;
- If the requester is representing a group, association or other organization, the name, address and telephone number of the represented group;
- A statement that the requester supports the preliminary determination as issued.

After the protest period has ended, the Director will either issue a Final Order or schedule a contested case hearing. The contested case hearing will be scheduled only if a protest has been filed under OAR 690-380-4030. In accordance with OAR 690-380-4200, notice and conduct of the hearing shall:

- Be under the applicable provisions of ORS 183.310 to 183.550, pertaining to contested cases, and the hearing shall be held in the area where the rights are located unless all parties stipulate otherwise; and
- If a protest has asserted that a water right to be transferred has been forfeited through non-use, include the notice and procedures described in OAR 690-017-0500 to 690-017-0900.

If after hearing the Department issues a proposed Final Order finding that a change in point of diversion or appropriation will result in injury, the applicant may file a notification of intent to pursue approval of the transfer under OAR 690-380-5030 to 690-380-5050 within 15 days of receipt of the proposed order. Notwithstanding 690-002-0175, if the applicant files a notification of intent to pursue approval of the transfer under 690-380-5030 to 690-380-5050, the deadline for filing exceptions to the proposed order shall be 30 days after the Department provides notice to the parties that the transfer does not meet the requirements of 690-380-5030 to 690-380-5050.

If you do not request a hearing within 30 days after the close of the protest period, or if you withdraw a request for a hearing, notify the Department or the administrative law judge that you will not appear, or fail to appear at a scheduled hearing, the Director may issue a final order by default. If the Director issues a Final Order by default, the Department designates the relevant portions of its files on this matter, including all materials that you have submitted relating to this matter, as the record for purpose of proving a *prima facie* case upon default.

You may be represented by an attorney at the hearing. Legal aid organizations may be able to assist a party with limited financial resources. Generally, partnerships, corporations, associations, governmental subdivisions, or public or private organizations are represented by an attorney. However, consistent with OAR 690-002-0020 and OAR 690-137-0555, an agency representative may represent partnerships, corporations, associations, governmental subdivisions or public, or private organizations if the Department determines that appearance of a person by an authorized representative will not hinder the orderly and timely development of the record in this case.

Notice Regarding Servicemembers: Active-duty servicemembers have a right to stay proceedings under the federal Servicemembers Civil Relief Act. 50 U.S.C. App. §§501-597b. For more information contact the Oregon State Bar at 800-452-8260, the Oregon Military Department at 971-355-4127, or the nearest United States Armed Forces Legal Assistance Office through <http://legalassistance.law.af.mil>.

If you have questions about how to file a protest or if you have previously filed a protest and you want to know the status, please contact Will Davidson at 503-507-2749.

If you have questions about the Department or any of its programs, please contact our Water Resources Customer Service Group at 503-986-0900.

Address any correspondence to: Oregon Water Resources Department, Transfer and Conservation Section, 725 Summer Street NE, Suite A, Salem OR 97301-1266.

Groundwater Transfer Review Summary Form

Transfer/PA # T- 14580 (RA)

GW Reviewer Stacey Garrison Date Review Completed: 2/10/2025

Summary of Same Source Review:

☐ The proposed change in point of appropriation is not within the same aquifer as per OAR 690-380-2110(2).

Summary of Water Level Decline Condition Review:

☐ Water levels at the original point(s) of appropriation have exceeded the allowed decline threshold defined by conditions in the originating water right.

Summary of Injury Review:

☐ The proposed transfer will result in another, existing water right not receiving previously available water to which it is legally entitled or result in significant interference with a surface water source as per 690-380-0100(3).

Summary of GW-SW Transfer Similarity Review:

☐ The proposed SW-GW transfer doesn't meet the definition of "similarly" as per OAR 690-380-2130.

This is only a summary. Documentation is attached and should be read thoroughly to understand the basis for determinations.



Oregon Water Resources Department
725 Summer Street NE, Suite A
Salem, Oregon 97301-1271
(503) 986-0900
www.wrd.state.or.us

Ground Water Review Form:

- ☒ Water Right Transfer
☐ Permit Amendment
☐ GR Modification
☐ Other

Application: T-14580

Applicant Name: Jensen Family LLC c/o Mark Tribbett

Proposed Changes: ☐ POA ☒ APOA ☐ SW→GW ☒ RA
☐ USE ☐ POU ☐ OTHER

Reviewer(s): Stacey Garrison

Date of Review: 2/10/2025

Date Returned to WRSD: 2/11/2025

The information provided in the application is insufficient to evaluate whether the proposed transfer may be approved because:

- ☐ The water well reports provided with the application do not correspond to the water rights affected by the transfer.
- ☐ The application does not include water well reports or a description of the well construction details sufficient to establish the ground water body developed or proposed to be developed.
- ☐ Other _____

1. Basic description of the changes proposed in this transfer: Applicant proposes to add three APOAs to **Certificate 42225**: APOA 2/Well 2 (**PROP 608**), APOA 3/Well 3 (**PROP 609**), APOA 4/Well 4 (**MARI 4749**). The authorized POA on **Certificate 42225** is POA 1/Well 1 (**MARI 6493**), which is authorized to irrigate 42.6 ac at a maximum rate of 0.53 cfs (238 gpm) and a maximum annual volume of 106.5 acre-feet/year. All four POAs are authorized or proposed to be authorized under other transfers: T-13599 approved on 12/12/2024 added APOA 2/Well 2 (**PROP 608**) and APOA 3/Well 3 (**PROP 609**) to **Claim GR-2579** to irrigate 78.7 ac with a maximum annual duty of 196.75 acre-feet/year* and maximum flow of 1.06 cfs (476 gpm); pending T-14581 proposes to add POA 1/Well 1 (**MARI 6493**), APOA 2/Well 2 (**PROP 608**), and APOA 3/Well 3 (**PROP 609**) to **Claim GR-859** with authorized POA APOA 4/Well 4 (**MARI 4749**) for irrigation of 80 ac with a maximum annual duty of 200 acre-feet/year* and maximum flow rate of 0.7442 cfs (336 gpm). The total maximum combined rates will be used and are summarized in the table below.

Rates and Duties		POA			
		Well 1/POA 1 (MARI 6493)	Well 2/APOA 2 (PROP 608)	Well 3/APOA 3 (PROP 609)	Well 4/APOA 4 (MARI 4749)
POU (ac)	This transfer, T-14580/Certificate 42225	42.6	42.6	42.6	42.6
	Claim GR 2579 per T-13599	NA	78.7	78.7	NA
	Claim GR 859/T-14581	80	80	80	80
	Total	122.6	201.3	201.3	122.6
Authorized duty (AF/year)	This transfer, T-14580/Certificate 42225	106.5	106.5	106.5	106.5
	Claim GR 2579 per T-13599*	NA	196.75	196.75	NA
	Claim GR 859/T-14581*	200	200	200	200
	Total	306.5	503.25	503.25	306.5
Flow rate CFS (gpm)	This transfer, T-14580/Certificate 42225	0.53 cfs (238 gpm)	0.53 cfs (238 gpm)	0.53 cfs (238 gpm)	0.53 cfs (238 gpm)
	Claim GR 2579 per T-13599	NA	1.06 cfs (476 gpm)	1.06 cfs (476 gpm)	NA
	Claim GR 859/T-14581	0.7442 cfs (336 gpm)	0.7442 cfs (336 gpm)	0.7442 cfs (336 gpm)	0.7442 cfs (336 gpm)
		1.2742 CFS (574 GPM)	2.3342 CFS (1,050 GPM)	2.3342 CFS (1,050 GPM)	1.2742 CFS (574 GPM)
	Total				

*Maximum annual volume as authorized duty per acre not described in Claim GR-2579 or Claim GR-859. Standard maximum duty for Willamette Basin of 2.5 AF/ac/year is applied here.

2. Will the proposed POA develop the same aquifer (source) as the existing authorized POA?
☒ Yes ☐ No Comments: The authorized well, POA 1/Well 1 (MARI 6493), is completed to a depth of 185 ft [27 ft amsl] with a static water level, SWL, of 39 ft bls [173 ft amsl] and utilizes the Middle Sedimentary Unit of the Willamette Aquifer, consisting of slightly to moderately consolidated Pleistocene sands and gravels (Gannett and Caldwell, 1998; Conlon et al., 2005). The constructed APOA, APOA 4/Well 4 (MARI 4749), is completed to a depth of 147 ft [52 ft amsl] with a SWL of 25 ft bls [174 ft amsl]. The proposed APOAs, APOA 2/Well 2 (PROP 608) and APOA 3/Well 3 (PROP 609), are anticipated to be completed to a depth of 200 ft [12 ft and 1 ft amsl, respectively]. The Willamette Aquifer is between 100 and 120 ft thick and overlain by 80 ft of fine-grained, low permeability Willamette Silt Gannett and Caldwell, 1998; MARI 4750 and MARI 6489). The three APOAs are anticipated to produce from the same aquifer is the authorized POA.
3. a) Is the existing authorized POA subject to a water level decline condition?
☐ Yes ☒ No Comments: _____

b) If yes, for each POA identify the reference level, most recent spring-high water level, and whether an applicable permit decline condition has been exceeded: NA
4. a) Is there more than one source developed under the right (e.g., basalt and alluvium)?
☐ Yes ☒ No Comments: Only the alluvial source is developed.

b) If yes, estimate the portion of the right supplied by each of the sources and describe any limitations that will need to be placed on the proposed change (rate, duty, etc.): NA

5. a) Will this proposed change, at its maximum allowed rate of use, likely result in an increase in interference with **another ground water right**?

☒ Yes ☐ No Comments: Proposed APOA 3/Well 3 (PROP 609) is ~750 ft northwest of MARI 6489, a POA on Certificate 47840 with priority date 5/23/1973. The authorized POA/POA 1 (MARI 6493) is ~1956 ft southwest of MARI 6489. The reduced distance is anticipated to increase interference with MARI 6489.

b) If yes, would this proposed change, at its maximum allowed rate of use, likely result in another groundwater right not receiving the water to which it is legally entitled?

☐ Yes ☒ No If yes, explain: The maximum drawdown produced by APOA 3/Well 3 (PROP 609) is not anticipated to result in MARI 6489 not receiving the water to which it is legally entitled.

6. a) Will this proposed change, at its maximum allowed rate of use, likely result in an increase in interference with **another surface water source**?

☒ Yes ☐ No Comments: Proposed APOA 3/Well 3 (PROP 609) is ~1680 ft northwest of Howell Prairie Creek. The authorized POA/POA 1 (MARI 6493) is ~2300 ft west Howell Prairie Creek. The reduced distance is anticipated to increase interference with Howell Prairie Creek.

b) If yes, at its maximum allowed rate of use, what is the expected change in degree of interference with any **surface water sources** resulting from the proposed change?

Stream: Howell Prairie Creek ☒ Minimal ☐ Significant

Provide context for minimal/significant impact: The Willamette Aquifer in this area is overlain by about 80 ft of the Willamette Silt Unit (WSU). Howell Prairie Creek is partially incised into the WSU and appears to be underlain by about 40-50 ft low permeability sediments from the WSU. Given the confined nature of the aquifer and presence of a thick sequence of low permeability sediments, interference with surface water sources is assumed to be minimal.

7. For SW-GW transfers, will the proposed change in point of diversion affect the surface water source similarly (as per OAR 690-380-2130) to the authorized point of diversion specified in the water use subject to transfer?

☐ Yes ☐ No Comments: NA

8. What conditions or other changes in the application are necessary to address any potential issues identified above: NA

9. Any additional comments: _____

References

Transfer File: T-14581, Certificate 42225, T-13599, Claim GR 2579, T-14851, Claim GR 859

Conlon, T.D., Wozniak, K.C., Woodcock, D., Herrera, N.B., Fisher, B.J., Morgan, D.S., Lee, K.K., and Hinkle, S.R., 2005, Ground-water hydrology of the Willamette Basin, Oregon, Scientific Investigations Report 2005-5168: U. S. Geological Survey, Reston, VA.

O'Connor, J.E., Sarna-Wojcick, A., Wozniak, K.C., Polette, D.J., Fleck, R.J., 2001, Origin, Extent, and Thickness of Quaternary Geologic Units in the Willamette Valley, Oregon; U.S. Geological Survey, Professional Paper 1620, 51 p.

Map

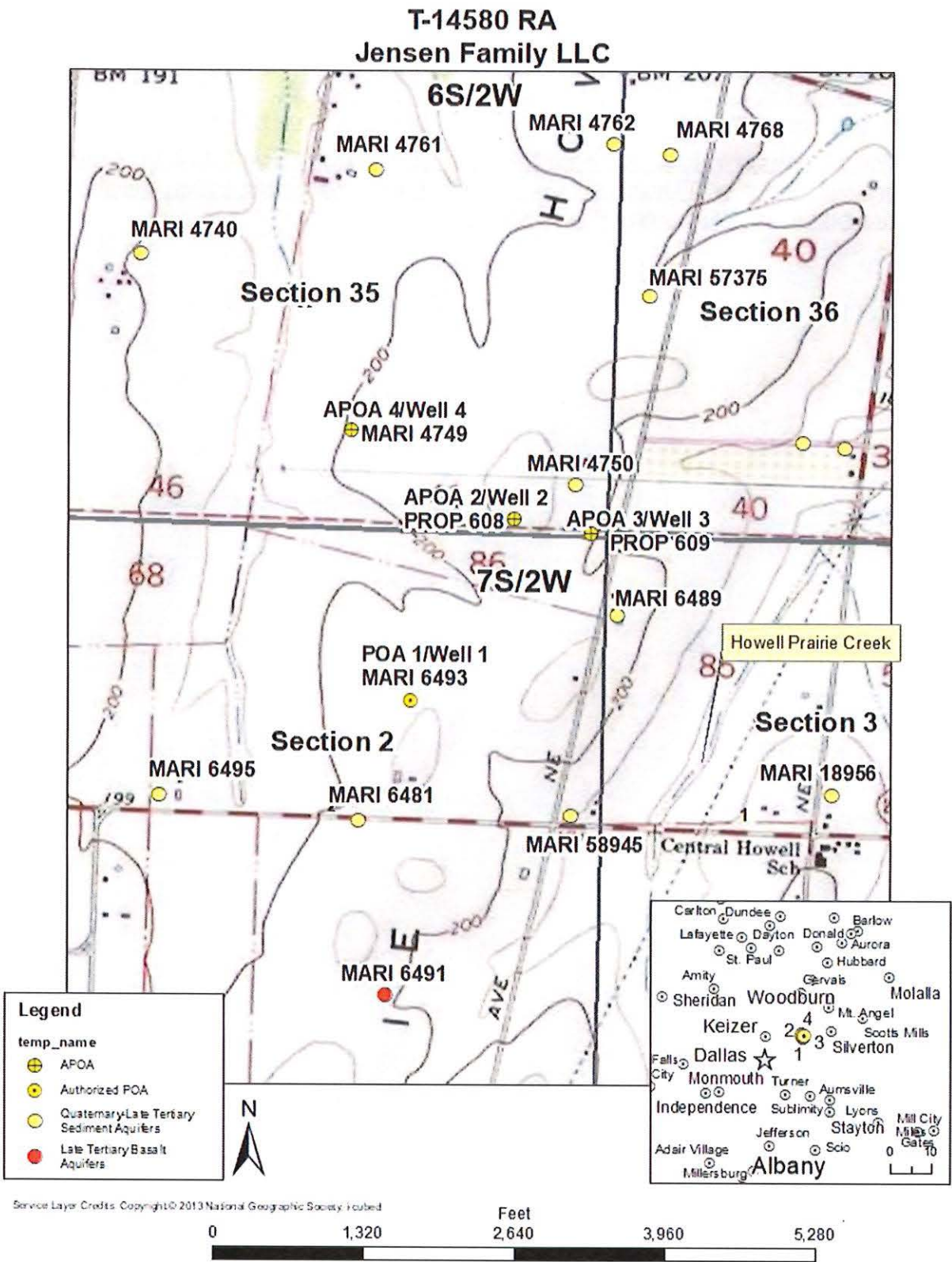

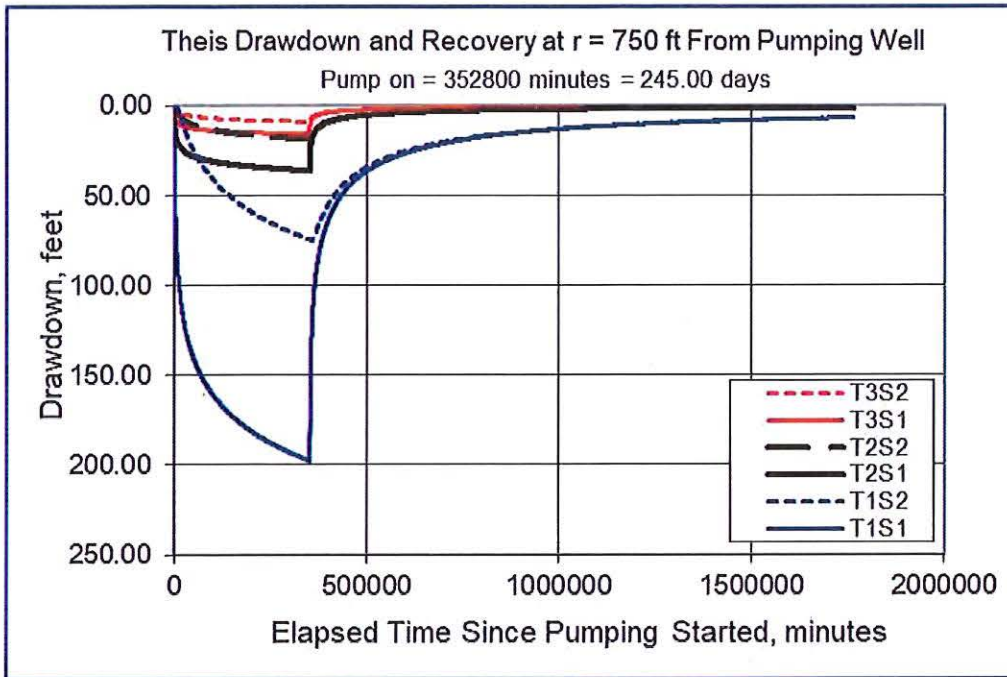
Injury Analysis

Radial distance from pumping well (r)=750 ft [estimated radial distance to nearest user, MARI 6489]

Pumping Rate (Q)= 1.0356 cfs (~464.78 gpm)*

Aquifer Transmissivity (T_1)= 1,497 gpd/ft (200 ft²/day), (T_2)= 4,115 gpd/ft (550 ft²/day), (T_3)= 32,060 gpd/ft (4,286 ft²/day)

Storativity (s_1) = 0.0003, (s_2) = 0.02 [Conlon et al 2005, Table 1 values for MSU]

Total pumping time= 245 days [March 1-October 31]

*The full pumping rate could not be utilized continuously for the entire 245-day period of use without exceeding the 503.25 ac-ft maximum allowed duty. For the maximum allowed duty of 503.25 ac-ft, continuous pumping would occur for 245 days at a rate of 1.0356 cfs (~464.78 gpm)

	208	ft amsl	elevation	
SWL	35	ft bls	MARI 6489	
			Gannett & Caldwell 1998 (MARI 6489 is 195 ft depth, essentially fully penetrates the aquifer)	
Aquifer Bottom	200	ft bls		
<hr/>				
Available Water				
Column	165	ft	Aquifer Bottom - SWL	
<hr/>				
Pump Height Above				
Bottom	5	ft	Estimate	
NPSHa	5	ft	Estimate	
			Driscoll estimate, Drawdown=Pumping Rate/Specific Capacity.	
			For Cert 47840, rate is 0.84 cfs (377 gpm). From MARI 6489	
			well log, drawdown at 400 gpm was 66 ft and at 540 gpm was	
			95 ft for specific capacity of 6.06 and 5.68, respectively.	
<hr/>				
Drawdown	66	ft		
<hr/>				
Minimum Water				
Column	76	ft	Estimated Drawdown + NPSHa + Pump Height	
Injury	89	ft	Available Water Column-Minimum Water Column	

**STATE OF OREGON
WATER RESOURCES DEPARTMENT**

725 Summer St. N.E. Ste. A
SALEM, OR 97301-4172
(503) 986-0900 / (503) 986-0904 (fax)

RECEIPT # **144552**

INVOICE # _____

RECEIVED FROM: Jensen Family LLC
BY: _____

APPLICATION	
PERMIT	
TRANSFER	T-14580

CASH: ☐ CHECK: # 5084 OTHER: (IDENTIFY) ☐ _____

TOTAL REC'D \$ 3390.70

1083 TREASURY 4170 WRD MISC CASH ACCT

0407 COPIES 47124 R 11-534-25 \$ _____
0412 OTHER: (IDENTIFY) Transfer RA \$ 3390.70

0243 I/S Lease _____ 0244 Muni Water Mgmt. Plan _____ 0245 Cons. Water _____

4270 WRD OPERATING ACCT

MISCELLANEOUS

0407	COPY & TAPE FEES	\$
0410	RESEARCH FEES	\$
0408	MISC REVENUE: (IDENTIFY) _____	\$
TC162	DEPOSIT LIAB. (IDENTIFY) _____	\$
0240	EXTENSION OF TIME	\$

WATER RIGHTS:

0201	SURFACE WATER	EXAM FEE \$	0202	RECORD FEE \$
0203	GROUND WATER	\$	0204	\$
0205	TRANSFER	\$		

WELL CONSTRUCTION

0218	WELL DRILL CONSTRUCTOR	EXAM FEE \$	0219	LICENSE FEE \$
	LANDOWNER'S PERMIT		0220	\$

OTHER (IDENTIFY) _____

0536 TREASURY 0437 WELL CONST. START FEE

0211	WELL CONST START FEE	\$	CARD#	
0210	MONITORING WELLS	\$	CARD#	

OTHER (IDENTIFY) _____

0607 TREASURY 0467 HYDRO ACTIVITY LIC NUMBER

0233	POWER LICENSE FEE (FWWRD)	\$
0231	HYDRO LICENSE FEE (FWWRD)	\$
	HYDRO APPLICATION	\$

TREASURY OTHER / RDX

FUND _____ TITLE _____
OBJ. CODE _____ VENDOR # _____
DESCRIPTION _____ \$ _____

RECEIPT: **144552** DATED: 1-16-25 BY: Ly. D Miller

**REIMBURSEMENT AUTHORITY
APPLICANT'S AGREEMENT
Contract Number: R11-534-25**

Received by OWRD

JAN 16 2025

Salem, OR

This Agreement is between the **Oregon Water Resources Department**, hereafter OWRD, and **Jensen Family LLC**, hereafter Applicant, hereafter known together as the parties.

OWRD Information	Applicant's Information	Applicant's Representative
Contact: Lisa Jaramillo	Name: Jensen Family LLC	Name: Pacific Hydro-Geology, Inc.
Title: Transfer Advisor/Manager	Contact: Mark Tribbett	Contact: Doann Hamilton
Address: 725 Summer Street, NE, Suite A Salem, OR 97301-1266	Address: 5289 Blue Grass Ln Silverton, OR 97381	Address: 18487 S. Valley Vista Rd Mulino, OR 97042
Phone: (503) 871-1889	Phone: (503) 991-6821	Phone: (503) 349-6946
Fax: (503) 986-0901	Fax:	Fax: (503) 632-5983
Email: lisa.jaramillo@water.oregon.gov	Email: mark@jbinstantlawn.net	Email: phgdmh@gmail.com

Purpose The purpose of this Agreement is to expedite the processing of the **Transfer Application**. (**Application Number: T-14580**)

1. **Authority.** The OWRD has been authorized pursuant to ORS 536.055 to enter into a voluntary agreement with any applicant, permittee or regulated entity (collectively Applicant) for expediting or enhancing a regulatory process. In making this agreement, OWRD shall require the applicant to pay the full cost of expedited process.
2. **Restrictions.** Applicant and OWRD agree that this Agreement shall not be construed to restrict in any way the decisions and actions by OWRD. OWRD shall be free to exercise independent judgment consistent with existing laws and regulations.
3. **Effective Date and Duration.** Unless otherwise terminated by non-deposit of funds by the Applicant, this Agreement shall become effective on the date on which both parties have signed the Agreement and the full deposit of the estimated cost of the proposed service.
4. **Consideration.**
 - a. Applicant shall pay OWRD in advance for actual costs incurred by OWRD. The estimated maximum reimbursement payable to OWRD under this Agreement is **\$3,390.96**. Applicant agrees to pay the full amount of **\$3,390.96** to OWRD prior to commencement of any work stated in this Agreement. This payment will be placed in an account administered by OWRD and drawn upon as costs are actually incurred. If the actual cost of performing the work is less than payments received, OWRD will refund the unspent balance. If the actual cost of processing exceeds the estimate, the Applicant can either elect to terminate this Agreement or amend the Agreement to reflect the increase in cost.
 - b. The costs stated in this Agreement do not include the statutory application processing and filing fees.
5. **Confidentiality.** Applicant agrees that any information provided to or acquired by OWRD under this Agreement will be subject to the Oregon Public Records Law and shall be considered public records.
6. **Indemnity.** Applicant shall defend, save, hold harmless, and indemnify the State of Oregon, OWRD, and their officers, employees, and agents from and against all claims, suits, actions, losses, damages, liabilities, costs, and expenses of any nature resulting from or arising out of, or relating to the activities of Applicant or its representatives, officers, employees, contractors, or agents under this Agreement or with respect to the expedited service. The Applicant acknowledges that the Oregon Water Resources Department cannot and does not guarantee a favorable review under the subject regulatory process.

7. **Termination by Applicant.** Applicant may request to terminate this agreement only in writing at anytime during the process. The Applicant agrees to pay for the work done by OWRD up until the time of the written termination request. OWRD, upon receiving such written termination request from the Applicant, will refund any unspent balance.
8. **Termination by OWRD.** OWRD may terminate this Agreement if the applicant fails to provide any requested items necessary to complete the application and/or comply with applicable rule requirements within the specified timeframe outlined in the request letter, being a period of not less than 30 days.
9. **Funds Authorized and Available.** By its execution of this Agreement, Applicants certify that sufficient funds are authorized and available to cover the expenditures contemplated by this Agreement.
10. **Duration of Estimate.** The Estimate of Time to completion is **approximately** 120 days once this Agreement has been fully executed and payment of the estimated cost deposited. If the Applicant's Agreement is not received by the Department within thirty (30) days of mailing the Agreement, the Applicant may need to re-apply for a new estimate. NOTE: Any time estimate is approximate; No guarantee of Final Order issuance of a date is certain. Duration estimates do not include any statutory waiting periods.
10. **Completion Date.** OWRD, by the execution of this Agreement does not guarantee the completion date indicated in this Agreement. Completion date is only an estimate and may be affected by the Department's workload, issues arising from the processing of the requested services and Applicant's timely response to requests for additional information.
11. **Captions.** The captions or headings in this Agreement are for the convenience only and in no way define, limit, or describe the scope, or intent, of any provision of this Agreement.
12. **Amendment and Merger.** The terms of this Agreement shall not be waived, altered, modified, supplemented, or amended in any manner whatsoever, except by written instrument signed by both parties. Such waiver, consent, modification or change, if made, shall be effective only in the specific instance and for the specific purpose given. There are no understandings, agreements or representations, oral or written, not specified herein regarding this Agreement.
13. **Signatures.** All parties, by the authorized representative's signature below, hereby acknowledge that they have read this Agreement, understand it and agree to be bound by its terms and conditions.

For Applicant: Mark H. D. Webb / manager
 Name/Title: Dwight French
 For OWRD: Dwight French – Administrator

1-13-2025
 Date
1-22-25
 Date

Mail signed Agreement to:

Stacy Phillips
 Oregon Water Resources Department
 725 Summer Street NE, Suite A
 Salem, OR 97301-1266

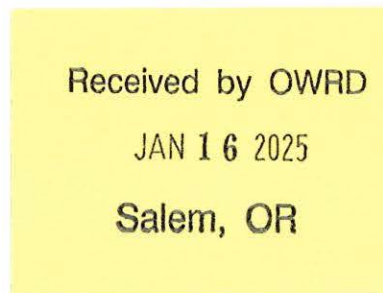

**STATE OF OREGON
WATER RESOURCES DEPARTMENT**

725 Summer St. N.E. Ste. A

SALEM, OR 97301-4172

(503) 986-0900 / (503) 986-0904 (fax)

RECEIPT # **144418**

INVOICE # _____

RECEIVED FROM: Jensen Family LLC
BY: _____

APPLICATION	
PERMIT	
TRANSFER	T-14580

CASH: ☐ CHECK: # 5081 OTHER: (IDENTIFY) ☐

TOTAL REC'D \$ 125.00

1083 TREASURY 4170 WRD MISC CASH ACCT

0407 COPIES 47124 R11534-25 \$ _____
0412 OTHER: (IDENTIFY) Transfer RA \$ 125.00

0243 I/S Lease _____ 0244 Muni Water Mgmt. Plan _____ 0245 Cons. Water _____

4270 WRD OPERATING ACCT

MISCELLANEOUS

0407 COPY & TAPE FEES	\$ _____
0410 RESEARCH FEES	\$ _____
0408 MISC REVENUE: (IDENTIFY) _____	\$ _____
TC162 DEPOSIT LIAB. (IDENTIFY) _____	\$ _____
0240 EXTENSION OF TIME	\$ _____

WATER RIGHTS:

0201 SURFACE WATER	EXAM FEE \$ _____	0202 \$ _____
0203 GROUND WATER	EXAM FEE \$ _____	0204 \$ _____
0205 TRANSFER	EXAM FEE \$ _____	

WELL CONSTRUCTION

0218 WELL DRILL CONSTRUCTOR	EXAM FEE \$ _____	0219 \$ _____
LANDOWNER'S PERMIT		0220 \$ _____

OTHER (IDENTIFY) _____

0536 TREASURY 0437 WELL CONST. START FEE

0211 WELL CONST START FEE	\$ _____	CARD# _____
0210 MONITORING WELLS	\$ _____	CARD# _____

OTHER (IDENTIFY) _____

0607 TREASURY 0467 HYDRO ACTIVITY LIC NUMBER

0233 POWER LICENSE FEE (FW/WRD)	\$ _____
0231 HYDRO LICENSE FEE (FW/WRD)	\$ _____
HYDRO APPLICATION	\$ _____

TREASURY OTHER / RDX

FUND _____ TITLE _____
OBJ. CODE _____ VENDOR # _____
DESCRIPTION _____ \$ _____

RECEIPT: **144418**

DATED: 12-18-24

BY: [Signature]



OREGON WATER RESOURCES DEPARTMENT
TRANSFER REIMBURSEMENT AUTHORITY
ESTIMATE APPLICATION



ORS 536.055 authorizes the Oregon Water Resources Department to expedite or enhance regulatory processes voluntarily requested under the agreement.

Please contact Transfer Staff before submitting this request, as the application fee of \$125.00 per request is non-refundable.

Checks submitted for this application must be separate from Transfer fees.

The purpose of this application is to obtain estimates of the cost and time required to process a Transfer Application Request. There is a non-refundable application fee of \$125.00 per request.

REQUEST	TYPE	FILE NUMBER
<input checked="" type="checkbox"/>	Transfer Application	T-14580 Transfer Number NA

	Applicant Information	Applicant's Representative/Contact
Name:	Jensen Family LLC c/o Mark Tribbett	Pacific Hydro-Geology, Inc. c/o Doann Hamilton
Address:	5289 Blue Grass Ln Silverton, OR 97381	18487 S. Valley Vista Road Mulino, OR 97042
Phone:	503-991-6821	(503) 349-6946 cell
Fax:		(503) 632-5983
E-Mail Address:	mark@jbinstantlawn.net	phgdmh@gmail.com

By signing this application, I understand:

- That upon receipt of my non-refundable application fee of **\$125.00**, OWRD will, within fourteen (14) days, notify me in writing of the estimate of costs and time frame for the expedited service.
- That this fee covers the reimbursement authority staff to evaluate and provide the estimate for processing of the request.
- That upon receiving the estimate, I may agree or decline to enter into a formal contract to pay the estimated cost in advance to initiate the expedited service.
- That an incomplete or inaccurate application may delay the process and increase the cost to process my request.
- That expedited processing does not guarantee a favorable review of my request.

I certify that I am the (check one):

☒ Applicant ☐ Applicant's Representative ☐ Other (Please specify) _____

Name: Jensen Family LLC Mark H. Tribbett manager

Signature: Jensen Family LLC Mark H. Tribbett manager

Send completed Application and payment to:

Oregon Water Resources Department
Transfer Reimbursement Authority Program
725 Summer St. NE, Suite A
Salem, OR 97301-1271

Received
DEC 18 2024
OWRD

OWRD USE ONLY: Reimbursement Authority Number: R11-534-25

Watermaster Review Form: Water Right Transfer



Oregon Water Resources Department
725 Summer St NE, Suite A
Salem, Oregon 97301-1266
(503) 986-0900
www.oregon.gov/OWRD

Transfer Application: T-14580

Review Due Date: 01/22/2025

Applicant Name: JENSEN FAMILY LLC. c/o MARK TRIBBETT

Proposed Changes: ☐ POU ☐ POD ☒ POA ☐ USE ☐ OTHER

Reviewer(s): G. Wacker

Date of Review: 01/03/2025

1. Do you have evidence that the right has not been used in the last 5 years and that the presumption of forfeiture would not likely be rebuttable? ☐ Yes ☒ No If "Yes", attach evidence (e.g. dated aerial photo showing pavement or building on the land for >5 yrs.)
2. Is there a history of regulation on the source that serves this (or these) right(s) that has involved the transferred right(s) and downstream water rights? ☐ Yes ☒ No Generally characterize the frequency of any regulation or explain why regulation has not occurred:
3. Have headgate notices been issued for the source that serves the transferred right(s)?
☐ Yes ☒ No ☐ Records not available.
4. In your estimation, after the proposed change, would distribution of water for the right(s) result in regulation of other water rights that would not have occurred if use under the original right(s) was/were maximized? ☐ Yes ☒ No If "Yes", explain:
5. In your estimation, if the proposed change is approved, are there upstream water rights that would be affected? ☐ Yes ☒ No If "Yes", describe how the rights would be affected and list the rights most affected:

6. Check here ☐ if it appears that downstream water rights benefit from return flows resulting from the current use of the transferred right(s)? If you check the box, generally characterize the locations where the return flows likely occur and list the water rights that benefit most:

☒ N/A

7. For POD changes and instream transfers, check here if there are channel losses between the old and new PODs or within the proposed instream reach? If you check the box, describe and, if possible, estimate the losses:

☒ N/A

8. For instream transfers that propose protection of a reach beyond the mouth of the source stream:

☒ N/A Would the quantity be measureable into the receiving stream consistent with OAR 690-077-0015(8)? ☐ Yes ☐ No

9. For POU changes: ☒ N/A Is it likely the original place of use would continue to receive water from the same source? ☐ Yes ☐ No If "Yes", explain:

10. For POU or USE changes: ☒ N/A In your best judgment, would use of the existing right at "full face value," result in the diversion of more water than can be used beneficially and without waste? ☐ Yes ☐ No If "Yes", explain:

11. For POU changes that involve micro-irrigation: ☒ N/A

- a. Has the applicant made changes (absent a transfer) to convert to micro-irrigation within the current place of use boundary of the water right proposed for transfer, and previously demonstrated to the Department through monitoring and site inspections by the Watermaster that the proposed transfer will not result in injury or enlargement?

☐ Yes ☐ No If "Yes", explain:

- b. Has a temporary transfer of this nature been previously filed and approved on the same lands (or portions thereof) as those lands involved in this transfer?

☐ Yes ☐ No If "Yes", answer the following:

- i. Were there any problems with more acres being irrigated (or wetted) than were authorized under the temporary transfer? ☐ Yes ☐ No If "Yes", explain:

- ii. Did the designated areas that were to remain dry (or not wetted) under the temporary transfer actually remain dry? ☐ Yes ☐ No If "No", explain:

- iii. Did the applicant comply with and meet all of the conditions of the temporary transfer? ☐ Yes ☐ No If "No", explain:

- iv. Do you have any other observations regarding the temporary transfer? ☐ Yes ☐ No If "Yes", describe:

- v. Did the applicant demonstrate to the Department through monitoring and site inspections by the Watermaster that neither injury nor enlargement occurred as a result of the temporary transfer? ☐ Yes ☐ No If "No", explain:

- c. To the best of your knowledge, if this transfer is approved, does it appear that:

- i. "Injury" will occur to other water rights that share the same source? ☐ Yes ☐ No If "Yes", explain:

- ii. "Enlargement" of the water right being transferred will occur? ☐ Yes ☐ No If "Yes", explain:

12. Are there other issues not identified through the above questions that should be considered in determining whether the change "can be effected without injury to other rights"?

☐ Yes ☒ No If "Yes", explain:

13. What alternatives may be available for addressing any issues identified above:

14. Do conditions need to be included in the transfer order to avoid enlargement of the right or injury to other rights? ☐ No ☒ Yes, as checked and provided below:

☐ For POU changes that involve micro-irrigation, provide the monitoring and reporting conditions necessary to prevent injury/enlargement:

☐ A Headgate should be required prior to diverting water.

☒ Measurement Devices for POD or POA: (if this condition is selected, also fill in the top sections of Page 4)

*a. Before water use may begin under this order, the water user shall install a **totalizing flow meter***, or, with prior approval of the Director, another suitable measuring device, ☒ at each point of diversion/appropriation (new and existing) **OR** at each new point of diversion/appropriation ☐ with the exception that water rights issued to the Bureau of Reclamation or an irrigation district (or similar entity) are not subject to this condition.*

b. The water user shall maintain the meters or measuring devices in good working order.

c. The water user shall allow the Watermaster access to the meters or measuring devices; provided however, where the meters or measuring devices are located within a private structure, the Watermaster shall request access upon reasonable notice.

☐ Reservoir water use measurement: (if this condition is selected, also fill in the top sections of Page 4)

*a. Before water use may begin under this order, the water user shall install **staff gages***, or, with prior approval of the Director, other suitable measuring devices, that measure the entire range and stage between empty and full in each reservoir. Staff gages shall be United States Geological Survey style.*

b. Before water use may begin under this order, if the reservoir is located in channel, weirs or other suitable measuring devices must be installed upstream and downstream of the reservoir, and, an adjustable outlet valve must be installed. The water user shall maintain such devices in good working order. A written waiver may be obtained, if in the judgment of the Director, the installation of weirs or other suitable measuring devices, or the adjustable outlet valve, will provide no public benefit.

* The following alternative device(s) should be substituted for the bold, underlined device in the above selected condition:

☐ Weir
☐ Parshall Flume
☐ Other: ____

☐ Submerged Orifice
☐ Flow Restrictor

Oregon Water Resources Department

Measurement Condition Information for the Applicant

(To be sent with the Draft Preliminary Determination or Final Order)

Transfer #: T- 14580



In order to avoid enlargement of the right or injury to other rights, a **totalizing flow meter** will be required to be installed **prior to diversion of water**, as a condition of this transfer:



at each point of diversion/appropriation (new and existing) **OR**



at each new point of diversion/appropriation.

For additional information, or to obtain approval of a different type of measurement device, the applicant should contact the area Watermaster:

Watermaster name: **Greg Wacker**District: **16**Address: **725 Summer St NE Ste A**City/State/Zip: **Salem, OR 97301**Phone: **541-971-719-6262**Email: **gregory.j.wacker@water.oregon.gov**

Note: If a device other than the one specified in the Preliminary Determination or Final Order is approved by the Watermaster, fill out and mail the form below to the Salem office.

Approval of an Alternate Measurement Device

T-

(to be filled out after consultation with the applicant, or after a site visit)

On behalf of the Director, I authorize use of the following suitable alternate measurement device:

Watermaster signature

District

Date

If this form is used for approval of an alternative measurement device, it must be mailed to:

Oregon Water Resources Department
725 Summer Street NE, Suite A
Salem, OR 97301-1266



Oregon

Tina Kotek, Governor

Water Resources Department

North Mall Office Building

725 Summer St NE, Suite A

Salem, OR 97301

Phone 503 986-0900

Fax 503 986-0904

December 23, 2024

Mark Tribbett
5289 Bluegrass Lane
Silverton, OR 97381
Reference: Application T-14580

On December 18, 2024, the Department received your water right Permanent Transfer Application. The application was accompanied by \$2660.00. Receipt number 144429 is enclosed.

By copy of this letter, we are asking the Watermaster for a report regarding the potential for injury to existing water rights which may be caused by the requested change. A review form will also be sent to our groundwater staff to determine whether the proposed well accesses the same source of water as the original well.

This application may require publication of a notice for two consecutive weeks in a newspaper with general circulation in the area where the water right is located. If it is determined that newspaper notice will be required, the Department will prepare the notice and notify you of the cost. You will be responsible for submitting payment to the Department prior to publication of the notice.

Except as provided under ORS 540.510(3) for municipalities, you may not use water from the new point of appropriation until a final order approving the transfer application has been issued by the Department. In order to avoid any possible forfeiture of the water right, you should continue to use the water as described by your existing water right.

If the land is sold before the application is approved, the buyer's consent to the application will be required unless a recorded deed or other legal document clearly established that the water right was not conveyed in the sale.

Refer to the following page for a chart showing the steps and expected timelines for the processing of your application.

If you have any questions, please contact the Transfer Section at (503) 986-0935.

Cc: Watermaster Dist. #16, Gregory J. Wacker (*via email*)
Doann Hamilton, Agent
Marion County Planning Department, Local Government

Enclosure

T.6S. R.2W. Section 35 T.7S. R.2W. Section 2, W.M.

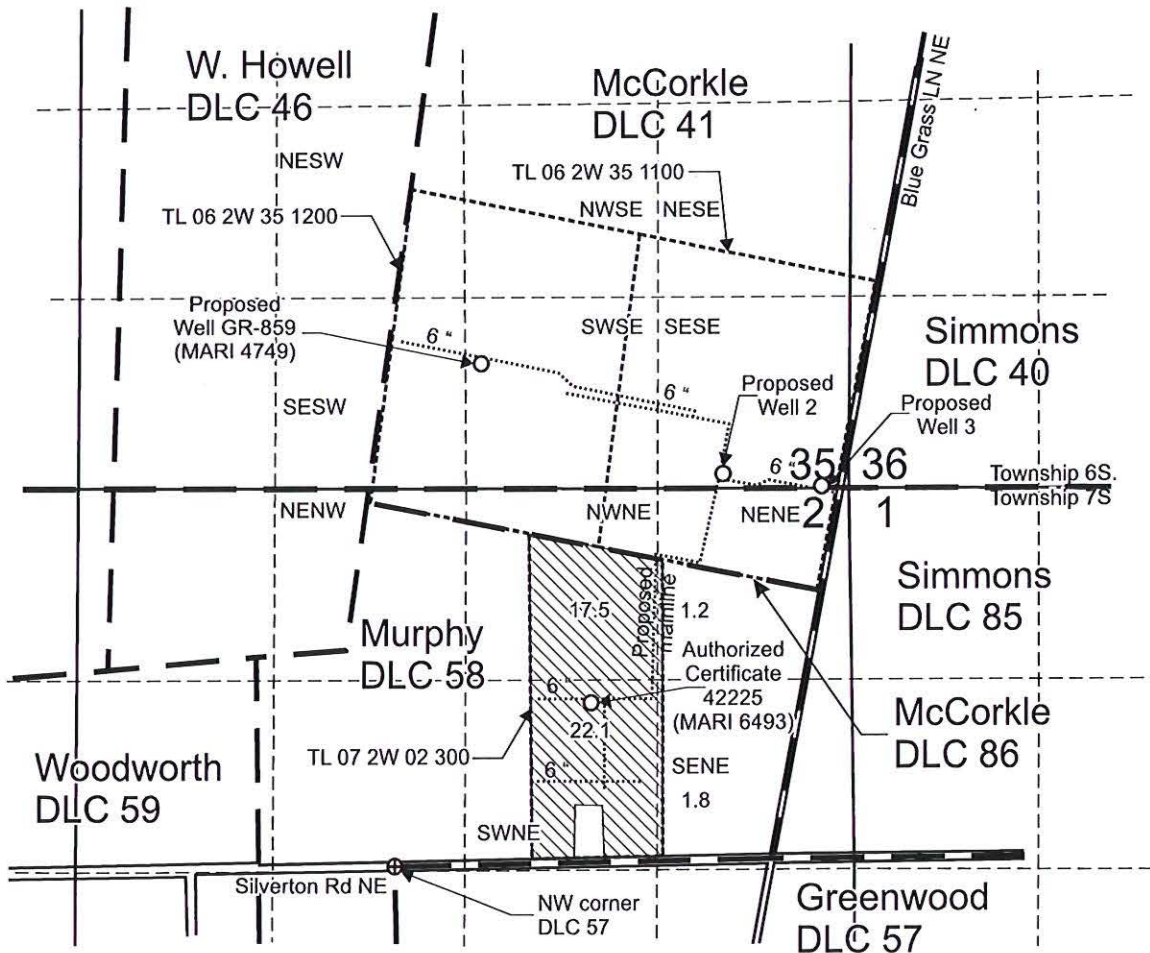

Authorized Certificate 42225 Well (MARI 6493) 1,110 feet north and 1,350 feet east from NW corner, DLC 57.
 Proposed Well 2 is located 100 feet north and 865 feet west from the SE corner, Section 35.
 Proposed Well 3 is located 15 feet north and 185 feet west from the SE corner, Section 35.
 Proposed GR-859 Well (MARI 4749) west 17 degrees north 2,640 feet from SE corner, Section 35.

 Area (42.6 Acres) irrigated under Certificate 42225, priority date 4-9-1969.

- Tax lot boundary
- ■ — Donor Land Claim boundary
- Irrigation mainlines

Scale: 1" = 1,320'



Received
DEC 18 2024

OWRD



This map was prepared for the purpose of identifying the location of a water right only and is not intended to provide legal dimensions or location of property ownership lines.

Transfer Application Map
 Certificate 42225
 Jensen Family LLC.
 T.6S. R.2W. Section 35,
 T.7S. R.2W. Section 2, W.M.

Pacific Hydro-Geology Inc.

12/2024

14580 -

**STATE OF OREGON
WATER RESOURCES DEPARTMENT**

725 Summer St. N.E. Ste. A

SALEM, OR 97301-4172

(503) 986-0900 / (503) 986-0904 (fax)

RECEIPT # **144429**

INVOICE # _____

RECEIVED FROM: Jensen Family LLC

BY: _____

APPLICATION _____

PERMIT _____

TRANSFER T-14580

CASH: ☐ CHECK: # 5080 OTHER: (IDENTIFY) ☐

TOTAL REC'D \$ 2,660.00

1083 TREASURY 4170 WRD MISC CASH ACCT

0407 COPIES \$ _____

OTHER: (IDENTIFY) \$ _____

0243 I/S Lease _____ 0244 Muni Water Mgmt. Plan _____ 0245 Cons. Water _____

4270 WRD OPERATING ACCT

MISCELLANEOUS 46110

0407 COPY & TAPE FEES \$ _____

0410 RESEARCH FEES \$ _____

0408 MISC REVENUE: (IDENTIFY) \$ _____

TC162 DEPOSIT LIAB. (IDENTIFY) \$ _____

0240 EXTENSION OF TIME \$ _____

WATER RIGHTS:

0201 SURFACE WATER \$ _____ 0202 \$ _____

0203 GROUND WATER \$ _____ 0204 \$ _____

0205 TRANSFER \$ 2,660.00

WELL CONSTRUCTION

0218 WELL DRILL CONSTRUCTOR \$ _____ 0219 \$ _____

LANDOWNER'S PERMIT 0220 \$ _____

OTHER (IDENTIFY) _____

0536 TREASURY 0437 WELL CONST. START FEE

0211 WELL CONST START FEE \$ _____ CARD# _____

0210 MONITORING WELLS \$ _____ CARD# _____

OTHER (IDENTIFY) _____

0607 TREASURY 0467 HYDRO ACTIVITY LIC NUMBER

0233 POWER LICENSE FEE (FW/WRD) \$ _____

0231 HYDRO LICENSE FEE (FW/WRD) \$ _____

HYDRO APPLICATION \$ _____

TREASURY OTHER / RDX

FUND _____ TITLE _____

OBJ. CODE _____ VENDOR # _____

DESCRIPTION \$ _____

RECEIPT: **144429**

DATED: 12/18/24 BY: [Signature]

Application for Permanent Water Right Transfer



Oregon Water Resources Department
725 Summer Street NE, Suite A
Salem, Oregon 97301-1266
(503) 986-0900
www.oregon.gov/OWRD

Part 1 of 5 – Minimum Requirements Checklist

This transfer application will be returned if Parts 1 through 5 and all required attachments are not completed and included.

For questions, please call (503) 986-0900, and ask for Transfer Section.

Check all items included with this application. (N/A = Not Applicable)

Received

DEC 18 2024

OWRD

- ☒ Part 1 – Completed Minimum Requirements Checklist.
- ☒ Part 2 – Completed Transfer Application Map Checklist.
- ☒ Part 3 – Application Fee, payable by check to the Oregon Water Resources Department, and completed Fee Worksheet, page 3. Try the new online fee calculator at:
http://apps.wrd.state.or.us/apps/misc/wrd_fee_calculator.

- ☒ Part 4 – Completed Applicant Information and Signature.

- ☒ Part 5 – Information about Water Rights to be Transferred: **How many water rights are to be transferred? 1 List them here: Certificate: 42225**

Please include a separate Part 5 for each water right. (See instructions on page 6)

NOTE: A separate transfer application is required for each water right unless the criteria in OAR 690-380-3220 are met.

Attachments:

- ☒ Completed Transfer Application Map.
- ☒ Completed Evidence of Use Affidavit and supporting documentation.
- ☐ ☒ N/A Affidavit(s) of Consent from Landowner(s) (if the applicant does not own the land the water right is on.)
- ☐ ☒ N/A Supplemental Form D – For water rights served by or issued in the name of an irrigation district. Complete when the transfer applicant is not the irrigation district.
- ☒ ☐ N/A Oregon Water Resources Department's Land Use Information Form with approval and signature (or signed land use form receipt stub) from each local land use authority in which water is to be diverted, conveyed, and/or used. Not required if water is to be diverted, conveyed, and/or used only on federal lands or if all of the following apply: a) a change in place of use only, b) no structural changes, c) the use of water is for irrigation only, and d) the use is located within an irrigation district or an exclusive farm use zone.
- ☒ ☐ N/A Water Well Report/Well Log for changes in point(s) of appropriation (well(s)) or additional point(s) of appropriation.
- ☐ ☒ N/A Geologist Report for a change from a surface water point of diversion to a ground water point of appropriation (well), if the proposed well is more than 500' from the surface water source and more than 1000' upstream or downstream from the point of diversion. See OAR 690-380-2130 for requirements and applicability.

(For Staff Use Only)

WE ARE RETURNING YOUR APPLICATION FOR THE FOLLOWING REASON(S):

- | | |
|--|--|
| <input type="checkbox"/> Application fee not enclosed/insufficient | <input type="checkbox"/> Map not included or incomplete |
| <input type="checkbox"/> Land Use Form not enclosed or incomplete | <input type="checkbox"/> Evidence of Use Form not enclosed or incomplete |
| <input type="checkbox"/> Additional signature(s) required | <input type="checkbox"/> Part _____ is incomplete |

Other/Explanation _____

Staff: _____ 503- _____ Date: ____/____/____

Part 2 of 5 – Transfer Application Map

Your transfer application will be returned if any of the map requirements listed below are not met.

Please be sure that the transfer application map you submit includes all the required items and matches the existing water right map. Check all boxes that apply.

- ☒ ☐ N/A Certified Water Right Examiner (CWRE) Stamp and Original Signature. For a list of CWREs, see http://apps.wrd.state.or.us/apps/wr/cwre_license_view/. CWRE stamp and signature are not required for substitutions.
- ☐ ☒ N/A If **more than three** water rights are involved, separate maps are needed for each water right.
- ☒ Permanent quality printed with dark ink on good quality paper.
- ☒ The size of the map can be 8½ x 11 inches, 8½ x 14 inches, 11 x 17 inches, or up to 30 x 30 inches. For 30 x 30 inch maps, one extra copy is required.
- ☒ A north arrow, a legend, and scale.
- ☒ The scale of the map must be: 1 inch = 400 feet, 1 inch = 1,320 feet, the scale of the Final Proof/Claim of Beneficial Use Map (the map used when the permit was certificated), the scale of the county assessor map if the scale is not smaller than 1 inch = 1,320 feet, or a scale that has been pre-approved by the Department.
- ☒ Township, Range, Section, ¼ ¼, DLC, Government Lot, and other recognized public land survey lines.
- ☒ Tax lot boundaries (property lines) are required. Tax lot numbers are recommended.
- ☒ Major physical features including rivers and creeks showing direction of flow, lakes and reservoirs, roads, and railroads.
- ☒ Major water delivery system features from the point(s) of diversion/appropriation such as main pipelines, canals, and ditches.
- ☒ Existing place of use that includes separate hachuring for each water right, priority date, and use including number of acres in each quarter-quarter section, government lot, or in each quarter-quarter section as projected within government lots, donation land claims, or other recognized public land survey subdivisions. If less than the entirety of the water right is being changed, a separate hachuring is needed for lands left unchanged.
- ☐ ☒ N/A Proposed place of use that includes separate hachuring for each water right, priority date, and use including number of acres in each quarter-quarter section, government lot, or in each quarter-quarter section as projected within government lots, donation land claims, or other recognized public land survey subdivisions.
- ☒ Existing point(s) of diversion or well(s) with distance and bearing or coordinates from a recognized survey corner. This information can be found in your water right certificate or permit.
- ☒ ☐ N/A If you are proposing a change in point(s) of diversion or well(s), show the proposed location and label it clearly with distance and bearing or coordinates. If GPS coordinates are used, latitude-longitude coordinates may be expressed as either degrees-minutes-seconds with at least one digit after the decimal (example – 42°32'15.5") or degrees-decimal with five or more digits after the decimal (example – 42.53764°).

Part 3 of 5 – Fee Worksheet

FEE WORKSHEET for PERMANENT TRANSFER (except Substitution)

1	Base Fee (includes one type of change to one water right for up to 1 cfs)	1	\$1,360
	Types of change proposed: <input type="checkbox"/> Place of Use <input type="checkbox"/> Character of Use <input checked="" type="checkbox"/> Point of Diversion/Appropriation Number of above boxes checked = <u>1 (2a)</u> Subtract 1 from the number in line 2a = <u>0 (2b)</u> <i>If only one change, this will be 0</i>		
2	Multiply line 2b by \$1090 and enter »	2	\$0
	Number of water rights included in transfer <u>1 (3a)</u> Subtract 1 from the number in 3a above: <u>0 (3b)</u> <i>If only one water right this will be 0</i>		
3	Multiply line 3b by \$610 and enter »	3	\$0
	Do you propose to add or change a well, or change from a surface water POD to a well? <input type="checkbox"/> No: enter 0 <input checked="" type="checkbox"/> Yes: enter \$480 for the 1 st well to be added or changed <u>\$480 (4a)</u> Do you propose to add or change additional wells? <input type="checkbox"/> No: enter 0 <input checked="" type="checkbox"/> Yes: multiply the number of additional wells by \$410 <u>\$820 (4b)</u>		
4	Add line 4a to line 4b and enter » » » » » » » » » » » » » » » » » »	4	\$1,300
	Do you propose to change the place of use or character of use? <input checked="" type="checkbox"/> No: enter 0 on line 5 <input type="checkbox"/> Yes: enter the cfs for the portions of the rights to be transferred (see below*): _____ (5a) Subtract 1.0 from the number in 5a above: _____ (5b) If 5b is 0 or less, enter 0 on line 5 » If 5b is greater than 0, round up to the nearest whole number: _____ (5c) and multiply		
5	5c by \$410, then enter on line 5 »	5	\$0
6	Add entries on lines 1 through 5 above » » » » » » » » » » Subtotal:	6	\$2,660
	Is this transfer: <input type="checkbox"/> necessary to complete a project funded by the Oregon Watershed Enhancement Board (OWEB) under ORS 541.932? <input type="checkbox"/> endorsed in writing by ODFW as a change that will result in a net benefit to fish and wildlife habitat? If one or more boxes is checked, multiply line 6 by 0.5 and enter on line 7 »		
7	If no box is applicable, enter 0 on line 7 »	7	\$0
8	Subtract line 7 from line 6 » » » » » » » » » » » » » » » » » » Transfer Fee:	8	\$2,660

*Example for Line 5a calculation to transfer 45.0 acres of Primary Certificate 12345 (total 1.25 cfs for 100 acres) and 45.0 acres of Supplemental Certificate 87654 (1/80 cfs per acre) on the same land:

1. For irrigation calculate cfs for each water right involved as follows:
 - a. Divide total authorized cfs by total acres in the water right (*for C12345, 1.25 cfs ÷ 100 ac*); then multiply by the number of acres to be transferred to get the transfer cfs (*x 45 ac = 0.56 cfs*).
 - b. If the water right certificate does not list total cfs, but identifies the allowable use as 1/40 or 1/80 of a cfs per acre; multiply number of acres proposed for change by either 0.025 (1/40) or 0.0125 (1/80). (*For C87654, 45.0 ac x 0.0125 cfs/ac = 0.56 cfs*)
2. Add cfs for the portions of water rights on all the land included in the transfer; however **do not count cfs for supplemental rights on acreage for which you have already calculated the cfs fee for the primary right on the same land**. The fee should be assessed only once for each "on the ground" acre included in the transfer. (*In this example, blank 5a would be only 0.56 cfs, since both rights serve the same 45.0 acres. Blank 5b would be 0 and Line 5 would then also become 0*).

FEE WORKSHEET for SUBSTITUTION

1	Base Fee (includes change to one well)	1	\$990.00
	Number of wells included in substitution _____ (2a) Subtract 1 from the number in 2a above: _____ (2b) <i>If only one well this will be 0</i>		
2	Multiply line 2b by \$480 and enter » » » » » » » » » » » » » » »	2	NA
3	Add entries on lines 1 through 2 above » » » » » » Fee for Substitution:	3	\$0

Received

Revised 7/7/2022

Permanent Transfer Application Form – Page 3 of 9

DEC 18 2024 TACS

14580 -

OWRD

Part 4 of 5 – Applicant Information and Signature

Applicant Information

OWRD

APPLICANT/BUSINESS NAME Jensen Family LLC c/o Mark Tribbett		PHONE NO. (503) 991-6821	ADDITIONAL CONTACT NO.
ADDRESS 5289 Blue Grass Ln		FAX NO.	
CITY Silverton	STATE OR	ZIP 97381	E-MAIL Mark@jbinstantlawn.net
BY PROVIDING AN E-MAIL ADDRESS, CONSENT IS GIVEN TO RECEIVE ALL CORRESPONDENCE FROM THE DEPARTMENT ELECTRONICALLY. COPIES OF THE FINAL ORDER DOCUMENTS WILL ALSO BE MAILED.			

Agent Information – The agent is authorized to represent the applicant in all matters relating to this application.

AGENT/BUSINESS NAME Doann Hamilton / Pacific Hydro-Geology, Inc.		PHONE NO. (503) 632-5016	ADDITIONAL CONTACT NO. (503) 349-6946 (cell)
ADDRESS 18487 S. Valley Vista Road		FAX NO. (503) 632-5983	
CITY Mulino	STATE OR	ZIP 97042	E-MAIL phgdmh@gmail.com
BY PROVIDING AN E-MAIL ADDRESS, CONSENT IS GIVEN TO RECEIVE ALL CORRESPONDENCE FROM THE DEPARTMENT ELECTRONICALLY. COPIES OF THE FINAL ORDER DOCUMENTS WILL ALSO BE MAILED.			

Explain in your own words what you propose to accomplish with this transfer application, and why:
The existing well MARI 6493 does not provide the production needed to supply the use under this water right so we are proposing three additional new wells to help provide our full allowed rate.

If you need additional space, continue on a separate piece of paper and attach to the application as "Attachment 1".

Check One Box

- ☒ By signing this application, I understand that, upon receipt of the draft preliminary determination and prior to Department approval of the transfer, I will be required to provide landownership information and evidence that I am authorized to pursue the transfer as identified in OAR 690-380-4010(5); OR
- ☐ I affirm the applicant is a municipality as defined in ORS 540.510(3)(b) and that the right is in the name of the municipality or a predecessor; OR
- ☐ I affirm the applicant is an entity with the authority to condemn property and is acquiring by condemnation the property to which the water right proposed for transfer is appurtenant and have supporting documentation.

By my signature below, I confirm that I understand:

- Prior to Department approval of the transfer application, I may be required to submit payment to the Department for publication of a notice in a newspaper with general circulation in the area where the water right is located, once per week for two consecutive weeks. If more than one qualifying newspaper is available, I suggest publishing the notice in the following newspaper: Woodburn Independent.
- Amendments to the application may only be made in response to the Department's Draft Preliminary Determination (DPD). The applicant will have a period of at least 30 days to amend the application to address any issues identified by the Department in the DPD, or to withdraw the application. Note that amendments may be subject to additional fees, pursuant to ORS 536.050.
- Failure to complete an approved change in place of use and/or change in character of use, will result in loss of the water right (OAR 690-380-6010).
- Refunds may only be granted upon request and, as set forth in ORS 536.050(4)(a), if the Director determines that a refund of all or part of a fee is appropriate in the interests of fairness to the public or necessary to correct an error of the Department.

I (we) affirm that the information contained in this application is true and accurate.

Jensen Family LLC
Mark H. Tribbett manager
Applicant Signature

MARK H. Tribbett mgr.
Print Name (and Title if applicable)

12-2-2024
Date

Applicant Signature

Print Name (and Title if applicable)

Date

Is the applicant the sole owner of the land on which the water right, or portion thereof, proposed for transfer is located? ☒ Yes ☐ No*

**If NO, include signatures of all deeded landowners (and mailing and/or e-mail addresses if different than the applicant's) or attach affidavits of consent (and mailing and/or e-mail addresses) from all landowners or individuals/entities to which the water right(s) were conveyed.*

Check the following boxes that apply:

- ☒ The applicant is responsible for completion of change(s). Notices and correspondence should continue to be sent to the applicant.
- ☐ The receiving landowner will be responsible for completing the proposed change(s) after the final order is issued. Copies of notices and correspondence should be sent to this landowner.
- ☐ Both the receiving landowner and applicant will be responsible for completion of change(s). Copies of notices and correspondence should be sent to this landowner and the applicant.

At this time, are the lands in this transfer application in the process of being sold? ☐ Yes ☒ No

If YES, and you know who the new landowner will be, please complete the receiving landowner information table below. If you do not know who the new landowner will be, then a request for assignment will have to be filed for at a later date.

If a property sells, the certificated water right(s) located on the land belong to the new owner, unless a sale agreement or other document states otherwise. For more information see:
https://www.oregon.gov/owrd/WRDFormsPDF/Transfer_Property_Transactions.pdf

RECEIVING LANDOWNER NAME NA			PHONE NO.	ADDITIONAL CONTACT NO.
ADDRESS				FAX NO.
CITY	STATE	ZIP	E-MAIL	
Describe any special ownership circumstances:				
The confirming Certificate shall be issued in the name of: <input type="checkbox"/> Applicant <input type="checkbox"/> Receiving Landowner				

☐ Check here if any of the water rights proposed for transfer are or will be located within or served by an irrigation or other water district. (Tip: **Complete and attach Supplemental Form D.**)

IRRIGATION DISTRICT NAME NA	ADDRESS	
CITY	STATE	ZIP

☐ Check here if water for any of the rights supplied under a water service agreement or other contract for stored water with a federal agency or other entity.

ENTITY NAME NA	ADDRESS	
CITY	STATE	ZIP

To meet State Land Use Consistency Requirements, you must list all county, city, municipal corporation, or tribal governments within whose jurisdiction water will be diverted, conveyed or used.

ENTITY NAME Marion County Planning Division	ADDRESS 5155 Silverton Road NE	
CITY Salem	STATE Oregon	ZIP 97305

Part 5 of 5 – Water Right Information

Please use a separate Part 5 for each water right being changed. See instructions on page 6, to copy and paste additional Part 5s, or to add additional rows to tables within the form.

CERTIFICATE # **42225**

Received

DEC 18 2024

OWRD

Description of Water Delivery System

System capacity: **0.53 cfs** cubic feet per second (cfs) OR

_____ gallons per minute (gpm)

Describe the current water delivery system or the system that was in place at some time within the last five years. Include information on the pumps, canals, pipelines, and sprinklers used to divert, convey, and apply the water at the authorized place of use.

Water is pumped from a 40 Hp line-shaft turbine pump through buried 6-inch mainline to supply portable hand lines with impact sprinklers or a wheel line.

Table 1. Location of Authorized and Proposed Point(s) of Diversion (POD) or Appropriation (POA)

(Note: If the POD/POA name is not specified on the certificate, assign it a name or number here.)

POD/POA Name or Number	Is this POD/POA Authorized on the Certificate or is it Proposed?	If POA, OWRD Well Log ID# (or Well ID Tag # L-___)	Twp		Rng		Sec	¼ ¼		Tax Lot, DLC or Gov't Lot	Measured Distances (from a recognized survey corner)
Certificate 42225 Well	<input checked="" type="checkbox"/> Authorized <input type="checkbox"/> Proposed	MARI 6493	7	S	2	W	2	SW	NE	DLC 58	1,110 feet north and 1,350 feet east from the NW corner, DLC 57.
Well 2	<input type="checkbox"/> Authorized <input checked="" type="checkbox"/> Proposed	NA	6	S	2	W	35	SE	SE	DLC 41	100 feet north and 865 feet west from the SE corner, Section 35.
Well 3	<input type="checkbox"/> Authorized <input checked="" type="checkbox"/> Proposed	NA	6	S	2	W	35	SE	SE	DLC 41	15 feet north and 185 feet west from the SE corner, Section 35.
GR-859 Well	<input type="checkbox"/> Authorized <input checked="" type="checkbox"/> Proposed	MARI 4749	6	S	2	W	35	SW	SE	DLC 41	West 17 degrees north and 2,640 feet from the SE corner, Section 35

Check all type(s) of change(s) proposed below (change "CODES" are provided in parentheses):

- | | |
|--|--|
| <input type="checkbox"/> Place of Use (POU) | <input type="checkbox"/> Supplemental Use to Primary Use (S to P) |
| <input type="checkbox"/> Character of Use (USE) | <input type="checkbox"/> Point of Appropriation/Well (POA) |
| <input type="checkbox"/> Point of Diversion (POD) | <input checked="" type="checkbox"/> Additional Point of Appropriation (APOA) |
| <input type="checkbox"/> Additional Point of Diversion (APOD) | <input type="checkbox"/> Substitution (SUB) |
| <input type="checkbox"/> Surface Water POD to Ground Water POA (SW/GW) | <input type="checkbox"/> Government Action POD (GOV) |

Will all of the proposed changes affect the entire water right?

- ☒ Yes Complete only the Proposed ("to" or "on" lands) section of Table 2 on the next page. Use the "CODES" listed above to describe the proposed changes.

☐ No Complete all of Table 2 to describe the portion of the water right to be changed.

Received
DEC 18 2024
OWRD

Please use and attach additional pages of Table 2 as needed.
See page 6 for instructions.

Do you have questions about how to fill-out the tables?
Contact the Department at 503-986-0900 and ask for Transfer Staff.

Table 2. Description of Changes to Water Right Certificate # 42225

List the change proposed for the acreage in each ¼ ¼. If more than one change is proposed, specify the acreage associated with each change.
If there is more than one POD/POA involved in the proposed changes, specify the acreage associated with each POD/POA.

AUTHORIZED (the “from” or “off” lands) The listing that appears on the certificate BEFORE PROPOSED CHANGES List only that part or portion of the water right that will be changed.										Proposed Changes (see “CODES” from previous page)	PROPOSED (the “to” or “on” lands) The listing as it would appear AFTER PROPOSED CHANGES are made.													
Twp	Rng	Sec	¼ ¼	Tax Lot	Gvt Lot or DLC	Acres	Type of USE listed on Certificate	POD(s) or POA(s) (name or number from Table 1)	Priority Date		Twp	Rng	Sec	¼ ¼	Tax Lot	Gvt Lot or DLC	Acres	New Type of USE	POD(s)/ POA(s) to be used (from Table 1)	Priority Date				
										APOA	7	S	2	W	2	NE	NE	300	DLC 58	1.2	IR	Certificate 42225 well, Wells 2&3 and GR-859 Well		4-9-1969
										APOA	7	S	2	W	2	NW	NE	300	DLC 58	17.5	IR	Certificate 42225 well, Wells 2&3 and GR-859 Well		4-9-1969
										APOA	7	S	2	W	2	SW	NE	300	DLC 58	22.1	IR	Certificate 42225 well, Wells 2&3 and GR-859 Well		4-9-1969
										APOA	7	S	2	W	2	SE	NE	300	DLC 58	1.8	IR	Certificate 42225 well, Wells 2&3 and GR-859 Well		4-9-1969
TOTAL ACRES:											TOTAL ACRES:						42.6							

Additional remarks: The well specifications given below for the additional wells are estimates only. The actual well construction will be based on conditions encountered in the field. The objective will be to construct a well which develops water from the alluvial aquifer.

For Place of Use or Character of Use Changes - NA

Are there other water right certificates, water use permits or ground water registrations associated with the "from" or the "to" lands? ☐ Yes ☐ No

If YES, list the certificate, water use permit, or ground water registration numbers: NA.

Pursuant to ORS 540.510, any "layered" water use such as an irrigation right that is supplemental to a primary right proposed for transfer must be included in the transfer or be cancelled. Any change to a ground water registration must be filed separately in a ground water registration modification application.

For Substitution (ground water supplemental irrigation will be substituted for surface water primary irrigation)

Ground water supplemental Permit or Certificate # NA;

Surface water primary Certificate # NA.

Received

DEC 18 2024

For a change from Supplemental Irrigation Use to Primary Irrigation Use

Identify the primary certificate to be cancelled. Certificate # NA

OWRD

For a change in point(s) of appropriation (well(s)) or additional point(s) of appropriation:

- ☒ Well log(s) are attached for each authorized and proposed well(s) that are clearly labeled and associated with the corresponding well(s) in Table 1 above and on the accompanying application map.

Tip: You may search for well logs on the Department's web page at:

http://apps.wrd.state.or.us/apps/gw/well_log/Default.aspx

AND/OR

- ☒ Describe the construction of the authorized and proposed well(s) in Table 3 for any wells that do not have a well log. For *proposed wells not yet constructed or built*, provide "a best estimate" for each requested information element in the table. The Department recommends you consult a licensed well driller, geologist, or certified water right examiner to assist with assembling the information necessary to complete Table 3.

Table 3. Construction of Point(s) of Appropriation

Any well(s) in this listing must be clearly tied to corresponding well(s) described in Table 1 and shown on the accompanying application map. Failure to provide the information will delay the processing of your transfer application until it is received. The information is necessary for the department to assess whether the proposed well(s) will access the same source aquifer as the authorized point(s) of appropriation (POA). The Department is prohibited by law from approving POA changes that do not access the same source aquifer.

Proposed or Authorized POA Name or Number	Is well already built? (Yes or No)	If an existing well: OWRD Well ID Tag No. L-___	Total well depth	Casing Diameter	Casing Intervals (feet)	Seal depth(s) (intervals)	Perforated or screened Intervals (in feet)	Static water level of completed well (in feet)	Source aquifer (sand, gravel, basalt, etc.)	Well-specific rate (cfs or gpm). If less than full rate of water right
Certificate 42225 Well	Yes	MARI 6493	See Well Log MARI 6493							Not less than full rate together with Certificate well
Well 2	No	NA	200	10 inch	0 to 200	0 to 30	TBD	NA	Alluvium	
Well 3	No	NA	200	10 inch	0 to 200	0 to 30	TBD	NA	Alluvium	
GR-859 Well	Yes	MARI 4749	See Well Log MARI 4749							

Application for Water Right Transfer Evidence of Use Affidavit



Oregon Water Resources Department
725 Summer Street NE, Suite A
Salem, Oregon 97301-1266
(503) 986-0900
www.wrd.state.or.us

Please print legibly or type. Be as specific as possible. Attach additional pages if you need more spacing.
Supporting documentation must be attached.

State of Oregon)
) ss
County of MARION)

I, MARK TRIBBETT, in my capacity as OPERATOR,
mailing address 5289 BLUE GRASS LN, SILVERTON, OR 97381
telephone number (503) 991-6821, being first duly sworn depose and say:

Received
DEC 18 2024
OWRD

1. My knowledge of the exercise or status of the water right is based on (check one):

☒ Personal observation ☐ Professional expertise

2. I attest that:

☒ Water was used during the previous five years on the **entire** place of use for
Certificate # 42225; **OR**

☐ My knowledge is specific to the use of water at the following locations within the last five years:

Certificate #	Township		Range		Mer	Sec	¼ ¼	Gov't Lot or DLC	Acres (if applicable)

OR

- ☐ Confirming Certificate # _____ has been issued within the past five years; **OR**
- ☐ Part or all of the water right was leased instream at some time within the last five years. The instream lease number is: _____ (Note: If the entire right proposed for transfer was not leased, additional evidence of use is needed for the portion not leased instream.); **OR**
- ☐ The water right is not subject to forfeiture and documentation that a presumption of forfeiture for non-use would be rebutted under ORS 540.610(2) is attached.
- ☐ Water has been used at the actual current point of diversion or appropriation for more than 10 years for Certificate # _____ (For Historic POD/POA Transfers)

(continues on reverse side)

3. The water right was used for: (e.g., crops, pasture, etc.): TURF GRASS SEED ^{OK MIT}

4. I understand that if I do not attach one or more of the documents shown in the table below to support the above statements, my application will be considered incomplete.

Jensen Family LLC

Mark H. Tidwell manager

Signature of Affiant

12-02-2024

Date

Signed and sworn to (or affirmed) before me this 2nd day of December, 2024.

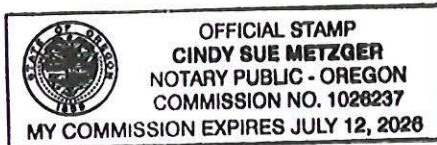

Cindy Metzger

Notary Public for Oregon

My Commission Expires: July 12, 2026

Supporting Documents	Examples
<input type="checkbox"/> Copy of a water right certificate that has been issued within the last five years. (not a remaining right certificate)	Copy of confirming water right certificate that shows issue date
<input type="checkbox"/> Copies of receipts from sales of irrigated crops or for expenditures related to use of water	<ul style="list-style-type: none">• Power usage records for pumps associated with irrigation use• Fertilizer or seed bills related to irrigated crops• Farmers Co-op sales receipt
<input type="checkbox"/> Records such as FSA crop reports, irrigation district records, NRCS farm management plan, or records of other water suppliers	<ul style="list-style-type: none">• District assessment records for water delivered• Crop reports submitted under a federal loan agreement• Beneficial use reports from district• IRS Farm Usage Deduction Report• Agricultural Stabilization Plan• CREP Report
<input checked="" type="checkbox"/> Aerial photos containing sufficient detail to establish location and date of photograph	Multiple photos can be submitted to resolve different areas of a water right. If the photograph does not print with a "date stamp" or without the source being identified, the date of the photograph and source should be added. Sources for aerial photos: OSU – www.oregonexplorer.info/imagery OWRD – www.wrd.state.or.us Google Earth – earth.google.com TerraServer – www.terra-server.com
<input type="checkbox"/> Approved Lease establishing beneficial use within the last 5 years	Copy of instream lease or lease number

Received

DEC 18 2024

OWRD

TACS

Received
DEC 18 2024
OWRD



Land Use Information Form



Oregon Water Resources Department
725 Summer Street NE, Suite A
Salem, Oregon 97301-1266
(503) 986-0900
www.oregon.gov/OWRD

NAME Mark Tribbett			PHONE 503-991-6821	
MAILING ADDRESS 5289 Blue Grass Ln				
CITY Silverton	STATE OR	ZIP 97381	EMAIL Mark@jbinstantlawn.net	

A. Land and Location

Please include the following information for all tax lots where water will be diverted (taken from its source), conveyed (transported), and/or used or developed. Applicants for municipal use, or irrigation uses within irrigation districts, may substitute existing and proposed service-area boundaries for the tax-lot information requested below.

Township	Range	Section	¼ ¼	Tax Lot #	Plan Designation (e.g., Rural Residential/RR-5)	Water to be:			Proposed Land Use:
6S	2W	35		1100	EFU	<input checked="" type="checkbox"/> Diverted	<input checked="" type="checkbox"/> Conveyed	<input type="checkbox"/> Used	IR
6S	2W	35		1200	EFU	<input checked="" type="checkbox"/> Diverted	<input checked="" type="checkbox"/> Conveyed	<input type="checkbox"/> Used	IR
7S	2W	2		300	EFU	<input checked="" type="checkbox"/> Diverted	<input checked="" type="checkbox"/> Conveyed	<input checked="" type="checkbox"/> Used	IR
						<input type="checkbox"/> Diverted	<input type="checkbox"/> Conveyed	<input type="checkbox"/> Used	

List all counties and cities where water is proposed to be diverted, conveyed, and/or used or developed:

Marion County

NOTE: A separate Land Use Information Form must be completed and submitted for each county and city, as applicable.

B. Description of Proposed Use

Type of application to be filed with the Oregon Water Resources Department:

- ☐ Permit to Use or Store Water
 ☒ Water Right Transfer
 ☐ Permit Amendment or Ground Water Registration Modification
☐ Limited Water Use License
 ☐ Exchange of Water
 ☐ Allocation of Conserved Water

Source of water: ☐ Reservoir/Pond ☒ Ground Water ☐ Surface Water (name) _____

Estimated quantity of water needed: 0.53 ☒ cubic feet per second ☐ gallons per minute ☐ acre-feet

Intended use of water: ☒ Irrigation ☐ Commercial ☐ Industrial ☐ Domestic for _____ household(s)
 ☐ Municipal ☐ Quasi-Municipal ☐ Instream ☐ Other _____

Briefly describe:

This Land Use Information Form is to accompany a water right transfer application that proposes to add three additional points of appropriation (wells) to an existing water right (Certificate 42225).

Note to applicant: For new water right applications only, if the Land Use Information Form cannot be completed while you wait, please have a local government representative sign the receipt on the bottom of page 4 and include it with the application filed with the Oregon Water Resources Department.

See Page 4 ➔

For Local Government Use Only

The following section must be completed by a planning official from each county and city listed unless the project will be located entirely within the city limits. In that case, only the city planning agency must complete this form. This deals only with the local land use plan. Do not include approval for activities such as building or grading permits.

Please check the appropriate box below and provide the requested information

- ☒ Land uses to be served by the proposed water use(s), including proposed construction, are allowed outright or are not regulated by your comprehensive plan. Cite applicable ordinance section(s): MCC 17.136.020.A
- ☐ Land uses to be served by the proposed water use(s), including proposed construction, involve discretionary land-use approvals as listed in the table below. (Please attach documentation of applicable land-use approvals which have already been obtained. Record of Action/land-use decision and accompanying findings are sufficient.) If approvals have been obtained but all appeal periods have not ended, check "Being Pursued."

Type of Land-Use Approval Needed (e.g., plan amendments, rezones, conditional-use permits, etc.)	Cite Most Significant, Applicable Plan Policies & Ordinance Section References	Land-Use Approval:	
		<input type="checkbox"/> Obtained <input type="checkbox"/> Denied	<input type="checkbox"/> Being Pursued <input type="checkbox"/> Not Being Pursued
		<input type="checkbox"/> Obtained <input type="checkbox"/> Denied	<input type="checkbox"/> Being Pursued <input type="checkbox"/> Not Being Pursued
		<input type="checkbox"/> Obtained <input type="checkbox"/> Denied	<input type="checkbox"/> Being Pursued <input type="checkbox"/> Not Being Pursued
		<input type="checkbox"/> Obtained <input type="checkbox"/> Denied	<input type="checkbox"/> Being Pursued <input type="checkbox"/> Not Being Pursued

Local governments are invited to express special land use concerns or make recommendations to the Oregon Water Resources Department regarding this proposed use of water in the box below or on a separate sheet.

Name: Alexander Seifer Title: Assistant Planner

Signature: *Alexander Seifer* Date: 12/11/2024

Governmental Entity: Marion County Phone: 503-588-5038

Receipt Acknowledging Request for Land Use Information

Note to Local Government Representative:

Please complete this form and return it to the applicant. For new water right applications only, if you are unable to complete this form while the applicant waits, you may complete this receipt and return it to the applicant. If you sign the receipt, you will have 30 days from the date of OWRD's Public Notice of the application to submit the completed Land Use Information Form to Oregon Water Resources Department. Please note while OWRD can accept a signed receipt as part of intake for an application for a new permit to use or store water, a completed Land Use Information Form is required for all other applications.

Applicant Name: _____

Staff Name: _____ Title: _____

Staff Signature: _____ Date: _____

Governmental Entity: _____ Phone: _____

NOTICE TO WATER WELL CONTRACTOR

The original and first copy
of this report are to be
filed with the

RECEIVED

APR 4 1969

WATER WELL REPORT

6493
MAR 11 1969

STATE ENGINEER, SALEM, OREGON 97301
within 30 days from the date
of well completion.

STATE OF OREGON
(Please type or print)
Do not write above this line

State Well No. 7/2W-2 ac

State Permit No. G-4838

(1) OWNER:

Name Don KuenziAddress 8153, Silverton, Rd, Silverton
Salem

(2) TYPE OF WORK (check):

New Well ☒ Deepening ☐ Reconditioning ☐ Abandon ☐

If abandonment, describe material and procedure in Item 12.

(3) TYPE OF WELL:

Rotary ☐ Driven ☐
Cable ☒ Jetted ☐
Dug ☐ Bored ☐

(4) PROPOSED USE (check):

Domestic ☐ Industrial ☐ Municipal ☐
Irrigation ☒ Test Well ☐ Other ☐

CASING INSTALLED:

Threaded ☐ Welded ☒

10" Diam. from 0 ft. to 186 ft. Gage 250

" Diam. from ft. to ft. Gage

" Diam. from ft. to ft. Gage

PERFORATIONS:

Perforated? ☒ Yes ☐ No.Type of perforator used MillsSize of perforations 3/8 in. by 3 in.

705 perforations from 105 ft. to 152 ft.

60 perforations from 163 ft. to 167 ft.

105 perforations from 175 ft. to 182 ft.

perforations from ft. to ft.

perforations from ft. to ft.

(7) SCREENS:

Well screen installed? ☐ Yes ☒ No

Manufacturer's Name

Type Model No.

Diam. Slot size Set from ft. to ft.

Diam. Slot size Set from ft. to ft.

(8) WATER LEVEL: Completed well.

Static level 39 ft. below land surface Date 3-25-69

Artesian pressure lbs. per square inch Date

(9) WELL TESTS:

Drawdown is amount water level is
lowered below static levelWas a pump test made? ☒ Yes ☐ No If yes, by whom? DrillerYield: 550 gal./min. with 76 ft. drawdown after 1 hrs.

" " " "

" " " "

Bailer test gal./min. with ft. drawdown after hrs.

Artesian flow g.p.m. Date

Temperature of water Was a chemical analysis made? ☐ Yes ☒ No

(10) CONSTRUCTION:

Well seal—Material used BentoniteDepth of seal 18 ft.Diameter of well bore to bottom of seal 14 in.Were any loose strata cemented off? ☐ Yes ☒ No DepthWas a drive shoe used? ☒ Yes ☐ NoDid any strata contain unusable water? ☐ Yes ☒ No

Type of water? depth of strata

Method of sealing strata off

Was well gravel packed? ☐ Yes ☒ No Size of gravel:

Gravel placed from ft. to ft.

(11) LOCATION OF WELL:

County Marion Driller's well number

1/4 1/4 Section T. R. W.M.

Bearing and distance from section or subdivision corner

2000 ft S. 1700 ft W. of N.E.

cor of sec 2, T.7S, R.2W.

(12) WELL LOG:

Diameter of well below casing 0

Depth drilled 185 ft. Depth of completed well 185 ft.

Formation: Describe color, texture, grain size and structure of materials;
and show thickness and nature of each stratum and aquifer penetrated,
with at least one entry for each change of formation. Report each change
in position of Static Water Level as drilling proceeds. Note drilling rates.

MATERIAL	From	To	SWL
Top soil brn.	0	2	
Clay brn.	2	28	
Clay grey.	28	48	
Clay brn.	48	71	
Sand brn med.	71	74	
Sandy clay brn.	74	88	
Conglom brn med dirty.	88	105	
Conglom grey med. w.b.	105	154	
Sandy clay brn.	154	160	
Conglom brn med. w.b.	160	169	
Sand brn med packed.	169	170	
Conglom grey med. w.b.	170	183	
Sandy clay grey.	183	185	

Received

DEC 18 2024

OWRD

Work started 3-10-69 19 Completed 3-25-69 19Date well drilling machine moved off of well 3-25-69 19

Drilling Machine Operator's Certification:

This well was constructed under my direct supervision. Materials
used and information reported above are true to my best
knowledge and belief.

[Signed] Paul R. Stadel Date 4-3-69, 19.....
(Drilling Machine Operator)

Drilling Machine Operator's License No. 322

Water Well Contractor's Certification:

This well was drilled under my jurisdiction and this report is
true to the best of my knowledge and belief.

NAME R. Stadel & Sons

(Person, firm or corporation) (Type or print)

Address Route 8, Box 169, Silverton, Ore

[Signed] Paul R. Stadel
(Water Well Contractor)

Contractor's License No. 296 Date 4-3-69, 19.....

(USE ADDITIONAL SHEETS IF NECESSARY)

14580 -

STATE ENGINEER
Salem, Oregon

Well Record

STATE WELL NO. 6/2W-35 Q
COUNTY Marion
APPLICATION NO. GR-859

OWNER: Donald D. Kuenzi

MAILING

ADDRESS: Route 2, Box 537

LOCATION OF WELL: Owner's No.

CITY AND

STATE: Salem

SW $\frac{1}{4}$ SE $\frac{1}{4}$ Sec. 35 T. 6 S., R. 2 W., W.M.

Bearing and distance from section or subdivision

corner 2640' W & 17' N Sec. 35

Altitude at well 195'

TYPE OF WELL: Drilled Date Constructed June, 1954

Depth drilled 147 Depth cased 147

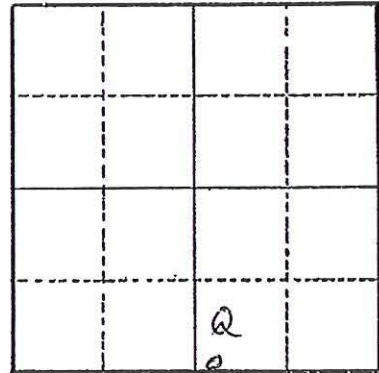

Section 35

CASING RECORD:

10-----inch 0 to 147 feet

FINISH:

10-inch perforations per foot - $\frac{1}{4}$ " x 3"

AQUIFERS:

WATER LEVEL:

25

PUMPING EQUIPMENT: Type Jacuzzi Turbine H.P. 40 Elec.
Capacity 600 G.P.M.

WELL TESTS:

Drawdown 65' ft. after hours 600 G.P.M.

Drawdown ft. after hours G.P.M.

USE OF WATER Irrigation Temp. °F. 19

SOURCE OF INFORMATION Registration Statement GR-832

DRILLER or DIGGER Rudolph Stadeli- Route 2, Silverton, Oregon

ADDITIONAL DATA:

Log X Water Level Measurements Chemical Analysis Aquifer Test

REMARKS:

Received

DEC 18 2024

OWRD

State Well No. 6/2W-35 Q
County Marion
Application No. GR-859

Owner: Donald D. Kuenzi Owner's No.
Driller: Rudolph Stadeli Date Drilled June , 1954

[illegible]

14580 -

Permanent Transfer Application Checklist

Check the Certificates in WRIS

Transfer # 14580

Checked by <u>__Dante__</u> Date <u>12/19/2024</u>	Type of Change(s) Proposed: <u>NO</u> other changes allowed other than those listed	
Fee Received: \$2660	<input type="checkbox"/> POU <input type="checkbox"/> POD <input type="checkbox"/> APOD <input type="checkbox"/> POA <input checked="" type="checkbox"/> APOA <input type="checkbox"/> USE	
Calculated Fee: \$2660		How many rights to be Transferred? 1
Deficiencies and Observations:		Certificate #(s) 42225

If OK, check box; if not, fill in.

- ☒ 1. Is the applicant information complete? Have all the applicants listed at the top of the page signed at the bottom?
If not, what is missing? Whose signature is missing? _____
- ☒ 2. Has the applicant indicated that the place of use is in or near an irrigation district? Have they included a Form D? ☒ N/A.
Name of the District _____
- ☒ 3. Part 5 of application, has the applicant completed the entire page and does the information match the description of the explanation of the reasons on Part 4 of the application?
If not, you may need to contact the applicant or agent? _____
- ☒ 4. For multiple certificates, do each of the certificates listed on Application Page 1 have their own separate completed Part 5 tables 1 & 2? (*compare with OAR 690-380-3220-may need to return*)
If no, which certificates are missing a separate Part 5, tables 1 & 2? _____
- ☒ 5. Has the map been completed and signed by a CWRE? Does the map meet the requirements?
If not, what is missing? _____. Map waiver included? ☐
- ☒ 6. If a change in point of appropriation, have the well logs been included? ☐ N/A.
- ☒ 7. If a change in place of use within Umatilla County, have the applicant(s) provided a Supplemental Form U? ☒ N/A.
- ☒ 8. Has applicant filled out the Minimum Requirements Checklist (Part 1 of 5)? Is the application complete? If not, what is missing (check Evidence of Use and Land Use)? _____

- ☒ 9. If all boxes on this checklist are checked (with no remaining deficiencies identified), accept the application. Put this check sheet in the transfer folder.

OR:

- ☐ This application is deficient, and **CANNOT** be accepted.
It should be returned and the **deficiencies listed in the "staff" section at the bottom of Application Page 1**, unless the applicant or agent can resolve the deficiencies within 2-3 days.

Actions taken:

_____ date _____

Permanent Transfer Application Checklist

FEE WORKSHEET for PERMANENT TRANSFER (except Substitution)			
1	Base Fee (includes one type of change to one water right for up to 1 cfs)	1	\$1,360
	Types of change proposed: <input type="checkbox"/> Place of Use <input type="checkbox"/> Character of Use <input type="checkbox"/> Point of Diversion/Appropriation Number of above boxes checked = _____ (2a) Subtract 1 from the number in line 2a = _____ (2b) <i>If only one change, this will be 0</i>		
2	Multiply line 2b by \$930 and enter » » » » » » » » » » » » » » » »	2	0
	Number of water rights included in transfer _____ (3a) Subtract 1 from the number in 3a above: _____ (3b) <i>If only one water right this will be 0</i>		
3	Multiply line 3b by \$520 and enter » » » » » » » » » » » » » » » »	3	0
	Do you propose to add or change a well, or change from a surface water POD to a well? <input type="checkbox"/> No: enter 0 » <input type="checkbox"/> Yes: enter \$410 »		
4		4	0
	Do you propose to change the place of use or character of use? <input type="checkbox"/> No: enter 0 on line 5 » <input type="checkbox"/> Yes: enter the cfs for the portions of the rights to be transferred (see example below*): _____ (5a) Subtract 1.0 from the number in 5a above: _____ (5b) If 5b is 0 or less, enter 0 on line 5 » If 5b is greater than 0, round up to the nearest whole number: _____ (5c) and multiply 5c by \$350, then enter on line 5 »		
5		5	0
6	Add entries on lines 1 through 5 above » » » » » » » » » » Subtotal:	6	0
	Is this transfer: <input type="checkbox"/> necessary to complete a project funded by the Oregon Watershed Enhancement Board (OWEB) under ORS 541.932? <input type="checkbox"/> endorsed in writing by ODFW as a change that will result in a net benefit to fish and wildlife habitat? If one or more boxes is checked, multiply line 6 by 0.5 and enter on line 7 »		
7	If no box is applicable, enter 0 on line 7 »	7	0
8	Subtract line 7 from line 6 » Transfer Fee:	8	