

Regular

Name Orchard Heights Water Association

## DESCRIPTION OF WATER RIGHT(S)

Address 4350 Orchard Heights NW  
Salem Oregon 97304  
DSPAAD@yahooName of Stream wellTrib. of Winslow GulchUse QuasiCounty Polk

Quantity of water (CFS)

No. of Acres

Name of ditch

App# 6522Per # 64823Cert # 45205PR Date 6/17/2020

App#

Per #

Cert #

PR Date

App#

Per #

Cert #

PR Date

App#

Per #

Cert #

PR Date

App#

Per #

Cert #

PR Date

Change in APDADate Filed 11/01/2022Initial notice date 11/18/2022

DPD issued date

PD issued date 6/9/2025PD notice date 6/10/2025Date of FO 7/29/2025 Vol 135 Page 229-232

C-Date

COBU due date

COBU Received date

Certificate issued

Assignments:

Irrigation District

Agent Ted Ressler - Summit Water Resources

CWRE

CC's list Polk County☐ - Oversized map - Location

## FEES PAID

Date	Amount	Receipt #
<u>11-1-2022</u>	<u>\$1840.00</u>	<u>139457</u>

## FEES REFUNDED

Date	Amount	Receipt #
------	--------	-----------





# Oregon

Tina Kotek, Governor

## Water Resources Department

North Mall Office Building

725 Summer St NE, Suite A

Salem, OR 97301

Phone 503 986-0900

Fax 503 986-0904

July 29, 2025

Orchard Heights Water Association  
4350 Orchard Heights Rd NW  
Salem, OR 97304

REFERENCE: Transfer Application T-14115

Enclosed is a copy of the final order approving your water right transfer application.

The time allowed to complete the transfer is specified in the final order. YOU SHOULD GIVE PARTICULAR ATTENTION TO THE TIME LIMIT. The water right for any portion of the authorized change in character of use or change in place of use NOT carried out within the time allowed will be lost.

An extension of the time limit can be allowed only upon a showing that diligent effort has been made to complete the actual change(s) within the time allowed.

You are required to hire a Certified Water Rights Examiner (CWRE) to complete a Claim of Beneficial Use report and map which must be submitted to this Department within one year of the date you complete the change(s) or within one year of the completion date authorized in the transfer final order, whichever occurs first.

If you have any questions related to the approval of this transfer, you may contact your caseworker, Elyse Richman, by telephone at (971) 701-5485 or by e-mail at [Elyse.d.richman@water.oregon.gov](mailto:Elyse.d.richman@water.oregon.gov).

Sincerely,

David V. Jones Jr  
Water Rights Services Support  
Transfers and Conservation Section

cc: Joel M. Plahn, Watermaster Dist. # 22 (via email)  
Ted Ressler, Agent  
Polk County Planning Department, Local Government

Enclosure

**BEFORE THE WATER RESOURCES DEPARTMENT  
OF THE  
STATE OF OREGON**

In the Matter of Transfer Application	)	FINAL ORDER APPROVING AN
T-14115, Polk County	)	ADDITIONAL POINT OF APPROPRIATION

**Authority**

Oregon Revised Statutes (ORS) 537.705 and 540.505 to 540.580 establish the process in which a water right holder may submit a request to transfer the point of appropriation, place of use, or character of use authorized under an existing water right. Oregon Administrative Rules (OAR) Chapter 690, Division 380 implement the statutes and provides the Department's procedures and criteria for evaluating transfer applications.

**Applicant**

ORCHARD HEIGHTS WATER ASSOCIATION  
4350 ORCHARD HEIGHTS ROAD NW  
SALEM, OR 97304

**Findings of Fact**

1. On November 1, 2022, Orchard Heights Water Association filed an application for an additional point of appropriation under Certificate 45205. The Department assigned the application number T-14115.
2. Notice of the application for transfer was published on November 8, 2022, pursuant to OAR 690-380-4000. No comments were filed in response to the notice.
3. On April 18, 2025, the Department mailed a copy of the draft Preliminary Determination proposing to approve Transfer Application T-14115 to the applicant. The draft Preliminary Determination cover letter set forth a deadline of May 19, 2025, for the applicant to respond. The applicant requested that the Department proceed with issuance of a Preliminary Determination and provided the necessary information to demonstrate that the applicant is authorized to pursue the transfer.

This final order is subject to judicial review by the Court of Appeals under ORS 183.482. Any petition for judicial review must be filed within the 60-day time period specified by ORS 183.482(1). Pursuant to ORS 536.075 and OAR 137-003-0675, you may petition for judicial review or petition the Director for reconsideration of this order. A petition for reconsideration may be granted or denied by the Director, and if no action is taken within 60 days following the date the petition was filed, the petition shall be deemed denied.

4. On June 9, 2025, the Department issued a Preliminary Determination proposing to approve Transfer T-14115 and mailed a copy to the applicant. Additionally, notice of the Preliminary Determination for the transfer application was published on the Department's weekly notice on June 10, 2025, pursuant to ORS 540.520 and OAR 690-380-4020. No protests were filed in response to the notice.

5. The right to be transferred is as follows:

**Certificate:** 45205 in the name of ORCHARD HEIGHTS WATER ASSOCIATION, INC.  
(perfected under Permit G-4823)

**Use:** QUASI-MUNICIPAL

**Priority Date:** JUNE 17, 1970

**Rate:** 0.15 CUBIC FOOT PER SECOND (CFS), BEING 0.075 CFS FROM EACH WELL

**Source:** TWO WELLS a tributary of WINSLOW GULCH

**Authorized Points of Appropriation:**

Twp	Rng	Mer	Sec	Q-Q	Measured Distances
7 S	3 W	WM	18	SW NW	Well No. 1 - SOUTH 5 DEGREES 14 MINUTES EAST 2412 FEET FROM THE NW CORNER OF SECTION 18
7 S	3 W	WM	18	SW NW	Well No. 2 - SOUTH 3 DEGREES 12 MINUTES EAST 2308 FEET FROM THE NW CORNER OF SECTION 18

**Authorized Place of Use:**

QUASI-MUNICIPAL				
Twp	Rng	Mer	Sec	Q-Q
7 S	3 W	WM	17	NW NE
7 S	3 W	WM	17	NE NW
7 S	3 W	WM	17	NW NW
7 S	3 W	WM	17	SW NW
7 S	3 W	WM	17	SE NW
7 S	3 W	WM	17	NE SW
7 S	3 W	WM	17	NW SW
7 S	3 W	WM	17	NE SE
7 S	3 W	WM	18	NW NE
7 S	3 W	WM	18	SW NE
7 S	3 W	WM	18	NE NW
7 S	3 W	WM	18	NW NW
7 S	3 W	WM	18	SW NW
7 S	3 W	WM	18	SE NW
7 S	3 W	WM	18	NE SW

QUASI-MUNICIPAL				
Twp	Rng	Mer	Sec	Q-Q
7 S	3 W	WM	18	NW SW
7 S	3 W	WM	18	SW SW
7 S	3 W	WM	18	NE SE
7 S	3 W	WM	18	NW SE
7 S	4 W	WM	13	NE NE
7 S	4 W	WM	13	NW NE
7 S	4 W	WM	13	NE NW
7 S	4 W	WM	13	NW NW
7 S	4 W	WM	13	NW SW
7 S	4 W	WM	13	SW SW
7 S	4 W	WM	13	SE SW
7 S	4 W	WM	13	SW SE
7 S	4 W	WM	13	SE SE
7 S	4 W	WM	14	NE NE
7 S	4 W	WM	14	NE SE



6. Transfer Application T-14115 proposes an additional point of appropriation as follows:

Twp	Rng	Mer	Sec	Q-Q	Measured Distances	Approximate distance from the authorized point of appropriation (POA) in feet (ft.)
7 S	3 W	WM	18	SW NW	LAFAYETTE WELL - NORTH 62 DEGREES, 54 MINUTES EAST, 780 FEET FROM THE WEST QUARTER CORNER OF SECTION 18	Well No. 1 – 530 ft. NE Well No. 2– 475 ft. NE

***Transfer Review Criteria [OAR 690-380-0100(14), OAR 690-380-4010(2), and OAR 690-380-2110(2)]***

7. Water has been used within the last five years according to the terms and conditions of the right. There is no information in the record that would demonstrate that the right is subject to forfeiture under ORS 540.610.
8. A water delivery system sufficient to use the full amount of water allowed under the existing right was present within the five-year period prior to submittal of Transfer Application T-14115.
9. The water right is subject to transfer as defined in ORS 540.505(4) and OAR 690-380-0100(14).
10. The proposed point of appropriation develops groundwater from the same aquifer as the authorized points of appropriation, as required by OAR 690-380-2110(2).
11. The proposed change would not result in enlargement of the right.
12. The proposed change would not result in injury to other existing water rights.
13. All other application requirements are met.

#### **Conclusions of Law**

The additional point of appropriation proposed in Transfer Application T-14115 is consistent with the requirements of ORS 537.705 and 540.505 to 540.580 and OAR 690-380-5000.

#### **Now, therefore, it is ORDERED:**

1. The additional point of appropriation proposed in Transfer Application T-14115 is approved.
2. The right to the use of the water is restricted to beneficial use at the place of use described and is subject to all other conditions and limitations contained in Certificate 45205 and any related decree.

3. Approval of this transfer application does not constitute nor grant legal access onto or through another person's property for purposes of accessing the new point of appropriation.
4. Water right Certificate 45205 is cancelled.
5. The quantity of water diverted at the new additional point of appropriation (Lafayette Well), together with that diverted at the original points of appropriation (Well No. 1 and Well No. 2) shall not exceed the quantity of water lawfully available at the original points of appropriation (Well No. 1 and Well No. 2).
6. Water shall be acquired from the same aquifer (water source) as the original points of appropriation.
7. Full beneficial use of the water shall be made, consistent with the terms of this order, on or before **October 1, 2030**. A Claim of Beneficial Use prepared by a Certified Water Right Examiner shall be submitted by the applicant to the Department within one year after the deadline for completion of the change and full beneficial use of the water.
8. After satisfactory proof of beneficial use is received, a new certificate confirming the right transferred will be issued.

Dated in Salem, Oregon on **JUL 29 2025**

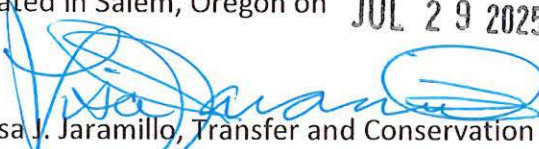
  
Lisa J. Jaramillo, Transfer and Conservation Section Manager, for  
IVAN GALL, DIRECTOR  
Oregon Water Resources Department

Mailing Date: JUL 30 2025

# TRANSFER COVER SHEET

Transfer: T-14115

GR Application #: GR-

File Assigned- Transfer Specialist: Elyse D. Richman

Transfer Type: Regular Transfer

Reimbursement Authority? ☐

<b>Applicant:</b> Orchard Heights Water Ass. 4350 Orchard Heights NW Salem, OR 97304 DSPAAD@yahoo.com	<b>Receiving Landowner:</b>  	<b>CWRE</b> <b>Agent:</b> Ted Ressler 4784 SE 17th Ave, Suite 111 Portland, OR 97202 tressler@summitwr.com
<b>Interested Parties:</b> BOR (date): _____ Tribal Gov't: _____ Gov'ts: Polk County Planning Department County: POLK	<b>Irrigation District:</b>  Check area of interest on map <input type="checkbox"/>	<b>Additional Contact Information:</b> _____

## Key Dates & Initial Actions (Support Staff)

Type of change(s) proposed- attach additional review checklists as necessary			
ADDITIONAL POINT OF APPROPRIATION			
If change is Historic or Substitution, application will go directly to Final Order. Add'l questions on last page for Historic and Gov't Action.			
Fees Pd:	\$1840.00	WM Review request date sent - WM District: 22	11/8/2022
Received Date:	November 1, 2022	WM Review - date received:	11/22/2022
Acknowledgement Letter Sent	Date: 11/8/2022	GW Review - date sent:	11/8/2022
County sent cc: of Ack Letter	Date: 11/8/2022	GW Review - date received:	9/10/2024
Initial Public Notice Date:	11/8/2022	ODFW Review - date sent: ODFW District:	
Comments Received:	Yes <input type="checkbox"/> No: <input checked="" type="checkbox"/>	ODFW Review - date received:	

## Water Rights Affected

File Marked	No.	App. File # or Decree Name	Permit	Certificate	RR/CR Needed	RR/CR Nos.
<input type="checkbox"/>	1	G-5221	G-4823	45205	<input type="checkbox"/> Yes <input type="checkbox"/> No	
<input type="checkbox"/>	2				<input type="checkbox"/> Yes <input type="checkbox"/> No	
<input type="checkbox"/>	3				<input type="checkbox"/> Yes <input type="checkbox"/> No	

I have confirmed that the information on this document is correct (or has been corrected): initials

## Caseworker Actions:

Assigned in WRIS: 4/9/2025	DPD Workflow updated:	WRIS Notes:
PD and RR sent to Data Entry:	Certified mail date:	
Newspaper notice needed: Yes <input type="checkbox"/> No: <input checked="" type="checkbox"/>	Name of Newspaper:	
PD notice email coordinator:	PD notice Request Date:	Amount Due: \$
		Received date:
Last day of publication:	Affidavit received:	

DOCUMENT	Drafted		Peer Review		Policy Review		Changes		ODFW contact info: <input type="checkbox"/> included NA: <input type="checkbox"/>	
	Date	initials	Date	initials	Date	initials	Date	initials	WM contact info: <input type="checkbox"/> included NA: <input type="checkbox"/>	
DPD			AD	AD	CC	4/18	ERA	4/18	Number of Docs for signature:	
NOTICE									Date in Signature bin	Signature date
PD										
FO										7/29/2025
RR										
Special Issues:										



**PERMANENT TRANSFER APPLICATION CHECKLIST**☐ RA**Transfer #: T-14115**

CW	PR	Coord	
<input checked="" type="checkbox"/>	<input type="checkbox"/>	<input type="checkbox"/>	Save all certificates in electronic "T" folder and highlight Priority Date, Rate, Use and Limit/Duty paragraph
<input type="checkbox"/>	<input type="checkbox"/>	<input type="checkbox"/>	<input type="checkbox"/> Supplemental checklist for transfers w/in a District (S:\groups\wr\TACS\WRISApps Templates\Transfer Checklists\SUPP_Within District Processing Checklist 9-5-2019) If this is a Living Certificate – check with Ann Reece      See Supplemental Language document for language

**Transfer Application Review and Deficiencies**

CW	PR	Coord			
<input checked="" type="checkbox"/>	<input type="checkbox"/>	<input type="checkbox"/>	Are all applicants/agents listed in WRIS with email addresses, if available?	<input checked="" type="checkbox"/> Yes	<input type="checkbox"/> No
<input checked="" type="checkbox"/>	<input type="checkbox"/>	<input type="checkbox"/>	Have all permit/certificates been entered in WRIS under Transfer #?	<input checked="" type="checkbox"/> Yes	<input type="checkbox"/> No
<input checked="" type="checkbox"/>	<input type="checkbox"/>	<input type="checkbox"/>	Were timely Public Comments received? (if yes, enter commenter names/email on mailing list)	<input type="checkbox"/> Yes	<input checked="" type="checkbox"/> No
Add finding for any comments received (see Supplemental Language document)					

**Groundwater Modification Application Review and Deficiencies**

CW	PR	Coord	<input type="checkbox"/> N/A		
<input type="checkbox"/>	<input type="checkbox"/>	<input type="checkbox"/>	<input type="checkbox"/>	If for a Groundwater Modification, were there any assignments? <i>All GR Mod applicants must be the holder of record.</i>	<input type="checkbox"/> Yes <input type="checkbox"/> No
<input type="checkbox"/>	<input type="checkbox"/>	<input type="checkbox"/>	<input type="checkbox"/>	Are there any past GR Modifications and/or letters documenting changes to the GR <i>These must be accounted for in the GR Mod Order.</i>	<input type="checkbox"/> Yes <input type="checkbox"/> No

**Review "From" and "To" Lands and/or POD/POA**

CW	PR	Coord			
<input checked="" type="checkbox"/>	<input type="checkbox"/>	<input type="checkbox"/>	<input type="checkbox"/>	Are only the authorized POD(s)/POA(s)/POU listed on the "from" map?	<input checked="" type="checkbox"/> Yes <input type="checkbox"/> No
<input checked="" type="checkbox"/>	<input type="checkbox"/>	<input type="checkbox"/>	<input type="checkbox"/>	Does the "from" map match the certificate map? If No, what is different?	<input checked="" type="checkbox"/> Yes <input type="checkbox"/> No
<input checked="" type="checkbox"/>	<input type="checkbox"/>	<input type="checkbox"/>	<input type="checkbox"/>	Compare FROM POU in application (Table 2) with certificate. <i>Mark certificate with acres being xferred, any RR acres and any acres being cancelled.</i>	
<input checked="" type="checkbox"/>	<input type="checkbox"/>	<input type="checkbox"/>	<input type="checkbox"/>	Compare TO POU in Table 2 with the TO Lands on map (for accuracy)	
<input checked="" type="checkbox"/>	<input type="checkbox"/>	<input type="checkbox"/>	<input type="checkbox"/>	Are any of the "from" lands being cancelled/diminished?	<input type="checkbox"/> Yes <input checked="" type="checkbox"/> No
<input type="checkbox"/>	<input type="checkbox"/>	<input type="checkbox"/>	<input type="checkbox"/>	If Yes, were cancellation/diminution affidavits submitted? (see findings and <b>additional authority</b> in Supplemental Language doc)	<input type="checkbox"/> Yes <input type="checkbox"/> No
<input checked="" type="checkbox"/>	<input type="checkbox"/>	<input type="checkbox"/>	<input type="checkbox"/>	Are any instream water rights affected? If Yes, Cert # (If Yes, check criteria for injury-upstream POD move, moving closer to SW, or return flows affected)	<input type="checkbox"/> Yes <input checked="" type="checkbox"/> No

**Layered/Supplemental Rights**

CW	PR	Coord	<input checked="" type="checkbox"/> N/A		
<input type="checkbox"/>	<input type="checkbox"/>	<input type="checkbox"/>	<input type="checkbox"/>	Are there any layered irrigation rights?	<input type="checkbox"/> Yes <input type="checkbox"/> No
<input type="checkbox"/>	<input type="checkbox"/>	<input type="checkbox"/>	<input type="checkbox"/>	If Yes, were they included in application? If No, they must move with the primary, to a "like" primary, or they will be cancelled though the transfer process	<input type="checkbox"/> Yes <input type="checkbox"/> No

<input type="checkbox"/>	<input type="checkbox"/>	<input type="checkbox"/>	Layered right(s) Cert:		
<input type="checkbox"/>	<input type="checkbox"/>	<input type="checkbox"/>	Are any supplemental rights being transferred? (verify that it is <b>actually</b> a supplemental right)	<input type="checkbox"/> Yes	<input type="checkbox"/> No
<input type="checkbox"/>	<input type="checkbox"/>	<input type="checkbox"/>	If Yes, are they being transferred to a "like" primary (i.e. similar reliability)?	<input type="checkbox"/> Yes	<input type="checkbox"/> No
<input type="checkbox"/>	<input type="checkbox"/>	<input type="checkbox"/>	Notes:		

Transfer Review Criteria					
CW	PR	Coord			
<input checked="" type="checkbox"/>	<input type="checkbox"/>	<input type="checkbox"/>	Validity of the right – Has the right been used in the last 5 years and is not subject to forfeiture?	<input checked="" type="checkbox"/> Yes	<input type="checkbox"/> No
<input checked="" type="checkbox"/>	<input type="checkbox"/>	<input type="checkbox"/>	<input checked="" type="checkbox"/> Evidence of use and supporting documentation <input type="checkbox"/> Confirming (not a remaining right) cert issued within the last 5 years <input type="checkbox"/> Rebuttal to forfeiture (ORS 540.610)		
<input checked="" type="checkbox"/>	<input type="checkbox"/>	<input type="checkbox"/>	Ready, Willing and Able – <input checked="" type="checkbox"/> Current delivery system sufficiently described in application. Does delivery system have capacity to fully divert and use the authorized rate/duty of the right?	<input checked="" type="checkbox"/> Yes	<input type="checkbox"/> No
<input checked="" type="checkbox"/>	<input type="checkbox"/>	<input type="checkbox"/>	Would the proposed transfer result in enlargement? If Yes, why? What conditions, if any, will avoid?	<input type="checkbox"/> Yes	<input checked="" type="checkbox"/> No
<input checked="" type="checkbox"/>	<input type="checkbox"/>	<input type="checkbox"/>	Would the proposed transfer result in injury? If Yes, why? What conditions, if any, will avoid?	<input type="checkbox"/> Yes	<input checked="" type="checkbox"/> No
<input checked="" type="checkbox"/>	<input type="checkbox"/>	<input type="checkbox"/>	If injury, has WM or GW provided a list of injured water right holders? <input checked="" type="checkbox"/> N/A	<input type="checkbox"/> Yes	<input type="checkbox"/> No
<input checked="" type="checkbox"/>	<input type="checkbox"/>	<input type="checkbox"/>	If POD/POA/APOD/APOA change, will it be from the same source? If No, deny per OAR 690-380-2110(2) <input type="checkbox"/> N/A	<input checked="" type="checkbox"/> Yes	<input type="checkbox"/> No
<input type="checkbox"/>	<input type="checkbox"/>	<input type="checkbox"/>	Notes:		

Draft Preliminary Determination and Cover Letter – 12 pt. Calibri font			
CW	PR	Coord	
<input checked="" type="checkbox"/>	<input type="checkbox"/>	<input type="checkbox"/>	Prepare ModPod workareas
<input checked="" type="checkbox"/>	<input type="checkbox"/>	<input type="checkbox"/>	Prepare DPD (save as T-XXXXX-dpd-approve/deny (where XXXXX is the transfer number)
<input checked="" type="checkbox"/>	<input type="checkbox"/>	<input type="checkbox"/>	Prepare DPD Cover letter (save as T-XXXXX-dpd-cov)
<input checked="" type="checkbox"/>	<input type="checkbox"/>	<input type="checkbox"/>	Prepare Public Notice <input checked="" type="checkbox"/> and/or <input type="checkbox"/> newspaper notice (if required) (save as T-XXXXX-pd-notice)
<input checked="" type="checkbox"/>	<input type="checkbox"/>	<input type="checkbox"/>	Prepare Remaining Right(s) (if applicable). Send with DPD, cover letter and notice for peer review.

Issue Draft Preliminary Determination	
CW	
<input checked="" type="checkbox"/>	Copy DPD and cover letter for paper file
<input checked="" type="checkbox"/>	Save DPD and cover letter as PDF
<input checked="" type="checkbox"/>	Mail/email to applicant/agent/WM
<input checked="" type="checkbox"/>	Add workflow item "Draft PD Issued"

N/A - Quasi-Municipal Report of Ownership Information (ROI)					
CW	PR	Coord			
<input type="checkbox"/>	<input type="checkbox"/>	<input type="checkbox"/>	Does legal description in ROI/Deed match "from" lands?	<input type="checkbox"/> Yes	<input type="checkbox"/> No
<input type="checkbox"/>	<input type="checkbox"/>	<input type="checkbox"/>	Have all owners on the ROI/Deed signed the application?	<input type="checkbox"/> Yes	<input type="checkbox"/> No
<input type="checkbox"/>	<input type="checkbox"/>	<input type="checkbox"/>	Has a notarized statement of consent been submitted? (if applicable) <input type="checkbox"/> N/A	<input type="checkbox"/> Yes	<input type="checkbox"/> No

Newspaper Notice (if required)			
CW	PR	Coord	
			<input checked="" type="checkbox"/> N/A

<input type="checkbox"/>	<input type="checkbox"/>	<input type="checkbox"/>	Prepare/send letter to applicant/agent regarding newspaper notice cost	<input type="checkbox"/> Yes	<input type="checkbox"/> No
<input type="checkbox"/>	<input type="checkbox"/>	<input type="checkbox"/>	TACS Support delivered receipted funds to caseworker	<input type="checkbox"/> Yes	<input type="checkbox"/> No

### Preliminary Determination and Cover Letter Preparation

CW	PR	Coord	See cheat sheet at (S:\groups\wr\TACS\6. Transfers\Procedures\DPD to PD Conversion 12-8-2016) for more detailed instructions	
<input checked="" type="checkbox"/>	<input type="checkbox"/>	<input type="checkbox"/>	Was application amended after DPD was issued? - <b>Make sure amended pages were scanned to WRIS (see support staff) and make sure you mark amended (replaced) pages with SUPERSEDED. Also make findings in PD.</b>	<input type="checkbox"/> Yes <input checked="" type="checkbox"/> No
<input type="checkbox"/>	<input type="checkbox"/>	<input type="checkbox"/>	If Yes, what was amended?	
<input type="checkbox"/>	<input type="checkbox"/>	<input type="checkbox"/>	Did amendment change outcome from denial to approval? <i>If Yes, make findings in PD.</i>	<input type="checkbox"/> Yes <input type="checkbox"/> No
<input type="checkbox"/>	<input type="checkbox"/>	<input type="checkbox"/>	<input type="checkbox"/> If POD/POA changes or changes in "from" lands – re-review required from WM <input type="checkbox"/> If POA changes – re-review required from GW	
<i>Note: If POD was amended and changed from a downstream move to upstream within an ISWR reach – Consent to Injury may be required.</i>				
<input checked="" type="checkbox"/>			Save DPD as a new document (T-XXXXX-pd-approve/deny.doc) – <b>12 pt. Calibri font</b>	
<input checked="" type="checkbox"/>			Remove "Draft" from document	
<input checked="" type="checkbox"/>			Unhide hidden findings (ctrl-A, select Font, uncheck "hidden" box) and add dates	
<input type="checkbox"/>			If application was amended, add finding including date of amendment	
<input type="checkbox"/>			Change language resulting from any amendments in response to the DPD, including language under Determination and Proposed Action	
<input checked="" type="checkbox"/>			Unhide appeal (protest) language at the end of the document	
<input checked="" type="checkbox"/>			Prepare PD Cover Letter (save as T-XXXXX-pd-cov)	
<input checked="" type="checkbox"/>			Check email address(s) for accuracy	
<input type="checkbox"/>			Notes:	
<input type="checkbox"/>			Send to caseworker/coordinator for Peer Review	

### Data Center Review of PD

CW	PR	Coord	
<input checked="" type="checkbox"/>	<input type="checkbox"/>	<input type="checkbox"/>	Email PD and RR(s)(with new cert numbers) to Data* for review – <b>indicate if file is RA</b> *email address is in key
<input checked="" type="checkbox"/>	<input type="checkbox"/>	<input type="checkbox"/>	Data Center will send notification that file is complete
<input checked="" type="checkbox"/>	<input type="checkbox"/>	<input type="checkbox"/>	Make any necessary changes to PD or prepare Revised DPD (if substantive changes)

### Issue Preliminary Determination

CW	
<input checked="" type="checkbox"/>	Print PD and put in Manager's box for signature and issuance (support will print cover letter)
<input type="checkbox"/>	Add workflow notes

### Protest

CW	PR	Coor	
<input checked="" type="checkbox"/>	<input type="checkbox"/>	<input type="checkbox"/>	Have protests been received? <input type="checkbox"/> Yes <input checked="" type="checkbox"/> No <b>If YES, STOP! Coordinate with Protest section.</b>



## Final Order

**CW** See cheat sheet at (S:\groups\wr\TACS\6. Transfers\Procedures\PD to FO Conversion 12-8-2016) for more detailed instructions

**Do not issue Final Order before this date:** 7/10/25 (protest period end date or 30 days after date of last newspaper publication)

- ☐ If application had a newspaper notice, verify that Affidavit of Publication was received. Date:
- ☒ Save PD as a new document (T-XXXXX-ord-approve (or deny))
- ☒ Remove "PRELIMINARY DETERMINATION" from document title and replace with "FINAL ORDER." Unhide hidden findings (cntrl-a, select Font, uncheck "hidden" box)
- ☒ Replace "PROPOSING APPROVAL/DENIAL OF" with APPROVING/DENYING
- ☒ Replace the "judicial review/reconsideration rights" box in the first page footer for the "Final Order" judicial review language; unhide and add Special Order Volume (support will add page #)
- ☒ Update the hidden paragraph following the public notice and amendments findings (regarding issuance of PD)
- ☒ Change "Determination and Proposed Action" to "Conclusions of Law" and update paragraph
- ☒ Replace "If application T-XXXXX is approved . . ." with Now, therefore, it is ORDERED:"
- ☒ Select list of conditions below "It is ORDERED" section and turn off Italics. Check numbering (start at "1").
- ☒ Delete Protest language, Document preparation box, and Notice Regarding Servicemembers; Insert "Mailing Date: \_\_\_\_\_"
- ☐ Final Check: All Conclusions of Law are supported by Findings and Transfer Review Criteria

## Remaining Rights

CW	PR	Coord	<input checked="" type="checkbox"/> N/A
<input type="checkbox"/>	<input type="checkbox"/>	<input type="checkbox"/>	Make sure all RR certs have new cert numbers and are entered on the right side of the footer of each RR
<input type="checkbox"/>	<input type="checkbox"/>	<input type="checkbox"/>	Update left side of footer to read: T-XXXXX.rr.YYYYYY.ini, where YYYYYY is original cert number and .ini stands for your initials. New certificate should be on the right.
<input type="checkbox"/>	<input type="checkbox"/>	<input type="checkbox"/>	Print RR on certificate paper and include with Final Order for signature

## Issue Final Order

- CW**
- ☒ Pull "Working Copy" folder from file
  - ☒ Print and put FO and RR in Manager's box for signature (manager will deliver to support for processing and issuance)

Notes:



# Oregon

Tina Kotek, Governor

## Water Resources Department

North Mall Office Building

725 Summer St NE, Suite A

Salem, OR 97301

Phone 503 986-0900

Fax 503 986-0904

[www.oregon.gov/owrd](http://www.oregon.gov/owrd)

June 9, 2025

VIA CERTIFIED MAIL AND E-MAIL

ORCHARD HEIGHTS WATER ASSOCIATION  
4350 ORCHARD HEIGHTS NW  
SALEM, OR 97304

SUBJECT: Water Right Transfer Application T-14115

Please find enclosed the Preliminary Determination indicating that, based on the information available, the Department intends to approve application T-14115. This document is an intermediate step in the approval process; water may not be used legally as proposed in the transfer application until a Final Order has been issued by the Department. Please read this entire letter carefully to determine your responsibility for additional action.

A public notice is being published in the Department's weekly publication, simultaneously with issuance of the Preliminary Determination. The notice initiates a period in which any person may file either a protest opposing the decision proposed by the Department in the Preliminary Determination or a standing statement supporting the Department's decision. The protest period will end 30 days after the Department's notice.

If no protest is filed, the Department will issue a Final Order consistent with the Preliminary Determination. You should receive a copy of the Final Order about 30 days after the close of the protest period.

If a protest is filed, the application may be referred to a contested case proceeding. A contested case provides an opportunity for the proponents and opponents of the decision proposed in the Preliminary Determination to present information and arguments supporting their position in a quasi-judicial proceeding.

Please don't hesitate to contact me at 971-701-5485 or at [elyse.d.richman@water.oregon.gov](mailto:elyse.d.richman@water.oregon.gov), if I may be of assistance.

Sincerely,

Transfer Specialist

Transfer and Conservation Section

cc: Transfer Application file T-14115

Joel M. Plahn, District 22 Watermaster *(via e-mail)*

Ted Ressler, Agent for the applicant *(via e-mail)*

encs

**BEFORE THE WATER RESOURCES DEPARTMENT  
OF THE  
STATE OF OREGON**

In the Matter of Transfer Application	)	PRELIMINARY DETERMINATION
T-14115, Polk County	)	PROPOSING APPROVAL FOR AN
	)	ADDITIONAL POINT OF APPROPRIATION

**Authority**

Oregon Revised Statutes (ORS) 537.705 and 540.505 to 540.580 establish the process in which a water right holder may submit a request to transfer the point of appropriation, place of use, or character of use authorized under an existing water right. Oregon Administrative Rules (OAR) Chapter 690, Division 380 implement the statutes and provides the Department's procedures and criteria for evaluating transfer applications.

**Applicant**

ORCHARD HEIGHTS WATER ASSOCIATION  
4350 ORCHARD HEIGHTS ROAD NW  
SALEM, OR 97304

**Findings of Fact**

1. On November 1, 2022, Orchard Heights Water Association filed an application for an additional point of appropriation under Certificate 45205. The Department assigned the application number T-14115.
2. Notice of the application for transfer was published on November 8, 2022, pursuant to OAR 690-380-4000. No comments were filed in response to the notice.
3. On April 18, 2025, the Department mailed a copy of the draft Preliminary Determination proposing to approve Transfer Application T-14115 to the applicant. The draft Preliminary Determination cover letter set forth a deadline of May 19, 2025, for the applicant to respond. The applicant requested that the Department proceed with issuance of a Preliminary Determination and provided the necessary information to demonstrate that the applicant is authorized to pursue the transfer.

Pursuant to OAR 690-380-4030, any person may file a protest or standing statement within 30 days after the last date of publication of the newspaper notice or the Department's weekly notice as prescribed by OAR 690-380-4020, whichever is later, of this preliminary determination.
---



4. The right to be transferred is as follows:

**Certificate:** 45205 in the name of ORCHARD HEIGHTS WATER ASSOCIATION, INC.  
(perfected under Permit G-4823)  
**Use:** QUASI-MUNICIPAL  
**Priority Date:** JUNE 17, 1970  
**Rate:** 0.15 CUBIC FOOT PER SECOND (CFS), BEING 0.075 CFS FROM EACH WELL  
**Source:** TWO WELLS a tributary of WINSLOW GULCH

**Authorized Points of Appropriation:**

Twp	Rng	Mer	Sec	Q-Q	Measured Distances
7 S	3 W	WM	18	SW NW	Well No. 1 - SOUTH 5 DEGREES 14 MINUTES EAST 2412 FEET FROM THE NW CORNER OF SECTION 18
7 S	3 W	WM	18	SW NW	Well No. 2 - SOUTH 3 DEGREES 12 MINUTES EAST 2308 FEET FROM THE NW CORNER OF SECTION 18

**Authorized Place of Use:**

QUASI-MUNICIPAL				
Twp	Rng	Mer	Sec	Q-Q
7 S	3 W	WM	17	NW NE
7 S	3 W	WM	17	NE NW
7 S	3 W	WM	17	NW NW
7 S	3 W	WM	17	SW NW
7 S	3 W	WM	17	SE NW
7 S	3 W	WM	17	NE SW
7 S	3 W	WM	17	NW SW
7 S	3 W	WM	17	NE SE
7 S	3 W	WM	18	NW NE
7 S	3 W	WM	18	SW NE
7 S	3 W	WM	18	NE NW
7 S	3 W	WM	18	NW NW
7 S	3 W	WM	18	SW NW
7 S	3 W	WM	18	SE NW
7 S	3 W	WM	18	NE SW

QUASI-MUNICIPAL				
Twp	Rng	Mer	Sec	Q-Q
7 S	3 W	WM	18	NW SW
7 S	3 W	WM	18	SW SW
7 S	3 W	WM	18	NE SE
7 S	3 W	WM	18	NW SE
7 S	4 W	WM	13	NE NE
7 S	4 W	WM	13	NW NE
7 S	4 W	WM	13	NE NW
7 S	4 W	WM	13	NW NW
7 S	4 W	WM	13	NW SW
7 S	4 W	WM	13	SW SW
7 S	4 W	WM	13	SE SW
7 S	4 W	WM	13	SE SE
7 S	4 W	WM	14	NE NE
7 S	4 W	WM	14	NE SE

5. Transfer Application T-14115 proposes an additional point of appropriation as follows:

Twp	Rng	Mer	Sec	Q-Q	Measured Distances	Approximate distance from the authorized point of appropriation (POA) in feet (ft.)
7 S	3 W	WM	18	SW NW	LAFAYETTE WELL - NORTH 62 DEGREES, 54 MINUTES EAST, 780 FEET FROM THE WEST QUARTER CORNER OF SECTION 18	Well No. 1 – 530 ft. NE Well No. 2 – 475 ft. NE

***Transfer Review Criteria [OAR 690-380-0100(14), OAR 690-380-4010(2), and OAR 690-380-2110(2)]***

6. Water has been used within the last five years according to the terms and conditions of the right. There is no information in the record that would demonstrate that the right is subject to forfeiture under ORS 540.610.
7. A water delivery system sufficient to use the full amount of water allowed under the existing right was present within the five-year period prior to submittal of Transfer Application T-14115.
8. The water right is subject to transfer as defined in ORS 540.505(4) and OAR 690-380-0100(14).
9. The proposed point of appropriation develops groundwater from the same aquifer as the authorized points of appropriation, as required by OAR 690-380-2110(2).
10. The proposed change would not result in enlargement of the right.
11. The proposed change would not result in injury to other existing water rights.
12. All other application requirements are met.

**Determination and Proposed Action**

The additional point of appropriation proposed in Transfer Application T-14115 appears to be consistent with the requirements of ORS 537.705 and 540.505 to 540.580 and OAR 690-380-5000. If protests are not filed pursuant to OAR 690-380-4030, the application will be approved.

*If Transfer Application T-14115 is approved the final order will include the following:*

1. *The additional point of appropriation proposed in Transfer Application T-14115 is approved.*
2. *The right to the use of the water is restricted to beneficial use at the place of use described and is subject to all other conditions and limitations contained in Certificate 45205 and any related decree.*
3. *Approval of this transfer application does not constitute nor grant legal access onto or through another person's property for purposes of accessing the new point of appropriation.*
4. *Water right Certificate 45205 is cancelled.*
5. *The quantity of water diverted at the new additional point of appropriation (Lafayette Well), together with that diverted at the original points of appropriation (Well No. 1 and Well No. 2) shall not exceed the quantity of water lawfully available at the original points of appropriation (Well No. 1 and Well No. 2).*

6. *Water shall be acquired from the same aquifer (water source) as the original points of appropriation.*
7. *Full beneficial use of the water shall be made, consistent with the terms of this order, on or before **October 1, 2026**. A Claim of Beneficial Use prepared by a Certified Water Right Examiner shall be submitted by the applicant to the Department within one year after the deadline for completion of the change and full beneficial use of the water.*
8. *After satisfactory proof of beneficial use is received, a new certificate confirming the right transferred will be issued.*

Dated in Salem, Oregon on **JUN 09 2025**

  
Lisa J. Jaramillo, Transfer and Conservation Section Manager, for  
IVAN GALL, DIRECTOR  
Oregon Water Resources Department

This Preliminary Determination was prepared by Elyse Richman. If you have questions about the information in this document, you may reach me at 971-701-5485 or at [elyse.d.richman@water.oregon.gov](mailto:elyse.d.richman@water.oregon.gov).

## Protests

Under the provisions of ORS 540.520(6) & (7) and OAR 690-380-4030, within 30 days after the last date of publication of the newspaper notice or the Department's weekly notice as prescribed by OAR 690-380-4020, whichever is later, any person may file, jointly or severally, a protest expressing opposition of approval of the transfer application and disagreement with this Preliminary Determination or a standing statement in support of this Preliminary Determination. If this Preliminary Determination determines that a change in point of diversion or appropriation would result in injury, the applicant may file a notification of intent to pursue approval of the transfer under OAR 690-380-5030 to 690-380-5050. Protests and standing statements must be received by the Water Resources Department within 30 days after the last date of publication of the newspaper notice or the Department's weekly notice as prescribed by OAR 690-380-4020, whichever is later.

Protests must be in writing and received in hard copy form with the appropriate statutory protest filing fee; protests cannot be filed by electronic mail. [OAR 690-002-0025(3) and 690-380-0100(9)]. The protest must include the following:

- The person's name, address, and telephone number;
- All reasonably ascertainable issues and all reasonably available arguments supporting the person's position by the close of the protest period. Failure to raise a reasonably



ascertainable issue in a protest or failure to provide sufficient specificity to afford the Department an opportunity to respond to the issue may preclude consideration of the issue during the hearing;

- If you are the applicant, a protest fee of \$480 required by ORS 536.050; and
- If you are not the applicant, a protest fee of \$950 required by ORS 536.050 and proof of service of the protest upon the applicant.

### **Requests for Standing**

Under the provisions of OAR 690-380-4030(5), the Department shall provide to persons who have filed standing statements as defined under OAR 690-380-0100(11) notice of any differences between the Department's Preliminary Determination and the Final Order, notice of a hearing on the application under OAR 137-003-0535, and an opportunity to request limited party status or party status in the hearing.

Requests for standing must be received in the Water Resources Department no later than 30 days after the last date of publication of the newspaper notice or the Department's weekly notice as prescribed by OAR 690-380-4020, whichever is later. Requests for standing must be in writing, and must include the following:

- The requester's name, mailing address and telephone number;
- If the requester is representing a group, association or other organization, the name, address and telephone number of the represented group;
- A statement that the requester supports the preliminary determination as issued.

After the protest period has ended, the Director will either issue a Final Order or schedule a contested case hearing. The contested case hearing will be scheduled only if a protest has been filed under OAR 690-380-4030. In accordance with OAR 690-380-4200, notice and conduct of the hearing shall:

- Be under the applicable provisions of ORS 183.310 to 183.550, pertaining to contested cases, and the hearing shall be held in the area where the rights are located unless all parties stipulate otherwise; and
- If a protest has asserted that a water right to be transferred has been forfeited through non-use, include the notice and procedures described in OAR 690-017-0500 to 690-017-0900.

If after hearing the Department issues a proposed Final Order finding that a change in point of diversion or appropriation will result in injury, the applicant may file a notification of intent to

pursue approval of the transfer under OAR 690-380-5030 to 690-380-5050 within 15 days of receipt of the proposed order. Notwithstanding 690-002-0175, if the applicant files a notification of intent to pursue approval of the transfer under 690-380-5030 to 690-380-5050, the deadline for filing exceptions to the proposed order shall be 30 days after the Department provides notice to the parties that the transfer does not meet the requirements of 690-380-5030 to 690-380-5050.

If you do not request a hearing within 30 days after the close of the protest period, or if you withdraw a request for a hearing, notify the Department or the administrative law judge that you will not appear, or fail to appear at a scheduled hearing, the Director may issue a final order by default. If the Director issues a Final Order by default, the Department designates the relevant portions of its files on this matter, including all materials that you have submitted relating to this matter, as the record for purpose of proving a *prima facie* case upon default.

You may be represented by an attorney at the hearing. Legal aid organizations may be able to assist a party with limited financial resources. Generally, partnerships, corporations, associations, governmental subdivisions, or public or private organizations are represented by an attorney. However, consistent with OAR 690-002-0020 and OAR 690-137-0555, an agency representative may represent partnerships, corporations, associations, governmental subdivisions or public, or private organizations if the Department determines that appearance of a person by an authorized representative will not hinder the orderly and timely development of the record in this case.

**Notice Regarding Servicemembers:** Active duty servicemembers have a right to stay proceedings under the federal Servicemembers Civil Relief Act. 50 U.S.C. App. §§501-597b. For more information contact the Oregon State Bar at 800-452-8260, the Oregon Military Department at 971-355-4127, or the nearest United States Armed Forces Legal Assistance Office through <http://legalassistance.law.af.mil>.

If you have questions about how to file a protest or if you have previously filed a protest and you want to know the status, please contact Will Davidson at 503-507-2749.

If you have questions about the Department or any of its programs, please contact our Water Resources Customer Service Group at 503-986-0900.

Address any correspondence to: Oregon Water Resources Department, Transfer and Conservation Section, 725 Summer Street NE, Suite A, Salem OR 97301-1266.

## **RICHMAN Elyse D \* WRD**

---

**From:** RICHMAN Elyse D \* WRD  
**Sent:** Friday, April 18, 2025 10:38 AM  
**To:** DSPAAD@yahoo.com; tressler@summitwr.com  
**Cc:** PLAHN Joel M \* WRD  
**Subject:** Orchard Heights Water Association, T-14115  
**Attachments:** T-14115-dpd-cov.pdf; T-14115-dpd.pdf

Good morning,

Please see attached and let me know if I may be of further assistance. A copy of the DPD will also be mailed to the applicant via USPS.

Thank you,

*Elyse D. Richman*

she/her/hers

Transfer Specialist

725 Summer Street NE, Suite A, Salem, OR 97301

Phone: 971-701-5485



OREGON  
WATER  
RESOURCES  
DEPARTMENT

Integrity | Service | Technical Excellence | Teamwork | Forward-Looking



# Oregon

Tina Kotek, Governor

## Water Resources Department

North Mall Office Building

725 Summer St NE, Suite A

Salem, OR 97301

Phone 503 986-0900

Fax 503 986-0904

[www.oregon.gov/owrd](http://www.oregon.gov/owrd)

April 18, 2025

VIA E-MAIL AND REGULAR MAIL

ORCHARD HEIGHTS WATER ASSOCIATION

4350 ORCHARD HEIGHTS ROAD NW

SALEM, OR 97304

Reference: Water Right Transfer Application T-14115

Your water right transfer is in the first of three phases of processing. Enclosed is a draft of the Department's Preliminary Determination regarding Transfer Application T-14115. The document reflects the Department's conclusion that, based on the information currently available, the transfer will be approved. Your response and submittal of the items outlined below are required by May 19, 2025.

***Required items needing your immediate attention:***

1. Please carefully review the Draft Preliminary Determination to verify that it accurately reflects the changes you intend to make and to become familiar with the proposed conditions.
2. **Respond in writing** by May 19, 2025, with acknowledgement that you agree to the proposed action and conditions.
3. If you find any errors, please let me know.
4. **REQUIRED:** You must submit a **Report of Ownership** for the lands where the water right is currently located (i.e., the FROM lands). This report:
  - a) Must be prepared by a title company;
  - b) Shall include a "prepared by" statement and the date the title company prepared the report printed on the cover sheet;
  - c) Must:
    - i. Be prepared no earlier than 3 months prior to the date of issuance of the Draft Preliminary Determination showing current ownership; **OR**
    - ii. Be prepared within 3 months of the date the water right conveyance agreement was recorded; **OR**
    - iii. Show ownership for the FROM land at the time a water right conveyance agreement was recorded.

*If water right conveyance agreements are involved, it is helpful to provide copies of those agreements along with the Report of Ownership.*

**IMPORTANT:** In order for the Department to clearly understand the date that the title company prepared the Report of Ownership, the title company must indicate/state the date that they prepared the report on the coversheet and/or first page of the report.

- d) Must include a list of owners at the time the report was generated; **AND**
  - e) Must include a legal description of the property where the water right to be transferred is currently located (i.e., the FROM lands).
5. You must provide a notarized statement of consent signed by any landowner listed in the Report of Ownership who is not already included in the transfer application. The Department's statement of consent form (**Consent By Deeded Landowner**) is available at:  
[https://www.oregon.gov/OWRD/WRDFormsPDF/consent to transfer form.pdf](https://www.oregon.gov/OWRD/WRDFormsPDF/consent%20to%20transfer%20form.pdf)

**Please note the proposed date by which all conditions must be met: October 1, 2026.** If the required completion date is insufficient to comply with any of the conditions, you may request more time, at no cost to you, during this stage of processing. **Please let me know by the comment deadline if you will need more time and explain the reasons why.**

**What happens next...**

Once the preliminary determination is issued a publication period is required. The Department will publish a notice in their weekly publication, which opens a 30-day period in which the transfer can be protested.

Issuance of the Preliminary Determination will occur shortly after we receive:

1. Your written response to the conditions and proposed action in the Draft Preliminary Determination (e-mail is acceptable); and
2. The Report of Ownership, including affidavits of consent from any landowners shown in the ownership report who have not signed the transfer application. The title company must indicate/state the date that they prepared the ownership report on the coversheet and/or first page of the report.

**If we do not receive the items listed above by May 19, 2025, a Preliminary Determination may be issued denying the application as incomplete.**

Please don't hesitate to contact me at (971) 701-5485 or at [elyse.d.richman@water.oregon.gov](mailto:elyse.d.richman@water.oregon.gov), if I may be of assistance.

Sincerely,



Transfer Specialist  
Transfer and Conservation Section

cc: Transfer Application file T-14115  
Joel M. Plahn, District 22 Watermaster (via e-mail)  
Ted Ressler, Agent for the applicant (via e-mail)

encs



**BEFORE THE WATER RESOURCES DEPARTMENT  
OF THE  
STATE OF OREGON**

In the Matter of Transfer Application  
T-14115, Polk County

)  
)  
)  
)  
)

**D R A F T**

PRELIMINARY DETERMINATION  
PROPOSING APPROVAL FOR AN  
ADDITIONAL POINT OF APPROPRIATION

**Authority**

Oregon Revised Statutes (ORS) 537.705 and 540.505 to 540.580 establish the process in which a water right holder may submit a request to transfer the point of appropriation, place of use, or character of use authorized under an existing water right. Oregon Administrative Rules (OAR) Chapter 690, Division 380 implement the statutes and provides the Department's procedures and criteria for evaluating transfer applications.

**Applicant**

ORCHARD HEIGHTS WATER ASSOCIATION  
4350 ORCHARD HEIGHTS ROAD NW  
SALEM, OR 97304

**Findings of Fact**

1. On November 1, 2022, Orchard Heights Water Association filed an application for an additional point of appropriation under Certificate 45205. The Department assigned the application number T-14115.
2. Notice of the application for transfer was published on November 8, 2022, pursuant to OAR 690-380-4000. No comments were filed in response to the notice.
3. The right to be transferred is as follows:

**Certificate:** 45205 in the name of ORCHARD HEIGHTS WATER ASSOCIATION, INC.  
(perfected under Permit G-4823)  
**Use:** QUASI-MUNICIPAL  
**Priority Date:** JUNE 17, 1970  
**Rate:** 0.15 CUBIC FOOT PER SECOND (CFS), BEING 0.075 CFS FROM EACH WELL  
**Source:** TWO WELLS a tributary of WINSLOW GULCH

**Authorized Points of Appropriation:**

Twp	Rng	Mer	Sec	Q-Q	Measured Distances
7 S	3 W	WM	18	SW NW	Well No. 1 - SOUTH 5 DEGREES 14 MINUTES EAST 2412 FEET FROM THE NW CORNER OF SECTION 18

Twp	Rng	Mer	Sec	Q-Q	Measured Distances
7 S	3 W	WM	18	SW NW	Well No. 2 - SOUTH 3 DEGREES 12 MINUTES EAST 2308 FEET FROM THE NW CORNER OF SECTION 18

**Authorized Place of Use:**

QUASI-MUNICIPAL				
Twp	Rng	Mer	Sec	Q-Q
7 S	3 W	WM	17	NW NE
7 S	3 W	WM	17	NE NW
7 S	3 W	WM	17	NW NW
7 S	3 W	WM	17	SW NW
7 S	3 W	WM	17	SE NW
7 S	3 W	WM	17	NE SW
7 S	3 W	WM	17	NW SW
7 S	3 W	WM	17	NE SE
7 S	3 W	WM	18	NW NE
7 S	3 W	WM	18	SW NE
7 S	3 W	WM	18	NE NW
7 S	3 W	WM	18	NW NW
7 S	3 W	WM	18	SW NW
7 S	3 W	WM	18	SE NW
7 S	3 W	WM	18	NE SW
7 S	3 W	WM	18	NW SW
7 S	3 W	WM	18	SW SW
7 S	3 W	WM	18	NE SE
7 S	3 W	WM	18	NW SE
7 S	4 W	WM	13	NE NE
7 S	4 W	WM	13	NW NE
7 S	4 W	WM	13	NE NW
7 S	4 W	WM	13	NW NW
7 S	4 W	WM	13	NW SW
7 S	4 W	WM	13	SW SW
7 S	4 W	WM	13	SE SW
7 S	4 W	WM	13	SW SE
7 S	4 W	WM	13	SE SE
7 S	4 W	WM	14	NE NE
7 S	4 W	WM	14	NE SE

4. Transfer Application T-14115 proposes an additional point of appropriation as follows:

Twp	Rng	Mer	Sec	Q-Q	Measured Distances	Approximate distance from the authorized point of appropriation (POA) in feet (ft.)
7 S	3 W	WM	18	SW NW	LAFAYETTE WELL - NORTH 62 DEGREES, 54 MINUTES EAST, 780 FEET FROM THE WEST QUARTER CORNER OF SECTION 18	Well No. 1 – 530 ft. NE Well No. 2 – 475 ft. NE

***Transfer Review Criteria [OAR 690-380-0100(14), OAR 690-380-4010(2), and OAR 690-380-2110(2)]***

5. Water has been used within the last five years according to the terms and conditions of the right. There is no information in the record that would demonstrate that the right is subject to forfeiture under ORS 540.610.
6. A water delivery system sufficient to use the full amount of water allowed under the existing right was present within the five-year period prior to submittal of Transfer Application T-14115.
7. The water right is subject to transfer as defined in ORS 540.505(4) and OAR 690-380-0100(14).
8. The proposed point of appropriation develops groundwater from the same aquifer as the authorized points of appropriation, as required by OAR 690-380-2110(2).
9. The proposed change would not result in enlargement of the right.
10. The proposed change would not result in injury to other existing water rights.
11. All other application requirements are met.

**Determination and Proposed Action**

The additional point of appropriation proposed in Transfer Application T-14115 appears to be consistent with the requirements of ORS 537.705 and 540.505 to 540.580 and OAR 690-380-5000. If protests are not filed pursuant to OAR 690-380-4030, the application will be approved.

*If Transfer Application T-14115 is approved the final order will include the following:*

1. *The additional point of appropriation proposed in Transfer Application T-14115 is approved.*
2. *The right to the use of the water is restricted to beneficial use at the place of use described and is subject to all other conditions and limitations contained in Certificate 45205 and any related decree.*
3. *Approval of this transfer application does not constitute nor grant legal access onto or through another person's property for purposes of accessing the new point of appropriation.*
4. *Water right Certificate 45205 is cancelled.*
5. *The quantity of water diverted at the new additional point of appropriation (Lafayette Well), together with that diverted at the original points of appropriation (Well No. 1 and Well No. 2) shall not exceed the quantity of water lawfully available at the original points of appropriation (Well No. 1 and Well No. 2).*

6. *Water shall be acquired from the same aquifer (water source) as the original points of appropriation.*
7. *Full beneficial use of the water shall be made, consistent with the terms of this order, on or before **October 1, 2026**. A Claim of Beneficial Use prepared by a Certified Water Right Examiner shall be submitted by the applicant to the Department within one year after the deadline for completion of the change and full beneficial use of the water.*
8. *After satisfactory proof of beneficial use is received, a new certificate confirming the right transferred will be issued.*

Dated in Salem, Oregon on

**D R A F T**

Lisa J. Jaramillo, Transfer and Conservation Section Manager, for  
IVAN GALL, DIRECTOR  
Oregon Water Resources Department

<p>This draft Preliminary Determination was prepared by Elyse Richman. If you have questions about the information in this document, you may reach me at 971-701-5485 or at <a href="mailto:elyse.d.richman@water.oregon.gov">elyse.d.richman@water.oregon.gov</a>.</p>
---

# Groundwater Transfer Review Summary Form

Transfer/PA # T- 14115

GW Reviewer Phillip I. Marcy Date Review Completed: 11/28/2023

## Summary of Same Source Review:

☐ The proposed change in point of appropriation is not within the same aquifer as per OAR 690-380-2110(2).

## Summary of Injury Review:

☐ The proposed transfer will result in another, existing water right not receiving previously available water to which it is legally entitled or result in significant interference with a surface water source as per 690-380-0100(3).

## Summary of GW-SW Transfer Similarity Review:

☐ The proposed SW-GW transfer doesn't meet the definition of "similarly" as per OAR 690-380-2130.

*This is only a summary. Documentation is attached and should be read thoroughly to understand the basis for determinations.*





Oregon Water Resources Department  
725 Summer Street NE, Suite A  
Salem, Oregon 97301-1271  
(503) 986-0900  
www.wrd.state.or.us

## Ground Water Review Form:

- ☒ Water Right Transfer  
☐ Permit Amendment  
☐ GR Modification  
☐ Other

Application: T-14115

Applicant Name: Orchard Heights Water Association

Proposed Changes: ☐ POA ☒ APOA ☐ SW→GW ☐ RA  
☐ USE ☐ POU ☐ OTHER

Reviewer(s): Phillip I. Marcy

Date of Review: 11/28/2023

Date Returned to WRSD: 9/9/2024

The information provided in the application is insufficient to evaluate whether the proposed transfer may be approved because:

- ☐ The water well reports provided with the application do not correspond to the water rights affected by the transfer.
- ☐ The application does not include water well reports or a description of the well construction details sufficient to establish the ground water body developed or proposed to be developed.
- ☐ Other \_\_\_\_\_

- 
1. Basic description of the changes proposed in this transfer: The applicant proposes to add an additional point of appropriation (APOA) to Certificate 45205 to reliably provide drinking water to Orchard Heights Water Association customers.
  2. Will the proposed POA develop the same aquifer (source) as the existing authorized POA?  
☒ Yes ☐ No Comments: There are currently two authorized POA wells under Certificate 45205, POLK 1787 and POLK 1786, both producing groundwater from the Columbia River Basalt (CRB) aquifer. The proposed APOA (POLK 1789) also produces from CRB.
  3. a) Is there more than one source developed under the right (e.g., basalt and alluvium)?  
☐ Yes ☒ No Both authorized POA wells produce from CRB.  
b) If yes, estimate the portion of the right supplied by each of the sources and describe any limitations that will need to be placed on the proposed change (rate, duty, etc.): NA
  4. a) Will this proposed change, at its maximum allowed rate of use, likely result in an increase in interference with **another ground water right**?  
☒ Yes ☐ No Comments: The proposed APOA well is already an authorized POA on Certificate 83546, with a maximum rate of 0.044 CFS.  
b) If yes, would this proposed change, at its maximum allowed rate of use, likely result in another groundwater right not receiving the water to which it is legally entitled?

- ☐ Yes ☒ No If yes, explain: Since these wells are for the same quasi-municipal use, it is not anticipated that additional use of this well would negatively impact the existing authorization.
5. a) Will this proposed change, at its maximum allowed rate of use, likely result in an increase in interference with **another surface water source**?
- ☐ Yes ☒ No Comments: The proposed APOA is not significantly closer to any surface water source than either of the currently authorized POA wells. It is also questionable whether the CRB aquifer is hydraulically connected to surface water in the immediate vicinity, based upon the difference between the elevations of surface water and groundwater in these CRB wells (see attached hydrograph and cross-section).
- b) If yes, at its maximum allowed rate of use, what is the expected change in degree of interference with any **surface water sources** resulting from the proposed change?
- Stream: NA ☐ Minimal ☐ Significant
- Stream: NA ☐ Minimal ☐ Significant
- Provide context for minimal/significant impact: NA
6. For SW-GW transfers, will the proposed change in point of diversion affect the surface water source similarly (as per OAR 690-380-2130) to the authorized point of diversion specified in the water use subject to transfer?
- ☐ Yes ☐ No Comments: NA
7. What conditions or other changes in the application are necessary to address any potential issues identified above: \_\_\_\_\_
8. Any additional comments: \_\_\_\_\_

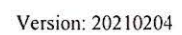

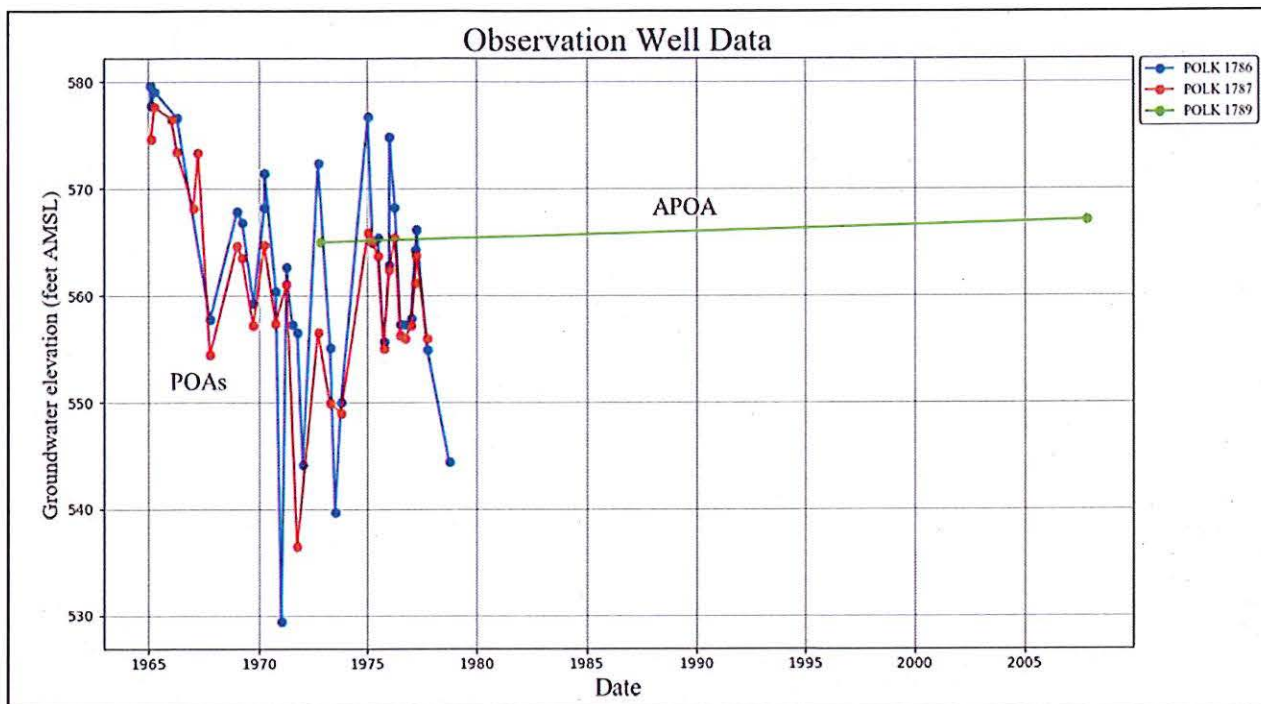

Available water level data indicate the APOA well is likely to produce from the same water-bearing zones as the two authorized POA wells.

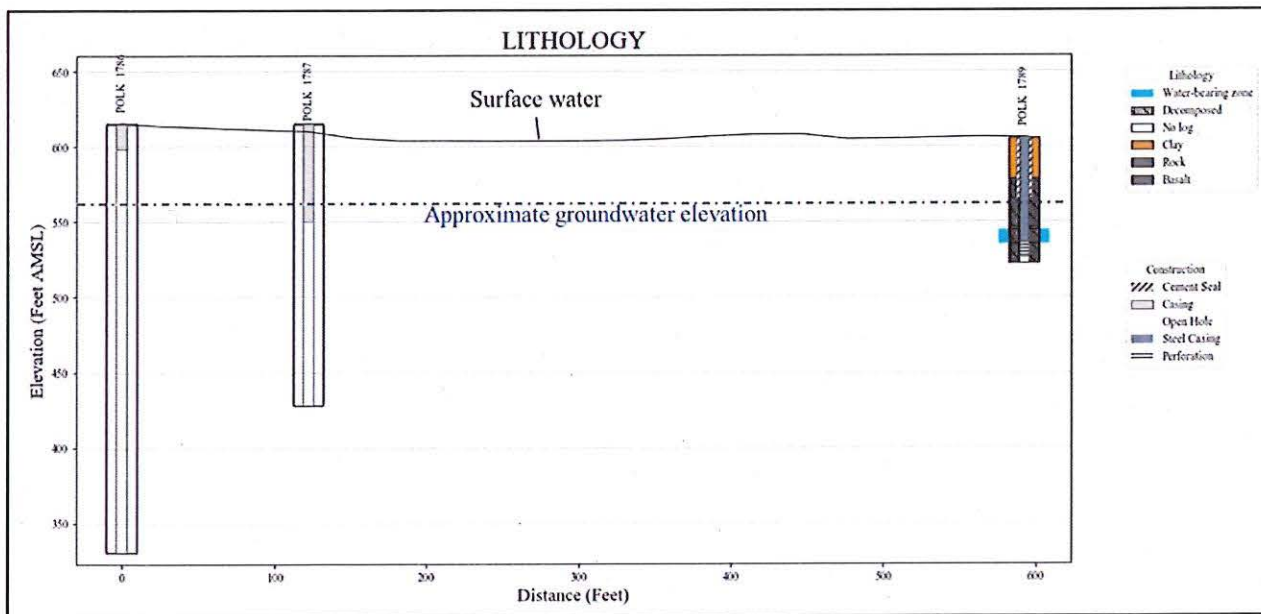



## Watermaster Review Form: Water Right Transfer



Oregon Water Resources Department  
725 Summer St NE, Suite A  
Salem, Oregon 97301-1266  
(503) 986-0900  
www.oregon.gov/OWRD

Transfer Application: T-14115

Review Due Date:

Applicant Name: Orchard Heights water Association

Proposed Changes: ☐ POU ☐ POD ☒ POA ☐ USE ☐ OTHER

Reviewer(s): Joel Plahn

Date of Review: 11/22/2022

1. Do you have evidence that the right has not been used in the last 5 years and that the presumption of forfeiture would not likely be rebuttable? ☐ Yes ☒ No If "Yes", attach evidence (e.g. dated aerial photo showing pavement or building on the land for >5 yrs.)
2. Is there a history of regulation on the source that serves this (or these) right(s) that has involved the transferred right(s) and downstream water rights? ☐ Yes ☒ No Generally characterize the frequency of any regulation or explain why regulation has not occurred:
3. Have headgate notices been issued for the source that serves the transferred right(s)?  
☐ Yes ☒ No ☐ Records not available.
4. In your estimation, after the proposed change, would distribution of water for the right(s) result in regulation of other water rights that would not have occurred if use under the original right(s) was/were maximized? ☐ Yes ☒ No If "Yes", explain:
5. In your estimation, if the proposed change is approved, are there upstream water rights that would be affected? ☐ Yes ☒ No If "Yes", describe how the rights would be affected and list the rights most affected:



6. Check here ☐ if it appears that downstream water rights benefit from return flows resulting from the current use of the transferred right(s)? If you check the box, generally characterize the locations where the return flows likely occur and list the water rights that benefit most:

☒ N/A

7. For POD changes and instream transfers, check here if there are channel losses between the old and new PODs or within the proposed instream reach? If you check the box, describe and, if possible, estimate the losses:

☒ N/A

8. For instream transfers that propose protection of a reach beyond the mouth of the source stream:

☒ N/A Would the quantity be measureable into the receiving stream consistent with OAR 690-077-0015(8)? ☐ Yes ☐ No

9. For POU changes: ☒ N/A Is it likely the original place of use would continue to receive water from the same source? ☐ Yes ☐ No If "Yes", explain:

10. For POU or USE changes: ☒ N/A In your best judgment, would use of the existing right at "full face value," result in the diversion of more water than can be used beneficially and without waste? ☐ Yes ☐ No If "Yes", explain:

11. For POU changes that involve micro-irrigation: ☒ N/A

- a. Has the applicant made changes (absent a transfer) to convert to micro-irrigation within the current place of use boundary of the water right proposed for transfer, and previously demonstrated to the Department through monitoring and site inspections by the Watermaster that the proposed transfer will not result in injury or enlargement?

☐ Yes ☐ No If "Yes", explain:

- b. Has a temporary transfer of this nature been previously filed and approved on the same lands (or portions thereof) as those lands involved in this transfer?

☐ Yes ☐ No If "Yes", answer the following:

- i. Were there any problems with more acres being irrigated (or wetted) than were authorized under the temporary transfer? ☐ Yes ☐ No If "Yes", explain:

- ii. Did the designated areas that were to remain dry (or not wetted) under the temporary transfer actually remain dry? ☐ Yes ☐ No If "No", explain:

- iii. Did the applicant comply with and meet all of the conditions of the temporary transfer? ☐ Yes ☐ No If "No", explain:

- iv. Do you have any other observations regarding the temporary transfer?

☐ Yes ☐ No If "Yes", describe:

- v. Did the applicant demonstrate to the Department through monitoring and site inspections by the Watermaster that neither injury nor enlargement occurred as a result of the temporary transfer? ☐ Yes ☐ No If "No", explain:

- c. To the best of your knowledge, if this transfer is approved, does it appear that:

- i. "Injury" will occur to other water rights that share the same source?

☐ Yes ☐ No If "Yes", explain:

- ii. "Enlargement" of the water right being transferred will occur?

☐ Yes ☐ No If "Yes", explain:

12. Are there other issues not identified through the above questions that should be considered in determining whether the change "can be effected without injury to other rights"?

☐ Yes ☒ No If "Yes", explain:

13. What alternatives may be available for addressing any issues identified above:

14. Do conditions need to be included in the transfer order to avoid enlargement of the right or injury to other rights? ☒ No ☐ Yes, as checked and provided below:

☐ For POU changes that involve micro-irrigation, provide the monitoring and reporting conditions necessary to prevent injury/enlargement:

☐ A Headgate should be required prior to diverting water.

☐ Measurement Devices for POD or POA: (if this condition is selected, also fill in the top sections of Page 4)

*a. Before water use may begin under this order, the water user shall install a **totalizing flow meter**\*, or, with prior approval of the Director, another suitable measuring device, ☐ at each point of diversion/appropriation (new and existing) OR at each new point of diversion/appropriation ☐ with the exception that water rights issued to the Bureau of Reclamation or an irrigation district (or similar entity) are not subject to this condition.*

*b. The water user shall maintain the meters or measuring devices in good working order.*

*c. The water user shall allow the Watermaster access to the meters or measuring devices; provided however, where the meters or measuring devices are located within a private structure, the Watermaster shall request access upon reasonable notice.*

☐ Reservoir water use measurement: (if this condition is selected, also fill in the top sections of Page 4)

*a. Before water use may begin under this order, the water user shall install **staff gages**\*, or, with prior approval of the Director, other suitable measuring devices, that measure the entire range and stage between empty and full in each reservoir. Staff gages shall be United States Geological Survey style.*

*b. Before water use may begin under this order, if the reservoir is located in channel, weirs or other suitable measuring devices must be installed upstream and downstream of the reservoir, and, an adjustable outlet valve must be installed. The water user shall maintain such devices in good working order. A written waiver may be obtained, if in the judgment of the Director, the installation of weirs or other suitable measuring devices, or the adjustable outlet valve, will provide no public benefit.*

\* The following alternative device(s) should be substituted for the bold, underlined device in the above selected condition:

<input type="checkbox"/> Weir	<input type="checkbox"/> Submerged Orifice
<input type="checkbox"/> Parshall Flume	<input type="checkbox"/> Flow Restrictor
<input type="checkbox"/> Other: ____	

**Oregon Water Resources Department**  
**Measurement Condition Information for the Applicant**  
*(To be sent with the Draft Preliminary Determination or Final Order)*

Transfer #: T-

☐ In order to avoid enlargement of the right or injury to other rights, a \_\_\_\_\_ will  
be required to be installed prior to diversion of water, as a condition of this transfer:

☐ at each point of diversion/appropriation (new and existing) **OR**

☐ at each new point of diversion/appropriation.

For additional information, or to obtain approval of a different type of measurement device, the applicant should contact the area Watermaster:

Watermaster name:

District:

Address:

City/State/Zip:

Phone:

Email:

**Note:** If a device other than the one specified in the Preliminary Determination or Final Order is approved by the Watermaster, fill out and mail the form below to the Salem office.

\*\*\*\*\*

**Approval of an Alternate Measurement Device                      T-**  
*(to be filled out after consultation with the applicant, or after a site visit)*

On behalf of the Director, I authorize use of the following suitable **alternate measurement device**:

\_\_\_\_\_  
 \_\_\_\_\_

\_\_\_\_\_  
 Watermaster signature

\_\_\_\_\_  
 District

\_\_\_\_\_  
 Date

If this form is used for approval of an alternative measurement device, it must be mailed to:

Oregon Water Resources Department  
 725 Summer Street NE, Suite A  
 Salem, OR 97301-1266



# Oregon

Kate Brown, Governor

Water Resources Department  
725 Summer St NE, Suite A  
Salem, OR 97301  
(503) 986-0900  
Fax (503) 986-0904

November 8, 2022

ORCHARD HEIGHTS WATER ASSOCIATION  
4350 ORCHARD HEIGHTS NW  
SALEM, OR 97304

Reference: Application T-14115

On November 1, 2022, OWRD received your water right Permanent Transfer Application. The application was accompanied by \$1840.00. Our receipt number 139457 is enclosed.

By copy of this letter, we are asking the Watermaster for a report regarding the potential for injury to existing water rights which may be caused by the requested change. A review form will also be sent to our groundwater staff to determine whether the proposed well accesses the same source of water as the original well or as the original POD.

This application may require publication of a notice for two consecutive weeks in a newspaper with general circulation in the area where the water right is located. If it is determined that newspaper notice will be required, the Department will prepare the notice and notify you of the cost. You will be responsible for submitting payment to the Department prior to publication of the notice.

Except as provided under ORS 540.510(3) for municipalities, you may not use water from the new point of appropriation until a final order approving the transfer application has been issued by the Department. In order to avoid any possible forfeiture of the water right, you should continue to use the water as described by your existing water right.

If the land is sold before the application is approved, the buyer's consent to the application will be required unless a recorded deed or other legal document clearly established that the water right was not conveyed in the sale.

Refer to the following page for a chart showing the steps and expected timelines for the processing of your application.

If you have any questions, please contact the Transfer Section at (503) 979-9931.

Cc: Watermaster Dist. #22, Joel M. Plahn (*via email*)  
Ted Ressler, Agent  
Polk County Planning Department

Enclosure



**STATE OF OREGON  
WATER RESOURCES DEPARTMENT**

725 Summer St. N.E. Ste. A  
SALEM, OR 97301-4172

(503) 986-0900 / (503) 986-0904 (fax)

RECEIPT # **139457**

INVOICE # \_\_\_\_\_

RECEIVED FROM: Orchard Heights Water Assoc.

BY: \_\_\_\_\_

CASH: ☐ CHECK: # 9771 OTHER: (IDENTIFY) ☐ \_\_\_\_\_

APPLICATION	
PERMIT	
TRANSFER	<u>1-14115</u>

TOTAL REC'D \$ 1840.00

**1083 TREASURY 4170 WRD MISC CASH ACCT**

0407 COPIES	\$
OTHER: (IDENTIFY) _____	\$

0243 I/S Lease \_\_\_\_\_ 0244 Muni Water Mgmt. Plan \_\_\_\_\_ 0245 Cons. Water \_\_\_\_\_

**4270 WRD OPERATING ACCT**

**MISCELLANEOUS**

0407 COPY & TAPE FEES	\$
0410 RESEARCH FEES	\$
0408 MISC REVENUE: (IDENTIFY) _____	\$
TC162 DEPOSIT LIAB. (IDENTIFY) _____	\$
0240 EXTENSION OF TIME	\$

**WATER RIGHTS:**

0201 SURFACE WATER	EXAM FEE	0202	RECORD FEE
0203 GROUND WATER	\$	0204	\$
0205 TRANSFER	\$ <u>1840.00</u>		

**WELL CONSTRUCTION**

0218 WELL DRILL CONSTRUCTOR	EXAM FEE	0219	LICENSE FEE
LANDOWNER'S PERMIT	\$	0220	\$

OTHER (IDENTIFY) \_\_\_\_\_

**0536 TREASURY 0437 WELL CONST. START FEE**

0211 WELL CONST START FEE	\$	CARD#
0210 MONITORING WELLS	\$	CARD#

OTHER (IDENTIFY) \_\_\_\_\_

**0607 TREASURY 0467 HYDRO ACTIVITY LIC NUMBER**

0233 POWER LICENSE FEE (FW/WRD)	\$
0231 HYDRO LICENSE FEE (FW/WRD)	\$
HYDRO APPLICATION	\$

**TREASURY OTHER / RDX**

FUND \_\_\_\_\_ TITLE \_\_\_\_\_  
OBJ. CODE \_\_\_\_\_ VENDOR # \_\_\_\_\_  
DESCRIPTION \_\_\_\_\_ \$ \_\_\_\_\_

RECEIPT: **139457**

DATED: 11-1-2022 BY: Mindy Carlson

# Application for Permanent Water Right Transfer



Oregon Water Resources Department  
725 Summer Street NE, Suite A  
Salem, Oregon 97301-1266  
(503) 986-0900  
www.oregon.gov/OWRD

## Part 1 of 5 – Minimum Requirements Checklist

**This transfer application will be returned if Parts 1 through 5 and all required attachments are not completed and included.**

For questions, please call (503) 986-0900, and ask for Transfer Section.

RECEIVED

NOV 01 2022

OWRD

Check all items included with this application. (N/A = Not Applicable)

- ☒ Part 1 – Completed Minimum Requirements Checklist.
- ☒ Part 2 – Completed Transfer Application Map Checklist.
- ☒ Part 3 – Application Fee, payable by check to the Oregon Water Resources Department, and completed Fee Worksheet, page 3. Try the new online fee calculator at:  
[http://apps.wrd.state.or.us/apps/misc/wrd\\_fee\\_calculator](http://apps.wrd.state.or.us/apps/misc/wrd_fee_calculator).
- ☒ Part 4 – Completed Applicant Information and Signature.
- ☒ Part 5 – Information about Water Rights to be Transferred: **How many water rights are to be transferred? 1 List them here: Certificate 45205**

Please include a separate Part 5 for each water right. (See instructions on page 6)

**NOTE: A separate transfer application is required for each water right unless the criteria in OAR 690-380-3220 are met.**

### Attachments:

- ☒ Completed Transfer Application Map.
- ☒ Completed Evidence of Use Affidavit and supporting documentation.
- ☐ ☒ N/A Affidavit(s) of Consent from Landowner(s) (if the applicant does not own the land the water right is on.)
- ☐ ☒ N/A Supplemental Form D – For water rights served by or issued in the name of an irrigation district. Complete when the transfer applicant is not the irrigation district.
- ☒ ☐ N/A Oregon Water Resources Department's Land Use Information Form with approval and signature from each local land use authority in which water is to be diverted, conveyed, and/or used. Not required if water is to be diverted, conveyed, and/or used only on federal lands or if all of the following apply: a) a change in place of use only, b) no structural changes, c) the use of water is for irrigation only, and d) the use is located within an irrigation district or an exclusive farm use zone.
- ☒ ☐ N/A Water Well Report/Well Log for changes in point(s) of appropriation (well(s)) or additional point(s) of appropriation.
- ☐ ☒ N/A Geologist Report for a change from a surface water point of diversion to a ground water point of appropriation (well), if the proposed well is more than 500' from the surface water source and more than 1000' upstream or downstream from the point of diversion. See OAR 690-380-2130 for requirements and applicability.

### (For Staff Use Only)

#### WE ARE RETURNING YOUR APPLICATION FOR THE FOLLOWING REASON(S):

- |  |  |
|--|--|
| <input type="checkbox"/> Application fee not enclosed/insufficient | <input type="checkbox"/> Map not included or incomplete                  |
| <input type="checkbox"/> Land Use Form not enclosed or incomplete  | <input type="checkbox"/> Evidence of Use Form not enclosed or incomplete |
| <input type="checkbox"/> Additional signature(s) required          | <input type="checkbox"/> Part _____ is incomplete                        |

Other/Explanation \_\_\_\_\_

Staff: \_\_\_\_\_ 503- \_\_\_\_\_ Date: \_\_\_\_/\_\_\_\_/\_\_\_\_



## Part 2 of 5 – Transfer Application Map

Your transfer application will be returned if any of the map requirements listed below are not met.

Please be sure that the transfer application map you submit includes all the required items and matches the existing water right map. Check all boxes that apply.

- ☒ ☐ N/A Certified Water Right Examiner (CWRE) Stamp and Original Signature. For a list of CWREs, see [http://apps.wrd.state.or.us/apps/wr/cwre\\_license\\_view/](http://apps.wrd.state.or.us/apps/wr/cwre_license_view/). CWRE stamp and signature are not required for substitutions.
- ☐ ☒ N/A If more than three water rights are involved, separate maps are needed for each water right.
- ☒ Permanent quality printed with dark ink on good quality paper.
- ☒ The size of the map can be 8½ x 11 inches, 8½ x 14 inches, 11 x 17 inches, or up to 30 x 30 inches. For 30 x 30 inch maps, one extra copy is required.
- ☒ A north arrow, a legend, and scale.
- ☒ The scale of the map must be: 1 inch = 400 feet, 1 inch = 1,320 feet, the scale of the Final Proof/Claim of Beneficial Use Map (the map used when the permit was certificated), the scale of the county assessor map if the scale is not smaller than 1 inch = 1,320 feet, or a scale that has been pre-approved by the Department.
- ☒ Township, Range, Section, ¼ ¼, DLC, Government Lot, and other recognized public land survey lines.
- ☒ Tax lot boundaries (property lines) are required. Tax lot numbers are recommended.
- ☒ Major physical features including rivers and creeks showing direction of flow, lakes and reservoirs, roads, and railroads.
- ☒ Major water delivery system features from the point(s) of diversion/appropriation such as main pipelines, canals, and ditches.
- ☒ Existing place of use that includes separate hachuring for each water right, priority date, and use including number of acres in each quarter-quarter section, government lot, or in each quarter-quarter section as projected within government lots, donation land claims, or other recognized public land survey subdivisions. If less than the entirety of the water right is being changed, a separate hachuring is needed for lands left unchanged.
- ☐ ☒ N/A Proposed place of use that includes separate hachuring for each water right, priority date, and use including number of acres in each quarter-quarter section, government lot, or in each quarter-quarter section as projected within government lots, donation land claims, or other recognized public land survey subdivisions.
- ☒ Existing point(s) of diversion or well(s) with distance and bearing or coordinates from a recognized survey corner. This information can be found in your water right certificate or permit.
- ☒ ☐ N/A If you are proposing a change in point(s) of diversion or well(s), show the proposed location and label it clearly with distance and bearing or coordinates. If GPS coordinates are used, latitude-longitude coordinates may be expressed as either degrees-minutes-seconds with at least one digit after the decimal (example – 42°32'15.5") or degrees-decimal with five or more digits after the decimal (example – 42.53764°).

14115



### Part 3 of 5 – Fee Worksheet

FEE WORKSHEET for PERMANENT TRANSFER (except Substitution)			
1	Base Fee (includes one type of change to one water right for up to 1 cfs)	1	\$1,360
	<p>Types of change proposed:</p> <p><input type="checkbox"/> Place of Use      <input type="checkbox"/> Character of Use      <input checked="" type="checkbox"/> Point of Diversion/Appropriation</p> <p>Number of above boxes checked = <u>1 (2a)</u></p> <p>Subtract 1 from the number in line 2a = <u>0 (2b)</u> <i>If only one change, this will be 0</i></p>		
2	Multiply line 2b by \$1090 and enter »	2	\$0
	<p>Number of water rights included in transfer <u>1 (3a)</u></p> <p>Subtract 1 from the number in 3a above: <u>0 (3b)</u> <i>If only one water right this will be 0</i></p>		
3	Multiply line 3b by \$610 and enter »	3	\$0
	<p>Do you propose to add or change a well, or change from a surface water POD to a well?</p> <p><input type="checkbox"/> No: enter 0    <input checked="" type="checkbox"/> Yes: enter \$480 for the 1<sup>st</sup> well to be added or changed <u>\$480 (4a)</u></p> <p>Do you propose to add or change additional wells?</p> <p><input checked="" type="checkbox"/> No: enter 0    <input type="checkbox"/> Yes: multiply the number of additional wells by \$410 _____ (4b)</p>		
4	Add line 4a to line 4b and enter »	4	\$480
	<p>Do you propose to change the place of use or character of use?</p> <p><input checked="" type="checkbox"/> No: enter 0 on line 5</p> <p><input type="checkbox"/> Yes: enter the cfs for the portions of the rights to be transferred (see below*): _____ (5a)</p> <p>Subtract 1.0 from the number in 5a above: _____ (5b)</p> <p>If 5b is 0 or less, enter 0 on line 5 »</p> <p>If 5b is greater than 0, round up to the nearest whole number: _____ (5c) and multiply 5c by \$410, then enter on line 5 »</p>		
5		5	\$0
6	Add entries on lines 1 through 5 above » » » » » » » » » » Subtotal:	6	\$1,840
	<p>Is this transfer:</p> <p><input type="checkbox"/> necessary to complete a project funded by the Oregon Watershed Enhancement Board (OWEB) under ORS 541.932?</p> <p><input type="checkbox"/> endorsed in writing by ODFW as a change that will result in a net benefit to fish and wildlife habitat?</p> <p>If one or more boxes is checked, multiply line 6 by 0.5 and enter on line 7 »</p>		
7	If no box is applicable, enter 0 on line 7 »	7	\$0
8	Subtract line 7 from line 6 » <b>Transfer Fee:</b>	8	<b>\$1,840</b>

\*Example for Line 5a calculation to transfer 45.0 acres of Primary Certificate 12345 (total 1.25 cfs for 100 acres) and 45.0 acres of Supplemental Certificate 87654 (1/80 cfs per acre) on the same land:

1. For irrigation calculate cfs for each water right involved as follows:
  - a. Divide total authorized cfs by total acres in the water right (for C12345,  $1.25 \text{ cfs} \div 100 \text{ ac}$ ); then multiply by the number of acres to be transferred to get the transfer cfs ( $\times 45 \text{ ac} = 0.56 \text{ cfs}$ ).
  - b. If the water right certificate does not list total cfs, but identifies the allowable use as 1/40 or 1/80 of a cfs per acre; multiply number of acres proposed for change by either 0.025 (1/40) or 0.0125 (1/80). (For C87654,  $45.0 \text{ ac} \times 0.0125 \text{ cfs/ac} = 0.56 \text{ cfs}$ )
2. Add cfs for the portions of water rights on all the land included in the transfer; however **do not count cfs for supplemental rights on acreage for which you have already calculated the cfs fee for the primary right on the same land**. The fee should be assessed only once for each "on the ground" acre included in the transfer. (In this example, blank 5a would be only 0.56 cfs, since both rights serve the same 45.0 acres. Blank 5b would be 0 and Line 5 would then also become 0).

FEE WORKSHEET for SUBSTITUTION			
1	Base Fee (includes change to one well)	1	\$990.00
	Number of wells included in substitution _____ (2a) Subtract 1 from the number in 2a above: _____ (2b) <i>If only one well this will be 0</i>		
2	Multiply line 2b by \$480 and enter » » » » » » » » » » » » » » »	2	
3	Add entries on lines 1 through 2 above » » » » » » <b>Fee for Substitution:</b>	3	

14115

RECEIVED

NOV 01 2022

### TACS

OWRD

## Part 4 of 5 – Applicant Information and Signature

### Applicant Information

APPLICANT/BUSINESS NAME <b>Orchard Heights Water Association</b>			PHONE NO. <b>503-428-8703</b>	ADDITIONAL CONTACT NO. -
ADDRESS <b>4350 Orchard Heights Road NW</b>			FAX NO. -	
CITY <b>Salem</b>	STATE <b>OR</b>	ZIP <b>97304</b>	E-MAIL <b>DSPAAD@YAHOO.COM</b>	
BY PROVIDING AN E-MAIL ADDRESS, CONSENT IS GIVEN TO RECEIVE ALL CORRESPONDENCE FROM THE DEPARTMENT ELECTRONICALLY. COPIES OF THE FINAL ORDER DOCUMENTS WILL ALSO BE MAILED.				

**Agent Information** – The agent is authorized to represent the applicant in all matters relating to this application.

AGENT/BUSINESS NAME <b>Ted Ressler, RG, CWRE / Summit Water Resources LLC</b>			PHONE NO. <b>503-701-4535</b>	ADDITIONAL CONTACT NO. -
ADDRESS <b>PO Box 11268</b>			FAX NO. -	
CITY <b>Portland</b>	STATE <b>OR</b>	ZIP <b>97211</b>	E-MAIL <b>tressler@summitwr.com</b>	
BY PROVIDING AN E-MAIL ADDRESS, CONSENT IS GIVEN TO RECEIVE ALL CORRESPONDENCE FROM THE DEPARTMENT ELECTRONICALLY. COPIES OF THE FINAL ORDER DOCUMENTS WILL ALSO BE MAILED.				

Explain in your own words what you propose to accomplish with this transfer application, and why:  
The Orchard Heights Water Association wishes to add a point of appropriation (Lafayette Well, POLK-1789) to Certificate 45205 to more efficiently use the authorized capacity of Certificate 45205 to reliably provide drinking water to the Association's customers.

If you need additional space, continue on a separate piece of paper and attach to the application as "Attachment 1".

### Check One Box

- ☐ By signing this application, I understand that, upon receipt of the draft preliminary determination and prior to Department approval of the transfer, I will be required to provide landownership information and evidence that I am authorized to pursue the transfer as identified in OAR 690-380-4010(5); **OR**
- ☒ I affirm the applicant is a municipality as defined in ORS 540.510(3)(b) and that the right is in the name of the municipality or a predecessor; **OR**
- ☐ I affirm the applicant is an entity with the authority to condemn property and is acquiring by condemnation the property to which the water right proposed for transfer is appurtenant and have supporting documentation.

**RECEIVED**

**NOV 01 2022**

**OWRD**



By my signature below, I confirm that I understand:

- Prior to Department approval of the transfer application, I may be required to submit payment to the Department for publication of a notice in a newspaper with general circulation in the area where the water right is located, once per week for two consecutive weeks. If more than one qualifying newspaper is available, I suggest publishing the notice in the following newspaper: Statesman Journal.
- Amendments to the application may only be made in response to the Department's Draft Preliminary Determination (DPD). The applicant will have a period of at least 30 days to amend the application to address any issues identified by the Department in the DPD, or to withdraw the application. Note that amendments may be subject to additional fees, pursuant to ORS 536.050.
- Failure to complete an approved change in place of use and/or change in character of use, will result in loss of the water right (OAR 690-380-6010).
- Refunds may only be granted upon request and, as set forth in ORS 536.050(4)(a), if the Director determines that a refund of all or part of a fee is appropriate in the interests of fairness to the public or necessary to correct an error of the Department.

I (we) affirm that the information contained in this application is true and accurate.

  
  
Applicant signature

Doug Priest  
Print Name (and Title if applicable)

9-19-2022  
Date

\_\_\_\_\_  
Applicant signature

\_\_\_\_\_  
Print Name (and Title if applicable)

\_\_\_\_\_  
Date

Is the applicant the sole owner of the land on which the water right, or portion thereof, proposed for transfer is located? ☐ Yes ☐ No\* **N/A – the applicant is a municipality as defined in ORS 540.510(3)(b); Certificate 45205 is used to supply municipal water through the Association's distribution system to the Association's customers.**

*\*If NO, include signatures of all deeded landowners (and mailing and/or e-mail addresses if different than the applicant's) or attach affidavits of consent (and mailing and/or e-mail addresses) from all landowners or individuals/entities to which the water right(s) were conveyed.*

Check the following boxes that apply:

- ☒ The applicant is responsible for completion of change(s). Notices and correspondence should continue to be sent to the applicant.
- ☐ The receiving landowner will be responsible for completing the proposed change(s) after the final order is issued. Copies of notices and correspondence should be sent to this landowner.
- ☐ Both the receiving landowner and applicant will be responsible for completion of change(s). Copies of notices and correspondence should be sent to this landowner and the applicant.

At this time, are the lands in this transfer application in the process of being sold? ☐ Yes ☒ No

If YES, and you know who the new landowner will be, please complete the receiving landowner information table below. If you do not know who the new landowner will be, then a request for assignment will have to be filed for at a later date.

If a property sells, the certificated water right(s) located on the land belong to the new owner, unless a sale agreement or other document states otherwise. For more information see:

[https://www.oregon.gov/owrd/WRDFormsPDF/Transfer\\_Property\\_Transactions.pdf](https://www.oregon.gov/owrd/WRDFormsPDF/Transfer_Property_Transactions.pdf)

RECEIVED

NOV 01 2022

OWRD

RECEIVING LANDOWNER NAME			PHONE NO.	ADDITIONAL CONTACT NO.
ADDRESS			FAX NO.	
CITY	STATE	ZIP	E-MAIL	
Describe any special ownership circumstances:				
The confirming Certificate shall be issued in the name of: <input type="checkbox"/> Applicant <input type="checkbox"/> Receiving Landowner				

☐ Check here if any of the water rights proposed for transfer are or will be located within or served by an irrigation or other water district. (Tip: Complete and attach Supplemental Form D.)

IRRIGATION DISTRICT NAME	ADDRESS	
CITY	STATE	ZIP

☐ Check here if water for any of the rights supplied under a water service agreement or other contract for stored water with a federal agency or other entity.

ENTITY NAME	ADDRESS	
CITY	STATE	ZIP

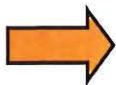

To meet State Land Use Consistency Requirements, you must list all county, city, municipal corporation, or tribal governments within whose jurisdiction water will be diverted, conveyed or used.

ENTITY NAME <b>Polk County</b>	ADDRESS <b>850 Main Street</b>	
CITY <b>Dallas</b>	STATE <b>OR</b>	ZIP <b>97338</b>

ENTITY NAME	ADDRESS	
CITY	STATE	ZIP

**RECEIVED**  
**NOV 01 2022**  
**OWRD**

**14115**



## Part 5 of 5 – Water Right Information

Please use a separate Part 5 for each water right being changed. See instructions on page 6, to copy and paste additional Part 5s, or to add additional rows to tables within the form.

**CERTIFICATE # 45205**

**RECEIVED**

**NOV 01 2022**

### Description of Water Delivery System

System capacity: 0.15 cubic feet per second (cfs) OR  
 \_\_\_\_\_ gallons per minute (gpm)

**OWRD**

Describe the current water delivery system or the system that was in place at some time within the last five years. Include information on the pumps, canals, pipelines, and sprinklers used to divert, convey, and apply the water at the authorized place of use. Existing water system infrastructure related to the beneficial use of water under Certificate 45205 includes two wells (Well #1 POLK-1786, Well #2 POLK-1787), two 25,000 gallon steel reservoirs, a booster pump, and 37,000 feet of piping to deliver municipal water through the Association's water distribution system to the Association's customers.

**Table 1. Location of Authorized and Proposed Point(s) of Diversion (POD) or Appropriation (POA)**

(Note: If the POD/POA name is not specified on the certificate, assign it a name or number here.)

POD/POA Name or Number	Is this POD/POA Authorized on the Certificate or is it Proposed?	If POA, OWRD Well Log ID# (or Well ID Tag # L-__)	Twp		Rng		Sec	¼ ¼		Tax Lot, DLC or Gov't Lot	Measured Distances (from a recognized survey corner)
Well #1*	<input checked="" type="checkbox"/> Authorized <input type="checkbox"/> Proposed	POLK-1786	7	S	3	W	18	SW	NW	601	South 3 degrees, 12 minutes East 2308 feet from the NW corner, Section 18
Well #2*	<input checked="" type="checkbox"/> Authorized <input type="checkbox"/> Proposed	POLK-1787	7	S	3	W	18	SW	NW	601	South 5 degrees, 14 minutes East 2412 feet from the NW corner, Section 18
Lafayette Well	<input type="checkbox"/> Authorized <input checked="" type="checkbox"/> Proposed	POLK-1789	7	S	3	W	18	SW	NW	600	North 62 degrees, 54 minutes east, 780 feet from W quarter corner of Section 18

**Notes:**

\* Well No. 1 of Certificate 45205 is called "Well #2" by the Association. Well No. 2 of Certificate 45205 is called "Well #1" by the Association.

**Check all type(s) of change(s) proposed below (change "CODES" are provided in parentheses):**

- |  |  |
|--|--|
| <input type="checkbox"/> Place of Use (POU)                            | <input type="checkbox"/> Supplemental Use to Primary Use (S to P)            |
| <input type="checkbox"/> Character of Use (USE)                        | <input type="checkbox"/> Point of Appropriation/Well (POA)                   |
| <input type="checkbox"/> Point of Diversion (POD)                      | <input checked="" type="checkbox"/> Additional Point of Appropriation (APOA) |
| <input type="checkbox"/> Additional Point of Diversion (APOD)          | <input type="checkbox"/> Substitution (SUB)                                  |
| <input type="checkbox"/> Surface Water POD to Ground Water POA (SW/GW) | <input type="checkbox"/> Government Action POD (GOV)                         |

14115

Will all of the proposed changes affect the entire water right?

- ☒ Yes Complete only the Proposed ("to" or "on" lands) section of Table 2 on the next page. Use the "CODES" listed above to describe the proposed changes.
- ☐ No Complete all of Table 2 to describe the portion of the water right to be changed.

RECEIVED

NOV 01 2022

OWRD

14115

Please use and attach additional pages of Table 2 as needed.  
See page 6 for instructions.

Do you have questions about how to fill-out the tables?  
Contact the Department at 503-986-0900 and ask for Transfer Staff.

**Table 2. Description of Changes to Water Right Certificate # 45205**

List the change proposed for the acreage in each ¼ ¼. If more than one change is proposed, specify the acreage associated with each change.  
If there is more than one POD/POA involved in the proposed changes, specify the acreage associated with each POD/POA.

AUTHORIZED (the "from" or "off" lands) The listing that appears on the certificate BEFORE PROPOSED CHANGES List only that part or portion of the water right that will be changed.										Proposed Changes (see "CODES" from previous page)	PROPOSED (the "to" or "on" lands) The listing as it would appear AFTER PROPOSED CHANGES are made.										
Twp	Rng	Sec	¼ ¼	Tax Lot	Gvt Lot or DLC	Acre	Type of USE listed on Certificate	POD(s) or POA(s) (name or number from Table 1)	Priority Date		Twp	Rng	Sec	¼ ¼	Tax Lot	Gvt Lot or DLC	Acre	New Type of USE	POD(s)/ POA(s) to be used (from Table 1)	Priority Date	
										APOA	7	S	3	W 17	NW	NE		No change	Well #1, Well #2, Lafayette Well	6/17/1970	
										APOA	7	S	3	W 17	ALL	NW		"			
										APOA	7	S	3	W 17	N1/2	SW		"			
										APOA	7	S	3	W 17	NE	SE		"			
										APOA	7	S	3	W 18	W1/2	NE		"			
										APOA	7	S	3	W 18	ALL	NW		"			
										APOA	7	S	3	W 18	N1/2	SW		"			
										APOA	7	S	3	W 18	SW	SW		"			
										APOA	7	S	3	W 18	N1/2	SE		"			
										APOA	7	S	4	W 13	N1/2	NE		"			
										APOA	7	S	4	W 13	N1/2	NW		"			
										APOA	7	S	4	W 13	NW	SW		"			
										APOA	7	S	4	W 13	S1/2	SW		"			
										APOA	7	S	4	W 13	S1/2	SE		"			
										APOA	7	S	4	W 14	NE	NE		"			
										APOA	7	S	4	W 14	NE	SE		"			
TOTAL ACRES:											TOTAL ACRES:						NA				

Additional remarks: The applicant is requesting to add an additional point of appropriation. No changes to the place of use or designated beneficial use are requested.

RECEIVED

NOV 01 2022

OWRD



**For Place of Use or Character of Use Changes**

Are there other water right certificates, water use permits or ground water registrations associated with the "from" or the "to" lands? ☐ Yes ☐ No

If YES, list the certificate, water use permit, or ground water registration numbers: \_\_\_\_\_.



Pursuant to ORS 540.510, any "layered" water use such as an irrigation right that is supplemental to a primary right proposed for transfer must be included in the transfer or be cancelled. Any change to a ground water registration must be filed separately in a ground water registration modification application.

**For Substitution (ground water supplemental irrigation will be substituted for surface water primary irrigation)**

Ground water supplemental Permit or Certificate # \_\_\_\_\_;

Surface water primary Certificate # \_\_\_\_\_.

**For a change from Supplemental Irrigation Use to Primary Irrigation Use**

Identify the primary certificate to be cancelled. Certificate # \_\_\_\_\_

**For a change in point(s) of appropriation (well(s)) or additional point(s) of appropriation:**

- ☒ Well log(s) are attached for each authorized and proposed well(s) that are clearly labeled and associated with the corresponding well(s) in Table 1 above and on the accompanying application map.

**Tip:** You may search for well logs on the Department's web page at:

[http://apps.wrd.state.or.us/apps/gw/well\\_log/Default.aspx](http://apps.wrd.state.or.us/apps/gw/well_log/Default.aspx)

**AND/OR**

- ☐ Describe the construction of the authorized and proposed well(s) in Table 3 for any wells that do not have a well log. For *proposed wells not yet constructed or built*, provide "a best estimate" for each requested information element in the table. The Department recommends you consult a licensed well driller, geologist, or certified water right examiner to assist with assembling the information necessary to complete Table 3.

**Table 3. Construction of Point(s) of Appropriation**

Any well(s) in this listing must be clearly tied to corresponding well(s) described in Table 1 and shown on the accompanying application map. Failure to provide the information will delay the processing of your transfer application until it is received. The information is necessary for the department to assess whether the proposed well(s) will access the same source aquifer as the authorized point(s) of appropriation (POA). The Department is prohibited by law from approving POA changes that do not access the same source aquifer.

Proposed or Authorized POA Name or Number	Is well already built? (Yes or No)	If an existing well: OWRD Well ID Tag No. L-____	Total well depth	Casing Diameter	Casing Intervals (feet)	Seal depth(s) (intervals)	Perforated or screened intervals (in feet)	Static water level of completed well (in feet)	Source aquifer (sand, gravel, basalt, etc.)	Well-specific rate (cfs or gpm). If less than full rate of water right
---	------------------------------------	--	------------------	-----------------	-------------------------	---------------------------	--	--	---	--

See Attachment 3 for Well Logs

RECEIVED

NOV 01 2022

14115

OWRD

RECEIVED

NOV 01 2022

OWRD

STATE OF OREGON  
COUNTY OF POLK  
**CERTIFICATE OF WATER RIGHT**

**This Is to Certify, That** ORCHARD HEIGHTS WATER ASSOCIATION, INC.

of 320 Oregon Building, Salem, State of Oregon, 97301, has made proof to the satisfaction of the Water Resources Director, of a right to the use of the waters of two wells

a tributary of Winslow Gulch for the purpose of quasi-municipal

under Permit No. G-4823 and that said right to the use of said waters has been perfected in accordance with the laws of Oregon; that the priority of the right hereby confirmed dates from June 17, 1970

that the amount of water to which such right is entitled and hereby confirmed, for the purposes aforesaid, is limited to an amount actually beneficially used for said purposes, and shall not exceed 0.15 cubic foot per second, being 0.075 c.f.s. from each well

or its equivalent in case of rotation, measured at the point of diversion from the stream. The point of diversion is located in the SW $\frac{1}{4}$  NW $\frac{1}{4}$ , Section 18, T. 7 S., R. 3 W., W. M., Well No. 1-South 5 degrees 14 minutes East 2412 feet; Well No. 2-South 3 degrees, 12 minutes East 2308 feet, both from the NW Corner, Section 18

The amount of water used for irrigation, together with the amount secured under any other right existing for the same lands, shall be limited to -----of one cubic foot per second per acre,

and shall conform to such reasonable rotation system as may be ordered by the proper state officer.

A description of the place of use under the right hereby confirmed, and to which such right is appurtenant, is as follows:

NW $\frac{1}{4}$ NE $\frac{1}{4}$	NE $\frac{1}{4}$ NE $\frac{1}{4}$
NW $\frac{1}{4}$	NE $\frac{1}{4}$ NW $\frac{1}{4}$
N $\frac{1}{2}$ SW $\frac{1}{4}$	NW $\frac{1}{4}$ SW $\frac{1}{4}$
NE $\frac{1}{4}$ SE $\frac{1}{4}$	S $\frac{1}{2}$ SW $\frac{1}{4}$
Section 17	S $\frac{1}{2}$ SE $\frac{1}{4}$
W $\frac{1}{2}$ NE $\frac{1}{4}$	Section 13
NW $\frac{1}{4}$	NE $\frac{1}{4}$ NE $\frac{1}{4}$
N $\frac{1}{2}$ SW $\frac{1}{4}$	NE $\frac{1}{4}$ SE $\frac{1}{4}$
SW $\frac{1}{4}$ SW $\frac{1}{4}$	Section 14
N $\frac{1}{2}$ SE $\frac{1}{4}$	T. 7 S., R. 4 W., W. M.
Section 18	
T. 7 S., R. 3 W., W. M.	

The right to the use of the water for the purposes aforesaid is restricted to the lands or place of use herein described, and is subject to the existing minimum flow policies established by the Water Policy Review Board.

WITNESS the signature of the Water Resources Director, affixed

this date. January 31, 1978

James E. Sexson

Water Resources Director



STATE ENGINEER  
Salem, Oregon

OBSERVATION WELL  
Well Record

STATE WELL NO. 7/3W-18E(2)

OHWA Well 1

POLK COUNTY Polk

APPLICATION NO. 1786

OWNER: Orchard Heights Water Assoc.

MAILING

ADDRESS:

Rt. 1, Box 135

LOCATION OF WELL: Owner's No. #2

CITY AND

STATE:

Salem, Oregon

SW 1/4 NW 1/4 Sec. 18 T. 7 S. R. 3 W., W.M.

Bearing and distance from section or subdivision

corner 4 miles W. of the Center St. Bridge  
on Orchard Heights Rd.

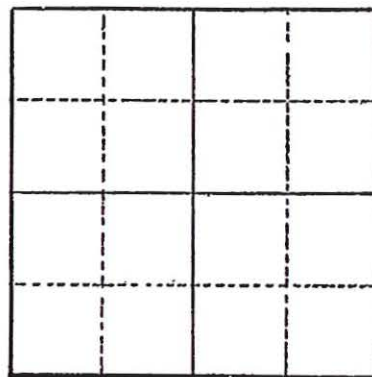

Section 18

Altitude at well 600 ft.

TYPE OF WELL: Drilled Date Constructed 1952

Depth drilled 285' Depth cased 162'

CASING RECORD:

8 inch

FINISH:

AQUIFERS:

WATER LEVEL:

100 ft.

PUMPING EQUIPMENT: Type Berkeley 6 bowls H.P. 10  
Capacity 40 G.P.M.

WELL TESTS:

Drawdown ft. after hours G.P.M.

Drawdown ft. after hours G.P.M.

USE OF WATER Domestic Temp. °F. 19

SOURCE OF INFORMATION Related registration statement

DRILLER or DIGGER

ADDITIONAL DATA:

Log Water Level Measurements Chemical Analysis Aquifer Test

REMARKS:

RECEIVED

14115

NOV 01 2022

OWRD

STATE ENGINEER  
Salem, Oregon

OBSERVATION WELL

Well Record

STATE WELL NO. 7/3W-18E(1)

COUNTY Polk

APPLICATION NO. 1787

OHWA Well 2

OWNER: Orchard Heights Water Association MAILING ADDRESS: Rt. 1, Box 135

LOCATION OF WELL: Owner's No. #1 CITY AND STATE: Salem, Oregon

SW 1/4 NW 1/4 Sec. 18 T. 7 S., R. 3 W., W.M.

Bearing and distance from section or subdivision

corner 1/4 miles W. of Center St. bridge  
on Orchard Heights Rd.

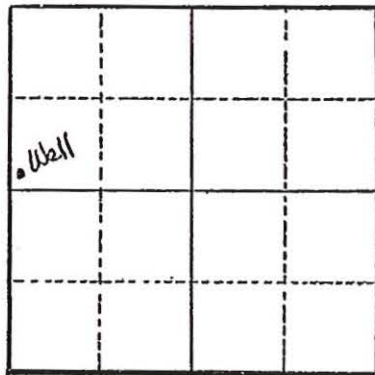

Section 18

Altitude at well 600 ft.

TYPE OF WELL: Drilled Date Constructed 1952

Depth drilled 187' Depth cased 65'

CASING RECORD:

8 inch from top to 65 ft.

RECEIVED

NOV 01 2022

FINISH:

OWRD

AQUIFERS:

WATER LEVEL:

100 ft.

PUMPING EQUIPMENT: Type Berkeley H.P. 7 1/2  
Capacity 40 G.P.M.

WELL TESTS:

Drawdown ft. after hours G.P.M.

Drawdown ft. after hours G.P.M.

USE OF WATER Domestic Temp. °F. 19

SOURCE OF INFORMATION Related registration statement

DRILLER or DIGGER Studebaker Bros.

ADDITIONAL DATA:

Log Water Level Measurements Chemical Analysis Aquifer Test

REMARKS:

14115



NOTICE TO WATER WELL CONTRACTOR  
The original and first copy  
of this report are to be  
filed with the

RECEIVED  
NOV 21 1972

WATER WELL REPORT

STATE ENGINEER, SALEM, OREGON 97310  
within 30 days from the date  
of well completion.

STATE OF OREGON  
(Please type or print)  
STATE ENGINEER  
SALEM, ORE. (Do not write above this line)  
OHWA Lafayette Well

State Well No. 75/3W-18

State Permit No. 6-6257

(1) OWNER:

Name William Staats  
Address ORCHARD HEIGHTS RD. NW.  
SALEM, ORE.

(2) TYPE OF WORK (check):

New Well ☒ Deepening ☐ Reconditioning ☐ Abandon ☐

If abandonment, describe material and procedure in Item 12.

(3) TYPE OF WELL:

Rotary ☒ Driven ☐  
Cable ☐ Jetted ☐  
Dug ☐ Bored ☐

(4) PROPOSED USE (check):

Domestic ☒ Industrial ☐ Municipal ☐  
Irrigation ☐ Test Well ☐ Other ☐

(5) CASING INSTALLED:

Threaded ☐ Welded ☒  
6" Diam. from 21 ft. to 79 ft. Gage 1250  
" Diam. from ft. to ft. Gage  
" Diam. from ft. to ft. Gage

(6) PERFORATIONS:

Perforated? ☒ Yes ☐ No  
Type of perforator used TORCH  
Size of perforations 28 in. by 6 in.  
28 perforations from 69 ft. to 79 ft.  
perforations from ft. to ft.  
perforations from ft. to ft.

(7) SCREENS:

Well screen installed? ☐ Yes ☒ No  
Manufacturer's Name  
Type Model No.  
Diam. Slot size Set from ft. to ft.  
Diam. Slot size Set from ft. to ft.

(8) WELL TESTS:

Drawdown is amount water level is  
lowered below static level  
Was a pump test made? ☐ Yes ☒ No If yes, by whom?  
Yield: gal./min. with ft. drawdown after hrs.  
AIR " " " "  
Pump test 4.5 gal./min. with 40 ft. drawdown after 1 hrs.  
Artesian flow g.p.m.  
Temperature of water Depth artesian flow encountered ft.

(9) CONSTRUCTION:

Well seal—Material used CEMENT  
Well sealed from land surface to 40 ft.  
Diameter of well bore to bottom of seal 9 in.  
Diameter of well bore below seal 6 in.  
Number of sacks of cement used in well seal 4 sacks  
Number of sacks of bentonite used in well seal sacks  
Brand name of bentonite  
Number of pounds of bentonite per 100 gallons  
of water lbs./100 gals.  
Was a drive shoe used? ☐ Yes ☒ No Plugs Size: location ft.  
Did any strata contain unusable water? ☐ Yes ☒ No  
Type of water? depth of strata  
Method of sealing strata off  
Was well gravel packed? ☒ Yes ☐ No Size of gravel: 3/4" round  
Gravel placed from 40 ft. to 79 ft.

(10) LOCATION OF WELL:

County POLK Driller's well number  
1/4 1/4 Section 18 T. 9S R. 3, W W.M.  
Bearing and distance, from section or subdivision corner  
WELL NO. 1

(11) WATER LEVEL: Completed well.

Depth at which water was first found 60 ft.  
Static level 40 ft. below land surface. Date 11-9-72  
Artesian pressure lbs. per square inch. Date

(12) WELL LOG:

Diameter of well below casing 5 ft.  
Depth drilled 83 ft. Depth of completed well 83 ft.

Formation: Describe color, texture, grain size and structure of materials;  
and show thickness and nature of each stratum and aquifer penetrated,  
with at least one entry for each change of formation. Report each change in  
position of Static Water Level and indicate principal water-bearing strata.

MATERIAL	From	To	SWL
RED-CLAY	0	27	
TAN-DECOMPOSED ROCK (SOFT)	27	59	
BLACK-BASALT BOULDER	59	61	
BROWN-DECOMPOSED ROCK (SOFT)	61	70	
BROWN+BLACK-PARTLY DECOMPOSED TO SOLID BASALT	70	83	

RECEIVED

NOV 01 2022

OWRD

Work started 11-7-1972 Completed 11-9-1972  
Date well drilling machine moved off of well 11-9-1972

Drilling Machine Operator's Certification:

This well was constructed under my direct supervision.  
Materials used and information reported above are true to my  
best knowledge and belief.

[Signed] Maxine West Date 11-17, 1972  
(Drilling Machine Operator)

Drilling Machine Operator's License No. 188

Water Well Contractor's Certification:

This well was drilled under my jurisdiction and this report is  
true to the best of my knowledge and belief.

Name William R. West  
(Person, firm or corporation) (Type or print)

Address 5945 Clatsop St. SE  
SALEM

[Signed] William R. West  
(Water Well Contractor)

Contractor's License No. 37 Date 11-17-1972



# Application for Water Right Transfer

## Evidence of Use Affidavit



Oregon Water Resources Department  
725 Summer Street NE, Suite A  
Salem, Oregon 97301-1266  
(503) 986-0900  
www.wrd.state.or.us

Please print legibly or type. Be as specific as possible. Attach additional pages if you need more spacing.  
Supporting documentation must be attached.

State of Oregon )  
 ) ss  
County of POLK

I, DOUG PRIEST, in my capacity as BOARD MEMBER OF THE ORCHARD HEIGHTS WATER ASSOCIATION,  
mailing address 4350 ORCHARD HEIGHTS ROAD NW SALEM, OR 97304  
telephone number (503)589-2193, being first duly sworn depose and say:

RECEIVED  
NOV 01 2022  
OWRD

1. My knowledge of the exercise or status of the water right is based on (check):

☒ Personal observation ☒ Professional expertise

2. I attest that:

☒ Water was used during the previous five years on the **entire** place of use for  
Certificate # 45205; OR

☐ My knowledge is specific to the use of water at the following locations within the last five years:

Certificate #	Township	Range	Mer	Sec	¼ ¼	Gov't Lot or DLC	Acres (if applicable)

OR

- ☐ Confirming Certificate # \_\_\_\_\_ has been issued within the past five years; OR
- ☐ Part or all of the water right was leased instream at some time within the last five years. The instream lease number is: \_\_\_\_\_ (Note: If the entire right proposed for transfer was not leased, additional evidence of use is needed for the portion not leased instream.); OR
- ☐ The water right is not subject to forfeiture and documentation that a presumption of forfeiture for non-use would be rebutted under ORS 540.610(2) is attached.
- ☐ Water has been used at the actual current point of diversion or appropriation for more than 10 years for Certificate # \_\_\_\_\_ (For Historic POD/POA Transfers)

(continues on reverse side)

14115

3. The water right was used for: (e.g., crops, pasture, etc.): QUASI-MUNICIPAL USE

4. I understand that if I do not attach one or more of the documents shown in the table below to support the above statements, my application will be considered incomplete.

[Signature]  
Signature of Affiant

9-22-2022  
Date

State of Oregon, County of Marion 22<sup>nd</sup>  
Signed and sworn to (or affirmed) before me this 22 day of September 2022.

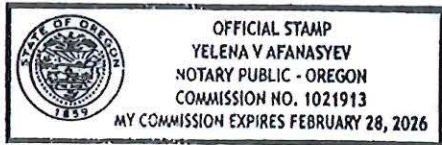

[Signature]  
Notary Public for Oregon

My Commission Expires: Feb. 28, 2026

Supporting Documents	Examples
<input type="checkbox"/> Copy of a water right certificate that has been issued within the last five years. (not a remaining right certificate)	Copy of <b>confirming</b> water right certificate that shows issue date
<input type="checkbox"/> Copies of receipts from sales of irrigated crops or for expenditures related to use of water	<ul style="list-style-type: none"><li>• Power usage records for pumps associated with irrigation use</li><li>• Fertilizer or seed bills related to irrigated crops</li><li>• Farmers Co-op sales receipt</li></ul>
<input checked="" type="checkbox"/> Records such as FSA crop reports, irrigation district records, NRCS farm management plan, or records of other water suppliers  See attached production records from the Orchard Heights Water Association's 2020 Water System Master Plan	<ul style="list-style-type: none"><li>• District assessment records for water delivered</li><li>• Crop reports submitted under a federal loan agreement</li><li>• Beneficial use reports from district</li><li>• IRS Farm Usage Deduction Report</li><li>• Agricultural Stabilization Plan</li><li>• CREP Report</li></ul>
<input type="checkbox"/> Aerial photos containing sufficient detail to establish location and date of photograph	Multiple photos can be submitted to resolve different areas of a water right. If the photograph does not print with a "date stamp" or without the source being identified, the date of the photograph and source should be added.  Sources for aerial photos: OSU – <a href="http://www.oregonexplorer.info/imagery">www.oregonexplorer.info/imagery</a> OWRD – <a href="http://www.wrd.state.or.us">www.wrd.state.or.us</a> Google Earth – <a href="http://earth.google.com">earth.google.com</a> TerraServer – <a href="http://www.terra-server.com">www.terra-server.com</a>
<input type="checkbox"/> Approved Lease establishing beneficial use within the last 5 years	Copy of instream lease or lease number

RECEIVED

NOV 01 2022

OWRD

14115



## Well 1 &amp; 2 Production Records - OHWA 2020 Water System Master Plan

OWRD

A summary of the water consumed (in gallons) and lost for Years 2016-2018 was compiled and is shown below:

**Table 4**  
**2016-2018 Water Consumed In Gallons**

Month/Year	Master Meter	Salem Pump Station	Total Production	Metered Sales	Unaccounted Water (Percent)	Number of Members
January, 2016	1,310,736	714,340	2,025,076	1,840,000	9.2%	175
February, 2016	869,205	18,700	887,905	161,000	N/A	176
March, 2016	1,001,434	166,056	1,167,490	1,540,000	N/A	176
April, 2016	1,053,174	47,124	1,100,298	933,000	15.3%	176
May, 2016	1,586,030	50,116	1,636,146	1,369,000	16.4%	177
June, 2016	1,783,976	636,548	2,420,524	2,090,000	13.7%	178
July, 2016	1,165,808	1,533,400	2,699,208	2,460,000	8.9%	178
August, 2016	1,369,138	1,564,068	2,933,206	2,436,000	17.0%	178
September, 2016	885,470	608,872	1,494,342	1,208,000	19.2%	178
October, 2016	760,888	769,296	1,530,184	593,000	N/A	178
November, 2016	713,200	51,612	764,812	556,000	27.4%	178
December, 2016	644,681	269,280	913,961	674,000	26.3%	179
<b>2016 TOTALS</b>	<b>13,143,740</b>	<b>6,429,412</b>	<b>19,573,152</b>	<b>15,860,000</b>	<b>19.0%</b>	<b>N/A</b>
January, 2017	887,960	0	887,960	638,000	28.2%	179
February, 2017	824,926	0	824,926	590,000	28.5%	179
March, 2017	907,868	0	907,868	669,000	28.4%	179
April, 2017	768,229	118,932	887,161	234,000	N/A	181
May, 2017	937,688	121,176	1,058,864	1,252,000	N/A	181
June, 2017	1,443,484	499,664	1,943,148	1,631,000	16.1%	181
July, 2017	N/A	N/A	N/A	N/A	N/A	N/A
August, 2017	3,340,761	1,849,056	5,189,817	4,380,000	15.7%	181
September, 2017	1,160,378	1,127,984	2,288,362	1,861,000	18.7%	181
October, 2017	994,341	103,224	1,097,565	904,000	17.7%	181
November, 2017	1,277,706	65,824	1,343,530	1,057,000	21.4%	182
December, 2017	838,294	138,380	976,674	807,000	17.4%	182
<b>2017 TOTALS</b>	<b>13,381,635</b>	<b>4,024,240</b>	<b>17,405,875</b>	<b>14,023,000</b>	<b>19.5%</b>	<b>N/A</b>
January, 2018	1,157,309	0	1,157,309	923,000	20.3%	182
February, 2018	1,040,491	0	1,040,491	815,000	21.7%	182
March, 2018	1,166,200	0	1,166,200	992,000	15.0%	182
April, 2018	1,153,400	0	1,153,400	939,000	18.6%	182
May, 2018	1,714,400	201,212	1,915,612	1,596,000	16.7%	182
June, 2018	1,320,681	586,432	1,907,113	1,630,000	14.6%	182
July, 2018	1,067,131	2,270,180	3,337,311	2,772,000	17.0%	182
August, 2018	1,268,088	1,641,860	2,909,948	2,566,000	11.9%	182
September, 2018	1,340,000	580,448	1,920,448	1,598,000	16.8%	182
October, 2018	1,115,667	307,428	1,423,095	1,188,000	16.6%	182
November, 2018	1,111,633	100,232	1,211,865	868,000	28.4%	182
December, 2018	1,188,500	54,604	1,243,104	893,000	28.2%	182
<b>2018 TOTALS</b>	<b>14,643,500</b>	<b>5,742,396</b>	<b>20,385,896</b>	<b>16,780,000</b>	<b>17.7%</b>	<b>N/A</b>

14115

# Land Use Information Form



Oregon Water Resources Department  
725 Summer Street NE, Suite A  
Salem, Oregon 97301-1266  
(503) 986-0900  
www.oregon.gov/OWRD

RECEIVED

NOV 01 2022

OWRD

Applicant(s): Orchard Heights Water Association

Mailing Address: 4350 Orchard Heights Road NW

City: Salem

State: OR

Zip Code: 97304

Daytime Phone: 503-589-2193

## A. Land and Location

Please include the following information for all tax lots where water will be diverted (taken from its source), conveyed (transported), and/or used or developed. Applicants for municipal use, or irrigation uses within irrigation districts may substitute existing and proposed service-area boundaries for the tax-lot information requested below.

Township	Range	Section	¼ ¼	Tax Lot #	Plan Designation (e.g., Rural Residential/RR-5)	Water to be:	Proposed Land Use:
<u>7S</u>	<u>3W</u>	<u>18</u>	<u>SWNW</u>	<u>00600</u>	<u>EFU</u>	<input checked="" type="checkbox"/> Diverted <input type="checkbox"/> Conveyed <input type="checkbox"/> Used	<u>Quasi-Municipal</u>

List all counties and cities where water is proposed to be diverted, conveyed, and/or used or developed:

City of Salem, Polk County

## B. Description of Proposed Use

Type of application to be filed with the Water Resources Department:

- ☐ Permit to Use or Store Water ☒ Water Right Transfer ☐ Permit Amendment or Ground Water Registration Modification  
☐ Limited Water Use License ☐ Allocation of Conserved Water ☐ Exchange of Water

Source of water: ☐ Reservoir/Pond ☒ Ground Water ☐ Surface Water (name) \_\_\_\_\_

Estimated quantity of water needed: 0 ☒ cubic feet per second ☐ gallons per minute ☐ acre-feet

Intended use of water: ☐ Irrigation ☐ Commercial ☐ Industrial ☐ Domestic for \_\_\_\_\_ household(s)  
☐ Municipal ☒ Quasi-Municipal ☐ Instream ☐ Other \_\_\_\_\_

Briefly describe:

The Orchard Heights Water Association (Association) wishes to add an existing well (Lafayette Well, POLK-1789) to an existing water right (Certificate 45205). The subject well (Lafayette Well, POLK-1789) is an existing, operational well that is already connected to the Association's system. This water right transaction is being completed so that the Association can more efficiently use the authorized capacity of Certificate 45205 to reliably provide drinking water to the Association's customers. The existing rate and volume authorized for use by the applicant under the water right (0.15 cfs) will not be modified by the proposed change and there will be no construction/development on the associated property resulting from the proposed change.

**Note to applicant:** If the Land Use Information Form cannot be completed while you wait, please have a local government representative sign the receipt at the bottom of the next page and include it with the application filed with the Water Resources Department.

14115

See bottom of Page 3. →



## For Local Government Use Only

OWRD

The following section must be completed by a planning official from each county and city listed unless the project will be located entirely within the city limits. In that case, only the city planning agency must complete this form. This deals only with the local land-use plan. Do not include approval for activities such as building or grading permits.

**Please check the appropriate box below and provide the requested information**

- ☒ Land uses to be served by the proposed water uses (including proposed construction) are allowed outright or are not regulated by your comprehensive plan. Cite applicable ordinance section(s): PCZO 127.020 (F) - Public Utilities
- ☐ Land uses to be served by the proposed water uses (including proposed construction) involve discretionary land-use approvals as listed in the table below. (Please attach documentation of applicable land-use approvals which have already been obtained. Record of Action/land-use decision and accompanying findings are sufficient.) **If approvals have been obtained but all appeal periods have not ended, check "Being pursued."**

Type of Land-Use Approval Needed (e.g., plan amendments, rezones, conditional-use permits, etc.)	Cite Most Significant, Applicable Plan Policies & Ordinance Section References	Land-Use Approval:	
		<input type="checkbox"/> Obtained <input type="checkbox"/> Denied	<input type="checkbox"/> Being Pursued <input type="checkbox"/> Not Being Pursued
		<input type="checkbox"/> Obtained <input type="checkbox"/> Denied	<input type="checkbox"/> Being Pursued <input type="checkbox"/> Not Being Pursued
		<input type="checkbox"/> Obtained <input type="checkbox"/> Denied	<input type="checkbox"/> Being Pursued <input type="checkbox"/> Not Being Pursued
		<input type="checkbox"/> Obtained <input type="checkbox"/> Denied	<input type="checkbox"/> Being Pursued <input type="checkbox"/> Not Being Pursued
		<input type="checkbox"/> Obtained <input type="checkbox"/> Denied	<input type="checkbox"/> Being Pursued <input type="checkbox"/> Not Being Pursued
		<input type="checkbox"/> Obtained <input type="checkbox"/> Denied	<input type="checkbox"/> Being Pursued <input type="checkbox"/> Not Being Pursued

Local governments are invited to express special land-use concerns or make recommendations to the Water Resources Department regarding this proposed use of water below, or on a separate sheet.

Name: Sidney Mulder Title: Planning Manager

Signature: [Signature] Phone: 503-623-9237 Date: 10-10-22

Government Entity: Polk County

**Note to local government representative:** Please complete this form or sign the receipt below and return it to the applicant. If you sign the receipt, you will have 30 days from the Water Resources Department's notice date to return the completed Land Use Information Form or WRD may presume the land use associated with the proposed use of water is compatible with local comprehensive plans.

**Receipt for Request for Land Use Information**

Applicant name: \_\_\_\_\_

City or County: \_\_\_\_\_ Staff contact: \_\_\_\_\_

Signature: \_\_\_\_\_ Phone: \_\_\_\_\_ Date: \_\_\_\_\_

14115



RECEIVED  
NOV 01 2022  
OWRD

October 18, 2022

Mr. Kelly Starnes  
Transfer Applications  
Oregon Water Resources Department  
725 Summer Street NE, Suite A  
Salem, Oregon 97301-1271

**Subject:** Application for a Permanent Water Right Transfer for Certificate 45205

Mr. Starnes:

On behalf of the permittee, please find enclosed an application for a permanent water right transfer for Certificate 45205. Please also find enclosed a check in the amount of \$1,840 for payment of the required fee for the transfer application.

If you have any questions regarding the enclosed transfer application, please call me at 503-701-4535.

Respectfully submitted,

Theodore Ressler, RG, CWRE  
Summit Water Resources LLC.

Enclosures:

Application for a Permanent Water Right Transfer for Certificate 45205  
Check #9771 in the amount of \$1,840

Cc: Doug Priest – Orchard Heights Water Association



# Permanent Transfer Application Intake Completion Checklist

Check the Certificate(s) in WRIS

Transfer # T-14115

Checked by: <u>Joan</u>	Type of Change(s) Proposed: Mark the Proposed Changes	Substitution	Supplemental to Primary	POU	POD	APOD
Date: <u>11/3/22</u>		Gov Action	Surface to Ground	USE	POA	<u>APOA</u>
Fee Received: <u>\$ 1840.00</u>						
Calculated Fee: <u>\$ 1840.00</u>						
Additional Observations: <u>Quasi muni</u>		How many rights to be Transferred? Certificate # <u>45205</u>				

If OK and complete, check box to the left; if NOT, fill in.

- ☒ 1. Is applicant information complete? Have all applicants listed at the top of the page signed at the bottom?  
If no, what is missing? Whose signature is missing? \_\_\_\_\_
  - ☒ 2. Does applicant indicate the place of use is in or near an irrigation district? Is a Form D included? ☒ N/A.  
Name of the district: \_\_\_\_\_
  - ☒ 3. Part 5 of application, has the applicant(s) completed the entire page and does the information match the description of the explanation of the reasons for transfer on Part 4 of the application?  
If no, you may need to contact the applicant or agent? \_\_\_\_\_
  - ☒ 4. Is there only one (1) water right included in this transfer application?  
If no, are the criteria of OAR 690-380-3220 for more than one WR met? Yes or No \_\_\_\_\_  
If no, then the transfer application **CANNOT** be accepted. See attached "3220" Decision Tree Flowchart.
  - ☒ 5. For multiple certificates do each of the certificates listed on Application Page 1 have their own separate completed Part 5 tables 1 & 2?  
If no, which certificate(s) are missing a separate Part 5 tables 1 & 2? \_\_\_\_\_
  - ☒ 6. Is the map prepared and signed by a CWRE? Does the map meet requirements?  
If no, what is missing? \_\_\_\_\_. Map waiver included? ☐ Yes ☐ No
  - ☒ 7. If a change in point of appropriation (POA), have the well logs been included? ☐ N/A.
  - ☒ 8. If a change in place of use (POU) within Umatilla County, have the applicant(s) provided a Supplemental Form U? ☒ N/A.
  - ☒ 9. If all boxes on this checklist are checked (with no remaining deficiencies identified), **ACCEPT** the application.  
Put this application intake completeness check sheet in the transfer folder.
- OR: ☐ If all boxes to the left are **NOT** checked, then this application is deficient and **CANNOT** be accepted.  
It should be returned and the deficiencies listed in the "staff" section at the bottom of Application Page 1, unless the applicant or agent can resolve the deficiencies within 2-3 days.

Actions taken: \_\_\_\_\_ Date: \_\_\_\_\_



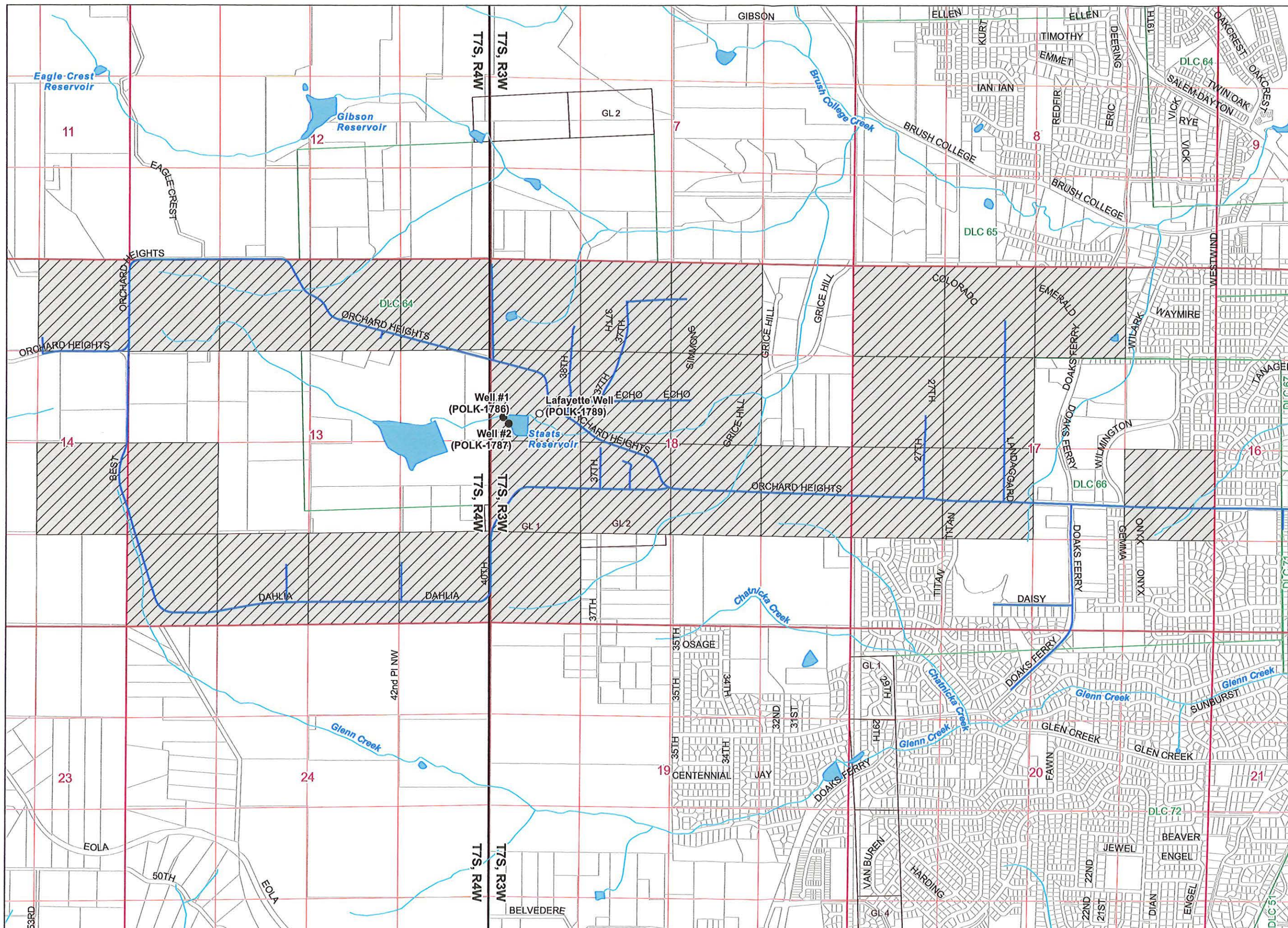

### LEGEND

- Authorized Point of Appropriation (POA)
- Additional POA
- ▨ Authorized Place of Use
- Sections
- Quarter Quarter Sections
- Donation Land Claims (DLCs)
- Government Lots (GLs)
- Tax Lots
- ~ Mainline (Approximate)
- ~ Watercourse

### POA Location Descriptions

Well #1 (POLK-1786):  
South 3 degrees, 12 minutes East 2308 feet from the NW  
18

Well #2 (POLK-1787):  
South 5 degrees, 14 minutes East 2412 feet from the NW  
18

Lafayette Well (POLK-1789):  
North 62 degrees, 54 minutes east, 780 feet from W quar  
Section 18



**Disclaimer:**  
This map was prepared for the purpose of identifying the location of a water right only and is not intended to show legal dimensions or location of property ownership.



Scale  
0 660  
1-inch = 1,320 feet

Data Sources: Polk County, OWRD, USGS, BLM  
Date: 10/10/2022

# Application for a Permanent Water Right Transfer Certificate

## A Water Right in the Name of Orchard Heights Water Association

Township 7S, Range 3W, Sections  
Township 7S, Range 4W, Sections 13

14115

