

Temporary

Name Correa Cattle Co.
C/O David Correa
Address 31777 Andrews Rd
Echo, OR 97826

DESCRIPTION OF WATER RIGHT(S)

Name of Stream

Trib. of Umatilla RiverUse IrrigationCounty Umatilla

Quantity of water (CFS)

No. of Acres

Name of ditch

App# Decree Per # Umatilla R. Cert # PR Date 12/31/1870App# Decree Per # Umatilla R. Cert # PR Date 1/9/1900

App# Per # Cert # PR Date

App# Per # Cert # PR Date

App# Per # Cert # PR Date

Change in POU
Date Filed 2/29/2024
Initial notice date 3/12/2024
DPD issued date
PD issued date
PD notice date
Date of FO 7/29/2024 Vol 131 Page 753-757

C-Date
COBU due date
COBU Received date
Certificate issued

Assignments:

Irrigation District Westland Irrigation District

Agent William Porfily
wporfily@gmail.com

CWRE

CC's list Umatilla County
U.S. BOR

☐ - Oversized map - Location

FEES PAID

Date	Amount	Receipt #
<u>2-29-2024</u>	<u>\$1,422.00</u>	<u>142486</u>

FEES REFUNDED

Date	Amount	Receipt #
------	--------	-----------



Oregon

Tina Kotek, Governor

Water Resources Department

North Mall Office Building

725 Summer St NE, Suite A

Salem, OR 97301

Phone 503 986-0900

Fax 503 986-0904

www.oregon.gov/owrd

July 29, 2024

David Correa
31777 Andrews Rd.
Echo, OR 97826

REFERENCE: District Temporary Transfer Application T-14410

Enclosed is a copy of the final order approving your TEMPORARY water right transfer application.

The temporary change shall be effective at the **beginning of the 2024 irrigation season**. The use shall revert to the original authorized place of use at the **end of the 2027 irrigation season**.

If you have any questions related to the approval of this temporary transfer, you may contact your caseworker, Scott Grew, by telephone at (503) 986-0890 or by e-mail at Scott.a.grew@water.oregon.gov.

Sincerely,

Elyse D. Richman
Water Rights Services Support
Transfers and Conservation Section

cc: Gregory M. Silbernagel, Watermaster Dist. # 5 (via email)
William Porfily, Agent
Irrigation District: Westland Irrigation District
Umatilla County, Local Government
US Bureau of Reclamation, Interested Party

Enclosure

**BEFORE THE WATER RESOURCES DEPARTMENT
OF THE
STATE OF OREGON**

In the Matter of Transfer Application)	FINAL ORDER APPROVING A TEMPORARY
T-14410, Umatilla County)	CHANGE IN PLACE OF USE

Authority

Oregon Revised Statute (ORS) 540.505 to 540.580 establish the process in which a water right holder may submit a request to temporarily transfer the place of use and, if necessary to convey the water to the temporary place of use, the point of diversion authorized under an existing water right.

Oregon Administrative Rule (OAR) Chapter 690, Division 380 implements the statutes and provides the Department's procedures and criteria for evaluating transfer applications.

Applicant

DAVID CORREA
31777 ANDREWS ROAD
ECHO, OR 97826

Findings of Fact

1. On February 29, 2024, David Correa filed an application to temporarily change the place of use under the Umatilla River Decree Vol. 3, Page 127 for a period of 4 years. The Department assigned the application number T-14410.
2. Notice of the application for transfer was published on March 12, 2024 pursuant to OAR 690-380-4000.
3. The portion of the first right to be temporarily transferred is as follows:

Decree: Water rights evidenced by the Umatilla River Decree, (Vol. 3, Page 239/Elmer Reeves) Vol. 3, Page 239/ Geo L. Ward) (Vol. 3, Page 239/ B.F McCullough, J.A. Mendenhall) and Vol. 15, Page 432/ Frank Correa Sr.) the portions identified as in the name of Pioneer Irrigation Company

Use: IRRIGATION of 49.0 ACRES

Priority Date: JANUARY 9, 1900

This is a final order in other than a contested case. This order is subject to judicial review under ORS 183.484. Any petition for judicial review must be filed within the 60-day time period specified by ORS 183.484(2). Pursuant to ORS 536.075 and OAR 137-004-0080, you may petition for judicial review or petition the Director for reconsideration of this order. A petition for reconsideration may be granted or denied by the Director, and if no action is taken within 60 days following the date the petition was filed, the petition shall be deemed denied.

Limit/Duty: Subject to the provisions of the Umatilla River Decree Vol. 3, Page 127
Paragraph 33

Period of Use: Usually March 1 to November 1

Source: UMATILLA RIVER a tributary to the COLUMBIA RIVER

Authorized Place of Use:

IRRIGATION					
Twp	Rng	Mer	Sec	Q-Q	Acres
3 N	29 E	WM	8	NE SW	8.0
3 N	29 E	WM	8	SE SW	10.0
3 N	29 E	WM	8	NW SE	12.0
3 N	29 E	WM	8	SW SE	3.5
4 N	29 E	WM	31	SE SW	8.5
4 N	29 E	WM	31	SW SE	7.0
Total					49.0

4. The Umatilla River Decree does not provide a detailed description of the point of diversion; however, the applicant provided a description of the point as:

Twp	Rng	Mer	Sec	Q-Q	Survey Coordinates
3 N	29 E	WM	21	SW NE	W.I.D. DIVERSION - NORTH 76°45'56" E. 2913.19 FEET FROM THE W1/4 CORNER OF SECTION 21

5. Temporary Transfer Application T-14410 proposes to temporarily change the place of use of the right to:

IRRIGATION					
Twp	Rng	Mer	Sec	Q-Q	Acres
3 N	29 E	WM	12	NE SE	19.0
3 N	29 E	WM	12	SE SE	30.0
Total					49.0

6. The portion of the second right to be temporarily transferred is as follows:

Decree: Water rights evidenced by the Umatilla River Decree, (Vol. 3, Page 195, the portion identified as in the name of Allen Ditch Company (Fred Andrews)

Use: IRRIGATION of 11.0 ACRES

Priority Date: 1870

Limit/Duty: Subject to the provisions of the Umatilla River Decree Vol. 3, Page 127, Paragraph 33

Period of Use: Usually March 1 to November 1

Source: UMATILLA RIVER a tributary of the COLUMBIA RIVER

Authorized Place of Use:

IRRIGATION					
Twp	Rng	Mer	Sec	Q-Q	Acres
3 N	29 E	WM	7	NE SE	5.5
3 N	29 E	WM	7	SE SE	5.5
Total					11.0

7. The uses tabulated above in Volume 3, Pages 239 and 240, and Volume 15, Pages 432 of the Umatilla River Decree identified as the Pioneer Ditch delivery system, but do not describe the location of the point of diversion from the Umatilla River through the Westland Irrigation canal at G#2 (the Pioneer/Courtney headgate). Information is available indicating that the point of diversion on the Umatilla River is located as follows:

Twp	Rng	Mer	Sec	Q-Q	Survey Coordinates
3 N	29 E	WM	21	SW NE	W.I.D. DIVERSION - NORTH 76°45'56" E. 2913.19 FEET FROM THE W1/4 CORNER OF SECTION 21

8. Temporary Transfer Application T-14410 proposes to temporarily change the place of use of the right to:

IRRIGATION					
Twp	Rng	Mer	Sec	Q-Q	Acres
3 N	28 E	WM	12	NE SE	11.0

9. There are water right Permits S-55061, S-55192, S-55190, and S-54633 for primary irrigation that are located on portions of the "TO" lands described in Finding of Facts Nos. 3, and 6. During the term of the Temporary Transfer, water use under these permits will either be already shut off, not allocated any water this season, cannot supply enough water, have not been activated by mitigation, or no intended water to be used for these acres and thus shall not be exercised.
10. A portion of the authorized "FROM" lands have appurtenant supplemental water rights for irrigation described in water use Permit S-7400 and Certificate 31294.
11. Temporary Transfer Application T-14410 proposes to temporarily transfer a water right within the boundaries of Westland Irrigation District. The district was notified of the proposed temporary transfer and did not provide any comments.

Temporary Transfer Review Criteria

12. Water has been used within the last five years according to the terms and conditions of the rights. There is no evidence available that would demonstrate that the rights are subject to forfeiture under ORS 540.610.
13. A diversion structure and ditch sufficient to use the full amount of water allowed under the existing rights are present.
14. The proposed change would prevent the lands from which the water rights are removed during the period of the temporary transfer from receiving water under the transferred rights, as required by ORS 540.523(7).
15. The proposed change would not result in injury to other water rights. This finding is made through an abbreviated review recognizing that the transfer may be revoked under ORS

540.523(5) if the Department later finds that the transfer is causing injury to any existing water right.

Conclusions of Law

The temporary change in places of use proposed in Temporary Transfer Application T-14410 is consistent with the requirements of ORS 540.523 and OAR 690-380-8000.

Now, therefore, it is ORDERED:

1. The temporary change in places of use proposed in Temporary Transfer Application T-14410 is approved.
2. The former places of use **shall not** be irrigated as part of these water rights during the 2024, 2025, 2026, 2027 irrigation seasons.
3. The use shall revert to the authorized places of use at the end of the 2027 irrigation season.
4. The approval of this temporary transfer may be revoked or modified if the Department finds the change causes injury to any existing water right.
5. A subsequent application for permanent transfer of Umatilla River Decree at Vol. 3, Page 127 shall be subject to a full and complete review to determine consistency with the requirements of OAR Chapter 690, Division 380. Approval of this temporary transfer does not establish a precedent for approval of a subsequent application filed for a permanent transfer.
6. The use of water at the temporary places of use authorized by this transfer shall be in accordance with the terms and conditions of Umatilla River Decree at Vol. 3, Page 127.
7. The time during which water is used under this approved temporary transfer does not apply toward a finding of forfeiture under ORS 540.610.
8. Water use measurement conditions:
 - a. Before water use may begin under this order, the water user shall install a totalizing flow meter, or, with prior approval of the Director, another suitable measuring device, at each point of diversion (new and existing).
 - b. The water user shall maintain the meters or measuring devices in good working order.
 - c. The water user shall allow the Watermaster access to the meters or measuring devices; provided however, where the meters or measuring devices are located within a private structure, the Watermaster shall request access upon reasonable notice.

9. The use of the remaining water rights described by Umatilla River Decree at Vol. 3, Page 127 shall continue to be in accordance with the terms and conditions of said Decree.



JUL 29 2024

Lisa J. Jaramillo, Transfer and Conservation Section Manager, for
IVAN GALL, DIRECTOR
Oregon Water Resources Department

Mailing Date: **JUL 30 2024**

Oregon Water Resources Department

Measurement Condition Information for the Applicant

(To be sent with the Draft Preliminary Determination or Final Order)

Transfer #: T- 14410



In order to avoid enlargement of the right or injury to other rights, a totalizing flowmeter will be required to be installed prior to diversion of water, as a condition of this transfer:



at each point of diversion/appropriation (new and existing) OR



at each new point of diversion/appropriation.

For additional information, or to obtain approval of a different type of measurement device, the applicant should contact the area Watermaster:

Watermaster name: Greg Silbernagel

District: 5

Address: 116 SE Dorion Avenue

City/State/Zip: Pendleton, Oregon 97801

Phone: 541-969-1677

Email: Greg.M.Silbernagel@water.oregon.gov

Note: If a device other than the one specified in the Preliminary Determination or Final Order is approved by the Watermaster, fill out and mail the form below to the Salem office.

Approval of an Alternate Measurement Device T-
(to be filled out after consultation with the applicant, or after a site visit)

On behalf of the Director, I authorize use of the following suitable alternate measurement device:

Watermaster signature

District

Date

If this form is used for approval of an alternative measurement device, it must be mailed to:

Oregon Water Resources Department
725 Summer Street NE, Suite A
Salem, OR 97301-1266

WATER RIGHT TRANSFER COVER SHEET

Transfer: T-14410

Transfer Specialist: SCOH

Transfer Type: Temporary Transfer

DROUGHT? ☐

Applicant: David Correa 31777 Andrews Rd Echo, OR 97826	Agent: William Porfily PO Box 643 Stanfield, OR 97875	Receiving Landowner:
Current Landowner if other than Applicant:	CWRE:	Irrigation District: Westland Irrigation District
Affected Local Gov'ts: Umatilla County	Affected Tribal Gov't:	BOR Notified (date):

Water Rights Affected

File Marked	App. File # or Decree Name	Permit	Certificate
<input type="checkbox"/>			
<input type="checkbox"/>			
<input type="checkbox"/>			

Key Dates & Initial Actions (Support Staff)

Rec'd: February 29, 2024	Proposed Action(s): PLACE OF USE	
Fees Pd: 1422.00	Acknowledgement Letter Sent <input checked="" type="checkbox"/>	Basin: 7 Umatilla
Initial Public Notice: 3/12/2024	County sent cc: of Ack Letter <input type="checkbox"/>	County: UMATILLA
WM District: 5 Gregory M. Silbernagel	WM Review request sent:	WM Review date received:
Groundwater	GW Review sent:	GW Review date received:

Peer Review:

Document	Drafted	Peer Review	Coordinator	Changes Made	Signature Bin	Signature Date
FO	Date: <u>7/12/24</u> Initials: <u>Scott</u>	Date: <u>7/15/24</u> Initials: <u>Joan</u>	Date: <u>7/18/24</u> Initials: <u>Bony</u>	Date: <u>7/18/24</u> Initials: <u>Scott</u>	Date: <u>7/18/24</u> No. of docs for sig: <u>1</u> WM Sheet <input checked="" type="checkbox"/>	Date: <u>7/29/24</u>

Special Issues: Identical to T-13723 & T-13955 WM Cells for TFM!

Special Order Volume: Vol. 131 Pages 753-757

Watermaster Review Form: Water Right Transfer



Oregon Water Resources Department
725 Summer St NE, Suite A
Salem, Oregon 97301-1266
(503) 986-0900
www.oregon.gov/OWRD

Transfer Application: T-14410

Review Due Date:

Applicant Name: David Correa

Proposed Changes: ☒ POU ☐ POD ☐ POA ☐ USE ☐ OTHER

Reviewer(s): Greg Silbernagel

Date of Review: 05/31/2024

1. Do you have evidence that the right has not been used in the last 5 years and that the presumption of forfeiture would not likely be rebuttable? ☐ Yes ☒ No If "Yes", attach evidence (e.g. dated aerial photo showing pavement or building on the land for >5 yrs.)
2. Is there a history of regulation on the source that serves this (or these) right(s) that has involved the transferred right(s) and downstream water rights? ☒ Yes ☐ No Generally characterize the frequency of any regulation or explain why regulation has not occurred:

The Pioneer Irrigation District was notified in 2023 that they need to install a totalizing measurement on the Pioneer Ditch. We have been flexible for 2024 to allow them time to get one installed. We anticipate regulation in 2025 if a measurement device is not installed. Use of water under this transfer without a Watermaster Approved Measurement Device will result in regulation.
3. Have headgate notices been issued for the source that serves the transferred right(s)?
☒ Yes ☐ No ☐ Records not available.
4. In your estimation, after the proposed change, would distribution of water for the right(s) result in regulation of other water rights that would not have occurred if use under the original right(s) was/were maximized? ☐ Yes ☒ No If "Yes", explain:
5. In your estimation, if the proposed change is approved, are there upstream water rights that would be affected? ☐ Yes ☒ No If "Yes", describe how the rights would be affected and list the rights most affected:

6. Check here ☐ if it appears that downstream water rights benefit from return flows resulting from the current use of the transferred right(s)? If you check the box, generally characterize the locations where the return flows likely occur and list the water rights that benefit most:

☐ N/A

7. For POD changes and instream transfers, check here if there are channel losses between the old and new PODs or within the proposed instream reach? If you check the box, describe and, if possible, estimate the losses:

☒ N/A

8. For instream transfers that propose protection of a reach beyond the mouth of the source stream:

☒ N/A Would the quantity be measureable into the receiving stream consistent with OAR 690-077-0015(8)? ☐ Yes ☐ No

9. For POU changes: ☐ N/A Is it likely the original place of use would continue to receive water from the same source? ☒ Yes ☐ No If "Yes", explain:

10. For POU or USE changes: ☐ N/A In your best judgment, would use of the existing right at "full face value," result in the diversion of more water than can be used beneficially and without waste? ☐ Yes ☒ No If "Yes", explain:

11. For POU changes that involve micro-irrigation: ☒ N/A

- a. Has the applicant made changes (absent a transfer) to convert to micro-irrigation within the current place of use boundary of the water right proposed for transfer, and previously demonstrated to the Department through monitoring and site inspections by the Watermaster that the proposed transfer will not result in injury or enlargement?

☐ Yes ☐ No If "Yes", explain:

- b. Has a temporary transfer of this nature been previously filed and approved on the same lands (or portions thereof) as those lands involved in this transfer?

☐ Yes ☐ No If "Yes", answer the following:

- i. Were there any problems with more acres being irrigated (or wetted) than were authorized under the temporary transfer? ☐ Yes ☐ No If "Yes", explain:

- ii. Did the designated areas that were to remain dry (or not wetted) under the temporary transfer actually remain dry? ☐ Yes ☐ No If "No", explain:

- iii. Did the applicant comply with and meet all of the conditions of the temporary transfer? ☐ Yes ☐ No If "No", explain:

- iv. Do you have any other observations regarding the temporary transfer?

☐ Yes ☐ No If "Yes", describe:

- v. Did the applicant demonstrate to the Department through monitoring and site inspections by the Watermaster that neither injury nor enlargement occurred as a result of the temporary transfer? ☐ Yes ☐ No If "No", explain:

- c. To the best of your knowledge, if this transfer is approved, does it appear that:

- i. "Injury" will occur to other water rights that share the same source?

☐ Yes ☐ No If "Yes", explain:

- ii. "Enlargement" of the water right being transferred will occur?

☐ Yes ☐ No If "Yes", explain:

12. Are there other issues not identified through the above questions that should be considered in determining whether the change "can be effected without injury to other rights"?

☒ Yes ☐ No If "Yes", explain:

Applicant needs notified that a measurement device within the Westland Irrigation District is not a sufficient measurement device and will not count as a measurement device for this transfer or any other Pioneer Irrigation District water rights.

13. What alternatives may be available for addressing any issues identified above:

Install a measurement device on the Pioneer Ditch.

14. Do conditions need to be included in the transfer order to avoid enlargement of the right or injury to other rights? ☐ No ☒ Yes, as checked and provided below:

☐ For POU changes that involve micro-irrigation, provide the monitoring and reporting conditions necessary to prevent injury/enlargement:

☐ A Headgate should be required prior to diverting water.

☒ Measurement Devices for POD or POA: (if this condition is selected, also fill in the top sections of Page 4)

*a. Before water use may begin under this order, the water user shall install a **totalizing flow meter***, or, with prior approval of the Director, another suitable measuring device, ☒ at each point of diversion/appropriation (new and existing) **OR** at each new point of diversion/appropriation ☐ with the exception that water rights issued to the Bureau of Reclamation or an irrigation district (or similar entity) are not subject to this condition.*

b. The water user shall maintain the meters or measuring devices in good working order.

c. The water user shall allow the Watermaster access to the meters or measuring devices; provided however, where the meters or measuring devices are located within a private structure, the Watermaster shall request access upon reasonable notice.

☐ Reservoir water use measurement: (if this condition is selected, also fill in the top sections of Page 4)

*a. Before water use may begin under this order, the water user shall install **staff gages***, or, with prior approval of the Director, other suitable measuring devices, that measure the entire range and stage between empty and full in each reservoir. Staff gages shall be United States Geological Survey style.*

b. Before water use may begin under this order, if the reservoir is located in channel, weirs or other suitable measuring devices must be installed upstream and downstream of the reservoir, and, an adjustable outlet valve must be installed. The water user shall maintain such devices in good working order. A written waiver may be obtained, if in the judgment of the Director, the installation of weirs or other suitable measuring devices, or the adjustable outlet valve, will provide no public benefit.

* The following alternative device(s) should be substituted for the bold, underlined device in the above selected condition:

<input type="checkbox"/> Weir	<input type="checkbox"/> Submerged Orifice
<input type="checkbox"/> Parshall Flume	<input type="checkbox"/> Flow Restrictor
<input type="checkbox"/> Other: ____	

Oregon Water Resources Department

Measurement Condition Information for the Applicant

(To be sent with the Draft Preliminary Determination or Final Order)

Transfer #: T- 14410



In order to avoid enlargement of the right or injury to other rights, a **totalizing flowmeter** will be required to be installed **prior to diversion of water**, as a condition of this transfer:



at each point of diversion/appropriation (new and existing) OR



at each new point of diversion/appropriation.

For additional information, or to obtain approval of a different type of measurement device, the applicant should contact the area Watermaster:

Watermaster name: **Greg Silbernagel**

District: **5**

Address: **116 SE Dorion Avenue**

City/State/Zip: **Pendleton, Oregon 97801**

Phone: **541-969-1677**

Email: **Greg.M.Silbernagel@water.oregon.gov**

Note: *If a device other than the one specified in the Preliminary Determination or Final Order is approved by the Watermaster, fill out and mail the form below to the Salem office.*

Approval of an Alternate Measurement Device

T-

(to be filled out after consultation with the applicant, or after a site visit)

On behalf of the Director, I authorize use of the following suitable **alternate measurement device**:

Watermaster signature

District

Date

If this form is used for approval of an alternative measurement device, it must be mailed to:

Oregon Water Resources Department
725 Summer Street NE, Suite A
Salem, OR 97301-1266



Oregon

Tina Kotek, Governor

Water Resources Department

North Mall Office Building

725 Summer St NE, Suite A

Salem, OR 97301

Phone 503 986-0900

Fax 503 986-0904

March 5, 2024

David Correa
31777 Andrews Rd
Echo, OR 97826

Reference: Application T-14410

On February 29, 2024, the Department received your water right Temporary Transfer Application. The application was accompanied by \$1422.00. Receipt number 142486 is enclosed.

By copy of this letter, we are asking the Watermaster for a report regarding the potential for injury to existing water rights which may be caused by the requested change.

Except as provided under ORS 540.510(3) for municipalities, you may not **temporarily** use water at the new place of use until a final order approving the temporary transfer application has been issued by the Department. Additionally, pursuant to OAR 690-380-8010, the lands from which an irrigation water right is to be temporarily transferred and the land to which the right is to be temporarily transferred may not both receive water during the same season. If the temporary transfer is approved during an irrigation season and water has already been used at the currently authorized location during that season, then the temporary transfer will not take effect until the following season.

If the land is sold before the temporary transfer is approved, the buyer's consent to the temporary transfer will be required unless a recorded deed or other legal document clearly established that the water right was not conveyed in the sale.

If you have any questions, please contact the Transfer Section at (503) 986-0935.

Cc: Watermaster Dist. #5, Gregory M. Silbernagel (via email)
William Porfily, Agent
Irrigation District: Westland Irrigation District & Ann Reece (if in District)
Bureau of Reclamation

Enclosure

DAVID CORREA

2024 3 YEAR TEMPORARY TRANSFER

MAP 1 OF 3

UMATILLA COUNTY

PIONEER IRRIGATION CO.

UMATILLA RIVER DECREE VOL 3
PAGE 239 IN THE NAME OF
B.F. McCULLOUGH, 01/09/1900

UMATILLA RIVER DECREE VOL 15
PAGE 432 IN THE NAME OF
FRANK CORREA SR, 01/09/1900

UMATILLA RIVER DECREE VOL 3
PAGE 239 IN THE NAME OF
ELMER REEVES, 01/09/1900

UMATILLA RIVER DECREE VOL 15
PAGE 240 IN THE NAME OF
GEO. WARD, 01/09/1900

FROM



49.0

T3N, R29E, WM
CORREA TO CORREA

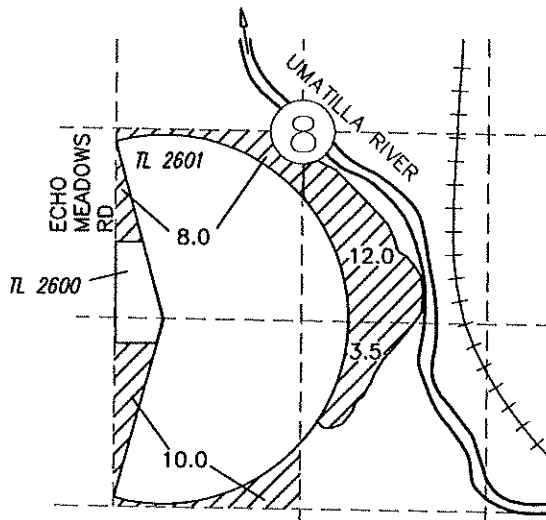

T4N, R29E, WM
EMERT TO CORREA

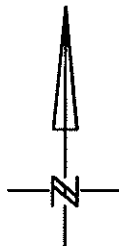
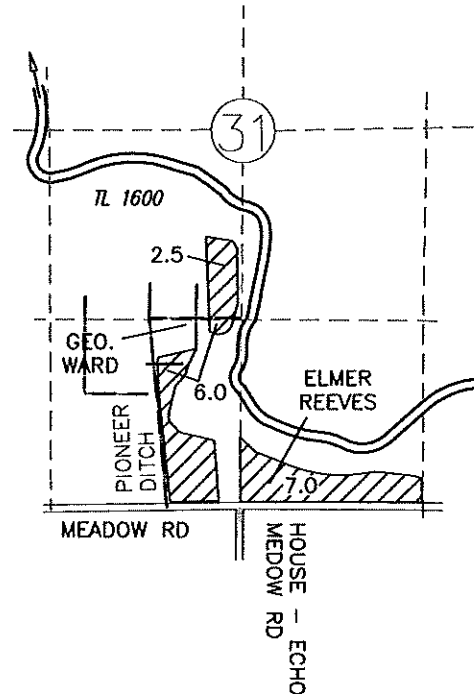

0' 1320' 2640'
SCALE: 1" = 1320'

NOTE:
THE PURPOSE OF THIS MAP IS TO IDENTIFY THE APPROXIMATE LOCATION
OF THE WATER RIGHT. IT IS NOT INTENDED TO PROVIDE INFORMATION
RELATIVE TO THE LOCATION OF PROPERTY OWNERSHIP BOUNDARY LINES.

DRAWING: \\Kwfiles\Public\Project\30-08-016 -- Porfily Water Rights Consulting\--00 Misc Engineering\Cad\correa\30-08-016 CORR BEAR 2024 1-3.dwg
PRINTED BY: kvaldovinos on 01/22/24 11:38 AM

Received

FEB 29 2024

OWRD

Received

FEB 29 2024

DAVID CORREA
(MILLS TO CORREA)

OWRD

2024 3 YEAR TEMPORARY TRANSFER

MAP 2 OF 3
UMATILLA COUNTY
T3N, R29E, WM

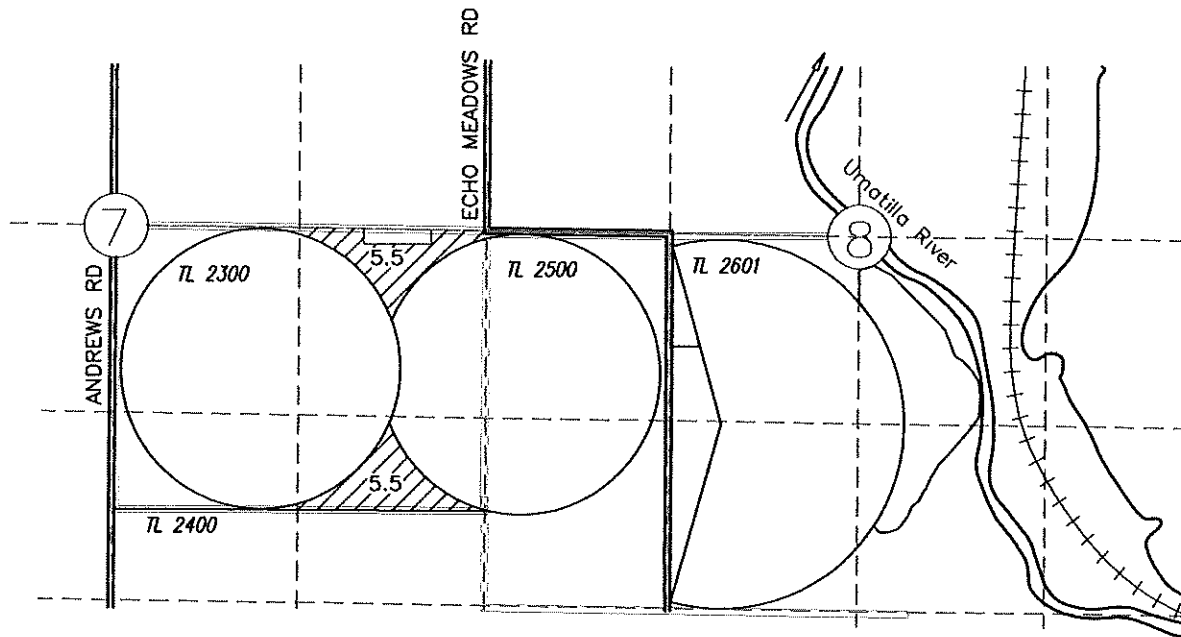

ALLAN DITCH CO
UMATILLA RIVER DECREE VOL 3
PAGE 195 IN THE NAME OF
FRED ANDREWS, 12/31/1870

T.3N., R.29E., W.M.

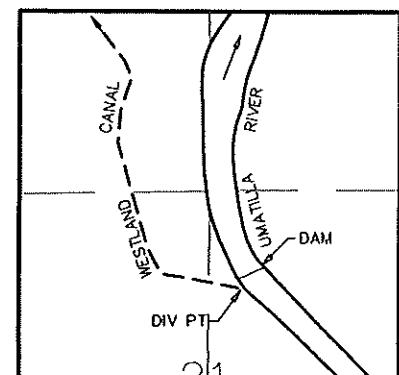

DIV PT LCT N.76°45'56"E. 2913.19' FROM W.1/4 COR. SEC 21

NOTE:
THE PURPOSE OF THIS MAP IS TO IDENTIFY THE APPROXIMATE LOCATION
OF THE WATER RIGHT. IT IS NOT INTENDED TO PROVIDE INFORMATION
RELATIVE TO THE LOCATION OF PROPERTY OWNERSHIP BOUNDARY LINES.

DRAWING: \\Kwkfiles\Public\Project\30-08-016 - Porfily Water Rights Consulting\00 Misc Engineering\Cad\correa\30-08-016 CORR BEAR 2024 1-3.dwg
PRINTED BY: kvoldovinos on 01/22/24 11:38 AM

OWRD

MAP 3 OF 3
UMATILLA COUNTY
T3N, R29E, WM

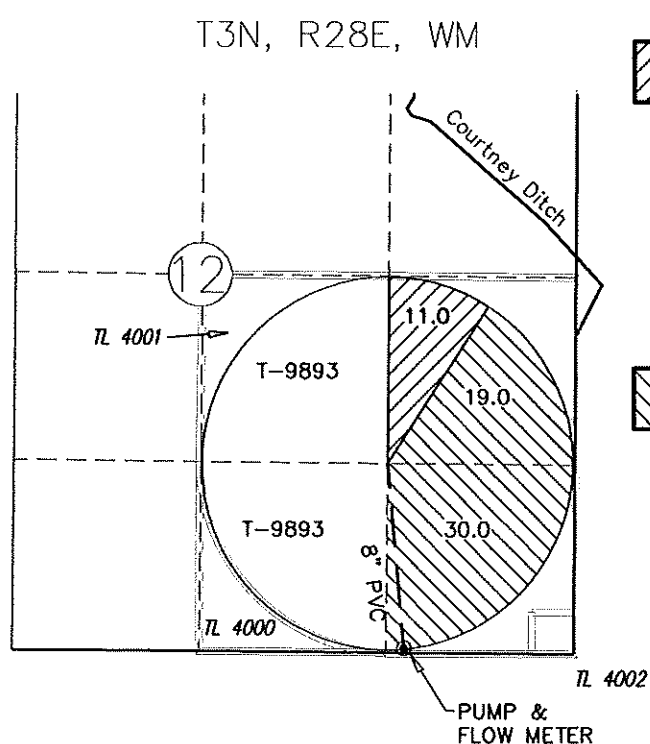

TO



11.0

ALLAN DITCH CO.
UMATILLA RIVER DECREE VOL 3
PAGE 195 IN THE NAME OF
FRED ANDREWS, 12/31/1870

TO



49.0

PIONEER IRRIGATION CO.
UMATILLA RIVER DECREE VOL 3
PAGE 239 IN THE NAME OF
B.F. McCULLOUGH, 01/09/1900
UMATILLA RIVER DECREE VOL 15
PAGE 432 IN THE NAME OF
FRANK CORREA SR, 01/09/1900
UMATILLA RIVER DECREE VOL 3
PAGE 239 IN THE NAME OF
ELMER REEVES, 01/09/1900
UMATILLA RIVER DECREE VOL 15
PAGE 240 IN THE NAME OF
GEO. WARD, 01/09/1900

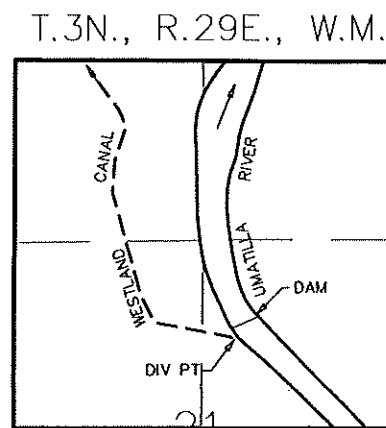
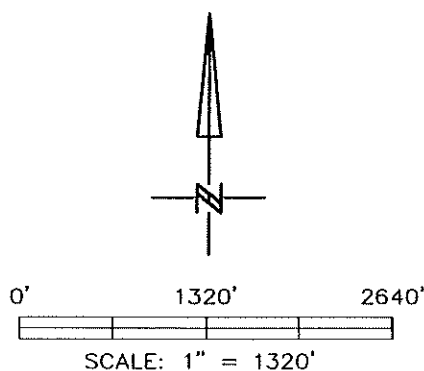

NOTE:
THE PURPOSE OF THIS MAP IS TO IDENTIFY THE APPROXIMATE LOCATION
OF THE WATER RIGHT. IT IS NOT INTENDED TO PROVIDE INFORMATION
RELATIVE TO THE LOCATION OF PROPERTY OWNERSHIP BOUNDARY LINES.

DIV PT LCT N.76°45'56"E. 2913.19' FROM W.1/4 COR. SEC 21

**STATE OF OREGON
WATER RESOURCES DEPARTMENT**

725 Summer St. N.E. Ste. A

SALEM, OR 97301-4172

(503) 986-0900 / (503) 986-0904 (fax)

RECEIPT # **142486**

INVOICE # _____

RECEIVED FROM: Correa Cattle Company
BY: _____

APPLICATION	
PERMIT	
TRANSFER	T-14410

CASH: ☐ CHECK:# 7508 OTHER: (IDENTIFY) ☐

TOTAL REC'D \$1,422.00

1083 TREASURY 4170 WRD MISC CASH ACCT

0407 COPIES	\$
OTHER: (IDENTIFY)	\$

0243 I/S Lease _____ 0244 Muni Water Mgmt. Plan _____ 0245 Cons. Water _____

4270 WRD OPERATING ACCT

MISCELLANEOUS

0407 COPY & TAPE FEES	\$
0410 RESEARCH FEES	\$
0408 MISC REVENUE: (IDENTIFY)	\$
TC162 DEPOSIT LIAB. (IDENTIFY)	\$
0240 EXTENSION OF TIME	\$

WATER RIGHTS:

0201 SURFACE WATER	EXAM FEE	0202	RECORD FEE
0203 GROUND WATER	\$	0204	\$
0205 TRANSFER	\$1,422.00		

WELL CONSTRUCTION

0218 WELL DRILL CONSTRUCTOR	EXAM FEE	0219	LICENSE FEE
LANDOWNER'S PERMIT	\$	0220	\$

OTHER (IDENTIFY) _____

0536 TREASURY 0437 WELL CONST. START FEE

0211 WELL CONST START FEE	\$	CARD#
0210 MONITORING WELLS	\$	CARD#

OTHER (IDENTIFY) _____

0607 TREASURY 0467 HYDRO ACTIVITY LIC NUMBER

0233 POWER LICENSE FEE (FW/WRD)	\$
0231 HYDRO LICENSE FEE (FW/WRD)	\$
HYDRO APPLICATION	\$

TREASURY OTHER / RDX

FUND _____	TITLE _____
OBJ. CODE _____	VENDOR # _____
DESCRIPTION _____	\$ _____

RECEIPT: **142486**

DATED: 2-29-24 BY: [Signature]

Application for Water Right
Temporary or Drought Temporary Transfer
Part 1 of 5 – Minimum Requirements Checklist



Oregon Water Resources Department
725 Summer Street NE, Suite A
Salem, Oregon 97301-1266
(503) 986-0900
www.oregon.gov/OWRD

This temporary transfer application will be returned if Parts 1 through 5 and all required attachments are not completed and included.

For questions, please call (503) 986-0900, and ask for Transfer Section.

FOR ALL TEMPORARY TRANSFER APPLICATIONS

Received

FEB 29 2024

OWRD

Check all items included with this application. (N/A = Not Applicable)

- ☒ Part 1 – Completed Minimum Requirements Checklist.
- ☒ Part 2 – Completed Temporary Transfer Application Map Checklist.
- ☒ Part 3 – Application Fee, payable by check to the Oregon Water Resources Department, and completed Fee Worksheet, page 3. Try the online fee calculator at: http://apps.wrd.state.or.us/apps/misc/wrd_fee_calculator. If you have questions, call Customer Service at (503) 986-0801.
- ☒ Part 4 – Completed Applicant Information and Signature.
- ☒ Part 5 – Information about Transferred Water Rights: **How many water rights are to be transferred? 2 List them here: 1: Umatilla Decrees Pioneer Irrigation Company Vol. 3 Page 239, (Elmar Reeves); Vol. 3 Page 240, (Geo. Ward) & Vol. 3 Page 239, & Vol. 15 Page 432, (Frank Correa Sr.), & 2: Umatilla Drcree Alen Dich Company Vol. 3 Page 195, (Fred Andrews).**
- Please include a separate Part 5 for each water right. (See instructions on page 6)
- ☒ ☐ N/A For standard Temporary Transfer (one to five years) **Begin Year: March 1, 2024 End Year: Nov 1st 2027.**

- ☐ ☒ N/A Temporary Drought Transfer (Only in counties where the Governor has declared drought)

Attachments:

- ☒ Completed Temporary Transfer Application Map.
- ☒ Completed Evidence of Use Affidavit and supporting documentation.
- ☒ Current recorded deed for the land **from** which the authorized place of use is temporarily being moved.
- ☒ ☐ N/A Affidavit(s) of Consent from Landowner(s) (if the applicant does not own the land upon which the water right is located.)
- ☒ ☐ N/A Supplemental Form D – For water rights served by or issued in the name of a district. Complete when the temporary transfer applicant is not the district.
- ☐ ☒ N/A Oregon Water Resources Department's Land Use Information Form with approval and signature (or signed land use form receipt stub) from each local land use authority in which water is to be diverted, conveyed, and/or used. Not required if water is to be diverted, conveyed, and/or used only on federal lands or if **all** of the following apply: a) a change in place of use only, b) no structural changes, c) the use of water is for irrigation only, and d) ,
- ☐ ☒ N/A Water Well Report/Well Log for changes in point(s) of appropriation (well(s)) or additional point(s) of appropriation (if necessary to convey water to the proposed place of use).

(For Staff Use Only)

WE ARE RETURNING YOUR APPLICATION FOR THE FOLLOWING REASON(S):

- ☐ Application fee not enclosed/or is insufficient ☐ Map not included or incomplete
- ☐ Land Use Form not enclosed or incomplete
- ☐ Additional signature(s) required ☐ Part _____ is incomplete

Other/Explanation _____

Staff: _____ 503-986-0 _____

Date: ____/____/____

Part 2 of 5 – Temporary Transfer Application Map Checklist

OWRD

Your temporary transfer application will be returned if any of the map requirements listed below are not met.

items and matches the existing water right map. Check all boxes that apply.

- ☒ ☐ N/A If more than three water rights are involved, separate maps are needed for each water right.
- ☒ Permanent quality printed with dark ink on good quality paper.
- ☒ The size of the map can be 8½ x 11 inches, 8½ x 14 inches, 11 x 17 inches, or up to 30 x 30 inches. For 30 x 30 inch maps, one extra copy is required.
- ☒ A north arrow, a legend, and scale.
- ☒ The scale of the map must be: 1 inch = 400 feet, 1 inch = 1,320 feet; the scale of the Final Proof/Claim of Beneficial Use Map (the map used when the permit was certificated); the scale of the county assessor map if the scale is not smaller than 1 inch = 1,320 feet; or a scale that has been pre-approved by the Department.
- ☒ Township, Range, Section, ¼ ¼, DLC, Government Lot, and other recognized public land survey lines.
- ☒ Tax lot boundaries (property lines) are required. Tax lot numbers are recommended.
- ☒ Major physical features including rivers and creeks showing direction of flow, lakes and reservoirs, roads, and railroads.
- ☒ Major water delivery system features from the point(s) of diversion/appropriation such as main pipelines, canals, and ditches.
- ☒ Existing place of use that includes separate hachuring for each water right, priority date, and use including number of acres in each quarter-quarter section, government lot, or in each quarter-quarter section as projected within government lots, donation land claims, or other recognized public land survey subdivisions. If less than the entirety of the water right is being changed, a separate hachuring is needed for lands left unchanged.
- ☒ ☐ N/A Proposed temporary place of use that includes separate hachuring for each water right, priority date, and use including number of acres in each quarter-quarter section, government lot, or in each quarter-quarter section as projected within government lots, donation land claims, or other recognized public land survey subdivisions.
- ☒ Existing point(s) of diversion or well(s) with distance and bearing or coordinates from a recognized survey corner. This information can be found in your water right certificate or permit.
- ☐ ☒ N/A If you are proposing a change in point(s) of diversion or well(s) to convey water to the new temporary place of use, show the proposed location and label it clearly with distance and bearing or coordinates. If GPS coordinates are used, latitude-longitude coordinates may be expressed as either degrees-minutes-seconds with at least one digit after the decimal

Part 3 of 5 – Fee Worksheet

FEE WORKSHEET for TEMPORARY DROUGHT TRANSFERS			
1	Base Fee (includes drought application and recording fee for up to 1 cfs)	1	\$200.00
2	Enter the cfs for the portions of the rights to be transferred (see example below*): _____ (2a)		
	Subtract 1.0 from the number in 2a above: _____ (2b)		
	If 2b is 0, enter 0 on line 2 » » » » » » » » » » » » » » » »		
	If 2b is greater than 0, round up to the nearest whole number: _____ (2c)		
2	and multiply 2c by \$50, then enter on line 2 » » » » » » » » »	2	
3	Add entries on lines 1 through 2 above » » » » » » » » » » Transfer Fee:	3	

1. Divide total authorized cfs by total acres in the water right (for C12345, $1.25 \text{ cfs} \div 100 \text{ ac}$); then multiply by the number of acres to be transferred to get the transfer cfs ($\times 45 \text{ ac} = 0.56 \text{ cfs}$).
2. If the water right certificate does not list total cfs, but identifies the allowable use as 1/40 or 1/80 of a cfs per acre; multiply number of acres proposed for change by either 0.025 (1/40) or 0.0125 (1/80). (For C87654, $45.0 \text{ ac} \times 0.0125 \text{ cfs/ac} = 0.56 \text{ cfs}$)
3. Add cfs for the portions of water rights on all the land included in the transfer; however **do not count cfs for supplemental rights on acreage for which you have already calculated the cfs fee for the primary right on the same land**. The fee should be assessed only once for each "on the ground" acre included in the transfer. (In this example, blank 2a would be only 0.56 cfs, since both rights serve the same 45.0 acres. Blank 2b would be 0 and Line 2 would then also become 0).

OWPD

FEB 29 2024

Received

Part 4 of 5 – Applicant Information and Signature

Applicant Information

APPLICANT/BUSINESS NAME David Correa			PHONE NO. (541) 376-8183	ADDITIONAL CONTACT NO. (541) 379-5675 cell
ADDRESS 31777 Andrews Road				FAX NO.
CITY Echo	STATE OR.	ZIP 97826	E-MAIL	
BY PROVIDING AN E-MAIL ADDRESS, CONSENT IS GIVEN TO RECEIVE ALL CORRESPONDENCE FROM THE DEPARTMENT ELECTRONICALLY. COPIES OF THE FINAL ORDER DOCUMENTS WILL ALSO BE MAILED.				

Agent Information – The agent is authorized to represent the applicant in all matters relating to this application.

AGENT/BUSINESS NAME William I. Porfily			PHONE NO.	ADDITIONAL CONTACT NO. (541) 561-7259 cell.
ADDRESS P.O. Box 643				FAX NO.
CITY Stanfield	STATE OR.	ZIP 97875	E-MAIL wporfily@gmail.com	
BY PROVIDING AN E-MAIL ADDRESS, CONSENT IS GIVEN TO RECEIVE ALL CORRESPONDENCE FROM THE DEPARTMENT ELECTRONICALLY. COPIES OF THE FINAL ORDER DOCUMENTS WILL ALSO BE MAILED.				

Explain in your own words what you propose to accomplish with this transfer application and why:

We propose to transfer small areas irrigated with hand lines and flood irrigation to an area under a center pivot. The irrigation with a center pivot is a much more economically, (financially), and efficiently, (less water used), use of the irrigation water.

This Temporary Transfer Application is Identical to 2021 Temporary Transfer T-13723 and 2023 Temporary Transfer T-13955.

If you need additional space, continue on a separate piece of paper and attach to the application as "Attachment 1".

I (we) affirm that the information contained in this application is true and accurate.

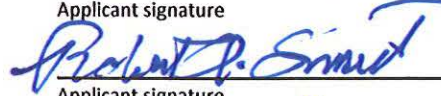
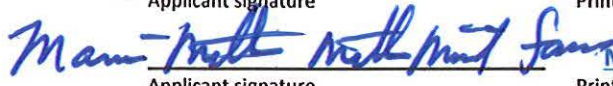
 Applicant signature	David Correa Owner Print Name (and Title if applicable)	1-5-24 Date
 Applicant signature	Robert Emert Owner Print Name (and Title if applicable)	1-24-24 Date
 Applicant signature	Marvin Mills an Owner Print Name (and Title if applicable)	1-24-24 Date

Is the applicant the sole owner of the land on which the water right, or portion thereof, proposed for transfer is located? ☒ Yes ☒ No: **Two of three of the right involved in From Areas in this Transfer are owned by third parties (Mills and Emert) and they have signed the application.**

If NO, include signatures of all landowners (and mailing and/or e-mail addresses if different than the applicant's) or attach affidavits of consent from all landowners or individuals/entities (and mailing and/or e-mail addresses) to which the water right(s) has been conveyed.

Received

FEB 29 2024

☒ Check here if any of the water rights proposed for transfer are or will be located within or served by an irrigation or other water district. (NOTE: If this box is checked, you must complete and attach Supplemental Form D.)

DISTRICT NAME Westland Irrigation District	ADDRESS P.O. Box 944	
CITY Hermiston	STATE OR.	ZIP 97838

☒ Check here if water for any of the rights supplied under a water service agreement or other contract for stored water with a federal agency or other entity.

ENTITY NAME U.S. Bureau of Reclamation, Pacific N.W. Region	ADDRESS 1150 N. Curtis Rd.	
CITY Boise	STATE Idaho	ZIP 83706-1234

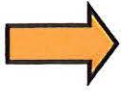

To meet State Land Use Consistency Requirements, you must list all local governments (each county, city, municipal corporation, or tribal government) within whose jurisdiction water will be diverted, conveyed and/or used.

ENTITY NAME Umatilla County	ADDRESS 216 S.E. 4th	
CITY Pendleton	STATE OR.	ZIP 97801

ENTITY NAME	ADDRESS	
CITY	STATE	ZIP

Received
FEB 29 2024
OWRD

Part 5 of 5 – Water Right Information

Please use a separate Part 5 for each water right being changed. See instructions on page 6, to copy and paste additional Part 5s, or to add rows to tables within the form.

Water Right Certificate # Umatilla Decrees Pioneer Irrigation Company Vol. 3 Page 239, (Elmar Reeves); Vol. 3 Page 240, (Geo. Ward) & Vol. 3 Page 239, & Vol. 15 Page 432, (Frank Correa Sr.)

Description of Water Delivery System:

System capacity: 6.0 cubic feet per second (cfs) **OR**

_____ gallons per minute (gpm)

Describe the current water delivery system or the system that was in place at some time within the last five years. Include information on the pumps, canals, pipelines, and sprinklers used to divert, convey, and apply the water at the authorized place of use. These Rights are served by the Pioneer Irrigation Company through the Pioneer Ditch. The Pioneer Ditch received water from the Westland Irr. Dist. Main Canal Headgate # G-2, (Pioneer – Courtney head gate), about 1 mile from the Westland Irr. Dist. Point of Diversion from the Umatilla River.

Table 1. Location of Authorized and Proposed Point(s) of Diversion (POD) or Appropriation (POA)

(Note: If the POD/POA name is not specified on the certificate, assign it a name or number here.)

POD/POA Name or Number	Is this POD/POA Authorized on the Certificate or is it Proposed?	If POA, OWRD Well Log ID# (or Well ID Tag # L-___)	Twp		Rng		Sec		¼ ¼		Tax Lot, DLC or Gov't Lot	Measured Distances (from a recognized survey corner)
W.I.D. Div.	<input checked="" type="checkbox"/> Authorized <input type="checkbox"/> Proposed	N/A	3	N	29	E	21		SW	NE		N.76°45'56"E. 2913.19' from W. ¼ Cor. Sec. 21
	<input type="checkbox"/> Authorized <input type="checkbox"/> Proposed											

Check all type(s) of temporary change(s) proposed below (change "CODES" are provided in parentheses):

- | | |
|---|---|
| <input checked="" type="checkbox"/> Place of Use (POU) | <input type="checkbox"/> Appropriation/Well (POA) |
| <input type="checkbox"/> Point of Diversion (POD) | <input type="checkbox"/> Additional Point of Appropriation (APOA) |
| <input type="checkbox"/> Additional Point of Diversion (APOD) | |

Check all type(s) of temporary change(s) due to drought proposed below (change "CODES" are provided in parentheses):

- | | |
|---|---|
| <input type="checkbox"/> Place of Use (POU) | <input type="checkbox"/> Point of Appropriation/Well (POA) |
| <input type="checkbox"/> Character of Use (USE) | <input type="checkbox"/> Additional Point of Appropriation (APOA) |
| <input type="checkbox"/> Point of Diversion (POD) | <input type="checkbox"/> Additional Point of Diversion (APOD) |

Will all of the proposed changes affect the entire water right?

- ☐ Yes Complete only the Proposed ("to" lands) section of Table 2 on the next page. Use the "CODES" listed above to describe the proposed changes.
- ☒ No Complete all of Table 2 to describe the portion of the water right to be changed.

OWRD
FEB 29 2024
Received

Please use and attach additional pages of Table 2 as needed.
See page 6 for instructions.

Do you have questions about how to fill-out the tables?
Contact the Department at 503-986-0900 and ask for Transfer Staff.

Table 2. Description of Temporary Changes to Water Right Certificate # Umatilla Decrees Pioneer Irrigation Company Vol. 3 Page 239, (Elmar Reeves); Vol. 3 Page 240, (Geo. Ward) & Vol. 3 Page 239, & Vol. 15 Page 432, (Frank Correa Sr.)

List only the part of the right that will be changed. For the acreage in each ¼ ¼, list the change proposed. If more than one change, specify the acreage associated with each change. If more than one POD/POA, specify the acreage associated with each POD/POA.

AUTHORIZED (the “from” or “off” lands) The listing that appears on the certificate BEFORE PROPOSED CHANGES List only that part or portion of the water right that will be changed.										Proposed Changes (see “CODES” from previous page)	PROPOSED (the “to” or “on” lands) The listing as it would appear AFTER PROPOSED CHANGES are made.														
Twp	Rng	Sec	¼	¼	Tax Lot	Gvt Lot or DLC	Acres	Type of USE listed on Certificate	POD(s) or POA(s) (name or number from Table 1)		Priority Date	Twp	Rng	Sec	¼	¼	Tax Lot	Gvt Lot or DLC	Acres	New Type of USE	POD(s)/ POA(s) to be used (from Table 1)	Priority Date			
										Elmar Reeves - Emert															
4	N	29	E	31	SW	SE	1600		7.0	Umatilla River	1/9/1900	POU													
										Geo Ward - Emert															
4	N	29	E	31	SE	SW	1600		2.5	Umatilla River	1/9/1900														
4	N	29	E	31	SE	SW	1600		6.0	Umatilla	1/9/1900	POU													
										B. F. McCullough & Frank Correa Sr.*- Correa															
3	N	29	E	8	NE	SW	2601		8.0	Umatilla River	1/9/1900	POU	3	N	29	E	12	NE	SE	4000		19.0		1/9/1900	
3	N	29	E	8	SE	SW	2601		10.0	Umatilla River	1/9/1900	POU	*3	N	28	E	12	SE	SE	4000		30		1/9/1900	
3	N	29	E	8	NW	SE	2601		12.0	Umatilla River	1/9/1900	POU									49.0				
3	N	29	E	8	SW	SE	2601		3.5	Umatilla River	1/9/1900	POU									0				
TOTAL ACRES							49.0						TOTAL ACRES							49.0					

Additional remarks: *Some of the irrigated acres described above have appurtenant supplemental water rights for irrigation described in Permit 7400 and Certificate 31294. No supplemental water Rights under Permit 7400 or Certificate 31294 will be transferred for use on the “to” lands, and no supplemental water will be used on the “Proposed” land during the 3 year period. Also some of the acres describe in this application are describe in Permits 55061, 55192, 55190, & 54633 “No Planned Active Irrigation” is proposed this year on ANY of these lands involving these permits. This Transfer is identical to the 2023 Transfer T-13955 and the 2021 Transfer T-13723

Please see ORS 540.523; OAR 690-380-8020.

Water Right Certificate # Umatilla Decrees Pioneer Irrigation Company Vol. 3 Page 239, (Elmar Reeves); Vol. 3 Page 240, (Geo. Ward) & Vol. 3 Page 239, & Vol. 15 Page 432, (Frank Correa Sr.)

For Place of Use Changes

Are there other water right certificates, water use permits or ground water registrations associated with the "from" or the "to" lands? ☒ Yes ☐ No

If YES, list the certificate, water use permit, or ground water registration numbers: Permit 7400

Pursuant to ORS 540.525, any "layered" water use such as an irrigation right that is supplemental to a primary right proposed for temporary transfer can be included in the transfer or remain unused on the authorized place of use. If the primary water right does not revert soon enough to allow use of the supplemental right within five years, the supplemental right shall become subject to cancellation for nonuse under ORS 540.610.

If a change in point(s) of appropriation (well(s)) or additional point(s) of appropriation is necessary to convey the water to the new temporary place of use you must provide: N/A

- ☐ Well log(s) for each authorized and proposed well(s) that are clearly labeled and associated with the corresponding well(s) in Table 1 above and on the accompanying application map. (Tip: You may search for well logs on the Department's web page at: http://apps.wrd.state.or.us/apps/gw/well_log/Default.aspx)

AND/OR

- ☐ Describe the construction of the authorized and proposed well(s) in Table 3 below for any well that does not have a well log. For a *proposed well(s) not yet constructed or built*, provide "a best estimate" for each requested information element in the table. The Department recommends you consult a licensed well driller, geologist, or certified water right examiner to assist with assembling the information necessary to complete Table 3.

Table 3. Construction of Point(s) of Appropriation

Any well(s) in this listing must be clearly tied to corresponding well(s) described in Table 1 and shown on the accompanying application map. Failure to provide the information will delay the processing of your transfer application until it is received. The information is necessary for the Department to assess whether the proposed well(s) will access the same source aquifer as the authorized point(s) of appropriation (POA). The Department is prohibited by law from approving POA changes that do not access the same source aquifer.

Proposed or Authorized POA Name or Number	Is well already built? (Yes or No)	If an existing well, OWRD Well ID Tag No. L-___	Total well depth	Casing Diameter	Casing Intervals (feet)	Seal depth(s) (intervals)	Perforated or screened intervals (in feet)	Static water level of completed well (in feet)	Source aquifer (sand, gravel, basalt, etc.)	Well - specific rate (cfs or gpm). If less than full rate of water right

Received

FEB 29 2024

OWRD

Part 5 of 5 – Water Right Information

Please use a separate Part 5 for each water right being changed. See instructions on page 6, to copy and paste additional Part 5s, or to add additional rows to tables within the form.

Certificate Umatilla Decree Alen Dich Company Vol. 3 Page 195, (Fred Andrews).

Description of Water Delivery System

System capacity: 14.0 cubic feet per second (cfs) **OR**
 _____ gallons per minute (gpm)

Describe the current water delivery system or the system that was in place at some time within the last five years. Include information on the pumps, canals, pipelines and sprinklers used to divert, convey and apply the water at the authorized place of use. The authorized place of use was flood irrigated from the Allen Ditch Delivery System. The Allen Ditch, 8 ft. wide x 3 ft. deep, diverts water from the Westland Irrigation District's Westland Canal at #G-4C Allen Ditch Headgate. The Allen Ditch delivers water approximately 2.5 miles from this head gate to the Mills Mint Farm parcel. The Mills Mint Farm parcel is irrigated by two center pivots. The acreage in the corners around the pivots in this application are flood irrigated.

Table 1. Location of Authorized and Proposed Point(s) of Diversion (POD) or Appropriation (POA)

Note: If the POD/POA name is not specified on the certificate, assign it a name or number here.)

POD/POA Name or Number	Is this POD/POA Authorized on the Certificate or is it Proposed?	If POA, OWRD Well Log ID# (or Well ID Tag # L-___)	Twp		Rng		Sec	¼ ¼		Tax Lot, DLC or Gov't Lot	Measured Distances (from a recognized survey corner)
W.I.D. Div.	<input checked="" type="checkbox"/> Authorized <input type="checkbox"/> Proposed	N/A	3	N	29	E	21	SW	NE		N.76°45'56" E. 2913.19' from W. ¼ Cor. Sec. 21
	<input type="checkbox"/> Authorized <input type="checkbox"/> Proposed										

Check all type(s) of temporary change(s) due to drought proposed below (change "CODES" are provided in parentheses): N/A

- | | |
|--|--|
| <input checked="" type="checkbox"/> Place of Use (POU)
<input type="checkbox"/> Character of Use (USE)
<input type="checkbox"/> Point of Diversion (POD) | <input type="checkbox"/> Point of Appropriation/Well (POA)
<input type="checkbox"/> Additional Point of Appropriation (APOA)
<input type="checkbox"/> Additional Point of Diversion (APOD) |
|--|--|

Will all of the proposed changes affect the entire water right?

- ☐ **Yes** Complete only the Proposed ("to" lands) section of Table 2 on the next page. Use the "CODES" listed above to describe the proposed changes.
- ☒ **No** Complete all of Table 2 to describe the portion of the water right to be changed.

Do you have questions about how to fill-out the tables?
Contact the Department at 503-986-0900 and ask for Transfer Staff.

List only the part of the right that will be changed. For the acreage in each ¼ ¼, list the change proposed. If more than one change, specify the acreage associated with each change. If more than one POD/POA, specify the acreage associated with each POD/POA.

Additional remarks: Also some of the acres describe in this application are describe in Permits 55061, 55192, 55190, & 54633 “No Planned Active Irrigation” is proposed this year on ANY of these lands involving these permits. This Transfer is identical to the 2023 Transfer T-13955 and the 2021 Transfer T-13723

TACS

For Place of Use Changes

Are there other water right certificates, water use permits or ground water registrations associated with the "from" or the "to" lands? ☒ Yes ☐ No

If YES, list the certificate, water use permit, or ground water registration numbers: _____

Pursuant to ORS 540.525, any "layered" water use such as an irrigation right that is supplemental to a primary right proposed for temporary transfer can be included in the transfer or remain unused on the authorized place of use. If the primary water right does not revert soon enough to allow use of the supplemental right within five years, the supplemental right shall become subject to cancellation for nonuse under ORS 540-610.

For a change in point(s) of appropriation (well(s)) or additional point(s) of appropriation if necessary to convey the water to the new temporary place of use:

- ☐ Well log(s) are attached for each authorized and proposed well(s) that are clearly labeled and associated with the corresponding well(s) in Table 1 above and on the accompanying application map. (Tip: You may search for well logs on the Department's web page at: http://apps.wrd.state.or.us/apps/gw/well_log/Default.aspx)

AND/OR

- ☐ Describe the construction of the authorized and proposed well(s) in Table 3 for any wells that do not have a well log. For *proposed wells not yet constructed or built*, provide "a best estimate" for each requested information element in the table. The Department recommends you consult a licensed well driller, geologist, or certified water right examiner to assist with assembling the information necessary to complete Table 3.

Table 3. Construction of Point(s) of Appropriation

Any well(s) in this listing must be clearly tied to corresponding well(s) described in Table 1 and shown on the accompanying application map. Failure to provide the information will delay the processing of your transfer application until it is received. The information is necessary for the department to assess whether the proposed well(s) will access the same source aquifer as the authorized point(s) of appropriation (POA). The Department is prohibited by law from approving

Proposed or Authorized POA Name or Number	Is well already built? (Yes or No)	If an existing well, OWRD Well ID Tag No. L-___	Total well depth	Casing Diameter	Casing Intervals (feet)	Seal depth(s) (intervals)	Perforated or screened intervals (in feet)	Static water level of completed well (in feet)	Source aquifer (sand, gravel, basalt, etc.)	Well - specific rate (cfs or gpm). If less than full rate of water right
N/A										

POA changes that do not access the same source aquifer.

Received

FEB 29 2024

**Water Right Transfer
EVIDENCE OF USE AFFIDAVIT**

Received
FEB 29 2024
OWRD

State of Oregon)
) ss
County of Umatilla)

I, David Correa, in my capacity as Lessee and Land Owner,
mailing address 31777 Andrews Road, Echo, OR. 97826
telephone number (541) 379-5675, being first duly sworn depose and say:

1. My knowledge of the exercise or status of the water right is based on (check one):

☒ Personal observation ☐ Professional expertise

2. I attest that:

☒ Water was used during the previous five years on the **entire** place of use for Certificates

Umatill River Decree Vol. 3 Pages 195, 239 and 240; OR

☐ My knowledge is specific to the use of water at the following locations within the last 5 yrs.:

Certificate #	Township		Range		Mer	Sec	¼ ¼ Section	Gov't Lot or DLC	Acres (if applicable)
Vol. 3 Page 239	3	N	29	E		8	NE SW	2300	8.0
Vol. 3 Page 239	3	N	29	E		8	SE SW	2601	10.
Vol. 3 Page 239 & Vol 15 Page 432	3	N	29	E		8	NW SE	2601	12.0
Vol. 3 Page 239	3	N	29	E		8	SW SE	2601	3.5
Vol.3 Page 195	3	N	29	E		7	NE SE	2300	5.5
Vol.3 Page 195	3	N	29	E		7	SE SE	2300	5.5
Vol. 3 Page 239	4	N	29	E		31	SW SE	1600	7.0
Vol. 3 Page 240	4	N	29	E		31	NE SW	1600	8.5

OR

☐ Part or all of the water right was leased instream at some time within the last five years. The instream lease number is: _____ (Note: If the entire right proposed for transfer was not leased, additional evidence of use is needed for that portion not leased instream.); **OR**

☐ Water has been used at the actual current point of diversion or appropriation for more than 10

Please print legibly or type. Be as specific as possible. Attach additional pages if you need more space. Supporting documentation must be attached.

Received

FEB 29 2024

OWRD

years for Certificate # _____ (For Historic POD/POA Transfers)

3. The water right was used for: (e.g., crops, pasture, etc.): crops.

4. I understand that if I do not attach one or more of the documents shown in the table below to support the above statements, my application will be considered incomplete.

Signature of Affiant

David Correa

Date

1-5-24

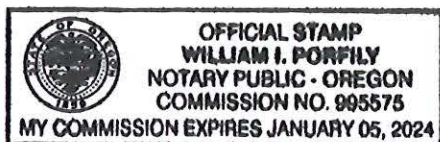
Signed and sworn to (or affirmed) before me this 5 day of JAN, 20 24.

Notary Public for Oregon
My Commission Expires: JAN 5, 2024

Supporting Documents	Examples
Copy of a water right certificate that has been issued within the last five years. (not a remaining right certificate)	Copy of confirming water right certificate that shows issue date
Copies of receipts from sales of irrigated crops or for expenditures related to use of water:	<ul style="list-style-type: none"> • Power usage records for pumps associated with irrigation use • Fertilizer or seed bills related to irrigated crops • Farmers Co-op sales receipt
Records such as FSA crop reports, irrigation district records, NRCS farm management plan, or records of other water suppliers <u>2019 Westland Irrigation Dist. Ditch Riders Records</u>	<ul style="list-style-type: none"> • District assessment records for water delivered • Crop reports submitted under a federal loan agreement • Beneficial use reports from district • IRS Farm Usage Deduction Report • Agriculture Stabilization Plan • CREP Report
Aerial photos containing sufficient detail to establish location and date of photograph	<p>Multiple photos can be submitted to resolve different areas of a water right.</p> <p>If the photograph does not print with a "date stamp" or without the source being identified, the date of the photograph and source should be added.</p> <p>Sources for aerial photos: OSU – www.oregonexplorer.info/imagery OWRD – www.wrd.state.or.us Google Earth – earth.google.com TerraServer – www.terraserver.com</p>
Approved Lease establishing beneficial use within the last 5 years	Copy of instream lease or lease number

Please print legibly or type. Be as specific as possible. Attach additional pages if you need more space. Supporting documentation must be attached.

Headgate #	Name	Meter	Pump Capacity	Total	notes
	ALLEN EXCHANGE-JEFF SPIKE		13.5 / 11.8	267.30	Jeff Spike Allen Exchange
	ALLEN EXCHANGE-DAN MILLS		13.5 / 11.8	213.84	Dan Mills Alle Exchange
G-2	PIONEER/COURTNEY			1103.06	PIONEER/COURTNEY
G-2	DAVID CORREA - PRIVATE			0.00	David Correa private
	DRL - DAN MILLS - PRIVATE			0.00	Dan Mills private
	DICK CORREA - PRIVATE			0.00	Dick Correa private
	DAN BAREMORE - PRIVATE			0.00	Dan Baremore private
G-2A	CORREA/MILLS PIONEER EXCHANGE USE			17.50	
	PIONEER EXCHANGE - DAVID CORREA			20.79	David Correa Pioneer Exchange
	PIONEER EXCHANGE - DAN MILLS			0.00	Dan Mills Pioneer Exchange
	COURTNEY EXCHANGE - DAVID CORREA			0.00	David Correa Courtney Exchange
	COURTNEY EXCHANGE - DAN MILLS			0.00	Dan Mill/Spike Ranch Courtney Exchange
G-8B	CORREA, DAVID	93-18-0853		16.94	

Received
FEB 29 2024
OWRD

Supplemental Form D

Water Right Transfers Within the Boundaries of or Served by an Irrigation District or other Water Supplier (Association, Ditch Co., etc.)

[For transfers submitted under OAR Chapter 690 Division 380]



Oregon Water Resources Department
725 Summer Street NE, Suite A
Salem, Oregon 97301-1266
503-986-0900
www.oregon.gov/OWRD

The Department requires non-district applicants to communicate with districts/water suppliers during the planning and preparation of transfer applications involving water rights having a point of diversion or appropriation (POD/POA) or place of use (POU) served by or located within the boundaries of an irrigation district, or other type of water supplier to which assessments are paid. In some cases consent will be required from the district or water supplier.

This form must be included with any transfer application that involves rights served by or located within the boundaries of a district or other type of water supplier.

1. APPLICANT INFORMATION

NAME DAVID CORREA		PHONE (HM) (541) 376-8183	
PHONE (WK)	CELL (541) 379-5675 cell	FAX	
ADDRESS 31777 ANDREWS ROAD			
CITY ECHO	STATE OR	ZIP 97875	E-MAIL**

2. DISTRICT or WATER SUPPLIER INFORMATION

DISTRICT/WATER SUPPLIER NAME WESTLAND IRRIGATION DISTRICT		PHONE (HM)	
PHONE (WK) (541) 667-2030	CELL	FAX	
ADDRESS P.O. Box 944			
CITY HERMISTON	STATE OR	ZIP 97838	E-MAIL** Curtis Engbretson <CURTIS@WESTLANDIRRIGATION.COM>

** By providing an e-mail address, the applicant and/or the district/water supplier consents to receive all correspondence from the Department electronically. Copies of final order documents will also be mailed.

3. WATER RIGHTS ISSUED IN THE NAME OF, or LOCATED WITHIN, or SERVED BY AN IRRIGATION DISTRICT, OTHER DISTRICT, OR WATER SUPPLIER

a. List the water right(s) involved in this transfer:

	Application / Decree	Permit / Previous Transfer	Certificate	Is the water right in the name of a district, water supplier, or BOR*?
--	----------------------	----------------------------	-------------	--

Received

FEB 29 2024

OWRD

1.	<u>Umatilla</u> <u>Decrees Pioneer</u> <u>Irrigation</u> <u>Company Vol. 3</u> <u>Page 239,</u> <u>(Elmar Reeves);</u> <u>Vol. 3 Page 240,</u> <u>(Geo. Ward) &</u> <u>Vol. 3 Page 239,</u> <u>& Vol. 15 Page</u> <u>432, (Frank</u> <u>Correa Sr.)</u>	-		<div style="text-align: right;"> Received FEB 29 2024 OWRD </div> <div> YES <input type="checkbox"/> </div>
2.	<u>Umatilla Drcree</u> <u>Alen Dich</u> <u>Company Vol. 3</u> <u>Page 195, (Fred</u> <u>Andrews).</u>	-		<div> YES <input type="checkbox"/> </div>
3.		-		<div> YES <input type="checkbox"/> </div>

Attach additional pages for additional water rights if necessary.

*Bureau of Reclamation

- b. Determine a district's/water supplier's connection to your points of diversion (POD) or appropriation (POA) and places of use (POU). [You may need to consult with your district/water supplier.]

CURRENT ASSOCIATIONS Please answer the following "yes" or "no" questions:

- YES ☒ NO ☐ One or more of the current POD(s) / POA(s) involved in the transfer are served by a district/water supplier or rely on BOR water.
- YES ☐ NO ☒ All or a portion of the current POU involved in this proposed transfer receives water for either primary or supplemental irrigation from the district/water supplier; i.e., the POU is currently layered with a district or BOR water supplied water right(s).

PROPOSED ASSOCIATIONS Please answer the following "yes" or "no" questions:

- YES ☒ NO ☐ One or more of the proposed POD(s) / POA(s) involved in the transfer are currently served or will be served by a district/water supplier if the transfer is approved, or rely on BOR water.
- YES ☐ NO ☒ All or a portion of the proposed POU involved in this proposed transfer currently receives or will receive either primary or supplemental irrigation from the district/water supplier; i.e., the POU will be layered with a district/water supplier or BOR water supplied water right(s).

COMMENTS OR ADDITIONAL INFORMATION

4. APPLICANT'S SIGNATURE

- (1) I certify that I have notified the district/water supplier about the proposed water right transfer application by [check one]:

☐ email, ☐ phone, ☐ postal mail, ☒ in person, or ☐ other (please specify) _____

- (2) I certify that to the best of my knowledge the information contained in this Supplemental Form D is true and accurate.

Applicant Signature

Name (print)

Date

5. (WHEN REQUIRED) DISTRICT or WATER SUPPLIER CONSENT TO THE PROPOSED WATER RIGHT TRANSFER

District Manager or Water Supplier consent is required if any box on this form is marked "YES."

The district/water supplier certifies the following:

(1) The district/water supplier has reviewed the applicant's proposed water right transfer application and maps; and

(2) The district/water supplier consents to the proposed water right transfer application.

YES ☒ NO ☐ After proof of completion, the confirming water right certificate is to remain in the name of the U.S. Bureau of Reclamation or the district/water supplier.

YES ☐ NO ☒ The district/water supplier will be responsible for submitting the claim of beneficial use prepared by a Certified Water Rights Examiner (CWRE).

Signature of District Manager /Water Supplier

Curtis Engbretson Mngr
Name (print), Title

1-26-2024
Date

Received

FEB 29 2024

OWRD

SEND TAX STATEMENTS TO:

AFTER RECORDING RETURN TO:

STATUTORY SPECIAL WARRANTY DEED

Nels R. Nelson and Barbara A. Nelson, husband and wife, as Grantor, hereby conveys and specially warrants to Robert A. Emert and Jerri V. Emert, Trustees of the Robert and Jerri Emert Living Trust dated June 17, 2008, and any amendments thereto, Grantee, the following described real property free of encumbrances created or suffered by the Grantor except as specifically set forth herein, situated in Umatilla County, Oregon to-wit:

The real property described on Exhibit "A" which is attached hereto and by this reference incorporated herein.

The true and actual consideration for this conveyance is \$360,000.00. This deed is in fulfillment of a Land Sale Contract dated June 17, 2014.

BEFORE SIGNING AND ACCEPTING THIS INSTRUMENT, THE PERSON TRANSFERRING FEE TITLE SHOULD INQUIRE ABOUT THE PERSON'S RIGHTS, IF ANY, UNDER ORS 195.300, 195.301 AND 195.305 TO 195.336 AND SECTIONS 5 TO 11, CHAPTER 424, OREGON LAWS 2007, AND SECTIONS 2 TO 9 AND 17, CHAPTER 855, OREGON LAWS 2009, AND SECTIONS 2 TO 7, CHAPTER 8, OREGON LAWS 2010. THIS INSTRUMENT DOES NOT ALLOW USE OF THE PROPERTY DESCRIBED IN THIS INSTRUMENT IN VIOLATION OF APPLICABLE LAND USE LAWS AND REGULATIONS. BEFORE SIGNING OR ACCEPTING THIS INSTRUMENT, THE PERSON ACQUIRING FEE TITLE TO THE PROPERTY SHOULD CHECK WITH THE APPROPRIATE CITY OR COUNTY PLANNING DEPARTMENT TO VERIFY THAT THE UNIT OF LAND BEING TRANSFERRED IS A LAWFULLY ESTABLISHED LOT OR PARCEL, AS DEFINED IN ORS 92.010 OR 215.010, TO VERIFY THE APPROVED USES, OF THE LOT OR PARCEL, TO DETERMINE ANY LIMITS ON LAWSUITS AGAINST FARMING OR FOREST PRACTICES, AS DEFINED IN ORS 30.930 AND TO INQUIRE ABOUT THE RIGHTS OF NEIGHBORING PROPERTY OWNERS, IF ANY, UNDER ORS 195.300, 195.301 AND 195.305 TO 195.336 AND SECTIONS 5 TO 11, CHAPTER 424, OREGON LAWS 2007, AND SECTIONS 2 TO 9 AND 17, CHAPTER 855, OREGON LAWS 2009, AND SECTIONS 2 TO 7, CHAPTER 8, OREGON LAWS 2010.

Received

FEB 29 2024

OWRD

DATED this 18th day of June, 2014.

Nels R. Nelson
Nels R. Nelson, Grantor

Barbara A. Nelson
Barbara A. Nelson, Grantor

State of OREGON
County of Umatilla

This record was acknowledged before me on June 18th, 2014 by Nels R. Nelson and Barbara A. Nelson.

Amy Gail Freeman
Notary Public – State of Oregon

PREPARED BY:

David Wm. Hadley, OSB No. 81252
Attorney At Law
130 SE 3rd Street
Hermiston, OR 97838

nelsonmeritdeed1363

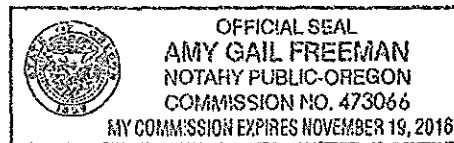

Received

FEB 29 2024

OWRD

TOWNSHIP 4 NORTH, RANGE 29, E.W.M.

Section 31: All that portion of the West Half of the Southeast Quarter lying Southerly and Westerly of the Umatilla River as it was located on January 1, 1980.

Section 31: East Half of the Southwest Quarter.

Excepting therefrom, beginning at the center of said Section 31; thence South along the North-South centerline of said Section, a distance of 18 rods (297 feet); thence Northwesterly, along a straight line, a distance of 80 rods (1,320 feet) more or less to a point in the West line of the Northeast Quarter of the Southwest Quarter of said Section, that is 13 rods (214.5 feet) South of the Northwest corner of said Northeast Quarter of the Southwest Quarter of Section 31; thence North along the West line of the Northeast Quarter of the Southwest Quarter of Section 31, a distance of 13 rods (214.5 feet) to the Northwest corner thereof; thence East along the East-West centerline of Section 31, a distance of 80 rods (1,320 feet) more or less to the point of beginning.

Excepting therefrom any portion of the described lands lying within the County Road right-of-way.

All being East of the Willamette Meridian, Umatilla County, Oregon.

Together with a 1979 Marlette Manufactured Home, Manufactured Serial No. 014270FBK60835, License No. X-245282, Home ID No. 290341, which is firmly affixed to the property and a part of it.

EXHIBIT A
PAGE 1 of 2

Received
FEB 29 2024
OWRD

SUBJECT TO:

1. As disclosed by the tax rolls the premises herein described have been zoned or classified for special use. At any time that said land is disqualified for such use said property will be subject to additional taxes and interest.
2. The premises herein described are within the boundaries of the Pioneer Ditch and Irrigation Company and this property is therefore subject to all easements, levies and assessments thereof.
3. Easement, including the terms and provisions thereof,
Grantee : Pacific Power & Light Company
Recorded : June 13, 1941 in Book 160, Page 198, Deed Records.
4. Grant and Agreement of Easements, including the terms and provisions thereof, between
First Party : Maria L. Norval, etal
Second Party : Stephen Mueller
Recorded : January 22, 1996 in Microfilm R-283, Page 1397, Office of Umatilla
County Records.
5. Right of the public and of governmental bodies in and to that portion of the premises herein described lying below the mean high water mark of the Umatilla River and any adverse claim based upon the assertion that some portion of said lands have been removed from or brought within the boundaries thereof by an avulsive movement of the Umatilla River or has been formed by the process of accretion or reliction or has been created by artificial means or has accreted to such portion so created, if any such exist.

nelsonmertesthibit064

EXHIBIT A
PAGE 2 of 2

Received
FEB 29 2024
OWRD

2010 5730713

2010-5730713 1 of 5

BARGAIN AND SALE DEED - STATUTORY FORM

Grantors Name:
Mills Mint Farm Inc., an Oregon Corporation

Grantees Name:
Danny L. Mills
June L. Mills

After recording return to:
Monahan, Grove & Tucker
105 North Main
Milton-Freewater, OR 97862

Until a change is requested, all tax statements shall
be sent to the following address:

Mr. & Mrs. Danny Mills
75944 Echo Meadows Rd.
Echo, OR 97826 - 9005

RECEIVED

DEC 28 2010

UMATILLA COUNTY
RECORDS

State of Oregon }
County of Umatilla }

This instrument was received
and recorded on

12-28-10 at 3:25

In the record of instrument
code type DE-B&S

Instrument Number 2010-5730713
Fee \$1.00

Office of County Records

Deann Humphill
Records Officer

Mills Mint Farm, Inc. Grantor, conveys to Danny L. Mills and June L. Mills,
husband and wife, Grantees, the following described real property.

See Exhibit A attached which is hereby referred to and made a part hereof.

The portion of tax lot 2500 which will be attached to tax lot 2300 is described in Exhibit
B. The revised description of tax lot 2300 is attached hereto as Exhibit C.

The true consideration for this conveyance is the exchange of other property
interests.

BEFORE SIGNING OR ACCEPTING THIS INSTRUMENT, THE PERSON
TRANSFERRING FEE TITLE SHOULD INQUIRE ABOUT THE PERSON'S
RIGHTS, IF ANY, UNDER ORS 195.300, 195.301 AND 195.305 TO 195.336 AND
SECTIONS 5 TO 11, CHAPTER 424, OREGON LAWS 2007. THIS INSTRUMENT
DOES NOT ALLOW USE OF THE PROPERTY DESCRIBED IN THIS
INSTRUMENT IN VIOLATION OF APPLICABLE LAND USE LAWS AND
REGULATIONS. BEFORE SIGNING OR ACCEPTING THIS INSTRUMENT, THE
PERSON ACQUIRING FEE TITLE TO THE PROPERTY SHOULD CHECK WITH
THE APPROPRIATE CITY OR COUNTY PLANNING DEPARTMENT TO VERIFY
THAT THE UNIT OF LAND BEING TRANSFERRED IS A LAWFULLY
ESTABLISHED LOT OR PARCEL, AS DEFINED IN ORS 92.010 OR 215.010, TO
VERIFY THE APPROVED USES OF THE LOT OR PARCEL, TO DETERMINE ANY

Received

FEB 29 2024

OWRD



2010-5730713 2 of 5

LIMITS ON LAWSUITS AGAINST FARMING OR FOREST PRACTICES, AS
DEFINED IN ORS 30.930, AND TO INQUIRE ABOUT THE RIGHTS OF
NEIGHBORING PROPERTY OWNERS, IF ANY, UNDER ORS 195.300, 195.301
AND 195.305 TO 195.336 AND SECTIONS 5 TO 11, CHAPTER 424, OREGON
LAWS, 2007.

Dated this 22 day of December, 2010.

Monte Mills
Mills Mint Farm Inc., President

Marvin Mills
Mills Mint Farm, Inc. Secretary

STATE OF OREGON)
) ss
County of Umatilla)

December 22, 2010.

Personally appeared Monte Mills and Marvin Mills, who
being duly sworn, did say that they are the President and Secretary of Mills Mint Farm,
Inc., an Oregon corporation, and that said instrument was signed in behalf of said
Corporation by authority of its Board of Directors; and they acknowledged the foregoing
instrument to be their voluntary act and deed. Before me.

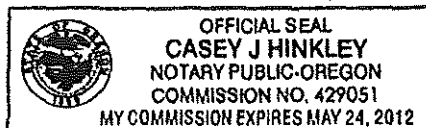

Casey J Hinkley
NOTARY PUBLIC FOR OREGON
My Commission Expires: May 24,
2012

\\Mgtserver\Data\MGT-3 Data\Sam's Docs\Clients\Mills\bargain and sale deed.danny.june.mills.5-6-10.doc

Received
FEB 29 2024

QWRD

EXHIBIT A



2010-5730713 3 of 5

February 4, 2010

DESCRIPTION OF REVISED TAX LOT 2500, ASSESSOR MAP NO. 3N 29B:

A tract of land located in the West half of the Southwest Quarter of Section 8, Township 3 North, Range 29 East, W.M., Umatilla County, Oregon, described as follows:

BEGINNING at the Southwest corner of the Southwest Quarter of said Section 8, thence North $00^{\circ}08'29''$ East along the West line of said Southwest Quarter a distance of 502.42 feet; thence North $89^{\circ}33'33''$ East a distance of 1324.59 feet to a point on the Westerly right-of-way line of Umatilla County Road No. 1347, A.K.A. Echo Meadows Road; thence South $00^{\circ}18'34''$ West along said Westerly right-of-way line a distance of 490.25 feet to a point on the South line of the Southwest Quarter of said Section 8; thence South $89^{\circ}01'54''$ West along said South line a distance of 1323.33 feet to the POINT OF BEGINNING.

Subject to any and all water rights-of-way and roads and canals.

Tract contains 15.08 acres, more or less.

\\danmillsrevt12500

Received

FEB 29 2024

OWRD

EXHIBIT B



2010-5730713 4 of 5

February 4, 2010

DESCRIPTION OF PORTION OF TAX LOT 2500, ASSESSOR MPA NO. 3N 29B TO
ATTACH TO TAX LOT 2300, ASSESSOR MAP NO. 3N 29D:

A tract of land located in the West half of the Southwest Quarter of Section 8, Township 3 North,
Range 29 East, W.M., Umatilla County, Oregon, described as follows:

The West Half of the of the Southwest Quarter, excepting therefrom, that portion of said West
Half of the Southwest Quarter described as follows:

BEGINNING at the Southwest corner of the Southwest Quarter of said Section 8, thence
North 00°08'29" East along the West line of said Southwest Quarter a distance of 502.42
feet; thence North 89°33'33" East a distance of 1324.59 feet to a point on the Westerly
right-of-way line of Umatilla County Road No. 1347, A.K.A. Echo Meadows Road; thence
South 00°18'34" West along said Westerly right-of-way line a distance of 490.25 feet to a
point on the South line of the Southwest Quarter of said Section 8; thence South 89°01'54"
West along said South line a distance of 1323.33 feet to the POINT OF BEGINNING.

Subject to any and all water rights-of-way and roads and canals.

Tract contains 63.10 acres, more or less.

\\danmillstl2500totl2300

Received
FEB 29 2024

OWRD



February 4, 2010

DESCRIPTION OF REVISED TAX LOT 2300, ASSESSOR MAP NO. 3N 29B:

That portion of the Southeast Quarter of Section 7, Township 3 North, Range 29 East, W.M., Umatilla County, Oregon, described as follows:

Beginning at a point on the West line of the Southeast Quarter of said Section 7, said point being 766.425 feet North of the Southwest corner of said Section 7; thence East and parallel with the South line of said Southeast Quarter to the East line of said Southeast Quarter; thence North along the East line of said Southeast Quarter to the Northeast corner of said Southeast Quarter; thence West along the North line of said Southeast Quarter to the Northwest corner of said Southeast Quarter; thence South along the West line of said Southeast Quarter to the point of beginning;

Subject to any and all water rights of way and roads, and canals.

The West Half of the Southwest Quarter of Section 8, Township 3 North, Range 29 East, W.M., Umatilla County, Oregon, excepting therefrom, the following tract:

BEGINNING at the Southwest corner of the Southwest Quarter of said Section 8, thence North 00°08'29" East along the West line of said Southwest Quarter a distance of 502.42 feet; thence North 89°33'33" East a distance of 1324.59 feet to a point on the Westerly right-of-way line of Umatilla County Road No. 1347, A.K.A. Echo Meadows Road; thence South 00°18'34" West along said Westerly right-of-way line a distance of 490.25 feet to a point on the South line of the Southwest Quarter of said Section 8; thence South 89°01'54" West along said South line a distance of 1323.33 feet to the POINT OF BEGINNING.

Subject to any and all water rights-of-way and roads and canals.

Land described contains 174.69 acres, more or less.

\\danmillsrevtl2300

Received

FEB 29 2024

OWRD

WARRANTY DEED

2003 4500491

KNOW ALL MEN BY THESE PRESENTS, That MANUEL J. CORREA who acquired title as MANUAL J. CORREA and IRENE M. CORREA, husband and wife, as tenants by the entirety hereinafter called grantor, for the consideration hereinafter stated, to grantor paid by DAVID M. CORREA and SUE ELLEN CORREA, husband and wife, as tenants by the entirety hereinafter called grantee, does hereby grant, bargain, sell and convey unto the said grantee and grantee's heirs, successors and assigns, that certain real property, with the tenements, hereditaments and appurtenances thereunto belonging or appertaining, situated in the County of UMATILLA and State of Oregon, described as follows, to-wit:

SEE EXHIBIT A WHICH IS MADE A PART HEREOF BY THIS REFERENCE

RECEIVED

OCT 23 2003

UMATILLA COUNTY
RECORDS

To Have and to Hold the same unto the said grantee and grantee's heirs, successors and assigns forever.
And said grantor hereby covenants to and with said grantee and grantee's heirs, successors and assigns, that grantor is lawfully seized in fee simple of the above granted premises, free from all encumbrances except

AS SET FORTH ON ATTACHED EXHIBIT "A"

and that grantor will warrant and forever defend the said premises and every part and parcel thereof against the lawful claims and demands of all persons whomsoever, except those claiming under the above described encumbrances.

The true and actual consideration paid for this transfer, stated in terms of dollars, is \$100,000.00.
~~However, the actual consideration consists of or includes other property or value given or promised which is (the whole/part of the) consideration (indicate which). (The sentence between the symbols &, if not applicable should be deleted. - See ORS 93.030.)~~

In construing this deed and where the context so requires, the singular includes the plural and all grammatical changes shall be implied to make the provisions hereof apply equally to corporations and to individuals.

In Witness Whereof, the grantor has executed this instrument this 22 day of OCTOBER 2003; if a corporate grantor, it has caused its name to be signed and seal affixed by its officers, duly authorized thereto by order of its board of directors.

THIS INSTRUMENT WILL NOT ALLOW USE OF THE PROPERTY DESCRIBED IN THIS INSTRUMENT IN VIOLATION OF APPLICABLE LAND USE LAWS AND REGULATIONS, BEFORE SIGNING OR ACCEPTING THIS INSTRUMENT, THE PERSON ACQUIRING FEE TITLE TO THE PROPERTY SHOULD CHECK WITH THE APPROPRIATE CITY OR COUNTY PLANNING DEPARTMENT TO VERIFY APPROVED USES AND TO DETERMINE ANY LIMITS ON LAWS ITS AGAINST FARMING OR FOREST PRACTICES AS DEFINED IN ORS 30.930.

Manuel J. Correa
MANUEL J. CORREA

IRENE M. CORREA

Irene M. Correa

STATE OF OREGON

County of Umatilla ss.

BE IT REMEMBERED, That on this 22 day of October, 2003, before me, the undersigned, a Notary Public in and for said County and State, personally appeared the within named MANUEL J. CORREA and IRENE M. CORREA

known to me to be the identical individual s described in and who executed the within instrument and acknowledged to me that they executed the same freely and voluntarily.

IN TESTIMONY WHEREOF, I have hereunto set my hand and affixed my official seal the day and year last above written.

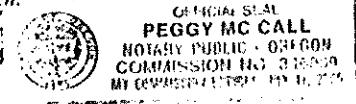

Peggy McCall

Notary Public for Oregon.

My Commission expires 7-11-2005

MANUEL J. CORREA

Grantor's Name and Address
DAVID M. CORREA
31777 ANDREWS ROAD
ECHO, OR 97826

Grantee's Name and Address
After recording return to:
PIONEER ESCROW, INC.
PO BOX 187
HEERMISTON, OR 97838

Until a change is requested, all tax statements shall be sent to the following address.

SAME AS GRANTEE



2003-4500491 1 of 2

STATE State of Oregon }
County of Umatilla }
This instrument was received and recorded on

10-23-03 at 3:15
In the record of instrument
code type DE-WD

Instrument Number 2003-4500491
Fee \$1.00

Office of County Records

Name

By

Deann Hemmiller
Records Officer

Space Reserved
for
Recorder's Use

Received

FEB 29 2024

OWRD

(2)

The East Half of the Southwest Quarter, and the West Half of the Southeast Quarter of Section 8, Township 3 North, Range 29, E.W.M.;

EXCEPT about ten acres of the above, described as follows:

Commencing 1423 feet West of the Southeast corner of the Northeast Quarter of Section 8; thence due West along the East and West line through the center of Section 8, 1090 feet to the middle of the Umatilla River; thence in a Southeasterly direction up the middle of said Umatilla River, 1174.5 feet to a point opposite a large rock on the East bank of said River; thence due East 90 feet to the West boundary of the right of way of the O. W. R. & N. Co.; thence in a Northeasterly direction along the West boundary of said right of way, 1032.5 feet to the point of beginning;

All being East of the Willamette Meridian in the County of Umatilla and State of Oregon;

EXCEPTING any and all water rights of way, ditches and roads;

ALSO EXCEPTING THEREFROM any and all railroad rights of way;

ALSO EXCEPTING THEREFROM that tract of land conveyed to United States of America, being described as follows, to-wit:

All that portion of the Northwest Quarter of the Southeast Quarter of Section 8, Township 3 North, Range 29, E. W. M., that lies between the Easterly boundary line of the right of way of the Oregon Railroad and Navigation Company (as it traverses said land) and a line parallel to, 50 feet distant from and on the Easterly side of the center line of the so called Umatilla Project Feed Canal, as the same is now located and staked out.

SUBJECT TO:

1. As disclosed by the tax rolls the premises herein described have been zoned or classified for special use. At any time that said land is disqualified for such use said property will be subject to additional taxes and interest.
2. The premises herein described are within the boundaries of the Stanfield Irrigation District and this property is therefore subject to all easements, levies and assessments thereof.
3. Subject to any and all water rights of way.
4. Easement for electric transmission and distribution line easement, including the terms and provisions thereof;
Grantee : Umatilla Electric Cooperative Association
Recorded : April 6, 1938, Book 120, page 428, Deed Records, Umatilla County, Oregon.
5. Right of the public and governmental bodied in and to that portion of said premises herein described lying below the high water mark of the Umatilla River.
6. Any adverse claim based upon the assertion that some portion of said lands have been removed from or brought within the boundaries thereof by an avulsive movement of the Umatilla River, or has been formed by the process of accretion or reliction or has been created by artificial means or has accreted to such portion so created.

Received

FEB 29 2024

OWRD

Regular Temporary Water Right Transfer Application Checklist

Checked by Jon

Date 3/4/24

A temporary transfer must be for a change in place of use. A temporary change in POD/POA or APOD/APOA cannot be accepted as a stand-alone change.

A change in POD/POA can accompany the temporary change in place of use, only if the proposed temporary POD/POA is supplying water to the proposed temporary place of use.

(If OK, check box to left; if not, fill in the blank)

- ☒ 1. Page 1 of application: Are all attachments that have been checked actually included?
If not, what is missing? _____
- ☒ 2. Are fees included and correct?
If not, the correct fee would be: _____, so the amount missing is: _____
- ☒ 3. Part 4 of application: Have all the applicants listed at the top of the page signed at the bottom?
If not, whose signature is missing? _____
- ☒ 4. Are all listed certificates shown by WRIS as non-cancelled?
If not, which are cancelled? _____
For each cancelled certificate, if there has been a remaining right certificate issued that covers the lands in the left side of Table 2, list its number _____ and check the #4 box at left on this checklist.
- ☒ 5. If any certificate is in the name of a "district", is a Supplemental Form D from that district enclosed?
☐ N/A ☒ Form D needed from Include (district)
- 6. If all #1-#5 boxes on this checklist are checked (with no remaining deficiencies identified), accept the application. Put this check sheet in the transfer folder.

If #1, #2, #3, #4 or #5 on this checklist is deficient, the application cannot be accepted. It should be returned and the deficiencies listed in the "staff" section at the bottom of Application Page 1, unless the applicant or agent can resolve the deficiencies within 2-3 days.