

Name Virgil L. Pade
 By _____
 Address 2820 Brush College Rd. NW
Salem, OR 97304

Change in POD
 Date filed August 7, 1979
 Date of hearing _____
 Place of hearing _____
 Date of order 10-26-79 Vol. 32, page 463
 Date for application of water complete
 Proof mailed _____

Proof received _____
 Certificate issued JAN 21 1980 Vol. 42, page 48903

FEB 24 1989

FEB 24 1989

60405
60406

REMARKS

Surveyed 8/1/85

4273
 DESCRIPTION OF WATER RIGHT

Name of stream Coon Creek (Winslow Gulch)
 Trib. of Willamette River County of POLK
 Use irrigation
 Quantity of water _____ No. of acres 4.3
 Name of ditch _____
 Date of priority August 19, 1946
 In name of Gurnee Flesher, Fred B. & Blanch E. Heath
 _____ Adjudication, Vol. _____, page _____
 App. No. 21893 Per. No. 17239 Cert. No. 21166

Certificate cancelled _____
 Notation made on record by _____

FEES PAID

Date	Amount	Receipt No.
<u>8-7-79</u>	<u>35.00</u>	<u>13306</u>
TOTAL . . .		
	Cert. Fee	

FEES REFUNDED

Date	Amount	Check No.

TO BE ENTERED WHERE CHECKED	INDEX CARDS:	
	Entered	Checked
<input checked="" type="checkbox"/> Name	<u>leg</u>	_____
<input checked="" type="checkbox"/> S. . .	<u>leg</u>	_____
<input checked="" type="checkbox"/> Pl. or Div.	<u>leg</u>	_____
<input checked="" type="checkbox"/> Calendar	<u>leg</u>	_____
<input checked="" type="checkbox"/> CHANGED TO RECORDS		
<input checked="" type="checkbox"/> Typ. & Reg.	<u>SRB</u>	_____
<input checked="" type="checkbox"/> Dep. & Reg.	_____	_____
<input checked="" type="checkbox"/> Dep. & Reg.	_____	_____
<input checked="" type="checkbox"/> Cert. of W/R	<u>SEA</u>	_____
<input checked="" type="checkbox"/> Per. & older	<u>leg</u>	_____
<input checked="" type="checkbox"/> Ch. Index	_____	_____
<input checked="" type="checkbox"/> Ch. Ref.	_____	_____
<input checked="" type="checkbox"/> Ch. Claim	<u>leg</u>	_____
<input checked="" type="checkbox"/> Abstracts	_____	_____

W.R.I.S.

Assembled 3-19-85 by SRB

Entered _____ by _____

Verified _____ by _____

RECEIVED

AUG - 1979

WATER RESOURCES DEPT
SALEM, OREGON

T-4273

Application for Transfer of Water Right

To the WATER RESOURCES DIRECTOR OF OREGON:

I, Virgil L Pade (Name of applicant)
of 2820 Brush College Rd NW Salem Ore 97304 (Mailing address) (City)
State of Oregon, 97304, 3635583, do hereby make application for change (Zip Code) (Phone number)
POINT OF DIVERSION
(In point of diversion; place of use; use heretofore made of the water)

1. Is the water right recorded in your name? GURNEE FLESHER & FRED B. & BLANCH E. HEATH
(If not, give name)

2. Was your water right determined by Decree of Court? NO If so, give title of proceedings
(Yes or No)

number of certificate
3. Was your water right acquired by Water Right Permit? YES If so, give number
(Yes or No)
of permit 17239 Number of certificate 21166
A# 21593

NOTE: If the entire right of record is not directly involved in the requested change, only that part of the right that is directly involved should be considered in answering the balance of the questions on this form.

4. The source of water is COON CREEK (WINSLOW GULCH) TRIB. WILLAMETTE

5. What is the date of priority of your water right? AUGUST 19, 1946

6. The authorized point of diversion is located 1950 ft. N and 525 ft. E from the SW
(N. or S.) (E. or W.)
corner of SEC. 8 being within the NW 1/4 SW 1/4 of Section 8 Tp. 7S R. 3W W. M.,
(No. N. or S.) (No. E. or W.)
in the county of POLK The name of the ditch used is

NOTE: Answer question if the application is for change in point of diversion.

7. The proposed point of diversion is located 1500 ft. N and 625 ft. E from the SW
(N. or S.) (E. or W.)
corner of SEC. 8 being within the NW 1/4 SW 1/4 of Section 8 Tp. 7S R. 3W W. M.,
(No. N. or S.) (No. E. or W.)
in the county of POLK The name of the ditch to be used is

8. The use to which the water is applied is IRRIGATION
(Irrigation, Mining, Power, Manufacturing, etc.)

Location of area irrigated, or place of use if other than irrigation:

Township North or South	Range E. or W. of Willamette Meridian	Section	List 1/4-1/4 of Section	Number Acres To Be Irrigated
7S	3W	8	NW 1/4 SW 1/4	4.40
7S	3W	8	SW 1/4 SW 1/4	0.10

(If more space required, attach separate sheet)

9. Are you the legal owner of the above described lands? yes
(If not owner, explain your interest)

⑩ To your knowledge, has any portion of the water right above described undergone a period of five or more consecutive years of nonuse? No
(Yes or No)

NOTE: Answer questions 11, 12 and 13 if application is for change in use or place of use.

11. Are the lands from which you propose to transfer your water right free of all encumbrances, including taxes, mortgages, liens, etc.? _____
(Answer Yes or No)

12. If not, give below a description of existing encumbrances:

NATURE OF ENCUMBRANCE	HELD BY	AMOUNT

13. The use to which the water is to be applied is _____
(Irrigation, power, mining, manufacturing, domestic supplies, etc.)

Location of area to be irrigated, or place of use if other than irrigation:

[illegible]

(If more space required, attach separate sheet)

14. Reasons for the proposed changes are TO GET PRESENT P.O.D.

LEGAL

15. Construction work will be completed on or before COMPLETED

16. The water will be completely applied to the proposed use on or before 10-1-79

Remarks This property has a supplemental right under Cert #31005, which is to be transferred also.

THIS APPLICATION PREPARED BY:

Michael J. Ladd

FROM INFORMATION FURNISHED BY
THE APPLICANT.

NOTE: THIS APPLICATION MUST BE ACCOMPANIED BY A MAP OR MAPS SHOWING THE BEFORE AND AFTER LOCATIONS OF THE POINT OF DIVERSION AND/OR PLACE OF USE, AS THE CASE MAY BE.

AFFIDAVIT OF APPLICANT

I, Michael J. Ladd, the applicant herein, being first duly sworn, depose and say that I have read the above and foregoing application for transfer of water right; that I know the contents thereof and that the statements therein made are true and correct to the best of my knowledge and belief.

In Witness Whereof, I have hereunto set my hand this 1st day of August, 1979

Michael J. Ladd
(Name of applicant)

Subscribed and sworn to before me this 1st day of August, 1979

[Notarial Seal]

John A. Affy
NOTARY PUBLIC FOR OREGON

My commission expires July 24th 1983

TO BE SENT IN WITH TRANSFER
APPLICATION

T-4273

RECEIVED

AUG 7 - 1979

WATER RESOURCES DEPT
SALEM, OREGON

T.7S. R.3W.W.M.

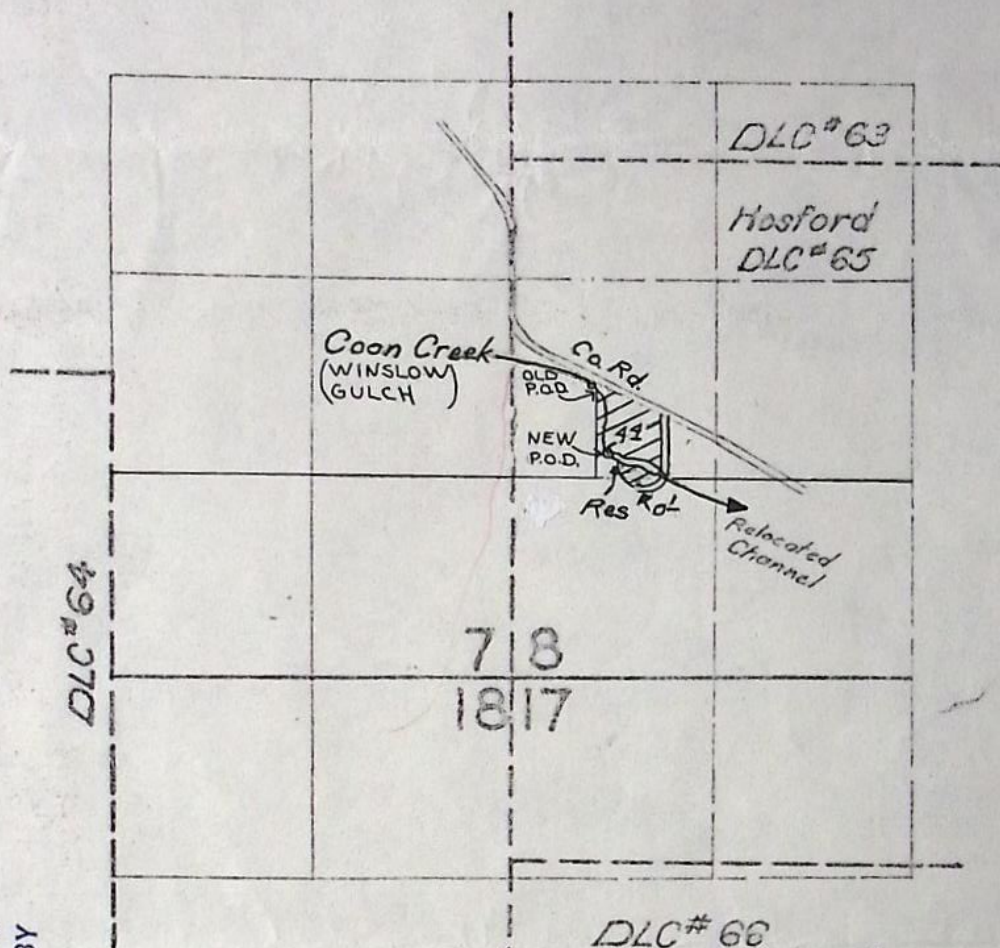

OLD P.O.D. 1950' N. & 525' E. FROM THE S.W. COR. OF SEC. 8 T.7S. R.3W.W.M.
NEW P.O.D. 1500' N. & 625' E. FROM THE S.W. COR. OF SEC. 8 T.7S. R.3W.W.M.

~~FINAL PROOF SURVEY~~
UNDER

THIS MAP PREPARED BY:
Michael J. Ladd
FROM INFORMATION FURNISHED BY
THE APPLICANT.

~~R 32455~~ ~~R 2156~~
Application No. ~~32455~~ Permit No. ~~25632~~
IN NAME OF

~~Gurnee Flesher & Al Friske~~

~~Surveyed 24 July 1962, by Carl R. Baker~~

DFP-IP-31 & 1962-W

STATE OF OREGON

INTEROFFICE MEMO

TO: TRANSFERS, WATER RIGHTS DIVISION

DATE: Oct 10, 1979.FROM: ** Michael F. Ladd, WatermasterSUBJECT: WATER RIGHT TRANSFER APPLICATION NO. 4273IN THE NAME OF Virgil L. Pade

In my opinion the proposed change in point of diversion from Coon Creek (Winslow Gulch)⁺⁺
MAY BE MADE WITHOUT INJURY WOULD RESULT IN INJURY* to an existing water right.

Headgate notices HAVE HAVE NOT been issued for diversion from the sources which serves this right.

If for change in point of diversion, is there any intervening point of diversion between the authorized and the proposed points of diversion? NO
(yes or no)

In my opinion, the order approving the subject transfer application should include the following in regard to the appropriator installing suitable measuring devices in the diversion works:

 (1) PRIOR to the diverting of water at the new point of diversion . . .

✓ (2) When in the judgment of the watermaster it becomes necessary . . .

* The approval of this transfer application would result in injury to other water rights because _____

WINSLOW GULCH

⁺⁺ Please clarify current, proper name of source.

** Michael F. Ladd
Watermaster's signature or initials

WINSTON CR TRIB BRUSH COLLEGE CR

WIF T-0982-C1

*** OREGON WATER RESOURCES DEPARTMENT ***
 *** WATER RIGHTS DIVISION ***
 *** WATER RIGHT DATA INPUT FORM ***

PAGE 1
 RUN ON: 3/20/81 AT: 9:08

WATER RIGHT NO. T00004273 / PERMIT NO. 017239 CERTIF. NO.
 ORIG. NO. A00021893 / PREV. NO. A00021893 / SUPER. NO.

NAME: VIRGIL L. PADE
 ADDRESS: 2820 BRUSH COLLEGE RD NW
 CITY/STATE/ZIP/COUNTY: SALEM, OR 97304

STREAM-ID 02 1140 0880 0090 050 030

RIV. MI.

WM. DIST. 18 W.R. TYPE SA STATUS ✓

27

CANCEL YEAR--->	CONSTR. COMPLT---> <u>1026 1979</u>	YR. LAST USED-----> _____	NEXT ACTION DUE---> _____
PRIORITY-----> <u>08 19 1946</u>	PUT TO USE-----> <u>1026 1979</u>	LAST TRANS. DATE--> _____	LAST TRANS. TYPE--> _____
APPLICATION---> <u>0807 1979</u>	SURVEYED-----> _____	EXAM. FEE-----> <u>20.00</u>	RECORDING FEE-----> <u>15.00</u>
PERMIT ISSUE---> <u>1026 1979</u>	CONCURRENCE-----> _____	CYCLE STATUS-----> _____	REPORTED FLAG-----> _____
CONSTR. STRT.---> <u>1026 1979</u>	CERTIFIED-----> _____	CORRES. INIT.-----> _____	CORRES. DATE-----> _____

POINT-OF-DIVERSION DATA;
 TWNSP RNGE SECT QTR/QTR STREAM-ID

RIV. MI.

RATE

STATUS S OR P

0703 030W 08 C B 02 1140 0880 0090 050 030

0.056

✓ P

** REMARKS; - - - - -
 ** DATED-->

** POD: 1500' N & 625' E FM SW COR
 ** S.B. CHANGES POD PART OF
 ** C-21166 RRC-48903. SUPP.
 ** RT UNDER C-31005.

PLACE-OF-USE DATA:

TWNSP RNGE SECT QTR/QTR CNTY USE % CNSMTV ACRES STATUS S OR P

0703 030W 08 C B 27 1R 100 4.40 ✓ P

1 1 1 C C 1 1 0.10 1 1

48903

W.R.I.S.

Assembled 3-19-85 by SDA
 Entered _____ by _____
 Verified _____ by _____

RESERVOIR

IR T-0982-C1

*** OREGON WATER RESOURCES DEPARTMENT ***
*** WATER RIGHTS DIVISION ***

PAGE 1
RUN ON: 3/20/81 AT: 9:08

*** WATER RIGHT DATA INPUT FORM ***

WATER RIGHT NO. 50020 42732 PERMIT NO. 025632 CERTIF. NO.

NAME: VIRGIL L. PAPE

ORIG. NO. A000324561 PREV. NO. A000324561 SUPER. NO.

ADDRESS: 2820 BRUSH COLLEGE RD NW

CITY/STATE/ZIP/COUNTY: SALEM, OR 97304

27

STREAM-ID 02 1140 0880 0040 050 030 - RIV. MI.

WM. DIST. 18 W.R. TYPE SA STATUS V

CANCEL YEAR--->

CONSTR. COMPLT---> 10 26 1979

YR. LAST USED----->

NEXT ACTION DUE-->

PRIORITY-----> 0715 1958

PUT TO USE-----> 1026 1979

LAST TRANS. DATE-->

LAST TRANS. TYPE-->

APPLICATION---> 08 07 1979

SURVEYED----->

EXAM. FEE-----> 20.00

RECORDING FEE-----> 15.00

PERMIT ISSUE--> 10 26 1979

CONCURRENCE----->

CYCLE STATUS----->

REPORTED FLAG----->

CONSTR. STRT.--> 10 26 1979

CERTIFIED----->

CORRES. INIT.----->

CORRES. DATE----->

POINT-OF-DIVERSION DATA;
TWNSP RNGE SECT QTR/QTR STREAM-ID

RIV. MI. RATE

STATUS S OR P

** REMARKS; - - - - -
** DATED-->

0705 030W 08 CB 02 1140 0880 0040 050 030 - 0.056

V S

** POD: 1950' N & 525' E FM SW COR S 8.
** CHANGES POD PRIMARY RT C-21166.
** RR C-48922.

PLACE-OF-USE DATA:
TWNSP RNGE SECT QTR/QTR CNTY USE % CNSMTV ACRES STATUS S OR P

0705 030W 08 CB 27 1R 100 4.40 V S

CC 0.10

**-----
**-----
**-----
**-----

W.R. I.S.

Assembled 3-19-85 by SPD

Entered _____ by _____

Verified _____ by _____

: POD
POU
USE
Add '1 POD

Transfer NO. 4273

County POLK

Old Certificate NO. 21166, 31005

1. Name Virgil L. Pade

Address 2820 Brush College Rd NW, Salem, OR 97304

2. Source of Supply Brush College Creek (per M. Ladd
Coon Creek) (Winslow Gulch) 10/30/79, Trib of Willamette River

3. Use irrigation of 4.5 acres

4. Amount of Water 0.056 cfs pri; 2 a.f. stored water Priority Date 8/19/46; 7/15/58
(sup'l)

5. Proposed Point of Diversion ~~1500 ft N & 625 ft E from SW Cor of Sec 8, w/in NW $\frac{1}{4}$ SW $\frac{1}{4}$, Sec 8, T 7S, R 3W, WM.~~

NW 1/4 SW 1/4 as projected within^C Hosford D1C # 65

Section 8, T. 7S., R. 3W., WM.; 1500 feet North and 625 feet East from SW corner of Section 8.

6. Completion Date COMPLETED

7. Place of Use:

[illegible]

Lots + DLC ✓

INFO: MR. RADE SHOWED US PRESENT "DIV. PT" WHICH IS ACTUALLY A PUMPING SITE ON THE RESERVOIR. THIS DIV. PT. HAS BEEN @ PRESENT SINCE THEY BOUGHT PLACE IN 1960's.

SOURCE: BRUSH COLLEGE CREEK & RESERVOIR.

PUMP & FAIRBANKS MORSE 5 Hp. @ 3420 RPM
MOTOR UNK DDC 2X 1 1/2

PIPE: SEE REPORT FOR G-9912
+ BURIED SYSTEM AROUND HOUSE.

HEADS: SEE REPORT FOR - G-9912
15 Hds MAX.

USE: IRRIGATION OF PASTURE LAWN & GARDEN

LIFT: 0 TO +20'

TIE: INSPECTION OF APP. MAP.

$$\frac{6.6(5)}{450} = .22 @ 50 \text{ psi}$$

8-1-85
Benjamin W. Bishop
W.R.E.

$$\frac{15(6.1)}{450} = .20 @ 50 \text{ psi}$$

$$\frac{4.5 \text{ ac.}}{450} = 0.056$$

TO BE LEFT IN THE TRANSFER APPLICATION

T-4273

RECEIVED

AUG 7 - 1979

WATER RESOURCES DEPT
SALEM, OREGON

T.7S. R.3W.W.M.

Per M. Ladd
10/30/79
fcj

F.M. 5 @ 3420
WIK DDC 2 x 1 1/2

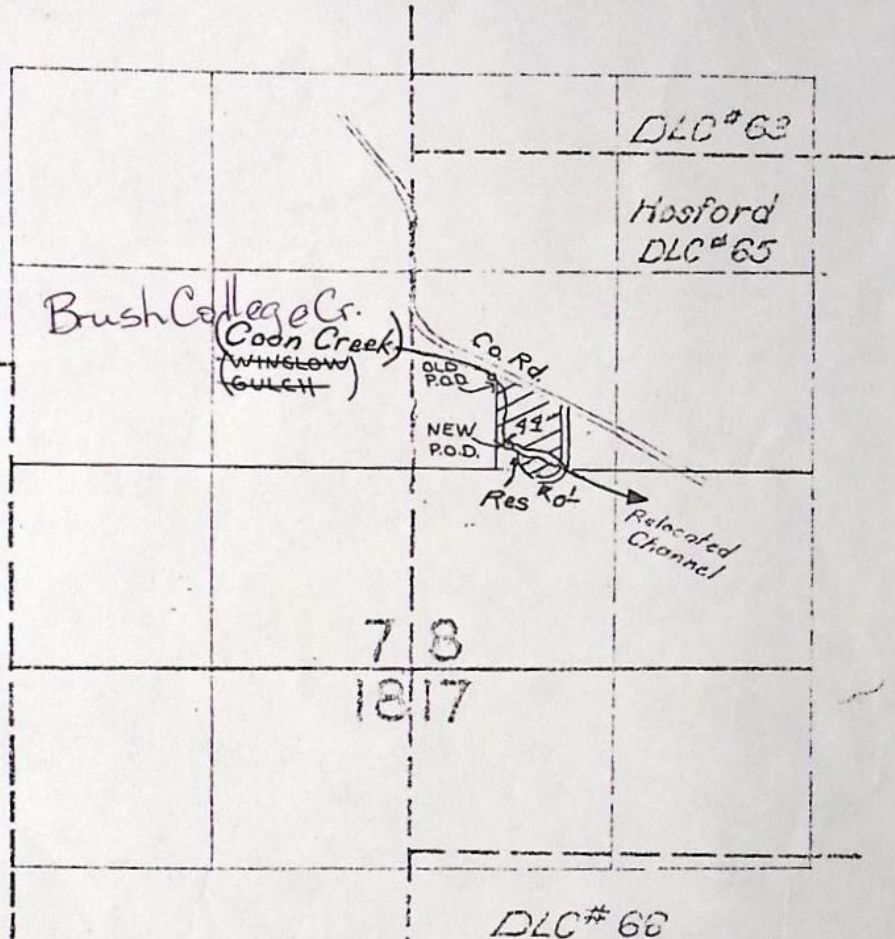

OLD P.O.D. 1950' N. & 525' E. FROM THE S.W. COR. OF SEC. 8 T.7S. R.3W.W.M.
NEW P.O.D. 1500' N. & 625' E. FROM THE S.W. COR. OF SEC. 8 T.7S. R.3W.W.M.

~~FINAL PROOF SURVEY~~
UNDER

THIS MAP PREPARED BY:
Michael J. Ladd
FROM INFORMATION FURNISHED BY
THE APPLICANT.

~~R 32455~~ ~~R 2156~~
Application No. ~~32456~~ Permit No. ~~25632~~
IN NAME OF

~~Gurnee Flesher & Al Friske~~
~~Surveyed 24 July 1962, by Carl R. Baker~~

DFP-IP-31 1/1952-W