

Groundwater Transfer Review Summary Form

Transfer/PA # T- 14756

GW Reviewer Stacey Garrison Date Review Completed: 12/29/2025

Summary of Same Source Review:

The proposed change in point of appropriation is not within the same aquifer as per OAR 690-380-2110(2).

Summary of Water Level Decline Condition Review:

Water levels at the original point(s) of appropriation have exceeded the allowed decline threshold defined by conditions in the originating water right.

Summary of Injury Review:

The proposed transfer will result in another, existing water right not receiving previously available water to which it is legally entitled or result in significant interference with a surface water source as per 690-380-0100(3).

Summary of GW-SW Transfer Similarity Review:

The proposed SW-GW transfer doesn't meet the definition of "similarly" as per OAR 690-380-2130.

This is only a summary. Documentation is attached and should be read thoroughly to understand the basis for determinations.



Oregon Water Resources Department
 725 Summer Street NE, Suite A
 Salem, Oregon 97301-1271
 (503) 986-0900
 www.wrd.state.or.us

Ground Water Review Form:

- Water Right Transfer
- Permit Amendment
- GR Modification
- Other

Application: T-14756

Applicant Name: Valley Pine Natives, LLC

Proposed Changes: POA APOA SW→GW RA
 USE POU OTHER

Reviewer(s): Stacey Garrison

Date of Review: 12/29/2025

Date Reviewed by GW Mgr. and Returned to WRSD: JTI 3/13/26

The information provided in the application is insufficient to evaluate whether the proposed transfer may be approved because:

- The water well reports provided with the application do not correspond to the water rights affected by the transfer.
- The application does not include water well reports or a description of the well construction details sufficient to establish the ground water body developed or proposed to be developed.
- Other _____

-
1. Basic description of the changes proposed in this transfer: Applicant proposes to move the POU and add two APOAs, POA 2/Well 2 (LANE 76613) and POA 3/Well 3 (LANE 77991), to GR 2475. GR 2475 authorizes POA 1/Well 1 (LANE 8345) to irrigate 9 acres at 0.1069 cfs (48 gpm).
 2. Will the proposed POA develop the same aquifer (source) as the existing authorized POA?
 Yes No Comments: Yes, the proposed POAs (LANE 76613, LANE 77991) develop the same alluvial gravel and sand Willamette Aquifer as the authorized POA (LANE 8345).
 3. a) Is the existing authorized POA subject to a water level decline condition?
 Yes No Comments: _____
 b) If yes, for each POA identify the reference level, most recent spring-high water level, and whether an applicable permit decline condition has been exceeded: N/A
 4. a) Is there more than one source developed under the right (e.g., basalt and alluvium)?
 Yes No Comments: Only the alluvial sourced is developed
 b) If yes, estimate the portion of the right supplied by each of the sources and describe any limitations that will need to be placed on the proposed change (rate, duty, etc.): N/A

5. a) Will this proposed change, at its maximum allowed rate of use, likely result in an increase in interference with **another ground water right**?

Yes No Comments: POA 3/Well 3 (LANE 77991) is closer to LANE 79707 than the authorized POA (LANE 8345). The reduced intervening distance is likely to result in an increase in interference with LANE 79707, a proposed APOA under T-14289/Certificate 38643.

b) If yes, would this proposed change, at its maximum allowed rate of use, likely result in another groundwater right not receiving the water to which it is legally entitled?

Yes No If yes, explain: POA 3/Well 3 (LANE 77991) is 630 ft northeast of LANE 79707. The Theis (1935) solution for drawdown was used to assess the potential for injury to LANE 79707 from the proposed changes (see attached Theis Interference Analysis). Results indicate the proposed change is unlikely to result in LANE 79707 not receiving the water to which it is legally entitled.

6. a) Will this proposed change, at its maximum allowed rate of use, likely result in an increase in interference with **another surface water source**?

Yes No Comments: The APOAs, POA 2/Well 2 (LANE 76613) and POA 3/Well 3 (LANE 77991), are closer to Spring Creek than the authorized POA, POA 1/Well 1 (LANE 8345). The reduced intervening distance is likely to result in an increase in interference with Spring Creek.

b) If yes, at its maximum allowed rate of use, what is the expected change in degree of interference with any **surface water sources** resulting from the proposed change?

Stream: Spring Creek

Minimal Significant

Provide context for minimal/significant impact: The expected increase in depletion from Spring Creek was assessed using the Hunt (1999) analytical model for stream depletion due to pumping in an unconfined aquifer (see attached Stream Depletion Analysis). Results indicate that stream depletion due to pumping could likely increase by 1.4% of the rate of withdrawal after 245 days of continuous pumping as a result of the proposed change. Assuming that POA 2/Well 2 (LANE 76613) were to pump at the maximum rate of 0.1069 cfs (48 gpm) over the full 245 days, the proposed change could result in an additional 0.013 cfs (5.83 gpm) of depletions to Spring Creek by the end of the irrigation season. Spring creek is within WAB #182 with the lowest month of natural stream flow in September; the Net Water Available in September is 206 cfs. The change in degree of interference with Spring Creek by the APOAs, POA 2/Well 2 (LANE 76613) and POA 3/Well 3 (LANE 77991), is anticipated to be minimal.

7. For SW-GW transfers, will the proposed change in point of diversion affect the surface water source similarly (as per OAR 690-380-2130) to the authorized point of diversion specified in the water use subject to transfer?

Yes No Comments: N/A

8. What conditions or other changes in the application are necessary to address any potential issues identified above: N/A

9. Any additional comments: N/A

ReferencesTransfer File: T-14756Pumping Test Files: LANE 8214, LANE 8061, LANE 7502, LANE 64556, LANE 63753, LANE 72693, LANE 58762, LANE 8377, LANE 5676Conlon, T.D., Wozniak, K.C., Woodcock, D., Herrera, N.B., Fisher, B.J., Morgan, D.S., Lee, K.K., and Hinkle, S.R., 2005, Ground-water hydrology of the Willamette Basin, Oregon, Scientific Investigations Report 2005-5168: U. S. Geological Survey, Reston, VA.Hunt, B., 1999, Unsteady Stream Depletion from Ground Water Pumping: Ground Water, January-February, Vol 37, p 98-102.O'Connor, J.E., Sarna-Wojcick, A., Wozniak, K.C., Polette, D.J., Fleck, R.J., 2001, Origin, Extent, and Thickness of Quaternary Geologic Units in the Willamette Valley, Oregon; U.S. Geological Survey, Professional Paper 1620, 51 p.Woodward, D.G., Gannett, M.W., and Vaccaro, J.J., 1998, Hydrogeologic framework of the Willamette Lowland aquifer system, Oregon and Washington: U.S. Geological Survey Professional Paper 1424-B, 82 p.

Map

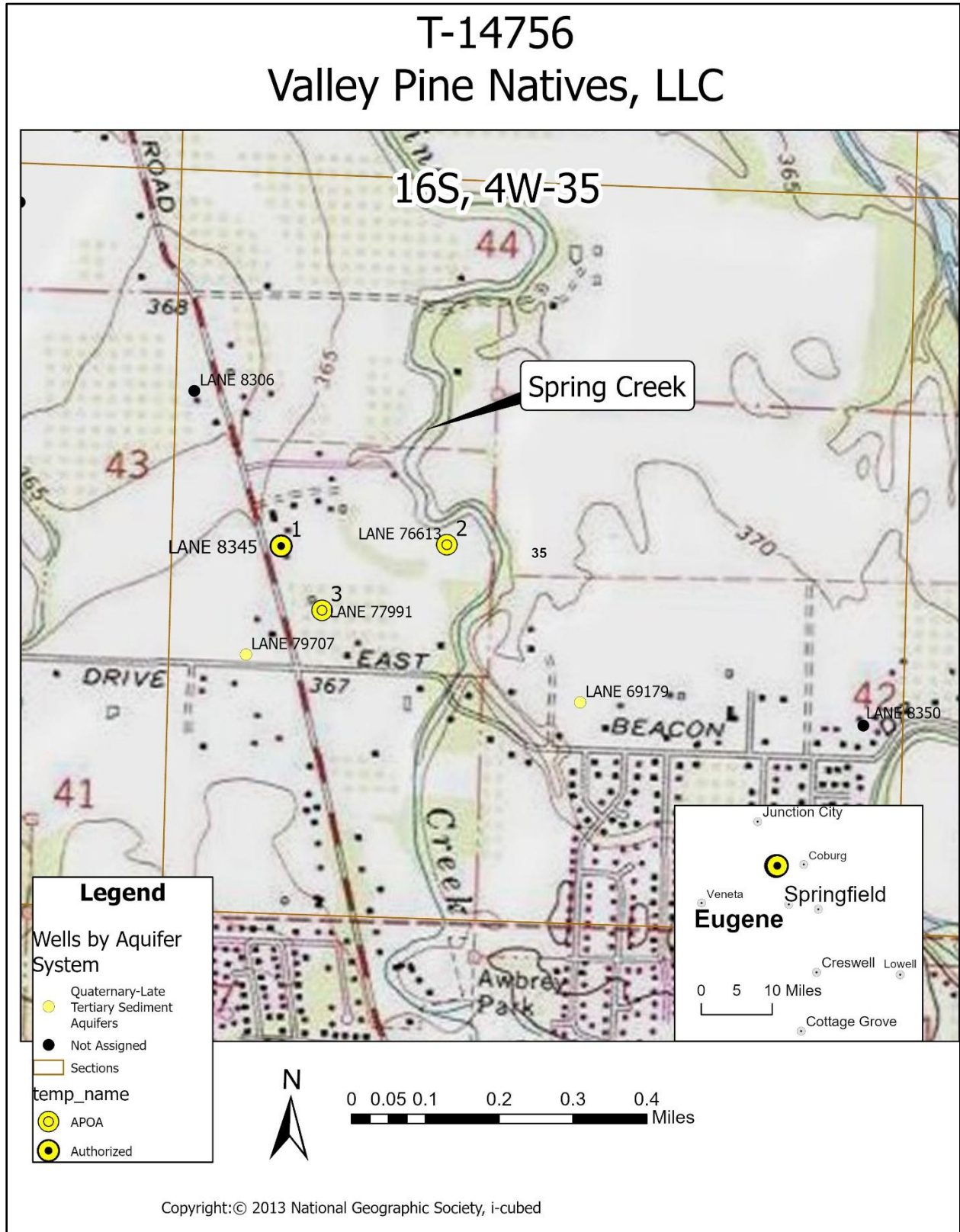

Theis Drawdown and Interference-POA 3 (LAN 77991)-LANE 79707

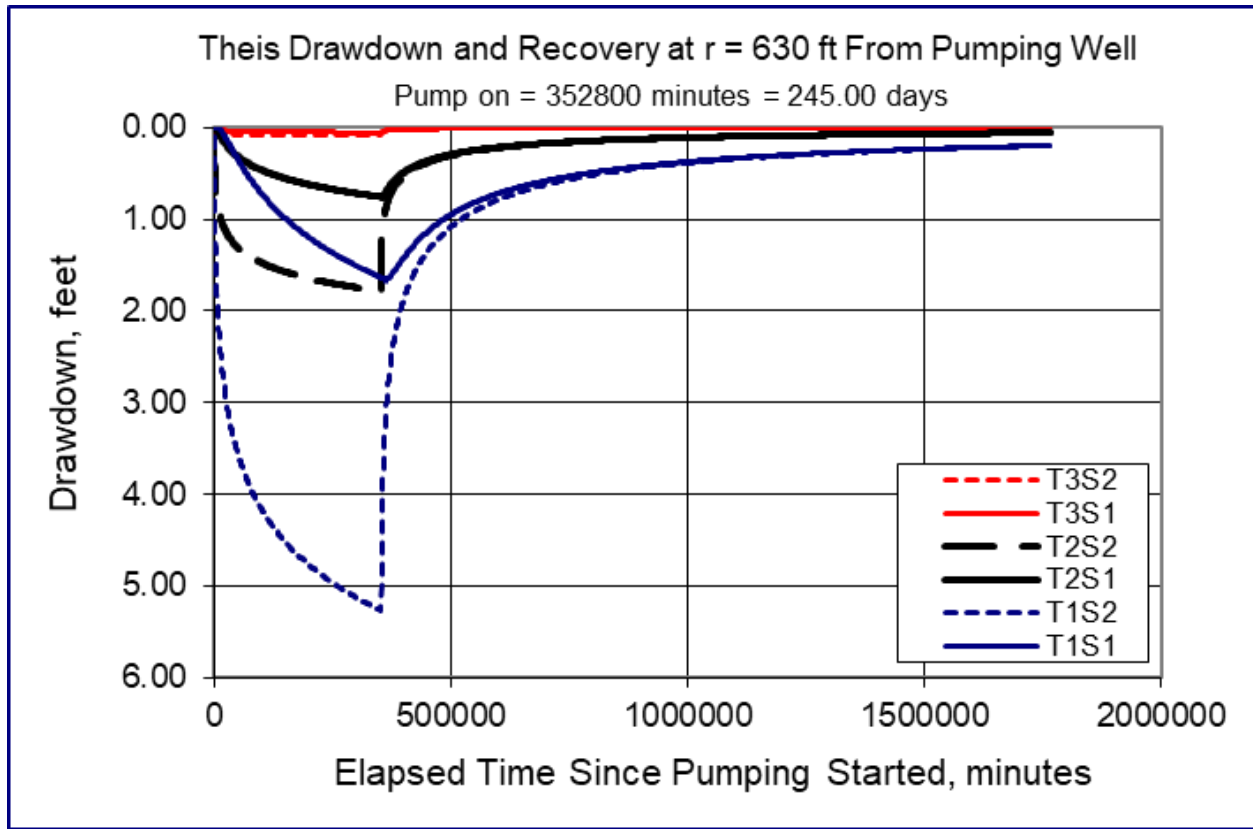

Input Data:	Var Name	Scenario 1	Scenario 2	Scenario 3	Units	
Total pumping time	t		245		d	
Radial distance from pumped well:	r		630		ft	Q conversions
Pumping rate	Q		0.1069		cfs	47.98 gpm
Hydraulic conductivity	K	13.83	49.67	1500	ft/day	0.11 cfs
Aquifer thickness	b		60		ft	6.41 cfm
Storativity	S 1		0.2			9,236.16 cfd
	S 2		0.003			0.21 af/d
Transmissivity Conversions	T_f2pd	829.8	2980.2	90000	ft ² /day	Recalculate
	T_ft2pm	0.57625	2.06958333	62.5	ft ² /min	
	T_gpdpft	6206.904	22291.896	673200	gpd/ft	

Stream Depletion Analysis: POA 1 (LANE 8645)-Spring Creek

Application type:	T						
Application number:	14756	Parameter	Symbol	Scenario 1	Scenario 2	Scenario 3	Units
Well number:	1	Distance from well to stream	a	970	970	970	ft
Stream Number:	1	Aquifer transmissivity	T	829.8	2980.2	90000	ft ² /day
Pumping rate (cfs):	0.1069	Aquifer storativity	S	0.2	0.02	0.003	-
Pumping duration (days):	245	Aquitard vertical hydraulic conductivity	Kva	0.05	0.05	0.05	ft/day
Pumping start month number (3=March)	3.0	Not used		10.0	10	10	
Plotting duration (days)	365	Aquitard thickness below stream	babs	20	20	20	ft
		Not used		0.2	0.2	0.2	
		Stream width	ws	60	60	60	ft

Days	10	330	360	30	60	90	120	150	180	210	240	270	300
Depletion (%)	2	8	7	4	6	8	9	10	11	12	13	11	9
Depletion (cfs)	0.00	0.01	0.01	0.00	0.01	0.01	0.01	0.01	0.01	0.01	0.01	0.01	0.01

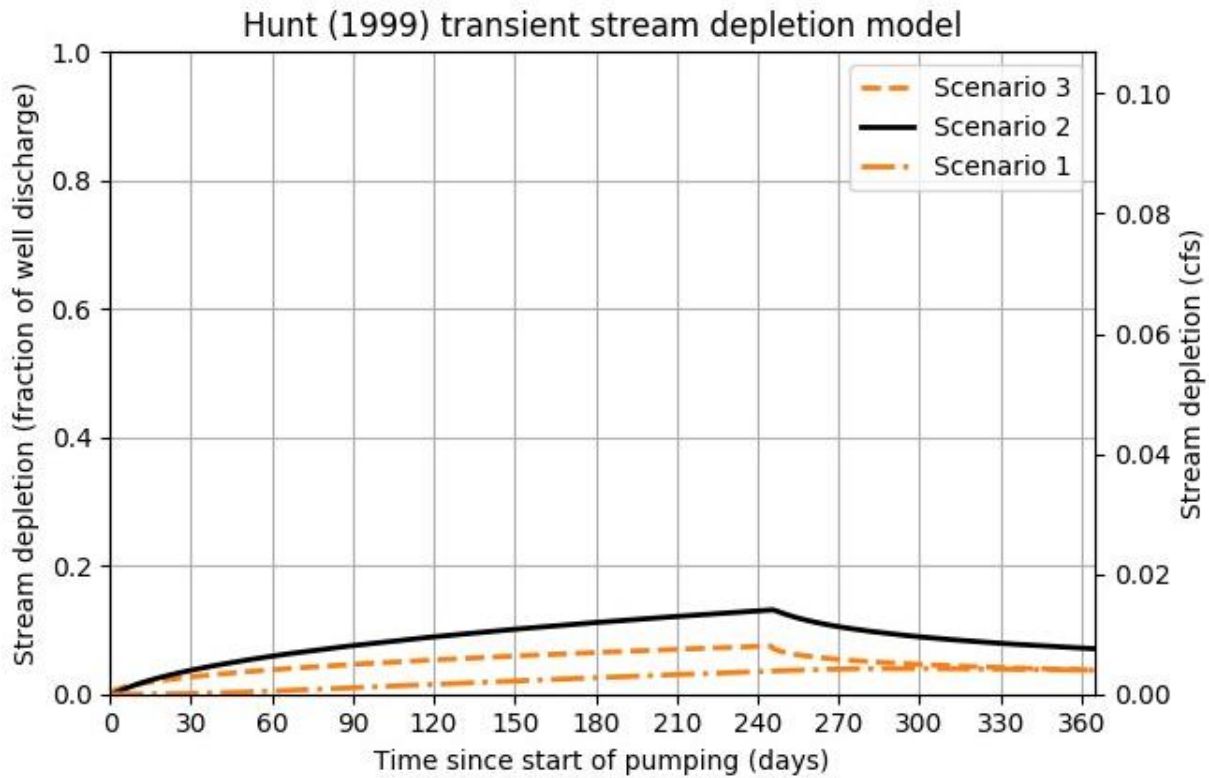

Stream Depletion Analysis: POA 2 (LANE 6613 -Spring Creek

	Parameter	Symbol	Scenario 1	Scenario 2	Scenario 3	Units	
Application type:	T	Distance from well to stream	a	236	236	236	ft
Application number:	14756	Aquifer transmissivity	T	829.8	2980.2	90000	ft ² /day
Well number:	2	Aquifer storativity	S	0.2	0.02	0.003	-
Stream Number:	1	Aquitard vertical hydraulic conductivity	Kva	0.05	0.05	0.05	ft/day
Pumping rate (cfs):	0.1069	Not used		10.0	10	10	
Pumping duration (days):	245	Aquitard thickness below stream	babs	20	20	20	ft
Pumping start month number (3=March)	3.0	Not used		0.2	0.2	0.2	
Plotting duration (days)	365	Stream width	ws	60	60	60	ft

Stream depletion for Scenario 2:

Days	10	330	360	30	60	90	120	150	180	210	240	270	300
Depletion (%)	3	8	7	5	7	9	10	12	13	14	14	11	9
Depletion (cfs)	0.00	0.01	0.01	0.01	0.01	0.01	0.01	0.01	0.01	0.01	0.02	0.01	0.01

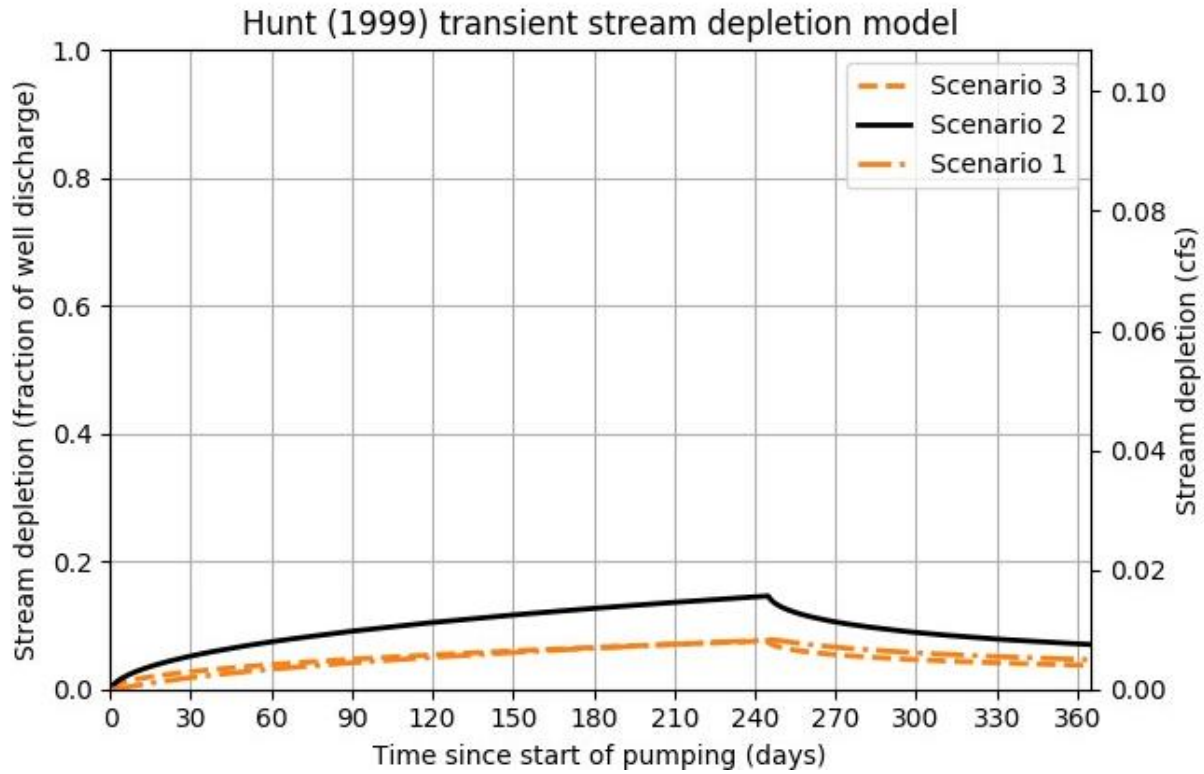

Water Availability Analysis



Water Availability Analysis Detailed Reports

WILLAMETTE R > COLUMBIA R - AB PERIWINKLE CR AT GAGE 14174
WILLAMETTE BASIN

Water Availability as of 12/29/2025

Watershed ID #: 30200321 ([Map](#))
Date: 12/29/2025

Exceedance Level: 80%
Time: 2:16 PM

Water Availability Calculation

Consumptive Uses and Storages

Instream Flow Requirements

Reservations

Water Rights

Watershed Characteristics

Water Availability Calculation

Monthly Streamflow in Cubic Feet per Second
Annual Volume at 50% Exceedance in Acre-Feet

Month	Natural Stream Flow	Consumptive Uses and Storages	Expected Stream Flow	Reserved Stream Flow	Instream Flow Requirement	Net Water Available
JAN	10,100.00	1,380.00	8,720.00	0.00	1,750.00	6,970.00
FEB	11,600.00	4,290.00	7,310.00	0.00	1,750.00	5,560.00
MAR	11,000.00	4,560.00	6,440.00	0.00	1,750.00	4,690.00
APR	9,760.00	4,260.00	5,500.00	0.00	1,750.00	3,750.00
MAY	8,430.00	2,560.00	5,870.00	0.00	1,750.00	4,120.00
JUN	5,360.00	856.00	4,500.00	0.00	1,750.00	2,750.00
JUL	3,270.00	666.00	2,600.00	0.00	1,750.00	854.00
AUG	2,560.00	604.00	1,960.00	0.00	1,750.00	206.00
SEP	2,540.00	517.00	2,020.00	0.00	1,750.00	273.00
OCT	2,860.00	269.00	2,590.00	0.00	1,750.00	841.00
NOV	4,170.00	355.00	3,820.00	0.00	1,750.00	2,070.00
DEC	8,150.00	382.00	7,770.00	0.00	1,750.00	6,020.00
ANN	7,460,000.00	1,240,000.00	6,230,000.00	0.00	1,270,000.00	4,960,000.00