

PERMIT AMENDMENT

T-10419

Name Driscoll Strawberry Association
Contact: Holly Burgess, Nursery Dept. Mgr
Address PO Box 50045 (345 Westridge Dr)
Watsonville, CA 95077-5045
530-221-6258 (530) 221-2582 Fax

DESCRIPTION OF WATER RIGHT(S)

Name of Stream Well
Trib. of Loot River
Use IR County Klamath
Quantity of water (CFS) _____ No. of Acres _____
Name of ditch _____
App # 6-15781 Per # 6-15347 Cert # _____ PR Date 2002
App # _____ Per # _____ Cert # _____ PR Date _____
App # _____ Per # _____ Cert # _____ PR Date _____
App # _____ Per # _____ Cert # _____ PR Date _____

Date	FEES PAID	
	Amount	Receipt #
<u>6/27/07</u>	<u>350.00</u>	<u>88366</u>

Change in POA
Date Filed 6-27-07
Initial notice date 7-3-07
DPD issued date _____
PD issued date _____
PD notice date _____
Date of FO 9-11-07 Vol 73 Page 272

Date	FEES REFUNDED	
	Amount	Receipt#

C-Date _____
COBU due date _____
COBU Received date _____
Certificate issued _____

Prior Contact: OREM Land Co. Gary Orem

Assignments:

Irrigation District Klamath Irrigation District Headquarters 6640 KID Lane Klamath Falls
OR 97603
Agent David J. Newton 521 SW 6th St., Suite 100 Redmond, OR 97756
541-504-9960 x211 541-325-3905 Cell 541-504-9961 Fax
CWRE David Newton
CC's list Bureau of Reclamation 6600 Washburn Way Klamath Falls OR 97603
Klamath County Clerks office 305 Main St. Klamath Falls OR 97601
Attorney: William Ganong: 514 Walnut Ave: Klamath Falls. OR. 97601

- Oversized map - Location

**STATE OF OREGON
WATER RESOURCES DEPARTMENT**

725 Summer St. N.E. Ste. A
SALEM, OR 97301-4172
(503) 986-0900 / (503) 986-0904 (fax)

RECEIPT # **88366**

INVOICE # _____

RECEIVED FROM: <u>Whiscoll Strawberry Associates, Inc</u>	APPLICATION	
BY: _____	PERMIT	
CASH: <input type="checkbox"/>	TRANSFER	<u>T-10419</u>
CHECK: # <u>4256</u> <input checked="" type="checkbox"/>	TOTAL REC'D	\$ <u>350.00</u>
OTHER: (IDENTIFY) _____		

1083 TREASURY	4170 WRD MISC CASH ACCT
0407 COPIES	\$ _____
OTHER: (IDENTIFY) _____	\$ _____
0243 I/S Lease _____	0244 Muni Water Mgmt. Plan _____
	0245 Cons. Water _____

4270 WRD OPERATING ACCT	
MISCELLANEOUS	
0407 COPY & TAPE FEES	\$ _____
0410 RESEARCH FEES	\$ _____
0408 MISC REVENUE: (IDENTIFY) _____	\$ _____
TC162 DEPOSIT LIAB. (IDENTIFY) _____	\$ _____
0240 EXTENSION OF TIME	\$ _____
WATER RIGHTS:	
0201 SURFACE WATER	EXAM FEE \$ _____ 0202 RECORD FEE \$ _____
0203 GROUND WATER	\$ _____ 0204 RECORD FEE \$ _____
0205 TRANSFER	\$ <u>350.00</u>
WELL CONSTRUCTION	
0218 WELL DRILL CONSTRUCTOR	EXAM FEE \$ _____ 0219 LICENSE FEE \$ _____
LANDOWNER'S PERMIT	0220 LICENSE FEE \$ _____
OTHER (IDENTIFY) _____	

0536 TREASURY	0437 WELL CONST. START FEE
0211 WELL CONST START FEE	\$ _____ CARD # _____
0210 MONITORING WELLS	\$ _____ CARD # _____
OTHER (IDENTIFY) _____	

0607 TREASURY	0467 HYDRO ACTIVITY	LIC NUMBER
0233 POWER LICENSE FEE (FWWRD)		\$ _____
0231 HYDRO LICENSE FEE (FWWRD)		\$ _____
HYDRO APPLICATION		\$ _____

TREASURY	OTHER / RDX
FUND _____	TITLE _____
OBJ. CODE _____	VENDOR # _____
DESCRIPTION _____	\$ _____

RECEIPT: **88366**

DATED: 6/27/07 BY: [Signature]



Oregon

Theodore R. Kulongoski, Governor

Water Resources Department

North Mall Office Building
725 Summer Street NE, Suite A
Salem, OR 97301-1266
503-986-0900
FAX 503-986-0904

September 12, 2007

DRISCOLL STRAWBERRY ASSC. INC.
HOLLY BURGESS, NURSERY MANAGER
PO BOX 50045
WATSONVILLE CA 96002

Reference: Permit Amendment Transfer 10419

Enclosed is a copy of the order approving your Permit Amendment transfer application.

YOU SHOULD GIVE PARTICULAR ATTENTION TO THE CONDITIONS OUTLINED IN THE ORDER. All other terms and conditions of the permit remain the same.

If you have any questions, please call the Transfer Section, (503)986-0900.

Sincerely,

DP Doug Parrow
Natural Resource Specialist

DP:sh

cc: Watermaster #17
David Newton (Newton Consultants Inc, 521 SW 6th Street, Suite 100, Redmond, OR 97756)
William Ganong (514 Walnut Avenue, Klamath Falls, OR 97601)
Klamath Irrigation District (6640 KID Lane, Klamath Falls, OR 97603)
Bureau of Reclamation (6600 Washburn Way, Klamath Falls, OR 97603)
Klamath County Clerks Office (305 Main Street, Klamath Falls, OR 97601)

Enclosure

Authorized Points of Appropriation:

Twp	Rng	Mer	Sec	Q-Q	Survey Coordinates
41 S	11 E	WM	10	NE SW	Well 1 - 400 feet North and 300 feet West from the S 1/16 th Corner of Section 10
41 S	11 E	WM	9	NE NW	Well 2 - 1050 feet North and 900 feet West from the N 1/16 th Corner of Section 9

Authorized Place of Use:

SUPPLEMENTAL IRRIGATION					
Twp	Rng	Mer	Sec	Q-Q	Acres
41 S	11 E	WM	8	NE NE	38.0
41 S	11 E	WM	8	NW NE	12.0
41 S	11 E	WM	8	SW NE	7.0
41 S	11 E	WM	8	SE NE	35.0
41 S	11 E	WM	8	NE SE	4.0
41 S	11 E	WM	9	NE NW	35.0
41 S	11 E	WM	9	NW NW	40.0
41 S	11 E	WM	9	SW NW	38.0
41 S	11 E	WM	9	SE NW	40.0
41 S	11 E	WM	9	NE SW	40.0
41 S	11 E	WM	9	NW SW	38.0
41 S	11 E	WM	9	SW SW	25.0
41 S	11 E	WM	9	SE SW	38.0
41 S	11 E	WM	9	NE SE	20.0
41 S	11 E	WM	9	NW SE	38.0
41 S	11 E	WM	9	SW SE	40.0
41 S	11 E	WM	9	SE SE	40.0
41 S	11 E	WM	10	SW NW	20.0
41 S	11 E	WM	10	SE NW	2.0
41 S	11 E	WM	10	NE SW	35.0
41 S	11 E	WM	10	NW SW	40.0
41 S	11 E	WM	10	SW SW	40.0
41 S	11 E	WM	10	SE SW	32.0
41 S	11 E	WM	10	NE SE	2.0
41 S	11 E	WM	10	NW SE	18.0
41 S	11 E	WM	10	SW SE	40.0
41 S	11 E	WM	10	SE SE	36.0
41 S	11 E	WM	15	NE NE	16.0
41 S	11 E	WM	15	NW NE	18.0
41 S	11 E	WM	15	NE NW	18.0
41 S	11 E	WM	15	NW NW	18.0
41 S	11 E	WM	16	NE NE	18.0
41 S	11 E	WM	16	NW NE	18.0
41 S	11 E	WM	16	NE NW	15.0
41 S	11 E	WM	16	NW NW	2.8

3. Application T-10419 proposes to change the point of appropriation of Well 2 only to:

Twp	Rng	Mer	Sec	Q-Q	Survey Coordinates
41 S	11 E	WM	9	NE NW	Well 3 - 90 feet South and 139 feet West from the N¼ Corner of Section 9

4. Notice of the application for the permit amendment was published in the Department's weekly notice on July 3, 2007, pursuant to ORS 540.520(5). No comments were filed in response to the notices.
5. The change would not result in injury to other water rights.
6. The change does not enlarge the permit.
7. The change does not alter any other terms of the permit.

Conclusions of Law

The change in point of appropriation of Well 2 proposed by Permit Amendment Application T-10419 is consistent with the requirements of ORS 537.211.

Now, therefore, it is ORDERED:

The change and subsequent use of water shall be subject to the following conditions:

1. The quantity of water diverted at the new point of appropriation (Well 3), together with that diverted at Well 1, shall not exceed the maximum rate and duty allowed under Permit G-15347.
2. Prior to water use from the proposed point of appropriation, the permittee shall install a meter or other suitable measuring device as approved by the Director. The permittee shall maintain the meter or measuring device in good working order, and shall keep a complete record of the amount of water used each month and shall submit a report which includes the recorded water use measurements to the Department annually or more frequently as may be required by the Director. Further, the Director may require the permittee to report general water use information, including the place and nature of use of water under the permit.

The permittee shall allow the watermaster access to the meter or measuring device; provided however, where the meter or measuring device is located within a private structure, the watermaster shall request access upon reasonable notice.

3. Water shall be acquired from the same aquifer as the original point of appropriation.
4. All other terms and conditions of Permit G-15347 remain the same.

5. Permit G-15347, in the name of Driscoll Strawberry Association, Inc., is amended as described herein.

Dated at Salem, Oregon this 11 day of September, 2007.

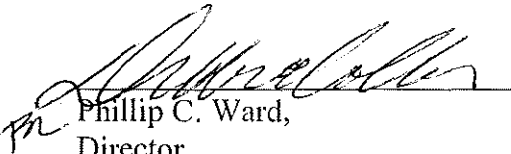
Phillip C. Ward,
Director

Mailing Date: SEP 13 2007

Permit Amendment Checklist

Permit Amendment T-10419

Transfer Specialist: pks

Applicant Name/Address: Driscoll Strawberry Association, Inc.
 Holly Burgess, Nursery Department Manager
 P.O. Box 50045
 Watsonville, California 95077-5045

Agent/CWRE Name/Address: David J. Newton CWRE #419
 Newton Consultants Inc.
 521 SW 6th Street, Suite 100
 Redmond, Oregon 97756

Attorney Name/Number: William Ganong
 514 Walnut Avenue
 Klamath Falls, Oregon 97601

Rec Landowner Name/Address: None

Irr. District Name/Address: Klamath Irrigation District
 6640 KID Lane
 Klamath Falls, Oregon 97603

Affected Govt's Name/Address: Bureau of Reclamation
 6600 Washburn Way
 Klamath Falls, Oregon 97603

Klamath County Clerks Office
 305 Main Street
 Klamath Falls, Oregon 97601

Commentors Name/Address: None

Permits Affected

Records Marked	Records Copied	App File No.	Permit No.
<input type="checkbox"/>	<input type="checkbox"/>	G-15781	G-15347

Key Dates & Initial Actions

Rec'd: 6/27/2007	Proposed Action(s): POU POD POA APOD/APOA SW/GW:	
Fees Pd: \$350.00	WM District: 17	ODFW District: N/A
Initial Notice: 7/3/2007	WM Review sent: 7/3/2007	ODFW Review sent: N/A
Acknowledgement Letter Sent: X		GW Review sent: 7/3/2007

Processing Dates & Actions

Deficiency Contacts:	Newspaper Pub Affid. Due: Xnot required
Affid of Pub Rec'd: Last Day Published:	Affidavit Reminder Sent:
Reminder Deadline:	<i>v. 73 p. 272</i> SEP 11 2007

Final Order

- Electronic Files uploaded
- Newspaper Notice Cover letter
- Newspaper Notice
- File Assigned/ ModPod updated
- Fee Refund Due

Kelly

Do NOT issue Final Order prior to August 27, 2007 (being 61 days after appl. received.)

Draft Order Review (Optional)	Final Order Review (Salem)
Reviewer: _____ Date: _____ Coordinator: _____ Date: _____	Reviewer: <u>SDP</u> Date: <u>8/14/07</u> Coordinator: <u>SDP</u> Date: <u>8/14/07</u>
Comments/Special Issues: Requests to change location of authorized Well 2 to Well 3.	

Special Order Volume: Vol: 73, Pages _____ Final Order Signature Date: **SEP 11 2007**

Notice of FO e-mailed to processors: _____

Application

- X The type of change is clearly indicated.
- X The application is appropriately signed.
- X Appropriate fees were paid. If overpayment, Refund Request to be sent with FO
- X Land use form matches affected tax lots and is signed by proper official. (from ALL affected Gov'ts)
- X Ditch company, district, and/or BOR, sent a copy of the application and map, if appropriate.
- X Valid permit completion date?
- X All required attachments received.

Application Map

- X The map size and scale accurate and appropriate per OAR 690-380-3100(1)(b)(c)&(d).
- X All authorized and proposed POD's/POA's and POU are properly described on the map.
- X Metes and bounds for the POD's/POA's are properly described on the map.
- X The POD/POA dimensions & ¼ ¼ on map match the permit amendment application and permit descriptions.
- Map acres match the tabulation on the permit.
- X Have permit maps. X Amendment map matches permit map.

Determining the "From" and "To" Lands (make working copy of application and permits to mark on)

- X Only the authorized POD's/POA's and POU's to be transferred are listed.
- X Application & permit tabulations match. (Mark on appl. and permit copies and note corrections needed)
- Marked on permit the acreage being transferred.

Permit Ownership

- X The applicant is the holder of the permit.
- All holders of the permit have signed the application.
- If necessary, there is a notarized, signed statement of consent from permit holders other than applicant.
- If necessary, the permit has been assigned to permit amendment applicant.
- X Agent has authorization to make decisions.

Evaluation (materials needed for peer reviewer in bold)

- | | | | |
|---------------------------------------|---|---|--|
| X Application complete | X Permit | X Land use form | <input type="checkbox"/> Plat card |
| X Amendment Map | X Permit Map | X Fees paid | X Well logs |
| Reviews/comments/conditions received? | X Watermaster | <input type="checkbox"/> ODFW | X GW |
| Headgate | <input type="checkbox"/> When in the judgment | <input type="checkbox"/> Prior to diverting | <input type="checkbox"/> Existing and maintain |
| Measuring Devices | <input type="checkbox"/> When in the judgment | X Prior to diverting | <input type="checkbox"/> Existing and maintain |
- Injury: N Enlargement: N
- Conditions to avoid enlargement/injury -

STATE OF OREGON

COUNTY OF KLAMATH

PERMIT TO APPROPRIATE THE PUBLIC WATERS

THIS PERMIT IS HEREBY ISSUED TO

GARY OREM, FOR OREM LAND CO.
20000 HWY 50
MERRILL, OREGON 97633

(541) 798-1072

The specific limits and conditions of the use are listed below.

APPLICATION FILE NUMBER: G-15781

SOURCE OF WATER: TWO WELLS IN LOST RIVER BASIN

PURPOSE OR USE: SUPPLEMENTAL IRRIGATION OF 916.8 ACRES

MAXIMUM RATE: 11.5 CUBIC FEET PER SECOND

PERIOD OF USE: MARCH 1 THROUGH OCTOBER 31

DATE OF PRIORITY: JUNE 24, 2002

WELL LOCATION:

WELL 1: NE 1/4 SW 1/4, SECTION 10, T41S, R11E, W.M.; 400 FEET NORTH
AND 300 FEET WEST FROM THE S 1/16TH CORNER SECTION 10

WELL 2: NE 1/4 NW 1/4, SECTION 9, T41S, R11E, W.M.; 1050 FEET NORTH
AND 900 FEET WEST FROM THE N 1/16TH CORNER SECTION 9

The amount of water used for irrigation under this right, together with the amount secured under any other right existing for the same lands, is limited to a diversion of ONE-EIGHTIETH of one cubic foot per second (or its equivalent) and 3.0 acre-feet for each acre irrigated during the irrigation season of each year.

THE PLACE OF USE IS LOCATED AS FOLLOWS:

NE ¼ NE ¼ 38.0 ACRES
NW ¼ NE ¼ 12.0 ACRES
SW ¼ NE ¼ 7.0 ACRES
SE ¼ NE ¼ 35.0 ACRES
NE ¼ SE ¼ 4.0 ACRES
SECTION 8

T-10419

NE ¼ NW ¼ 35.0 ACRES
 NW ¼ NW ¼ 40.0 ACRES
 SW ¼ NW ¼ 38.0 ACRES
 SE ¼ NW ¼ 40.0 ACRES
 NE ¼ SW ¼ 40.0 ACRES
 NW ¼ SW ¼ 38.0 ACRES
 SW ¼ SW ¼ 25.0 ACRES
 SE ¼ SW ¼ 38.0 ACRES
 NE ¼ SE ¼ 20.0 ACRES
 NW ¼ SE ¼ 38.0 ACRES
 SW ¼ SE ¼ 40.0 ACRES
 SE ¼ SE ¼ 40.0 ACRES

SECTION 9

SW ¼ NW ¼ 20.0 ACRES
 SE ¼ NW ¼ 2.0 ACRES
 NE ¼ SW ¼ 35.0 ACRES
 NW ¼ SW ¼ 40.0 ACRES
 SW ¼ SW ¼ 40.0 ACRES
 SE ¼ SW ¼ 32.0 ACRES
 NE ¼ SE ¼ 2.0 ACRES
 NW ¼ SE ¼ 18.0 ACRES
 SW ¼ SE ¼ 40.0 ACRES
 SE ¼ SE ¼ 36.0 ACRES

SECTION 10

NE ¼ NE ¼ 16.0 ACRES
 NW ¼ NE ¼ 18.0 ACRES
 NE ¼ NW ¼ 18.0 ACRES
 NW ¼ NW ¼ 18.0 ACRES

SECTION 15

NE ¼ NE ¼ 18.0 ACRES
 NW ¼ NE ¼ 18.0 ACRES
 NE ¼ NW ¼ 15.0 ACRES
 NW ¼ NW ¼ 2.8 ACRES

SECTION 16

TOWNSHIP 41 SOUTH, RANGE 11 EAST, W.M.

Measurement, recording and reporting conditions:

- A. Before water use may begin under this permit, the permittee shall install a meter or other suitable measuring device as approved by the Director. The permittee shall maintain the meter or measuring device in good working order, shall keep a complete record of the amount of water used each month and shall submit a report which includes the recorded water use measurements to the Department annually or more frequently as may be required by the Director. Further, the Director may

require the permittee to report general water use information, including the place and nature of use of water under the permit.

- B. The permittee shall allow the watermaster access to the meter or measuring device; provided however, where the meter or measuring device is located within a private structure, the watermaster shall request access upon reasonable notice.

To monitor the effect of water use from the well(s) authorized under this permit, the Department requires the water user to make and report annual static water level measurements. The static water level shall be measured in the month of March. Reports shall be submitted to the Department within 30 days of measurement.

Measurements must be made according to the following schedule:

Before Use of Water Takes Place

Initial and Annual Measurements

The Department requires the permittee to submit an initial water level measurement in the month specified above once well construction is complete and annually thereafter until use of water begins; and

After Use of Water has Begun

Seven Consecutive Annual Measurements

Following the first year of water use, the user shall submit seven consecutive annual reports of static water level measurements. The first of these seven annual measurements will establish the reference level against which future annual measurements will be compared. Based on an analysis of the data collected, the Director may require that the user obtain and report additional annual static water level measurements beyond the seven year minimum reporting period. The additional measurements may be required in a different month. If the measurement requirement is stopped, the Director may restart it at any time.

All measurements shall be made by a certified water rights examiner, registered professional geologist, registered professional engineer, licensed well constructor or pump installer licensed by the Construction Contractors Board and be submitted to the Department on forms provided by the Department. The Department requires the individual performing the measurement to:

- (A) Identify each well with its associated measurement; and
- (B) Measure and report water levels to the nearest tenth of a foot as depth-to-water below ground surface; and
- (C) Specify the method used to obtain each well measurement; and

- (D) Certify the accuracy of all measurements and calculations submitted to the Department.

The water user shall discontinue use of, or reduce the rate or volume of withdrawal from, the well(s) if annual water level measurements reveal any of the following events:

- (A) An average water level decline of three or more feet per year for five consecutive years; or
- (B) A water level decline of 15 or more feet in fewer than five consecutive years; or
- (C) A water level decline of 25 or more feet; or
- (D) Hydraulic interference leading to a decline of 25 or more feet in any neighboring well with senior priority.

The period of non or restricted use shall continue until the annual water level rises above the decline level which triggered the action or until the Department determines, based on the permittee's and/or the Department's data and analysis, that no action is necessary because the aquifer in question can sustain the observed declines without adversely impacting the resource or senior water rights. The water user shall in no instance allow excessive decline, as defined in Commission rules, to occur within the aquifer as a result of use under this permit. If more than one well is involved, the water user may submit an alternative measurement and reporting plan for review and approval by the Department.

STANDARD CONDITIONS

If substantial interference with a senior water right occurs due to withdrawal of water from any well listed on this permit, then use of water from the well(s) shall be discontinued or reduced and/or the schedule of withdrawal shall be regulated until or unless the Department approves or implements an alternative administrative action to mitigate the interference. The Department encourages junior and senior appropriators to jointly develop plans to mitigate interferences.

The wells shall be constructed in accordance with the General Standards for the Construction and Maintenance of Water Wells in Oregon. The works shall be equipped with a usable access port, and may also include an air line and pressure gauge adequate to determine water level elevation in the well at all times.

The use shall conform to such reasonable rotation system as may be ordered by the proper state officer.

Prior to receiving a certificate of water right, the permit holder shall submit the results of a pump test meeting the department's standards, to the Water Resources Department. The Director may require water level or pump test results every ten years thereafter.

Failure to comply with any of the provisions of this permit may result in action including, but not limited to, restrictions on the use, civil penalties, or cancellation of the permit.

This permit is for the beneficial use of water without waste. The water user is advised that new regulations may require the use of best practical technologies or conservation practices to achieve this end.

By law, the land use associated with this water use must be in compliance with statewide land-use goals and any local acknowledged land-use plan.

The use of water shall be limited when it interferes with any prior surface or ground water rights.

The Director finds that the proposed use(s) of water described by this permit, as conditioned, will not impair or be detrimental to the public interest.

Complete application of the water to the use shall be made on or before October 1, 2007. If the water is not completely applied before this date, and the permittee wishes to continue development under the permit, the permittee must submit an application for extension of time, which may be approved based upon the merit of the application.

Within one year after complete application of water to the proposed use, the permittee shall submit a claim of beneficial use, which includes a map and report, prepared by a Certified Water Rights Examiner (CWRE).

Issued March 6, 2003



Paul R. Cleary
Water Resources Department

REAL ESTATE TRANSACTIONS: Pursuant to ORS 537.330, in any transaction for the conveyance of real estate that includes any portion of the lands described in this permit, the seller of the real estate shall, upon accepting an offer to purchase that real estate, also inform the purchaser in writing whether any permit, transfer approval order, or certificate evidencing the water right is available and that the seller will deliver any permit, transfer approval order or certificate to the purchaser at closing, if the permit, transfer approval order or certificate is available.

CULTURAL RESOURCES PROTECTION LAWS: Permittees involved in ground-disturbing activities should be aware of federal and state cultural resources protection laws. ORS 358.920 prohibits the excavation, injury, destruction or alteration of an archeological site or object, or removal of archeological objects from public and private lands without an archeological permit issued by the State Historic Preservation Office. 16 USC 470, Section 106, National Historic Preservation Act of 1966 requires a federal agency, prior to any undertaking to take into account the effect of the undertaking that is included on or eligible for inclusion in the National Register. For further information, contact the State Historic Preservation Office at 503-378-4168, extension 232.

Nursery Division Office
434 Redcliff Drive, Suite D
Redding, CA 96002
Phone: 530-221-6258
Fax: 530-221-2582

**Driscoll Strawberry
Associates, Inc.**

Fax

To: Sara Henderson From: Jma
 Fax: 503 986 0903 Date: 6/28/07
 Phone: _____ Pages: Cover
 Re: _____ CC: _____

- Urgent For Review Please Comment Please Reply

Don's card as requested.

Don Roberts
Director of Nursery Department

Driscoll's
Driscoll Strawberry Associates, Inc.
434 Redcliff Drive, Suite D.
Redding, CA, 96002
(530) 221-6258 OFFICE
(530) 221-2582 FAX





Oregon

John A. Kitzhaber, M.D., Governor

Water Resources Department

Commerce Building
158 12th Street NE
Salem, OR 97310-0210
(503) 378-3739
FAX (503) 378-8130

INTEROFFICE MEMO

TO: TRANSFER SECTION

DATE: ~~7~~ 7-3-07

FROM: _____ WATERMASTER, DISTRICT # _____
 X _____ GROUNDWATER SECTION

(SIGNATURE) Gerald Driscoll date signed 24 July 2007

SUBJECT: PERMIT AMENDMENT # 10419

A change in: POU POD POA of water.

In the name(s) of Holly Burgess, Driscoll Strawberry Assoc.

In my opinion (assuming the right is valid), the proposed change

MAY BE MADE WITHOUT INJURY WOULD RESULT IN INJURY* to an existing water right.

*The approval of this transfer application would result in injury to other water rights because _____

The existing right may not be valid because _____

Headgate notices HAVE HAVE NOT Been issued for diversion from the source(s) which serve(s) this right.

If for change in point of diversion, is there any intervening point(s) for diversion between the authorized and proposed points of diversion? (Yes or No) _____

In my opinion, the order approving the subject transfer application should include the following in regard to the appropriator installing suitable measuring devices in the diversion works:

_____ (1) PRIOR to the diverting of water at the new point of diversion . . .

_____ (2) WHEN IN the judgement of the watermaster it becomes necessary . . .

The enclosed copy of the transfer application and map(s) is for your records.



**Oregon Water Resources Department
Memorandum**

Date: 24 July 2007
To: Transfer Section and Application File G-15781 and Transfer File T-10419
From: Jerry Grondin, OWRD Hydrogeologist
Subject: Ground Water Transfer Technical Review
Application Number: G-15781
Permit Number: G-15347
Certificate Number: none
Transfer Number: T-10419
Transfer Applicant: Driscoll Strawberry Association

Driscoll Strawberry Association has applied for a water right transfer related to application G-15781, permit G-15347. The transfer seeks to change the point of appropriation (POA) from abandoned owner well 2 (KLAM 52796, no well tag) located in T40S/R11E-sec 9 (900 feet west and 1050 feet north from the SE corner of the NE quarter of the NW quarter section) to owner well 3 (KLAM 52972) located further NE in T40S/R11E-sec 9 (139 feet west and 90 feet south from the NE corner of the NW quarter section).

Water Right and Well History

11 June 2001	Owner well 1 (KLAM 52795) is constructed in T41S/R11E-sec 10
14 June 2001	Owner well 2 (KLAM 52796) is drilled and abandoned in T41S/R11E-sec 9
14 June 2001	OWRD receive drought application G-15427 from Gary Orem OWRD issues drought permit G-14009 on 19 June 2001
30 June 2001	Owner well 1 (KLAM 52972) is constructed in T41S/R11E-sec 9
5 October 2001	OWRD issues Limited License 0564 to Gary Orem Ground water use valid from 5 Oct 2001 to 20 Nov 2001
24 June 2002	OWRD receives application G-15781 from Gary Orem OWRD issues permit 15347 on 6 March 2003
20 April 2005	OWRD receives drought application G-16443 from USBOR OWRD issues drought permit G-15915 on 24 May 2005
1 June 2007	OWRD receives request to assign permit G-15347 (application G-15781) from Gary Orem to Driscoll Strawberry Associates, Inc.
27 June 2007	OWRD receives transfer application T-10419 to change the location of one of two POA under permit G-15347 (application G-15781)

Transfer Technical Review by Ground Water Section Staff

1. The transfer seeks to change the point of appropriation (POA) from abandoned owner well 2 (KLAM 52796, no well tag) located in T40S/R11E-sec 9 (900 feet west and 1050 feet north from the SE corner of the NE quarter of the NW quarter section) to owner well 3 (KLAM 52972) located further NE in T40S/R11E-sec 9 (139 feet west and 90 feet south from the NE corner of the NW quarter section).

The available information from water well reports indicates the new POA (KLAM 52972) obtains water from basalt that is below basin-fill. Available hydrogeologic data indicates ground water in the basalt and the overlying sediments in the Upper Klamath Basin valleys is hydraulically connected. However, the yield from basalt is typically much higher than the yield from the overlying sediments.

2. Available data indicates ground water at the new POA (KLAM 52972) is hydraulically connected to the Lost River. The POA well proposed by transfer application T-10419 is further away from the Lost River than the original POA well. Therefore, the ground water interference with the Lost River should be the same or less than currently allowed under the existing water right.

Well	Distance to Lost River	Comment
KLAM 52796	3,500 feet	original POA well
KLAM 52972	4,200 feet	proposed new POA well

3. The POA well proposed by transfer application T-10419 is closer to a neighboring water right well than the original POA well.

Well	Distance to nearest Water right well	Comment
KLAM 52796	5,350 feet	original POA well
KLAM 52972	4,900 feet	proposed new POA well

The ground water drawdown interference with the closest neighboring water right well will be greater than currently occurs under the existing water right. The increased drawdown was estimated using the Theis equation and a range of transmissivity values derived from specific capacity data for well KLAM 52972 and the "Silbernagle aquifer test" conducted by OWRD staff.

The drawdown at the closest water right well is estimated to increase at most an additional 0.50 feet to 0.75 feet during the irrigation season (see attached spreadsheet), a 2 to 9 percent increase. This should not result in "injury" as defined by OAR 690-380-0100.

Injury Assessment by Ground Water Section Staff

OAR 690-380-100 (definitions) notes "(3) 'Injury' or 'Injury to an existing water right' means a proposed transfer would result in another, existing water right not receiving previously available water to which it is legally entitled."

The proposed change by water right transfer T-10419 may be made without "injury" as defined by OAR 690-380-100 given:

- The new POA well is located further away from the Lost River; and
- The closest neighboring water right well should continue receiving previously available water to which it is legally entitled despite the increased drawdown.

Water Right Information Query Results																																																									
Contact Information	Documents <small>view all documents & comments</small>																																																								
<p>▼ Current contact information</p> <p>DRISCOLL STRAWBERRY ASSOCIATES INC. HOLLY BURGESS ▶ PO BOX 50045 345 WESTRIDGE DR WATSONVILLE, CA 96002</p> <p>▼ Prior contact information</p> <p>OREM LAND CO. ▶ GARY OREM 20000 HWY 50 MERRILL, OR 97633</p>	<p>▶ Application: G 15781 digital map</p> <p>▶ Permit: G 15347 document, digital map, paper map</p> <p>▶ Transfer(s)</p>																																																								
Water Right Information																																																									
Status: Non-Cancelled County: Klamath File Folder Location: Salem Watermaster District: 17																																																									
Point(s) of Diversion																																																									
<p>▼ POD 1 - A WELL > LOST RIVER</p> <p>▼ Description</p> <p>▶ Name: WELL 1 ▶ T-R-S-QQ: 41.00S-11.00E-10-NE SW ▶ Location Description: 400 FEET NORTH & 300 FEET WEST FROM SE CORNER, NESW, SECTION 10</p> <p>▼ POD Rate</p> <table border="1" style="width:100%; border-collapse: collapse;"> <thead> <tr> <th>Max Rate (cfs)</th> <th>Rate (cfs)</th> <th>Max Volume (af)</th> <th>Volume (af)</th> </tr> </thead> <tbody> <tr> <td>11.5</td> <td>5.75(est)</td> <td></td> <td></td> </tr> </tbody> </table> <p>▼ SUPPLEMENTAL IRRIGATION (Supplemental)</p> <table border="1" style="width:100%; border-collapse: collapse;"> <thead> <tr> <th>Priority Date</th> <th>Max Rate (cfs)</th> <th>Rate (cfs)</th> <th>Max Volume (af)</th> <th>Volume (af)</th> <th>Rate/Acre</th> <th>Duty</th> <th>Start Date</th> <th>End Date</th> <th>Remarks</th> </tr> </thead> <tbody> <tr> <td>6/24/2002</td> <td>11.5</td> <td>5.75(est)</td> <td></td> <td></td> <td>1/80</td> <td>3.00000</td> <td>3/1</td> <td>10/31</td> <td></td> </tr> </tbody> </table> <p>▼ POD 2 - A WELL > LOST RIVER</p> <p>▼ Description</p> <p>▶ Name: WELL 2 ▶ T-R-S-QQ: 41.00S-11.00E-9-NE NW ▶ Location Description: 1050 FEET NORTH & 900 FEET WEST FROM SE CORNER, NENW, SECTION 9</p> <p>▼ POD Rate</p> <table border="1" style="width:100%; border-collapse: collapse;"> <thead> <tr> <th>Max Rate (cfs)</th> <th>Rate (cfs)</th> <th>Max Volume (af)</th> <th>Volume (af)</th> </tr> </thead> <tbody> <tr> <td>11.5</td> <td>5.75(est)</td> <td></td> <td></td> </tr> </tbody> </table> <p>▼ SUPPLEMENTAL IRRIGATION (Supplemental)</p> <table border="1" style="width:100%; border-collapse: collapse;"> <thead> <tr> <th>Priority Date</th> <th>Max Rate (cfs)</th> <th>Rate (cfs)</th> <th>Max Volume (af)</th> <th>Volume (af)</th> <th>Rate/Acre</th> <th>Duty</th> <th>Start Date</th> <th>End Date</th> <th>Remarks</th> </tr> </thead> <tbody> <tr> <td>6/24/2002</td> <td>11.5</td> <td>5.75(est)</td> <td></td> <td></td> <td>1/80</td> <td>3.00000</td> <td>3/1</td> <td>10/31</td> <td></td> </tr> </tbody> </table>		Max Rate (cfs)	Rate (cfs)	Max Volume (af)	Volume (af)	11.5	5.75(est)			Priority Date	Max Rate (cfs)	Rate (cfs)	Max Volume (af)	Volume (af)	Rate/Acre	Duty	Start Date	End Date	Remarks	6/24/2002	11.5	5.75(est)			1/80	3.00000	3/1	10/31		Max Rate (cfs)	Rate (cfs)	Max Volume (af)	Volume (af)	11.5	5.75(est)			Priority Date	Max Rate (cfs)	Rate (cfs)	Max Volume (af)	Volume (af)	Rate/Acre	Duty	Start Date	End Date	Remarks	6/24/2002	11.5	5.75(est)			1/80	3.00000	3/1	10/31	
Max Rate (cfs)	Rate (cfs)	Max Volume (af)	Volume (af)																																																						
11.5	5.75(est)																																																								
Priority Date	Max Rate (cfs)	Rate (cfs)	Max Volume (af)	Volume (af)	Rate/Acre	Duty	Start Date	End Date	Remarks																																																
6/24/2002	11.5	5.75(est)			1/80	3.00000	3/1	10/31																																																	
Max Rate (cfs)	Rate (cfs)	Max Volume (af)	Volume (af)																																																						
11.5	5.75(est)																																																								
Priority Date	Max Rate (cfs)	Rate (cfs)	Max Volume (af)	Volume (af)	Rate/Acre	Duty	Start Date	End Date	Remarks																																																
6/24/2002	11.5	5.75(est)			1/80	3.00000	3/1	10/31																																																	
Place(s) of Use <small>add new equipment</small>																																																									
▶ Use - SUPPLEMENTAL IRRIGATION (Supplemental) - 916.8 acres; Priority Date: 6/24/2002																																																									
Water Right Genealogy																																																									
--App:G 15781 ↳Permit:G 15347 *																																																									

[View Water Rights in same Family](#)

[Help understanding and working with the Water Rights Information System](#)

[Report Errors with Water Right Data](#)

[Return to WRIS Query](#)

STATE OF OREGON
WATER SUPPLY WELL REPORT

(as required by ORS 537.765)

(1) OWNER:

Name: Clary Orem
Address: 19980 Hwy 50
City: Merrill State: OR Zip: 97633

Well Number: 1

(2) TYPE OF WORK: (repair)
 New Well Deepening Alteration/recondition Abandonment

(3) DRILL METHOD:
 Rotary Air Rotary Mud Cable Auger
 Other: _____

(4) PROPOSED USE:
 Domestic Community Industrial Irrigation
 Thermal Injection Livestock Other _____

(5) BORE HOLE CONSTRUCTION:
Special Construction approval Yes No
Depth of Completed Well 288.6'
Explosives Used Yes No Type --- Amount ---

HOLE			SEAL			sacks or pounds
Diameter	From	To	Material	From	To	
24"	-50'	117'	Coment	50'	117'	150 Sacks
24"	0	50	Bent Chip	0	50	55 Sacks

How was seal placed: Method A B C D E

Other Bent Chips Poured Dry

Backfill placed from 50 to 90 Material Bent
from --- to --- Material ---

Gravel placed from --- to --- Size of gravel ---

(6) CASING/LINER:

CASING:

Diameter	From	To	Gauge	Steel	Plastic	Welded	Threaded
20"	1'	117'	.375	<input checked="" type="checkbox"/>	<input type="checkbox"/>	<input checked="" type="checkbox"/>	<input type="checkbox"/>

LINER:

Diameter	From	To	Gauge	Steel	Plastic	Welded	Threaded
				<input type="checkbox"/>	<input type="checkbox"/>	<input type="checkbox"/>	<input type="checkbox"/>

Final location of Shoe(s): _____

(7) PERFORATIONS/SCREENS:

Perforations Method: _____
 Screen Type: _____ Material: _____

From	To	Slot Size	No.	Diameter	Tele/pipe size	Casing	Liner
						<input type="checkbox"/>	<input type="checkbox"/>

(8) WELL TESTS: Minimum testing time is 1 hour

Pump Bailor Air Flowing Artesian
Yield gpm Drawdown Drill Stem at Time

3000+		287	1 hr.
3800	2		8 hrs

Temperature of water 58 Depth Artesian Flow Found ---

Was a water analysis done? --- By whom: ---

Did any strata contain water not suitable for intended use? (explain) ---

Depth of Strata: ---

K-LAM
52795

WELL ID # L 50211
START CARD # 111253

(9) LOCATION OF WELL by legal description:

County: Klamath Latitude: _____ Longitude: _____
Township: 41S Range: 11E
Section: 8 SW $\frac{1}{4}$ SE $\frac{1}{4}$
Tax Lot: 1300 Lot: _____ Block: _____ Subdivision: _____
Street Address of Well (or nearest address) _____
19980 Hwy 50 Merrill OR

(10) STATIC WATER LEVEL:

40' Ft. below land surface Date 6/12/01
Arterian pressure --- lb. per sq. in. Date ---

(11) WATER BEARING ZONES:

Depth at which water was first found 155

From	To	Est. Flow Rate	SWL
155	175	1000+	40
250	280	2000+	40

(12) WELL LOG:

Ground Elevation: _____

Material	From	To	SWL
Soil Sandy	0	2	
Sand Dirt Dry	2	11	
Silty Sand Brown	11	33	
Sand Black & Gray	33	40	
Clay Sticky Blue	40	66	
Sand Brown Gray (120)	66	71	
Clay Green Gray	71	89	
Clay Gray Sticky	89	107	
Basalt Black Hard	107	145	
Basalt Red & Blue Soft	145	150	
Basalt Gray Slightly Decomposed	150	157	
Basalt Gray Hard w/Brown Fractures	157	186	
Basalt Red & Blue Decomposed Med	186	246	
Cinders Red Soft	246	280	
Cinders Dark Red - Brown	280	284	
Basalt Blue - Gray w/Slight Red	284	288.6	

RECEIVED

JUL 11 2001

WATER RESOURCES DEPT.
SALEM, OREGON

RECEIVED

AUG 17 2001

WATER RESOURCES DEPT.
SALEM, OREGON

Date Started: 6/1/01 Completed: 6/1/01

(unbonded) Water Well Construction Certification:

I certify that the work performed on the construction, alteration, or abandonment of this well is in compliance with Oregon water supply well construction standards. Materials used and information reported above are true to the best of my knowledge and belief.

Signed _____ WWC Number 723
Date 7/6/01

(bonded) Water Well Constructor Certification:

I accept responsibility for the construction, alteration, or abandonment work performed on this well during the construction dates reported above. All work performed during this time is in compliance with Oregon water supply well construction standards. This report is true to the best of my knowledge and belief.

Signed _____ WWC Number 723
Date 7/6/01

Drawdown Calculations Using This Equation

This Equation: $s = [Q/(4 \cdot T \cdot \pi)] [W(u)]$
 $u = (r^2 \cdot S)/(4 \cdot T \cdot t)$
 $W(u) = (-\ln u) - (0.5772157) + (u/1 \cdot 1!) - (u^2/2 \cdot 2!) + (u^3/3 \cdot 3!) - (u^4/4 \cdot 4!) + \dots$

s = drawdown (L) r = radial distance (L)
 T = transmissivity (L²/T) t = time (T)
 S = storage coefficient (dimensionless) u = dimensionless
 pi = 3.141592654 W(u) = well function

Transmissivity T (gpd/ft)	Transmissivity T (ft ² /day)	Storage Coefficient S	Pumping Rate Q (gal/min)	Pumping Rate Q (ft ³ /sec)	Time t (days)	Distance r (feet)	pi	u	W(u)	Drawdown s (feet)	Comments
								Note : W(u) calculation valid when u < 7.1			
Note: yellow grid areas are where values are calculated								7.0000	1.1545E-04		W(u) calculation test
KLAM 52972 (Owner Well 3) to Closest Water Right Well (KLAM 10506) using the lowest Transmissivity from Silbernagle Aquifer Test											
141,100.00	18,862.33	0.00750	5,161.56	11.50	30.00	4,900.00	3.14	0.0796	2.0321	8.5182	Continuous Pumping at Full Rate
141,100.00	18,862.33	0.00750	5,161.56	11.50	184.00	4,900.00	3.14	0.0130	3.7807	15.8483	Continuous Pumping at Full Rate
141,100.00	18,862.33	0.00750	5,161.56	11.50	245.00	4,900.00	3.14	0.0097	4.0638	17.0351	Continuous Pumping at Full Rate
KLAM 52972 (Owner Well 3) to Closest Water Right Well (KLAM 10506) using the highest Transmissivity from Silbernagle Aquifer Test											
174,700.00	23,353.99	0.00750	5,161.56	11.50	30.00	4,900.00	3.14	0.0643	2.2309	7.5531	Continuous Pumping at Full Rate
174,700.00	23,353.99	0.00750	5,161.56	11.50	184.00	4,900.00	3.14	0.0105	3.9919	13.5150	Continuous Pumping at Full Rate
174,700.00	23,353.99	0.00750	5,161.56	11.50	245.00	4,900.00	3.14	0.0079	4.2756	14.4756	Continuous Pumping at Full Rate
KLAM 52972 (Owner Well 3) to Closest Water Right Well (KLAM 10506) using the Transmissivity from KLAM 52972 Specific Capacity Data											
211,866.13	28,322.38	0.00010	5,161.56	11.50	30.00	4,900.00	3.14	0.0007	6.6787	18.6452	Continuous Pumping at Full Rate
211,866.13	28,322.38	0.00010	5,161.56	11.50	184.00	4,900.00	3.14	0.0001	8.4919	23.7070	Continuous Pumping at Full Rate
211,866.13	28,322.38	0.00010	5,161.56	11.50	245.00	4,900.00	3.14	0.0001	8.7782	24.5063	Continuous Pumping at Full Rate
KLAM 52796 (Owner Well 2) to Closest Water Right Well (KLAM 10506) using the lowest Transmissivity from Silbernagle Aquifer Test											
141,100.00	18,862.33	0.00750	5,161.56	11.50	30.00	5,350.00	3.14	0.0948	1.8710	7.8429	Continuous Pumping at Full Rate
141,100.00	18,862.33	0.00750	5,161.56	11.50	184.00	5,350.00	3.14	0.0155	3.6075	15.1221	Continuous Pumping at Full Rate
141,100.00	18,862.33	0.00750	5,161.56	11.50	245.00	5,350.00	3.14	0.0116	3.8900	16.3063	Continuous Pumping at Full Rate
KLAM 52796 (Owner Well 2) to Closest Water Right Well (KLAM 10506) using the highest Transmissivity from Silbernagle Aquifer Test											
174,700.00	23,353.99	0.00750	5,161.56	11.50	30.00	5,350.00	3.14	0.0766	2.0671	6.9985	Continuous Pumping at Full Rate
174,700.00	23,353.99	0.00750	5,161.56	11.50	184.00	5,350.00	3.14	0.0125	3.8181	12.9268	Continuous Pumping at Full Rate
174,700.00	23,353.99	0.00750	5,161.56	11.50	245.00	5,350.00	3.14	0.0094	4.1014	13.8857	Continuous Pumping at Full Rate
KLAM 52796 (Owner Well 2) to Closest Water Right Well (KLAM 10506) using the Transmissivity from KLAM 52972 Specific Capacity Data											
211,866.13	28,322.38	0.00010	5,161.56	11.50	30.00	5,350.00	3.14	0.0008	6.5032	18.1550	Continuous Pumping at Full Rate
211,866.13	28,322.38	0.00010	5,161.56	11.50	184.00	5,350.00	3.14	0.0001	8.3162	23.2165	Continuous Pumping at Full Rate
211,866.13	28,322.38	0.00010	5,161.56	11.50	245.00	5,350.00	3.14	0.0001	8.6025	24.0157	Continuous Pumping at Full Rate

Transmissivity from Specific Capacity using the Theis Equation

Adapted from Vorhls (1979)

Theis Equation: $T = [Q/(4*s*\pi)] [W(u)]$

$u = (r^2*S)/(4*T*t)$

$W(u) = (-\ln u) - (0.5772157) + (u^{1.1}) - (u^{1.1}/2) + (u^{1.1}/3) - (u^{1.1}/4) + \dots$

T = transmissivity (L²/T)

s = drawdown (L)

S = storage coefficient (dimensionless)

pi = 3.141592654

r = radial distance (L)

t = time (T)

u = dimensionless

W(u) = well function

Note: Transmissivity is derived using an iterative process

The calculations use a known or assumed Storage Coefficient (S) provided by the user
 Specific Capacity (Q/s) is used to first approximate the Transmissivity (T) used to calculate u in the first Theis equation iteration
 The Transmissivity of the previous iteration is used to calculate u in a given Theis equation iteration
 Total Theis Equation iterations = 25 iterations
 Can accept answer if difference in calculated Transmissivity for the last 2 iterations is < 0.0001
 Can accept answer if u in the last iteration is < 7.1

Note: Well efficiency is not included in the calculations

References:

Theis, C.V. 1935. The relation between the lowering of the piezometric surface and the rate and duration of discharge of a well using ground water storage. American Geophysical Union Transactions, 16 annual meeting, vol. 16, pg. 519-524.

Vorhls, R.C. 1979. Transmissivity from pumped well data. Well Log, National Water Well Association newsletter, vol. 10, no. 11, Dec. 1979, pg. 50-52.

Data Entry

Enter Data Below
(yellow boxes only)

Well Log ID or Comment for Records	KLAM-52972	
Pumping Rate (gpm) = Q =	4,000.00	(gpm)
Drawdown (feet) = s =	40.00	(feet)
Time (hours) = t =	24.0000	(hours)
Storage Coefficient = S =	0.007000	(dimensionless)
Well Diameter (Inches) = d =	18.5000	(Inches)
Press F9 to Calculate		

Calculated Results	Calculated Results	
Transmissivity (ft ² /day) = T =	28,322.38	(ft ² /day)
Transmissivity (gpd/ft) = T =	211,866.13	(gpd/ft)
Transmissivity Difference = (last 2 iterations)	0.0000E+00 okay to use T if diff < 0.0001	(ft ² /day)
u = (last iteration)	5.2448E-09 okay to use T if u < 7.1	

Drawdown s (feet)	Storage Coefficient S	Pumping Rate Q (gal/min)	Pumping Rate Q (ft ³ /sec)	Time t (days)	Distance r = d/2 (feet)	u	W(u)	Transmissivity T (ft ² /day)	Transmissivity difference from previous	Comments	Theis Equation Iteration
Note: yellow grid areas are where values are calculated						Note: W(u) calculation valid when u < 7.1					
						7.0000	1.1545E-04			W(u) calculation test	
40.00	0.00100	4,000.00	8.91	1.00	0.77			19,250.00		T = Q/s	
40.00	0.00100	4,000.00	8.91	1.00	0.77	7.7167E-09	18.1027	27,730.86	8.4809E+03	T = Theis Equation	1.00
40.00	0.00100	4,000.00	8.91	1.00	0.77	5.3587E-09	18.4677	28,290.05	5.5918E+02	T = Theis Equation	2.00
40.00	0.00100	4,000.00	8.91	1.00	0.77	5.2508E-09	18.4877	28,320.83	3.0582E+01	T = Theis Equation	3.00
40.00	0.00100	4,000.00	8.91	1.00	0.77	5.2452E-09	18.4887	28,322.29	1.6561E+00	T = Theis Equation	4.00
40.00	0.00100	4,000.00	8.91	1.00	0.77	5.2448E-09	18.4888	28,322.37	8.9522E-02	T = Theis Equation	5.00
40.00	0.00100	4,000.00	8.91	1.00	0.77	5.2448E-09	18.4888	28,322.38	4.8419E-03	T = Theis Equation	6.00
40.00	0.00100	4,000.00	8.91	1.00	0.77	5.2448E-09	18.4888	28,322.38	2.6189E-04	T = Theis Equation	7.00
40.00	0.00100	4,000.00	8.91	1.00	0.77	5.2448E-09	18.4888	28,322.38	1.4165E-05	T = Theis Equation	8.00
40.00	0.00100	4,000.00	8.91	1.00	0.77	5.2448E-09	18.4888	28,322.38	7.6611E-07	T = Theis Equation	9.00
40.00	0.00100	4,000.00	8.91	1.00	0.77	5.2448E-09	18.4888	28,322.38	4.1437E-08	T = Theis Equation	10.00
40.00	0.00100	4,000.00	8.91	1.00	0.77	5.2448E-09	18.4888	28,322.38	2.2448E-09	T = Theis Equation	11.00
40.00	0.00100	4,000.00	8.91	1.00	0.77	5.2448E-09	18.4888	28,322.38	1.2005E-10	T = Theis Equation	12.00
40.00	0.00100	4,000.00	8.91	1.00	0.77	5.2448E-09	18.4888	28,322.38	0.0000E+00	T = Theis Equation	13.00
40.00	0.00100	4,000.00	8.91	1.00	0.77	5.2448E-09	18.4888	28,322.38	0.0000E+00	T = Theis Equation	14.00
40.00	0.00100	4,000.00	8.91	1.00	0.77	5.2448E-09	18.4888	28,322.38	0.0000E+00	T = Theis Equation	15.00
40.00	0.00100	4,000.00	8.91	1.00	0.77	5.2448E-09	18.4888	28,322.38	0.0000E+00	T = Theis Equation	16.00
40.00	0.00100	4,000.00	8.91	1.00	0.77	5.2448E-09	18.4888	28,322.38	0.0000E+00	T = Theis Equation	17.00
40.00	0.00100	4,000.00	8.91	1.00	0.77	5.2448E-09	18.4888	28,322.38	0.0000E+00	T = Theis Equation	18.00
40.00	0.00100	4,000.00	8.91	1.00	0.77	5.2448E-09	18.4888	28,322.38	0.0000E+00	T = Theis Equation	19.00
40.00	0.00100	4,000.00	8.91	1.00	0.77	5.2448E-09	18.4888	28,322.38	0.0000E+00	T = Theis Equation	20.00
40.00	0.00100	4,000.00	8.91	1.00	0.77	5.2448E-09	18.4888	28,322.38	0.0000E+00	T = Theis Equation	21.00
40.00	0.00100	4,000.00	8.91	1.00	0.77	5.2448E-09	18.4888	28,322.38	0.0000E+00	T = Theis Equation	22.00
40.00	0.00100	4,000.00	8.91	1.00	0.77	5.2448E-09	18.4888	28,322.38	0.0000E+00	T = Theis Equation	23.00
40.00	0.00100	4,000.00	8.91	1.00	0.77	5.2448E-09	18.4888	28,322.38	0.0000E+00	T = Theis Equation	24.00
40.00	0.00100	4,000.00	8.91	1.00	0.77	5.2448E-09	18.4888	28,322.38	0.0000E+00	T = Theis Equation	25.00



Oregon Water Resources Department
725 Summer Street NE, Suite A
Salem, Oregon 97301-1271
(503) 986-0900
www.wrd.state.or.us

Watermaster Review Form: Water Right Transfer

Transfer Application: T-10419

Review Due Date: 8/1/2007

Applicant Name: Holly Burgess, Driscoll Strawberry Assoc.

Proposed Changes: POU POD POA USE OTHER

Reviewer(s): Vern Church

Date of Review: Jul. 18, 2007

1. Do you have information suggesting that the water rights may be subject to forfeiture?
 Yes No If "Yes", describe the information and indicate if you intend to file a cancellation affidavit or if you need additional time to determine if a cancellation affidavit should be filed: _____
2. Is there a history of regulation on the source that serves the right proposed for transfer that has involved the right and downstream water rights? Yes No Generally characterize the frequency of any regulation or explain why regulation has not occurred: using the groundwater source when the primary is there.
3. Check here if it appears that downstream water rights benefit from return flows resulting from the current use of the right? If you check the box, generally characterize the locations where the return flows likely occur and list the water rights that benefit most:

4. Are there upstream water rights that would be affected by the proposed change?
 Yes No If "Yes", describe how the rights would be affected and list the rights most affected: _____
5. For POD changes and instream transfers, check here if there are channel losses between the old and new PODs or within the proposed instream reach? If you check the box, describe and, if possible, estimate the losses: _____
6. Would distribution of water for the right after the proposed change result in regulation of other water rights that would not have occurred if use of the existing right was maximized?
 Yes No If "Yes", explain: _____
7. For POU changes, would the original place of use continue to receive water from the same source? Yes No N/A If "Yes", explain: _____
8. For POU or USE changes, would use of the existing right at "full face value," result in the diversion of more water than can be used beneficially and without waste? Yes No If "Yes", explain: _____
9. Are there other issues not identified through the above questions? Yes No If "Yes", explain: _____
10. What alternatives may be available for addressing any issues identified above: _____

11. Have headgate notices been issued for the source that serves the right? Yes No

12. What water control and measurement conditions should be included in the transfer:

Measurement Devices	<input type="checkbox"/> Present and should be maintained.	<input type="checkbox"/> Should be required prior to diverting water.	<input type="checkbox"/> May be required in the future.
Headgates	<input type="checkbox"/> Present and should be maintained.	<input type="checkbox"/> Should be required prior to diverting water.	<input type="checkbox"/> May be required in the future.



Oregon Water Resources Department Land Use Information Form

THIS FORM IS NOT REQUIRED IF: 1) water is to be diverted, conveyed, and/or used only on federal lands; or 2) the application is for a water-right transfer, allocation of conserved water, exchange, permit amendment, or ground water registration modification, and all of the following apply: a) only the place of use is proposed for change, b) there are no structural changes, c) the use of water is for irrigation, and d) the use is located in an irrigation district or exclusive farm-use zone.

Applicant Name: Driscoll Strawberry Association, Inc., Contact: Holly Burgess, Nursery Dept. Mgr.
Mailing Address: P.O. Box 50045 (345 Westridge Dr.)
City: Watsonville State: CA Zip: 95077-5045 Day Phone: (530) 221-6258

This application is related to a Measure 37 claim. Yes No

A. Land and Location

Please include the following information for all tax lots where water will be diverted (taken from its source), conveyed (transported), or used. Applicants for municipal use, or irrigation uses within irrigation districts may substitute existing and proposed service-area boundaries for the tax-lot information requested below.

Township	Range	Section	¼ ¼	Tax Lot #	Plan Designation (e.g. Rural Residential/RR-5)	Water to be:	Proposed Land Use:
				See		<input type="checkbox"/> Diverted <input type="checkbox"/> Conveyed <input checked="" type="checkbox"/> Used	
				Attached		<input type="checkbox"/> Diverted <input type="checkbox"/> Conveyed <input checked="" type="checkbox"/> Used	
				Sheet		<input type="checkbox"/> Diverted <input type="checkbox"/> Conveyed <input checked="" type="checkbox"/> Used	
						<input type="checkbox"/> Diverted <input type="checkbox"/> Conveyed <input checked="" type="checkbox"/> Used	

List all counties and cities where water is proposed to be diverted, conveyed, or used. Klamath County

B. Description of Proposed Use

Type of application to be filed with the Water Resources Department:

- Permit to Use or Store Water Water-Right Transfer Exchange of Water
 Allocation of Conserved Water Limited Water Use License
 Permit Amendment or Ground Water Registration Modification

Source of water: Reservoir/Pond Ground Water Surface Water (name) _____

Estimated quantity of water needed: 11.5 cubic feet per second gallons per minute acre-feet

Intended use of water: Irrigation Commercial Industrial Domestic for _____ household(s)
 Municipal Quasi-municipal Instream Other _____

Briefly describe: The Permit Amendment for G-15347 is to change the POA from the authorized Well #2 location (Klam 52796), a dry Well, to allow groundwater appropriation from the "West" Well #3 (KLAM 52972).

There is no other amendment or change to the permit.

Note to applicant: *If the Land Use Information Form cannot be completed while you wait, please have a local government representative sign the receipt below and include it with the application filed with the Water Resources Department.*

RECEIVED

JUN 27 2007

WATER RESOURCES DEPT
SALEM, OREGON

1 10419

For Local Government Use Only

The following section must be completed by a planning official from each county and city listed unless the project will be located entirely within the city limits. In that case, only the city planning agency must complete this form.

This deals only with the local land-use plan. Do not include approval for activities such as building or grading permits.

Please check the appropriate box below and provide the requested information

Land uses to be served by proposed water uses (including proposed construction) are allowed outright or are not regulated by your comprehensive plan. Cite applicable ordinance section(s): Exclusive Farm Use

Land uses to be served by proposed water uses (including proposed construction) involve discretionary land-use approvals as listed in the table below. (Please attach documentation of applicable land-use approvals which have already been obtained. Record of Action/land-use decision and accompanying findings are sufficient.)

If approvals have been obtained but all appeal periods have not ended, check "Being pursued".

Type of Land-Use Approval Needed (e.g. plan amendments, rezones, conditional-use permits, etc.)	Cite Most Significant, Applicable Plan Policies & Ordinance Section References	Land-Use Approval:	
		<input type="checkbox"/> Obtained <input type="checkbox"/> Denied	<input type="checkbox"/> Being pursued <input type="checkbox"/> Not being pursued
		<input type="checkbox"/> Obtained <input type="checkbox"/> Denied	<input type="checkbox"/> Being pursued <input type="checkbox"/> Not being pursued
		<input type="checkbox"/> Obtained <input type="checkbox"/> Denied	<input type="checkbox"/> Being pursued <input type="checkbox"/> Not being pursued
		<input type="checkbox"/> Obtained <input type="checkbox"/> Denied	<input type="checkbox"/> Being pursued <input type="checkbox"/> Not being pursued
		<input type="checkbox"/> Obtained <input type="checkbox"/> Denied	<input type="checkbox"/> Being pursued <input type="checkbox"/> Not being pursued

Local governments are invited to express special land-use concerns or make recommendations to the Water Resources Department regarding this proposed use of water below, or on a separate sheet.

RECEIVED

JUN 27 2007

**WATER RESOURCES DEPT
SALEM, OREGON**

Name: Alyssa Boles Title: Permit Tech

Signature: Alyssa Boles Phone: 503-883-5121 Date: 6/25/07

Government Entity: Clatsop County

T 10419

Note to local government representative: Please complete this form or sign the receipt below and return it to the applicant. If you sign the receipt, you will have 30 days from the Water Resources Department's notice date to return the completed Land Use Information Form or WRD may presume the land use associated with the proposed use of water is compatible with local comprehensive plans.

Receipt for Request for Land Use Information

Applicant name: _____

City or County: _____ Staff contact: _____

Signature: _____ Phone: _____ Date: _____

Last updated 12/22/06 WR

Land and Location

Township	Range	Section	1/4-1/4	Tax Lot Number	Plan Designation (e.g. Rural Residential/RR-5)	Water To Be:	Proposed Land Use:
T41S	R11E	8	NE-NE	100	EFU	Used	Irr.
T41S	R11E	8	NW-NE	200	EFU	Used	Irr.
T41S	R11E	8	SW-NE	600	EFU	Used	Irr.
T41S	R11E	8	SE-NE	700	EFU	Used	Irr.
T41S	R11E	8	NE-SE	700	EFU	Used	Irr.
T41S	R11E	9	NW-NW	501	EFU	Used	Irr.
T41S	R11E	9	NE-NW	501	EFU	Used	Irr.
T41S	R11E	9	SW-NW	501	EFU	Used	Irr.
T41S	R11E	9	SE-NW	501	EFU	Used	Irr.
T41S	R11E	9	NE-SW	502	EFU	Used	Irr.
T41S	R11E	9	NW-SW	500,502	EFU	Used	Irr.
T41S	R11E	9	SW-SW	500,600	EFU	Used	Irr.
T41S	R11E	9	SE-SW	502	EFU	Used	Irr.
T41S	R11E	9	NE-SE	700	EFU	Used	Irr.
T41S	R11E	9	NW-SE	503	EFU	Used	Irr.
T41S	R11E	9	SW-SE	503	EFU	Used	Irr.
T41S	R11E	9	SE-SE	700	EFU	Used	Irr.
T41S	R11E	10	SW-NW	400	EFU	Used	Irr.
T41S	R11E	10	SE-NW	400	EFU	Used	Irr.
T41S	R11E	10	NE-SW	1300	EFU	Used	Irr.
T41S	R11E	10	NW-SW	501,1101,1200	EFU	Used	Irr.
T41S	R11E	10	SW-SW	2000	EFU	Used	Irr.
T41S	R11E	10	SE-SW	1900,2000	EFU	Used	Irr.
T41S	R11E	10	NE-SE	1400	EFU	Used	Irr.
T41S	R11E	10	NW-SE	1400	EFU	Used	Irr.
T41S	R11E	10	SW-SE	1400	EFU	Used	Irr.
T41S	R11E	10	SE-SE	1600,1700	EFU	Used	Irr.
T41S	R11E	15	NE-NE	1700	EFU	Used	Irr.
T41S	R11E	15	NW-NE	200	EFU	Used	Irr.
T41S	R11E	15	NE-NW	300	EFU	Used	Irr.
T41S	R11E	15	NW-NW	300	EFU	Used	Irr.
T41S	R11E	16	NE-NE	100	EFU	Used	Irr.
T41S	R11E	16	NW-NE	201	EFU	Used	Irr.
T41S	R11E	16	NE-NW	200	EFU	Used	Irr.
T41S	R11E	16	NW-NW	200	EFU	Used	Irr.

RECEIVED

JUN 27 2007

**WATER RESOURCES DEPT
SALEM, OREGON**

T 10419

Indicate in this column whether or not the item is satisfied.

Permit Amendment Application – ORS 537.211

Completeness Checklist

Applicant's Name: Driscoll Assc. Burgess (Form last revised: October 30, 2006)

Section A – Status of Permit

Is this a permit that can be amended?

NOTE: The Department CANNOT accept a Permit Amendment application for any permit that has:
___ 1) a permit completion date that has expired; *or*
___ 2) a pending permit extension of time application on file with the Department; *or*
___ 3) a pending claim of beneficial use report on file with the Department.

If the subject permit falls into any of the above categories, RETURN the application & fee to the applicant.

Section B – Type of Change

Is the proposed change(s) allowed under the Permit Amendment process? [ORS 537.211(4)]

NOTE: Only POD, POA or POU changes are allowed on Permit Amendments.

If the application proposes a change other than those listed above, RETURN the application & fee to the applicant.

Section C - Fees

Have the appropriate fees been paid?

Total Required Fees: _____

Fee Schedule – ORS 536.050(1)(h)

Total Fees Paid: 350

\$350 - Base fee (1st change and 1st CFS of water)

Fees Due (if any): _____

+ \$350 - Each additional type of change requested

+ \$175 - For each CFS, or fraction thereof, requested beyond 1st CFS

Refund Due (if any): _____

(for POU, Type of Use, or Exchange)

If the applicant has NOT submitted the total fees required, RETURN the application & deficient fee to the applicant.

Section D – Completeness

Indicate in this column whether an item is incomplete, and if so, identify the deficiency.

Is the Permit Amendment application complete?

All required elements necessary for a complete permit amendment application are listed below. Indicate whether or not the applicant has answered and/or supplied attachments to adequately address each of the following items. If any one of the items is deficient, then the application is incomplete.

NOTE: For reference, the application page number upon which each item is requested is identified.

If the application is NOT complete, RETURN the application & fee to the applicant.

• Applicant's name, mailing address and contact information. (Page 1)

• Agent's name, mailing address and contact information, if applicable. (Page 1)

• Are multiple permits being amended? YES NO (Page 2)

If YES..... the applicant must supply a separate "set" of pages 3 through 7 of the application form for each permit to be amended.

• The type of amendment being proposed. POA (Page 2)

• Reason for the permit amendment. (Page 2)

• Current permit information – permit number, use, priority date, source(s), etc. (Page 3)

N/A	<ul style="list-style-type: none"> • If for a change in POU.....Are there any "layered" irrigation rights, permits, or GR registrations appurtenant to the same place of use as the permit proposed to be amended? YES NO If YES..... the other "layered" water uses subject to transfer must either change concurrently or be cancelled, except as provided in OAR 690-380-2240(5). (Page 3)
OK	<ul style="list-style-type: none"> • Location description of the authorized POA/POD to be amended. (Page 4) <i>NOTE:</i> Ensure that the location coordinates listed in the application match the point and location coordinates illustrated on the application map. Additionally, if the existing authorized source is ground water (POA), the applicant must either: _____ 1) supply a copy of the well log(s), <u>or</u> _____ 2) if well logs are not available, describe the construction of the well(s) in the table provided on page 4 of the application.
N/A	<ul style="list-style-type: none"> • Location description of the existing authorized POU and associated acres (if applicable). (Page 5) <i>NOTE:</i> Ensure that the location and number of acres listed per ¼ ¼ in the application match those illustrated on the application map.
OK	<ul style="list-style-type: none"> • Location description of the proposed POA/POD. (Page 6) <i>NOTE:</i> Ensure that the proposed location coordinates listed in the application match the proposed point and location coordinates illustrated on the application map. Additionally, if the proposed source is ground water (POA), the applicant must either: _____ 1) supply a copy of the well log(s), <u>or</u> _____ 2) if well logs are not available <u>or</u> the well is not yet constructed, describe the construction of the well(s) in the table provided on page 6 of the application.
N/A	<ul style="list-style-type: none"> • Location description of the proposed POU and associated acres (if applicable). (Page 7) <i>NOTE:</i> Ensure that the location and number of acres listed per ¼ ¼ in the application match those illustrated on the application map.
OK	<ul style="list-style-type: none"> • Affected districts and local governments. (Page 8) If within a district/local government jurisdiction, ensure that name & mailing address is provided.
OK	<ul style="list-style-type: none"> • Is the applicant the permit holder of record? YES NO (Page 8) If NO..... the applicant must either submit: _____ 1) a Request for Assignment form & fee in order to be assigned to the permit, <u>or</u> _____ 2) an Affidavit of Consent from the permit holder giving permission for the amendment.
N/A	<ul style="list-style-type: none"> • If the permit holder of record does not own or control the land TO which the place of use is being moved, has a Request for Assignment form been submitted to assign the owner of the TO land to the permit? YES NO (Page 9)
OK	<ul style="list-style-type: none"> • Map..... (NOT required to be prepared by a CWRE). (Page 10) __ north arrow __ size & scale __ other: _____ __ authorized acreage per ¼ ¼ matches the permit __ authorized POD/POA and POU (<i>clearly shown, labeled & matches application listing</i>) __ point plotted for the authorized POD/POA agrees with location coordinates __ proposed POD/POA and/or POU (<i>clearly shown, labeled & matches application "proposed" listing</i>) __ location coordinates accurately describe the point identified as the proposed POD/POA
OK	<ul style="list-style-type: none"> • Land Use form, <i>if applicable</i>. (Page 10) May be needed if the POD/POA or POU is moving a great distance <u>and</u> off of land originally involved in permit.
	<ul style="list-style-type: none"> • Signature(s) of applicant(s): (Page 11) <u>All</u> applicants listed on page 1 of the application <u>must</u> sign the application.

WRD Completeness Reviewer's Name: S. Henderson Date: 6.28.07



Oregon

Theodore R. Kulongoski, Governor

Water Resources Department
North Mall Office Building
725 Summer Street NE, Suite A
Salem, OR 97301-1266
503-986-0900
FAX 503-986-0904

July 2, 2007

HOLLY BURGESS
DRISCOLL STRAWBERRY ASSOCIATION
PO BOX 50045
WATSONVILLE CA 96002

Reference: Permit Amendment T- 10419

On June 27, 2007 we received your request for permit amendment. The application was accompanied by \$350.00. Our receipt 88366 is enclosed.

By copy of this letter, we are asking the Watermaster for a report regarding the potential for injury to existing water rights which may be caused by the change.

Except as provided under ORS 540.510(3) for municipalities, you may not use water in the new place of use, or from the new point of appropriation, until we issue a final order approving the application.

We will notify you if additional information or corrections to the application or map are required.

If you have any questions, please call the Transfer Section, (503)986-0900.

cc: Watermaster #17
David Newton, Agent
Klamath Irrigation District Headquarters
Groundwater
Bureau of Reclamation
William Ganong, Attorney
Klamath County Clerks Office

enclosure



Oregon

Theodore R. Kulongoski, Governor

Water Resources Department

725 Summer Street NE, Suite A

Salem, OR 97301-1271

503-986-0900

FAX 503-986-0904

**Notice of Application for
Water Right Transfer, Temporary Transfer, or Permit Amendment
07/03/2007**

The Department seeks comment on the recently-filed application listed below. Any person may comment on the application. Comments must be received by the Department within 30 days of the date of this notice. The Director may presume that the transfer would be allowed by, and compatible with comprehensive plans unless an affected local government informs the Director otherwise within 30 days of this notice.

County: Klamath
Transfer: T -10419
Water Right: Permit:G 15347 *
Priority Date: 2002
Name: HOLLY BURGESS, DRISCOLL STRAWBERRY ASSOC
Address: PO BOX 50045 WATSONVILLE CA 96002
Change: POA
Source: A WELL > LOST RIVER
Authorized POA: T41S R11E 9
Proposed POA: T41S R11E 9

The holder of a water right may apply to permanently change an existing water use subject to transfer. A transfer application may involve any of the following changes: Point of diversion or appropriation (POD; POA); Additional point of diversion or appropriation (APOD; APOA); Historic POD (HIST); Place of use (POU); Character of use (USE); Instream (ISWR); Substitution (SUB); or Exchange (EXCH).

The holder of a water right subject to transfer may request to temporarily change the place of use of the water for up to 5 years and, if necessary to convey the water, to temporarily change the point of diversion or appropriation.

The holder of a water right permit may apply to change a point of diversion (POD) or appropriation (POA) or to change the place of use (POU).

Any person who provides comments within the comment period will receive a copy of the Department's preliminary determination of whether the application should be approved or rejected after the Department has completed a review of the application and will be provided an opportunity to protest the application and preliminary determination at that time. Comments should be sent to the Transfers Section at the Department's Salem office.

Oregon State Bar
Number 78213

WILLIAM M. GANONG
ATTORNEY AT LAW
514 WALNUT AVENUE
KLAMATH FALLS, OREGON 97601

(541) 882-7228
Fax: (541) 883-1923

June 25, 2007

Oregon Water Resources Department
725 Summer Street, NE, Suite A
Salem OR 97301-1266

Re: Permit Amendment for Ground Water Registration

Greetings:

Please find enclosed a completed and executed Permit Amendment or Ground Water Registration Modification, the Klamath County Planning Department's Land Use Information Form, and Driscoll Strawberry Associates, Inc.'s check to the Oregon Water Resources Department for \$350.

Please file and process this application.

Sincerely,



William M. Ganong

WMG:wy

Enclosures

Copy: James Newton

T 10419

RECEIVED

JUN 27 2007

**WATER RESOURCES DEPT
SALEM, OREGON**



Oregon Water Resources
725 Summer Street NE, Suite 100
Salem Oregon 97301-1266
(503) 986-0900
www.wrd.state.or.us

Originals

Application for Permit Amendment or Ground Water Registration Modification

Please type or print legibly in dark ink. If your application is incomplete or inaccurate, we will return it to you. If any requested information does not apply to your application, insert "N/A" to indicate Not Applicable. As you complete this form, please refer to notes and guidance included on the application. A summary of review criteria and procedures that are generally applicable to these applications is available at www.wrd.state.or.us/OWRD/PUBS/forms.shtml.

1. TYPE OF APPLICATION

Please check one of the following:

Permit Amendment
 Ground Water Registration Modification

2. APPLICANT INFORMATION

Name: Driscoll Strawberry Association, Inc., Contact: Holly Burgess, Nursery Dept. Mgr.
First Last

Address: P.O. Box 50045 (345 Westridge Dr.)

Watsonville California 95077-5045
City State Zip

Phone: (530) 221-6258
Home Work Other

Fax: (530) 221-2582 E-Mail address: holly.burgess@Driscolls.com

3. AGENT INFORMATION

(The agent listed is authorized to represent the applicant in all matters relating to this application.)

Name: David J. Newton
First Last

Address: 521 SW 6th Street, Suite 100

Redmond Oregon 97756
City State Zip

Phone: 541 504-9960 x211 541 325-3905 (cell)
Home Work Other

Fax: 541 504-9961 E-Mail address: dnewton@newtonconsultants.com

RECEIVED

JUN 27 2007

WATER RESOURCES DEPT
SALEM, OREGON

- If an agent is listed above, please check one of the following:
 - Please send all correspondence to Agent. Send *copies* of correspondence to Applicant; **or**
 - Please send all correspondence to Applicant. Send *copies* of correspondence to Agent.

Permit Amendments

- *If you propose to amend multiple permits under this application, a separate set of pages 3 through 7 must be provided for each permit. (NOTE: Concurrent changes to a water right must be filed separately on a transfer application.)*

Ground Water Registration Modifications

- *You may propose modification of only one ground water registration per application, unless in accordance with OAR 690-382-0300(2), the ground water registrations to be modified are layered. (NOTE: Concurrent changes to a water right must be filed separately on a transfer application.)*

4. TYPE OF AMENDMENT OR MODIFICATION PROPOSED

Please check **all** of the following that apply:

Point of Diversion or Appropriation	Place of Use	Character of Use
<p><input checked="" type="checkbox"/> Change (The old point of diversion or appropriation will not be used for the portion of the water right affected by the amendment or modification.)</p> <p><input type="checkbox"/> Additional (Both the old and new points of diversion or appropriation will be used for the portion of the water right affected by the amendment or modification.)</p> <p style="text-align: center;"><i>Not Available for <u>Ground Water Registrations</u></i></p> <p><input type="checkbox"/> Surface Water to Ground Water (A new point of appropriation will be used instead of the old point of diversion. The old point of diversion will not be used.)</p>	<p><input type="checkbox"/> All of the Permit or Registration will be exercised at a different location than currently authorized (Use of water at the current authorized location will be discontinued.)</p> <p><input type="checkbox"/> Only a portion of the Permit or Registration will be exercised at a different location than currently authorized (Use of water at a <u>portion</u> of the current authorized location will be discontinued.)</p>	<p style="text-align: center;"><i>Not Available for <u>Permit Amendments</u></i></p> <p>Change existing authorized use to the following proposed <u>new</u> use:</p> <p><input type="checkbox"/> Irrigation</p> <p><input type="checkbox"/> Municipal</p> <p><input type="checkbox"/> Quasi-municipal</p> <p><input type="checkbox"/> Commercial</p> <p><input type="checkbox"/> Industrial</p> <p><input type="checkbox"/> Domestic (indicate number of households): _____</p> <p><input type="checkbox"/> Other _____</p> <p style="text-align: right; color: blue; font-weight: bold; font-size: 1.2em;">RECEIVED</p> <p style="text-align: right; color: blue; font-weight: bold; font-size: 1.2em;">JUN 27 2007</p> <p style="text-align: right; color: blue; font-weight: bold; font-size: 0.8em;">WATER RESOURCES DEPT SALEM, OREGON</p>

- Reason(s) for amendment/modification(s) : Well location for Well #2 on Permit G-15347 resulted in a poor producing well. Well driller drilled a successful alternate well site in the target basalt aquifer approximately 800 feet east of the Authorized Point of Appropriation for Well #2.

5. CURRENT PERMIT OR REGISTRATION INFORMATION

Permit or Registration to be Amended/Modified (*check and complete one of the following*):

<input checked="" type="checkbox"/> Permit to be Amended:	<u>G-15347</u> Permit Number	<u>October 1, 2007</u> Current Completion Date of Permit
<input type="checkbox"/> Ground Water Registration to be Modified:	_____ Ground Water Registration Number	<i>NOTE: Concurrent changes to a water right must be filed separately on a transfer application.</i>

- Name on Permit or Registration: Driscoll Strawberry Association, Inc.
- County: Klamath
- Authorized Use(s) to be affected by this Amendment/Modification: Allow use of west Well (#3) to replace Well #2 as Authorized Point of Appropriation
- Priority Date(s): June 24, 2002
If there are multiple Priority Dates identified on the Permit or Registration, any information provided on pages 4 through 7 must identify which priority date is associated with each of the authorized and proposed points of diversion or appropriation and places of use.
- All Source(s) of Water to be affected by this Amendment/Modification: Location of Well #2 to be replaced by location of West Well (Well#3)

Tributary to: Lost River Basin

If there are multiple Sources listed on the Permit or Registration, any information provided on pages 4 through 7 must identify which source is associated with each of the authorized and proposed points of diversion or appropriation and places of use.

For an application proposing a Change in Place of Use or Character of Use:

- Are there any other “Layered” Water Rights, Permits, or Ground Water Registrations issued for **Irrigation** purposes that are appurtenant to the same place of use as the Permit or Registration being Amended/Modified? Yes No N/A -No Change in Use or Place of Use

If “Yes”, pursuant to ORS 540.510, OAR 690-380-2240 and OAR 690-382-0200, the other “layered” water uses subject to transfer **must either change concurrently or be cancelled**, except as provided in OAR 690-380-2240(5).

- Remarks: N/A

RECEIVED

JUN 27 2007

**WATER RESOURCES DEPT
SALEM, OREGON**

1 10419

- The following information **must be provided** only for those points of diversion or appropriation that are involved in the permit amendment or ground water registration modification (i.e., list only the portion of the permit/registration you propose to amend/modify.) Attach additional pages as necessary.

Government lot and donation land claim numbers must be included in the tables below **only** if the information is reflected on the existing permit or ground water registration.

Location of Existing Authorized Point(s) of Diversion or Appropriation to be Changed:

(i.e., the allowed point(s) of diversion/appropriation that will be affected by the proposed amendment/modification, the "FROM" point(s) of diversion/appropriation)

If Ground Water, OWRD Well Log ID No. (or Well ID Tag No. L-___)	Source and Priority Date	Township	Range	Mer	Sec	¼ ¼	Tax Lot, DLC or Gov't Lot	Survey Coordinates (coordinates from a recognized survey corner)
** KLAM 52796	Lost River Basin 6/24/02	41S	11E	WM	9	NE-NW	TL501	1,050ft North & 900ft West from North 1/16 corner Sec. 9

** See Attached Well Log for KLAM 52796

- Does the permit/registration being amended/modified involve a ground water source(s)?
 - Yes
 - No (Surface water source only.)

If "Yes", for each authorized point of appropriation (well) involved, you must either:

A. Supply a copy of the well log(s) for each point of appropriation that is **clearly labeled** and associated with the corresponding well in the table above and on the accompanying application map.

(NOTE: You may search for well logs on the Department's website at: www.wrd.state.or.us)

or

B. If a well log is **not** available, you must describe the construction of the authorized point of appropriation by completing the table below. Attach additional copies as necessary.

Construction of Existing Authorized Point(s) of Appropriation – (Only needed if no well log is available.)

Wells in this listing must be **clearly tied** to corresponding well location(s) described in the table above and shown on the accompanying application map.

OWRD Well No. as identified in table above	Diameter	Type and size of casing	No. of feet of casing	Intervals casing is perforated (in feet)	Seal depth	Est. depth to water	Est. depth to water bearing stratum	Type of access port or measuring device	Total well depth
**KLAM 52795									

** See Attached Well Log for KLAM 52795

RECEIVED
JUN 27 2007
WATER RESOURCES DEPT
SALEM, OREGON

T 10419

**6. PROPOSED PERMIT AMENDMENT OR REGISTRATION
MODIFICATION**

- Describe proposed changes to the permit or registration involving point(s) of diversion and/or appropriation. Survey coordinates described below should accurately correspond to the points shown on the accompanying application map. Attach additional pages as necessary.

Location of Proposed Point(s) of Diversion or Appropriation: (i.e., the "TO" point(s) of diversion/appropriation)
(NOTE: Complete this table only if a Change in Point of Diversion or Appropriation is being proposed.)

Source	Township	Range	Mer	Sec	¼ ¼ Section	Tax Lot, DLC or Gov't Lot	Survey Coordinates (coordinates from a recognized survey corner)
**Field Located	41S	11E	WM	9	NE NW	TL501	139 ft West, 90 ft South, of North ¼ Corner, Section 9

** See Attached Well Location Map. Figure 1

- If there are proposed point(s) of appropriation (wells) listed in the table above, are the well(s) already constructed? Yes No N/A - No proposed well(s) listed above.

If "Yes", attach and clearly label the corresponding well log(s) for each proposed well, or if well log(s) are not available, describe the construction of the well(s) using the table below.
(NOTE: You may search for well logs on the Department's website at: www.wrd.state.or.us)

If "No", describe the anticipated construction for the proposed well(s) in the following table:

Construction of Proposed Point(s) of Appropriation or Well(s):

Well numbers in this listing must be clearly tied to corresponding well location(s) described in the table above and shown on the accompanying application map.

Well already built? (Yes/No)	If an existing well, OWRD Well Log ID No. (or Well ID Tag No. L-___)	Diameter	Type and size of casing	No. of feet of casing	Intervals casing is perforated (in feet)	Seal depth	Est. depth to water	Est. depth to water bearing stratum	Type of access port or measuring device	Total well depth
Yes	** KLAM 52972	23" 0-627' 18.5" 627-720'	20" Diameter Steel 0.375" Wall	628'	Open Hole 627-720' bgs	0-50' 426- 627' bgs	45' bgs	641' bgs	Threaded Access Port	720' bgs
									RECEIVED	
									JUN 27 2007	

WATER RESOURCES DEPT
SALEM, OREGON

** See Attached Well Log for KLAM 52972. See Attached Ground Water Measurements.

- Describe

1 10419

7. AFFECTED DISTRICTS AND LOCAL GOVERNMENTS

- Are any of the Permit(s) or Registration(s) proposed for amendment/modification located within or served by an irrigation or other water district? Yes No
- Will any of the Permit(s) or Registration(s) be located within or served by an irrigation or other water district after the proposed amendment/modification? Yes No
- Is water for any of the Permit(s) or Registration(s) supplied under a water service agreement or other contract for stored water with a federal agency? Yes No

If "Yes", for any of the above, list the name and mailing address of the district and/or agency:

Klamath Irrigation District Headquarters	US Bureau of Reclamation
6640 KID Lane	6600 Washburn Way
Klamath Falls, OR. 97603	Klamath Falls, OR. 97603

- List the name and mailing address of all affected local governments (e.g., county, city, municipal corporation, and tribal governments within whose jurisdiction the right(s) are located).

Klamath County Clerk's Office
305 Main Street
Klamath Falls, OR. 97601

8. PERMIT HOLDER OF RECORD

This section is to be completed only for Permit Amendment applications.

N/A – This is a Ground Water Registration Modification application.

- Is the applicant the permit holder of record? Yes No

If "No", the applicant must either:

*A. Be assigned as a permit holder of record by submitting a completed **Request for Assignment** form and the required statutory fee for an assignment;*

or

*B. Submit an **Affidavit of Consent** from the permit holder of record that gives permission for the applicant to amend the permit.*

RECEIVED

JUN 27 2007

**WATER RESOURCES DEPT
SALEM, OREGON**

10. ATTACHMENTS

*Check each of the following attachments included with this application.
The application will be returned if all required attachments are not included.*

<p>Map:</p> <p><input checked="" type="checkbox"/> A map meeting the requirements of OAR 690-380-3100 must be included but need not be prepared by a Certified Water Right Examiner.</p> <p>Land Use Information Form:</p> <p><input checked="" type="checkbox"/> Enclosed; <i>or</i></p> <p><input type="checkbox"/> Not required if all of the following are met:</p> <ul style="list-style-type: none">❶ In EFU zone or irrigation district;❷ Change in place of use only;❸ No structural changes needed, including diversion works, delivery facilities, other structures; <i>and</i>❹ Irrigation only. <p>Water Well Reports/Well Logs:</p> <p><input checked="" type="checkbox"/> The application involves a change in point of appropriation or change from surface water to ground water and copies of all water well reports are attached.</p> <p><input type="checkbox"/> Water well reports are not available and a description of construction details including well depth, static water level, and information necessary to establish the ground water body developed or proposed to be developed is attached.</p> <p><input type="checkbox"/> N/A. The application does not involve a change in point of appropriation or a change from surface water to ground water, so water well reports are not required.</p>	<p>Fees:</p> <p><input checked="" type="checkbox"/> Amount enclosed: \$ <u>350.00</u></p> <p>See the Department's Fee Schedule at www.wrd.state.or.us/OWRD/PUBS/forms.shtml or call (503) 986-0900.</p> <p><u>For Permit Amendments Only...</u></p> <p>Request for Assignment:</p> <p><input type="checkbox"/> Enclosed. The applicant is NOT the permit holder of record and needs to be assigned to the permit; OR the landowner of the proposed place of use is NOT the permit holder of record and needs to be assigned to the permit. <i>The Request for Assignment form is available online at: www.wrd.state.or.us/OWRD/PUBS/forms.shtml ; or</i></p> <p><input checked="" type="checkbox"/> N/A. The applicant is the permit holder of record and owns or controls the proposed place of use; OR the applicant is not the permit holder of record but is supplying an Affidavit of Consent from the permit holder.</p> <p>Affidavit of Consent:</p> <p><input type="checkbox"/> Enclosed. Because the applicant is NOT the permit holder of record, an Affidavit of Consent is being supplied that gives permission for the applicant to amend the permit; or</p> <p><input checked="" type="checkbox"/> N/A. Not required because the applicant is the permit holder of record.</p>
---	---

RECEIVED

JUN 27 2007

WATER RESOURCES DEPT
SALEM, OREGON

T 10419

Before submitting your application to the Department, be sure you have:

- Answered each question completely.
- Included all the required attachments.
- Provided original signatures for all named deed holders, or other parties, with an interest in the water right.
- Included a check payable to the Oregon Water Resources Department for the appropriate amount.

11. SIGNATURES

- **For Ground Water Registration Modification Applications only, check the appropriate one and sign the application in the signature box below:**

N/A In accordance with OAR 690-382-0400(16)(a), I (we) understand that prior to Department approval of a permanent modification and upon my receipt of a draft Preliminary Determination for the proposed modification, I (we) will be required [pursuant to OAR 690-382-0700(5)] to provide the following landownership information and evidence demonstrating that I (we) are authorized to pursue the modification:

- (a) A report of ownership and lien information that has been prepared by a title company *within the last three months;*
- (b) A copy of written notification of the proposed modification provided by the applicant to all lien holders on the subject lands unless the report of ownership and lien information shows that a water right conveyance agreement has been recorded for the subject lands. *If a water right conveyance agreement has been recorded for the subject lands, a copy of the recorded agreement and a listing of the owner(s) of the lands at the time the agreement was recorded must be submitted; and*
- (c) If the applicant is not both the person named on the ground water registration or the assignee *and* the owner of the lands to which the registration is appurtenant, as identified in the report of ownership and lien information, then either of the following must be provided:
 - A) Notarized statements consenting to the modification by all persons, other than the applicant, who are named on the ground water registration or identified as landowners in the report of ownership and lien information or who are authorized representatives of an entity to whom the interest in the water right has been conveyed as identified in a water right conveyance agreement; or
 - B) Documentation demonstrating that the applicant is authorized to pursue the modification in the absence of consent of the persons named on the ground water registration or the assignee and the owner of the lands to which the registration is appurtenant.

N/A I (we) affirm that the applicant is a municipality, as defined in ORS 540.510(3)(b), and that the right is in the name of the municipality or a predecessor. Therefore, pursuant to OAR 690-382-0400(16)(b), the applicant is NOT required to provide the above described report of ownership and lien information.

N/A I (we) affirm that the applicant is an entity with the authority to condemn property and is acquiring the property to which the ground water registration proposed for modification is appurtenant by condemnation. Documentation is provided with this application supporting this statement. Therefore, pursuant to OAR 690-382-0400(16)(c), the applicant is NOT required to provide the above described report of ownership and lien information. (NOTE: Such an entity may only apply for recognition of a modification under this subsection if it has filed a condemnation action to acquire the property and deposited the funds with the court as required by ORS 35.265.)

- **For both Permit Amendment and Ground Water Registration Modification Applications, I (we) affirm that the information contained in this application is true and accurate.**

 applicant signature	<u>Don S. Roberts</u> name (print)	<u>6/7/07</u> date
_____ applicant signature	_____ name (print)	_____ date

RECEIVED

JUN 27 2007

**WATER RESOURCES DEPT
SALEM, OREGON**

1 10419

G:\1000\1040\102\01\Cad\Water\W104-0102_01_F1_WellLoc 15:29 03/08/2007 SS

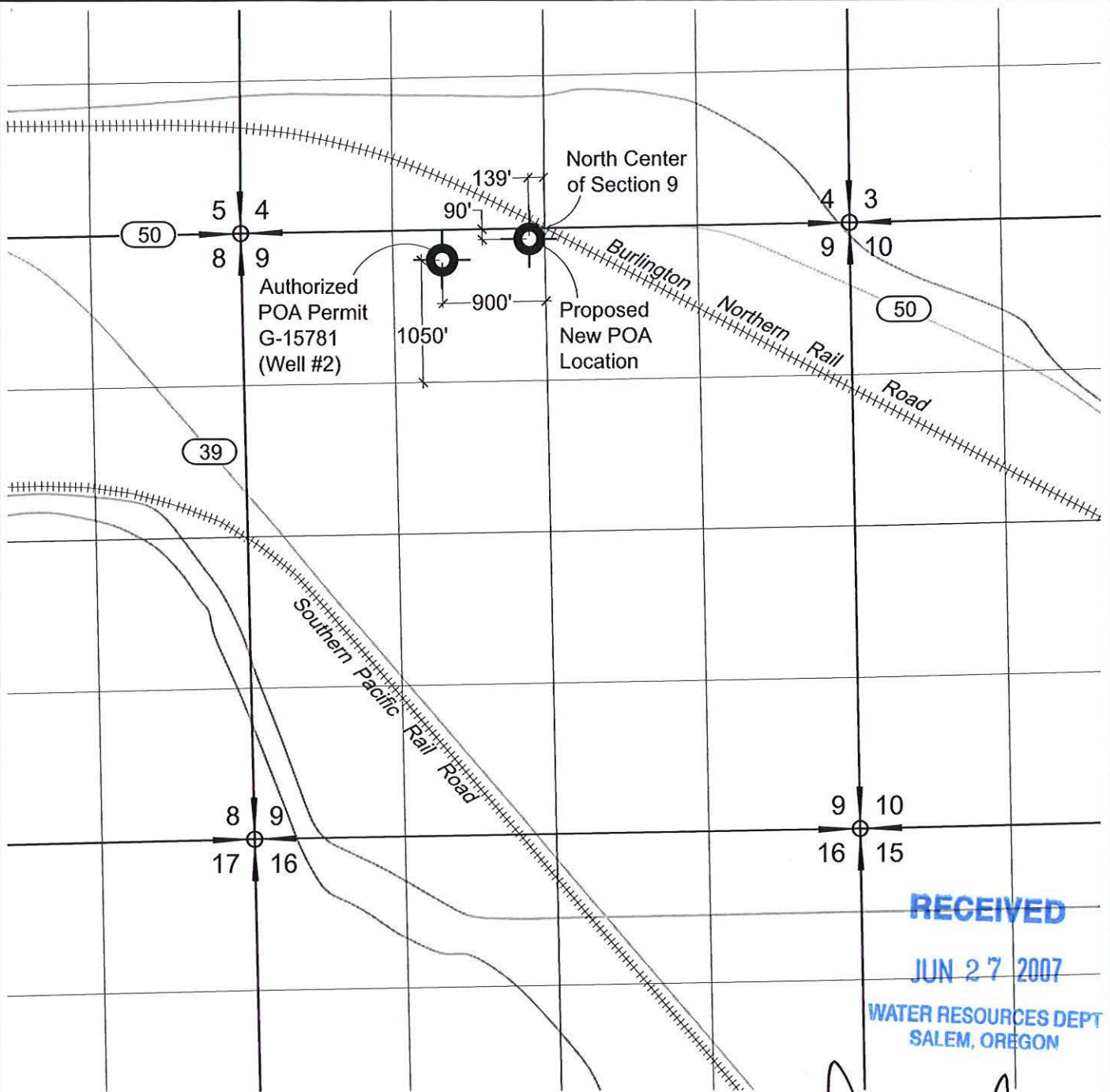

RECEIVED

JUN 27 2007

WATER RESOURCES DEPT
SALEM, OREGON

WATER TRANSFER MAP

Located in NE 1/4 NW 1/4
Section 9, T41S R11E, W.M.
Klamath County, Oregon

NOTES

1. This map was prepared for the purpose of identifying the location of water rights only and is not intended to provide legal dimensions or locations of property ownership lines.

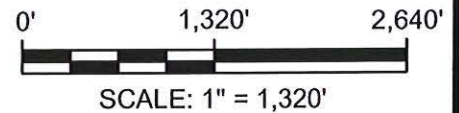
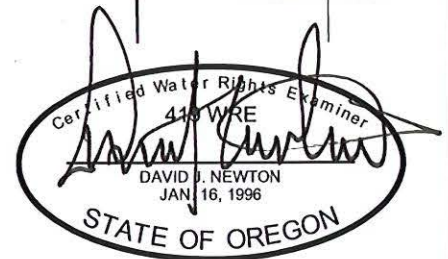

NEWTON
CONSULTANTS INC.
Earth, Water and Rock Specialists
Ph. 541 504-9669 Fax 541 504-9661

Permit Ammendment Application
Groundwater Permit G-15347
Klamath County, Oregon

DESIGNED BY: J. Newton	DRAWN BY: S. Schenck	DATE: March 2007	PROJECT NO. 1040-102-01	FIGURE 1
----------------------------------	--------------------------------	----------------------------	-----------------------------------	--------------------

STATE OF OREGON
WATER SUPPLY WELL REPORT

(as required by ORS 537.765)

(1) OWNER:

Name: Clary Orem
Address: 19980 Hwy 50
City: Merrill State: OR Zip: 97633

Well Number: 1

K-LAM
52795

WELL ID # L 50211
START CARD # 111253

(9) LOCATION OF WELL by legal description:

County: Klamath Latitude: _____ Longitude: _____
Township: 41S Range: 11E
Section: 8 SW $\frac{1}{4}$ SE $\frac{1}{4}$
Tax Lot: 1300 Lot: _____ Block: _____ Subdivision: _____
Street Address of Well (or nearest address):
19980 Hwy 50 Merrill OR

(10) STATIC WATER LEVEL:

40' Ft. below land surface Date 6/12/01
Artesian pressure --- lb. per sq. in. Date ---

(2) TYPE OF WORK: (repair/

New Well Deepening Alteration/recondition Abandonment

(3) DRILL METHOD:

Rotary Air Rotary Mud Cable Auger
 Other: _____

(4) PROPOSED USE:

Domestic Community Industrial Irrigation
 Thermal Injection Livestock Other _____

(5) BORE HOLE CONSTRUCTION:

Special Construction approval Yes No

Depth of Completed Well 288.6'

Explosives Used Yes No Type --- Amount ---

HOLE			SEAL			sacks or pounds
Diameter	From	To	Material	From	To	
24"	-50'	117'	Cement	50'	117'	150 Sacks
24"	0	50	Bent Chip	0	50	55 Sacks

How was seal placed: Method A B C D E

Other Bent Chips Poured Dry

Backfill placed from 50 to 90 Material Bent

from --- to --- Material ---

Gravel placed from --- to --- Size of gravel ---

(6) CASING/LINER:

CASING:

Diameter	From	To	Gauge	Steel	Plastic	Welded	Threaded
20"	-1'	117'	.375	<input checked="" type="checkbox"/>	<input type="checkbox"/>	<input checked="" type="checkbox"/>	<input type="checkbox"/>

LINER:

Diameter	From	To	Steel	Plastic	Welded	Threaded
			<input type="checkbox"/>	<input type="checkbox"/>	<input type="checkbox"/>	<input type="checkbox"/>

Final location of Shoe(s): _____

(7) PERFORATIONS/SCREENS:

Perforations Method: _____

Screen Type: _____ Material: _____

Front	To	Slot Size	No.	Diameter	Tele/pipe size	Casing	Liner
						<input type="checkbox"/>	<input type="checkbox"/>

(8) WELL TESTS: Minimum testing time is 1 hour

Pump Bailor Air Flowing Artesian

Yield gpm	Drawdown	Drill Stem at	Time
3000+		287	1 hr.
3800	2		8 hrs

Temperature of water 58 Depth Artesian Flow Found ---

Was a water analysis done? --- By whom: ---

Did any strata contain water not suitable for intended use? (explain)

Depth of Strata: ---

(11) WATER BEARING ZONES:

From	To	Est. Flow Rate	SWL
155	175	1000+	40
250	280	2000+	40

(12) WELL LOG:

Material	Ground Elevation:		SWL
	From	To	
Soil Sandy	0	2	
Sand Dirt Dry	2	11	
Silty Sand Brown	11	33	
Sand Black & Gray	33	40	
Clay Sticky Blue	40	66	
Sand Brown Gray (120)	66	71	
Clay Green Gray	71	89	
Clay Gray Sticky	89	107	
Basalt Black Hard	107	145	
Basalt Red & Blue Soft	145	150	
Basalt Gray Slightly Decomposed	150	157	
Basalt Gray Hard w/Brown Fractures	157	186	
Basalt Red & Blue Decomposed Med	186	246	
Cinders Red Soft	246	280	
Cinders Dark Red - Brown	280	284	
Basalt Blue - Gray w/Slight Red	284	288.6	

RECEIVED

RECEIVED

JUL 11 2001

AUG 17 2001

WATER RESOURCES DEPT. SALEM, OREGON

Date Started: 6/1/01 Completed: 6/11/01

(unbonded) Water Well Constructor Certification:

I certify that the work performed on the construction, alteration, or abandonment of this well is in compliance with Oregon water supply well construction standards. Materials used and information reported above are true to the best of my knowledge and belief.

Signed _____ WWC Number 723
Date 7/6/01

(bonded) Water Well Constructor Certification:

I accept responsibility for the construction, alteration, or abandonment work performed on this well during the construction dates reported above. All work performed during this time is in compliance with Oregon water supply well construction standards. This report is true to the best of my knowledge and belief.

Signed _____ WWC Number 723
Date 7/6/01

ORIGINAL & FIRST COPY - Water Resources Department SECOND COPY - Constructor THIRD COPY - Customer

T 10419

JUN 27 2007

WATER RESOURCES DEPT
SALEM, OREGON

**STATE OF OREGON
WATER SUPPLY WELL REPORT**

(as required by ORS 537.765)

(1) OWNER:

Well Number: 2
Name: Gary Orem
Address: 19980 Hwy 50
City: Merrill State: OR Zip: 97633

(2) TYPE OF WORK: (repair/
 New Well Deepening Alteration/recondition Abandonment

(3) DRILL METHOD:
 Rotary Air Rotary Mud Cable Auger
 Other: _____

(4) PROPOSED USE:
 Domestic Community Industrial Irrigation
 Thermal Injection Livestock Other _____

(5) BORE HOLE CONSTRUCTION:
Special Construction approval Yes No
Depth of Completed Well ---
Explosives Used Yes No Type --- Amount ---

HOLE			SEAL			sacks or pounds
Diameter	From	To	Material	From	To	
15"	0	464	---	---	---	---
15"	0	464	Bent Chip	0	464	410 Bags

How was seal placed: Method A B C D E
 Other Bent Chips Poured Dry
Backfill placed from --- to --- Material ---
from --- to --- Material ---
Gravel placed from --- to --- Size of gravel ---

(6) CASING/LINER:

CASING:

Diameter	From	To	Gauge	Steel	Plastic	Welded	Threaded
				<input type="checkbox"/>	<input type="checkbox"/>	<input type="checkbox"/>	<input type="checkbox"/>
				<input type="checkbox"/>	<input type="checkbox"/>	<input type="checkbox"/>	<input type="checkbox"/>
				<input type="checkbox"/>	<input type="checkbox"/>	<input type="checkbox"/>	<input type="checkbox"/>

LINER:

Diameter	From	To	Gauge	Steel	Plastic	Welded	Threaded
				<input type="checkbox"/>	<input type="checkbox"/>	<input type="checkbox"/>	<input type="checkbox"/>
				<input type="checkbox"/>	<input type="checkbox"/>	<input type="checkbox"/>	<input type="checkbox"/>

Final location of Shoe(s): _____

(7) PERFORATIONS/SCREENS:

Perforations Method: _____
 Screen Type: _____ Material: _____
Slot Size: _____ Tele/pipe size: _____

From	To	Size	No.	Diameter	Tele/pipe size	Casing	Liner
						<input type="checkbox"/>	<input type="checkbox"/>
						<input type="checkbox"/>	<input type="checkbox"/>
						<input type="checkbox"/>	<input type="checkbox"/>
						<input type="checkbox"/>	<input type="checkbox"/>

(8) WELL TESTS: Minimum testing time is 1 hour
 Pump Bailer Air Flowing Artesian
Yield gpm Drawdown Drill Stem at Time

Yield gpm	Drawdown	Drill Stem at	Time
			1 hr.

Temperature of water --- Depth Artesian Flow Found ---
Was a water analysis done? --- By whom: ---
Did any strata contain water not suitable for intended use? (explain) ---
Depth of Strata: ---

(9) LOCATION OF WELL by legal description:
County: Klamath Latitude: _____ Longitude: _____
Township: 41S Range: 11E
Section: 8 SW $\frac{1}{4}$ SE $\frac{1}{4}$
Tax Lot: 1300 Lot: _____ Block: _____ Subdivision: _____
Street Address of Well (or nearest address) _____
19980 Hwy 50 Merrill OR

(10) STATIC WATER LEVEL:
--- Ft. below land surface Date 6/14/01
Artesian pressure --- lb. per sq. in. Date ---

(11) WATER BEARING ZONES:
Depth at which water was first found

From	To	Est. Flow Rate	SWL
			ABANDONED

(12) WELL LOG: Ground Elevation: _____

Material	From	To	SWL
Top Soil	0	3	
Sand Pumus	3	46	
Sandstone	46	62	
Claystone Blue	62	96	
Clay Brown Sticky	96	132	
Clay Brown	132	250	
Clay Blue	250	270	
Sandstone Siltstone Gray	270	280	
Clay Blue	280	390	
Sand Black Coarse	390	400	
Clay Blue Gray	400	464	

RECEIVED **RECEIVED**
JUL 11 2001 JUN 27 2007
WATER RESOURCES DEPT. SALEM, OREGON WATER RESOURCES DEPT. SALEM, OREGON

Date Started: 6/11/01 Completed: 6/14/01

(unbonded) Water Well Constructor Certification:
I certify that the work I performed on the construction, alteration,, or abandonment of this well is in compliance with Oregon water supply well construction standards. Materials used and information reported above are true to the best of my knowledge and belief.
Signed Steven McGuire WWC Number 1224
Date 7/6/01

(bonded) Water Well Constructor Certification:
I accept responsibility for the construction, alteration, or abandonment work performed on this well during the construction dates reported above. All work performed during this time is in compliance with Oregon water supply well construction standards. This report is true to the best of my knowledge and belief.
Signed [Signature] WWC Number 723
Date 7/6/01

GW Water Level Input - Standard

Logid KLAM 52972 Well Tag Log _____ Csg Diam Field _____ TRS 41.00 S / 11.00 E - 09 BAA
 State Obs Well _____ Well Tag Field _____ Max Depth _____ County _____ KLAM
 Use IRRIGATION
 Owner Well Name WELL #3 Lsd Elev 4070 LsdAccuracy 10
 Owner GARY OREM Ph Home _____
 Contact _____ Call Before Visit Ph Work _____
 Owner _____ Ph Cell _____
 Comments _____ FAX _____
 Cail First Phone _____
 Well Address South side of Merril Malin Highway next to Railroad overpass.

Sow Num	Logid	Source Org	SourceOWRD	Date	Time	MP Hght	Reprtd Wtr Lvl	Verified WL BLS	Export WL BLS	Method
	KLAM	52972	OWRD	GWATER	05/04/2005	18:17	1.00	56.06	56.06	ETAPE
	KLAM	52972	OWRD	GWATER	04/12/2006	17:44	1.00	58.18	58.18	STEEL TAPE

Gail mentioned that Gary had been taking static well measurements on this well!!

I 10419

Jun 09 06 03:04 P
06/05/2006 13:08
541-388-5101

WTR RESOURCES DIVISOR

PAGE 3/3
P. 3

RECEIVED

JUN 27 2007

WATER RESOURCES DEPT
SALEM, OREGON

T41S R11E

1" - 1270'

Well 1 - 400' N & 300' W from SE corner, NESW, section 10

Well 2 - 1050' N & 900' W from SE corner, NENW, section 9

M. Rohring

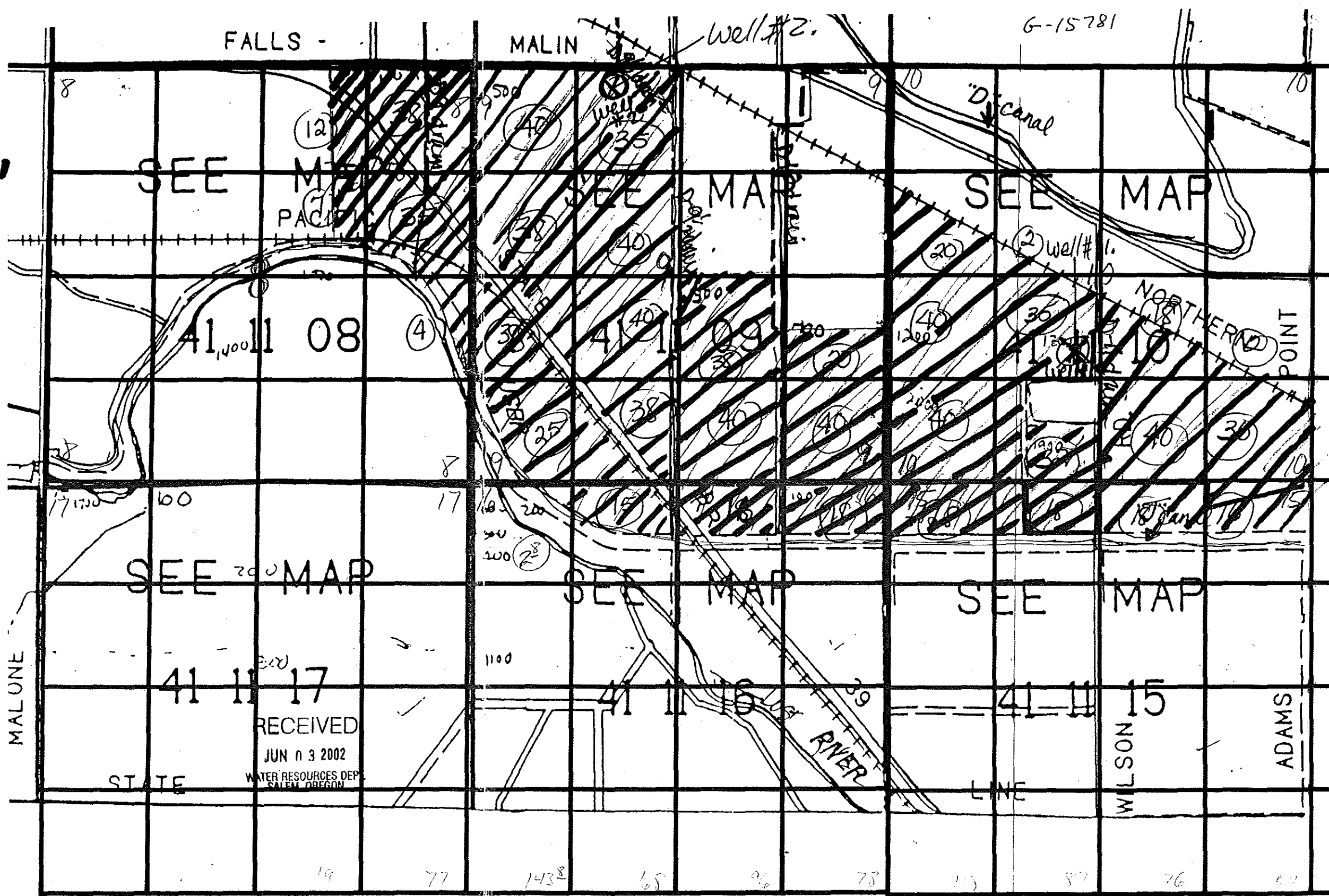

RECEIVED
 JUN 24 2002
 WATER RESOURCES DEPT.
 SALEM, OREGON

Approximate
 Location of
 Wells #1, #2.

WELL #1 - 300' WEST 400' NORTH OF THE CENTER SECTION OF 41 South, 11 East, OF THE NE 1/4 SW 1/4 OF SECTION 10.

WELL #2 - 900' WEST 1050' NORTH OF THE CENTER SECTION OF 41 South, 11 East, OF THE NE 1/4 NW 1/4 OF SECTION 9.

T41S R11E

(Well 1 - 400 ft N & 300 ft W from the S 1/4 corner)
 (Well 2 - 1050 ft N & 900 ft W from the N 1/4 corner)

9/6.8 AC

T41S R11E

1" = 1320'



RECEIVED

JUN 24 2002

WATER RESOURCES DEPT.
SALEM, OREGON

Approximate
Location of
Wells #1, #2.

App # 6-15781
Permit # 6-15347

T41S R11E

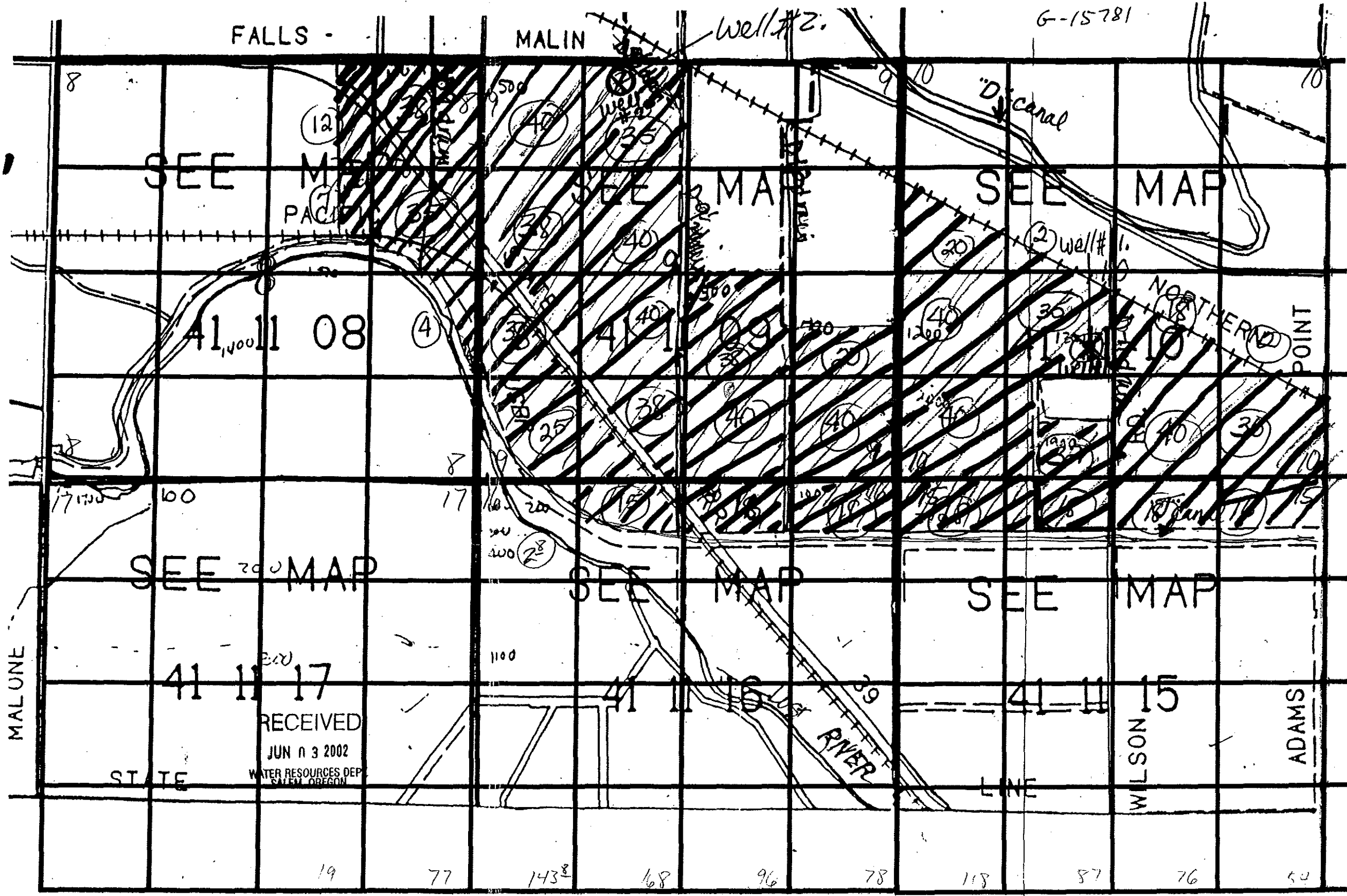

(Well 1 - 400 FT N & 300 FT W FROM THE S 1/4TH CORNER)
(Well 2 - 1050 FT N & 900 FT W FROM THE N 1/4TH CORNER)

916.8 AC

FALLS -

MALIN

SEE MAP
PACIFIC

SEE MAP

SEE MAP

41 11 08

41 11 09

41 11 10

RECEIVED
JUN 24 2002
WATER RESOURCES DEPT.
SALEM, OREGON

SEE MAP

SEE MAP

SEE MAP

41 11 17

41 11 16

41 11 15

RECEIVED
JUN 23 2002
WATER RESOURCES DEPT.
SALEM, OREGON

STATE

LINE

WILSON

ADAMS

G-15781

MALONE

Drum

Well #2

D Canal

STATE

USBR

Drum

Drum

NORTHERN

POINT

Drum RD.

J Canal

RIVER