

T-10423

DISTRICT TEMP

Name Echo Irrigation District
Contact: Bill Porfily
Address P.O. Box 110
Hermiston, OR 97838
541-449-1327

Change in POA & POA
Date Filed _____
Initial notice date _____
DPD issued date _____
PD issued date _____
PD notice date _____
Date of FO 8-1-07 Vol 73 Page 31

C-Date _____
COBU due date _____
COBU Received date _____
Certificate issued _____

DESCRIPTION OF WATER RIGHT(S)

Name of Stream Wells
Trib. of Stage Gulch, Umatilla River
Use IR County Umatilla
Quantity of water (CFS) _____ No. of Acres _____
Name of ditch _____
App # G5541 Per # G-4969 Cert # 80851 PR Date 1971
App # G-7195 Per # G-6626 Cert # 80849 PR Date 1975
App # G-5998 Per # G-5215 Cert # 80850 PR Date 1973
App # _____ Per # _____ Cert # _____ PR Date _____
App # _____ Per # _____ Cert # _____ PR Date _____

Rick, Robert + Douglas Hale
Kennith Coppinger
H4 Farms: Rick Hale

FEES PAID		
Date	Amount	Receipt #
<u>6-28-07</u>	<u>281.00</u>	<u>88397</u>
<u>7-2-07</u>	<u>24.07</u>	<u>88473</u>

FEES REFUNDED		
Date	Amount	Receipt#
<u>8/9/07</u>	<u>25.02</u>	<u>88397</u>

Assignments: _____

REC'D JUL 09 2007

Irrigation District _____

Agent _____

CWRE _____

CC's list _____

- Oversized map - Location

Keep w/ T-10424

T. 3N.,
 R. 29E.,
 W. M.

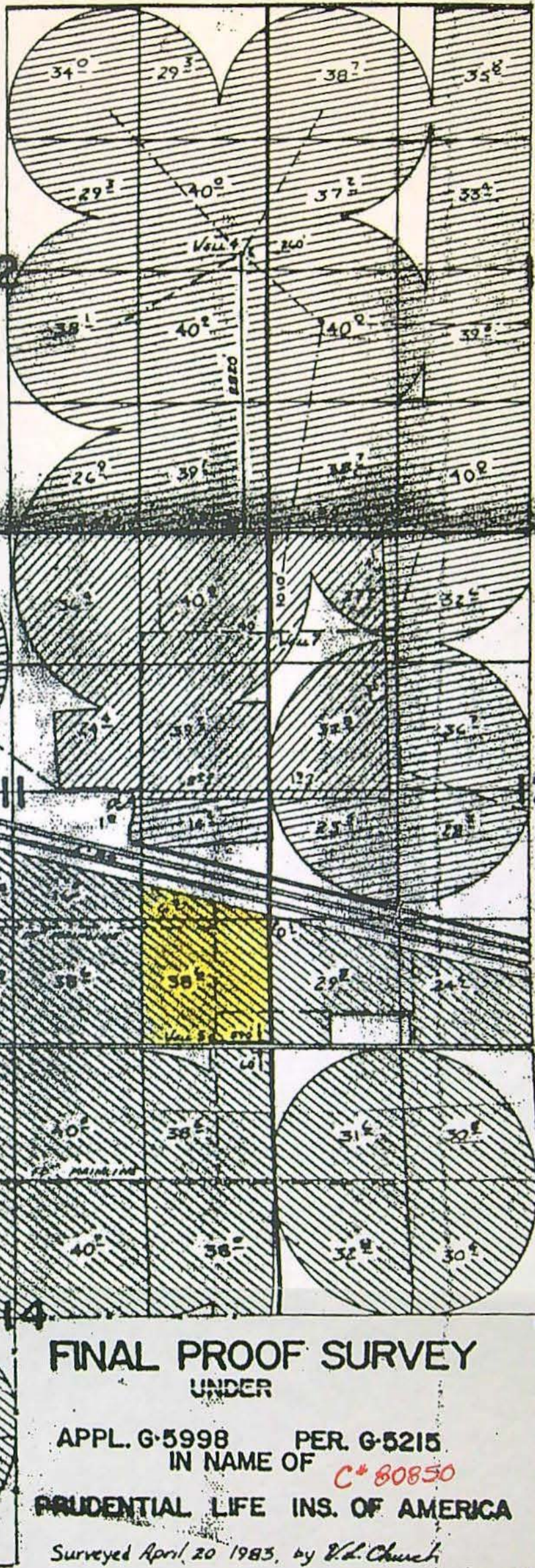

FINAL PROOF SURVEY
 UNDER

APPL. G-5998 PER. G-5215
 IN NAME OF *C# 80850*

PRUDENTIAL LIFE INS. OF AMERICA

Surveyed April 20 1985, by *V.L. Church*

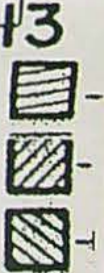

**STATE OF OREGON
WATER RESOURCES DEPARTMENT**

725 Summer St. N.E. Ste. A
SALEM, OR 97301-4172

(503) 986-0900 / (503) 986-0904 (fax)

RECEIPT # **88397**

INVOICE # _____

RECEIVED FROM: <u>Hale Farms, L.L.C.</u>	APPLICATION
BY: _____	PERMIT
CASH: <input type="checkbox"/> CHECK:# _____ OTHER: (IDENTIFY) _____	TRANSFER <u>T-10423</u>
<input checked="" type="checkbox"/> <u>10168</u> <input type="checkbox"/>	TOTAL REC'D \$ <u>281.00</u>

1083 TREASURY	4170 WRD MISC CASH ACCT
0407 COPIES	\$ _____
OTHER: (IDENTIFY) _____	\$ _____
0243 I/S Lease _____	0244 Muni Water Mgmt. Plan _____
0245 Cons. Water _____	

4270 WRD OPERATING ACCT	
MISCELLANEOUS	<u>PCA 46111</u>
0407 COPY & TAPE FEES	\$ _____
0410 RESEARCH FEES	\$ _____
0408 MISC REVENUE: (IDENTIFY) _____	\$ _____
TC162 DEPOSIT LIAB. (IDENTIFY) _____	\$ _____
0240 EXTENSION OF TIME	\$ _____
WATER RIGHTS:	EXAM FEE
0201 SURFACE WATER	\$ _____ 0202
0203 GROUND WATER	\$ _____ 0204
0205 TRANSFER	\$ <u>281.00</u>
WELL CONSTRUCTION	EXAM FEE
0218 WELL DRILL CONSTRUCTOR	\$ _____ 0219
LANDOWNER'S PERMIT	\$ _____ 0220
OTHER (IDENTIFY) _____	

0536 TREASURY	0437 WELL CONST. START FEE
0211 WELL CONST START FEE	\$ _____
0210 MONITORING WELLS	\$ _____
OTHER (IDENTIFY) _____	

0607 TREASURY	0467 HYDRO ACTIVITY	LIC NUMBER
0233 POWER LICENSE FEE (FW/WRD)		\$ _____
0231 HYDRO LICENSE FEE (FW/WRD)		\$ _____
HYDRO APPLICATION		\$ _____

TREASURY	OTHER / RDX
FUND _____	TITLE _____
OBJ. CODE _____	VENDOR # _____
DESCRIPTION _____	\$ _____

RECEIPT: **88397** DATED: 6/28/07 BY: Diana Duchin

Distribution - White Copy - Customer, Yellow Copy - Fiscal, Blue Copy - File, Buff Copy - Fiscal

**STATE OF OREGON
WATER RESOURCES DEPARTMENT**

725 Summer St. N.E. Ste. A
SALEM, OR 97301-4172
(503) 986-0900 / (503) 986-0904 (fax)

RECEIPT # **88473**

INVOICE # _____

RECEIVED FROM: Pacific Water Rights Consulting
BY: _____

APPLICATION	
PERMIT	T-10424
TRANSFER	T-10423

CASH: CHECK:# 3326 OTHER: (IDENTIFY) _____

TOTAL REC'D \$ 45.07

1083 TREASURY 4170 WRD MISC CASH ACCT

0407 COPIES \$ _____
OTHER: (IDENTIFY) \$ _____
0243 I/S Lease _____ 0244 Muni Water Mgmt. Plan _____ 0245 Cons. Water _____

4270 WRD OPERATING ACCT

MISCELLANEOUS
0407 COPY & TAPE FEES \$ _____
0410 RESEARCH FEES \$ _____
0408 MISC REVENUE: (IDENTIFY) \$ _____
TC162 DEPOSIT LIAB. (IDENTIFY) \$ _____
0240 EXTENSION OF TIME \$ _____

**T-10423-24.07
T-10424-21.50
RECEIVED
OVER THE COUNTER**

WATER RIGHTS:		EXAM FEE	RECORD FEE	
0201	SURFACE WATER	\$ _____	0202	\$ _____
0203	GROUND WATER	\$ _____	0204	\$ _____
0205	TRANSFER	\$ <u>45.07</u>		
WELL CONSTRUCTION		EXAM FEE	LICENSE FEE	
0218	WELL DRILL CONSTRUCTOR	\$ _____	0219	\$ _____
	LANDOWNER'S PERMIT		0220	\$ _____
	OTHER (IDENTIFY)			

0536 TREASURY 0437 WELL CONST. START FEE

0211 WELL CONST START FEE \$ _____ CARD # _____
0210 MONITORING WELLS \$ _____ CARD # _____
OTHER (IDENTIFY) _____

0607 TREASURY 0467 HYDRO ACTIVITY LIC NUMBER

0233 POWER LICENSE FEE (FWWRD) \$ _____
0231 HYDRO LICENSE FEE (FWWRD) \$ _____
HYDRO APPLICATION \$ _____

TREASURY OTHER / RDX

FUND _____ TITLE _____
OBJ. CODE _____ VENDOR # _____
DESCRIPTION _____ \$ _____

RECEIPT: **88473** DATED: 7-207 BY: J. Passolunghi

Distribution - White Copy - Customer, Yellow Copy - Fiscal, Blue Copy - File, Buff Copy - Fiscal



Oregon

Theodore R. Kulongoski, Governor

Water Resources Department

North Mall Office Building
725 Summer Street NE, Suite A
Salem, OR 97301-1266
503-986-0900
FAX 503-986-0904

July 2, 2007

ECHO IRRIGATION DISTRICT
PO BOX 110
HERMISTON OR 97838

Reference: District Temporary Transfer 10423

On June 28, 2007 we received your district transfer application. The application was accompanied by \$281.00 and \$24.07. Our receipts 88397 and 88473 are enclosed.

By copy of this letter, we are asking the Watermaster for a report regarding the potential for injury to existing water rights which may be caused by the change.

The district may begin delivering water to the proposed place of use immediately provided that water has not been delivered to the existing, authorized place of use during this season. Pursuant to OAR 690-385-3000(4), the district and water user may be subject to civil penalties and the loss of use of the water if deliveries are made to both the existing and proposed places of use during any one season.

We will notify you if additional information or corrections to the application or map are required.

If you have any questions, please call the Transfer Section, (503)986-0900.

cc: Watermaster #5

enclosure



Oregon

Theodore R. Kulongoski, Governor

Water Resources Department

725 Summer Street NE, Suite A

Salem, OR 97301-1271

503-986-0900

FAX 503-986-0904

Notice of Application for Water Right Transfer, Temporary Transfer, or Permit Amendment 07/03/2007

The Department seeks comment on the recently-filed application listed below. Any person may comment on the application. Comments must be received by the Department within 30 days of the date of this notice. The Director may presume that the transfer would be allowed by, and compatible with comprehensive plans unless an affected local government informs the Director otherwise within 30 days of this notice.

County: Umatilla
Transfer: T -10423
Water Right: Cert:80849 CF *, Cert:80851 RR *, Cert:80850 RR
Priority Date: 1971, 1975, 1973
Name: ECHO IRRIGATION DISTRICT
Address: PO BOX 110; HERMISTON OR 97838
Change: POU
Source: A WELL > STAGE GULCH
Authorized POU: T3N R30E 6,19
T3N R29E 11,12,14,24
Proposed POU: T3N R30E 8
T3N R29E 13,25

The holder of a water right may apply to permanently change an existing water use subject to transfer. A transfer application may involve any of the following changes: Point of diversion or appropriation (POD; POA); Additional point of diversion or appropriation (APOD; APOA); Historic POD (HIST); Place of use (POU); Character of use (USE); Instream (ISWR); Substitution (SUB); or Exchange (EXCH).

The holder of a water right subject to transfer may request to temporarily change the place of use of the water for up to 5 years and, if necessary to convey the water, to temporarily change the point of diversion or appropriation.

The holder of a water right permit may apply to change a point of diversion (POD) or appropriation (POA) or to change the place of use (POU).

Any person who provides comments within the comment period will receive a copy of the Department's preliminary determination of whether the application should be approved or rejected after the Department has completed a review of the application and will be provided an opportunity to protest the application and preliminary determination at that time. Comments should be sent to the Transfers Section at the Department's Salem office.

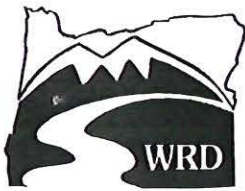

Oregon Water Resources Department
721 Summer Street NE, Suite A
Salem, OR 97301-1271

2007

OAR Chapter 690, Division 385
District Temporary Transfer Application
Duration: One Irrigation Season

COPY

District: Echo Irrigation District

Contact Person: Bill Porfily Phone: (541) 449-1327

Mailing Address: P.O. Box 110, Hermiston, Oregon 97838

I. Pursuant to ORS 540.570 and OAR Chapter 690, Division 385, the district proposes to change the place of use for the following water rights:

1st of 3 Primary Water Rights

WATER RIGHT			
PERMIT NUMBER	CERTIFICATE NUMBER	DECREE (name, volume, and page)	PRIMARY (P) or SUPP (S)
G-4969	80851	Robert C., Rick L., & Douglas L. Hale	P

II. The point(s) of diversion for the water right proposed for transfer are as follows:

POINT(S) OF DIVERSION / APPROPRIATION				
PERMIT	DECREE or CERTIFICATE	POD#	SOURCE	LOCATION - LEGAL DESCRIPTION
G-4969	80851	H-1	Hale's Well #1	4340' N & 1830' W from S1/4 Cor Sec 7, T3N, R30E WM
G-4969	80851	H-2	Hale's Well #2	2010' N & 1330' E from SW Cor Sec 6, T3N, R30E WM
G-4969	80851	H-3	Hale's Well #3	1420'S & 40' E from W1/4 Cor Sec 7, T3N, R30E WM
G-4969	80851	H-4	Hale's Well #4	180' N & 260' W from E1/4 Cor Sec 2, T3N, R29E WM
G-4969	80851	H-6	Hale's Well #6	132' N & 2190' W from E1/4 Cor Sec 11, T3N, R29E WM
G-4969	80851	H-7	Hale's Well #7	1010' S & 40' E from NW Cor Sec 12, T3N, R29 E WM

III. The district proposes to change the place of use from the authorized location listed in Table 1 to the location listed in Table 2.

T 10423

RECEIVED

JUN 28 2007

TABLE 1. – AUTHORIZED PLACE OF USE

WATER RIGHT		Primary PRIORITY DATE	USE	POD #	LEGAL DESCRIPTION							ACRES	USER NAME
Cert/Decree PRIMARY	Cert/Perm SUPP				TWP	RNG	SEC	QQ	DLC	GOV'T LOT	TAX LOT		
80851		6/8/71	Irr	H-1, H-2, H-3, H-4, H-6, & H-7,	3N	30 E WM	6	NE NW			703	30.0*	Hales Bros Farms
80851		6/8/71	Irr	H-1, H-2, H-3, H-4, H-6, & H-7,	3N	30 E WM	6	SE NW			703	36.31*	Hales Bros Farms
											Total	66.31	

*These areas are described in Permit G-8907. Permit G-8907 was allocated no water in the Stage Gulch Critical Groundwater Order, thus we will not describe or use this water right under this temporary transfer.

RECEIVED

JUN 28 2007

TABLE 2. – PROPOSED PLACE OF USE

WATER RIGHT		Primary PRIORITY DATE	USE	POD #	LEGAL DESCRIPTION							ACRES	USER NAME
Cert/Decree PRIMARY	Cert/Perm SUPP				TWP	RNG	SEC	QQ	DLC	GOV'T LOT	TAX LOT		
80851		6/8/71	Irr	H-1, H-2, H-3, H-4, H-6, & H-7,	3N	30 E WM	8	NE SW			802	6.31	Hales Bros Farms
80851		6/8/71	Irr	H-1, H-2, H-3, H-4, H-6, & H-7,	3N	30 E WM	8	NW SW			802	30.0	Hales Bros Farms
80851		6/8/71	Irr	H-1, H-2, H-3, H-4, H-6, & H-7,	3N	30 E WM	8	SW SW			802	30.0	Hales Bros Farms
											Total	66.31	

WATER RESOURCES DEPT
SALEM, OREGON

110423

2nd of 3 Primary Water Rights

I. Pursuant to ORS 540.570 and OAR Chapter 690, Division 385, the district proposes to change the place of use for the following water rights:

WATER RIGHT			
PERMIT NUMBER	CERTIFICATE NUMBER	DECREE (name, volume, and page)	PRIMARY (P) or SUPP (S)
G-6626	80849	Kenneth Coppinger	P

II. The point(s) of diversion for the water right proposed for transfer are as follows:

POINT(S) OF DIVERSION / APPROPRIATION				
PERMIT	DECREE or CERTIFICATE	POD#	SOURCE	LOCATION - LEGAL DESCRIPTION
G-6626	80849	C-1	Coppinger Well #1	20' N & 1570' W from E1/4 Cor Sec 24, T3N, R29E WM*
G-6626	80849	C-2	Coppinger Well #2	960' N & 30' W from E1/4 Cor Sec 24, T3N, R29E WM*
G-6626	80849	* New C-1	Coppinger Well New #1	20' N & 1490' W from E1/4 Cor Sec 24, T3N, R29E WM*

***We propose Coppinger's New #1 to be an Additional POA during this temporary transfer.**

III. The district proposes to change the place of use from the authorized location listed in Table 1 to the location listed in Table 2.

10423

RECEIVED

JUN 28 2007

**WATER RESOURCES DEPT
SALEM, OREGON**

TABLE 1. -- AUTHORIZED PLACE OF USE

WATER RIGHT		Primary PRIORITY DATE	USE	POD #	LEGAL DESCRIPTION							ACRES	USER NAME
Cert/Decree PRIMARY	Cert/Perm SUPP				TWP	RNG	SEC	QQ	DLC	GOV'T LOT	TAX LOT		
80849		12/29/75	Irr	*C-1	3N	29E WM	24	NE NE			8600	9.0	Kenneth Coppinger
80849		12/29/75	Irr	*C-1	3N	29E WM	24	NW NE			8600	9.0	Kenneth Coppinger
80849		12/29/75	Irr	*C-1	3N	29E WM	24	SW NE			8600	9.0	Kenneth Coppinger
80849		12/29/75	Irr	*C-1	3N	29E WM	24	SE NE			8600	9.0	Kenneth Coppinger
80849		12/29/75	Irr	*C-1	3N	29E WM	24	NE SE			8700	37.1	Kenneth Coppinger
80849		12/29/75	Irr	*C-1	3N	29E WM	24	NW SE			8700	26.0	Kenneth Coppinger
80849		12/29/75	Irr	*C-1	3N	29E WM	24	SW SE			8700	9.0	Kenneth Coppinger
80849		12/29/75	Irr	*C-1	3N	29E WM	24	SE SE			8700	9.0	Kenneth Coppinger
80849		12/29/75	Irr	*C-1	3N	30E WM	19	NE NW			2601	27.5	Kenneth Coppinger
80849		12/29/75	Irr	*C-1	3N	30E WM	19	NW NW			2601	13.2	Kenneth Coppinger
80849		12/29/75	Irr	*C-1	3N	30E WM	19	SW NW			2601	13.6	Kenneth Coppinger
80849		12/29/75	Irr	*C-1	3N	30E WM	19	SE NW			2601	26.7	Kenneth Coppinger
80849		12/29/75	Irr	*C-1	3N	30E WM	19	NE SW			2600	28.5	Kenneth Coppinger
80849		12/29/75	Irr	*C-1	3N	30E WM	19	NW SW			2600	8.1	Kenneth Coppinger
80849		12/29/75	Irr	*C-1	3N	30E WM	19	SW SW			2600	9.2	Kenneth Coppinger
80849		12/29/75	Irr	*C-1	3N	30E WM	19	SE SW			2600	26.4	Kenneth Coppinger
											Total	270.3	

*We propose Coppinger's New #1 to be an Additional POA during this temporary transfer.

RECEIVED

JUN 28 2007

WATER RESOURCES DEPT
SALEM, OREGON

110422

TABLE 2. -- PROPOSED PLACE OF USE

WATER RIGHT		Primary PRIORITY DATE	USE	POD #	LEGAL DESCRIPTION							ACRES	USER NAME
Cert/Decree	Cert/Perm				TWP	RNG	SEC	QQ	DLC	GOVT LOT	TAX LOT		
PRIMARY	SUPP												
80849		12/29/75	Irr	New C-1	3N	29E WM	13	NE NE			3700	30.0	Hale Bros. Farms
	80849	12/29/75	Irr	New C-1	3N	29E WM	13	SW NE			3700	29.5*	Hale Bros. Farms
80849		12/29/75	Irr	New C-1	3N	29E WM	13	SE NE			3700	30.0	Hale Bros. Farms
80849		12/29/75	Irr	New C-1	3N	29E WM	13	NE SE			3700	30.2	Hale Bros. Farms
80849		12/29/75	Irr	New C-1	3N	29E WM	13	NW SE			3700	30.2	Hale Bros. Farms
80849		12/29/75	Irr	New C-1	3N	29E WM	13	SW SE			3700	30.2	Hale Bros. Farms
80849		12/29/75	Irr	New C-1	3N	29E WM	13	SE SE			3700	30.2	Hale Bros. Farms
80849		12/29/75	Irr	New C-1	3N	29E WM	25	NE NE			8800	30.0	Hale Bros. Farms
80849		12/29/75	Irr	New C-1	3N	29E WM	25	NW NE			8800	30.0	Hale Bros. Farms
											Total	270.3	

* This 29.5 acres of Certificate 80849 will become supplemental to permit G-7183 certificate 79889 in 2007 Private Temporary Transfer, Cook to Echo Irrigation District.

RECEIVED

JUN 28 2007

WATER RESOURCES DEPT
SALEM, OREGON

110423

3rd of 3 Primary Water Rights

I. Pursuant to ORS 540.570 and OAR Chapter 690, Division 385, the district proposes to change the place of use for the following water rights:

WATER RIGHT			
PERMIT NUMBER	CERTIFICATE NUMBER	DECREE (name, volume, and page)	PRIMARY (P) or SUPP (S)
G-5215	80850	H-4 Farms, Inc	P

II. The point(s) of diversion for the water right proposed for transfer are as follows:

POINT(S) OF DIVERSION / APPROPRIATION				
PERMIT	DECREE or CERTIFICATE	POD#	SOURCE	LOCATION - LEGAL DESCRIPTION
G-5215	80850	H-5	Hale's Well #5	60' N & 590' W from SE Cor Sec 11, T3N, R29E WM
G-5215	80850	H-8	Hale's Well #8	1350' S & 50' W from NE Cor NW1/4 NW1/4 Sec 14, T3N, R29E WM
		New C-1	Coppinger Well #1	20' N & 1490' W from E1/4 Cor Sec 24, T3N, R29E WM
		H- 3**	Hale's Well #3	1420'S & 40' E from W1/4 Cor Sec 7, T3N, R30E WM

***Propose as an Additional POA**

**** We propose Hale's Well #3 to be the Point of Appropriation for the 53.69 acres located in the E1/2 SW1/4 Section 8, T3N, R30, WM . Hale 's Well #3 is recognized as being in the same Sub Areas (H) as Hale's Well, #8, in the Stage Gulch Critical Ground Water Order. We propose Well #3 to be an Additional POA during this Temporary Transfer.**

III. The district proposes to change the place of use from the authorized location listed in Table 1 to the location listed in Table 2.

RECEIVED

JUN 28 2007

WATER RESOURCES DEPT
SALEM, OREGON

10423

TABLE 1. – AUTHORIZED PLACE OF USE

WATER RIGHT		Primary PRIORITY	USE	POD #	LEGAL DESCRIPTION							ACRES	USER NAME
Cert/Decree	Cert/Perm				TWP	RNG	SEC	QQ	DLC	GOV'T LOT	TAX LOT		
PRIMARY	SUPP	DATE											
80850		2/16/73	Irr	H-5, H-8,	3N	29E WM	11	NE SE			3603	2.0	Hale's Bro's Farms
80850		2/16/73	Irr	H-5, H-8,	3N	29E WM	11	SE SE			3603	5.0	Hale's Bro's Farms
80850		2/16/73	Irr	H-5, H-8,	3N	29E WM	12	SW SW			3603	29.8	Hale's Bro's Farms
80850		2/16/73	Irr	H-5, H-8,	3N	29E WM	12	SE SW			3603	2.89	Hale's Bro's Farms
80850		2/16/73	Irr	H-5, H-8,	3N	29E WM	14	NW NE			3900	9.3	Hale's Bro's Farms
80850		2/16/73	Irr	H-5, H-8,	3N	29E WM	14	SW NE			3900	9.3	Hale's Bro's Farms
80850		2/16/73	Irr	H-5, H-8,	3N	29E WM	14	SE NE			3900	7.3	Hale's Bro's Farms
80850		2/16/73	Irr	H-5, H-8,	3N	29E WM	14	NE NW			3900	9.3	Hale's Bro's Farms
80850		2/16/73	Irr	H-5, H-8,	3N	29E WM	14	SE NW			3900	8.8	Hale's Bro's Farms
											Total	83.69	

RECEIVED

JUN 28 2007

WATER RESOURCES DEPT
SALEM, OREGON

110423

TABLE 2. – PROPOSED PLACE OF USE

WATER RIGHT		Primary PRIORITY	USE	POD #	LEGAL DESCRIPTION							ACRES	USER NAME
Cert/Decree	Cert/Perm				TWP	RNG	SEC	QQ	DLC	GOV'T LOT	TAX LOT		
PRIMARY	SUPP	DATE											
80850		2/16/73	Irr	H-5, H-8, & New C-1	3N	29E WM	13	NW NE			3700	30.0	Hale's Bro's Farms
80850		2/16/73	Irr	H-3	3N	30E WM	8	NE SW			802	23.69	Hale's Bro's Farms
80850		2/16/73	Irr	H-3	3N	30E WM	8	SE SW			802	30.0	Hale's Bro's Farms
											Total	83.69	

RECEIVED

JUN 28 2007

**WATER RESOURCES DEPT
SALEM, OREGON**

110423

- IV. Enclosed is a map for each proposed change in place of use meeting the standards of OAR Chapter 690, Division 385.
- V. The water right proposed for transfer is a water right subject to transfer and has not been forfeited for nonuse under ORS 540.610.
- VI. Each user affected by the proposed transfer has provided written authorization for the transfer and such authorization is on file with the district.
- VII. The district has notified each affected user that the Department may condition or reject the transfer at any time to the extent necessary to avoid injury to an existing water right, and that the use of water on lands from which the water right is transferred (authorized place of use) and at the proposed place of use during the same irrigation season or calendar year may subject both the user and district to civil penalties.
- VIII. Enclosed is the application fee in the amount of: \$281 .

I certify that the information contained in this district permanent transfer application is true and accurate.

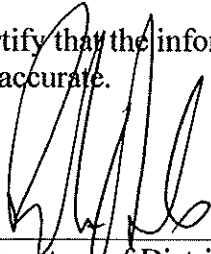

Signature of District Manager
or Authorized Representative

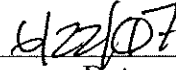

Date

Robert C. Hale

Typed Name of District Manager
or Authorized Representative

10423

RECEIVED
JUN 28 2007
WATER RESOURCES DEPT
SALEM, OREGON

STATE OF OREGON
 COUNTY OF UMATILLA
 CERTIFICATE OF WATER RIGHT

THIS CERTIFICATE ISSUED TO

KENNETH H. COPPINGER
 ROUTE 2, BOX 10
 ECHO, OR

confirms the right to use the waters of COPPINGER WELLS #1 and #2, a tributary of STAGE GULCH, for IRRIGATION of 714.0 acres.

This right was perfected under Permit G-6626. The date of priority is DECEMBER 29, 1975. The amount of water to which the right is entitled is limited to an amount actually beneficially used and shall not exceed 7.55 CUBIC FEET PER SECOND, or the equivalent in case of rotation, measured at the well. Any deficiency in the available supply from Well #1 may be made up by appropriation from Well #2.

The point of appropriation is located as follows:

TWP	RNG	MER	SEC	1/4	1/4	LOT	DLC	LOCATION
3	N	29	E	WM	24	SW	NE	WELL #1 - 20 FEET NORTH & 1570 FEET WEST FROM E1/4 CORNER, SECTION 24
3	N	29	E	WM	24	SE	NE	WELL #2 - 960 FEET NORTH & 30 FEET WEST FROM E1/4 CORNER, SECTION 24

The amount of water used for irrigation, together with the amount secured under any other right existing for the same lands, is limited to ONE-EIGHTIETH of one cubic foot per second per acre, or the equivalent for each acre irrigated, and is further limited to a total diversion not to exceed 3.0 acre-feet per acre for each acre irrigated during the irrigation season of each year.

The use shall conform to such reasonable rotation system as may be ordered by the proper state officer.

A description of the place of use under the right, and to which such right is appurtenant, is as follows:

IRRIGATION									
Legal Description									
TWP	RNG	MER	SEC	1/4	1/4	LOT	DLC	ACRES	
3	N	29	E	WM	24	NE	NE		40.00
3	N	29	E	WM	24	NW	NE		40.00
3	N	29	E	WM	24	SW	NE		40.00

IRRIGATION									
Legal Description									
TWP	RNG	MER	SEC	1/4	1/4	LOT	DLC	ACRES	
3	N	29	E	WM	24	SE	NE		40.00
3	N	29	E	WM	24	NE	SE		37.10
3	N	29	E	WM	24	NW	SE		40.00
3	N	29	E	WM	24	SW	SE		40.00
3	N	29	E	WM	24	SE	SE		40.00
3	N	30	E	WM	19	NE	NW		40.50
3	N	30	E	WM	19	NW	NW	1	59.00
3	N	30	E	WM	19	SW	NW	2	58.70
3	N	30	E	WM	19	SE	NW		41.50
3	N	30	E	WM	19	NE	SW		41.50
3	N	30	E	WM	19	NW	SW	3	56.70
3	N	30	E	WM	19	SW	SW	4	58.50
3	N	30	E	WM	19	SE	SW		40.50
									714.00

This certificate is issued in accordance with OAR 690-380-6010(6) to confirm the water right for a non-completed change in point of appropriation approved by an order of the Water Resources Director entered July 29, 2003, at Special Order Volume 57, Page 1172, approving Transfer 6777. This certificate supercedes Water Right Certificate 49733.

The issuance of this superseding certificate does not confirm the status of the water right in regard to the provisions of ORS 540.610 pertaining to forfeiture or abandonment.

The right to the use of the water for the above purpose is restricted to beneficial use on the lands or place of use described.

Issued: JUL 26 2004

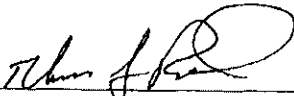
 For Phillip C. Ward, Acting Director

STATE OF OREGON
 COUNTY OF UMATILLA

CERTIFICATE OF WATER RIGHT

THIS CERTIFICATE ISSUED TO

ROBERT C., RICK L., AND DOUGLAS L. HALE
 P.O. BOX 110
 HERMISTON, OR 97838

confirms the right to use the waters of WELLS #1, #2, #3, #4, #6, and #7 in the STAGE GULCH BASIN for IRRIGATION of 879.31 acres and SUPPLEMENTAL IRRIGATION of 410.89 acres.

This right was perfected under Permit G-4969. The date of priority is JUNE 8, 1971. This right is limited to 12.0 CUBIC FEET PER SECOND (cfs); being 6.0 cfs from WELLS #1, #2, #4, #6, and #7, and 6.0 cfs from WELL #3 if available at the original wells (WELL #2 -NW¼ SW¼, Section 6; and WELL #3 - SW¼ SW¼, Section 7), or the equivalent in case of rotation, measured at the well.

The point of appropriation is located as follows:

TWP	RNG	MER	SEC	1/4	1/4	LOT	DLC	LOCATION
3	N	29	E	WM	2	SE	NE	WELL #4 - 180 FEET NORTH & 260 FEET WEST FROM E1/4 CORNER, SECTION 2
3	N	29	E	WM	11	SW	NE	WELL #6 - 132 FEET NORTH & 2190 FEET WEST FROM E1/4 CORNER, SECTION 11
3	N	29	E	WM	12	NW	NW	WELL #7 - 1010 FEET SOUTH & 40 FEET EAST FROM NW CORNER, SECTION 12
3	N	30	E	WM	6	NW	SW	WELL #2 - 2010 FEET NORTH & 1330 FEET EAST FROM SW CORNER, SECTION 6
3	N	30	E	WM	7	NW	NW	WELL #1 - 4340 FEET NORTH & 1830 FEET WEST FROM S1/4 CORNER, SECTION 7
3	N	30	E	WM	7	SW	SW	WELL #3 - 1420 FEET SOUTH & 40 FEET EAST FROM W1/4 CORNER, SECTION 7

The amount of water used for irrigation, together with the amount secured under any other right existing for the same lands, is limited to ONE-EIGHTIETH of one cubic foot per second per acre, or the equivalent for each acre irrigated, and is further limited to a total diversion not to exceed 3.0 acre-feet per acre for each acre irrigated during the irrigation season of each year.

The use shall conform to such reasonable rotation system as may be ordered by the proper state officer.

A description of the place of use under the right, and to which such right is appurtenant, is as follows:

IRRIGATION									
Legal Description									
TWP	RNG	MER	SEC	1/4	1/4	LOT	DLC	ACRES	
3	N	29	E	WM	1	NE	NE		40.00
3	N	29	E	WM	1	NW	NE		36.00
3	N	29	E	WM	1	SW	NE		40.00
3	N	29	E	WM	1	SE	NW		40.00
3	N	29	E	WM	1	NE	SE		39.50
3	N	29	E	WM	1	NW	SE		40.00
3	N	29	E	WM	1	SW	SE		40.00
3	N	29	E	WM	1	SE	SE		39.00
3	N	29	E	WM	12	NE	NE		39.00
3	N	29	E	WM	12	NW	NE		40.00
3	N	29	E	WM	12	SW	NE		40.00
3	N	29	E	WM	12	SE	NE		39.00
3	N	29	E	WM	12	NE	SE		39.11
3	N	29	E	WM	12	NW	SE		40.00
3	N	29	E	WM	12	SW	SE		12.80
3	N	29	E	WM	12	SE	SE		22.00
3	N	30	E	WM	6	NE	NW		32.80
3	N	30	E	WM	6	NW	NW		53.80
3	N	30	E	WM	6	SW	NW		54.40
3	N	30	E	WM	6	SE	NW		40.00
3	N	30	E	WM	6	NE	SW		23.40
3	N	30	E	WM	6	NW	SW		32.60
3	N	30	E	WM	7	NE	SW		6.80
3	N	30	E	WM	7	NW	SW		9.50
3	N	30	E	WM	7	SW	SW		39.60
									879.31

SUPPLEMENTAL IRRIGATION									
Legal Description									
TWP	RNG	MER	SEC	1/4	1/4	LOT	DLC	ACRES	
3	N	29	E	WM	1	NE	SE		0.50
3	N	29	E	WM	1	SE	SE		1.00
3	N	29	E	WM	12	NE	NE		1.00
3	N	29	E	WM	12	SE	NE		1.00
3	N	29	E	WM	12	NE	SE		0.89
3	N	30	E	WM	6	NE	SW		16.60
3	N	30	E	WM	6	NW	SW		23.80
3	N	30	E	WM	6	SW	SW		57.40
3	N	30	E	WM	6	SE	SW		40.00
3	N	30	E	WM	7	NE	NW		40.00

SUPPLEMENTAL IRRIGATION									
Legal Description									
TWP	RNG	MER	SEC	1/4	1/4	LOT	DLC	ACRES	
3	N	30	E	WM	7	NW	NW		58.40
3	N	30	E	WM	7	SW	NW		50.70
3	N	30	E	WM	7	SE	NW		38.00
3	N	30	E	WM	7	NE	SW		33.20
3	N	30	E	WM	7	NW	SW		48.40
									410.89

This certificate is issued in accordance with OAR 690-380-6010(6) to confirm the water right for a non-completed change in point of appropriation approved by an order of the Water Resources Director entered May 31, 2003, at Special Order Volume 57, Page 902, approving Transfer 6775. This certificate supercedes Water Right Certificate 74897.

The issuance of this superseding certificate does not confirm the status of the water right in regard to the provisions of ORS 540.610 pertaining to forfeiture or abandonment.

The right to the use of the water for the above purpose is restricted to beneficial use on the lands or place of use described.

Issued: JUL 26 2004

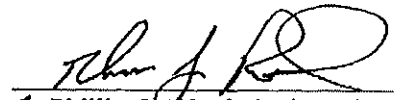
 For Phillip C. Ward, Acting Director

STATE OF OREGON
 COUNTY OF UMATILLA
 CERTIFICATE OF WATER RIGHT

THIS CERTIFICATE ISSUED TO

H - 4 FARMS, INC.
 RICK HALE, PRESIDENT
 200 GOLF COURSE ROAD
 ECHO, OR 97826

confirms the right to use the waters of TWO WELLS in the UMATILLA RIVER BASIN for IRRIGATION of 786.8 acres.

This right was perfected under Permit G-5215. The date of priority is FEBRUARY 16, 1973. This right is limited to 5.94 CUBIC FEET PER SECOND; being 2.90 cfs from WELL #5 and 3.04 cfs from WELL #8, or the equivalent in case of rotation, measured at the well.

The point of appropriation is located as follows:

TWP	RNG	MER	SEC	1/4	1/4	LOT	DLC	LOCATION
3	N	29	E	WM	11	SE	SE	WELL #5 - 60 FEET NORTH & 590 FEET WEST FROM SE CORNER, SECTION 11
3	N	29	E	WM	14	SW	NW	WELL #8 - 1350 FEET SOUTH & 50 FEET WEST FROM NE CORNER, NWNW, SECTION 14

The amount of water used for irrigation, together with the amount secured under any other right existing for the same lands, is limited to ONE-EIGHTIETH of one cubic foot per second per acre, or the equivalent for each acre irrigated, and is further limited to a total diversion not to exceed 3.0 acre-feet per acre for each acre irrigated during the irrigation season of each year.

The use shall conform to such reasonable rotation system as may be ordered by the proper state officer.

A description of the place of use under the right, and to which such right is appurtenant, is as follows:

IRRIGATION								
Legal Description								
TWP	RNG	MER	SEC	1/4	1/4	LOT	DLC	ACRES
3	N	29	E	WM	11	NE	SW	21.20
3	N	29	E	WM	11	NW	SW	25.80
3	N	29	E	WM	11	SW	SW	30.50
3	N	29	E	WM	11	SE	SW	30.70

IRRIGATION									
Legal Description									
TWP	RNG	MER	SEC	1/4	1/4	LOT	DLC	ACRES	
3	N	29	E	WM	11	NE	SE		6.20
3	N	29	E	WM	11	NW	SE		16.00
3	N	29	E	WM	11	SW	SE		38.60
3	N	29	E	WM	11	SE	SE		38.60
3	N	29	E	WM	12	NW	SW		0.10
3	N	29	E	WM	12	SW	SW		29.80
3	N	29	E	WM	12	SE	SW		24.40
3	N	29	E	WM	13	NE	NW		30.80
3	N	29	E	WM	13	NW	NW		31.60
3	N	29	E	WM	13	SW	NW		32.80
3	N	29	E	WM	13	SE	NW		30.40
3	N	29	E	WM	14	NE	NE		30.40
3	N	29	E	WM	14	NW	NE		40.00
3	N	29	E	WM	14	SW	NE		40.00
3	N	29	E	WM	14	SE	NE		38.00
3	N	29	E	WM	14	NE	NW		39.80
3	N	29	E	WM	14	NW	NW		33.60
3	N	29	E	WM	14	SW	NW		33.50
3	N	29	E	WM	14	SE	NW		39.00
3	N	29	E	WM	14	NE	SW		31.70
3	N	29	E	WM	14	NW	SW		26.90
3	N	29	E	WM	14	SW	SW		20.40
3	N	29	E	WM	14	SE	SW		26.00
									786.80

This certificate is issued in accordance with OAR 690-380-6010(6) to confirm the water right for a non-completed change in point of appropriation approved by an order of the Water Resources Director entered May 31, 2003, at Special Order Volume 57, Page 902, approving Transfer 6775. This certificate supercedes Water Right Certificate 65485.

The issuance of this superseding certificate does not confirm the status of the water right in regard to the provisions of ORS 540.610 pertaining to forfeiture or abandonment.

The right to the use of the water for the above purpose is restricted to beneficial use on the lands or place of use described.

Issued: JUL 26 2004

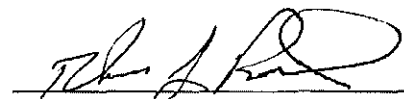
 Phillip C. Ward, Acting Director



Oregon

Theodore R. Kulongoski, Governor

Water Resources Department

North Mall Office Building
725 Summer Street NE, Suite A
Salem, OR 97301-1266
503-986-0900
FAX 503-986-0904

August 10, 2007

ECHO IRRIGATION DISTRICT
PO BOX 110
HERMISTON OR 97838

Reference: District Temporary Transfer T- 10423

Enclosed is a copy of the order approving your District temporary transfer. Also enclosed is a refund check in the amount of \$25.02 for excess fees collected.

Sincerely,

Sarah Henderson
Executive Support

cc: Watermaster #5
Fiscal

Enclosure

**BEFORE THE WATER RESOURCES DEPARTMENT
OF THE
STATE OF OREGON**

In the Matter of Transfer Application) **F I N A L O R D E R**
T-10423, Umatilla County) **APPROVING A DISTRICT**
) **TEMPORARY TRANSFER**

Authority

ORS 540.570 establishes the process in which a district may submit a request to temporarily transfer a water right within district boundaries. OAR Chapter 690, Division 385 implements the statutes and provides the Department's procedures and criteria for evaluating district transfer applications.

Applicant

Echo Irrigation District
P.O. Box 110
Hermiston, OR 97838

Findings of Fact

1. On June 28, 2007, Echo Irrigation District filed a district transfer application to temporarily change the place of use under Certificates 80849, 80850 and 80851. The Department assigned the application number T-10423.
2. Notice of the application for transfer was published on July 3, 2007, pursuant to ORS 540.580 and OAR 690-385-3400. No comments were filed in response to the notice.
3. Pursuant to OAR 690-385-3130 the applicant applied to temporarily change a portion of water right Certificate 80849 to supplemental irrigation at the proposed place of use during the 2007 irrigation season as described in Finding of Fact #7. In addition, Echo Irrigation District specified water use on the authorized "FROM" lands under existing Permit G-8907 will not be used or transferred during the course of the 2007 Irrigation Season, as fully described in Finding of Fact #4.

NOTICE OF RIGHT TO PETITION FOR RECONSIDERATION OR JUDICIAL REVIEW

This is an order other than a contested case. This order is subject to judicial review under ORS 183.484. Any petition for judicial review must be filed within the 60 day time period specified by ORS 183.484(2).

Pursuant to ORS 536.075 and OAR 137-004-080 and OAR 690-01-005, you may either petition for judicial review or petition the Director for reconsideration of this order. A petition for reconsideration may be granted or denied by the Director, and if no action is taken within 60 days following the date the petition was filed, the petition shall be deemed denied.

4. The portion of the FIRST right to be transferred is as follows:

Certificate: 80851, issued in the names of Robert C., Rick L. and Douglas L. Hale (perfected under Permit G-4969)

Use: Irrigation of 66.31 acres

Priority Date: June 8, 1971

Rate & Duty: 1/80 cfs and 3.0 acre feet per acre during the irrigation season each year

Source: Hale Wells # 1, #2, #3, #4, #6 & #7

Authorized Points of Appropriation:

TWP	RNG	MER	SEC	Q - Q	LOCATION
3 N	30 E	WM	7	NW NW	Well #1 - 4340 feet North and 1830 feet West from the S¼ Corner, Section 7
3 N	30 E	WM	6	NW SW	Well #2 - 2010 feet North and 1330 feet East from the SW Corner, Section 6
3 N	30 E	WM	7	SW SW	Well #3 - 1420 feet South and 40 feet East from the W¼ Corner, Section 7
3 N	29 E	WM	2	SE NE	Well #4 - 180 feet North and 260 feet West from the E¼ Corner, Section 2
3 N	29 E	WM	11	SW NE	Well #6 - 132 feet North and 2190 feet West from the E¼ Corner, Section 11
3 N	29 E	WM	12	NW NW	Well #7 - 1010 feet South and 40 feet East from the NW Corner, Section 12

Authorized Place of Use:

TWP	RNG	MER	SEC	Q - Q	TL	ACRES	RECIPIENT
3 N	30 E	WM	6	NE NW	703	30.00*	HALE BROS. FARMS
3 N	30 E	WM	6	SE NW	703	36.31*	HALE BROS. FARMS
TOTAL:						66.31	

*NOTE: The applicant has stated that there will be no use of the 66.31 acres under the supplemental water right Permit G-8907 on these lands, nor will it be transferred during the 2007 irrigation season.

5. Application T-10423 proposes to TEMPORARILY change the place of use of the right to:

Proposed Place of Use:

TWP	RNG	MER	SEC	Q - Q	TL	ACRES	RECIPIENT
3 N	30 E	WM	8	NE SW	802	6.31	HALE BROS. FARMS
3 N	30 E	WM	8	NW SW	802	30.00	HALE BROS. FARMS
3 N	30 E	WM	8	SW SW	802	30.00	HALE BROS. FARMS
TOTAL:						66.31	

6. The portion of the SECOND right to be transferred is as follows:

Certificate: 80849, issued in the name Kenneth H. Coppinger (perfected under Permit G-6626)

Use: Irrigation of 270.3 acres

Priority Date: December 29, 1975

Rate & Duty: 1/80 cfs per acre and 3.0 acre feet per acre during the irrigation season each year

Source: Coppinger Wells #1 & 2, within the Stage Gulch Basin

Authorized Points of Appropriation:

TWP	RNG	MER	SEC	Q - Q	LOCATION
3 N	29 E	WM	24	SW NE	Coppinger Well #1 - 20 feet North and 1570 feet West from the E¼ Corner, Section 24
3 N	29 E	WM	24	SE NE	Coppinger Well #2 - 960 feet North and 30 feet West from the E¼ Corner, Section 24

Authorized Place of Use:

TWP	RNG	MER	SEC	Q - Q	TL	ACRES	USER
3 N	29 E	WM	24	NE NE	8600	9.00	KENNETH COPPINGER
3 N	29 E	WM	24	NW NE	8600	9.00	KENNETH COPPINGER
3 N	29 E	WM	24	SW NE	8600	9.00	KENNETH COPPINGER
3 N	29 E	WM	24	SE NE	8600	9.00	KENNETH COPPINGER
3 N	29 E	WM	24	NE SE	8700	37.10	KENNETH COPPINGER
3 N	29 E	WM	24	NW SE	8700	26.00	KENNETH COPPINGER
3 N	29 E	WM	24	SW SE	8700	9.00	KENNETH COPPINGER
3 N	29 E	WM	24	SE SE	8700	9.00	KENNETH COPPINGER
3 N	30 E	WM	19	NE NW	2601	27.50	KENNETH COPPINGER
3 N	30 E	WM	19	NW NW	2601	13.20	KENNETH COPPINGER
3 N	30 E	WM	19	SW NW	2601	13.60	KENNETH COPPINGER
3 N	30 E	WM	19	SE NW	2601	26.70	KENNETH COPPINGER
3 N	30 E	WM	19	NE SW	2600	28.50	KENNETH COPPINGER
3 N	30 E	WM	19	NW SW	2600	8.10	KENNETH COPPINGER
3 N	30 E	WM	19	SW SW	2600	9.20	KENNETH COPPINGER
3 N	30 E	WM	19	SE SW	2600	26.40	KENNETH COPPINGER
TOTAL:						270.30	

7. Application T-10423 proposes to TEMPORARILY change the place of use of the right to:

Proposed Place of Use:

TWP	RNG	MER	SEC	Q - Q	TL	ACRES	USER
3 N	29 E	WM	13	NE NE	3700	30.00	HALE BROS. FARMS
3 N	29 E	WM	13	SW NE	3700	29.50*	HALE BROS. FARMS
3 N	29 E	WM	13	SE NE	3700	30.00	HALE BROS. FARMS
3 N	29 E	WM	13	NE SE	3700	30.20	HALE BROS. FARMS
3 N	29 E	WM	13	NW SE	3700	30.20	HALE BROS. FARMS
3 N	29 E	WM	13	SW SE	3700	30.20	HALE BROS. FARMS
3 N	29 E	WM	13	SE SE	3700	30.20	HALE BROS. FARMS
3 N	29 E	WM	25	NE NE	8800	30.00	HALE BROS. FARMS
3 N	30 E	WM	25	NW NE	8800	30.00	HALE BROS. FARMS
TOTAL:						270.30	

*NOTE: The applicant has requested to diminish the 29.5 acres under Certificate 80849 on the new place of use to supplemental irrigation for incoming primary District water right proposed under Echo Irrigation District Temporary Transfer 10424 (Cook) proposed for the 2007 irrigation season.

8. Application T-10423 also proposes to TEMPORARILY ADD A POINT OF APPROPRIATION under this right to:

Proposed Additional Point of Appropriation:

TWP	RNG	MER	SEC	Q - Q	LOCATION
3 N	29 E	WM	24	SW NE	Coppinger NEW Well #1 - 20 feet North and 1490 feet West from the E $\frac{1}{4}$ Corner, Section 24

9. The portion of the THIRD right to be transferred is as follows:

Certificate: 80850, issued in the name of H-4 FARMS, INC. (perfected under Permit G-5215)

Use: Irrigation of 83.69 acres

Priority Date: February 16, 1973

Rate & Duty: 1/80 cfs per acre and 3.0 acre-feet per acre during the irrigation season each year

Source: Two Wells, within the Umatilla River Basin

Authorized Points of Appropriation:

TWP	RNG	MER	SEC	Q - Q	LOCATION
3 N	29 E	WM	11	SE SE	Well #5 - 60 feet North and 590 feet West from the SE Corner, Section 11
3 N	29 E	WM	14	SW NW	Well #8 - 1350 feet South and 50 feet West from the NE Corner of the NW $\frac{1}{4}$ of the NW $\frac{1}{4}$, Section 14

Authorized Place of Use:

TWP	RNG	MER	SEC	Q - Q	TL	ACRES	USER
3 N	29 E	WM	11	NE SE	3603	2.00	HALE BROS. FARMS
3 N	29 E	WM	11	SE SE	3603	5.00	HALE BROS. FARMS
3 N	29 E	WM	12	SW SW	3603	29.80	HALE BROS. FARMS
3 N	29 E	WM	12	SE SW	3603	2.89	HALE BROS. FARMS
3 N	29 E	WM	14	NW NE	3900	9.30	HALE BROS. FARMS
3 N	29 E	WM	14	SW NE	3900	9.30	HALE BROS. FARMS
3 N	29 E	WW	14	SE NE	3900	7.30	HALE BROS. FARMS
3 N	29 E	WM	14	NE NW	3900	9.30	HALE BROS. FARMS
3 N	29 E	WM	14	SE NW	3900	8.80	HALE BROS. FARMS
TOTAL:						83.69	

10. Application T-10423 proposes to TEMPORARILY change the place of use of the right to:

Proposed Place of Use:

TWP	RNG	MER	SEC	Q - Q	TL	ACRES	USER
3 N	29 E	WM	13	NW NE	3700	30.00	HALE BROS. FARMS
3 N	30 E	WM	8	NE SW	802	23.69*	HALE BROS. FARMS
3 N	30 E	WM	8	SE SW	802	30.00*	HALE BROS. FARMS
TOTAL:						83.69	* = add'l POA (see Finding #11 below)

- Application T-10423 also proposes to TEMPORARILY ADD A POINT OF APPROPRIATION under this right to accommodate the place of use change for the 53.69 acres within the E½ SW¼, Section 8 located:

Proposed Additional Point of Appropriation:

TWP	RNG	MER	SEC	Q - Q	LOCATION
3 N	30 E	WM	7	SW SW	Hale Well #3 – 1420 feet South and 40 feet East from the W¼ Corner, Section 7

- The water rights are subject to transfer as defined in OAR 690-385-0100(17).
- The proposed changes in place of use and additional points of appropriation would not result in enlargement of the rights.
- The proposed changes would not result in injury to other water rights.

Conclusions of Law

The TEMPORARY changes proposed in application T-10423 satisfy the requirements of ORS 540.574(3) and 540.570.

Now, therefore, it is ORDERED:

- The proposed TEMPORARY changes to the water rights evidenced by Certificates 80849, 80850 and 80851 are approved.
- The TEMPORARY transfer is effective for the 2007 irrigation season.
- The right to the use of the water is restricted to beneficial use at the place of use described and is subject to all other conditions and limitations contained in Certificates 80849, 80850 and 80851 and any related decree.
- The use of water under the portion of Permit G-8907 appurtenant to the lands described in Finding of Fact #4 above may not be exercised during the 2007 irrigation season.
- The use of water on the lands from which the water right is transferred and at the new temporary place of use during the same irrigation season or calendar year is prohibited and may subject the district and landowner to civil penalties.
- The water user shall maintain and operate the existing measurement device and shall make such improvements as may be required by the Department.
- The use of water under this temporary transfer may be conditioned or revoked at any time to the extent necessary to avoid injury if the Department finds the transfer causes injury to any existing water right.

8. At the end of the 2007 irrigation season all uses of water under this temporary transfer revert automatically to the terms and conditions of the original water right permit, certificate, or adjudication as evidenced by a court decree.

Dated at Salem, Oregon this 15th day of August, 2007.



jm
Phillip C. Ward, Director

Mailing date: AUG 14 2007

VP026229

MEMORANDUM

To: Janet Vitolo, Fiscal
From: Mike Ladd, Manager, N.C. Region
Subject: Request for Refund / T-10423
Date: July 20, 2007 (Receipts # 88397 & 88473)

Please **refund** \$ 25.02 to the ECHO IRRIGATION DISTRICT, attn: Bob Hale, Jr., P.O. Box 110, Hermiston, OREGON 97838,

These funds are refunded due to:

- Application rejected
- Transfer Application withdrawn
- Excess fees collected for application
- File closed
- Protest Filing Fees
- Other

46111 | 0205

OR

Please **transfer** \$ _____ **from** file number _____, receipt number _____ **to** file number _____. The funds are transferred for:

- Transfer Application
- Surface Water Application
- Ground Water Application
- Reservoir Application (regular)

Action to file and request for refund authorized by:

MANAGER, N.C. REGION  Date 7/31/07
Mike Ladd Date 7/20/07

Mike Ladd

Calculation for "Request for Refund"

T-10423 (ECHO IRRIGATION DISTRICT)

Date: July 20, 2007

Receipt # 88397 was issued for having received **\$281.00**

We mistakenly asked for more money based on a per acre mis-calculation (Salem)

Receipt # 88473 was issued for having received **\$24.07**

Fee schedule at the time applies \$175 base fee (Dist. Temp)

	▲ POU	\$175.00
digital per acre x 25 cents		\$105.05
		<hr/>
Total :		\$ 280.05

The Department accepted \$305.07 in fees from the District.

So, to recalculate, $\$305.07 - 280.05 = \25.02 ,

and, therefore, *refund* of \$ 25.02 is due the ECHO IRRIGATION DISTRICT



Oregon

John A. Kitzhaber, M.D., Governor

Water Resources Department

Commerce Building
158 12th Street NE
Salem, OR 97301-4172
(503) 378-3739
FAX (503) 378-8130

INTEROFFICE MEMO

FORWARD TO:

Sarah Henderson
FIELD TRANSFER PROCESSOR WORKING ON THIS TRANSFER

DATE: 7/3/07

FROM:

_____ WATERMASTER, DISTRICT # _____
X _____ GROUNDWATER SECTION

(SIGNATURE) Mike Zwart
Signed by injury reviewer

SUBJECT: TEMPORARY TRANSFER # 10423 Date Signed 7/20/07

A change in: (POU) (PCA) of water.

In the name(s) of Echo I.D.

In my opinion (assuming the right is valid), the proposed change

MAY BE MADE WITHOUT INJURY WOULD RESULT IN INJURY* to an existing water right.

*The approval of this transfer application would result in injury to other water rights because _____

The existing right may not be valid because _____

Headgate notices HAVE HAVE NOT Been issued for diversion from the source(s) which serve(s) this right.

If for change in point of diversion, is there any intervening point(s) for diversion between the authorized and proposed points of diversion? (Yes or No) _____

In my opinion, the order approving the subject transfer application should include the following in regard to the appropriator installing suitable measuring devices in the diversion works:

- _____ (1) PRIOR to the diverting of water at the new point of diversion . . .
- _____ (2) WHEN IN the judgement of the watermaster it becomes necessary . . .

The enclosed copy of the transfer application and map(s) is for your records.

**OREGON WATER RESOURCES DEPARTMENT
INTEROFFICE MEMO**

To: Ground Water files Date: July 20, 2007
From: Michael J. Zwart
Subject: Application Review: T-10423, Echo Irrigation District

This application proposes a change in POA and POU for 2006. The authorized wells and the proposed wells are both within the same subareas (D and H) of the Stage Gulch Critical Ground Water Area and develop the same basalt ground-water source.

I find that the proposed change may be made without injury provided the following: the rights are valid and the Watermaster can approve the proposal.



Oregon Water Resources Department
725 Summer Street NE, Suite A
Salem, Oregon 97301-1271
(503) 986-0900
www.wrd.state.or.us

Watermaster Review Form: Water Right Transfer

Transfer Application: T-10423

Review Due Date: 8/1/2007

Applicant Name: Echo I.D.

Proposed Changes: POU POD POA USE OTHER

Reviewer(s): Tony Justus

Date of Review: Jul. 20, 2007

1. Do you have information suggesting that the water rights may be subject to forfeiture?
 Yes No If "Yes", describe the information and indicate if you intend to file a cancellation affidavit or if you need additional time to determine if a cancellation affidavit should be filed: _____
2. Is there a history of regulation on the source that serves the right proposed for transfer that has involved the right and downstream water rights? Yes No Generally characterize the frequency of any regulation or explain why regulation has not occurred:
groundwater in Stage Gulch Critical Groundwater Area.
3. Check here if it appears that downstream water rights benefit from return flows resulting from the current use of the right? If you check the box, generally characterize the locations where the return flows likely occur and list the water rights that benefit most:

4. Are there upstream water rights that would be affected by the proposed change?
 Yes No If "Yes", describe how the rights would be affected and list the rights most affected: _____
5. For POD changes and instream transfers, check here if there are channel losses between the old and new PODs or within the proposed instream reach? If you check the box, describe and, if possible, estimate the losses: _____
6. Would distribution of water for the right after the proposed change result in regulation of other water rights that would not have occurred if use of the existing right was maximized?
 Yes No If "Yes", explain: _____
7. For POU changes, would the original place of use continue to receive water from the same source? Yes No N/A If "Yes", explain: _____
8. For POU or USE changes, would use of the existing right at "full face value," result in the diversion of more water than can be used beneficially and without waste? Yes No If "Yes", explain: _____
9. Are there other issues not identified through the above questions? Yes No If "Yes", explain: _____
10. What alternatives may be available for addressing any issues identified above: _____

11. Have headgate notices been issued for the source that serves the right? Yes No

12. What water control and measurement conditions should be included in the transfer:

Measurement Devices	<input checked="" type="checkbox"/> Present and should be maintained.	<input type="checkbox"/> Should be required prior to diverting water.	<input type="checkbox"/> May be required in the future.
Headgates	<input type="checkbox"/> Present and should be maintained.	<input type="checkbox"/> Should be required prior to diverting water.	<input type="checkbox"/> May be required in the future.

STATE OF OREGON
 COUNTY OF UMATILLA
 CERTIFICATE OF WATER RIGHT

THIS CERTIFICATE ISSUED TO

H - 4 FARMS, INC.
 RICK HALE, PRESIDENT
 200 GOLF COURSE ROAD
 ECHO, OR 97826

confirms the right to use the waters of TWO WELLS in the UMATILLA RIVER BASIN for IRRIGATION of 786.8 acres.

This right was perfected under Permit G-5215. The date of priority is FEBRUARY 16, 1973. This right is limited to 5.94 CUBIC FEET PER SECOND; being 2.90 cfs from WELL #5 and 3.04 cfs from WELL #8, or the equivalent in case of rotation, measured at the well.

The point of appropriation is located as follows:

TWP	RNG	MER	SEC	1/4	1/4	LOT	DLC	LOCATION
3	N	29	E	WM	11	SE	SE	WELL #5 - 60 FEET NORTH & 590 FEET WEST FROM SE CORNER, SECTION 11
3	N	29	E	WM	14	SW	NW	WELL #8 - 1350 FEET SOUTH & 50 FEET WEST FROM NE CORNER, NWNW, SECTION 14

The amount of water used for irrigation, together with the amount secured under any other right existing for the same lands, is limited to ONE-EIGHTIETH of one cubic foot per second per acre, or the equivalent for each acre irrigated, and is further limited to a total diversion not to exceed 3.0 acre-feet per acre for each acre irrigated during the irrigation season of each year.

The use shall conform to such reasonable rotation system as may be ordered by the proper state officer.

A description of the place of use under the right, and to which such right is appurtenant, is as follows:

IRRIGATION									
Legal Description									
TWP	RNG	MER	SEC	1/4	1/4	LOT	DLC	ACRES	
3	N	29	E	WM	11	NE	SW		21.20
3	N	29	E	WM	11	NW	SW		25.80
3	N	29	E	WM	11	SW	SW		30.50
3	N	29	E	WM	11	SE	SW		30.70

IRRIGATION										
Legal Description										
TWP	RNG	MER	SEC	1/4	1/4	LOT	DLC			ACRES
3	N	29	E	WM	11	NE	SE			6.20
3	N	29	E	WM	11	NW	SE			16.00
3	N	29	E	WM	11	SW	SE			38.60
3	N	29	E	WM	11	SE	SE			38.60
3	N	29	E	WM	12	NW	SW			0.10
3	N	29	E	WM	12	SW	SW			29.80
3	N	29	E	WM	12	SE	SW			24.40
3	N	29	E	WM	13	NE	NW			30.80
3	N	29	E	WM	13	NW	NW			31.60
3	N	29	E	WM	13	SW	NW			32.80
3	N	29	E	WM	13	SE	NW			30.40
3	N	29	E	WM	14	NE	NE			30.40
3	N	29	E	WM	14	NW	NE			40.00
3	N	29	E	WM	14	SW	NE			40.00
3	N	29	E	WM	14	SE	NE			38.00
3	N	29	E	WM	14	NE	NW			39.80
3	N	29	E	WM	14	NW	NW			33.60
3	N	29	E	WM	14	SW	NW			33.50
3	N	29	E	WM	14	SE	NW			39.00
3	N	29	E	WM	14	NE	SW			31.70
3	N	29	E	WM	14	NW	SW			26.90
3	N	29	E	WM	14	SW	SW			20.40
3	N	29	E	WM	14	SE	SW			26.00
										786.80

-2
-5.0

This certificate is issued in accordance with OAR 690-380-6010(6) to confirm the water right for a non-completed change in point of appropriation approved by an order of the Water Resources Director entered May 31, 2003, at Special Order Volume 57, Page 902, approving Transfer 6775. This certificate supercedes Water Right Certificate 65485.

The issuance of this superseding certificate does not confirm the status of the water right in regard to the provisions of ORS 540.610 pertaining to forfeiture or abandonment.

The right to the use of the water for the above purpose is restricted to beneficial use on the lands or place of use described.

Issued: JUL 26 2004

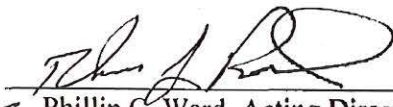
Phillip C. Ward, Acting Director

STATE OF OREGON
COUNTY OF UMATILLA
CERTIFICATE OF WATER RIGHT

THIS CERTIFICATE ISSUED TO

ROBERT C., RICK L., AND DOUGLAS L. HALE
P.O. BOX 110
HERMISTON, OR 97838

confirms the right to use the waters of WELLS #1, #2, #3, #4, #6, and #7 in the STAGE GULCH BASIN for IRRIGATION of 879.31 acres and SUPPLEMENTAL IRRIGATION of 410.89 acres.

This right was perfected under Permit G-4969. The date of priority is JUNE 8, 1971. This right is limited to 12.0 CUBIC FEET PER SECOND (cfs); being 6.0 cfs from WELLS #1, #2, #4, #6, and #7, and 6.0 cfs from WELL #3 if available at the original wells (WELL #2 - NW¼ SW¼, Section 6; and WELL #3 - SW¼ SW¼, Section 7), or the equivalent in case of rotation, measured at the well.

The point of appropriation is located as follows:

TWP	RNG	MER	SEC	1/4	1/4	LOT	DLC	LOCATION
3	N	29	E	WM	2	SE	NE	WELL #4 - 180 FEET NORTH & 260 FEET WEST FROM E1/4 CORNER, SECTION 2
3	N	29	E	WM	11	SW	NE	WELL #6 - 132 FEET NORTH & 2190 FEET WEST FROM E1/4 CORNER, SECTION 11
3	N	29	E	WM	12	NW	NW	WELL #7 - 1010 FEET SOUTH & 40 FEET EAST FROM NW CORNER, SECTION 12
3	N	30	E	WM	6	NW	SW	WELL #2 - 2010 FEET NORTH & 1330 FEET EAST FROM SW CORNER, SECTION 6
3	N	30	E	WM	7	NW	NW	WELL #1 - 4340 FEET NORTH & 1830 FEET WEST FROM S1/4 CORNER, SECTION 7
3	N	30	E	WM	7	SW	SW	WELL #3 - 1420 FEET SOUTH & 40 FEET EAST FROM W1/4 CORNER, SECTION 7

The amount of water used for irrigation, together with the amount secured under any other right existing for the same lands, is limited to ONE-EIGHTIETH of one cubic foot per second per acre, or the equivalent for each acre irrigated, and is further limited to a total diversion not to exceed 3.0 acre-feet per acre for each acre irrigated during the irrigation season of each year.

The use shall conform to such reasonable rotation system as may be ordered by the proper state officer.

A description of the place of use under the right, and to which such right is appurtenant, is as follows:

IRRIGATION									
Legal Description									
TWP	RNG	MER	SEC	1/4	1/4	LOT	DLC	ACRES	
3	N	29	E	WM	1	NE	NE		40.00
3	N	29	E	WM	1	NW	NE		36.00
3	N	29	E	WM	1	SW	NE		40.00
3	N	29	E	WM	1	SE	NW		40.00
3	N	29	E	WM	1	NE	SE		39.50
3	N	29	E	WM	1	NW	SE		40.00
3	N	29	E	WM	1	SW	SE		40.00
3	N	29	E	WM	1	SE	SE		39.00
3	N	29	E	WM	12	NE	NE		39.00
3	N	29	E	WM	12	NW	NE		40.00
3	N	29	E	WM	12	SW	NE		40.00
3	N	29	E	WM	12	SE	NE		39.00
3	N	29	E	WM	12	NE	SE		39.11
3	N	29	E	WM	12	NW	SE		40.00
3	N	29	E	WM	12	SW	SE		12.80
3	N	29	E	WM	12	SE	SE		22.00
3	N	30	E	WM	6	NE	NW		32.80
3	N	30	E	WM	6	NW	NW		53.80
3	N	30	E	WM	6	SW	NW		54.40
3	N	30	E	WM	6	SE	NW		40.00
3	N	30	E	WM	6	NE	SW		23.40
3	N	30	E	WM	6	NW	SW		32.60
3	N	30	E	WM	7	NE	SW		6.80
3	N	30	E	WM	7	NW	SW		9.50
3	N	30	E	WM	7	SW	SW		39.60
									879.31

-30.0 FROM

-36.31 FROM

SUPPLEMENTAL IRRIGATION									
Legal Description									
TWP	RNG	MER	SEC	1/4	1/4	LOT	DLC	ACRES	
3	N	29	E	WM	1	NE	SE		0.50
3	N	29	E	WM	1	SE	SE		1.00
3	N	29	E	WM	12	NE	NE		1.00
3	N	29	E	WM	12	SE	NE		1.00
3	N	29	E	WM	12	NE	SE		0.89
3	N	30	E	WM	6	NE	SW		16.60
3	N	30	E	WM	6	NW	SW		23.80
3	N	30	E	WM	6	SW	SW		57.40
3	N	30	E	WM	6	SE	SW		40.00
3	N	30	E	WM	7	NE	NW		40.00

SUPPLEMENTAL IRRIGATION									
Legal Description									
TWP	RNG	MER	SEC	1/4	1/4	LOT	DLC	ACRES	
3	N	30	E	WM	7	NW	NW		58.40
3	N	30	E	WM	7	SW	NW		50.70
3	N	30	E	WM	7	SE	NW		38.00
3	N	30	E	WM	7	NE	SW		33.20
3	N	30	E	WM	7	NW	SW		48.40
									410.89

This certificate is issued in accordance with OAR 690-380-6010(6) to confirm the water right for a non-completed change in point of appropriation approved by an order of the Water Resources Director entered May 31, 2003, at Special Order Volume 57, Page 902, approving Transfer 6775. This certificate supercedes Water Right Certificate 74897.

The issuance of this superseding certificate does not confirm the status of the water right in regard to the provisions of ORS 540.610 pertaining to forfeiture or abandonment.

The right to the use of the water for the above purpose is restricted to beneficial use on the lands or place of use described.

Issued: JUL 26 2004

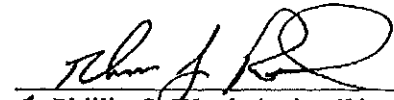
 For Phillip C. Ward, Acting Director

STATE OF OREGON
 COUNTY OF UMATILLA
 CERTIFICATE OF WATER RIGHT

THIS CERTIFICATE ISSUED TO

KENNETH H. COPPINGER
 ROUTE 2, BOX 10
 ECHO, OR

confirms the right to use the waters of COPPINGER WELLS #1 and #2, a tributary of STAGE GULCH, for IRRIGATION of 714.0 acres.

This right was perfected under Permit G-6626. The date of priority is DECEMBER 29, 1975. The amount of water to which the right is entitled is limited to an amount actually beneficially used and shall not exceed 7.55 CUBIC FEET PER SECOND, or the equivalent in case of rotation, measured at the well. Any deficiency in the available supply from Well #1 may be made up by appropriation from Well #2.

The point of appropriation is located as follows:

TWP	RNG	MER	SEC	1/4	1/4	LOT	DLC	LOCATION
3	N	29	E	WM	24	SW	NE	WELL #1 - 20 FEET NORTH & 1570 FEET WEST FROM E1/4 CORNER, SECTION 24
3	N	29	E	WM	24	SE	NE	WELL #2 - 960 FEET NORTH & 30 FEET WEST FROM E1/4 CORNER, SECTION 24

The amount of water used for irrigation, together with the amount secured under any other right existing for the same lands, is limited to ONE-EIGHTIETH of one cubic foot per second per acre, or the equivalent for each acre irrigated, and is further limited to a total diversion not to exceed 3.0 acre-feet per acre for each acre irrigated during the irrigation season of each year.

The use shall conform to such reasonable rotation system as may be ordered by the proper state officer.

A description of the place of use under the right, and to which such right is appurtenant, is as follows:

IRRIGATION									
Legal Description									
TWP	RNG	MER	SEC	1/4	1/4	LOT	DLC	ACRES	
3	N	29	E	WM	24	NE	NE		40.00
3	N	29	E	WM	24	NW	NE		40.00
3	N	29	E	WM	24	SW	NE		40.00

IRRIGATION									
Legal Description									
TWP	RNG	MER	SEC	1/4	1/4	LOT	DLC	ACRES	
3	N	29	E	WM	24	SE	NE		40.00
3	N	29	E	WM	24	NE	SE		37.10
3	N	29	E	WM	24	NW	SE		40.00
3	N	29	E	WM	24	SW	SE		40.00
3	N	29	E	WM	24	SE	SE		40.00
3	N	30	E	WM	19	NE	NW		40.50
3	N	30	E	WM	19	NW	NW	1	59.00
3	N	30	E	WM	19	SW	NW	2	58.70
3	N	30	E	WM	19	SE	NW		41.50
3	N	30	E	WM	19	NE	SW		41.50
3	N	30	E	WM	19	NW	SW	3	56.70
3	N	30	E	WM	19	SW	SW	4	58.50
3	N	30	E	WM	19	SE	SW		40.50
									714.00

This certificate is issued in accordance with OAR 690-380-6010(6) to confirm the water right for a non-completed change in point of appropriation approved by an order of the Water Resources Director entered July 29, 2003, at Special Order Volume 57, Page 1172, approving Transfer 6777. This certificate supercedes Water Right Certificate 49733.

The issuance of this superseding certificate does not confirm the status of the water right in regard to the provisions of ORS 540.610 pertaining to forfeiture or abandonment.

The right to the use of the water for the above purpose is restricted to beneficial use on the lands or place of use described.

Issued: JUL 26 2004

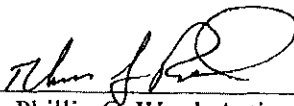
 for Phillip C. Ward, Acting Director

Water Rights Platcard Report

"FROM" LANDS

pg. 2 of 9

Meridian: WILLAMETTE Township: 3 North Range: 30 East Section: 6 Records per Page: 7 Search

Water Right	Changing Xfers	Priority	Use	Use Status	DLC	Gov't Lot	QQ(40): Q(160):	NE NE	NW NE	SW NE	SE NE	NE NW	NW NW	SW NW	SE NW	NE SW	NW SW	SW SW	SE SW	NE SE	NW SE	SW SE	SE SE	Unkwn QQ	
Select App:S 81070 *		4/12/1996	FISH CULTURE																					*	
Additional Info: HERMISTON DEVELOPMENT CORP.;IRZ CONSULTING C/O App: S81070																									
Select Cert:37252 OR CN		4/8/1963	IRRIGATION CN													16.6	23.8	57.4	40						
Additional Info: MARSHALL E MEYERS App: G2588 Permit: G2415 Cert: 37252																									
Select Cert:47094 OR CN		6/8/1971	IRRIGATION CN								32.8				40	23.4									
Additional Info: IVAN COOK App: G5541 Permit: G4969 Cert: 47094																									
Select Cert:47094 OR CN		6/8/1971	IRRIGATION CN			1							53.8												
Additional Info: IVAN COOK App: G5541 Permit: G4969 Cert: 47094																									
Select Cert:47094 OR CN		6/8/1971	IRRIGATION CN			2								54.4											
Additional Info: IVAN COOK App: G5541 Permit: G4969 Cert: 47094																									
Select Cert:47094 OR CN		6/8/1971	IRRIGATION CN			3											32.6								
Additional Info: IVAN COOK App: G5541 Permit: G4969 Cert: 47094																									
Select Cert:56164 CF CN		6/8/1971	IRRIGATION CN								32.8	53.8	54.4	40	23.4	32.6									
Additional Info: PRUDENTIAL INSURANCE CO. OF AMERICA App: G5541 Permit: G4969 Cert: 56164																									

1 2 3 4

Acreage Legend: 12.25 Regular acreage 12.25 Acreage is on a canceled right (12.25) Acreage is part of a transfer and has not been proven up on yet (inchoate) [12.25] Acreage has been suspended * Acreage is not specified

NO CONFLICTS

Water Rights Platcard Report

Meridian: WILLAMETTE Township: 3 North Range: 30 East Section: 6 Records per Page: 7 Search

Water Right	Changing Xfers	Priority	Use	Use Status	DLC	Gov't Lot	QQ(40): Q(160)	NE NE	NW NE	SW NE	SE NE	NE NW	NW NW	SW NW	SE NW	NE SW	NW SW	SW SW	SE SW	NE SE	NW SE	SW SE	SE SE	Unkown QQ
Select Cert:74896 CF CN Additional Info: ROBERT C HALE App: G2588 Permit: G2415 Cert: 74896	T8406, T7903, T8144, T9671	4/8/1963	IRRIGATION	CN									23.8			16.6		57.4	40					
Select Cert:74897 CF CN Additional Info: ROBERT HALE App: G5541 Permit: G4969 Cert: 74897	T8144, T9043, T8406, T7903, T8687, T6775, T9671	6/8/1971	IRRIGATION	CN								32.8	53.8	54.4	40	23.4	32.6							
Select Inchoate: T 6787 CF (REG) * Additional Info: DOUGLAS HALE App: G2588 Permit: G2415		4/8/1963	IRRIGATION													(16.6)	(23.8)	(36.4)	(29.5)					
Select Inchoate: T 9043 (ALT) RJ Additional Info: ECHO IRRIGATION DISTRICT App: G5541 Permit: G4969		6/8/1971	IRRIGATION	RJ								(32.8)	(53.8)	(54.4)	(40)	(23.4)	(32.6)							
Select Cert:80851 RR * Additional Info: ROBERT HALE App: G5541 Permit: G4969 Cert: 80851	T10095, T9878, T10423	6/8/1971	IRRIGATION									32.8	53.8	54.4	40	23.4	32.6							
Select App:S 81070 * Additional Info: HERMISTON DEVELOPMENT CORP.;IRZ CONSULTING C/O App: S81070		4/12/1996	SUPPLEMENTAL IRRIGATION (Suppl'mtl)					13.5	13	14	35	40.8	53.8	54.4	40	40	56.4	57.4	40	40	40	40	40	
Select Permit:G 8907 * Additional Info: MERLE A GEHRKE App: G9815 Permit: G8907		7/1/1980	SUPPLEMENTAL IRRIGATION (Suppl'mtl)									32.8			40	40			40					

SUBJECT RIGHT

OK

NOT A RIGHT

WILL NOT BE USED THIS SUMMER

see pg. 2 of 9 REMARK (NOTE)

Acreege Legend: 12.25 Regular acreage 12.25 Acreege is on a canceled right (12.25) Acreege is part of a transfer and has not been proven up on yet (inchoate) [12.25] Acreege has been suspended * Acreege is not specified

Water Rights Platcard Report

Meridian: Township: North Range: East Section: Records per Page:

Water Right	Changing Xfers	Priority	Use	Use Status	DLC	Gov't Lot	QQ(40): Q(160):	NE NE	NW NE	SW NE	SE NE	NE NW	NW NW	SW NW	SE NW	NE SW	NW SW	SW SW	SE SW	NE SE	NW SE	SW SE	SE SE	Unkown QQ
Select Permit:G 8907 * Additional Info: MERLE A GEHRKE App: G9815 Permit: G8907		7/1/1980	SUPPLEMENTAL IRRIGATION (Suppl'mtl)			1							53.8											
Select Permit:G 8907 * Additional Info: MERLE A GEHRKE App: G9815 Permit: G8907		7/1/1980	SUPPLEMENTAL IRRIGATION (Suppl'mtl)			2							54.4											
Select Permit:G 8907 * Additional Info: MERLE A GEHRKE App: G9815 Permit: G8907		7/1/1980	SUPPLEMENTAL IRRIGATION (Suppl'mtl)			3										56.4								
Select Permit:G 8907 * Additional Info: MERLE A GEHRKE App: G9815 Permit: G8907		7/1/1980	SUPPLEMENTAL IRRIGATION (Suppl'mtl)			4										57.4								
Select Cert:47094 OR CN Additional Info: IVAN COOK App: G5541 Permit: G4969 Cert: 47094		6/8/1971	SUPPLEMENTAL IRRIGATION (Suppl'mtl) CN													16.6		40						
Select Cert:47094 OR CN Additional Info: IVAN COOK App: G5541 Permit: G4969 Cert: 47094		6/8/1971	SUPPLEMENTAL IRRIGATION (Suppl'mtl) CN			3										23.8								
Select Cert:47094 OR CN Additional Info: IVAN COOK App: G5541 Permit: G4969 Cert: 47094		6/8/1971	SUPPLEMENTAL IRRIGATION (Suppl'mtl) CN			4										57.4								

Water Rights Platcard Report

Meridian: WILLAMETTE Township: 3 North Range: 30 East Section: 6 Records per Page: 7 Search

Water Right	Changing Xfers	Priority	Use	Use Status	DLC	Gov't Lot	QQ(40): Q(160)	NE NE	NW NE	SW NE	SE NE	NE NW	NW NW	SW NW	SE NW	NE SW	NW SW	SW SW	SE SW	NE SE	NW SE	SW SE	SE SE	Unknown QQ
<u>Select</u> Cert:56164 CF CN <u>Additional Info:</u> PRUDENTIAL INSURANCE CO. OF AMERICA App: G5541 Permit: G4969 Cert: 56164		6/8/1971	SUPPLEMENTAL IRRIGATION (Suppl'mtl)	CN												16.6	23.8	57.4	40					
<u>Select</u> Cert:74897 CF CN <u>Additional Info:</u> ROBERT HALE App: G5541 Permit: G4969 Cert: 74897	T8144, T9043, T8406, T7903, T8687, T6775, T9671	6/8/1971	SUPPLEMENTAL IRRIGATION (Suppl'mtl)	CN												16.6	23.8	57.4	40					
<u>Select</u> Inchoate: T 9043 (ALT) RJ <u>Additional Info:</u> ECHO IRRIGATION DISTRICT App: G5541 Permit: G4969		6/8/1971	SUPPLEMENTAL IRRIGATION (Suppl'mtl)	RJ												(16.6)	(23.8)	(57.4)	(40)					
<u>Select</u> Cert:80851 RR * <u>Additional Info:</u> ROBERT HALE App: G5541 Permit: G4969 Cert: 80851	T10095, T9878, T10423	6/8/1971	SUPPLEMENTAL IRRIGATION (Suppl'mtl)													16.6	23.8	57.4	40					

Acreege Legend: 12.25 Regular acreege ±2.25 Acreege is on a canceled right (12.25) Acreege is part of a transfer and has not been proven up on yet (inchoate) [12.25] Acreege has been suspended * Acreege is not specified

Water Rights Platcard Report

"TO" LANDS

Pg. 2 of 9

Meridian: Township: North East Section: Records per Page:

Water Right	Changing Xfers	Priority	Use	Use Status	DLC	Gov't Lot	QQ(40): Q(160):	NE NE	NW NE	SW NE	SE NE	NE NW	NW NW	SW NW	SE NW	NE SW	NW SW	SW SW	SE SW	NE SE	NW SE	SW SE	SE SE	Unkown QQ
Select Cert:24686 OR CN Additional Info: RALPH A REESE App: U746 Permit: U680 Cert: 24686		9/16/1954	IRRIGATION	CN																0.02				
Select App:S 81070 * Additional Info: HERMISTON DEVELOPMENT CORP.;IRZ CONSULTING C/O App: S81070		4/12/1996	SUPPLEMENTAL IRRIGATION (Suppl'mtl)					40	40	40	40	40	40	40	40	40	40	40	40	39.98	40	39	39	

Acreage Legend: 12.25 Regular acreage 12.25 Acreage is on a canceled right (12.25) Acreage is part of a transfer and has not been proven up on yet (inchoate) [12.25] Acreage has been suspended * Acreage is not specified

NO CONFLICTS

Water Rights Platcard Report

"FROM" LANDS

pg. 4 of 9

Meridian: WILLAMETTE Township: 3 North Range: 29 East Section: 24 Records per Page: 6 Search

Water Right	Changing Xfers	Priority	Use	Use Status	DLC	Gov't Lot	QQ(40): NE NE	NW NE	SW NE	SE NE	NE NW	NW NW	SW NW	SE NW	NE SW	NW SW	SW SW	SE SW	NE SE	NW SE	SW SE	SE SE	Unkown QQ	
Select App:S 81070 *		4/12/1996	FISH CULTURE																				*	
Additional Info: HERMISTON DEVELOPMENT CORP.;IRZ CONSULTING C/O App: S81070																								
Select Cert:49733 OR *		12/29/1975	IRRIGATION				40	40	40	40									37.1	40	40	40		
Additional Info: KENNETH COPPINGER App: G7195 Permit: G6626 Cert: 49733		T8144, T9043, T8406, T7903, T7682, T8687, T6777, T9671, T7477					CANCELED												CANCELED					
Select Cert:80849 CF *		12/29/1975	IRRIGATION				40	40	40	40									37.1	40	40	40		
Additional Info: KENNETH COPPINGER App: G7195 Permit: G6626 Cert: 80849		T10095, T9878, T10423					SUBJECT RIGHT												OK					
Select App:S 81070 *		4/12/1996	SUPPLEMENTAL IRRIGATION (Suppl'mtl)				31.2	31.3	31.3	31.2									31.2	31.3	31.3	31.2		
Additional Info: HERMISTON DEVELOPMENT CORP.;IRZ CONSULTING C/O App: S81070							NOT A RIGHT																	

Acreage Legend: 12.25 Regular acreage 12.25 Acreage is on a canceled right (12.25) Acreage is part of a transfer and has not been proven up on yet (inchoate) [12.25] Acreage has been suspended * Acreage is not specified

Water Rights Platcard Report

"FROM" LANDS

pg. 4 of 9

Meridian: WILLAMETTE Township: 3 North Range: 30 East Section: 19 Records per Page: 6 Search

Water Right	Changing Xfers	Priority	Use	Use Status	DLC	Gov't Lot	QQ(40): Q(160)	NE NE	NW NE	SW NE	SE NE	NE NW	NW NW	SW NW	SE NW	NE SW	NW SW	SW SW	SE SW	NE SE	NW SE	SW SE	SE SE	Unkwnn QQ
Select App:S 81070 * Additional Info: HERMISTON DEVELOPMENT CORP.;IRZ CONSULTING C/O App: S81070		4/12/1996	FISH CULTURE																					*
Select Cert:49733 OR * Additional Info: KENNETH COPPINGER App: G7195 Permit: G6626 Cert: 49733	T8144, T9043, T8406, T7903, T7682, T8687, T6777, T9671, T7477	12/29/1975	IRRIGATION									40.5			41.5	41.5						40.5		
Select Cert:49733 OR * Additional Info: KENNETH COPPINGER App: G7195 Permit: G6626 Cert: 49733	T8144, T9043, T8406, T7903, T7682, T8687, T6777, T9671, T7477	12/29/1975	IRRIGATION			1								59										
Select Cert:49733 OR * Additional Info: KENNETH COPPINGER App: G7195 Permit: G6626 Cert: 49733	T8144, T9043, T8406, T7903, T7682, T8687, T6777, T9671, T7477	12/29/1975	IRRIGATION			2								58.7										
Select Cert:49733 OR * Additional Info: KENNETH COPPINGER App: G7195 Permit: G6626 Cert: 49733	T8144, T9043, T8406, T7903, T7682, T8687, T6777, T9671, T7477	12/29/1975	IRRIGATION			3																56.7		
Select Cert:49733 OR * Additional Info: KENNETH COPPINGER App: G7195 Permit: G6626 Cert: 49733	T8144, T9043, T8406, T7903, T7682, T8687, T6777, T9671, T7477	12/29/1975	IRRIGATION			4																	58.5	

CANCELED

C# 49733 HAS BEEN superseded by C# 90849

SEE NEXT PAGE

Acreage Legend: 12.25 Regular acreage 12-25 Acreage is on a canceled right (12.25) Acreage is part of a transfer and has not been proven up on yet (inchoate) [12.25] Acreage has been suspended * Acreage is not specified

NCR

NO CONFLICTING RIGHTS

Water Rights Platcard Report

Meridian: WILLAMETTE Township: 3 North Range: 30 East Section: 19 Records per Page: 6 Search

Water Right	Changing Xfers	Priority	Use	Use Status	DLC	Gov't Lot	QQ(40): Q(100):	NE NE	NW NE	SW NE	SE NE	NE NW	NW NW	SW NW	SE NW	NE SW	NW SW	SW SW	SE SW	NE SE	NW SE	SW SE	SE SE	Unkown QQ
Select Cert:80849 CF * Additional Info: KENNETH COPPINGER App: G7195 Permit: G6626 Cert: 80849	T10095, T9878, T10423	12/29/1975	IRRIGATION									40.5			41.5	41.5			40.5					
Select Cert:80849 CF * Additional Info: KENNETH COPPINGER App: G7195 Permit: G6626 Cert: 80849	T10095, T9878, T10423	12/29/1975	IRRIGATION			1						59												
Select Cert:80849 CF * Additional Info: KENNETH COPPINGER App: G7195 Permit: G6626 Cert: 80849	T10095, T9878, T10423	12/29/1975	IRRIGATION			2								58.7										
Select Cert:80849 CF * Additional Info: KENNETH COPPINGER App: G7195 Permit: G6626 Cert: 80849	T10095, T9878, T10423	12/29/1975	IRRIGATION			3											56.7							
Select Cert:80849 CF * Additional Info: KENNETH COPPINGER App: G7195 Permit: G6626 Cert: 80849	T10095, T9878, T10423	12/29/1975	IRRIGATION			4												58.5						
Select App:S 81070 * Additional Info: HERMISTON DEVELOPMENT CORP.;IRZ CONSULTING C/O App: S81070		4/12/1996	SUPPLEMENTAL IRRIGATION (Suppl'mtl)									14.7	47.8	47.8	14.7	14.7	47.8	47.8	14.7					

SUBJECT RIGHTS

NOT A RIGHT

Acreage Legend: 12.25 Regular acreage ±2.25 Acreage is on a canceled right (12.25) Acreage is part of a transfer and has not been proven up on yet (inchoate) [12.25] Acreage has been suspended * Acreage is not specified

Water Rights Platcard Report

"TO" LANDS

Pg. 5 of 9

Meridian: WILLAMETTE Township: 3 North Range: 29 East Section: 13 Records per Page: 6 Search

Water Right	Changing Xfers	Priority	Use	Use Status	DLC	Gov't Lot	QQ(40): NE NE	NW NE	SW NE	SE NE	NE NW	NW NW	SW NW	SE NW	NE SW	NW SW	SW SW	SE SW	NE SE	NW SE	SW SE	SE SE	Unkown QQ	
Select App:S 81070 *		4/12/1996	FISH CULTURE																				*	
Additional Info: HERMISTON DEVELOPMENT CORP.;IRZ CONSULTING C/O App: S81070																								
Select Cert:52901 OR CN		2/16/1973	IRRIGATION	CN							30.8	31.6	32.8	30.4										
Additional Info: PRUDENTIAL INSURANCE CO. OF AMERICA App: G5998 Permit: G5215 Cert: 52901																								
Select Cert:53661 CF CN		2/16/1973	IRRIGATION	CN							30.8	31.6	32.8	30.4										
Additional Info: PRUDENTIAL INSURANCE CO. OF AMERICA App: G5998 Permit: G5215 Cert: 53661																								
Select Cert:65485 RR *	T8144, T9043, T7682, T8687, T6775, T9671, T7477	2/16/1973	IRRIGATION								30.8	31.6	32.8	30.4										
Additional Info: RICK HALE App: G5998 Permit: G5215 Cert: 65485																								
Select Cert:80850 RR *	T10095, T9878, T10423	2/16/1973	IRRIGATION								30.8	31.6	32.8	30.4										
Additional Info: RICK HALE App: G5998 Permit: G5215 Cert: 80850																								
Select App:S 81070 *		4/12/1996	SUPPLEMENTAL IRRIGATION (Suppl'mtl)				31.2	31.2	31.3	31.3	40	35.4	40	40							31.2	31.3	31.3	31.2
Additional Info: HERMISTON DEVELOPMENT CORP.;IRZ CONSULTING C/O App: S81070																								

NOT A RIGHT

12

Acreege Legend: 12.25 Regular acreege 12.25 Acreege is on a canceled right (12.25) Acreege is part of a transfer and has not been proven up on yet (Inchoate) [12.25] Acreege has been suspended * Acreege is not specified

NCR

Water Rights Platcard Report

Meridian: Township: North Range: East Section: Records per Page:

Water Right	Changing Xfers	Priority	Use	Use Status	DLC	Gov't Lot	QQ(40): Q(160):	NE NE	NW NE	SW NE	SE NE	NE NW	NW NW	SW NW	SE NW	NE SW	NW SW	SW SW	SE SW	NE SE	NW SE	SW SE	SE SE	Unkown QQ	
Select Inchoate: T 9853 CF (REG) * Additional Info: ECHO IRRIGATION DISTRICT App: G7851		2/25/1977	SUPPLEMENTAL IRRIGATION (Suppl'mtl)										(36.1)	(7.6)											
1 2																									

Acreage Legend: 12.25 Regular acreage ~~12.25~~ Acreage is on a canceled right (12.25) Acreage is part of a transfer and has not been proven up on yet (inchoate) [12.25] Acreage has been suspended * Acreage is not specified

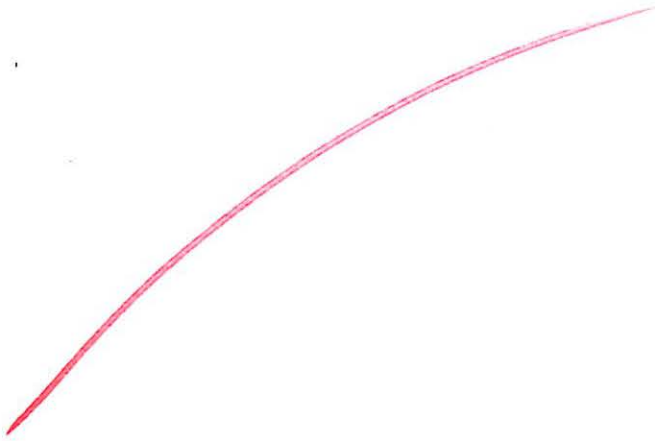

Water Rights Platcard Report

TO LANDS

pg. 5 of 9

Meridian: WILLAMETTE Township: 3 North Range: 29 East Section: 25 Records per Page: 6 Search

Water Right	Changing Xfers	Priority	Use	Use Status	DLC	Gov't Lot	QQ(40):	NE	NW	SW	SE	NE	NW	SW	SE	NE	NW	SW	SE	NE	NW	SW	SE	Unkown
							Q(160):	NE	NE	NE	NE	NW	NW	NW	NW	SW	SW	SW	SW	SE	SE	SE	SE	QQ
Select Permit: G 5970 CN		12/17/1973	SUPPLEMENTAL IRRIGATION (Suppl'mtl)	CN															35	25				
Additional Info: JESS A CORREA App: G6378 Permit: G5970																								

Acreage Legend: 12.25 Regular acreage ~~12.25~~ Acreage is on a canceled right (12.25) Acreage is part of a transfer and has not been proven up on yet (inchoate) [12.25] Acreage has been suspended * Acreage is not specified

No CONFLICTS w/ EXISTING RIGHTS

TOWNSHIP 3N RANGE 29E W. M.

SECTION 13

NE				NW				SW				SE				APPLICATION NUMBER	PERMIT NUMBER	CERTIFICATE NUMBER
NE	NW	SW	SE	NE	NW	SW	SE	NE	NW	SW	SE	NE	NW	SW	SE			
White																G-3963	G-3476	
				30 ⁸	31 ⁶	32 ⁸	30 ⁴	T-0095	CANCELLED				G-5998	G-5215	53661			
				30 ⁸	31 ⁶	32 ⁸	30 ⁴	V45P134	CANCELLED				T-10095	G-5215	32981			
									T-6775				V45P134	G-5315	U5485			
									V.57 P.902				V70P387	G#80850				
									Supp				T-9853	G-5215				
				30 ⁸	31 ⁶	32 ⁸	30 ⁴						V57P902	CA 65482				
													T-6775	G-5215	80850			

Water Rights Platcard Report

"FROM" LANDS pg. 7 of 9

Meridian: WILLAMETTE Township: 3 North Range: 29 East Section: 11 Records per Page: 6 Search

Water Right	Changing Xfers	Priority	Use	Use Status	DLC	Gov't Lot	Q(40): Q(160):	NE NE	NW NE	SW NE	SE NE	NE NW	NW NW	SW NW	SE NW	NE SW	NW SW	SW SW	SE SW	NE SE	NW SE	SW SE	SE SE	Unkown QQ
Select App:S 81070 * Additional Info: HERMISTON DEVELOPMENT CORP.;IRZ CONSULTING C/O App: S81070		4/12/1996	FISH CULTURE																					*
Select Cert:28478 OR CN Additional Info: CLAUDE O MEYERS App: U802 Permit: U714 Cert: 28478		3/25/1955	IRRIGATION CN					40	38.5	26.4	40													
Select Cert:52901 OR CN Additional Info: PRUDENTIAL INSURANCE CO. OF AMERICA App: G5998 Permit: G5215 Cert: 52901		2/16/1973	IRRIGATION CN									30.7	30.7	27.2	26	21.2	25.8	30.5	30.7	20.6	17	38.6	38.6	
Select Cert:53661 CF CN Additional Info: PRUDENTIAL INSURANCE CO. OF AMERICA App: G5998 Permit: G5215 Cert: 53661		2/16/1973	IRRIGATION CN													21.2	25.8	30.5	30.7	6.2	16	38.6	38.6	
Select Cert:56163 CF CN Additional Info: PRUDENTIAL INSURANCE CO. OF AMERICA App: U802 Permit: U714 Cert: 56163		3/25/1955	IRRIGATION CN					40	38.5	26.4	40													
Select Cert:56165 CF CN Additional Info: PRUDENTIAL INSURANCE CO. OF AMERICA App: G5998 Permit: G5215 Cert: 56165		2/16/1973	IRRIGATION CN									30.7	30.7	27.2	26									

1 2 3
 Acreage Legend: 12.25 Regular acreage 12.25 Acreage is on a canceled right (12.25) Acreage is part of a transfer and has not been proven up on yet (inchoate) [12.25] Acreage has been suspended * Acreage is not specified

NO CONFLICT of EXISTING RIGHTS

Water Rights Platcard Report

Meridian: WILLAMETTE Township: 3 North Range: 29 East Section: 11 Records per Page: 6 Search

Water Right	Changing Xfers	Priority	Use	Use Status	DLC	Gov't Lot	QQ(40): Q(160):	NE NE	NW NE	SW NE	SE NE	NE NW	NW NW	SW NW	SE NW	NE SW	NW SW	SW SW	SE SW	NE SE	NW SE	SW SE	SE SE	Unkown QQ
Select Cert:65485 RR * Additional Info: RICK HALE App: G5998 Permit: G5215 Cert: 65485	T8144, T9043, T7682, T8687, T6775, T9671, T7477	2/16/1973	IRRIGATION	CANCELLED												21.2	25.8	30.5	30.7	6.2	16	38.6	38.6	
Select Cert:74762 RR * Additional Info: ROBERT C HALE App: U802 Permit: U714 Cert: 74762		3/25/1955	IRRIGATION					40	36.4	24.4	40									2	0.1			
Select Cert:74898 CF CN Additional Info: ROBERT HALE App: G5998 Permit: G5215 Cert: 74898	T7903, T8144, T8406, T9043, T8687, T6775	2/16/1973	IRRIGATION	CN								30.7	30.7	27.2	26					14.4	±			
Select Inchoate: T 6775 CF (REG) * Additional Info: ROBERT HALE App: G5998 Permit: G5215		2/16/1973	IRRIGATION									(30.7)	(30.7)	(27.2)	(26)					(14.4)	(1)			
Select Cert:80850 RR * Additional Info: RICK HALE App: G5998 Permit: G5215 Cert: 80850	T10095, T9878, T10423	2/16/1973	IRRIGATION													21.2	25.8	30.5	30.7	6.2	16	38.6	38.6	
Select App:S 81070 * Additional Info: HERMISTON DEVELOPMENT CORP.;IRZ CONSULTING C/O App: S81070		4/12/1996	SUPPLEMENTAL IRRIGATION (Suppl'mtl)					40	40	40	40	40	40	36	39.8	29.7	33	40	40	29.3	28.1	38.6	38.6	

Acreege Legend: 12.25 Regular acreage ±2.25 Acreege is on a canceled right (12.25) Acreege is part of a transfer and has not been proven up on yet (Inchoate) [12.25] Acreege has been suspended * Acreege is not specified

Water Rights Platcard Report

Meridian: WILLAMETTE Township: 3 North Range: 29 East Section: 11 Records per Page: 6 Search

Water Right	Changing Xfers	Priority	Use	Use Status	DLC	Gov't Lot	QQ(40): Q(160):	NE NE	NW NE	SW NE	SE NE	NE NW	NW NW	SW NW	SE NW	NE SW	NW SW	SW SW	SE SW	NE SE	NW SE	SW SE	SE SE	Unkown QQ
Select Cert:52901 OR CN Additional Info: PRUDENTIAL INSURANCE CO. OF AMERICA App: G5998 Permit: G5215 Cert: 52901		2/16/1973	SUPPLEMENTAL IRRIGATION (Suppl'mtl)	CN				40	36.4	24.4	39									2	0.1			
Select Cert:56165 CF CN Additional Info: PRUDENTIAL INSURANCE CO. OF AMERICA App: G5998 Permit: G5215 Cert: 56165		2/16/1973	SUPPLEMENTAL IRRIGATION (Suppl'mtl)	CN				40	36.4	24.4	39									2	0.1			
Select Cert:74898 CF CN Additional Info: ROBERT HALE App: G5998 Permit: G5215 Cert: 74898	T7903, T8144, T8406, T9043, T8687, T6775	2/16/1973	SUPPLEMENTAL IRRIGATION (Suppl'mtl)	CN				40	36.4	24.4	39									2	0.1			
Select Inchoate: T 6775 CF (REG) * Additional Info: ROBERT HALE App: G5998 Permit: G5215		2/16/1973	SUPPLEMENTAL IRRIGATION (Suppl'mtl)					(40)	(36.4)	(24.4)	(39)									(2)	(0.1)			

Acreege Legend: 12.25 Regular acreege ~~12.25~~ Acreege is on a canceled right (12.25) Acreege is part of a transfer and has not been proven up on yet (inchoate) [12.25] Acreege has been suspended * Acreege is not specified

Water Rights Platcard Report

"FROM" LANDS

pg. 7 of 9

Meridian: WILLAMETTE Township: 3 North Range: 29 East Section: 12 Records per Page: 6 Search

Water Right	Changing Xfers	Priority	Use	Use Status	DLC	Gov't Lot	Q(40)	Q(160)	NE	NW	SW	SE	NE	NW	SW	SE	NE	NW	SW	SE	NE	NW	SW	SE	Unknown		
Select App:S 81070 *		4/12/1996	FISH CULTURE																						*		
Additional Info: HERMISTON DEVELOPMENT CORP.;IRZ CONSULTING C/O App: S81070																											
Select Cert:28478 OR CN		3/25/1955	IRRIGATION CN								35.2	36.3				1.9											
Additional Info: CLAUDE O MEYERS App: U802 Permit: U714 Cert: 28478																											
Select Cert:37252 OR CN		4/8/1963	IRRIGATION CN						±														0.89				
Additional Info: MARSHALL E MEYERS App: G2588 Permit: G2415 Cert: 37252																											
Select Cert:47094 OR CN		6/8/1971	IRRIGATION CN						39	40	40	39												39.11	40	12.8	22
Additional Info: IVAN COOK App: G5541 Permit: G4969 Cert: 47094																											
Select Cert:52901 OR CN		2/16/1973	IRRIGATION CN										32.6	4.1	3.1	36.7	29.3	23.6	29.8	24.4							
Additional Info: PRUDENTIAL INSURANCE CO. OF AMERICA App: G5998 Permit: G5215 Cert: 52901																											
Select Cert:53661 CF CN		2/16/1973	IRRIGATION CN																								
Additional Info: PRUDENTIAL INSURANCE CO. OF AMERICA App: G5998 Permit: G5215 Cert: 53661																											

1 2 3 4 5

Acreege Legend: 12.25 Regular acreage 12.25 Acreage is on a canceled right (12.25) Acreage is part of a transfer and has not been proven up on yet (inchoate) [12.25] Acreage has been suspended * Acreage is not specified

NCR



Water Rights Platcard Report

Meridian: WILLAMETTE Township: β North Range: 29 East Section: 12 Records per Page: 6 Search

Water Right	Changing Xfers	Priority	Use	Use Status	DLC	Gov't Lot	QQ(40): Q(160):	NE NE	NW NE	SW NE	SE NE	NE NW	NW NW	SW NW	SE NW	NE SW	NW SW	SW SW	SE SW	NE SE	NW SE	SW SE	SE SE	Unknown QQ	
Select Cert:56163 CF CN Additional Info: PRUDENTIAL INSURANCE CO. OF AMERICA App: U802 Permit: U714 Cert: 56163		3/25/1955	IRRIGATION	CN									35.2	36.3			1.9								
Select Cert:56164 CF CN Additional Info: PRUDENTIAL INSURANCE CO. OF AMERICA App: G5541 Permit: G4969 Cert: 56164		6/8/1971	IRRIGATION	CN				39	40	40											39.11	40	12.8	22	
Select Cert:56165 CF CN Additional Info: PRUDENTIAL INSURANCE CO. OF AMERICA App: G5998 Permit: G5215 Cert: 56165		2/16/1973	IRRIGATION	CN								32.6	4.1	3.1	36.7	28.3	23.5								
Select Cert:65485 RR * Additional Info: RICK HALE App: G5998 Permit: G5215 Cert: 65485	T8144, T9043, T7682, T8687, T6775, T9671, T7477	2/16/1973	IRRIGATION	CN													0.1	29.8	24.4						
Select Cert:74762 RR * Additional Info: ROBERT C HALE App: U802 Permit: U714 Cert: 74762		3/25/1955	IRRIGATION										35.2	36.3			1.9								
Select Cert:74896 CF CN Additional Info: ROBERT C HALE App: G2588 Permit: G2415 Cert: 74896	T8406, T7903, T8144, T9671	4/8/1963	IRRIGATION	CN				±			±										0.89				

1 2 3 4 5

Acreage Legend: 12.25 Regular acreage ±2.25 Acreage is on a canceled right (12.25) Acreage is part of a transfer and has not been proven up on yet (inchoate) [12.25] Acreage has been suspended * Acreage is not specified

Water Rights Platcard Report

Meridian: WILLAMETTE Township: 3 North Range: 29 East Section: 12 Records per Page: 6 Search

Water Right	Changing Xfers	Priority	Use	Use Status	DLC	Gov't Lot	QQ(40): Q(160):	NE NE	NW NE	SW NE	SE NE	NE NW	NW NW	SW NW	SE NW	NE SW	NW SW	SW SW	SE SW	NE SE	NW SE	SW SE	SE SE	Unkwnn QQ	
Select Cert:74897 CF CN Additional Info: ROBERT HALE App: G5541 Permit: G4969 Cert: 74897	T8144, T9043, T8406, T7903, T8687, T6775, T9671	6/8/1971	IRRIGATION	CN				39	40	40	39									39.11	40	12.8	22		
Select Cert:74898 CF CN Additional Info: ROBERT HALE App: G5998 Permit: G5215 Cert: 74898	T7903, T8144, T8406, T9043, T8687, T6775	2/16/1973	IRRIGATION	CN								32.6	4.1	3.1	36.7	28.3	23.5								
Select Inchoate: T 6775 CF (REG) * Additional Info: ROBERT HALE App: G5998 Permit: G5215		2/16/1973	IRRIGATION									(32.6)	(4.1)	(3.1)	(36.7)	(28.3)	(23.5)								
Select Inchoate: T 6787 CF (REG) * Additional Info: DOUGLAS HALE App: G2588 Permit: G2415		4/8/1963	IRRIGATION					(1)												(0.89)					
Select Inchoate: T 9043 (ALT) RJ Additional Info: ECHO IRRIGATION DISTRICT App: G5541 Permit: G4969		6/8/1971	IRRIGATION	RJ				(39)	(40)	(40)	(39)									(39.11)	(40)	(12.8)	(22)		
Select Cert:80851 RR * Additional Info: ROBERT HALE App: G5541 Permit: G4969 Cert: 80851	T10095, T9878, T10423	6/8/1971	IRRIGATION					39	40	40	39									39.11	40	12.8	22		

1 2 3 4 5

Acreege Legend: 12.25 Regular acreege ~~12.25~~ Acreege is on a canceled right (12.25) Acreege is part of a transfer and has not been proven up on yet (inchoate) [12.25] Acreege has been suspended * Acreege is not specified

Water Rights Platcard Report

Meridian: WILLAMETTE Township: 3 North Range: 29 East Section: 12 Records per Page: 6 Search

Water Right	Changing Xfers	Priority	Use	Use Status	DLC	Gov't Lot	QQ(40): Q(160):	NE NE	NW NE	SW NE	SE NE	NE NW	NW NW	SW NW	SE NW	NE SW	NW SW	SW SW	SE SW	NE SE	NW SE	SW SE	SE SE	Unkown QQ	
Select Cert:80850 RR *	T10095, T9878, T10423	2/16/1973	IRRIGATION															0.1	29.8	24.4					
Additional Info: RICK HALE App: G5998 Permit: G5215 Cert: 80850		SUBJECT RIGHT																							
Select App:S 81070 *		4/12/1996	SUPPLEMENTAL IRRIGATION (Suppl'mtl)					40	40	40	40	40	39.3	39.4	40	39.8	35.4	29.8	28.5	40	40	12.8	22		
Additional Info: HERMISTON DEVELOPMENT CORP.;IRZ CONSULTING C/O App: S81070		NOT A RIGHT																							
Select Cert:47094 OR CN		6/8/1971	SUPPLEMENTAL CN IRRIGATION (Suppl'mtl)					±			±										0.89				
Additional Info: IVAN COOK App: G5541 Permit: G4969 Cert: 47094																									
Select Cert:52901 OR CN		2/16/1973	SUPPLEMENTAL CN IRRIGATION (Suppl'mtl)										27.6	32.8				1.9							
Additional Info: PRUDENTIAL INSURANCE CO. OF AMERICA App: G5998 Permit: G5215 Cert: 52901																									
Select Cert:56164 CF CN		6/8/1971	SUPPLEMENTAL CN IRRIGATION (Suppl'mtl)					±			±										0.89				
Additional Info: PRUDENTIAL INSURANCE CO. OF AMERICA App: G5541 Permit: G4969 Cert: 56164																									
Select Cert:56165 CF CN		2/16/1973	SUPPLEMENTAL CN IRRIGATION (Suppl'mtl)										27.6	32.8				1.9							
Additional Info: PRUDENTIAL INSURANCE CO. OF AMERICA App: G5998 Permit: G5215 Cert: 56165																									

1 2 3 4 5

Acreege Legend: 12.25 Regular acreege ±2.25 Acreege is on a canceled right (12.25) Acreege is part of a transfer and has not been proven up on yet (inchoate) [12.25] Acreege has been suspended * Acreege is not specified

Water Rights Platcard Report

Meridian: WILLAMETTE Township: 3 North Range: 29 East Section: 12 Records per Page: 6 Search

Water Right	Changing Xfers	Priority	Use	Use Status	DLC	Gov't Lot	QQ(40): Q(160):	NE NE	NW NE	SW NE	SE NE	NE NW	NW NW	SW NW	SE NW	NE SW	NW SW	SW SW	SE SW	NE SE	NW SE	SW SE	SE SE	Unkown QQ
<u>Select</u> Cert:74897 CF CN <u>Additional Info:</u> ROBERT HALE App: G5541 Permit: G4969 Cert: 74897	T8144, T9043, T8406, T7903, T8687, T6775, T9671	6/8/1971	SUPPLEMENTAL IRRIGATION (Suppl'mtl)	CN				±			±									0.89				
<u>Select</u> Cert:74898 CF CN <u>Additional Info:</u> ROBERT HALE App: G5998 Permit: G5215 Cert: 74898	T7903, T8144, T8406, T9043, T8687, T6775	2/16/1973	SUPPLEMENTAL IRRIGATION (Suppl'mtl)	CN								27.6	32.8				1.9							
<u>Select</u> Inchoate: T 6775 CF (REG) * <u>Additional Info:</u> ROBERT HALE App: G5998 Permit: G5215		2/16/1973	SUPPLEMENTAL IRRIGATION (Suppl'mtl)									(27.6)	(32.8)				(1.9)							
<u>Select</u> Inchoate: T 9043 (ALT) RJ <u>Additional Info:</u> ECHO IRRIGATION DISTRICT App: G5541 Permit: G4969		6/8/1971	SUPPLEMENTAL IRRIGATION (Suppl'mtl)	RJ				(±)			(±)									(0.89)				
<u>Select</u> Cert:80851 RR * <u>Additional Info:</u> ROBERT HALE App: G5541 Permit: G4969 Cert: 80851	T10095, T9878, T10423	6/8/1971	SUPPLEMENTAL IRRIGATION (Suppl'mtl)					1			1									0.89				

1 2 3 4 5

Acreege Legend: 12.25 Regular acreege ~~12.25~~ Acreege is on a canceled right (12.25) Acreege is part of a transfer and has not been proven up on yet (inchoate) [12.25] Acreege has been suspended * Acreege is not specified

Water Rights Platcard Report

"FROM" LANDS

pg. 7 of 9

Meridian: WILLAMETTE Township: 3 North Range: 29 East Section: 14 Records per Page: 6 Search

Water Right	Changing Xfers	Priority	Use	Use Status	DLC	Gov't Lot	QQ(40): Q(100):	NE NE	NW NE	SW NE	SE NE	NE NW	NW NW	SW NW	SE NW	NE SW	NW SW	SW SW	SE SW	NE SE	NW SE	SW SE	SE SE	Unknown QQ
Select App:S 81070 *		4/12/1996	FISH CULTURE																					*
Additional Info: HERMISTON DEVELOPMENT CORP.;IRZ CONSULTING C/O App: S81070																								
Select Cert:52901 OR CN		2/16/1973	IRRIGATION CN				38.6	40	40	38	39.8	33.6	33.5	39	31.7	26.9	20.4	26						
Additional Info: PRUDENTIAL INSURANCE CO. OF AMERICA App: G5998 Permit: G5215 Cert: 52901																								
Select Cert:53661 CF CN		2/16/1973	IRRIGATION CN				38.6	40	40	38	39.8	33.6	33.5	39	31.7	26.9	20.4	26						
Additional Info: PRUDENTIAL INSURANCE CO. OF AMERICA App: G5998 Permit: G5215 Cert: 53661																								
Select Cert:65485 RR *		2/16/1973	IRRIGATION				30.4	40	40	38	39.8	33.6	33.5	39	31.7	26.9	20.4	26						
Additional Info: RICK HALE App: G5998 Permit: G5215 Cert: 65485 <i>CANCELED by</i>																								
Select Cert:80850 RR *		2/16/1973	IRRIGATION				30.4	40	40	38	39.8	33.6	33.5	39	31.7	26.9	20.4	26						
Additional Info: RICK HALE App: G5998 Permit: G5215 Cert: 80850 <i>SUBJECT RIGHT</i>																								
Select Inchoate: T 9853 CF (REG) *		2/25/1977	IRRIGATION										(6.5)			(6.4)				(30.6)				
Additional Info: ECHO IRRIGATION DISTRICT App: G7851 <i>OKAY</i>																								

12

Acreege Legend: 12.25 Regular acreege ~~12.25~~ Acreege is on a canceled right (12.25) Acreege is part of a transfer and has not been proven up on yet (inchoate) [12.25] Acreege has been suspended * Acreege is not specified

NCR

Water Rights Platcard Report

Meridian: Township: North East Section: Records per Page:

Water Right	Changing Xfers	Priority	Use	Use Status	DLC	Gov't Lot	QQ(40): Q(160):	NE	NW	SW	SE	NE	NW	SW	SE	NE	NW	SW	SE	NE	NW	SW	SE	Unkown
								NE	NE	NE	NE	NW	NW	NW	NW	SW	SW	SW	SW	SE	SE	SE	SE	QQ
Select App:S 81070 * Additional Info: HERMISTON DEVELOPMENT CORP.;IRZ CONSULTING C/O App: S81070		4/12/1996	SUPPLEMENTAL IRRIGATION (Suppl'mtl)					40	40	40	40	39.8	40	40	39	40	40	40	40					

NOT A RIGHT

Acreage Legend: 12.25 Regular acreage
 ~~12.25~~ Acreage is on a canceled right
 (12.25) Acreage is part of a transfer and has not been proven up on yet (inchoate)
 [12.25] Acreage has been suspended
 * Acreage is not specified

Water Rights Platcard Report

"TO" LANDS

pg. 8 of 9

Meridian: WILLAMETTE Township: 3 North Range: 29 East Section: 13 Records per Page: 6 Search

Water Right	Changing Xfers	Priority	Use	Use Status	DLC	Gov't Lot	QQ(40): Q(160)	NE NE	NW NE	SW NE	SE NE	NE NW	NW NW	SW NW	SE NW	NE SW	NW SW	SW SW	SE SW	NE SE	NW SE	SW SE	SE SE	Unkown QQ		
Select App:S 81070 *		4/12/1996	FISH CULTURE																					*		
Additional Info: HERMISTON DEVELOPMENT CORP.;IRZ CONSULTING C/O App: S81070																										
Select Cert:52901 OR CN		2/16/1973	IRRIGATION	CN								30.8	31.6	32.8	30.4											
Additional Info: PRUDENTIAL INSURANCE CO. OF AMERICA App: G5998 Permit: G5215 Cert: 52901																										
Select Cert:53661 CF CN		2/16/1973	IRRIGATION	CN								30.8	31.6	32.8	30.4											
Additional Info: PRUDENTIAL INSURANCE CO. OF AMERICA App: G5998 Permit: G5215 Cert: 53661																										
Select Cert:65485 RR *	T8144, T9043, T7682, T8687, T6775, T9671, T7477	2/16/1973	IRRIGATION									30.8	31.6	32.8	30.4											
Additional Info: RICK HALE App: G5998 Permit: G5215 Cert: 65485																										
Select Cert:80850 RR *	T10095, T9878, T10423	2/16/1973	IRRIGATION									30.8	31.6	32.8	30.4											
Additional Info: RICK HALE App: G5998 Permit: G5215 Cert: 80850																										
Select App:S 81070 *		4/12/1996	SUPPLEMENTAL IRRIGATION (Suppl'mtl)					31.2	31.2	31.3	31.3	40	35.4	40	40								31.2	31.3	31.3	31.2
Additional Info: HERMISTON DEVELOPMENT CORP.;IRZ CONSULTING C/O App: S81070																										

Acreage Legend: 12.25 Regular acreage 12.25 Acreage is on a canceled right (12.25) Acreage is part of a transfer and has not been proven up on yet (inchoate) [12.25] Acreage has been suspended * Acreage is not specified

NCR = NO CONFLICTS w/ EXISTING RIGHTS

Water Rights Platcard Report

Meridian: Township: North Range: East Section: Records per Page:

Water Right	Changing Xfers	Priority	Use	Use Status	DLC	Gov't Lot	QQ(40): Q(160):	NE NE	NW NE	SW NE	SE NE	NE NW	NW NW	SW NW	SE NW	NE SW	NW SW	SW SW	SE SW	NE SE	NW SE	SW SE	SE SE	Unkown QQ	
Select Inchoate: T 9853 CF (REG) * Additional Info: ECHO IRRIGATION DISTRICT App: G7851		2/25/1977	SUPPLEMENTAL IRRIGATION (Suppl'mtl)										(36.1)	(7.6)											
1 2																									

Acreage Legend: 12.25 Regular acreage ~~12.25~~ Acreage is on a canceled right (12.25) Acreage is part of a transfer and has not been proven up on yet (inchoate) [12.25] Acreage has been suspended * Acreage is not specified

Water Rights Platcard Report

08 **TO** 20
LANDS

Meridian: Township: North Range: East Section: Records per Page:

Water Right	Changing Xfers	Priority	Use	Use Status	DLC	Gov't Lot	QQ(40): Q(160):	NE NE	NW NE	SW NE	SE NE	NE NW	NW NW	SW NW	SE NW	NE SW	NW SW	SW SW	SE SW	NE SE	NW SE	SW SE	SE SE	Unkown QQ	
Select Inchoate: T 9853 CF (REG) * Additional Info: ECHO IRRIGATION DISTRICT App: G7851		2/25/1977	SUPPLEMENTAL IRRIGATION (Suppl'mtl)										(36.1)	(7.6)											
1 2																									

Acreage Legend: 12.25 Regular acreage ~~12.25~~ Acreage is on a canceled right (12.25) Acreage is part of a transfer and has not been proven up on yet (inchoate) [12.25] Acreage has been suspended * Acreage is not specified

NCR

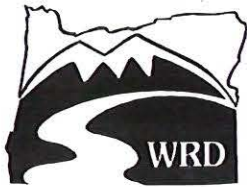

2007

OAR Chapter 690, Division 385
District Temporary Transfer Application
 Duration: One Irrigation Season

District: Echo Irrigation District

Contact Person: Bill Porfily Phone: (541) 449-1327

Mailing Address: P.O. Box 110, Hermiston, Oregon 97838

I. Pursuant to ORS 540.570 and OAR Chapter 690, Division 385, the district proposes to change the place of use for the following water rights:

1st of 3 Primary Water Rights

WATER RIGHT			
PERMIT NUMBER	CERTIFICATE NUMBER	DECREE (name, volume, and page)	PRIMARY (P) or SUPP (S)
G-4969	80851	Robert C., Rick L., & Douglas L. Hale	P

II. The point(s) of diversion for the water right proposed for transfer are as follows:

POINT(S) OF DIVERSION / APPROPRIATION				
PERMIT	DECREE or CERTIFICATE	POD#	SOURCE	LOCATION - LEGAL DESCRIPTION
G-4969	80851	H-1	Hale's Well #1	4340' N & 1830' W from S1/4 Cor Sec 7, T3N, R30E WM
G-4969	80851	H-2	Hale's Well #2	2010' N & 1330' E from SW Cor Sec 6, T3N, R30E WM
G-4969	80851	H-3	Hale's Well #3	1420'S & 40' E from W1/4 Cor Sec 7, T3N, R30E WM
G-4969	80851	H-4	Hale's Well #4	180' N & 260' W from E1/4 Cor Sec 2, T3N, R29E WM
G-4969	80851	H-6	Hale's Well #6	132' N & 2190' W from E1/4 Cor Sec 11, T3N, R29E WM
G-4969	80851	H-7	Hale's Well #7	1010' S & 40' E from NW Cor Sec 12, T3N, R29 E WM

III. The district proposes to change the place of use from the authorized location listed in Table 1 to the location listed in Table 2.

1 10423

RECEIVED

JUN 28 2007

WATER RESOURCES DEPT
 SALEM, OREGON

TABLE 1. – AUTHORIZED PLACE OF USE

WATER RIGHT		Primary PRIORITY DATE	USE	POD #	LEGAL DESCRIPTION							ACRES	USER NAME
Cert/Decree PRIMARY	Cert/Perm SUPP				TWP	RNG	SEC	QQ	DLC	GOV'T LOT	TAX LOT		
80851		6/8/71	Irr	H-1, H-2, H-3, H-4, H-6, & H-7,	3N	30 E WM	6	NE NW			703	30.0*	Hales Bros Farms
80851		6/8/71	Irr	H-1, H-2, H-3, H-4, H-6, & H-7,	3N	30 E WM	6	SE NW			703	36.31*	Hales Bros Farms
											Total	66.31	

*These areas are described in Permit G-8907. Permit G-8907 was allocated no water in the Stage Gulch Critical Groundwater Order, thus we will not describe or use this water right under this temporary transfer.

RECEIVED

JUN 28 2007

WATER RESOURCES DEPT
SALEM, OREGON

TABLE 2. – PROPOSED PLACE OF USE

WATER RIGHT		Primary PRIORITY DATE	USE	POD #	LEGAL DESCRIPTION							ACRES	USER NAME
Cert/Decree PRIMARY	Cert/Perm SUPP				TWP	RNG	SEC	QQ	DLC	GOV'T LOT	TAX LOT		
80851		6/8/71	Irr	H-1, H-2, H-3, H-4, H-6, & H-7,	3N	30 E WM	8	NE SW			802	6.31	Hales Bros Farms
80851		6/8/71	Irr	H-1, H-2, H-3, H-4, H-6, & H-7,	3N	30 E WM	8	NW SW			802	30.0	Hales Bros Farms
80851		6/8/71	Irr	H-1, H-2, H-3, H-4, H-6, & H-7,	3N	30 E WM	8	SW SW			802	30.0	Hales Bros Farms
											Total	66.31	

1 10423

2nd of 3 Primary Water Rights

I. Pursuant to ORS 540.570 and OAR Chapter 690, Division 385, the district proposes to change the place of use for the following water rights:

WATER RIGHT			
PERMIT NUMBER	CERTIFICATE NUMBER	DECREE (name, volume, and page)	PRIMARY (P) or SUPP (S)
G-6626	80849	Kenneth Coppinger	P

II. The point(s) of diversion for the water right proposed for transfer are as follows:

POINT(S) OF DIVERSION / APPROPRIATION				
PERMIT	DECREE or CERTIFICATE	POD#	SOURCE	LOCATION - LEGAL DESCRIPTION
G-6626	80849	C-1	Coppinger Well #1	20' N & 1570' W from E1/4 Cor Sec 24, T3N, R29E WM*
G-6626	80849	C-2	Coppinger Well #2	960' N & 30' W from E1/4 Cor Sec 24, T3N, R29E WM*
G-6626	80849	* New C-1	Coppinger Well New #1	20' N & 1490' W from E1/4 Cor Sec 24, T3N, R29E WM*

***We propose Coppinger's New #1 to be an Additional POA during this temporary transfer.**

III. The district proposes to change the place of use from the authorized location listed in Table 1 to the location listed in Table 2.

f 10423

RECEIVED
JUN 28 2007
WATER RESOURCES DEPT
SALEM, OREGON

TABLE 1. – AUTHORIZED PLACE OF USE

WATER RIGHT		Primary PRIORITY DATE	USE	POD #	LEGAL DESCRIPTION							ACRES	USER NAME
Cert/Decree PRIMARY	Cert/Perm SUPP				TWP	RNG	SEC	QQ	DLC	GOV'T LOT	TAX LOT		
80849		12/29/75	Irr	*C-1	3N	29E WM	24	NE NE			8600	9.0	Kenneth Coppinger
80849		12/29/75	Irr	*C-1	3N	29E WM	24	NW NE			8600	9.0	Kenneth Coppinger
80849		12/29/75	Irr	*C-1	3N	29E WM	24	SW NE			8600	9.0	Kenneth Coppinger
80849		12/29/75	Irr	*C-1	3N	29E WM	24	SE NE			8600	9.0	Kenneth Coppinger
80849		12/29/75	Irr	*C-1	3N	29E WM	24	NE SE			8700	37.1	Kenneth Coppinger
80849		12/29/75	Irr	*C-1	3N	29E WM	24	NW SE			8700	26.0	Kenneth Coppinger
80849		12/29/75	Irr	*C-1	3N	29E WM	24	SW SE			8700	9.0	Kenneth Coppinger
80849		12/29/75	Irr	*C-1	3N	29E WM	24	SE SE			8700	9.0	Kenneth Coppinger
80849		12/29/75	Irr	*C-1	3N	30E WM	19	NE NW			2601	27.5	Kenneth Coppinger
80849		12/29/75	Irr	*C-1	3N	30E WM	19	NW NW			2601	13.2	Kenneth Coppinger
80849		12/29/75	Irr	*C-1	3N	30E WM	19	SW NW			2601	13.6	Kenneth Coppinger
80849		12/29/75	Irr	*C-1	3N	30E WM	19	SE NW			2601	26.7	Kenneth Coppinger
80849		12/29/75	Irr	*C-1	3N	30E WM	19	NE SW			2600	28.5	Kenneth Coppinger
80849		12/29/75	Irr	*C-1	3N	30E WM	19	NW SW			2600	8.1	Kenneth Coppinger
80849		12/29/75	Irr	*C-1	3N	30E WM	19	SW SW			2600	9.2	Kenneth Coppinger
80849		12/29/75	Irr	*C-1	3N	30E WM	19	SE SW			2600	26.4	Kenneth Coppinger
											Total	270.3	

***We propose Coppinger's New #1 to be an Additional POA during this temporary transfer.**

RECEIVED

JUN 28 2007

**WATER RESOURCES DEPT
SALEM, OREGON**

10422

TABLE 2. – PROPOSED PLACE OF USE

WATER RIGHT		Primary PRIORITY	USE	POD #	LEGAL DESCRIPTION							ACRES	USER NAME
Cert/Decree	Cert/Perm				TWP	RNG	SEC	QQ	DLC	GOV'T LOT	TAX LOT		
PRIMARY	SUPP	DATE											
80849		12/29/75	Irr	New C-1	3N	29E WM	13	NE NE			3700	30.0	Hale Bros. Farms
	80849	12/29/75	Irr	New C-1	3N	29E WM	13	SW NE			3700	29.5*	Hale Bros. Farms
80849		12/29/75	Irr	New C-1	3N	29E WM	13	SE NE			3700	30.0	Hale Bros. Farms
80849		12/29/75	Irr	New C-1	3N	29E WM	13	NE SE			3700	30.2	Hale Bros. Farms
80849		12/29/75	Irr	New C-1	3N	29E WM	13	NW SE			3700	30.2	Hale Bros. Farms
80849		12/29/75	Irr	New C-1	3N	29E WM	13	SW SE			3700	30.2	Hale Bros. Farms
80849		12/29/75	Irr	New C-1	3N	29E WM	13	SE SE			3700	30.2	Hale Bros. Farms
80849		12/29/75	Irr	New C-1	3N	29E WM	25	NE NE			8800	30.0	Hale Bros. Farms
80849		12/29/75	Irr	New C-1	3N	29E WM	25	NW NE			8800	30.0	Hale Bros. Farms
											Total	270.3	

*** This 29.5 acres of Certificate 80849 will become supplemental to permit G-7183 certificate 79889 in 2007 Private Temporary Transfer, Cook to Echo Irrigation District.**

RECEIVED
JUN 28 2007
WATER RESOURCES DEPT
SALEM, OREGON

110423

3rd of 3 Primary Water Rights

I. Pursuant to ORS 540.570 and OAR Chapter 690, Division 385, the district proposes to change the place of use for the following water rights:

WATER RIGHT			
PERMIT NUMBER	CERTIFICATE NUMBER	DECREE (name, volume, and page)	PRIMARY (P) or SUPP (S)
G-5215	80850	H-4 Farms, Inc	P

II. The point(s) of diversion for the water right proposed for transfer are as follows:

POINT(S) OF DIVERSION / APPROPRIATION				
PERMIT	DECREE or CERTIFICATE	POD#	SOURCE	LOCATION - LEGAL DESCRIPTION
G-5215	80850	H-5	Hale's Well #5	60' N & 590' W from SE Cor Sec 11, T3N, R29E WM
G-5215	80850	H-8	Hale's Well #8	1350' S & 50' W from NE Cor NW1/4 NW1/4 Sec 14, T3N, R29E WM
		New C-1	Coppinger Well #1	20' N & 1490' W from E1/4 Cor Sec 24, T3N, R29E WM
		H- 3**	Hale's Well #3	1420'S & 40' E from W1/4 Cor Sec 7, T3N, R30E WM

***Propose as an Additional POA**

**** We propose Hale's Well #3 to be the Point of Appropriation for the 53.69 acres located in the E1/2 SW1/4 Section 8, T3N, R30, WM . Hale 's Well #3 is recognized as being in the same Sub Areas (H) as Hale's Well, #8, in the Stage Gulch Critical Ground Water Order. We propose Well #3 to be an Additional POA during this Temporary Transfer.**

III. The district proposes to change the place of use from the authorized location listed in Table 1 to the location listed in Table 2.

1 10423

TABLE 1. – AUTHORIZED PLACE OF USE

WATER RIGHT		Primary PRIORITY	USE	POD #	LEGAL DESCRIPTION							ACRES	USER NAME
Cert/Decree	Cert/Perm				TWP	RNG	SEC	QQ	DLC	GOV'T LOT	TAX LOT		
PRIMARY	SUPP	DATE											
80850		2/16/73	Irr	H-5, H-8,	3N	29E WM	11	NE SE			3603	2.0	Hale's Bro's Farms
80850		2/16/73	Irr	H-5, H-8,	3N	29E WM	11	SE SE			3603	5.0	Hale's Bro's Farms
80850		2/16/73	Irr	H-5, H-8,	3N	29E WM	12	SW SW			3603	29.8	Hale's Bro's Farms
80850		2/16/73	Irr	H-5, H-8,	3N	29E WM	12	SE SW			3603	2.89	Hale's Bro's Farms
80850		2/16/73	Irr	H-5, H-8,	3N	29E WM	14	NW NE			3900	9.3	Hale's Bro's Farms
80850		2/16/73	Irr	H-5, H-8,	3N	29E WM	14	SW NE			3900	9.3	Hale's Bro's Farms
80850		2/16/73	Irr	H-5, H-8,	3N	29E WM	14	SE NE			3900	7.3	Hale's Bro's Farms
80850		2/16/73	Irr	H-5, H-8,	3N	29E WM	14	NE NW			3900	9.3	Hale's Bro's Farms
80850		2/16/73	Irr	H-5, H-8,	3N	29E WM	14	SE NW			3900	8.8	Hale's Bro's Farms
											Total	83.69	

RECEIVED

JUN 28 2007

**WATER RESOURCES DEPT
SALEM, OREGON**

I 10425

TABLE 2. – PROPOSED PLACE OF USE

WATER RIGHT		Primary PRIORITY	USE	POD #	LEGAL DESCRIPTION							ACRES	USER NAME	
Cert/Decree	Cert/Perm				TWP	RNG	SEC	QQ	DLC	GOVT LOT	TAX LOT			
PRIMARY	SUPP	DATE												
80850		2/16/73	Irr	H-5, H-8, & New C-1	3N	29E WM	13	NW NE				3700	30.0	Hale's Bro's Farms
80850		2/16/73	Irr	H-3	3N	30E WM	8	NE SW				802	23.69	Hale's Bro's Farms
80850		2/16/73	Irr	H-3	3N	30E WM	8	SE SW				802	30.0	Hale's Bro's Farms
												Total	83.69	

RECEIVED
JUN 28 2007
WATER RESOURCES DEPT
SALEM, OREGON

10423

- IV. Enclosed is a map for each proposed change in place of use meeting the standards of OAR Chapter 690, Division 385.
- V. The water right proposed for transfer is a water right subject to transfer and has not been forfeited for nonuse under ORS 540.610.
- VI. Each user affected by the proposed transfer has provided written authorization for the transfer and such authorization is on file with the district.
- VII. The district has notified each affected user that the Department may condition or reject the transfer at any time to the extent necessary to avoid injury to an existing water right, and that the use of water on lands from which the water right is transferred (authorized place of use) and at the proposed place of use during the same irrigation season or calendar year may subject both the user and district to civil penalties.
- VIII. Enclosed is the application fee in the amount of: \$281 .

I certify that the information contained in this district permanent transfer application is true and accurate.

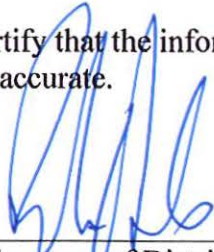

Signature of District Manager
or Authorized Representative



Date

Robert C. Hale

Typed Name of District Manager
or Authorized Representative

1 10423



Oregon

Theodore R. Kulongoski, Governor

Water Resources Department

North Mall Office Building
725 Summer Street NE, Suite A
Salem, OR 97301-1266
503-986-0900
FAX 503-986-0904

July 2, 2007

ECHO IRRIGATION DISTRICT
PO BOX 110
HERMISTON OR 97838

Reference: District Temporary Transfer 10423

On June 28, 2007 we received your district transfer application. The application was accompanied by \$281.00 and \$24.07. Our receipts 88397 and 88473 are enclosed.

By copy of this letter, we are asking the Watermaster for a report regarding the potential for injury to existing water rights which may be caused by the change.

The district may begin delivering water to the proposed place of use immediately provided that water has not been delivered to the existing, authorized place of use during this season. Pursuant to OAR 690-385-3000(4), the district and water user may be subject to civil penalties and the loss of use of the water if deliveries are made to both the existing and proposed places of use during any one season.

We will notify you if additional information or corrections to the application or map are required.

If you have any questions, please call the Transfer Section, (503)986-0900.

cc: Watermaster #5

enclosure



Oregon

Theodore R. Kulongoski, Governor

Water Resources Department

725 Summer Street NE, Suite A

Salem, OR 97301-1271

503-986-0900

FAX 503-986-0904

Notice of Application for Water Right Transfer, Temporary Transfer, or Permit Amendment 07/03/2007

The Department seeks comment on the recently-filed application listed below. Any person may comment on the application. Comments must be received by the Department within 30 days of the date of this notice. The Director may presume that the transfer would be allowed by, and compatible with comprehensive plans unless an affected local government informs the Director otherwise within 30 days of this notice.

County: Umatilla
Transfer: T -10423
Water Right: Cert:80849 CF *, Cert:80851 RR *, Cert:80850 RR
Priority Date: 1971, 1975, 1973
Name: ECHO IRRIGATION DISTRICT
Address: PO BOX 110; HERMISTON OR 97838
Change: POU
Source: A WELL > STAGE GULCH
Authorized POU: T3N R30E 6,19
T3N R29E 11,12,14,24
Proposed POU: T3N R30E 8
T3N R29E 13,25

The holder of a water right may apply to permanently change an existing water use subject to transfer. A transfer application may involve any of the following changes: Point of diversion or appropriation (POD; POA); Additional point of diversion or appropriation (APOD; APOA); Historic POD (HIST); Place of use (POU); Character of use (USE); Instream (ISWR); Substitution (SUB); or Exchange (EXCH).

The holder of a water right subject to transfer may request to temporarily change the place of use of the water for up to 5 years and, if necessary to convey the water, to temporarily change the point of diversion or appropriation.

The holder of a water right permit may apply to change a point of diversion (POD) or appropriation (POA) or to change the place of use (POU).

Any person who provides comments within the comment period will receive a copy of the Department's preliminary determination of whether the application should be approved or rejected after the Department has completed a review of the application and will be provided an opportunity to protest the application and preliminary determination at that time. Comments should be sent to the Transfers Section at the Department's Salem office.

2007 ECHO IRRIGATION DISTRICT TEMPORARY TRANSFERS

P.O.A. AS REFERENCED IN APPLICATION

T 10424
T 10423

WELL LEGEND	
H-1	HALE NO ① 4340'N + 1830'W FROM S1/4 COR, SEC 7 T3N R 30E W.M.
H-2	HALE NO ② 2010'N + 1330'E FROM SW COR, SEC 6 T3N R 30E W.M.
H-3	HALE NO ③ 1420'S + 40'E FROM W1/4 COR, SEC 7 T3N R 30E W.M.
H-4	HALE NO ④ 180'N + 260'W FROM E1/4 COR, SEC 2 T3N R 29E W.M.
H-5	HALE NO ⑤ 60'N + 590'W FROM SE COR, SEC 11 T3N R 29E W.M.
H-6	HALE NO ⑥ 132'N + 2190'W FROM E1/4 COR, SEC 11 T3N R 29E W.M.
H-7	HALE NO ⑦ 1010'S + 40'E FROM NW COR, SEC 12 T3N R 29E W.M.
H-8	HALE NO ⑧ 1350'S + 50'W FROM NE COR NW 1/4 NW 1/4 SEC 14 T3N R 29E W.M.

AUTHORIZED C-1	COPPINGER NO ① 20'N + 1570'W FROM E1/4 COR, SEC 24 T3N R 29E W.M.**
PROPOSED C-1	COPPINGER NO ① 20'N + 1490'W FROM E1/4 COR, SEC 24 T3N R 29E W.M.**
C-2	COPPINGER NO ② 960'N + 30'W FROM E1/4 COR, SEC 24 T3N R 29E W.M.
C-3	COPPINGER NO ③ 3960'N + 1320'W FROM SE COR, SEC 23 T3N R 29E W.M.

PROPOSED NEW P.O.A. UNDER THIS TEMPORARY TRANSFER
** NEW LOCATION OF COPPINGER WELL NO 1

NOTE:
THE AREA H OF THE STAGE GULCH CRITICAL GROUND WATER ORDER ALLOCATES NO WATER FOR PERMIT G-8907. THE AREAS DESCRIBED IN PERMIT G-8907 THAT ARE ALSO INVOLVED IN THIS TEMPORARY TRANSFER WILL NOT BE IRRIGATED UNDER THE AUTHORIZATION OF PERMIT G-8907.

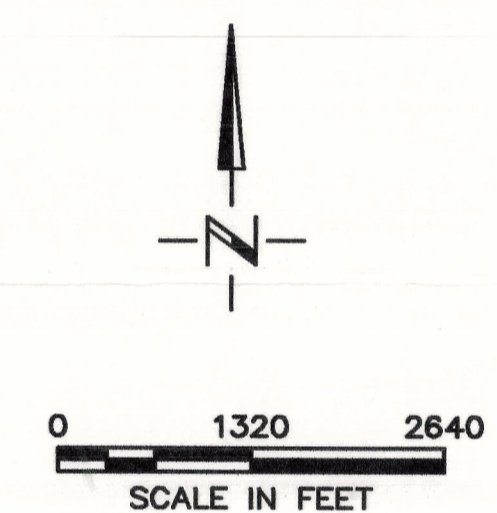
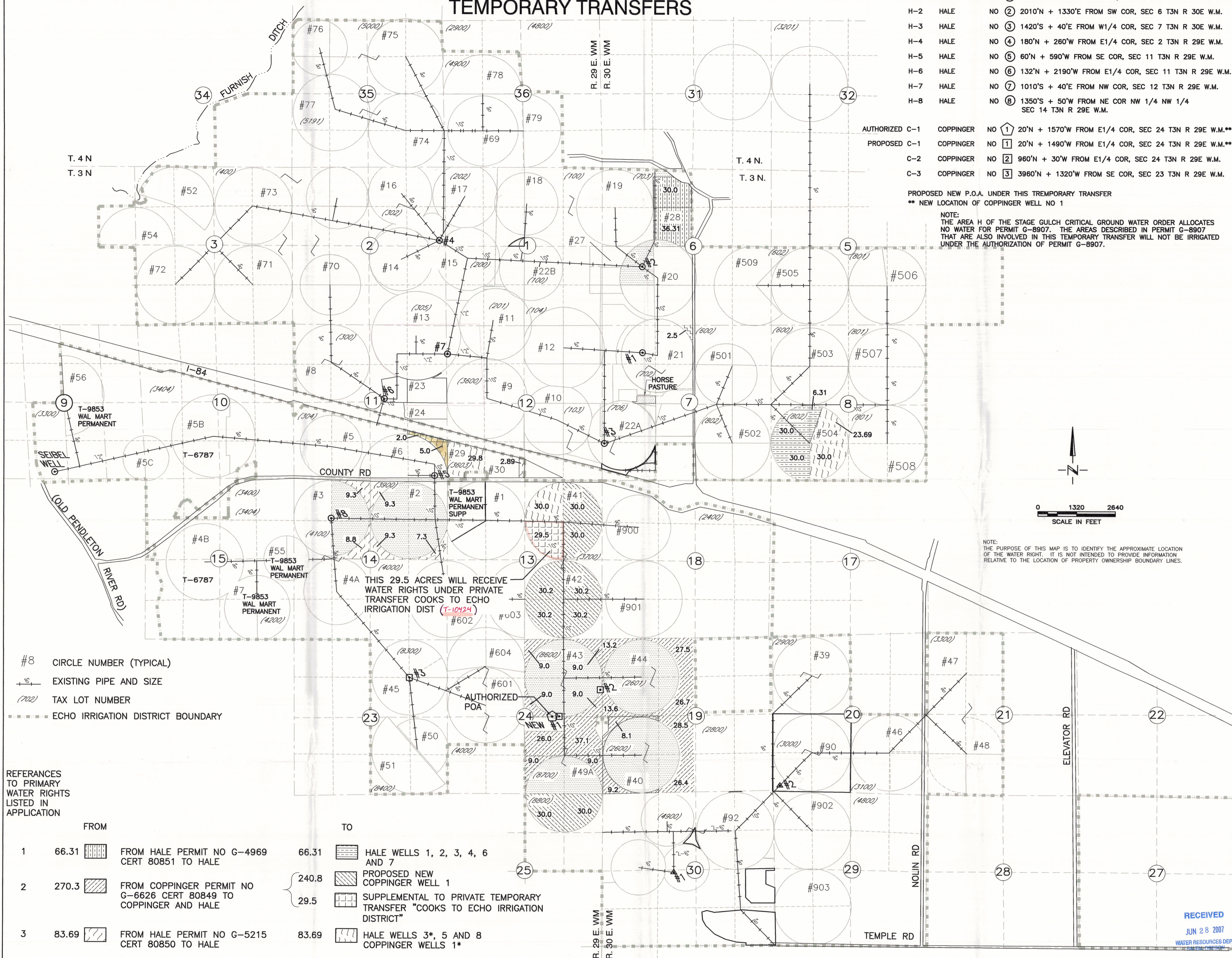

NOTE:
THE PURPOSE OF THIS MAP IS TO IDENTIFY THE APPROXIMATE LOCATION OF THE WATER RIGHT. IT IS NOT INTENDED TO PROVIDE INFORMATION RELATIVE TO THE LOCATION OF PROPERTY OWNERSHIP BOUNDARY LINES.

- #8 CIRCLE NUMBER (TYPICAL)
- EXISTING PIPE AND SIZE
- (702) TAX LOT NUMBER
- ECHO IRRIGATION DISTRICT BOUNDARY

REFERENCES TO PRIMARY WATER RIGHTS LISTED IN APPLICATION

FROM	TO
1 66.31 [diagonal lines] FROM HALE PERMIT NO G-4969 CERT 80851 TO HALE	66.31 [diagonal lines] HALE WELLS 1, 2, 3, 4, 6 AND 7
2 270.3 [cross-hatch] FROM COPPINGER PERMIT NO G-6626 CERT 80849 TO COPPINGER AND HALE	240.8 [cross-hatch] PROPOSED NEW COPPINGER WELL 1
	29.5 [cross-hatch] SUPPLEMENTAL TO PRIVATE TEMPORARY TRANSFER "COOKS TO ECHO IRRIGATION DISTRICT"
3 83.69 [wavy lines] FROM HALE PERMIT NO G-5215 CERT 80850 TO HALE	83.69 [wavy lines] HALE WELLS 3*, 5 AND 8 COPPINGER WELLS 1*

* ADDITIONAL P.O.A. THIS TEMPORARY TRANSFER

[hatched box] AREAS OF EXISTING WATER RIGHTS NOT INCLUDED IN THIS TRANSFER

DRAWING: H:\CAD\40_3522\313\3522a107.dwg
PRINTED BY: Roger Willard on 06/13/07 01:37 PM

RECEIVED
 JUN 28 2007
 WATER RESOURCES DEPT
 SALEM, OREGON