

Regular

Name Oregon Dept. of Fish and Wildlife  
Attn: Perry A. Baker  
Address 4034 Industrial Dr. SE  
Salem, OR 97302  
perry.a.baker@odfw.oregon.gov

DESCRIPTION OF WATER RIGHT(S)

Name of Stream Unnamed Spring  
Trib. of Summer Lake  
Use Domestic County Lake  
Quantity of water (CFS) No. of Acres  
Name of ditch  
App# S-24384 Per # S-19237 Cert # 21405 PR Date 1/5/1950  
App# Per # Cert # PR Date  
App# Per # Cert # PR Date  
App# Per # Cert # PR Date

FEES PAID  
Date 4-24-23 Amount \$ 1,360.00 Receipt # 142549

Change in DOW  
Date Filed 4-24-2023  
Initial notice date 5-2-2023  
DPD issued date  
PD issued date  
PD notice date  
Date of FO Vol Page  
C-Date  
COBU due date  
COBU Received date  
Certificate issued

FEES REFUNDED  
Date Amount Receipt #

Assignments:

Irrigation District  
Agent  
CWRE  
CC's list Lake County

- Oversized map - Location

**WATER RIGHT TRANSFER COVER SHEET**

Transfer: T-14224

Transfer Specialist:

Transfer Type: Regular Transfer

Reimbursement Authority?

<b>Applicant:</b> PERRY A. BAKER 4034 FAIRVIEW INDUSTRIAL DR SE SALEM, OR 97302	<b>Agent:</b> UNAVAILABLE	<b>Receiving Landowner:</b>
<b>Current Landowner if other than Applicant:</b>	<b>CWRE:</b>	<b>Irrigation District:</b>
<b>Affected Local Gov'ts:</b> Lake County	<b>Affected Tribal Gov't:</b>	<b>BOR Notified (date):</b>

**Water Rights Affected**

File Marked	App. File # or Decree Name	Permit	Certificate	RR/CR Needed	RR/CR Nos.
<input type="checkbox"/>	S-24384	S-19237	21405	<input type="checkbox"/> Yes <input type="checkbox"/> No	
<input type="checkbox"/>				<input type="checkbox"/> Yes <input type="checkbox"/> No	
<input type="checkbox"/>				<input type="checkbox"/> Yes <input type="checkbox"/> No	

**Key Dates & Initial Actions (Support Staff)**

Rec'd: April 24, 2023	Proposed Action(s): PLACE OF USE	
Fees Pd: 1360.00	Acknowledgement Letter Sent <input type="checkbox"/>	Basin: 13 Goose & Summer Lake
Initial Public Notice:	County sent cc: of Ack Letter <input type="checkbox"/>	County: LAKE
WM District: 12 Matt A. Anderson	WM Review request sent:	WM Review date received:
ODFW District:	ODFW Review sent:	ODFW Review date received:
Groundwater	GW Review sent:	GW Review date received:

**Caseworker Actions: Newspaper & PD Notice:**

Newspaper notice needed: <input type="checkbox"/>	Name of Newspaper:
Newspaper notice sent to coordinator:	Newspaper notice quote requested (NRS1):
Request for news \$ sent:	News \$ received:
Affidavit of publication received:	Last day of publication:

**Peer Review:**

Document	Drafted	Peer Review	Coordinator	Changes Made	Signature Bin	Signature Date
DPD	Date: _____ Initials: _____	Date: _____ Initials: _____	Date: _____ Initials: _____	Date: _____ Initials: _____	CW Sent: _____ WM Sheet <input type="checkbox"/> ODFW Sheet: <input type="checkbox"/>	N/A
PD	Date: _____ Initials: _____	Date: _____ Initials: _____	Date: _____ Initials: _____	Date: _____ Initials: _____ Data Review Date: _____	Date: _____	Date: _____
FO	Date: _____ Initials: _____	Date: _____ Initials: _____	Date: _____ Initials: _____	Date: _____ Initials: _____	Date: _____ No. of docs for sig: _____	Date: _____

Special Issues: \_\_\_\_\_

Special Order Volume: Vol. \_\_\_\_\_ Pages \_\_\_\_\_



# Oregon

Tina Kotek, Governor

## Water Resources Department

North Mall Office Building

725 Summer St NE, Suite A

Salem, OR 97301

Phone 503 986-0900

Fax 503 986-0904

April 28, 2023

OREGON DEPT OF FISH AND WILDLIFE  
PERRY A. BAKER  
4034 FAIRVIEW INDUSTRIAL DR SE  
SALEM, OR 97302

Reference: Application T-14224

On April 24, 2023, the Department received your water right Permanent Transfer Application. The application was accompanied by \$1360.00. Receipt number 140549 is enclosed.

By copy of this letter, we are asking the Watermaster for a report regarding the potential for injury to existing water rights which may be caused by the requested change.

This application may require publication of a notice for two consecutive weeks in a newspaper with general circulation in the area where the water right is located. If it is determined that newspaper notice will be required, the Department will prepare the notice and notify you of the cost. You will be responsible for submitting payment to the Department prior to publication of the notice.

Except as provided under ORS 540.510(3) for municipalities, you may not use water in the new place of use until a final order approving the transfer application has been issued by the Department. In order to avoid any possible forfeiture of the water right, you should continue to use the water as described by your existing water right.

If the land is sold before the application is approved, the buyer's consent to the application will be required unless a recorded deed or other legal document clearly established that the water right was not conveyed in the sale.

Refer to the following page for a chart showing the steps and expected timelines for the processing of your application.

If you have any questions, please contact the Transfer Section at (503) 986-0935.

Cc: Watermaster Dist. #12, Matt A. Anderson (*via email*)  
Lake County

Enclosure

# Watermaster Review Form: Water Right Transfer



Oregon Water Resources Department  
725 Summer St NE, Suite A  
Salem, Oregon 97301-1266  
(503) 986-0900  
www.oregon.gov/OWRD

Transfer Application: T-14224

Review Due Date:

Applicant Name: Perry A. Baker / Oregon Dept. of Fish and Wildlife

Proposed Changes:  POU  POD  POA  USE  OTHER

Reviewer(s): **Matt Anderson**

Date of Review: 08/18/2023

1. Do you have evidence that the right has not been used in the last 5 years and that the presumption of forfeiture would not likely be rebuttable?  Yes  No If "Yes", attach evidence (e.g. dated aerial photo showing pavement or building on the land for >5 yrs.)
2. Is there a history of regulation on the source that serves this (or these) right(s) that has involved the transferred right(s) and downstream water rights?  Yes  No Generally characterize the frequency of any regulation or explain why regulation has not occurred:
3. Have headgate notices been issued for the source that serves the transferred right(s)?  
 Yes  No  Records not available.
4. In your estimation, after the proposed change, would distribution of water for the right(s) result in regulation of other water rights that would not have occurred if use under the original right(s) was/were maximized?  Yes  No If "Yes", explain:
5. In your estimation, if the proposed change is approved, are there upstream water rights that would be affected?  Yes  No If "Yes", describe how the rights would be affected and list the rights most affected:

6. Check here  if it appears that downstream water rights benefit from return flows resulting from the current use of the transferred right(s)? If you check the box, generally characterize the locations where the return flows likely occur and list the water rights that benefit most:

N/A

7. For POD changes and instream transfers, check here if there are channel losses between the old and new PODs or within the proposed instream reach? If you check the box, describe and, if possible, estimate the losses:

N/A

8. For instream transfers that propose protection of a reach beyond the mouth of the source stream:

N/A Would the quantity be measureable into the receiving stream consistent with OAR 690-077-0015(8)?  Yes  No

9. For POU changes:  N/A Is it likely the original place of use would continue to receive water from the same source?  Yes  No If "Yes", explain:

10. For POU or USE changes:  N/A In your best judgment, would use of the existing right at "full face value," result in the diversion of more water than can be used beneficially and without waste?

Yes  No If "Yes", explain:

11. For POU changes that involve micro-irrigation:  N/A

a. Has the applicant made changes (absent a transfer) to convert to micro-irrigation within the current place of use boundary of the water right proposed for transfer, and previously demonstrated to the Department through monitoring and site inspections by the Watermaster that the proposed transfer will not result in injury or enlargement?

Yes  No If "Yes", explain:

b. Has a temporary transfer of this nature been previously filed and approved on the same lands (or portions thereof) as those lands involved in this transfer?

Yes  No If "Yes", answer the following:

i. Were there any problems with more acres being irrigated (or wetted) than were authorized under the temporary transfer?  Yes  No If "Yes", explain:

ii. Did the designated areas that were to remain dry (or not wetted) under the temporary transfer actually remain dry?  Yes  No If "No", explain:

iii. Did the applicant comply with and meet all of the conditions of the temporary transfer?  Yes  No If "No", explain:

iv. Do you have any other observations regarding the temporary transfer?  Yes  No If "Yes", describe:

v. Did the applicant demonstrate to the Department through monitoring and site inspections by the Watermaster that neither injury nor enlargement occurred as a result of the temporary transfer?  Yes  No If "No", explain:

c. To the best of your knowledge, if this transfer is approved, does it appear that:

i. "Injury" will occur to other water rights that share the same source?  Yes  No If "Yes", explain:

ii. "Enlargement" of the water right being transferred will occur?  Yes  No If "Yes", explain:

12. Are there other issues not identified through the above questions that should be considered in determining whether the change "can be effected without injury to other rights"?

Yes  No If "Yes", explain:

13. What alternatives may be available for addressing any issues identified above:

14. Do conditions need to be included in the transfer order to avoid enlargement of the right or injury to other rights?  No  Yes, as checked and provided below:

For POU changes that involve micro-irrigation, provide the monitoring and reporting conditions necessary to prevent injury/enlargement:

A Headgate should be required prior to diverting water.

Measurement Devices for POD or POA: (if this condition is selected, also fill in the top sections of Page 4)

*a. Before water use may begin under this order, the water user shall install a **totalizing flow meter\***, or, with prior approval of the Director, another suitable measuring device,  at each point of diversion/appropriation (new and existing) OR at each new point of diversion/appropriation  with the exception that water rights issued to the Bureau of Reclamation or an irrigation district (or similar entity) are not subject to this condition.*

*b. The water user shall maintain the meters or measuring devices in good working order.*

*c. The water user shall allow the Watermaster access to the meters or measuring devices; provided however, where the meters or measuring devices are located within a private structure, the Watermaster shall request access upon reasonable notice.*

Reservoir water use measurement: (if this condition is selected, also fill in the top sections of Page 4)

*a. Before water use may begin under this order, the water user shall install **staff gages\***, or, with prior approval of the Director, other suitable measuring devices, that measure the entire range and stage between empty and full in each reservoir. Staff gages shall be United States Geological Survey style.*

*b. Before water use may begin under this order, if the reservoir is located in channel, weirs or other suitable measuring devices must be installed upstream and downstream of the reservoir, and, an adjustable outlet valve must be installed. The water user shall maintain such devices in good working order. A written waiver may be obtained, if in the judgment of the Director, the installation of weirs or other suitable measuring devices, or the adjustable outlet valve, will provide no public benefit.*

\* The following alternative device(s) should be substituted for the bold, underlined device in the above selected condition:

Weir

Submerged Orifice

Parshall Flume

Flow Restrictor

Other: \_\_\_\_\_



**STATE OF OREGON  
WATER RESOURCES DEPARTMENT**

725 Summer St. N.E. Ste. A

SALEM, OR 97301-4172

(503) 986-0900 / (503) 986-0904 (fax)

RECEIPT # **140549**

INVOICE # \_\_\_\_\_

RECEIVED FROM: State of Oregon  
 BY: Oregon Dept of Fish and Wildlife

APPLICATION	
PERMIT	
TRANSFER	T-14224

CASH:  CHECK: # 1264 OTHER: (IDENTIFY)   
90469

TOTAL REC'D \$ 1,360.00

**1083 TREASURY 4170 WRD MISC CASH ACCT**

0407 COPIES \$  
 OTHER: (IDENTIFY) \$  
 0243 I/S Lease \_\_\_\_\_ 0244 Muni Water Mgmt. Plan \_\_\_\_\_ 0245 Cons. Water \_\_\_\_\_

**4270 WRD OPERATING ACCT**

**MISCELLANEOUS**

0407 COPY & TAPE FEES \$ 46110  
 0410 RESEARCH FEES \$  
 0408 MISC REVENUE: (IDENTIFY) \$  
 TC162 DEPOSIT LIAB. (IDENTIFY) \$  
 0240 EXTENSION OF TIME \$

**WATER RIGHTS:**

0201 SURFACE WATER	\$	0202	\$
0203 GROUND WATER	\$	0204	\$
0205 TRANSFER	\$ <u>1,360.00</u>		

<b>EXAM FEE</b>		<b>RECORD FEE</b>
\$		\$
\$		\$

0218 WELL DRILL CONSTRUCTOR \$ 0219 \$  
 LANDOWNER'S PERMIT 0220 \$

**WELL CONSTRUCTION**

OTHER (IDENTIFY) \_\_\_\_\_

**0536 TREASURY 0437 WELL CONST. START FEE**

0211 WELL CONST START FEE \$ CARD# \_\_\_\_\_  
 0210 MONITORING WELLS \$ CARD# \_\_\_\_\_  
 OTHER (IDENTIFY) \_\_\_\_\_

**0607 TREASURY 0467 HYDRO ACTIVITY LIC NUMBER**

0233 POWER LICENSE FEE (FWWRD) \$  
 0231 HYDRO LICENSE FEE (FWWRD) \$  
 HYDRO APPLICATION \$

**TREASURY OTHER / RDX**

FUND \_\_\_\_\_ TITLE \_\_\_\_\_  
 OBJ. CODE \_\_\_\_\_ VENDOR # \_\_\_\_\_  
 DESCRIPTION \_\_\_\_\_ \$

**RECEIVED  
OVER THE COUNTER**

RECEIPT: **140549**

DATED: 7/24/2023 BY: [Signature]

# Application for Permanent Water Right Transfer



Oregon Water Resources Department  
725 Summer Street NE, Suite A  
Salem, Oregon 97301-1266  
(503) 986-0900  
www.oregon.gov/OWRD

## Part 1 of 5 – Minimum Requirements Checklist

**This transfer application will be returned if Parts 1 through 5 and all required attachments are not completed and included.**

For questions, please call (503) 986-0900, and ask for Transfer Section.

Check all items included with this application. (N/A = Not Applicable)

- Part 1 – Completed Minimum Requirements Checklist.
- Part 2 – Completed Transfer Application Map Checklist.
- Part 3 – Application Fee, payable by check to the Oregon Water Resources Department, and completed Fee Worksheet, page 3. Try the new online fee calculator at: [http://apps.wrd.state.or.us/apps/misc/wrd\\_fee\\_calculator](http://apps.wrd.state.or.us/apps/misc/wrd_fee_calculator).
- Part 4 – Completed Applicant Information and Signature.
- Part 5 – Information about Water Rights to be Transferred: **How many water rights are to be transferred? 1 List them here: 21405**  
Please include a separate Part 5 for each water right. (See instructions on page 6)  
**NOTE: A separate transfer application is required for each water right unless the criteria in OAR 690-380-3220 are met.**

### Attachments:

- Completed Transfer Application Map.
- Completed Evidence of Use Affidavit and supporting documentation.
- N/A Affidavit(s) of Consent from Landowner(s) (if the applicant does not own the land the water right is on.)
- N/A Supplemental Form D – For water rights served by or issued in the name of an irrigation district. Complete when the transfer applicant is not the irrigation district.
- N/A Oregon Water Resources Department's Land Use Information Form with approval and signature from each local land use authority in which water is to be diverted, conveyed, and/or used. Not required if water is to be diverted, conveyed, and/or used only on federal lands or if **all** of the following apply: a) a change in place of use only, b) no structural changes, c) the use of water is for irrigation only, and d) the use is located within an irrigation district or an exclusive farm use zone.
- N/A Water Well Report/Well Log for changes in point(s) of appropriation (well(s)) or additional point(s) of appropriation.
- N/A Geologist Report for a change from a surface water point of diversion to a ground water point of appropriation (well), if the proposed well is more than 500' from the surface water source and more than 1000' upstream or downstream from the point of diversion. See OAR 690-380-2130 for requirements and applicability.

(For Staff Use Only)

WE ARE RETURNING YOUR APPLICATION FOR THE FOLLOWING REASON(S):

- |  |  |
|--|--|
| <input type="checkbox"/> Application fee not enclosed/insufficient | <input type="checkbox"/> Map not included or incomplete                  |
| <input type="checkbox"/> Land Use Form not enclosed or incomplete  | <input type="checkbox"/> Evidence of Use Form not enclosed or incomplete |
| <input type="checkbox"/> Additional signature(s) required          | <input type="checkbox"/> Part _____ is incomplete                        |

Other/Explanation \_\_\_\_\_

Staff: \_\_\_\_\_ 503- \_\_\_\_\_ Date: \_\_\_\_/\_\_\_\_/\_\_\_\_

RECEIVED  
FEB 27 2023  
OWRD  
SALEM, OREGON

RECEIVED  
APR 24 2023

RECEIVED

FEB 27 2023

OWRD  
SALEM, OREGON

## Part 2 of 5 – Transfer Application Map

Your transfer application will be returned if any of the map requirements listed below are not met.

Please be sure that the transfer application map you submit includes all the required items and matches the existing water right map. Check all boxes that apply.

- N/A Certified Water Right Examiner (CWRE) Stamp and Original Signature. For a list of CWREs, see [http://apps.wrd.state.or.us/apps/wr/cwre\\_license\\_view/](http://apps.wrd.state.or.us/apps/wr/cwre_license_view/). CWRE stamp and signature are not required for substitutions.
- N/A If more than three water rights are involved, separate maps are needed for each water right.
  - Permanent quality printed with dark ink on good quality paper.
  - The size of the map can be 8½ x 11 inches, 8½ x 14 inches, 11 x 17 inches, or up to 30 x 30 inches. For 30 x 30 inch maps, one extra copy is required.
  - A north arrow, a legend, and scale.
  - The scale of the map must be: 1 inch = 400 feet, 1 inch = 1,320 feet, the scale of the Final Proof/Claim of Beneficial Use Map (the map used when the permit was certificated), the scale of the county assessor map if the scale is not smaller than 1 inch = 1,320 feet, or a scale that has been pre-approved by the Department.
- Township, Range, Section, ¼ ¼, DLC, Government Lot, and other recognized public land survey lines.
- Tax lot boundaries (property lines) are required. Tax lot numbers are recommended.
- Major physical features including rivers and creeks showing direction of flow, lakes and reservoirs, roads, and railroads.
- Major water delivery system features from the point(s) of diversion/appropriation such as main pipelines, canals, and ditches.
- Existing place of use that includes separate hachuring for each water right, priority date, and use including number of acres in each quarter-quarter section, government lot, or in each quarter-quarter section as projected within government lots, donation land claims, or other recognized public land survey subdivisions. If less than the entirety of the water right is being changed, a separate hachuring is needed for lands left unchanged.
- N/A Proposed place of use that includes separate hachuring for each water right, priority date, and use including number of acres in each quarter-quarter section, government lot, or in each quarter-quarter section as projected within government lots, donation land claims, or other recognized public land survey subdivisions.
- Existing point(s) of diversion or well(s) with distance and bearing or coordinates from a recognized survey corner. This information can be found in your water right certificate or permit.
- N/A If you are proposing a change in point(s) of diversion or well(s), show the proposed location and label it clearly with distance and bearing or coordinates. If GPS coordinates are used, latitude-longitude coordinates may be expressed as either degrees-minutes-seconds with at least one digit after the decimal (example – 42°32'15.5") or degrees-decimal with five or more digits after the decimal (example – 42.53764°).

RECEIVED

APR 24 2023



## Part 4 of 5 – Applicant Information and Signature

### Applicant Information

APPLICANT/BUSINESS NAME <b>Perry A. Baker / Oregon Dept. of Fish and Wildlife</b>			PHONE NO. <b>503-947-6241</b>	ADDITIONAL CONTACT NO.
ADDRESS <b>4034 Industrial Dr. SE</b>				FAX NO.
CITY <b>Salem</b>	STATE <b>OR</b>	ZIP <b>97302</b>	E-MAIL <b>perry.a.baker@odfw.oregon.gov</b>	
BY PROVIDING AN E-MAIL ADDRESS, CONSENT IS GIVEN TO RECEIVE ALL CORRESPONDENCE FROM THE DEPARTMENT ELECTRONICALLY. COPIES OF THE FINAL ORDER DOCUMENTS WILL ALSO BE MAILED.				

**Agent Information** – The agent is authorized to represent the applicant in all matters relating to this application.

AGENT/BUSINESS NAME <b>Same as above</b>			PHONE NO.	ADDITIONAL CONTACT NO.
ADDRESS				FAX NO.
CITY	STATE	ZIP	E-MAIL	
BY PROVIDING AN E-MAIL ADDRESS, CONSENT IS GIVEN TO RECEIVE ALL CORRESPONDENCE FROM THE DEPARTMENT ELECTRONICALLY. COPIES OF THE FINAL ORDER DOCUMENTS WILL ALSO BE MAILED.				

Explain in your own words what you propose to accomplish with this transfer application, and why:  
A new home and office have been built outside the existing use area for domestic water use. Proposed transfer application to increase the place of use to include additional area.

If you need additional space, continue on a separate piece of paper and attach to the application as "Attachment 1".

#### Check One Box

- By signing this application, I understand that, upon receipt of the draft preliminary determination and prior to Department approval of the transfer, I will be required to provide landownership information and evidence that I am authorized to pursue the transfer as identified in OAR 690-380-4010(5); OR
- I affirm the applicant is a municipality as defined in ORS 540.510(3)(b) and that the right is in the name of the municipality or a predecessor; OR
- I affirm the applicant is an entity with the authority to condemn property and is acquiring by condemnation the property to which the water right proposed for transfer is appurtenant and have supporting documentation.

RECEIVED

FEB 27 2023

OWRD  
SALEM, OREGON

RECEIVED

APR 24 2023

OWRD

FEB 27 2023

OWRD  
SALEM, OREGON

By my signature below, I confirm that I understand:

- Prior to Department approval of the transfer application, I may be required to submit payment to the Department for publication of a notice in a newspaper with general circulation in the area where the water right is located, once per week for two consecutive weeks. If more than one qualifying newspaper is available, I suggest publishing the notice in the following newspaper: \_\_\_\_\_
- Amendments to the application may only be made in response to the Department's Draft Preliminary Determination (DPD). The applicant will have a period of at least 30 days to amend the application to address any issues identified by the Department in the DPD, or to withdraw the application. Note that amendments may be subject to additional fees, pursuant to ORS 536.050.
- Failure to complete an approved change in place of use and/or change in character of use, will result in loss of the water right (OAR 690-380-6010).
- Refunds may only be granted upon request and, as set forth in ORS 536.050(4)(a), if the Director determines that a refund of all or part of a fee is appropriate in the interests of fairness to the public or necessary to correct an error of the Department.

I (we) affirm that the information contained in this application is true and accurate.



Shannon Hurn

Digitally signed by Shannon Hurn  
Date: 2023.02.24 16:15:02 -08'00'

Shannon M. Hurn, Deputy Director for Administration

Applicant signature

Print Name (and Title if applicable)

Date

Applicant signature

Print Name (and Title if applicable)

Date

Is the applicant the sole owner of the land on which the water right, or portion thereof, proposed for transfer is located?  Yes  No\*

\*If NO, include signatures of all deeded landowners (and mailing and/or e-mail addresses if different than the applicant's) or attach affidavits of consent (and mailing and/or e-mail addresses) from all landowners or individuals/entities to which the water right(s) were conveyed.

Check the following boxes that apply:

- The applicant is responsible for completion of change(s). Notices and correspondence should continue to be sent to the applicant.
- The receiving landowner will be responsible for completing the proposed change(s) after the final order is issued. Copies of notices and correspondence should be sent to this landowner.
- Both the receiving landowner and applicant will be responsible for completion of change(s). Copies of notices and correspondence should be sent to this landowner and the applicant.

At this time, are the lands in this transfer application in the process of being sold?  Yes  No

If YES, and you know who the new landowner will be, please complete the receiving landowner information table below. If you do not know who the new landowner will be, then a request for assignment will have to be filed for at a later date.

If a property sells, the certificated water right(s) located on the land belong to the new owner, unless a sale agreement or other document states otherwise. For more information see:

[https://www.oregon.gov/owrd/WRDFormsPDF/Transfer\\_Property\\_Transactions.pdf](https://www.oregon.gov/owrd/WRDFormsPDF/Transfer_Property_Transactions.pdf)

RECEIVED

APR 24 2023

RECEIVING LANDOWNER NAME N/A		PHONE NO.	ADDITIONAL CONTACT NO.
ADDRESS			FAX NO.
CITY	STATE	ZIP	E-MAIL
Describe any special ownership circumstances:			
The confirming Certificate shall be issued in the name of: <input type="checkbox"/> Applicant <input type="checkbox"/> Receiving Landowner			

OWRD

Check here if any of the water rights proposed for transfer are or will be located within or served by an irrigation or other water district. (Tip: Complete and attach Supplemental Form D.)

IRRIGATION DISTRICT NAME	ADDRESS	
CITY	STATE	ZIP

Check here if water for any of the rights supplied under a water service agreement or other contract for stored water with a federal agency or other entity.

ENTITY NAME	ADDRESS	
CITY	STATE	ZIP



To meet State Land Use Consistency Requirements, you must list all county, city, municipal corporation, or tribal governments within whose jurisdiction water will be diverted, conveyed or used.

ENTITY NAME Lake County	ADDRESS 513 Center Street	
CITY Lake View	STATE OR	ZIP 97630

ENTITY NAME	ADDRESS	
CITY	STATE	ZIP

RECEIVED

APR 24 2023

OWRD

RECEIVED

FEB 27 2023

OWRD  
SALEM, OREGON

## Part 5 of 5 – Water Right Information

Please use a separate Part 5 for each water right being changed. See instructions on page 6, to copy and paste additional Part 5s, or to add additional rows to tables within the form.

CERTIFICATE # 21405

### Description of Water Delivery System

System capacity: 0.1 cubic feet per second (cfs) OR  
 \_\_\_\_\_ gallons per minute (gpm)

Describe the current water delivery system or the system that was in place at some time within the last five years. Include information on the pumps, canals, pipelines, and sprinklers used to divert, convey, and apply the water at the authorized place of use. The current POD is an unnamed spring with an electric submersible pump that delivers water to an above ground 30,000 gallon steel storage tank. From there the water is conveyed with a 4" gravity main line thru the property with various connections to the existing homes and offices and place of businesses.

**Table 1. Location of Authorized and Proposed Point(s) of Diversion (POD) or Appropriation (POA)**  
 (Note: If the POD/POA name is not specified on the certificate, assign it a name or number here.)

POD/POA Name or Number	Is this POD/POA Authorized on the Certificate or is it Proposed?	If POA, OWRD Well Log ID# (or Well ID Tag # L-____)	Twp	Rng	Sec	¼	¼	Tax Lot, DLC or Gov't Lot	Measured Distances (from a recognized survey corner)	
POD	<input checked="" type="checkbox"/> Authorized <input type="checkbox"/> Proposed		30	S	16	E	23	SE	NW	
	<input type="checkbox"/> Authorized <input type="checkbox"/> Proposed									
	<input type="checkbox"/> Authorized <input type="checkbox"/> Proposed									
	<input type="checkbox"/> Authorized <input type="checkbox"/> Proposed									

Check all type(s) of change(s) proposed below (change "CODES" are provided in parentheses):

- |   |   |
|---|---|
| <input checked="" type="checkbox"/> Place of Use (POU)<br><input type="checkbox"/> Character of Use (USE)<br><input type="checkbox"/> Point of Diversion (POD)<br><input type="checkbox"/> Additional Point of Diversion (APOD)<br><input type="checkbox"/> Surface Water POD to Ground Water POA (SW/GW) | <input type="checkbox"/> Supplemental Use to Primary Use (S to P)<br><input type="checkbox"/> Point of Appropriation/Well (POA)<br><input type="checkbox"/> Additional Point of Appropriation (APOA)<br><input type="checkbox"/> Substitution (SUB)<br><input type="checkbox"/> Government Action POD (GOV) |
|---|---|

Will all of the proposed changes affect the entire water right?

- Yes Complete only the Proposed ("to" or "on" lands) section of Table 2 on the next page. Use the "CODES" listed above to describe the proposed changes.
- No Complete all of Table 2 to describe the portion of the water right to be changed.

RECEIVED  
APR 24 2023

OWRD

RECEIVED  
FEB 27 2023 TACS

OWRD  
SALEM, OREGON

Please use and attach additional pages of Table 2 as needed.  
See page 6 for instructions.

Do you have questions about how to fill-out the tables?  
Contact the Department at 503-986-0900 and ask for Transfer Staff.

**Table 2. Description of Changes to Water Right Certificate # 21405**

List the change proposed for the acreage in each ¼ ¼. If more than one change is proposed, specify the acreage associated with each change.  
If there is more than one POD/POA involved in the proposed changes, specify the acreage associated with each POD/POA.

AUTHORIZED (the "from" or "off" lands) The listing that appears on the certificate BEFORE PROPOSED CHANGES List only that part or portion of the water right that will be changed.											Proposed Changes (see "CODES" from previous page)	PROPOSED (the "to" or "on" lands) The listing as it would appear AFTER PROPOSED CHANGES are made.									
Twp	Rng	Sec	¼ ¼	Tax Lot	Gvt Lot or DLC	Acres	Type of USE listed on Certificate	POD(s) or POA(s) (name or number from Table 1)	Priority Date	Twp		Rng	Sec	¼ ¼	Tax Lot	Gvt Lot or DLC	Acres	New Type of USE	POD(s)/ POA(s) to be used (from Table 1)	Priority Date	
EXAMPLE																					
2	S	9	E 15 NE NW	100		15.0	Irrigation	POD #1 POD #2	1901	POU/POD	2	S	9	E 1 NW NW	500	1	10.0		POD #5	1901	
											2	S	9	E 2 SW NW	500		5.0		POD #6	1901	
										POU	30	S	16	E 23 SW NE			160	DOM		1950	
										POU	30	S	16	E 23 NW SE			80	DOM		1950	
										POU	30	S	16	E 23 NE SE			80	DOM		1950	
TOTAL ACRES:												TOTAL ACRES:						320			

Additional remarks: POU is in addition to the current POU. Adding to SW 1/4 NE 1/4 and adding East 1/2 of NW 1/4 SE 1/4 and adding West 1/2 of NE 1/4 SE 1/4.

RECEIVED  
APR 24 2023  
OWRD

RECEIVED  
FEB 27 2023  
OWRD  
SALEM, OREGON

OWRD

Certificate #

For Place of Use or Character of Use Changes

Are there other water right certificates, water use permits or ground water registrations associated with the "from" or the "to" lands?  Yes  No

If YES, list the certificate, water use permit, or ground water registration numbers: N/A.

 Pursuant to ORS 540.510, any "layered" water use such as an irrigation right that is supplemental to a primary right proposed for transfer must be included in the transfer or be cancelled. Any change to a ground water registration must be filed separately in a ground water registration modification application.

For Substitution (ground water supplemental irrigation will be substituted for surface water primary irrigation)

Ground water supplemental Permit or Certificate # N/A.

Surface water primary Certificate # N/A.

For a change from Supplemental Irrigation Use to Primary Irrigation Use

Identify the primary certificate to be cancelled. Certificate # N/A

For a change in point(s) of appropriation (well(s)) or additional point(s) of appropriation:

Well log(s) are attached for each authorized and proposed well(s) that are clearly labeled and associated with the corresponding well(s) in Table 1 above and on the accompanying application map.

Tip: You may search for well logs on the Department's web page at:

[http://apps.wrd.state.or.us/apps/gw/well\\_log/Default.aspx](http://apps.wrd.state.or.us/apps/gw/well_log/Default.aspx)

AND/OR

Describe the construction of the authorized and proposed well(s) in Table 3 for any wells that do not have a well log. For *proposed wells not yet constructed or built*, provide "a best estimate" for each requested information element in the table. The Department recommends you consult a licensed well driller, geologist, or certified water right examiner to assist with assembling the information necessary to complete Table 3.

Table 3. Construction of Point(s) of Appropriation

Any well(s) in this listing must be clearly tied to corresponding well(s) described in Table 1 and shown on the accompanying application map. Failure to provide the information will delay the processing of your transfer application until it is received. The information is necessary for the department to assess whether the proposed well(s) will access the same source aquifer as the authorized point(s) of appropriation (POA). The Department is prohibited by law from approving POA changes that do not access the same source aquifer.

Proposed or Authorized POA Name or Number	Is well already built? (Yes or No)	If an existing well: OWRD Well ID Tag No. L-	Total well depth	Casing Diameter	Casing Intervals (feet)	Seal depth(s) (intervals)	Perforated or screened intervals (in feet)	Static water level of completed well (in feet)	Source aquifer (sand, gravel, basalt, etc.)	Well-specific rate (cfs or gpm). If less than full rate of water right

# Land Use Information Form



Oregon Water Resources Department  
 725 Summer Street NE, Suite A  
 Salem, Oregon 97301-1266  
 (503) 986-0900  
 www.oregon.gov/OWRD

Applicant(s): Oregon Department of Fish and Wildlife

Mailing Address: 53447 Hwy 31 Summer Lake OR 97640

City: Summer Lake State: OR Zip Code: 97640 Daytime Phone: 541-943-3152

## A. Land and Location

Please include the following information for all tax lots where water will be diverted (taken from its source), conveyed (transported), and/or used or developed. Applicants for municipal use, or irrigation uses within irrigation districts may substitute existing and proposed service-area boundaries for the tax-lot information requested below.

Township	Range	Section	¼¼	Tax Lot #	Plan Designation (e.g., Rural Residential/RR-5)	Water to be:	Proposed Land Use:
<u>30 S</u>	<u>16 E</u>	<u>23</u>	<u>SWNE</u>	_____	_____	<input type="checkbox"/> Diverted <input type="checkbox"/> Conveyed <input checked="" type="checkbox"/> Used	_____
<u>30 S</u>	<u>16 E</u>	<u>23</u>	<u>NWSE</u>	_____	_____	<input type="checkbox"/> Diverted <input type="checkbox"/> Conveyed <input checked="" type="checkbox"/> Used	_____
<u>30 S</u>	<u>16 E</u>	<u>23</u>	<u>NESE</u>	_____	_____	<input type="checkbox"/> Diverted <input type="checkbox"/> Conveyed <input checked="" type="checkbox"/> Used	_____
_____	_____	_____	_____	_____	_____	<input type="checkbox"/> Diverted <input type="checkbox"/> Conveyed <input type="checkbox"/> Used	_____

List all counties and cities where water is proposed to be diverted, conveyed, and/or used or developed:

Lake

## B. Description of Proposed Use

Type of application to be filed with the Water Resources Department:

- Permit to Use or Store Water   
  Water Right Transfer   
  Permit Amendment or Ground Water Registration Modification  
 Limited Water Use License   
  Allocation of Conserved Water   
  Exchange of Water

Source of water:  Reservoir/Pond     Ground Water     Surface Water (name) \_\_\_\_\_

Estimated quantity of water needed: 0.1  cubic feet per second     gallons per minute     acre-feet

Intended use of water:  Irrigation     Commercial     Industrial     Domestic for 6 household(s)  
 Municipal     Quasi-Municipal     Instream     Other \_\_\_\_\_

Briefly describe:

Expanding use area for domestic water.

**Note to applicant:** If the Land Use Information Form cannot be completed while you wait, please have a local government representative sign the receipt at the bottom of the next page and include it with the application filed with the Water Resources Department.

See bottom of Page 3. →

RECEIVED

APR 24 2023

OWRD

## For Local Government Use Only

The following section must be completed by a planning official from each county and city listed unless the project will be located entirely within the city limits. In that case, only the city planning agency must complete this form. This deals only with the local land-use plan. Do not include approval for activities such as building or grading permits.

**Please check the appropriate box below and provide the requested information**

- Land uses to be served by the proposed water uses (including proposed construction) are allowed outright or are not regulated by your comprehensive plan. Cite applicable ordinance section(s): Lake County Zoning Ordinance Articles 2, 3 + 4.
- Land uses to be served by the proposed water uses (including proposed construction) involve discretionary land-use approvals as listed in the table below. (Please attach documentation of applicable land-use approvals which have already been obtained. Record of Action/land-use decision and accompanying findings are sufficient.) **If approvals have been obtained but all appeal periods have not ended, check "Being pursued."**

Type of Land-Use Approval Needed (e.g., plan amendments, rezones, conditional-use permits, etc.)	Cite Most Significant Applicable Plan Policies & Ordinance Section References	Land-Use Approval:	
		<input type="checkbox"/> Obtained <input type="checkbox"/> Denied	<input type="checkbox"/> Being Pursued <input type="checkbox"/> Not Being Pursued
		<input type="checkbox"/> Obtained <input type="checkbox"/> Denied	<input type="checkbox"/> Being Pursued <input type="checkbox"/> Not Being Pursued
		<input type="checkbox"/> Obtained <input type="checkbox"/> Denied	<input type="checkbox"/> Being Pursued <input type="checkbox"/> Not Being Pursued
		<input type="checkbox"/> Obtained <input type="checkbox"/> Denied	<input type="checkbox"/> Being Pursued <input type="checkbox"/> Not Being Pursued
		<input type="checkbox"/> Obtained <input type="checkbox"/> Denied	<input type="checkbox"/> Being Pursued <input type="checkbox"/> Not Being Pursued

Local governments are invited to express special land-use concerns or make recommendations to the Water Resources Department regarding this proposed use of water below, or on a separate sheet.

30-16-23-100,  
30-16-00-1000, etc. SEE ATTACHED MAP.  
DIRECT USE FOR HALLMARKS.

Name: Darwin Johnson Title: Planning Director  
 Signature: [Signature] Phone: 541-747-6036 Date: 17 April 2023  
 Government Entity: Lake County Planning Dept

**Note to local government representative:** Please complete this form or sign the receipt below and return it to the applicant. If you sign the receipt, you will have 30 days from the Water Resources Department's notice date to return the completed Land Use Information Form or WRD may presume the land use associated with the proposed use of water is compatible with local comprehensive plans.



### Receipt for Request for Land Use Information

Applicant name: \_\_\_\_\_  
 City or County: \_\_\_\_\_ Staff contact: \_\_\_\_\_  
 Signature: \_\_\_\_\_ Phone: \_\_\_\_\_ Date: \_\_\_\_\_

RECEIVED

APR 24 2023

WR / FS

OWRD

STATE OF OREGON  
COUNTY OF LAKE  
**CERTIFICATE OF WATER RIGHT**

**This Is to Certify,** That OREGON STATE GAME COMMISSION  
1634 S. W. Alder St., Portland and FRANK GRAVES  
of & Summer Lake, State of Oregon, has made proof  
to the satisfaction of the STATE ENGINEER of Oregon, of a right to the use of the waters of  
an unnamed spring  
a tributary of Summer Lake for the purpose of  
domestic  
under Permit No. 19237 of the State Engineer, and that said right to the use of said waters  
has been perfected in accordance with the laws of Oregon; that the priority of the right hereby  
confirmed dates from January 5, 1950.

that the amount of water to which such right is entitled and hereby confirmed, for the purposes  
aforesaid, is limited to an amount actually beneficially used for said purposes, and shall not exceed  
0.1 cubic foot per second,

or its equivalent in case of rotation, measured at the point of diversion from the stream.  
The point of diversion is located in the SE $\frac{1}{4}$  NW $\frac{1}{4}$ , Section 23, Township 30 South, Range 16  
East, W. M.

The amount of water used for irrigation, together with the amount secured under any other  
right existing for the same lands, shall be limited to - - - - - of one cubic foot per second  
per acre,

and shall conform to such reasonable rotation system as may be ordered by the proper state officer.

A description of the place of use under the right hereby confirmed, and to which such right is  
appurtenant, is as follows:

SE $\frac{1}{4}$  SW $\frac{1}{4}$  NE $\frac{1}{4}$   
Section 23  
Township 30 South, Range 16 East, W. M.

The right to the use of the water for the purposes aforesaid is restricted to the lands or place of  
use herein described.

WITNESS the signature of the State Engineer, affixed

this 20th day of June, 1956.

LEWIS A. STANLEY

State Engineer

Recorded in State Record of Water Right Certificates, Volume 15, page 21405.

# Application for Water Right Transfer

## Evidence of Use Affidavit



Oregon Water Resources Department  
 725 Sumner Street NE, Suite A  
 Salem, Oregon 97301-1266  
 (503) 986-0900  
 www.wrd.state.or.us

Please print legibly or type. Be as specific as possible. Attach additional pages if you need more spacing. Supporting documentation must be attached.

State of Oregon )  
 ) ss  
 County of LAKE

I, JASON JOURNEY, in my capacity as SUMMER LAKE WILDLIFE AREA MANAGER,  
 mailing address 53447 HWY 31 SUMMER LAKE OR 97640  
 telephone number (541)943-3152, being first duly sworn depose and say:

1. My knowledge of the exercise or status of the water right is based on (check one):

- Personal observation       Professional expertise

2. I attest that:

- Water was used during the previous five years on the entire place of use for Certificate # 21405; OR
- My knowledge is specific to the use of water at the following locations within the last five years:

Certificate #	Township		Range		Mer	Sec	¼ ¼		Gov't Lot or DLC	Acres (if applicable)
21405	30	S	16	E		23	SW	NE		

OR

- Confirming Certificate # \_\_\_\_\_ has been issued within the past five years; OR
- Part or all of the water right was leased instream at some time within the last five years. The instream lease number is: \_\_\_\_\_ (Note: If the entire right proposed for transfer was not leased, additional evidence of use is needed for the portion not leased instream.); OR
- The water right is not subject to forfeiture and documentation that a presumption of forfeiture for non-use would be rebutted under ORS 540.610(2) is attached.
- Water has been used at the actual current point of diversion or appropriation for more than 10 years for Certificate # \_\_\_\_\_ (For Historic POD/POA Transfers)

(continues on reverse side)

RECEIVED

APR 24 2023

OWRD

3. The water right was used for: (e.g., crops, pasture, etc.): DOMESTIC
4. I understand that if I do not attach one or more of the documents shown in the table below to support the above statements, my application will be considered incomplete.

[Signature]  
Signature of Affiant

12-21-22  
Date

Signed and sworn to (or affirmed) before me this 21 day of December 2022.

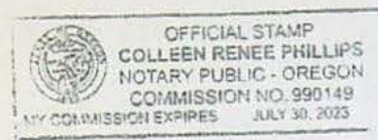

[Signature]  
Notary Public for Oregon  
My Commission Expires: July 30, 2023

Supporting Documents	Examples
<input checked="" type="checkbox"/> Copy of a water right certificate that has been issued within the last five years. (not a remaining right certificate)	Copy of confirming water right certificate that shows issue date
<input checked="" type="checkbox"/> Copies of receipts from sales of irrigated crops or for expenditures related to use of water	<ul style="list-style-type: none"> <li>• Power usage records for pumps associated with irrigation use</li> <li>• Fertilizer or seed bills related to irrigated crops</li> <li>• Farmers Co-op sales receipt</li> </ul>
<input type="checkbox"/> Records such as FSA crop reports, irrigation district records, NRCS farm management plan, or records of other water suppliers	<ul style="list-style-type: none"> <li>• District assessment records for water delivered</li> <li>• Crop reports submitted under a federal loan agreement</li> <li>• Beneficial use reports from district</li> <li>• IRS Farm Usage Deduction Report</li> <li>• Agricultural Stabilization Plan</li> <li>• CREP Report</li> </ul>
<input type="checkbox"/> Aerial photos containing sufficient detail to establish location and date of photograph	<p>Multiple photos can be submitted to resolve different areas of a water right. If the photograph does not print with a "date stamp" or without the source being identified, the date of the photograph and source should be added.</p> <p>Sources for aerial photos:            OSU – <a href="http://www.oregonexplorer.info/imagery">www.oregonexplorer.info/imagery</a>            OWRD – <a href="http://www.wrd.state.or.us">www.wrd.state.or.us</a>            Google Earth – <a href="http://earth.google.com">earth.google.com</a>            TerraServer – <a href="http://www.terraserver.com">www.terraserver.com</a></p>
<input type="checkbox"/> Approved Lease establishing beneficial use within the last 5 years	Copy of instream lease or lease number

**RECEIVED**  
**APR 24 2023**  
**OWRD**



# SECTION 23 T30S, R16E W.M., LAKE COUNTY, OREGON

Date: 11/29/2022

RECEIVED

APR 24 2023

OWRD

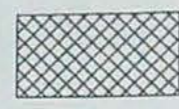
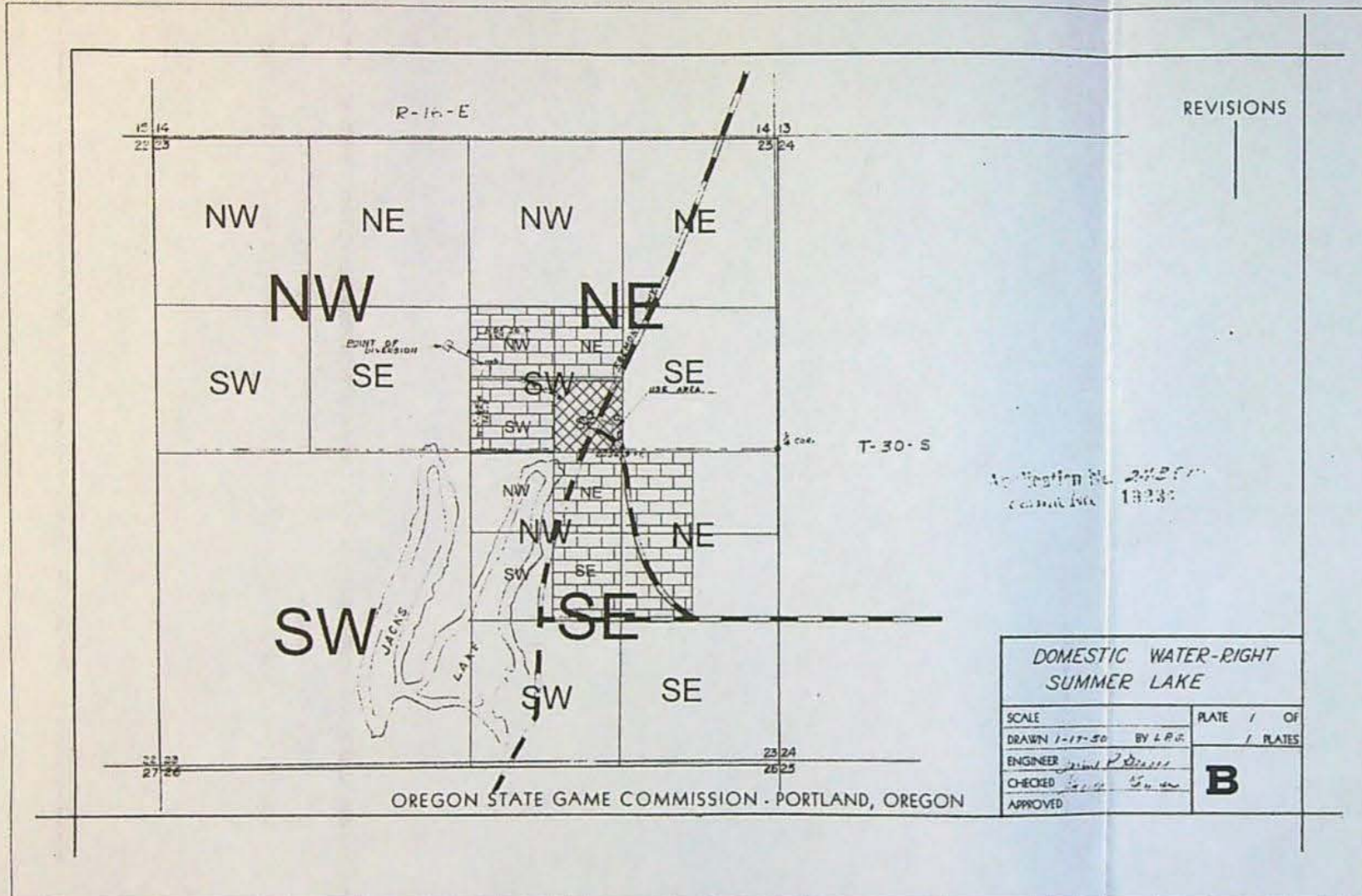

Authorized POU Certificate # 21405



Additional / Added POU

Disclaimer - This map is not intended to provide legal dimensions or locations of property ownership lines.

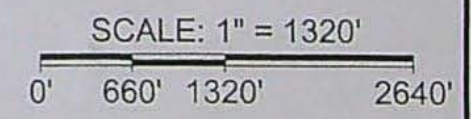

SITE MAP  
SCALE: 1" = 1320'

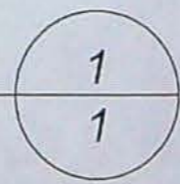

## OREGON DEPARTMENT OF FISH AND WILDLIFE

RECEIVED

FEB 27 2023

OWRD  
SALEM, OREGON

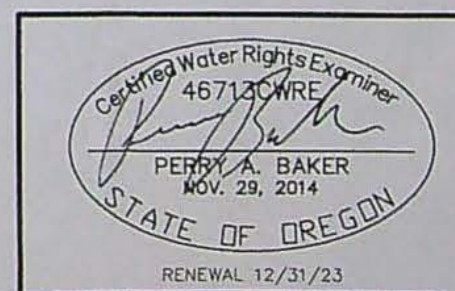

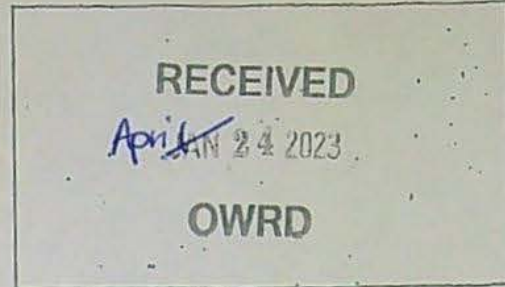

Date Received (Date Stamp Here)

## OWRD Over-the-Counter Submission Receipt

Applicant Name(s) & Address: Perry Baker / ODFW

4034 Industrial Dr. SE, Salem OR 97302

Transaction Type: Transfer

Fees Received: \$ 1360.00

Cash  Check: Check No. 126490469

Name(s) on Check: ODFW

Thank you for your submission. Oregon Water Resources Department (Department) staff will review your submittal as soon as possible.

If your submission is determined to be complete, you will receive a receipt for the fees paid and an acknowledgement letter stating your submittal is complete.

If determined to be incomplete, your submission and the accompanying fees will be returned with an explanation of deficiencies that must be addressed in order for the submittal to be accepted.

If you have any questions, please feel free to contact the Department's Customer Service staff at 503-986-0801 or 503-986-0810.

Sincerely,

OWRD Customer Service Staff

Submission received by: Corie Lornien  
(Name of OWRD staff)

### Instructions for OWRD staff:

- Complete this Submission Receipt and make two (2) copies. Place one copy with the check/cash, and place the other copy with the submission (i.e., the application or other document).
- Date-stamp all pages. (NOTE: Do not stamp check.)
- Give this original Submission Receipt to the applicant.
- Record Submission Receipt Information on the "RECEIVED OVER THE COUNTER" log sheet.
- Fold and put one copy of the Submission Receipt with check/cash into the Safe slot. Place the other copy of the Submission Receipt with submission (application/other document) in the top drawer of filing cabinet.



# Oregon

Kate Brown, Governor

**Water Resources Department**

725 Summer St NE, Suite A

Salem, OR 97301

(503) 986-0900

Fax (503) 986-0904

March 1, 2023

PERRY A. BAKER  
OREGON DEPT. OF FISH AND WILDLIFE  
4034 INDUSTRIAL DR. SE  
SALEM, OR 97302

**RECEIVED**

APR 24 2023

**OWRD**

Permanent Transfer Application:

The Department is returning your application for the following reasons.

- Land Use form was not enclosed.
  - Please submit with the completed Land Use Form.
  
- Evidence of Use form was missing.
  - Please submit with the Evidence of Use form and supporting documentation.

Please contact the customer service number at 503-986-0801  
If you need assistance with your application.

Transfer and Conservation Section  
Oregon Department of Water Resources

## Permanent Transfer Application Checklist

Check the Certificates in WRIS

Transfer # T- 14224

Checked by <u>  Dante  </u>	Type of Change(s) Proposed: <u>NO</u> other changes allowed other than those listed	
Date <u>  4/25/2023  </u>		
Fee Received: \$1360	<input type="checkbox"/> POU <input type="checkbox"/> POD <input checked="" type="checkbox"/> APOD <input type="checkbox"/> POA <input type="checkbox"/> APOA <input type="checkbox"/> USE	
Calculated Fee: \$1360		How many rights to be Transferred? <u>  1  </u>
Deficiencies and Observations:		Certificate #(s) <u>  21405  </u>

If OK, check box; if not, fill in.

- 1. Is the applicant information complete? Have all the applicants listed at the top of the page signed at the bottom?  
If not, what is missing? Whose signature is missing? \_\_\_\_\_
- 2. Has the applicant indicated that the place of use is in or near an irrigation district? Have they included a Form D?  N/A.  
Name of the District \_\_\_\_\_
- 3. Part 5 of application, has the applicant completed the entire page and does the information match the description of the explanation of the reasons on Part 4 of the application?  
If not, you may need to contact the applicant or agent? \_\_\_\_\_
- 4. For multiple certificates, do each of the certificates listed on Application Page 1 have their own separate completed Part 5 tables 1 & 2? (compare with OAR 690-380-3220-may need to return)  
If no, which certificates are missing a separate Part 5, tables 1 & 2? \_\_\_\_\_
- 5. Has the map been completed and signed by a CWRE? Does the map meet the requirements?  
If not, what is missing? \_\_\_\_\_. Map waiver included?
- 6. If a change in point of appropriation, have the well logs been included?  N/A.
- 7. If a change in place of use within Umatilla County, have the applicant(s) provided a Supplemental Form U?  N/A.
- 8. Has applicant filled out the Minimum Requirements Checklist (Part 1 of 5)? Is the application complete? If not, what is missing (check Evidence of Use and Land Use)? \_\_\_\_\_  
\_\_\_\_\_
- 9. If all boxes on this checklist are checked (with no remaining deficiencies identified), accept the application. Put this check sheet in the transfer folder.

OR:

- This application is deficient, and **CANNOT** be accepted.  
It should be returned and the deficiencies listed in the "staff" section at the bottom of Application Page 1, unless the applicant or agent can resolve the deficiencies within 2-3 days.

Actions taken:

\_\_\_\_\_ date \_\_\_\_\_

