

TEMPORARY

T-14719

Name Knife River Corporation-Northwest
Attn: Jeff Steyaert
Address 32260 Old Highway 34
Tangent, OR 97389
jeff.steyaert@kniferiver.com

DESCRIPTION OF WATER RIGHT(S)

Name of Stream Middle Fork Willamette River, Mill Race
Trib. of Willamette River, Middle Fork Willamette River
Use Industrial/Manufacturing uses, Mining County Lane
Quantity of water (CFS) No. of Acres
Name of ditch
App# S-39170 Per # S-29217 Cert # 91508 PR Date 10/16/1963
App# Per # Cert # PR Date
App# Per # Cert # PR Date
App# Per # Cert # PR Date

FEES PAID		
Date	Amount	Receipt #
8-8-25	\$ 1,180.00	145788
8-22-25	\$ 590.00	145890

Change in POV, POD
Date Filed 8/22/2025
Initial notice date 9/9/2025
DPD issued date
PD issued date
PD notice date
Date of FO 11/24/2025 Vol 138 Page 121-124
C-Date
COBU due date
COBU Received date
Certificate issued

FEES REFUNDED		
Date	Amount	Receipt #

Assignments:

Irrigation District

Agent Thomas J. Calabrese - Enviro Logic Resources, Inc.
tomcalabrese@h2ogeo.com

CWRE
CC's list Lane County Land Management, City of Springfield, City of Eugene

- Oversized map - Location



Oregon

Tina Kotek, Governor

Water Resources Department

North Mall Office Building

725 Summer St NE, Suite A

Salem, OR 97301

Phone 503 986-0900

Fax 503 986-0904

www.oregon.gov/owrd

November 24, 2025

Jeff Steyaert
32260 Old Highway 34
Tangent, OR 97389

REFERENCE: District Temporary Transfer Application T-14719

Enclosed is a copy of the final order approving your TEMPORARY water right transfer application.

The temporary change shall be effective at the **beginning of the 2026 irrigation season**. The use shall revert to the original authorized place of use at the **end of the 2030 irrigation season**.

If you have any questions related to the approval of this temporary transfer, you may contact your caseworker, Joan Smith, by telephone at (503) 986-0892 or by e-mail at Joan.m.smith@water.oregon.gov.

Sincerely,

David V. Jones Jr
Water Rights Services Support
Transfers and Conservation Section

cc: Lanaya F. Blakely, Watermaster Dist. # 2 (via email)
Thomas J. Calabrese, Agent
Lane County Land Management, Local Government
City of Springfield, Local Government
City of Eugene, Local Government

Enclosure

**BEFORE THE WATER RESOURCES DEPARTMENT
OF THE
STATE OF OREGON**

In the Matter of Transfer Application)	FINAL ORDER APPROVING TEMPORARY
T-14719, Lane County)	CHANGES IN PLACE OF USE AND POINT
)	OF DIVERSION

Authority

Oregon Revised Statute (ORS) 540.505 to 540.580 establish the process in which a water right holder may submit a request to temporarily transfer the place of use and, if necessary to convey the water to the temporary place of use, the point of diversion authorized under an existing water right.

Oregon Administrative Rule (OAR) Chapter 690, Division 380 implements the statutes and provides the Department's procedures and criteria for evaluating transfer applications.

Applicant

KNIFE RIVER CORPORATION-NORTHWEST
ATTN: JEFF STEYAERT
32260 OLD HIGHWAY 34
TANGENT, OR 97389

Findings of Fact

1. On August 22, 2025, Knife River Corporation - Northwest, Attn: Jeff Steyaert filed an application to temporarily change the place of use and to change the point of diversion to serve the proposed place of use under Certificate 91508 for a period of 5 years. The Department assigned the application number T-14719.
2. Notice of the application for transfer was published on September 9, 2025, pursuant to OAR 690-380-4000.
3. The right to be temporarily transferred is as follows:
Certificate: 91508 in the name of MORSE BROS INC. DBA KNIFE RIVER CORPORATION AND MDU RESOURCES COMPANY (perfected under Permit S-29217)
Use: INDUSTRIAL AND MINING
Priority Date: OCTOBER 16, 1963

This is a final order in other than a contested case. This order is subject to judicial review under ORS 183.484. Any petition for judicial review must be filed within the 60-day time period specified by ORS 183.484(2). Pursuant to ORS 536.075 and OAR 137-004-0080, you may petition for judicial review or petition the Director for reconsideration of this order. A petition for reconsideration may be granted or denied by the Director, and if no action is taken within 60 days following the date the petition was filed, the petition shall be deemed denied.

Rate: 1.3 CUBIC FEET PER SECOND
Limit/Duty: The amount of water used to which this right is entitled is limited to the amount used beneficially, and shall not exceed the amount specified, or its equivalent in the case of rotation, measure at the points of diversion from the source.
Source: MIDDLE FORK WILLAMETTE RIVER THROUGH GEORGIA PACIFIC MILL RACE, tributary to WILLAMETTE RIVER

Authorized Points of Diversion / Re-diversion:

Twp	Rng	Mer	Sec	Q-Q	DLC	Measured Distances
18 S	2 W	WM	8	NW NE		RIVER DIVERSION - 450 FEET SOUTH AND 2150 FEET WEST FROM THE NE CORNER OF SECTION 8
18 S	3 W	WM	1	NE NW	39	MILL RACE RE-DIVERSION - 370 FEET SOUTH AND 2370 FEET EAST FROM THE NW CORNER OF SECTION 1

Authorized Place of Use:

INDUSTRIAL AND MINING						
Twp	Rng	Mer	Sec	Q-Q	GLot	DLC
18 S	3 W	WM	1	NE NW	11	
18 S	3 W	WM	1	NE NW		39
18 S	3 W	WM	1	NW NW	12	
18 S	3 W	WM	1	NW SW		
18 S	3 W	WM	2	NE NE	10	
18 S	3 W	WM	2	SE NE	11	
18 S	3 W	WM	2	NE SE	12	

4. Temporary Transfer Application T-14719 proposes to temporarily change the place of use of the right to:

INDUSTRIAL AND MINING					
Twp	Rng	Mer	Sec	Q-Q	GLot
17 S	3 W	WM	7	SW SW	4
17 S	3 W	WM	12	SE SE	
17 S	3 W	WM	13	NE NE	
17 S	3 W	WM	18	NW NW	

5. A change in point of diversion is necessary to convey the water to the proposed temporary place of use. Temporary Transfer Application T-14719 proposes to move the authorized points of diversion (POD) with approximate distances downstream from the authorized points to:

Twp	Rng	Mer	Sec	Q-Q	GLot	Measured Distances	Distance from the authorized POD in miles (mi.)
17 S	3 W	WM	7	SW SW	4	PROPOSED POD – 770 FEET NORTH AND 760 FEET EAST FROM THE SW CORNER OF SECTION 7	River Div. – 6.84 mi.
							Mill Race Re-Div.– 9.11 mi.

Temporary Transfer Review Criteria

6. Water has been used within the last five years according to the terms and conditions of the right. There is no evidence available that would demonstrate that the right is subject to forfeiture under ORS 540.610.
7. A pump, pipeline, and sprinkler system sufficient to use the full amount of water allowed under the existing right are present.
8. The proposed changes would prevent the lands from which the water right is removed during the period of the temporary transfer from receiving water under the transferred right, as required by ORS 540.523(7).
9. The proposed changes would not result in injury to other water rights. This finding is made through an abbreviated review recognizing that the transfer may be revoked under ORS 540.523(5) if the Department later finds that the transfer is causing injury to any existing water right.

Conclusions of Law

The temporary changes in place of use and point of diversion to convey water to the temporary place of use proposed in Temporary Transfer Application T-14719 are consistent with the requirements of ORS 540.523 and OAR 690-380-8000.

Now, therefore, it is ORDERED:

1. The temporary change in place of use and change in point of diversion to convey water to the temporary place of use proposed in Temporary Transfer Application T-14719 are approved.
2. The former place of use **shall not** receive water as part of this water right during 2026, 2027, 2028, 2029, and 2030.
3. The use shall revert to the authorized place of use at the end of the 2030. The authorization to use the additional point of diversion shall be terminated concurrently.
4. The approval of this temporary transfer may be revoked or modified if the Department finds the changes cause injury to any existing water right.
5. The quantity of water diverted at the proposed temporary point of diversion (Proposed POD) shall not exceed the quantity of water lawfully available at the original points of diversion (River Diversion and Mill Race Re-Diversion).
6. A subsequent application for permanent transfer of Certificate 91508 shall be subject to a full and complete review to determine consistency with the requirements of OAR Chapter 690, Division 380. Approval of this temporary transfer does not establish a precedent for approval of a subsequent application filed for a permanent transfer.

7. The use of water at the temporary place of use authorized by this transfer shall be in accordance with the terms and conditions of Certificate 91508.
8. The time during which water is used under this approved temporary transfer does not apply toward a finding of forfeiture under ORS 540.610.
9. Water use measurement conditions:
 - a. Before water use may begin under this order, the water user shall install a totalizing flow meter, or, with prior approval of the Director, another suitable measuring device, at each point of diversion.
 - b. The water user shall maintain the meters or measuring devices in good working order.
 - c. The water user shall allow the Watermaster access to the meters or measuring devices; provided however, where the meters or measuring devices are located within a private structure, the Watermaster shall request access upon reasonable notice.

Dated in Salem, Oregon on NOV 24 2025



Lisa J. Jaramillo, Transfer and Conservation Section Manager, for
IVAN GALL, DIRECTOR
Oregon Water Resources Department

Mailing Date: NOV 25 2025

WATER RIGHT TRANSFER COVER SHEET

Transfer: T-14719

Transfer Specialist: *Jon*

Transfer Type: Temporary Transfer

DROUGHT?

Applicant: Jeff Steyaert 32260 Old Highway 34 Tangent, OR 97389	Agent: Thomas J. Calabrese PO BOX 80762 Portland, OR 97280	Receiving Landowner:
Current Landowner if other than Applicant:	CWRE:	Irrigation District:
Affected Local Gov'ts: Lane County Land Management	Affected Tribal Gov't:	BOR Notified (date):

Water Rights Affected

File Marked	App. File # or Decree Name	Permit	Certificate
<input type="checkbox"/>	S-39170	S-29217	91508
<input type="checkbox"/>			
<input type="checkbox"/>			

Key Dates & Initial Actions (Support Staff)

Rec'd: August 22, 2025	Proposed Action(s): POINT OF DIVERSION; PLACE OF USE	
Fees Pd: 1770.00	Acknowledgement Letter Sent <input checked="" type="checkbox"/>	Basin: 2 Willamette
Initial Public Notice: 9/9/2025	County sent cc: of Ack Letter <input checked="" type="checkbox"/>	County: LANE
WM District: 2 Lanaya F. Blakely	WM Review request sent: 9/2/2025	WM Review date received:
Groundwater	GW Review sent:	GW Review date received:

Peer Review:

Document	Drafted	Peer Review	Coordinator	Changes Made	Signature Bin	Signature Date
FO	Date: <u>11/4/25</u> Initials: <i>Jon</i>	Date: <u>11/5/25</u> Initials: <i>Scott</i>	Date: <u>11/10/25</u> Initials: <i>Jon</i>	Date: _____ Initials: _____	Date: <u>11/7/25</u> No. of docs for sig: _____ WM Sheet <input type="checkbox"/>	Date: <u>11/24/2025</u>

Special Issues: _____

Special Order Volume: Vol. 138 Pages 121-124

*5 yr
TEMP*

Watermaster Review Form: Water Right Transfer



Oregon Water Resources Department
725 Summer St NE, Suite A
Salem, Oregon 97301-1266
(503) 986-0900
www.oregon.gov/OWRD

Transfer Application: T-14719

Review Due Date:

Applicant Name: **KNIFE RIVER CORPORATION**

Proposed Changes: POU POD POA USE OTHER

Reviewer(s): **L. Blakely**

Date of Review: **10/06/2025**

1. Do you have evidence that the right has not been used in the last 5 years and that the presumption of forfeiture would not likely be rebuttable? Yes No If "Yes", attach evidence (e.g. dated aerial photo showing pavement or building on the land for >5 yrs.)

2. Is there a history of regulation on the source that serves this (or these) right(s) that has involved the transferred right(s) and downstream water rights? Yes No Generally characterize the frequency of any regulation or explain why regulation has not occurred:

3. Have headgate notices been issued for the source that serves the transferred right(s)?
 Yes No Records not available.

4. In your estimation, after the proposed change, would distribution of water for the right(s) result in regulation of other water rights that would not have occurred if use under the original right(s) was/were maximized? Yes No If "Yes", explain:

5. In your estimation, if the proposed change is approved, are there upstream water rights that would be affected? Yes No If "Yes", describe how the rights would be affected and list the rights most affected:

6. Check here if it appears that downstream water rights benefit from return flows resulting from the current use of the transferred right(s)? If you check the box, generally characterize the locations where the return flows likely occur and list the water rights that benefit most:

N/A

7. For POD changes and instream transfers, check here if there are channel losses between the old and new PODs or within the proposed instream reach? If you check the box, describe and, if possible, estimate the losses:

N/A

8. For instream transfers that propose protection of a reach beyond the mouth of the source stream:

N/A Would the quantity be measureable into the receiving stream consistent with OAR 690-077-0015(8)? Yes No

9. For POU changes: N/A Is it likely the original place of use would continue to receive water from the same source? Yes No If "Yes", explain:

10. For POU or USE changes: N/A In your best judgment, would use of the existing right at "full face value," result in the diversion of more water than can be used beneficially and without waste?

Yes No If "Yes", explain:

11. For POU changes that involve micro-irrigation: N/A

a. Has the applicant made changes (absent a transfer) to convert to micro-irrigation within the current place of use boundary of the water right proposed for transfer, and previously demonstrated to the Department through monitoring and site inspections by the Watermaster that the proposed transfer will not result in injury or enlargement?

Yes No If "Yes", explain:

b. Has a temporary transfer of this nature been previously filed and approved on the same lands (or portions thereof) as those lands involved in this transfer?

Yes No If "Yes", answer the following:

i. Were there any problems with more acres being irrigated (or wetted) than were authorized under the temporary transfer? Yes No If "Yes", explain:

ii. Did the designated areas that were to remain dry (or not wetted) under the temporary transfer actually remain dry? Yes No If "No", explain:

iii. Did the applicant comply with and meet all of the conditions of the temporary transfer? Yes No If "No", explain:

iv. Do you have any other observations regarding the temporary transfer? Yes No If "Yes", describe:

v. Did the applicant demonstrate to the Department through monitoring and site inspections by the Watermaster that neither injury nor enlargement occurred as a result of the temporary transfer? Yes No If "No", explain:

c. To the best of your knowledge, if this transfer is approved, does it appear that:

i. "Injury" will occur to other water rights that share the same source? Yes No If "Yes", explain:

ii. "Enlargement" of the water right being transferred will occur? Yes No If "Yes", explain:

12. Are there other issues not identified through the above questions that should be considered in determining whether the change “can be effected without injury to other rights”?

Yes No If “Yes”, explain:

13. What alternatives may be available for addressing any issues identified above:

14. Do conditions need to be included in the transfer order to avoid enlargement of the right or injury to other rights? No Yes, as checked and provided below:

For POU changes that involve micro-irrigation, provide the monitoring and reporting conditions necessary to prevent injury/enlargement:

A Headgate should be required prior to diverting water.

Measurement Devices for POD or POA: (if this condition is selected, also fill in the top sections of Page 4)

*a. Before water use may begin under this order, the water user shall install a **totalizing flow meter***, or, with prior approval of the Director, another suitable measuring device, at each point of diversion/appropriation (new and existing) **OR** at each new point of diversion/appropriation with the exception that water rights issued to the Bureau of Reclamation or an irrigation district (or similar entity) are not subject to this condition.*

b. The water user shall maintain the meters or measuring devices in good working order.

c. The water user shall allow the Watermaster access to the meters or measuring devices; provided however, where the meters or measuring devices are located within a private structure, the Watermaster shall request access upon reasonable notice.

Reservoir water use measurement: (if this condition is selected, also fill in the top sections of Page 4)

*a. Before water use may begin under this order, the water user shall install **staff gages***, or, with prior approval of the Director, other suitable measuring devices, that measure the entire range and stage between empty and full in each reservoir. Staff gages shall be United States Geological Survey style.*

b. Before water use may begin under this order, if the reservoir is located in channel, weirs or other suitable measuring devices must be installed upstream and downstream of the reservoir, and, an adjustable outlet valve must be installed. The water user shall maintain such devices in good working order. A written waiver may be obtained, if in the judgment of the Director, the installation of weirs or other suitable measuring devices, or the adjustable outlet valve, will provide no public benefit.

*** The following alternative device(s) should be substituted for the bold, underlined device in the above selected condition:**

Weir

Submerged Orifice

Parshall Flume

Flow Restrictor

Other: ___



Oregon

Tina Kotek, Governor

Water Resources Department

North Mall Office Building

725 Summer St NE, Suite A

Salem, OR 97301

Phone 503 986-0900

Fax 503 986-0904

September 2, 2025

Jeff Steyaert
32260 Old Highway 34
Tangent, OR 97389

Reference: Application T-14719

On August 22, 2025, the Department received your water right Temporary Transfer Application. The application was accompanied by \$1770.00. Receipts are enclosed.

By copy of this letter, we are asking the Watermaster for a report regarding the potential for injury to existing water rights which may be caused by the requested change.

Except as provided under ORS 540.510(3) for municipalities, you may not *temporarily* use water at the new place of use or from the new point of diversion until a final order approving the temporary transfer application has been issued by the Department. Additionally, pursuant to OAR 690-380-8010, the lands from which an irrigation water right is to be temporarily transferred and the land to which the right is to be temporarily transferred may not both receive water during the same season. If the temporary transfer is approved during an irrigation season and water has already been used at the currently authorized location during that season, then the temporary transfer will not take effect until the following season.

If the land is sold before the temporary transfer is approved, the buyer's consent to the temporary transfer will be required unless a recorded deed or other legal document clearly established that the water right was not conveyed in the sale.

If you have any questions, please contact the Transfer Section at (503) 986-0935.

Cc: Watermaster Dist. #2, Lanaya F. Blakely (via email)
Thomas J. Calabrese, Agent
Lane County Land Management, Local Government
City of Springfield, Local Government
City of Eugene, Local Government

Enclosure

Steyaert, Jeff

From: RICHMAN Elyse D * WRD <Elyse.D.RICHMAN@water.oregon.gov>
Sent: Monday, August 11, 2025 1:09 PM
To: Steyaert, Jeff; tomcalabrese@h2ogeo.com
Subject: Insufficient fees for temporary transfer

You don't often get email from elyse.d.richman@water.oregon.gov. [Learn why this is important](#)

**** WARNING: EXTERNAL SENDER. NEVER click links or open attachments without positive sender verification of purpose. DO NOT provide your user ID or password on sites or forms linked from this email. ****

Good afternoon,

I just spoke with Tom regarding the insufficient fees that were submitted along with a temporary transfer application for Knife River Corporation. He explained that the process of submitting the application was held up by the county Land Use form and ended up being submitted after the Department fee increases took effect.

I entered the information for your application into the updated fee calculation tool on our website and the total needed for application processing is \$1,770. We received \$1,180.00, so an amount of \$590.00 is still needed before I can finish the intake process for the application. You can find the Transfer Fee Calculation Tool for Temporary Transfers here: [Transfer Fee Calculation for Temporary Transfer](#).

I will hang onto the application until I have received the remaining \$590.00 and will submit both checks to be receipted by our fiscal section at the same time.

Thank you and please don't hesitate to reach out if you have any questions.

Best regards,

[Elyse D. Richman](#)

she/her/hers

Transfer Specialist

725 Summer Street NE, Suite A, Salem, OR 97301

Phone: 971-701-5485



[Integrity](#) | [Service](#) | [Technical Excellence](#) | [Teamwork](#) | [Forward-Looking](#)

Received
AUG 22 2025
OWRD

Temporary Transfer Application Intake Checklist

Transfer # T- 14719

Reviewer Elyse	Type of Change(s) Proposed: <u>MUST INCLUDE A CHANGE IN PLACE OF USE</u>		
Date 8/11/2025	<input checked="" type="checkbox"/> POU	<input checked="" type="checkbox"/> POU/POD	<input type="checkbox"/> POU/APOD <input type="checkbox"/> POU/POA <input type="checkbox"/> POU/APOA
Calculated Fee \$ 1,770 Use fee calculator on back of this form		Fee Received \$ 1,180.00	
Certificate(s): 91508		Check <u>ALL</u> Certs in WRIS to confirm they are not cancelled	
For multiple certificates, does application meet requirement of OAR 690-380-3220? If no, why? Use the flow chart for multiple Certs			<input type="checkbox"/> YES <input type="checkbox"/> NO <input checked="" type="checkbox"/> N/A
Notes:			

Application: OAR 690-380-3000; OAR 690-380-3220			
1.	<input checked="" type="checkbox"/> YES	<input type="checkbox"/> NO	Have <u>ALL</u> of the applicant's signed and dated the application? If no, whose signature is missing?
2.	<input checked="" type="checkbox"/> YES	<input type="checkbox"/> NO	Part 5 of application: Does the information match the description of the explanation on Part 4 of the application?
3.	<input type="checkbox"/> YES	<input type="checkbox"/> NO	<input checked="" type="checkbox"/> N/A
For multiple certificates: Each certificate proposed for transfer has their own separate completed Part 5, Tables 1 & 2? If no, which certificate(s) are missing separate Part 5, Tables 1 & 2?			

Map Requirements: OAR 690-380-3100			
4.	<input checked="" type="checkbox"/> YES	<input type="checkbox"/> NO	Map included and meets mapping requirements?
5.	<input type="checkbox"/> YES	<input type="checkbox"/> NO	<input checked="" type="checkbox"/> N/A
Map Waiver? The map waiver must be issued by the Department			
Notes:			

Attachments: OAR 690-380-3000			
6.	<input checked="" type="checkbox"/> YES	<input type="checkbox"/> NO	Evidence of Use included, signed, & notarized w/supporting documentation?
	<input type="checkbox"/> YES	<input type="checkbox"/> NO	Current recorded deed for the land from which the authorized place of use is temporarily being moved included?
	<input type="checkbox"/> YES	<input type="checkbox"/> NO	<input checked="" type="checkbox"/> N/A
Affidavit of Consent from Landowner(s) described on the deed?			
7.	<input checked="" type="checkbox"/> YES	<input type="checkbox"/> NO	<input type="checkbox"/> N/A
Land Use Form included and signed by the County?			
8.	<input type="checkbox"/> YES	<input type="checkbox"/> NO	<input checked="" type="checkbox"/> N/A
Consent Form included, signed, and notarized?			
9.	<input type="checkbox"/> YES	<input checked="" type="checkbox"/> NO	<input type="checkbox"/> N/A
	District: Place of use is in <u>or</u> near an irrigation district?		
If Yes, is Form D included? Name of the District			
10.	<input type="checkbox"/> YES	<input type="checkbox"/> NO	<input checked="" type="checkbox"/> N/A
For changes in POA/APOA – are the well logs included?			
11.	<input type="checkbox"/> YES	<input type="checkbox"/> NO	<input checked="" type="checkbox"/> N/A
For change in POU within Umatilla County, Supplemental Form U included?			

<input type="checkbox"/>	Application complete: no deficiencies identified, assign a T-number and put this checklist in T-folder.
<input type="checkbox"/>	Application DEFICIENT: DO NOT accept - return to applicant with letter explaining deficiencies identified.

**STATE OF OREGON
WATER RESOURCES DEPARTMENT**

725 Summer St. N.E. Ste. A

SALEM, OR 97301-4172

(503) 986-0900 / (503) 986-0904 (fax)

RECEIPT # **145890**

INVOICE # _____

RECEIVED FROM: Knap River Corporation - Northwest
BY: _____

APPLICATION	
PERMIT	
TRANSFER	<u>T-14719</u>

CASH: CHECK:# 2479 OTHER: (IDENTIFY) 4772

TOTAL REC'D \$ 590.00

1083 TREASURY 4170 WRD MISC CASH ACCT

0407	COPIES	\$
_____	OTHER: (IDENTIFY) _____	\$
0243	I/S Lease _____	
0244	Muni Water Mgmt. Plan _____	
0245	Cons. Water _____	

4270 WRD OPERATING ACCT

MISCELLANEOUS		
0407	COPY & TAPE FEES <u>46110</u>	\$
0410	RESEARCH FEES	\$
0408	MISC REVENUE: (IDENTIFY) _____	\$
TC162	DEPOSIT LIAB. (IDENTIFY) _____	\$
0240	EXTENSION OF TIME	\$
WATER RIGHTS:		
0201	SURFACE WATER	EXAM FEE 0202 \$
0203	GROUND WATER	EXAM FEE 0204 \$
0205	TRANSFER	EXAM FEE \$ <u>590.00</u>
WELL CONSTRUCTION		
0218	WELL DRILL CONSTRUCTOR	EXAM FEE 0219 \$
_____	LANDOWNER'S PERMIT	0220 \$
_____	OTHER (IDENTIFY) _____	

0536 TREASURY 0437 WELL CONST. START FEE

0211	WELL CONST START FEE	\$	CARD#	
0210	MONITORING WELLS	\$	CARD#	
_____	OTHER (IDENTIFY) _____			

0607 TREASURY 0467 HYDRO ACTIVITY LIC NUMBER

0233	POWER LICENSE FEE (FW/WRD)	\$
0231	HYDRO LICENSE FEE (FW/WRD)	\$
_____	HYDRO APPLICATION	\$

TREASURY OTHER / RDX

FUND _____ TITLE _____
OBJ. CODE _____ VENDOR # _____
DESCRIPTION _____ \$ _____

RECEIPT: **145890**

DATED: 8/22/25 BY: [Signature]

**STATE OF OREGON
WATER RESOURCES DEPARTMENT**

725 Summer St. N.E. Ste. A
SALEM, OR 97301-4172

(503) 986-0900 / (503) 986-0904 (fax)

RECEIPT # **145788**

INVOICE # _____

RECEIVED FROM: Knik River Corporation
BY: Walthurst

APPLICATION	
PERMIT	
TRANSFER	<u>T-14719</u>

CASH: CHECK:# 2479 OTHER: (IDENTIFY)
3966

TOTAL REC'D \$ 1,180.

1083 TREASURY 4170 WRD MISC CASH ACCT

0407	COPIES		\$
	OTHER: (IDENTIFY)		\$
0243	I/S Lease		
0244	Muni Water Mgmt. Plan		
0245	Cons. Water		

4270 WRD OPERATING ACCT

MISCELLANEOUS			
0407	COPY & TAPE FEES	<u>46110</u>	\$
0410	RESEARCH FEES		\$
0408	MISC REVENUE: (IDENTIFY)		\$
TC162	DEPOSIT LIAB. (IDENTIFY)		\$
0240	EXTENSION OF TIME		\$
WATER RIGHTS:			
0201	SURFACE WATER	EXAM FEE	RECORD FEE
0203	GROUND WATER	\$	0202 \$
0205	TRANSFER	\$	0204 \$
WELL CONSTRUCTION			
0218	WELL DRILL CONSTRUCTOR	EXAM FEE	LICENSE FEE
	LANDOWNER'S PERMIT	\$ <u>1,180.00</u>	0219 \$
	OTHER (IDENTIFY)		0220 \$

0536 TREASURY 0437 WELL CONST. START FEE

0211	WELL CONST START FEE	\$	CARD#
0210	MONITORING WELLS	\$	CARD#
	OTHER (IDENTIFY)		

0607 TREASURY 0467 HYDRO ACTIVITY LIC NUMBER

0233	POWER LICENSE FEE (FW/WRD)		\$
0231	HYDRO LICENSE FEE (FW/WRD)		\$
	HYDRO APPLICATION		\$

TREASURY OTHER / RDX

FUND _____ TITLE _____
OBJ. CODE _____ VENDOR # _____
DESCRIPTION _____ \$ _____

**RECEIVED
OVER THE COUNTER**

RECEIPT: **145788**

DATED: 8/8/25 BY: [Signature]

**Application for Water Right
Temporary or Drought Temporary Transfer
Part 1 of 5 – Minimum Requirements Checklist**



Oregon Water Resources Department
725 Summer Street NE, Suite A
Salem, Oregon 97301-1266
(503) 986-0900
www.oregon.gov/OWRD

This temporary transfer application will be returned if Parts 1 through 5 and all required attachments are not completed and included.
For questions, please call (503) 986-0900, and ask for Transfer Section.

Salem, OR

AUG 08 2025

Received by OWRD

FOR ALL TEMPORARY TRANSFER APPLICATIONS

Check all items included with this application. (N/A = Not Applicable)

- Part 1 – Completed Minimum Requirements Checklist.
- Part 2 – Completed Temporary Transfer Application Map Checklist.
- Part 3 – Application Fee, payable by check to the Oregon Water Resources Department, and completed Fee Worksheet, page 3. Try the online fee calculator at: http://apps.wrd.state.or.us/apps/misc/wrd_fee_calculator.
- Part 4 – Completed Applicant Information and Signature.
- Part 5 – Information about Transferred Water Rights: **How many water rights are to be transferred? 1 List them here: Certificate 91508**
Please include a separate Part 5 for each water right. (See instructions on page 6)
- N/A For standard Temporary Transfer (one to five years) Begin Year: 2026 End Year: 2030.
- N/A Temporary Drought Transfer (Only in counties where the Governor has declared drought)

Attachments:

- Completed Temporary Transfer Application Map.
- Completed Evidence of Use Affidavit and supporting documentation.
- Current recorded deed for the land **from** which the authorized place of use is temporarily being moved.
- N/A Affidavit(s) of Consent from Landowner(s) (if the applicant does not own the land upon which the water right is located.)
- N/A Supplemental Form D – For water rights served by or issued in the name of a district. Complete when the temporary transfer applicant is not the district.
- N/A Oregon Water Resources Department’s Land Use Information Form with approval and signature from each local land use authority in which water is to be diverted, conveyed, and/or used. Not required if water is to be diverted, conveyed, and/or used only on federal lands or if **all** of the following apply: a) a change in place of use only, b) no structural changes, c) the use of water is for irrigation only, and d) the use is located within an irrigation district or an exclusive farm use zone.
- N/A Water Well Report/Well Log for changes in point(s) of appropriation (well(s)) or additional point(s) of appropriation (if necessary to convey water to the proposed place of use).

(For Staff Use Only)

WE ARE RETURNING YOUR APPLICATION FOR THE FOLLOWING REASON(S):

Application fee not enclosed/insufficient Map not included or incomplete

Land Use Form not enclosed or incomplete

Additional signature(s) required Part _____ is incomplete

Other/Explanation _____

Staff: _____ Phone: _____ Date: ____/____/____

Part 2 of 5 – Temporary Transfer Application Map Checklist

Your temporary transfer application will be returned if any of the map requirements listed below are not met.

Please be sure that the temporary transfer application map you submit includes all the required items and matches the existing water right map. Check all boxes that apply.

- N/A If more than three water rights are involved, separate maps are needed for each water right.
- Permanent quality printed with dark ink on good quality paper.
- The size of the map can be 8½ x 11 inches, 8½ x 14 inches, 11 x 17 inches, or up to 30 x 30 inches. For 30 x 30 inch maps, one extra copy is required.
- A north arrow, a legend, and scale.
- The scale of the map must be: 1 inch = 400 feet, 1 inch = 1,320 feet; the scale of the Final Proof/Claim of Beneficial Use Map (the map used when the permit was certificated); the scale of the county assessor map if the scale is not smaller than 1 inch = 1,320 feet; or a scale that has been pre-approved by the Department.
- Township, Range, Section, ¼ ¼, DLC, Government Lot, and other recognized public land survey lines.
- Tax lot boundaries (property lines) are required. Tax lot numbers are recommended.
- Major physical features including rivers and creeks showing direction of flow, lakes and reservoirs, roads, and railroads.
- Major water delivery system features from the point(s) of diversion/appropriation such as main pipelines, canals, and ditches.
- Existing place of use that includes separate hachuring for each water right, priority date, and use including number of acres in each quarter-quarter section, government lot, or in each quarter-quarter section as projected within government lots, donation land claims, or other recognized public land survey subdivisions. If less than the entirety of the water right is being changed, a separate hachuring is needed for lands left unchanged.
- N/A Proposed temporary place of use that includes separate hachuring for each water right, priority date, and use including number of acres in each quarter-quarter section, government lot, or in each quarter-quarter section as projected within government lots, donation land claims, or other recognized public land survey subdivisions.
- Existing point(s) of diversion or well(s) with distance and bearing or coordinates from a recognized survey corner. This information can be found in your water right certificate or permit.
- N/A If you are proposing a change in point(s) of diversion or well(s) to convey water to the new temporary place of use, show the proposed location and label it clearly with distance and bearing or coordinates. If GPS coordinates are used, latitude-longitude coordinates may be expressed as either degrees-minutes-seconds with at least one digit after the decimal (example – 42°32'15.5") or degrees-decimal with five or more digits after the decimal (example – 42.53764°).

Received by OWRD
AUG 08 2025

Part 4 of 5 – Applicant Information and Signature

Applicant Information

APPLICANT/BUSINESS NAME Knife River Corporation - Northwest Attn: Jeff Steyaert			PHONE NO. (541) 918-5142	ADDITIONAL CONTACT NO.
ADDRESS 32260 Old Highway 34				FAX NO.
CITY Tangent	STATE OR	ZIP 97389	E-MAIL jeff.steyaert@kniferiver.com	
BY PROVIDING AN E-MAIL ADDRESS, CONSENT IS GIVEN TO RECEIVE ALL CORRESPONDENCE FROM THE DEPARTMENT ELECTRONICALLY. COPIES OF THE FINAL ORDER DOCUMENTS WILL ALSO BE MAILED.				

Agent Information – The agent is authorized to represent the applicant in all matters relating to this application.

AGENT/BUSINESS NAME Thomas J. Calabrese – EnviroLogic Resources, Inc.			PHONE NO. (503) 768-5121	ADDITIONAL CONTACT NO.
ADDRESS P.O. Box 80762				FAX NO.
CITY Portland	STATE OR	ZIP 97280	E-MAIL tomcalabrese@h2ogeo.com	
BY PROVIDING AN E-MAIL ADDRESS, CONSENT IS GIVEN TO RECEIVE ALL CORRESPONDENCE FROM THE DEPARTMENT ELECTRONICALLY. COPIES OF THE FINAL ORDER DOCUMENTS WILL ALSO BE MAILED.				

Explain in your own words what you propose to accomplish with this transfer application and why:
This transfer is intended to temporarily change the place of diversion and place of use of an industrial/mining right downriver from our Springfield quarry to our Eugene location.

If you need additional space, continue on a separate piece of paper and attach to the application as "Attachment 1".

I (we) affirm that the information contained in this application is true and accurate.

Applicant signature

Jeffrey R. Steyaert, Assistant Secretary
Print Name (and Title if applicable)

Date

7/10/2025

Applicant signature

Print Name (and Title if applicable)

Date

Applicant signature

Print Name (and Title if applicable)

Date

Applicant signature

Print Name (and Title if applicable)

Date

Applicant signature

Print Name (and Title if applicable)

Date

Applicant signature

Print Name (and Title if applicable)

Date

Is the applicant the sole owner of the land on which the water right, or portion thereof, proposed for transfer is located? Yes No

If NO, include signatures of all landowners (and mailing and/or e-mail addresses if different than the applicant's) or attach affidavits of consent from all landowners or individuals/entities (and mailing and/or e-mail addresses) to which the water right(s) has been conveyed.

Received by OWRD

AUG 08 2025

Salem, OR

Check here if any of the water rights proposed for transfer are or will be located within or served by an irrigation or other water district. (NOTE: If this box is checked, you must complete and attach Supplemental Form D.)

DISTRICT NAME	ADDRESS	
CITY	STATE	ZIP

Check here if water for any of the rights supplied under a water service agreement or other contract for stored water with a federal agency or other entity.

ENTITY NAME	ADDRESS	
CITY	STATE	ZIP

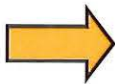

To meet State Land Use Consistency Requirements, you must list all local governments (each county, city, municipal corporation, or tribal government) within whose jurisdiction water will be diverted, conveyed and/or used.

ENTITY NAME Lane County Land Management	ADDRESS 3050 N. Delta Highway	
CITY Eugene	STATE OR	ZIP 97408

ENTITY NAME City of Springfield	ADDRESS 225 Fifth Street	
CITY Springfield	STATE OR	ZIP 97401

ENTITY NAME City of Eugene	ADDRESS 99 W. 10th Avenue	
CITY Eugene	STATE OR	ZIP 97401

Received by OWRD
AUG 08 2025
Salem, OR

Place of Use (POU)

Point of Appropriation/Well (POA)

Character of Use (USE)

Additional Point of Appropriation (APOA)

Point of Diversion (POD)

Additional Point of Diversion (APOD)

Will all of the proposed changes affect the entire water right?

Yes Complete only the Proposed ("to" lands) section of Table 2 on the next page. Use the "CODES" listed above to describe the proposed changes.

No Complete all of Table 2 to describe the portion of the water right to be changed.

Received by OWRD
AUG 08 2025
Salem, OR

Please use and attach additional pages of Table 2 as needed.
See page 6 for instructions.

Do you have questions about how to fill-out the tables?
Contact the Department at 503-986-0900 and ask for Transfer Staff.

Table 2. Description of Temporary Changes to Water Right Certificate # 91508

List only the part of the right that will be changed. For the acreage in each ¼ ¼, list the change proposed. If more than one change, specify the acreage associated with each change. If more than one POD/POA, specify the acreage associated with each POD/POA.

AUTHORIZED (the "from" or "off" lands) The listing that appears on the Certificate BEFORE PROPOSED CHANGES List only that part or portion of the water right that will be changed.										Proposed Changes (see "CODES" from previous page)	PROPOSED (the "to" or "on" lands) The listing as it would appear AFTER PROPOSED CHANGES are made.												
Twp	Rng	Sec	¼ ¼	Tax Lot	Gvt Lot or DLC	Acres	Type of USE listed on Certificate	POD(s) or POA(s) (name or number from Table 1)	Priority Date		Twp	Rng	Sec	¼ ¼	Tax Lot	Gvt Lot or DLC	Acres	New Type of USE	POD(s)/ POA(s) to be used (from Table 1)	Priority Date			
										POU/POD	17	S	3	W	7	SW	SW	400 & 700	L4	N/A	no change	Proposed POD	10/16/1963
										POU/POD	17	S	4	W	12	SE	SE	301, 400 & 700	-	N/A	no change	Proposed POD	10/16/1963
										POU/POD	17	S	4	W	13	NE	NE	400	-	N/A	no change	Proposed POD	10/16/1963
										POU/POD	17	S	3	W	18	NW	NW	400 & 700	-	N/A	no change	Proposed POD	10/16/1963
TOTAL ACRES							TOTAL ACRES										N/A						

Additional remarks: The industrial/mining use authorized in the transferred right would remain unchanged.

Received by OWRD
 AUG 08 2025
 Salem, OR

For Place of Use Changes

Are there other water right certificates, water use permits or ground water registrations associated with the “from” or the “to” lands? Yes No

If YES, list the certificate, water use permit, or ground water registration numbers: Certificate 67279

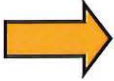

Pursuant to ORS 540.523, any “layered” water use such as an irrigation right that is supplemental to a primary right proposed for temporary transfer can be included in the transfer or remain unused on the authorized place of use. If the primary water right does not revert soon enough to allow use of the supplemental right within five years, the supplemental right shall become subject to cancellation for nonuse under ORS 540.610.

If a change in point(s) of appropriation (well(s)) or additional point(s) of appropriation is necessary to convey the water to the new temporary place of use you must provide:

- Well log(s) for each authorized and proposed well(s) that are clearly labeled and associated with the corresponding well(s) in Table 1 above and on the accompanying application map. (Tip: You may search for well logs on the Department’s web page at: http://apps.wrd.state.or.us/apps/gw/well_log/Default.aspx)

AND/OR

- Describe the construction of the authorized and proposed well(s) in Table 3 below for any well that does not have a well log. For a *proposed well(s) not yet constructed or built*, provide “a best estimate” for each requested information element in the table. The Department recommends you consult a licensed well driller, geologist, or certified water right examiner to assist with assembling the information necessary to complete Table 3.

Table 3. Construction of Point(s) of Appropriation

Any well(s) in this listing must be clearly tied to corresponding well(s) described in Table 1 and shown on the accompanying application map. Failure to provide the information will delay the processing of your transfer application until it is received. The information is necessary for the Department to assess whether the proposed well(s) will access the same source aquifer as the authorized point(s) of appropriation (POA). The Department is prohibited by law from approving POA changes that do not access the same source aquifer.

Proposed or Authorized POA Name or Number	Is well already built? (Yes or No)	If an existing well, OWRD Well ID Tag No. L-___	Total well depth	Casing Diameter	Casing Intervals (feet)	Seal depth(s) (intervals)	Perforated or screened intervals (in feet)	Static water level of completed well (in feet)	Source aquifer (sand, gravel, basalt, etc.)	Well - specific rate (cfs or gpm). If less than full rate of water right
N/A										

Received by OWRD

AUG 08 2025

Salem, OR

Application for Water Right Transfer

Evidence of Use Affidavit



Received by OWRD
 AUG 08 2025
 Salem, OR

Please print legibly or type. Be as specific as possible. Attach additional pages if you need more spacing. Supporting documentation must be attached.

State of Oregon)
) ss
 County of Linn)
LANE)

I, JEFF STEYAERT, in my capacity as ENVIRONMENTAL, PERMITTING AND PROPERTY MANAGER,
 mailing address 32260 OLD HIGHWAY 34, TANGENT, OR 97389
 telephone number (541) 918-5142, being first duly sworn depose and say:

1. My knowledge of the exercise or status of the water right is based on (check one):

- Personal observation Professional expertise

2. I attest that:

- Water was used during the previous five years on the entire place of use for Certificate # _____; OR (Subject of T-13701 Final Order issued 9/2/21 for Certificate 91508)
 My knowledge is specific to the use of water at the following locations within the last five years:

Certificate #	Township		Range		Mer	Sec	¼ ¼		Gov't Lot or DLC	Acres (if applicable)
	17	W	3	W	WM	7	SW	SW	L4	N/A
	17	W	3	W	WM	12	SE	SE	--	N/A
	17	W	3	W	WM	13	NE	NE	--	N/A
	17	W	3	W	WM	18	NW	NW	--	N/A

OR

- Confirming Certificate # _____ has been issued within the past five years; OR
 Part or all of the water right was leased instream at some time within the last five years. The instream lease number is: _____ (Note: If the entire right proposed for transfer was not leased, additional evidence of use is needed for the portion not leased instream.); OR
 The water right is not subject to forfeiture and documentation that a presumption of forfeiture for non-use would be rebutted under ORS 540.610(2) is attached.
 Water has been used at the actual current point of diversion or appropriation for more than 10 years for Certificate # _____ (For Historic POD/POA Transfers)

(continues on reverse side)

3. The water right was used for: (e.g., crops, pasture, etc.): AGGREGATE PROCESSING AND DUST CONTROL

4. I understand that if I do not attach one or more of the documents shown in the table below to support the above statements, my application will be considered incomplete.

[Signature]
Signature of Affiant

7/10/2025
Date

Signed and sworn to (~~or affirmed~~) before me this 10th day of July, 2025.

Received by OWRD
AUG 08 2025
Salem, OR



[Signature]
Notary Public for Oregon

My Commission Expires: Mar. 21, 2028

Supporting Documents	Examples
<input type="checkbox"/> Copy of a water right certificate that has been issued within the last five years. (not a remaining right certificate)	Copy of confirming water right certificate that shows issue date
<input type="checkbox"/> Copies of receipts from sales of irrigated crops or for expenditures related to use of water	<ul style="list-style-type: none"> • Power usage records for pumps associated with irrigation use • Fertilizer or seed bills related to irrigated crops • Farmers Co-op sales receipt
<input type="checkbox"/> Records such as FSA crop reports, irrigation district records, NRCS farm management plan, or records of other water suppliers	<ul style="list-style-type: none"> • District assessment records for water delivered • Crop reports submitted under a federal loan agreement • Beneficial use reports from district • IRS Farm Usage Deduction Report • Agricultural Stabilization Plan • CREP Report
<input checked="" type="checkbox"/> Aerial photos containing sufficient detail to establish location and date of photograph (Subject of T-13701 Final Order issued 9/2/2021 for Certificate 91508) Google Earth imagery from 2021, 2023 and 2025	Multiple photos can be submitted to resolve different areas of a water right. If the photograph does not print with a "date stamp" or without the source being identified, the date of the photograph and source should be added. Sources for aerial photos: OSU – www.oregonexplorer.info/imagery OWRD – www.wrd.state.or.us Google Earth – earth.google.com TerraServer – www.terra-server.com
<input type="checkbox"/> Approved Lease establishing beneficial use within the last 5 years	Copy of instream lease or lease number

Received by OWRD

AUG 08 2025

Salem, OR



Received by OWRD

AUG 08 2025

Salem, OR



14719 -

Received by OWRD

AUG 08 2025

Salem, OR



Received by OWRD

AUG 08 2025

Land Use Information Form

Salem, OR



Oregon Water Resources Department
725 Summer Street NE, Suite A
Salem, Oregon 97301-1266
(503) 986-0900
www.oregon.gov/OWRD

NAME Knife River Corporation - Northwest Attn: Jeff Steyaert			PHONE (541) 918-5142
MAILING ADDRESS 32260 Old Highway 34			
CITY Tangent	STATE OR	ZIP 97389	EMAIL jeff.steyaert@kniferiver.com

A. Land and Location

Please include the following information for all tax lots where water will be diverted (taken from its source), conveyed (transported), and/or used or developed. Applicants for municipal use, or irrigation uses within irrigation districts, may substitute existing and proposed service-area boundaries for the tax-lot information requested below.

Township	Range	Section	¼ ¼	Tax Lot #	Plan Designation (e.g., Rural Residential/RR-5)	Water to be:	Proposed Land Use:
17 S	3 W	7	SW SW	400 & 700		<input checked="" type="checkbox"/> Diverted <input checked="" type="checkbox"/> Conveyed <input checked="" type="checkbox"/> Used	
17 S	4 W	12	SE SE	301, 400 & 700		<input type="checkbox"/> Diverted <input checked="" type="checkbox"/> Conveyed <input checked="" type="checkbox"/> Used	
17 S	4 W	13	NE NE	400		<input type="checkbox"/> Diverted <input checked="" type="checkbox"/> Conveyed <input checked="" type="checkbox"/> Used	
17 S	3 W	18	NW NW	400 & 700		<input type="checkbox"/> Diverted <input checked="" type="checkbox"/> Conveyed <input checked="" type="checkbox"/> Used	

List all counties and cities where water is proposed to be diverted, conveyed, and/or used or developed:

Lane County; and, Eugene

NOTE: A separate Land Use Information Form must be completed and submitted for each county and city, as applicable.

B. Description of Proposed Use

Type of application to be filed with the Oregon Water Resources Department:

- Permit to Use or Store Water Water Right Transfer Permit Amendment or Ground Water Registration Modification
 Limited Water Use License Exchange of Water Allocation of Conserved Water

Source of water: Reservoir/Pond Ground Water Surface Water (name) Willamette River

Estimated quantity of water needed: 1.3 cubic feet per second gallons per minute acre-feet

Intended use of water: Irrigation Commercial Industrial Domestic for _____ household(s)
 Municipal Quasi-Municipal Instream Other _____

Briefly describe:

The proposed transfer is intended to temporarily change the place of diversion and place of use of an industrial/mining right downriver from our Springfield quarry to our Eugene location.

Note to applicant: For new water right applications only, if the Land Use Information Form cannot be completed while you wait, please have a local government representative sign the receipt on the bottom of page 4 and include it with the application filed with the Oregon Water Resources Department.

See Page 4 →

14719 -

Received by OWRD

AUG 08 2025

For Local Government Use Only

Salem, OR

The following section must be completed by a planning official from each county and city listed unless the project will be located entirely within the city limits. In that case, only the city planning agency must complete this form. This deals only with the local land use plan. Do not include approval for activities such as building or grading permits.

Please check the appropriate box below and provide the requested information

- Land uses to be served by the proposed water use(s), including proposed construction, are allowed outright or are not regulated by your comprehensive plan. Cite applicable ordinance section(s): LC 16.217(2)(b)(i)-(vii)
- Land uses to be served by the proposed water use(s), including proposed construction, involve discretionary land-use approvals as listed in the table below. (Please attach documentation of applicable land-use approvals which have already been obtained. Record of Action/land-use decision and accompanying findings are sufficient.) **If approvals have been obtained but all appeal periods have not ended, check "Being Pursued."**

Type of Land-Use Approval Needed (e.g., plan amendments, rezones, conditional-use permits, etc.)	Cite Most Significant, Applicable Plan Policies & Ordinance Section References	Land-Use Approval:	
		<input type="checkbox"/> Obtained <input type="checkbox"/> Denied	<input type="checkbox"/> Being Pursued <input type="checkbox"/> Not Being Pursued
		<input type="checkbox"/> Obtained <input type="checkbox"/> Denied	<input type="checkbox"/> Being Pursued <input type="checkbox"/> Not Being Pursued
		<input type="checkbox"/> Obtained <input type="checkbox"/> Denied	<input type="checkbox"/> Being Pursued <input type="checkbox"/> Not Being Pursued
		<input type="checkbox"/> Obtained <input type="checkbox"/> Denied	<input type="checkbox"/> Being Pursued <input type="checkbox"/> Not Being Pursued

Local governments are invited to express special land use concerns or make recommendations to the Oregon Water Resources Department regarding this proposed use of water in the box below or on a separate sheet.

Name: Marilyn Padilla Zavala Title: Planning Technician

Signature: Marilyn PADILLA ZAVALA Date: 8/7/2025

Governmental Entity: Lane County Phone: 541-682-6446

Receipt Acknowledging Request for Land Use Information	
Note to Local Government Representative:	
Please complete this form and return it to the applicant. For new water right applications <u>only</u> , if you are unable to complete this form while the applicant waits, you may complete this receipt and return it to the applicant. If you sign the receipt, you will have 30 days from the date of OWRD's Public Notice of the application to submit the completed Land Use Information Form to Oregon Water Resources Department. Please note while OWRD can accept a signed receipt as part of intake for an application for a new permit to use or store water, a completed Land Use Information Form is required for all other applications.	
Applicant Name: _____	
Staff Name: _____	Title: _____
Staff Signature: _____	Date: _____
Governmental Entity: _____	Phone: _____

WPT 171402

AFTER RECORDING, RETURN TO:

Metro Rock & Construction Co.
c/o Morse Bros., Inc.
Attn: Steve Frey
P.O. Box 7
Lebanon, Oregon 97355

35
10
11

Division of Chief Deputy Clerk
Lane County Deeds and Records

2001-057607



\$56.00

09/04/2001 02:14:21 PM
RPR-DEED Cnt=1 Stn=3 CASHIER 02
\$35.00 \$11.00 \$10.00

UNTIL A CHANGE IS REQUESTED,
SEND ALL TAX STATEMENTS TO:

Metro Rock & Construction Co.
c/o Morse Bros., Inc.
Attn: Steve Frey
P.O. Box 7
Lebanon, Oregon 97355

After Recording Return To
Western Pioneer Title Co
P.O. Box 10166
Eugene, OR 97440

Received by OWRD

AUG 08 2025

Salem, OR

STATUTORY BARGAIN AND SALE DEED

ROCK RESOURCES, LLC, an Oregon limited liability company ("Grantor"), conveys to METRO ROCK & CONSTRUCTION CO., an Oregon corporation ("Grantee"), the real property situated in Lane County, Oregon, more particularly described in Exhibit A attached hereto and by this reference incorporated herein.

The true consideration for this conveyance is \$10,600,612.

THIS INSTRUMENT WILL NOT ALLOW USE OF THE PROPERTY DESCRIBED IN THIS INSTRUMENT IN VIOLATION OF APPLICABLE LAND USE LAWS AND REGULATIONS. BEFORE SIGNING OR ACCEPTING THIS INSTRUMENT, THE PERSON ACQUIRING FEE TITLE TO THE PROPERTY SHOULD CHECK WITH THE APPROPRIATE CITY OR COUNTY PLANNING DEPARTMENT TO VERIFY APPROVED USES AND TO DETERMINE ANY LIMITS ON LAWSUITS AGAINST FARMING OR FOREST PRACTICES AS DEFINED IN ORS 30.930.

Dated this 31 day of August, 2001.

ROCK RESOURCES, LLC,
an Oregon limited liability company

By: 
Gary R. Warren, Member

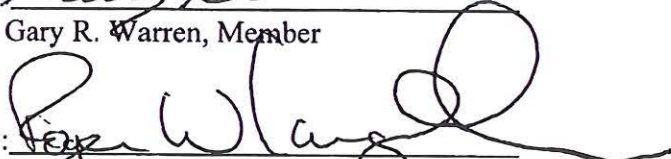
By: 
Roger W. Langeliers, Member

Received by OWRD

AUG 08 2025

Salem, OR

STATE OF OREGON)
) ss.
County of Linn)

This instrument was acknowledged before me on this 31 day of August, 2001, by Gary R. Warren, as Member of Rock Resources, LLC, an Oregon limited liability company, on behalf of the company.



Stacey Harrison
Notary Public for Oregon
My Commission expires: 05-07-05

STATE OF OREGON)
) ss.
County of Linn)

This instrument was acknowledged before me on this 31 day of August, 2001, by Roger W. Langeliers, as Member of Rock Resources, LLC, an Oregon limited liability company, on behalf of the company.



Stacey Harrison
Notary Public for Oregon
My Commission expires: 05-07-05

Received by OWRD
AUG 08 2025
Salem, OR

EXHIBIT "A"

PARCEL I:

Government Lots 9, 10, 11 and 12 and that part of Government Lot 8 lying East of the East line and the East line extended South of the Elias M. Briggs Donation Land Claim No. 67, all in Section 2, Township 18 South, Range 3 West of the Willamette Meridian, in Lane County, Oregon.

EXCEPT THEREFROM: That tract described in Warranty Deed to J. W. Machen and Dora L. Machen, husband and wife, by instrument recorded March 2, 1911, in Book 92, Page 312, Lane County Oregon Deed Records, in Lane County, Oregon.

PARCEL II:

Government Lots 4, 10, 11 and 12 and the Southwest quarter of the Northwest quarter and the Northwest quarter of the Southwest quarter of Section 1, Township 18 South, Range 3 West of the Willamette Meridian, in Lane County, Oregon.

EXCEPT from said Government Lots 10 and 11, that tract conveyed to Pratt Holverson, et al, by deed recorded July 1, 1927, in Book 153, Page 508, as corrected by instrument recorded January 4, 1937, in Book 189, Page 149, Lane County Oregon Deed Records, and that tract conveyed to Booth Kelly Lumber Company by deed recorded in Book 60, Page 33, Lane County Oregon Deed Records, in Lane County, Oregon.

ALSO EXCEPT: Beginning at the center of Section 1 in Township 18 South, Range 3 West of the Willamette Meridian; and run thence North 00° 08' 04" West 471.30 feet along the East line of Lot 10 of said Section 1 to a point on the South line of the Isaac Briggs Donation Land Claim No. 39, in said Township and Range; thence following said claim line North 89° 22' 35" West 362.03 feet to the Southerly Southwest corner of said Briggs Claim; thence continuing North 89° 22' 35" West 10.00 feet to a point in the center of a drainage ditch; thence following said drainage ditch South 01° 25' 20" East 139.02 feet to a point; thence South 39° 22' 55" East 189.54 feet to a point; thence South 18° 59' 50" East 75.05 feet to a point; thence South 06° 29' 15" East 111.15 feet to a point on the South line of said Lot 10; thence leaving said ditch and following said Lot line South 87° 43' 00" East 212.60 feet to the place of beginning, all in said Section 1, Lane County, Oregon.

Received by OWRD

AUG 08 2025

Salem, OR

EXHIBIT "A" Cont.

PARCEL III:

Lot 9, Block 13, AMENDED PLAT OF WILLAMETTE HEIGHTS ADDITION to Springfield, as platted and recorded in Book 4, Page 78, Lane County Oregon Plat Records, in Lane County, Oregon.

PARCEL IV:

Beginning at the stone marking the re-entrant corner of the Isaac Briggs Donation Land Claim No. 39, Township 18 South, Range 3 West of the Willamette Meridian; thence North $89^{\circ} 50' 40''$ West 868.63 feet along the South line of said claim to the iron pin marking the Southwest corner of that tract described in instrument recorded in Book 438, Page 432, Lane County Oregon Deed Records, and the true point of beginning; thence North $89^{\circ} 50' 40''$ West 501.86 feet continuing along said South line to the East line of that easement granted to the United States of America, by instrument recorded July 15, 1960, Reception No. 4706, being a line parallel with and 30.00 feet Easterly of the centerline described in said instrument; thence North $18^{\circ} 35' 30''$ East 114.27 feet along said East line to an angle point opposite 234+00.90 Back = 243+00.00 Ahead; thence North $22^{\circ} 31' 20''$ East 225 feet, more or less, to a point on the South bank of the Mill Race; thence Southeasterly 250 feet, more or less, along said South bank to a point on the West line of said tract described in Book 438, Page 432, Lane County Oregon Deed Records; thence South $0^{\circ} 30' 20''$ West 270 feet, more or less, to the true point of beginning, in Lane County, Oregon.

PARCEL V:

Beginning at the stone marking the re-entrant corner of the Isaac Briggs Donation Land Claim No. 39, Township 18 South, Range 3 West of the Willamette Meridian; thence North $89^{\circ} 50' 40''$ West 346.00 feet along the South line of said claim to the iron pin marking the Southeast corner of that tract described in Book 438, Page 432, Lane County Oregon Deed Records; thence North $0^{\circ} 16' 20''$ East 150 feet, more or less, along the East line of said tract to a point on the South bank of the Mill Race; thence Southeasterly along said Mill Race to a point on the West line of the vehicular bridge giving access over the Mill Race to Springfield Quarry Rock Products, Inc.; thence Northeasterly 60 feet, more or less, along said West line to a point on the North line of said Mill Race; thence Southeasterly along the Northerly side of said Mill Race to a point on the East line of said bridge; thence Southwesterly along said East line to a point on Southerly side of said Mill Race; thence Southeasterly along said Southerly side to a point on the East line of the West one-half of said Briggs Claim No. 39; thence South $0^{\circ} 02' 15''$ West 530 feet, more or less, along said East line to an iron pin set in that survey filed at the Lane County Surveyor's Office under No. 27718; thence North $89^{\circ} 43' 48''$ West 1127.06 feet to an iron pin set in said Survey No. 27718; thence South $0^{\circ} 48' 42''$ West 470.00 feet to an iron pin set in said survey; thence North $88^{\circ} 16' 18''$ West 68.42 feet to a point; thence South $0^{\circ} 21' 12''$ West 396.35 feet to an iron pin set in said survey; thence South $87^{\circ} 13' 42''$ West 21.13 feet to an iron pin set in said survey on the West line of said claim; thence South $0^{\circ} 22' 25''$ West 261.51 feet along said West line to an iron pin

Continued

14719 -

Received by OWRD

AUG 08 2025

Salem, OR

EXHIBIT "A" Cont.

set in said survey; thence North $89^{\circ} 37' 35''$ West 168.90 feet to a point; thence North $3^{\circ} 22' 25''$ East 306.14 feet to a point; thence North $6^{\circ} 22' 25''$ East 322.05 feet to a point; thence North $1^{\circ} 22' 35''$ West 204.75 feet to a point; thence North $8^{\circ} 52' 35''$ West 122.59 feet to a point; thence North $4^{\circ} 37' 25''$ East 109.33 feet to a point; thence North $15^{\circ} 52' 25''$ East 135.18 feet to a point; thence North $20^{\circ} 07' 25''$ East 127.90 feet to a point; thence North $16^{\circ} 23' 30''$ East 209.20 feet to the point of beginning, in Lane County, Oregon.

PARCEL VI:

Beginning at a point on the South line of Donation Land Claim No. 39, in Township 18 South, Range 3 West of the Willamette Meridian, Lane County, Oregon, 5.25 chains North $89^{\circ} 52'$ West of the corner in the angle of said Donation Land Claim; and running thence North $89^{\circ} 52'$ West 7.93 chains; thence North $0^{\circ} 29'$ East 5.15 chains to the center line of the Booth Kelly Lumber Company Mill Race; thence South 73° East along said Mill Race center line 8.19 chains; thence South $0^{\circ} 15'$ West 2.35 chains to the beginning point in Section 1, Township 18 South, Range 3 West of the Willamette Meridian, in Lane County, Oregon.

PARCEL VII:

Beginning at a point on the North line of Lot 3 in Section 1 in Township 18 South, Range 3 West of the Willamette Meridian, 212.60 feet North $87^{\circ} 43' 00''$ West from the center of said Section 1; and run thence along the center of a drainage ditch South $10^{\circ} 24' 00''$ East 152.65 feet to a point; thence South $26^{\circ} 49' 40''$ West 163.88 feet to a point; thence South $03^{\circ} 46' 50''$ West 231.48 feet to a point; thence South $05^{\circ} 47' 25''$ East 150.60 feet to a point; thence South $12^{\circ} 50' 00''$ East 213.93 feet to a point on the meander line of the right bank of the Willamette River; thence North $89^{\circ} 51' 00''$ West 63.41 feet to a point; thence North $09^{\circ} 51' 00''$ West 907.60 feet to a point on the North line of said Lot 3; thence following said Lot line South $87^{\circ} 43' 00''$ East 217.32 feet to the point of beginning, all in said Lot 3, Section 1, Lane County, Oregon.

Continued

Received by OWRD

AUG 08 2025

Salem, OR

EXHIBIT "A" Cont.

PARCEL VIII:

A tract of land beginning at the 3/4 inch iron pipe marking the Northeast corner of the Northwest quarter of the Southwest quarter of Section 1 in Township 18 South, Range 2 West of the Willamette Meridian, said pipe bearing South 87° 43' 00" East 1358.16 feet from the West one-quarter corner of said Section 1; and run thence South 87° 43' 00" East 929.57 feet along the North line of Lot 3 of said Section 1 to a 5/8 inch pin; thence South 09° 51' 00" East 907.60 feet to a point; thence South 89° 51' 00" East 63.41 feet to a point on the meander line of the right bank of the Willamette River hereinafter referred to as Point A; thence following said meander line South 01° 43' 52" West 277.81 feet to a point; thence South 26° 43' 52" West 394.05 feet to a point; thence South 36° 43' 52" West 737.77 feet to a point; thence South 78° 43' 52" West 554.78 feet to a point on the West line of said Lot 3 hereinafter referred to as Point B; thence North 00° 35' 40" East 2260.87 feet along the West line of said Lot 3 to the point of beginning, all in said Section 1, Lane County, Oregon.

EXCEPT: From the above described tract a strip of land 63 feet in width extending along and parallel with said meander line from said Point A to said Point B and bounded on the Easterly and Southerly sides by side meander line, in Lane County, Oregon.

PARCEL IX:

Beginning at a point in the center of a creek, said creek being the overflow from the Booth-Kelly Mill Race to the Willamette River, said beginning point begin 360.0 feet West of the Southeast corner of Lot 10, said Southeast corner of Lot 10 being also the center of Section 1, Township 18 South, Range 3 West of the Willamette Meridian; thence West 56.0 feet; thence North 22° 53' West 1100.0 feet; thence East 370.0 feet to the center of said creek; thence Southerly along center of said creek to the place of beginning, in Section 1, Township 18 South, Range 3 West of the Willamette Meridian, in Lane County, Oregon.

Continued

14719 -

Received by OWRD

AUG 08 2025

Salem, OR

EXHIBIT "A" Cont.

PARCEL X:

Beginning at the Southerly Southwest corner of the Isaac Briggs Donation Land Claim No. 39, in Section 1, Township 18 South, Range 3 West of the Willamette Meridian; thence South $89^{\circ} 30' 49''$ East 1228.36 feet along the South boundary of Isaac Briggs Donation Land Claim No. 39 to the Southeast corner of the West one-half of said claim; thence North $00^{\circ} 02' 27''$ East 1436.80 feet along the East line of the West one-half of said claim to a point; thence North $89^{\circ} 43' 48''$ West 1126.95 feet to a point; thence South $00^{\circ} 48' 42''$ West 470 feet to a point; thence North $88^{\circ} 16' 18''$ West 68.42 feet to a point; thence South $00^{\circ} 21' 12''$ West 396.35 feet to a point; thence South $87^{\circ} 13' 42''$ West 21.00 feet to a point; thence South $00^{\circ} 24' 47''$ West 566.44 feet to the point of beginning, in Lane County, Oregon.



Phone: (503) 986-2200
Fax: (503) 378-4381

Secretary of State
Corporation Division
255 Capitol St NE, Suite 151
Salem, OR 97310-1327

Articles of Merger

Check the appropriate box below:

- MULTI ENTITY MERGER
(Complete only 1, 2, 3, 4, 10, 11)
- FOR PARENT AND 90% OWNED SUBSIDIARY
WITHOUT SHAREHOLDER APPROVAL
(Complete only 5, 6, 7, 8, 9, 10, 11)

10/23/01 3:22PM 000#6641 For office use only
BUSINESS REG \$20.00

FILED
OCT 23 2001
OREGON
SECRETARY OF STATE

Survivor Registry Number: 068610-17

Attach Additional Sheet if Necessary
Please Type or Print Legibly in Black Ink

1) NAMES AND TYPES OF THE ENTITIES PROPOSING TO MERGE

NAME	TYPE	REGISTRY NUMBER

2) NAME AND TYPE OF THE SURVIVING ENTITY

Check here if there is a name change in this plan of merger.

3) A COPY OF THE MERGER PLAN IS ATTACHED.

4) THE PLAN OF MERGER WAS DULY AUTHORIZED AND APPROVED BY EACH ENTITY THAT IS A PARTY TO THE MERGER.

A copy of the vote required by each entity is attached.

Received by OWR
AUG 08 2025
Salem, OR

FOR PARENT AND 90% OWNED SUBSIDIARY WITHOUT SHAREHOLDER APPROVAL

5) NAME OF PARENT CORPORATION Morse Bros., Inc.

Oregon Registry Number 068610-17

6) NAME OF SUBSIDIARY CORPORATION Metro Rock & Construction Co.

Oregon Registry Number 087438-17

7) NAME OF SURVIVING CORPORATION Morse Bros., Inc.

8) COPY OF PLAN

A copy of the plan of merger setting forth the manner and basis of converting shares of the subsidiary into shares, obligations, or other securities of the parent corporation or any other corporation or into cash or other property is attached.

9) CHECK THE APPROPRIATE BOX

A copy of the plan of merger or summary was mailed to each shareholder of record of the subsidiary corporation on or before _____

Date

The mailing of a copy of the plan or summary was waived by all outstanding shares.

10) EXECUTION

Printed Name

Terry D. Hilstad

Signature

Title

Chief Executive Officer

FEES

Make check for \$10 payable to "Corporation Division."

NOTE: Filing fees may be paid with VISA or MasterCard. The card number and expiration date should be submitted on a separate sheet for your protection.

11) CONTACT NAME

Bruce J. Gallagher

DAYTIME PHONE NUMBER - INCLUDING AREA CODE

701-222-7852

14719 - 10/23

Received by QWRD

AUG 08 2023

Salem, OR

PLAN OF MERGER

THIS PLAN OF MERGER, dated October 19, 2001 (the "Agreement"), is between Metro Rock & Construction Co., an Oregon corporation (hereinafter called "Metro Rock"), and MORSE BROS., INC., an Oregon corporation (hereinafter sometimes called "MBI" and sometimes called the "surviving corporation"). The parties are collectively referred to herein as "constituent corporations."

WITNESSETH:

That in consideration of the premises and mutual covenants and promises herein made, the constituent corporations agree as follows:

1. Merger. On the effective date of the merger, Metro Rock shall be merged with and into MBI and the constituent corporations shall become a single corporation. Metro Rock shall cease to exist as a separate corporate entity, and MBI shall continue to exist as the surviving corporation under the name of "Morse Bros., Inc." (hereinafter the "Merger").

2. Effective Date. The Merger shall become effective upon (1) the approval of this Agreement by the Board of Directors of the constituent corporations in accordance with Section 60.491 of the Oregon Revised Statutes, as amended, and (2) the execution, acknowledgment, filing, issuance, and recording of this Agreement and the articles of merger as required under the laws of Oregon. Pursuant to Section 60.491, O.R.S., approval of the Merger by the shareholders of the constituent corporations is not required. The term "Effective Date", as used in this Agreement, means the time and date on which the last act required to make the Merger effective under the laws of Oregon shall have been performed.

3. Cancellation of Metro Rock Shares. The manner and basis of canceling the shares of Metro Rock is as follows: On the Effective Date, the sole stockholder of shares of common stock

in Metro Rock shall surrender said shares. Upon surrender of the Metro Rock share certificates, each share of common stock of Metro Rock that is issued and outstanding or in its treasury on the Effective Date shall be cancelled.

4. Rights and Obligations. On the Effective Date, the surviving corporation shall possess all the rights, privileges, powers, and franchises, of a public or private nature, of each of the constituent corporations, and the surviving corporation shall be subject to all restrictions, disabilities, and duties of each of the constituent corporations; and all and singular, the rights, privileges, powers, and franchises of each of the constituent corporations, and all property (real, personal, and mixed), and all debts due to each of the constituent corporations on whatever account, as well as for stock subscriptions and all other things in action or belonging to or due to each of the constituent corporations, shall be vested in the surviving corporation without further act or deed; and all property, assets, rights, privileges, powers, franchises, and all and every other interest shall be thereafter as effectively the property of the surviving corporation as they were of their respective constituent corporations, and the title to any real estate vested by deed or otherwise in either of the constituent corporations shall not revert or be in any way impaired by reason of the Merger; provided, however, that all rights of creditors and all liens upon any property of either constituent corporation shall be preserved unimpaired, and all debts, liabilities, obligations, and duties of the respective constituent corporations shall thenceforth attach to the surviving corporation, and may be enforced against it to the same extent as if said debts, liabilities, obligations and duties had been incurred or contracted by the surviving corporation.

5. Certificate of Incorporation. The Certificate of Incorporation of MBI on the Effective Date shall be the Certificate of Incorporation of the surviving corporation following the Effective Date unless and until the same shall be amended or repealed in accordance with the provisions thereof.

Received by OWRD

2 147197

AUG 08 2025

Salem, OR

6. Bylaws. The Bylaws of MBI as they exist on the Effective Date shall be the Bylaws of the surviving corporation following the Effective Date unless and until the same shall be amended or repealed in accordance with the provisions thereof.

7. Directors and Officers. The members of the Board of Directors and the officers of MBI immediately prior to the Effective Date shall the members of the Board of Directors and the officers of the surviving corporation immediately after the Effective Date and such persons shall serve in such offices, respectively, for the terms provided by law or in the Bylaws, or until their respective successors are elected and qualified.

8. Execution of Instruments. If, at any time after the Effective Date, MBI shall consider or be advised that any further assignment or assurance is desirable to vest in MBI the title of any property or rights of Metro Rock in accordance with the Merger, the appropriate directors and officers of the constituent corporations are hereby authorized to execute and make all such proper assignments and assurances, and to do such other acts or things, either in the name of the constituent corporations or in the name of MBI, as may be requisite or desirable to carry out the purposes of this Agreement as herein expressed; and the officers and directors of the surviving corporation are fully authorized in the name of Metro Rock, or otherwise, to take any and all such actions.

9. Termination or Amendment of Agreement. Anything herein or elsewhere to the contrary notwithstanding, this Agreement may be terminated or amended, in accordance with law, without action by the stockholders of either constituent corporation, at any time before it becomes effective, by action of the Board of Directors of the constituent corporations.

Received by OWRD
AUG 08 2025
Salem, OR

VOID IF ALTERED OR ERASED

VOID IF ALTERED OR ERASED

AUG 08 2025

Salem, OR



Phone: (503) 986-2200
Fax: (503) 378-4381

Articles of Amendment—Business/Professional/Nonprofit

Secretary of State
Corporation Division
255 Capitol St. NE, Suite 151
Salem, OR 97310-1327
FilingInOregon.com

Check the appropriate box below:

- BUSINESS/PROFESSIONAL CORPORATION
(Complete only 1, 2, 3, 4, 6, 7)
- NONPROFIT CORPORATION
(Complete only 1, 2, 3, 5, 6, 7)

FILED

DEC 30 2009

OREGON
SECRETARY OF STATE

REGISTRY NUMBER: 068610-17

In accordance with Oregon Revised Statute 192.410-192.490, the information on this application is public record.
We must release this information to all parties upon request and it will be posted on our website.

For office use only

Please Type or Print Legibly in Black Ink.

1) ENTITY NAME: Morse Bros., Inc.

2) STATE THE ARTICLE NUMBER(S) AND SET FORTH THE ARTICLE(S) AS IT IS AMENDED TO READ. (Attach a separate sheet if necessary.)

ARTICLE I - The name of this Corporation shall be Knife River Corporation - Northwest and its duration shall be perpetual.

3) THE AMENDMENT WAS ADOPTED ON: 12/18/2009 Effective January 1, 2010

(If more than one amendment was adopted, identify the date of adoption of each amendment.)

BUSINESS/PROFESSIONAL CORPORATION ONLY

4) CHECK THE APPROPRIATE STATEMENT

Shareholder action was required to adopt the amendment(s). The vote was as follows:

Class or series of shares	Number of shares outstanding	Number of votes entitled to be cast	Number of votes cast FOR	Number of votes cast AGAINST

Shareholder action was not required to adopt the amendment(s). The amendment(s) was adopted by the board of directors without shareholder action.

The corporation has not issued any shares of stock. Shareholder action was not required to adopt the amendment(s). The amendment(s) was adopted by the incorporators or by the board of directors.

NONPROFIT CORPORATION ONLY

5) CHECK THE APPROPRIATE STATEMENT

Membership approval was not required. The amendment(s) was approved by a sufficient vote of the board of directors or incorporators.

Membership approval was required. The membership vote was as follows:

Class(es) entitled to vote	Number of members entitled to vote	Number of votes entitled to be cast	Number of votes cast FOR	Number of votes cast AGAINST

6) EXECUTION

Signature

Printed Name

William S. Schneider

Title

Chief Executive Officer

7) CONTACT NAME (To resolve questions with this filing.)

Mary W. Davison

DAYTIME PHONE NUMBER (Include area code.)

(701) 530-1042

FEEES

Required Processing Fee \$50

Confirmation Copy (Optional) \$5

No Fee for Nonprofit Type Change

No Fee for President/Secretary Change

Processing Fees are nonrefundable.

Please make check payable to "Corporation Division."

NOTE:

Fees may be paid with VISA or MasterCard. The card number and expiration date should be submitted on a separate sheet for your protection.



Secretary of State
Corporation Division
255 Capitol Street NE, Suite 151
Salem, OR 97310-1327

Phone:(503)986-2200
Fax:(503)378-4381
www.filinginoregon.com

Registry Number: 068610-17
Type: DOMESTIC BUSINESS CORPORATION

Next Renewal Date: 04/16/2010

Received by OWRD

KNIFE RIVER CORPORATION - NORTHWEST
PO BOX 5650
BISMARCK ND 58506-5850

AUG 08 2025

Salem, OR

Acknowledgment Letter

The document you submitted was recorded as shown below. Please review and verify the information listed for accuracy.

If you have any questions regarding this acknowledgement, contact the Secretary of State, Corporation Division at (503)986-2200. Please refer to the registration number listed above. A copy of the filed documentation may be ordered for a fee of \$5.00. Submit your request to the address listed above or call (503)986-2317 with your Visa or MasterCard number.

Document

ARTICLES OF AMENDMENT

Filed On	Effective Date	Jurisdiction
12/30/2009	01/01/2010	OREGON

Name

KNIFE RIVER CORPORATION - NORTHWEST

Principal Place of Business

32260 OLD HWY 34
TANGENT OR 97389

Registered Agent

C T CORPORATION SYSTEM
388 STATE ST STE 420
SALEM OR 97301

Mailing Address

PO BOX 5650
BISMARCK ND 58506-5850

President

DAVE BULL
32260 OLD HWY 34
TANGENT OR 97389

Secretary

STEPHEN FREY
1300 E GRANT ST
LEBANON OR 97355

AUG 08 2025

Salem, OR

TRANSFER APPLICATION MAP
Certificate 67279
Sections 1 & 2, T18S, R3W
Section 8, T18S, R2W, W.M., Lane County
Knife River Corporation

RECEIVED

MAY 06 2021

OWRD

FROM MAP

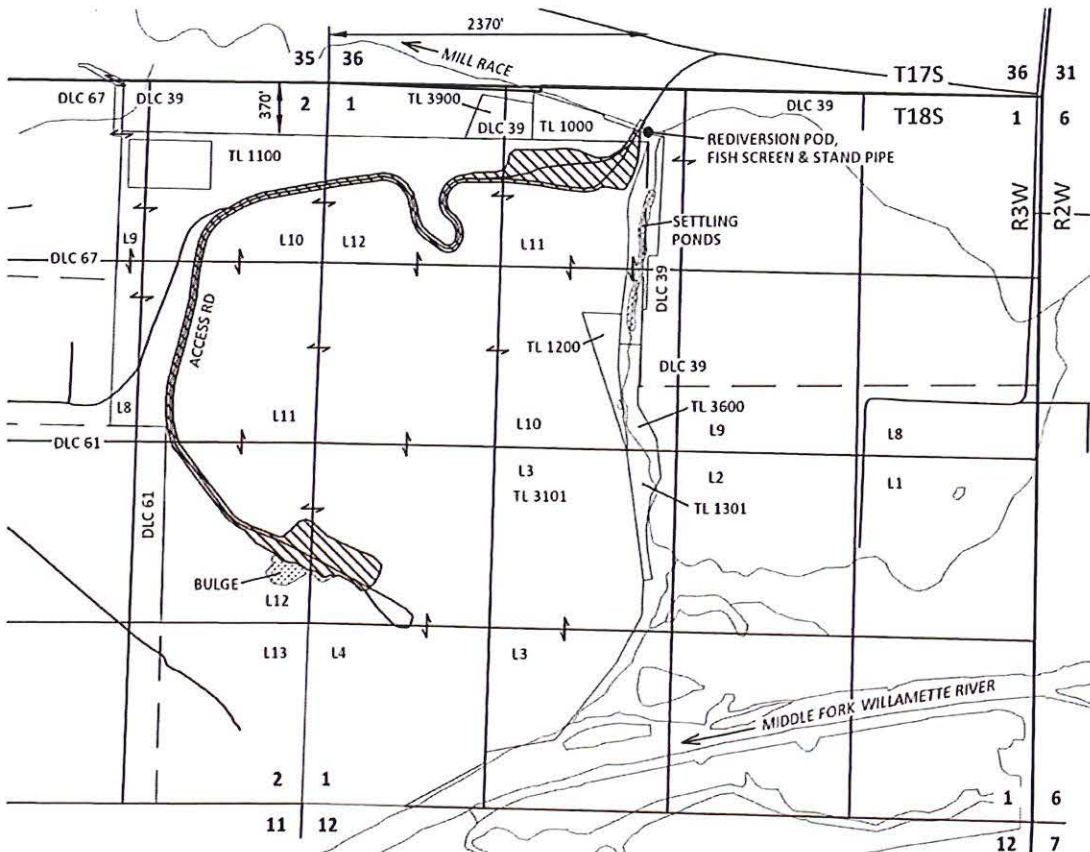

FROM POD

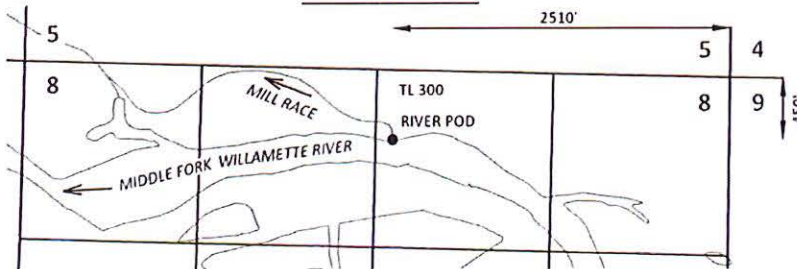

EXPLANATION

FROM LANDS



CERTIFICATE 91508
INDUSTRIAL / MINING
PRIORITY: 10/16/1963



POINT OF DIVERSION (POD)

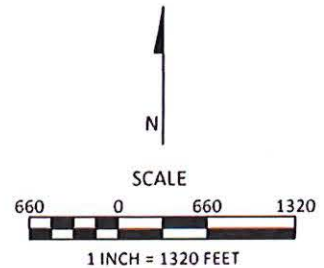

This map is not intended to provide legal dimensions or locations of property ownership lines

April 30, 2021

Figure 1

kpff

111 SW Fifth Ave., Suite 2600
Portland, OR 97204
O: 503.542.3860
F: 503.224.4681
www.kpff.com

13701 -

14719 -

Received by OWRD
AUG 08 2025

TRANSFER APPLICATION MAP
Certificate 91508
Sections 7 & 18, T17S, R3W
Sections 12 & 13, T17S, R4W,
W.M., Lane County

Salem, OR

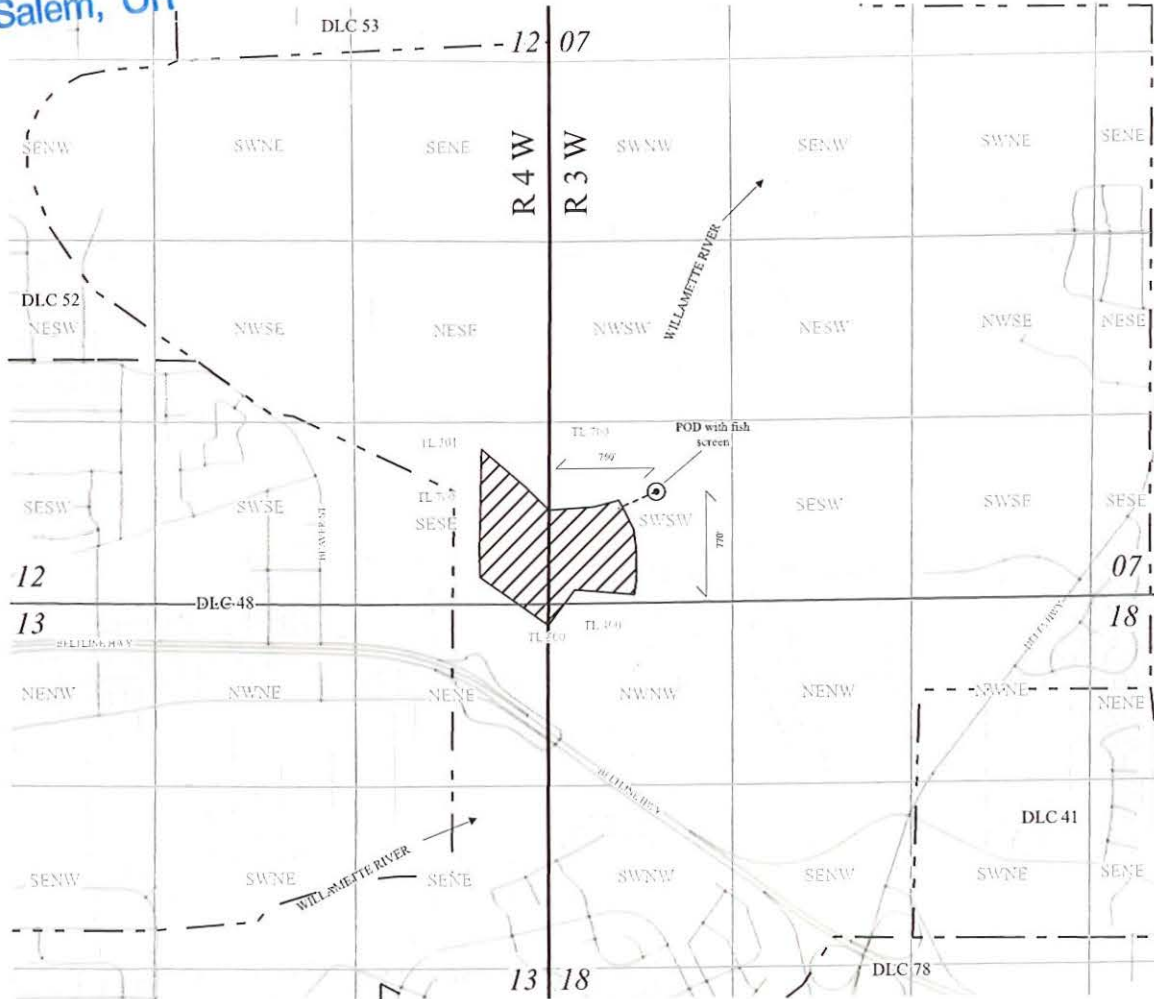

POD is located 770' N and 760' E from the SW corner of Section 7 T17S, R3W, SW 1/4 SW1/4



Explanation

- Proposed Transfer POU
- QtrQtr
- Pipeline
- Township
- Taxlots (TL 700)
- Proposed Transfer POD
- Section
- Roads

NAD 1983 HARN
Datum of 1983
Prepared June 30, 2025

Sources: ELM CadNSDI PLSS, roads, county lines & tax lots (Yamhill County), Oregon Spatial Data Library water features, DLC lines, et al. Locations of proposed wells and points of use provided by client.

This map was prepared for the purpose of identifying the location of a water right only and is not intended to provide legal dimensions or locations of property ownership lines.

EnviroLogic Resources, Inc.
ENVIRONMENTAL • WATER RESOURCES SCIENTISTS



TO MAP
Knife River Corporation
Eugene, Oregon



Received by OWRD
AUG 08 2025
Salem, OR

Date Received (Date Stamp Here)

OWRD Over-the-Counter Submission Receipt

Applicant Name(s) & Address: Knife River Corporation

32260 Old Highway 34 Tangent, OR 97389

Transaction Type: Temporary Trans

Fees Received: \$ 1180

Cash

Check:

Check No. 24793966

Name(s) on Check: Knife River Corporation

Thank you for your submission. Oregon Water Resources Department (Department) staff will review your submittal as soon as possible.

If your submission is determined to be complete, you will receive a receipt for the fees paid and an acknowledgement letter stating your submittal is complete.

If determined to be incomplete, your submission and the accompanying fees will be returned with an explanation of deficiencies that must be addressed in order for the submittal to be accepted.

If you have any questions, please feel free to contact the Department's Customer Service staff at 503-986-0801 or 503-986-0810.

Sincerely,

OWRD Customer Service Staff

Submission received by: Sarah Benham

(Name of OWRD staff)

Instructions for OWRD staff:

- Complete this Submission Receipt and make two (2) copies. Place one copy with the check/cash; and place the other copy with the submission (i.e., the application or other document).
- Date-stamp all pages. (NOTE: Do not stamp check.)
- Give this original Submission Receipt to the applicant.
- Record Submission Receipt information on the "RECEIVED OVER THE COUNTER" log sheet.
- Fold and put one copy of the Submission Receipt with check/cash into the Safe slot. Place the other copy of the Submission Receipt with submission (application/other document) in the top drawer of filing cabinet.