

Application for Permanent Water Right Transfer



Oregon Water Resources Department
 725 Summer Street NE, Suite A
 Salem, Oregon 97301-1266
 (503) 986-0900
www.oregon.gov/OWRD

This application will be returned if Parts 1 through Part 4 and all required attachments are not completed and included upon submittal.

Part 1 of 4 – Permanent Water Right Transfer Application Minimum Requirements Checklist

Check all items included with this application. (N/A = Not Applicable)	
<input checked="" type="checkbox"/>	Part 1 – Completed Minimum Requirements Checklist.
<input checked="" type="checkbox"/>	Part 2 – Completed Transfer Application Map Checklist.
<input checked="" type="checkbox"/>	Part 3 – Completed Applicant Information and Signature. NOTE: If the applicant is a public agency, corporation or business, trust, or other organization, the title or authority of the person who signs the application on behalf of the entity and evidence of signatory authority or a signed statement that such authority exists must be included.
<input checked="" type="checkbox"/>	Part 4 – Information about Water Rights to be Transferred: How many water rights are to be transferred? <u>4</u> List them here: <u>28391, 33730, 63748, 63792</u> Please include a separate Part 4 for each water right. NOTE: A separate transfer application is required for each water right unless the criteria in OAR 690-380-3220 are met.
<input checked="" type="checkbox"/>	Application Fee - payable by check to the Oregon Water Resources Department (OWRD). The online fee calculator is located: https://apps.wrd.state.or.us/apps/wr/wr_transfer_calculator/permanent_transfer.aspx NOTE: If claiming a fee waiver, you must provide documentation showing that the proposed transfer qualifies for the fee waiver pursuant to OAR 690-380-3400.
Required Attachments:	
<input checked="" type="checkbox"/>	Completed Transfer Application Map.
<input checked="" type="checkbox"/>	Completed Evidence of Use Affidavit and supporting documentation.
<input checked="" type="checkbox"/> Yes <input type="checkbox"/> N/A	Oregon Water Resources Department’s Land Use Information Form with approval and signature from each local land use authority in which water is to be diverted, conveyed, and/or used. NOTE: This form is not required if water is to be diverted, conveyed, and/or used only on federal lands or if all of the following apply: a) a change in place of use only, b) no structural changes, c) the use of water is for irrigation only, and d) the use is located within an irrigation district or an exclusive farm use zone.
<input type="checkbox"/> Yes <input checked="" type="checkbox"/> N/A	Affidavit(s) of Consent from Deeded Landowner(s) or Deeded Water Right Holder(s) NOTE: only if the applicant does not own the land on which the water right is located or if the water right was severed from the land and conveyed separately to other individuals/entities.)
<input type="checkbox"/> Yes <input checked="" type="checkbox"/> N/A	Supplemental Form D – For water rights served by or issued in the name of an irrigation district. NOTE: Complete when the transfer applicant is not the irrigation district.)
<input type="checkbox"/> Yes <input checked="" type="checkbox"/> N/A	Supplemental Form U - For water rights involving irrigation within portions of Morrow & Umatilla Counties <u>only</u> .
<input type="checkbox"/> Yes <input checked="" type="checkbox"/> N/A	Affidavit of Voluntary Cancellation or Diminution. NOTE: only if application proposes to cancel or diminish a water right.
Required Groundwater Attachments:	
<input type="checkbox"/> Yes <input checked="" type="checkbox"/> N/A	Water Well Report/Well Log for changes in point(s) of appropriation (well(s)) or additional point(s) of appropriation. Find well logs here: http://apps.wrd.state.or.us/apps/gw/well_log/Default.aspx
<input type="checkbox"/> Yes <input checked="" type="checkbox"/> N/A	Geologist Report for a change from a surface water point of diversion to a ground water point of appropriation (well), if the proposed well is more than 500 feet from the surface water source and more than 1000 feet upstream or downstream from the point of diversion. See OAR 690-380-2130 for requirements and applicability.

- 14873 -

**Part 2 of 4 – Permanent Water Right Transfer Application
Map Requirements Checklist**

The transfer application map you submit must include all the required items and match the existing water right map.

Check all boxes that apply.

- Yes N/A Certified Water Right Examiner (CWRE) stamp and original signature. A digital stamp or seal and signature are acceptable, provided they meet OAR 690-014-0050. **NOTE: CWRE stamp and signature are not required for substitutions.** For a list of CWRE's, see http://apps.wrd.state.or.us/apps/wr/cwre_license_view/.
- Yes N/A If **more than three** water rights are involved, a separate map for each water right is required.
- Permanent quality printed with dark ink on polyester film or good quality paper. Maps may also be submitted as a PDF (portable document format) if they meet all other requirements.
- The preferred size is 8½ x 11 inches and should be no larger than 30 x 30 inches (one extra map copy is required for 30 x 30 inch maps). To request a waiver for a map larger than 30 x 30 inches, please send an email to mapwaiver@water.oregon.gov.
- A north arrow and a legend.
- Include the scale, which must be even-numbered and not exceed 1 inch = 1,320 feet. To request a waiver for a map scale that exceeds 1 inch = 1,320 feet, please send an email to mapwaiver@water.oregon.gov.
- Yes N/A **For uses other than municipal use, quasi-municipal use, and similar uses**, include Township, Range, Section, ¼ ¼, tax lot boundaries (property lines) and tax lot numbers, DLC, Government Lot, and other recognized public land survey lines.
- Yes N/A **If the use is municipal, quasi-municipal, or similar uses**, include Township, Range, Section, and service area boundaries. The map must also identify quarter-quarter (¼ ¼) sections but does not need to label the ¼ ¼.
- Major physical features including rivers, creeks, streams, lakes, reservoirs, ponds, roads and railroads. For any surface water on the map, indicate the direction of flow.
- All point(s) of diversion (POD for surface water), point(s) of appropriation (POA for wells/groundwater), or dam location(s) (or center of reservoir(s) if no dam exists) authorized by the water right(s), clearly labeled, shown by distance and bearing, or by coordinates (distance north/south and distance east/west) from a recognized public land survey corner. (This information can be found in the water right certificate or decree.) In addition, include latitude and longitude for each POD or POA in degrees-decimal with five or more digits after the decimal (example – 44.53764°) and the datum used (example – NAD 83, NAD 27 or WGS 84).
- Yes N/A If a change in POD or a change in POA is proposed, include the proposed location(s), clearly labeled, shown by distance and bearing, or by coordinates (distance north/south and distance east/west) from a recognized public land survey corner. In addition, include latitude and longitude for each POD or POA in degrees-decimal with five or more digits after the decimal (example – 44.53764°) and the datum used (example – NAD 83, NAD 27 or WGS 84).
- General location of main canals, ditches, flumes, pipelines, pumps, or other water delivery features used to transport water from the point(s) of diversion, point(s) of appropriation, and/or reservoir/pond to the place of use, including delivery features at the place of use.
- Place of use (POU) by Township, Range, Section, and ¼ ¼, that includes separate hachuring for lands affected by changes proposed in this transfer application, for lands left unchanged and not affected by this transfer application, for each water right, for each priority date, for each use, and served by each point of diversion (POD), point of appropriation (POA), and/or reservoir/pond (POD).
- Yes N/A For a POU limited to a point, like a stock watering tank, include latitude and longitude for the POU in degrees-decimal with five or more digits after the decimal (example – 44.53764°) and the datum used (example – NAD 83, NAD 27 or WGS 84).
- Yes N/A If the USE is irrigation, nursery, cranberry, or other similar uses with acreage associated with it, the place of use must include the number of acres in each ¼ ¼ section, government lot, or in each ¼ ¼ section as projected within government lots, donation land claims, or other recognized public land survey subdivisions.
- Yes N/A If the use is supplemental irrigation, include the location(s) and water right reference number of the underlying primary right, registration, or claim.

**Part 3 of 4 –Permanent Water Right Transfer Application
Applicant(s) Information and Signature(s)**

Applicant Information

APPLICANT/BUSINESS NAME Southern Oregon Terra, Inc.	PHONE NO(S). 541-601-8038	EMAIL ADDRESS none
ADDRESS 374 Hammel Road	CITY Eagle Point	STATE OR
		ZIP 97524

DOCUMENTS AND NOTIFICATIONS WILL BE SENT BY E-MAIL UNLESS REQUESTED OTHERWISE.

ANY PROPOSED FINAL ORDER WILL BE SENT BY CERTIFIED MAIL AND ANY CERTIFICATE BY STANDARD MAIL.

* **IMPORTANT NOTE - Electronic forms of documents:** Beginning on April 1, 2026, and unless requested otherwise by the applicant, the Department will send documents and notifications associated with processing of applications in electronic form (i.e., by email). These emails may come from an automated system (wrd_automated_email@water.oregon.gov). **Consider adding this email address to your safe sender list.**

I/we affirm:

- The applicant is the sole owner of the land on which the water right, or portion thereof, proposed for transfer is located. **NOTE:** If the applicant is not the sole owner, include signatures of all deeded landowners (and mailing and e-mail addresses if different than the applicant's) or attach affidavits of consent from all landowners or individuals/entities to which the water right(s) were conveyed.
- Amendments to the application may only be made in response to the Initial Review (IR). The applicant will have a period of at least 30 days to amend the application to address any issues identified by the Department in the IR, or to withdraw the application. **NOTE:** that amendments may be subject to additional fees, pursuant to ORS 536.050.
- Refunds may only be granted upon request and as set forth in ORS 536.050(4)(a), if the Director determines that a refund of all or part of a fee is appropriate in the interests of fairness to the public or necessary to correct an error of the Department.
- Approval of the change(s) proposed in this application does not constitute a right to trespass upon property or ditches not owned or controlled by the applicant.
- Prior to Department approval of the transfer application, if more than five (5) water rights would be injured as a result of my proposed transfer, then I will be required to submit payment to the Department pursuant to OAR 690-380-4020(3) for publication of a notice in a newspaper with general circulation in the area where the water right is located, once per week for two consecutive weeks. If more than one qualifying newspaper is available, I suggest publishing the notice in the following newspaper: Rogue Valley Times.
- Failure to complete an approved change in place of use and/or change in character of use, will result in loss of the water right (OAR 690-380-6010).
- The person signing this application is doing so on behalf of a public agency, corporation or business, trust, or other organization and must provide evidence of signatory authority or a signed statement that such authority exists must be attached to this application.

I/we affirm that the information contained in this application is true and accurate.

	Rick Anderson, Secretary	<u>5-21-26</u>
Applicant signature	Print Name (and Title if applicable)	Date
_____	_____	_____
Applicant signature	Print Name (and Title if applicable)	Date

Check One Box:

- By signing this application, I/we understand that, upon receipt of the Initial Review (IR) and prior to Department approval of the transfer, I will be required to provide landownership information and evidence that I am authorized to pursue the transfer as identified in 690-380-4000(5)(b)(B); **OR**
- I/we affirm the applicant is a municipality as defined in ORS 540.510(3)(b) and that the right is in the name of the municipality or a predecessor; **OR**
- I/we affirm the applicant is an entity with the authority to condemn property and is acquiring by condemnation the property to which the water right proposed for transfer is appurtenant and have supporting documentation.

Agent Information - The agent is authorized to represent the applicant in all matters relating to this application.

AGENT NAME/BUSINESS NAME Evan Malepsy, Rogue Civil LLC		PHONE NO(S). 541-621-2868	EMAIL ADDRESS emalepsy@roguecivil.com	
ADDRESS 4251 Tami Lane		CITY Central Point	STATE OR	ZIP 97502

DOCUMENTS AND NOTIFICATIONS WILL BE SENT BY E-MAIL UNLESS REQUESTED OTHERWISE.

ANY PROPOSED FINAL ORDER WILL BE SENT BY CERTIFIED MAIL AND ANY CERTIFICATE BY STANDARD MAIL.

* **IMPORTANT NOTE - Electronic forms of documents:** Beginning on April 1, 2026, and unless requested otherwise by the applicant, the Department will send documents and notifications associated with processing of applications in electronic form (i.e., by email). These emails may come from an automated system (wrd_automated_email@water.oregon.gov). **Consider adding this email address to your safe sender list.**

Check here if any of the water rights proposed for transfer are or will be located within or served by an irrigation or other water district. **NOTE: Complete Supplemental Form D.**

IRRIGATION DISTRICT NAME N/A	ADDRESS (CITY, STATE, ZIP)	EMAIL
---------------------------------	----------------------------	-------

Check here if water for any of the rights supplied under a water service agreement or other contract for stored water with a federal agency or other entity.

ENTITY NAME Bureau of Reclamation	ADDRESS (CITY, STATE, ZIP) 1150 Curtis Road, Boise, ID 83706	EMAIL jkelly@usbr.gov
--------------------------------------	---	--------------------------

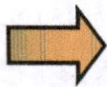

To meet state land use compatibility requirements, you must list the names and mailing addresses of all affected local governments, including but not limited to county, city, municipal corporation, or tribal governments within whose jurisdiction water will be diverted, conveyed and/or used.

ENTITY NAME Jackson County	ADDRESS (CITY, STATE, ZIP) 10 South Oakdale Ave, Medford, OR 96501	EMAIL jcplanning@jacksoncounty.org
-------------------------------	---	---------------------------------------

ENTITY NAME	ADDRESS (CITY, STATE, ZIP)	EMAIL
-------------	----------------------------	-------

Responsibility for Completion of Changes and Receiving Landowner Information

Check the following box that applies:

- The applicant is responsible for completion of change(s). Notices and correspondence should continue to be sent to the applicant. **OR**
- The receiving landowner will be responsible for completing the proposed change(s) after the final order is issued. Copies of notices and correspondence should be sent to this landowner. NOTE: Complete the Receiving Landowner Information Table below. **OR**
- Both the receiving landowner and applicant will be responsible for completion of change(s). Copies of notices and correspondence should be sent to this landowner and the applicant. NOTE: Complete the Receiving Landowner Information Table below.

Yes No At this time, are the lands in this transfer application in the process of being sold?
 If Yes, and you know who the new landowner will be, please complete the receiving landowner information table below. If you do not know who the new landowner will be, a Request for Assignment form is required to be submitted to the Department at a later date. If a property sells, the certificated water right(s) located on the land belong to the new owner, unless a properly recorded sale agreement or other document states otherwise.

NOTE: For more information:
https://www.oregon.gov/owrd/WRDFormsPDF/Transfer_Property_Transactions.pdf

Receiving Landowner Information

RECEIVING LANDOWNER NAME N/A	PHONE NO.(S)	EMAIL ADDRESS		
ADDRESS	CITY	STATE	ZIP	

DOCUMENTS AND NOTIFICATIONS WILL BE SENT BY E-MAIL UNLESS REQUESTED OTHERWISE.
ANY PROPOSED FINAL ORDER WILL BE SENT BY CERTIFIED MAIL AND ANY CERTIFICATE BY STANDARD MAIL.
IMPORTANT NOTE - Electronic forms of documents: Beginning on April 1, 2026, and unless requested otherwise by the applicant, the Department will send documents and notifications associated with processing of applications in electronic form (i.e., by email). These emails may come from an automated system (wrd_automated_email@water.oregon.gov). **Consider adding this email address to your safe sender list.**

Describe any special ownership circumstances:

The confirming Certificate shall be issued in the name of: Applicant Receiving Landowner

PROPOSED CHANGES

Check all type(s) of change(s) proposed below (change "CODES" are provided in parentheses):

Change to Surface Water Point(s) of Diversion:

- Point(s) of Diversion (POD) – the proposed POD(s) will replace the existing authorized POD(s)
- Additional Point(s) of Diversion (APOD) – the proposed POD(s) will be in addition to the existing authorized POD(s)
- Surface Water POD to Groundwater POA (SW/GW) – proposed POA(s) will replace the existing authorized POD
- Government Action POD (GOV) – the proposed POD is due to a government action (ORS 540.510(6))

Change to Point(s) of Groundwater Appropriation:

- Point(s) of Appropriation (POA) – the proposed POA(s) will replace the authorized POA(s)
- Additional Point(s) of Appropriation (APOA) – the proposed POA(s) will be in addition to the authorized POA(s)

Changes in Place of Use and Character of Use:

- Place of Use (POU) - the proposed changes to the place of use will replace the authorized place of use
- Character of Use (USE) - the proposed changes to the character of use of the water right will modify the authorized character of use

Substitution:

- Substitution (SUB) – Substitution of Groundwater Supplemental Irrigation will be substituted for Surface Water Primary Irrigation:

Certificate#	Groundwater supplemental irrigation	Certificate#	Surface water primary irrigation
--------------	-------------------------------------	--------------	----------------------------------

Supplemental to Primary Use

- Supplemental Use to Primary Use (S to P) – supplemental groundwater irrigation replaces primary surface water irrigation:

Certificate #	Primary Surface water right to be cancelled
---------------	---

NOTE: If water rights will be cancelled you must submit a signed and notarized voluntary cancellation/ diminution affidavit with your application.

Explain in your own words what you propose to accomplish with this transfer application, and why:

We wish to move the point of diversion for four certificates due to a change in the course of the river. In addition, we plan to obtain a contract with the Bureau of Reclamation to used stored water from Lost Creek Lake for one of the certificates.

If you need additional space, continue on separate piece of paper and attach to application as "Attachment 1".

**Part 4 of 4 – Permanent Water Right Transfer Application
Authorized POD/POA**

Provide a Separate Part 4 for each water right proposed for transfer.

WATER RIGHT CERTIFICATE # 28391

Name(s) appearing on the certificate: John N. Winton

Description of Water Delivery System

System capacity: 2.5 Cubic Feet per Second (CFS) Gallons Per Minute (GPM) Acre-Feet (AF)

Source (live flow, stored water, etc.): Live Flow from the Rogue River

Describe the current water delivery system. Include information on the capacity of pumps, canals, pipelines, and sprinklers used to divert, convey, and apply the water at the authorized place of use. Please provide as much detail as possible:

A 50HP pump is placed on the bank of the old river channel/canal. Water is pumped via pipes to a system of wheel lines and handlines that apply the water to the pasture.

Amount proposed for transfer: 1.21 CFS GPM AF

Please check the appropriate box below and provide the requested information:

If the water right was certificated under a decree, please indicate:

- Name of Decree: _____

If the water right was certificated through the permit process, please indicate:

- Permit # 19542 and the name(s) appearing on the permit: John N. Winton

If Proof of Appropriation under the water right has been determined by the Department, please indicate:

Special Order Volume # _____, Page # _____

and the name(s) appearing on the Proof of Appropriation Special Order: _____

Table 1A – For Both SW and GW Rights - Location of Existing SW POD(s) or GW POA(s)

NOTE: If the POD/POA name is not specified on the Certificate, assign it a name or number below

Authorized POA/POD Name or Number	Twp		Rng		Sec	¼	¼	Tax Lot, DLC, or Gov-Lot
POD-1	36	S	1	W	7	NE	NW	TL 100

Measured Distances (from a recognized survey corner)

500' South and 3,900' West from NE Corner of Section 7

If authorized point is groundwater:

Well log attached and associated with the well described above **and** on the accompanying application map.

AND/OR

No well log is available - construction of the authorized well is provided in table below.

OWRD Well ID Tag No.	Total well depth	Casing Diameter	Casing Intervals (in feet)	Seal depth(s) (intervals)	Perforated or screened intervals (in feet)	Static water level of completed well (in feet)	Source aquifer (sand, gravel, basalt, etc.)	Well -specific rate if less than full rate of water right
L-								<input type="checkbox"/> CFS <input type="checkbox"/> GPM

Part 4 of 4 continued – Permanent Water Right Transfer Application

Authorized POD/POA

WATER RIGHT CERTIFICATE # 28391

Authorized POA/POD Name or Number		Twp		Rng		Sec		¼ ¼		Tax Lot, DLC, or Gov-Lot	
N/A											
Measured Distances (from a recognized survey corner)											
If authorized point is groundwater: <input type="checkbox"/> Well log attached and associated with the well described above and on the accompanying application map. AND/OR <input type="checkbox"/> No well log is available - construction of the authorized well is provided in table below.											
OWRD Well ID Tag No.	Total well depth	Casing Diameter	Casing Intervals (in feet)	Seal depth(s) (intervals)	Perforated or screened intervals (in feet)	Static water level of completed well (in feet)	Source aquifer (sand, gravel, basalt, etc.)	Well -specific rate if less than full rate of water right			
L-								<input type="checkbox"/> CFS <input type="checkbox"/> GPM			
Authorized POA/POD Name or Number		Twp		Rng		Sec		¼ ¼		Tax Lot, DLC, or Gov-Lot	
N/A						7					
Measured Distances (from a recognized survey corner)											
If authorized point is groundwater: <input type="checkbox"/> Well log attached and associated with the well described above and on the accompanying application map. AND/OR <input type="checkbox"/> No well log is available - construction of the authorized well is provided in table below.											
OWRD Well ID Tag No.	Total well depth	Casing Diameter	Casing Intervals (in feet)	Seal depth(s) (intervals)	Perforated or screened intervals (in feet)	Static water level of completed well (in feet)	Source aquifer (sand, gravel, basalt, etc.)	Well -specific rate if less than full rate of water right			
L-								<input type="checkbox"/> CFS <input type="checkbox"/> GPM			
Authorized POA/POD Name or Number		Twp		Rng		Sec		¼ ¼		Tax Lot, DLC, or Gov-Lot	
N/A											
Measured Distances (from a recognized survey corner)											
If authorized point is groundwater: <input type="checkbox"/> Well log attached and associated with the well described above and on the accompanying application map. AND/OR <input type="checkbox"/> No well log is available - construction of the authorized well is provided in table below.											
OWRD Well ID Tag No.	Total well depth	Casing Diameter	Casing Intervals (in feet)	Seal depth(s) (intervals)	Perforated or screened intervals (in feet)	Static water level of completed well (in feet)	Source aquifer (sand, gravel, basalt, etc.)	Well -specific rate if less than full rate of water right			
L-								<input type="checkbox"/> CFS <input type="checkbox"/> GPM			

- 1 4 8 7 2 -

**Part 4 of 4 continued – Permanent Water Right Transfer Application
Proposed POD/APOD Information – Surface Water Right(s) ONLY**

WATER RIGHT CERTIFICATE # 28391

Table 1BSW - Location of Proposed Surface Water POD/APOD(s)

Proposed POD Name or Number	Twp		Rng		Sec	¼	¼	Tax Lot, DLC, or Gov-Lot
POD-2	36	S	1	W	6	SW	SW	TL 501
Type of Change (from Page 6): <input checked="" type="checkbox"/> POD or <input type="checkbox"/> APOD					From Authorized POD: <input checked="" type="checkbox"/> UPSTREAM or <input type="checkbox"/> DOWNSTREAM			
Measured Distances (from a recognized survey corner)								
2,350' West and 970' North from the South 1/4 Corner of Section 6								
Fish Screen Information:								
<input type="checkbox"/> Yes <input checked="" type="checkbox"/> No The proposed POD/APOD has an existing approved fish screen pursuant to ORS 540.525 or 540.532 If Yes , please, submit documentation of the approved fish screen with your application, such as any Oregon Department of Fish and Wildlife (ODFW) fish screening certification letter and/or passage approval letter. Additional Information/Remarks:								
<hr/>								
Proposed POD Name or Number	Twp		Rng		Sec	¼	¼	Tax Lot, DLC, or Gov-Lot
N/A								
Type of Change (from Page 6): <input type="checkbox"/> POD or <input type="checkbox"/> APOD					From Authorized POD: <input type="checkbox"/> UPSTREAM or <input type="checkbox"/> DOWNSTREAM			
Measured Distances (from a recognized survey corner)								
<hr/>								
Fish Screen Information:								
<input type="checkbox"/> Yes <input type="checkbox"/> No The proposed POD/APOD has an existing approved fish screen pursuant to ORS 540.525 or 540.532 If Yes , please, submit documentation of the approved fish screen with your application, such as any Oregon Department of Fish and Wildlife (ODFW) fish screening certification letter and/or passage approval letter. Additional Information/Remarks:								
<hr/>								
Proposed POD Name or Number	Twp		Rng		Sec	¼	¼	Tax Lot, DLC, or Gov-Lot
N/A								
Type of Change (from Page 6): <input type="checkbox"/> POD or <input type="checkbox"/> APOD					From Authorized POD: <input type="checkbox"/> UPSTREAM or <input type="checkbox"/> DOWNSTREAM			
Measured Distances (from a recognized survey corner)								
<hr/>								
Fish Screen Information:								
<input type="checkbox"/> Yes <input type="checkbox"/> No The proposed POD/APOD has an existing approved fish screen pursuant to ORS 540.525 or 540.532 If Yes , please, submit documentation of the approved fish screen with your application, such as any Oregon Department of Fish and Wildlife (ODFW) fish screening certification letter and/or passage approval letter. Additional Information/Remarks:								

**Part 4 of 4 continued – Permanent Water Right Transfer Application
Proposed POA/APOA Information – Groundwater Right(s) ONLY**

WATER RIGHT CERTIFICATE # 28391

Table 1B-GW - Location of Proposed Groundwater POA/APOA(s)

Proposed POA Name or Number	Twp	Rng	Sec	¼	¼	Tax Lot, DLC, or Gov-Lot
N/A						

Measured Distances (from a recognized survey corner) POA APOA

Well log attached and associated with the well described above **and** on the accompanying application map.
AND/OR

No well log is available - construction of the authorized well is provided in table below.

OWRD Well ID Tag No.	Total well depth	Casing Diameter	Casing Intervals (in feet)	Seal depth(s) (intervals)	Perforated or screened intervals (in feet)	Static water level of completed well (in feet)	Source aquifer (sand, gravel, basalt, etc.)	Well -specific rate if less than full rate of water right
L-								<input type="checkbox"/> CFS <input type="checkbox"/> GPM

Proposed POA Name or Number	Twp	Rng	Sec	¼	¼	Tax Lot, DLC, or Gov-Lot
N/A						

Measured Distances (from a recognized survey corner) POA APOA

Well log attached and associated with the well described above **and** on the accompanying application map.
AND/OR

No well log is available - construction of the authorized well is provided in table below.

OWRD Well ID Tag No.	Total well depth	Casing Diameter	Casing Intervals (in feet)	Seal depth(s) (intervals)	Perforated or screened intervals (in feet)	Static water level of completed well (in feet)	Source aquifer (sand, gravel, basalt, etc.)	Well -specific rate if less than full rate of water right
L-								<input type="checkbox"/> CFS <input type="checkbox"/> GPM

Proposed POA Name or Number	Twp	Rng	Sec	¼	¼	Tax Lot, DLC, or Gov-Lot
N/A						

Measured Distances (from a recognized survey corner) POA APOA

Well log attached and associated with the well described above **and** on the accompanying application map,
AND/OR

No well log is available - construction of the authorized well is provided in table below.

OWRD Well ID Tag No.	Total well depth	Casing Diameter	Casing Intervals (in feet)	Seal depth(s) (intervals)	Perforated or screened intervals (in feet)	Static water level of completed well (in feet)	Source aquifer (sand, gravel, basalt, etc.)	Well -specific rate if less than full rate of water right
L-								<input type="checkbox"/> CFS <input type="checkbox"/> GPM

**Part 4 of 4 continued – Permanent Water Right Transfer Application
Proposed POU “TO” LANDS**

WATER RIGHT CERTIFICATE# 28391

Table 2B - Description of the PROPOSED (the “to” or “on” lands) Place of Use, Character of Use and POD/APOD(s) or POA/APOA(s) to the Water Right Certificate AFTER PROPOSED CHANGES are made.

NOTE: If more than one change is proposed, specify the acreage associated with each change. If there is more than one POA/APOA involved in the proposed changes, specify the acreage associated with each POA/APOA.

Proposed POD/APOD(s) or POA/APOA(s) Name(s) from Table 1B (SW or GW)	Twp		Rng		Sec	¼	¼	Tax Lot, DLC, or Gov-Lot	Acres	Authorized Use	Priority Date
POD-2	36	S	1	W	6	SW	SE	801, 900	11.90	Irrigation	6/5/1950
POD-2	36	S	1	W	6	SE	SE	801, 900	4.05	Irrigation	6/5/1950
POD-2	36	S	1	W	7	NE	NE	100	18.20	Irrigation	6/5/1950
POD-2	36	S	1	W	7	NW	NE	100	25.90	Irrigation	6/5/1950
POD-2	36	S	1	W	7	NE	NW	100	36.75	Irrigation	6/5/1950
TOTAL ACRES									96.8		

Additional remarks:
This transfer is for a change of POD only.

For Place of Use Changes – Irrigation Water Rights ONLY

Are there other water right certificates, water use permits or ground water registrations associated with the “to” lands?
 Yes No If YES, list the certificate, water use permit, or groundwater registration number(s) that may become layered if the modification is approved:
 N/A

NOTE: If water rights will be cancelled or diminished you must submit a signed and notarized voluntary cancellation/ diminution affidavit with your application.

**Part 4 of 4 – Permanent Water Right Transfer Application
Authorized POD/POA**

Provide a Separate Part 4 for each water right proposed for transfer.

WATER RIGHT CERTIFICATE # 33730

Name(s) appearing on the certificate: Trans Bay Construction Co., Inc.

Description of Water Delivery System

System capacity: 2.5 Cubic Feet per Second (CFS) Gallons Per Minute (GPM) Acre-Feet (AF)

Source (live flow, stored water, etc.): Live Flow from the Rogue River

Describe the current water delivery system. Include information on the capacity of pumps, canals, pipelines, and sprinklers used to divert, convey, and apply the water at the authorized place of use. Please provide as much detail as possible:

A 50HP pump is placed on the bank of the old river channel/canal. Water is pumped via pipes to a system of wheel lines and handlines that apply the water to the pasture.

Amount proposed for transfer: 0.28 CFS GPM AF

Please check the appropriate box below and provide the requested information:

If the water right was certificated under a decree, please indicate:

- Name of Decree: _____

If the water right was certificated through the permit process, please indicate:

- Permit # 27260 and the name(s) appearing on the permit: Trans Bay Construction Co. Inc.

If Proof of Appropriation under the water right has been determined by the Department, please indicate:

Special Order Volume # _____, Page # _____

and the name(s) appearing on the Proof of Appropriation Special Order: _____

Table 1A – For Both SW and GW Rights - Location of Existing SW POD(s) or GW POA(s)

NOTE: If the POD/POA name is not specified on the Certificate, assign it a name or number below

Authorized POA/POD Name or Number	Twp		Rng		Sec	¼	¼	Tax Lot, DLC, or Gov-Lot
POD-1	36	S	1	W	7	NE	NW	TL 100

Measured Distances (from a recognized survey corner)

500' South and 1,180' West from N 1/4 Corner of Section 7

If authorized point is groundwater:

Well log attached and associated with the well described above **and** on the accompanying application map.

AND/OR

No well log is available - construction of the authorized well is provided in table below.

OWRD Well ID Tag No.	Total well depth	Casing Diameter	Casing Intervals (in feet)	Seal depth(s) (intervals)	Perforated or screened intervals (in feet)	Static water level of completed well (in feet)	Source aquifer (sand, gravel, basalt, etc.)	Well -specific rate if less than full rate of water right
L-								<input type="checkbox"/> CFS <input type="checkbox"/> GPM

Part 4 of 4 continued – Permanent Water Right Transfer Application

Authorized POD/POA

WATER RIGHT CERTIFICATE # 33730

Authorized POA/POD Name or Number		Twp		Rng		Sec		¼ ¼		Tax Lot, DLC, or Gov-Lot	
N/A											
Measured Distances (from a recognized survey corner)											
If authorized point is groundwater: <input type="checkbox"/> Well log attached and associated with the well described above and on the accompanying application map. AND/OR <input type="checkbox"/> No well log is available - construction of the authorized well is provided in table below.											
OWRD Well ID Tag No.	Total well depth	Casing Diameter	Casing Intervals (in feet)	Seal depth(s) (intervals)	Perforated or screened intervals (in feet)	Static water level of completed well (in feet)	Source aquifer (sand, gravel, basalt, etc.)	Well -specific rate if less than full rate of water right			
L-								<input type="checkbox"/> CFS <input type="checkbox"/> GPM			
Authorized POA/POD Name or Number		Twp		Rng		Sec		¼ ¼		Tax Lot, DLC, or Gov-Lot	
N/A						7					
Measured Distances (from a recognized survey corner)											
If authorized point is groundwater: <input type="checkbox"/> Well log attached and associated with the well described above and on the accompanying application map. AND/OR <input type="checkbox"/> No well log is available - construction of the authorized well is provided in table below.											
OWRD Well ID Tag No.	Total well depth	Casing Diameter	Casing Intervals (in feet)	Seal depth(s) (intervals)	Perforated or screened intervals (in feet)	Static water level of completed well (in feet)	Source aquifer (sand, gravel, basalt, etc.)	Well -specific rate if less than full rate of water right			
L-								<input type="checkbox"/> CFS <input type="checkbox"/> GPM			
Authorized POA/POD Name or Number		Twp		Rng		Sec		¼ ¼		Tax Lot, DLC, or Gov-Lot	
N/A											
Measured Distances (from a recognized survey corner)											
If authorized point is groundwater: <input type="checkbox"/> Well log attached and associated with the well described above and on the accompanying application map. AND/OR <input type="checkbox"/> No well log is available - construction of the authorized well is provided in table below.											
OWRD Well ID Tag No.	Total well depth	Casing Diameter	Casing Intervals (in feet)	Seal depth(s) (intervals)	Perforated or screened intervals (in feet)	Static water level of completed well (in feet)	Source aquifer (sand, gravel, basalt, etc.)	Well -specific rate if less than full rate of water right			
L-								<input type="checkbox"/> CFS <input type="checkbox"/> GPM			

**Part 4 of 4 continued – Permanent Water Right Transfer Application
Proposed POD/APOD Information – Surface Water Right(s) ONLY**

WATER RIGHT CERTIFICATE # 33730

Table 1BSW - Location of Proposed Surface Water POD/APOD(s)

Proposed POD Name or Number	Twp		Rng		Sec	¼	¼	Tax Lot, DLC, or Gov-Lot
POD-2	36	S	1	W	6	SW	SW	TL 501

Type of Change (from Page 6): POD or APOD From Authorized POD: UPSTREAM or DOWNSTREAM

Measured Distances (from a recognized survey corner)
2,350' West and 970' North from the South 1/4 Corner of Section 6

Fish Screen Information:

Yes No The proposed POD/APOD has an existing approved fish screen pursuant to ORS 540.525 or 540.532
If Yes, please, submit documentation of the approved fish screen with your application, such as any Oregon Department of Fish and Wildlife (ODFW) fish screening certification letter and/or passage approval letter.
 Additional Information/Remarks:

Proposed POD Name or Number	Twp		Rng		Sec	¼	¼	Tax Lot, DLC, or Gov-Lot
N/A								

Type of Change (from Page 6): POD or APOD From Authorized POD: UPSTREAM or DOWNSTREAM

Measured Distances (from a recognized survey corner)

Fish Screen Information:

Yes No The proposed POD/APOD has an existing approved fish screen pursuant to ORS 540.525 or 540.532
If Yes, please, submit documentation of the approved fish screen with your application, such as any Oregon Department of Fish and Wildlife (ODFW) fish screening certification letter and/or passage approval letter.
 Additional Information/Remarks:

Proposed POD Name or Number	Twp		Rng		Sec	¼	¼	Tax Lot, DLC, or Gov-Lot
N/A								

Type of Change (from Page 6): POD or APOD From Authorized POD: UPSTREAM or DOWNSTREAM

Measured Distances (from a recognized survey corner)

Fish Screen Information:

Yes No The proposed POD/APOD has an existing approved fish screen pursuant to ORS 540.525 or 540.532
If Yes, please, submit documentation of the approved fish screen with your application, such as any Oregon Department of Fish and Wildlife (ODFW) fish screening certification letter and/or passage approval letter.
 Additional Information/Remarks:

**Part 4 of 4 continued – Permanent Water Right Transfer Application
Proposed POA/APOA Information – Groundwater Right(s) ONLY**

WATER RIGHT CERTIFICATE # 33730

Table 1B-GW - Location of Proposed Groundwater POA/APOA(s)

Proposed POA Name or Number	Twp	Rng	Sec	¼	¼	Tax Lot, DLC, or Gov-Lot		
N/A								
Measured Distances (from a recognized survey corner)						<input type="checkbox"/> POA <input type="checkbox"/> APOA		
<input type="checkbox"/> Well log attached and associated with the well described above and on the accompanying application map. AND/OR <input type="checkbox"/> No well log is available - construction of the authorized well is provided in table below.								
OWRD Well ID Tag No.	Total well depth	Casing Diameter	Casing Intervals (in feet)	Seal depth(s) (intervals)	Perforated or screened intervals (in feet)	Static water level of completed well (in feet)	Source aquifer (sand, gravel, basalt, etc.)	Well -specific rate if less than full rate of water right
L-								<input type="checkbox"/> CFS <input type="checkbox"/> GPM
Proposed POA Name or Number	Twp	Rng	Sec	¼	¼	Tax Lot, DLC, or Gov-Lot		
N/A								
Measured Distances (from a recognized survey corner)						<input type="checkbox"/> POA <input type="checkbox"/> APOA		
<input type="checkbox"/> Well log attached and associated with the well described above and on the accompanying application map. AND/OR <input type="checkbox"/> No well log is available - construction of the authorized well is provided in table below.								
OWRD Well ID Tag No.	Total well depth	Casing Diameter	Casing Intervals (in feet)	Seal depth(s) (intervals)	Perforated or screened intervals (in feet)	Static water level of completed well (in feet)	Source aquifer (sand, gravel, basalt, etc.)	Well -specific rate if less than full rate of water right
L-								<input type="checkbox"/> CFS <input type="checkbox"/> GPM
Proposed POA Name or Number	Twp	Rng	Sec	¼	¼	Tax Lot, DLC, or Gov-Lot		
N/A								
Measured Distances (from a recognized survey corner)						<input type="checkbox"/> POA <input type="checkbox"/> APOA		
<input type="checkbox"/> Well log attached and associated with the well described above and on the accompanying application map. AND/OR <input type="checkbox"/> No well log is available - construction of the authorized well is provided in table below.								
OWRD Well ID Tag No.	Total well depth	Casing Diameter	Casing Intervals (in feet)	Seal depth(s) (intervals)	Perforated or screened intervals (in feet)	Static water level of completed well (in feet)	Source aquifer (sand, gravel, basalt, etc.)	Well -specific rate if less than full rate of water right
L-								<input type="checkbox"/> CFS <input type="checkbox"/> GPM

**Part 4 of 4 continued – Permanent Water Right Transfer Application
Proposed POU “TO” LANDS**

WATER RIGHT CERTIFICATE# 33730

Table 2B - Description of the PROPOSED (the “to” or “on” lands) Place of Use, Character of Use and POD/APOD(s) or POA/APOA(s) to the Water Right Certificate AFTER PROPOSED CHANGES are made.

NOTE: If more than one change is proposed, specify the acreage associated with each change. If there is more than one POA/APOA involved in the proposed changes, specify the acreage associated with each POA/APOA.

Proposed POD/APOD(s) or POA/APOA(s) Name(s) from Table 1B (SW or GW)	Twp		Rng		Sec	¼ ¼		Tax Lot, DLC, or Gov-Lot	Acres	Authorized Use	Priority Date
POD-2	36	S	1	W	6	NE	SE	801	6.4	Irrigation	3/14/1961
POD-2	36	S	1	W	6	NW	SE	801	7.2	Irrigation	3/14/1961
POD-2	36	S	1	W	6	SW	SW	801, 900	8.4	Irrigation	3/14/1961
POD-2	36	S	1	W	6	SE	SE	801, 900	0.7	Irrigation	3/14/1961
TOTAL ACRES									22.7		

Additional remarks:
This transfer is for a change of POD only.

For Place of Use Changes – Irrigation Water Rights ONLY

Are there other water right certificates, water use permits or ground water registrations associated with the “to” lands?
 Yes No If YES, list the certificate, water use permit, or groundwater registration number(s) that may become layered if the modification is approved:
 N/A

NOTE: If water rights will be cancelled or diminished you must submit a signed and notarized voluntary cancellation/ diminution affidavit with your application.

**Part 4 of 4 – Permanent Water Right Transfer Application
Authorized POD/POA**

Provide a Separate Part 4 for each water right proposed for transfer.

WATER RIGHT CERTIFICATE # 63748

Name(s) appearing on the certificate: Southern Oregon Tallow Company, Inc.

Description of Water Delivery System

System capacity: 2.5 Cubic Feet per Second (CFS) Gallons Per Minute (GPM) Acre-Feet (AF)

Source (live flow, stored water, etc.): Stored Water from Lost Creek Reservoir via the

Describe the current water delivery system. Include information on the capacity of pumps, canals, pipelines, and sprinklers used to divert, convey, and apply the water at the authorized place of use. Please provide as much detail as possible:

A 50HP pump is placed on the bank of the old river channel/canal. Water is pumped via pipes to a system of wheel lines and handlines that apply the water to the pasture.

Amount proposed for transfer: 45 CFS GPM AF

Please check the appropriate box below and provide the requested information:

If the water right was certificated under a decree, please indicate:

- Name of Decree: _____

If the water right was certificated through the permit process, please indicate:

- Permit # 46092 and the name(s) appearing on the permit: Southern Oregon Tallow Co. Inc.

If Proof of Appropriation under the water right has been determined by the Department, please indicate:

Special Order Volume # _____, Page # _____

and the name(s) appearing on the Proof of Appropriation Special Order: _____

Table 1A – For Both SW and GW Rights - Location of Existing SW POD(s) or GW POA(s)

NOTE: If the POD/POA name is not specified on the Certificate, assign it a name or number below

Authorized POA/POD Name or Number	Twp		Rng		Sec	¼	¼	Tax Lot, DLC, or Gov-Lot
POD-1	36	S	1	W	7	NE	NW	TL 100

Measured Distances (from a recognized survey corner)

500' South and 3,900' West from NE Corner of Section 7

If authorized point is groundwater:

Well log attached and associated with the well described above **and** on the accompanying application map.

AND/OR

No well log is available - construction of the authorized well is provided in table below.

OWRD Well ID Tag No.	Total well depth	Casing Diameter	Casing Intervals (in feet)	Seal depth(s) (intervals)	Perforated or screened intervals (in feet)	Static water level of completed well (in feet)	Source aquifer (sand, gravel, basalt, etc.)	Well -specific rate if less than full rate of water right
L-								<input type="checkbox"/> CFS <input type="checkbox"/> GPM

Part 4 of 4 continued – Permanent Water Right Transfer Application
Authorized POD/POA

WATER RIGHT CERTIFICATE # 63748

Authorized POA/POD Name or Number		Twp		Rng		Sec		¼ ¼		Tax Lot, DLC, or Gov-Lot	
N/A											
Measured Distances (from a recognized survey corner)											
If authorized point is groundwater: <input type="checkbox"/> Well log attached and associated with the well described above and on the accompanying application map. AND/OR <input type="checkbox"/> No well log is available - construction of the authorized well is provided in table below.											
OWRD Well ID Tag No.	Total well depth	Casing Diameter	Casing Intervals (in feet)	Seal depth(s) (intervals)	Perforated or screened intervals (in feet)	Static water level of completed well (in feet)	Source aquifer (sand, gravel, basalt, etc.)	Well -specific rate if less than full rate of water right			
L-								<input type="checkbox"/> CFS <input type="checkbox"/> GPM			
Authorized POA/POD Name or Number		Twp		Rng		Sec		¼ ¼		Tax Lot, DLC, or Gov-Lot	
N/A						7					
Measured Distances (from a recognized survey corner)											
If authorized point is groundwater: <input type="checkbox"/> Well log attached and associated with the well described above and on the accompanying application map. AND/OR <input type="checkbox"/> No well log is available - construction of the authorized well is provided in table below.											
OWRD Well ID Tag No.	Total well depth	Casing Diameter	Casing Intervals (in feet)	Seal depth(s) (intervals)	Perforated or screened intervals (in feet)	Static water level of completed well (in feet)	Source aquifer (sand, gravel, basalt, etc.)	Well -specific rate if less than full rate of water right			
L-								<input type="checkbox"/> CFS <input type="checkbox"/> GPM			
Authorized POA/POD Name or Number		Twp		Rng		Sec		¼ ¼		Tax Lot, DLC, or Gov-Lot	
N/A											
Measured Distances (from a recognized survey corner)											
If authorized point is groundwater: <input type="checkbox"/> Well log attached and associated with the well described above and on the accompanying application map. AND/OR <input type="checkbox"/> No well log is available - construction of the authorized well is provided in table below.											
OWRD Well ID Tag No.	Total well depth	Casing Diameter	Casing Intervals (in feet)	Seal depth(s) (intervals)	Perforated or screened intervals (in feet)	Static water level of completed well (in feet)	Source aquifer (sand, gravel, basalt, etc.)	Well -specific rate if less than full rate of water right			
L-								<input type="checkbox"/> CFS <input type="checkbox"/> GPM			

**Part 4 of 4 continued – Permanent Water Right Transfer Application
Proposed POD/APOD Information – Surface Water Right(s) ONLY**

WATER RIGHT CERTIFICATE # 63748

Table 1BSW - Location of Proposed Surface Water POD/APOD(s)

Proposed POD Name or Number	Twp		Rng		Sec	¼	¼	Tax Lot, DLC, or Gov-Lot
POD-2	36	S	1	W	6	SW	SW	TL 501
Type of Change (from Page 6): <input checked="" type="checkbox"/> POD or <input type="checkbox"/> APOD					From Authorized POD: <input checked="" type="checkbox"/> UPSTREAM or <input type="checkbox"/> DOWNSTREAM			
Measured Distances (from a recognized survey corner)								
2,350' West and 970' North from the South 1/4 Corner of Section 6								
Fish Screen Information:								
<input type="checkbox"/> Yes <input checked="" type="checkbox"/> No The proposed POD/APOD has an existing approved fish screen pursuant to ORS 540.525 or 540.532								
If Yes , please, submit documentation of the approved fish screen with your application, such as any Oregon Department of Fish and Wildlife (ODFW) fish screening certification letter and/or passage approval letter.								
Additional Information/Remarks:								
Proposed POD Name or Number	Twp		Rng		Sec	¼	¼	Tax Lot, DLC, or Gov-Lot
N/A								
Type of Change (from Page 6): <input type="checkbox"/> POD or <input type="checkbox"/> APOD					From Authorized POD: <input type="checkbox"/> UPSTREAM or <input type="checkbox"/> DOWNSTREAM			
Measured Distances (from a recognized survey corner)								
Fish Screen Information:								
<input type="checkbox"/> Yes <input type="checkbox"/> No The proposed POD/APOD has an existing approved fish screen pursuant to ORS 540.525 or 540.532								
If Yes , please, submit documentation of the approved fish screen with your application, such as any Oregon Department of Fish and Wildlife (ODFW) fish screening certification letter and/or passage approval letter.								
Additional Information/Remarks:								
Proposed POD Name or Number	Twp		Rng		Sec	¼	¼	Tax Lot, DLC, or Gov-Lot
N/A								
Type of Change (from Page 6): <input type="checkbox"/> POD or <input type="checkbox"/> APOD					From Authorized POD: <input type="checkbox"/> UPSTREAM or <input type="checkbox"/> DOWNSTREAM			
Measured Distances (from a recognized survey corner)								
Fish Screen Information:								
<input type="checkbox"/> Yes <input type="checkbox"/> No The proposed POD/APOD has an existing approved fish screen pursuant to ORS 540.525 or 540.532								
If Yes , please, submit documentation of the approved fish screen with your application, such as any Oregon Department of Fish and Wildlife (ODFW) fish screening certification letter and/or passage approval letter.								
Additional Information/Remarks:								

**Part 4 of 4 continued – Permanent Water Right Transfer Application
Proposed POA/APOA Information – Groundwater Right(s) ONLY**

WATER RIGHT CERTIFICATE # 63748

Table 1B-GW - Location of Proposed Groundwater POA/APOA(s)

Proposed POA Name or Number	Twp	Rng	Sec	¼	¼	Tax Lot, DLC, or Gov-Lot
N/A						

Measured Distances (from a recognized survey corner) POA APOA

Well log attached and associated with the well described above **and** on the accompanying application map. **AND/OR**

No well log is available - construction of the authorized well is provided in table below.

OWRD Well ID Tag No.	Total well depth	Casing Diameter	Casing Intervals (in feet)	Seal depth(s) (intervals)	Perforated or screened intervals (in feet)	Static water level of completed well (in feet)	Source aquifer (sand, gravel, basalt, etc.)	Well -specific rate if less than full rate of water right
L-								<input type="checkbox"/> CFS <input type="checkbox"/> GPM

Proposed POA Name or Number	Twp	Rng	Sec	¼	¼	Tax Lot, DLC, or Gov-Lot
N/A						

Measured Distances (from a recognized survey corner) POA APOA

Well log attached and associated with the well described above **and** on the accompanying application map. **AND/OR**

No well log is available - construction of the authorized well is provided in table below.

OWRD Well ID Tag No.	Total well depth	Casing Diameter	Casing Intervals (in feet)	Seal depth(s) (intervals)	Perforated or screened intervals (in feet)	Static water level of completed well (in feet)	Source aquifer (sand, gravel, basalt, etc.)	Well -specific rate if less than full rate of water right
L-								<input type="checkbox"/> CFS <input type="checkbox"/> GPM

Proposed POA Name or Number	Twp	Rng	Sec	¼	¼	Tax Lot, DLC, or Gov-Lot
N/A						

Measured Distances (from a recognized survey corner) POA APOA

Well log attached and associated with the well described above **and** on the accompanying application map. **AND/OR**

No well log is available - construction of the authorized well is provided in table below.

OWRD Well ID Tag No.	Total well depth	Casing Diameter	Casing Intervals (in feet)	Seal depth(s) (intervals)	Perforated or screened intervals (in feet)	Static water level of completed well (in feet)	Source aquifer (sand, gravel, basalt, etc.)	Well -specific rate if less than full rate of water right
L-								<input type="checkbox"/> CFS <input type="checkbox"/> GPM

**Part 4 of 4 continued – Permanent Water Right Transfer Application
Proposed POU “TO” LANDS**

WATER RIGHT CERTIFICATE# 63748

Table 2B - Description of the PROPOSED (the “to” or “on” lands) Place of Use, Character of Use and POD/APOD(s) or POA/APOA(s) to the Water Right Certificate AFTER PROPOSED CHANGES are made.

NOTE: If more than one change is proposed, specify the acreage associated with each change. If there is more than one POA/APOA involved in the proposed changes, specify the acreage associated with each POA/APOA.

Proposed POD/APOD(s) or POA/APOA(s) Name(s) from Table 1B (SW or GW)	Twp		Rng		Sec	¼	¼	Tax Lot, DLC, or Gov-Lot	Acres	Authorized Use	Priority Date
POD-2	36	S	1	W	6	NE	SE	801	6.4	Sup. Irrigation	3/14/1961
POD-2	36	S	1	W	6	NW	SE	801	7.2	Sup. Irrigation	3/14/1961
POD-2	36	S	1	W	6	SW	SW	801, 900	8.4	Sup. Irrigation	3/14/1961
POD-2	36	S	1	W	6	SE	SE	801, 900	0.7	Sup. Irrigation	3/14/1961
TOTAL ACRES									22.7		

Additional remarks:
This transfer is for a change of POD only. This certificate had a contract with the Bureau of Reclamation (No. 1-07-10-Wo41) but it expires

For Place of Use Changes – Irrigation Water Rights ONLY

Are there other water right certificates, water use permits or ground water registrations associated with the “to” lands?
 Yes No If YES, list the certificate, water use permit, or groundwater registration number(s) that may become layered if the modification is approved:
 N/A

NOTE: If water rights will be cancelled or diminished you must submit a signed and notarized voluntary cancellation/ diminution affidavit with your application.

Part 4 of 4 – Permanent Water Right Transfer Application
Authorized POD/POA

Provide a Separate Part 4 for each water right proposed for transfer.

WATER RIGHT CERTIFICATE # 63792

Name(s) appearing on the certificate: Southern Oregon Tallow Company

Description of Water Delivery System

System capacity: 2.5 Cubic Feet per Second (CFS) Gallons Per Minute (GPM) Acre-Feet (AF)

Source (live flow, stored water, etc.): Live Flow from the Rogue River

Describe the current water delivery system. Include information on the capacity of pumps, canals, pipelines, and sprinklers used to divert, convey, and apply the water at the authorized place of use. Please provide as much detail as possible:

A 50HP pump is placed on the bank of the old river channel/canal. Water is pumped via pipes to a system of wheel lines and handlines that apply the water to the pasture.

Amount proposed for transfer: 0.53 CFS GPM AF

Please check the appropriate box below and provide the requested information:

If the water right was certificated under a decree, please indicate:

- Name of Decree: _____

If the water right was certificated through the permit process, please indicate:

- Permit # 19542 and the name(s) appearing on the permit: John N. Winton

If Proof of Appropriation under the water right has been determined by the Department, please indicate:

Special Order Volume # _____, Page # _____

and the name(s) appearing on the Proof of Appropriation Special Order: _____

Table 1A – For Both SW and GW Rights - Location of Existing SW POD(s) or GW POA(s)

NOTE: If the POD/POA name is not specified on the Certificate, assign it a name or number below

Authorized POA/POD Name or Number	Twp		Rng		Sec	¼	¼	Tax Lot, DLC, or Gov-Lot
POD-1	36	S	1	W	7	NE	NW	TL 100

Measured Distances (from a recognized survey corner)

500' South and 3,900' West from NE Corner of Section 7

If authorized point is groundwater:

Well log attached and associated with the well described above **and** on the accompanying application map.

AND/OR

No well log is available - construction of the authorized well is provided in table below.

OWRD Well ID Tag No.	Total well depth	Casing Diameter	Casing Intervals (in feet)	Seal depth(s) (intervals)	Perforated or screened intervals (in feet)	Static water level of completed well (in feet)	Source aquifer (sand, gravel, basalt, etc.)	Well -specific rate if less than full rate of water right
L-								<input type="checkbox"/> CFS <input type="checkbox"/> GPM

Part 4 of 4 continued – Permanent Water Right Transfer Application

Authorized POD/POA

WATER RIGHT CERTIFICATE # 63792

Authorized POA/POD Name or Number		Twp		Rng		Sec		¼ ¼		Tax Lot, DLC, or Gov-Lot	
N/A											
Measured Distances (from a recognized survey corner)											
If authorized point is groundwater: <input type="checkbox"/> Well log attached and associated with the well described above and on the accompanying application map. AND/OR <input type="checkbox"/> No well log is available - construction of the authorized well is provided in table below.											
OWRD Well ID Tag No.	Total well depth	Casing Diameter	Casing Intervals (in feet)	Seal depth(s) (intervals)	Perforated or screened intervals (in feet)	Static water level of completed well (in feet)	Source aquifer (sand, gravel, basalt, etc.)	Well -specific rate if less than full rate of water right			
L-											<input type="checkbox"/> CFS <input type="checkbox"/> GPM
Authorized POA/POD Name or Number		Twp		Rng		Sec		¼ ¼		Tax Lot, DLC, or Gov-Lot	
N/A						7					
Measured Distances (from a recognized survey corner)											
If authorized point is groundwater: <input type="checkbox"/> Well log attached and associated with the well described above and on the accompanying application map. AND/OR <input type="checkbox"/> No well log is available - construction of the authorized well is provided in table below.											
OWRD Well ID Tag No.	Total well depth	Casing Diameter	Casing Intervals (in feet)	Seal depth(s) (intervals)	Perforated or screened intervals (in feet)	Static water level of completed well (in feet)	Source aquifer (sand, gravel, basalt, etc.)	Well -specific rate if less than full rate of water right			
L-											<input type="checkbox"/> CFS <input type="checkbox"/> GPM
Authorized POA/POD Name or Number		Twp		Rng		Sec		¼ ¼		Tax Lot, DLC, or Gov-Lot	
N/A											
Measured Distances (from a recognized survey corner)											
If authorized point is groundwater: <input type="checkbox"/> Well log attached and associated with the well described above and on the accompanying application map. AND/OR <input type="checkbox"/> No well log is available - construction of the authorized well is provided in table below.											
OWRD Well ID Tag No.	Total well depth	Casing Diameter	Casing Intervals (in feet)	Seal depth(s) (intervals)	Perforated or screened intervals (in feet)	Static water level of completed well (in feet)	Source aquifer (sand, gravel, basalt, etc.)	Well -specific rate if less than full rate of water right			
L-											<input type="checkbox"/> CFS <input type="checkbox"/> GPM

**Part 4 of 4 continued – Permanent Water Right Transfer Application
Proposed POD/APOD Information – Surface Water Right(s) ONLY**

WATER RIGHT CERTIFICATE # 63792

Table 1BSW - Location of Proposed Surface Water POD/APOD(s)

Proposed POD Name or Number	Twp		Rng		Sec	¼	¼	Tax Lot, DLC, or Gov-Lot
POD-2	36	S	1	W	6	SW	SW	TL 501
Type of Change (from Page 6): <input checked="" type="checkbox"/> POD or <input type="checkbox"/> APOD					From Authorized POD: <input checked="" type="checkbox"/> UPSTREAM or <input type="checkbox"/> DOWNSTREAM			
Measured Distances (from a recognized survey corner)								
2,350' West and 970' North from the South 1/4 Corner of Section 6								
Fish Screen Information:								
<input type="checkbox"/> Yes <input checked="" type="checkbox"/> No The proposed POD/APOD has an existing approved fish screen pursuant to ORS 540.525 or 540.532 If Yes , please, submit documentation of the approved fish screen with your application, such as any Oregon Department of Fish and Wildlife (ODFW) fish screening certification letter and/or passage approval letter. Additional Information/Remarks:								
Proposed POD Name or Number	Twp		Rng		Sec	¼	¼	Tax Lot, DLC, or Gov-Lot
N/A								
Type of Change (from Page 6): <input type="checkbox"/> POD or <input type="checkbox"/> APOD					From Authorized POD: <input type="checkbox"/> UPSTREAM or <input type="checkbox"/> DOWNSTREAM			
Measured Distances (from a recognized survey corner)								
Fish Screen Information:								
<input type="checkbox"/> Yes <input type="checkbox"/> No The proposed POD/APOD has an existing approved fish screen pursuant to ORS 540.525 or 540.532 If Yes , please, submit documentation of the approved fish screen with your application, such as any Oregon Department of Fish and Wildlife (ODFW) fish screening certification letter and/or passage approval letter. Additional Information/Remarks:								
Proposed POD Name or Number	Twp		Rng		Sec	¼	¼	Tax Lot, DLC, or Gov-Lot
N/A								
Type of Change (from Page 6): <input type="checkbox"/> POD or <input type="checkbox"/> APOD					From Authorized POD: <input type="checkbox"/> UPSTREAM or <input type="checkbox"/> DOWNSTREAM			
Measured Distances (from a recognized survey corner)								
Fish Screen Information:								
<input type="checkbox"/> Yes <input type="checkbox"/> No The proposed POD/APOD has an existing approved fish screen pursuant to ORS 540.525 or 540.532 If Yes , please, submit documentation of the approved fish screen with your application, such as any Oregon Department of Fish and Wildlife (ODFW) fish screening certification letter and/or passage approval letter. Additional Information/Remarks:								

**Part 4 of 4 continued – Permanent Water Right Transfer Application
Proposed POA/APOA Information – Groundwater Right(s) ONLY**

WATER RIGHT CERTIFICATE # 63792

Table 1B-GW - Location of Proposed Groundwater POA/APOA(s)

Proposed POA Name or Number	Twp	Rng	Sec	¼	¼	Tax Lot, DLC, or Gov-Lot
N/A						

Measured Distances (from a recognized survey corner) POA APOA

Well log attached and associated with the well described above **and** on the accompanying application map.
AND/OR

No well log is available - construction of the authorized well is provided in table below.

OWRD Well ID Tag No.	Total well depth	Casing Diameter	Casing Intervals (in feet)	Seal depth(s) (intervals)	Perforated or screened intervals (in feet)	Static water level of completed well (in feet)	Source aquifer (sand, gravel, basalt, etc.)	Well -specific rate if less than full rate of water right
L-								<input type="checkbox"/> CFS <input type="checkbox"/> GPM

Proposed POA Name or Number	Twp	Rng	Sec	¼	¼	Tax Lot, DLC, or Gov-Lot
N/A						

Measured Distances (from a recognized survey corner) POA APOA

Well log attached and associated with the well described above **and** on the accompanying application map.
AND/OR

No well log is available - construction of the authorized well is provided in table below.

OWRD Well ID Tag No.	Total well depth	Casing Diameter	Casing Intervals (in feet)	Seal depth(s) (intervals)	Perforated or screened intervals (in feet)	Static water level of completed well (in feet)	Source aquifer (sand, gravel, basalt, etc.)	Well -specific rate if less than full rate of water right
L-								<input type="checkbox"/> CFS <input type="checkbox"/> GPM

Proposed POA Name or Number	Twp	Rng	Sec	¼	¼	Tax Lot, DLC, or Gov-Lot
N/A						

Measured Distances (from a recognized survey corner) POA APOA

Well log attached and associated with the well described above **and** on the accompanying application map,
AND/OR

No well log is available - construction of the authorized well is provided in table below.

OWRD Well ID Tag No.	Total well depth	Casing Diameter	Casing Intervals (in feet)	Seal depth(s) (intervals)	Perforated or screened intervals (in feet)	Static water level of completed well (in feet)	Source aquifer (sand, gravel, basalt, etc.)	Well -specific rate if less than full rate of water right
L-								<input type="checkbox"/> CFS <input type="checkbox"/> GPM

14873 -



439-25-01131-ZON

07/15/2025

Land Use Compatibility

36-1W-07-100

ZONING: Exclusive Farm Use

RECORD NO: 439-25-01131-ZON

PROCESS: Type I Permit

PROJECT NAME: LUCS

ASSIGNED STAFF:

RECEIVED DATE: 07/15/2025

SITE ADDRESS: 0 AGATE RD

Owners

SOUTHERN OREGON TERRA INC
280 WORTHINGTON RD
EAGLE POINT, OR 97524-8562

Record Detail Description

OWRD Water Rights Transfer_Southern Oregon Terra Inc

Contacts

SOUTHERN OREGON TERRA INC
280 WORTHINGTON RDEAGLE POINT, OR 97524-8562

541-821-3107

Land Use Information Form



Oregon Water Resources Department
725 Summer Street NE, Suite A
Salem, Oregon 97301-1266
(503) 986-0900
www.oregon.gov/OWRD

NOTE TO APPLICANTS

In order for your application to be processed by the Oregon Water Resources Department (OWRD), this Land Use Information Form must be completed by a local government planning official in the jurisdiction(s) where your water right will be diverted, conveyed, used, and developed. The planning official may choose to complete the form while you wait or return the "Receipt Acknowledging Request for Land Use Information" to you. Applications received by OWRD without the Land Use Information Form, or the signed receipt, will be returned to you. **IMPORTANT:** Please note that while OWRD can accept a signed receipt as part of intake for an application for a new permit to use or store water, a completed Land Use Information Form is required for OWRD's acceptance of all other applications. Please be aware that your application cannot be approved without land use approval.

This form is **NOT** required if:

- 1) Water is to be diverted, conveyed, and used on federal lands only; **OR**
- 2) The application is for a water right transfer, allocation of conserved water, exchange, permit amendment, or ground water registration modification, and **all** of the following apply:
 - a. The existing and proposed water use is located entirely within lands zoned for exclusive farm-use or within an irrigation district;
 - b. The application involves a change in place of use only;
 - c. The change does not involve the placement or modification of structures, including but not limited to water diversion, impoundment, distribution facilities, water wells and well houses: **and**

NOTE TO LOCAL GOVERNMENTS

The person presenting the attached Land Use Information Form is applying for a new water right or modifying an existing water right. The Oregon Water Resources Department (OWRD) requires applicants to obtain land use information to ensure the water right does not result in land uses that are incompatible with your comprehensive plan. Please complete the form and return it to the applicant for inclusion in their application. **NOTE:** For new water right applications only, if you are unable to complete this form while the applicant waits, you may complete the "Receipt Acknowledging Request for Land Use Information" and return it to the applicant.

You will receive notice via OWRD's weekly Public Notice once the applicant formally submits their request to OWRD. The notice will give more information about OWRD's water right process and provide additional comment opportunities. If you previously only completed the receipt for an application for a new permit to use or store water, you will have 30 days from the Public Notice date to complete the Land Use Information Form and return it to OWRD. Your attention to this request for information is greatly appreciated. If you have questions concerning this form, please contact OWRD's Customer Service Group at 503-986-0900 or WRD_DL_customerservice@water.oregon.gov.

Land Use Information Form



Attachment 2: Land Use Information Form
Oregon Water Resources Department
 725 Summer Street NE, Suite A
 Salem, Oregon 97301-1266
 (503) 986-0900
 www.oregon.gov/OWRD

NAME <u>Southern Oregon Terra, Inc. – Contact: Ron Anderson</u>			PHONE <u>541-821-3107</u>
MAILING ADDRESS <u>280 Worthington Road</u>			
CITY <u>Eagle Point</u>	STATE <u>OR</u>	ZIP <u>97524</u>	EMAIL <u>None</u>

A. Land and Location

Please include the following information for all tax lots where water will be diverted (taken from its source), conveyed (transported), and/or used or developed. Applicants for municipal use, or irrigation uses within irrigation districts, may substitute existing and proposed service-area boundaries for the tax-lot information requested below.

Township	Range	Section	¼ ¼	Tax Lot #	Plan Designation (e.g., Rural Residential/RR-5)	Water to be:	Proposed Land Use:
36S	1W	6	SW/SW	501	EFU	Diverted and Conveyed	Diversion and conveyance only
36S	1W	7	NE/NW	100	EFU	Conveyed and Used	Farm

List all counties and cities where water is proposed to be diverted, conveyed, and/or used or developed:

Jackson County

NOTE: A separate Land Use Information Form must be completed and submitted for each county and city, as applicable.

B. Description of Proposed Use

Type of application to be filed with the Oregon Water Resources Department:

- Permit to Use or Store Water
 Water Right Transfer
 Permit Amendment or Ground Water Registration Modification
 Limited Water Use License
 Exchange of Water
 Allocation of Conserved Water

Source of water:
 Reservoir/Pond
 Ground Water
 Surface Water (name) Rogue River

Estimated quantity of water needed: 2
 cubic feet per second
 gallons per minute
 acre-feet

Intended use of water:
 Irrigation
 Commercial
 Industrial
 Domestic for _____ household(s)
 Municipal
 Quasi-Municipal
 Instream
 Other _____

Briefly describe:

We are applying for a water right transfer to move the point of diversion from the old river channel to the current bank of the Rogue River. The POD and canal are already in place and in use but need to be moved on the water right documents.

Note to applicant: For new water right applications only, if the Land Use Information Form cannot be completed while you wait, please have a local government representative sign the receipt on the bottom of page 4 and include it with the application filed with the Oregon Water Resources Department.

See Page 4 →

For Local Government Use Only

The following section must be completed by a planning official from each county and city listed unless the project will be located entirely within the city limits. In that case, only the city planning agency must complete this form. This deals only with the local land use plan. Do not include approval for activities such as building or grading permits.

Please check the appropriate box below and provide the requested information

- Land uses to be served by the proposed water use(s), including proposed construction, are allowed ~~outright~~ [&] or are not regulated by your comprehensive plan. Cite applicable ordinance section(s): _____
- Land uses to be served by the proposed water use(s), including proposed construction, involve discretionary land-use approvals as listed in the table below. (Please attach documentation of applicable land-use approvals which have already been obtained. Record of Action/land-use decision and accompanying findings are sufficient.) **If approvals have been obtained but all appeal periods have not ended, check "Being Pursued."**

Type of Land-Use Approval Needed (e.g., plan amendments, rezones, conditional-use permits, etc.)	Cite Most Significant, Applicable Plan Policies & Ordinance Section References	Land-Use Approval:	
	LDO TABLE 4.2-1(1)	<input checked="" type="checkbox"/> Obtained <input type="checkbox"/> Denied	<input type="checkbox"/> Being Pursued <input type="checkbox"/> Not Being Pursued
		<input type="checkbox"/> Obtained <input type="checkbox"/> Denied	<input type="checkbox"/> Being Pursued <input type="checkbox"/> Not Being Pursued
		<input type="checkbox"/> Obtained <input type="checkbox"/> Denied	<input type="checkbox"/> Being Pursued <input type="checkbox"/> Not Being Pursued
		<input type="checkbox"/> Obtained <input type="checkbox"/> Denied	<input type="checkbox"/> Being Pursued <input type="checkbox"/> Not Being Pursued

Local governments are invited to express special land use concerns or make recommendations to the Oregon Water Resources Department regarding this proposed use of water in the box below or on a separate sheet.

Name: KT WIRTH Title: PLANNER I
 Signature: [Handwritten Signature] Date: 07/15/2025
 Governmental Entity: JACKSON COUNTY Phone: 501-774-6945

Receipt Acknowledging Request for Land Use Information

Note to Local Government Representative:
 Please complete this form and return it to the applicant. **For new water right applications only**, if you are unable to complete this form while the applicant waits, you may complete this receipt and return it to the applicant. If you sign the receipt, you will have 30 days from the date of OWRD's Public Notice of the application to submit the completed Land Use Information Form to Oregon Water Resources Department. Please note while OWRD can accept a signed receipt as part of intake for an application for a new permit to use or store water, a completed Land Use Information Form is required for all other applications.

Applicant Name: _____

Staff Name: _____ Title: _____

Staff Signature: _____ Date: _____

Governmental Entity: _____ Phone: _____

Pump Capacity Calculation Sheet - POD 1

using Department designed formula:

$(hp)(\text{efficiency}) / (\text{lift} + \text{psi head}) = \text{capacity in cfs}$

Efficiency:

Centrifugal = 6.61

Turbine = 7.04

Data Entry (fill in underlined blanks)

HP = 50
Efficiency = 6.61
Lift = 80
PSI = 20

Results Calculated

$(hp)(\text{efficiency}) = 330.5$
Head based on psi = 50.8
Total dynamic head = 130.8
(head + lift)

Pump Capacity = 2.53 feet per second

Application for Water Right Transfer

Evidence of Use Affidavit



Oregon Water Resources Department
 725 Summer Street NE, Suite A
 Salem, Oregon 97301-1266
 (503) 986-0900
 www.wrd.state.or.us

Please print legibly or type. Be as specific as possible. Attach additional pages if you need more spacing. Supporting documentation must be attached.

State of Oregon)
) ss
 County of JACKSON)

I, RICK ANDERSON, in my capacity as PROPERTY OWNER,
 mailing address 374 HAMMEL ROAD, EAGLE POINT, OR 97524
 telephone number (541)601-8038, being first duly sworn depose and say:

1. My knowledge of the exercise or status of the water right is based on (check one):

- Personal observation Professional expertise

2. I attest that:

Water was used during the previous five years on the **entire** place of use for Certificate # 28391, 33730, 63748, 63792; **OR**

My knowledge is specific to the use of water at the following locations within the last five years:

Certificate #	Township	Range	Mer	Sec	¼ ¼	Gov't Lot or DLC	Acres (if applicable)

OR

- Confirming Certificate # _____ has been issued within the past five years; **OR**
- Part or all of the water right was leased instream at some time within the last five years. The instream lease number is: _____ (Note: If the entire right proposed for transfer was not leased, additional evidence of use is needed for the portion not leased instream.); **OR**
- The water right is not subject to forfeiture and documentation that a presumption of forfeiture for non-use would be rebutted under ORS 540.610(2) is attached.
- Water has been used at the actual current point of diversion or appropriation for more than 10 years for Certificate # _____ (For Historic POD/POA Transfers)

(continues on reverse side)

3. The water right was used for: (e.g., crops, pasture, etc.): PASTURE

4. I understand that if I do not attach one or more of the documents shown in the table below to support the above statements, my application will be considered incomplete.

Quik Anderson
Signature of Affiant

5-21-2026
Date

Signed and sworn to (or affirmed) before me this 21st day of May, 2026.

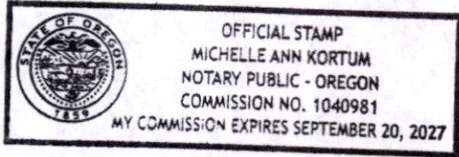

Michelle Kortum
Notary Public for Oregon

My Commission Expires: ~~9-20~~ 9-20-2027

Supporting Documents	Examples
<input type="checkbox"/> Copy of a water right certificate that has been issued within the last five years. (not a remaining right certificate)	Copy of confirming water right certificate that shows issue date
<input type="checkbox"/> Copies of receipts from sales of irrigated crops or for expenditures related to use of water	<ul style="list-style-type: none"> ● Power usage records for pumps associated with irrigation use ● Fertilizer or seed bills related to irrigated crops ● Farmers Co-op sales receipt
<input type="checkbox"/> Records such as FSA crop reports, irrigation district records, NRCS farm management plan, or records of other water suppliers	<ul style="list-style-type: none"> ● District assessment records for water delivered ● Crop reports submitted under a federal loan agreement ● Beneficial use reports from district ● IRS Farm Usage Deduction Report ● Agricultural Stabilization Plan ● CREP Report
<input checked="" type="checkbox"/> Aerial photos containing sufficient detail to establish location and date of photograph	<p>Multiple photos can be submitted to resolve different areas of a water right. If the photograph does not print with a "date stamp" or without the source being identified, the date of the photograph and source should be added.</p> <p>Sources for aerial photos: OSU – www.oregonexplorer.info/imagery OWRD – www.wrd.state.or.us Google Earth – earth.google.com TerraServer – www.terra-server.com</p>
<input type="checkbox"/> Approved Lease establishing beneficial use within the last 5 years	Copy of instream lease or lease number

e of use. Photo is Google Earth, dated 4/14/2023



14873 - =

Agate Rd

Copy of contact
forms sent to
B.O.R.



CONTRACT DATA SHEET



1. Applicant Information:

A. Landowners

- 1) Name of landowner(s): Southern Oregon Terra Inc.
- 2) Address: 10175 Aqate Road, Eagle Point, OR 97524
- 3) Mailing Address (if different): 374 Hammel Road, Eagle Point, OR 97524
- 4) Do you own all of the land where you propose to divert and make use of water? No

B. Water User Organizations (Such as Irrigation Districts, Ditch/Canal Companies, Water Control Districts, Water User Associations & Cooperatives, Irrigation Improvement Districts, and similar entities organized according to State Law)

- 1) Name of Organization: _____
- 2) Name & Title of Applicant: _____
- 3) Mailing Address of Organization: _____
- 4) Please provide the following information:
 - (a) A description of the area served by the organization (location, total acreage, # of water users, prominent crops, etc.)
 - (b) Copy of organization by-laws, articles of incorporation (if applicable), board resolution authorizing the applicant to represent and bind the organization under contract with the United States.

2. Source of Water (name of stream, river): Stored water in Lost Creek Reservoir via the Rogue River
3. Proposed point of diversion: 2350 feet West and 970 feet North of S1/4 corner of Section 6 36S Township, Range 1W, Willamette Meridian.
4. A water right permit to divert storage water is required. Application or file number with OWRD if you have applied for a permit to divert storage water: Certificate 63748
5. Include a map of lands and diversion points. **[Same as required by Oregon Water Resources Department (OWRD) for application for surface/ground water permit].**
6. Do you currently hold a right to natural flows for irrigating the property described herein?
 If yes, what is/are the priority date(s)? Yes, 8/27/1981
7. Total quantity of water from storage requested: 45.0 acre-feet.
8. Location of land to be irrigated in each 40-acre tract:

Township	Range	Section	40-Acre Tract (1/4) (1/4)	No. of Acres	Type of Irrigated Crop <small>Please note that Cannabis is not an authorized crop Under Reclamation's Contracting Program. See PEC P16</small>
36S	1W	6	NE/SE	6.4	Pasture Grass
36S	1W	6	NW/SE	7.2	Pasture Grass
36S	1W	6	SW/SE	8.4	Pasture Grass
36S	1W	6	SE/SE	0.7	Pasture Grass

Total number of Acres: 22.7



9. What is the present use of the land identified above? [farming; idle (fallow cultivated land); native (appears never to have been tilled, walked on, driven on); planted pasture or other (please specify)].

Planted Pasture

10. Is the land identified above currently being irrigated?
If yes, what is the source? (natural flows, wells, etc.)

Yes, natural flows from the Rogue River

11. Diversion must be screened to prevent uptake of fish and other aquatic life. Describe plan(s) to comply with State/Federal fish standards:

Install a state and federally approved fish screen.

12. Telephone number where you can be reached during the day: 541-601-8038

Sign and Date:

Quik Anderson

E-mail completed form and associated information to: jkelly@usbr.gov Any questions, please contact Joy Kelley at (986) 999-8984

Please send contract administration fee directly to: CPN Regional Office, Attn: CPN-6323, 1150 N. Curtis Road, Boise, ID 83706

Before returning the completed Contract Data Sheet to the address provided above, please check that you have done the following:

- ANSWERED ALL QUESTIONS COMPLETELY
- ATTACHED AND IDENTIFIED ADDITIONAL SHEET(S) AS NECESSARY
- ATTACHED THE REQUIRED MAP
- SUBMIT PAYMENT FOR THE APPROPRIATE CONTRACT ADMINISTRATION FEE 1., MAKE CHECK PAYABLE TO THE U.S. BUREAU OF RECLAMATION

¹The minimum contract administration fee for most applications is \$100. However, from time to time this fee may be revised to cover the costs of the United States. We recommend you contact this office to verify the current minimum contract administration fee. In the event that the costs to the United States of evaluating the application are in excess of the minimum contract administration fee, an estimate of the reimbursable costs for which advance payment is required will be provided to the applicant.



REQUEST FOR TAX IDENTIFICATION NUMBER



Section 1: General Information

IN ACCORDANCE with the Debt Collection Improvement Act of 1996 (Pub.L. 104-134), you are required to provide your tax identification number. This number will be used to make payments (refunds), or to collect and report any delinquent amounts that arise out of your relationship with the Federal Government. Please complete and return this form to the Bureau of Reclamation.

Section 2: Indicate your status

- Corporation
 City/State Government
 Individual
 Partnership
 Federal Government
 Other (Specify): _____

Section 3: Personal Information

Social Security Number:

____ - ____ - _____
xxx - xx - xxxxx

Business Tax Identification Number:

93 - 0384791
xx - xxxxxxxx

Print Full Name: Southern Oregon Terra Inc. Telephone: 541-601-8038 Email: none

Mailing Address: 374 Hammel Road City: Eagle Point State: OR Zip: 97524

Signature: *Geik Anderson*

Section 4: Fax or mail completed form to the Bureau of Reclamation

Fax: 208-378-5381

Mail: Bureau of Reclamation, CPN Regional Office, Attn: CPN-4119, 1150 N. Curtis Road, Boise, ID 83706

Section 5: For Official Use Only

U.S. Bureau of Reclamation Contract No: _____ Contract Description: _____

Privacy Act Statement

Pursuant to 5 U.S.C. 552(e)(3), enacted into law by section 3 of the Privacy Act of 1974 (Pub.L.93-579), the information below is pertinent to individuals who provide information to the Bureau of Reclamation. This information is maintained in a system of records designated and described at 74 Federal Register 596 (January 6, 2009), or the most recent Federal Register publication.

- 1) PRINCIPLE PURPOSE:** To obtain a tax identification number or social security number to enable the Bureau of Reclamation to process payments or collect and report delinquent debts.
- 2) ROUTINE USES:** Information from this form may be transmitted to debt collection contractors, or Federal agencies for collecting debts (or collection action on such debts), or Treasury on past-due nontax debts for the purpose of locating the debtor and/or effecting offset under Treasury Offset Program. Information may be publically disseminated regarding the identity of delinquent nontax debtors and the existence of nontax debts under the provisions of the Debt Collections Improvement Act of 1996.
- 3) MANDATORY DISCLOSURE:** It is mandatory that you provide the requested information pursuant to the Debt Collection Improvement Act of 1996 (Pub.L. 104-134). If you do not provide the requested information, the Bureau of Reclamation may no longer conduct business with you; all contracts, licenses, permits or agreements will cease and be terminated.
- 4) AUTHORITY:** 5 U.S.C. 552a; 5 U.S.C. 5514; 15 U.S.C. 1681; 26 U.S.C. 6103(m)(2); 31 U.S.C. 37, subchapters I and II; 31 U.S.C. 3701(a)(3); 31 U.S.C. 3711; 31 U.S.C. 3716; 31 U.S.C. 3717; 31 U.S.C. 3718; 31 U.S.C. 3720; 42 U.S.C. 2201; 42 U.S.C. 5841; Cash Management Improvement Act Amendments of 1992 (Pub.L. 102-589); Debt Collection Improvement Act of 1996 (Pub.L. 104-134); 31 CFR Chapter IX, Parts 900-904; 10 CFR Parts 15, 16, 170, 171; Executive Order (E.O.) 9397, as amended by E.O. 13478; E.O. 12101; and E.O. 12731.

MAP FOR B.O.R. CONTRACT DATA SHEET

EXISTING PLACE OF USE AND NEW POINT OF DIVERSION
 CERTIFICATE:
 63748 - PRIORITY DATE: AUGUST 27, 1981
 FOR
 SOUTHERN OREGON TERRA, INC.
 10175 AGATE ROAD, EAGLE POINT, OREGON
 SITUATED IN
 SECTION 6 & 7, TOWNSHIP 36 SOUTH, RANGE 1 WEST, W.M.
 JACKSON COUNTY, OREGON

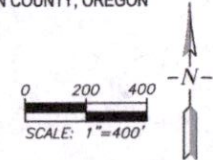

This map is not intended to provide legal dimensions or locations of property ownership lines.

EHM-May 20, 2026



RENEWS: 12/31/2026

ROGUE CIVIL LLC
 emalepsy@roguecivil.com 541-621-2868

LEGEND

- POD 1 (POINT OF DIVERSION PER CERTIFICATE 63748)
 500' SOUTH & 390' WEST FROM NE CORNER SECTION 7
- POD 2 (NEW POINT OF DIVERSION FOR CERTIFICATE 63748)
 2350' WEST & 970' NORTH FROM S $\frac{1}{4}$ CORNER OF SECTION 6
- PLACE OF USE (IRRIGATION)
- - - 1/4-1/4 SECTION LINE
- - - - EDGE OF WATER/WATERLINE (APPROXIMATE)

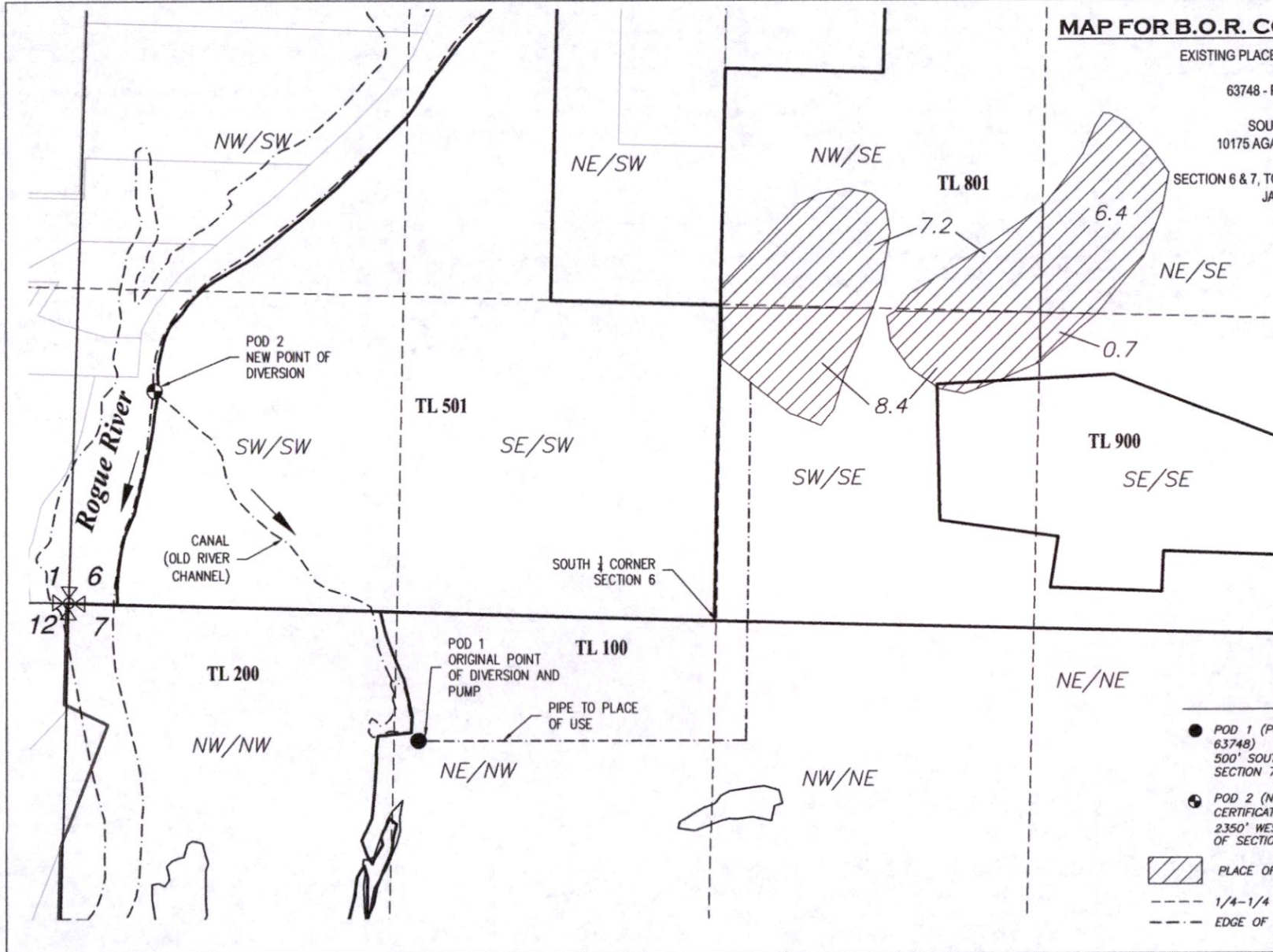

Re: Lost Creek Rogue Re: [EXTERNAL] FW: Case #2513009NOV - Ron Anderson

From Evan Malepsy <emalepsy@roguecivil.com>
Date Thu 5/21/2026 3:18 PM
To Kelley, Joyclyn M <jkelley@usbr.gov>
Cc CONNER Hailey K * WRD <Hailey.K.CONNER@water.oregon.gov>

1 attachment (6 MB)
Contract Data Sheet - Anderson - 05.21.26.pdf;

Hi Joy,

Here's the signed contract data sheet, map, and tax ID form. Please send the offer of contract.

Thanks,

Evan Malepsy, PE CWRE
541-621-2868
emalepsy@roguecivil.com

ROGUE CIVIL LLC

Civil Engineering
Water Rights

From: Kelley, Joyclyn M <jkelley@usbr.gov>
Sent: Thursday, May 21, 2026 5:22 AM
To: Evan Malepsy <emalepsy@roguecivil.com>
Cc: CONNER Hailey K * WRD <Hailey.K.CONNER@water.oregon.gov>
Subject: Re: Lost Creek Rogue Re: [EXTERNAL] FW: Case #2513009NOV - Ron Anderson

Hi, Evan

Thank you for making those edits. Please have Mr. Anderson sign. Once signed, it's ok if you want to email back to me. We can request funds when we send out the offer of contract. We will also need a Tax Identification for southern Oregon Terra Inc. I am including the form.

Respectfully,

Joy M. Kelley, CPN-6323
Repayment Specialist, Reclamation Law Administration
Columbia-Pacific Northwest Region
Bureau of Reclamation

1150 Curtis Road
Boise, Idaho 83706

Remote Direct Phone Number 986-999-8984



From: Evan Malepsy <emalepsy@roguecivil.com>
Sent: Wednesday, May 20, 2026 5:18 PM
To: Kelley, Joyclyn M <jkelley@usbr.gov>
Cc: CONNER Hailey K * WRD <Hailey.K.CONNER@water.oregon.gov>
Subject: Re: Lost Creek Rogue Re: [EXTERNAL] FW: Case #2513009NOV - Ron Anderson

Thanks for the comments Joy. Here's a revised data sheet. Please review and let me know if it looks ok. If so, I'll get Rick to sign it again.

Yes, the POD is changing from the original (not an additional POD). We have not submitted the application to change the POD to the State yet. We needed to get this contract figured out before they would accept it. That application is ready to submit as soon as I can include a copy of this contract data sheet with it.

Thanks,

Evan Malepsy, PE CWRE
541-621-2868
emalepsy@roguecivil.com

ROGUE CIVIL LLC
Civil Engineering
Water Rights

From: Kelley, Joyclyn M <jkelley@usbr.gov>
Sent: Wednesday, May 20, 2026 8:51 AM
To: Evan Malepsy <emalepsy@roguecivil.com>
Cc: CONNER Hailey K * WRD <Hailey.K.CONNER@water.oregon.gov>
Subject: Re: Lost Creek Rogue Re: [EXTERNAL] FW: Case #2513009NOV - Ron Anderson

Hi, Evan

A couple edits for you:

Please edit the contract data sheet..... when looking at the Jackson County Property Records, the landowner is Southern Oregon Terra Inc., which Mr. Anderson is the Registered Agent. Southern Oregon Terra Inc. should be the

contractor and Mr. Anderson would be signing the contract. We contract with the landowners.

Also, county records reflect the situs address of the property is: 10175 Agate Road, Eagle Point, which would need to be changed on the Contract data sheet as well. The mailing address can be left as is, if that is where Mr. Anderson receives the mail.

Reclamation is now charging actual time for the contract development. If the \$100 check is sent in, we will apply that towards the total amount and request that at the time of the offer of contract.

If I am understanding the map you provided, the POD is changing from the original (expired, 1981 contract) No. 1-07-10-W0410, OR will this POD be in addition to the original POD?

Also, have you submitted the change of POD with OWRD? I was not able to find that in the information on the 'scanned documents' portion of the Certificate No. 63748.

Joy M. Kelley, CPN-6323
Repayment Specialist, Reclamation Law Administration
Columbia-Pacific Northwest Region
Bureau of Reclamation
1150 Curtis Road
Boise, Idaho 83706

Remote Direct Phone Number 986-999-8984



From: Evan Malepsy <emalepsy@roguecivil.com>

Sent: Tuesday, May 19, 2026 5:42 PM

To: Kelley, Joyclyn M <jkelley@usbr.gov>

Cc: CONNER Hailey K * WRD <Hailey.K.CONNER@water.oregon.gov>

Subject: Re: Lost Creek Rogue Re: [EXTERNAL] FW: Case #2513009NOV - Ron Anderson

Hi Joy,

Here's the contract data sheet and map for Rick Anderson. Please review and let me know if any changes are needed before I put it in the mail.

Recall that this contract is associated with an existing water right certificate that we are trying to move the point of diversion.

Thanks,

Evan Malepsy, PE CWRE
541-621-2868

14873 -

emalepsy@roguecivil.com

ROGUE CIVIL LLC

Civil Engineering
Water Rights

From: Kelley, Joyclyn M <jkelley@usbr.gov>
Sent: Wednesday, May 13, 2026 7:02 AM
To: Evan Malepsy <emalepsy@roguecivil.com>
Cc: CONNER Hailey K * WRD <Hailey.K.CONNER@water.oregon.gov>
Subject: Re: Lost Creek Rogue Re: [EXTERNAL] FW: Case #2513009NOV - Ron Anderson

Hi, Evan
Please use the attached contract data sheet.

Joy M. Kelley, CPN-6323
Repayment Specialist, Reclamation Law Administration
Columbia-Pacific Northwest Region
Bureau of Reclamation
1150 Curtis Road
Boise, Idaho 83706

Remote Direct Phone Number 986-999-8984



From: Evan Malepsy <emalepsy@roguecivil.com>
Sent: Tuesday, May 12, 2026 11:10 AM
To: Kelley, Joyclyn M <jkelley@usbr.gov>
Cc: CONNER Hailey K * WRD <Hailey.K.CONNER@water.oregon.gov>
Subject: Re: Lost Creek Rogue Re: [EXTERNAL] FW: Case #2513009NOV - Ron Anderson

Hi Joy,

Can you please let me know if the attached form is the correct one to use for a new contract? And, what else is required to complete the process?

Our local watermaster has given us a deadline of June 5th to complete this work, so we are hoping to get it moving quickly.

Thanks,

Evan Malepsy, PE CWRE
541-621-2868

emalepsy@roguecivil.com

ROGUE CIVIL LLC

Civil Engineering
Water Rights

From: Evan Malepsy <emalepsy@roguecivil.com>
Sent: Wednesday, May 6, 2026 11:29 AM
To: McGarry, Elizabeth G <EMcgarry@usbr.gov>
Cc: Kelley, Joyclyn M <jkelley@usbr.gov>; CONNER Hailey K * WRD <Hailey.K.CONNER@water.oregon.gov>; MONTIEL-GOMEZ Hilda * WRD <Hilda.MONTIEL-GOMEZ@water.oregon.gov>; HAYNES Shavon L * WRD <shavon.l.haynes@water.oregon.gov>
Subject: Re: Lost Creek Rogue Re: [EXTERNAL] FW: Case #2513009NOV - Ron Anderson

Hi Gail,

Please send the applicable contract forms and I will work with the Anderson's to get them completed.

Thanks,

Evan Malepsy, PE CWRE
541-621-2868
emalepsy@roguecivil.com

ROGUE CIVIL LLC

Civil Engineering
Water Rights

From: HAYNES Shavon L * WRD <shavon.l.haynes@water.oregon.gov>
Sent: Monday, April 27, 2026 3:38 PM
To: McGarry, Elizabeth G <EMcgarry@usbr.gov>; emalepsy@roguecivil.com <emalepsy@roguecivil.com>; MONTIEL-GOMEZ Hilda * WRD <Hilda.MONTIEL-GOMEZ@water.oregon.gov>
Cc: Kelley, Joyclyn M <jkelley@usbr.gov>; CONNER Hailey K * WRD <Hailey.K.CONNER@water.oregon.gov>
Subject: RE: Lost Creek Rogue Re: [EXTERNAL] FW: Case #2513009NOV - Ron Anderson

Gail,

Thank you for the update. I am assuming that Evan Malepsy will be assisting the applicant on getting an updated USBR water contract.

Evan...please keep Hailey involved with updates pertaining to this process.

[Shavon Haynes \(him/his\)](#)

District 13 Watermaster – Field Services
10 S. Oakdale, Room 309a Medford, Oregon 97501 | Phone (w) 541-774-6883 (c) 541-218-5125
Integrity | Service | Technical Excellence | Teamwork | Forward-Looking

From: McGarry, Elizabeth G <EMcgarry@usbr.gov>
Sent: Monday, April 27, 2026 9:27 AM
To: emalepsy@roguecivil.com; MONTIEL-GOMEZ Hilda * WRD <hilda.montiel-gomez@water.oregon.gov>;

HAYNES Shavon L * WRD <shavon.l.haynes@water.oregon.gov>

Cc: Kelley, Joyclyn M <jkelley@usbr.gov>

Subject: Lost Creek Rogue Re: [EXTERNAL] FW: Case #2513009NOV - Ron Anderson

You don't often get email from emcgarry@usbr.gov. [Learn why this is important](#)

The existing contract expired 1-07-10-W0410
from 1981 has expired.

Reclamation will need to work with applicant to develop a new contract with POU or POD.
Contract Joy Kelly to work on this. Reclamation would not be able sign off on a water right
transfer until the environmental compliance is completed for the new contract with new POD or
POU.

E. Gail McGarry, P.E.

208-378-5306

Program Manager, Reclamation Law Administration

Columbia-Pacific Northwest Region, Bureau of Reclamation

Attention: CPN-6300

1150 N. Curtis Rd.

Boise, ID 83706

From: Kelley, Joyclyn M <jkelley@usbr.gov>

Sent: Monday, April 27, 2026 9:56 AM

To: McGarry, Elizabeth G <EMcgarry@usbr.gov>

Subject: Fw: [EXTERNAL] FW: Case #2513009NOV - Ron Anderson

This is what OWRD sent to me last week

Joy M. Kelley, CPN-6323

Repayment Specialist, Reclamation Law Administration

Columbia-Pacific Northwest Region

Bureau of Reclamation

1150 Curtis Road

Boise, Idaho 83706

Remote Direct Phone Number 986-999-8984



From: HAYNES Shavon L * WRD <Shavon.L.HAYNES@water.oregon.gov>

Sent: Monday, April 20, 2026 4:38 PM

To: Kelley, Joyclyn M <jkelley@usbr.gov>

Subject: [EXTERNAL] FW: Case #2513009NOV - Ron Anderson

This email has been received from outside of DOI - Use caution before clicking on links, opening attachments, or responding.

Fyi....

[Shavon Haynes \(him/his\)](#)

District 13 Watermaster – Field Services

10 S. Oakdale, Room 309a Medford, Oregon 97501 | Phone (w) 541-774-6883 (c) 541-218-5125

[Integrity](#) | [Service](#) | [Technical Excellence](#) | [Teamwork](#) | [Forward-Looking](#)

From: Evan Malepsy <emalepsy@roguecivil.com>

Sent: Monday, August 11, 2025 1:16 PM

To: MONTIEL-GOMEZ Hilda * WRD <hilda.montiel-gomez@water.oregon.gov>

Cc: HAYNES Shavon L * WRD <Shavon.L.HAYNES@water.oregon.gov>

Subject: Case #2513009NOV - Ron Anderson

Hi Hilda,

I am assisting Ron Anderson with his transfer application. Ron forwarded your letter (attached) to me for review. I wanted to provide the attached application and supporting documents to show that we have been working to get into compliance. At this point, the application is ready for submittal with the exception that we are waiting for review of Supplemental Form D by the Bureau of Reclamation. Initially it was not clear if their review was necessary, but we were informed that it is, see attached BOR Email. This has led to a delay in the submittal.

So, we can go ahead and submit the application without the Supplemental Form D or wait until their review is complete. Please advise how we should proceed.

Please confirm you received this email.

Thanks,

Evan Malepsy, PE CWRE

541-621-2868

emalepsy@roguecivil.com

ROGUE CIVIL LLC

Civil Engineering

Water Rights