

G-9322

35323

RECORDED
JAN 3 1987

T. 4 N. R. 29 E. W. M.

J.Y.



SCALE: 1"=1320'

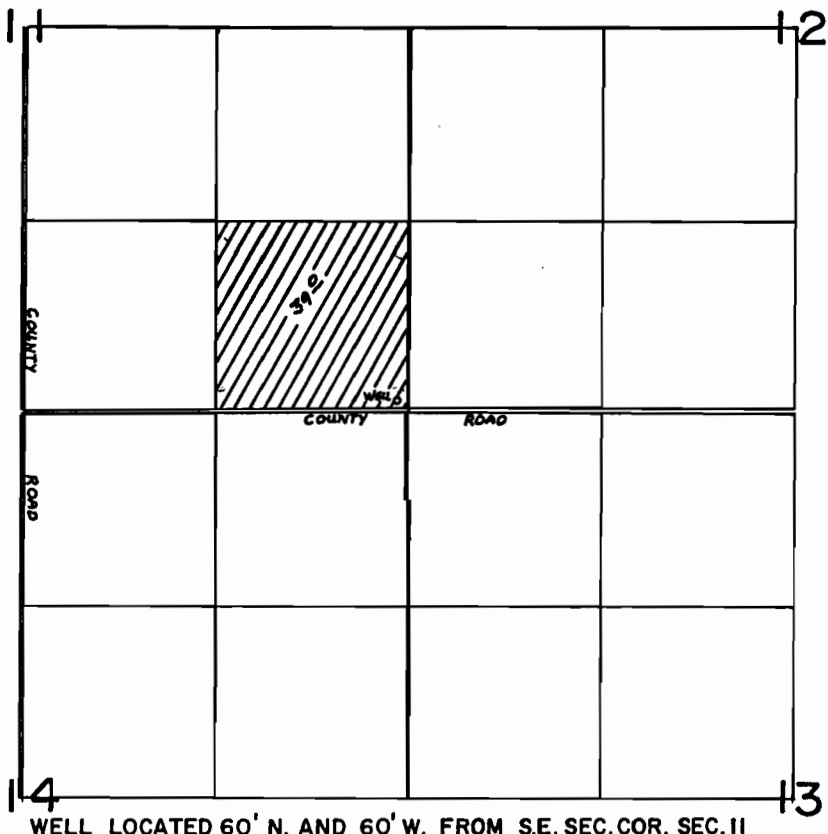

WELL LOCATED 60' N. AND 60' W. FROM S.E. SEC. COR. SEC. 11

FINAL PROOF SURVEY UNDER

Application No. G-10236 Permit No. G-9322.....
IN NAME OF

.....MILLS MINT FARM INC.....

Surveyed JAN. 28... 1985... by Y.L. CHURCH.....