

STATE OF OREGON

COUNTY OF UMATILLA

CERTIFICATE OF WATER RIGHT

This is to certify, That MILLS MINT FARM, INC.

of Route 1, Box 84, Stanfield, State of OR 97875, has made proof to the satisfaction of the Water Resources Director, of a right to the use of the waters of a well

a tributary of Cold Springs Canyon (Umatilla Basin) for the purpose of supplemental irrigation of 39.0 acres

under Permit No. G-9322 and that said right to the use of said waters has been perfected in accordance with the laws of Oregon; that the priority of the right hereby confirmed dates from March 30, 1981 that the amount of water to which such right is entitled and hereby confirmed, for the purposes aforesaid, is limited to an amount actually beneficially used for said purposes, and shall not exceed 0.49 cubic foot per second

or its equivalent in case of rotation, measured at the point of diversion from the well. The well is located in the SE 1/4 SE 1/4, Section 11, T4N, R29E, WM; 60 feet North and 60 feet West from SE corner Section 11.

The amount of water used for irrigation, together with the amount secured under any other right existing for the same lands, shall be limited to one-eightieth of one cubic foot per second per acre, or its equivalent for each acre irrigated and shall be further limited to a diversion of not to exceed 3.0 acre-feet per acre for each acre irrigated during the irrigation season of each year,

and shall conform to such reasonable rotation system as may be ordered by the proper state officer. A description of the place of use under the right hereby confirmed, and to which such right is appurtenant, is as follows:

39.0 acres SE 1/4 SE 1/4 Section 11 Township 4 North, Range 29 East, WM -> 4.0 ac. WILL NOT BE USED IN 2007

PORTIONS of THESE RIGHTS WILL NOT BE USED DURING 2007 SEASONS

the water for the purposes aforesaid is restricted to the lands or place of use herein

WITNESS the signature of the Water Resources Director, affixed

this date. December 19, 1986

/s/ William H. Young

Water Resources Director

T. 4 N. R. 29 E. W. M.

RECEIVED
JAN 3 1987
BY



SCALE: 1"=1320'

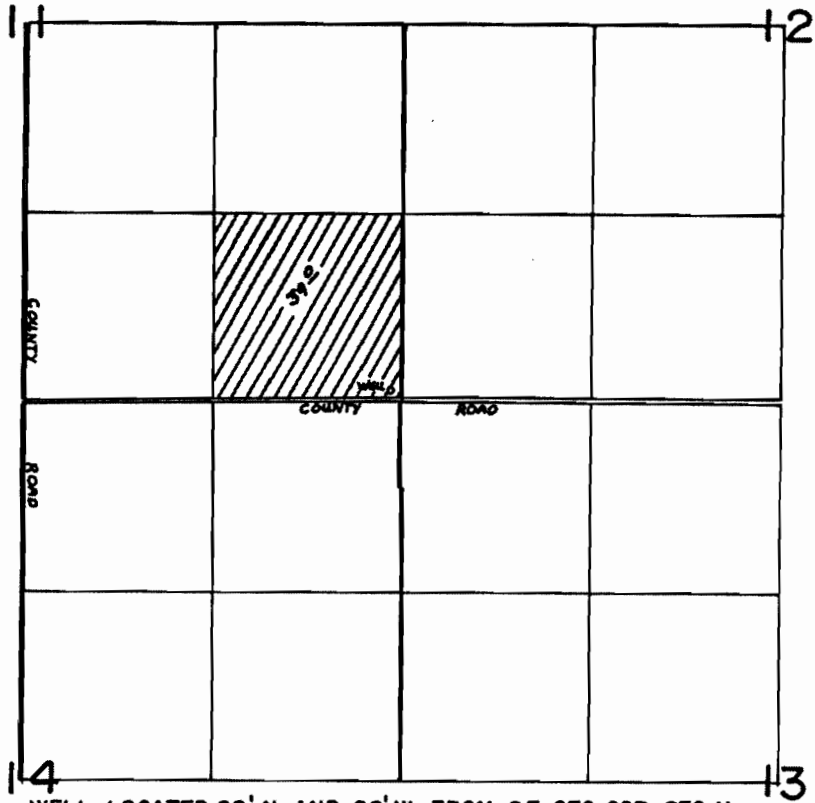

FINAL PROOF SURVEY
UNDER

Application No. G-10236 Permit No. G-9322.....
IN NAME OF

.....MILLS MINT FARM INC.....

Surveyed JAN. 28.... 1985., by Y.L. CHURCH.....