

T. 7 S. R. 19 E. W. M.

6

■ AREA IRRIGATED  
 IN 2002  
 HALF OF field  
 planted to  
 WILDLIFE SEED  
 mix in spring  
 and irrigated  
 through Sept.  
 HALF planted  
 to winter  
 wheat in  
 early Sept &  
 irrigated once.

G. W. W.

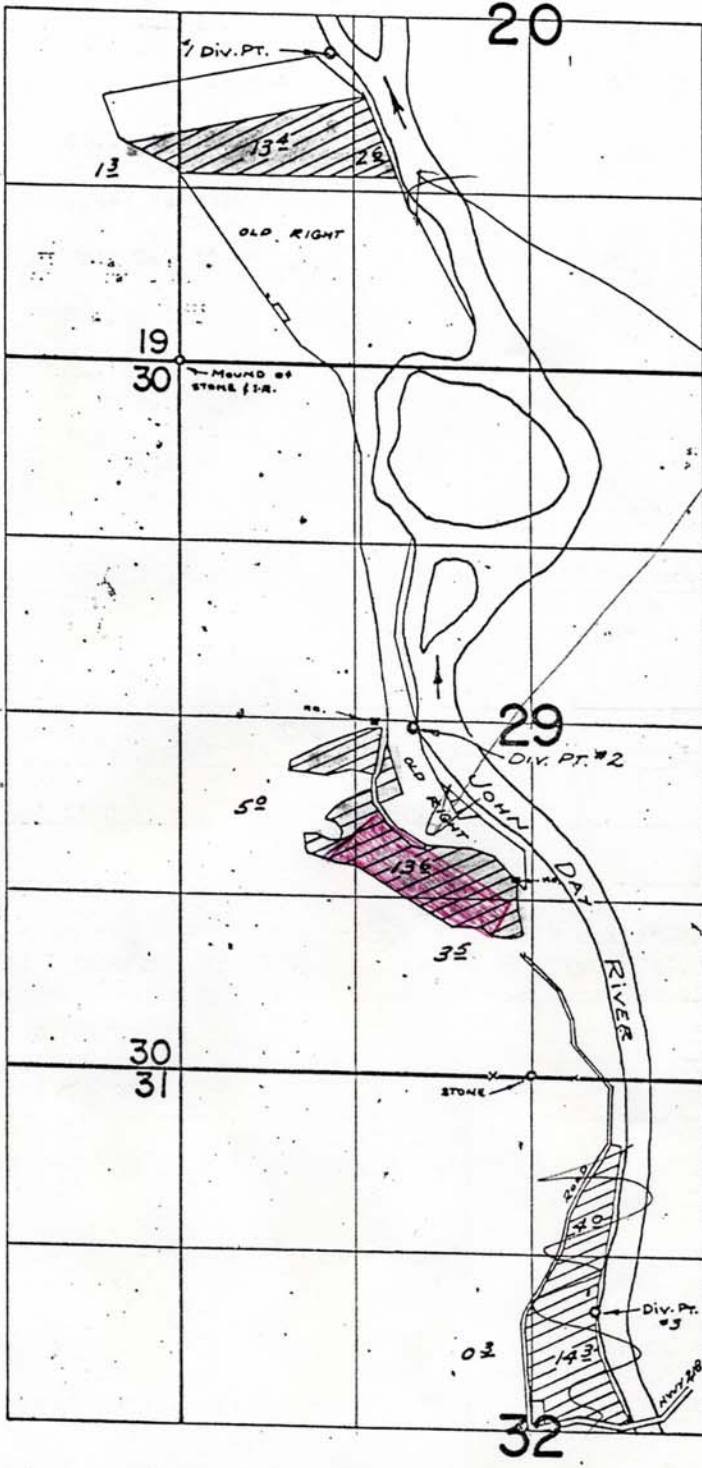

Horseshoe

FINAL PROOF SURVEY

UNDER

Application No. 33448 Permit No. 26435

IN NAME OF

FRANK T. & EDNA JUNE THOMPSON