

26435

T.7S.R.19E.W.M.

6

 AREA  
 irrig. IN 2005  
 HALF irrig &  
 planted to  
 native grasses  
 and wildlife  
 mix.  
 HALF summer  
 fallowed  
 G. Wm

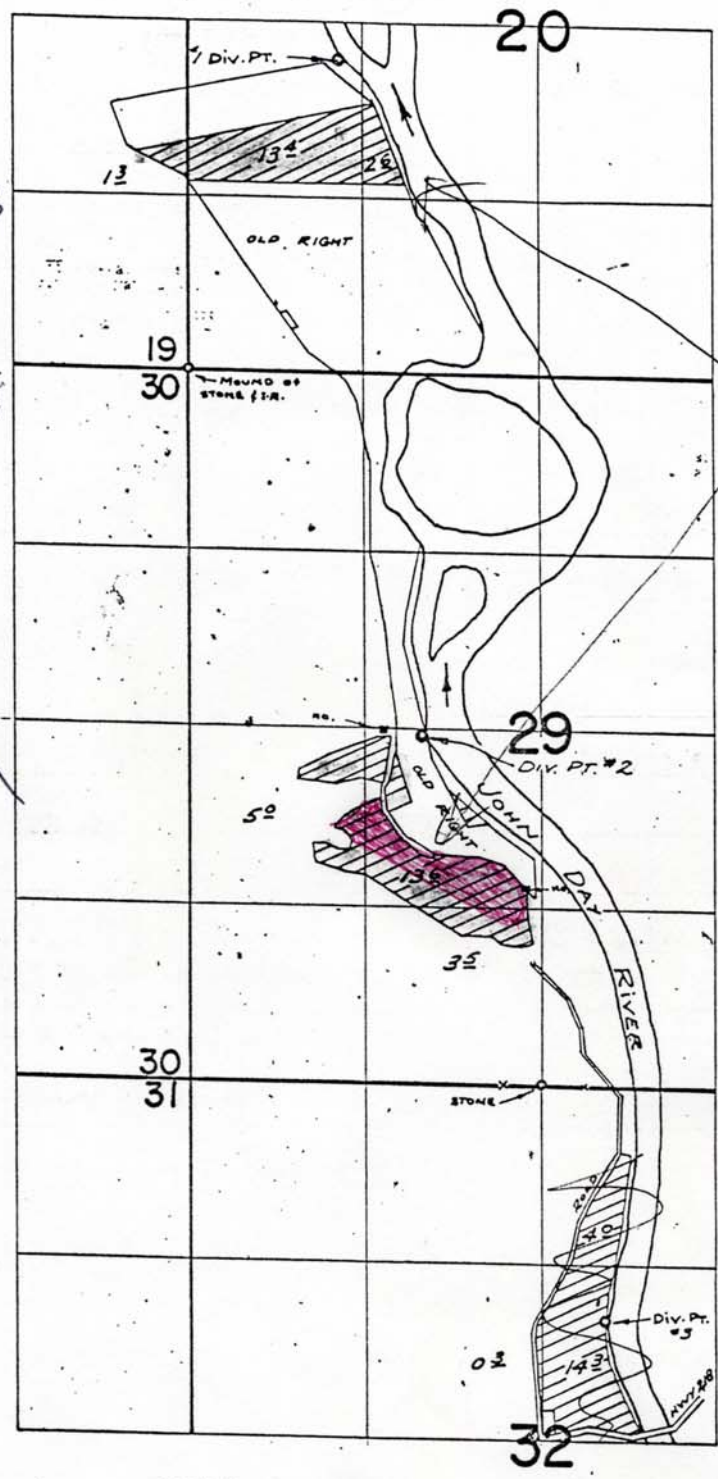

FINAL PROOF SURVEY

UNDER

Application No. 32448 Permit No. 26435

IN NAME OF

FRANK T. & EDNA JUNE THOMPSON