

# T. 7 S. R. 19 E. W. M.

6

■ AREAS irrig. IN 2001

SITE #1, PLANTED TO NATIVE GRASSES & LOCALLY ADAPTED SPECIES.

PLANTED 5-22-01 DATES RECORDED AS WATERED:

5-23

6-6

6-13<sup>TH</sup> 14<sup>TH</sup>

6-19<sup>TH</sup> 21<sup>ST</sup>

7-2<sup>ND</sup> - 3<sup>RD</sup>

PLUS OTHER DATES THROUGH SEPT. BUT NOT RECORDED

SITE #2

PLANTED TO A WHEAT-BARLEY RYE GRAIN MIX AND WATERED TO SEPT.

G. C. King

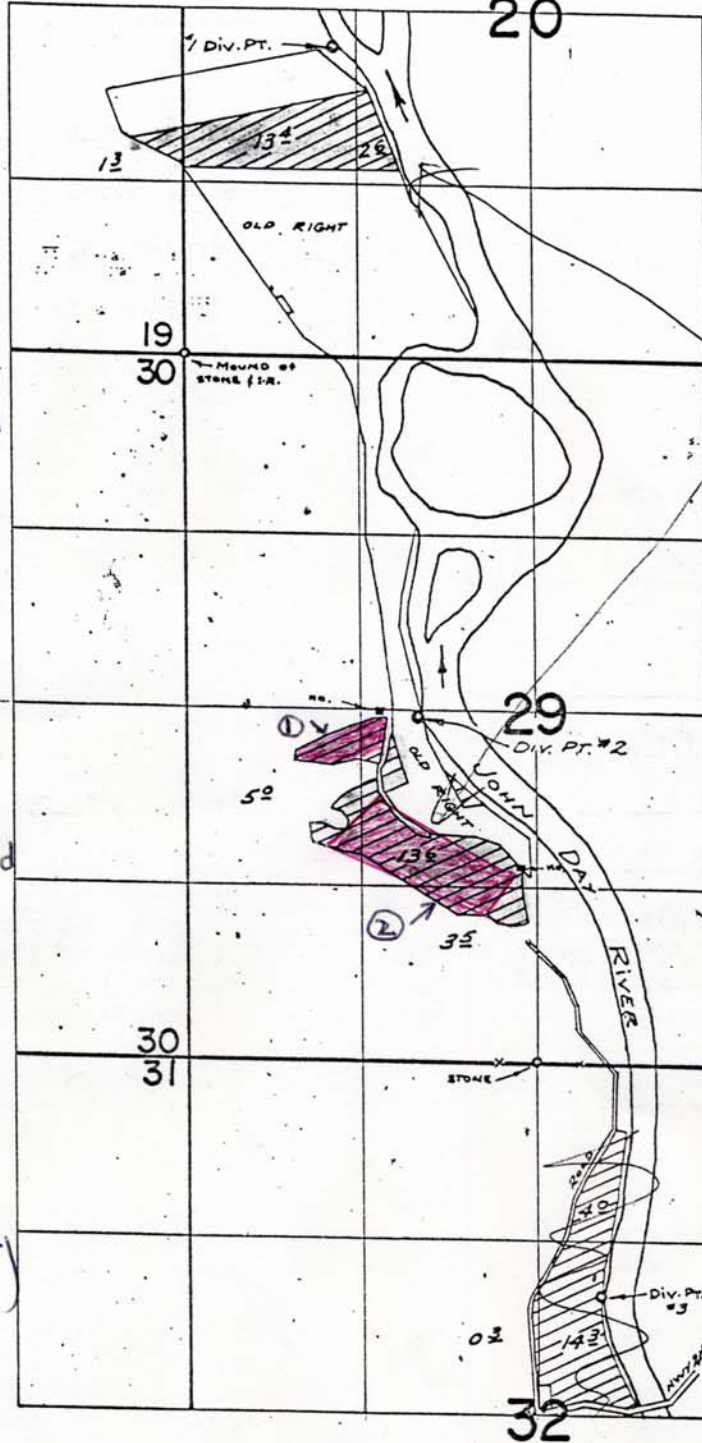

## FINAL PROOF SURVEY

UNDER

Application No. 32448 Permit No. 26435

IN NAME OF

FRANK T. & EDNA JUNE THOMPSON