



State of Oregon
Water Resources Department
725 Summer Street NE, Suite A
Salem, Oregon 97301-1266
(503) 986-0900

Application for Instream Lease

A summary of review criteria and procedures that are generally applicable to these applications is available at www.wrd.state.or.us/OWRD/PUBS/forms.shtml.

Pursuant to ORS 537.348(2) and OAR 690-077

Optional Identification by Lessor/Lessee: _____
Lease Application Number (assigned by WRD): L-605

This Lease is between:

Lessor #1:

Name Shotgun Ranch, LLC by Cal Cannon
Mailing address 2730 NW Nightfall Circle
City, State, Zip Code Bend, OR 97701
Telephone number (541) 480-6000
Email address _____

Lessor #2, 3, etc.

The water right to be leased is located in Creek County.

Lessee (if different than Oregon Water Resources Department):

Name _____
Mailing address _____
City, State, Zip Code _____
Telephone number _____
Email address _____

Trustee:

Oregon Water Resources Department
725 Summer Street NE, Suite A
Salem, OR 97301-1266
(503) 986-0900

~I~ Water Right Holder and Water Right Information

- 1.1 Lessor #1 is the water right holder, or authorized agent for water right holder of the property located at: Township 17 S Range 20 E, Sections 5 & 6 and Tax Lot number 800 & 901. If the water right appurtenant to these lands is also appurtenant to lands owned by others who are not included in this application, then Attachment 1 (tax lot map), needs to be included.

RECEIVED

MAR 09 2007

1.2 Lessor #2 is the (Check one):

Not applicable

Official representative of _____, the irrigation district which conveys water to the subject water rights.

Another party with an interest in the subject water rights representing _____.

1.3 For the water right(s) being leased, list all water rights appurtenant to the same lands. Indicate if there are any supplemental or overlying rights.

Certificate No. 596, 37627 & 47692

1.4 Are some or all of the lands being leased part of a Conservation Reserve Enhancement Program. Yes No

1.5 Water Rights Proposed to be Leased Instream.

The first right to be leased identified in Section 1.3 is further described as follows:

Certificate No.: 596

Priority date: 1885 Type of use: irrigation

Legal Season of Use: Feb 1 to Dec 1

Is the entire water right certificate being leased? Yes No

If no, list the acres of the subject water right by legal description of township, range, section, and 1/4 1/4 which will be dried up as part of this lease, and include a map (Attachment 2) showing the lands which will not receive water.

Place of use: T ____, R ____, Section __, 1/4 1/4 - ____ acres to be leased
Enter additional places of use here, using format above:

Page ____ (Identify page number of certificate, if certificate is greater than 10 pages.)

Number of acres being leased, if for irrigation: 710

Acre-feet of storage, if applicable: _____

Maximum rate associated with the right to be leased (cfs): 0.89

(Use additional lines if there is more than one rate associated with the water right.)

Maximum duty associated with the right to be leased (ac-ft): 2841

(Use additional lines if there is more than one duty associated with the water right.)

Conditions or other limitations, if any: _____

If you need to enter another leased right, please use the additional water rights form.

1.6 **Validity of rights.** Lessor(s) attests (mark one) that:

the water has been used over the past five years according to the terms and conditions of the water right certificate or as an instream water right or

the water has not been used over the past five years according to the terms and conditions of the water right certificate, however the water right is not subject to forfeiture under ORS 540.610(2)()(include necessary supporting documentation as Attachment 3).

1.5a **Water Rights Proposed to be Leased Instream.**

The ~~first~~^{2nd} right to be leased identified in Section 1.3 is further described as follows:

Certificate No.: 37627

Priority date: 6/1/10 Type of use: irrigation

Legal Season of Use: Feb 1 - Dec 1

Is the entire water right certificate being leased? Yes No

T17S, R20E Sec 6	NE NE	83	acres
	NW NE	151	
	SW NE	03	
	SE NE	50	
	NENW	71	

(NWNW 160 supplemental to C-596)

Number of acres being leased, if for irrigation: 363

Acre-feet of storage, if applicable: _____

Maximum rate associated with the right to be leased (cfs): 0.45

(Use additional lines if there is more than one rate associated with the water right.)

Maximum duty associated with the right to be leased (ac-ft): 1453

(Use additional lines if there is more than one duty associated with the water right.)

Conditions or other limitations, if any: _____

If you need to enter another leased right, please use the additional water rights form.

1.5b **Water Rights Proposed to be Leased Instream.**

The ~~first~~^{3rd} right to be leased identified in Section 1.3 is further described as follows:

Certificate No.: 47692

Priority date: 6/1/10 Type of use: irrigation

Legal Season of Use: Feb 1 - Dec 1

Is the entire water right certificate being leased? Yes No

T17S, R20E Sec 5	NW NE	20	acres
	NE NW	200	
	NWNW	135	

Number of acres being leased, if for irrigation: 355

Acre-feet of storage, if applicable: _____

Maximum rate associated with the right to be leased (cfs): 0.44

(Use additional lines if there is more than one rate associated with the water right.)

Maximum duty associated with the right to be leased (ac-ft): 1420

(Use additional lines if there is more than one duty associated with the water right.)

Conditions or other limitations, if any: _____

If you need to enter another leased right, please use the additional water rights form.

RECEIVED

MAR 09 2007

WATER RESOURCES DEPT
SALEM, OREGON

~II~ Instream Water Right Information

2.1 Public use. This lease will increase streamflows that will benefit:

- Conservation, maintenance and enhancement of aquatic and fish life, wildlife, and fish and wildlife habitat
- Pollution abatement
- Recreation and scenic attraction

2.2 Instream use created by lease. The instream use to be created is described as follows:

Crooked River Deschutes R.
Tributary to Deschutes in the Deschutes Basin.

Describe the point of diversion (POD) and any associated reach(es) of the instream use being created. If possible list the reach by river mile. If no reach is identified, and there is only one POD listed on the certificate, the lease may be processed to be protected at the POD. (If more than one POD is listed on the certificate, then the POD and any associated reach(es) must be identified): river mile 102.6 to Princville Reservoir
Maximum volume in acre-feet: 5716
Rate in cfs: 1.78
(Use the section below to indicate a more restrictive period of use than allowed by the water right.)

Conditions to prevent injury, if any:

- None
- The instream flow will be allocated on a daily average basis up to the described rate from 4/15 through 9/30
- Other (describe): ?

If you need to enter more instream uses, please use the additional water rights form.

2.3 Term of lease. This lease shall terminate on January 1, 2012

2.4 Flow protection. The Trustee will regulate use of water from the source, subject to prior appropriation and the agency enforcement guidance, to assure the water is delivered to the point of diversion, and through the reach past junior downstream users, so long as flow is sufficient to meet the demand under priority date of the new instream use (see Section 2.2). As part of regulation activities the watermaster or a designee has access to the point of diversion and place of use for the water rights involved in this lease. No party is required to continuously measure the flow of the waterway described in Section 2.2.

~III~ Other Information

3.1 Accuracy. The Undersigned Lessor(s) and Lessee(s) declare that, to the best of their knowledge and belief, the information contained in this application is true, correct and complete. If after the lease order is signed, any information is determined to be false, the lease order may be modified or terminated. The lease only exercises the water rights being leased, for the term of the lease. It shall not be construed to overcome any claim that the water right may otherwise be subject to forfeiture for nonuse pursuant to ORS 540.610 during the period of time prior to the execution of the lease.

RECEIVED

MAR 09 2007

FSD

3.2 **Lease.** Lessor(s) and Lessee(s) agree to lease the water rights listed in Section(s) 1.5 for instream use for the term of this lease through Lessee to the Trustee, the Oregon Water Resources Department, pursuant to the provisions of ORS 537.348(2) and OAR 690-077.

3.3 **Precedent.** If a right which has been leased is later proposed to be leased again or transferred to an instream use under ORS 537.348 and OAR 690-077 a new injury review shall be required, and a prior lease shall not set a precedent for the amount of water to be leased or transferred instream.

3.4 **Suspension of original use.** During the period of the lease, the water right holder agrees to suspend use of water allowed under the subject water rights and under any water right that is supplemental to the subject water rights.

3.5 **Termination provision.**

For multiyear leases, the Lessor(s) shall have the option of terminating the lease each year with written notice to the Department. The lease may be terminated at any time during the calendar year. However, if the termination request is received less than 30-days prior to the period of allowed instream use or after the period of allowed use has begun for the water right(s) being leased, water may not be used under the right(s) leased until the following calendar year, unless the Director determines that enlargement would not occur. The Department may also require:

- Written notice to the Department with original signatures;
- Consent by all parties to the lease; and/or
- Written notice to the Watermaster's office.

For multiyear leases, the lessor shall not have the option of terminating the lease, without consent by all parties to the lease.

3.6 **Modification to prevent injury.** Allocation of water to the instream use described in Section 2.2 during the term of this lease is not reasonably expected to cause injury to other rights to use water from the same source. If injury is found after this lease is signed, the lease may be modified or terminated to prevent injury.

3.7 **Fees.** Pursuant to ORS 536.050, the following fee is included:

\$200 for an application with four or more landowners or four or more water rights.

\$100 for all other applications.

Lessor #1: _____



Date: _____

3-4-07

STIGSON RANCH LLC By Carl Cannon

For additional Lessors, type in space for signature and date

Lessee: _____

Date: _____

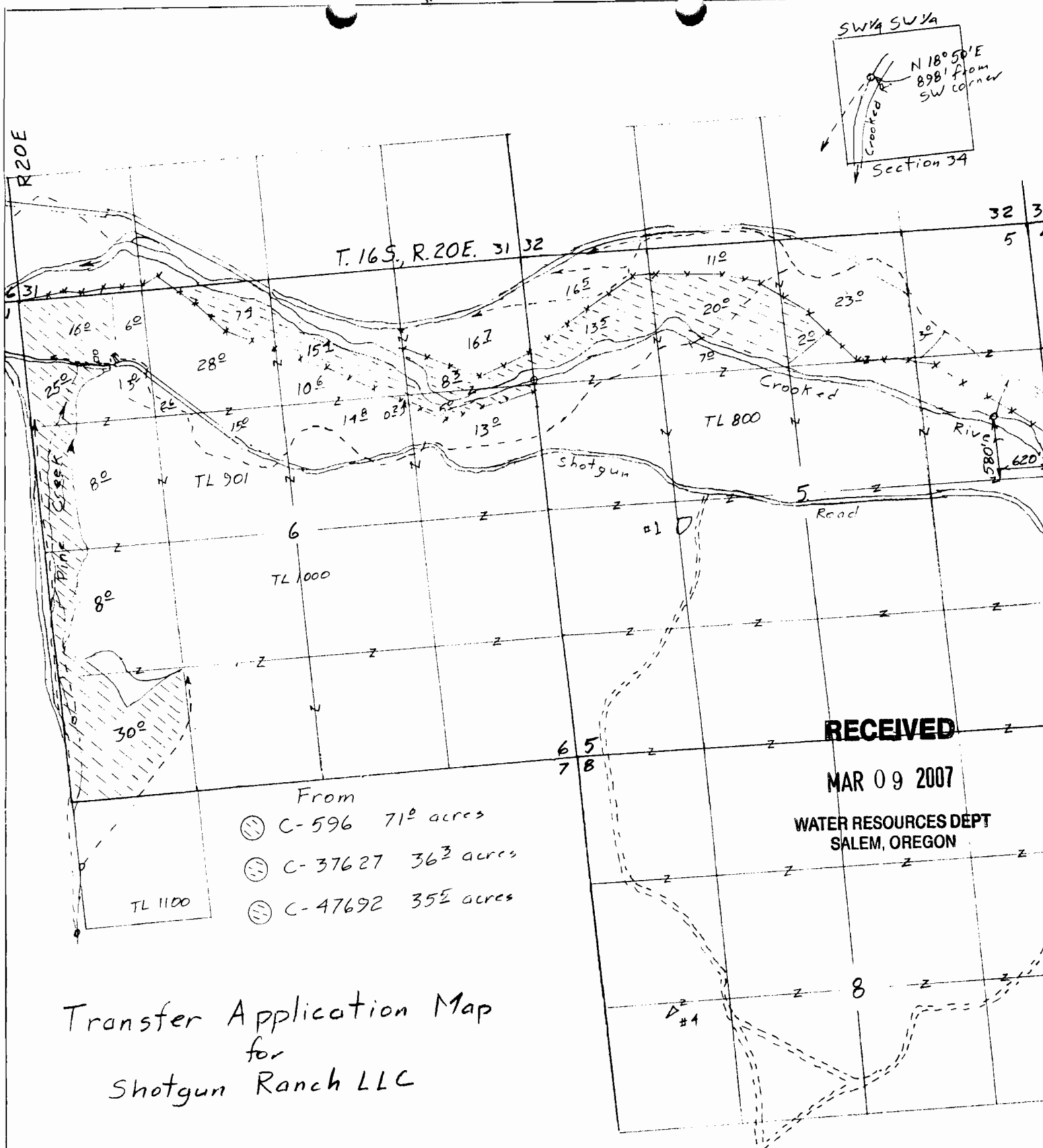

RECEIVED

MAR 09 2007

WATER RESOURCES DEPT
SALEM, OREGON

- From
- ⊗ C-596 71⁰ acres
 - ⊗ C-37627 36³ acres
 - ⊗ C-47692 35² acres

Transfer Application Map
for
Shotgun Ranch LLC

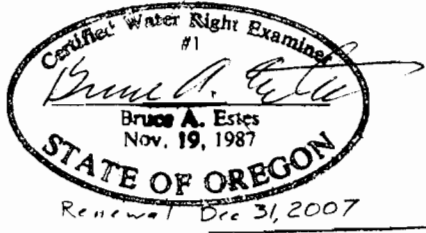

This map is for the purpose of locating a water right only and has no intent to provide legal dimensions or the locator of property lines.

ESTES SURVEYS, LLC
 PO Box 17519 60382 Arnold Rd
 Salem, OR 97306-7519 Bend, OR 97702
 (503) 585-7593 (541) 382-7391