

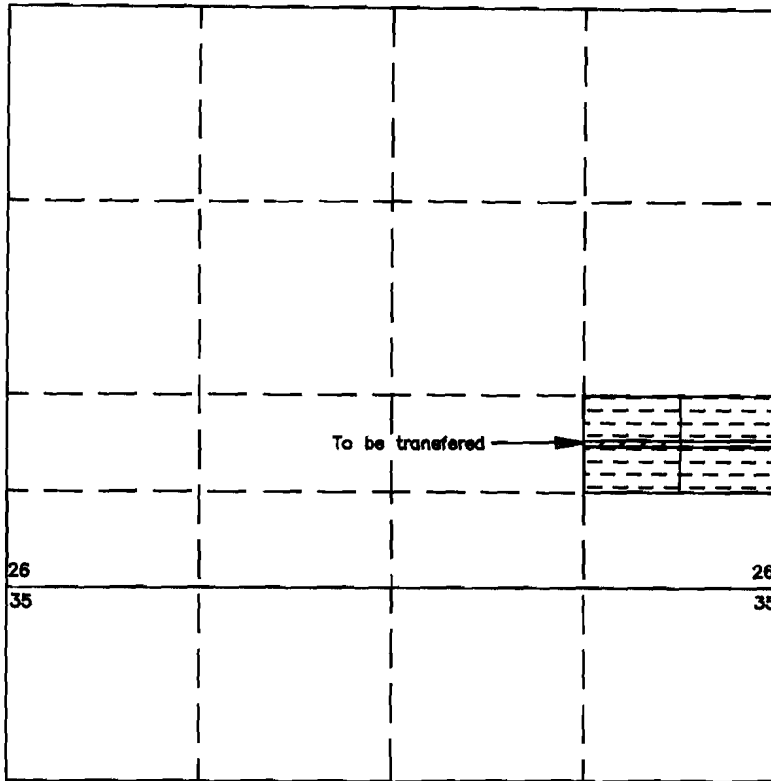

AUTHORIZED PLACE OF USE
SECTION 26, T.39S. R.19E.
Tax Lot 301

AMENDED
MAP TO ACCOMPANY APPLICATION
FOR A TRANSFER OF WATER RIGHT
LAKEVIEW WATER USERS C/O
WILLIAM RAY & KATHRYN J. ROGERS

DR

*Dec 1999
5/26/99
DRB*



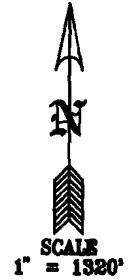

 .70 a available for transfer Certificate #75557

 18.6 a remaining in the SE1/4 SE1/4

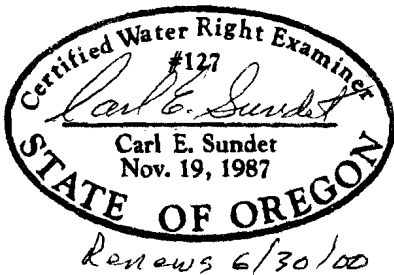

PROPOSED PLACE OF USE
SECTION 26, T.39S. R.19E.
Tax Lot 301



 .70 a area to transfer to

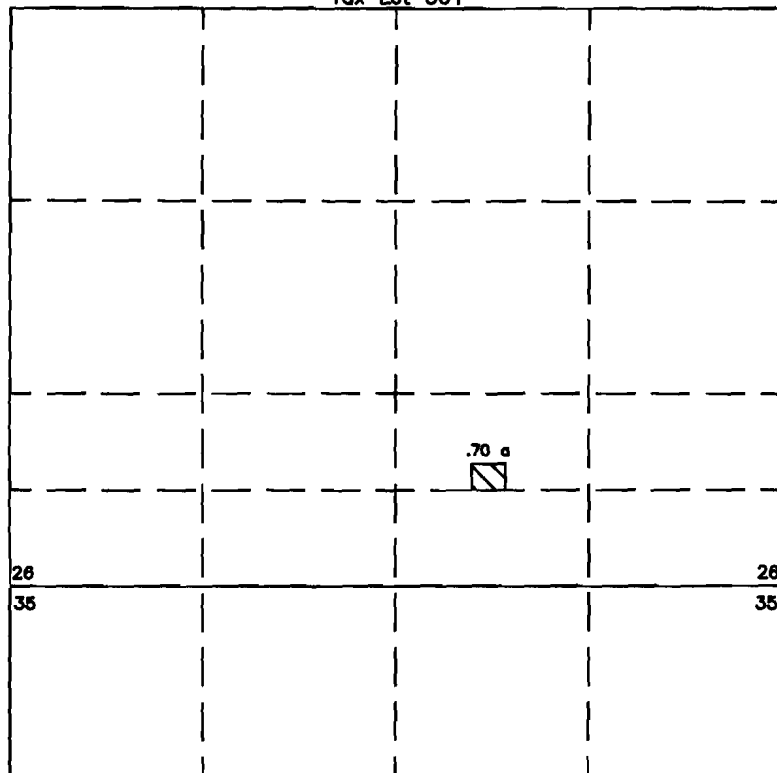

PREPARED FOR: WILLIAM RAY & KATHRYN J. ROGERS
PREPARED BY: SUNDET & ASSOCIATES
P.O. BOX 1228
LAKEVIEW, OR 97630
(541) 947-3293
JANUARY 1999 DR #ROGERS

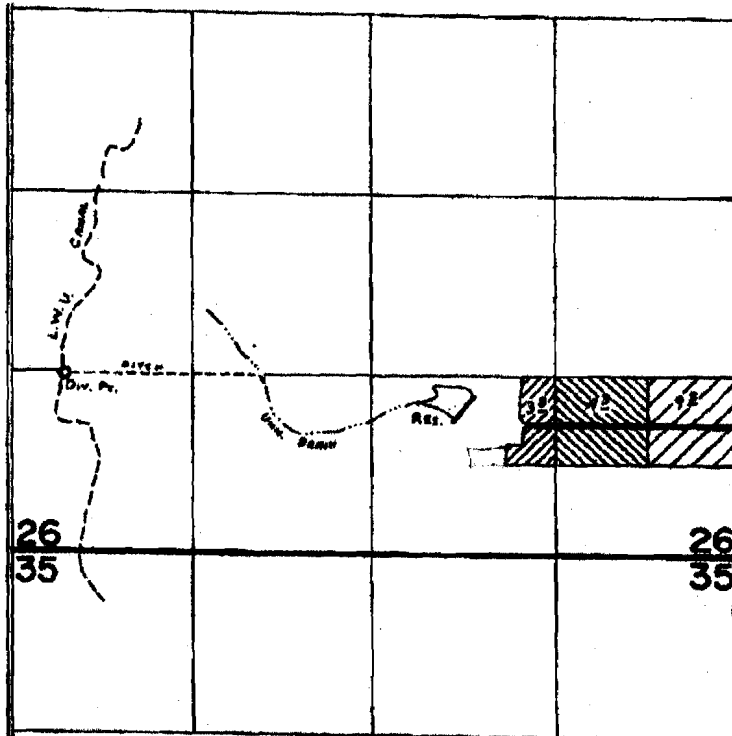

T.39S. R.19E. W.M.



Div. Pt. Loc: 1340' N. & 700' E. fr. S.W. Cor. Sec. 26.

DAM Loc: 1000' N. & 1970' W. fr. S.E. CoR. Sec. 26.

50pp

-  PRIMARY IRR. fr. CANAL (APP. 37062), SUPPLEMENTAL IRR. fr. U.N.W. DRAIN fr. RES. (APP. R-56336 & 56390)
-  PRIMARY IRR. fr. CANAL (T-9209), SUPPLEMENTAL IRR. fr. U.N.W. DRAIN fr. RES. (APP. R-56336 & 56390)
-  PRIMARY IRR. fr. U.N.W. DRAIN fr. RES. (APP. R-56336 & 56390)

FINAL PROOF SURVEY UNDER

T-4209

R-56336

R-6706

Application No. 56340 Permit No. 42347.....

IN NAME OF

WILLIAM RAY ROGERS.....

Surveyed June...7... 1980, by C.L. Hughes.....