

T. 4S., R. 12 & 13E., W. M.

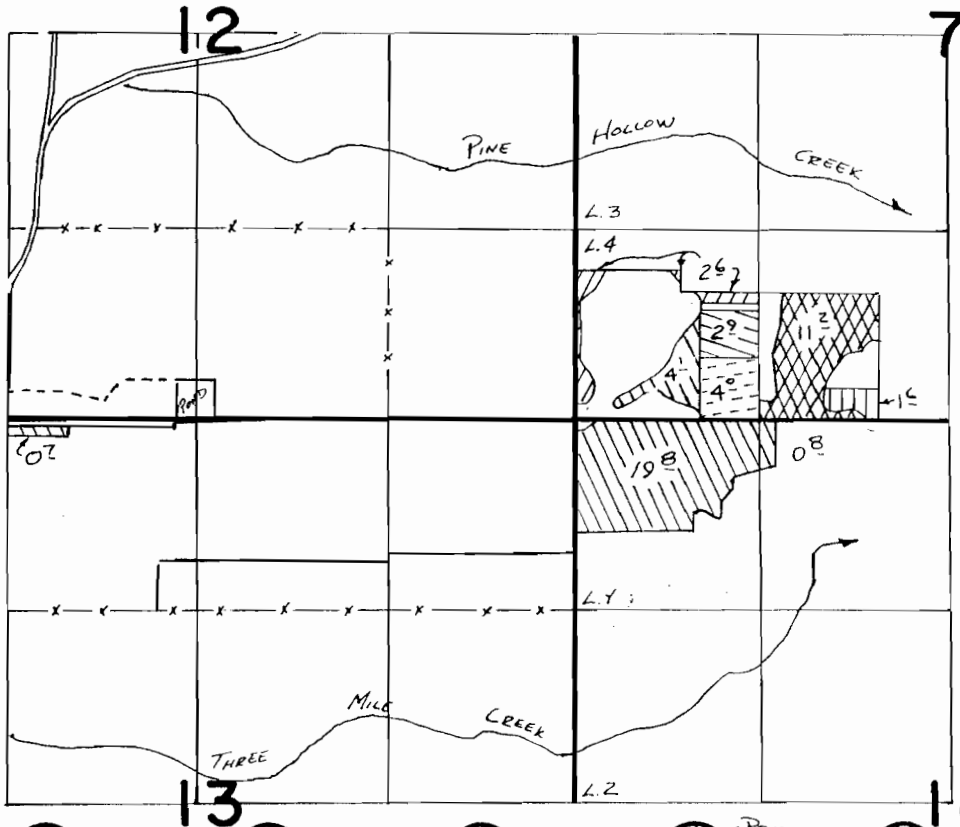

SCALE 1" = 1320'

FINAL PROOF SURVEY
UNDER

TRANSFERS 4324, 4313, 4312, 4314, 5553
IN NAME OF

.....**RAY A. BENZEL**.....

Surveyed 10-18 1988, by V.L. Church

RECEIVED

OCT 12 1984

WATER RESOURCES
SALEM, OREGON

T-5551

T. AS. R. 12E Sec 9

January 7, 1874	Threemile Creek	Primary	20.5	5764'
March 22, 1961	Badger Creek & Misc	Primary	23.7	46368
		Supplemental	4.81	46368
October 27, 1964	Threemile Creek & Misc.	Primary	14.2	46529'
July 23, 1968	Threemile Creek & Misc.	Supplemental	58.4	51486
May 1, 1975	Threemile Creek & Misc.	Supplemental	58.4	51486

TAS RIZE SEC 9

