

T. 4S., R. 12 & 13E., W. M.

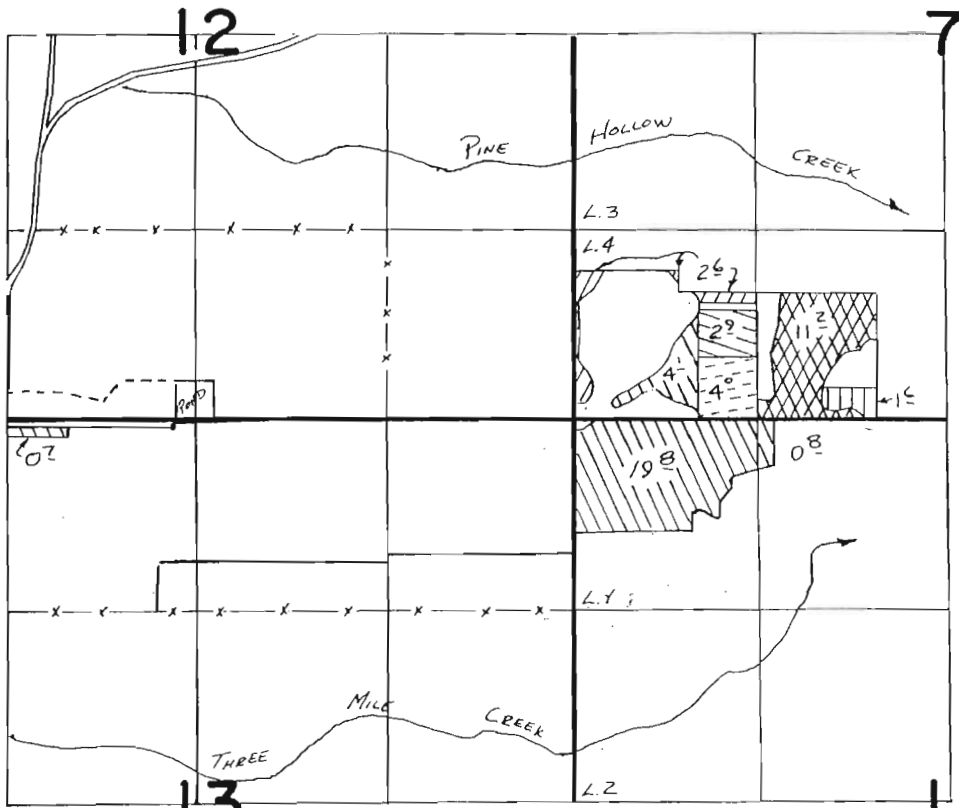

-  T-4324
-  T-4313
-  T-4312
-  Prim.
T-4314
Suppl.
-  T-5553

FINAL PROOF SURVEY
UNDER

TRANSFERS 4324, 4313, 4312, 4314, 5553
IN NAME OF

RAY A. BENZEL

Surveyed 10-18-1988, by V.L. Church

RECEIVED
OCT 12 1984

WATER RESOURCES DEPT
SALEM, OREGON

3

RANGE 12E
RANGE 13E

THREEMILE CREEK



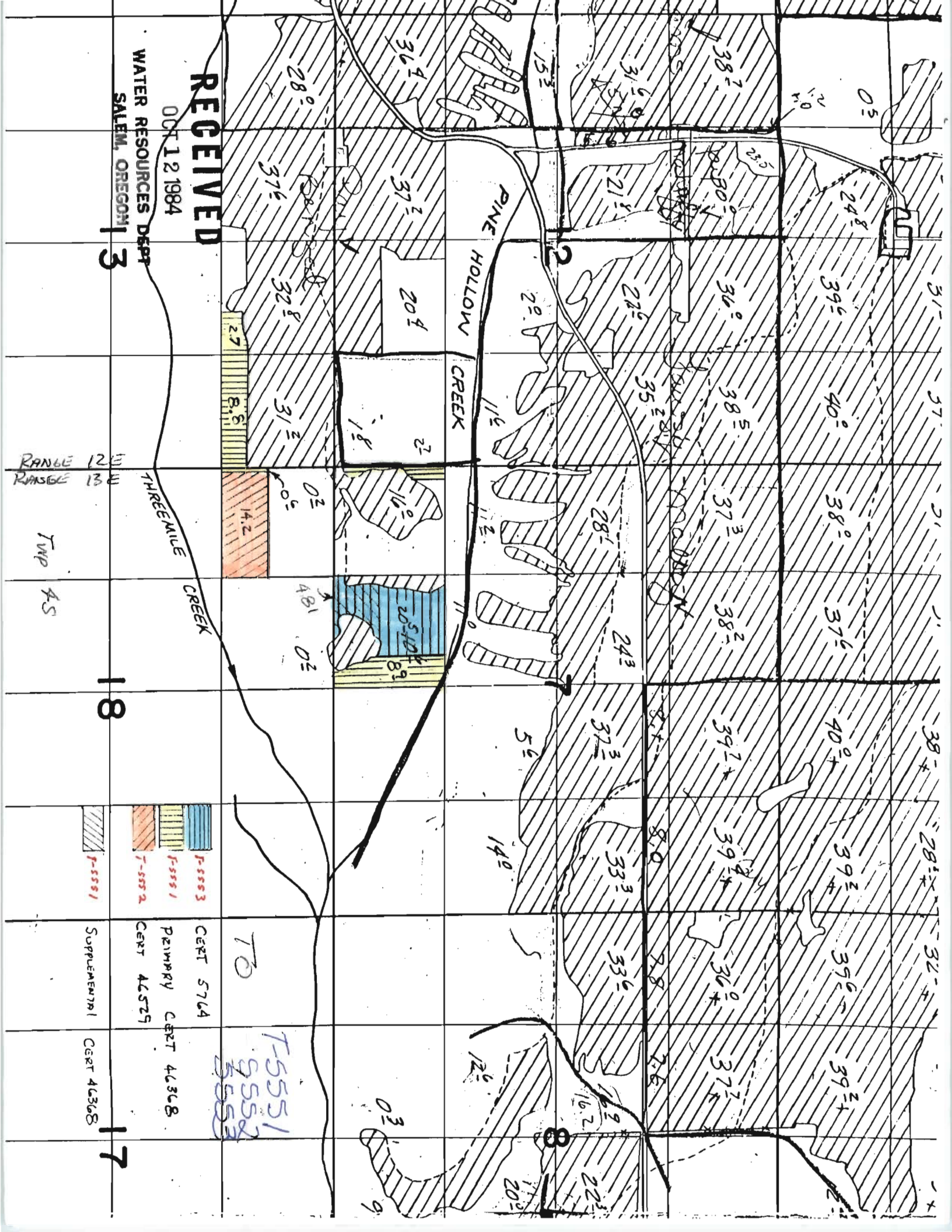

TWP 4S

18

17



7-5551
5552
5553

	F-5553	CERT 5764
	F-5551	PRIMARY CERT 46368
	F-5552	CERT 46368
	F-5551	SUPPLEMENTAL CERT 46368

RECEIVED

OCT 12 1984

WATER RESOURCES
SALEM, OREGON

T-5551

T.A.S. R. 12E Sec 9

January 7, 1874	Threemile Creek	Primary	20.5	5764
March 22, 1961	Badger Creek & Misc.	Primary	23.7	46368
		Supplemental	4.81	46368
October 27, 1964	Threemile Creek & Misc.	Primary	14.2	46529
July 23, 1968	Threemile Creek & Misc.	Supplemental	58.4	51486
May 1, 1975	Threemile Creek & Misc.	Supplemental	58.4	51486

TAS RIZE SEC 9

