

T. 4N. R. 28 & 29E. W. M.

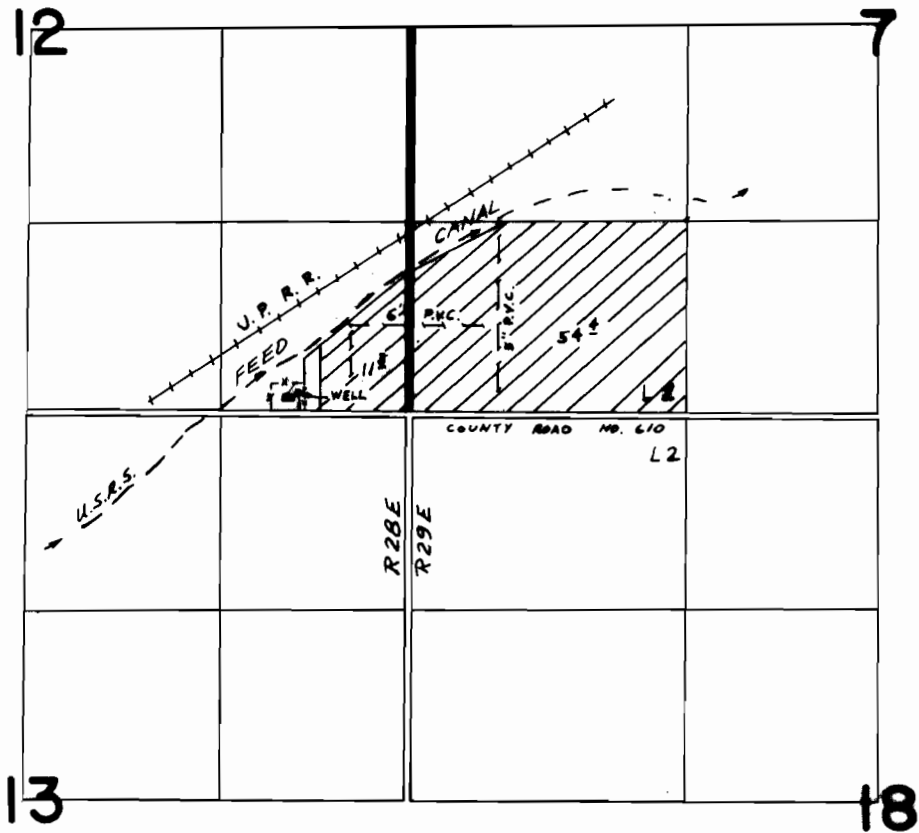

WELL LOC. 760'W & 150'N FROM SE COR SEC 12

**FINAL PROOF SURVEY**  
UNDER

Application No. G-6744.. Permit No. G-6268..  
IN NAME OF

.....FRANK E. & DOYLENE M. DYE.....

Surveyed 11-30..... 1977, by R. BARKIN.....