

RECEIVED
MAY 02 2006
WATER RESOURCES DEPT
SALEM, OREGON

RECEIVED
OVER THE COUNTER

C:\1000\1003\103\Corp\Water\1003\103_FT_WRP.C 08.23.03/29/2006 SS

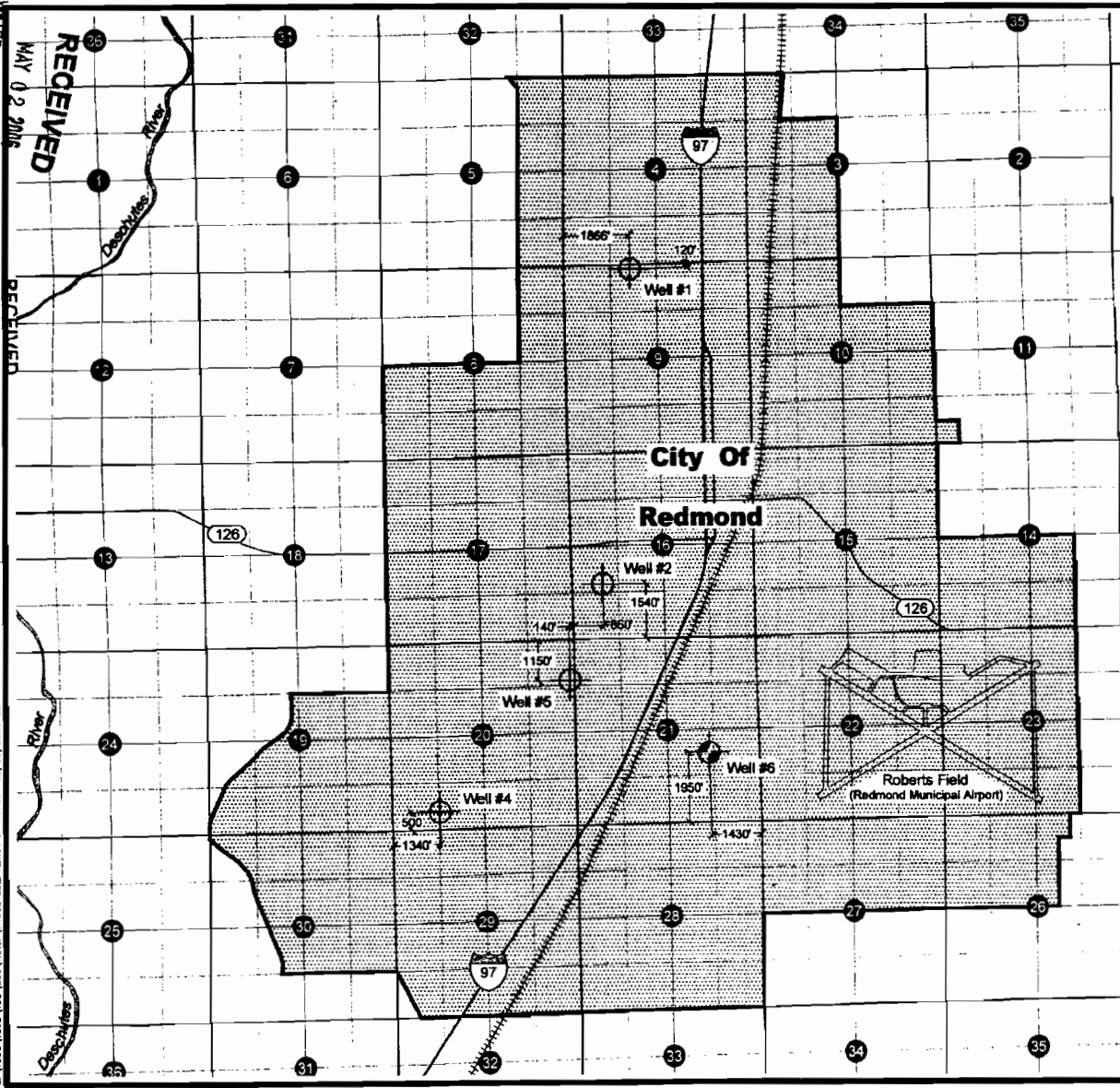

WATER RIGHT PERMIT

Place of Use Located in Sections
3, 4, 5, 8, 9, 10, 11, 14, 15, 16, 17, 19,
20, 21, 22, 23, 26, 27, 28, 29 & 30
T15S, R13E W.M.
Deschutes County, Oregon

EXPLANATION

- Place Of Use For Water Right Permit G-12401, City Of Redmond UGB
- Well #6
- Approximate Location Of City Well #6 For Additional Point Of Appropriation. NW 1/4, SE 1/4, Section 21, T15S, R13E, W.M., 1430 West, 1950' North of SE Corner of Section 21.
- Well #1, 2, 4, 5
- Current Points of Appropriation Under Water Permit G-12401.

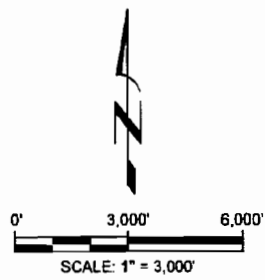

NOTES

1. THIS MAP WAS PREPARED FOR THE PURPOSE OF IDENTIFYING THE LOCATION OF WATER RIGHTS ONLY AND IS NOT INTENDED TO PROVIDE LEGAL DIMENSIONS OR LOCATIONS OF PROPERTY OWNERSHIP LINES.

T 10163

Additional Point of Appropriation
Water Right Permit G-12401
City of Redmond, Oregon



DESIGNED BY
J. NEWTON

DRAWN BY
S. Schenck

DATE
March 2006

PROJECT NO.
1003-103

FIGURE
1

MAR 27 2008

WATER RESOURCES DEPT
SALEM, OREGON

FIGURE 1

PROJECT NO. 1003-109

DATE: March 2008

DATE:

DRAWN BY: S. Schenck

DESIGNED BY: K. Turner

City of Redmond Well Locations
Ground Water Right Permit Amendment G-1240
Redmond, Deschutes County, Oregon

Explanation

- Place Of Use For Water Right Permit G-12401, City Of Redmond UGB
- Location of City Well and Designation
- Location of Proposed Additional Point of Appropriation

City Well Location

- | Well # | Location |
|--|--|
| W-01 | T15S, R13E, W.M., Section 9, NE 1/4 - NW 1/4 ; South 89° 49' West and 532.67' from the N 1/4 Corner of Section 9 |
| W-02 | T15S, R13E, W.M., Section 16, NW 1/4 - SW 1/4 ; 990' South & 660' East from the W 1/4 Corner of Section 16 |
| W-04 | T15S, R13E, W.M., Section 20, SE 1/4 - SW 1/4 ; 520' North & 1430' East from the SW Corner of Section 20 |
| W-05 | T15S, R13E, W.M., Section 20, NE 1/4 - NE 1/4 ; 1200' South & 150' West from the NE Corner of Section 20 |
| W-06 | T15S, R13E, W.M., Section 21, NW 1/4 - SE 1/4 ; 1950' North & 1430' West from the SE Corner of Section 21 |
| Proposed Additional Point of Appropriation | |
| W-07 | T15S, R13E, W.M., Section 10, SW 1/4 - SE 1/4 ; 1210' North & 1640' East from the SW Corner of Section 10 |
- Deschutes County, Oregon
Township 15 South, Range 13 East, W.M.
Sections 3, 4, 5, 8, 9, 10, 11, 14, 15, 16, 17, 19, 20, 21, 22, 23, 26, 27, 28, 29, 30, & 32

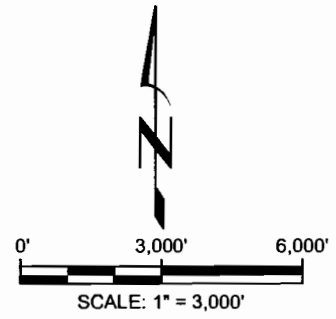

NOTES

- THIS MAP WAS PREPARED FOR THE PURPOSE OF IDENTIFYING THE LOCATION OF WATER RIGHTS ONLY AND IS NOT INTENDED TO PROVIDE LEGAL DIMENSIONS OR LOCATIONS OF PROPERTY OWNERSHIP LINES.

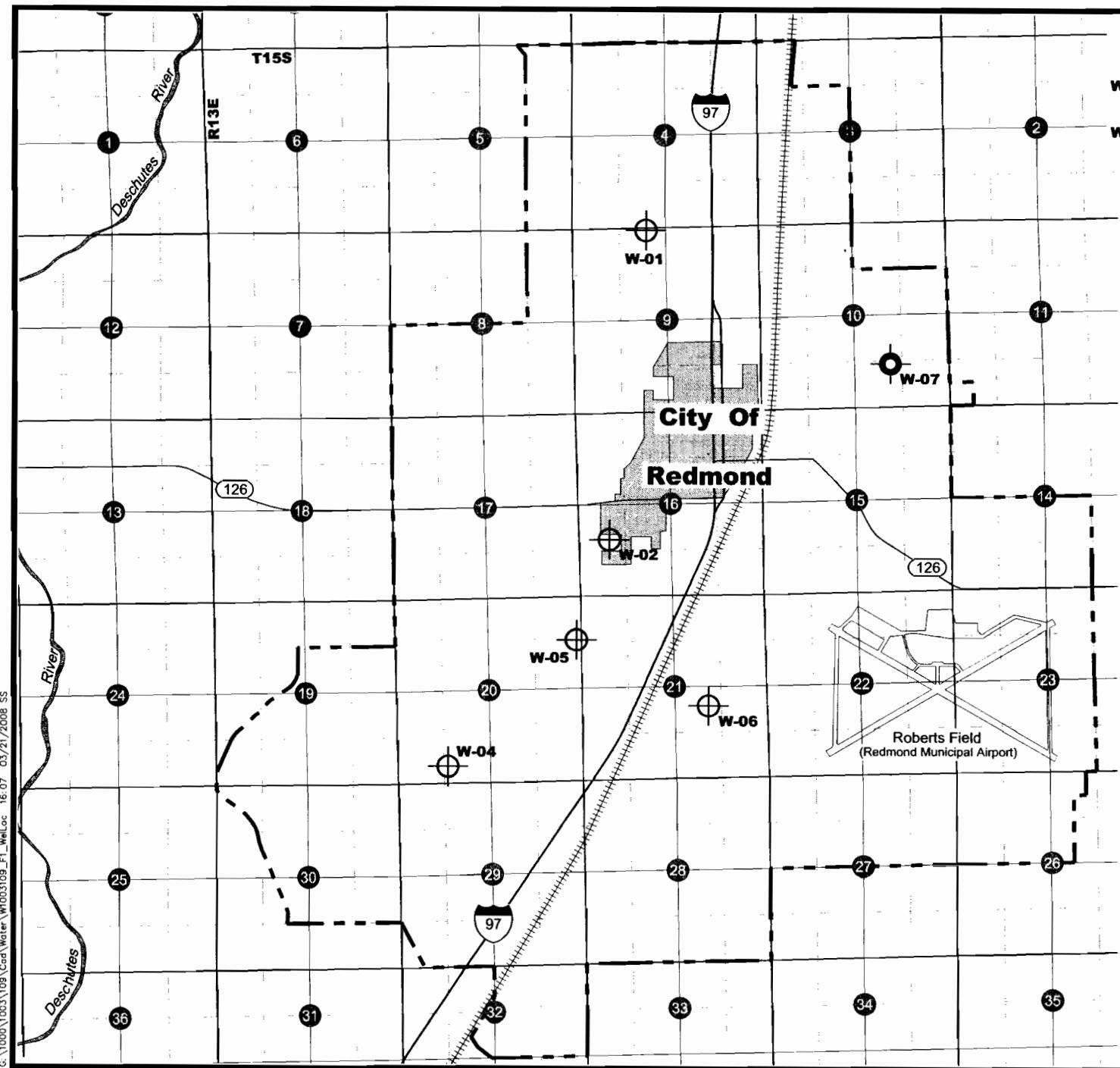

G:\1000\1003109\Cadd\Water\1003109_F1_WellLoc 16.07 03/21/2008 SS



NEWTON
CONSULTANTS INC.
Earth, Water and Rock Specialists
Ph: 541.504-9960 Fax: 541.504-9961