

# 2008 WESTLAND IRRIGATION DISTRICT Temporary Transfer, Mueller to Newman March 14, 1903, Cert. 76715 Primary; & July 1, 1924 Cert. 79439 Supplemental.

T4N., R28E., W.M.

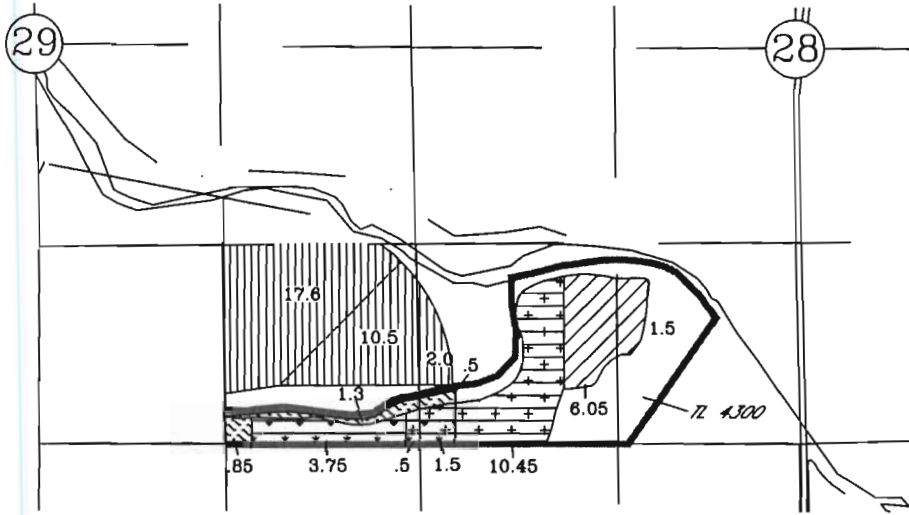

T4N., R28E., W.M.

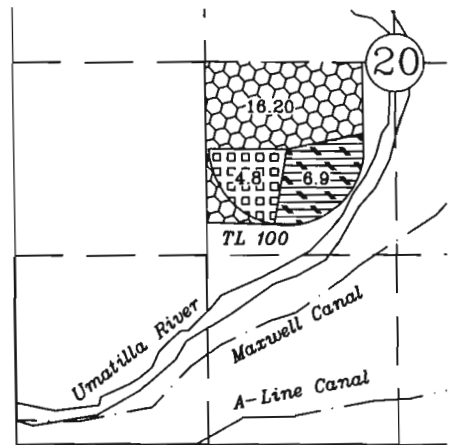

### FROM GROUNDS



FROM: 76715 & 79439 - 16.2 ac.

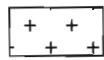

12.45 acres of Cert. 76749 on from ground. Will not be used during this transfer

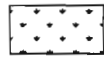

5.75 acres of Cert. 38388 on from ground. Will not be used during this transfer

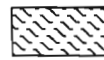

Cert. 38388 not involved with this transfer

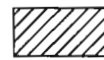

Cert. 76715, 79439 & 76749 not involved with this transfer



Cert. 76799 not involved with this transfer

### TO GROUNDS

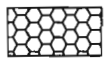

TO: 76715 & 79439 - 16.2 acres  
Existing 79893 to become supplemental to Incoming Prim. 76715 for this season only

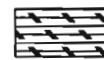

76717 & 79439 not involved with this transfer. Placed here on 2002 transfer T-9311.

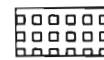

76715 & 79439 not involved with this transfer. Placed here on 2002 transfer T-9311.

T3N., R 29E., W.M.

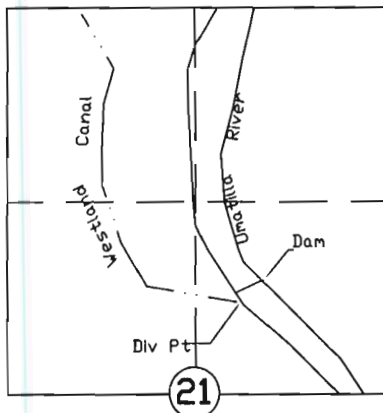

RECEIVED

MAR 27 2008

WATER RESOURCES DEPT  
SALEM, OREGON

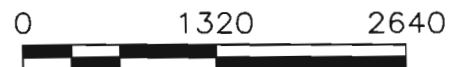

SCALE IN FEET

NOTE: THE PURPOSE OF THIS MAP IS TO IDENTIFY THE APPROXIMATE LOCATION OF THE WATER RIGHT. IT IS NOT INTENDED TO PROVIDE INFORMATION RELATIVE TO THE LOCATION OF PROPERTY OWNERSHIP BOUNDARY LINES.

# Westland Irrigation District Boundary

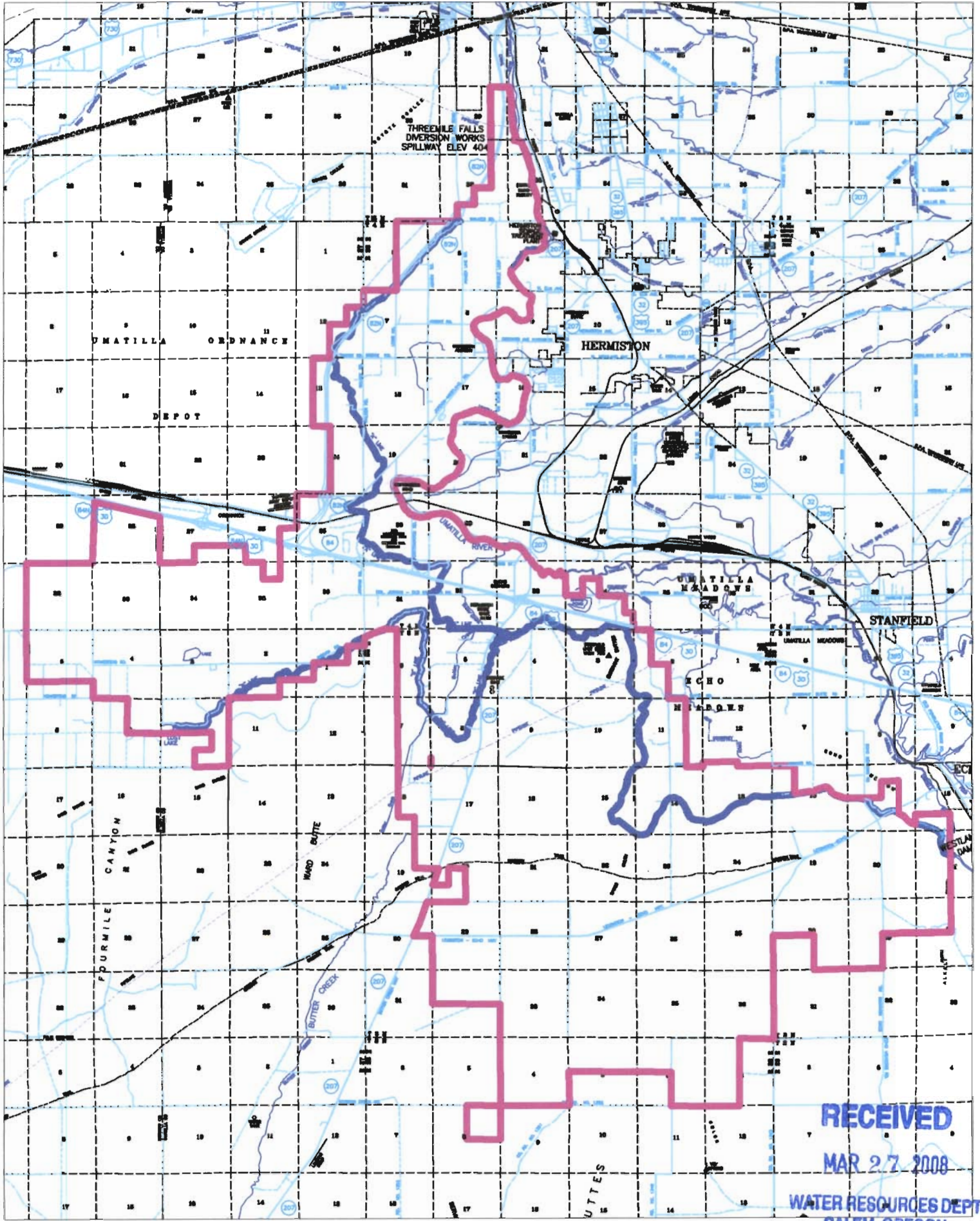

**RECEIVED**  
MAR 27 2008  
WATER RESOURCES DEPT  
SALEM, OREGON