

TUMALO IRRIGATION DISTRICT IN-STREAM LEASED WATER RIGHTS SURVEY

EXHIBIT 5-A & B
L08-011

FOR

Schutt/Tuten Family Trust

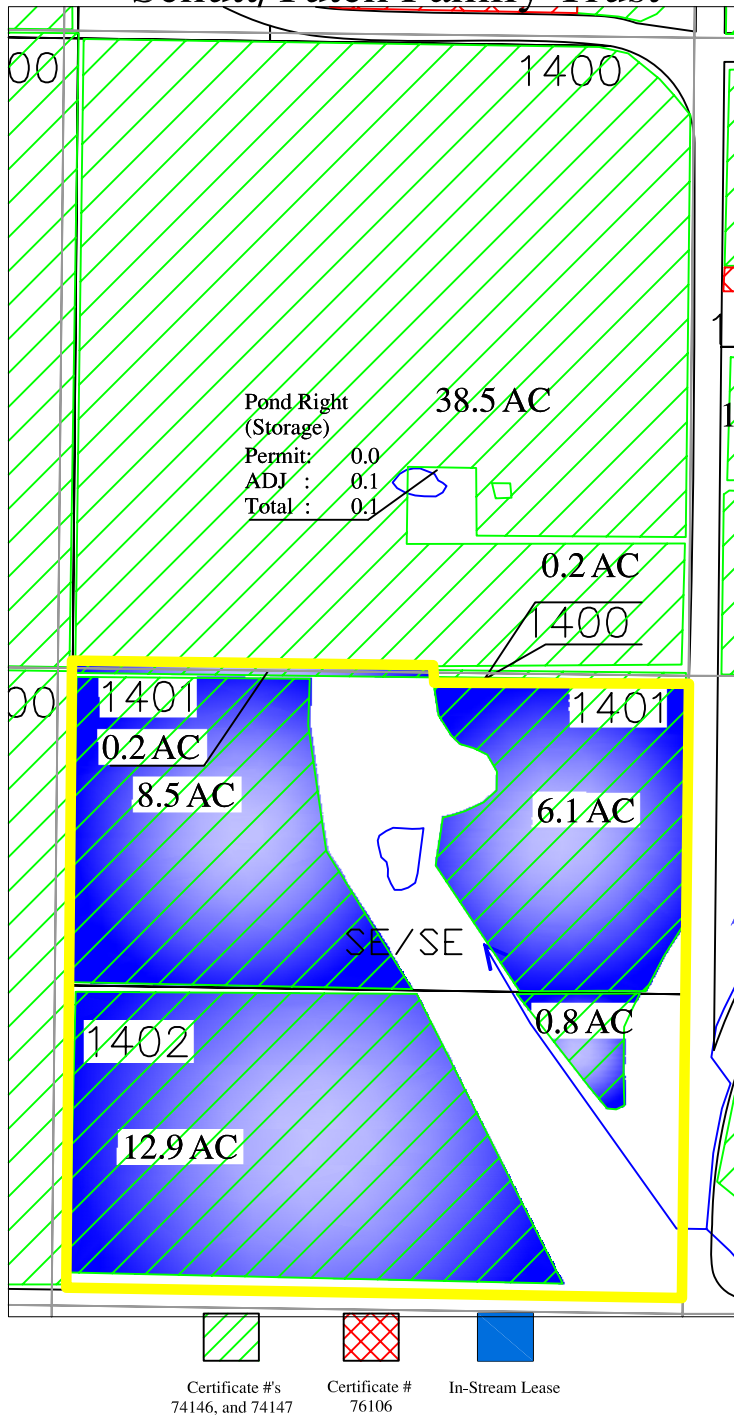

INITIAL: _____

LOCATED IN THE SE 1/4 OF THE SE 1/4 & NE/SE
OF SECTION 07, T.16 S., R.12 E., W.M.
TAX LOTS # 01401 & SE/SE 1402
DESCHUTES COUNTY, OREGON



SCALE: 1" = 800'

Prepared By: Tumalo Irrigation District, 64697 Cook Ave, Bend, Oregon 97701 541-382-3053