

APPLICATION NO. 589
Application No. 589

Permit No. 707
MEDFORD, OREGON

MEDFORD, OREGON

MAY 1909

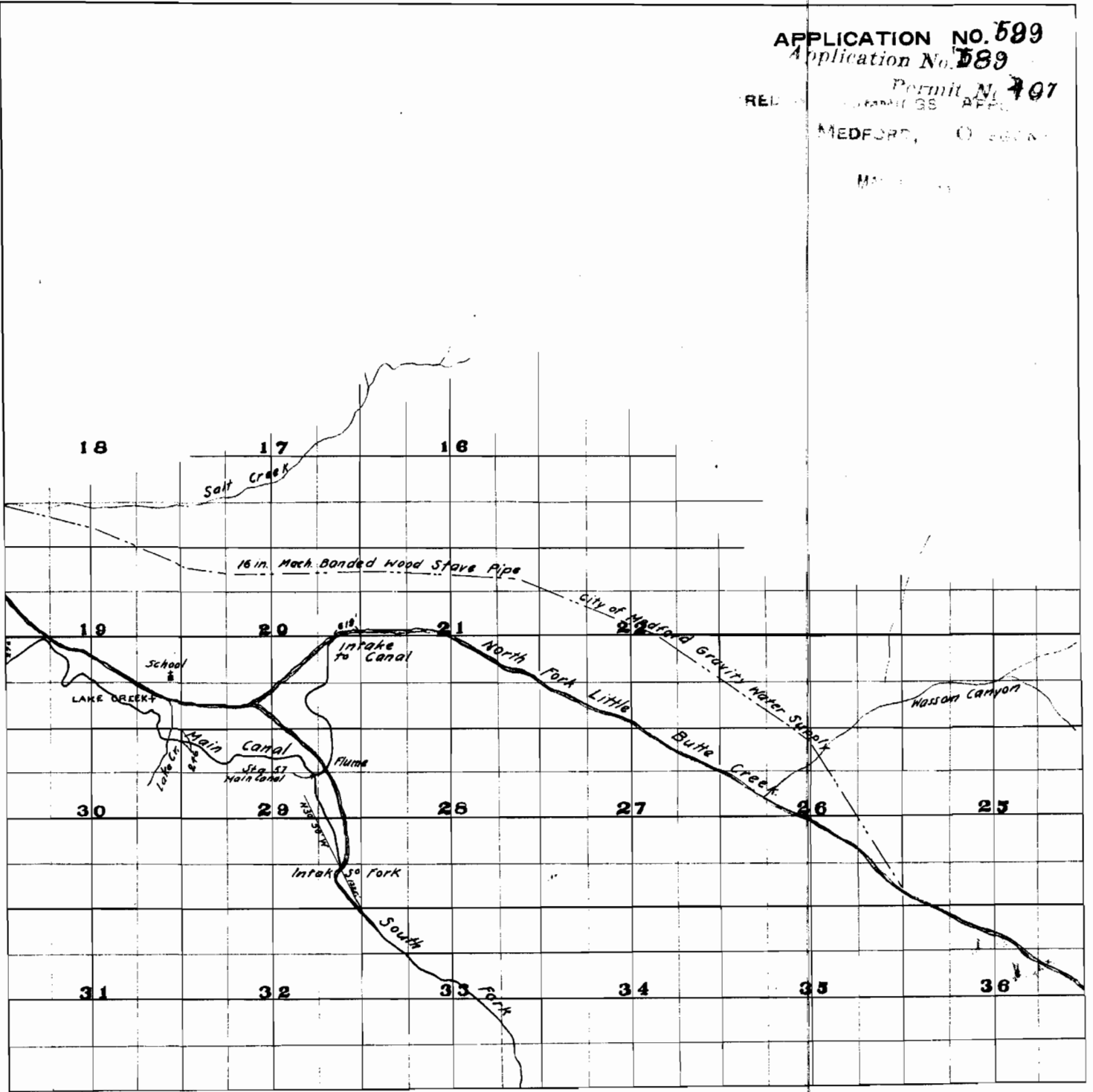



CERTIFICATE OF SURVEYOR

Irving Worthington, of Medford Oregon do hereby certify that this map was made from notes taken during an actual survey made under my immediate supervision during Apr, May, June, July, Aug, and Sept. 1909 and that it correctly represents the works described in the accompanying application together with the location of streams and other ditches in the immediate vicinity and has written thereon the area in each smallest legal subdivision which it is proposed to irrigate.

Irving Worthington Surveyor

Subscribed and sworn to before me this 10 day of *May* 1909
Notary Public State of Oregon.

CLAY PUBLIC JOB JACKSON COUNTY
MISSION EXPIRES 1910

- LEGEND
-  Lands under existing rights.
 -  Lands applied for.

City of Eagle Point City Limits
Area of Municipal Water Right Coverage
 T 35 S , R 1 W, W.M. Sections 34 & 35
 T 36 S, R 1 W, W.M. Sections 2, 3, 4, 9, 10 & 11
 Map 4 of 5

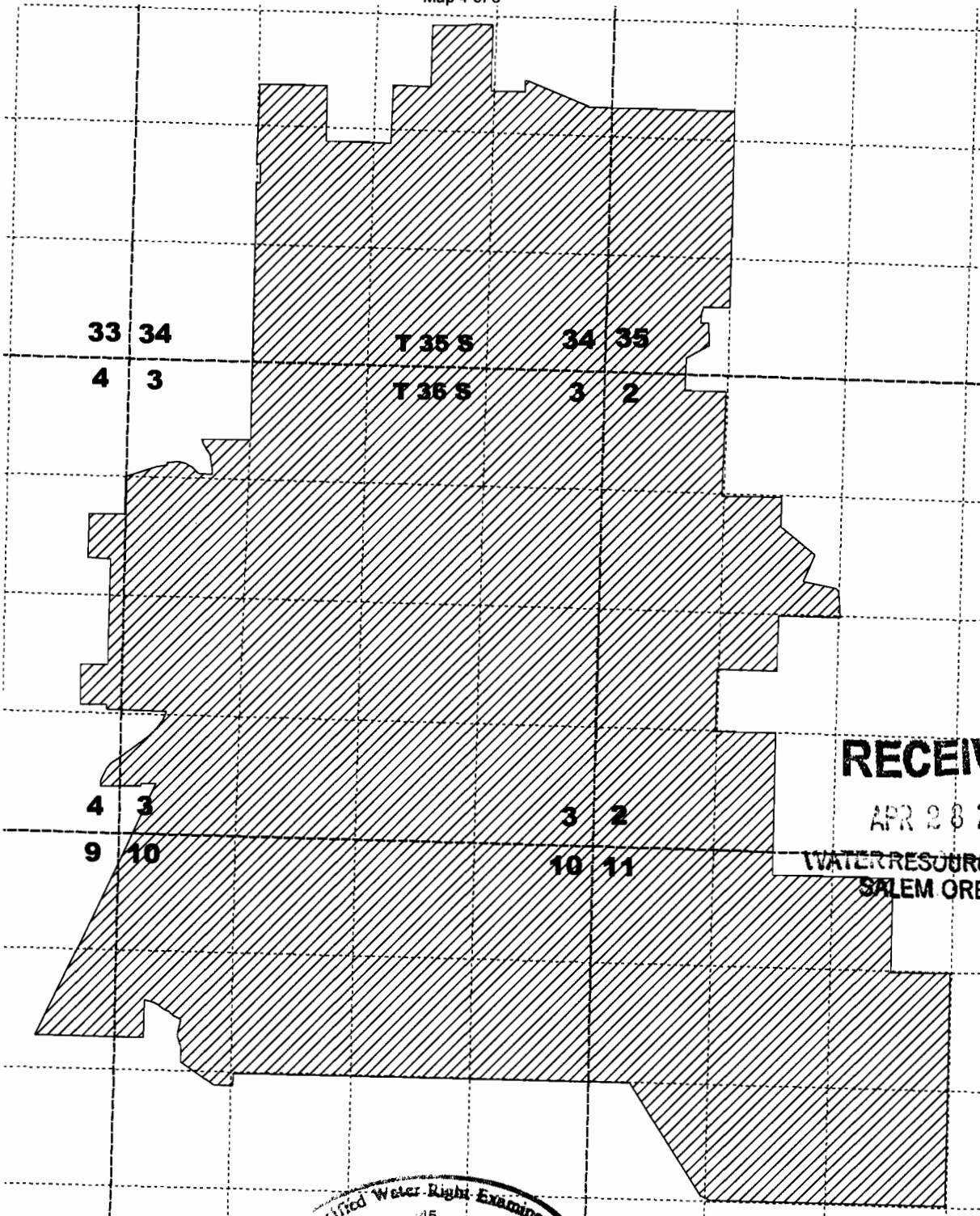



RECEIVED

APR 28 2008

WATER RESOURCES DEPT
 SALEM OREGON

Legend

-  Area of Municipal use
-  Section line
-  Quarter quarter line



Scale 1" = 1320'

This map is for water right purposes only.
 It is not to be used for property line location.

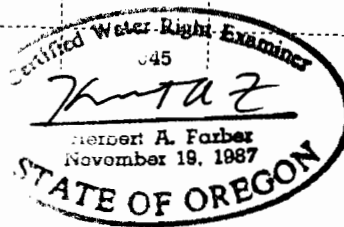

FARBER
SURVEYING

PO Box 5286
 Central Point, Oregon 97502
 Phone 541-664-5599
 Fax 541-664-5603
 Email hafarber@charter.net

Farber & Sons, Inc.
 431 Oak Street
 Central Point, Oregon
 Tax ID: 93-1057173

T 10614

Map of Transfer of Water Right

Jackson County to City of Eagle Point
Certificate 81635
T 37 S, R 2 W, Sec 16, W.M.
Map 2 of 5

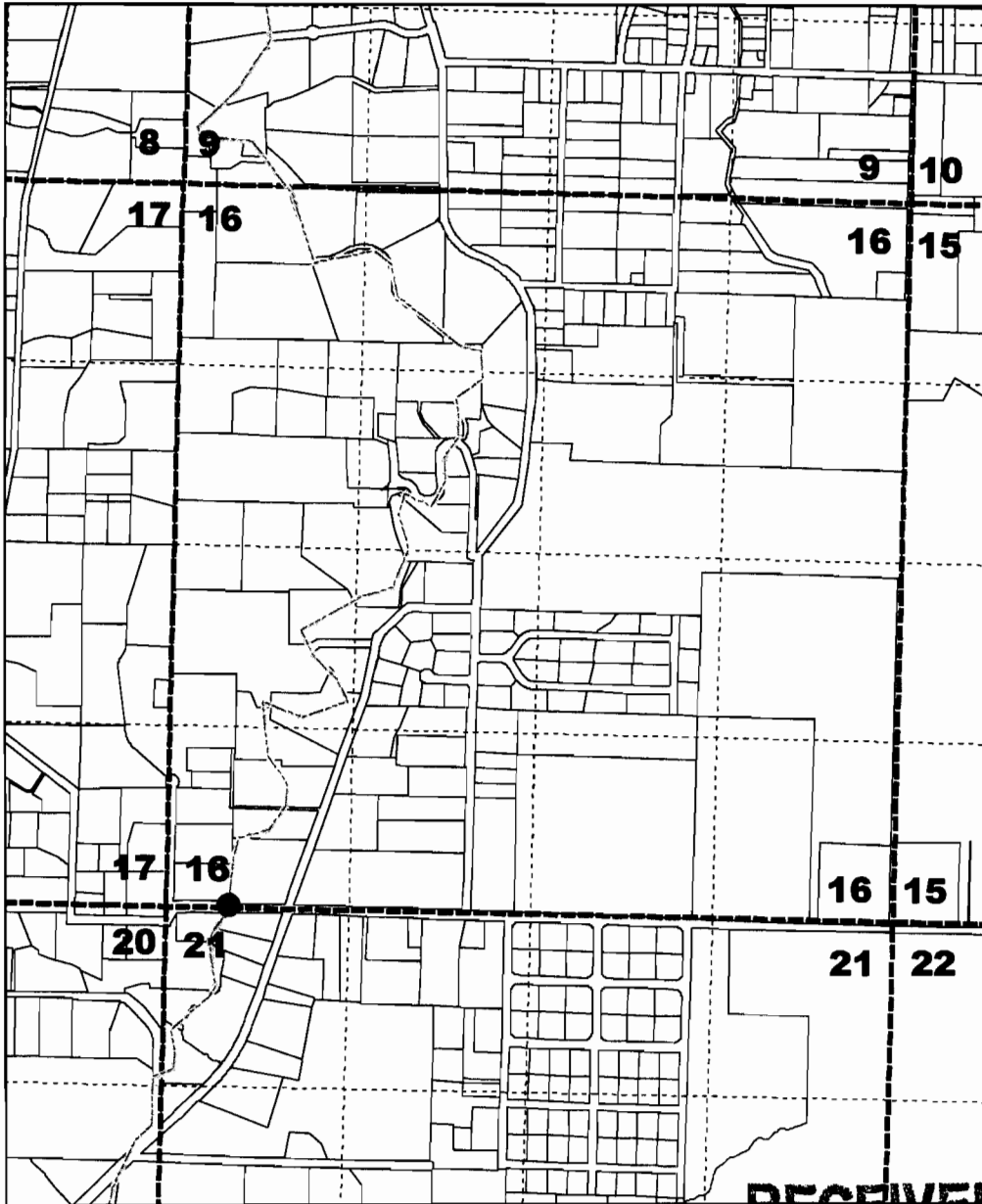

Note: Water is pumped from MID Canal on the County Road Right of Way. There is no tax lot number for the place of use.

Note: this map is for water right purposes only. it is not to be used for property line location.

Legend

- Water removal location
- MID Canal
- - - Section Line
- · · Quarter-Quarter Line

N



1 inch equals 1,320 feet

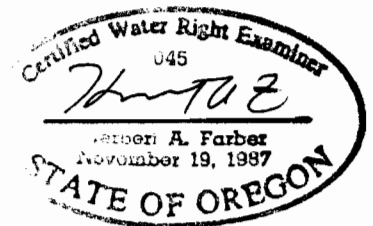

RENEWAL DATE 12-31-09

RECEIVED

APR 28 2008

WATER RESOURCES DEPT
SALEM OREGON

FARBER
SURVEYING

P.O. Box 5286
Central Point, Oregon 97502
Phone 541-664-5599
Fax 541-664-3603
Email hfarber@charter.net

Farber & Sons, Inc.
431 Oak Street
Central Point, Oregon
Tax ID: 99-1057173

T 10614

**Map of Transfer of Water Right
Jackson County to City of Eagle Point
Certificate 81635**

Map 1 of 5

Note: Water is pumped from MID Canal on the County Road Right of Way. There is no tax lot number for the place of use.

Note: this map is for water right purposes only. it is not to be used for property line location.

Legend

- Water removal location
- MID Canal
- - - Section Line
- - - - Quarter-Quarter Line

N



1 inch equals 1,320 feet

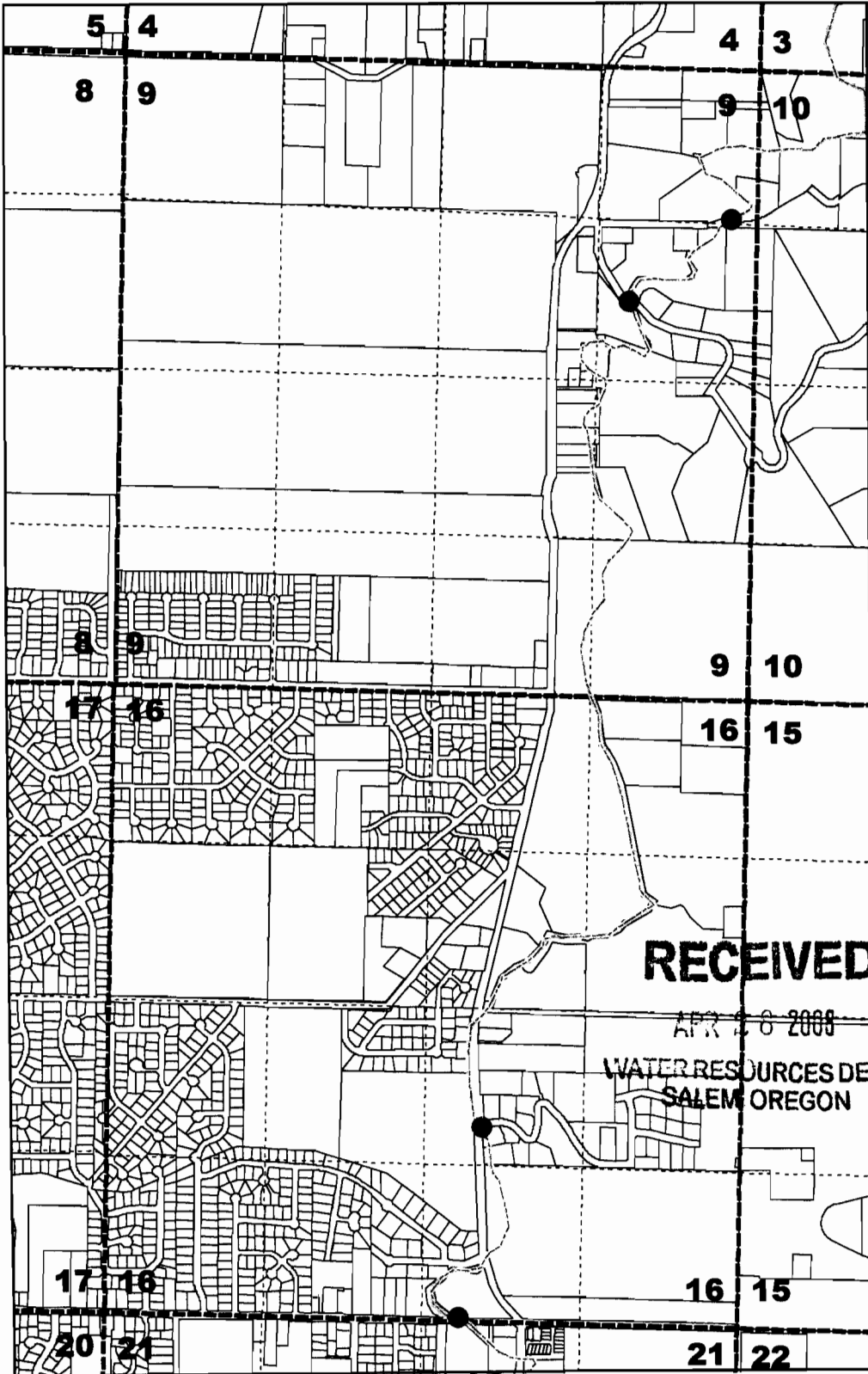

RECEIVED

APR 26 2008

WATER RESOURCES DEPT
SALEM OREGON

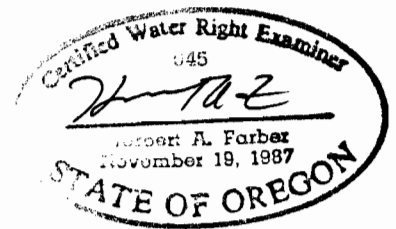

RENEWAL DATE 12-31-09



PO Box 5286
Central Point, Oregon 97502
Phone 541-664-5599
Fax 541-664-5603
Email hafarber@charter.net

Farber & Sons, Inc.
431 Oak Street
Central Point, Oregon
Tax ID: 93-11057173

T 10614

Township 36 S., Range 1 E W.M.



APPLICATION NO. 589

Application No. 589

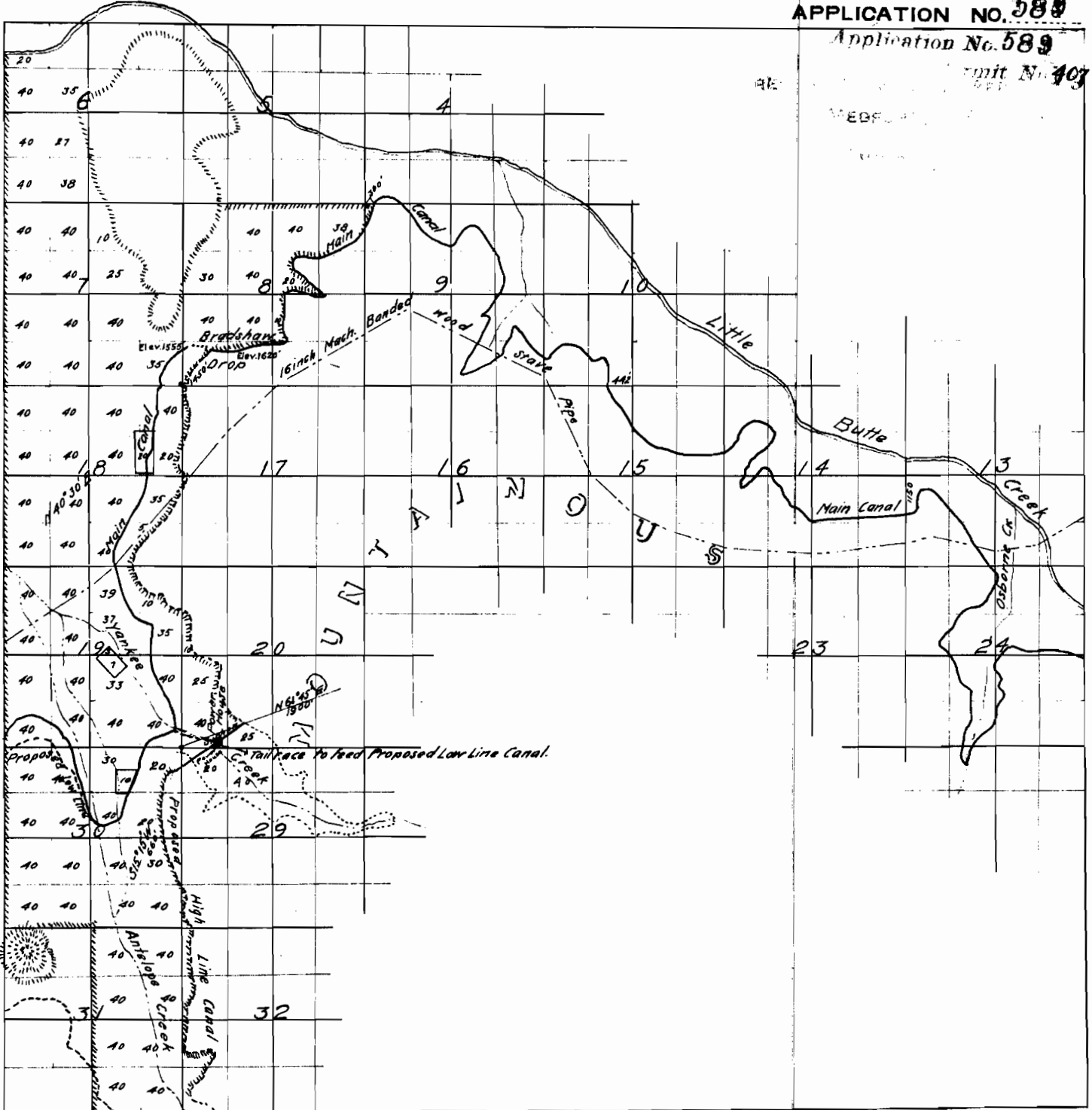
Unit No. 40



CERTIFICATE OF SURVEYOR

- LEGEND
-  Lands under existing rights.
 -  Lands applied for.

I, Irving Northrup of Medford Oregon do hereby certify that this map was made from notes taken during an actual survey made under my immediate supervision during Apr. May, June, July, Aug and Sept. 1909 and that it correctly represents the works described in the accompanying application together with the location of streams and other ditches in the immediate vicinity and has written thereon the area in each smallest legal subdivision which is proposed to irrigate.

Subscribed and sworn to before me this 10 day of Sept 1909
Irving Northrup Surveyor
 Notary Public State of Oregon.

NOTARY PUBLIC FOR JACKSON COUNTY, OREGON.
 MY COMMISSION EXPIRES 28, 1911

T 10614

Application No. 589

Unit No. 707

Township 36 S.

Range 1 W W.M.

MAR 28 1910

APPLICATION NO. 589

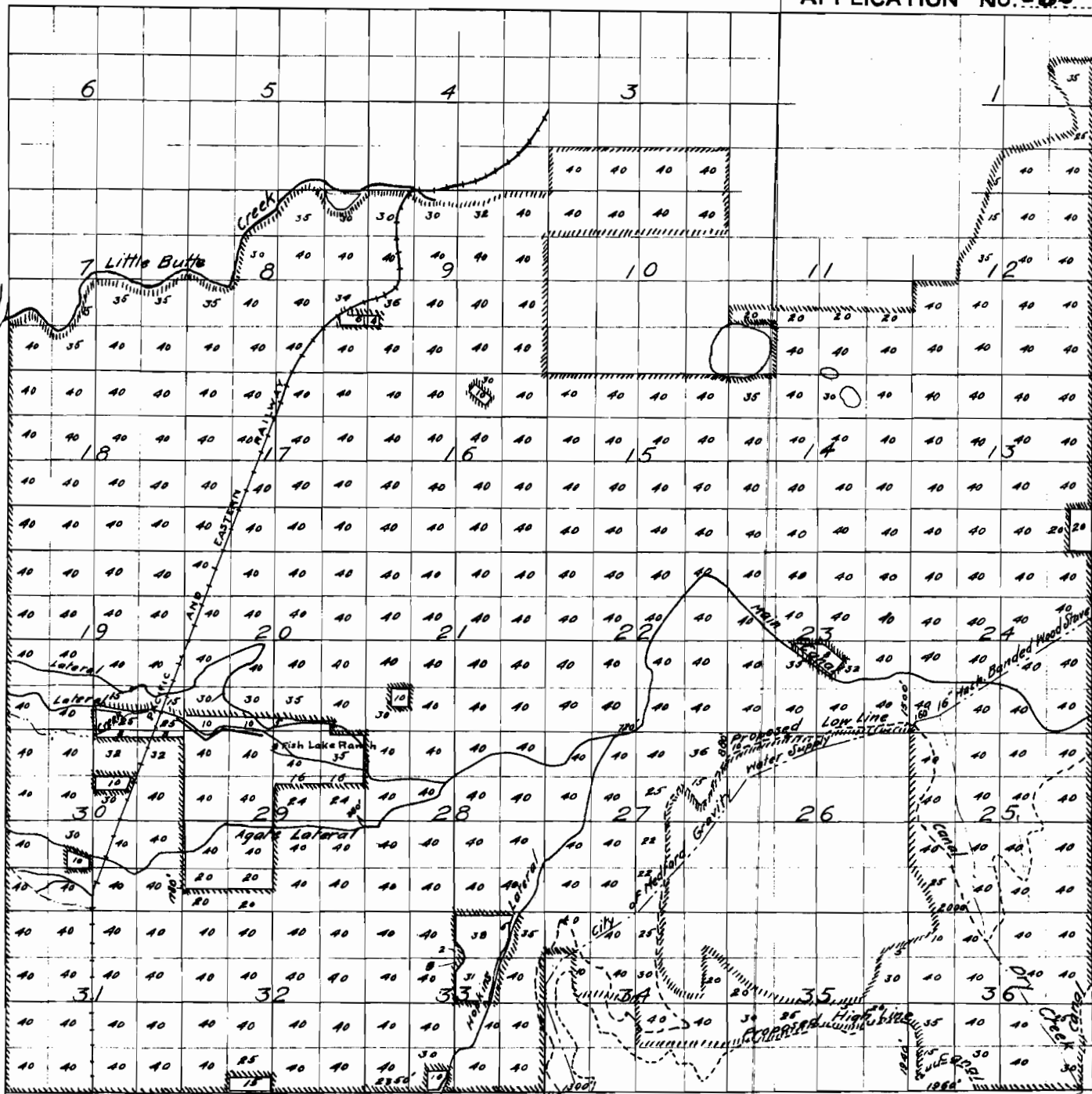

CERTIFICATE OF SURVEYOR

I, Living Northrup, of Medford Oregon do hereby certify that this map was made from notes taken during an actual survey made under my immediate supervision during Apr. May, June, July, Aug. and Sept. 1909 and that it correctly represents the works described in the accompanying application together with the location of streams and other ditches in the immediate vicinity and has written thereon the area in each smallest legal subdivision which is proposed to be surveyed.

Subscribed and sworn to before me this 15th day of May 1910.

Living Northrup Surveyor
Notary Public State of Oregon

NOTARY PUBLIC FOR JACKSON COUNTY, OREGON.
MY COMMISSION EXPIRES JUNE 29, 1911.

LEGEND

 Lands under existing rights.

 Lands applied for.

T 10614

Application No. 589
Permit No. 407

Township 37 S , Range 4 E W M

APPLICATION NO. 589



T 10614

Township 36 S.,

Range 2 W.W.M.

Application No. 589
Enlargement Permit No. 407

APPLICATION NO. 589.

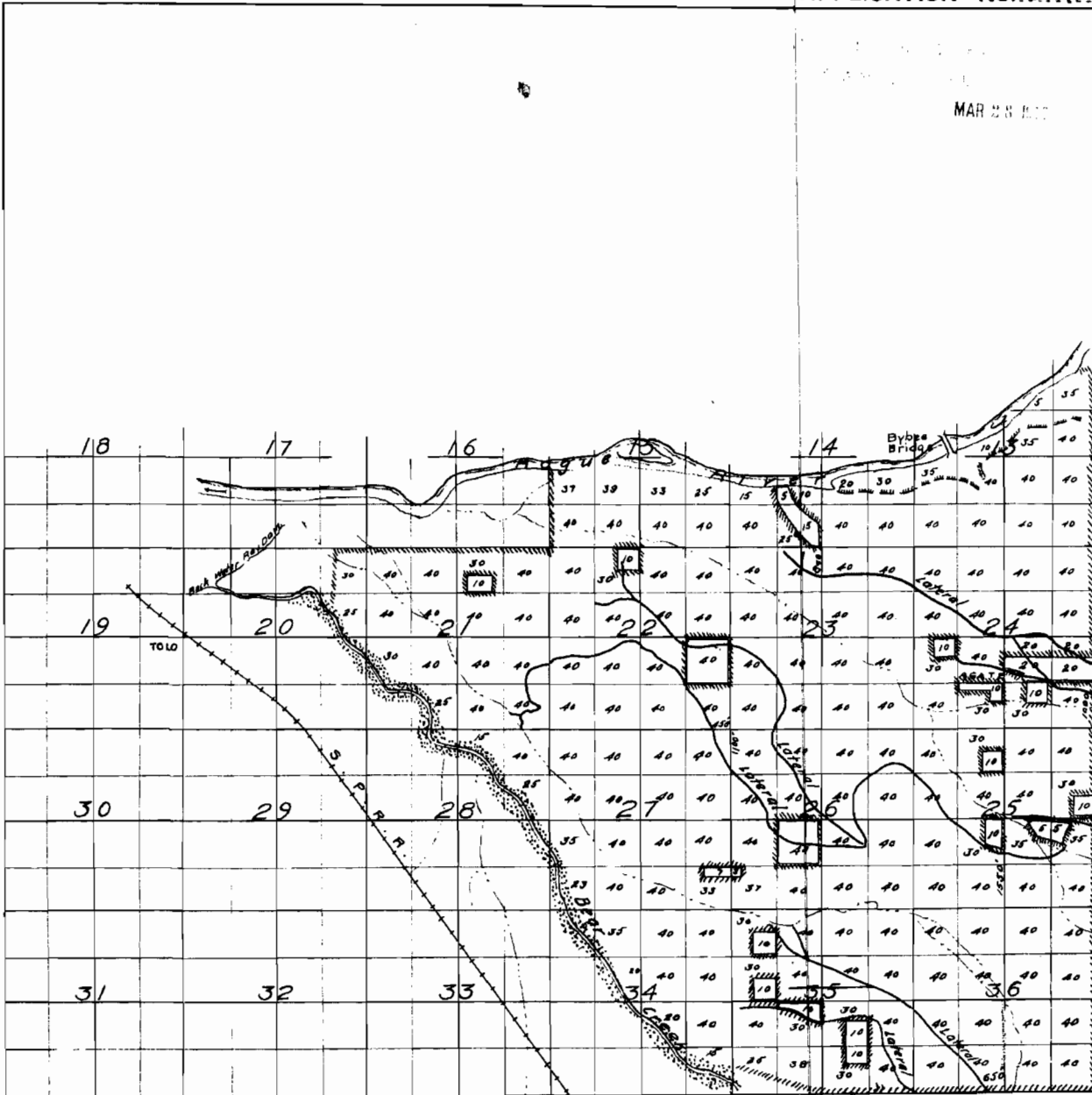



CERTIFICATE OF SURVEYOR

I, Irving Northington of Medford Oregon do hereby certify that this map was made from notes taken during an actual survey made under my immediate supervision during Apr. May, June, July, Aug. and Sept. 1909 and that it correctly represents the works described in the accompanying application together with the location of streams and other ditches in the immediate vicinity and has written thereon the area in each smallest legal subdivision which it is proposed to designate.

Subscribed and sworn to before me this 10th day of - Nov. 1911.

Notary Public State of Oregon.

LEGEND

-  Lands under existing rights.
-  Lands applied for.

NOTARY PUBLIC FOR JACKSON COUNTY, OREGON
BY COMMISSION EXPIRES JUNE 16 1912

T 10614

Township.....36 S.,

Range

3 E.W.M.

Application No. 188
Permit No. 707

APPLICATION NO. 682

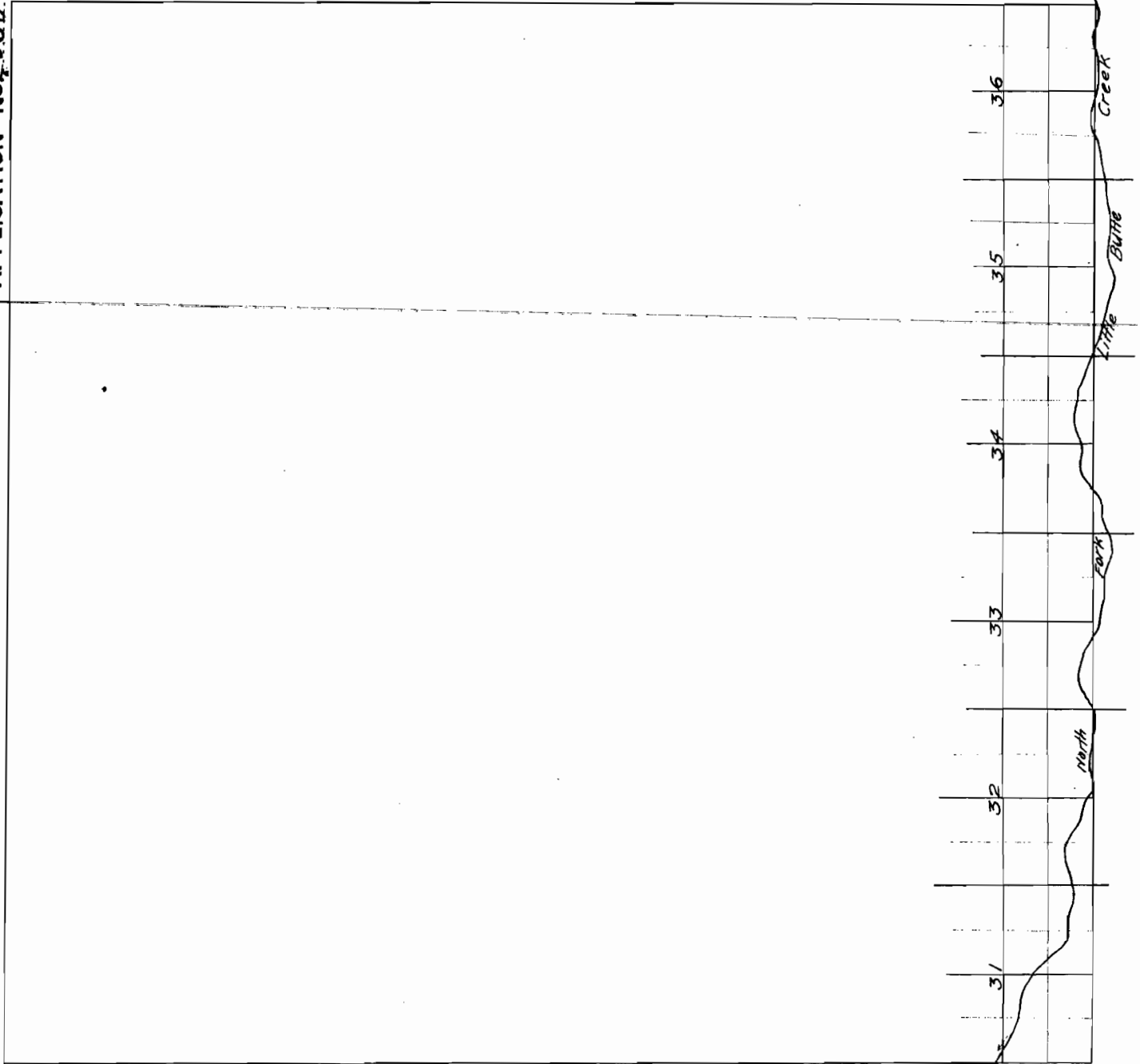

Township 37 S., Range 2 W W M Enlargement Permi. No. 407

APPLICATION NO. 589

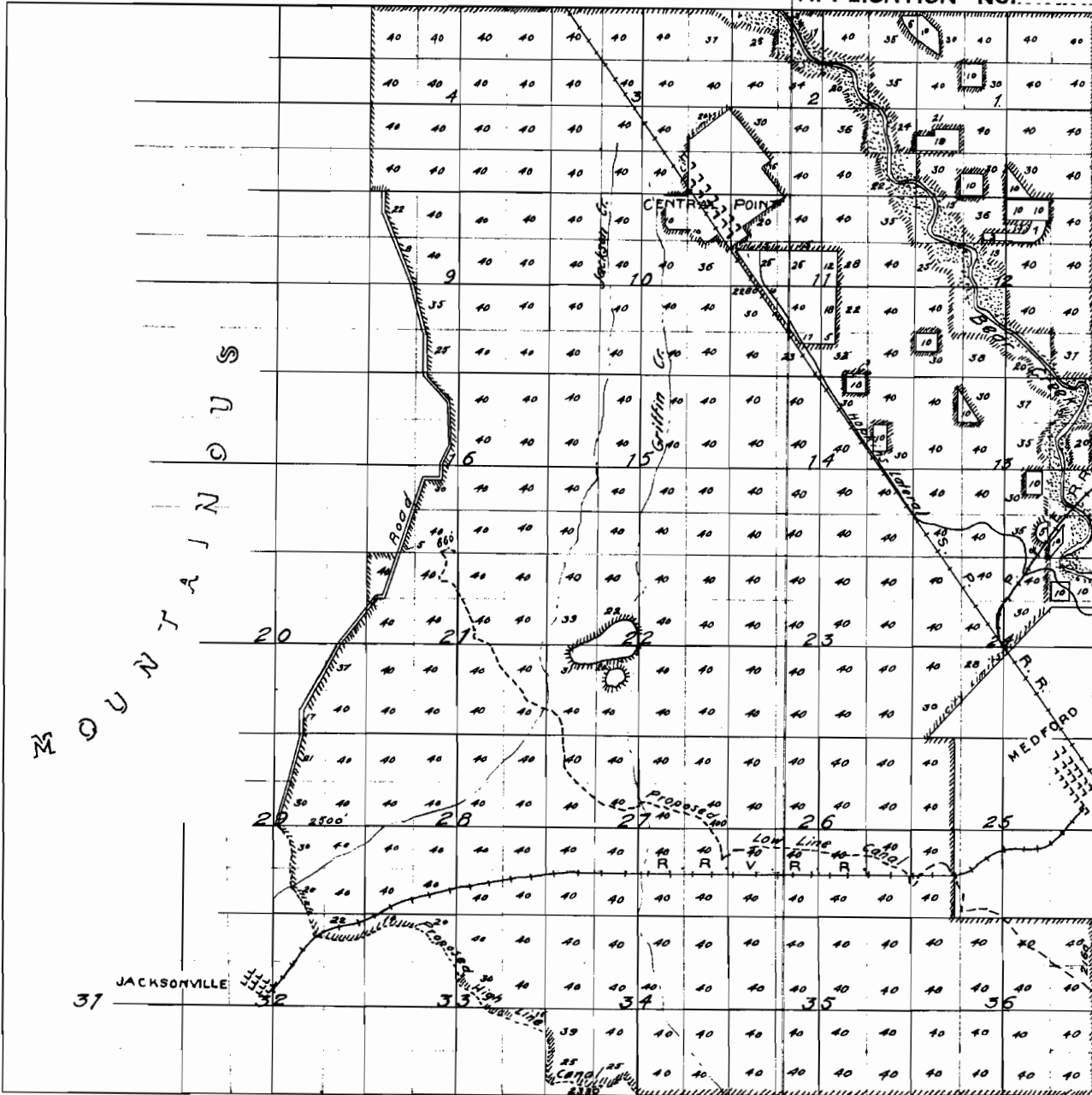

CERTIFICATE OF SURVEYOR

LEGEND

 Lands under existing rights.

 Lands applied for.

I, Irving Northington of Medford Oregon do hereby certify that this map was made from notes taken during an actual survey made under my immediate supervision during the months of May, June, July, Aug. and Sept. 1909 and that it correctly represents the works described in the accompanying application together with the location of streams and other ditches in the immediate vicinity and has written thereon the area in each smallest legal subdivision which I propose to subdivide.

Irving Northington Surveyor

Subscribed and sworn to before me this 19th day of July 1910

H. H. King
Notary Public State of Oregon.

NOTARY PUBLIC FOR JACKSON COUNTY, OREGON
BY COMMISSION EXPIRES JUNE 28, 1911

Township 37 S., Range 1 W.W.M.

Application No 589
 Enclosure Permit No. 407

APPLICATION NO. 589

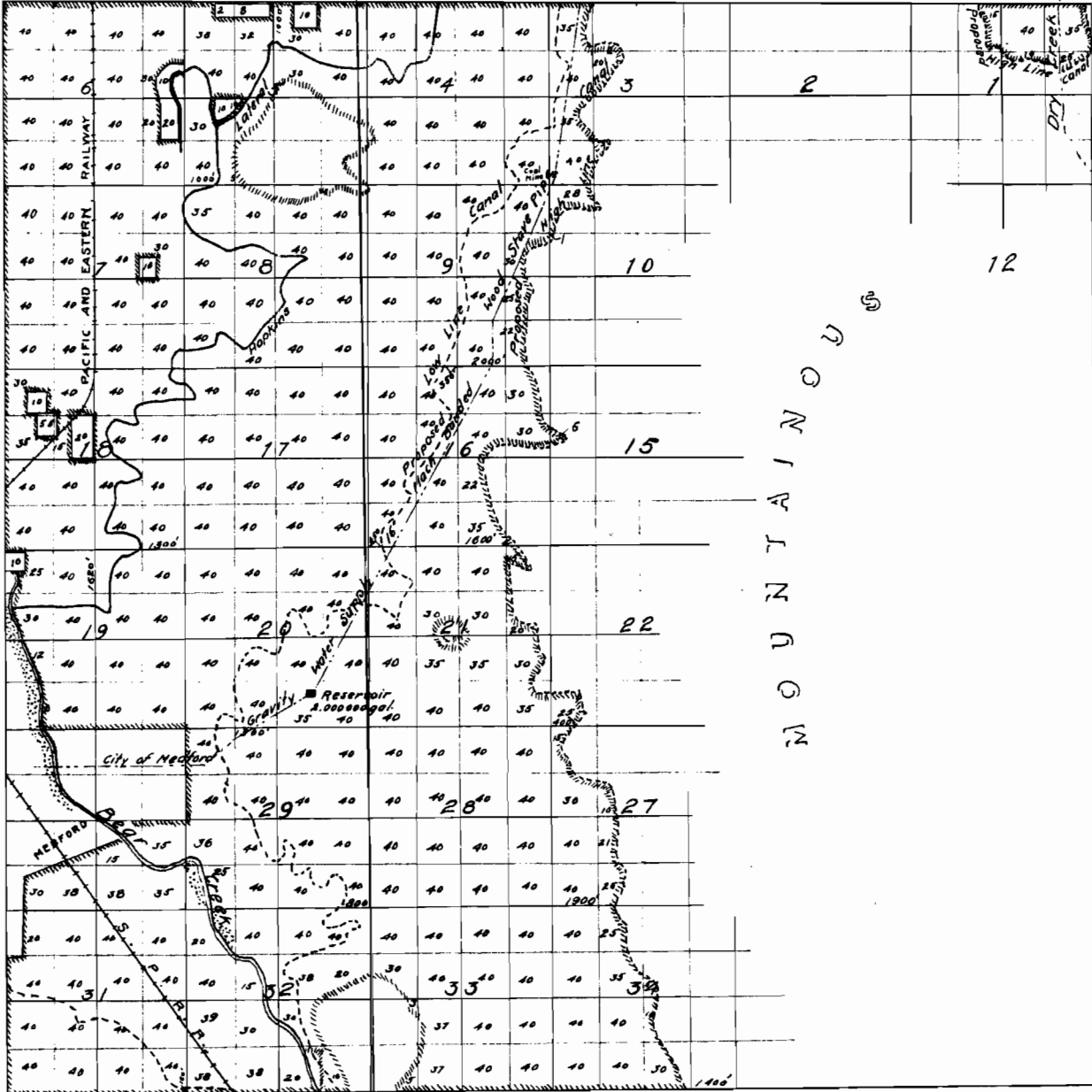

MOUNTAINOUS

CERTIFICATE OF SURVEY OR

I, Levin Northington, of Medford Oregon do hereby certify that this map was made from notes taken during an actual survey made under my immediate supervision during the months of May, June, July, Aug and Sept. 1909 and that it correctly represents the marks described in the accompanying application together with the location of streams and other ditches in the immediate vicinity and has written thereon the area in each smallest legal subdivision which is proposed to irrigate.

- LEGEND
- 10 Lands under existing rights.
 - 10 Lands applied for.

Subscribed and sworn to before me this 10 day of Sept 1910.

Notary Public State of Oregon.

NOTE: LABEL FOR JACKSON COOP. "MOUNTAINOUS" LETTERS MUST BE 24, 3

T 10614

MAR 25 1910

Township 3 S S,

Range 1 W W M.

Application No. 587
Enlargement Permit No. 407
APPLICATION NO. 51

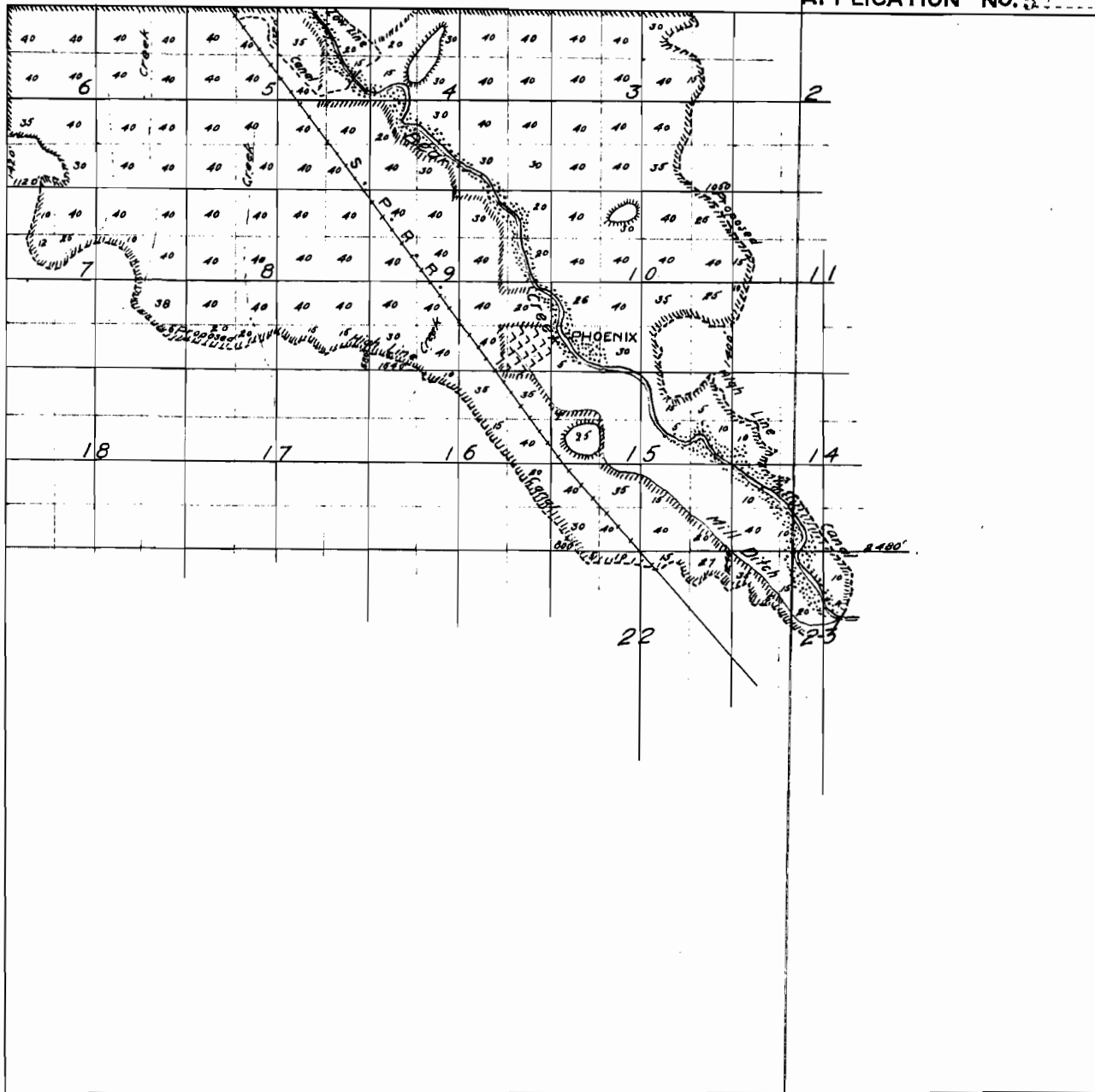



CERTIFICATE OF SURVEYOR

I, Irving M. Worthington, of Medford Oregon do hereby certify that this map was made from notes taken during an actual survey made under my immediate supervision during Apr. May, June, July, Aug. and Sept. 1909 and that it correctly represents the works described in the accompanying application together with the location of streams and other ditches in the immediate vicinity and has written thereon the area in each smallest legal subdivision which it is proposed to include.

Subscribed and sworn to before me this 10th day of June 1910
J. C. Nix
 Notary Public State of Oregon.

LEGEND

-  Lands under existing rights
-  Lands applied for.

NOTES: 4405 JOURNAL COUNTY OF ORON
 #1 22-23-24-25-26-27-28-29-30-31-32-33-34-35-36-37-38-39-40-41-42-43-44-45-46-47-48-49-50-51-52-53-54-55-56-57-58-59-60-61-62-63-64-65-66-67-68-69-70-71-72-73-74-75-76-77-78-79-80-81-82-83-84-85-86-87-88-89-90-91-92-93-94-95-96-97-98-99-100-101-102-103-104-105-106-107-108-109-110-111-112-113-114-115-116-117-118-119-120-121-122-123-124-125-126-127-128-129-130-131-132-133-134-135-136-137-138-139-140-141-142-143-144-145-146-147-148-149-150-151-152-153-154-155-156-157-158-159-160-161-162-163-164-165-166-167-168-169-170-171-172-173-174-175-176-177-178-179-180-181-182-183-184-185-186-187-188-189-190-191-192-193-194-195-196-197-198-199-200-201-202-203-204-205-206-207-208-209-210-211-212-213-214-215-216-217-218-219-220-221-222-223-224-225-226-227-228-229-230-231-232-233-234-235-236-237-238-239-240-241-242-243-244-245-246-247-248-249-250-251-252-253-254-255-256-257-258-259-260-261-262-263-264-265-266-267-268-269-270-271-272-273-274-275-276-277-278-279-280-281-282-283-284-285-286-287-288-289-290-291-292-293-294-295-296-297-298-299-300-301-302-303-304-305-306-307-308-309-310-311-312-313-314-315-316-317-318-319-320-321-322-323-324-325-326-327-328-329-330-331-332-333-334-335-336-337-338-339-340-341-342-343-344-345-346-347-348-349-350-351-352-353-354-355-356-357-358-359-360-361-362-363-364-365-366-367-368-369-370-371-372-373-374-375-376-377-378-379-380-381-382-383-384-385-386-387-388-389-390-391-392-393-394-395-396-397-398-399-400-401-402-403-404-405-406-407-408-409-410-411-412-413-414-415-416-417-418-419-420-421-422-423-424-425-426-427-428-429-430-431-432-433-434-435-436-437-438-439-440-441-442-443-444-445-446-447-448-449-450-451-452-453-454-455-456-457-458-459-460-461-462-463-464-465-466-467-468-469-470-471-472-473-474-475-476-477-478-479-480-481-482-483-484-485-486-487-488-489-490-491-492-493-494-495-496-497-498-499-500-501-502-503-504-505-506-507-508-509-510-511-512-513-514-515-516-517-518-519-520-521-522-523-524-525-526-527-528-529-530-531-532-533-534-535-536-537-538-539-540-541-542-543-544-545-546-547-548-549-550-551-552-553-554-555-556-557-558-559-560-561-562-563-564-565-566-567-568-569-570-571-572-573-574-575-576-577-578-579-580-581-582-583-584-585-586-587-588-589-590-591-592-593-594-595-596-597-598-599-600-601-602-603-604-605-606-607-608-609-610-611-612-613-614-615-616-617-618-619-620-621-622-623-624-625-626-627-628-629-630-631-632-633-634-635-636-637-638-639-640-641-642-643-644-645-646-647-648-649-650-651-652-653-654-655-656-657-658-659-660-661-662-663-664-665-666-667-668-669-670-671-672-673-674-675-676-677-678-679-680-681-682-683-684-685-686-687-688-689-690-691-692-693-694-695-696-697-698-699-700-701-702-703-704-705-706-707-708-709-710-711-712-713-714-715-716-717-718-719-720-721-722-723-724-725-726-727-728-729-730-731-732-733-734-735-736-737-738-739-740-741-742-743-744-745-746-747-748-749-750-751-752-753-754-755-756-757-758-759-760-761-762-763-764-765-766-767-768-769-770-771-772-773-774-775-776-777-778-779-780-781-782-783-784-785-786-787-788-789-790-791-792-793-794-795-796-797-798-799-800-801-802-803-804-805-806-807-808-809-810-811-812-813-814-815-816-817-818-819-820-821-822-823-824-825-826-827-828-829-830-831-832-833-834-835-836-837-838-839-840-841-842-843-844-845-846-847-848-849-850-851-852-853-854-855-856-857-858-859-860-861-862-863-864-865-866-867-868-869-870-871-872-873-874-875-876-877-878-879-880-881-882-883-884-885-886-887-888-889-890-891-892-893-894-895-896-897-898-899-900-901-902-903-904-905-906-907-908-909-910-911-912-913-914-915-916-917-918-919-920-921-922-923-924-925-926-927-928-929-930-931-932-933-934-935-936-937-938-939-940-941-942-943-944-945-946-947-948-949-950-951-952-953-954-955-956-957-958-959-960-961-962-963-964-965-966-967-968-969-970-971-972-973-974-975-976-977-978-979-980-981-982-983-984-985-986-987-988-989-990-991-992-993-994-995-996-997-998-999-1000

T 10614

Township

38 S,

Range

2 W.W.M.

MAY 11 1910

Application No. 590

Permit No. 407

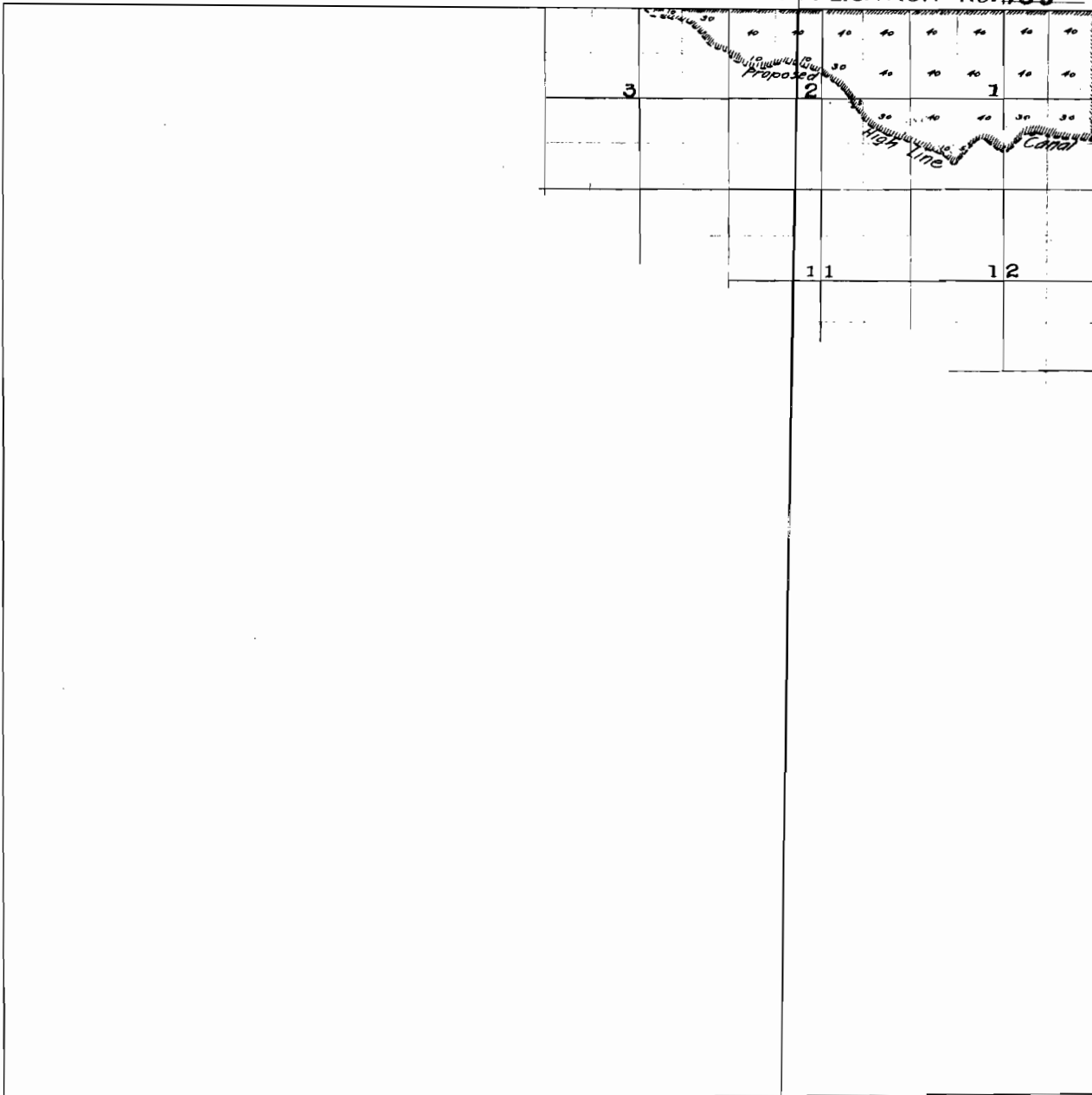

APPLICATION NO. 590



CERTIFICATE OF SURVEYOR

I, Irving Weatherston, of Medford Oregon do hereby certify that this map was made from notes taken during an actual survey made under my immediate supervision during Apr. May, June, July Aug and Sept. 1909 and that it correctly represents the works described in the accompanying application together with the location of streams and other ditches in the immediate vicinity and has written thereon the area in each smallest legal subdivision which is proposed to irrigate.

LEGEND

-  Lands under existing rights
-  Lands applied for.

Subscribed and sworn to before me this 10th day of June 1910

Irving Weatherston
 Notary Public State of Oregon
 PUBLIC FOR JACKSON COUNTY, OREGON

NOTARY PUBLIC STATE OF OREGON
PUBLIC FOR JACKSON COUNTY, OREGON
EXPIRES JUNE 26 1911

**Vacinity Map
Water Right Transfer**

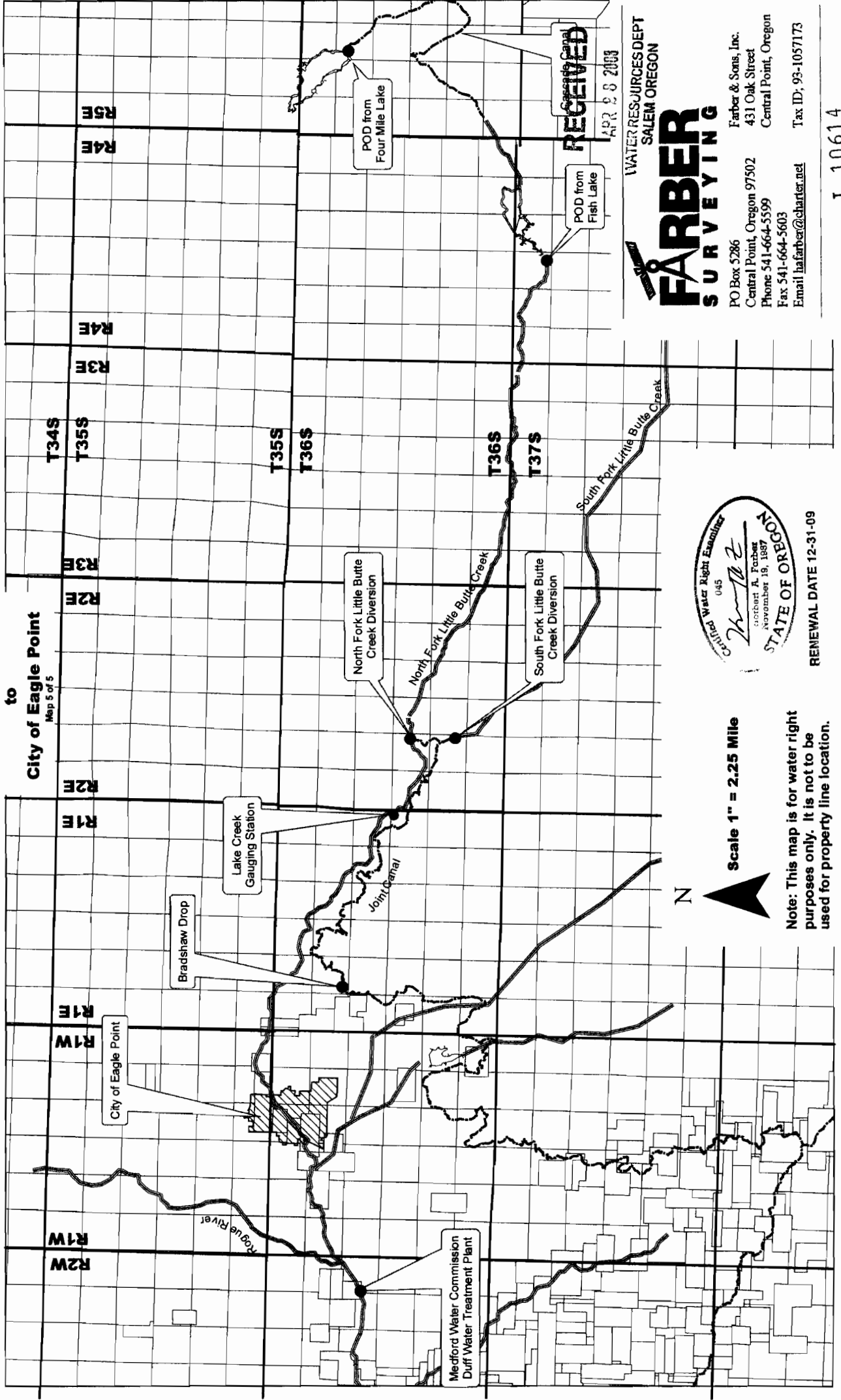

to
City of Eagle Point
Map 5 of 5

R2E R1E R1W R2W

R3E R3F R3S

T34S T35S

R2E R1E R1W R2W

R3E R3F R3S

T35S T36S

R2E R1E R1W R2W

R3E R3F R3S

T36S T37S

R2E R1E R1W R2W

R3E R3F R3S

T34S T35S

WATER RESOURCES DEPT
SALEM OREGON

FARBER SURVEYING

PO Box 5286
Central Point, Oregon 97502
Phone 541-664-5599
Fax 541-664-5603
Email hfarber@charter.net

Farber & Sons, Inc.
431 Oak Street
Central Point, Oregon
Tax ID: 93-1057173

RECEIVED
APR 28 2009



RENEWAL DATE 12-31-09



Scale 1" = 2.25 Mile

Note: This map is for water right purposes only. It is not to be used for property line location.

T 10614

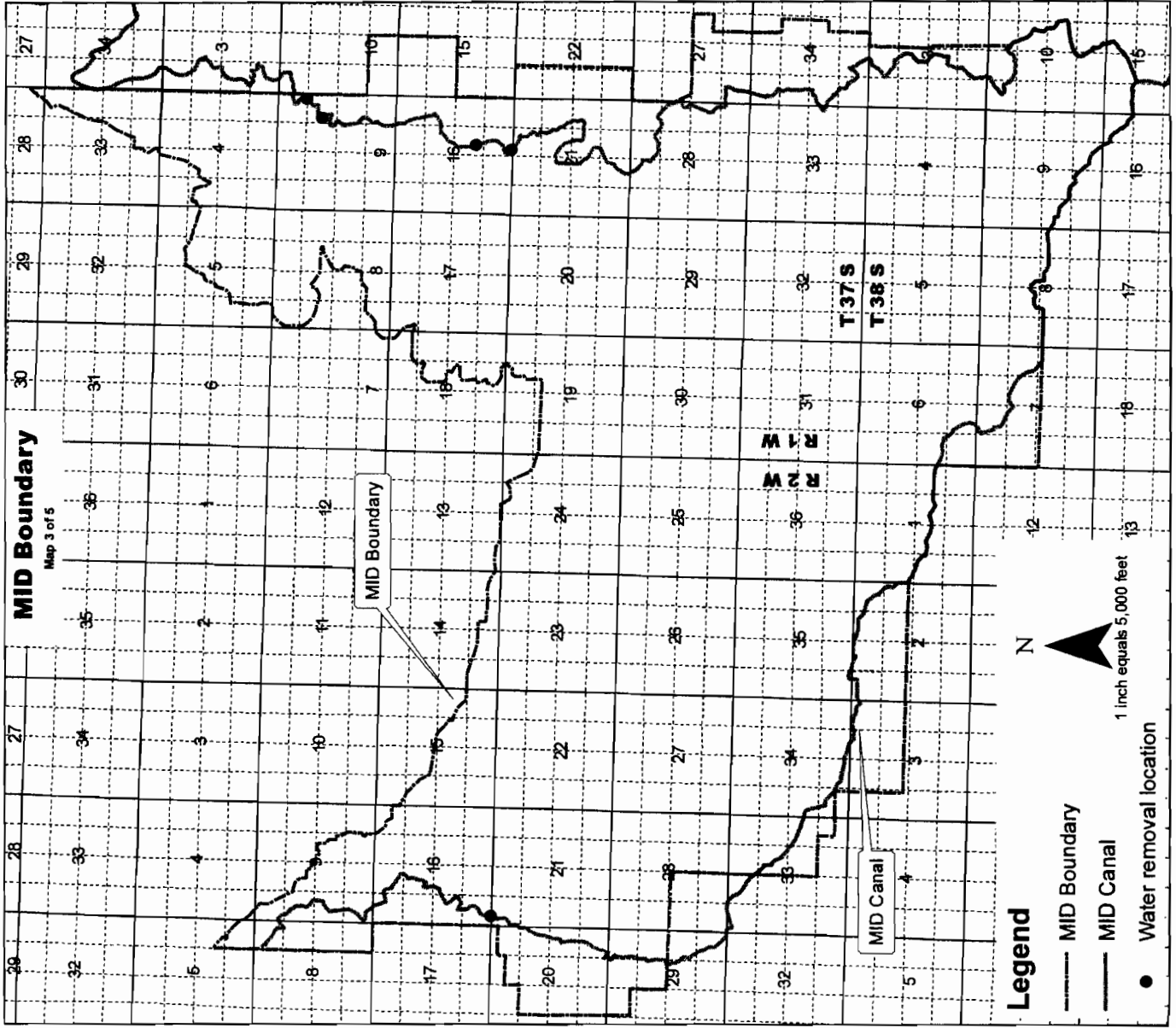

POD Maps
Map 3 of 5

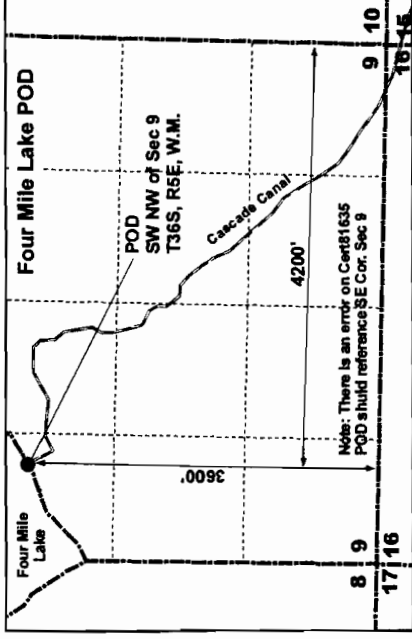

Note: This map is for water right use only. It is not to be used for property line location.

N



POD Maps
Scale 1" = 1320'

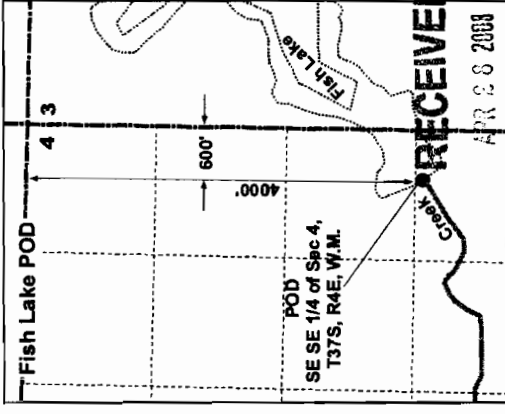
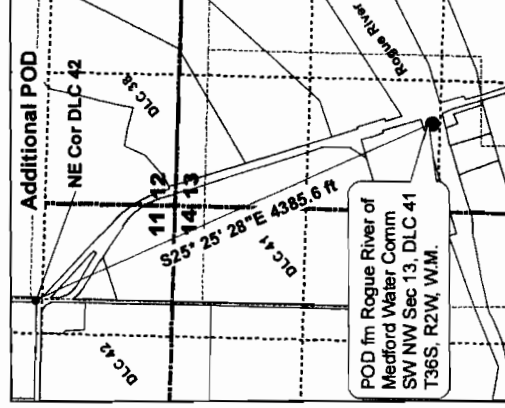

RECEIVED

APR 28 2008

WATER RESOURCES DEPT
SALEM OREGON



RENEWAL DATE 12-31-09

FARBER SURVEYING

Farber & Sons, Inc.
PO Box 5286
Central Point, Oregon 97502
Phone 541-664-5599
Fax 541-664-5603
Email farber@farber.net
Tax ID: 99-1057173

T 10614