

Scale: 1:24000



RECEIVED

APR 25 2008

WATER RESOURCES DEPT
SALEM, OREGON



Source: Seamless USGS Topographic Maps
on CD-ROM, National Geographic

Figure A-1. Well Locations

Arrowhead Farms, Inc.; Westwood Farms, Inc.;
and Echo Ridge Farms, Inc.
Stream Depletion Modeling
Surface to Ground Water Transfer Application

Pacific Hydro-Geology Inc.

4/2008

ColemanFigA-1.cdr

T 10602

T. 6 S.R.3W.W. M.

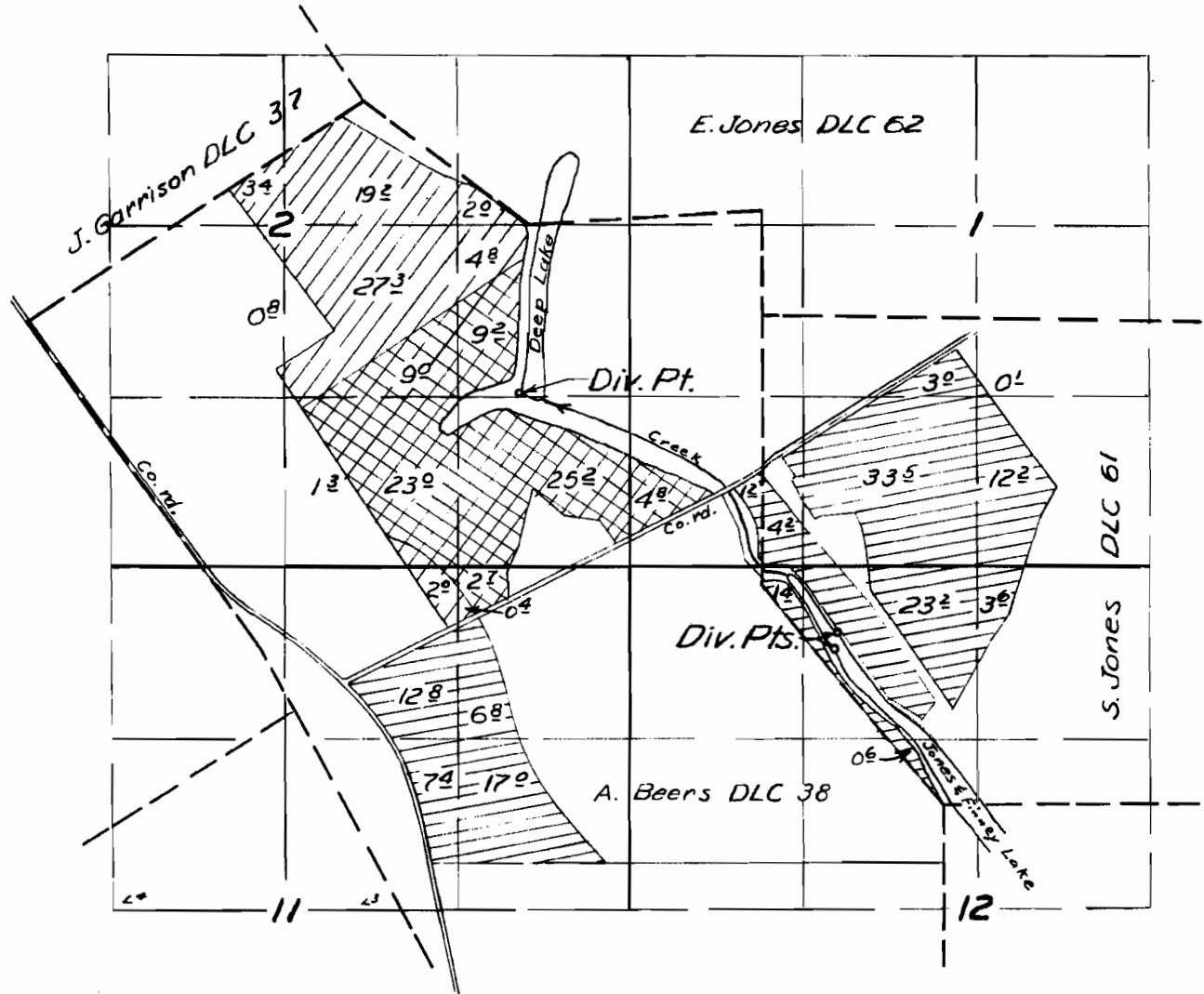

FINAL PROOF SURVEY

UNDER

Application No. 28286 Permit No. 22354.
IN NAME OF

Creighton B. Jones

Surveyed 5 Sept. 1956, by Tom Bick

From Deep Lake Prim. Supp.
From Jones & Finney Lake

1956 K
DFN-3D-50

T 10602

T. 6S., R. 3W., W.M.

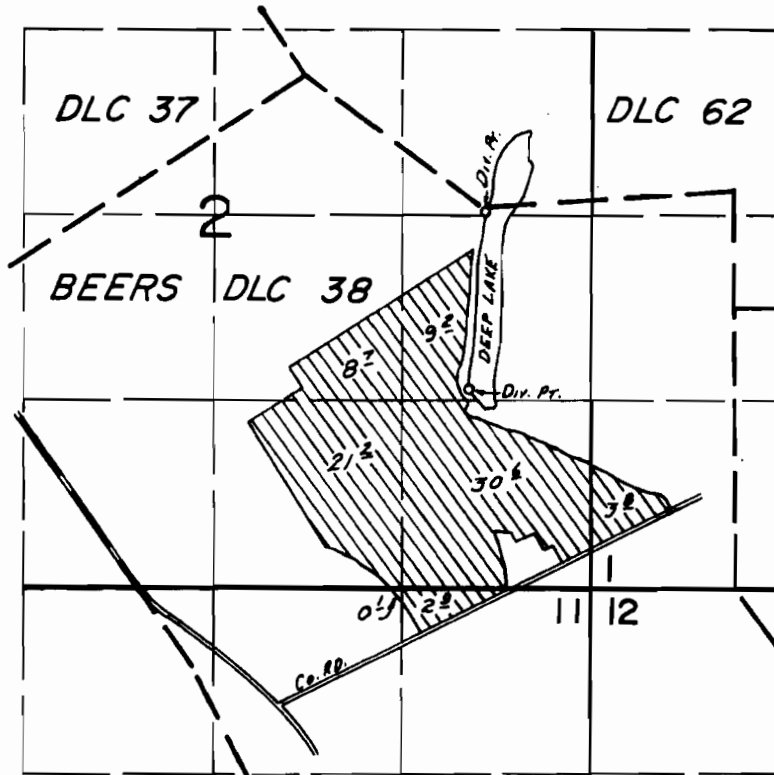

DIV. PR. LOC.: 970 S. & 1280 E., AND 2240 S. & 1170 E., BOTH FROM THE MOST NORTHERLY COR. BEERS DLC 38.

SCALE: 1"=1320'

FINAL PROOF SURVEY UNDER

Application No. 56052.. Permit No. 43640.....
IN NAME OF

.....PHILLIP H. GOULET.....

Surveyed May 16.... 1984, by B.W. BISHOP.....

T 10602