

RECEIVED
MAY 06 2008
WATER RESOURCES DEPT
SALEM, OREGON

TOWNSHIP 2 SOUTH, RANGE 26 EAST, W.M.

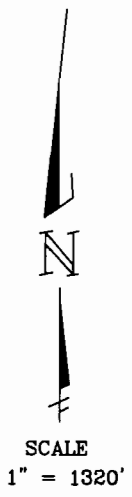
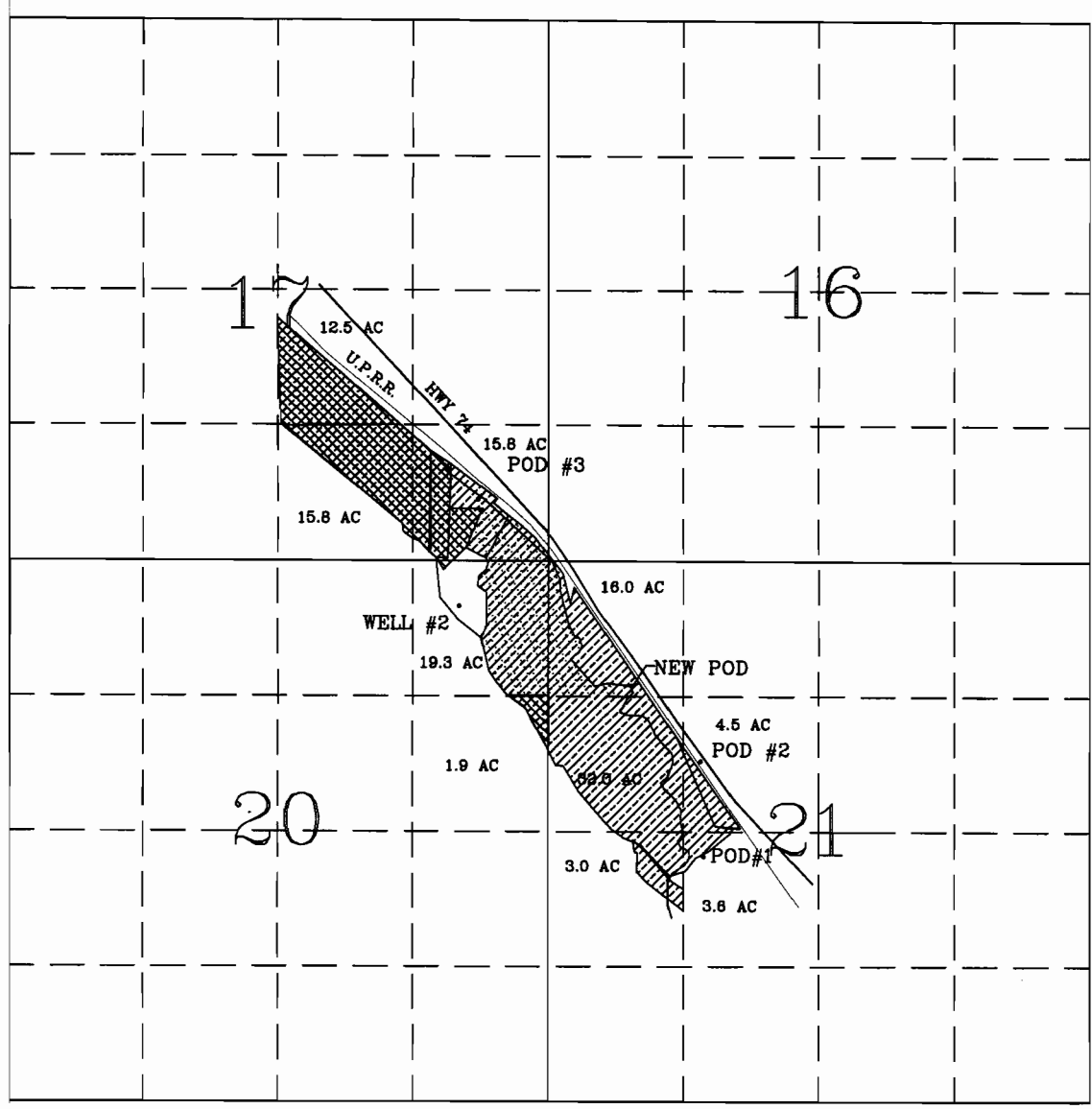

EXISTING GROUND WATER RIGHT PER PERMITS #G-7210, G-7211 & G15697
EXISTING SURFACE WATER RIGHT PER PERMITS #T-3207

- DENOTES AREA OF EXISTING GROUND WATER RIGHTS
- DENOTES AREA OF EXISTING SURFACE WATER RIGHTS

CHANGE OF DIVERSION
&
SUPPLEMENTAL APPLICATION MAP
FOR

BERNARD & JEAN DAMON
2315 ROCKY LANE
EUGENE, OR, 97401
541-686-2590

BY
H. TIMOTHY FASSBENDER, PLS,CWRE
28796 SARAH LANE
EUGENE, OR 97408
541-485-3136

NEW DIVERSION POINT LOCATION
815 FEET EAST & 1215 FEET NORTH
OF SOUTHWEST CORNER OF THE SOUTHWEST
CORNER OF SECTION 21

EXISTING DIVERSION POINT LOCATION
POD #2 1120 FEET WEST & 240 FEET SOUTH
OF CENTER OF SECTION 21

POD #3 680 FEET WEST & 600 FEET NORTH
OF SOUTHWEST CORNER OF THE SOUTHWEST
CORNER OF SECTION 17

WELL #2 870 FEET WEST & 440 FEET SOUTH
OF NORTHEAST CORNER OF SECTION 20

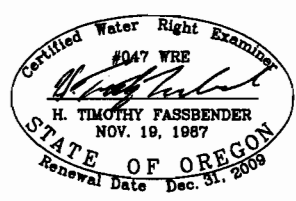

NOTE:
THIS MAP IS NOT INTENDED TO PROVIDE LEGAL DIMENSIONS
OR LOCATION OF OWNERSHIP LINES.

RECEIVED

MAY 06 2008

WATER RESOURCES DEPT
SALEM, OREGON

Township 2 S.

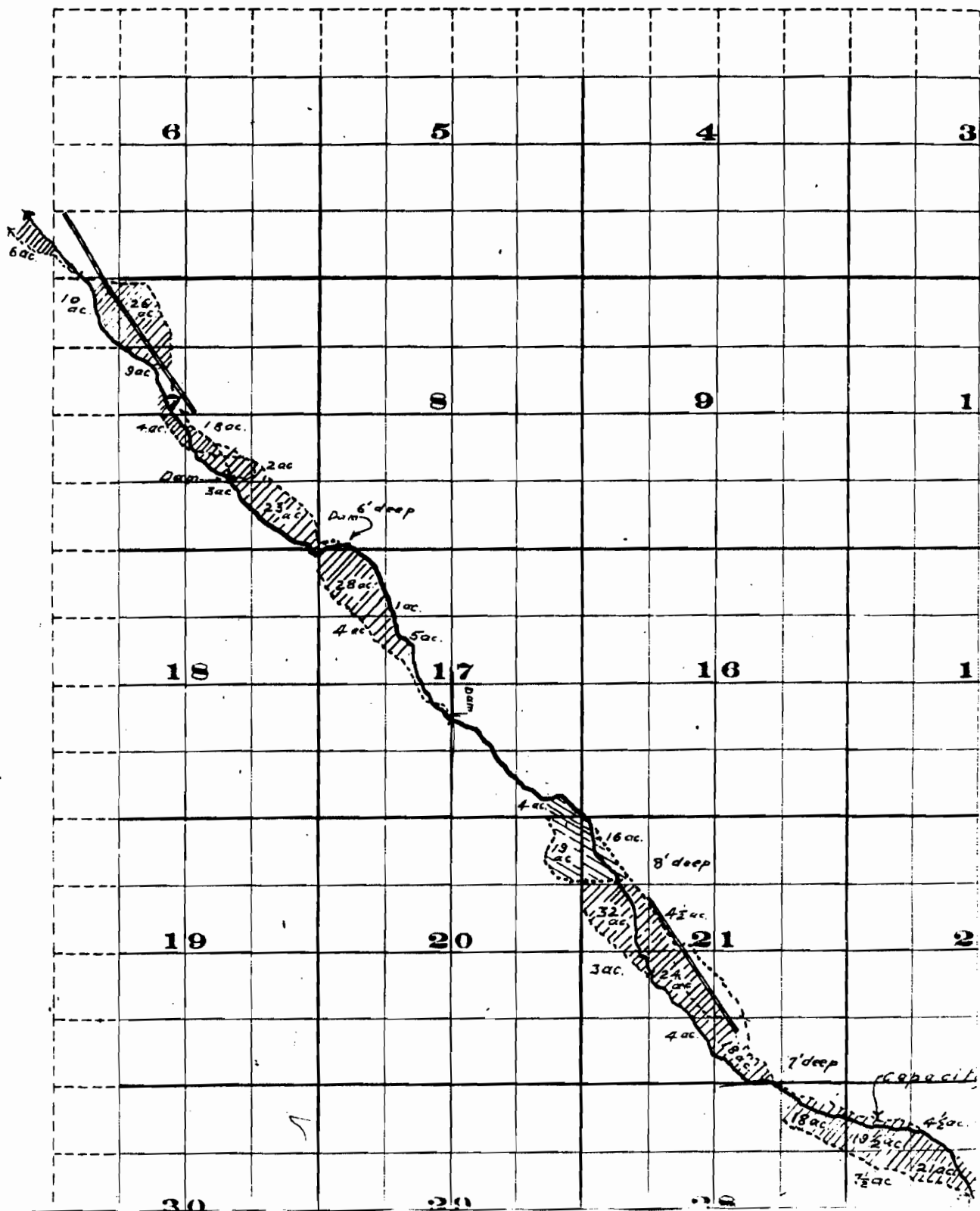

S. , Range 26 E. W. M. .

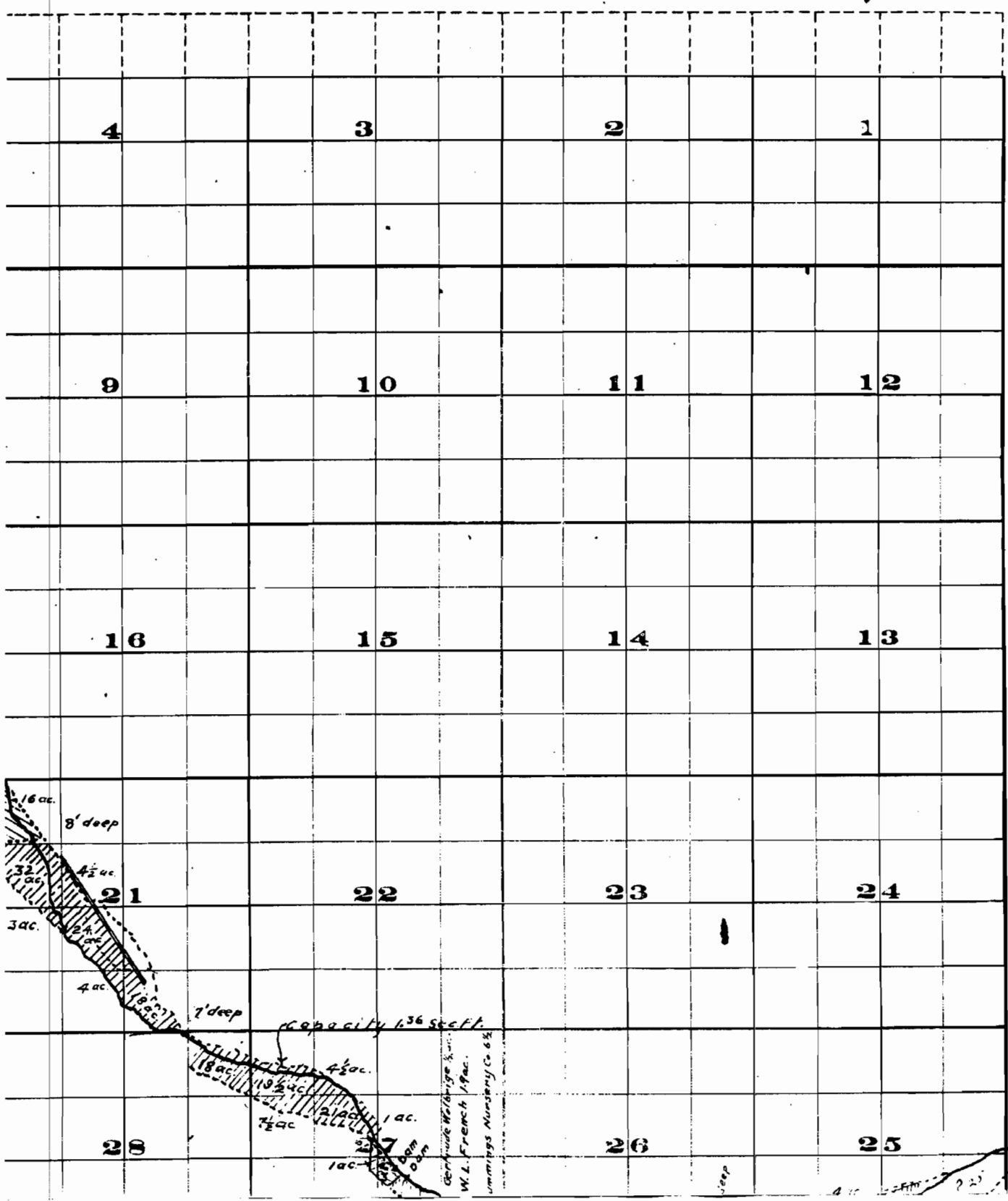

Township 2 S. ,

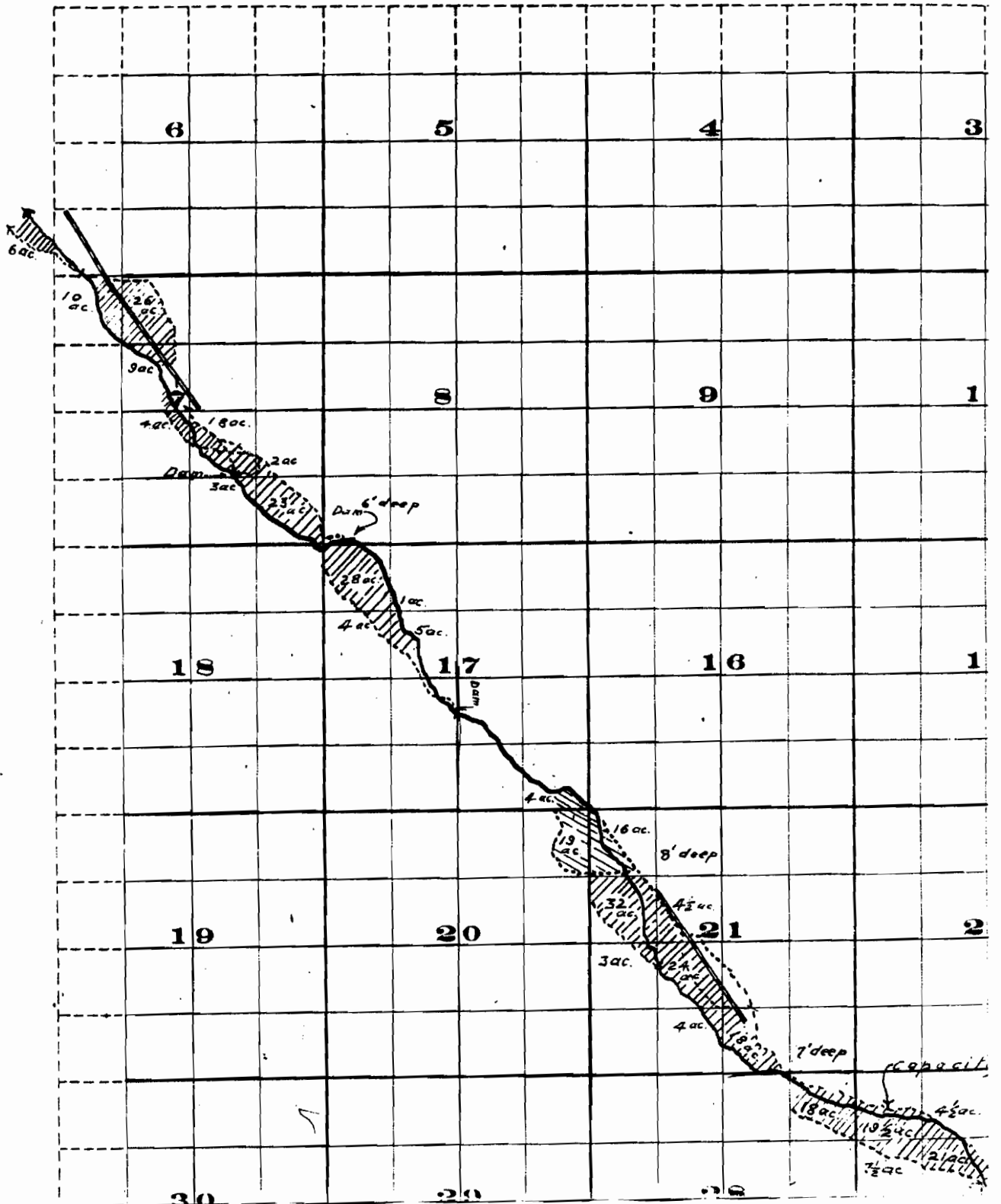

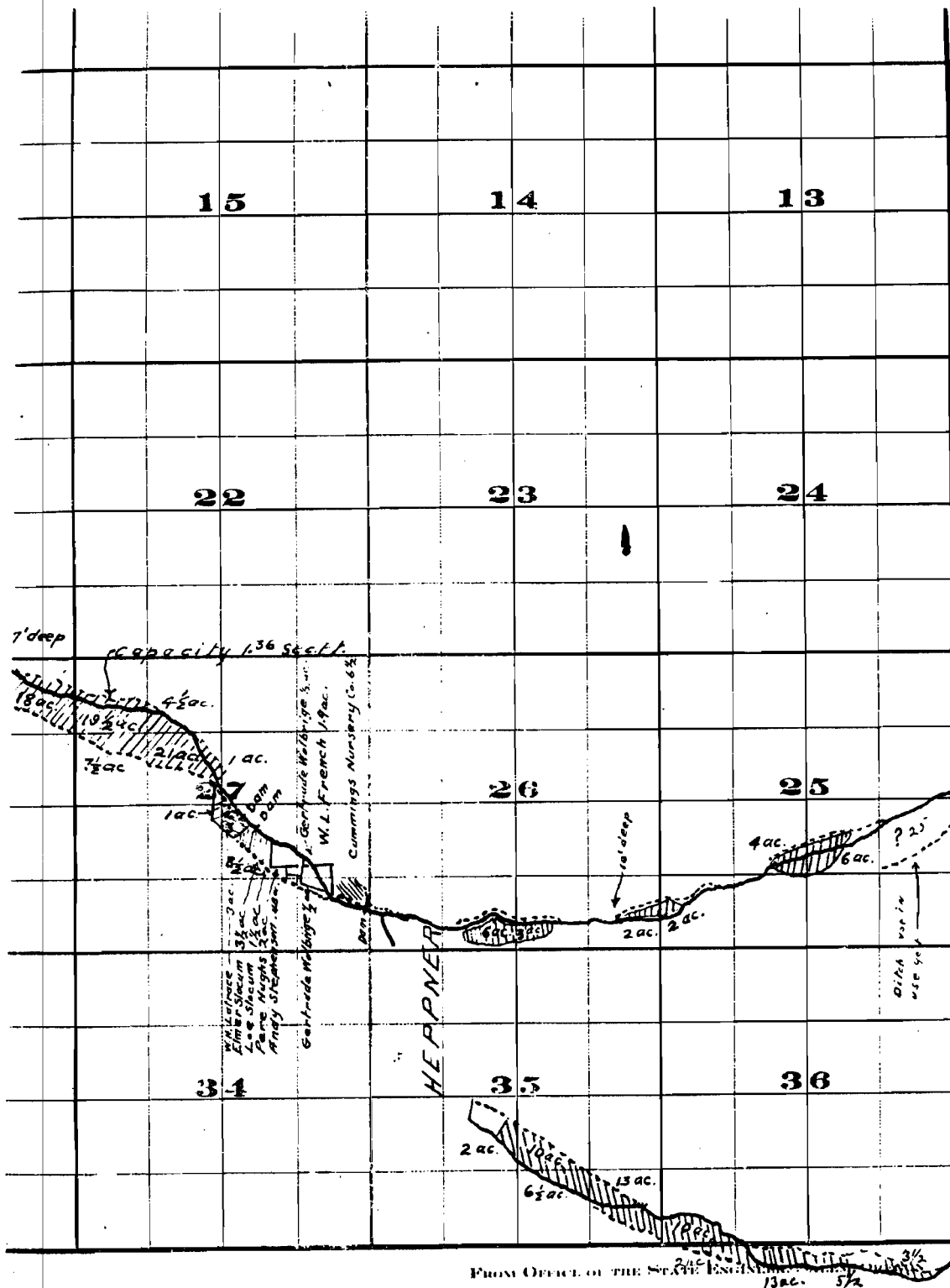

FROM OFFICE OF THE STATE ENGINEER

Willow Creek Adjudication



Part 35.26
25.26

T. 2S., R. 26E., W.M.

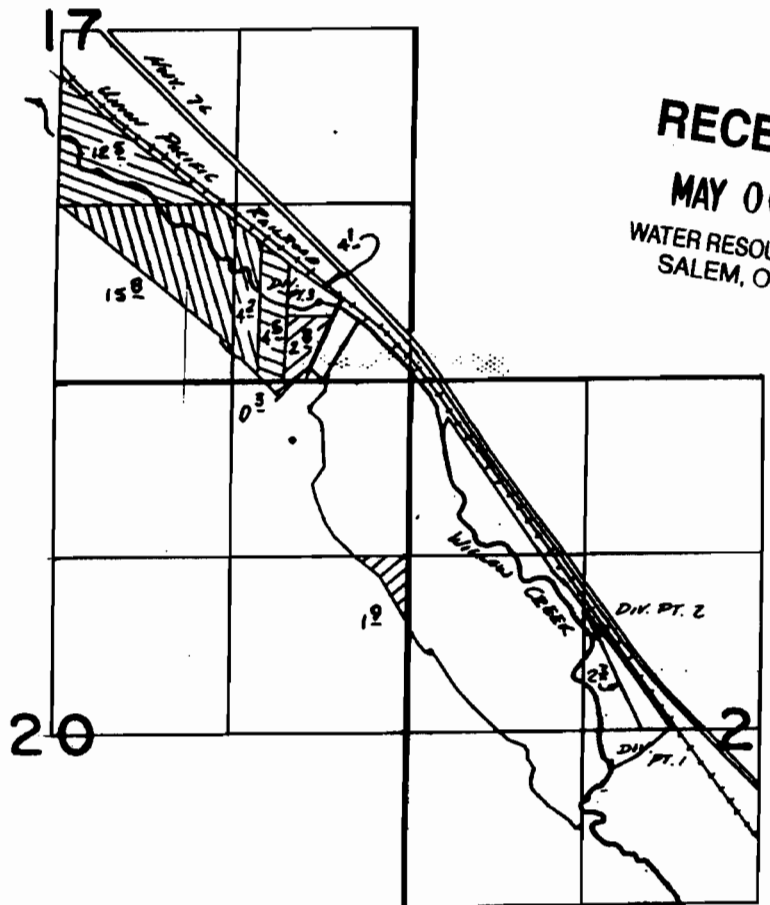

RECEIVED
MAY 06 2008
 WATER RESOURCES DEPT
 SALEM, OREGON

DIV. PT. 1 240'S & 1120'W FROM CENTER SEC. 21
DIV. PT. 2 1930'S & 1490'E. FROM NW COR. SEC. 21
DIV. PT. 3 600'N. & 600'W. FROM SE COR. SEC. 17

FINAL PROOF SURVEY
 UNDER

TRANSFER 3207

-  1891
-  1884
-  1889

IN NAME OF
MRS. ANNA GRAHAM

Surveyed Oct. 11, 1982., by K.L. CONNER

529

T. 2S., R. 26E., W.M.

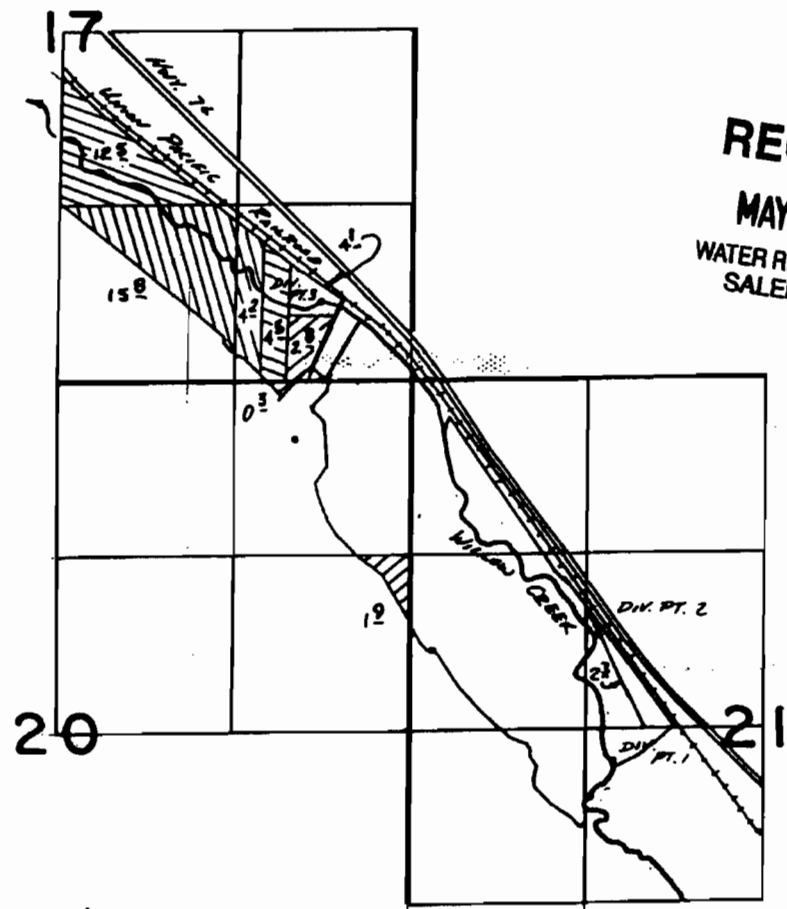

RECEIVED
MAY 06 2008
 WATER RESOURCES DEPT
 SALEM, OREGON

DIV. PT. 1 840'S & 1160'W FROM CENTER SEC. 21
 DIV. PT. 2 1930'S & 1470'E. FROM NW COR. SEC. 21
 DIV. PT. 3 600' N. & 600' W. FROM SE COR. SEC. 17

FINAL PROOF SURVEY
 UNDER

TRANSFER 3207

-  1891
-  1884
-  1889

IN NAME OF

MRS. ANNA GRAHAM

Surveyed Oct. 11, 1982, by K.L. Cramer

0.29