



State of Oregon  
Water Resources Department  
725 Summer Street NE, Suite A  
Salem, Oregon 97301-1266  
(503) 986-0900

# Application for Instream Lease

A summary of review criteria and procedures that are generally applicable to these applications is available at [www.wrd.state.or.us/OWRD/PUBS/forms.shtml](http://www.wrd.state.or.us/OWRD/PUBS/forms.shtml).

## Pursuant to ORS 537.348(2) and OAR 690-077

Optional Identification by Lessor/Lessee E Pt. \_\_\_\_\_  
Lease Application Number (assigned by WRD): \_\_\_\_\_

This Lease is between:

**Lessor #1**

**Co-lessor:**

Name Rogue River Valley Irrigation District  
Mailing address 3139 Merriman Road  
City, State, Zip Code Medford, OR 97501  
Telephone number 541-773-6127  
Email address ravid@charterinternet.com

Please also notify  
Steve Shropshire, Attorney for RRVID  
PO Box 230699  
Portland OR, 97281  
E-mail: [steve.shropshire@jordanschrader.com](mailto:steve.shropshire@jordanschrader.com)

**Lessor #2, 3, etc.**

**Co-lessor**

Name City of Eagle Point  
Mailing address PO Box 779  
City, State, Zip Code Eagle Point and 97524  
Telephone number 541-826-4212  
Email address davidhussell@cityofeaglepoint.org

Please also notify  
Joe Kellerman, Attorney for City of Eagle Point  
717 Murphy Road  
Medford, OR 97504  
E-mail: [jek@roguelaw.com](mailto:jek@roguelaw.com)

The water right to be leased is located in Jackson County.

**Lessee (if different than Oregon Water Resources Department):**

Name Oregon Water Trust  
Mailing address 522 SW Fifth Avenue, Suite 825  
City, State, Zip Code Portland, OR 97204  
Telephone number 503-525-0141  
Email address steve@owt.org

**RECEIVED**

**JUN 30 2008**

**WATER RESOURCES DEPT  
SALEM, OREGON**

**Trustee:**

Oregon Water Resources Department  
725 Summer Street NE, Suite A  
Salem, OR 97301-1266  
(503) 986-0900

**~I~ Water Right Holder and Water Right Information**

~~1.1~~ Lessor #1 is the water right holder, or authorized agent for water right holder of the property located at: Township \_\_\_\_\_ N, Range \_\_\_\_\_ W, Section \_\_\_\_\_ and Tax Lot number \_\_\_\_\_. If the water right appurtenant to these lands is also appurtenant to lands owned by others who are not included in this application, then Attachment 1 (tax lot map), needs to be included.

1.1 Jointly, the co-lessors have the authority to deliver to and use the water on lands described in T-10160, located at: Township 35 and 36 S, Range 1 W, Sections 34, 35, 2, 3, 4, 9, 10, 11 and Tax Lot numbers N/A. Please see attached map. If the water right appurtenant to these lands is also appurtenant to lands owned by others who are not included in this application, then Attachment 1 (tax lot map), needs to be included.

1.2 Lessor #2 is the (Check one):  
 Not applicable  
 Official representative of \_\_\_\_\_, the irrigation district which conveys water to the subject water rights.  
 Another party with an interest in the subject water rights representing \_\_\_\_\_.

1.3 For the water right(s) being leased, list all water rights appurtenant to the same lands. Indicate if there are any supplemental or overlying rights.

Certificate No. T-10160

1.4 Are some or all of the lands being leased part of a Conservation Reserve Enhancement Program.  Yes  No

**1.5 Water Rights Proposed to be Leased Instream.**

The first right to be leased identified in Section 1.3 is further described as follows:

Certificate No.: T-10160

Priority date: 3/31/1910 Type of use: Municipal

Legal Season of Use: 4/1-10/1

Is the entire water right certificate being leased?  Yes  No

If no, list the acres of the subject water right by legal description of township, range, section, and ¼ ¼ which will be dried up as part of this lease, and include a map (Attachment 2) showing the lands which will not receive water.

Place of use: T S, R W, Section 5, ¼ ¼ - acres to be leased

Enter additional places of use here, using format above:

\_\_\_\_\_

Page \_\_\_\_\_ (Identify page number of certificate, if certificate is greater than 10 pages)

**RECEIVED**

**JUN 30 2008**

**WATER RESOURCES DEPT  
SALEM, OREGON**

Number of acres being leased, if for irrigation: None

Acre-feet of storage, if applicable: \_\_\_\_\_

Maximum rate associated with the right to be leased (cfs): 1.25

(Use additional lines if there is more than one rate associated with the water right.)

Maximum duty associated with the right to be leased (ac-ft): 356.94

(Use additional lines if there is more than one duty associated with the water right.)

Conditions or other limitations, if any:

If you need to enter another leased right, please use the additional water rights form.

**1.6 Validity of rights.** Lessor(s) attests (mark one) that:

- the water has been used over the past five years according to the terms and conditions of the water right certificate or as an instream water right or
- the water has not been used over the past five years according to the terms and conditions of the water right certificate, however the water right is not subject to forfeiture under ORS 540.610(2)(  )(include necessary supporting documentation as Attachment 3).

### ~II~ Instream Water Right Information

**2.1 Public use.** This lease will increase streamflows that will benefit:

- Conservation, maintenance and enhancement of aquatic and fish life, wildlife, and fish and wildlife habitat
- Pollution abatement
- Recreation and scenic attraction

**2.2 Instream use created by lease.** The instream use to be created is described as follows:

Little Butte Creek

Tributary to Rogue River in the Rogue Basin.

Describe the point of diversion (POD) and any associated reach(es) of the instream use being created. If possible list the reach by river mile. If no reach is identified, and there is only one POD listed on the certificate, the lease may be processed to be protected at the POD. (If more than one POD is listed on the certificate, then the POD and any associated reach(es) must be identified): The reach to be protected begins at the POD at RM 1 on North Fork Little Butte Creek – 40 feet North and 620 feet west from the E ¼ corner of section 20, flows into Little Butte Creek and then continues to river mile 0 at the confluence with the Rogue River. The primary points of protection and measurement will be at the Lake Creek gage and at the Eagle Point gage. The water delivered for this lease will be in addition to water delivered into Little Butte Creek for other obligations.

Maximum volume in acre-feet: 356.94

Rate in cfs: 1.25

(Use the section below to indicate a more restrictive period of use than allowed by the water right.)

**Conditions to prevent injury, if any:**

- None
- The instream flow will be allocated on a daily average basis up to the described rate from 5/11 through 10/31.

**RECEIVED**

**JUN 30 2008**

**WATER RESOURCES DEPT  
SALEM, OREGON**

- Other (describe): In the event the irrigation district ends the irrigation season prior to October 31, then delivery for this instream right will also stop.

If you need to enter more instream uses, please use the additional water rights form.

**2.3 Term of lease.** This lease shall terminate on October 31, 2010.

**2.4 Flow protection.** The Trustee will regulate use of water from the source, subject to prior appropriation and the agency enforcement guidance, to assure the water is delivered to the point of diversion, and through the reach past junior downstream users, so long as flow is sufficient to meet the demand under priority date of the new instream use (see Section 2.2). As part of regulation activities the watermaster or a designee has access to the point of diversion and place of use for the water rights involved in this lease. No party is required to continuously measure the flow of the waterway described in Section 2.2.

### ~III~ Other Information

**3.1 Accuracy.** The Undersigned Lessor(s) and Lessee(s) declare that, to the best of their knowledge and belief, the information contained in this application is true, correct and complete. If after the lease order is signed, any information is determined to be false, the lease order may be modified or terminated. The lease only exercises the water rights being leased, for the term of the lease. It shall not be construed to overcome any claim that the water right may otherwise be subject to forfeiture for nonuse pursuant to ORS 540.610 during the period of time prior to the execution of the lease.

**3.2 Lease.** Lessor(s) and Lessee(s) agree to lease the water rights listed in Section(s) 1.5 for instream use for the term of this lease through Lessee to the Trustee, the Oregon Water Resources Department, pursuant to the provisions of ORS 537.348(2) and OAR 690-077.

**3.3 Precedent.** If a right which has been leased is later proposed to be leased again or transferred to an instream use under ORS 537.348 and OAR 690-077 a new injury review shall be required, and a prior lease shall not set a precedent for the amount of water to be leased or transferred instream.

**3.4 Suspension of original use.** During the period of the lease, the water right holder agrees to suspend use of water allowed under the subject water rights and under any water right that is supplemental to the subject water rights.

**3.5 Termination provision.**

For multiyear leases, the Lessor(s) shall have the option of terminating the lease each year with written notice to the Department. The lease may be terminated at any time during the calendar year. However, if the termination request is received less than 30-days prior to the period of allowed instream use or after the period of allowed use has begun for the water right(s) being leased, water may not be used under the right(s) leased until the following calendar year, unless the Director determines that enlargement would not occur. The Department may also require:

- Written notice to the Department with original signatures;
- Consent by all parties to the lease; and/or
- Written notice to the Watermaster's office.

For multiyear leases, the lessor shall not have the option of terminating the lease without consent by all parties to the lease.

RECEIVED

JUN 30 2008

WATER RESOURCES DEPT  
SALEM, OREGON

3.6 **Modification to prevent injury.** Allocation of water to the instream use described in Section 2.2 during the term of this lease is not reasonably expected to cause injury to other rights to use water from the same source. If injury is found after this lease is signed, the lease may be modified or terminated to prevent injury.

3.7 **Fees.** Pursuant to ORS 536.050, the following fee is included:

- \$200 for an application with four or more landowners or four or more water rights.
- \$100 for all other applications.

Lessor #1:

Co-lessor: Brian Hempe

Date: 6-19-08

Rogue River Valley Irrigation District

For additional Lessors, type in space for signature and date

Co-lessor:

David Samuel  
City of Eagle Point

Date: 6/19/08

Lessee:

Oregon Water Trust

Date: \_\_\_\_\_

Other Attachments as Needed:

Attachment 1: Tax Lot Map. (See instructions.)

Attachment 2: Detailed map illustrating lands under subject rights to be leased; required if only part of a right is being leased instream. (See instructions.)

Attachment 3: Supporting documentation indicating why a right is valid and not subject to forfeiture even though the right has not been exercised for five or more consecutive years (required if the second box in Section 1.6 is checked).

Attachment 4: Split Season Instream Use Form

**RECEIVED**  
JUN 30 2008  
WATER RESOURCES DEPT  
SALEM, OREGON

Map for  
Claim of Beneficial Use  
City of Eagle Point  
T-10160

Detail of POD  
T 36 S, R 2 W, Sec 13, W.M.  
Scale 1" = 1320

POD from Rogue River  
9961.8 ft S. & 1883.3 ft E  
from the NE Cor. DLC 42  
SW NW Sec. 13  
T 36 S, R 2 W, W.M.

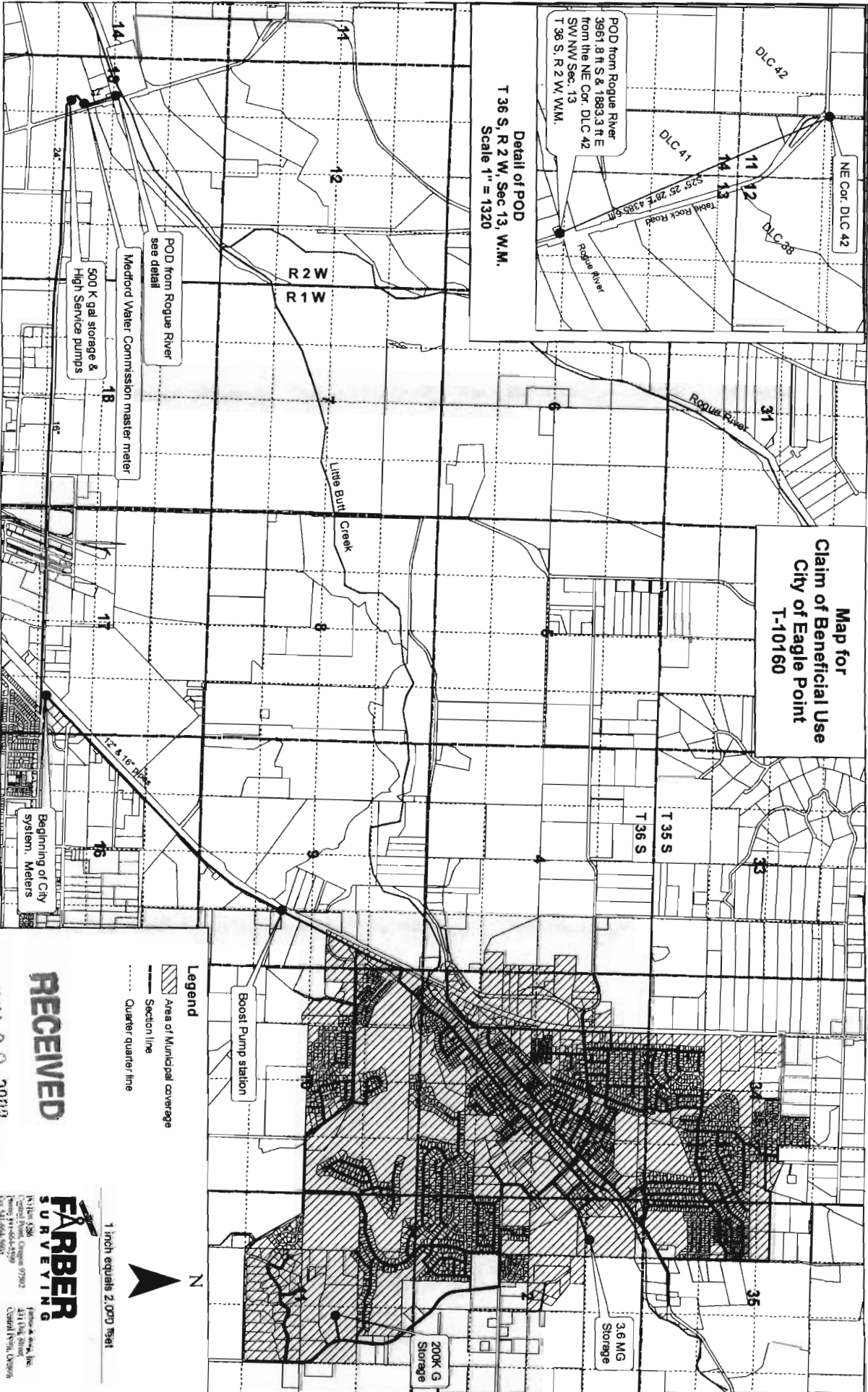

POD from Rogue River  
see detail

500 K gal storage &  
High Service pumps

Medford Water Commission master meter

Beginning of City  
system, Meters

- Legend**
- Area of Municipal coverage
  - Section line
  - Quarter quarter line

1 inch equals 2,000 feet

**RECEIVED**

JUN 30 2014

WATER RESOURCES DEPT  
SALEM, OREGON

**FARBER**  
SURVEYING  
1511 NW 12th St  
Gresham, OR 97030  
Phone: 503-662-2229  
Fax: 503-662-2229  
www.farbersurveying.com  
Toll-free: 800-541-1173