

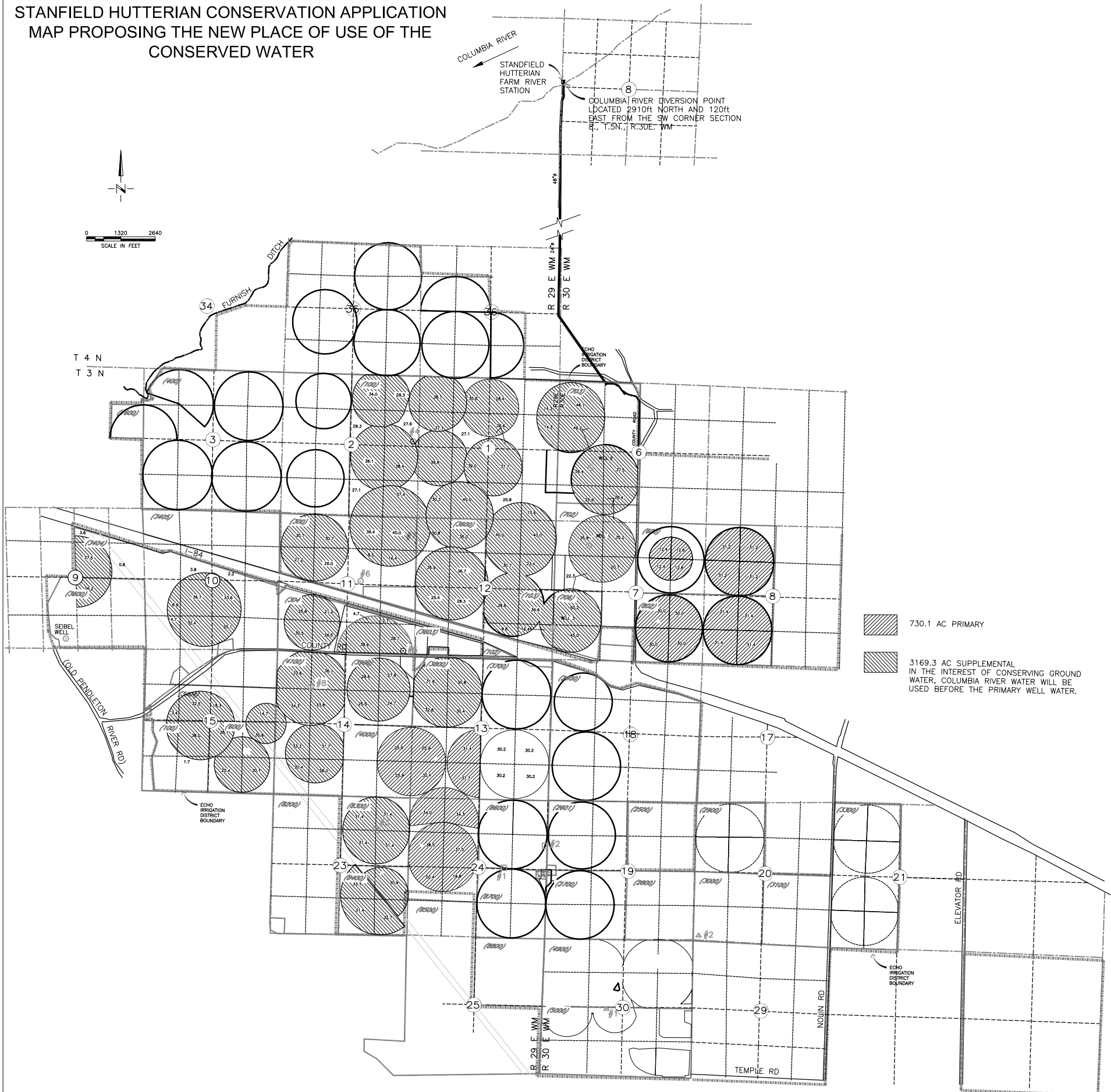

**STANFIELD HUTTERIAN CONSERVATION APPLICATION
MAP PROPOSING THE NEW PLACE OF USE OF THE
CONSERVED WATER**



 730.1 AC PRIMARY
 3169.3 AC SUPPLEMENTAL
 IN THE INTEREST OF CONSERVING GROUND WATER, COLUMBIA RIVER WATER WILL BE USED BEFORE THE PRIMARY WELL WATER.