

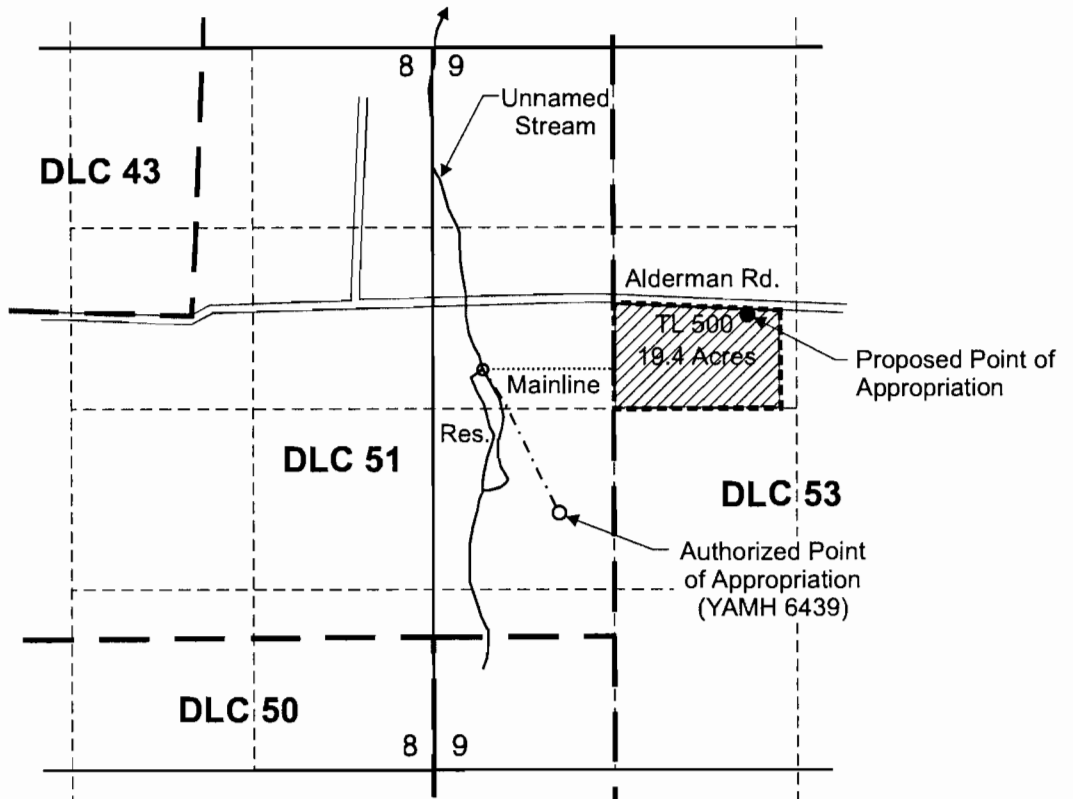

T.5S. R.3W. Sec. 8 & 9, W.M.



Authorized point of appropriation (YAMH 6439) is located 1,880 feet north and 920 feet east from the SW corner of Section 9.

Proposed new point of appropriation is located 3,335 feet north and 2,285 feet east from the SW corner of Section 9.

 Area (19.4 Acres) irrigated under Certificate 84840.

 Tax lot Boundary

RECEIVED

NOV 25 2008



EXPIRATION DATE 6/30/09



Scale: 1" = 1,320'



This map was prepared for the purpose of identifying the location of a water right only and is not intended to provide legal dimensions or location of property ownership lines.

CarltonCOBU.cdr

T 10735

Pacific Hydro-Geology Inc.

Transfer Application Map
Holbrook Farm

Carlton Plants
T.5S. R.3W. Sec. 9

10/2008