

NW¼ -NE¼

NE¼ -NE¼

33 34

SURFACE WATER TO GROUND WATER TRANSFER APPLICATION MAP

Deschutes Valley Water District
SEC 33, T.12S., R.12E., W.M. TAX LOT 2800

EXPLANATION

- Section Lines —————
- Quarter - Quarter - - - - -
- Section Lines —————

NOTES

- Horizontal distances from section corner to proposed wells are based on March 17, 1998 survey data by Dejarnatt Land Surveys, Inc. And are rounded to the nearest 10 feet.
- This map was prepared for the purpose of identifying the location of proposed point of diversion transfer only and is not intended to provide legal dimensions or locations of property ownership lines.
- Partial transfer - 10.38 cfs Certificate 83733 from existing point of diversion at Opal Springs to new points of appropriation at well numbers 1-9.
- Existing point of diversion for Certificate 83733 is at Opal Springs 1215 feet north, 1940 feet west from east 1/4 corner of section 33.

Existing Point of Diversion for Certificate 83733 (Opal Springs).
10.38cfs of Certificate 83733 is to be transferred to new Points of Appropriation at Well No.'s 1 through 9.

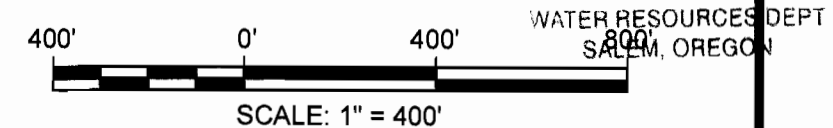
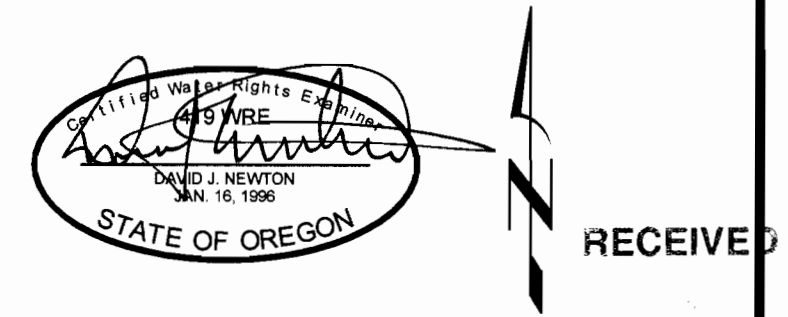
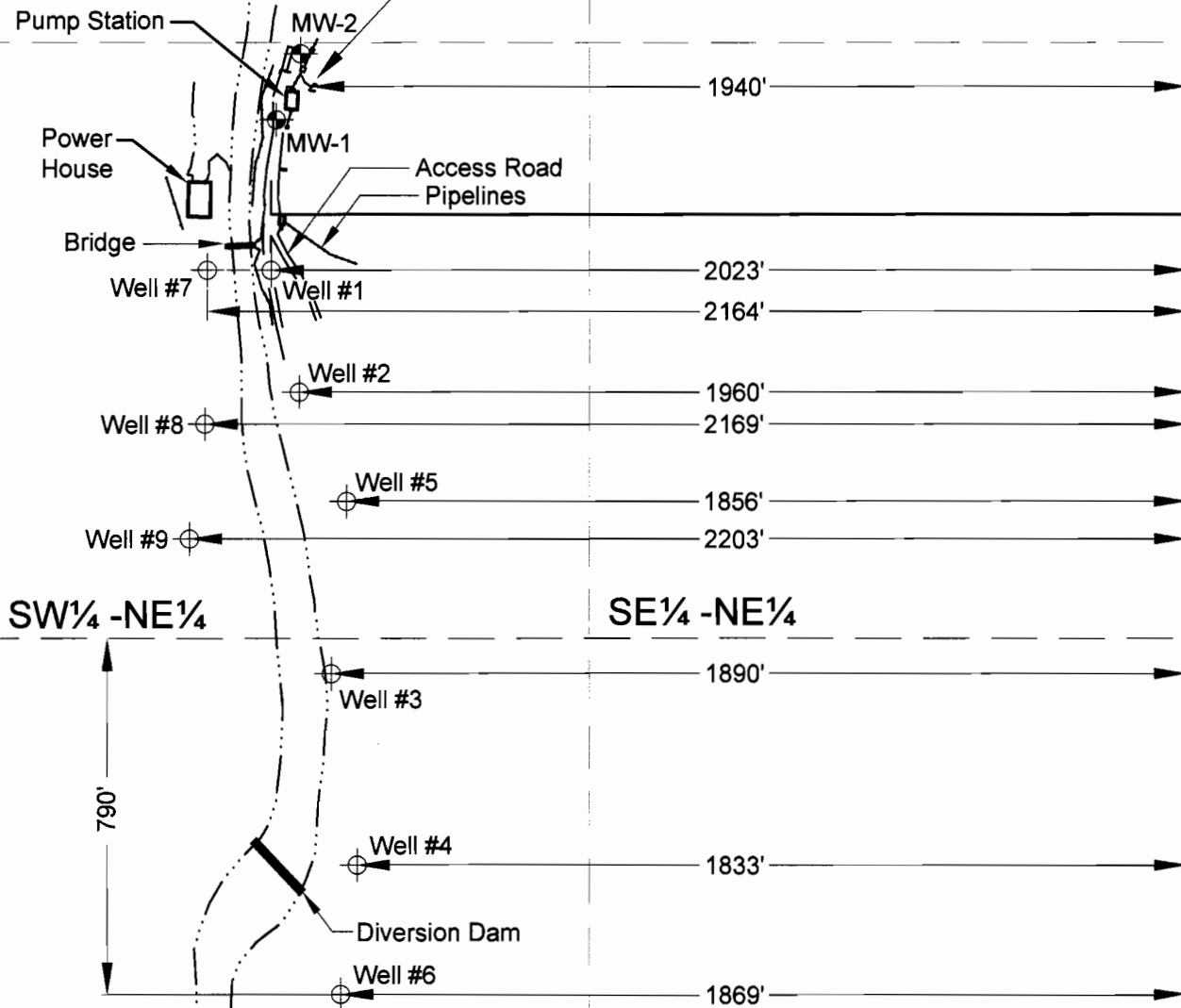

NEWTON
CONSULTANTS INC.
Earth, Water and Rock Specialists
Ph. 541 504-9960 Fax. 541 504-9961

Surface Water to Ground Water
Point of Diversion Transfer Application Map
Deschutes Valley Water District
Jefferson County, Oregon

DESIGNED BY: D. Newton	DRAWN BY: S. Schenck	DATE: FEB 2009	PROJECT NO. 450-109	FIGURE 1
---------------------------	-------------------------	-------------------	------------------------	----------

G:\0400\450\109\Cad\Water\W450109_F1_POD 08:48 02/25/2009 SS