

5/23/00

T.26S., R.18E., W.M.

Copy

This map is in error. the section/quarter-quarter lines are off. all land is located ~~at~~ within the 1/2 of sections 31 & 32. OK to correct based upon a request of the landowner per OAR 690-15-400 when requested

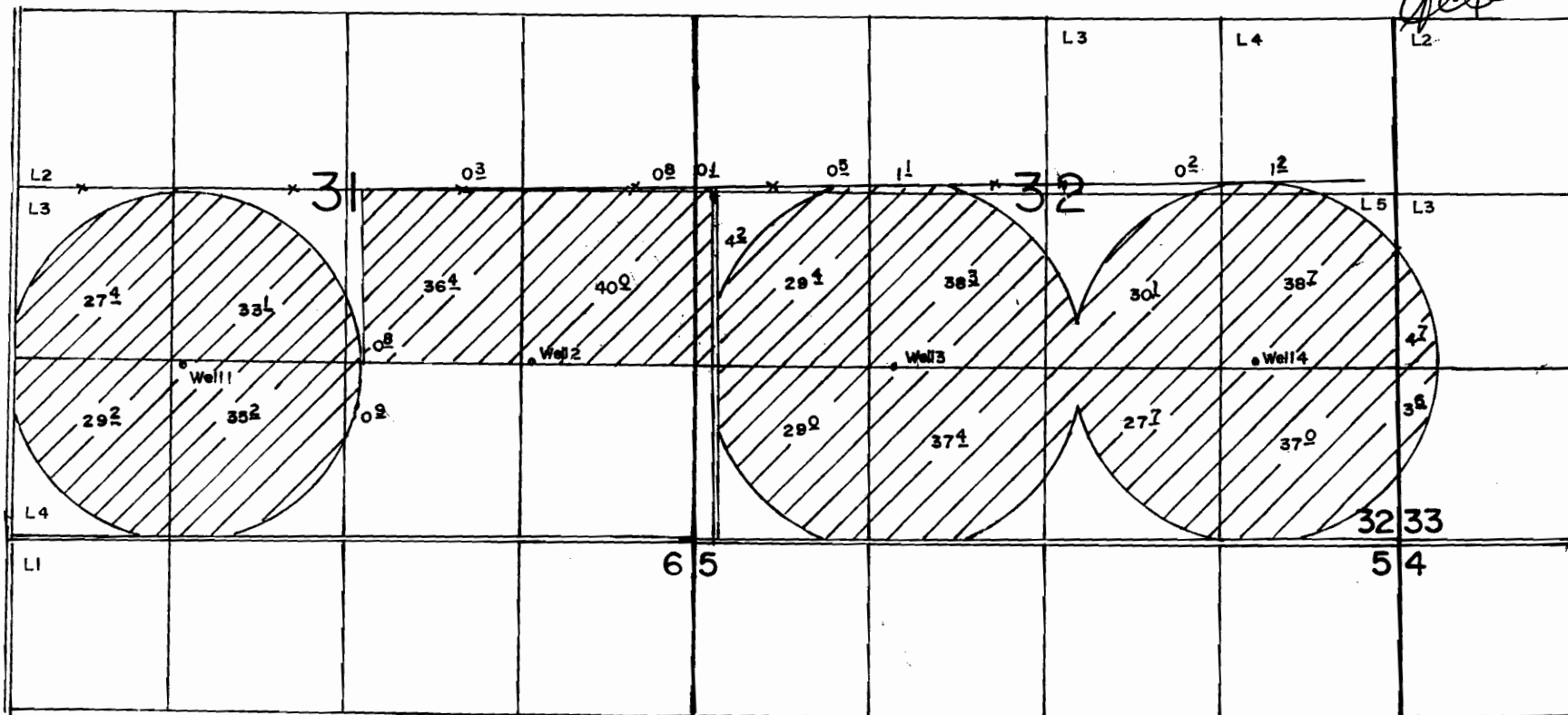

Well 1-1300' N&1230' W, Well 2-1350' N&1400' E, Both From S1/4 Cor. Sec 31 Well 3-1340' N&1150' W, Well 4-1360' N&1580' E, Both From S1/4 Cor Sec 32

FINAL PROOF SURVEY

UNDER

Application No G-10071 Permit No G-9124

IN NAME OF

TERRY L NOFZIGER

Surveyed June 14 1990 By B.W. BISHOP

PTS II-1990 9-5-90 DLM