

**JON C. AND KAREN S. TUCKER**  
 P. O. Box 615  
 Stayton, Oregon 97383

MAR 13 2009

**TRANSFER MAP**  
 For  
 Surface Water POD to Ground Water POA

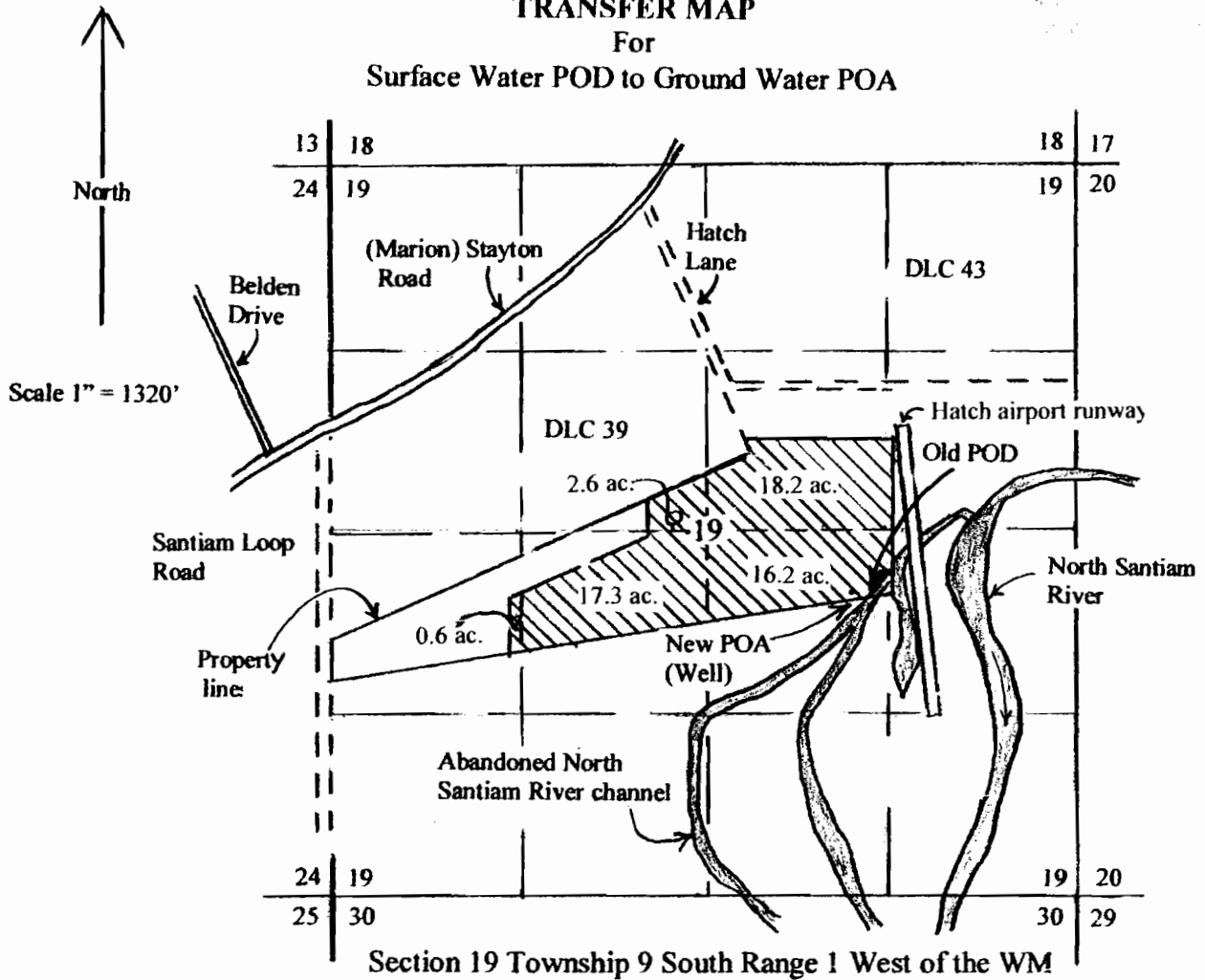

New POA is 3140' South and 1630'  
 West from the NE corner Section 19

- Property lines
- Irrigation boundary
- ▨ Irrigated area (Certificate 23864)

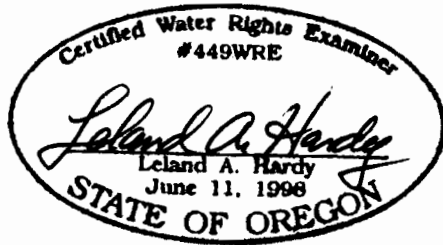

RENEWAL DATE: 06/2009

This map was prepared for the purpose of identifying the location of a new Point of Appropriation (POA) and is not intended to provide legal ownership lines.