

KERN'S RAINBOW RANCH, Inc.

4
58.7

C.eger. Ln.



T 7975

4121
431
T 3464 TRANSFER
PLACE of APPROPRIATION

T 3465

R 3061

T 88

R 306



29
125.6

32
44.0

31
11.5

138.6

78
80.4 NW

30
7.8

RECEIVED
APR - 6 1998
WATER RESOURCES DEPT.
SALEM, OREGON

52.3 NW

5
15.4

N.C
WILLOW

CREAK

A 130

ASCS AERIAL PHOTO

KERNS RAINBOW RANCH, INC.

4
58.7

C.eger. Ln.

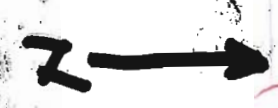

(App'l G-13794
Permit G-13157)
T 7975

PLATE OF APPROPRIATION
T 3464 TRANSFER

T 88

R 30 E

R 39 E



32
44.0

(X) NW

29
125.6

PC

PC

31
11.5

28
80.4 NW

(X) NW 30
7.8

Remainder
413/57

138.6

RECEIVED
APR - 6 1998
WATER RESOURCES DEPT.
SALEM, OREGON

ASCS AERIAL PHOTO

A+30

4
52.3

(X) NW

5
15.4

(X) NW

N.C
WILLOW

COYOTE

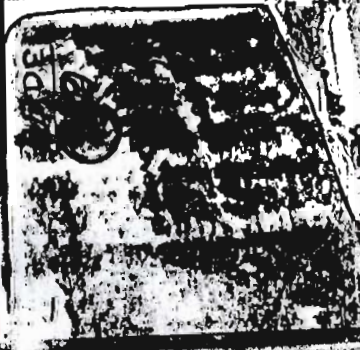

DIAGRAM TO ACCOMPANY
TRANSFER PLACE OF APPROPRIATION
(NOT TO SCALE)

R39E 617
R38E 112

T8S

SCHOOLHOUSE Rd (Co. road)

N

PROPERTY LINE FENCE

434' = b

20'

1305' = a

BORROW PIT
FENCE

20'

40'

WILLOW
CREEK

PROPERTY LINE

PROPOSED WELL SITE
TRANSFER PLACE OF APPROPRIATION

1321.5' = c

RECEIVED
APR - 6 1998
WATER RESOURCES DEPT.
SALEM, OREGON

KERNS
RAINBOW
RANCH, INC.

T 7975

G 15794 AMENDED MAP

KERN'S RAINBOW RANCH, IN

17975

THIS MAP IS FOR THE PURPOSE OF IDENTIFYING THE WATER RIGHT LOCATION ONLY AND HAS NO INTENT TO PROVIDE DIMENSIONS OR LOCATION OF PROPERTY OWNERSHIP LINES.

P. 38 E.
P. 39 E.

T. 7 S.
R. 8 S.

S. 1 E.
C. 1 E.

LEGEND

	P 11773	180 ac.	—
	G 13794	180 ac.	ORIGINAL
	G 13794	241 ac.	ADDITIONAL

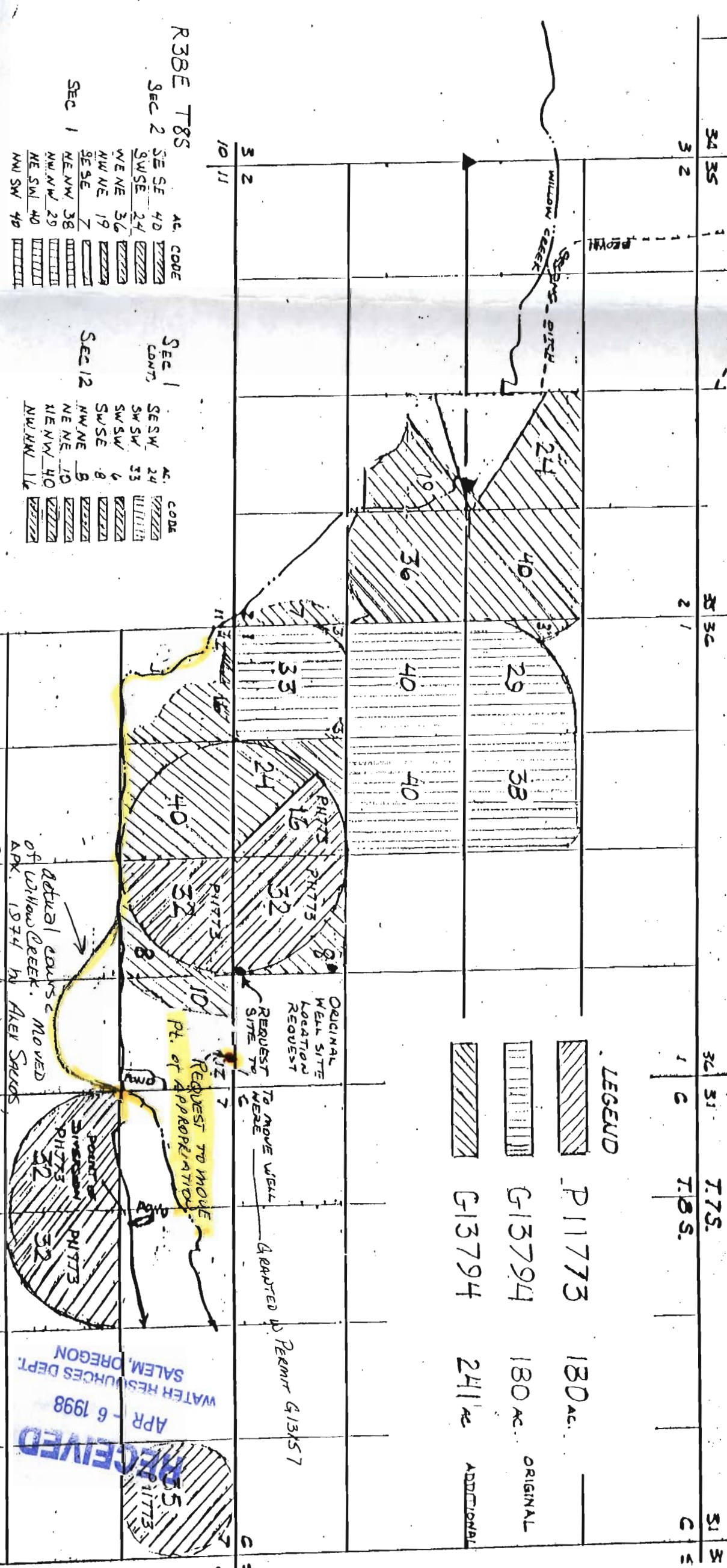

R 38 E T 8 S

SEC 1	AC.	CODE
SE SE	40	
SW SE	24	
NE NE	36	
NW NE	19	
SE SE	7	
NE NW	38	
NW NW	29	
NE SW	40	
NW SW	40	

SEC 1	AC.	CODE
SE SW	24	
SW SW	33	
SW SW	6	
SW SE	8	
NW NE	8	
NE NE	10	
NE NW	40	
NW NW	16	

ORIGINAL WELL SITE LOCATION REQUEST REQUEST TO MOVE WELL TO HERE PERMIT G13857

Actual course moved of Willow Creek. APR. 1974 by Aker Saldis

POINT OF APPROXIMATION

RECEIVED APR - 6 1998 WATER RESOURCES DEPT. SALEM, OREGON