

T.7S., R.1W., W.M.

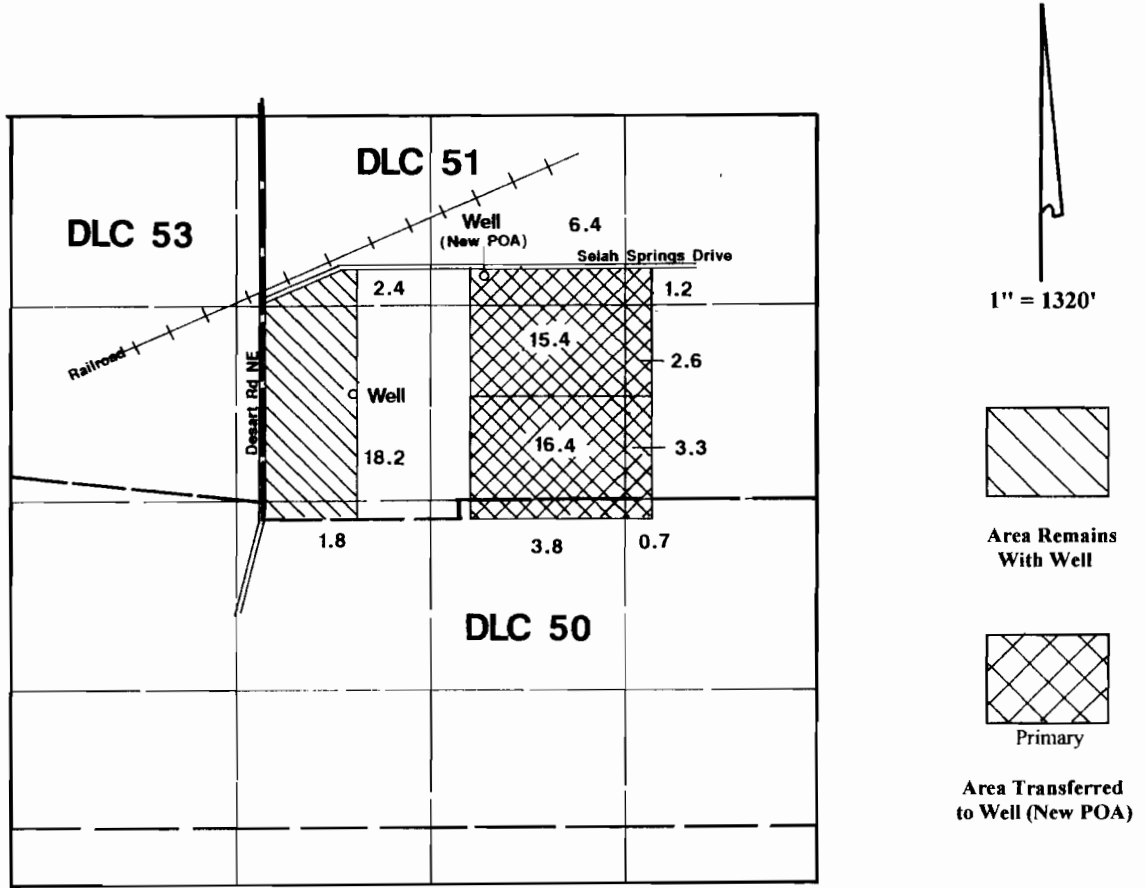

Well is located 860'N & 620'E from SW corner of T. Shaw DLC 51.
 Well (New POA) is located 1705 'N & 1532' E from SW corner of T. Shaw DLC 51.

RECEIVED

APR 29 2009

WATER RESOURCES DEPT
 SALEM, OREGON

Application Map

RECEIVED

Stan A. Herr & Greg L. Herr

MAY 01 2009

Transfer #:

WATER RESOURCES DEPT
 SALEM, OREGON

This Map was Prepared for the Purpose of Identifying the Location of a Water Right Only and is Not Intended to Provide

